



Workshop literature

STILL
ELECTRONIC
DOCUMENTATION
SYSTEM

Order Picker

CX 20
CX-M 10
CX-S 16
CX-Z 30



1044 1045 1046 1047

51038070901 EN - 11.2010

first in intralogistics



CLICK HERE TO **DOWNLOAD** THE COMPLETE MANUAL

- Thank you very much for reading the preview of the manual.
- You can download the complete manual from: www.heydownloads.com by clicking the link below



- Please note: If there is no response to CLICKING the link, please download this PDF first and then click on it.

CLICK HERE TO **DOWNLOAD** THE COMPLETE MANUAL

CXZ 30

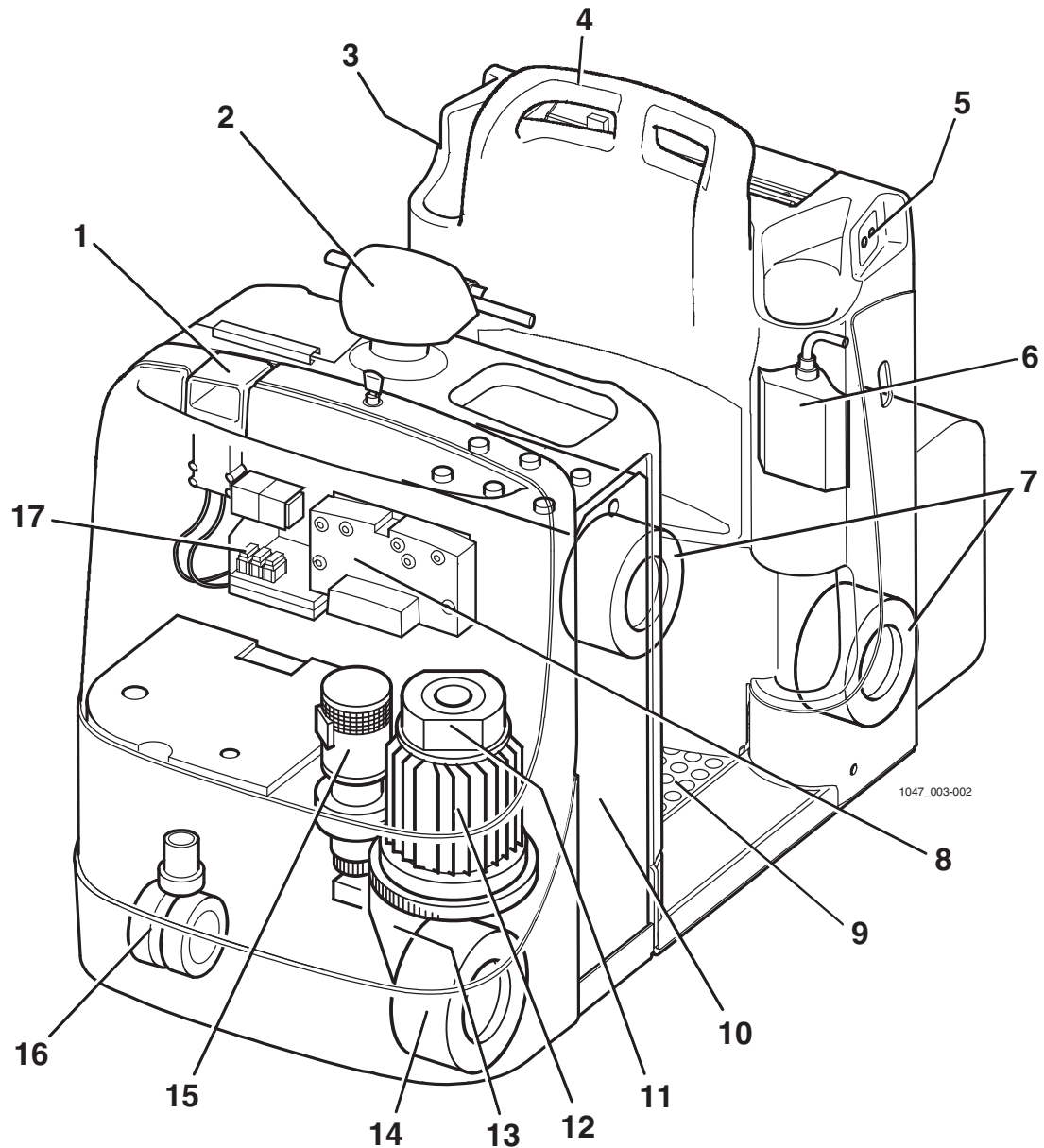

- | | | | |
|---|--|----|------------------|
| 1 | Battery connector | 10 | Traction battery |
| 2 | Handlebar | 11 | Brake |
| 3 | Button for driving in pedestrian mode (option) | 12 | Traction motor |
| 4 | Backrest | 13 | Gearbox |
| 5 | Button for driving in pedestrian mode (option) | 14 | Traction wheel |
| 6 | Shackle-type tow coupling | 15 | Steering motor |
| 7 | Wheels | 16 | Stabiliser wheel |
| 8 | Steering and traction current controller | 17 | Fuse carrier |
| 9 | Platform | | |

Dimensions

CX 10 M

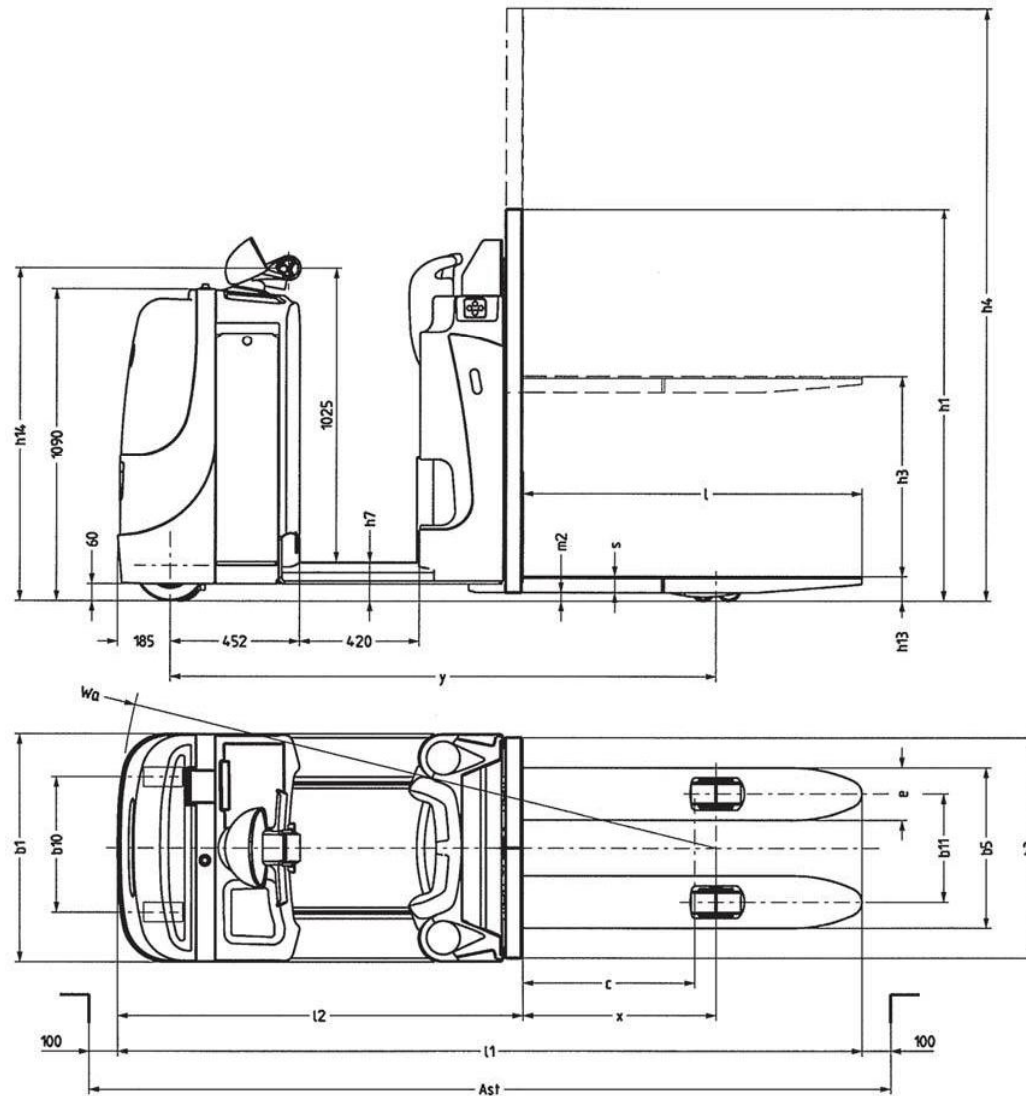

1045_000-003

Data sheet VDI

Characteristics

			CX 10 M
Manufacturer's model designation			STILL GmbH
Platform			Fixed
Power source: Battery, diesel, petrol, LP gas, mains power			Battery
Operator type: Hand, pedestrian, stand-on, seated, order picker			Stand-on
Load capacity / hoisted load		Q (kg)	1000
Load centre		c (mm)	600

CX 10 M

Dimension	(in mm)
b ₅	565

Dimension	(in mm)
L	1185
X	675

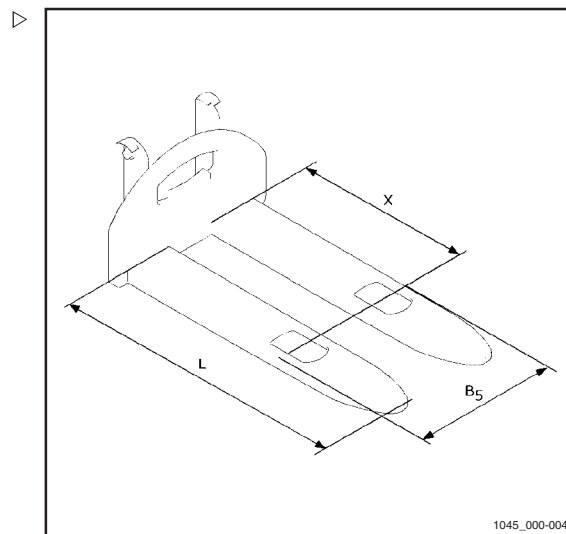

CX 16 S

Dimension	(in mm)
b ₅	540

Dimension	(in mm)
L	2887
X	1542

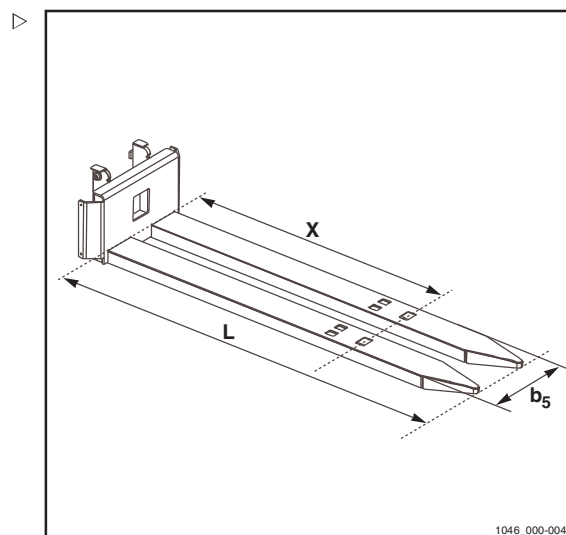

Extra-length test clips, pair

(Ident. No.: 143 424)

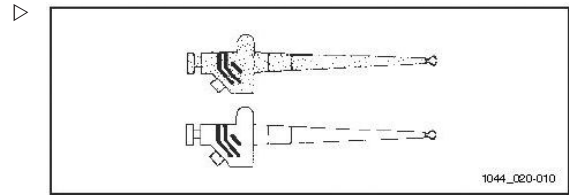

Desoldering tool

(Ident. No.: 1 675 079)

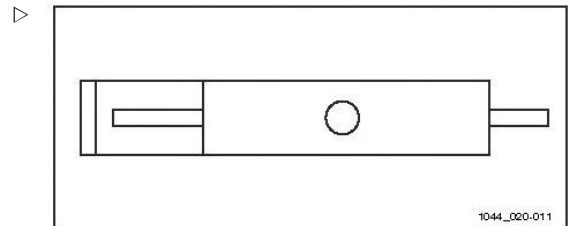

Crimping tool

(Ident. No.: 144 087)

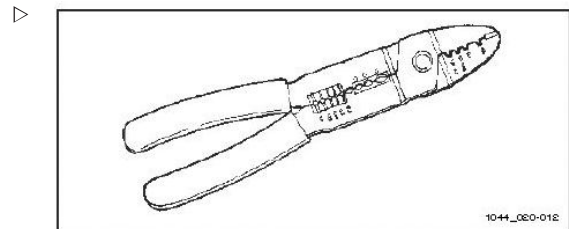

Connector 2-pin, 4-pin, 6-pin

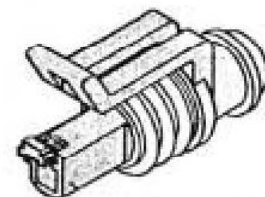
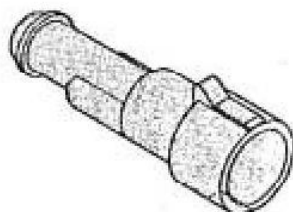
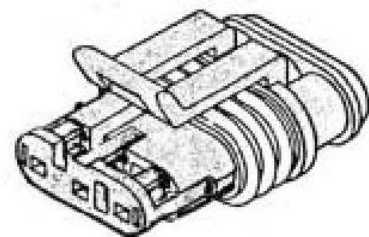
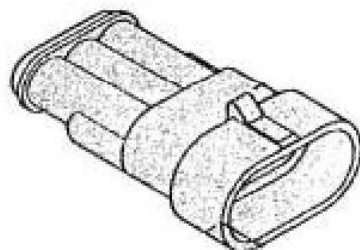

Connector 2-pin (female connector: Ident. No.: 4480621; male connector: Ident. No.: 4480385)

Connector 4-pin (female connector: Ident. No.: 4478840; male connector: Ident. No.: 4478840)

Connector 6-pin (female connector: Ident. No.: 4480261; male connector: Ident. No.: 4478839)

For precise measurements you need a suitable calibrated test instrument.

Loading and saving

These functions allow the following:

- Loading of data into the "F3: Setup" menu from the existing truck data (**truck -> PC**) or from a text configuration file ('ptx' format) or binary file (**PC "file" -> PC "F3"**).
- Saving of the values contained in the "F3: Setup" menu into the vehicle (**PC -> vehicle**) or into a text configuration file ('ptx' format) or binary file (**PC "F3" -> PC "file"**).
- After selecting the type of saving, you can choose the data you want to save by making the appropriate selection in the following window:



1044_021-013-en

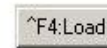

1044_021-018-en



1044_021-019-en

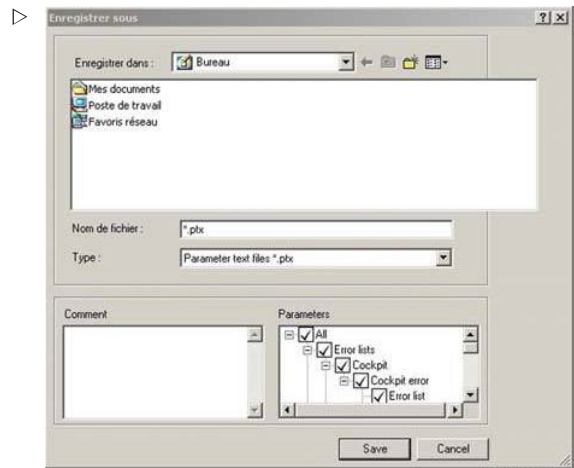

1044_021-020-en

- Printing of parameters
- Keyboard short-cut (fast access to a diagnosis screen)
- Reloading of the parameters due to errors on one or more pages of the diagnosed truck.



1044_021-021-en

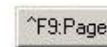

1044_021-022-en

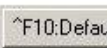

1044_021-023-en

Problem of asymmetry in the steering

To determine an asymmetry in the electric steering select

- **[F4:Monitor]**.
- Select the "Electric steering" tab.
- Select "Speed reduction when cornering".

Reduction gear

Removal of the reduction gear

Removal

- Disconnect the battery connector.
- Block up the truck 350 mm above the floor (1). ▷
- Removal of the traction motor ⇒ Chapter "Traction motor - removal and installation", P. 11- 2
- Removal of the traction wheel ⇒ Chapter "Traction wheel", P. 46- 1

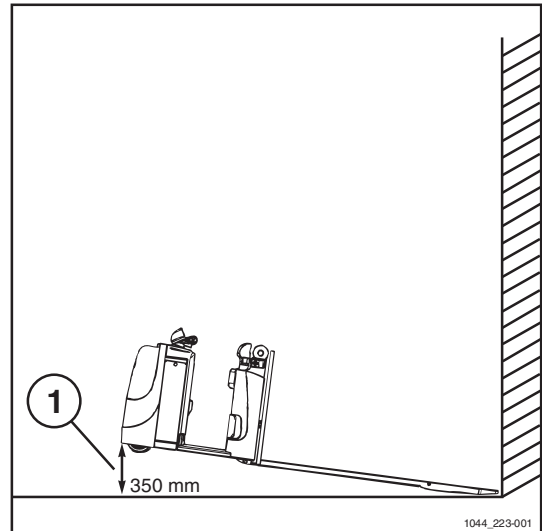

- Allow the oil in the reduction gearbox to drain, carefully remove the particles of metal on the oil drain plug (2). ▷

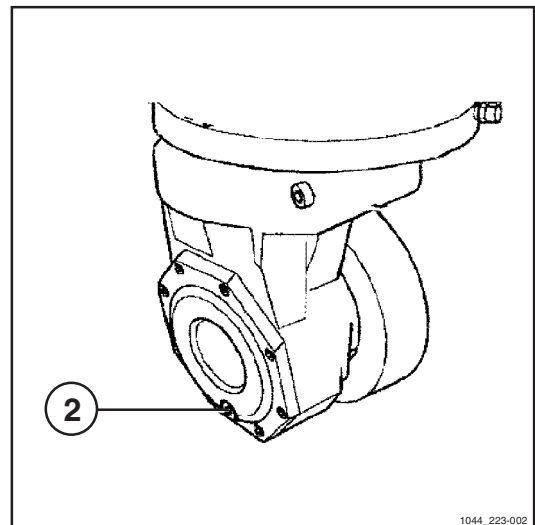

Seat

Folding seat

Removal

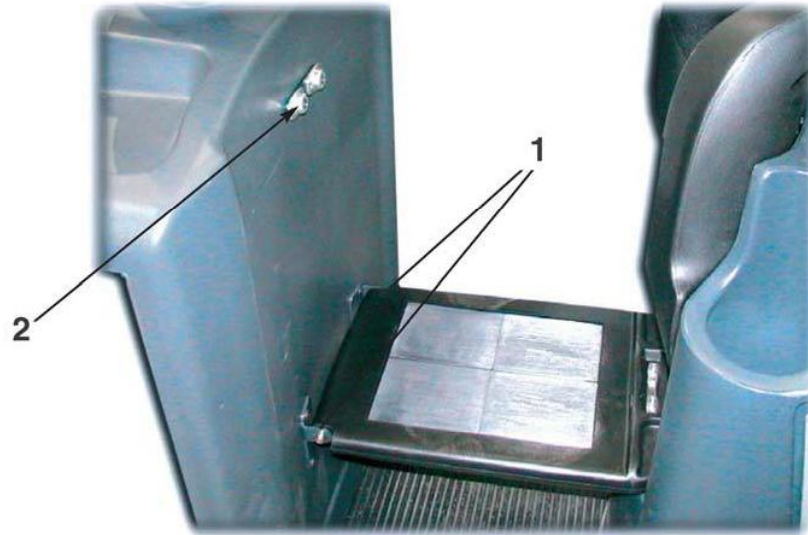

1044_342-001

- To remove the folding seat, unscrew the two nuts (1).

Replacing the seat holders

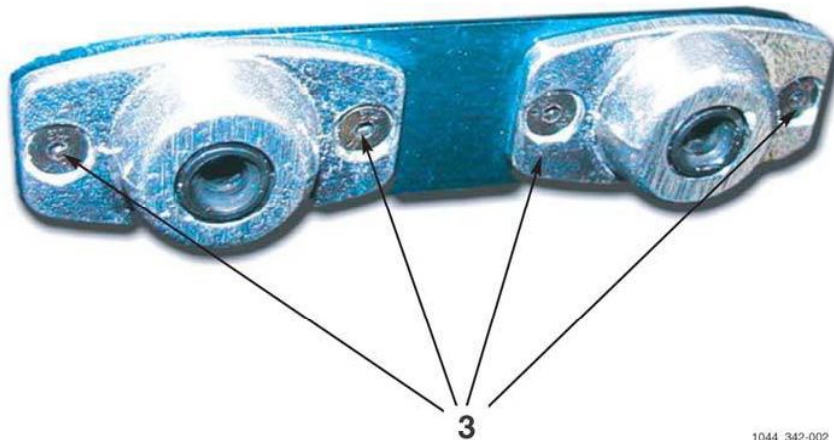

1044_342-002

- To replace the seat holders (2) remove the four fastening screws (3).

CLICK HERE TO **DOWNLOAD** THE COMPLETE MANUAL

- Thank you very much for reading the preview of the manual.
- You can download the complete manual from: www.heydownloads.com by clicking the link below



- Please note: If there is no response to CLICKING the link, please download this PDF first and then click on it.

CLICK HERE TO **DOWNLOAD** THE COMPLETE MANUAL

Wheels

Traction wheel

General

Dimensions of new traction wheel: 250 mm X 100 mm.

The traction wheel must be replaced if:

- the running surface is heavily damaged or not round,
- the diameter of the tyre is reduced by over 10%.

Type of tyre: VULKOLLAN

Removal of the traction wheel

- Disconnect the battery connector.
- Block up the truck 230 mm (1) on squared timbers and secure it against rolling (set against a wall).

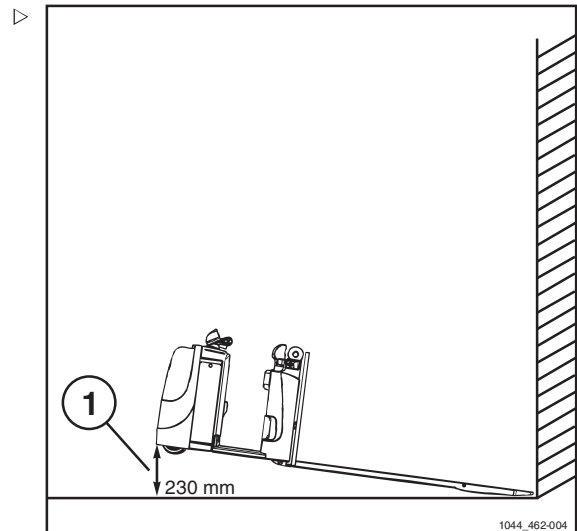

- Turn the traction wheel so that the five wheel nuts (2) can be loosened.
- Remove the wheel nuts (2).
- Remove the traction wheel.

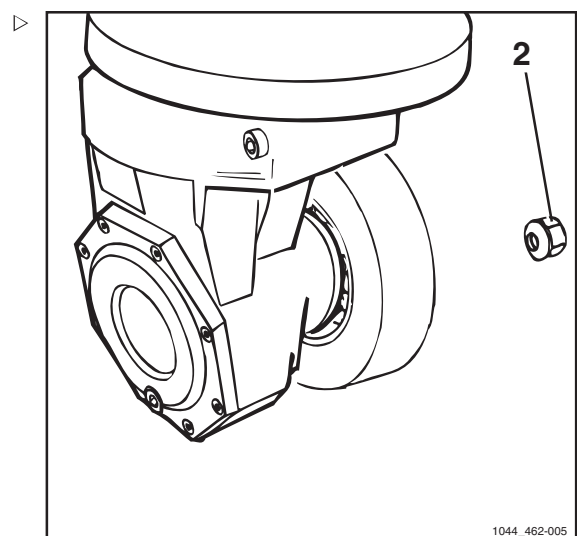

Installation of the traction wheel

- Before installation of the traction wheel, clean its running surface and check it for proper condition.
- Install the traction wheel.
- Tighten the five nuts (2) by hand.
- Tighten opposite nuts (2) to a torque of 140 Nm.
- Adjust the stabiliser.

Brake air gap

- ▷
- Measure the brake air gap with an adjustment shim at three different points separated by 120°.

Air gap "a" must equal $0.2 \text{ mm} -0.05 \text{ mm}/+0.1 \text{ mm}$.

 NOTE

Consider checking the air gap (with the brake released)! The air gap of this brake is not adjustable. It is factory installed with an air gap of 0.3mm.

- *Min. air gap : 0.3mm*
- *Max. air gap : 0.8mm*

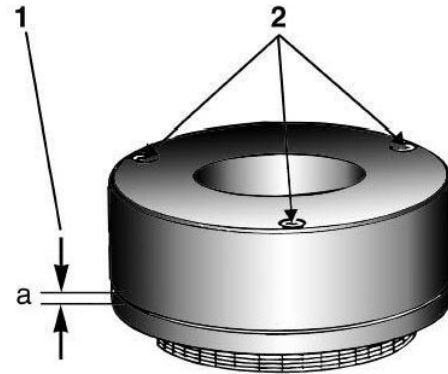

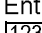
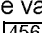
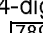

Cockpit (control console)

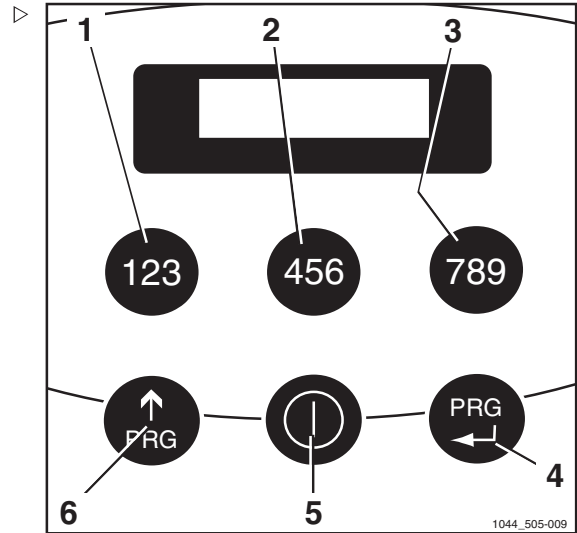
- Push button  (driving) (5).
- Enter the valid 4-digit master code with the  (1),  (2),  (3) buttons.

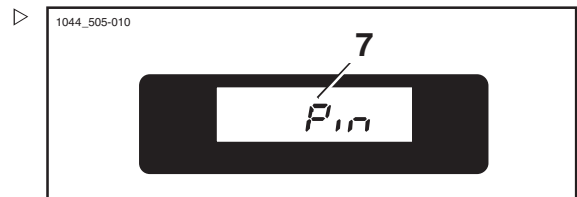

- Scroll with the  (scrolling) button (6) until Pin (7) appears in the display.



- Confirm with the  (enter) button (4) until dEL (10) appears in the display.

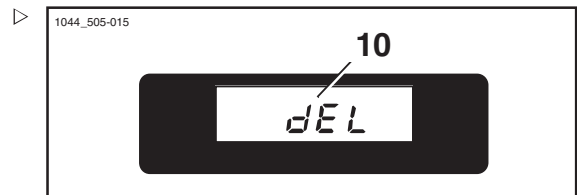

- Confirm with the  (Enter) button (4). A flashing line cursor (8) will appear in the display.
- Enter the 4-digit master code to be deleted with the buttons (1), (2) or (3) as described above.

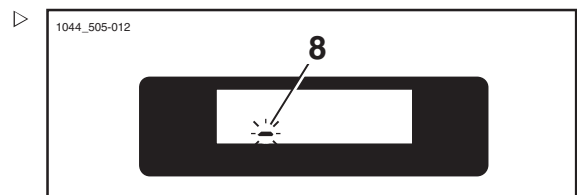

 **NOTE**

If one attempts to delete an erroneous master code, Err will appear in the display. If only one master code remains, None will appear in the display.

- Confirm with the  (enter) button (4) until the master code (9) to be deleted blinks.



Location of components

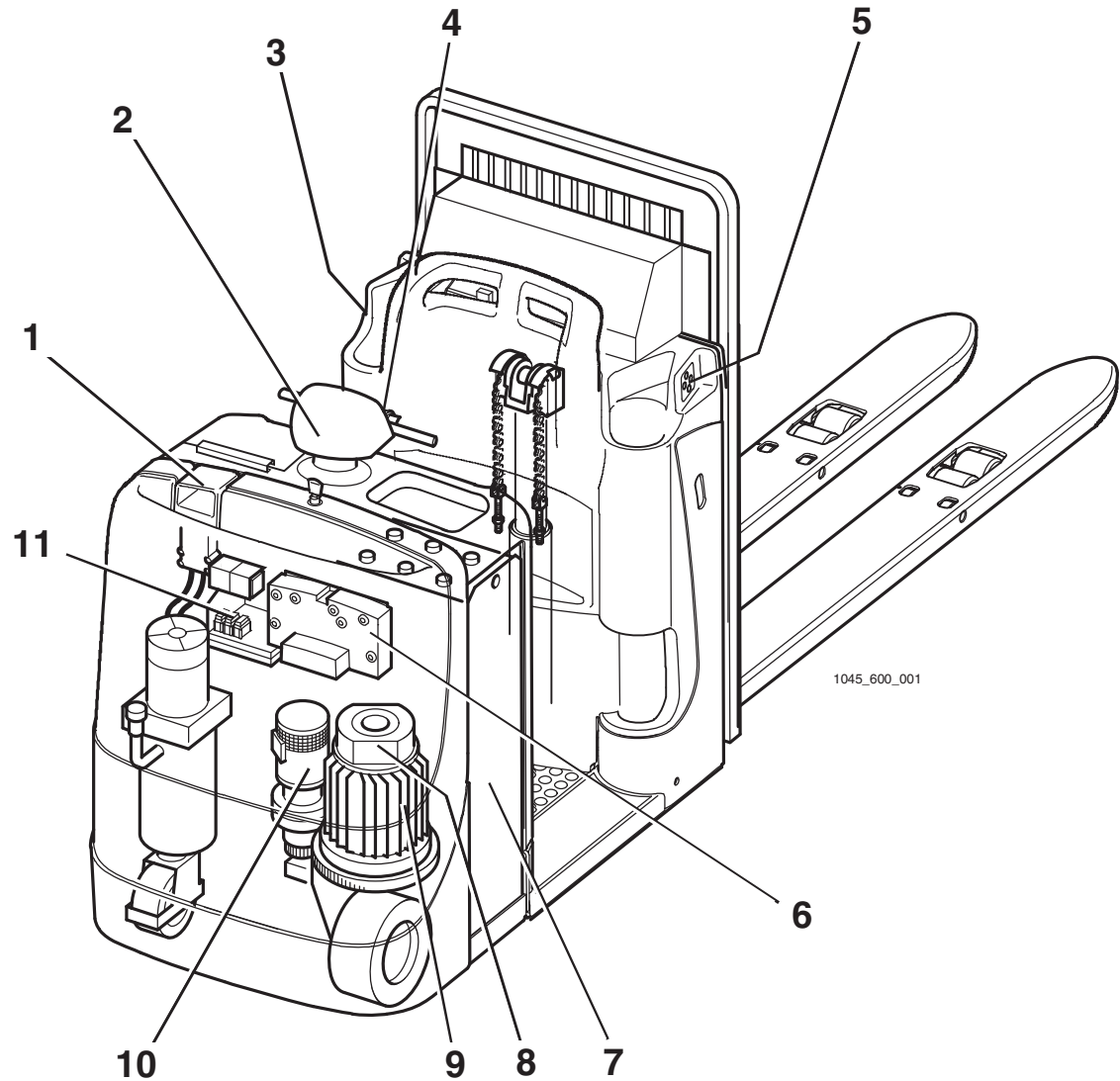

- | | | | |
|---|--|----|------------------|
| 1 | Battery plug | 7 | Traction battery |
| 2 | Cockpit (control console) | 8 | Brake |
| 3 | Button for driving in pedestrian mode (option) | 9 | Traction motor |
| 4 | Belly switch | 10 | Steering motor |
| 5 | Button for driving in pedestrian mode (option) | 11 | Fuse mount |
| 6 | Steering and traction current controller | | |

- Adjust the height of the sensor so that the pump unit cuts out electrically when the forks reach a height of 200 mm (3) from the floor.
- Install the load backrest and torque the four lateral fastening bolts to 25 Nm.

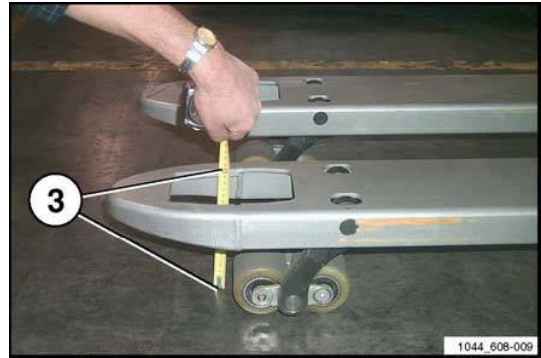

CX 10 M

Removal

- Truck turned off, battery disconnected.
- Remove the 2x2 CHC screws (1) at the bottom of the protective screen on both sides of the truck.



- Remove the screw ((2)), take off the mounting for the protective screen at the fork carriage upwards.

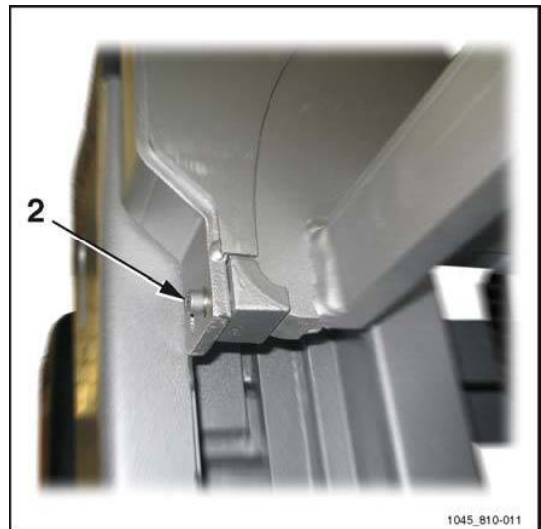

- Remove the two fastening screws (3) at the protective plate on the upper mast cross member.

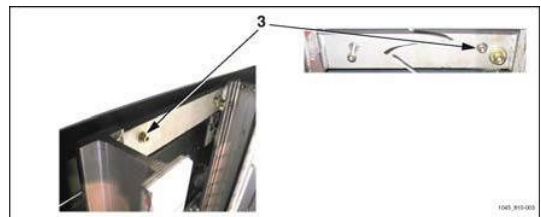

- Under the cover, disconnect the electric connectors (1) on each of the two lateral control buttons for lifting/lowering/forward/reverse (4). Remove the 4 cross-slotted screws under the label and remove the controls upwards (mark the forward travel direction of the truck good, well to avoid an interchanging of the travel directions upon installation ...).



Pump unit

Technical Data

Pump

Type:	K3.823.16.409
Manufacturer	Oil-System
Motor performance:	Motor, 4-pole series
Voltage V	24 V
Current (A):	134 A at 100 bar
Excitation:	No
Power (kW):	2.2 kW
Operating method:	S3 - 8 %
Protection:	IP43
Insulation class:	F
Carbon brushes:	
a) Size:	16 mm
b) Wear limit:	11 mm
c) Quantity (number):	4
d) Carbon brush monitoring:	No
Weight (kg):	11 kg
Ventilation:	No
Pump	
Output:	3.6 cm ³ /rev
Oil capacity (for standard equipment):	
Filter on suction and return:	90 microns
Oil replacement:	Once a year

- Remove the 2 x 2 CHC screws ((1)) at the bottom of the protective screen on both sides of the truck.

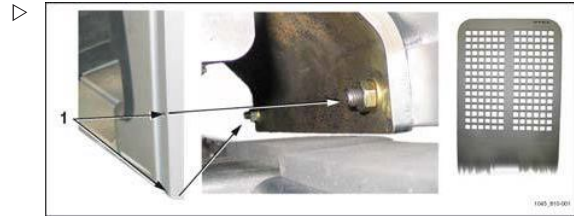

- Remove the screw ((2)), take off the mounting for the protective screen at the fork carriage upwards.

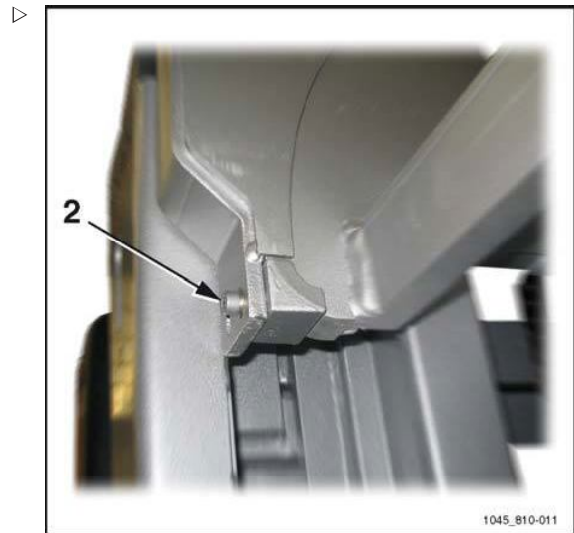

- Remove the two fastening screws ((3)) at the protective plate on the upper mast cross member.

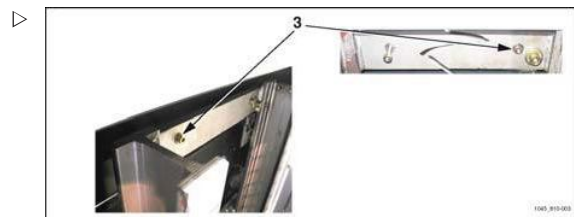

- Under the cover, disconnect the electric connectors (A) on each of the two lateral control buttons for lifting/lowering/forward/reverse (4). Remove the 4 cross-slotted screws under the label and remove the controls upwards (mark the forward travel direction of the truck good, well to avoid an interchanging of the travel directions upon installation ...).



- Remove the 6 fastening screws on the back wall assy. (backrest and plastic housing) (5) on both sides of the mast with the 6 cable ties bundling the electric cables.

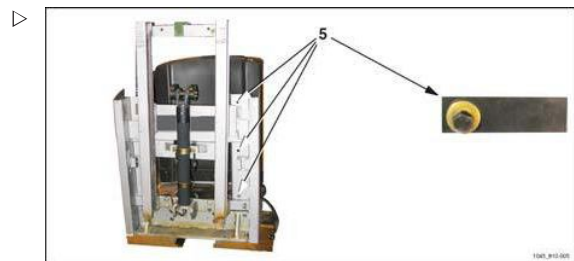

Fork carriage

- Take off both transmitters (6) (remove 2 screws each).

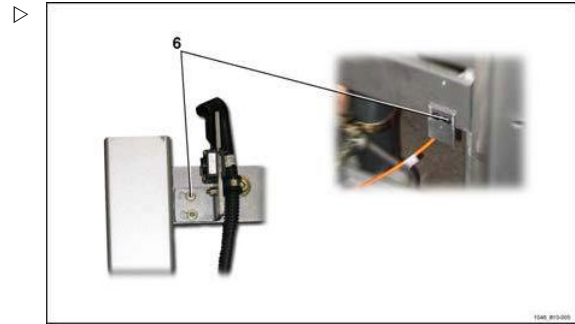

- Remove the 2 screws retaining the chains in their mountings (17).

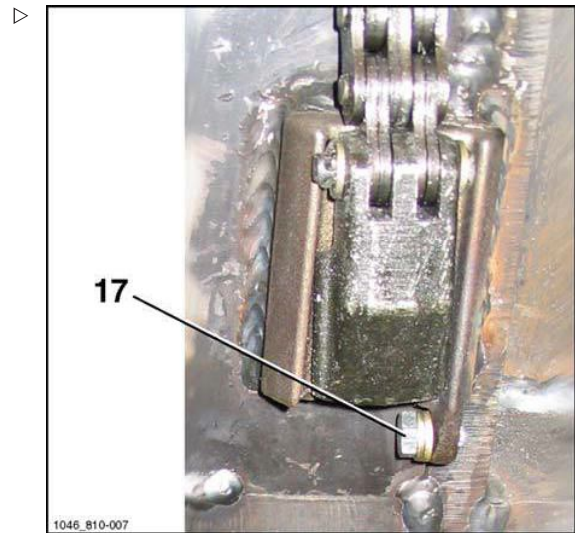

⚠ WARNING

Accident hazard.

For the removal of the forks secure the driver's stand safely (at least 3 resting points).

- Using the hoist, put the truck on squared timbers (the forks and the scissors stay in the raised position).



- Place two squared timbers symmetrically across the scissors, then join the squared timbers with a suitable means so that they can no longer be separated (G).



- Unhook the fork carriage chains. (To relax the chains, press on the head end of the cylinder piston to start a lowering movement.)

CLICK HERE TO **DOWNLOAD** THE COMPLETE MANUAL

- Thank you very much for reading the preview of the manual.
- You can download the complete manual from: www.heydownloads.com by clicking the link below



- Please note: If there is no response to CLICKING the link, please download this PDF first and then click on it.

CLICK HERE TO **DOWNLOAD** THE COMPLETE MANUAL