

STIHL 017, 018

2000-06

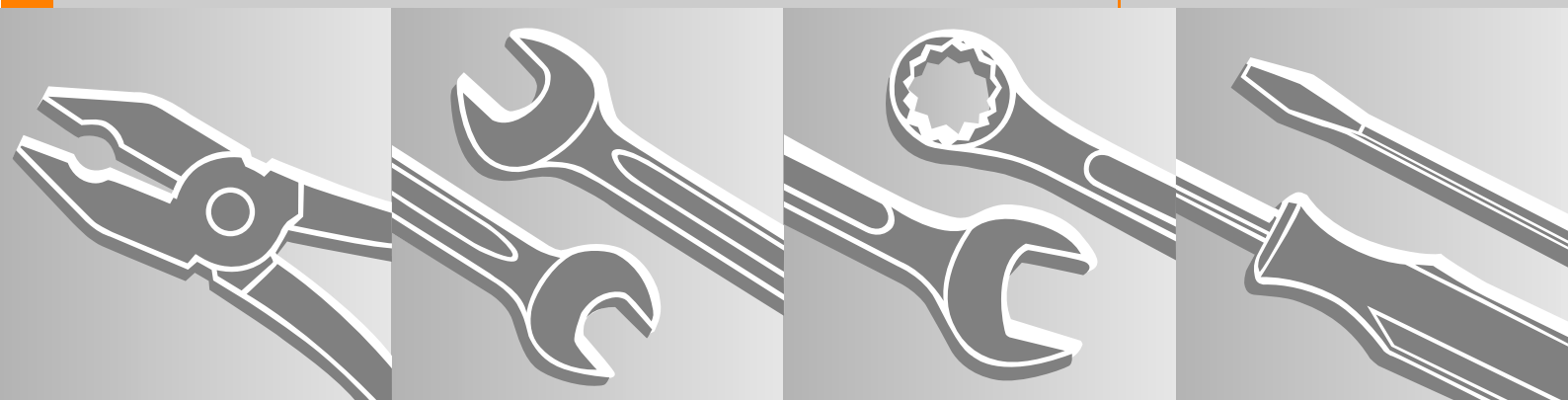

CLICK HERE TO **DOWNLOAD** THE COMPLETE MANUAL

- Thank you very much for reading the preview of the manual.
- You can download the complete manual from: www.heydownloads.com by clicking the link below



- Please note: If there is no response to CLICKING the link, please download this PDF first and then click on it.

CLICK HERE TO **DOWNLOAD** THE COMPLETE MANUAL

3.6 Front Chain Tensioner

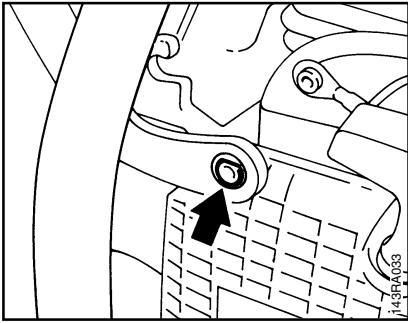

- Fit hand guard over boss on fan housing.
- Insert screw and tighten to 1.7 Nm (1.25 lbf.ft).
- Fit the shroud - see 3.1.

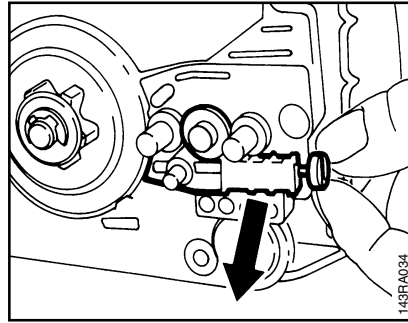

- Remove chain sprocket cover.
- Pull the cover out of the engine housing.

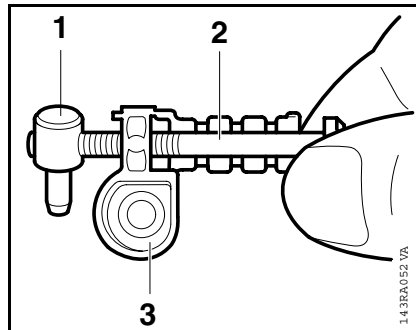

- Unscrew the nut (1) from the adjusting screw (2) and take the adjusting screw out of the cover (3).

Reverse the above sequence to install the chain tensioner.

3.7 Bar Studs

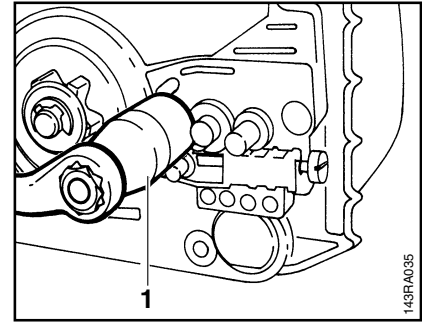

- Remove chain sprocket cover.
- Push the stud puller (1) onto the stud as far as it will go.
- Unscrew the stud.
- Coat thread of stud with Loctite - see 11.2.
- Insert stud and torque down to 16 Nm (11.8 lbf.ft).

5. IGNITION SYSTEM

Warning! Exercise extreme caution when carrying out maintenance and repair work on the ignition system. The high voltages which occur can cause serious or even fatal accidents!

Troubleshooting on the ignition system should always begin at the spark plug. See „General Servicing, Troubleshooting“ handbook.

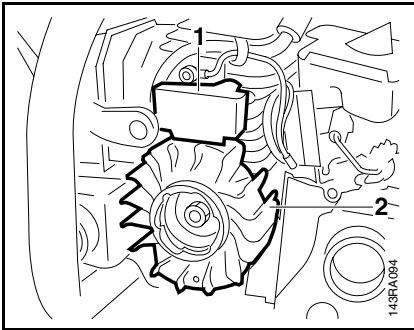

The electronic (breakerless) ignition system basically consists of an ignition module (1) and fly wheel (2).

5.1 Spark Plug Terminal

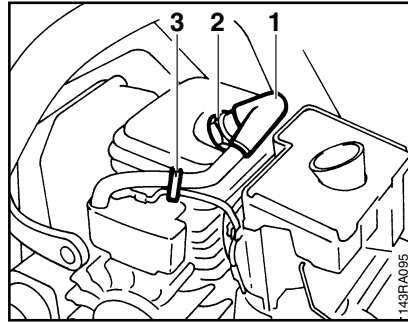

- Remove the shroud - see 3.3.
- Pull the terminal (1) off the spark plug (2).
- Pull the ignition lead out of the retainer (3).

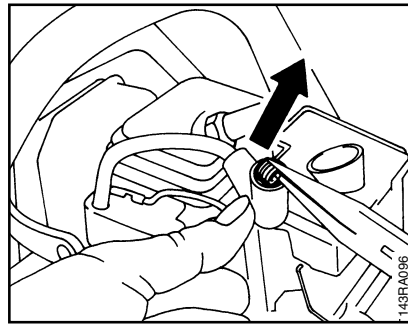

- Use pliers to grip the leg spring and pull it out of the spark plug terminal.
- Unhook the leg spring from the ignition lead.
- Pull spark plug terminal off the ignition lead.
- Coat end of the ignition lead (about 20 mm/3/4") with oil.
- Fit spark plug terminal over the ignition lead.
- Use pliers to grip the end of the ignition lead inside the spark plug terminal and pull it out.

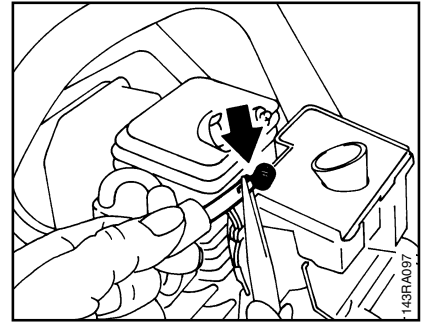

- Pinch the hook of the leg spring into the center of the lead, i.e. about 8 mm (0.3") from the end of the lead.

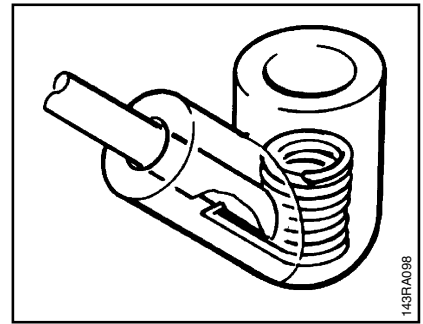

- Pull the lead back into the terminal so that the leg spring locates properly inside it (see illustration).
- Push the ignition lead into the retainer, see 5.5.
- Fit terminal on spark plug.
- Fit the shroud - see 3.3.

8.4 Handle Frame

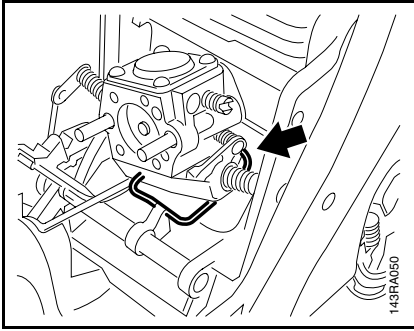

- Remove the filter housing - see 10.2.
- Disconnect throttle rod from the throttle shaft.

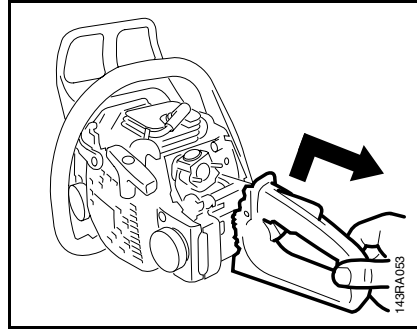

- Push the handle frame to one side and lift it away.

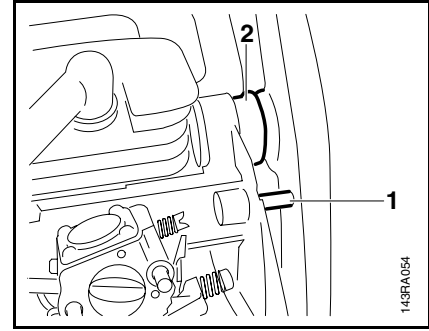

Note: The pin (1) must engage the hole.

The groove (2) must engage the inner rib in the handle frame.

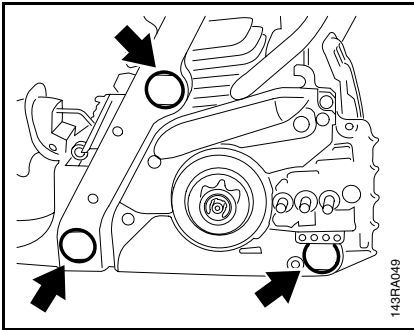

- Pry the plugs out of the annular buffers.

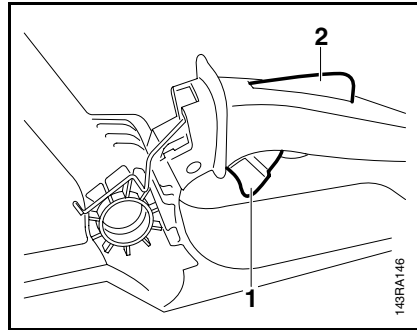

- Remove the throttle trigger (1) and interlock lever (2) - see 8.3.

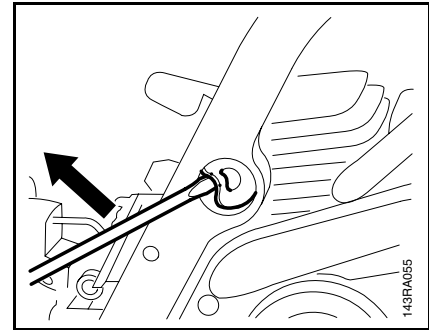

- Install annular buffer in handle frame.
- Fit plugs in the annular buffers.
- Fit the filter housing - see 10.2.

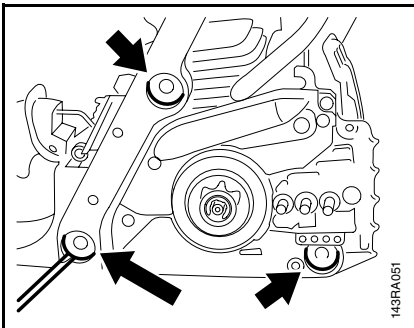

- Push the annular buffers out of their seats.

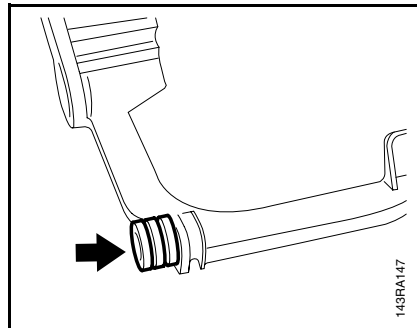

- Remove the annular buffer - see 7.

Reassemble in the reverse sequence.

11.2 Servicing Aids

No.	Part Name	Part No.	Application
1	Lubricating grease	0781 120 1111	Oil seals, oil pump drive, chain sprocket bearing, chain tensioner, switch shaft/contact spring
2	Standard commercial, solvent-based degreasant without chlorinated or halogenated hydrocarbons		Cleaning crankshaft stub
3	STIHL special lubricant	0781 417 1315	Bearing bore in rope rotor, rewind spring in starter cover
4	Electrician's repair kit	5910 007 1050	
5	Graphite grease		Peg on starter pawl
6	Molykote grease		Sliding and pivot points of chain brake
7	Dirko sealant (100 g/3.5 oz)	0783 830 2120	Engine pan, oil seals (outside diameter)
8	Securing screws (Loctite 242)	0786 111 1101	Engine housing mounting screws
9	Screw set	5910 007 1060	

Illustration C

Anwerfvorrichtung,
Zündanlage

Rewind starter, Ignition
system

Dispositif de lancement,
Dispositif d'allumage

Bild-Nr.	Teile-Nr.	St-Zahl	Benennung	Part Name	Désignation
	1130 080 2100	1	Lüftergehäuse mit Anwerfvorrichtung (1) □ 1 - 9, 13	Fan housing with rewind starter (1) □ 1 - 9, 13	Carter de ventilateur avec lanceur (1) □ 1 - 9, 13
	1130 080 2105	1	Lüftergehäuse mit Anwerfvorrichtung (2) □ 1 - 7, 10 - 12	Fan housing with rewind starter (2) □ 1 - 7, 10 - 12	Carter de ventilateur avec lanceur (2) □ 1 - 7, 10 - 12
1	1130 080 1800	1	Lüftergehäuse □ 2	Fan housing □ 2	Carter de ventilateur □ 2
2	1110 084 9102	1	Buchse	Bushing	Douille
3	1123 195 0400	1	Seilrolle	Rope rotor	Poulie à câble
4	1125 195 7200	1	Klinke	Pawl	Cliquet
5	0000 958 0923	1	Scheibe	Washer	Rondelle
6	1118 195 3500	1	Feder	Spring	Ressort
7	1129 190 0601	1	Rückholfeder	Rewind spring	Ressort de rappel
8	0000 195 8200	1	Anwerfseil Ø 3x800 mm (1)	Starter rope Ø 3x800mm (1)	Câble de lancement Ø 3x800 mm (1)
9	1121 195 3400	1	Griff (1)	Starter grip (1)	Poignée (1)
10	0000 190 3402	1	Griff ElastoStart Ø 3 mm (2) □ 11, 12	Starter grip ElastoStart Ø 3mm (2) □ 11, 12	Poignée ElastoStart Ø 3 mm (2) □ 11, 12
11	0000 195 8200	1	Anwerfseil Ø 3x800 mm (2)	Starter rope Ø 3x800mm (2)	Câble de lancement Ø 3x800 mm (2)
12	0000 195 7001	1	Kappe (2)	Cap (2)	Capuchon (2)
13	1130 967 1500	1	Typenschild 017	Model plate 017	Plaque matricule 017
14	9075 478 4155	3	Schraube IS-D5x24	Pan head self-tapping screw IS-D5x24	Vis cylindrique IS-D5x24
15	9104 003 3002	1	Schraube P4x12	Self-tapping screw P4x12	Vis Parker P4x12
16	1130 400 1201	1	Schwungrad	Flywheel	Rotor
17 *	1130 400 1200	1	→ 2 44 076 104 (05.2000) Schwungrad	→ 2 44 076 104 (05.2000) Flywheel	→ 2 44 076 104 (05.2000) Rotor
18	0000 955 0802	1	Bundmutter M8x1	Collar nut M8x1	Ecrou à embase M8x1
19	9075 478 3022	2	Schraube IS-D4x20	Pan head self-tapping screw IS-D4x20	Vis cylindrique IS-D4x20
20	1130 400 1302	1	Zündmodul □ 21, 22	Ignition module □ 21, 22	Module d'allumage □ 21, 22
21	1128 405 1000	1	Zündleitungsstecker	Spark plug boot	Contact de câble d'allumage

(1) 017, (2) 017 C

Illustration G

Griffrahmen, Werkzeuge

Handle frame, Tools

Cadre de poignée, Outils

Bild-Nr.	Teile-Nr.	St-Zahl	Benennung	Part Name	Désignation
1	1130 791 4901	1	Griffrahmen	Handle frame	Carde de Poignée
2	1130 182 1500	1	Gasgestänge	Throttle rod	Tringlerie des gaz
3	1123 791 2800	1	Ringpuffer	Annular buffer	Butoir annulaire
4	1123 791 7305	1	Stopfen	Plug	Bouchon
5	1123 791 7300	1	Stopfen	Plug	Bouchon
6	1130 182 0800	1	Sperrhebel	Trigger interlock	Levier d'arrêt
7	1130 182 1000	1	Gashebel	Throttle trigger	Manette des gaz
8	1117 182 4500	1	Schenkelfeder	Torsion spring	Ressort coudé
9	1130 791 0601	1	Griffschale	Handle molding	Monture de poignée
10	9074 478 3075	2	Schraube IS-P4x19	Pan head self-tapping screw IS-P4x19	Vis cylindrique IS-P4x19
11	0000 967 3662	1	Warnhinweis Piktogramm MS	Warning pictogram MS	Pictogramme d'avertissement MS
12	0000 967 3500	1	Hinweisschild USA	Instruction label USA	Plaque indicatrice USA
13	1129 890 3401	1	Kombischlüssel	Combination wrench	Clé multiple
14	0000 792 9128	1	Kettenschutz	Chain scabbard	Protège chaîne
			➔ 2 44 076 104 (05.2000)	➔ 2 44 076 104 (05.2000)	➔ 2 44 076 104 (05.2000)
20 *	1130 791 0600	1	Griffschale	Handle molding	Monture de poignée
21 *	1130 791 4900	1	Griffrahmen	Handle frame	Cadre de poignée

(1) 017, (2) 017 C

STIHL 018 (1130)**Ersatzteilliste
Spare Parts List
Liste des pièces**

- A** Motorgehäuse
Engine housing
Carter moteur
- B** Zylinder
Cylinder
Cylindre
- C** Schalldämpfer
Muffler
Silencieux
- D** Anwerfvorrichtung Zündanlage
Rewind starter; Ignition system
Dispositif de lancement; Dispositif
d'allumage
- E** Kettenbremse
Chain brake
Frein de chaîne
- F** Kettenschnellspannung
Quick tensioner parts
Pièces de tendeur de chaîne rapide
- G** Luftfilter, Haube
Air filter, Cover
Filtre à air, Capot
- H** Griffrahmen, Werkzeuge
Handle frame, Tools
Cadre de poignée, Outils
- J** Vergaser C1Q-S57A
Carburetor C1Q-S57A
Carburateur C1Q-S57A
- K** Vergaser C1Q-S43B
Carburetor C1Q-S43B
Carburateur C1Q-S43B

Bild-Nr.	Teile-Nr.	St-Zahl	Benennung	Part Name	Désignation
1	1123 640 7105	1	Schnecke □ 2	Worm □ 2	Vis sans fin □ 2
2	1123 647 2400	1	Feder	Spring	Ressort
3	1123 160 2050	1	Kupplung □ 4 - 7	Clutch □ 4 - 7	Embrayage □ 4 - 7
4	1129 162 0800	3	Fliehkewicht	Clutch shoe	Masselotte
5	1127 162 3000	3	Halter	Retainer	Pièce de fixation
6	0000 997 5515	3	Zugfeder	Tension spring	Ressort de tension
7	1121 162 1001	1	Abdeckscheibe	Cover washer	Rondelle de recouvrement
			(35.2000)	(35.2000)	(35.2000)
8 *	1121 162 3000	3	Halter	Retainer	Pièce de fixation
9	1123 162 7800	1	Blattfeder	Flat spring	Ressort à lame
10	1130 792 9100	1	Handschutz	Hand guard	Protège-main
11	1130 790 9100	1	Handschutz Kat. (2) □ 12, 13	Hand guard Cat. (2) □ 12, 13	Protège-main Cat. (2) □ 12, 13
12	1130 145 0600	1	Abstrahlblech Kat. (2)	Heat shield Cat. (2)	Tôle calorifuge Cat. (2)
13	9104 003 8600	2	Schraube P3x10 Kat. (2)	Self-tapping screw P3x10 Cat. (2)	Vis Parker P3x10 Cat. (2)
14	1128 160 5000	1	Hebel	Lever	Levier
15	0000 958 0521	1	Scheibe	Washer	Rondelle
16	1123 162 5800	1	Lasche	Strap	Bride de fixation
17	9460 624 0400	1	Sicherungsscheibe DIN6799-4	E-clip 4	Anneau d'arrêt 4
18	1123 160 5400	1	Bremsband	Brake band	Collier de frein
19	1123 162 7900	1	Zugfeder	Tension spring	Ressort de tension
20	1130 021 1100	1	Deckel	Cover	Couvercle
21	9512 933 2260	1	Nadelkranz 10x13x10	Needle cage 10x13x10	Cage à aiguilles 10x13x10
22	1123 640 2005	1	Kettenrad 3/8" Picco 6Z	Chain sprocket 3/8" Picco 6T	Pignon 3/8" Picco 6D
23	0000 958 1022	1	Scheibe Ø 27 mm	Washer Ø 27mm	Rondelle Ø 27 mm
24	9460 624 0801	1	Sicherungsscheibe DIN6799-8x1,3	E-clip 8x1.3	Anneau d'arrêt 8x1,3
25	1120 664 1500	1	Spannmutter	Tensioning nut	Ecrou de tension
26	1123 664 1605	1	Spannschraube	Adjusting screw	Vis de tension
27	1123 664 2205	1	Abdeckung	Cover	Recouvrement
28	1123 640 1705	1	Kettenraddeckel	Chain sprocket cover	Couvercle de pignon
29	0000 955 0804	2	Bundmutter M8	Collar nut M8	Ecrou à embase M8
30	0000 967 3630	1	Hinweisschild USA	Instruction label USA	Plaque indicatrice USA

(1) 018, (2) 018 C

CLICK HERE TO **DOWNLOAD** THE COMPLETE MANUAL

- Thank you very much for reading the preview of the manual.
- You can download the complete manual from: www.heydownloads.com by clicking the link below



- Please note: If there is no response to CLICKING the link, please download this PDF first and then click on it.

CLICK HERE TO **DOWNLOAD** THE COMPLETE MANUAL