



Important information

Serious risk of injury

When working on the engine, for example when adjusting drive belts and the clutch, or when changing the oil, it is important not to start the engine. The engine could be damaged, but more importantly there is a serious risk of injury.

For this reason, always secure the starting device or disconnect a battery cable before working on the engine. This is especially important if the engine has a remote starter or automatic starting.



WARNING!

This warning symbol and text can be found next to those maintenance items where it is particularly important to bear in mind the risk of injury.

Operator's manual

DC13

XPI

Industrial engine

en-GB 2 399 007



Issue 3.0



IMPORTANT!

The owner is responsible for making sure that maintenance is carried out on time and in accordance with the instructions.

The owner must entrust the maintenance, renewal and repair of emission-related components and systems to a qualified workshop or person.

CLICK HERE TO **DOWNLOAD** THE COMPLETE MANUAL

- Thank you very much for reading the preview of the manual.
- You can download the complete manual from: www.heydownloads.com by clicking the link below



- Please note: If there is no response to CLICKING the link, please download this PDF first and then click on it.

CLICK HERE TO **DOWNLOAD** THE COMPLETE MANUAL

Before starting

Ensure that all guards are in place before starting the engine. Ensure that no tools or other objects have been left on the engine.



WARNING!

The air filter must be fitted before starting the engine. Otherwise there is a risk of objects being sucked into the compressor impeller or of injury if you come into contact with the air filter.

Certification

An emissions certified engine fulfils the emissions requirements for a particular range of application.

On each emissions certified engine there is a label which shows which requirements the engine fulfils. Scania guarantees that each such engine fulfils the emissions requirements for the range of application for which it is certified.

The following are required for the certified engine to fulfil the emissions requirements once it has been taken into service:

- Maintenance is to be carried out in accordance with the instructions in this Operator's manual.
- The maintenance and repair of injection equipment are to be carried out by a qualified workshop or person.
- The engine may only be modified with equipment that has been approved by Scania.
- Seals may be broken and setting data edited only once approval has been granted by Scania. Modifications may be made by authorised personnel only.
- Modifications affecting the exhaust and intake systems must be approved by Scania.

Otherwise, the instructions in the Operator's manual for the running and maintenance of the engine shall apply. The safety precautions should be observed.



IMPORTANT!

For Scania to guarantee that the engine corresponds to its certified configuration, and take responsibility for any damage and injuries that occur, maintenance must be carried out as above.

SCR system

The illustration provides an overview of SCR system components.

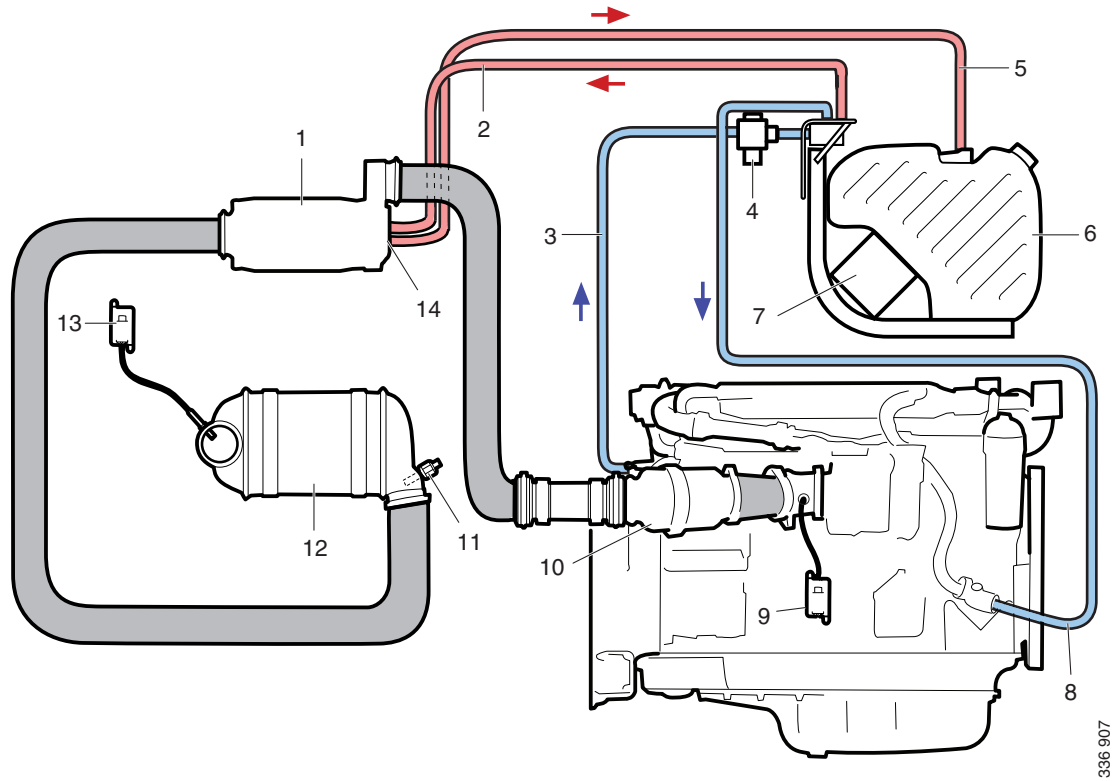

336 907

- | | |
|---|--|
| 1. Evaporator | 8. Coolant hose, return from tank and pump heating |
| 2. Pressure line for reductant | 9. NOx sensor with control unit ¹ |
| 3. Coolant hose for tank and pump heating | 10. Oxidation catalytic converter ² |
| 4. Coolant valve | 11. Exhaust gas temperature sensor |
| 5. Reductant return line | 12. SCR catalytic converter |
| 6. Reductant tank | 13. NOx sensor with control unit |
| 7. Reductant pump and control unit | 14. Reductant doser |

1. DC13 084/085/087/089A only.

2. DC13 084/087/089A only.

Engines with few hours of operation



IMPORTANT!

On engines with few hours of operation, maintenance must be carried out annually or every 5 years.

Stand-by generator sets and the like that are not used regularly should be test run and checked in accordance with the manufacturer's instructions.

The following maintenance items must be carried out once the engine has been warmed up to operating temperature.

1. Checking oil level.
2. Checking coolant level.
3. Checking vacuum indicator.
4. Checking fuel level.
5. Checking for engine leaks.

Cleaning the engine

The engine must be cleaned before starting work.

Clean the engine with hot water. Also use a degreasing agent, if necessary.

Avoid spraying water on the engine control unit, see illustration.



WARNING!

Beware of hot water! Use suitable protective equipment.



Environment

The washing water must be disposed of in compliance with the relevant national and international regulations.

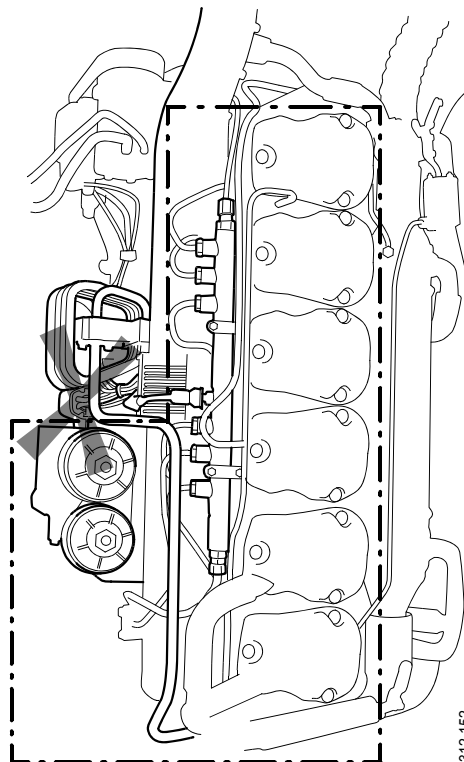

Clean within the marked area

312 152

11. Fit a new paper insert on the inside of the rotor cover.

1

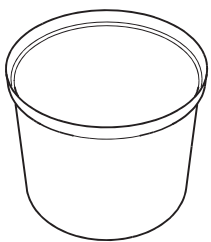

2

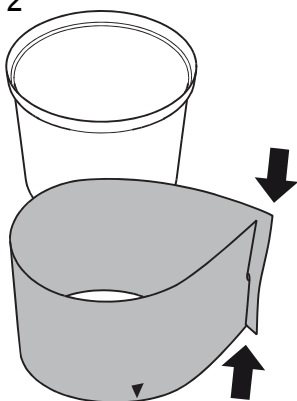

3

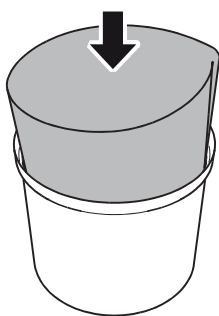

4

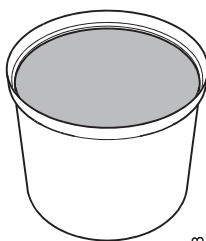

337 178

Changing coolant



Environment

Avoid spillage and use a suitable container. Used coolant must be disposed of as specified in national and international law.



IMPORTANT!

Mix the coolant as specified under the section Coolant.

1. Remove the expansion tank cap.
2. Drain the coolant at the following two points:
 - Lowest point of the cylinder block.
 - The lowest point of the cooling system.
3. Close the drain taps.

! IMPORTANT!

Do not use an adjustable spanner or other open tool to undo the filter covers, as this risks damaging the filter covers.

1. Make a mark on the water separating suction filter cover (A). Unscrew the cover 3 to 4 turns using a socket wrench with hexagon driver, e.g. 588 475.

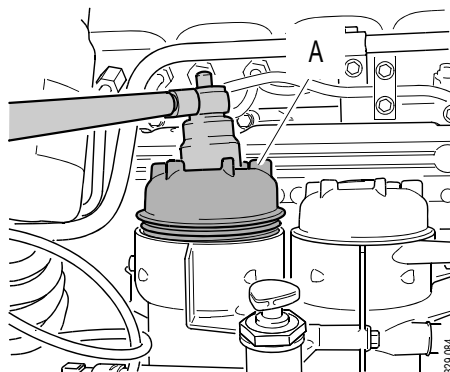

! IMPORTANT!

Wait a minimum of 2 minutes to allow as much of the fuel as possible to drain out of the filter housing.

2. Unscrew the filter cover (A) and lift it up slowly with the filter element.
3. Make sure the suction tool is completely drained before starting work. Draw out remaining fuel and any particles using suction tool 588 793 or a similar tool.
4. Keep the suction tool hose in the filter housing for the water separating suction filter (A).

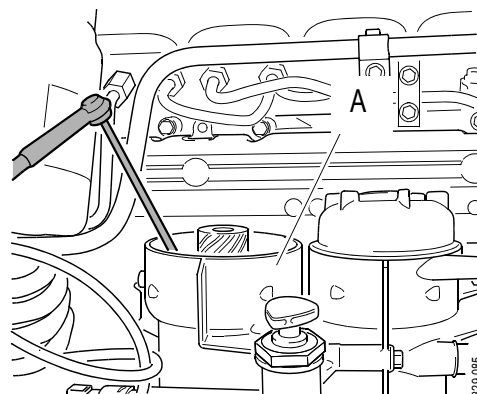

5. Make a mark on the pressure filter cover (B). Unscrew the cover 3 to 4 turns, using a socket wrench with hexagon driver, e.g. 588 475. Draw out fuel which may drain into the water separating suction filter housing when the pressure filter is detached.

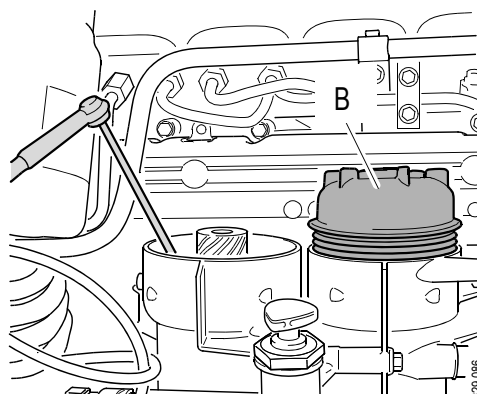

! IMPORTANT!

Wait a minimum of 2 minutes to allow as much of the fuel as possible to drain out of the filter housing.

Cleaning the reductant tank filler filter

Make sure that the filler filter (1) is clean. If it is dirty: Clean the filler filter with clean water and refit it.

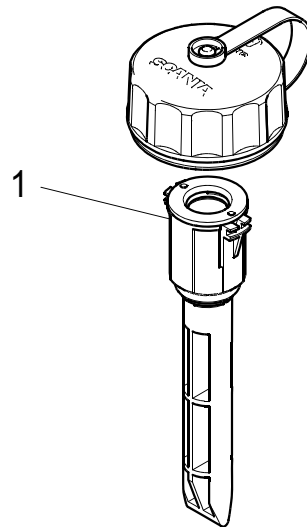

350 114

Cleaning the reductant tank ventilation filter

Make sure that the ventilation filter (2) is clean. If it is dirty: Clean the ventilation filter with clean water and refit it.

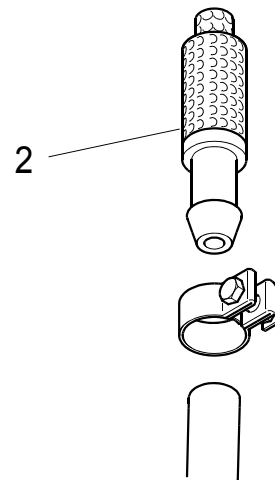

352 009

CLICK HERE TO **DOWNLOAD** THE COMPLETE MANUAL

- Thank you very much for reading the preview of the manual.
- You can download the complete manual from: www.heydownloads.com by clicking the link below



- Please note: If there is no response to CLICKING the link, please download this PDF first and then click on it.

CLICK HERE TO **DOWNLOAD** THE COMPLETE MANUAL