

Service Manual

Pioneer

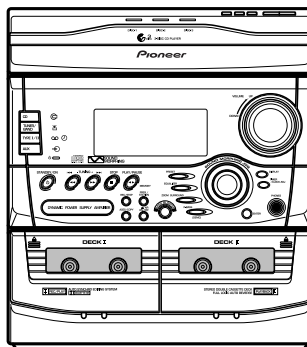

● XR-A660

ORDER NO.
RRV2006

STEREO CD CASSETTE DECK RECEIVER

XR-A660

XR-A550

XR-A330

THIS MANUAL IS APPLICABLE TO THE FOLLOWING MODEL(S) AND TYPE(S).

Type	Model			Power Requirement	The Voltage can be converted by the following method.
	XR-A660	XR-A550	XR-A330		
DBDXJ	○	—	○	AC110-127V/220-230V/240V	With the voltage selector
DLXJ/NC	○	—	○	AC110-127V/220-230V/240V	With the voltage selector
DXJ/NC	○	—	○	AC110-127V/220-230V/240V	With the voltage selector
DXJ	—	○	—	AC110-127V/220-230V/240V	With the voltage selector

CONTENTS

1. SAFETY INFORMATION	2	7. GENERAL INFORMATION	61
2. EXPLODED VIEWS AND PARTS LIST	3	7.1 PARTS	61
3. SCHEMATIC DIAGRAM	16	7.1.1 IC	61
4. PCB CONNECTION DIAGRAM	32	7.1.2 DISPLAY	68
5. PCB PARTS LIST	44	7.2 DISASSEMBLY	72
6. ADJUSTMENT	52	7.3 BLOCK DIAGRAM	76
		8. PANEL FACILITIES AND SPECIFICATIONS	78

PIONEER ELECTRONIC CORPORATION 4-1, Meguro 1-Chome, Meguro-ku, Tokyo 153-8654, Japan
PIONEER ELECTRONICS SERVICE, INC. P.O. Box 1760, Long Beach, CA 90801-1760, U.S.A.
PIONEER ELECTRONIC (EUROPE) N.V. Haven 1087, Keetberglaan 1, 9120 Melsele, Belgium
PIONEER ELECTRONICS ASIACENTRE PTE. LTD. 501 Orchard Road, #10-00 Wheelock Place, Singapore 238880
 © PIONEER ELECTRONIC CORPORATION 1998

CLICK HERE TO **DOWNLOAD** THE COMPLETE MANUAL

- Thank you very much for reading the preview of the manual.
- You can download the complete manual from: www.heydownloads.com by clicking the link below



- Please note: If there is no response to CLICKING the link, please download this PDF first and then click on it.

CLICK HERE TO **DOWNLOAD** THE COMPLETE MANUAL

2.6 SERVO MECHANISM ASSY

● \$M MECHANISM CD PARTS LIST

Mark	No.	Description	Part No.
⊗	1	MOTOR Assy	AWZ8428
NSP	2	SW Assy	AWZ8429
⊗	3	CD Assy	AWZ3050
	4	•••••	
	5	Servo Spring	ABH7126
	6	Belt	AEB7072
	7	Clamp Magnet	AMF7001
	8	Yoke	ANB7067
	9	Mecha Base	ANW7125
	10	Loading Tray	ANW7088
	11	Servo Base	ANW7089
	12	Rotary Tray	ANW7113
	13	Clamper	ANW7091
	14	Clamper Holder	ANW7092
	15	Main Cam	ANW7093
	16	Gear Pully	ANW7094
	17	Lock Lever	ANW7095
	18	Planet Gear	ANW7096
	19	Actuator	ANW7097
	20	•••••	
	21	15P F.F.C/30V	ADD7038
	22	Connector Assy (6P)	ADE7010
	23	Float Rubber A	AEB7063
	24	Float Rubber B	AEB7066
	25	Servo Mechanism Assy	AXA7039
	26	Screw	IPZ30P080FMC
	27	Carriage Motor	VXM1033
	28	Motor Pulley	PNW1634
	29	Ha Narl	GEM1016

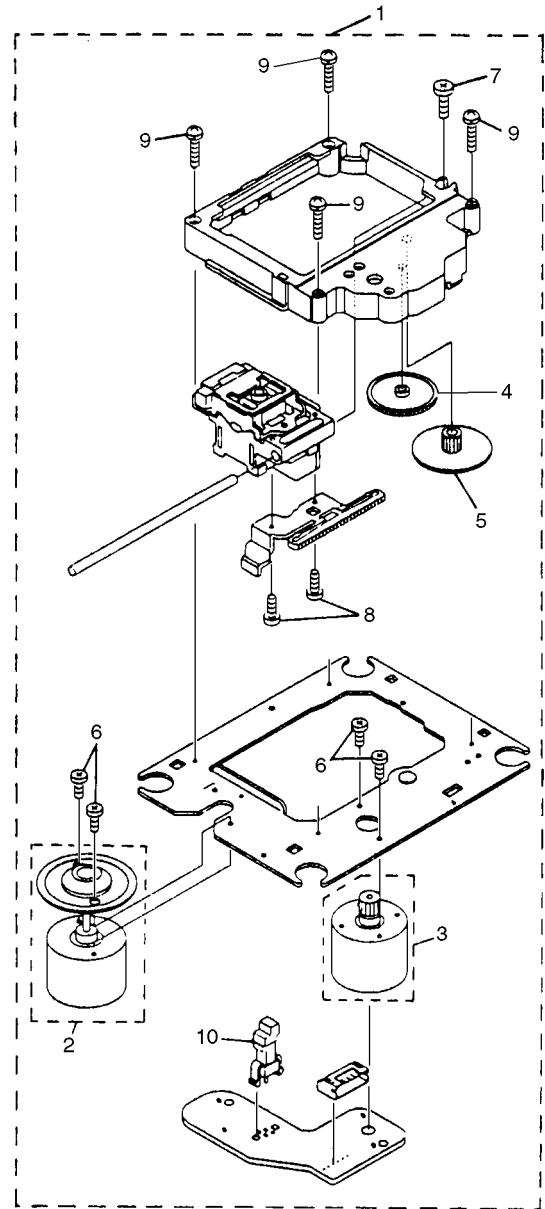

● SERVO MECHANISM ASSY PARTS LIST

Mark	No.	Description	Part No.
	1	Servo Mechanism	AXA7039
	2	SPINDLE MOTOR Assy	AEA7009
	3	SLEAD MOTOR Assy	AEA7010
	4	Gear A	AEA7013
	5	Gear B	AEA7014
	6	Screw	AEA7015
	7	Screw	AEA7016
	8	Screw	AEA7017
	9	Screw	AEA7018
	10	Leaf Switch	AEA7011

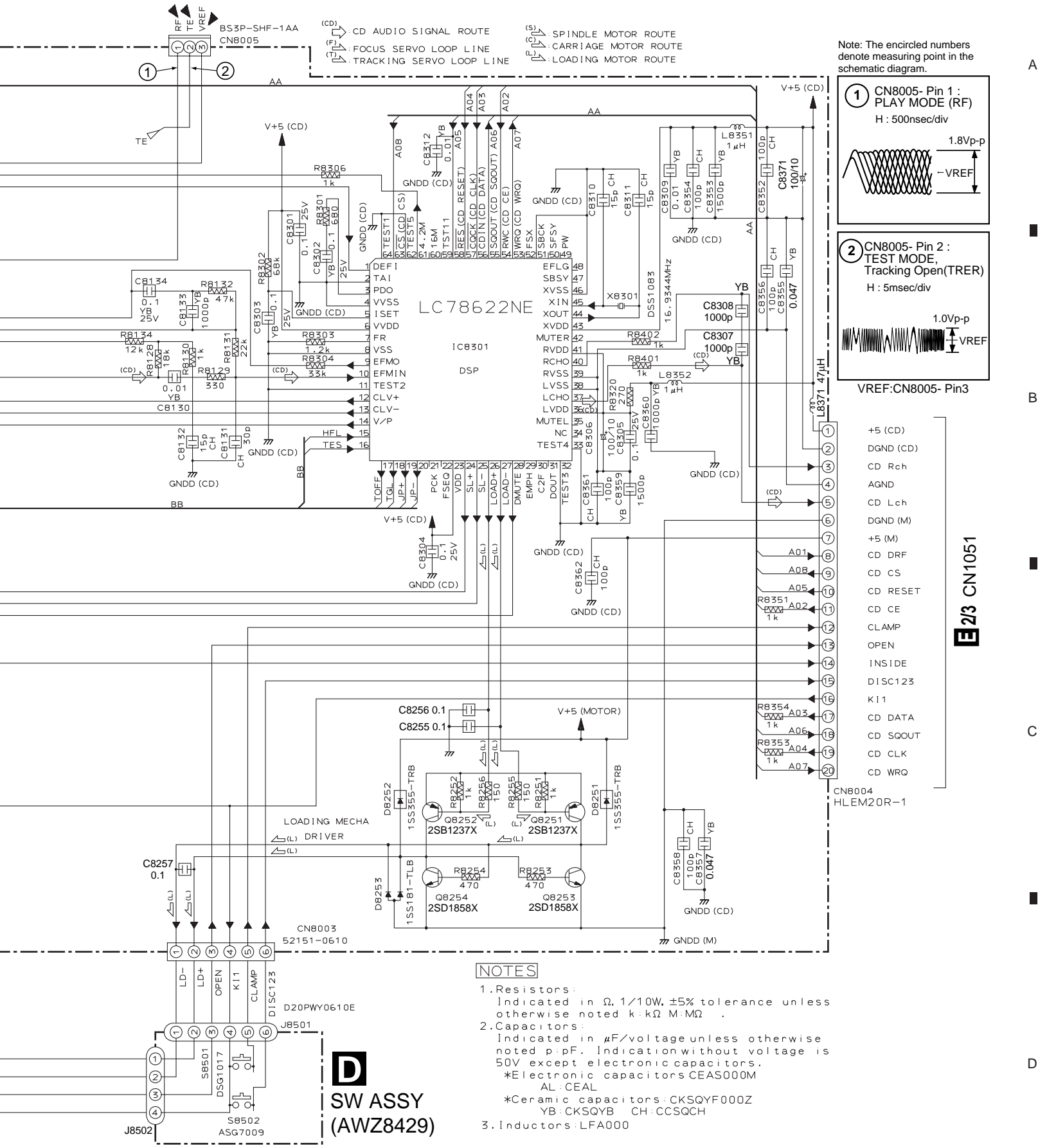

Note: The encircled numbers denote measuring point in the schematic diagram.

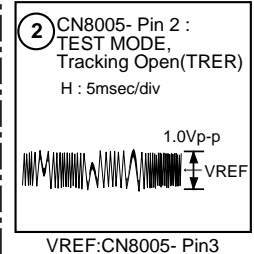
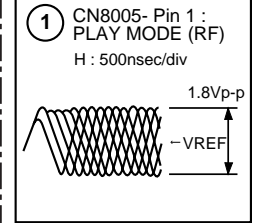

- ① +5 (CD)
- ② DGND (CD)
- ③ CD Rch
- ④ AGND
- ⑤ CD Lch
- ⑥ DGND (M)
- ⑦ +5 (M)
- ⑧ CD DRF
- ⑨ CD CS
- ⑩ CD RESET
- ⑪ CD CE
- ⑫ CLAMP
- ⑬ OPEN
- ⑭ INSIDE
- ⑮ DISC123
- ⑯ K11
- ⑰ CD DATA
- ⑱ CD SQOUT
- ⑳ CD CLK
- ㉑ CD WRQ

E 2/3 CN1051

D
SW ASSY
(AWZ8429)

XR-A660, XR-A550, XR-A330

NOTES ALL CAPACITORS ARE IN μF
 UNLESS OTHERWISE SPECIFIED
 TL : OFLTA
 M : CQMA
 CH : CCSQCH
 YB : CKSQYB
 SL : CCSQSL
 (OTHER : CKSQYF)
 AL : CEAL JA : CEJA
 HAQ : CEHAQ
 (OTHER : CEAS**M###orCEAT**M###)
 ALL RESISTORS ARE IN Ω
 $\frac{\square}{\square}$: 1/10W (CHIP)
 $\frac{\square}{\square}$: 1/4WPU
 ALL INDUCTORS ARE IN μH
 LAU

CN5501
 52045-3845

E/23 CN5101

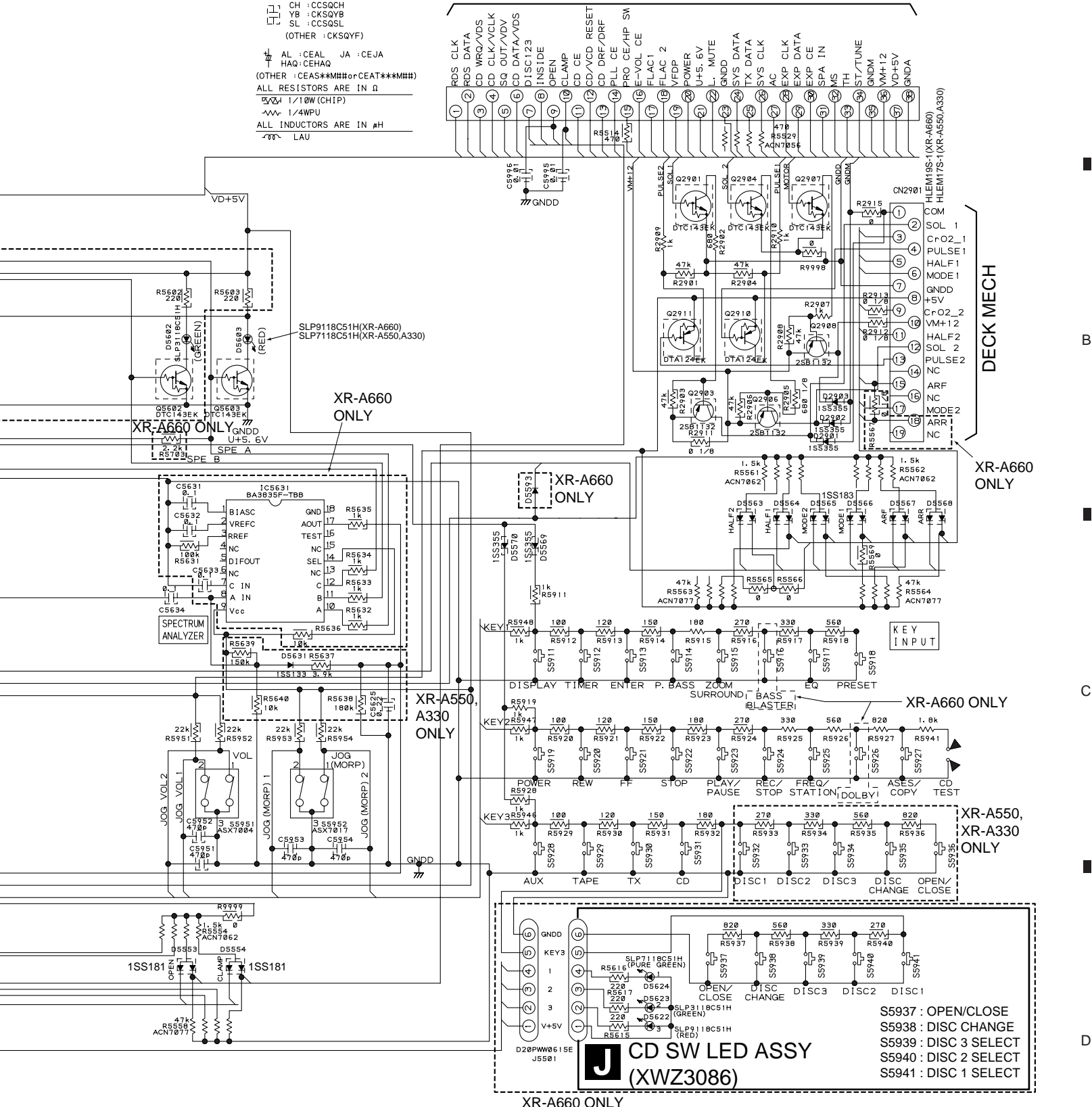

DECK MECH

XR-A660 ONLY

XR-A660 ONLY

XR-A550, XR-A330 ONLY

J CD SW LED ASSY (XWZ3086)

- S5937 : OPEN/CLOSE
- S5938 : DISC CHANGE
- S5939 : DISC 3 SELECT
- S5940 : DISC 2 SELECT
- S5941 : DISC 1 SELECT

XR-A660 ONLY



4.5 SUB TRANS ASSY

H SUB TRANS ASSY

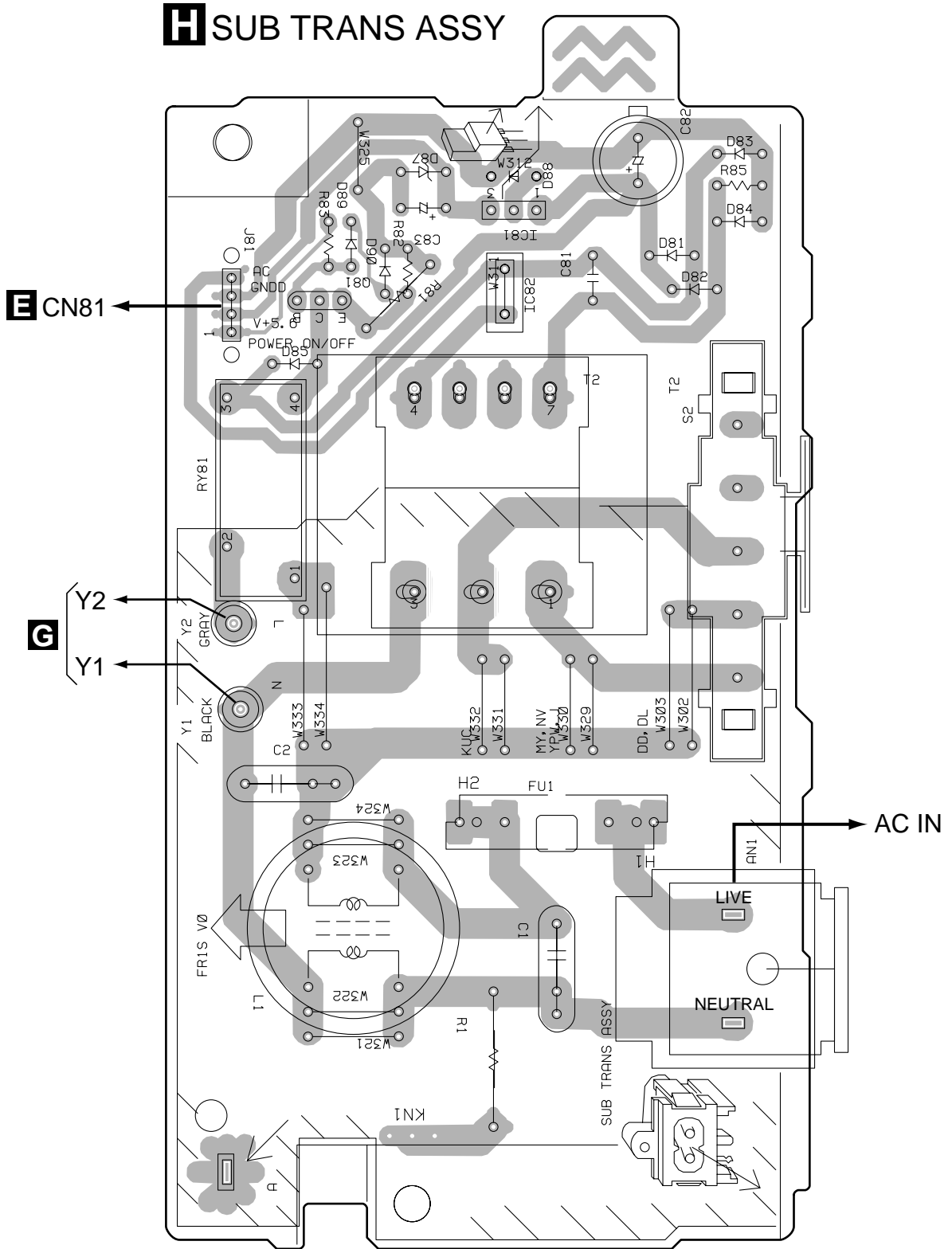

(XNP3012-B)

SIDE A



Mark	No.	Description	Part No.
OTHERS			
	X5501	CERAMIC RESONATOR (6MHz)	RSS1050
	CN2901	17P FFC CONNECTOR	52045-1745
	CN5501	38P FFC CONNECTOR	52045-3845
	X5901	REMOTE RECEIVER UNIT	GP1U28X
	5631	FL HOLDER	VNF1096
	V5621	FL TUBE	XAV3003

J CD SW LED ASSY

SEMICONDUCTORS

D5623	SLP3118C51H
D5624	SLP7118C51H
D5622	SLP9118C51H

SWITCHES

S5937-S5941	XSG3001
-------------	---------

RESISTORS

All Resistors	RS1/10S□□□J
---------------	-------------

OTHERS

J5501	JUMPER WIRE	D20PWW0615E
-------	-------------	-------------

7. GENERAL INFORMATION

7.1 PARTS

7.1.1 IC

• The information shown in the list is basic information and may not correspond exactly to that shown in the schematic diagrams.

■ HA12136AF (AF ASSY : IC2201)

• Dolby B Type NR System IC

●Pin Function

No.	Pin Name	Function	No.	Pin Name	Function
1	REC IN	Recording (Encode) input	9	REC OUT	Recording (Encode) output
2	Vcc	Power supply	10	DET	Time constant pin for the level detector
3	PB IN	Playback (Decode) input	11	PB OUT	Playback (Decode) output
4	Vref	Reference voltage	12	REC/PB	Mode control pin for REC/PB (Encode/Decode) "H" : REC (Encode), "L" : PB (Decode)
5	NR ON/OFF	Mode control pin for NR ON/OFF "H" : NR ON, "L" : NR OFF	13	BIAS	Reference current input pin for the active filters
6	PB OUT	Playback (Decode) output	14	PB IN	Playback (Decode) input
7	DET	Time constant pin for the level detector	15	GND	Ground
8	REC OUT	Recording (Encode) output	16	REC IN	Recording (Encode) input

■ HA12211NT (AF ASSY : IC2301)

• REC Equalizer and PB Equalizer System IC

●Block Diagram

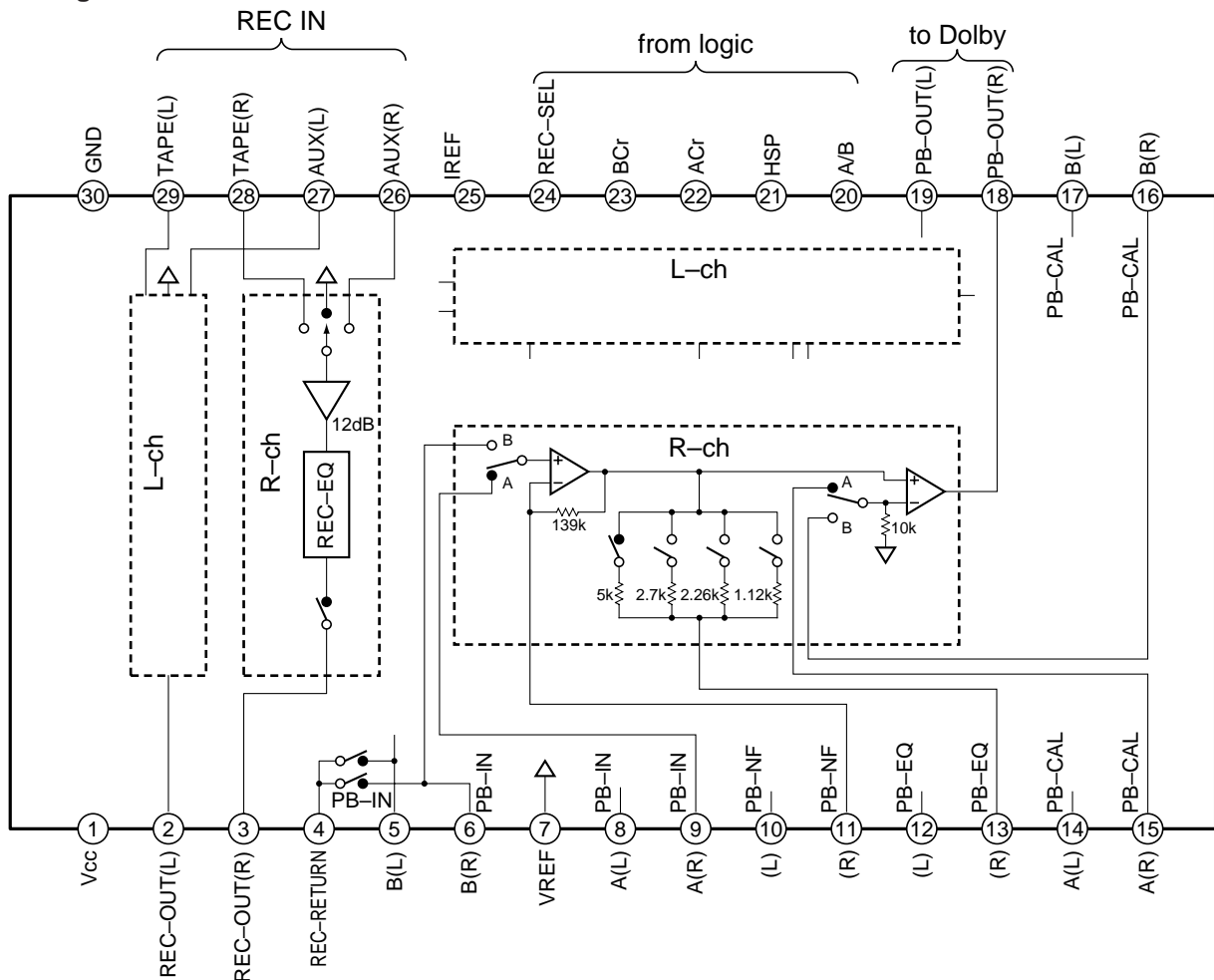

• Anode Connection

	1G	2G	3G to 6G	7G	8G	9G	10G	11G	12G	13G	14G
P1		a1	a1	a1	a1	a1	L1	B1	B1	B1	R1
P2		a2	a2	a2	a2	a2	L2	B2	B2	B2	R2
P3		h	h	h	h	h	L3	B3	B3	B3	R3
P4		j	j	j	j	j	L4	B4	B4	B4	R4
P5		k	k	k	k	k	L5	B5	B5	B5	R5
P6		b	b	b	b	b	L6	B6	B6	B6	R6
P7	REC	f	f	f	f	f	L7	B7	B7	B7	R7
P8		g	g	g	g	g	L8	B8	B8	B8	R8
P9	ASES	m	m	m	m	m	L9	B9	V-CD	B9	R9
P10		c	c	c	c	c	L10	B10		B10	R10
P11	RPT	e	e	e	e	e	L11	B11	PBC	B11	R11
P12	-1	r	r	r	r	r	L12	B12		B12	R12
P13	PGM	p	p	p	p	p	-	B13		B13	-
P14	RDM	n	n	n	n	n	-	B14	KEY	B14	-
P15		d1	d1	d1	d1	d1	-	B15	L	B15	-
P16	-	d2	d2	d2	d2	d2	-	B16	R	B16	-
P17	-	s	-	-	-		LS	B17		B17	RS
P18	-	t	-	-	-	-	-	B18	S1	B18	-
P19	-	u	-	-	-	-	-	B19	[(EQ)]	B19	-
P20	-	w	-	-	-	-	-	B20	[(SURR.)]	B20	-
P21	-	-	-	-	-	-	-	B21	[(P.BASS)]	B21	-
P22	-	-	-	-	-	-	-	B22	-	B22	-
P23	-	-	-	-	-	-	-	B23	-	B23	-
P24	-	-	-	-	-	-	-	B24	-	B24	-
P25	-	Dp1	Dp1	Dp1	Dp1	-	-	-	-	-	-
P26	-	-	-	Dp2	-	-	-	-	-	-	-
P27	-	-	-		-	-	-	-	-	-	-

CLICK HERE TO **DOWNLOAD** THE COMPLETE MANUAL

- Thank you very much for reading the preview of the manual.
- You can download the complete manual from: www.heydownloads.com by clicking the link below



- Please note: If there is no response to CLICKING the link, please download this PDF first and then click on it.

CLICK HERE TO **DOWNLOAD** THE COMPLETE MANUAL