

Service Manual

Personal Computer

CF-W4

This is the Service Manual for
the following areas.
M ...for U.S.A. and Canada

Model No. CF-W4GWCZZ 1 2

1: Operation System

B: Microsoft® Windows® XP Professional

2: Area

M: Refer to above area table

 **WARNING**

This service information is designed for experienced repair technicians only and is not designed for use by the general public. It does not contain warnings or cautions to advise non-technical individuals of potential dangers in attempting to service a product. Products powered by electricity should be serviced or repaired only by experienced professional technicians. Any attempt to service or repair the product or products dealt with in this service information by anyone else could result in serious injury or death.

Panasonic®

© 2005 Matsushita Electric Industrial Co., Ltd. All rights reserved.
Unauthorized copying and distribution is a violation of law.

CLICK HERE TO **DOWNLOAD** THE COMPLETE MANUAL

- Thank you very much for reading the preview of the manual.
- You can download the complete manual from: www.heydownloads.com by clicking the link below



- Please note: If there is no response to CLICKING the link, please download this PDF first and then click on it.

CLICK HERE TO **DOWNLOAD** THE COMPLETE MANUAL

2.2.3. Remove the HDD

Preparation : perform the section 2.2.1. 2.2.2. first.

1. Remove the 2 Screws (V).
Screw(V):DFHE5025XA(N1)
2. The slide is done in the direction of the arrow and the HDD Cover is removed.

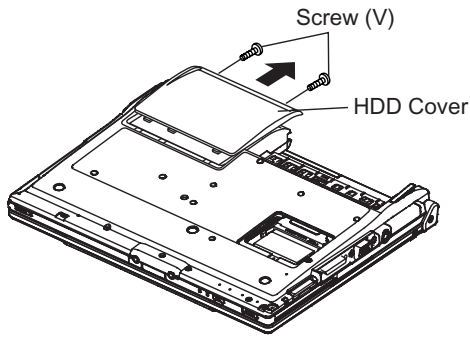

3. Lift up the HDD Unit and remove the FFC Connector and then remove the HDD Unit.
4. HDD is taken out of the HDD Case.

Note:

Please do not bend pins of the HDD Connector, at the time of removing HDD and FFC Connector.

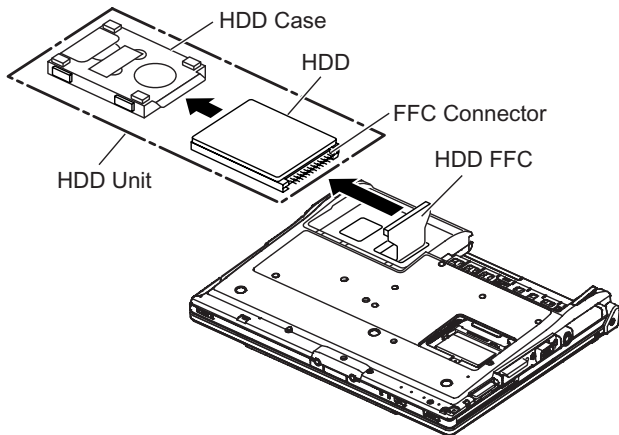

2.2.4. Remove the Top Case

Preparation : perform the section 2.2.1. , 2.2.2. first.

1. Insert a small screwdriver into the hole and slide the lock in the direction shown by arrow (C) to open the Disc Cover.
2. The Antenna Cover (R) is rotated from the Bottom Case side in the direction of arrow (A) and the Antenna Cover (R) removed in the direction of arrow (B).

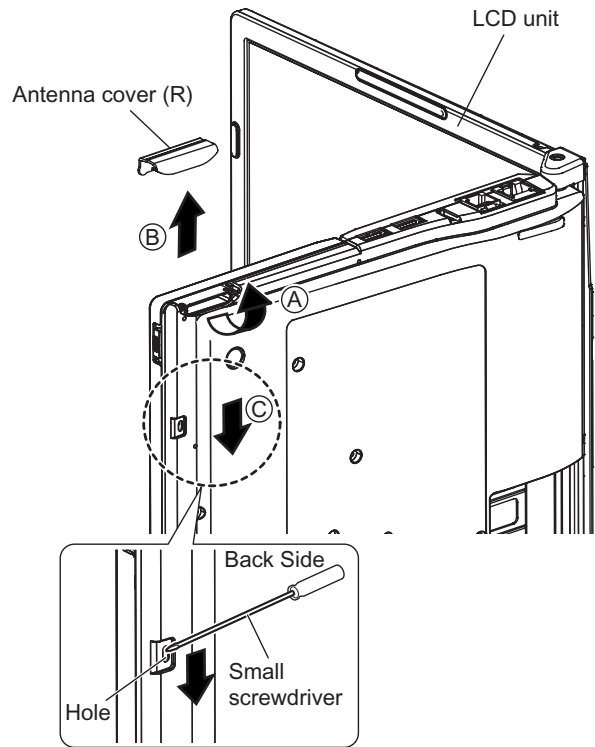

3. Remove the 3 Screws (B), 2 Screws (C) and 3 Screws (E) from the Bottom Case.

- Screw(B):DRHM0092ZA(N4)
- Screw(C):DXHM0057ZA(N7)
- Screw(E):DXHM0039ZA(N6)

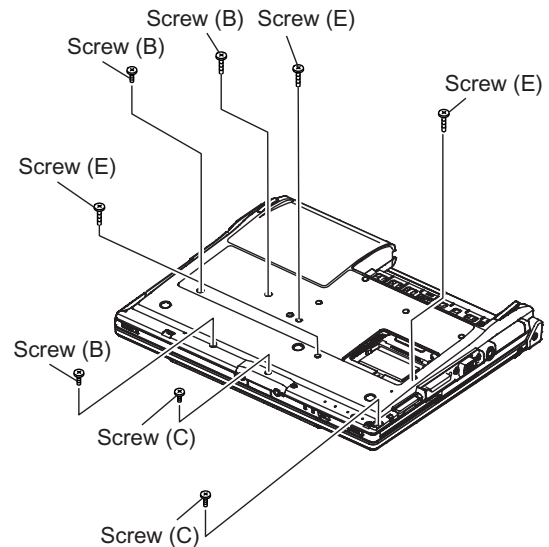

●Putting of LCD Damper(C)

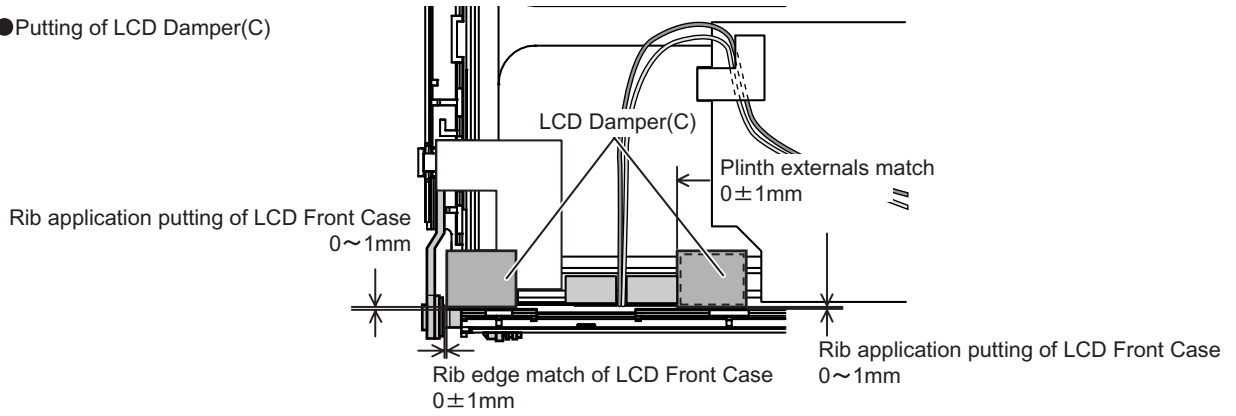

●Drawing out specification of LCD Cable

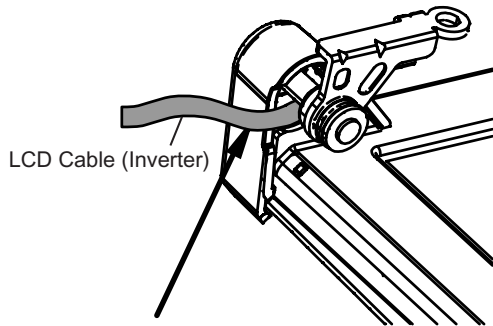

The Cable is processed under the shaft .

Note:It is confirmed that the cable does not narrow between cabinets.

●Putting of Conductive Cloth of LCD Cable

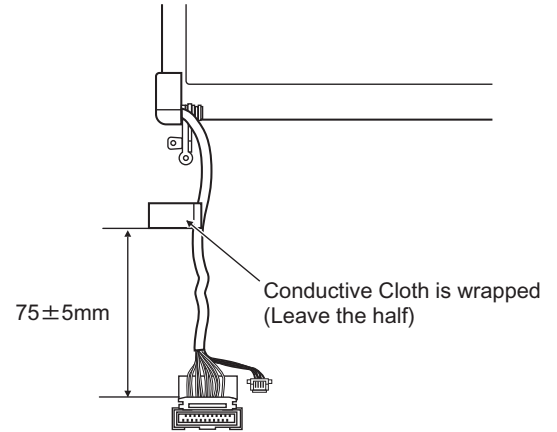

●LCD cable processing 1

Process the LCD Cable (2) such as DC-IN Jack Holders, after process the Conductive Cloth of the LCD cable puts as shown in the figure below.

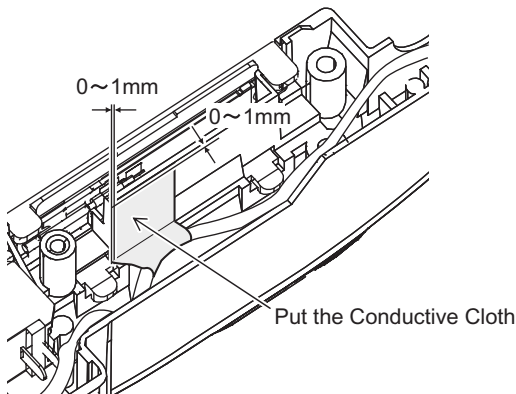

●LCD Cable processing 2

Processing cable to under point hanging part

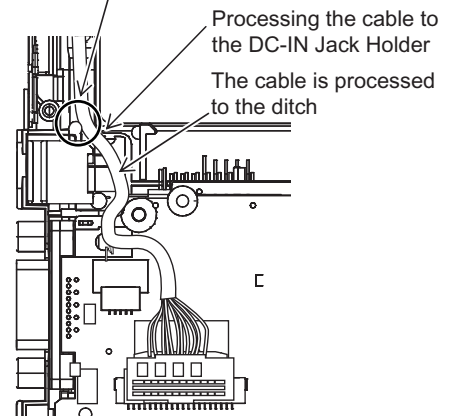

●Connector connection specification

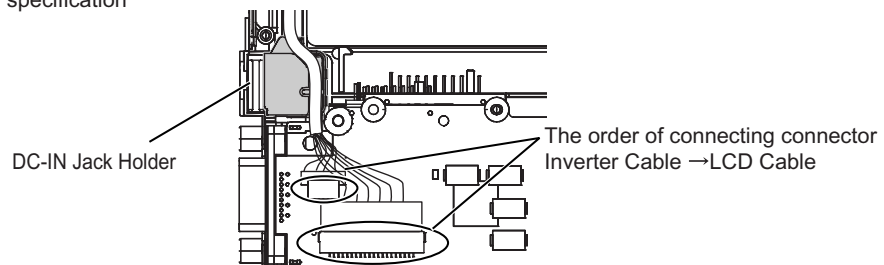

C 408			
C 409			
C 412			
C 413			
C 417			
C 429			
C 430			
C 431			
C 432			
C 434			
C 435			
C 442			
C 443			
C 444			
C 446			
C 605			
C 609			
C 625			
C 631			
C 702			
C 49	F1J0J1060004	CAPACITOR, 6.3V, 10 μ F	25
C 54			
C 74			
C 81			
C 89			
C 90			
C 102			
C 106			
C 107			
C 111			
C 169			
C 174			
C 180			
C 181			
C 184			
C 291			
C 292			
C 352			
C 353			
C 354			
C 355			
C 356			
C 404			
C 433			
C 723			
C 50	F1G1E103A062	CAPACITOR, 25V, 0.01 μ F	28
C 170			
C 172			
C 173			
C 175			

Q 646			
Q 655			
Q 665			
Q 614	B1MBEDA00017	TRANSISTOR	3
Q 636			
Q 638			
Q 619	B1DHFB000003	TRANSISTOR	2
Q 667			
Q 629	B1ABCF000023	TRANSISTOR	2
Q 631			
Q 633	B1DFGD000032	TRANSISTOR	1
Q 637	B1CFGD000003	TRANSISTOR	2
Q 660			
Q 645	B1DFED000020	TRANSISTOR	1
Q 650	B1MBEDA00018	TRANSISTOR	1
Q 674	B1CFMC000008	TRANSISTOR	1
R 1	ERJ2GEJ681X	RESISTOR, 1/16W, 680Ω	2
R 252			
R 2	ERJ2RKF27R4X	RESISTOR, 1/16W, 27.4Ω	3
R 15			
R 16			
R 3	ERJ2GEJ151X	RESISTOR, 1/16W, 150Ω	2
R 6			
R 4	ERJ2RKF54R9X	RESISTOR, 1/16W, 54.9Ω	6
R 7			
R 17			
R 18			
R 35			
R 36			
R 5	ERJ2RKF39R2X	RESISTOR, 1/16W, 39.2Ω	1
R 11	ERJ3GEY0R00V	RESISTOR, 1/16W, 0Ω	5
R 240			
R 335			
R 336			
R 447			
R 12	ERJ2RKF2000X	RESISTOR, 1/16W, 200Ω	2
R 43			
R 13	ERJ2GEJ560X	RESISTOR, 1/16W, 56Ω	6
R 14			
R 27			
R 29			
R 31			
R 32			
R 23	ERJ3GEYJ100V	RESISTOR, 1/16W, 10Ω	6
R 679			
R 703			
R 734			
R 738			
R 780			
R 24	ERJ2RKF1001X	RESISTOR, 1/16W, 1KΩ	1

CLICK HERE TO **DOWNLOAD** THE COMPLETE MANUAL

- Thank you very much for reading the preview of the manual.
- You can download the complete manual from: www.heydownloads.com by clicking the link below



- Please note: If there is no response to CLICKING the link, please download this PDF first and then click on it.

CLICK HERE TO **DOWNLOAD** THE COMPLETE MANUAL