

# **CLAAS**

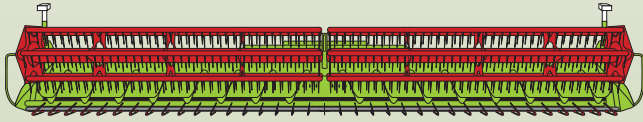

**C1200**

## **Repair manual**

***SERVICE & PARTS***

CLICK HERE TO **DOWNLOAD** THE COMPLETE MANUAL

- Thank you very much for reading the preview of the manual.
- You can download the complete manual from: [www.heydownloads.com](http://www.heydownloads.com) by clicking the link below



- Please note: If there is no response to CLICKING the link, please download this PDF first and then click on it.

CLICK HERE TO **DOWNLOAD** THE COMPLETE MANUAL

### 1.2.4 Front attachment and trailers

- Support raised front attachments securely before doing any work underneath the units.
- Take particular care when mounting front attachments to the basic machine and when attaching a trailer.
- Owing to their function, front attachments and feeder mechanisms such as belts, rollers, chains, worm gears, reels and the like cannot be completely protected by design measures; for this reason, an adequate safety distance must be maintained from these moving elements during operation. These instructions also apply to all other accessories operated on the machine.
- No person must ever be allowed between the machine and the front attachment unless the parking brake is applied and/or the wheels are chocked so that the vehicle can not start to move on its own.
- Front attachments and trailers must only be attached to the coupling devices provided for that purpose. Observe the maximum permissible load capacity of the trailer hitch.
- Hitch the trailer correctly to the forage harvester. Be alert when connecting a trailer to the forage harvester.
- Before disconnecting a front attachment always make sure that it is stable and securely parked.
- When attaching front attachments always make sure that the load on the existing rear axle is sufficient to maintain the forage harvester's steering and braking capabilities.

2423

### 1.2.5 Adjustment and maintenance work

The drives on the machine will not be automatically secured from moving after the engine has been switched off.

Moreover, when it comes to adjustments, it may be necessary to turn the drives.

For this reason, comply with the following rules:

- Before setting, cleaning and maintenance operations and when remedying problems:
  - Switch off the chopper unit.
  - Shut off the engine.
  - Disconnect the battery isolating switch.
- Before setting, cleaning and maintenance operations and when remedying problems on the hydraulic system, lower front attachment and/or feeder unit completely.
- Always turn off the battery isolating switch before carrying out any electrical repairs on the machine.

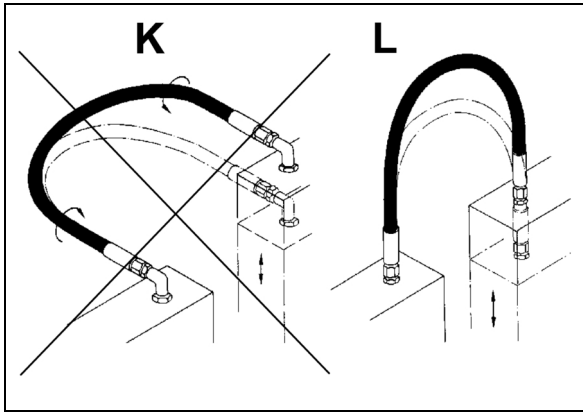

5729

5

Avoiding torsional loads:

- When connecting a hose to moving parts, avoid twisting the hose, especially when the movement and the bending occur in the same plane.

**K** = incorrect installation

**L** = correct installation

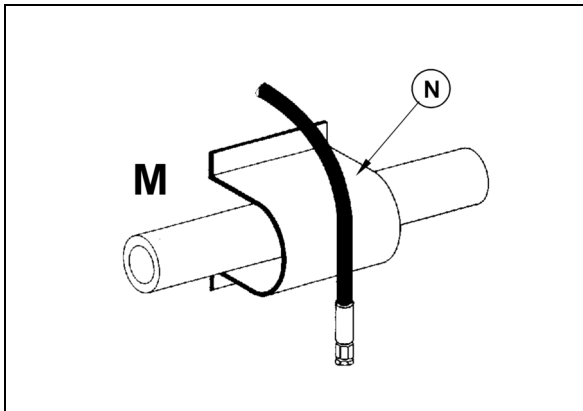

5730

6

Protection against external temperature effects:

- When major external temperature effects occur, install hoses at a sufficient distance from heat-emitting components.
- Or protect hose by a shielding (N).

### 1.3.14 Welding Work



**Note!**

All information regarding this subject-matter can be found in the current Operator's manual of the machine.

## 1.5 Specifications

### 1.5.1 Lubricants

**Note!**

All information regarding this subject-matter can be found in the current Operator's manual of the machine.

### 2.1.10 Removing chain (K9)

- Observe the general warnings at the beginning of the "Maintenance" chapter.



**Warning!**

Pinch points during assembly work.

Bruises of limbs.

- Keep limbs out of the hazard area.
- Use suitable tools.

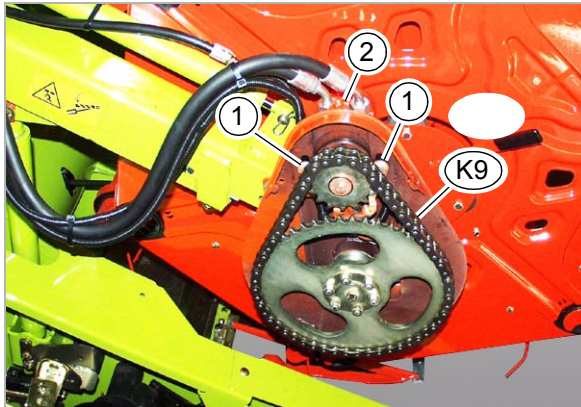

15

8393

- Remove safety device.
- Slightly loosen the bolts (1).
- Relieve tension of chain (K9) with bolt (2).
- Open chain connector and remove chain (K9).

48952

### 2.1.11 Installing chain (K9)



**Warning!**

Use of unauthorised spare parts.

Machine damage.

- Spare parts must at least comply with the technical standards required by the manufacturer of the implement!
- We recommend using genuine CLAAS spare parts.

- Observe the general warnings at the beginning of the "Maintenance" chapter.



**Warning!**

Pinch points during assembly work.

Bruises of limbs.

- Keep limbs out of the hazard area.
- Use suitable tools.

Observe the specifications in the overview.

- Relieve the stress of joint by slight blows with a plastic-tip hammer on the yokes.
- Check if bearing is running smoothly.
- Grease centre cross assembly (4).

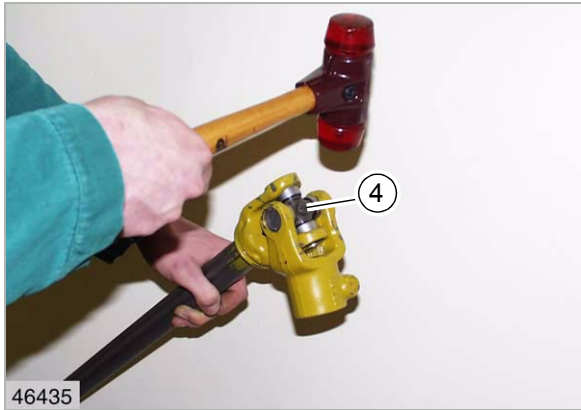

46435

**41**

17392

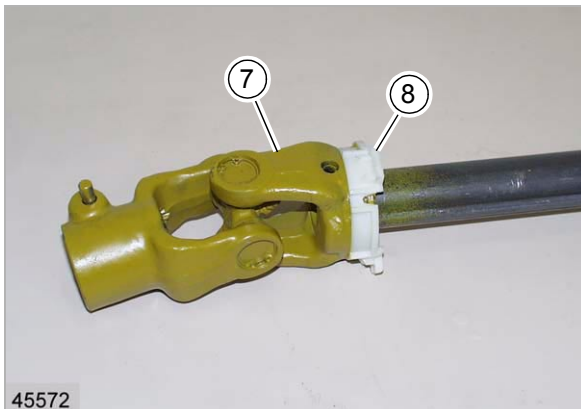

45572

**42**

17377

- Insert slide ring (8) into the groove of yoke (7).

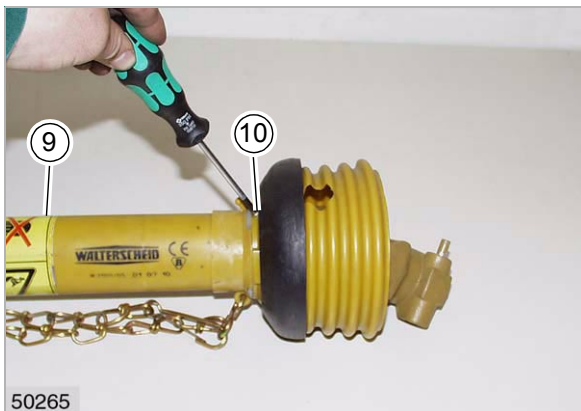

50265

**43**

17376

- Slide on the tube (9) and secure it with bolt (10).

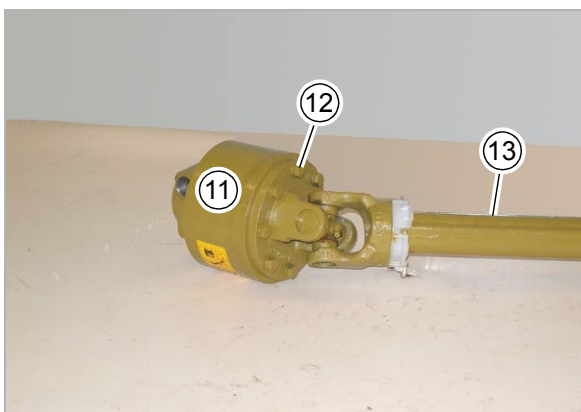

**44**

17372

- Bolt cam-type cut-out clutch (11) to the universal drive shaft half (13) with bolts (12).

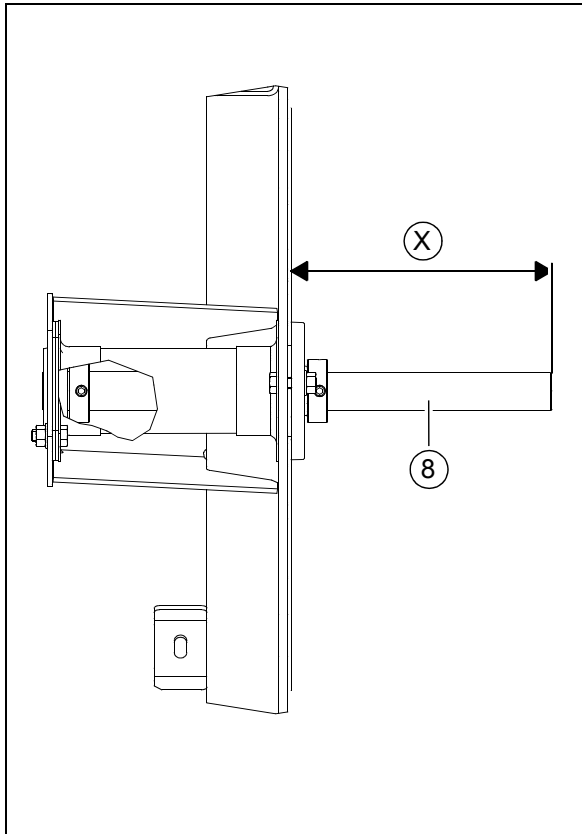

66

17420

Pos.	M <sub>A</sub> (Nm)	Auxiliary operating materials	Dimensions	Remarks
7, 8			230.5 mm	Align the intermediate drive shaft on the left (7) and the shaft end on the right (8) to dimension (X) prior to bolting down.
M <sub>A</sub> = Tightening torque				

48409

### 2.3.3 Assembling / installing the intermediate drive shaft

- Slide the flange ball bearings, universal drive shaft guards and flanges on the intermediate drive shaft (1).
- Insert the intermediate drive shaft (1).

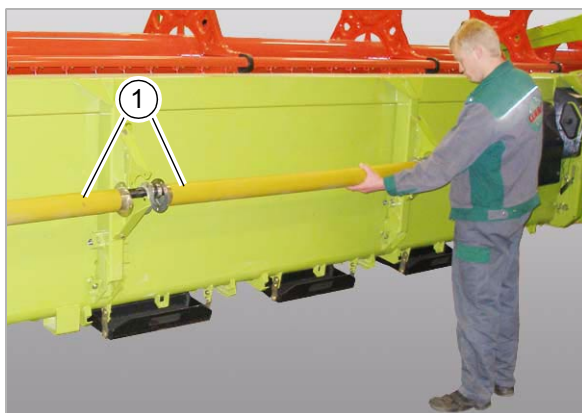

67

17417

**2.4.11 Removing the driven pulley of belt (R1)**

The drive is on the left and right side of the front attachment.

- Remove belt (R1).
- Unscrew bolts (1).
- Remove flyweight (2).

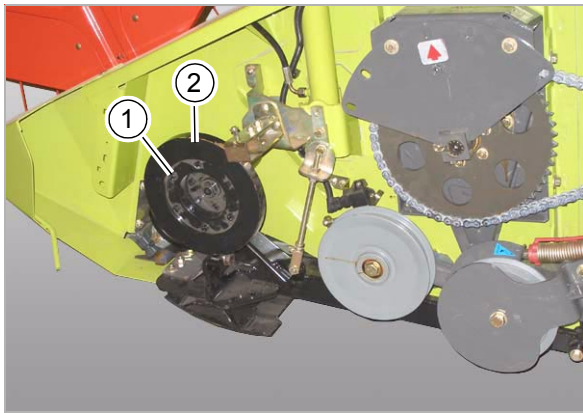

**83**

17550

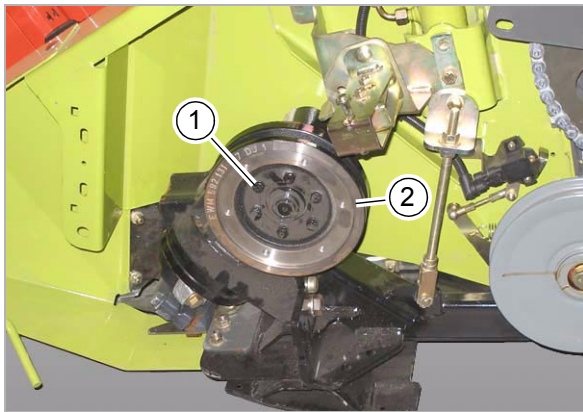

**84**

17551

- Unscrew bolts (1).
- Remove pulley (2).

**2.4.12 Installing the driven pulley of belt (R1)**

The drive is on the left and right side of the front attachment.

Observe the specifications in the overview.

- Bolt down pulley (1) with bolts (2).

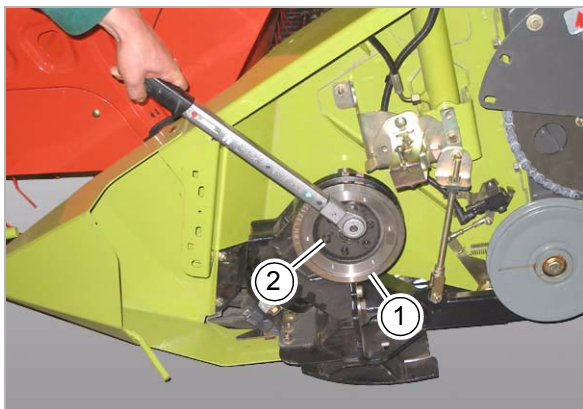

**85**

17556

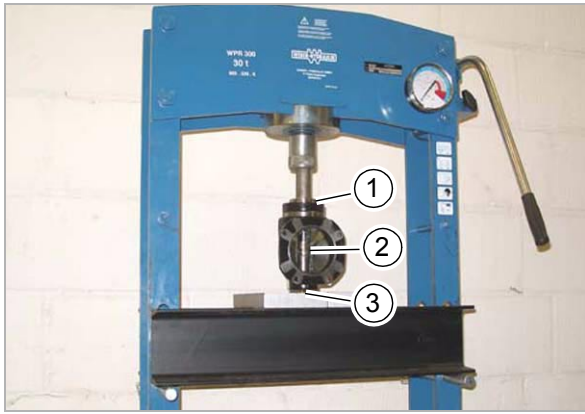

**112**

19740

- Force the bevel gear (1) on the drive axle (2).
- Back up drive axle (2) at position (3).

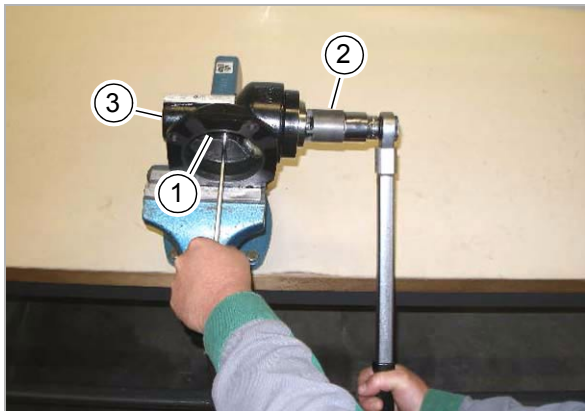

**113**

19727

Observe the specifications in the overview.

- Slide washer on the drive axle (1).
- Block the drive axle (1).
- Bolt down slotted nut (2) with a special tool.
- Install cap (3).

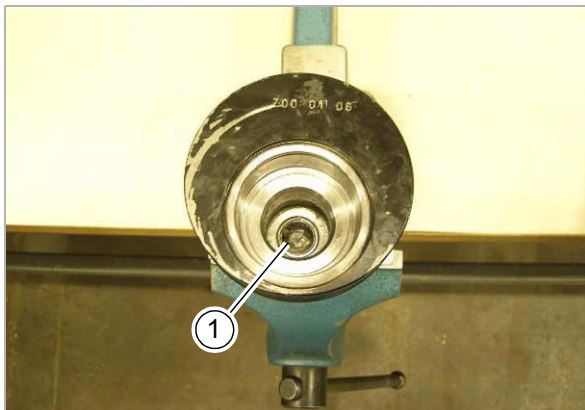

**114**

19579

- Install new needle bearing (1).

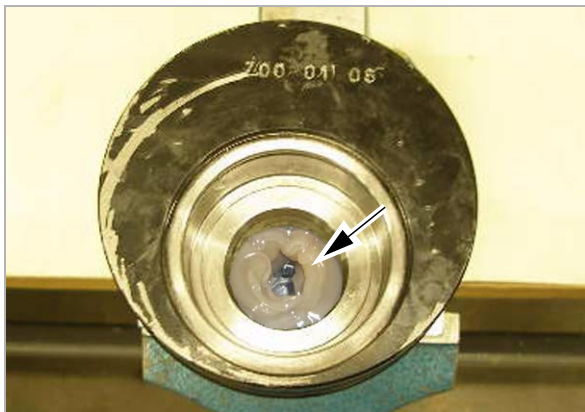

**115**

19789

Observe the specifications in the overview.

- Fill in grease.

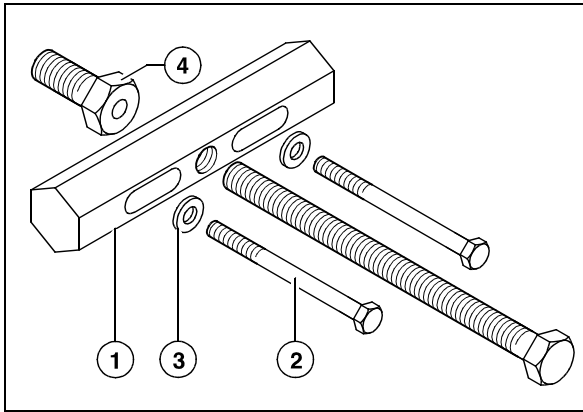

**145**

586

**Special tool:**

- 1 Puller bridge  
Part no. 000 181 622 1
- 2 Hex. bolt  
ISO 4017 M8 x 70-8.8  
Part no. 000 238 092 0
- 3 Washer  
Part no. 000 233 577 0
- 4 Hex. bolt, head-centred  
ISO 4074 M12 x 20-8.8  
Part no. 000 237 458 0



**146**

19586

**2.5.3 Assembling the planetary gear**

56238

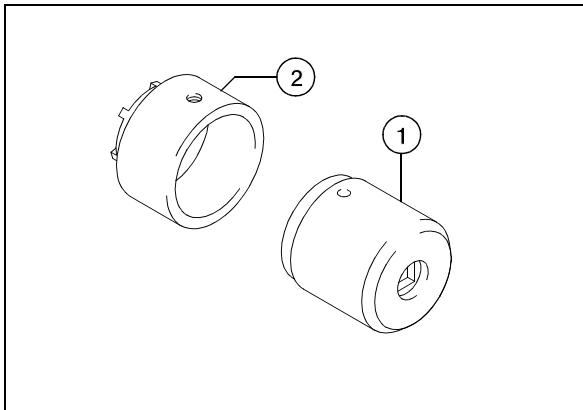

**147**

10691

**Special tool:**

- 1 Adapter  
Part no. 000 181 641 0
- 2 Socket spanner  
Part no. 000 181 808 0



**148**

19738

CLICK HERE TO **DOWNLOAD** THE COMPLETE MANUAL

- Thank you very much for reading the preview of the manual.
- You can download the complete manual from: [www.heydownloads.com](http://www.heydownloads.com) by clicking the link below



- Please note: If there is no response to CLICKING the link, please download this PDF first and then click on it.

CLICK HERE TO **DOWNLOAD** THE COMPLETE MANUAL

**2.6.8 Installing the outer intake auger bearing**

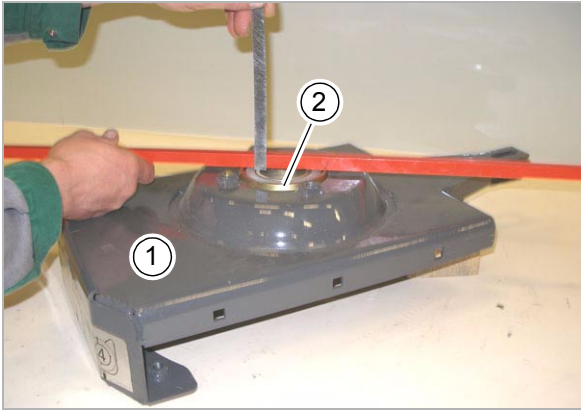

**175**

17685

- Bolt the sheet metal flange (2) down to the bearing plate (1) hand-tight.
- Align the sheet metal flange (2) to be parallel with the bearing plate (1).
- Determine dimension (V).



**176**

17686

- Determine dimension (X).



**177**

17687

- Determine dimension (Y) from the side panel to the shaft shoulder.

**2.7.2 Removing the outer intake auger bearing**

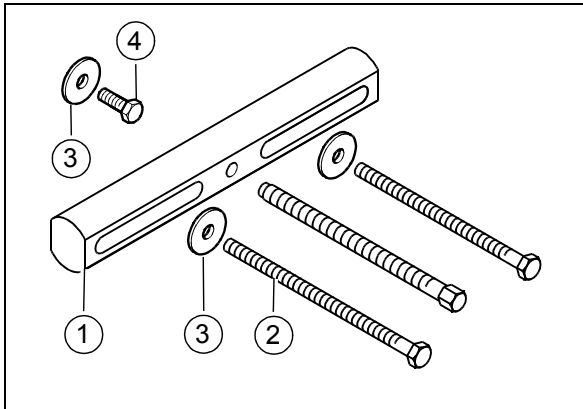

**203**

17676

- 1 Puller bridge  
Part no. 000 181 621 0
- 2 Hex. bolt  
ISO 4017 M12 x 200-8.8  
Part no. 000 244 421 0  
2 pcs.
- 3 Washer  
12.5 x 45 x 10  
Part no. 000 712 415 0  
3 pcs.
- 4 Hex. bolt, head-centred  
ISO 4017 M12 x 25-8.8  
Part no. 000 236 056 0

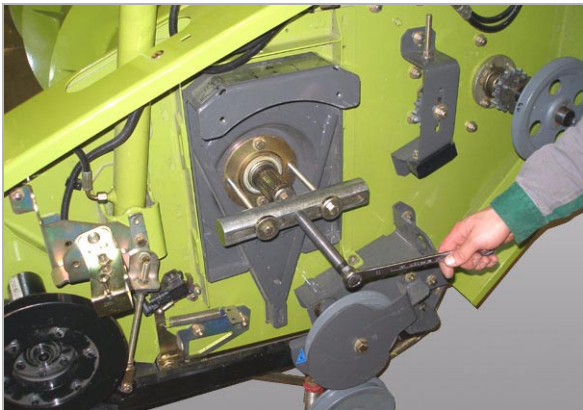

**204**

17663

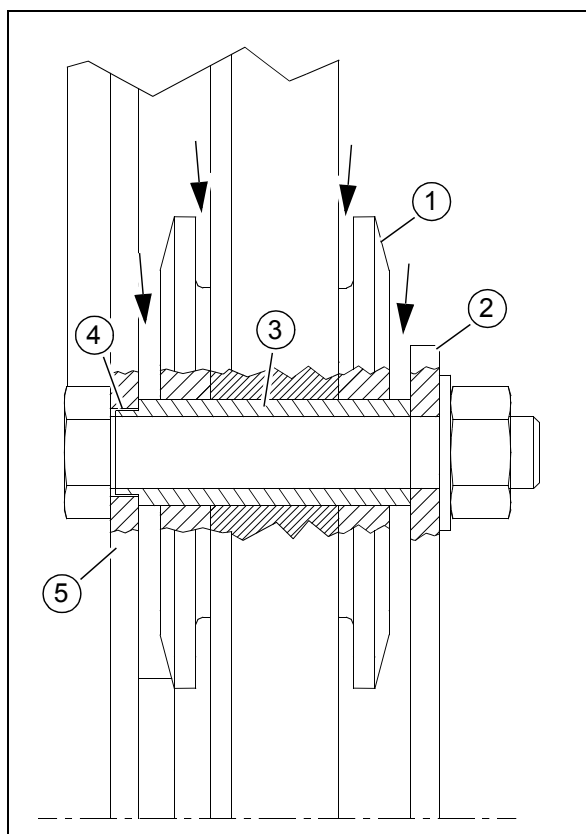

233

18198



234

19106

	Designation
1	Cam roller
2	Supporting plate
3	Sleeve
4	Centring section
5	Cam roller bracket

- Ensure proper seating of centring section (4) of sleeve (3) in the bore of cam roller bracket (5).
- Bolt down all cam rollers (1).  
Ensure that all cam rollers (1) can move freely and will have not contact at the points marked with an arrow.

- Install the right reel.
- Install the right reel shaft bearing.
- Fit hydraulic reel drive motor (2012).
- Install the drive sprocket of chain (K9)
- Install the driven sprocket of chain (K9)
- Install chain (K9)
- Perform a function check.

54302

**2.8.11 Removing the flanged shaft between the left and right reel**

- Remove / disassemble the centre reel shaft bearing.

54303

**2.8.12 Installing the flanged shaft between the left and right reel**

- Assemble / install centre reel shaft bearing.

**3.4.2 Left reel height adjustment hydraulic cylinder (3015) - Overview**

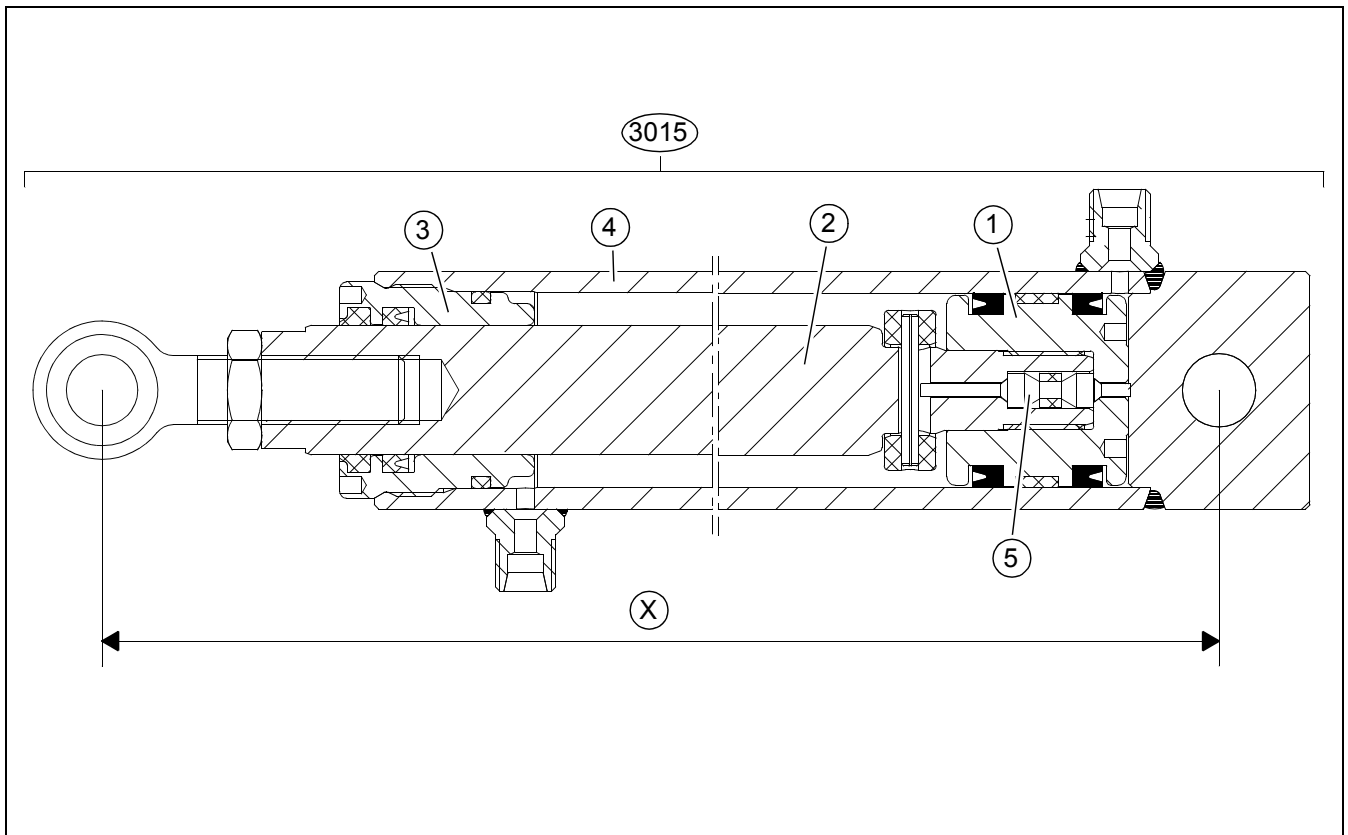

17995 **18**

Pos.	M <sub>A</sub> (Nm)	Auxiliary operating materials	Remarks
1, 2	<b>80 Nm</b>	Liquid locking compound (high-strength), e.g.: DELO-ML-5328, Part no. 000 178 779 1	Join the ram (1) and the connecting rod (2) with liquid locking compound.
3, 4	<b>150 Nm</b>	Liquid locking compound (high-strength), e.g.: DELO-ML-5328, Part no. 000 178 779 1	Join cylinder head (3) and cylinder barrel (4) with liquid locking compound.
5			Observe correct installation position of spring (5).
M <sub>A</sub> = Tightening torque			

Pos.	Designation	Dimensions	Remarks
X	Adjustment dimension	<b>570 mm</b>	Adjust basic adjustment of dimension (X) with the ram rod completely retracted.

**3.4.12 Installing the hydraulic fore and aft reel adjustment hydraulic cylinder (3016)**

- Secure reel with straps.

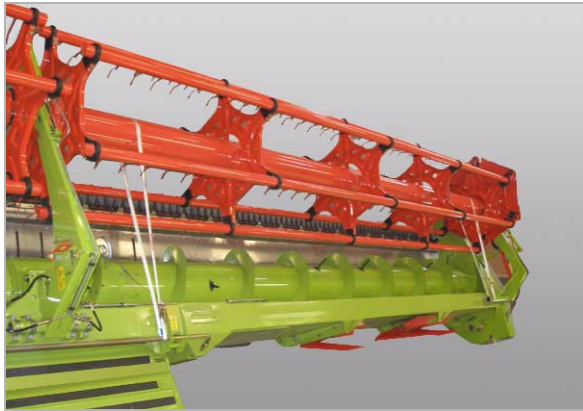

18004

**34**



18005

**35**

- Install hydraulic cylinder (1).
- Slide in pins (2) and (3) and secure with cotter pin.
- Bolt down hose (4).
- Fasten hose (4) to the hydraulic cylinder (1) with cable band (5).

**Bleeding the hydraulic cylinders:**

- Start the diesel engine.
- Retract the reel completely and move it against the end position for approx. 15 seconds.
- Extend the reel completely and move it against the end position for approx. 15 seconds.

*When reaching the end position, air inclusions are flushed out of the hydraulic cylinders.*

- Check hydraulic oil level and top up if necessary.

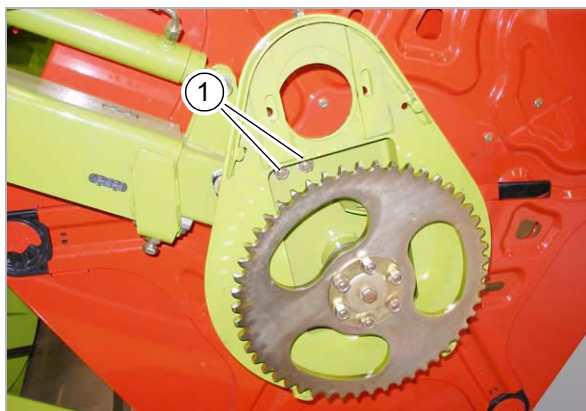

**20**

17975

- Insert bolts (1) and bolt them down.



**21**

17981

- Bolt down bolts (1).
- Unhook the lifting strap.



**22**

17977

- Screw reel drive hydraulic motor (2012) to bracket (1).

- Install the drive sprocket of chain (K9)
- Install chain (K9)
- Perform a function check.



49

19478

- Slide on parts of inner bearing part.  
Ensure that the inner bearing part has clicked.

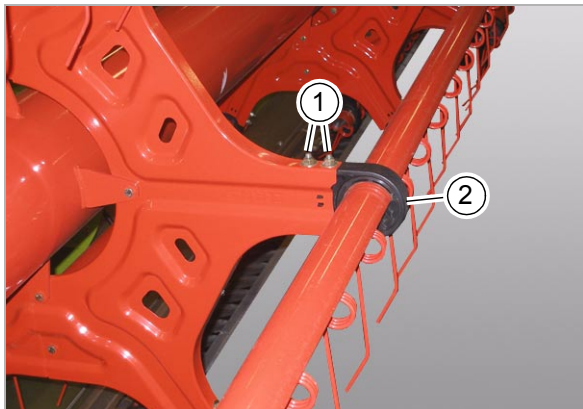

50

19292

- Screw in bolts (1) of the inner bearing part (2).  
Observe the installation position of bolts (1) and of the inner bearing part (2) at the left reel (L) and the right reel (R).  
- **Tightening torque = 10 Nm**

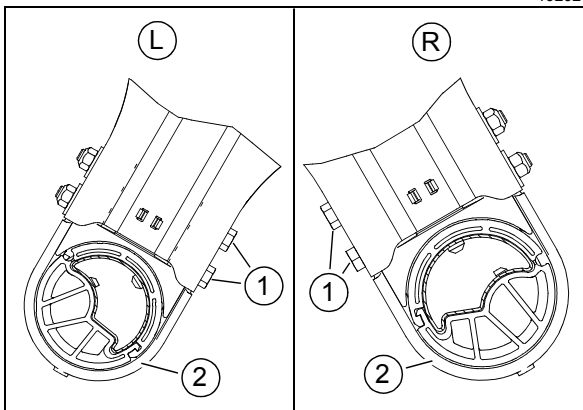

51

19290

- Insert sheet metal plates (1) and bolt them down.

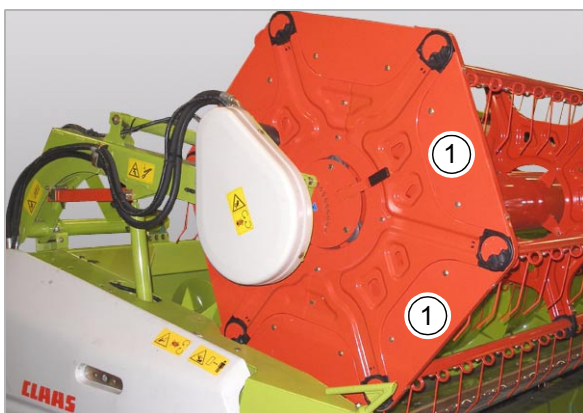

52

19167

- Perform a function check.

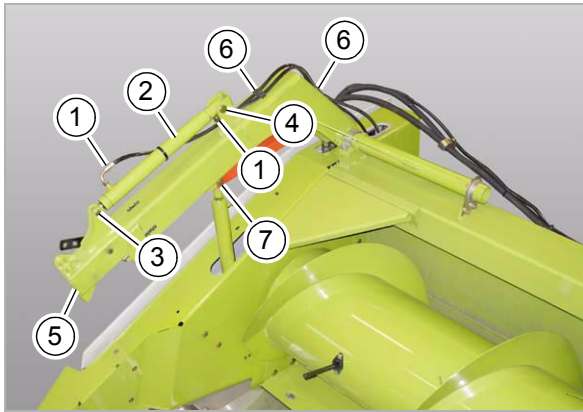

17979

81

- Remove reel.
- Remove hydraulic lines (1) from hydraulic cylinder (2) and plug with plugs on both sides. Collect any escaping hydraulic oil.
- Unlock pins (3) and (4) and pull them out.
- Remove hydraulic cylinder (2).
- Pull out telescopic arm (5).
- Unscrew clamps (6).
- Unlock pin (7) and pull it out.

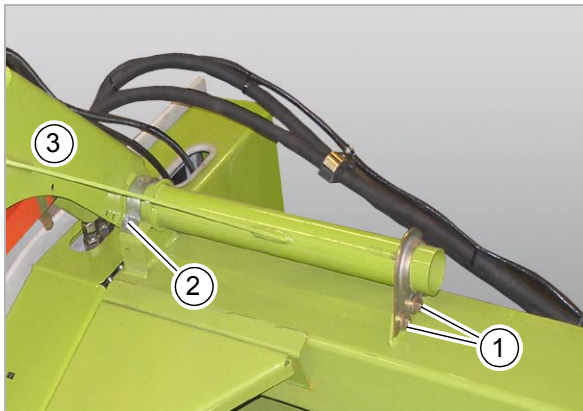

18139

82

- Slacken off bolts (1) and (2).
- Remove reel support arm (3).

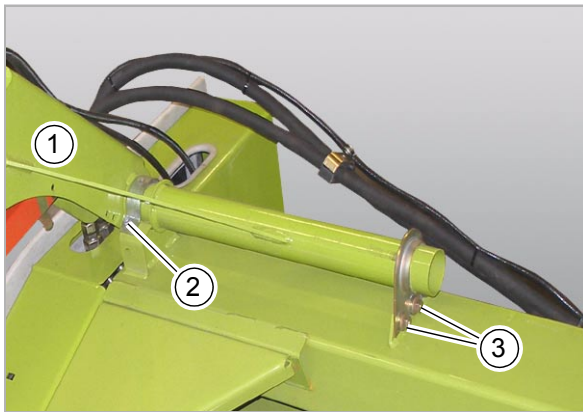

18139

83

### 5.1.25 Installing the outer reel support arm

50707

- Put the reel support arm (1) in place.
- Bolt down bolts (2) and (3).

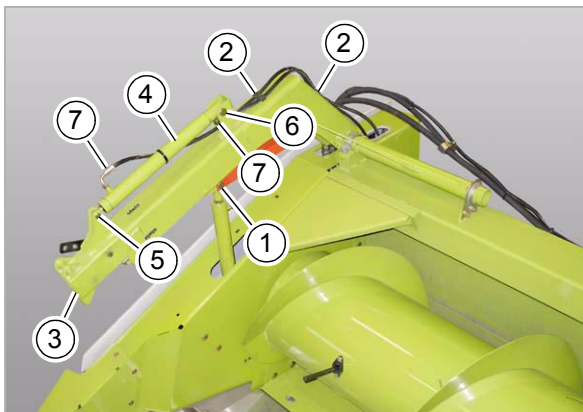

17979

84

- Insert pins (1) and secure them.
- Bolt down clamps (2).
- Slide in telescopic arm (3).
- Insert hydraulic cylinder (4).
- Insert pins (5) and (6) and secure them.
- Bolt down hoses (7).
- Install the reel.

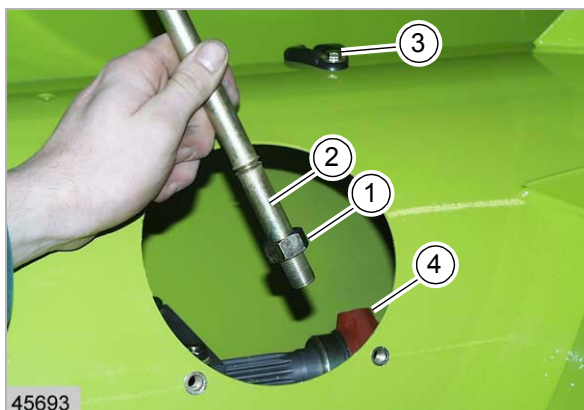

17

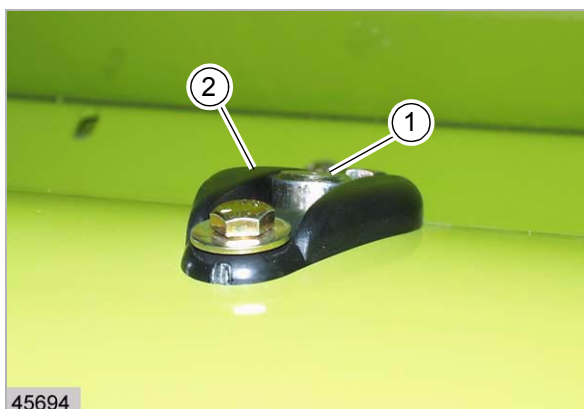

18



19

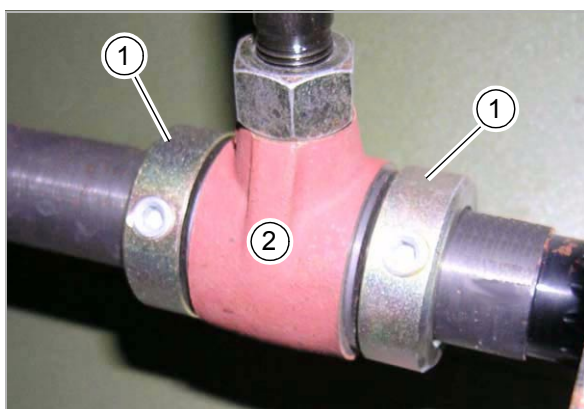

20

### 6.1.4 Installing intake auger fingers

- Turn back nut (1) until the end of the thread of the new finger (2).
- Introduce finger (2) into the auger housing from the bottom through guide (3).
- Screw finger (2) into the support (4).  
Screw in finger only so that it will not touch the axle of support (4).  
If required, turn back finger (2) by one turn.

- Turn auger until the finger (2) has been drawn into the auger housing as far as possible.
- In this auger position, adjust the finger (1) so that it is flush with the top edge of the guide (2).
- Screw on nut (3).
- By turning the auger, ensure that finger (1) will not collide with the auger trough anywhere.

- Ensure that the play between the set collars (1) and support (2) is about 2 mm.  
If required, adjust set collars (1).

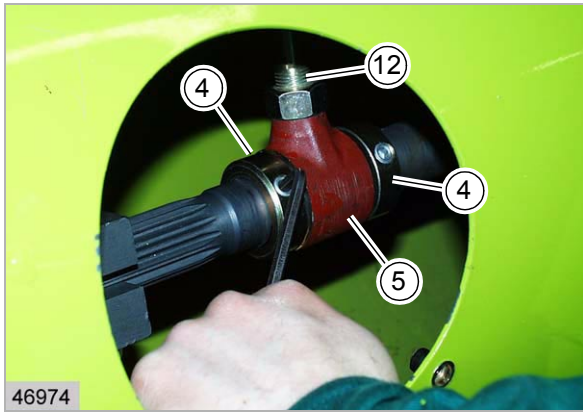

**47**

- Align swivel bearing (5) with the finger guide.  
To do this, slacken off the set collars (4) on the control shaft.
- Install fingers (12) of intake auger.
- Adjust a play of 2 mm between set collars (4) and swivel bearing (5).
- Secure set collars (4).

- Rotate intake auger by hand and check if all fingers work properly.
- Install chain (K6).
- Install belt (R1).
- Connect universal drive shaft to the feed rake conveyor.
- Move reel tines to working position.
- Move out the reel safety locks.  
In doing this, observe the information given in the Operator's manual!
- Remove the feed rake conveyor safety lock.  
In doing this, observe the information given in the Operator's manual!

CLICK HERE TO **DOWNLOAD** THE COMPLETE MANUAL

- Thank you very much for reading the preview of the manual.
- You can download the complete manual from: [www.heydownloads.com](http://www.heydownloads.com) by clicking the link below



- Please note: If there is no response to CLICKING the link, please download this PDF first and then click on it.

CLICK HERE TO **DOWNLOAD** THE COMPLETE MANUAL