

[CLICK HERE FOR  
TRACTOR  
TABLE OF CONTENTS](#)

[CLICK HERE FOR  
TRAILER  
TABLE OF CONTENTS](#)



# Parts Book

[CLICK HERE TO RETURN TO  
MAIN LIBRARY INDEX](#)

**Part Number  
15275609**

P10894

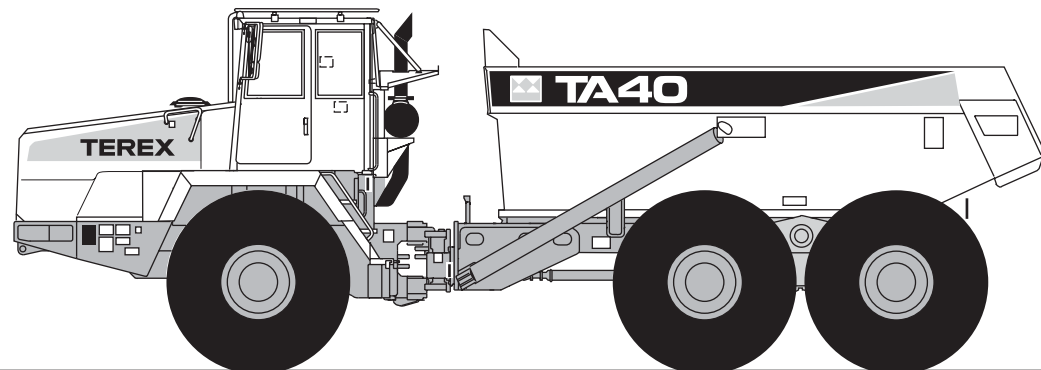

## TA40 OCDB Articulated Truck

(Detroit Diesel Series 60 Powered)

**From Serial No. A8201001**

Nov 01  
Revised Aug 02

PUBLISHED BY:  
PRODUCT SUPPORT DEPARTMENT

TEREX EQUIPMENT LIMITED  
MOTHERWELL, SCOTLAND

CLICK HERE TO **DOWNLOAD** THE COMPLETE MANUAL

- Thank you very much for reading the preview of the manual.
- You can download the complete manual from: [www.heydownloads.com](http://www.heydownloads.com) by clicking the link below



- Please note: If there is no response to CLICKING the link, please download this PDF first and then click on it.

CLICK HERE TO **DOWNLOAD** THE COMPLETE MANUAL

**100-0010-8211 CHASSIS**  
FROM SERIAL NO. A8201001

NC	REF	QTY	PART NO.	DESCRIPTION	SER.NO. FROM	SER.NO. TO
----	-----	-----	----------	-------------	-----------------	---------------

001	001		15310725	FRAME ASSY-COMLETE		
-----	-----	--	----------	--------------------	--	--

**110-0060-8211 AIR CLEANER PIPES AND HOSES**  
 FROM SERIAL NO. A8201001

NC	REF	QTY	PART NO.	DESCRIPTION	SER.NO. FROM	SER.NO. TO
001	001		15308940	BRACKET-A/C MTG		
002	008		06351240	BOLT		
003	008		07161230	LOCKWASHER		
004	016		09267660	WASHER		
005	008		06431201	NUT		
006	001		15310968	TUBE ASSY-AIR INTAKE		
007	001		15246331	HOSE		
008	001		09356047	CLAMP		
009	001		15246332	ELBOW		
010	002		09229246	CLAMP		
011	001		15246333	INSERT		
012	001		09204030	CLAMP		
013	001		15310973	BRACKET-A/C MTG		
014	001		15312286	BRACKET-AIR INTAKE TUB		
015	001		06441020	BOLT		
016	001		07161030	LOCKWASHER		
017	001		06350820	SCREW		
018	001		07160830	LOCKWASHER		
019	002		15244714	WASHER-HARDENED		
020	001		09065853	CLAMP		
021	001		15250363	PLATE		
022	001		00179837	BOLT		
023	001		00102635	NUT		
024	001		09131881	CLAMP		

**120-0070-8211 SHIFT CONTROL**  
FROM SERIAL NO. A8201001

NC	REF	QTY	PART NO.	DESCRIPTION	SER.NO. FROM	SER.NO. TO
001	001		15305235	AUTO KIT EST-37	A8201001	A8201011
001	001		15312088	AUTO KIT EST-37	A8201012	
002	001		15274262	.SHIFT CONTROLLER		
003	001		15273731	.VDU AND CABLE		
004	001		15275194	.MODULE		
005	001		15271329	.HARNESS		
006	001		15266837	.FOOTSWITCH		

**120-0390-8211 TORQUE CONVERTER**  
FROM SERIAL NO. A8201001

NC	REF	QTY	PART NO.	DESCRIPTION	SER.NO. FROM	SER.NO. TO
----	-----	-----	----------	-------------	-----------------	---------------

001	001		15269255	CONVERTER		
-----	-----	--	----------	-----------	--	--

120-0440-8211 GEARSHIFT  
FROM SERIAL NO. A8201001

DRAWING NO. P9666B

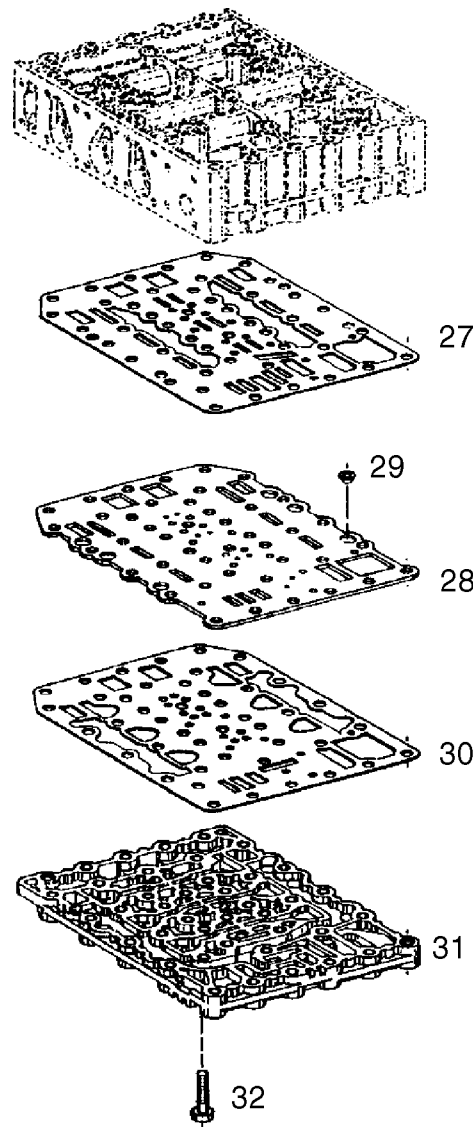

THIS PAGE IS INTENTIONALLY LEFT BLANK

**120-0510-8211 POWER TAKE-OFF**  
FROM SERIAL NO. A8201001

NC	REF	QTY	PART NO.	DESCRIPTION	SER.NO. FROM	SER.NO. TO
001	001		15269460	SHAFT		
002	001		15269461	GEAR		
003	001		15269462	BEARING-ROLLER		
004	001		15269463	ORIFICE		
005	001		15269455	BEARING-ROLLER		
006	001		15269440	SHIM-2.00		
007	001		15269429	SHIM-1.15		
007	001		15269430	SHIM-1.20		
007	001		15269431	SHIM-1.25		
007	001		15269432	SHIM-1.30		
007	001		15269428	SHIM-1.10		
007	001		15269427	SHIM-1.05		
007	001		15269426	SHIM-1.00		
007	001		15269425	SHIM-0.95		
007	001		15269440	SHIM-2.00		
007	001		15269439	SHIM-1.65		
007	001		15269438	SHIM-1.60		
007	001		15269437	SHIM-1.55		
007	001		15269436	SHIM-1.50		
007	001		15269435	SHIM-1.45		
007	001		15269434	SHIM-1.40		
007	001		15269433	SHIM-1.35		
007	001		15269424	SHIM-0.90		
007	001		15269415	SHIM-0.45		
007	001		15269414	SHIM-0.40		
007	001		15269413	SHIM-0.35		
007	001		15269412	SHIM-0.30		
007	001		15269411	SHIM-0.25		
007	001		15269410	SHIM-0.20		
007	001		15269409	SHIM-0.15		
007	001		15269408	SHIM-0.10		
007	001		15269423	SHIM-0.85		
007	001		15269422	SHIM-0.80		
007	001		15269421	SHIM-0.75		
007	001		15269420	SHIM-0.70		
007	001		15269419	SHIM-0.65		
007	001		15269418	SHIM-0.60		
007	001		15269417	SHIM-0.55		
007	001		15269416	SHIM-0.50		
008	001		09397714	CIRCLIP		

**120-0510-8211 POWER TAKE-OFF**  
FROM SERIAL NO. A8201001

NC	REF	QTY	PART NO.	DESCRIPTION	SER.NO. FROM	SER.NO. TO
009	001		15271656	FLANGE-PUMP		
010	001		15269466	O RING		
011	004		15269467	SCREW		
012	001		15269474	SHIM-2.00		
012	001		15269475	SHIM-1.85		
012	001		15269476	SHIM-1.70		
012	001		15269477	SHIM-1.55		
012	001		15269478	SHIM-1.40		
012	001		15269473	SHIM-2.15		
012	001		15269468	SHIM-2.90		
012	001		15269469	SHIM-2.75		
012	001		15269470	SHIM-2.60		
012	001		15269471	SHIM-2.45		
012	001		15269472	SHIM-2.30		
013	001		15271657	O RING		
014	001		15268869	GASKET		

**120-0550-8211 AXLE DISCONNECT**  
FROM SERIAL NO. A8201001

NC	REF	QTY	PART NO.	DESCRIPTION	SER.NO. FROM	SER.NO. TO
001	001		15273953	HOUSING-G/SHIFT		
002	001		15269622	GASKET		
003	006		15269623	CAPSCREW		
004	006		15269624	SCREW-HEXAGON		
005	001		15269625	SCREW-HEXAGON		
006	002		15269626	PIN-CYLINDRICAL		
007	001		15269627	SPRING		
008	001		15269628	PISTON		
009	001		15269629	SHIM RING		
009	001		15269630	SHIM RING		
009	001		15267214	SHIM		
009	001		15269631	SHIM RING		
009	001		15267216	SHIM		
010	001		15269615	CAPSCREW		
011	001		15269616	RING-PISTON		
012	001		09398637	DISC		
013	001		09398636	ELEMENT-FILTER		
014	001		15269045	PLUG		
015	001		15271643	BOLT		
016	001		15271545	WASHER-TAB		
017	001		15271644	SWITCH		
018	001		15269646	RING		
019	001		15265435	O RING		
020	001		15269618	PIN		
021	001		15274166	SHIFT FORK		
022	002		09398642	BLOCK-THRUST		
023	001		15269620	SLEEVE-SLIDING		
024	001		15271637	BEARING		
025	001		15269610	WASHER		
026	001		15269632	RING-RETAINER		
027	001		15269633	CAP-SEALING		
028	001		15269636	WASHER-0.50		
028	001		15269637	WASHER-1.50		
028	001		15269638	WASHER-1.60		
028	001		15269639	WASHER-1.70		
028	001		15269640	WASHER-1.80		
028	001		15269635	WASHER-0.40		
028	001		15269634	WASHER-0.30		
029	001		09397919	CIRCLIP		
030	001		15269642	SHIM-4.00		

**120-0550-8211 AXLE DISCONNECT**  
FROM SERIAL NO. A8201001

NC	REF	QTY	PART NO.	DESCRIPTION	SER.NO. FROM	SER.NO. TO
030	001		15269641	SHIM-3.00		
031	001		15271884	FLANGE-OUTPUT		
032	001		15269611	SHAFT-SEAL		
033	001		15269645	WASHER		
034	002		09399327	SCREW		
035	001		15271650	SCREEN SHEET		

**140-0060-8211 DIFFERENTIAL-FRONT**  
FROM SERIAL NO. A8201001

NC	REF	QTY	PART NO.	DESCRIPTION	SER.NO. FROM	SER.NO. TO
	001	001	15275563	DIFF ASSY-FRONT AXLE		
	002	008	15265844	.SETSCREW		
	003	008	15265845	.WASHER		
	004	001	15265846	.RETAINER		
	005	ASR	15265849	.SHIM (0.38 MM)		
	005	ASR	15265848	.SHIM (0.25 MM)		
	005	ASR	15265847	.SHIM (0.20 MM)		
	006	001	15273192	.HOUSING		
	007	001	15265852	.BEARING		
	008	001	15269793	.HELICAL PINION		
	009	001	15265883	.BEARING		
	010	ASR	15265864	.SPACER (6.750MM)		
	010	ASR	15265862	.SPACER (6.700MM)		
	010	ASR	15265861	.SPACER (6.675MM)		
	010	ASR	15265859	.SPACER (6.625MM)		
	010	ASR	15265854	.SPACER (6.500MM)		
	010	ASR	15265855	.SPACER (6.525MM)		
	010	ASR	15265857	.SPACER (6.575MM)		
	010	ASR	15265858	.SPACER (6.600MM)		
	011	ASR	15265868	.SPACER (9.300MM)		
	011	ASR	15265869	.SPACER (9.600MM)		
	011	ASR	15265871	.SPACER (10.200MM)		
	011	ASR	15265867	.SPACER (9.000MM)		
	012	001	15265872	.BEARING		
	013	001	15273193	.GEAR SET-2400 RATIO		
	014	001	15265874	.BEARING		
	015	003	15265876	.DOWEL		
A	016	001	15273194	.CASE ASSY		
	017	012	15273195	.BOLT		
	018	020	15265878	.STUD		
B	019	001	15273981	.DIFF HOUSING ASSY		
	020	001	15274403	.END-FLANGED		
	021	012	15265881	.NUT		
	022	002	15265882	.NUT-ADJUSTING		
	023	002	15265883	.BEARING		
	024	002	15273799	.THRUST WASHER		
	025	004	15265885	.PLATE		
	026	004	15265886	.PLATE		
	027	002	15273797	.DIFF CAGE		
	028	002	15265888	.WHEEL-DIFF		

**140-0060-8211 DIFFERENTIAL-FRONT**  
FROM SERIAL NO. A8201001

NC	REF	QTY	PART NO.	DESCRIPTION	SER.NO. FROM	SER.NO. TO
	029	002	15267865	.TRUNNION-DIFF		
	030	004	15273798	.PINION GEAR		
	031	002	15274402	.STRAP-GEAR CASING		
	032	004	15265890	.WASHER		
	033	004	15265891	.NUT		
	034	002	15265907	.PIN SPLIT		
	035	001	15274404	.END-BOLTED		
	036	020	15273196	.NUT		
	037	004	15265911	.STUD		
	038	ASR	15265918	.SHIM (0.005 IN)		
	038	ASR	15265919	.SHIM (0.007 IN)		
	039	001	15265921	.HOUSING		
	040	001	15265872	.BEARING		
	041	007	15275542	.SETSCREW		
	042	001	15269795	.HELICAL WHEEL		
	043	001	15265931	.NUT		
	044	013	15265925	.WASHER		
	045	013	15265926	.BOLT		
	046	001	15275540	AXLE CASING		
	047	001	15271234	LOCKNUT		
	048	001	15271235	LOCKPLATE		
	049	001	15265896	BEARING		
	050	001	15265939	SEAL-VITON		
	051	001	15265898	CAP		
	052	001	15267716	SHAFT		
	053	006	15265900	NUT		
	054	006	15265901	WASHER		
	055	006	15265902	STUD		
	056	001	15265903	PLUG		
	057	001	15265905	PLUG		
	058	007	15265906	STUD		
	058	007	15275541	STUD-AXLE CASING		
	059	014	15265912	WASHER-SPRING		
	060	014	15265913	NUT		







**NOTES:**

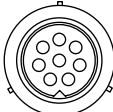

- A ITEM 16 INCLUDES ITEMS 31,32,33 & 37
- B ITEM 19 INCLUDES ITEMS 18,20,27 & 35

**190-0011-8211 CONNECTORS**  
FROM SERIAL NO. A8201001

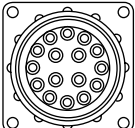
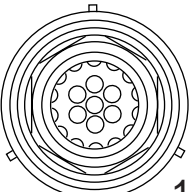
DRAWING NO. P9337B

P9337

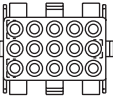
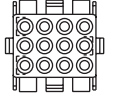
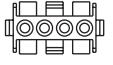
TERMINAL; SOCKET, HARNESSFLEX SUITABLE CONNECTORS;- 		
OUTLINE	TYPE	PART NO
 <b>14</b>	5-WAY	15252801
 <b>15</b>	BAYONET 8-WAY	15252729
 <b>16</b>	BAYONET 8-WAY	15252044
 <b>17</b>	BAYONET 16-WAY	15255081
 <b>18</b>	BAYONET 21-WAY	15252045
 <b>19</b>	90° SWIVEL (M27)	15234423
 <b>20</b>	90° SWIVEL (M24)	15244784

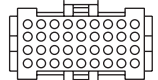
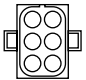
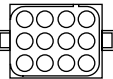
TERMINAL; PIN, AMPLIVERSAL SUITABLE CONNECTORS;- 		
OUTLINE	TYPE	PART NO
 <b>21</b>	MATE-N-LOCK	15248364
 <b>22</b>	MATE-N-LOCK	15251638
 <b>23</b>	MATE-N-LOCK	15256836
 <b>24</b>	MATE-N-LOCK	15256587
 <b>25</b>	MR 11	15256611
 <b>26</b>	MATE-N-LOCK	09377007
 <b>27</b>	MATE-N-LOCK	09371774

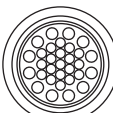
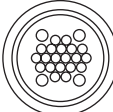
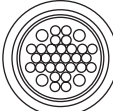
TERMINAL; PIN, RISTS & CANNON SUITABLE CONNECTORS;- 		
OUTLINE	TYPE	PART NO
 <b>28</b>	CANNON (12-19)	15248074
 <b>29</b>	CANNON (4-20)	15248077
 <b>30</b>	CANNON (4-28)	15257951

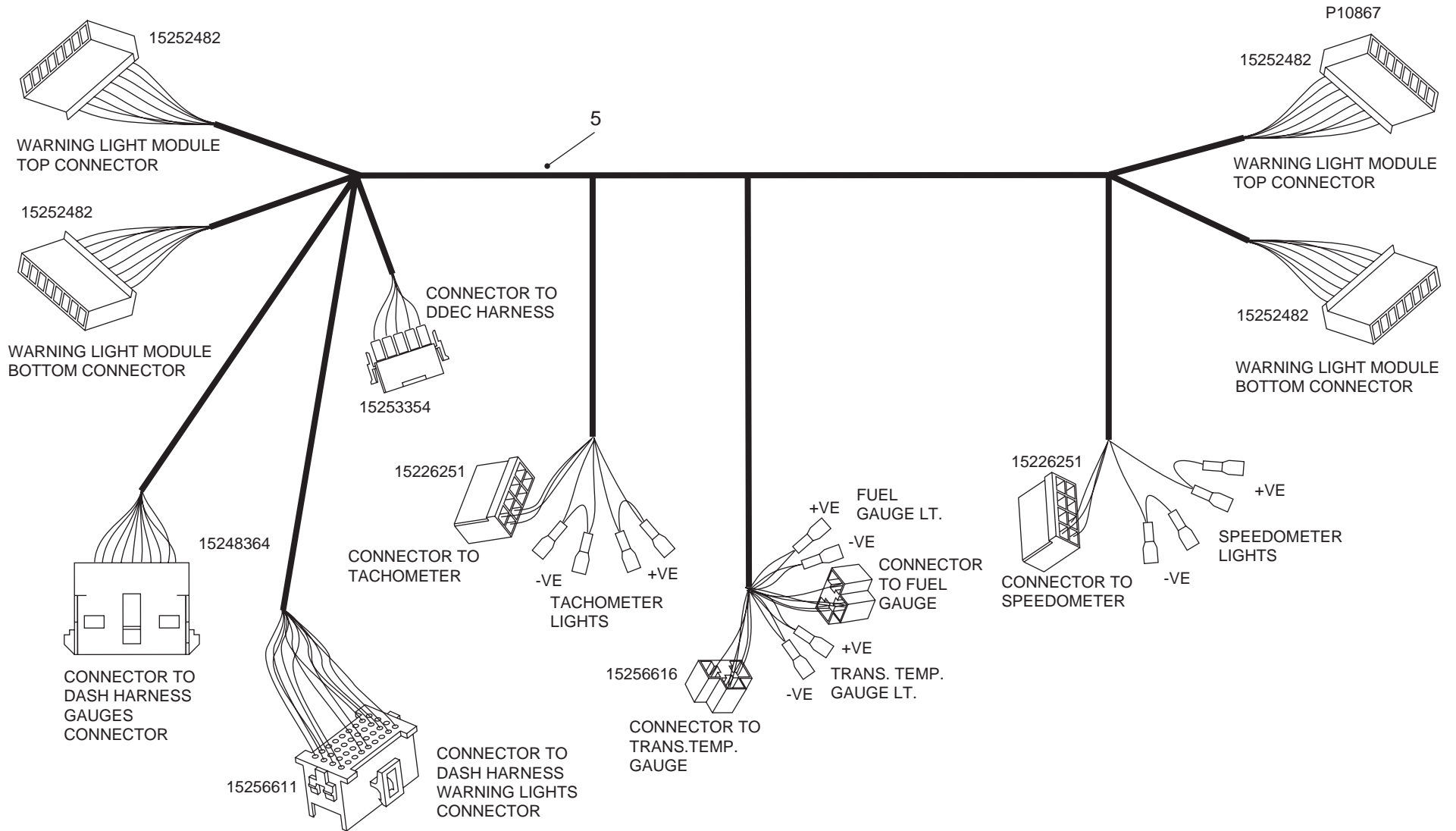

**190-0070-8211 BATTERY AND CABLES**  
FROM SERIAL NO. A8201001

NC	REF	QTY	PART NO.	DESCRIPTION	SER.NO. FROM	SER.NO. TO
001	002		15226158	BATTERY		
002	001		15248302	CABLE-STARTER MOTOR		
003	001		15306264	CABLE ASSY		
004	001		15306221	CABLE ASSY-BATTERY B		
005	001		15300103	CABLE-BATTERY		
006	001		15230097	CABLE-INTER BATTERY		
007	001		15306220	CABLE ASSY-BATTERY		
008	001		15305862	SWITCH-MAGNETIC		
009	002		06350612	SCREW		
010	002		07150615	LOCKWASHER		

**190-0170-8211 FLOODLAMP/SPOTLIGHT/WORK LIGHT**  
FROM SERIAL NO. A8201001

NC	REF	QTY	PART NO.	DESCRIPTION	SER.NO. FROM	SER.NO. TO
001	002		15248898	LAMP-FLOOD		
002	002		15271434	.BULB-24V-70W		
003	001		15258800	SWITCH-WORK LIGHTS		
004	001		15249195	LENS-WORK LIGHTS		

**200-0040-8211 FUEL LINES**  
FROM SERIAL NO. A8201001

NC	REF	QTY	PART NO.	DESCRIPTION	SER.NO. FROM	SER.NO. TO
001	001		15248701	COOLER-FUEL		
002	001		15313373	HOSE ASSY		
003	001		15313372	HOSE ASSY		
004	001		15308429	HOSE ASSY		
005	001		09402865	ELBOW		
006	001		09423452	ELBOW		
007	002		15248706	ELBOW		
008	001		15303096	ELBOW		
009	001		15275567	BRACKET ASSY		
010	004		15300463	MOUNT-FLEXIBLE		
011	016		06350625	BOLT		
012	016		07150615	LOCKWASHER		
013	016		06470601	LOCKNUT		

CLICK HERE TO **DOWNLOAD** THE COMPLETE MANUAL

- Thank you very much for reading the preview of the manual.
- You can download the complete manual from: [www.heydownloads.com](http://www.heydownloads.com) by clicking the link below



- Please note: If there is no response to CLICKING the link, please download this PDF first and then click on it.

CLICK HERE TO **DOWNLOAD** THE COMPLETE MANUAL

**210-0030-8211 RADIATOR PIPING**  
FROM SERIAL NO. A8201001

NC	REF	QTY	PART NO.	DESCRIPTION	SER.NO. FROM	SER.NO. TO
001	008		15311494	CLAMP		
002	004		15311474	HOSE-SILICON		
003	001		15310970	PIPE-ENG TO RAD		
004	001		15312108	PIPE-RAD TO ENG		
005	001		15307667	HOSE ASSY		
006	001		00116524	BUSHING		
007	001		09402708	CONNECTOR		
008	001		15236118	ELBOW		
009	001		09214090	CONNECTOR		
010	001		15230961	VALVE-BALL SHUT-OFF		
011	001		00444704	PLUG		

THIS PAGE IS INTENTIONALLY LEFT BLANK

**220-0050-8211 PUMP-STEERING**

FROM SERIAL NO. A8201001

NC	REF	QTY	PART NO.	DESCRIPTION	SER.NO. FROM	SER.NO. TO
001	001		15257085	PUMP-MAIN/STEERING		
002	001		NSS	.WEAR PLATE		
003	001		NSS	.WEARPLATE		
004	001		15272175	.SEAL KIT		
006	004		06351240	BOLT		
007	004		00103329	LOCKWASHER		

**220-0230-8211 STEERING COLUMN MOUNTING**  
 FROM SERIAL NO. A8201001

NC	REF	QTY	PART NO.	DESCRIPTION	SER.NO. FROM	SER.NO. TO
001	001		15308960	STEERING COLUMN ASSY		
002	001		15274167	.GAS STRUT ASSY		
003	001		15274168	.BRACKET ASSY		
004	001		15274169	.NUT		
005	001		15274170	.COLUMN ASSY-TOP-NSS		
006	002		15274171	.BUSH-PIVOT		
007	002		15274172	.SHOLDER BOLT		
008	001		15274173	.SHAFT ASSY-LOWER		
009	001		15274174	.UNIVERSAL JOINT		
010	001		15254883	BELLOWS		
011	001		15255096	COUPLING-STRG COLUMN		
012	001		15230837	COUPLING-FLEXIBLE		
013	001		15255304	STEERING WHEEL		
014	005		15255161	BOLT		
015	006		07150815	WASHER		
016	006		06470801	NUT		
017	002		06351025	BOLT		
018	002		07161030	LOCKWASHER		
019	001		06350825	BOLT		
021	001		15255238	SEAL-FOAM-NITRILE/PV		
022	003		06351255	BOLT		
023	003		07151220	WASHER		
024	003		15244057	MOUNTING-RUBBER		
025	003		09037837	WASHER		
026	001		06431201	NUT		
027	001		15300396	BRACKET ASSY		
028	001		15234744	COLUMN-STEERING		
029	004		00179843	BOLT		
030	003		07161030	LOCKWASHER		

**230-0081-8211 JOYSTICK-BODY CONTROL**  
FROM SERIAL NO. A8201001

NC	REF	QTY	PART NO.	DESCRIPTION	SER.NO. FROM	SER.NO. TO
----	-----	-----	----------	-------------	-----------------	---------------

A	001	001	15310435	JOYSTICK - BODY HOIST		
	002	004	15311666	SCREW-BUTTON HEAD		

NOTES:

A NON-SERVICEABLE ITEM, AVAILABLE AS A COMPLETE ASSEMBLY ONLY

**250-0040-8211 BRAKE PUMP**  
FROM SERIAL NO. A8201001

NC	REF	QTY	PART NO.	DESCRIPTION	SER.NO. FROM	SER.NO. TO
001	001		15310868	TRIPLE PUMP ASSY		
002	001		15275605	.REPAIR KIT		
003	001		15275606	.O RING SEAL		
004	001		15275607	.REPAIR KIT		
005	002		06351235	BOLT		
006	002		09270000	WASHER-HARDENED		

**250-0070-8211 TREADLE VALVE**  
FROM SERIAL NO. A8201001

NC	REF	QTY	PART NO.	DESCRIPTION	SER.NO. FROM	SER.NO. TO
	001	001	15312932	TREADLE VALVE		
	002	001	NSS	.VALVE SUB ASSY-TNDM		
	003	001	15273735	.BASE-ACTUATOR		
	004	001	15275579	.PEDAL ASSY		
	005	002	NSS	.SCREW		
	006	002	NSS	.NUT		
	007	002	NSS	.WASHER		
	008	001	NSS	.LABEL-PART & SERIAL		
	009	001	15268405	.SPRING-PEDAL RETURN		
	010	001	15268404	.SPRING-PEDAL RETURN		
	011	001	15275580	.PROXIMITY SWITCH		
A	012	001	15273740	.SEAL KIT		

NOTES:

A ITEM NOT ILLUSTRATED

**260-0010-8211 CAB ASSEMBLY**  
FROM SERIAL NO. A8201001

NC	REF	QTY	PART NO.	DESCRIPTION	SER.NO. FROM	SER.NO. TO
A	001	001	15310233	CAB ASSEMBLY-COMplete		
	002	001	15270842	.BOLT-LOCKING		
	003	001	15270768	.COVER-STRIKER		
	004	002	15270752	.HANDLE-PULL		
	005	004	15270845	.SCREW		
	006	001	15270851	.WINDOW-REAR		
	007	001	15270853	.WINDOW-SIDE LH		
	008	001	15270854	.WINDOW-EMERGENCY EXIT		
	009	001	15272742	.WINDOW-SLIDING		
	010	001	15273745	..GLASS-FIXED		
	011	001	15273744	..GLASS-SLIDING		
	012	001	15273746	..LATCH		
	013	001	15270756	.HOOK-COAT		
	014	002	15270779	.SCREW		
	015	001	15270757	.SUNBLIND		
	016	002	15270770	.SCREW		
	017	002	15270845	.SCREW		
	018	001	15250390	.LIGHT-CAB INTERIOR		
	019	002	15270991	.SCREW		
	020	002	15270859	.NUT		
	021	001	15270860	.COVER		
	022	001	15250392	.PLATE-COVER LH		
	023	001	15250393	.PLATE-COVER RH		
	024	001	15270856	.WINDSCREEN		
	025	001	15270857	.AERIAL		
	026	001	00274208	.LOCKNUT		
	027	001	15255793	.PLATE-ROPS/FOPS CERT		
	028	001	15270861	.HAMMER		
	029	002	15270779	.SCREW		
	030	001	15270862	.BRACKET		
	031	004	15270834	.SCREW		
	032	004	07161030	.LOCKWASHER		
	033	001	15270863	.WIPER MOTOR-FRONT		
	034	002	15270764	.SPACER		
	035	001	15270864	.WASHER-FIBRE		
	036	001	15270865	.CAP-NUT		
	037	001	15270866	.WASHER		
	038	001	15270867	.SCREW		
	039	001	15270840	.WASHER		
	040	002	15270749	.VALVE-SCREEN WASHER		

**260-0010-8211 CAB ASSEMBLY**  
FROM SERIAL NO. A8201001

NC	REF	QTY	PART NO.	DESCRIPTION	SER.NO. FROM	SER.NO. TO
	041	ASR	15270868	.TUBING-PVC		
	042	001	15270765	.ARM-WIPER		
	043	001	15270766	.BLADE-WIPER		
	044	001	15257298	.NOISE INSUL-U/FLOOR		
	045	001	15257299	.NOISE INSUL-U/FLOOR		
	046	001	15257300	.NOISE INSUL-HATCH		
	047	036	15270869	.NUT-SPIRE		
	048	001	15234575	.PLATE-COVER		
	049	006	06350620	.SCREW		
	050	006	07160630	.WASHER		
	051	001	15252694	.PLATE-COVER		
	052	006	06350620	.SCREW		
	053	006	07160630	.WASHER		
	054	001	15252756	.BARRIER MAT-COVER		
	055	004	15270870	.RETAINER		
	056	004	15270871	.RIVET		
	057	001	15270872	.HARNES		
	058	025	09379264	.TIE-CABLE		
	059	006	06351225	.BOLT		
	060	006	15270873	.WASHER		
	061	006	15270874	.WASHER-FIBRE		
	062	001	15271322	.STRAP		
	063	002	15270799	.SCREW		
	064	002	15270787	.GROMMET		
	065	ASR	15270868	.TUBING-PVC		
	066	001	15270922	.GUTTER		
	067	002	15270799	.SCREW		
	068	001	15270992	.PLATE-IDENTITY		
	069	001	15272743	.TRIM PANEL-ROOF		
	070	016	15270878	.FIXING		
	071	005	15270993	.SCREW		
	072	005	15270833	.NUT		
	073	001	15272765	.TRIM PANEL-REAR		
	074	001	15270880	.ADDITIVE-TRIM REAR		
	075	005	15270878	.FIXING		
	076	001	15272745	.TRIM PANEL-SIDE		
	077	001	15270882	.ADDITIVE-TRIM SIDE		
	078	001	15272746	.LINING		
	079	001	15272766	.TRIM PANEL-SIDE		
	080	001	15270885	.ADDITIVE-TRIM SIDE		

260-0090-8211 SEAT-DRIVER  
FROM SERIAL NO. A8201001

DRAWING NO. P10770B

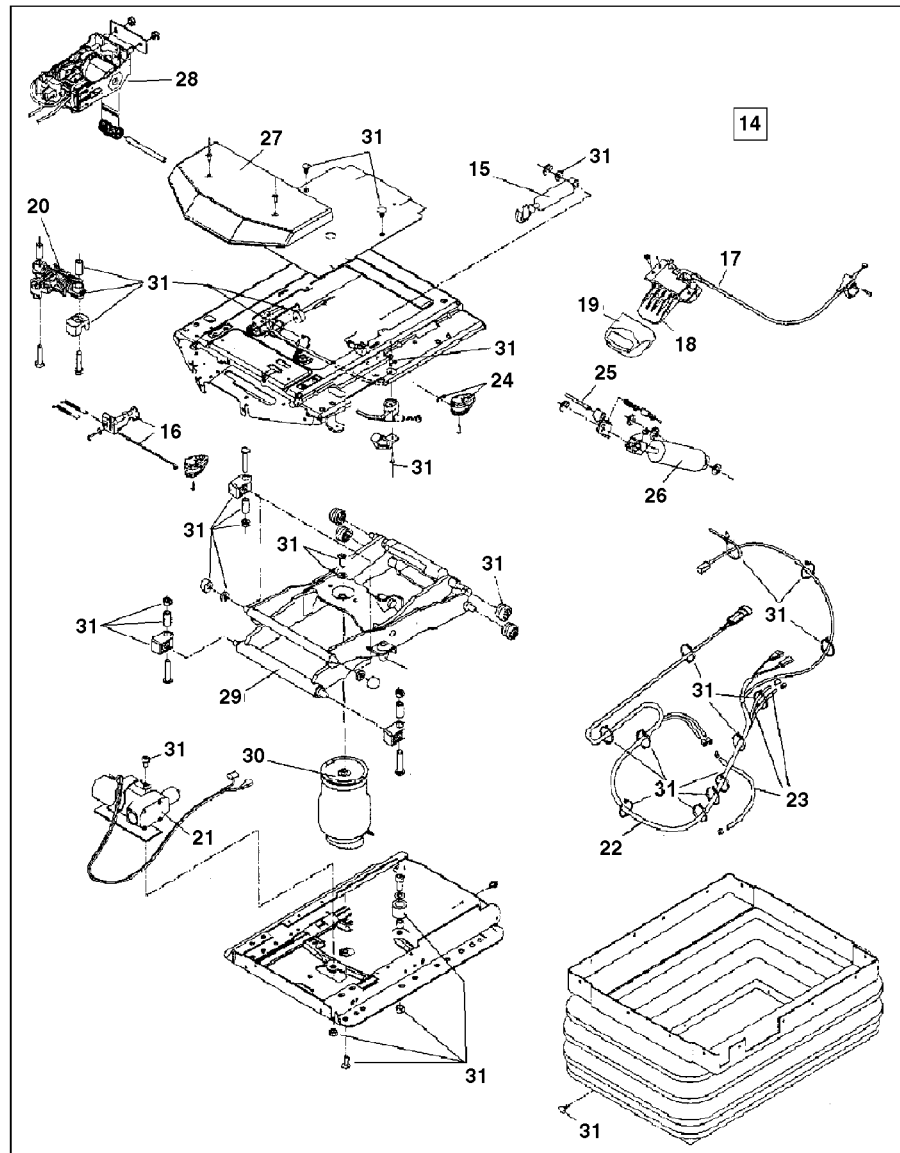
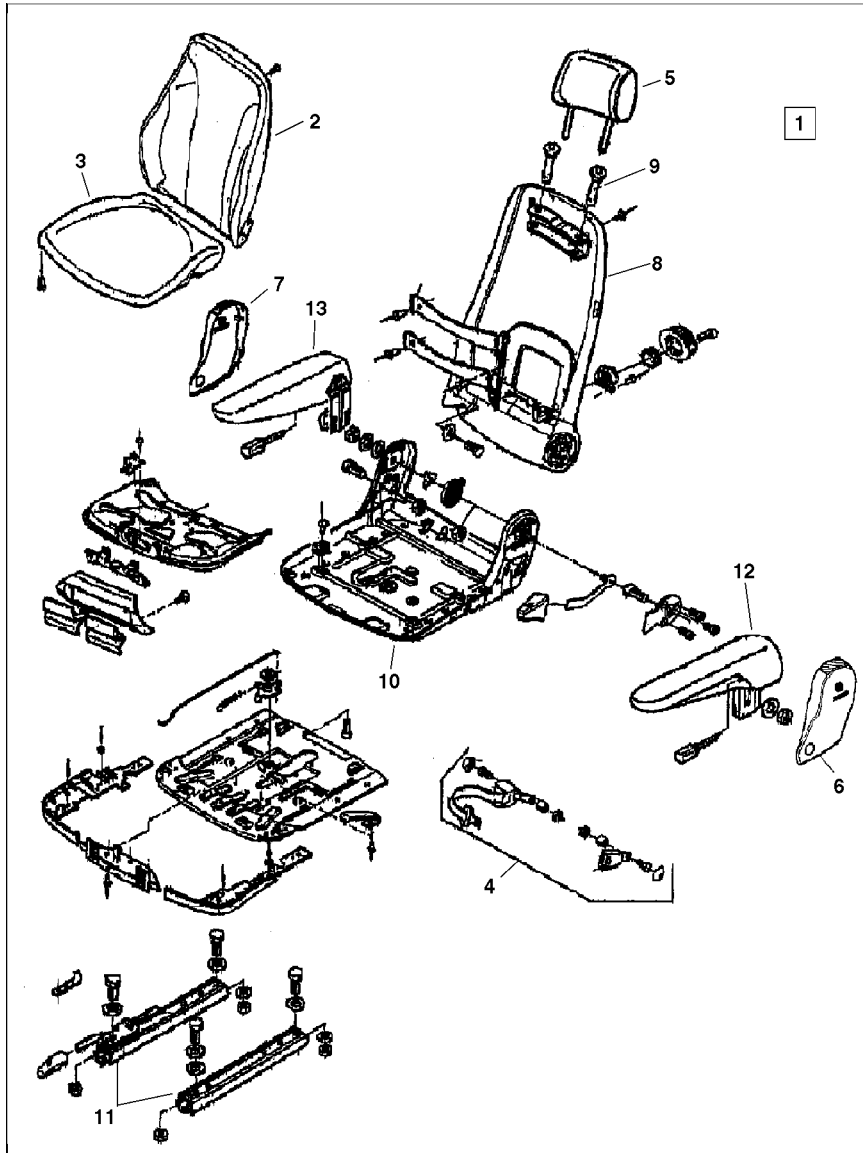

**260-0140-8211 HEATER LINES AND WIRING**  
FROM SERIAL NO. A8201001

NC	REF	QTY	PART NO.	DESCRIPTION	SER.NO. FROM	SER.NO. TO
001	002		09014950	CONNECTOR		
002	004		09379664	CLAMP		
003	ASR		07551826	HOSE-BULK		
004	001		15301018	TUBE		
005	001		15301019	TUBE		
006	002		15230961	VALVE-BALL SHUT-OFF		
007	003		00108686	ELBOW		
008	002		00144034	BUSHING		

THIS PAGE IS INTENTIONALLY LEFT BLANK

**150-0010-8221 AXLE COMPLETE-CENTRE**  
FROM SERIAL NO. A8201015

NC	REF	QTY	PART NO.	DESCRIPTION	SER.NO. FROM	SER.NO. TO
001	001		15313723	AXLE-CENTRE (OCDB)		
002	001		15247154	ADAPTOR		
003	001		15301070	HOSE ASSY		
004	001		09403096	TEE		
005	001		00119930	BUSHING-REDUCER		

**150-0030-8221 AXLE GROUP-CENTRE**

SERIAL NO. A8201001 TO A8201014

NC	REF	QTY	PART NO.	DESCRIPTION	SER.NO. FROM	SER.NO. TO
001	002		15265843	PLUG		
002	070		15265840	BOLT		
003	070		15265957	WASHER		
004	003		15265803	WASHER		
005	006		15265804	PINION		
006	003		15265803	WASHER		
007	002		15265838	BUTTON-THRUST		
008	002		15265807	CIRCLIP		
009	002		15265808	GEAR-SUN		
010	002		15272904	BEARING ASSY		
011	002		15265817	RETAINER		
012	002		15265816	RING-HUB GEAR		
013	002		15265815	RING-PLANETARY GEAR		
014	002		15265814	NUT-HUB		
015	004		15265813	LOCKRING		
016	002		15265812	RING-SPRING		
017	002		15265803	WASHER		
018	006		15265806	SCREW		
019	002		15265802	CARRIER		
020	002		15265841	WASHER		
021	002		15265842	BOLT		
022	006		15265801	PIN		
023	006		15265800	O RING		
024	001		15265810	DRIVESHAFT RH		
024	001		15265811	DRIVESHAFT LH		
025	046		15265820	NUT		
026	046		15265821	STUD		
027	002		15272904	BEARING ASSY		
028	002		15275552	FACE SEAL-HUB/STUB		
029	002		15275562	STUB AXLE		
030	002		15275561	CAPSCREW		
031	002		15275553	SPACER-OIL SEAL		
032	002		15275554	O RING		
033	002		15275555	HOUSING-OIL SEAL		
034	002		15275556	RING		
035	038		15275557	CAPSCREW		
036	008		15275558	CAPSCREW		
037	002		15275559	SEAL		
038	002		15275560	HUB		
039	002		15275581	O RING		

**165-0015-8221 BRAKE ASSY-OCDB(ARTICS)**

FROM SERIAL NO. A8201001

NC	REF	QTY	PART NO.	DESCRIPTION	SER.NO. FROM	SER.NO. TO
	001	001	15275493	BRAKE ASSY-(4 PLATE)		
	002	003	15275495	.NUT-SLACK ADJUSTER		
A	003	003	NSS	.SEAL-SLACK ADJUSTER		
	004	003	15275497	.JAM NUT-SLACK ADJUSTE		
A	005	003	NSS	.SEAL-SLACK ADJUSTER		
	006	003	15275499	.SCREW-SLACK ADJUSTER		
	007	001	15275500	.CAP-WEAR INDICATOR		
A	008	001	NSS	..O RING		
	009	001	15275502	.PIN-WEAR INDICATOR		
B	009	001	NSS	.O RING-WEAR INDICATOR		
	010	005	15275504	.PLUG-DRAIN		
A	011	025	NSS	..O RING		
	012	002	15275506	.PLUG-PRESS INLET		
A	013	004	NSS	..O RING		
	014	001	15275508	.BLEEDER SCREW		
	015	001	NSS	.COVER-BRAKE INNER		
	016	003	15275510	.PIN-DOWEL		
B	017	003	NSS	.O RING		
B	018	001	NSS	.O RING		
B	019	001	15275513	.SEAL-PISTON INNER		
B	020	001	NSS	.SEAL-PISTON OUTER		
	021	001	15275515	.PISTON-BRAKE		
	022	020	15275516	.CAPSCREW		
	023	020	15275517	.WASHER		
	024	001	15275518	.COVER-BRAKE OUTER		
B	025	001	NSS	.O RING		
	026	004	15275520	.FRICTION DISC & LININ		
	027	009	15275521	.DISC-REACTION		
	028	010	15275522	.SPRING-RETRACTOR		
	029	010	15275523	.GUIDE PIN		
	030	001	15275524	.PLATE-PISTON PRESS		
	031	001	15275525	.BRK COVER & HSG ASSY		

## NOTES:

A PARTS IN 15275527 SEAL KIT-BRAKE ASSY OUTER, PARTS ARE ALSO INCLUDED IN KIT 15275526

B PARTS IN 15275526 SEAL KIT-COMplete BRAKE ASSY

**190-0100-8221 ELECTRICAL LIGHTING SYSTEM**  
FROM SERIAL NO. A8201001

NC	REF	QTY	PART NO.	DESCRIPTION	SER.NO. FROM	SER.NO. TO
001	001		15308406	LIGHT ASSY-REAR LH		
002	002		15274967	.BULB 21W-HEAVY DUTY		
003	002		15274968	.BULB 5W-HEAVY DUTY		
004	001		15308407	LIGHT ASSY-REAR RH		
005	002		15274967	.BULB 21W-HEAVY DUTY		
006	002		15274968	.BULB 5W-HEAVY DUTY		
007	001		15248898	LAMP-FLOOD		
008	001		15271434	.BULB-24V-10W		
009	002		15258992	GUARD-REAR LIGHT		
010	008		00179839	BOLT		
011	008		07151020	WASHER		
012	002		09373548	BUTTON PLUG		

CLICK HERE TO **DOWNLOAD** THE COMPLETE MANUAL

- Thank you very much for reading the preview of the manual.
- You can download the complete manual from: [www.heydownloads.com](http://www.heydownloads.com) by clicking the link below



- Please note: If there is no response to CLICKING the link, please download this PDF first and then click on it.

CLICK HERE TO **DOWNLOAD** THE COMPLETE MANUAL