

MODELS | SJIII 3220 SJIII 3226 SJIII 4626 SJIII 4632



Parts Manual

SJIII Conventional Series (ANSI/CSA & KC)

Part No. 155181AF October 2018

SKYJACK

CLICK HERE TO **DOWNLOAD** THE COMPLETE MANUAL

- Thank you very much for reading the preview of the manual.
- You can download the complete manual from: www.heydownloads.com by clicking the link below



- Please note: If there is no response to CLICKING the link, please download this PDF first and then click on it.

CLICK HERE TO **DOWNLOAD** THE COMPLETE MANUAL

Index No.	Skyjack Part No.	Qty.	Description
1	128719	2	KICK PLATE, End entrance (Models 46xx)
2	128722	1	WELDMENT, End entrance railing (Models 46xx)
3	104183	1	PAD, Entry Railing (Models 46xx)
4	112329	4	BOLT, Self tapping (1/4"-14 x 1")
5	125580	4	SPACER, Railing retainer
6	103984	8	NUT, Hex lock (5/16"-18, Grade 5)
7	127437	8	BOLT, Carriage (5/16"-18 x 2")
8	(Ref.)	-	GUARD, Cable (For components, refer to Section 1.8)
9	130111	2	WELDMENT, End entrance railing (Full gate) (Models 46xx)
10	103404	2	WASHER, Lock (5/16")
11	100702	2	PLUG, Plastic tube
12	103864	2	BOLT, Hex head (5/16"-18 x 1", Grade 5)
13	157778	2	PLATE, Kick (Universal)
14	125448	1	GUARD, Cable
15	125504	1	RAILING, Rigid (Right hand)
16	(Ref.)	-	ENTRANCE GATE AND CHAINS (For components, refer to Section 1.1)
17	125503	1	RAILING, Rigid (Left hand)
18	(Ref.)	-	OUTLET, Platform AC (For components, refer to Section 1.20)
19	(Ref.)	-	QUICK RELEASE LARGE OR SMALL LOOP PIN ASSEMBLY (For components, refer to Section 1.7)
20	139641	1	RIVET, Pop (1/4" diameter x 0.615") (If equipped)
21	103995	1	WASHER, Flat (1/4") (If equipped)

Index No.	Skyjack Part No.	Qty.	Description
A	151019	1	MANUAL EXTENSION PLATFORM ASSEMBLY (3') (Models 322x)
B	153285	1	POWERED EXTENSION PLATFORM ASSEMBLY (6') (Model 3220)
C	151026	1	MANUAL EXTENSION PLATFORM ASSEMBLY (4') (Models 46xx)
D	155868	1	POWERED EXTENSION PLATFORM ASSEMBLY (6') (Model 4626 ANSI/CSA)
1	151018	1	• WELDMENT, Manual extension platform, A
	151025	1	• WELDMENT, Manual extension platform, C
	153280	1	• WELDMENT, Powered extension platform, B
	155861	1	• WELDMENT, Powered extension platform, D
2	125424	2	• • PIN, Roll out
3	125431	2	• • ROLLER, Narrow
4	125433	6	• BUSHING, Slider
5	300064	2	• BOLT, Button head (5/16"-18 x 3/4"), A, C
6	103984	2	• NUT, Hex lock (5/16"-18, Grade 5), A, C
7	133037	1	• STOP, Extension platform, A, C

Index No.	Skyjack Part No.	Qty.	Description
A	156879	-	CONTROL CONSOLE ASSEMBLY
B	156953	-	CONTROL CONSOLE ASSEMBLY (with powered extension platform)
1	147373	1	• CONTROL CONSOLE (Bottom)
2	156923	1	• CONTROL CONSOLE (Top)
3	147058	1	• HEAD, Pushbutton (Horn)
4	147051	1	• HEAD, Emergency stop
5	122093	1	• INDICATOR, Battery charge
6	111181	2	• GUARD, Toggle switch
7	(Ref.)	-	• ENABLE CONTROLLER ASSEMBLY (For components, refer to Section 1.16a or Section 1.16b)
8	-	-	• SWITCH ASSEMBLY, Emergency stop
	147056	1	• • LATCH
	147053	2	• • BLOCK, N.C. contact
	147061	1	• • LED BLOCK, 24V (red)
9	-	-	• SWITCH ASSEMBLY, Horn
	147056	1	• • LATCH
	147054	1	• • BLOCK, N.O. contact
10	116382	1	• SWITCH, Toggle (4NT1-1)
11	115574	1	• SWITCH, Toggle (1NT1-2)
12	102956	2	• PLUG (7/8" hole), A
13	103957	1	• SCREW, Round head machine (#8-32 x 1/2")
14	112249	1	• WASHER, Lock (#8)
15	103986	1	• NUT, Hex head (#8-32)
16	112327	9	• SCREW, Hex head self tapping (#8-18 x 1/2")
17	(Ref.)	-	• CONTROL CABLE ASSEMBLY (16 pin) (For components, refer to Section 1.21)
18	300788	1	• STRAIN RELIEF
19	116993	1	• HOUSING, Male connector (9 pin) (to controller harness)
20	(Ref.)	-	CABLE, Powered extension platform (For components, refer to Section 1.17)
21	144016	2	• SEAL, Panel bushing

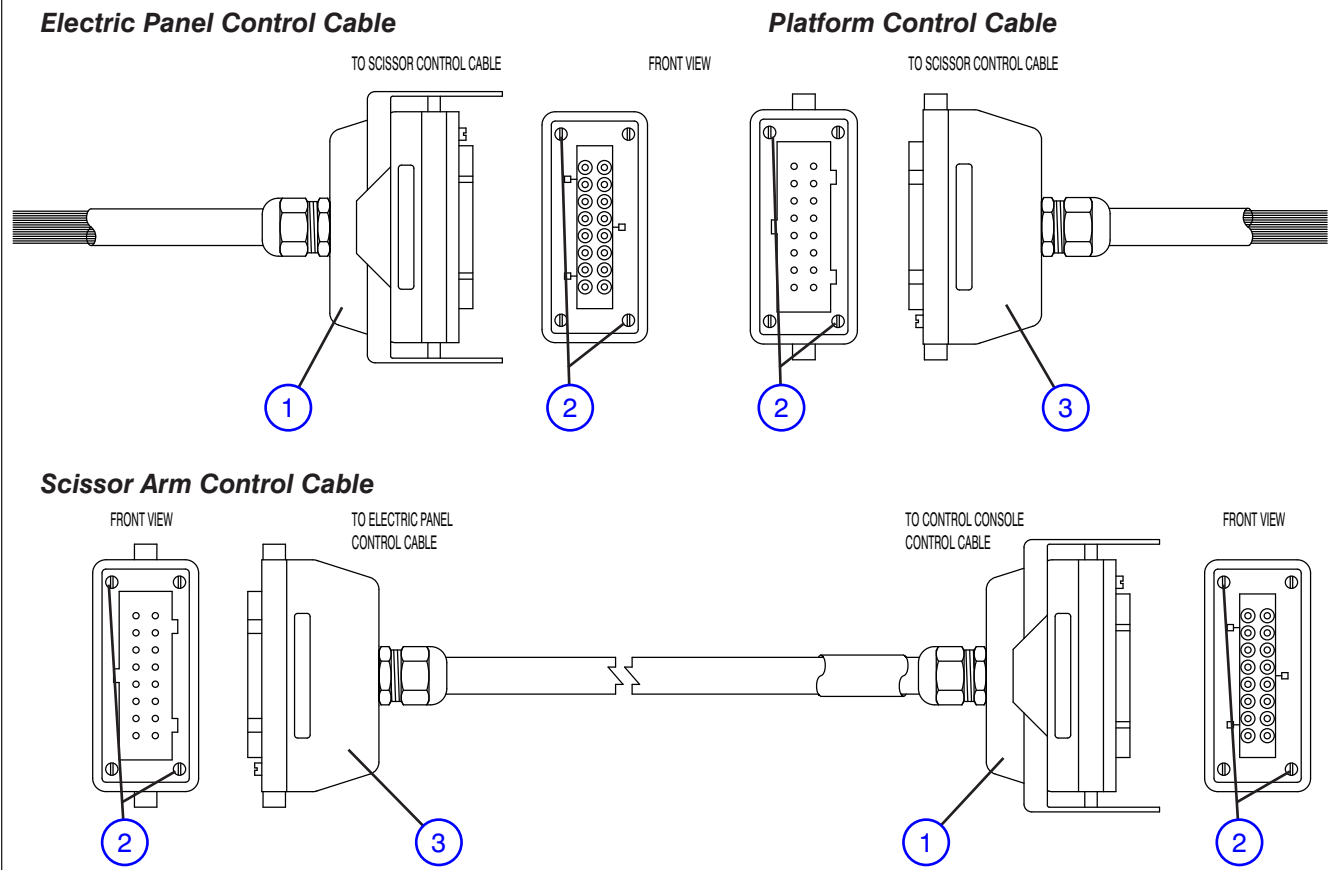

M146601AA2

Index No.	Skyjack Part No.	Qty.	Description
A	156893	-	PLATFORM CONTROL CABLE ASSEMBLY
B	146650	-	SCISSOR ARM CONTROL CABLE ASSEMBLY (Model xx20)
C	146599	-	SCISSOR ARM CONTROL CABLE ASSEMBLY (Model xx26)
D	146600	-	SCISSOR ARM CONTROL CABLE ASSEMBLY (Model xx32)
E	146585	-	ELECTRIC PANEL CONTROL CABLE ASSEMBLY (Non-EE Rated)
	159307	-	ELECTRIC PANEL CONTROL CABLE ASSEMBLY (EE Rated)
1	107821	1	CONNECTOR, Female (16 pin)
	103565	1	• HOUSING, Female
	103573	1	• INSERT, Female
2	119727	2	PIN, Code, A, E
		4	PIN, Code, B, C, D
3	107820	1	CONNECTOR, Male (16 pin)
	103564	1	• HOUSING, Male
	103574	1	• INSERT, Male

Index No.	Skyjack Part No.	Qty.	Description
1	121674	4	PIN, Outside scissor
2	123430	2	BUSHING, Fiberglide (3/4" inner diameter x 1.5")
3	121874	1	PIN, Cotter (1/4" x 1.5")
4	121605	1	TUBE, Outside scissor arms cross member (Models 322x)
	121672	1	TUBE, Outside scissor arms cross member (Models 46xx)
5	128250	1	PIN, Inside scissor
6	121677	1	PIN, Limit switch
7	(Ref.)	-	LIMIT SWITCH ASSEMBLY (For components, refer to Section 2.6)
8	128256	AR	CENTER PIN ASSEMBLY (without cable carrier weldment)
	130385	AR	CENTER PIN ASSEMBLY (with cable carrier weldment)
9	120673	1	• PIN, Center
10	101520	1	• WASHER, Nylon (1.28 I.D. x 2 O.D. x 0.12)
11	123431	4	• BUSHING, Fiberglide (1.25" x 1.8125")
12	121703	1	• SPACER, Bearing thrust fiberglide (1.25 inner diameter)
13	122502	1	• WASHER, Flat (1.25" I.D. x 2.25" O.D.) (without cable carrier weldment)
14	121875	1	• PIN, Cotter (5/16" diameter x 2")

Index No.	Skyjack Part No.	Qty.	Description
1	132769	1	BAR ASSEMBLY (Emergency lowering)
	132477	1	• BAR, Emergency lowering access
	119920	2	• CLIP, Spring coated
	103991	2	• WASHER, Flat (#8)
	132768	2	• RIVET, Pop (5/32" diameter x 0.435")
	124160	2	• PIN, Locking
2	103199	20	BOLT, Wheel
3	(Ref.)	-	TIE ROD ASSEMBLY (For components, refer to Section 3.4)
4	(Ref.)	-	STEER CYLINDER ASSEMBLY (For components, refer to Section 3.5)
5	125730	2	KING PIN ASSEMBLY
	100120	1	• PIN, Axle king
	100825	1	• PIN (1/4" x 1.1875")
	103478	1	• PIN, Cotter (1/4" x 1.25")
	104129	1	• WASHER, Bronze
6	(Ref.)	-	FRONT AXLE HUB & SPINDLE ASSEMBLY (For components, refer to Section 3.9)
7	125785	2	WHEEL ASSEMBLY (Front) (ITL)
	132285	2	WHEEL ASSEMBLY (Front) (Carlisle)
8	155926	1	WELDMENT, Base (Model 3220)
	155925	1	WELDMENT, Base (Model 3220 with powered extension platform)
		1	WELDMENT, Base (Model 3226)
	158981	1	WELDMENT, Base (Model 46xx with S/N 70009804 & Above)
	136494	1	WELDMENT, Base (Model 46xx with S/N 70009803 & Below)
9	146658	1	SWITCH, Tilt (Model 322x)
	146661	1	SWITCH, Tilt (Model 46xx)
10	120094	2	• SCREW, Round head machine (#10-32 x 5/8")
11	104003	2	• NUT, Hex head (#10-32)
12	104185	2	• WASHER, Lock (#10)
13	130192	1	LADDER (Model 3220/4620)
	151961	1	LADDER (Model 3226/4626/4632)
	103999	4	WASHER, Lock (3/8")
	103472	4	WASHER, Flat (3/8")
	103473	4	BOLT, Hex head (3/8"-16 x 1", Grade 5)
14	119725	1	SWITCH, Main power disconnect
	108714	1	• KIT, Battery switch lockout
15	115005	1	STATIC STRAP ASSEMBLY
	115420	1	• STRAP, Ground
	101632	1	• BOLT, Hex head (3/8"-16 x 3/4")
	103999	1	• WASHER, Lock (3/8" NOM)
	103978	1	• NUT, Hex head (3/8"-16)
-	-	-	Parts list continued on the following page.

CLICK HERE TO **DOWNLOAD** THE COMPLETE MANUAL

- Thank you very much for reading the preview of the manual.
- You can download the complete manual from: www.heydownloads.com by clicking the link below



- Please note: If there is no response to CLICKING the link, please download this PDF first and then click on it.

CLICK HERE TO **DOWNLOAD** THE COMPLETE MANUAL

Notes

3.12 Hydraulic Hose Connections - Disc Brake (Model 46xx)

Index No.	Skyjack Part No.	Qty.	Description
1	119833	2	HOSE ASSEMBLY (Steer)
2	104656	2	HOSE ASSEMBLY (Drive)
3	137175	1	HOSE ASSEMBLY (Brake supply)
4	136569	2	HOSE ASSEMBLY (Wheel motor)
5	113348	1	FITTING, Elbow 90° (#515-6-4)
6	136573	1	HOSE ASSEMBLY (Right brake)
7	136568	2	HOSE ASSEMBLY (Wheel motor)
8	136576	1	HOSE ASSEMBLY (Right motor drain)
9	136572	1	HOSE ASSEMBLY (Brake release manifold)
10	137636	1	HOSE ASSEMBLY (Left brake)
11	121602	1	FITTING, Tee (06 JICM - 04 ORBM - 06 JICM)
12	138133	1	HOSE ASSEMBLY (Main case drain)

4.4 Proportional Manifold Assembly

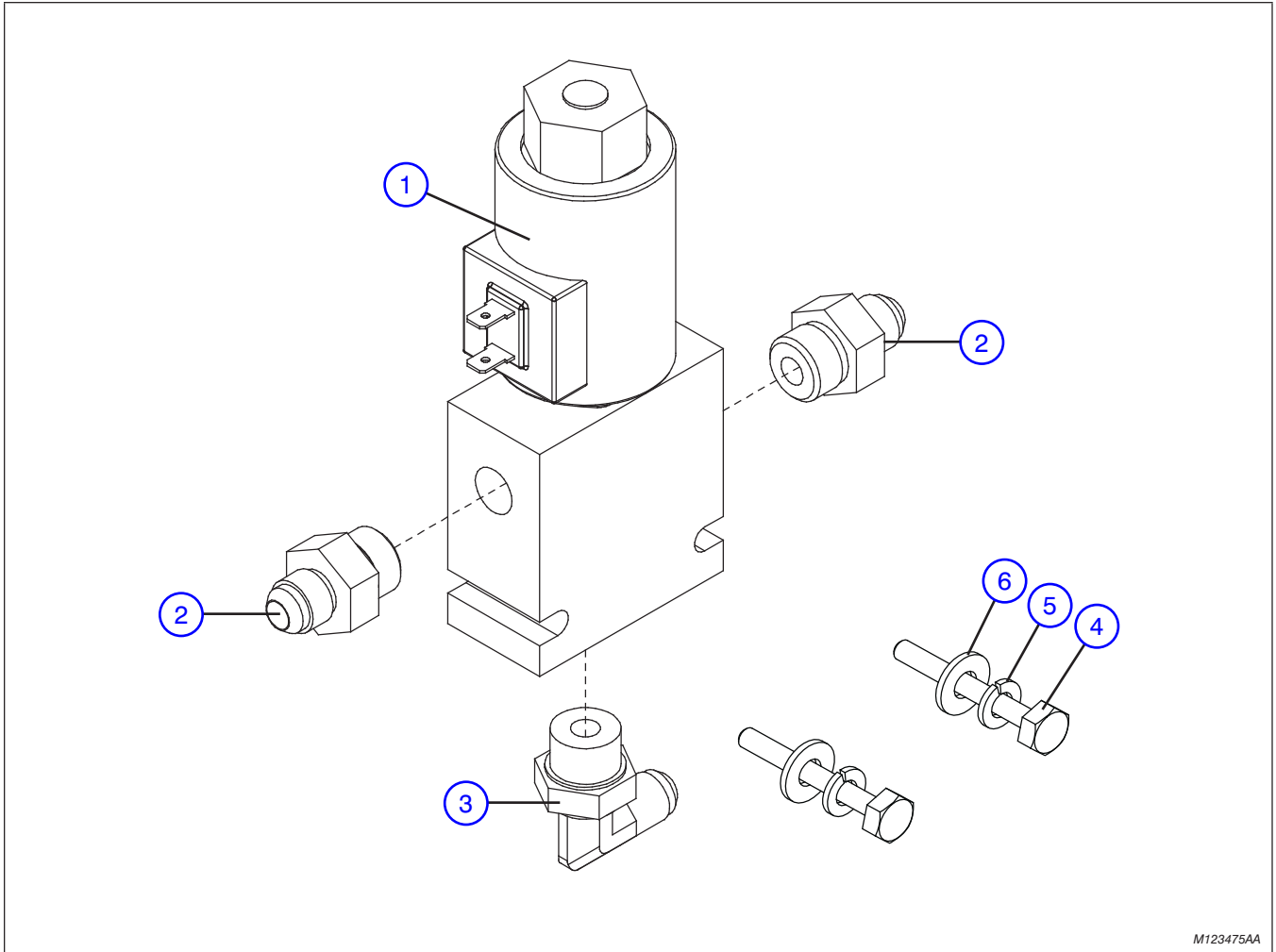

M123475AA

Index No.	Skyjack Part No.	Qty.	Description
-	132761	1	PROPORTIONAL MANIFOLD ASSEMBLY
1	132750	1	• MANIFOLD ASSEMBLY
	132748	1	• • BLOCK, Manifold
	132749	1	• • VALVE, Control
	115370	1	• • COIL (24 volt)
2	103070	2	• FITTING, Straight (06 JICM - 08 ORBM)
3	102665	1	• FITTING, Elbow 90° (06 JICM - 08 ORBM)
4	103860	2	BOLT, Hex head (1/4"-20 x 1.75", Grade 5)
5	104000	2	WASHER, Lock (1/4")
6	103995	2	WASHER, Flat (1/4")

Index No.	Skyjack Part No.	Qty.	Description
A	146642	-	ELECTRICAL PANEL HARDWARE ASSEMBLY (ANSI/CSA)
B	156398	-	ELECTRICAL PANEL HARDWARE ASSEMBLY (KC)
1	132661	1	• WELDMENT, Control panel, A
	156399	1	• WELDMENT, Control panel, B
	112495	4	• BOLT, Hex head (1/4"-20 x 3/8", Grade 5)
2	132794	1	• CLAMP
3	125893	1	• BUMPER, Rubber female
	103892	1	• BOLT, Hex head (1/4"-20 x 5/8", Grade 5)
	103995	1	• WASHER, Flat (1/4")
	104000	1	• WASHER, Lock (1/4")
	103980	1	• NUT, Hex head (1/4"-20, Grade 5)
4	125892	1	• BUMPER, Rubber male
5	103336	1	• HOURMETER
6	117325	2	• CIRCUIT BREAKER (15 Amp)
7	146644	1	• RESISTOR (30 Ohm, 25 watt)
	116066	2	• SCREW, Round head machine (#4-40 x 1/2")
	116068	2	• WASHER, Lock (#4)
	116067	2	• NUT, Hex (#4-40)
8	108589	3	• RELAY (24 volt), A
		4	• RELAY (24 volt), B
9	116711	1	• SPACER, Relay stand-off
10	112449	4	• BOLT, Machine (1/4"-20 x 1", Grade 5)
11	146475	1	• CONTACTOR, Solenoid
12	103962	4	• SCREW, Round head machine (#10-32 x 1/2")
13	104003	5	• NUT, Hex head (#10-32)
14	104185	3	• WASHER, Lock (#10)
15	104694	2	• WASHER, Flat (#10)
16	104546	1	• SCREW, Round head (#10-32 x 2")
17	103057	1	• BEEPER (4-28VDC), A
		2	• BEEPER (4-28VDC), B
18	103011	3	• BLOCK, Terminal
	103956	8	• SCREW, Round head (#6-32 x 1")
	103985	8	• NUT, Hex head (#6-32)
19	147374	1	• HARNESS, Ground ("02")

Index No.	Skyjack Part No.	Qty.	Description
1	135990	-	INVERTER, 24VDC (120VAC @ 60 Hz) (ANSI/CSA) (For components, refer to Section 7.2)
2	129145	1	SUPPORT, Inverter
3	159320	1	CABLE (1/4 x 30 x 5/16, #4GA)
4	119061	1	FUSE BOX, Cover
5	110853	2	BOLT, FHCS Zinc (1/4"- 20 x 0.63)
6	103068	2	INSULATOR, Fuse
7	146442	1	FUSE (100 Amp)
8	112495	2	BOLT, Hex head (1/4"-20 x 3/8", Grade 5)
9	103855	4	BOLT, Hex head (1/4"-20 x 1/2", Grade 5)
10	104000	4	WASHER, Luck (1/4")
11	103473	2	BOLT, Hex head (3/8"-16 x 1", Grade 5)
12	104606	2	NUT, Hex lock (3/8"-16, Grade B)
13	103999	2	WASHER, Lock (1/4")
14	108503	1	CONNECTOR, Blue butt (#14-16)
15	137417	1	RELAY, Inverter timer cutoff
L	146454	1	LABEL, Inverter fuse (100 A)

7.6 Dual Flashing Amber Light Option (Diagonal)

Index No.	Skyjack Part No.	Qty.	Description
1	126111	2	FLASHING AMBER LIGHT ASSEMBLY
	121477	1	• LIGHT, Beacon
	121533	1	• • LENS, Amber
	146153	1	• • BULB (24 volt)
2	134587	1	HARNESS, Dual flashing light
3	156695	2	BRACKET, Flashing light
4	115649	5	NUT, Hex nylon lock (1/4"-20, Grade 5)
5	134715	1	GUARD, Cable (Modified)
6	108791	2	CLIP, Cord (Adhesive back)

7.12 Elevate Telematics

Index No.	Skyjack Part No.	Qty.	Description
A	230302	1	SERVICE KIT, ELEVATE TELEMATICS - CONVENTIONALS
B	230299	1	SERVICE KIT, ELEVATE TELEMATICS - CONVENTIONALS (WITH KEYPAD)
-	213098	1	• CONTROL UNIT GROUP, Track Unit
1	(Ref.)	1	• • CONTROL UNIT
2	(Ref.)	1	• • BRACKET, Control Unit
3	(Ref.)	1	• • FUSE HOLDER
4	(Ref.)	1	• • FUSE, 1 AMP
-	230303	1	• TELEMATICS ASM, Install Parts
5	114678	4	• • SCREW, Round Head Machined - #6-32 x 1/2"
6	196306	4	• • NUT, Nylon Lock - #6-32 Gr. 5
7	191833	4	• • WASHER, Flat - #6
8	112248	2	• • BOLT, Round Head Machine - #8-32 x 1", B
9	138765	2	• • NUT, Nylon Lock - #8-32 Gr. 5 Zinc, B
10	226433	1	• • HARNESS, Track Unit (Not Shown)
11	220577	1	• • WIRE ASSEMBLY, B+
12	220619	1	• • RELAY ASM, Motor Contactor Cut Off
13	103962	1	• • BOLT, Machined Head/Zinc - #10-32 x 1/2"
14	104185	1	• • WASHER, Lock/Zinc - #10
15	104003	1	• • NUT, Machined - #10-32 Gr. B
16	229266	1	• • LABEL, 19DCR
17	102891	10	• • TIE WRAP CABLE, 5-3/8" (Not Shown)
18	103995	2	• • WASHER, Flat - 1/4", B
19	115649	1	• • NUT, Nylon Lock - 1/4"-20 Gr. 5, B
20	103856	1	• • BOLT, Hex Head Nylon - 1/4"-20 x 3/4" Gr. 5, B
21	114594	1	• • TERMINAL, Male - 18-22 AWG
22	114595	1	• • TERMINAL, Female - 18-22 AWG - Red
23	229265	1	• INSTRUCTIONS, Elevate Telematics - SJIII (Not Shown)
24	221111	1	• INSTRUCTIONS, OP-Telematics Track Unit (English) (Not Shown) , B
25	213099	1	• KEYPAD, Track Unit, B
26	226214	1	• BRACKET, Keypad - Track Unit, B
27	173002	1	• LABEL, Equipped with Keypad, B

CLICK HERE TO **DOWNLOAD** THE COMPLETE MANUAL

- Thank you very much for reading the preview of the manual.
- You can download the complete manual from: www.heydownloads.com by clicking the link below



- Please note: If there is no response to CLICKING the link, please download this PDF first and then click on it.

CLICK HERE TO **DOWNLOAD** THE COMPLETE MANUAL