

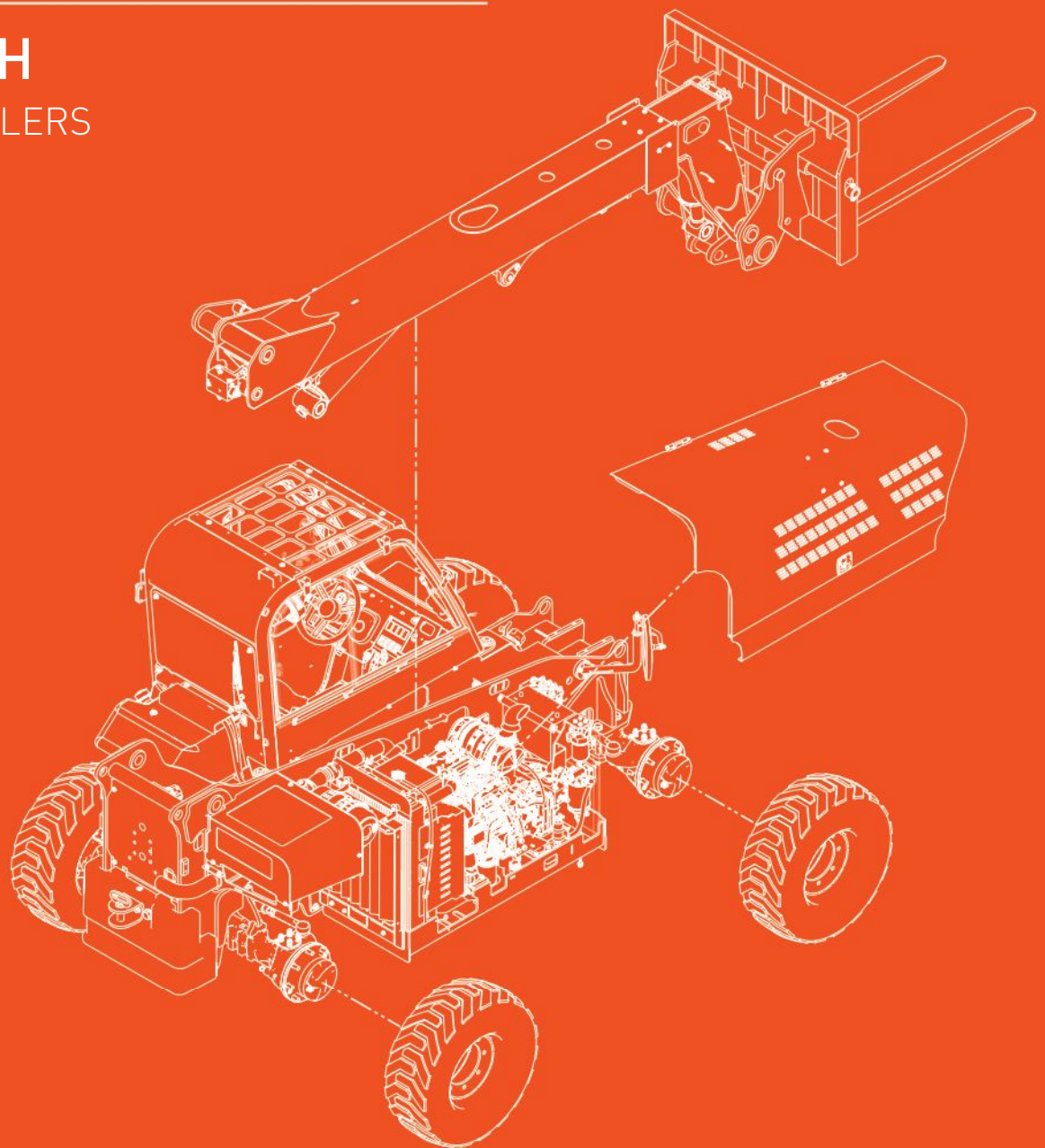

PARTS MANUAL

SJ519 TH
TELEHANDLERS



216941AB

July 2019
ANSI/CSA

CLICK HERE TO **DOWNLOAD** THE COMPLETE MANUAL

- Thank you very much for reading the preview of the manual.
- You can download the complete manual from: www.heydownloads.com by clicking the link below



- Please note: If there is no response to CLICKING the link, please download this PDF first and then click on it.

CLICK HERE TO **DOWNLOAD** THE COMPLETE MANUAL

1.1 Frame

Index No.	Skyjack Part No.	Qty.	Description
-	9-206215	1	FRAME COMPONENTS
1	9-206047	1	• FRAME
2	9-205621	2	• PAD, Frame
3	9-157822	4	• SCREW, Socket Head Cap 5/16"-18 x 7/8"
4	9-923025	1	• HORN, Electric 12 V
5	9-159294	9	• NUT, Speed clip 3/8"-16
6	9-921172	1	• BACK UP ALARM
7	9-103996	2	• WASHER, Flat 5/16"
8	9-207266	1	• BOLT, Hex head 5/16"-18 x 0.875 gr5
9	9-103984	1	• NUT, Lock with nylon insert 5/16"-18 Gr. 5
10	9-103995	4	• WASHER, Flat 1/4"
11	9-103855	2	• BOLT, Hex head 1/4"-20 x 1/4" gr5
12	9-125959	27	• WASHER, Flat 3/8" hard
13	9-205510	4	• BOLT, Hex head 3/8"-16 x 1.125 gr5
14	9-206132	1	• COVER, Frame, rear
15	9-103473	16	• BOLT, Hex head zinc plated (3/8"-16 x 1" gr. 5)
16	9-197539	2	• PLUG, Snap in for 1-3/8" hole
17	9-114377	8	• PLUG, Snap in for 1/2" hole
18	9-103999	17	• WASHER, lock 3/8"
19	9-206899	1	• COVER, Front
20	9-206336	1	• CLAMP, Hose
21	9-206337	1	• PLATE, Clamp top
22	9-103861	2	• BOLT, Hex head zinc plated (1/4"-20 x 2" Gr. 5)
23	9-104000	2	• WASHER, Lock 1/4"
24	9-138464	2	• BOLT, Hex head 3/8"-16 x 5/8" gr5
25	9-206617	1	• MOUNT, Mirror
26	9-191892	2	• WASHER, Plastic 3/8" x 1-1/4"
27	9-191890	1	• WELDMENT, Mirror rotation
28	9-931379	1	• MIRROR
29	9-104606	2	• NUT, Lock with nylon insert 3/8"-16 Gr. 5
30	9-127067	1	• WASHER, Flat 3/8" style
31	9-206979	1	• BULKHEAD, Weldment
32	9-206890	1	• COVER, Engine side weldment
33	9-206488	1	• PLATE, Cover bottom
34	9-162053	35"	• PROTECTIVE TRIM - 3/4"
35	9-162053	18"	• PROTECTIVE TRIM - 3/4"
36	9-162053	18"	• PROTECTIVE TRIM - 3/4"
37	9-162053	21.2"	• PROTECTIVE TRIM - 3/4"
38	9-162053	31"	• PROTECTIVE TRIM - 3/4"
39	9-206901	1	• COVER, rear
40	9-196566	21	• PROTECTIVE TRIM, 1/2" to 5/8"
41	9-300437	3	• BOLT, Hex head 3/8"-16 x 7/8" Gr. 5

2.1 Front Axle

Index No.	Skyjack Part No.	Qty.	Description
-	9-205739	-	FRONT AXLE
1	9-206918	1	• MOTOR, HYDRAULIC, 105 CC VARIABLE
-	9-224151	1	• • SEAL, SHAFT
-	9-224152	1	• • RING, SUPPORT
-	9-224153	1	• • RING, SNAP
-	9-224154	1	• • COIL
-	9-224155	1	• • VALVE, FLUSHING
-	9-224156	1	• • VALVE, SWITCH
-	9-224157	1	• • SEAL KIT
2	9-205226	1	• AXLE, Front - dropbox SJ519
3	9-205680	2	• PLATE, Axle mount
4	9-206990	1	• O-RING, 70 Durometer nitrile
5	9-205682	8	• WASHER, Flat 7/8" hard
6	9-205683	4	• BOLT, Hex Head 7/8"-9 x 8-1/2" Gr. 8
7	9-147498	4	• NUT, Lock 7/8"-9 Gr C
8	9-144329	2	• WASHER, Flat hard zinc plated (M16)
9	9-221310	2	• BOLT, Hex Head M16 x 2 x 45 mm CL 8.8 zinc plated
10	9-206133	1	• FITTING, 90° (10 JICM - M22 ORBM)
11	9-224200	1	• FITTING, Straight (M18M - 06JICM)
14	9-206473	2	• FLANGE KIT, Split code 62 - 16 M12
13	9-149181	2	• FITTING, Straight (04JICM - M14x1-1/2")
14	9-149224	1	• FITTING, 90° (M14M-06JICM)
15	9-707041	1	• FITTING, Straight (06JICF - 04JICM)
16	9-110498	1	• FITTING, Straight (08JICF - 06JICM)
17	9-224296	1	• FITTING, 90° (M18M - 08JICM)

3.2 Engine Assembly

Index No.	Skyjack Part No.	Qty.	Description
-	9-206586	1	ENGINE 2.2 TCD
1	9-206567	1	• ENGINE, TCD 2.2L3 - DEUTZ
-	9-224303	1	• • CONTROL UNIT
-	9-224304	1	• • FAN
-	9-224305	1	• • CATALYST, INLET
-	9-224306	1	• • OIL PAN
-	9-224307	1	• • STARTER
-	9-224308	1	• • DIPSTICK
-	9-224309	1	• • FILTER, OIL
-	9-224310	1	• • ALTERNATOR
-	9-224312	1	• • RELAY
-	9-224313	1	• • V-GROOVED PULLEY
-	9-224314	1	• • FUEL SUPPLY PUMP
-	9-224315	1	• • PRESSURE SENSOR
-	9-224316	1	• • COOLANT PUMP
-	9-224317	1	• • TACHO-GENERATOR
-	9-224318	1	• • TRANSMITTER, Temperature
-	9-224319	1	• • CATALYST, Returns elevator
-	9-224320	1	• • FILTER, FUEL
-	9-224321	1	• • PRESSURE, SENSOR
-	9-224322	1	• • FILTER, SPIN-ON FUEL
-	9-224323	1	• • PRE-FILTER
-	9-224324	1	• • CARTRIDGE, FILTER
-	9-224330	1	• • CABLE, SENSOR
-	9-224331	1	• • PLUG, VENT
2	9-206589	1	• MOUNT, ENGINE - Left hand rear
3	9-206590	1	• MOUNT, ENGINE - Right hand rear
4	9-206528	1	• MOUNT, ENGINE - Right hand forward
5	9-206529	1	• MOUNT, ENGINE - Left hand forward
6	9-205280	1	• COUPLING, Engine pump SJ519 TH, TD2.2L3
7	9-217422	10	• BOLT, Hex head M12 x 1-3/4" x 40 CL 8.8
8	9-933817	14	• WASHER, Flat M12 CL 200 Y
9	9-217267	4	• BOLT, Hex head M12 x 1-3/4" x 45 CL 10.9
10	9-116995	14	• WASHER, Lock M12 Plated din 127B
11	9-198177	1	• CLAMP, Perforated hose #52, 2-13/16" - 3-3/4"
12	9-121869	1	• CLAMP, Hose (2-1/2")
13	9-103995	4	• WASHER, Flat 1/4"
14	9-104000	4	• WASHER, Lock 1/4"
15	9-103857	4	• BOLT, Hex head zinc plated (1/4"-20 x 1" Gr. 5)
16	9-224205	16.5"	• FOAM, PSA 0.30" Thick x 1/2" wide (not shown)
17	9-224183	1	• ELBOW, 90° 2 x M16 x 1-1/2" brass (not shown)

3.7 Hydraulic Pump (Variable Displacement)

Index No.	Skyjack Part No.	Qty.	Description
-	-	-	<i>For serial numbers 87 500 009 to 87 500 031</i>
-	9-224187	1	HYDRAULIC PUMP SUBGROUP
1	9-206718	1	• PUMP, 30 CC high pressure gear
2	9-224180	1	• PUMP, 64 CC variable displacement
3	9-206544	1	• CONTROLLER, HFX12M
4	9-162387	1	• O-RING, 3-1/4" ID x 1/16"
5	9-103472	2	• WASHER, Flat 3/8"
6	9-104379	4	• WASHER, Flat 1/4" hard
7	9-103470	4	• WASHER, Lock 1/2" NOM x 1/8"
8	9-103999	2	• WASHER, Lock 3/8"
9	9-101297	2	• BOLT, Hex head zinc plated (3/8"-16 x 1-1/4" Gr. 5)
10	9-103907	4	• BOLT, Hex Head 1/2"-13 x 1-1/2" Gr. 5
11	9-104694	4	• WASHER, Flat #10
12	9-300450	4	• NUT, Lock with nylon insert, 10-32 Gr. 5
13	9-707040	1	• FITTING, 90° (16JICM-16ORBM)
14	9-138981	3	• FITTING, 90° (10JICM-12ORBM)
15	9-135091	1	• FITTING, 90° (10JICM-10ORBM)
16	9-191857	1	• FITTING, 90° LL (10JICM-10ORBM)
17	9-205722	2	• FLANGE KIT, Split code 62 - 16
18	9-196193	2	• FITTING, Straight (06 ORBM - 06 ORBF)
19	9-221785	2	• FITTING, FS1804-16-16-FG
20	9-138667	1	• FITTING, 16 ORBM TO 16 JICM
21	9-206931	2	• SENSOR, PRESSURE -7500 PSI 0-5V

4.3 Open Cab Components

Index No.	Skyjack Part No.	Qty.	Description
-	9-205390	1	Open Cab
1	9-191570	1	• DASH COVER PLATE
2	9-205348	1	• PANEL, Joystick cover
3	9-205313	1	• WELDMENT, Cab
4	9-104000	2	• WASHER, Lock, hel spring, 1/4"
5	9-191686	6	• WASHER, Flat 3/16" Type a,w ser
6	9-104185	5	• WASHER, Lock, hel spring, 3/16"
7	9-933625	1	• NUT, Hex, M8 x 1-1/4", DIN 934
8	9-103911	2	• BOLT, Hex head 1/2"-13 NC x 1" Gr. 5
9	9-205364	1	• SEAL, Flap clip-on
10	9-205364	1	• SEAL, Flap clip-on
11	9-103957	2	• BOLT, Machine, #8-32 NC x 1/2" PH phil
12	9-191536	2	• WASHER, Flat 1/2" type A,n ser
13	9-138834	4	• SCREW, Machine #10-24 NC x 3/4" PH phil
14	9-191538	4	• BOLT, Machine 1/2"-13 NC x 1" BH soc
15	9-191540	2	• WIRE TIE, Nylon, black, 7.5
16	9-205403	1	• CUP HOLDER, Black plastic
17	9-191917	2	• BOLT, Machine, #10-24 NC x 1/2" PH PHIL
18	9-191542	9	• BOLT, Machine 3/8"-16 NC x 3/4" BH torx
19	9-191548	20	• BOLT, 1/4"-20 NC x 1/2" TH Torx
20	9-191521	1	• MIRROR HEAD, Stud mount
21	9-103991	3	• WASHER, Flat no. 8 SAE
22	9-205392	1	• ARMREST
23	9-191574	4	• NUT, Hex, 5/16"-18 NC
24	9-190534	1	• SEAT, Milsco
25	9-928355	1	• LEVEL INDICATOR
26	9-205360	1	• TAPE, Anti-skid psa
27	9-205327	1	• BUBBLE SEAL, 180°
28	9-220608	1	• BOX, Manual holder
34	9-205402	1	• ASSEMBLY, Flow control
30	9-205363	1	• ASSEMBLY, Pedals
31	9-205393	1	• ASSEMBLY, Joystick
32	9-205397	1	• ASSEMBLY, Front dash
33	9-205400	1	• ASSEMBLY, Steering
-	9-205391	1	• ASSEMBLY, Seat mount
34	9-205398	1	• • PLATE, Seat adapter
35	9-205314	1	• • WELDMENT, Seat riser with shelf
36	9-191542	4	• • BOLT, Machine 3/8"-16 NC x 3/4" BH Torx
37	9-205327	13.5	• • BUBBLE SEAL, 180°
38	9-205327	28	• • BUBBLE SEAL, 180°
39	9-191518	44	• • FOAM SEAL
40	9-191548	3	• • BOLT, Machine 1/4"-20 NC x 1/4" TH Torx
41	9-191524	17.5	• • GASKET, Foam seal
42	9-191524	36.3	• • GASKET, Foam seal
43	9-924972	2	• • NUT, Lock with nylon insert no. 6
44	9-191753	2	• • BOLT, Phil TMS 6-32 UNC x 1/2" SS
45	9-191563	1	• • LATCH, Pad lockable
46	9-191747	1	• • SPACER, Catch latch
47	9-191587	1	• • TOOL DOOR

4.8 Front Dash

Index No.	Skyjack Part No.	Qty.	Description
-	9-205397	1	FRONT DASH
1	9-191519	1	• WELDMENT, Steering column mount
2	9-191686	2	• WASHER, Flat 3/16" type A, w ser
3	9-198996	4	• WIRE TIE, Nylon, 11.8" long, black (Not shown)
4	9-191545	2	• NUTSERT, 8-32 UNC x 0.350"
5	9-191542	6	• BOLT, Machine, 3/8"-16 NC x 3/4" BH torx
6	9-191518	1	• FOAM SEAL
7	9-191548	9	• BOLT, Machine 1/4"-20 NC x 1/4" TH torx
8	9-191550	5	• BOLT, Machine 1/4"-18 NC x 3/4" TH torx
9	9-191753	8	• PHIL TMS 6-32 UNC x 1/2" SS
10	9-191575	2	• PHIL TMS, 8-32 UNC x 1/2" 18-8SS
11	9-205335	1	• DASH PANEL, Plastic
12	9-206101	1	• HARNESS, Console 5K (Not shown)
13	9-191576	1	• ASSEMBLY, Fuse and power
14	9-205395	1	• ASSEMBLY, Left Hand Dash panel switches
15	9-205396	1	• ASSEMBLY, Right Hand Dash panel
16	9-205898	1	• ASSEMBLY, Micro relay

4.13 Enclosed Cab

Index No.	Skyjack Part No.	Qty.	Description
-	9-205407	1	ENCLOSED CAB
1	9-191649	1	PANEL, Screen intake
2	9-191651	1	RETAINER, Front upper window
3	9-191652	1	RETAINER, Window slider lo
4	9-191653	1	PLATE, Retainer, top
5	9-204288	2	LATCH, Swell, red handle
6	9-205318	1	PANEL, Tank cover
7	9-205338	1	PANEL, Belly pan
8	9-191926	1	HINGE, Upper
9	9-191926	1	HINGE, Lower
10	9-204287	1	RETAINER, Top
11	9-205871	2	TANK, Spacer
12	9-103472	11	WASHER, Flat 3/8" Type A,W SER
13	9-103911	2	BOLT, Hex Head 1/2"-13 NC x 1" Gr. 5
14	9-191532	4	CLAMP, Hose, #40 2-1/16" - 3"
15	9-191689	1	BALL STUD, Gas spring, 10 mm
16	9-191536	4	WASHER, Flat 1/2" Type A,N SER
17	9-191692	2	KNOB, Black, 1-1/4" DIA 1/4" x 3/4"
18	9-191695	2	HOSE, Tee 3/16" DIA
19	9-191538	4	BOLT, Machine 1/2"-13 NC x 1" BH soc
20	9-191512	1	PLUG, Hole, plastic, 3/32" DIA
21	9-191542	12	BOLT, Machine 3/8"-16 NC x 3/4" BH torx
22	9-223900	1	RUBBER, D-seal, PSA hats
23	9-159294	8	NUT, U-clip, 3/8"-16 UNC
24	9-191702	1	NUT, Hex jam, M12 x 1.0 F
25	9-191703	1	STRIKER STUD, 17 mm
26	9-191517	1	GROMMET, Snap bushing, 1"
27	9-191548	9	MSCR, 1/4"-20 NC x 1/2" TH torx
28	9-191677	4	MSCR, 5/16"-18 NC x 1/2" TH torx
29	9-191523	1	DUCT, Flex air
30	9-191523	1	DUCT, Flex air
31	9-191706	2	LOUVER, Round, 2.79 w/2.0 hose
32	9-921521	1	FILTER, HVAC
33	9-191574	1	NUT, Hex, 5/16"-18 NC
34	9-191707	2	HINGE WASHER, Brass
35	9-191525	1	FITTING, Wiper hose
36	9-191658	1	DOME LIGHT, Oval with switch
37	9-191491	1	CONTROLLER, HVAC
38	9-922749	1	HEATER UNIT
39	9-191665	3	CLIP, Window slider
40	9-191666	2	RETAINER, Front window lo
41	9-191472	1	WIRE HARNESS, Cab components
42	9-191490	1	WIRE HARNESS, Heater/AC
43	9-191459	2	SWITCH, Wiper/washer
44	9-931298	2	MICRO RELAY, 20A
45	9-223793	7	BOLT, Machine 3/8"-16 NC x 1" BH torx
46	9-204421	2	DECAL, Emergency exit

Section 5 – Electrical

5.1 *Glow Plug Harness*

5.2 *Console Harness*

5.3 *Engine Harness*

5.4 *Battery Cables*

5.3 Engine Harness

Index No.	Skyjack Part No.	Qty.	Description
48	9-156163	6	• CONNECTOR ASSEMBLY 2F, AMP
49	9-164572	7	• TERMINAL FEMALE (2.5-1.0mm ²), MCP2.8
50	9-117594	1	• CONNECTOR SEALING PLUG
51	9-156118	-	• TERMINAL FEMALE (5.0-3.0 mm ²), 630 M/P PULL-TO-SEAT
52	9-156127	4	• CONNECTOR 2F, 630 M/P FUSE HOLDER
53	9-117591	19	• CONNECTOR CONTACT SOCKET 16-18
54	9-156117	1	• COVER, INLINE AUTOFUSE
55	9-105359	1	• TERMINAL, FEMALE DISCONNECT FULLY NYLON-INS
56	9-163021	-	• RESISTOR
57	9-117596	1	• CONNECTOR, RECEPTACLE 2-PIN
58	9-117598	3	• WEDGE, PIN W2P
59	9-156104	1	• PLUG CAVITY 1W, 280 M/P & W/P
60	9-156132	5	• CONNECTOR 5F, 280 M/P
61	9-156133	18	• TPA, 5W 280 M/P
62	9-156134	-	• TERMINAL FEMALE SEALED (5.0-3.0 mm ²), 280M/P TANGLESS
63	9-156142	-	• TERMINAL FEMALE SEALED (2.0-1.0 mm ²), 280 M/P TANGLESS
64	9-156147	2	• WIRE SEAL GRAY (3.5-2.8 mm), 280 M/P
65	9-121504	4	• FUSE, ATC, 20A
66	9-156200	1	• RELAY
67	9-117597	1	• CONNECTOR, PLUG 2-PIN
68	9-117599	1	• WEDGE, SOCKET
69	9-117590	2	• CONNECTOR - CONTACT PIN 16-18
70	9-156105	2	• CONNECTOR 2M, W/P
71	9-156137	1	• TERMINAL FEMALE SEALED (2.0-1.0 mm ²), W/P
72	9-124036	1	• CONNECTOR 2F, W/P
73	9-124369	1	• WIRE SEAL GREEN (2.9-2.0 mm), 280 M/P

CLICK HERE TO **DOWNLOAD** THE COMPLETE MANUAL

- Thank you very much for reading the preview of the manual.
- You can download the complete manual from: www.heydownloads.com by clicking the link below



- Please note: If there is no response to CLICKING the link, please download this PDF first and then click on it.

CLICK HERE TO **DOWNLOAD** THE COMPLETE MANUAL

6.2 Boom Components

Index No.	Skyjack Part No.	Qty.	Description
45	9-190545	1	• SPACER, SS 1/2 OD x 5/16" long x 1/4" ID
46	9-190019	1	• PLATE, Angle indicator
47	9-205263	1	• CLAMP, Tube - uhmw
48	9-205262	1	• PLATE, Clamp
49	9-205458	5	• CLAMP, Hose 5/8" tube
50	9-932668	5	• COVER PLATE
51	9-148817	4	• BUSHING - CJS 3232 (2.00" x 2.00" long)
52	9-205816	1	• TUBE, Pressure 5/8" OD x .083 wall
53	9-205817	1	• TUBE, Pressure 5/8" OD x .083 wall
54	9-205818	1	• TUBE, Pressure 5/8" OD x .083 wall
55	9-205819	1	• TUBE, Pressure 5/8" OD x .083 wall
56	9-205820	1	• TUBE, Pressure 5/8" OD x .083 wall
57	9-205821	1	• TUBE, Pressure 5/8" OD x .083 wall
58	9-205980	2	• HOSE, Twin 08 JIC x 230.75" long (not shown)
59	9-154241	4	• FITTING, 90° Bulkhead (08 JICM - 08 JICM)
60	9-154242	4	• NUT, Bulkhead - 08 JIC
61	9-103071	2	• FITTING, Straight (08 JICM - 10 ORBM)
62	9-197449	2	• PLUG, 1/2" wide flange

7.3 Extend Cylinder

Index No.	Skyjack Part No.	Qty.	Description
-	9-224199	1	EXTEND CYLINDER
1	9-224026	1	• VALVE, COUNTERBALANCE - 5000 PSI
2	9-224271	1	• VALVE, COUNTERBALANCE
3	9-224033	4	• BEARING, Dry
4	9-213481	1	• SCREW, Set (M8 x 1.25 x 8)
5	9-224032	1	• PISTON
6	9-224031	1	• GLAND
7	9-224030	1	• ROD ASSEMBLY
8	9-224029	1	• TUBE ASSEMBLY
9	9-224034	1	• SEAL KIT (Not shown)

8.2 Main Manifold Assembly

Index No.	Skyjack Part No.	Qty.	Description
-	9-206866	1	MAIN MANIFOLD
1	9-206311	1	<ul style="list-style-type: none"> • MANIFOLD, Main, spool
2	9-206659	1	<ul style="list-style-type: none"> • PLATE, Main manifold mounting
3	9-125959	6	<ul style="list-style-type: none"> • WASHER, Flat 3/8" hard
4	9-104606	3	<ul style="list-style-type: none"> • NUT, Lock with nylon insert 3/8" Gr 5
5	9-208945	3	<ul style="list-style-type: none"> • BOLT, Hex head 3/8"-16 x 1-5/8" Gr 5

8.7 Steer Valve Assembly

Index No.	Skyjack Part No.	Qty.	Description
-	9-206884	1	STEER MANIFOLD
1	9-206897	1	• PLATE, Steer select valve
2	9-206312	1	• VALVE, Steer select
			<i>(For components, refer to Section 8.8 - Steer Valve)</i>
3	9-103918	4	• SCREW, Socket Head #10-24 x 1-1/4"
4	9-103999	2	• WASHER, Lock 3/8"
5	9-125959	2	• WASHER Flat 3/8" hard
6	9-300437	2	• BOLT, Hex Head 3/8"-16 x 7/8" Gr. 5

8.12 Drive and System Pump Hoses

Index No.	Hose P/N	From		To		
		Description	Port	Port	Description	
-	-	<i>For S/N 87 500 009 - 87 500 030</i>				
1	H341200750	Cooler inlet		T	Main manifold	
2	H341201022	Cooler outlet			Filter inlet	
3	H311600720	Filter outlet		TOP	Hydraulic Tank (return)	
4	H751600500	Drive pump - hydrostat	H		Hydraulic Tank suction	
5	H311000270	Drive pump - charge	W		Charge filter inlet	
6	H321000222	Drive pump - charge	M		Pilot manifold (charge)	
7	H341000123	Charge filter outlet		PUMP	Pilot manifold	
8	H340400410	Pilot manifold	MOTOR	E	Drive motor	
9	9-221784	Drive motor	A	B	Drive pump	
10	9-221783	Drive motor	B	A	Drive pump	
11	H321000350	Drive pump	F	U	Drive motor	
12	H341000270	Tank return		E	Drive pump	
13	H761600460	System pump inlet			Hydraulic tank suction	
14	H671001040	System pump outlet		P	Main manifold	

Section 9 – Standard and Optional Attachments

9.1 *Mechanical Quick Coupler*

9.2 *Hydraulic Quick Coupler*

9.3 *Standard Carriage*

9.4 *Side Tilt Carriage*

9.5 *Side Shift Carriage*

9.6 *Forks*

9.7 *Skid Steer Adapter*

9.8 *72" Trust Boom*

9.9 *1/2 Cubic Yard Bucket*

9.5 Side Shift Carriage

Index No.	Skyjack Part No.	Qty.	Description
1	9-205240	1	SIDE SHIFT CARRIAGE 48"

10.1 Road Lights

Index No.	Skyjack Part No.	Qty.	Description
-	9-206204	1	ROAD LIGHTS
1	9-206205	1	• HARNESS, Road light
2	9-190596	1	• LIGHTS, Road front left hand
3	9-196380	1	• LIGHTS, Road front right hand
4	9-206306	1	• SUPPORT, Roadlight left hand
5	9-206621	1	• BRACKET, Roadlight right hand
6	9-191758	2	• GROMMET, Oval lamp
7	9-190578	2	• LIGHT, Stop/tail/turn/backup
8	9-206305	2	• BRACKET, Roadlight rear
9	9-931298	3	• RELAY
10	9-191457	2	• SWITCH, Rocker
11	9-191455	1	• SWITCH, Boomlight/haz-posi
12	9-925386	1	• FLASHER
13	9-156202	1	• FUSE, ATO, 5 A
14	9-156204	1	• FUSE, ATO, 15 A
15	9-104606	3	• NUT, Lock with nylon insert 3/8"-16 Gr. 5
16	9-103472	12	• WASHER, Flat 3/8"
17	9-103999	7	• WASHER, Lock 3/8"
18	9-103473	3	• BOLT, Hex head zinc plated (3/8"-16 x 1" Gr. 5)
19	9-101632	4	• BOLT, Hex head zinc plated (3/8"-16 x 3/4" Gr. 5)
20	9-101297	2	• BOLT, Hex head zinc plated (3/8"-16 x 1-1/4" Gr. 5)

10.6 Backup Camera and Sensor

Index No.	Skyjack Part No.	Qty.	Description
-	9-224070	1	KIT, BACK UP CAMERA AND SENSOR
1	9-206279	1	• BRACKET, Rear view camera
2	9-212196	1	• CAMERA, Back up
3	9-116192	3	• SCREW, Round head machine 8-32 x 5/8"
4	9-103991	3	• WASHER, Flat #8
5	9-207240	3	• NUT, Lock with nylon insert 8-32 Gr. 5
6	9-206271	1	• BRACKET, Reverse warning device
7	9-211708	1	• SENSOR, Back up sentry
8	9-151155	4	• SCREW, Round head machine 10-24 x 1"
9	9-104694	4	• WASHER, Flat #10
10	9-126642	4	• NUT, Lock with nylon insert 10-24 Gr. 5
11	9-224173	1	• CABLE, Back up camera (Not Shown)
12	9-207266	4	• BOLT, HXHD 0.312-18 X 0.875 GR5
13	9-224167	1	• HARNESS, Reverse warning sys. th (Not Shown)
14	9-211707	1	• DISPLAY, Back up camera
15	9-212195	1	• STAND, Monitor - modified
16	9-206137	1	• MOUNT, Telematics and monitor
17	9-114595	1	• TERMINAL, Female 18-22 awg red (Not Shown)
18	9-111354	1	• WIRE PROTECTOR (Not Shown)
19	9-162464	4	• INSERT, .313-18 AK OPEN .027-.150
20	9-103996	4	• Washer Flat 0.312
21	9-103404	4	• WASHER, LOCK 0.312
22	9-223630	1	• INSTRUCTIONS, Backup camera and sensor installation (Not shown)

10.11 A/C Compressor

Index No.	Skyjack Part No.	Qty.	Description
-	9-206709	1	COMPRESSOR ASSEMBLY
1	9-163903	1	• AC COMPRESSOR
2	9-224327	1	• WELDMENT, Pivot adjustment
3	9-191238	1	• V-BELT, A34
4	9-224325	1	• BRACKET, Compressor
5	9-103472	12	• WASHER, Flat 3/8"
6	9-104606	6	• NUT, Lock with nylon insert 3/8"-16 Gr. 5
7	9-103871	3	• BOLT, Hex Head 3/8"-16 x 1-3/4" Gr. 5
8	9-103870	1	• BOLT, Hex Head 3/8"-16 x 1-1/2" Gr. 5
9	9-922004	1	• LABEL, Refrigerant charge (not shown)
10	9-224000	1	• GUARD, A/C belt
11	9-103857	2	• BOLT, Hex head zinc plated (1/4"-20 x 1" Gr. 5)
12	9-104000	2	• WASHER, Lock 1/4"
13	9-103995	2	• WASHER, Flat 1/4"
14	9-103596	1	• BOLT, Hex Head, zinc (3/8"-16 x 2" Gr. 5)

11.2 Pictorial Labels Layout

Index No.	Skyjack Part No.	Qty.	Description
-	9-220514	1	PICTORIAL LABELS ASSEMBLY
1	9-152230	3	• LABEL, Grease point
2	9-137988	1	• LABEL, Crush/pinch hazard pictorial
3	9-172425	1	• LABEL, Hydraulic oil level (min/max)
4	9-139314	4	• LABEL, Body crush pictorial
5	9-124631	4	• LABEL, Wheel info pictorial
6	9-157528	2	• LABEL, Tie down pictorial
7	9-139855	4	• LABEL, Keep clear pictorial
8	9-138146	1	• LABEL, No smoking pictorial
9	9-143688	2	• LABEL, Lift point
10	9-162852	1	• LABEL, Diesel 'ultra low sulfur only'
11	9-102961	1	• LABEL, ATF Dexron III pictorial
12	9-163095	1	• LABEL, Caution coolant fill
13	9-196184	1	• LABEL, Boom angle indicator
14	9-195421	2	• LABEL, Fork pins warning
15	9-119674	1	• LABEL, Battery disconnect switch pictorial
16	9-207462	1	• LABEL, Hot surface pictorial large
17	9-195422	1	• LABEL, Lifting hook
18	9-115543	1	• LABEL, No step
19	9-172946	1	• LABEL, Towing capacity SJ519 TH
20	9-124767	2	• LABEL, Lift point/tie down
21	9-173081	1	• LABEL, Warning California proposition 65
22	9-220515	1	• LABEL GROUP, 5k cab labels (not shown)

CLICK HERE TO **DOWNLOAD** THE COMPLETE MANUAL

- Thank you very much for reading the preview of the manual.
- You can download the complete manual from: www.heydownloads.com by clicking the link below



- Please note: If there is no response to CLICKING the link, please download this PDF first and then click on it.

CLICK HERE TO **DOWNLOAD** THE COMPLETE MANUAL