

Manitowoc

TRADITIONAL CRANE PARTS MANUAL

This manual has been prepared for and is considered part of

4000W

Model

40398

Serial Number

GROUP A = Rotating Structure (Includes rotating bed, operator's cab, cases, fuel tanks, transfer pump, counterweights, guards, platforms, catwalks, machinery enclosure, horn)

GROUP B = Upperworks Machinery (Includes front, rear, and auxiliary drums, boom hoist, swing and drive shafts, hand levers, foot pedals, control linkage, rotation indicators, upperworks hydraulic components, hydraulic piping, hydraulic oil reservoir, lubrication pump and piping, blowers)

GROUP C = Air Components & Electrical (Includes control console, air piping, electric wiring, auxiliary light plant and lighting, TV monitoring, compressor and air tank)

GROUP D = Power Components - Upperworks (Includes engine or motor, radiator, auxiliary power plant, take off converters and piping, controls, VICON power lowering, torque limiter, hydraulic pumps and piping, fuel piping, battery box)

GROUP E = Lower Structure & Control (Includes carbody, crawlers, travel shafts and control, steering travel locks, hydraulic travel, travel power outriggers, carrier, pedestal, lowerworks hydraulic piping, RINGER components, barge mounting and machinery, spud drums)

GROUP F = Attachments (Includes booms, jibs, masts, tower, wire rope guides, equalizer, gantry, fairlead, timber guards, boom angle indicator, block-up limit, tag line, hook block, weight ball, upper and lower boom point, wind speed indicator, crowd and retract dipper sticks, dippers,)

O-NUMBER SECTION = (Includes lacing drawings and purchased component parts drawings referenced in sections A through F)

This manual is arranged in sections as listed above. Sections A through F are arranged by group numerical order with an index after each section tab. An alphabetical index for groups A Through F combined is located after the O-number Section. The O-number section is arranged in numerical order by O-number. Following this cover page are the Basic Specifications, Warranty Information, Tool List (if applicable) Outline Dimensions, Weights, and Dealer Listing.

CLICK HERE TO **DOWNLOAD** THE COMPLETE MANUAL

- Thank you very much for reading the preview of the manual.
- You can download the complete manual from: www.heydownloads.com by clicking the link below



- Please note: If there is no response to CLICKING the link, please download this PDF first and then click on it.

CLICK HERE TO **DOWNLOAD** THE COMPLETE MANUAL

MANITOWOC ENGINEERING CO.

A Division of The Manitowoc Company, Inc.

Manitowoc, Wisconsin

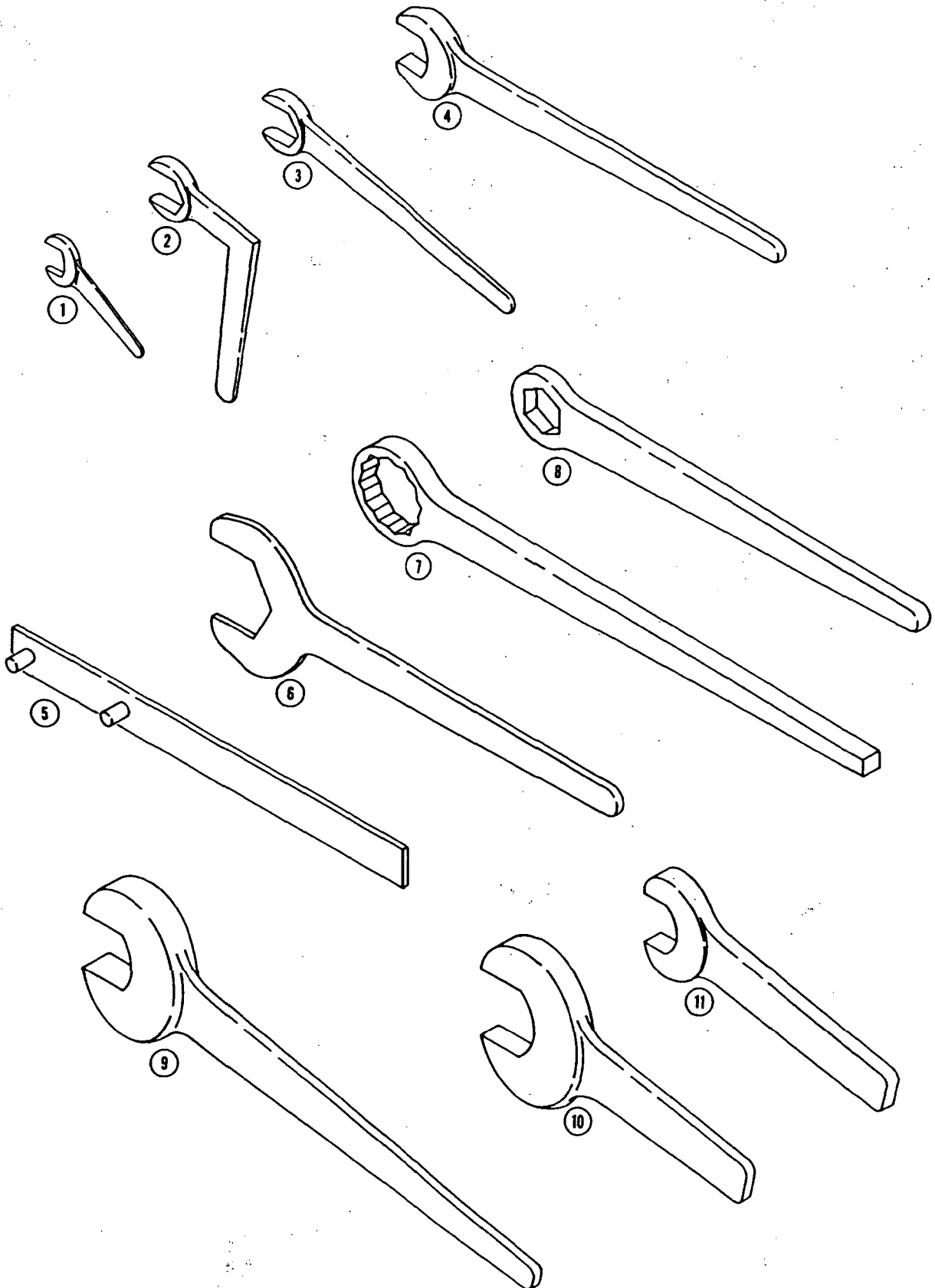

0-480-1A

MATERIAL LIST ON BACK

MASTER

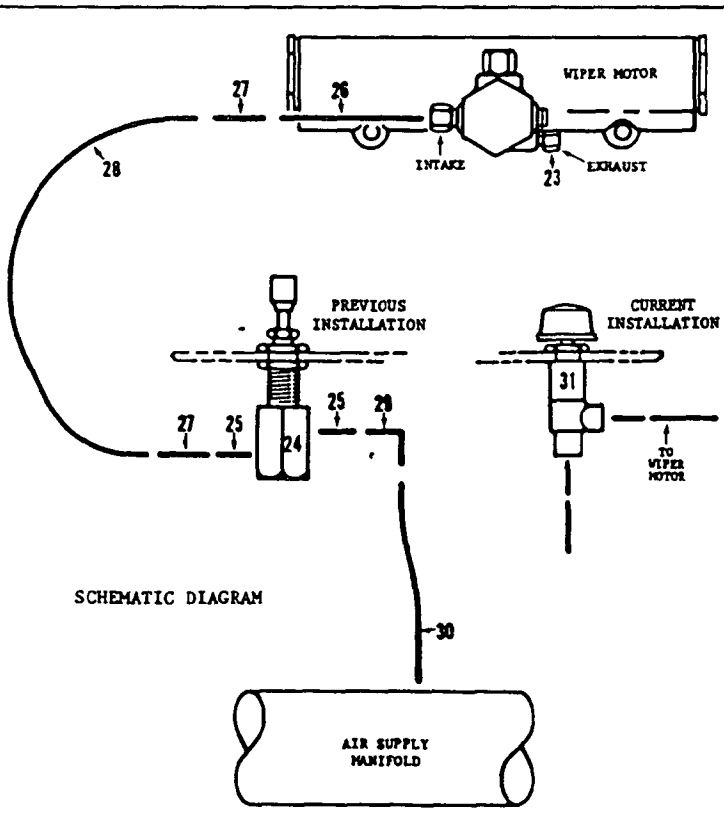
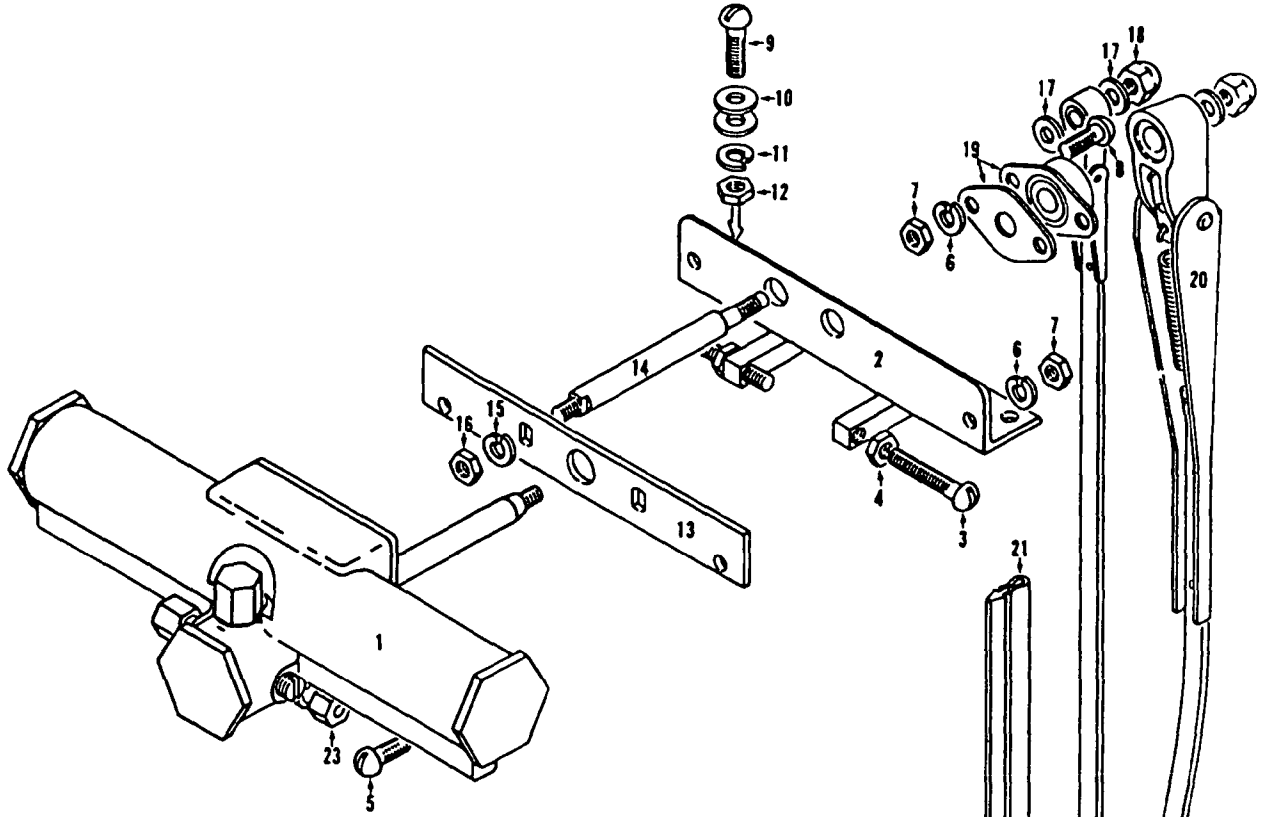

SCHEMATIC DIAGRAM

MATERIAL LIST ON BACK

WINDSHIELD WIPER

MASTER

FUEL GAUGE AND FILTER
Design Change of Mar. 21, 1973

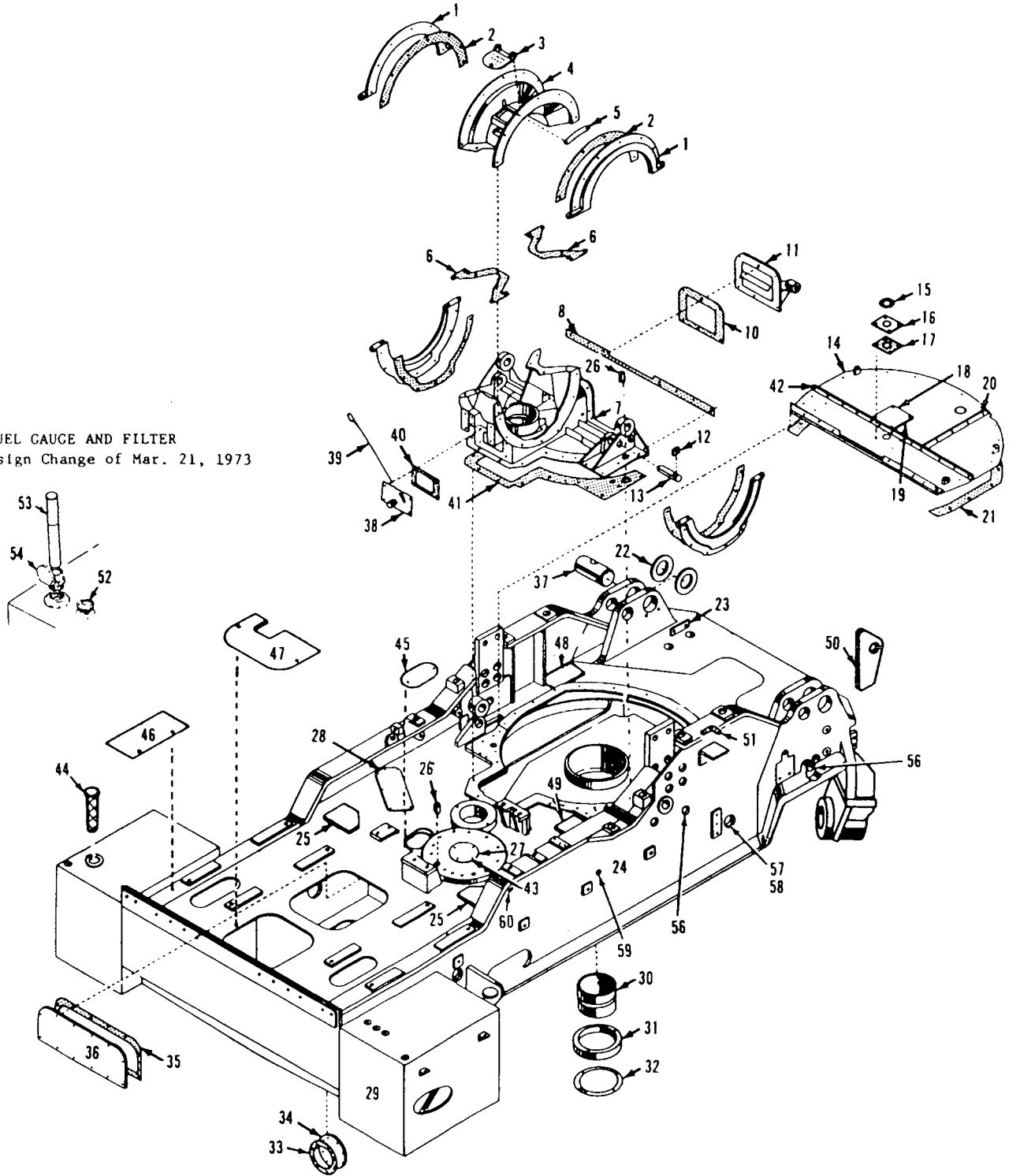

42103K1

ROTATING BED

GROUP B - Upperworks Machinery

MANITOWOC ENGINEERING CO.

A Division of The Manitowoc Company, Inc.

Manitowoc, Wisconsin

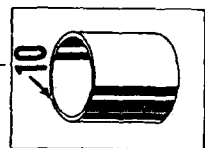
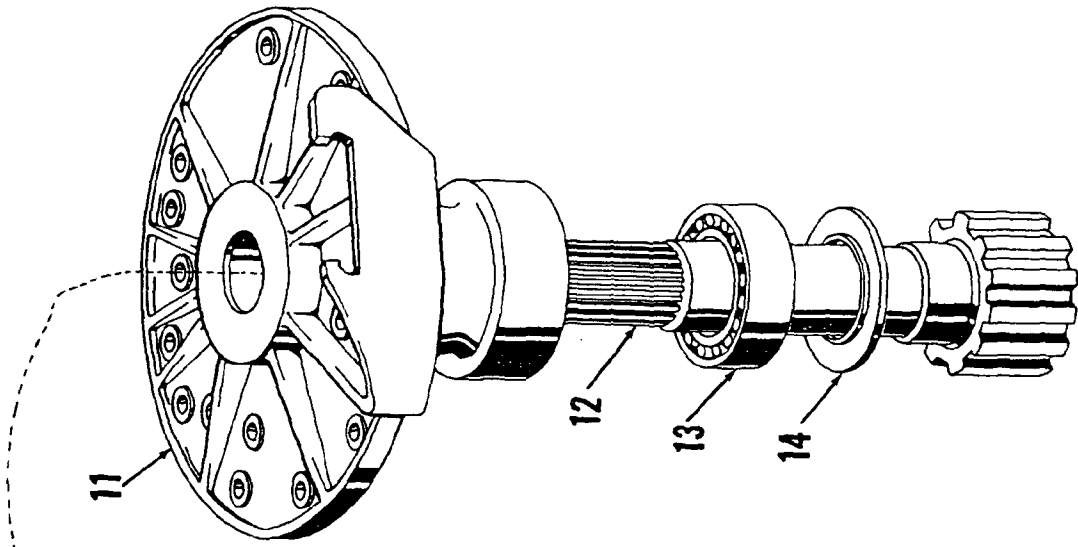

Without Swing Brake

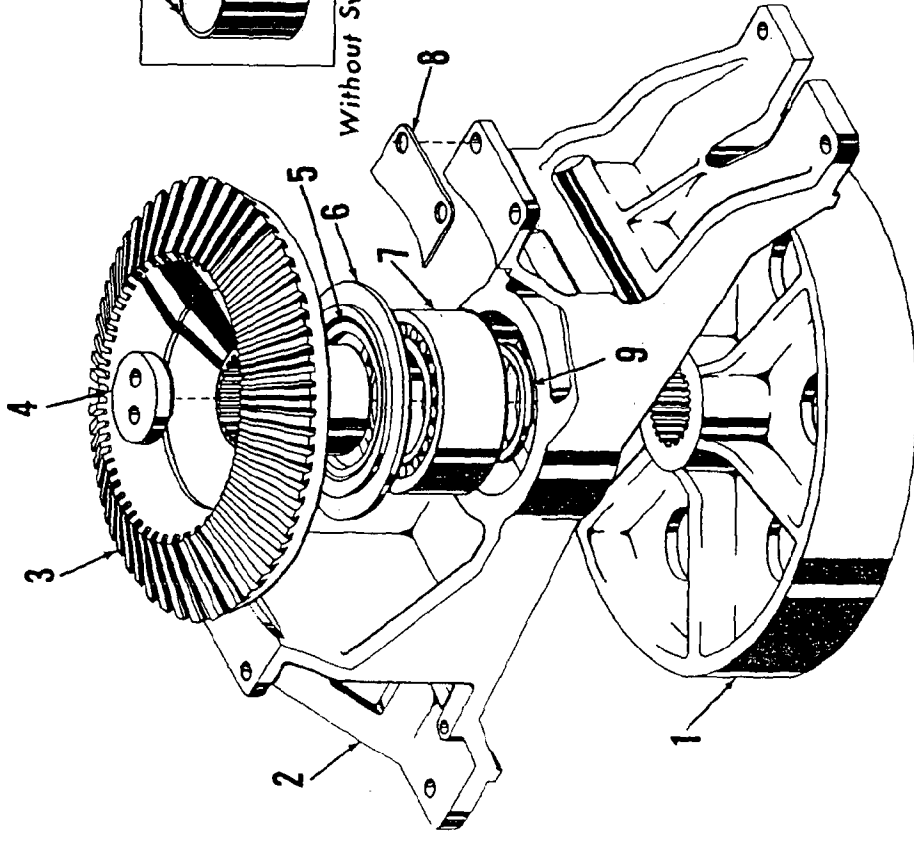

ILLUST. No. 23439-A-1

MATERIAL LIST ON BACK

VERTICAL DRIVE SHAFT

23439

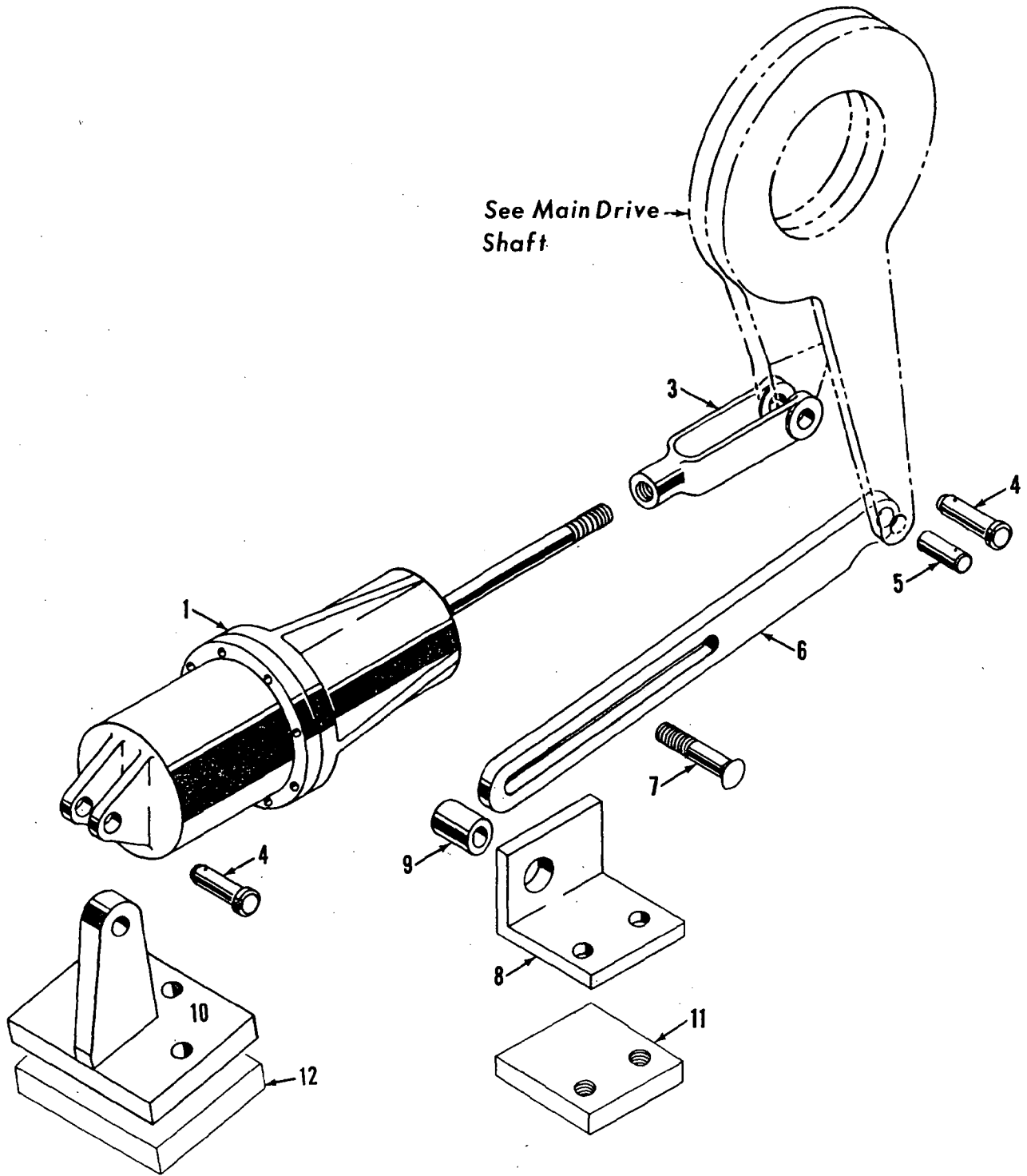

3234081

MATERIAL LIST ON BACK

LEFT SWING CLUTCH CONTROL

A Division of The Manitowoc Company, Inc.

Manitowoc, Wisconsin

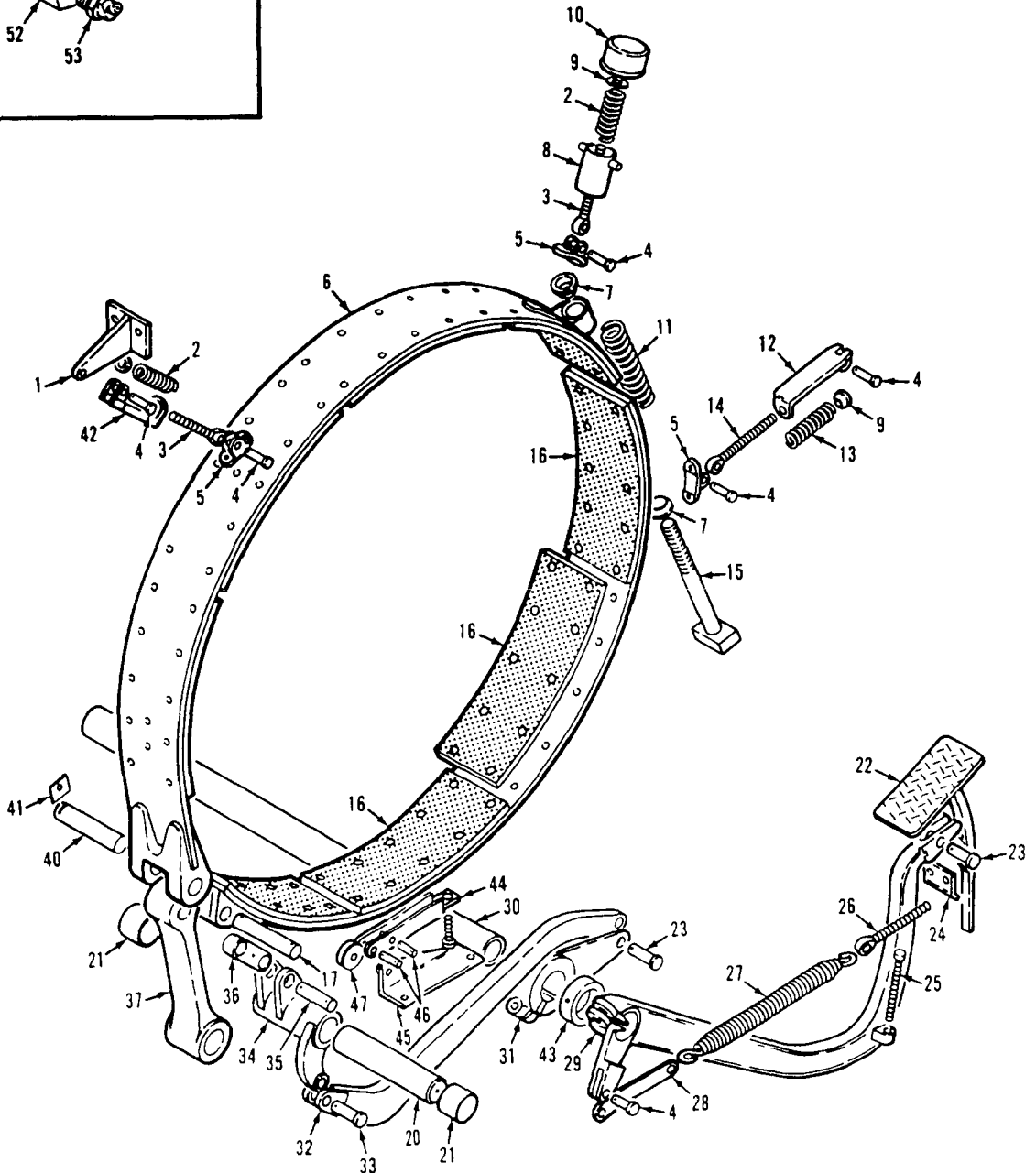
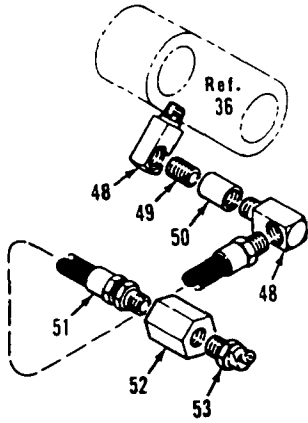

42183C1

MATERIAL LIST ON BACK

RIGHT DRUM BRAKE

MANITOWOC ENGINEERING CO.

A Division of The Manitowoc Company, Inc.

Manitowoc, Wisconsin

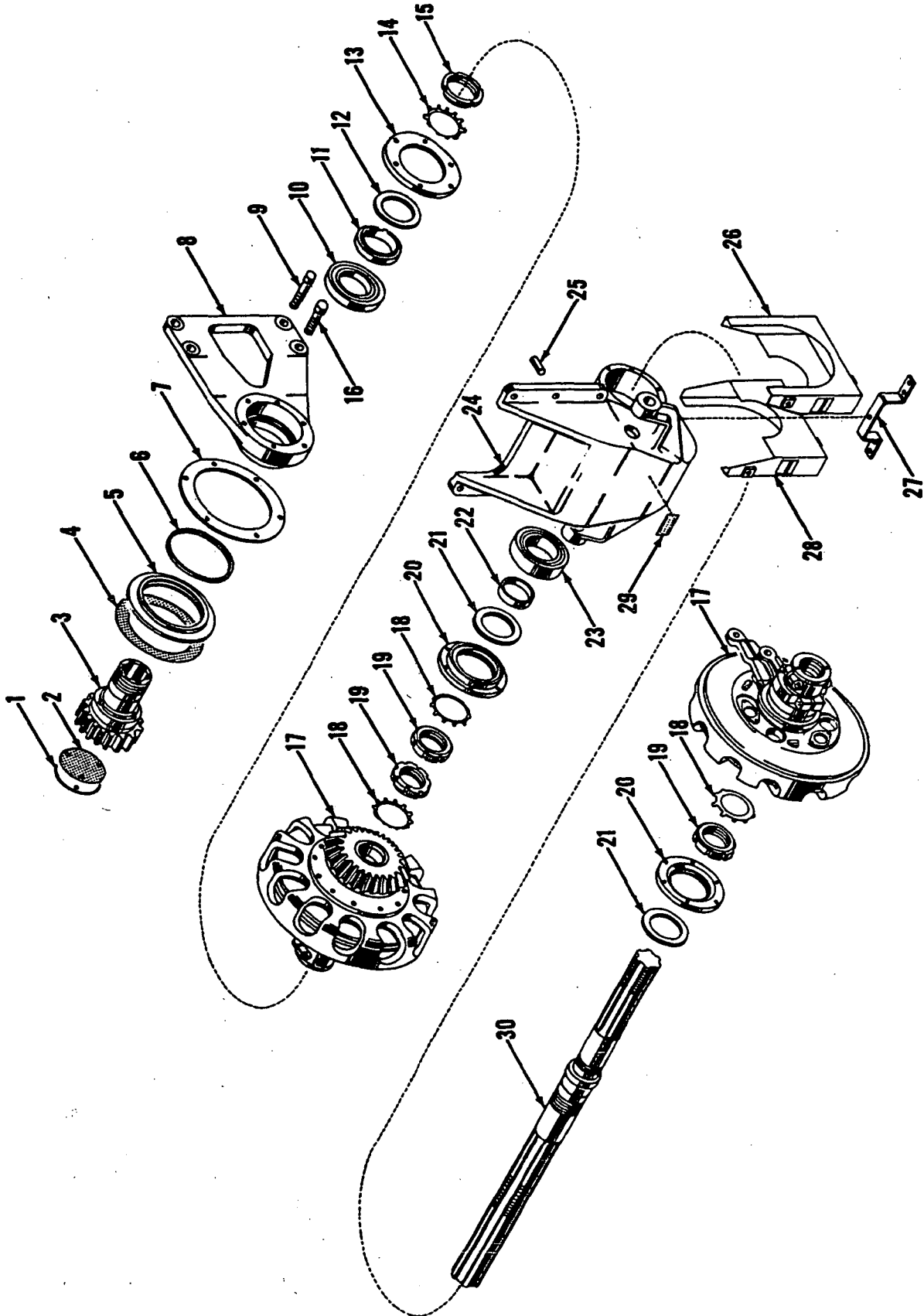

ILLUST. No. 42197 - A-1

MATERIAL LIST ON BACK

CLUTCH SHAFT ASSEMBLY

MASTER

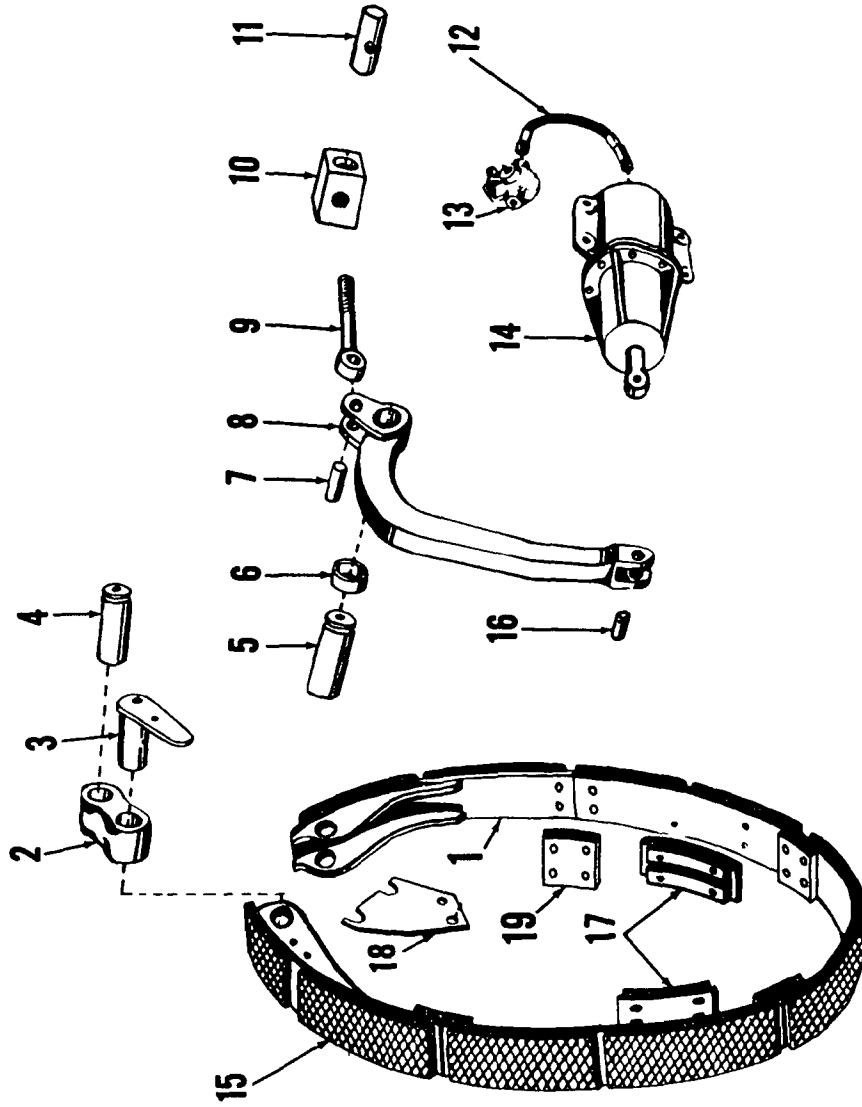

4170282

MATERIAL LIST ON BACK

CLUTCH BAND ASSEMBLY

Use 4238 E2 Back

MANITOWOC ENGINEERING CO.

Division of The Manitowoc Company, Inc.

Manitowoc, Wisconsin 54220

B13.1

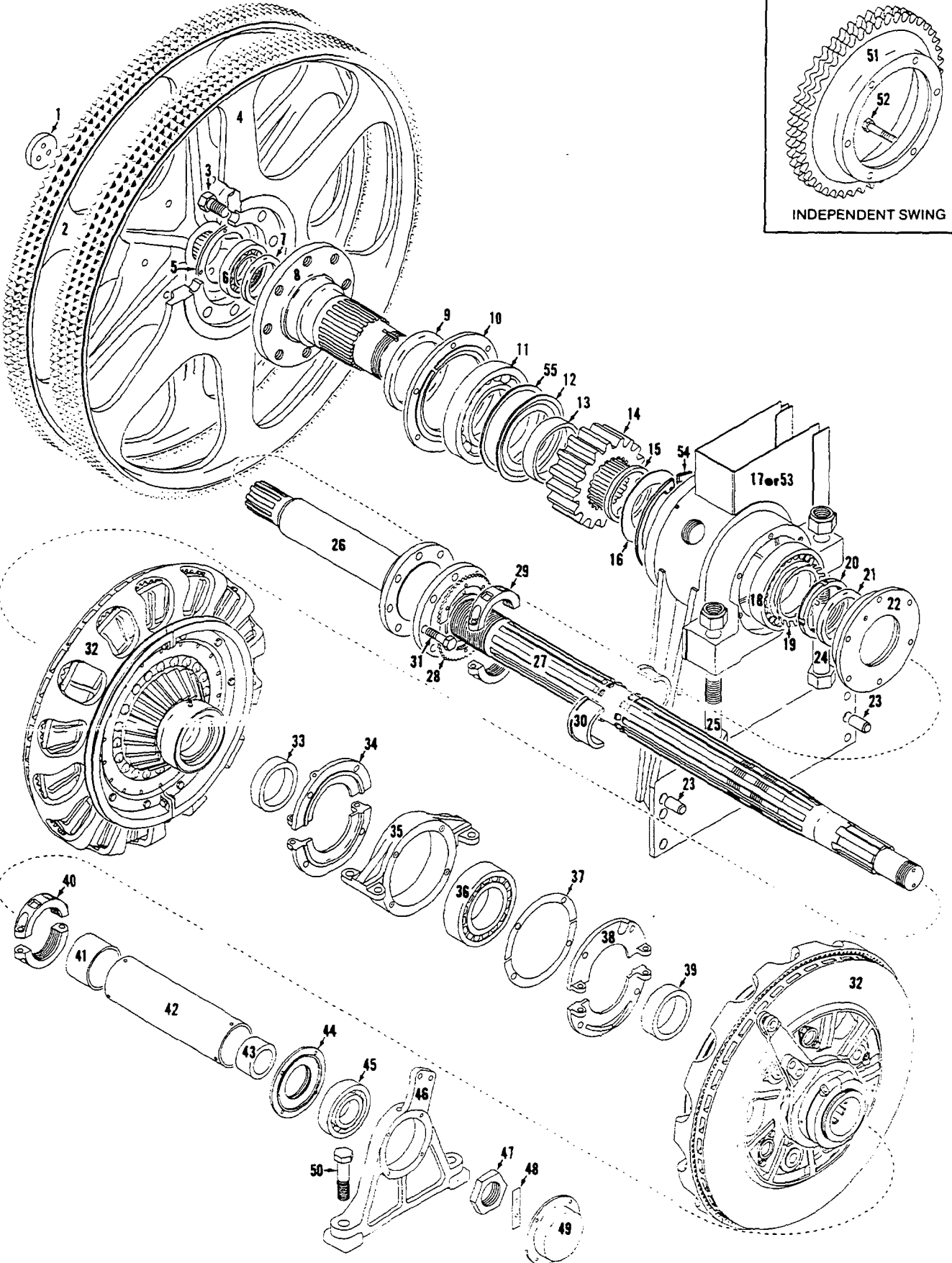

INDEPENDENT SWING

MAIN DRIVE SHAFT

43132B1

MATERIAL LIST ON BACK

43923-1Cont.	REV. E	MODEL 4000-4000W
--------------	-----------	---------------------

IND. BOOM HOIST

REF. NO.	PART NUMBER	QUANTITY REQUIRED	DESCRIPTION OF PART	VENDORS PART NO.
47	225112	1	NUT, Lock	
48	622378	1	SEAL, Oil	
49	71052	1	ADAPTER W/gr. fitting, capscrews and lockwashers	
50	72004	1	COVER, Plate	
51	139518	1	DRUM, Brake (See Note)	
53	139519	1	DRUM, Aux. Brake (See Note)	
52	139518	1	KEY (1/2" x 5/8" x 5-1/2") (See Note) (Weld in #139519 Keyway)	
54	17328	1	PLATE, End (Use 2 capscrews #613876 - 1/2" - 13 NC x 2-1/2" - Gr. 5)	
			<u>MACH. W/BOOM HOIST PAWL</u> (Delete Ref. #2 - Right Side)	
2a	181289	1	DRUM, Boom Hoist Right	
			<u>MACH. W/BOOM HOIST PAWL - PRIOR TO DESIGN</u> <u>CHANGE OF OCT. 14, 1970</u> (Delete Ref. #2 and 3 - Right Side)	
2b	180593	1	DRUM, Boom Hoist Right	
3a	79558	1	WEDGE, Anchor (Straight) (7/8" wire rope)	
			NOTE: Ref. Nos. 51, 52, 53 are per design change of 2-12-71. Prior to this change the following were used:	
51	77848	1	DRUM, Brake	
52	77850	1	KEY (3/8" x 1/2" x 5") W/roll pin	
53	77849	1	DRUM, Aux. Brake	

REV. E	43923 - 1
-----------	-----------

PLEASE GIVE MACHINE S/N W/ORDER

43923-1

MACH

43923-1

A Division of The Manitowoc Company, Inc.

Manitowoc, Wisconsin

MASTER

50841A1

50841A1

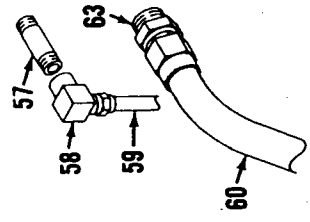
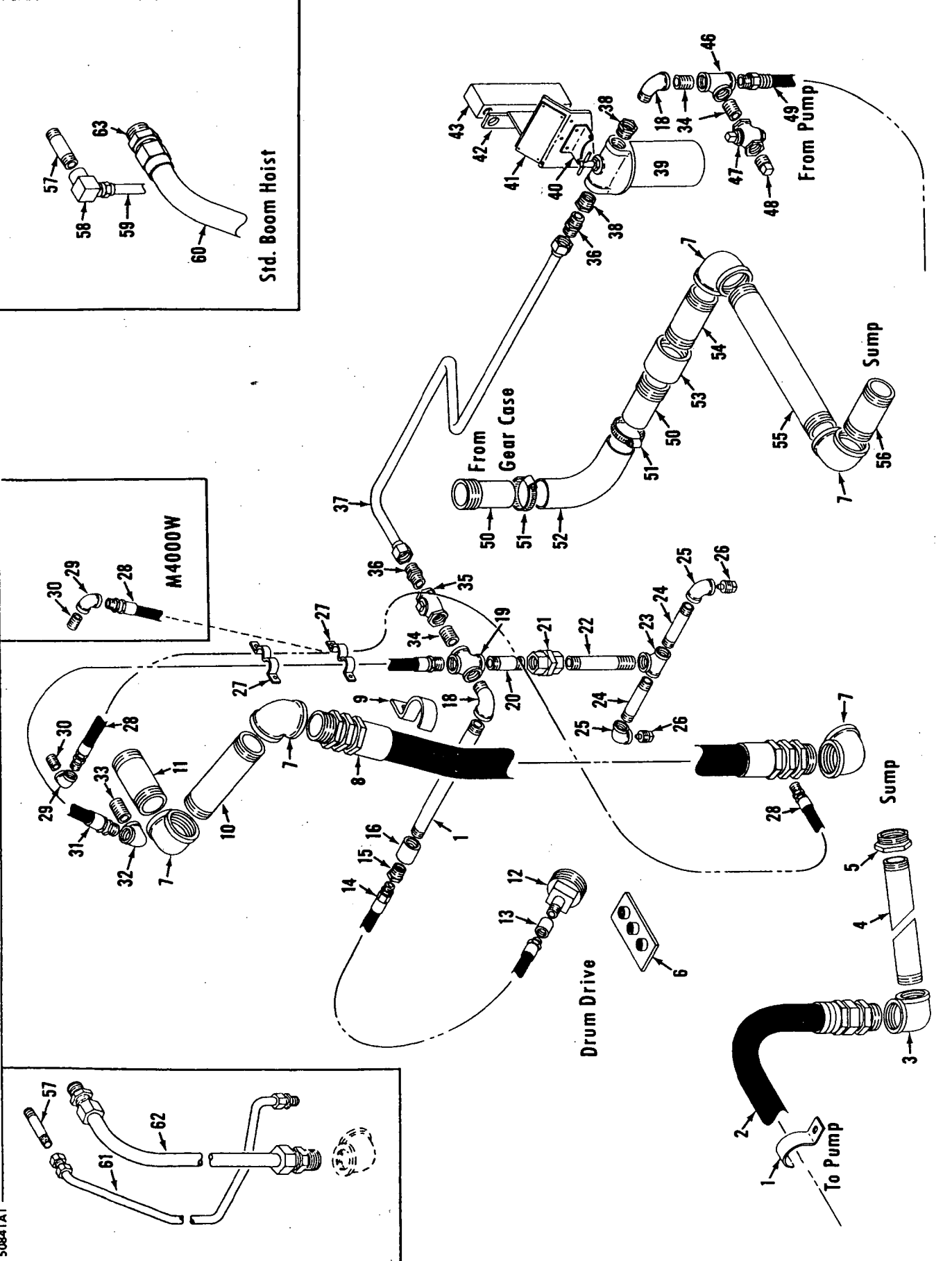

Std. Boom Hoist

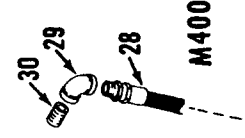

M4000W

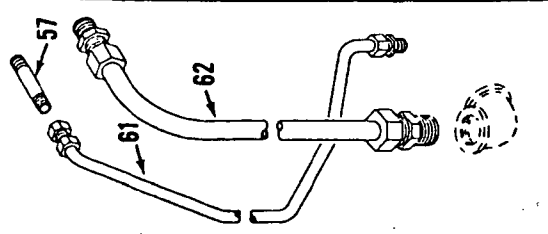

MATERIAL LIST ON BACK

LUBE. OIL PIPING

PARTS MANUAL ALPHABETICAL INDEX
Group C - Air Components & Electrical

DESCRIPTION	PUBLICATION	REV	START DATE	END DATE	GROUP
Boom & Mast Lighting	31117	C1	07/14/57	03/14/69	C1201
Cab Lighting	31116	F1	07/14/57	10/14/81	C1301
Compressor & Piping	49342	B2	01/04/71	06/05/75	C0101
Compressor & Piping	50949	B1	01/29/71	12/18/72	C0101
Compressor & Piping	50949	E2	01/29/71	10/23/80	C0101
Control Console	48462	Q1	08/20/71	07/07/81	C0201
Light Plant - Alternator - Generator	42518	C1	02/04/60	06/30/71	C1101

48462-1 Cont.	REV. Q	MODEL 3000W, 3600, 3900, 3900T, 3900W, 4000W
---------------	--------	--

CONTROL CONSOLE

REF. NO.	PART NUMBER	QUANTITY REQUIRED	DESCRIPTION OF PART	VENDORS PART NO.
41	715511	1	VALVE, Hydraulic Winch Control	
42	139244	1	HANDLE, Valve	
43	714440	1	KNOB, Handle	
44	715506	1	VALVE, Front or Right Front Drum Control	
44	182873		VALVE, Right or Right Front Drum Control (Lift Combination Mach. W/out Manual Converter Control) (See Note 5)	
44	183210		VALVE, Right or Right Front Drum Control (Straight Lift W/out Manual Converter Control) (See Note 5)	
44	180848		VALVE, Right or Right Front Drum Control (Vicon W/Out Manual Converter Control) (Superseded by #182873 or 183210)	
45	137496	1	HANDLE, Valve	
46	500812	1	KNOB, Handle	
47	714491	1	VALVE, Left Front or Rear Drum Control (See Note 3)	
47	182873		VALVE, Left Front or Rear Drum Control (Lift Combination W/Out Manual Converter Control) (See Note 5)	
47	183210		VALVE, Left Front or Rear Drum Control (Straight Lift W/Out Manual Converter Control) (See Note 5)	
47	180848		VALVE, Left Front or Rear Drum Control (Vicon W/Out Manual Converter Control) (Superseded by #182873 or 183210)	
48	714491	1	VALVE, Ind. Boom Hoist Control (M3000W, 3600, 3900, 4000W Vicon)	
48	714420	1	VALVE, Ind. Boom Hoist Control (All Non-Vicon and M3900T, 3900W Vicon) (See Note 4 - M3900W W/Hyd. Boom Hoist)	
49	76833	1	BRACKET, Quick Release Valve W/capscrews, hex nuts and lockwashers (Vicon)	
50	714688	as req	VALVE, Quick Release	
51	92398	1	MANIFOLD, Valve Standard	
52	93626	1	NAMEPLATE W/capscrews (M3000W, 3600)	
52	93822	1	NAMEPLATE W/capscrews (M3900, 3900T, 3900W, 4000W)	
53	139241	1	SPACER (M3000W, 3600, 3900, 3900W, 4000W)	
53a	139242	1	BRACKET (M3900T only)	
54	136217	1	BRACKET, Stand Right	
55	139243	1	SPACER W/capscrews (M3900T only)	
56	136218	1	BRACKET, Stand Left	
57	70188	1	HOSE, Flex (9'4" - 2.845 m long)	
58	15054	2	HOSE, Flex (3'4" - 1.016 m long)	
59	472025	2	GROMMET, Rubber	
60	679106	1	TEE (3/4" x 1/2" x 1/2")	
61	288834	1	BUSHING (1/2" x 1/2")	
62	673356	1	SWITCH, Pressure (See Note 2)	
63	543185	2	NIPPLE (3/4" x 2")	
64	511111	1	INJECTOR, Alcohol (Optional)	
65	543185	1	NIPPLE (3/4" x 2") (W/Alcohol Injector Only)	
66	427130	1	FILTER, Air (See Note 2)	
67	406873	1	ELBOW, 90° Reducing (3/4" x 1/2")	
69	79017	1	BRACKET W/capscrews, hex nuts and lockwashers (W/Filter Only)	
68	667227	2	STRAP, Pipe	
70	73366	1	BRACKET W/capscrews, hex nuts and lockwashers (W/Filter and Alcohol Injector)	
71	73368	1	CLAMP W/capscrews, hex nuts and lockwashers (W/Filter and Alcohol Injector)	

REV. Q	48462-1 Cont.
--------	---------------

PLEASE GIVE MACHINE S/N W/ORDER

MANIFOLD

TOTAL 50

TOTAL 71

PARTS MANUAL ALPHABETICAL INDEX
Group D - Power Components

DESCRIPTION	PUBLICATION	REV	START DATE	END DATE	GROUP
Battery Boxes	48960	A1	08/28/70	08/22/74	D0104
Converter Control	32600	F1	02/23/62	07/19/77	D0601
Converter Control	42958	F1	11/12/62	11/29/78	D0601
Converter Piping	48648	D1	02/26/69	08/12/80	D0701
Converter Piping	48648	G2	02/26/69	08/12/80	D0701
Converter Piping	48648	A3	02/26/69	08/12/80	D0701
Converter Piping	48648	E4	02/26/69	08/12/80	D0701
Converter Piping	48648	D5	02/26/69	08/12/80	D0701
Engine & Clutch Control	32498	D1	08/18/69	12/15/72	D0501
Exhaust Stack	92299	B1	06/20/68	07/17/75	D0102
Instrument Panel/Engine	49301	C1	11/17/70	04/04/74	D0301
Power Plant	48016	B1	02/14/67	04/29/76	D0101
Power Take Off - Transmission Case	180623	G1	11/12/68	12/17/84	D0401
Power Take Off - Transmission Case	42749	P1	07/14/62	04/25/94	D0401

MASTER

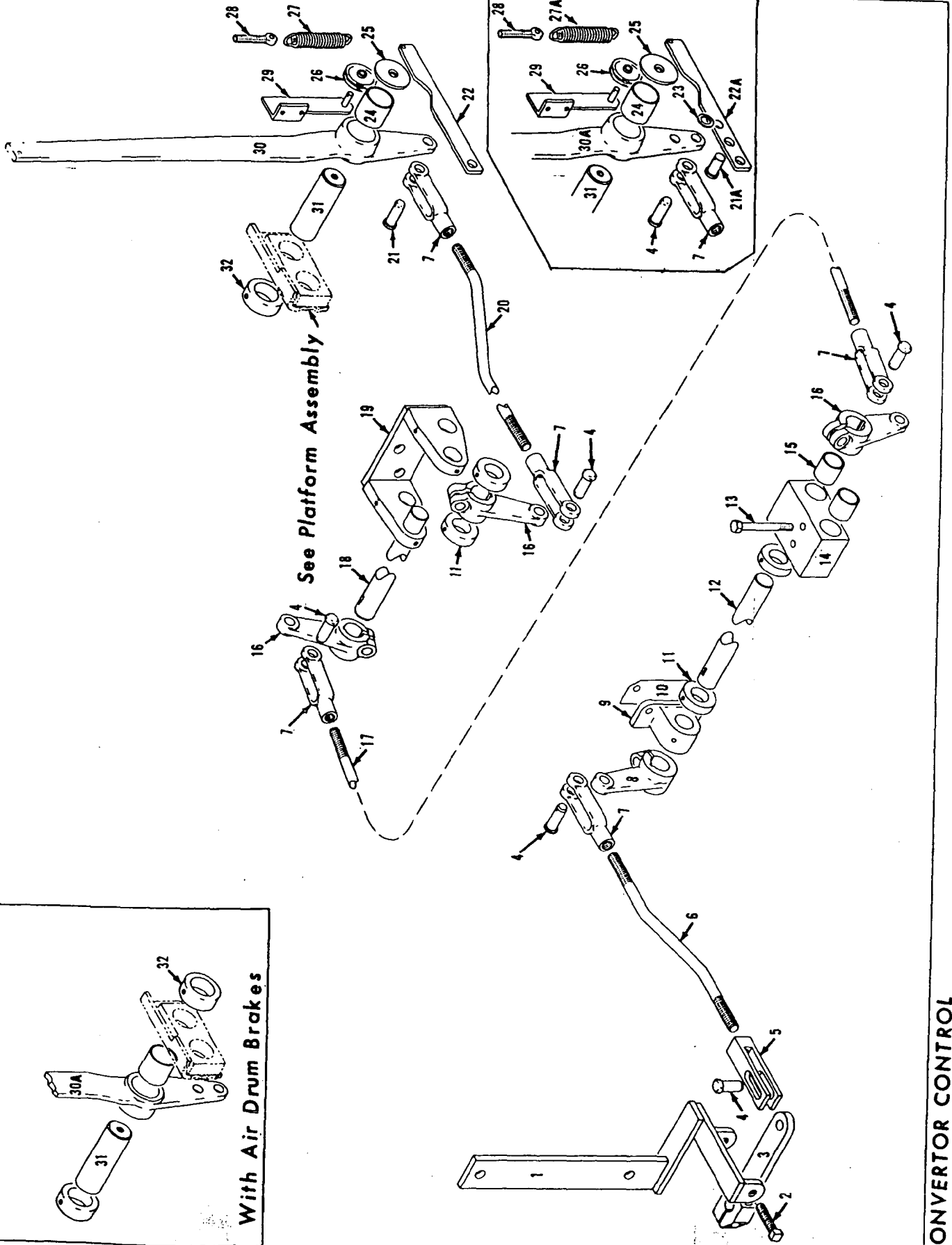

See Platform Assembly

With Air Drum Brakes

MATERIAL LIST ON BACK

CONVERTOR CONTROL

42958C1

MANITOWOC ENGINEERING CO.

A Division of The Manitowoc Company, Inc.

Manitowoc, Wisconsin

MASTER

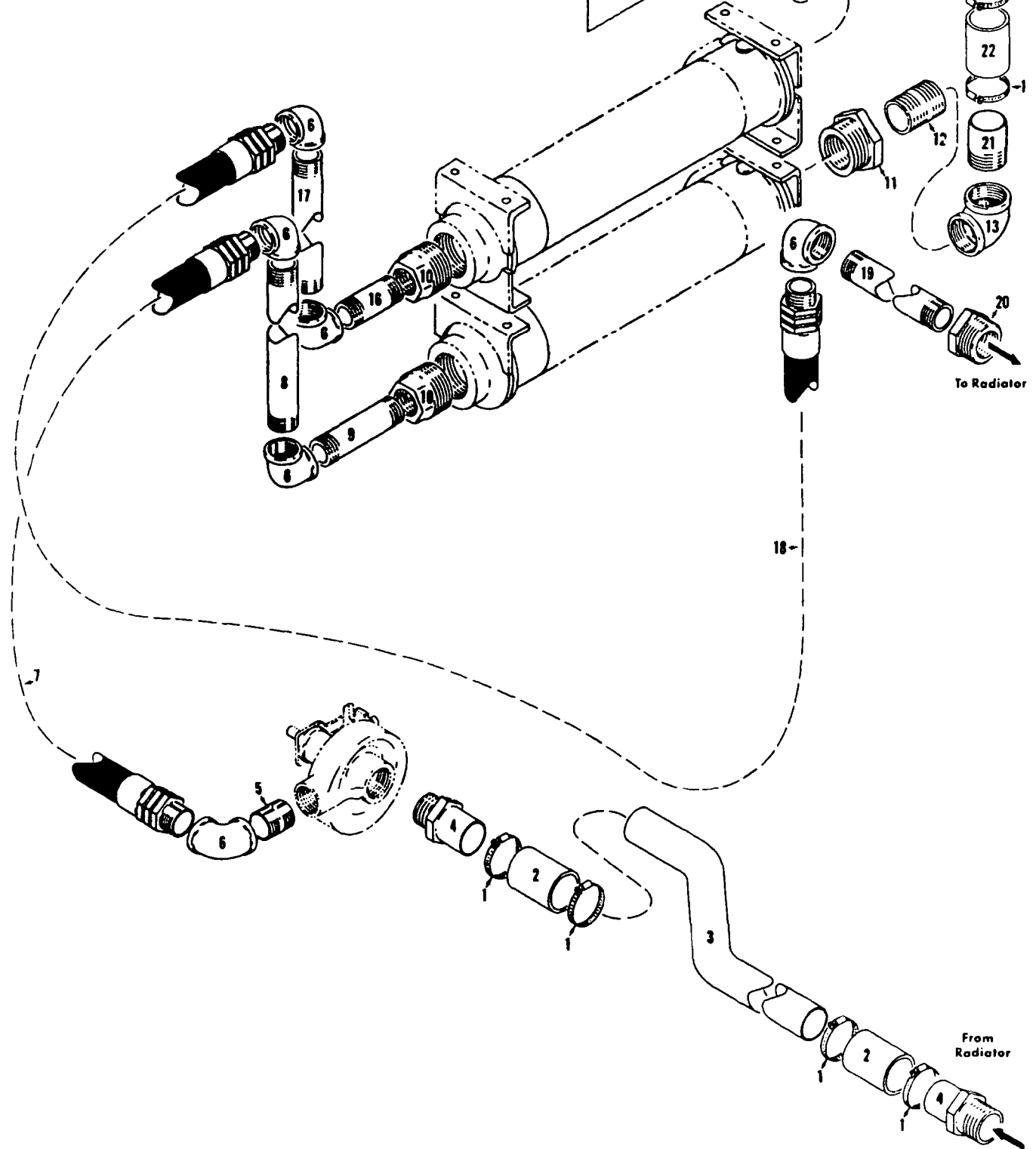
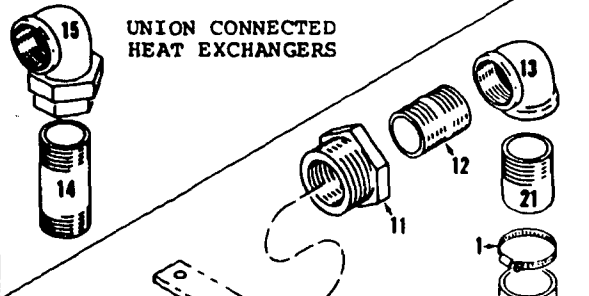

486-48D2

MATERIAL LIST ON BACK

HEAT EXCHANGER COOLING

CLICK HERE TO **DOWNLOAD** THE COMPLETE MANUAL

- Thank you very much for reading the preview of the manual.
- You can download the complete manual from: www.heydownloads.com by clicking the link below



- Please note: If there is no response to CLICKING the link, please download this PDF first and then click on it.

CLICK HERE TO **DOWNLOAD** THE COMPLETE MANUAL

MANITOWOC ENGINEERING CO.

A Division of The Manitowoc Company, Inc.

Manitowoc, Wisconsin

MASTER

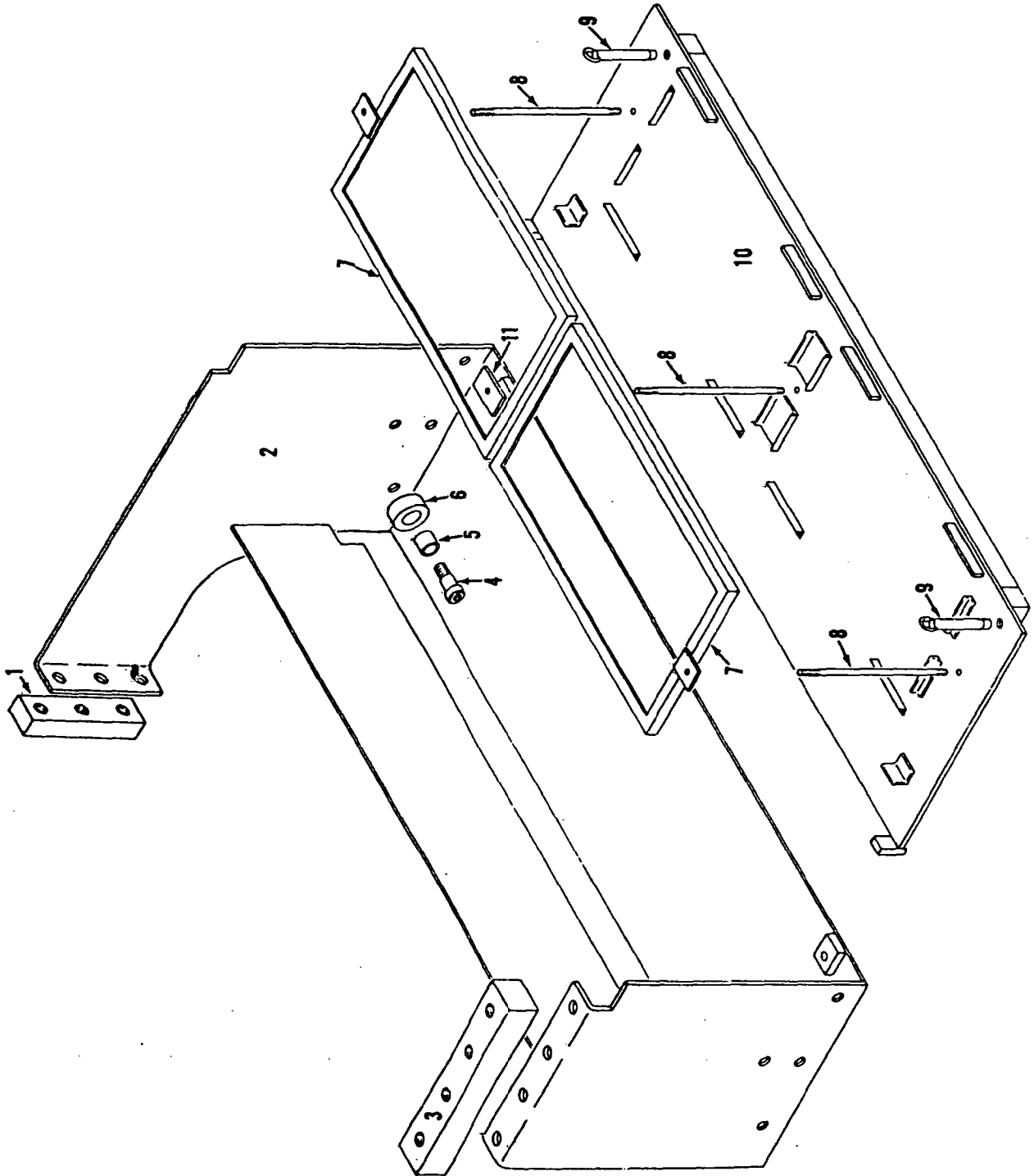

48960A1

MATERIAL LIST ON BACK

BATTERY BOX

PARTS MANUAL ALPHABETICAL INDEX
Group E - Lower Structure & Control

DESCRIPTION	PUBLICATION	REV	START DATE	END DATE	GROUP
Carbody	43369	J1	09/21/64	02/07/85	E0101
Carbody Lubrication Piping	32233	B1	08/07/59	08/03/83	E0102
Crawler Lubrication Piping	180239	E1	03/25/68	12/14/84	E0202
Crawler Lubrication Piping	180239	C2	03/25/68	04/25/85	E0202
Crawler Lubrication Piping	180239	-	04/10/85	04/25/85	E0202
Crawlers	43148	Q1	09/18/63	01/13/86	E0201
Horizontal Travel Shaft	32907	B1	09/04/63	02/14/84	E0401
King Pin & Vertical Travel Shaft	33098	E1	08/21/64	10/21/81	E0301
Steering Control	20729	A1	05/14/41		E0501
Steering Control	42396	E1	06/15/60	01/24/84	E0501
Steering Control	42396	C2	05/11/59	07/07/81	E0501
Travel Lock Control	31743	I1	08/19/69	07/30/81	E0601

3287 A1

MASTER

MANITOWOC ENGINEERING CO

A Division of The Manitowoc Company Inc.

Manitowoc, Wisconsin

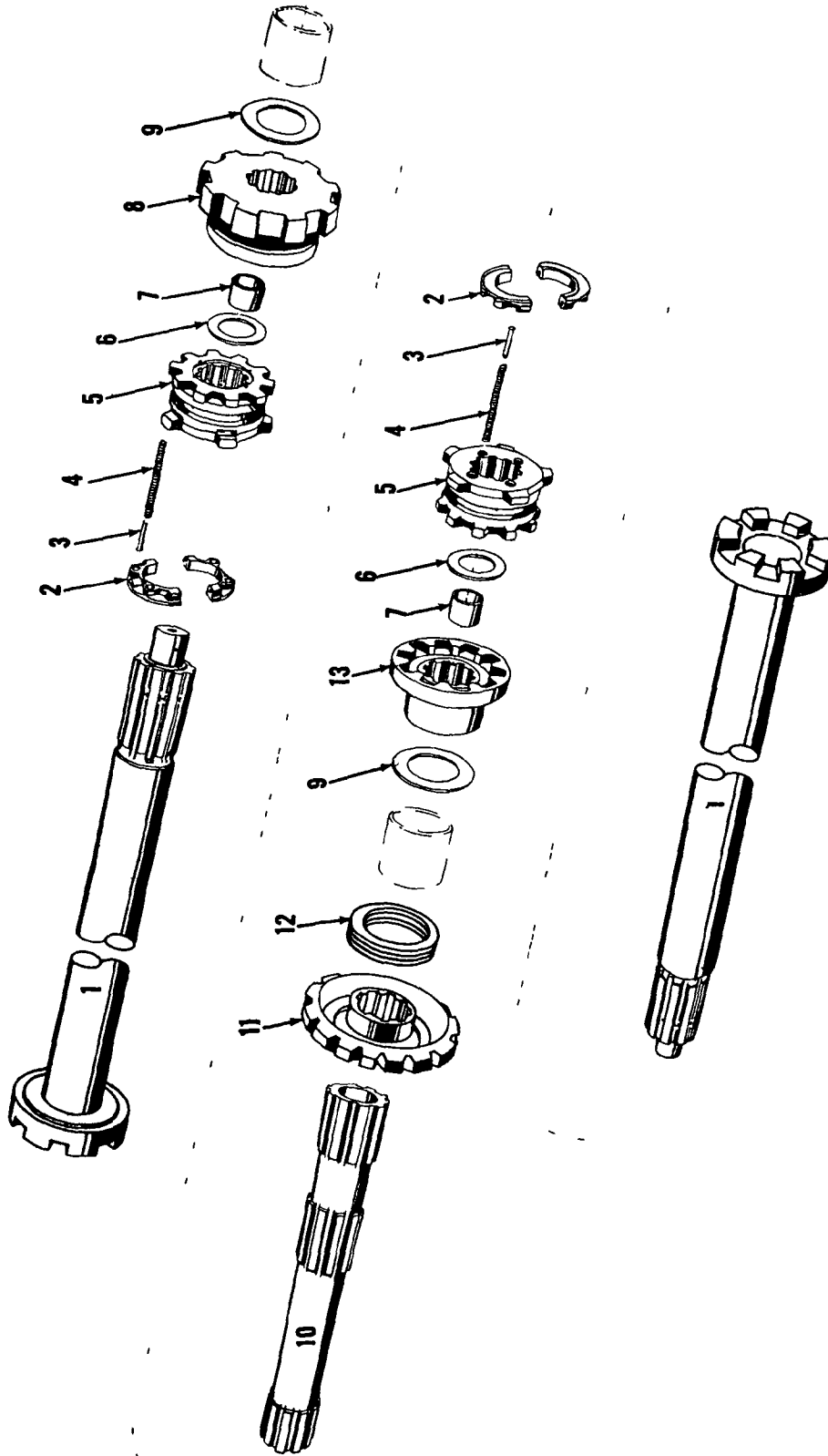

32907A1

MATERIAL LIST ON BACK

HORIZONTAL TRAVEL SHAFT

MASTER

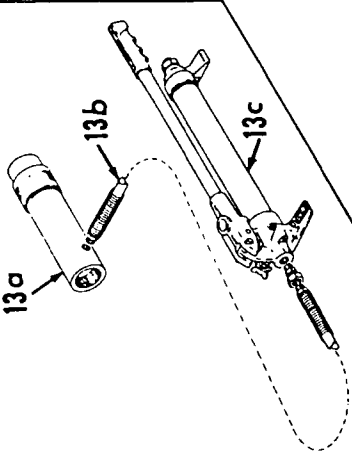
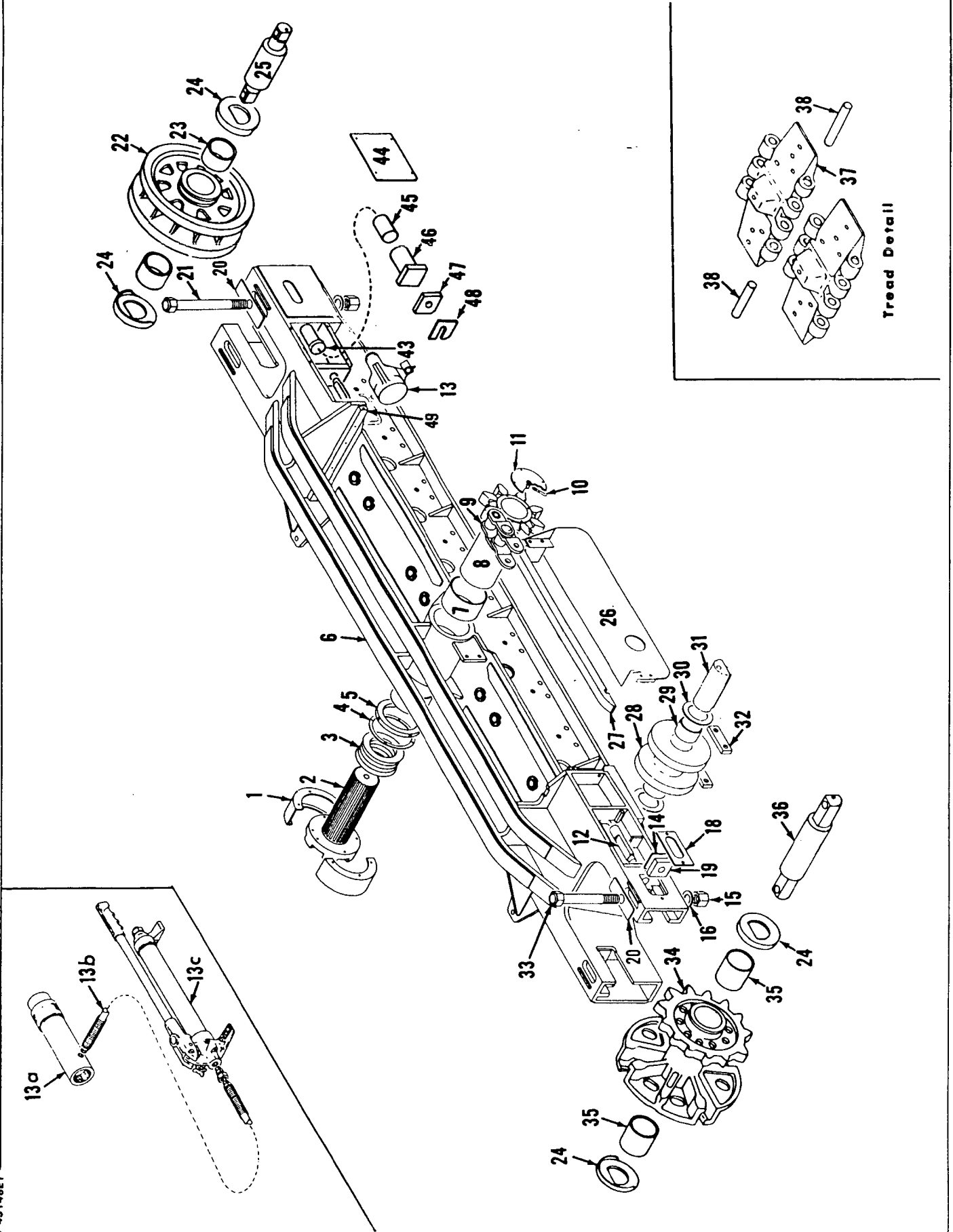

43148E1

MATERIAL LIST ON BACK

CRAWLERS

MANITOWOC ENGINEERING CO.

A Division of The Manitowoc Company, Inc.

Manitowoc, Wisconsin

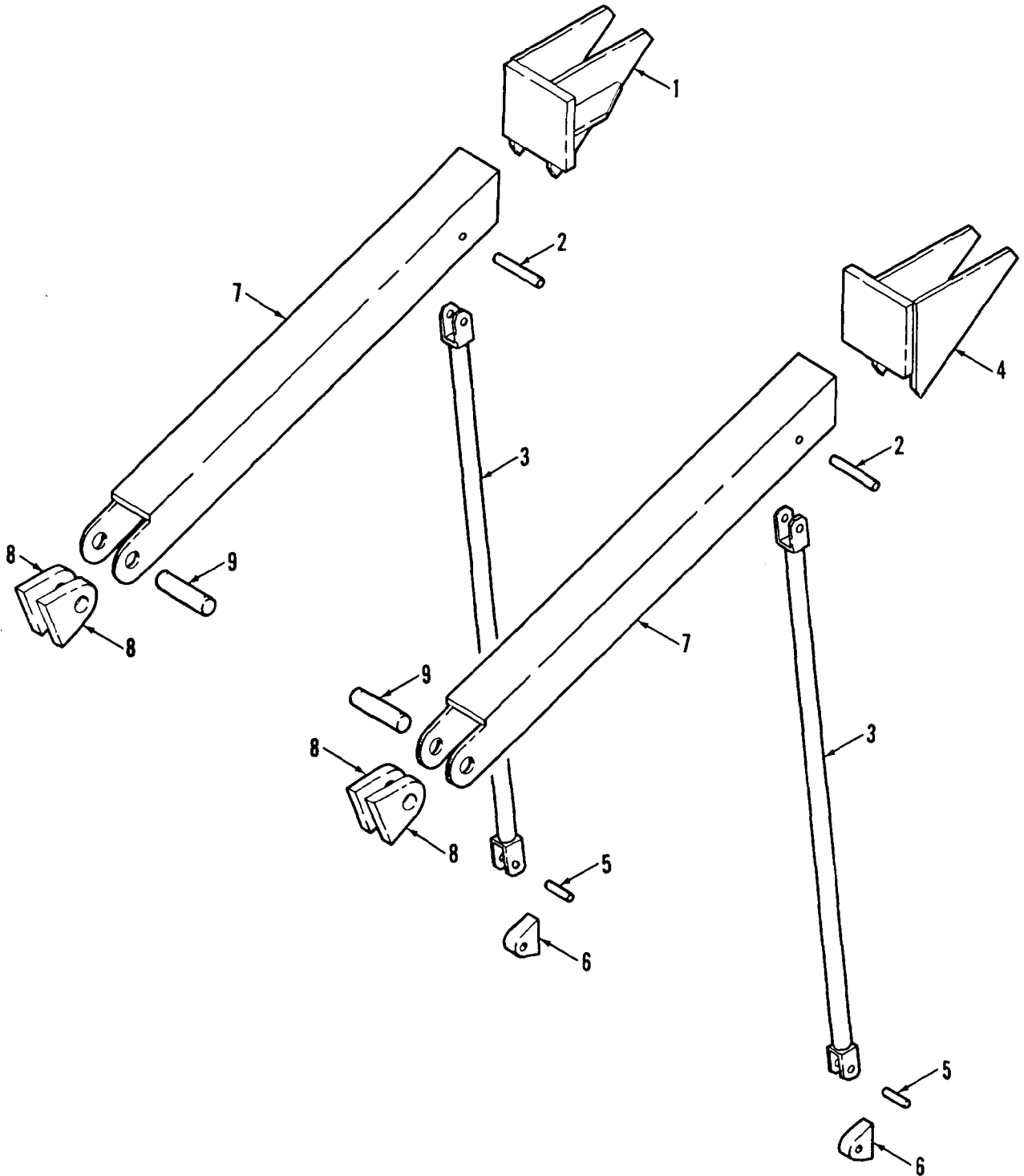

33017-A1

32275A1

MATERIAL LIST ON BACK

Boom Stop

48227

REQ'D FOR VARIOUS BOOM LENGTHS

DRWG. NO. & BOOM LENGTH	32692-2 10'-FT. INSERT	32693-2 20'-FT. INSERT	181169-2 30'-FT. INSERT	181169-3 35'-FT. INSERT W/10 BACK STN	277008 10'-FT. PENDANTS	277009 20'-FT. PENDANTS	277010 30'-FT. PENDANTS	73833 WIRE ROPE ROLLER GUIDE ASS'Y	33814 ADJ. SPREADER SEE DIM.	79332 SPREADER BRACKET	79336 PIN
70	1	0	0	0	2	0	0	0	0	0	0
80	0	1	0	0	0	2	0	1	1	2	2
90	0	0	1	0	0	0	2	1	1	2	2
100	1	0	1	0	2	0	2	1	1	2	2
110	0	1	1	0	0	2	2	2	1	2	2
120	0	0	1	1	0	0	4	2	1	2	2
130	1	0	1	1	2	0	4	2	1	2	2
140	0	1	1	1	0	2	4	3	1	2	2
150	0	0	2	1	0	0	6	3	1	2	2
160	1	0	2	1	2	0	6	3	1	2	2
170	0	1	2	1	0	2	6	4	1	2	2
180	1	1	2	1	2	2	6	4	1	2	2
190	1	0	3	1	2	0	8	4	1	2	2
200	0	1	3	1	0	2	8	4	1	2	2
210	1	1	3	1	2	2	8	4	1	2	2
220	1	0	4	1	2	0	10	4	1	2	2

181169-2 WITHOUT LUGS
 181169-3 WITH 24958 PENDANT ATTACH LUGS

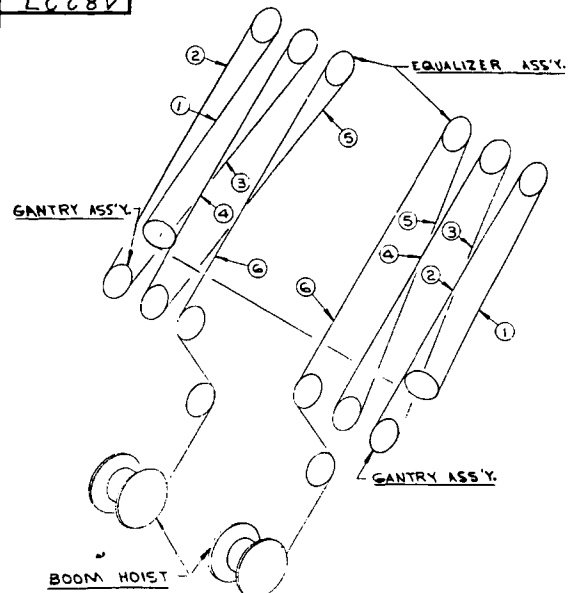

BOOM HOIST REEVING DIAGRAM
 BOOM HOIST LINE - 12 PART
 650 FT - 7/8" - 6 x 26 WARRINGTON-SCALE EXTRA
 IMPROVED PLOW STEEL I.W.R.C. (719035)

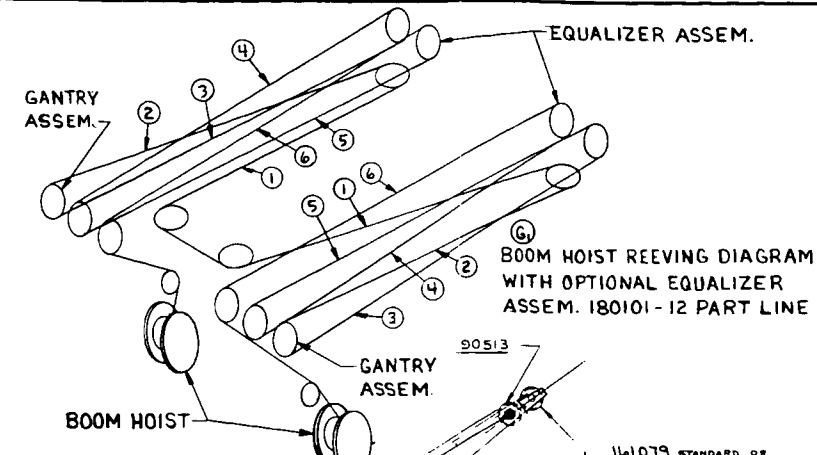

BOOM HOIST REEVING DIAGRAM
 WITH OPTIONAL EQUALIZER
 ASSEM. 180101-12 PART LINE

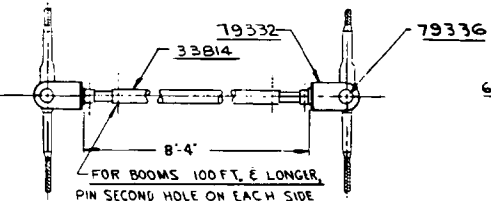
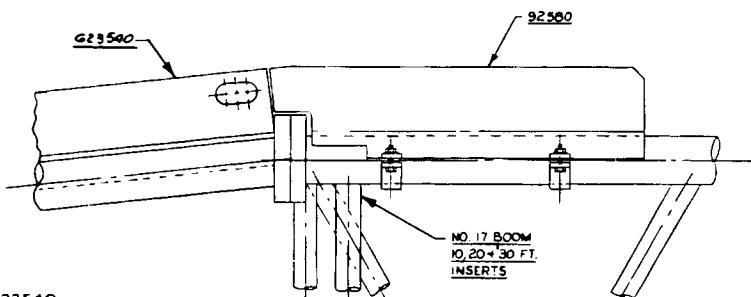

FOR BOOMS 100 FT. & LONGER,
 PIN SECOND HOLE ON EACH SIDE

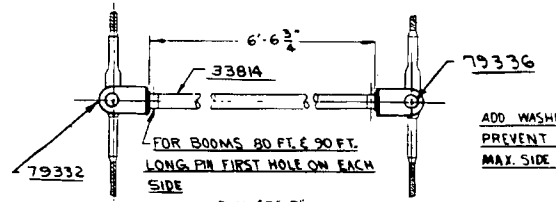

FOR BOOMS 80 FT. & 90 FT.
 LONG, PIN FIRST HOLE ON EACH
 SIDE

ADD WASHERS EACH SIDE TO
 PREVENT SIDE PLAY IN BOOM.
 MAX. SIDE PLAY ALLOWED 1/8"

SECTION 'A-A'

NOTE: 1
 ADJUSTABLE SPREADER REQUIRED FOR BOOMS 140 FT
 & LONGER WITH GANTRY UP. WITH GANTRY DOWN,
 SPREADER IS REQUIRED FOR BOOMS 80 FT & LONGER

SPREADER LOCATION
 - 36'-2" BACK FROM LOWER BOOM PT.
 ON BOOMS 80 FT. & 90 FT. LONG
 - 66'-2" BACK FROM LOWER BOOM PT.
 ON BOOMS 100 FT. & LONGER

NOTE: 2
 FOR FIELD CONVERSION USE GANTRY ASSEM. 95175

BASIC PARTS

NO. REQ'D	DRWG. NO.	DESCRIPTION
2	22656	BOOM SIGN
1	32866	WIRE ROPE GUIDE
1	33686	WIRE ROPE GUIDE ASS'Y.
1 OR 2	160814	GANTRY ASS'Y. (LIFT-TOWER RINGER)
1	50303	BOOM TOP 34'-0"
1	623540	BOOM BUTT 26'-0" (DRWG. 50347)
2	71236	WASHER
2	77804	PIN
1	161079	UPPER BOOM POINT ASS'Y. (1-SHEAVE, STRAIGHT ROLLER BEARING)
1	90513	LOWER BOOM POINT ASS'Y. (STRAIGHT ROLLER BEARING)
1	181766	EQUALIZER ASS'Y.
2	277007	BASIC PENDANT 36'-2" (DRWG. 140120)
2	92580	REMOVABLE EQUALIZER RAIL

BOOM HANDLING INSTRUCTIONS

ATTACHMENT ARRANGEMENT	GANTRY POSITION	MAX. LG. OF BOOM TO BE HANDLED	BOOM MAKEUP	BOOM CONDITIONS OR LIMITATIONS
FORWARD HOLE IN EQUALIZER PINNED TO RAIL	UP	56 FT.	BUTT & INSERTS	30 FT. MAY BE CANTILEVERED
PENDANTS PINNED TO STRIP (71865) ATTACHED TO LUGS (24958) ON INSERT	UP	146 FT.	BUTT & INSERTS ONLY	2-30FT. INSERTS MAX. CAN BE CANTILEVERED UP TO 146 FT.
PENDANTS ATTACHED TO BOOM POINT	DOWN	120 FT. 30' BOOM WITH 40" x 23 JIB OR 50" JIB	120 BOOM NO JIB	BOOM CARRIED IN HORIZONTAL POSITION
REAR HOLE IN EQUALIZER PINNED TO RAIL				PROVIDES NECESSARY PENDANT SLACK FOR ASSEMBLING AND DISASSEMBLING
FORWARD HOLE IN EQUALIZER PINNED TO RAIL				EQUALIZER WILL NORMALLY LAND AT THIS POSITION WHEN LOWERED ON THE BUTT

OPTIONAL PARTS

1	24003	UPPER BOOM POINT ASS'Y. (2-SHEAVE, STRAIGHT ROLLER BEARING)
1	24166	UPPER BOOM POINT ASS'Y. (2-SHEAVE, TAPERED ROLLER BEARING)
2	74111	PIN REED FOR BOOM HANDLING
2	77865	STRAP SEE PENDANT ATTACHMENT LUG DIAGRAM
1	90210	WIRE ROPE ANCHOR JOINT ASS'Y. (C) REQ'D FOR 2-PART LINE
1	24488	UPPER BOOM POINT ASS'Y. (1-SHEAVE, TAPERED ROLLER BEARING)
1	180101	EQUALIZER (H) (FOR USE ON STRAIGHT OR TAPERED ROLLER BEARINGS)

GANTRY REEVING WITHOUT REAR AUX. DRUM AND BOOM HOIST W/EXTERNAL RATCHET & PAWL

GANTRY REEVING WITH REAR AUX. DRUM AND BOOM HOIST W/EXTERNAL RATCHET & PAWL

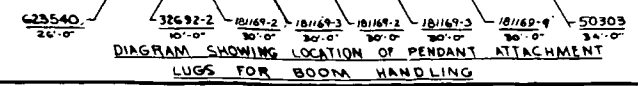

DIAGRAM SHOWING LOCATION OF PENDANT ATTACHMENT LUGS FOR BOOM HANDLING

NOTICE
 THIS PRINT REMAINS THE PROPERTY OF
 MANITOWOC ENGINEERING CO.

ALL INFORMATION CONTAINED THEREON IS CONFIDENTIAL. IT IS LOANED, SUBJECT TO RETURN UPON DEMAND, AND ON EXPRESS CONDITION THAT IT IS NOT TO BE COPIED OR USED DIRECTLY OR INDIRECTLY IN ANY WAY WHATSOEVER DETRIMENTAL TO OUR INTERESTS.

MANITOWOC ENGINEERING CO. 48227

MANITOWOC ENGINEERING CO. BOOM RIGGING ASS'Y. 17 BOOM LIFTCRANE - VERT. SHEAVE GANT. 12 PART BOOM HOIST 4000-W

REVISIONS

NO.	DATE	DESCRIPTION
1	7-13-66	ADD
2	8-14-66	ADD
3	8-14-66	ADD
4	8-14-66	ADD
5	8-14-66	ADD
6	8-14-66	ADD
7	8-14-66	ADD
8	8-14-66	ADD
9	8-14-66	ADD
10	8-14-66	ADD
11	8-14-66	ADD
12	8-14-66	ADD
13	8-14-66	ADD
14	8-14-66	ADD
15	8-14-66	ADD
16	8-14-66	ADD
17	8-14-66	ADD
18	8-14-66	ADD
19	8-14-66	ADD
20	8-14-66	ADD
21	8-14-66	ADD
22	8-14-66	ADD
23	8-14-66	ADD
24	8-14-66	ADD
25	8-14-66	ADD
26	8-14-66	ADD
27	8-14-66	ADD
28	8-14-66	ADD
29	8-14-66	ADD
30	8-14-66	ADD
31	8-14-66	ADD
32	8-14-66	ADD
33	8-14-66	ADD
34	8-14-66	ADD
35	8-14-66	ADD
36	8-14-66	ADD
37	8-14-66	ADD
38	8-14-66	ADD
39	8-14-66	ADD
40	8-14-66	ADD
41	8-14-66	ADD
42	8-14-66	ADD
43	8-14-66	ADD
44	8-14-66	ADD
45	8-14-66	ADD
46	8-14-66	ADD
47	8-14-66	ADD
48	8-14-66	ADD
49	8-14-66	ADD
50	8-14-66	ADD
51	8-14-66	ADD
52	8-14-66	ADD
53	8-14-66	ADD
54	8-14-66	ADD
55	8-14-66	ADD
56	8-14-66	ADD
57	8-14-66	ADD
58	8-14-66	ADD
59	8-14-66	ADD
60	8-14-66	ADD
61	8-14-66	ADD
62	8-14-66	ADD
63	8-14-66	ADD
64	8-14-66	ADD
65	8-14-66	ADD
66	8-14-66	ADD
67	8-14-66	ADD
68	8-14-66	ADD
69	8-14-66	ADD
70	8-14-66	ADD
71	8-14-66	ADD
72	8-14-66	ADD
73	8-14-66	ADD
74	8-14-66	ADD
75	8-14-66	ADD
76	8-14-66	ADD
77	8-14-66	ADD
78	8-14-66	ADD
79	8-14-66	ADD
80	8-14-66	ADD
81	8-14-66	ADD
82	8-14-66	ADD
83	8-14-66	ADD
84	8-14-66	ADD
85	8-14-66	ADD
86	8-14-66	ADD
87	8-14-66	ADD
88	8-14-66	ADD
89	8-14-66	ADD
90	8-14-66	ADD
91	8-14-66	ADD
92	8-14-66	ADD
93	8-14-66	ADD
94	8-14-66	ADD
95	8-14-66	ADD
96	8-14-66	ADD
97	8-14-66	ADD
98	8-14-66	ADD
99	8-14-66	ADD
100	8-14-66	ADD

REVISED DATE: 12-5-67

PATTERN NO. 48227

CODE NO. 48227

MASTER

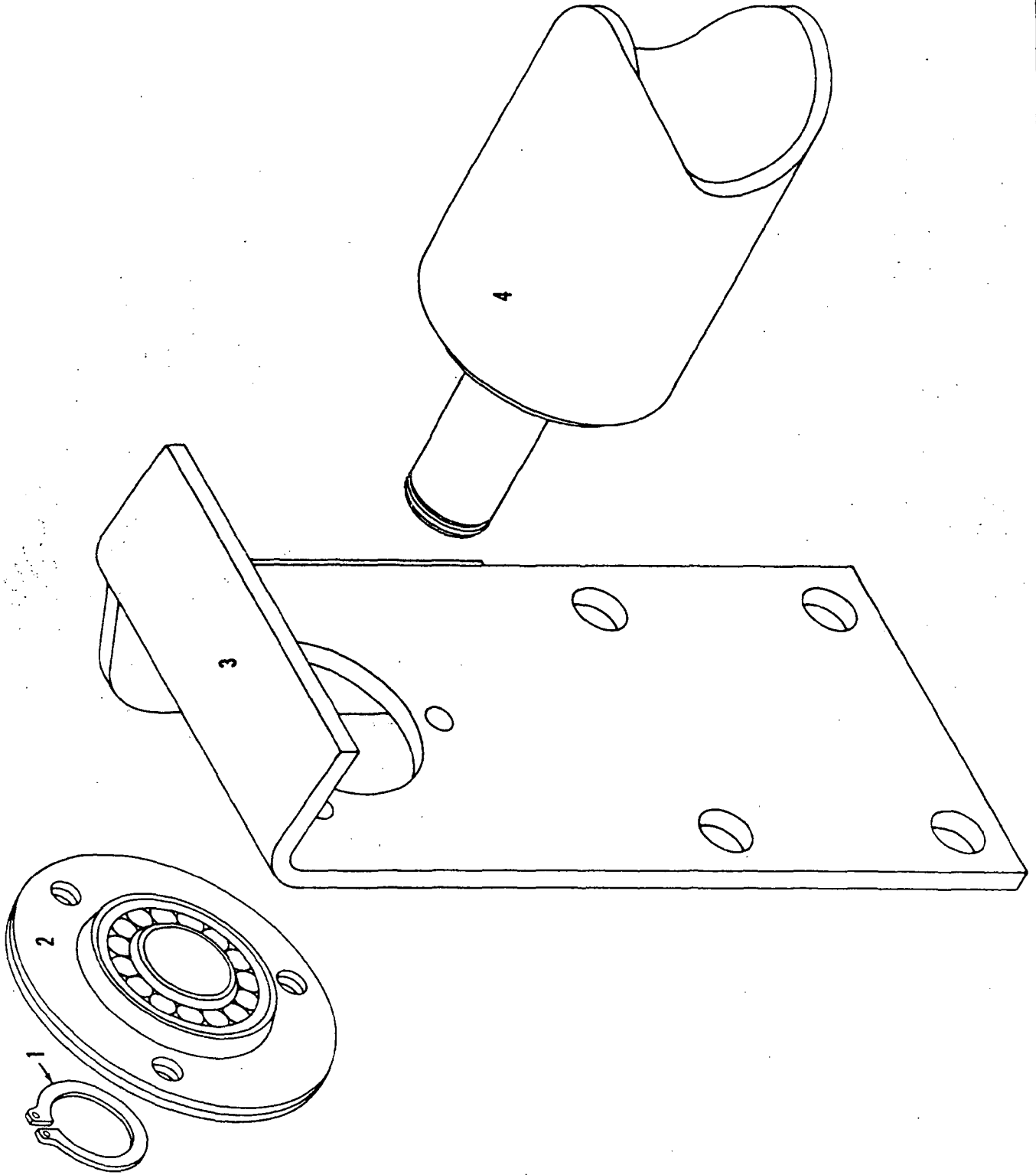

77728A1

MATERIAL LIST ON BACK

CABLE ROLLER GUIDE ASSEMBLY

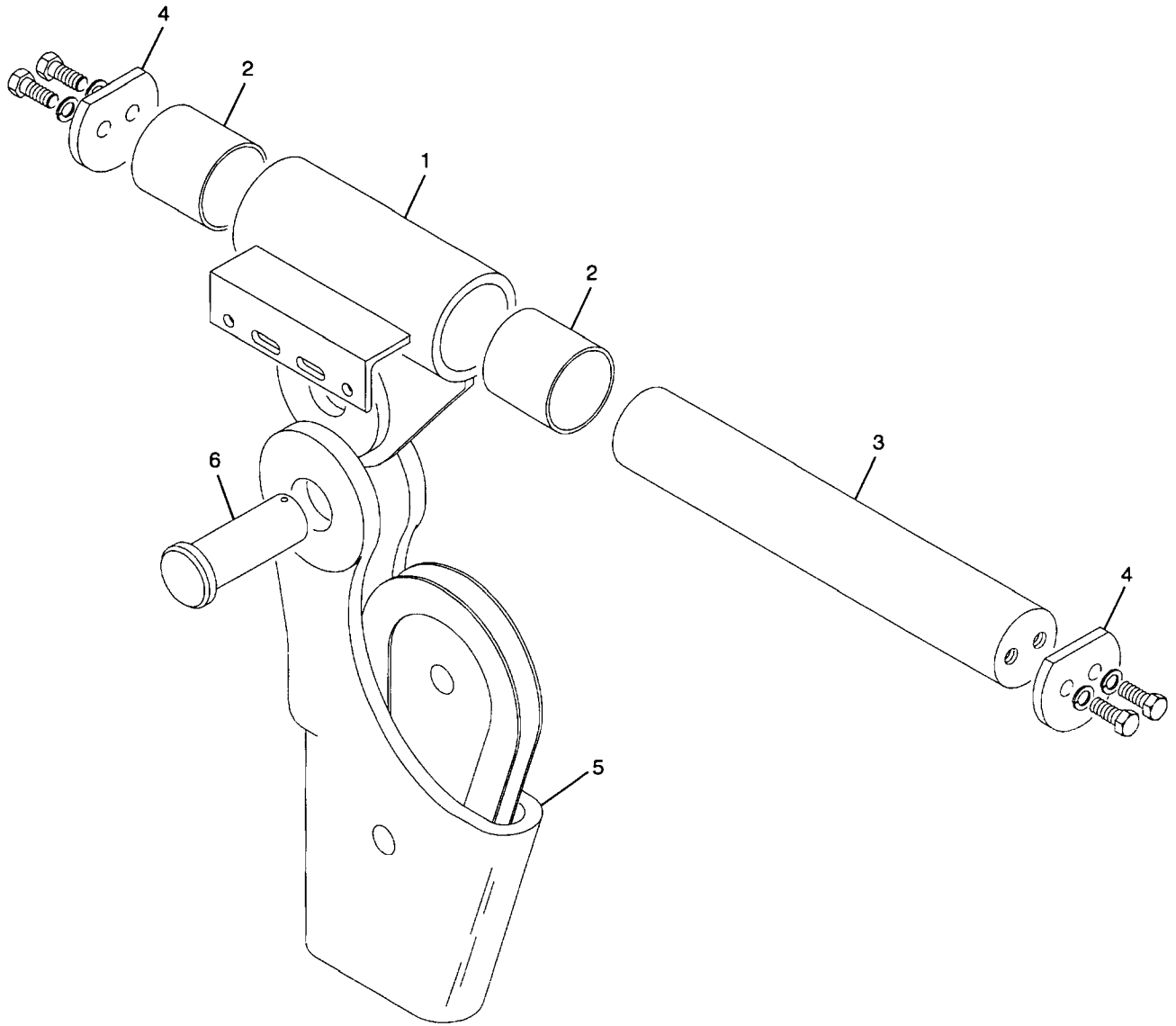

ASSEMBLY	REVISION
90317	A

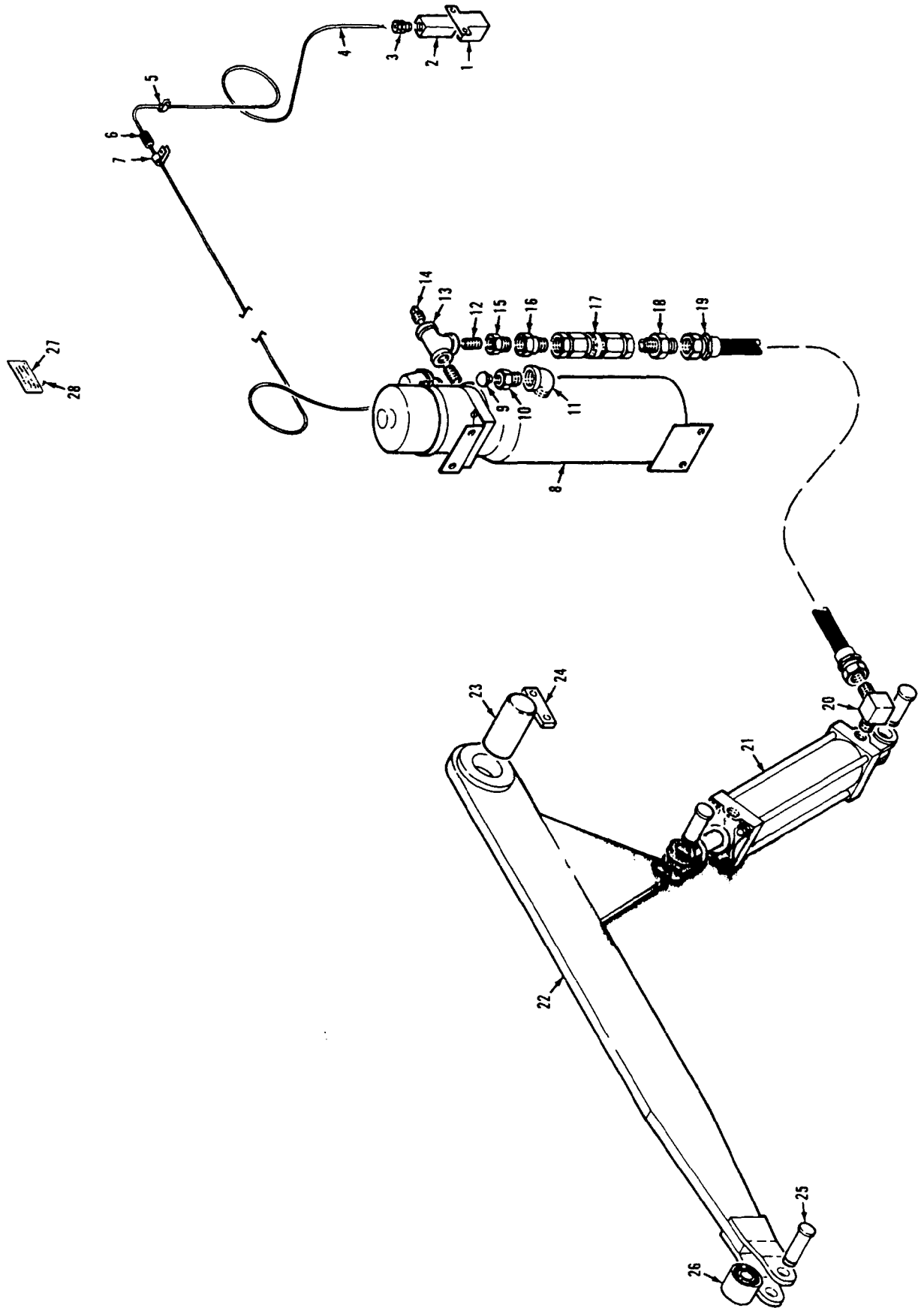

181193B1

MATERIAL LIST ON BACK

GANTRY LIFTING DEVICE

MANITOWOC ENGINEERING CO.

A Division of The Manitowoc Company, Inc.

Manitowoc, Wisconsin

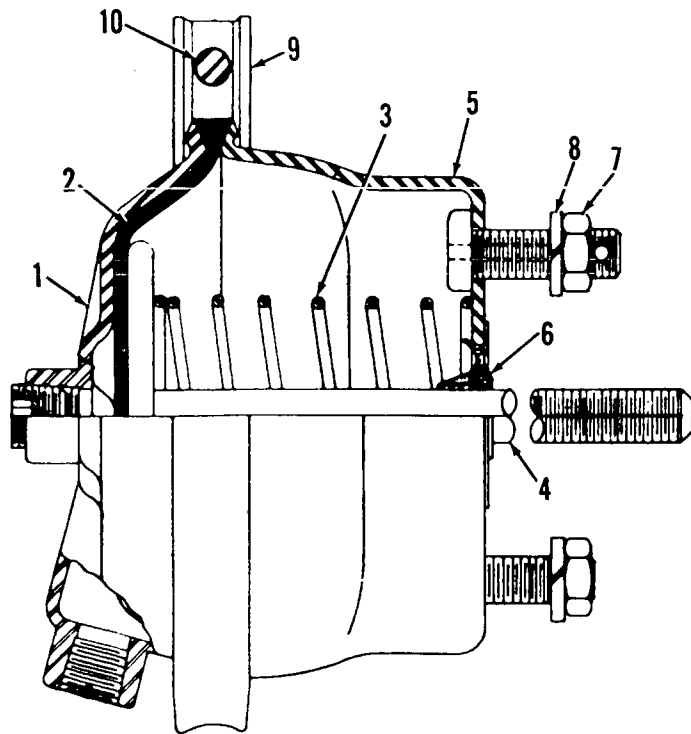
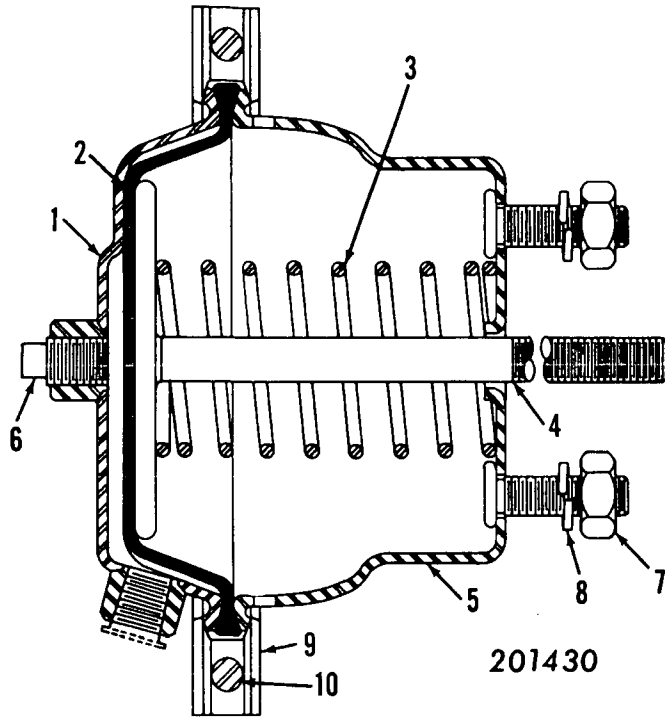

MASTER

0123A1

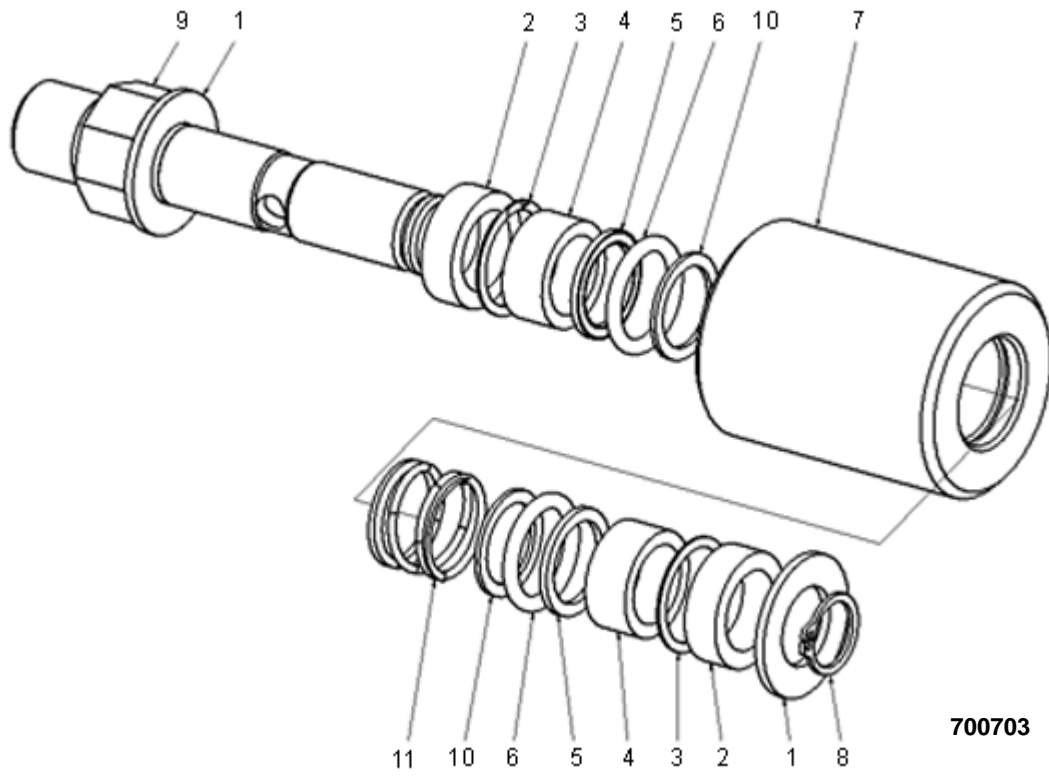

700703

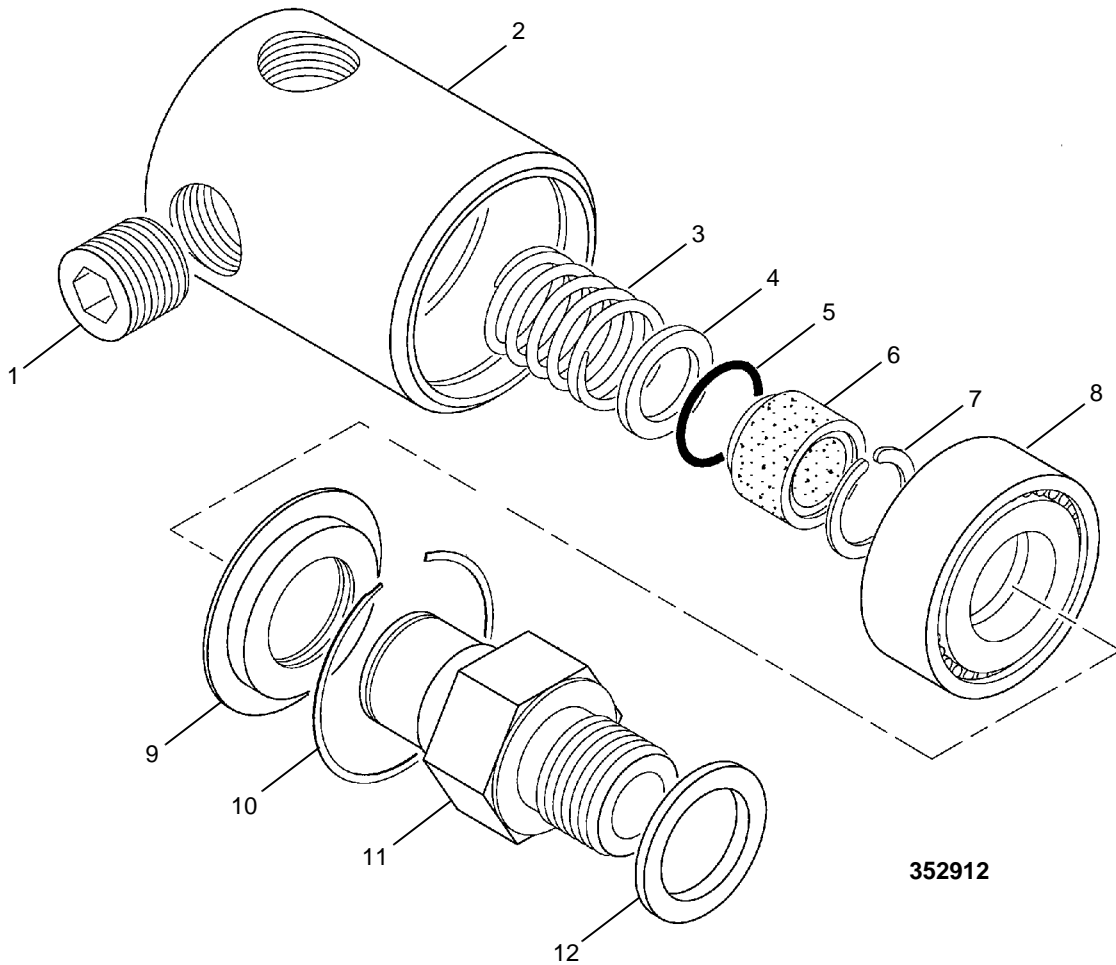

352912

ASSEMBLY	REVISION
O-157	C

MASTER

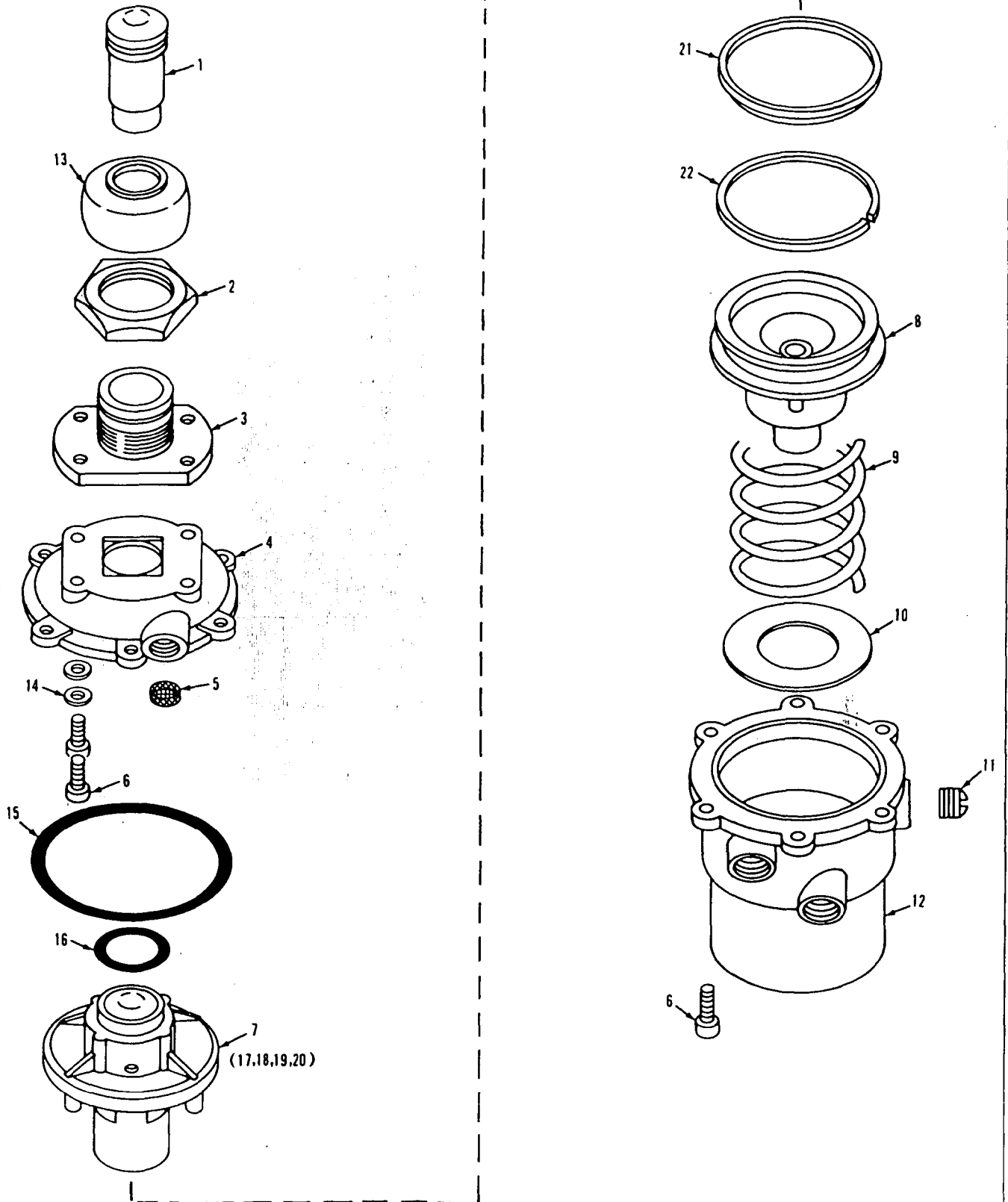

0-247-18

MATERIAL LIST ON BACK

Control Valve

MANITOWOC ENGINEERING CO.

A Division of The Manitowoc Company, Inc.

Manitowoc, Wisconsin

MASTER

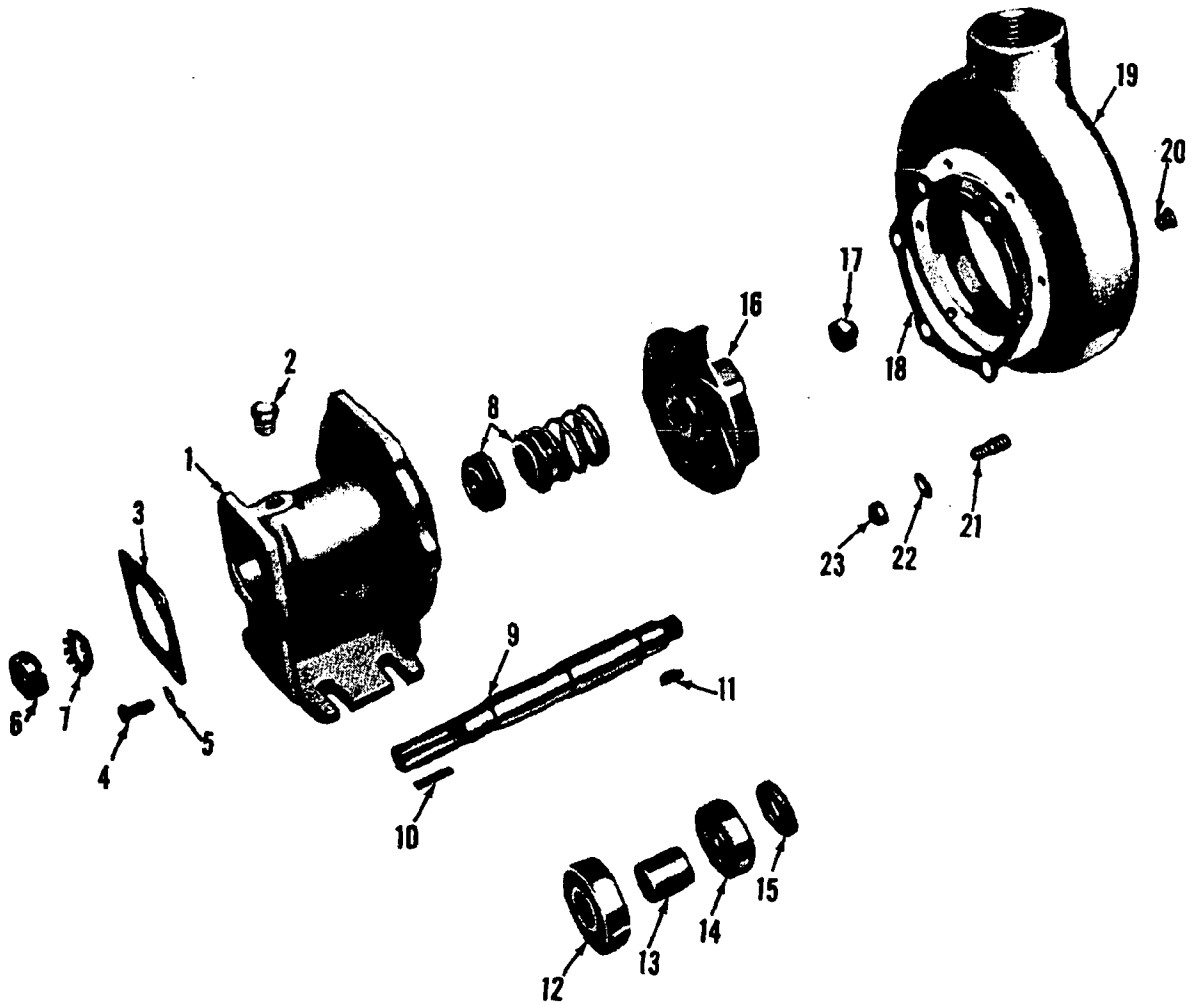

43051A6

MATERIAL LIST ON BACK

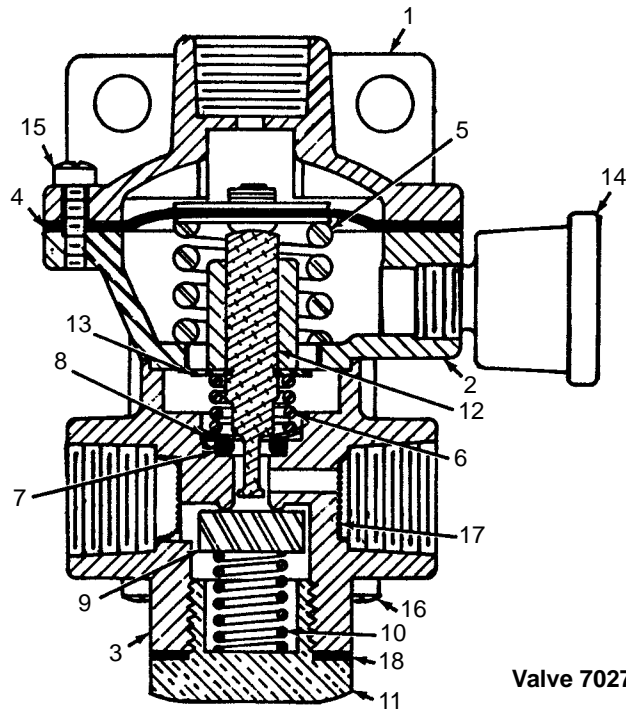

Valve 702755

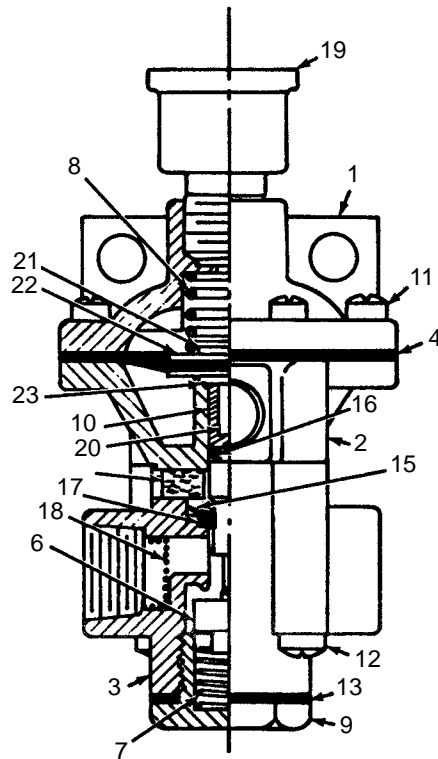

Valve 702756

ASSEMBLY	REVISION
O-294	E

RELAY VALVE

MASTER

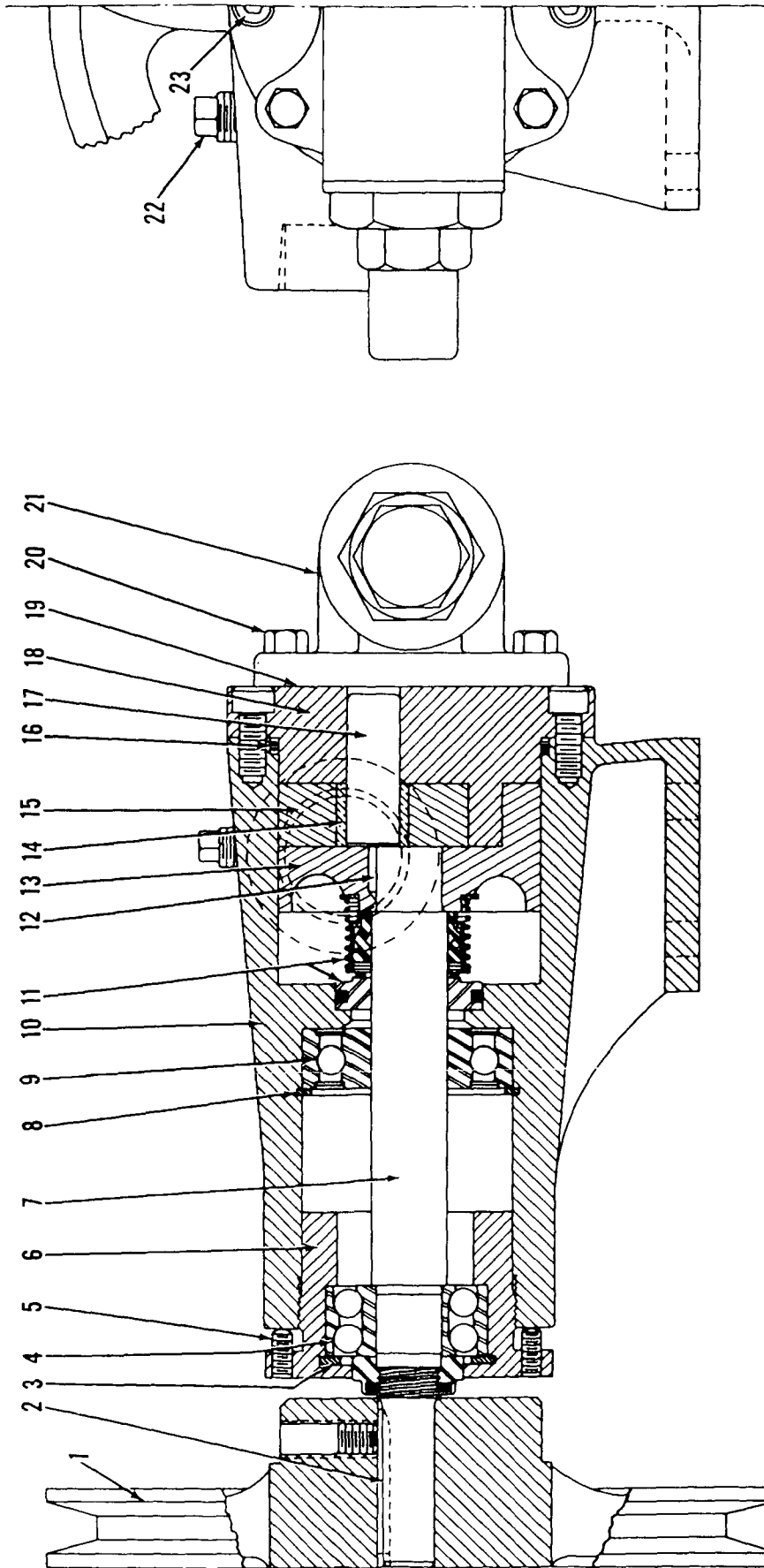

4305187

MATERIAL LIST ON BACK

OIL PUMP

MANITOWOC ENGINEERING CO.

A Division of the Manitowoc Company, Inc.

Manitowoc, Wisconsin

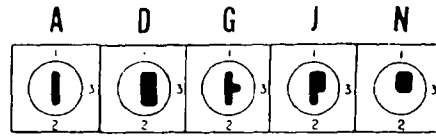
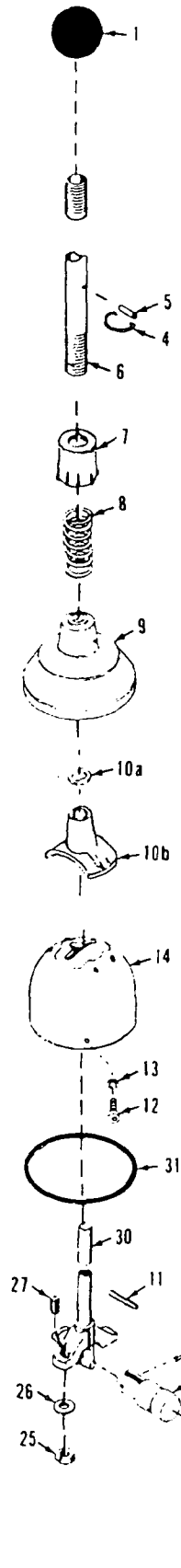

Handle Guide Inserts for Ref. No. 14

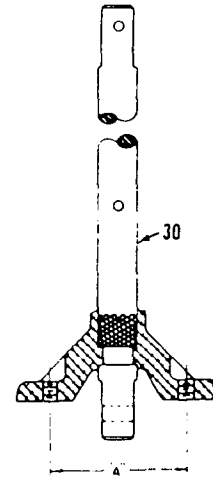

Yoke Spacing
Ref. No. 30

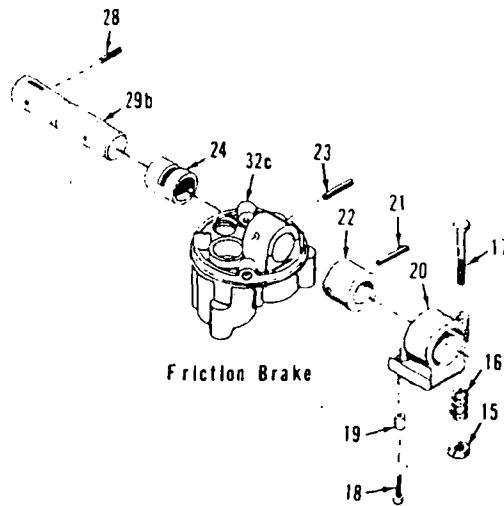

Friction Brake

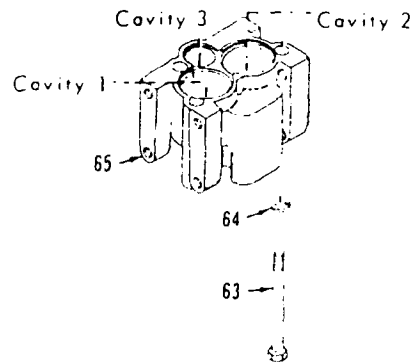

0-441-2B

MATERIAL LIST ON BACK

FLEXAIR VALVE OPERATING MECHANISM

BOOMS #13 AND 17

Opposite Lacings (Black) same unless Noted

26'0" (7.925m) Butt

- 50347
- 50429
- 50479
- 623540

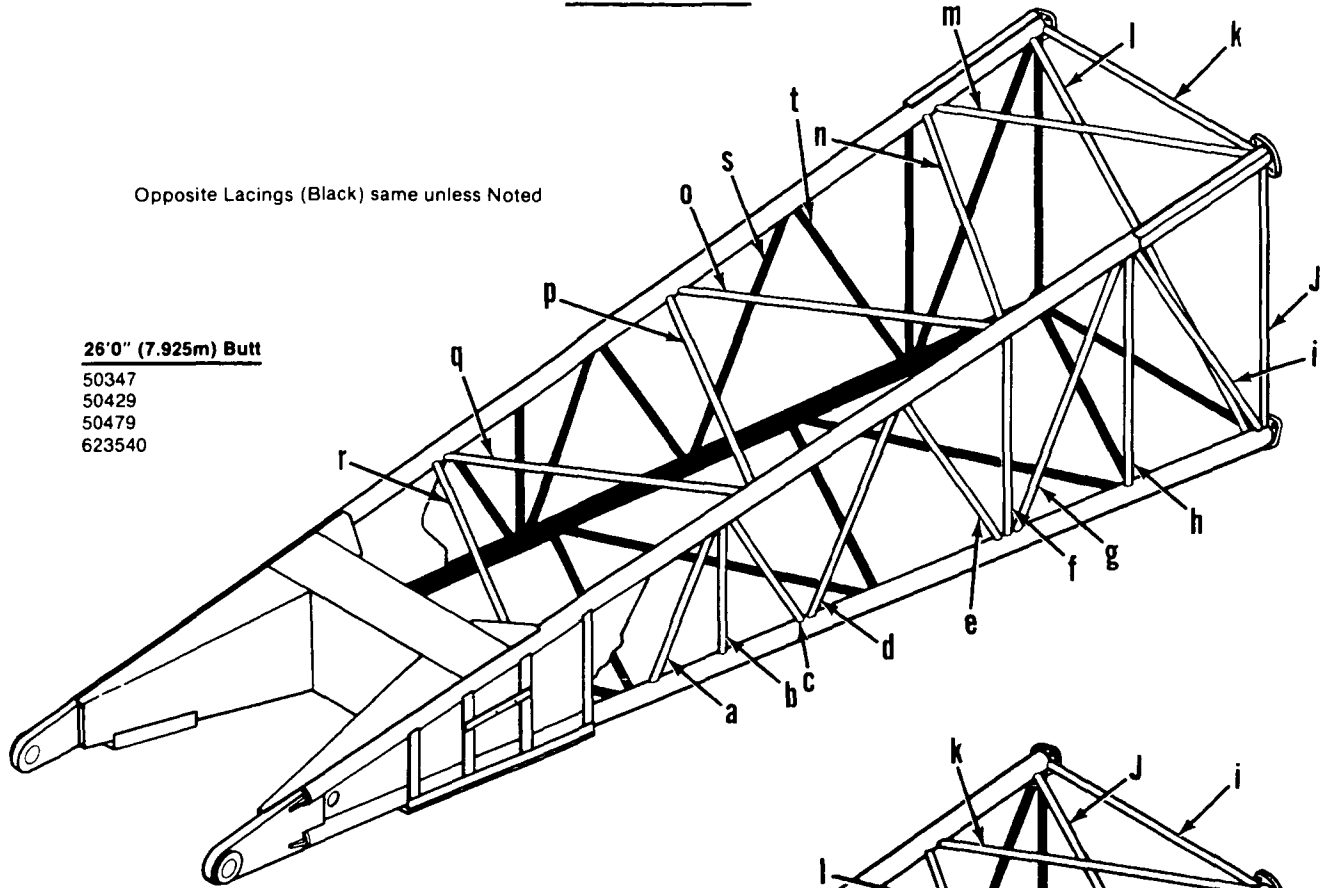

26'0" (7.925m) Butt

- 42453
- 50304

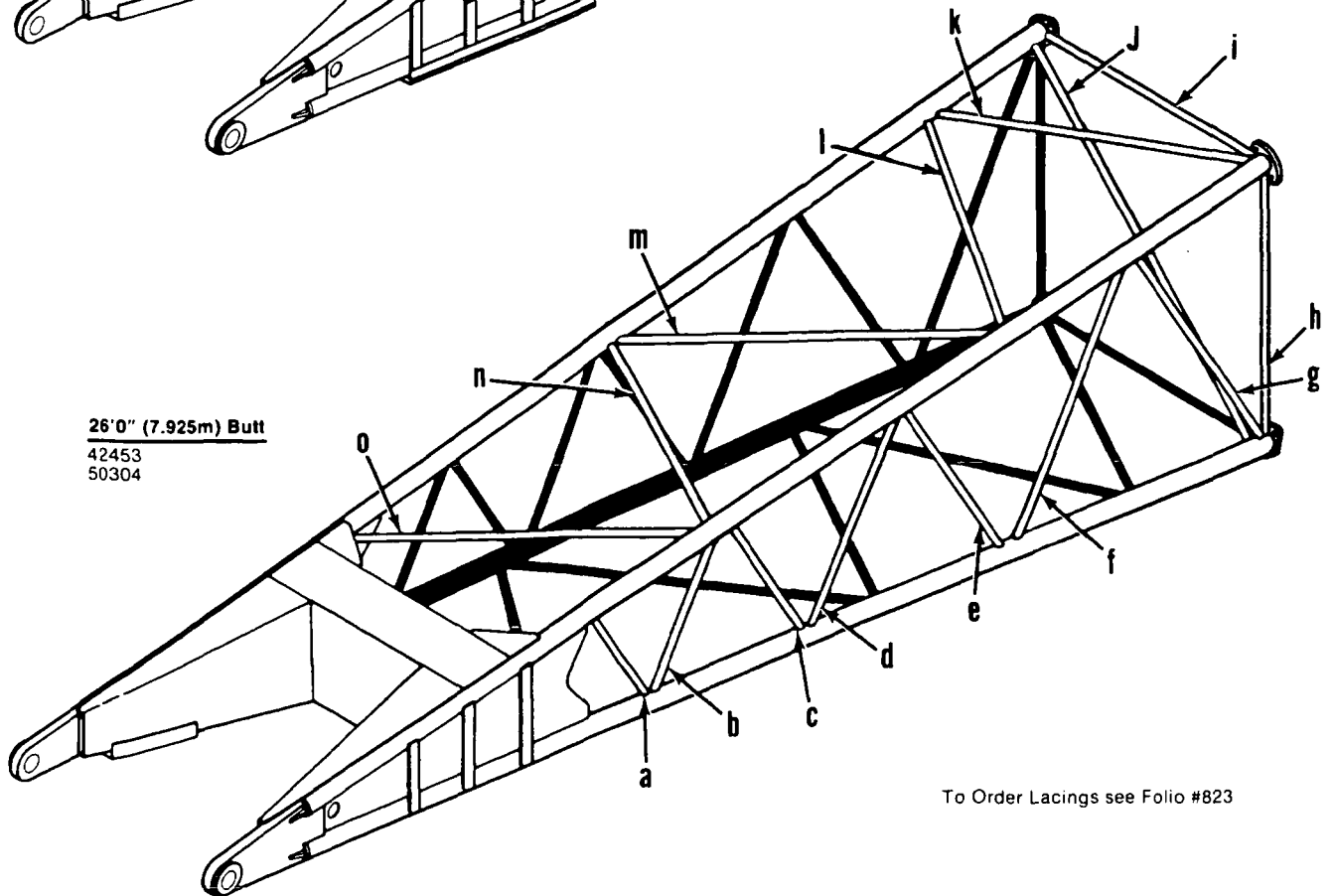

To Order Lacings see Folio #823

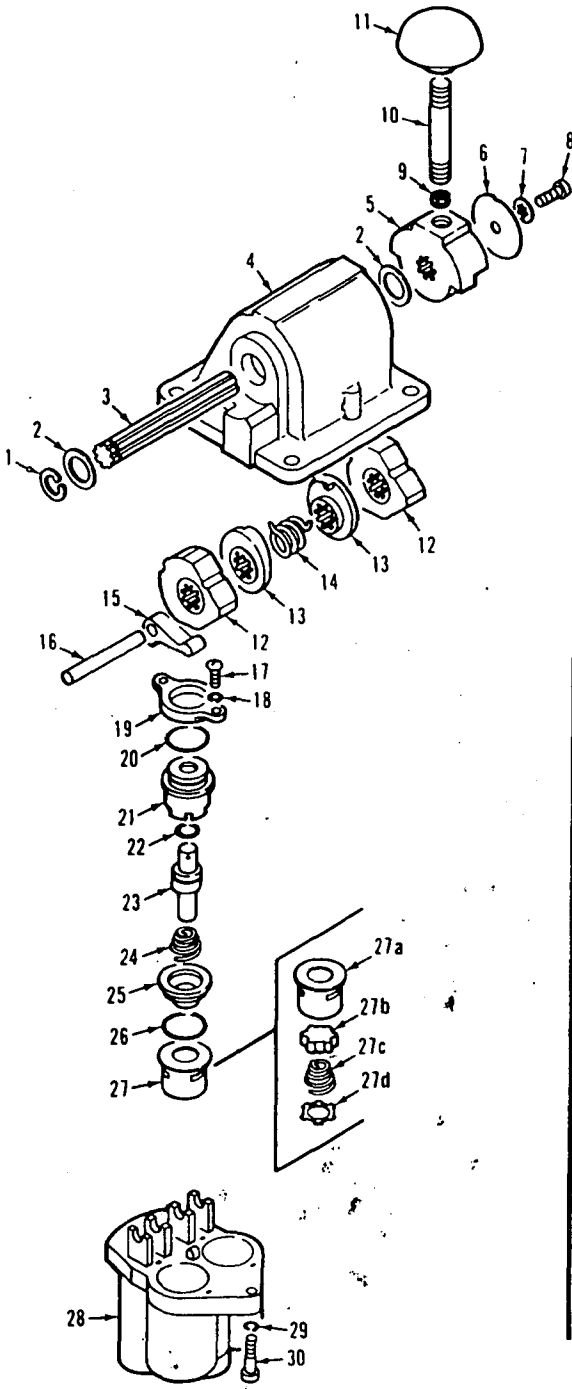

P59339

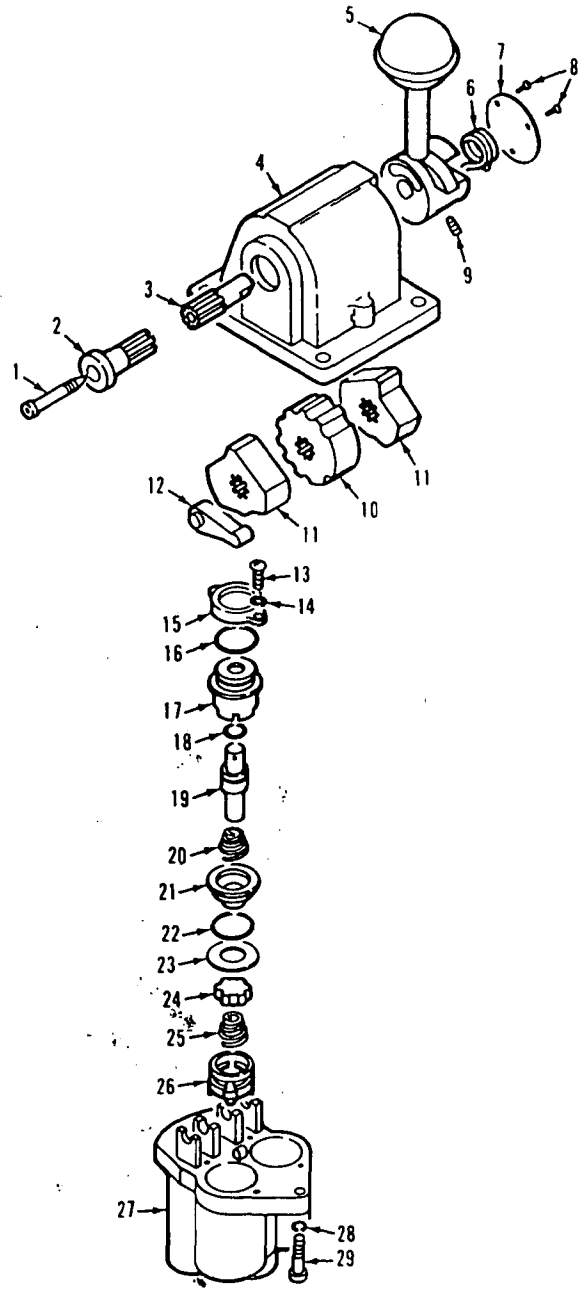

P54425-0310

15-AUX-525A UNLOADER PILOT AND PARTS LIST

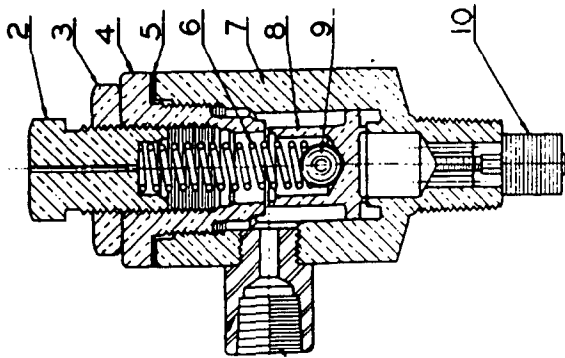

B-37695

Manitowoc #558902

REF. NO.	NAME OF PART	SYMBOL
1	Unloader Outlet Connection	45-AUX-113
2	Adjusting Screw	7-AAB-86
3	Adjusting Nut	AAB-83
4	Unloader Cap	4-AAB-78
5	Unloader Cap Shim	77A133 (10)
6	Unloader Spring	78A236
7	Unloader Body	4-AAB-79
8	Unloader Valve	3-AAB-87
9	Valve Ball	10C4
10	Filter Element	5E2
	Unloader Body Union	64AP4

When ordering repairs give Model Number of Pilot and Symbol of unloader parts desired. (Model Number is stamped on hexagon face near unloader pipe fitting 45-AUX-113.)

5-AUX-525 UNLOADER PILOT AND PARTS LIST

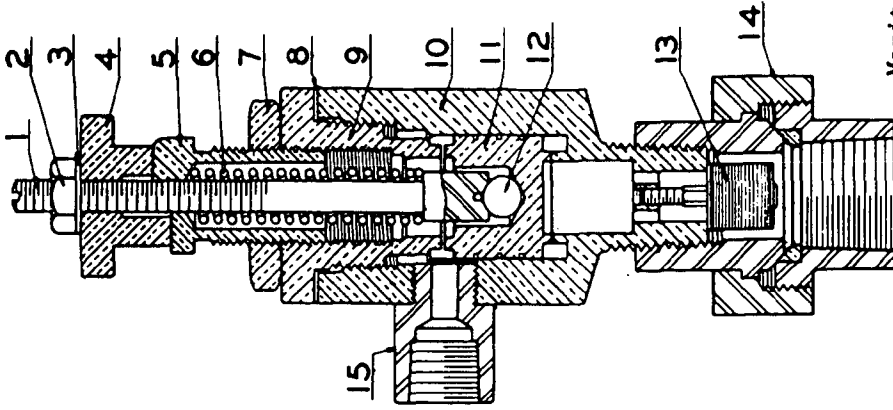

B-37823

Manitowoc #558903

REF. NO.	NAME OF PART	SYMBOL
1	Unloader Spring Carrier	3-AAB-82
2	Hand Unloader Knob Nut	50Y1
3	Hand Unloader Knob Lock Washer	95H1
4	Hand Unloader Knob	AAB-85
5	Adjusting Screw	AAB-86
6	Valve Spring	78A122
7	Adjusting Screw Nut	AAB-83
8	Adjusting Shim	77A133 (10)
9	Unloader Cap	4-AAB-78
10	Unloader Body	4-AAB-79
11	Valve	2-AAB-87
12	Valve Ball	10A6
13	Filter Element	5E2
14	Inlet Union	64AP4
15	Unloader Outlet Connection	45-AUX-113

CLICK HERE TO **DOWNLOAD** THE COMPLETE MANUAL

- Thank you very much for reading the preview of the manual.
- You can download the complete manual from: www.heydownloads.com by clicking the link below



- Please note: If there is no response to CLICKING the link, please download this PDF first and then click on it.

CLICK HERE TO **DOWNLOAD** THE COMPLETE MANUAL