



**MANITOU NORTH AMERICA, INC.**

6401 IMPERIAL DRIVE  
Waco, TX 76712-6803

**NOTE:** *Manitou Forklift Manuals are continually updated and subject to change without prior notice. If your Forklift Model or parts are not found in this manual, please contact your dealer or the Manitou North America Parts Department for the latest information and parts availability.*

S/N: 756587  
S/N: 757730 & 757731, 757733 thru 757742  
S/N: 758315, 758320 & above

**M30/40/50-2T H/L**  
**M30/40/50-4T H/L**

**HYDROSTATIC & 4-SPEED  
TRANSMISSIONS  
- TIER III ENGINE -**

**PARTS MANUAL**

For Parts Orders contact your Manitou North America Dealer or call:  
Manitou North America, Parts Dept. 800-425-3727 or (254) 799-0232  
Parts Dept. Fax: (254) 867-6504 Email: [parts.mna@manitou.com](mailto:parts.mna@manitou.com)

CLICK HERE TO **DOWNLOAD** THE COMPLETE MANUAL

- Thank you very much for reading the preview of the manual.
- You can download the complete manual from: [www.heydownloads.com](http://www.heydownloads.com) by clicking the link below



- Please note: If there is no response to CLICKING the link, please download this PDF first and then click on it.

CLICK HERE TO **DOWNLOAD** THE COMPLETE MANUAL

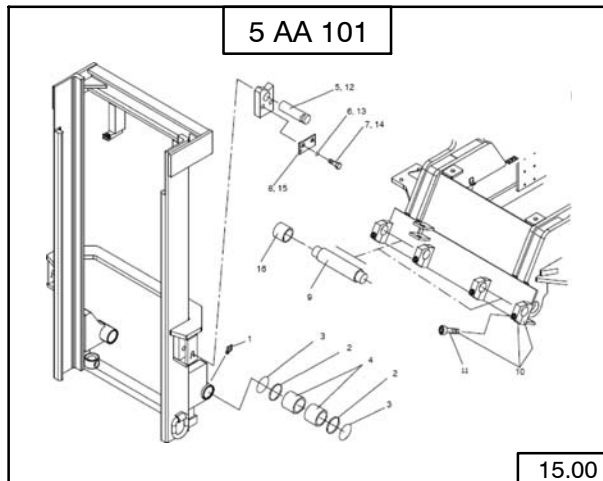

15.00

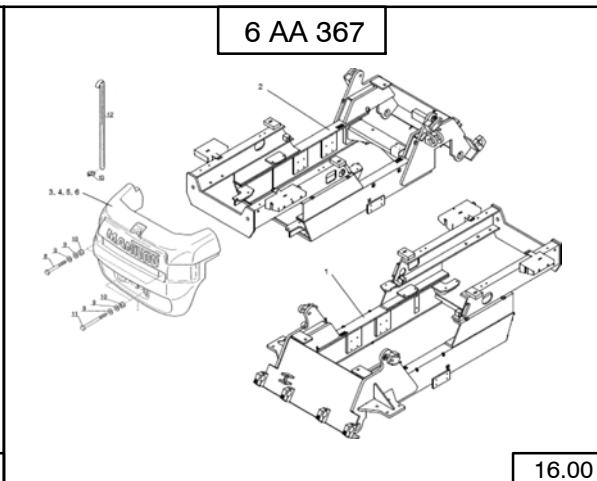

16.00

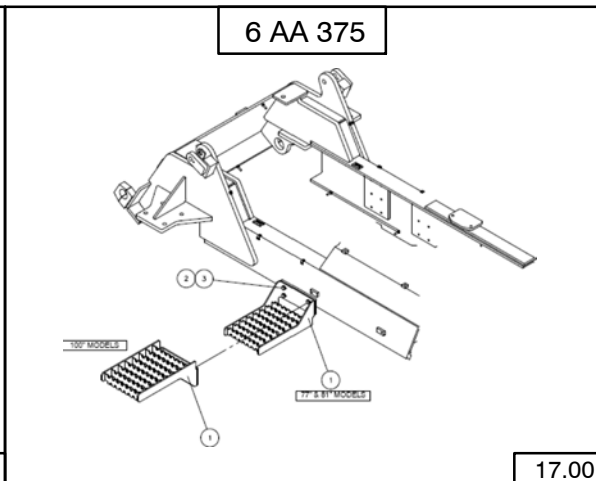

17.00

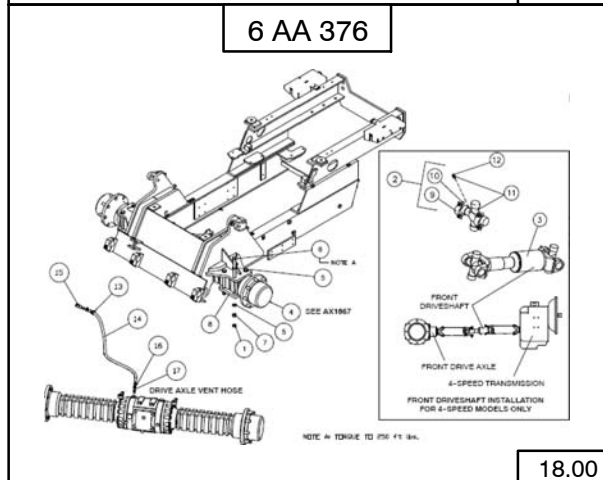

18.00

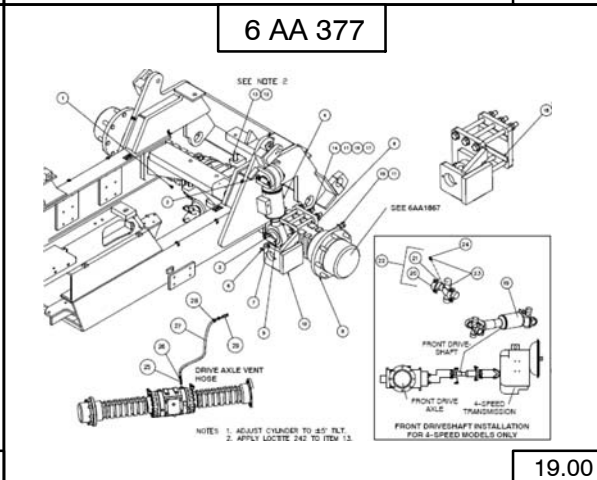

19.00

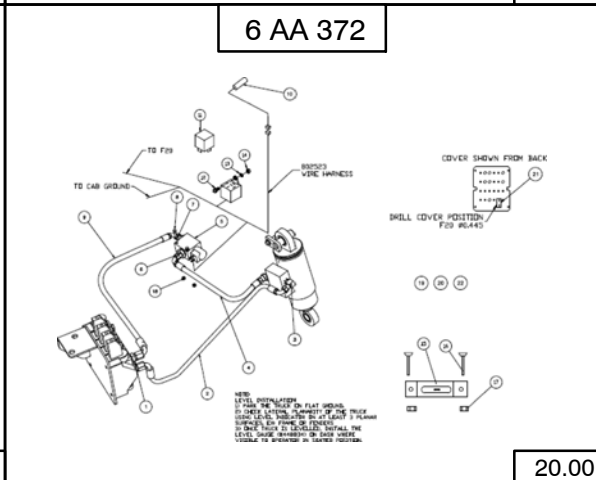

20.00

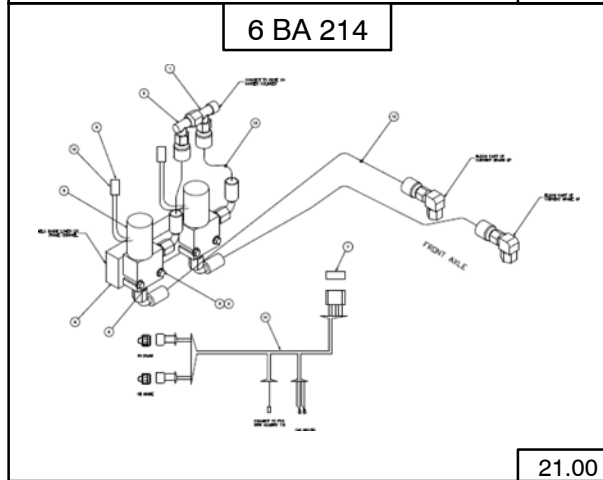

21.00

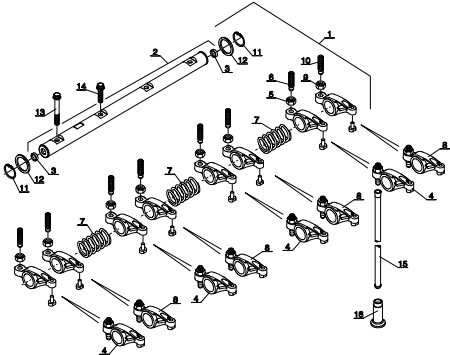
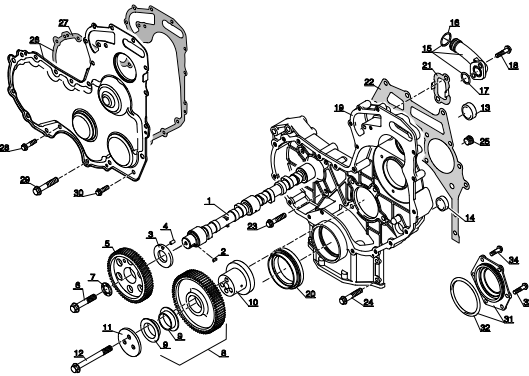
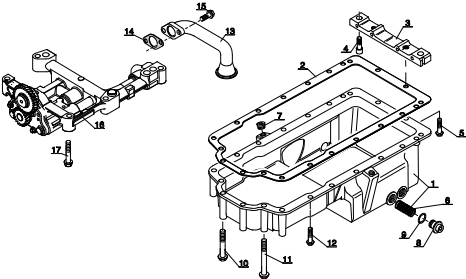
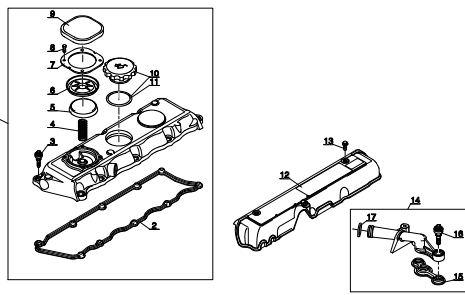
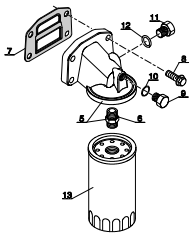
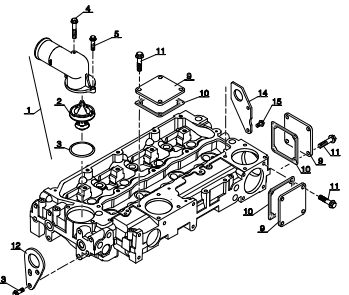
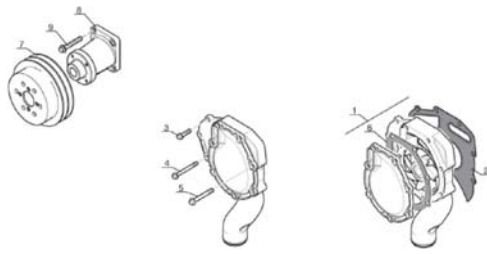
<p style="text-align: center;">AP 1953 PERKINS</p>  <p style="text-align: right;">85.00</p>	<p style="text-align: center;">AP 1954 PERKINS</p>  <p style="text-align: right;">86.00</p>	<p style="text-align: center;">AP 1955 PERKINS</p>  <p style="text-align: right;">87.00</p>
<p style="text-align: center;">AP 1956 PERKINS</p>  <p style="text-align: right;">88.00</p>	<p style="text-align: center;">AP 1957 PERKINS</p>  <p style="text-align: right;">89.00</p>	<p style="text-align: center;">AP 1958 PERKINS</p>  <p style="text-align: right;">90.00</p>
<p style="text-align: center;">AP 1959 PERKINS</p>  <p style="text-align: right;">91.00</p>	<p style="text-align: center;">[Empty]</p>	<p style="text-align: center;">[Empty]</p>

3	TIRE AND WHEELS FRONT		QUANTITY / MODEL						3 AA 245					
			M 30-4 T	M 40-4 T	M 50-4 T	M 30-4 TH	M 40-4 TH	M 50-4 TH	M 30-4 TL	M 40-4 TL	M 50-4 TL	M 30-4 THL	M 40-4 THL	M 50-4 THL
ITEM	PART NO.	DESCRIPTION	M 30-2 T	M 40-2 T	M 50-2 T	M 30-2 TH	M 40-2 TH	M 50-2 TH	M 30-2 TL	M 40-2 TL	M 50-2 TL	M 30-2 THL	M 40-2 THL	M 50-2 THL
34*	812613L	Tire Assy. LH	1			1			1			1		
35*	812615	Rim Assy.	1			1			1			1		
36*	812614	Tire 445/55D19.5	1			1			1			1		
37*	812613R	Tire Assy. RH	1			1			1			1		
38*	812615	Rim Assy.	1			1			1			1		
39*	812614	Tire 445/55D19.5	1			1			1			1		
40*	807833	Angle												
* THIS ITEMS ARE NOT SHOWN.														
41	813125L	Tire Assy. Drive LH Duramax 15.5x25		1	1		1	1		1	1		1	1
42	813125R	Tire Assy. Drive RH Duramax 15.5x25		1	1		1	1		1	1		1	1
43	804443	Rim Assy.		A/R	A/R		A/R	A/R		A/R	A/R		A/R	A/R
44	813126	Tire, DURAMAX 15.5x25		A/R	A/R		A/R	A/R		A/R	A/R		A/R	A/R
45	813075L	Tire Assy, LH		1	1		1	1		1	1		1	1
46	813075R	Tire Assy. RH		1	1		1	1		1	1		1	1
47	804443	Rim Assy.		A/R	A/R		A/R	A/R		A/R	A/R		A/R	A/R
48	813076	Tire, PRIMEX 15.5x25		A/R	A/R		A/R	A/R		A/R	A/R		A/R	A/R

2.00

1	EXHAUST SYSTEM ASSEMBLY		QUANTITY / MODEL											4 AA 602			
			M30-4T	M40-4T	M50-4T		M30-4T H	M40-4T H	M50-4T H		M30-4T L	M40-4T L	M50-4T L		M30-4T HL	M40-4T HL	M50-4T HL
ITEM	PART NO.	DESCRIPTION	M30-2T	M40-2T	M50-2T		M30-2T H	M40-2T H	M50-2T H		M30-2T L	M40-2T L	M50-2T L		M30-2T HL	M40-2T HL	M50-2T HL
1	423625	Clamp	1	1	1	1	1	1	1	1	1	1	1	1	1	1	1
2	42325	Washer	2	2	2	2	2	2	2	2	2	2	2	2	2	2	2
3	42347	Bolt	2	2	2	2	2	2	2	2	2	2	2	2	2	2	2
4	803501	Muffler, exhaust down (standard)	1	1	1	1	1	1	1	1	1	1	1	1	1	1	1
5	804684	Exhaust tube	1	1	1	1	1	1	1	1	1	1	1	1	1	1	1
6	803607	Muffler, Catalytic (optional)	1	1	1	1	1	1	1	1	1	1	1	1	1	1	1
7	551768	Gasket, metal	1	1	1	1	1	1	1	1	1	1	1	1	1	1	1



1	HYDROSTATIC GEARBOX HYDRAULICS		QUANTITY / MODEL								4 AB 152				
											M30-4T H	M40-4T H	M50-4T H		M30-4T HL
ITEM	PART NO.	DESCRIPTION	M30-2T H	M40-2T H	M50-2T H					M30-2T HL	M40-2T HL	M50-2T HL			
1	803684	Connector	1	1	1	1				1	1	1	1		
2	803196	Connector	1	1	1	1				1	1	1	1		
3	62179	Check valve	1	1	1	1				1	1	1	1		
4	58546	Bolt	2	2	2	2				2	2	2	2		
5	42231	Washer	2	2	2	2				2	2	2	2		
6	168706	Screw	4	4	4	4				4	4	4	4		
7	25714	Nut	4	4	4	4				4	4	4	4		
8	174132	Washer	4	4	4	4				4	4	4	4		
9	803175	Hose assembly	2	2	2	2				2	2	2	2		
10	805118	Hose assembly	1	1	1	1				1	1	1	1		
11	802504	Plate, valve support	1	1	1	1				1	1	1	1		
12	803174	Connector	1	1	1	1				1	1	1	1		
13	803180	Hose assembly	1	1	1	1				1	1	1	1		
14	60998	Electrovalve	1	1	1	1				1	1	1	1		
15	805120	Hose assembly	1	1	1	1				1	1	1	1		
16	803185	Hose assembly	1	1	1	1				1	1	1	1		
17	75498	Valve, TH7	1	1	1	1				1	1	1	1		
18	61674	Washer	4	4	4	4				4	4	4	4		
19	58528	Nut	2	2	2	2				2	2	2	2		
20	58531	Bolt	2	2	2	2				2	2	2	2		
21	42325	Washer	2	2	2	2				2	2	2	2		
22	803182	Connector	5	5	5	5				5	5	5	5		
23	805119	Hose assembly	1	1	1	1				1	1	1	1		
24	803184	Connector	3	3	3	3				3	3	3	3		
25	86506	Clamp	1	1	1	1				1	1	1	1		
26	K55691	Nut	1	1	1	1				1	1	1	1		
27	K44722	Washer	1	1	1	1				1	1	1	1		
28	Z4525	Sleeve, hose x 60"	1	1	1	1				1	1	1	1		
29	805121	Connector	3	3	3	3				3	3	3	3		

13.00

1	SIDE STEP INSTALLATION			QUANTITY / MODEL									6 AA 375					
				M30-4T	M40-4T	M50-4T		M30-4T H	M40-4T H	M50-4T H		M30-4T L	M40-4T L	M50-4T L		M30-4T HL	M40-4T HL	M50-4T HL
ITEM	PART NO.	DESCRIPTION	M30-2T	M40-2T	M50-2T		M30-2T H	M40-2T H	M50-2T H		M30-2T L	M40-2T L	M50-2T L		M30-2T HL	M40-2T HL	M50-2T HL	
1	807492	Step assembly, all models	2	2	2	2	2	2	2	2	2	2	2	2	2	2	2	2
2	42231	Washer	8	8	8	8	8	8	8	8	8	8	8	8	8	8	8	8
3	63546	Bolt	8	8	8	8	8	8	8	8	8	8	8	8	8	8	8	8

1	BRAKE SYSTEM ASSEMBLY, HYDRAULIC, 100 IN. CABS											6 BB 160						
	ITEM	PART NO.	DESCRIPTION	M30-4T	M40-4T	M50-4T		M30-4T H	M40-4T H	M50-4T H		M30-4T L	M40-4T L	M50-4T L		M30-4T HL	M40-4T HL	M50-4T HL
				M30-2T	M40-2T	M50-2T		M30-2T H	M40-2T H	M50-2T H		M30-2T L	M40-2T L	M50-2T L		M30-2T HL	M40-2T HL	M50-2T HL
1	79412	Pedal axle		1	1	1	1	1	1	1	1	1	1	1	1	1	1	1
2	54951	Bolt		1	1	1	1	1	1	1	1	1	1	1	1	1	1	1
3	42325	Washer		1	1	1	1	1	1	1	1	1	1	1	1	1	1	1
4	189172	Bolt		A/R	A/R	A/R	A/R	A/R	A/R	A/R	A/R	A/R	A/R	A/R	A/R	A/R	A/R	A/R
5	802780	Brake pedal		1	1	1	1	1	1	1	1	1	1	1	1	1	1	1
6	5398	Spring		2	2	2	2	2	2	2	2	2	2	2	2	2	2	2
7	56354	Nut		1	1	1	1	1	1	1	1	1	1	1	1	1	1	1
8	53501	Rubber stop		1	1	1	1	1	1	1	1	1	1	1	1	1	1	1
9	240821	Pad, pedal cover		1	1	1	1	1	1	1	1	1	1	1	1	1	1	1
10	217947	Brake hose		1	1	1	1	1	1	1	1	1	1	1	1	1	1	1
11	218074	Bolt, hollow		1	1	1	1	1	1	1	1	1	1	1	1	1	1	1
12	80305	Seal		2	2	2	2	2	2	2	2	2	2	2	2	2	2	2
13	219834	Master cylinder rod		1	1	1	1	1	1	1	1	1	1	1	1	1	1	1
15	5549	Short clevis		1	1	1	1	1	1	1	1	1	1	1	1	1	1	1
16	K20386SS	Bolt		2	2	2	2	2	2	2	2	2	2	2	2	2	2	2
17	K34806SS	Washer		2	2	2	2	2	2	2	2	2	2	2	2	2	2	2
18	K33922	Nut		1	1	1	1	1	1	1	1	1	1	1	1	1	1	1
19	271498	Master cylinder		1	1	1	1	1	1	1	1	1	1	1	1	1	1	1
20	802781	Hose		1	1	1	1	1	1	1	1	1	1	1	1	1	1	1
21	479218	Hose clamp		2	2	2	2	2	2	2	2	2	2	2	2	2	2	2
22	233837	Seal		1	1	1	1	1	1	1	1	1	1	1	1	1	1	1
23	81044	Seal		1	1	1	1	1	1	1	1	1	1	1	1	1	1	1
24	218075	Banjo fitting		1	1	1	1	1	1	1	1	1	1	1	1	1	1	1
25	79414	Tube		1	1	1	1	1	1	1	1	1	1	1	1	1	1	1
26	175498	Fitting		2	2	2	2	2	2	2	2	2	2	2	2	2	2	2
27	190442	Tee fitting		1	1	1	1	1	1	1	1	1	1	1	1	1	1	1
28	237806	Tube assembly		1	1	1	1	1	1	1	1	1	1	1	1	1	1	1

1	ACCELERATOR PEDAL ASSEMBLY, 77 & 81 IN. CAB		QUANTITY / MODEL												6 BB 163			
			M30-4T	M40-4T	M50-4T		M30-4T H	M40-4T H	M50-4T H		M30-4T L	M40-4T L	M50-4T L		M30-4T HL	M40-4T HL	M50-4T HL	
ITEM	PART NO.	DESCRIPTION	M30-2T	M40-2T	M50-2T		M30-2T H	M40-2T H	M50-2T H		M30-2T L	M40-2T L	M50-2T L		M30-2T HL	M40-2T HL	M50-2T HL	
1	202144	Screw	4	4	4	4	4	4	4	4	4	4	4	4	4	4	4	4
2	42316	Washer	4	4	4	4	4	4	4	4	4	4	4	4	4	4	4	4
3	42325	Washer	4	4	4	4	4	4	4	4	4	4	4	4	4	4	4	4
4	806748	Cable, accelerator	1	1	1	1	1	1	1	1	1	1	1	1	1	1	1	1
5	493789	Nut	5	5	5	5	5	5	5	5	5	5	5	5	5	5	5	5
6	58528	Nut	4	4	4	4	4	4	4	4	4	4	4	4	4	4	4	4
7	61674	Washer	4	4	4	4	4	4	4	4	4	4	4	4	4	4	4	4
8	801864	Bearing	2	2	2	2	2	2	2	2	2	2	2	2	2	2	2	2
9	804222	Pedal	1	1	1	1	1	1	1	1	1	1	1	1	1	1	1	1
10	806869	Arm	1	1	1	1	1	1	1	1	1	1	1	1	1	1	1	1
11	K300858	Bolt	1	1	1	1	1	1	1	1	1	1	1	1	1	1	1	1
12	K44719	Washer	2	2	2	2	2	2	2	2	2	2	2	2	2	2	2	2
13	46668	Bolt	3	3	3	3	3	3	3	3	3	3	3	3	3	3	3	3
14	29469	Washer	3	3	3	3	3	3	3	3	3	3	3	3	3	3	3	3
15	271456	Bracket	1	1	1	1	1	1	1	1	1	1	1	1	1	1	1	1
16	162229	Nut, lock	3	3	3	3	3	3	3	3	3	3	3	3	3	3	3	3
17	6224	Bolt	1	1	1	1	1	1	1	1	1	1	1	1	1	1	1	1
18	204069	Clip, spring	2	2	2	2	2	2	2	2	2	2	2	2	2	2	2	2
19	475379	Spring	1	1	1	1	1	1	1	1	1	1	1	1	1	1	1	1
20	804806	Cover	1	1	1	1	1	1	1	1	1	1	1	1	1	1	1	1
21	205275	Screw	4	4	4	4	4	4	4	4	4	4	4	4	4	4	4	4
22	25714	Nut	1	1	1	1	1	1	1	1	1	1	1	1	1	1	1	1

1	CAB ASSEMBLY, 100 IN. FULLY ENCLOSED		QUANTITY / MODEL											8 AA 462			
			M30-4T	M40-4T	M50-4T		M30-4T H	M40-4T H	M50-4T H		M30-4T L	M40-4T L	M50-4T L		M30-4T HL	M40-4T HL	M50-4T HL
ITEM	PART NO.	DESCRIPTION	M30-2T	M40-2T	M50-2T		M30-2T H	M40-2T H	M50-2T H		M30-2T L	M40-2T L	M50-2T L		M30-2T HL	M40-2T HL	M50-2T HL
1	804783	Cab assembly, fully enclosed (DOES NOT include the front fenders or Items 2 thru 15)	1	1	1	1	1	1	1	1	1	1	1	1	1	1	1
2	802658	Cab support angle	1	1	1	1	1	1	1	1	1	1	1	1	1	1	1
3	29437	Washer, flat	4	4	4	4	4	4	4	4	4	4	4	4	4	4	4
4	56354	Nut	2	2	2	2	2	2	2	2	2	2	2	2	2	2	2
5	168351	Bolt	2	2	2	2	2	2	2	2	2	2	2	2	2	2	2
6	804782	Cover, cab RH	1	1	1	1	1	1	1	1	1	1	1	1	1	1	1
7	804781	Cover, cab LH	1	1	1	1	1	1	1	1	1	1	1	1	1	1	1
8	25713	Bolt	6	6	6	6	6	6	6	6	6	6	6	6	6	6	6
9	42316	Washer, lock	6	6	6	6	6	6	6	6	6	6	6	6	6	6	6
10	802755	Plate, gauge	1	1	1	1	1	1	1	1	1	1	1	1	1	1	1
11	79533	Screw	4	4	4	4	4	4	4	4	4	4	4	4	4	4	4
12	804303	Plate, cover	1	1	1	1	1	1	1	1	1	1	1	1	1	1	1
13	28959	Washer	4	4	4	4	4	4	4	4	4	4	4	4	4	4	4
14	54232	Nut	2	2	2	2	2	2	2	2	2	2	2	2	2	2	2
15	184036	Screw	2	2	2	2	2	2	2	2	2	2	2	2	2	2	2

1	CAB DETAILS 3, 100 IN. FULLY ENCLOSED		QUANTITY / MODEL												8 AA 465		
			M30-4T	M40-4T	M50-4T		M30-4T H	M40-4T H	M50-4T H		M30-4T L	M40-4T L	M50-4T L		M30-4T HL	M40-4T HL	M50-4T HL
ITEM	PART NO.	DESCRIPTION	M30-2T	M40-2T	M50-2T		M30-2T H	M40-2T H	M50-2T H		M30-2T L	M40-2T L	M50-2T L		M30-2T HL	M40-2T HL	M50-2T HL
1	551582	Nut	3	3	3	3	3	3	3	3	3	3	3	3	3	3	3
2	551582	Nut	4	4	4	4	4	4	4	4	4	4	4	4	4	4	4
3	552760	Windshield wiper motor	1	1	1	1	1	1	1	1	1	1	1	1	1	1	1
4	202144	Screw	1	1	1	1	1	1	1	1	1	1	1	1	1	1	1
5	42412	Screw	1	1	1	1	1	1	1	1	1	1	1	1	1	1	1
6	194661	Washer	1	1	1	1	1	1	1	1	1	1	1	1	1	1	1
7	551560	Washer	1	1	1	1	1	1	1	1	1	1	1	1	1	1	1
8	61674	Washer	2	2	2	2	2	2	2	2	2	2	2	2	2	2	2
9	42325	Washer	2	2	2	2	2	2	2	2	2	2	2	2	2	2	2
10	58528	Nut	2	2	2	2	2	2	2	2	2	2	2	2	2	2	2
11	551582	Nut	2	2	2	2	2	2	2	2	2	2	2	2	2	2	2
12	561528	Drain trough	1	1	1	1	1	1	1	1	1	1	1	1	1	1	1
13	551600	Washer	2	2	2	2	2	2	2	2	2	2	2	2	2	2	2
14	199976	Screw	2	2	2	2	2	2	2	2	2	2	2	2	2	2	2
15	561529	Roof fitting	1	1	1	1	1	1	1	1	1	1	1	1	1	1	1
16	166702	Cap	1	1	1	1	1	1	1	1	1	1	1	1	1	1	1
17	205275	Screw	2	2	2	2	2	2	2	2	2	2	2	2	2	2	2
21	61799	Bulb	1	1	1	1	1	1	1	1	1	1	1	1	1	1	1
22	54564	Roof lamp	1	1	1	1	1	1	1	1	1	1	1	1	1	1	1
23	194668	Screw	2	2	2	2	2	2	2	2	2	2	2	2	2	2	2
25	199976	Screw	7	7	7	7	7	7	7	7	7	7	7	7	7	7	7
26	551600	Washer	7	7	7	7	7	7	7	7	7	7	7	7	7	7	7
29	184526	Blade holder	1	1	1	1	1	1	1	1	1	1	1	1	1	1	1
30	54557	Brush	1	1	1	1	1	1	1	1	1	1	1	1	1	1	1

			QUANTITY / MODEL											8 AA 468			
			M30-4T	M40-4T	M50-4T		M30-4T H	M40-4T H	M50-4T H		M30-4T L	M40-4T L	M50-4T L		M30-4T HL	M40-4T HL	M50-4T HL
1	CAB DETAILS 6, 100 IN. FULLY ENCLOSED		M30-2T	M40-2T	M50-2T		M30-2T H	M40-2T H	M50-2T H		M30-2T L	M40-2T L	M50-2T L		M30-2T HL	M40-2T HL	M50-2T HL
ITEM	PART NO.	DESCRIPTION															
1	198059	Connection	2	2	2	2	2	2	2	2	2	2	2	2	2	2	2
2	B2236-3	Clamp	6	6	6	6	6	6	6	6	6	6	6	6	6	6	6
3	802820	Heater hose	1	1	1	1	1	1	1	1	1	1	1	1	1	1	1
4	802821	Heater hose	1	1	1	1	1	1	1	1	1	1	1	1	1	1	1
5	802822	Heater hose	1	1	1	1	1	1	1	1	1	1	1	1	1	1	1
6	198060	Valve, heater	1	1	1	1	1	1	1	1	1	1	1	1	1	1	1
7	196821	Bracket	1	1	1	1	1	1	1	1	1	1	1	1	1	1	1
8	4240	Screw	2	2	2	2	2	2	2	2	2	2	2	2	2	2	2
9	29483	Washer	2	2	2	2	2	2	2	2	2	2	2	2	2	2	2
10	54232	Nut	2	2	2	2	2	2	2	2	2	2	2	2	2	2	2
11	79533	Screw	2	2	2	2	2	2	2	2	2	2	2	2	2	2	2

1	STEERING COLUMN ASSEMBLY, 100 IN. SEMI & FULLY ENCLOSED CAB		QUANTITY / MODEL											8 AA 473				
			M30-4T	M40-4T	M50-4T		M30-4T H	M40-4T H	M50-4T H		M30-4T L	M40-4T L	M50-4T L		M30-4T HL	M40-4T HL	M50-4T HL	
			M30-2T	M40-2T	M50-2T		M30-2T H	M40-2T H	M50-2T H		M30-2T L	M40-2T L	M50-2T L		M30-2T HL	M40-2T HL	M50-2T HL	
ITEM	PART NO.	DESCRIPTION	M30-2T	M40-2T	M50-2T		M30-2T H	M40-2T H	M50-2T H		M30-2T L	M40-2T L	M50-2T L		M30-2T HL	M40-2T HL	M50-2T HL	
1	203115	Bracket, steering column	1	1	1	1	1	1	1	1	1	1	1	1	1	1	1	1
2	168870	Plate, cover	1	1	1	1	1	1	1	1	1	1	1	1	1	1	1	1
3	174321	Clamp, hose half	2	2	2	2	2	2	2	2	2	2	2	2	2	2	2	2
4	202953	Cover, column front	1	1	1	1	1	1	1	1	1	1	1	1	1	1	1	1
5	202954	Cover, column rear	1	1	1	1	1	1	1	1	1	1	1	1	1	1	1	1
6	165919	Bolt	2	2	2	2	2	2	2	2	2	2	2	2	2	2	2	2
7	29469	Washer, flat	2	2	2	2	2	2	2	2	2	2	2	2	2	2	2	2
8	162229	Nut	2	2	2	2	2	2	2	2	2	2	2	2	2	2	2	2
9	196951	Screw	8	8	8	8	8	8	8	8	8	8	8	8	8	8	8	8
10	30327	Column, steering	1	1	1	1	1	1	1	1	1	1	1	1	1	1	1	1
11	42232	Washer, lock	4	4	4	4	4	4	4	4	4	4	4	4	4	4	4	4
12	63544	Bolt	4	4	4	4	4	4	4	4	4	4	4	4	4	4	4	4
13	191613	Steering wheel	1	1	1	1	1	1	1	1	1	1	1	1	1	1	1	1
14	216000	Bracket, steering	1	1	1	1	1	1	1	1	1	1	1	1	1	1	1	1
15	42325	Washer, lock	4	4	4	4	4	4	4	4	4	4	4	4	4	4	4	4
16	42347	Bolt	4	4	4	4	4	4	4	4	4	4	4	4	4	4	4	4
17	195069	Steering wheel cap	1	1	1	1	1	1	1	1	1	1	1	1	1	1	1	1

40.00

1	SEAT ASSEMBLY, LOW BACK, 77 & 81 IN. CAB		QUANTITY / MODEL												8 AA 480			
			M30-4T	M40-4T	M50-4T		M30-4T H	M40-4T H	M50-4T H		M30-4T L	M40-4T L	M50-4T L		M30-4T HL	M40-4T HL	M50-4T HL	
ITEM	PART NO.	DESCRIPTION	M30-2T	M40-2T	M50-2T		M30-2T H	M40-2T H	M50-2T H		M30-2T L	M40-2T L	M50-2T L		M30-2T HL	M40-2T HL	M50-2T HL	
1	807543	Seat, 17.5 in. height	1	1	1	1	1	1	1	1	1	1	1	1	1	1	1	1
2	802398	Rail kit, less hardware	1	1	1	1	1	1	1	1	1	1	1	1	1	1	1	1
3	495931	Seat belt, 3 in.	1	1	1	1	1	1	1	1	1	1	1	1	1	1	1	1
4	K20346SS	Bolt	4	4	4	4	4	4	4	4	4	4	4	4	4	4	4	4
5	K44722	Washer	4	4	4	4	4	4	4	4	4	4	4	4	4	4	4	4
6	K34806	Washer, lock	4	4	4	4	4	4	4	4	4	4	4	4	4	4	4	4
7	K55961	Nut, lock	4	4	4	4	4	4	4	4	4	4	4	4	4	4	4	4
8	K34808	Washer, lock	2	2	2	2	2	2	2	2	2	2	2	2	2	2	2	2
9	K20391	Bolt	2	2	2	2	2	2	2	2	2	2	2	2	2	2	2	2
10	807168	Seat belt, 3 inch wide, retractable (includes hardware)	1	1	1	1	1	1	1	1	1	1	1	1	1	1	1	1

1	WINDSHIELD KIT, 77 AND 81 IN. OPEN CAB (HYDROSTATIC OR 4-SPEED)		QUANTITY / MODEL												8 AA 485		
			M30-4T	M40-4T	M50-4T		M30-4T H	M40-4T H	M50-4T H		M30-4T L	M40-4T L	M50-4T L		M30-4T HL	M40-4T HL	M50-4T HL
ITEM	PART NO.	DESCRIPTION	M30-2T	M40-2T	M50-2T		M30-2T H	M40-2T H	M50-2T H		M30-2T L	M40-2T L	M50-2T L		M30-2T HL	M40-2T HL	M50-2T HL
	803138	Windshield kit	1	1	1	1	1	1	1	1	1	1	1	1	1	1	1
1	803144	Glass plate, front	1	1	1	1	1	1	1	1	1	1	1	1	1	1	1
2	803142	Glass plate, rear	1	1	1	1	1	1	1	1	1	1	1	1	1	1	1
3	803140	Glass plate, top	1	1	1	1	1	1	1	1	1	1	1	1	1	1	1
4	Z4056	Gasket, front, 117 in.	1	1	1	1	1	1	1	1	1	1	1	1	1	1	1
5	Z4056	Gasket, rear, 89 in.	1	1	1	1	1	1	1	1	1	1	1	1	1	1	1
6	Z4053	Trim-Lock, 115 in.	1	1	1	1	1	1	1	1	1	1	1	1	1	1	1
7*	803622	Frame, front upper	1	1	1	1	1	1	1	1	1	1	1	1	1	1	1
8*	803623	Frame, front side	1	1	1	1	1	1	1	1	1	1	1	1	1	1	1
9*	803621	Frame, front lower	1	1	1	1	1	1	1	1	1	1	1	1	1	1	1
10*	803625	Frame, rear upper	1	1	1	1	1	1	1	1	1	1	1	1	1	1	1
11*	803626	Frame, rear side	2	2	2	2	2	2	2	2	2	2	2	2	2	2	2
12*	803624	Frame, rear lower	1	1	1	1	1	1	1	1	1	1	1	1	1	1	1
		* For cabs without window framing (welding required)															

CLICK HERE TO **DOWNLOAD** THE COMPLETE MANUAL

- Thank you very much for reading the preview of the manual.
- You can download the complete manual from: [www.heydownloads.com](http://www.heydownloads.com) by clicking the link below



- Please note: If there is no response to CLICKING the link, please download this PDF first and then click on it.

CLICK HERE TO **DOWNLOAD** THE COMPLETE MANUAL

			QUANTITY / MODEL								10 AA 634							
1 HYDRAULIC TANK ASSEMBLY, HYDROSTATIC TRANSMISSION							M30-4T H	M40-4T H	M50-4T H					M30-4T HL	M40-4T HL	M50-4T HL		
ITEM	PART NO.	DESCRIPTION					M30-2T H	M40-2T H	M50-2T H					M30-2T HL	M40-2T HL	M50-2T HL		
2	189536	Seal, drain plug					1	1	1	1					1	1	1	1
3	189535	Drain plug					1	1	1	1					1	1	1	1
4	425497	Temp switch					1	1	1	1					1	1	1	1
5	234292	Filter assembly, complete - see <b>10AA636</b>					1	1	1	1					1	1	1	1
6	29437	Washer, flat					4	4	4	4					4	4	4	4
7	63727	Bolt					4	4	4	4					4	4	4	4
8	488236	Level gauge					1	1	1	1					1	1	1	1
9	424764	Strainer, hydraulic suction					1	1	1	1					1	1	1	1
12	803269	Connector					1	1	1	1					1	1	1	1
13	802451	Fitting					1	1	1	1					1	1	1	1
14	K8-326	Ring, back-up					1	1	1	1					1	1	1	1
19	425501	Filler cap, vented					1	1	1	1					1	1	1	1
20	803039	Cap					1	1	1	1					1	1	1	1
22	807431	Tank, hydraulic					1	1	1	1					1	1	1	1
23	802354	Gasket					1	1	1	1					1	1	1	1
24	803733	Elbow, tapped					1	1	1	1					1	1	1	1
25	213400	Adapter					1	1	1	1					1	1	1	1
26	803735	Connector					1	1	1	1					1	1	1	1
27	175743	Plug					1	1	1	1					1	1	1	1
28	803966	Plug					1	1	1	1					1	1	1	1

1	MAST SIDE-SHIFT CYLINDER ASSEMBLY		QUANTITY / MODEL												10 AE 737			
			M30-4T	M40-4T	M50-4T		M30-4T H	M40-4T H	M50-4T H		M30-4T L	M40-4T L	M50-4T L		M30-4T HL	M40-4T HL	M50-4T HL	
ITEM	PART NO.	DESCRIPTION	M30-2T	M40-2T	M50-2T		M30-2T H	M40-2T H	M50-2T H		M30-2T L	M40-2T L	M50-2T L		M30-2T HL	M40-2T HL	M50-2T HL	
	803827	Side Shift Cylinder Assembly	1	1	1	1	1	1	1	1	1	1	1	1	1	1	1	1
1*	803818	Wiper	1	1	1	1	1	1	1	1	1	1	1	1	1	1	1	1
2*	803817	Seal, rod	1	1	1	1	1	1	1	1	1	1	1	1	1	1	1	1
3*	803820	O-Ring	1	1	1	1	1	1	1	1	1	1	1	1	1	1	1	1
4*	803821	O-Ring	1	1	1	1	1	1	1	1	1	1	1	1	1	1	1	1
5*	803822	Back-up Ring	1	1	1	1	1	1	1	1	1	1	1	1	1	1	1	1
6*	803823	Cap seal	1	1	1	1	1	1	1	1	1	1	1	1	1	1	1	1
7*	803824	O-Ring	1	1	1	1	1	1	1	1	1	1	1	1	1	1	1	1
8	803825	Wear ring	1	1	1	1	1	1	1	1	1	1	1	1	1	1	1	1
9	803826	Seal Kit	1	1	1	1	1	1	1	1	1	1	1	1	1	1	1	1
10	803841	Locknut	1	1	1	1	1	1	1	1	1	1	1	1	1	1	1	1
11	803840	Retaining ring	1	1	1	1	1	1	1	1	1	1	1	1	1	1	1	1
13	803845	Barrel, Side Shift	1	1	1	1	1	1	1	1	1	1	1	1	1	1	1	1
14	803844	Rod, Side Shift Cylinder	1	1	1	1	1	1	1	1	1	1	1	1	1	1	1	1
15	803843	Head, side shift cylinder	1	1	1	1	1	1	1	1	1	1	1	1	1	1	1	1
16	803842	Piston, side shift cylinder	1	1	1	1	1	1	1	1	1	1	1	1	1	1	1	1

\* Included in Seal Kit (Item 9).

1	HYDRAULIC VALVE BANK ASSEMBLY		QUANTITY / MODEL											10 DA 318			
			M30-4T	M40-4T	M50-4T		M30-4T H	M40-4T H	M50-4T H		M30-4T L	M40-4T L	M50-4T L		M30-4T HL	M40-4T HL	M50-4T HL
ITEM	PART NO.	DESCRIPTION	M30-2T	M40-2T	M50-2T		M30-2T H	M40-2T H	M50-2T H		M30-2T L	M40-2T L	M50-2T L		M30-2T HL	M40-2T HL	M50-2T HL
2	209131	Valve bank assembly	1	1	1	1	1	1	1	1	1	1	1	1	1	1	1
3	551239	Inlet member	1	1	1	1	1	1	1	1	1	1	1	1	1	1	1
4	548112	Relief valve	1	1	1	1	1	1	1	1	1	1	1	1	1	1	1
5	476318	O-ring	A/R	A/R	A/R	A/R	A/R	A/R	A/R	A/R	A/R	A/R	A/R	A/R	A/R	A/R	A/R
6	476321	Seal	A/R	A/R	A/R	A/R	A/R	A/R	A/R	A/R	A/R	A/R	A/R	A/R	A/R	A/R	A/R
7	561340	Single acting member	1	1	1	1	1	1	1	1	1	1	1	1	1	1	1
8	476341	Plug	1	1	1	1	1	1	1	1	1	1	1	1	1	1	1
9	476322	Valve	A/R	A/R	A/R	A/R	A/R	A/R	A/R	A/R	A/R	A/R	A/R	A/R	A/R	A/R	A/R
10	476324	Seal	A/R	A/R	A/R	A/R	A/R	A/R	A/R	A/R	A/R	A/R	A/R	A/R	A/R	A/R	A/R
11	476325	Plate	A/R	A/R	A/R	A/R	A/R	A/R	A/R	A/R	A/R	A/R	A/R	A/R	A/R	A/R	A/R
12	548894	Spring return drive	A/R	A/R	A/R	A/R	A/R	A/R	A/R	A/R	A/R	A/R	A/R	A/R	A/R	A/R	A/R
13	476850	Double acting member	1	1	1	1	1	1	1	1	1	1	1	1	1	1	1
14	476850	Double acting member	1	1	1	1	1	1	1	1	1	1	1	1	1	1	1
15	476850	Double acting member	1	1	1	1	1	1	1	1	1	1	1	1	1	1	1
16	549774	Fastening member	1	1	1	1	1	1	1	1	1	1	1	1	1	1	1
17	549672	Single drive	A/R	A/R	A/R	A/R	A/R	A/R	A/R	A/R	A/R	A/R	A/R	A/R	A/R	A/R	A/R
18	192871	Seal kit	A/R	A/R	A/R	A/R	A/R	A/R	A/R	A/R	A/R	A/R	A/R	A/R	A/R	A/R	A/R
20	600726	Tie rod	1	1	1	1	1	1	1	1	1	1	1	1	1	1	1
21	801851	Lever, valve	1	1	1	1	1	1	1	1	1	1	1	1	1	1	1
22	202226	Handle, valve	1	1	1	1	1	1	1	1	1	1	1	1	1	1	1
23	58548	Nut	1	1	1	1	1	1	1	1	1	1	1	1	1	1	1
24	199728	Boot, single lever	1	1	1	1	1	1	1	1	1	1	1	1	1	1	1
25	600753	Tie rod	3	3	3	3	3	3	3	3	3	3	3	3	3	3	3
26	175743	Plug	2	2	2	2	2	2	2	2	2	2	2	2	2	2	2

APPLY DI-ELECTRIC GREASE TO ALL CONNECTIONS

**11 AA 1036**  
TIER III

ELECTRICAL ASSEMBLY, HYDROSTATIC  
(SHEET 1 OF 2)

807663)C

M30-2T H	M30-4T H
M40-2T H	M40-4T H
M50-2T H	M50-4T H

M30-2T H L	M30-4T H L
M40-2T H L	M40-4T H L
M50-2T H L	M50-4T H L

CIRCUIT BREAKER IDENTIFICATION	WIRE COLOR 'A'	WIRE COLOR 'B'
01 - STARTER (20A)	PURPLE	PURPLE
02 - WORK LIGHTS (20A)	RED	RED
03 - DASH PANEL (5A)	BLUE,RED,RED/BLACK	RED
04 - FNR (10A)	ORANGE,RED,RED/BLACK	RED
05 - HORN (10A)	RED,GREEN	RED
06 - PARK BRAKE (10A)	ORANGE	RED
07 - 2 SPEED GEAR BOX (10A)	BROWN	RED
08 - ROAD LIGHTS (15A)	RED	YELLOW
09 - BEACON (10A)	RED	RED
10 - GAUGES ENGINE SHUTDOWN (10A)	RED	RED
11 - FRAME LEVEL (5A)	RED	RED
12 - WARNING (10A)	RED	YELLOW
13 - RIGHT HAND TURN SIGNAL (10A)	GRAY	GRAY
14 - LEFT HAND TURN SIGNAL (10A)	BLACK	BLACK
15 - FLASHER UNIT (10A)	RED	RED
16 - FRONT WIPER (10A)	PINK	RED
17 - REAR WIPER (10A)	RED	RED
18 - HEATER (15A)	RED	RED
19 - DOME LIGHT (3A)	YELLOW	YELLOW
20 - OPEN	RED	RED
41 - FUSES FOR EQUIPMENT (40A)	YELLOW	
42 - ENGINE PREHEAT (80A)	BLACK	
43 - ALTERNATOR (80A)	WHITE	

LEGEND:

- VI - VIOLET
- BC - WHITE
- RD - PINK
- R - RED
- N - BLACK
- J - YELLOW
- V - GREEN
- M - BROWN
- BL - BLUE
- O - ORANGE
- G - GRAY

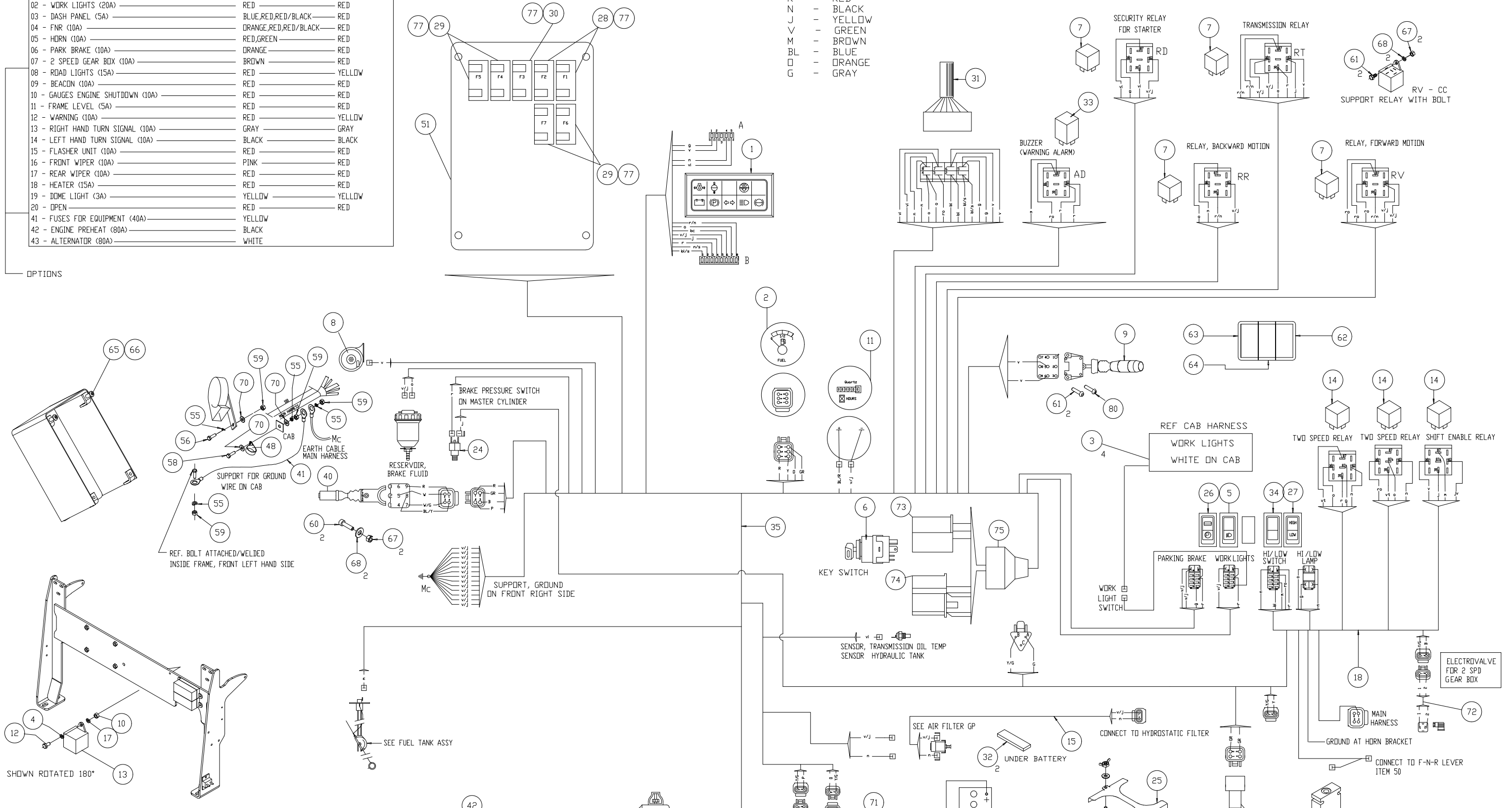

OPTIONS

REF. BOLT ATTACHED/WELDED  
INSIDE FRAME, FRONT LEFT HAND SIDE

SUPPORT, GROUND  
ON FRONT RIGHT SIDE

SHOWN ROTATED 180°

SEE FUEL TANK ASSY

SEE AIR FILTER GP

CONNECT TO HYDROSTATIC FILTER

GROUND AT HORN BRACKET

CONNECT TO F-N-R LEVER  
ITEM 50

ELECTROVALVE  
FOR 2 SPD  
GEAR BOX

REF CAB HARNESS  
WORK LIGHTS  
WHITE ON CAB

BRAKE PRESSURE SWITCH  
ON MASTER CYLINDER

RESERVOIR,  
BRAKE FLUID

EARTH CABLE  
MAIN HARNESS

SUPPORT FOR GROUND  
WIRE ON CAB

KEY SWITCH

SENSOR, TRANSMISSION OIL TEMP  
SENSOR HYDRAULIC TANK

PARKING BRAKE WORK LIGHTS

HI/LOW SWITCH

HI/LOW LAMP

WORK LIGHT SWITCH

TWO SPEED RELAY TWO SPEED RELAY SHIFT ENABLE RELAY

RELAY, BACKWARD MOTION

RELAY, FORWARD MOTION

BUZZER  
(WARNING ALARM)

SECURITY RELAY  
FOR STARTER

TRANSMISSION RELAY

RV - CC  
SUPPORT RELAY WITH BOLT

1	ELECTRICAL, ROAD LIGHTING OPTION		QUANTITY / MODEL											11 BA 120			
			M30-4T	M40-4T	M50-4T		M30-4T H	M40-4T H	M50-4T H		M30-4T L	M40-4T L	M50-4T L		M30-4T HL	M40-4T HL	M50-4T HL
			M30-2T	M40-2T	M50-2T		M30-2T H	M40-2T H	M50-2T H		M30-2T L	M40-2T L	M50-2T L		M30-2T HL	M40-2T HL	M50-2T HL
ITEM	PART NO.	DESCRIPTION	M30-2T	M40-2T	M50-2T		M30-2T H	M40-2T H	M50-2T H		M30-2T L	M40-2T L	M50-2T L		M30-2T HL	M40-2T HL	M50-2T HL
1	807514	Light, white	4	4	4	4	4	4	4	4	4	4	4	4	4	4	4
2	496680	Guard, headlight (without lights)	2	2	2	2	2	2	2	2	2	2	2	2	2	2	2
3	B3698-8	Clamp	4	4	4	4	4	4	4	4	4	4	4	4	4	4	4
4	174132	Washer, lock	4	4	4	4	4	4	4	4	4	4	4	4	4	4	4
5	25714	Nut	4	4	4	4	4	4	4	4	4	4	4	4	4	4	4
6	192310	Washer, lock	4	4	4	4	4	4	4	4	4	4	4	4	4	4	4
7	54232	Nut	4	4	4	4	4	4	4	4	4	4	4	4	4	4	4
8	219533	Tail light bracket	2	2	2	2	2	2	2	2	2	2	2	2	2	2	2
9	58523	Bolt	4	4	4	4	4	4	4	4	4	4	4	4	4	4	4
10	675	Bulb, 21W	4	4	4	4	4	4	4	4	4	4	4	4	4	4	4
11	676	Bulb, 5W	2	2	2	2	2	2	2	2	2	2	2	2	2	2	2
12	2163	Tail light assembly	2	2	2	2	2	2	2	2	2	2	2	2	2	2	2
13	169917	Flasher unit	1	1	1	1	1	1	1	1	1	1	1	1	1	1	1
15	805888	Circuit breaker, 10 amp	4	4	4	4	4	4	4	4	4	4	4	4	4	4	4
16	805973	Circuit breaker, 15 A	1	1	1	1	1	1	1	1	1	1	1	1	1	1	1
17	806341	Boot, breaker	5	5	5	5	5	5	5	5	5	5	5	5	5	5	5
18	807871	Harness, road lights	1	1	1	1	1	1	1	1	1	1	1	1	1	1	1
19	807872	Switch, warning	1	1	1	1	1	1	1	1	1	1	1	1	1	1	1
20	807826	Jumper wire	3	3	3	3	3	3	3	3	3	3	3	3	3	3	3
21	812041	Bulb. 35 w	2	2	2	2	2	2	2	2	2	2	2	2	2	2	2

1	WINDSHIELD WIPER INSTALLATION, 77 & 81 IN. CAB											11 CC 226						
	ITEM	PART NO.	DESCRIPTION	M30-2T	M40-2T	M50-2T		M30-2T H	M40-2T H	M50-2T H		M30-2T L	M40-2T L	M50-2T L		M30-2T HL	M40-2T HL	M50-2T HL
	807822	Windshield wiper kit, front and rear	1	1	1	1	1	1	1	1	1	1	1	1	1	1	1	1
1	491718	Motor, wiper	2	2	2	2	2	2	2	2	2	2	2	2	2	2	2	2
2	803208	Wiper arm	2	2	2	2	2	2	2	2	2	2	2	2	2	2	2	2
3	803209	Wiper blade	2	2	2	2	2	2	2	2	2	2	2	2	2	2	2	2
4	58531	Bolt	2	2	2	2	2	2	2	2	2	2	2	2	2	2	2	2
5	803168	Wiper motor	1	1	1	1	1	1	1	1	1	1	1	1	1	1	1	1
6	803202	Wiper blade	1	1	1	1	1	1	1	1	1	1	1	1	1	1	1	1
7	61674	Washer, flat	4	4	4	4	4	4	4	4	4	4	4	4	4	4	4	4
8	58528	Nut	2	2	2	2	2	2	2	2	2	2	2	2	2	2	2	2
9	807170	Switch	1	1	1	1	1	1	1	1	1	1	1	1	1	1	1	1
10	805904	Switch	2	2	2	2	2	2	2	2	2	2	2	2	2	2	2	2
11	804024	Spacer	2	2	2	2	2	2	2	2	2	2	2	2	2	2	2	2
12	804025	Spacer	2	2	2	2	2	2	2	2	2	2	2	2	2	2	2	2
13	807824	Harness, wiper	1	1	1	1	1	1	1	1	1	1	1	1	1	1	1	1
14	805905	Jumper wire	1	1	1	1	1	1	1	1	1	1	1	1	1	1	1	1
15	805937	Bracket	1	1	1	1	1	1	1	1	1	1	1	1	1	1	1	1
16	805936	Washer bottle	1	1	1	1	1	1	1	1	1	1	1	1	1	1	1	1
17	29469	Washer	4	4	4	4	4	4	4	4	4	4	4	4	4	4	4	4
18	42316	Washer	4	4	4	4	4	4	4	4	4	4	4	4	4	4	4	4
19	25714	Nut	4	4	4	4	4	4	4	4	4	4	4	4	4	4	4	4
20	168343	Bolt	4	4	4	4	4	4	4	4	4	4	4	4	4	4	4	4
21	805938	Fitting	1	1	1	1	1	1	1	1	1	1	1	1	1	1	1	1
22	805939	Hose	1	1	1	1	1	1	1	1	1	1	1	1	1	1	1	1
23	803169	Wiper arm	1	1	1	1	1	1	1	1	1	1	1	1	1	1	1	1
24	806341	Boot, breaker	2	2	2	2	2	2	2	2	2	2	2	2	2	2	2	2
26	805888	Circuit breaker, 10 amp	2	2	2	2	2	2	2	2	2	2	2	2	2	2	2	2
27	807826	Jumper wire	2	2	2	2	2	2	2	2	2	2	2	2	2	2	2	2

74.00

1	SENSORS, ENGINE AND TRANSMISSION (4-SPEED, 2WD/4WD)		QUANTITY / MODEL												11 CD 161		
			M30-4T	M40-4T	M50-4T		M30-4T H	M40-4T H	M50-4T H		M30-4T L	M40-4T L	M50-4T L		M30-4T HL	M40-4T HL	M50-4T HL
ITEM	PART NO.	DESCRIPTION	M30-2T	M40-2T	M50-2T		M30-2T H	M40-2T H	M50-2T H		M30-2T L	M40-2T L	M50-2T L		M30-2T HL	M40-2T HL	M50-2T HL
1	605030	Heating plug	4	4	4	4	4	4	4	4	4	4	4	4	4	4	4
2	745801	Engine oil pressure switch	1	1	1	1	1	1	1	1	1	1	1	1	1	1	1
3	601673	Electrovalve	1	1	1	1	1	1	1	1	1	1	1	1	1	1	1
4	705991	Electrovalve	1	1	1	1	1	1	1	1	1	1	1	1	1	1	1
5	604928	Water temp sensor	1	1	1	1	1	1	1	1	1	1	1	1	1	1	1
6	702318	Water temp sensor	1	1	1	1	1	1	1	1	1	1	1	1	1	1	1
8	552502	Oil temp sensor	1	1	1	1					1	1	1	1			
9	109657	O-ring	1	1	1	1					1	1	1	1			
10	549100	Transmission oil pressure switch	1	1	1	1					1	1	1	1			
11	496213	Engine block heater	1	1	1	1	1	1	1	1	1	1	1	1	1	1	1
12	802225	Tie wrap, 12 in.	2	2	2	2	2	2	2	2	2	2	2	2	2	2	2

1	ENGINE, CRANKSHAFT											QUANTITY / MODEL						AP 1951		
	ITEM	PART NO.	DESCRIPTION	M30-4T	M40-4T	M50-4T		M30-4T H	M40-4T H	M50-4T H		M30-4T L	M40-4T L	M50-4T L		M30-4T HL	M40-4T HL	M50-4T HL		
				M30-2T	M40-2T	M50-2T		M30-2T H	M40-2T H	M50-2T H		M30-2T L	M40-2T L	M50-2T L		M30-2T HL	M40-2T HL	M50-2T HL		
1	702000	Crankshaft	1	1	1	1	1	1	1	1	1	1	1	1	1	1	1	1	1	
3	604894	Main bearing set (standard)	1	1	1	1	1	1	1	1	1	1	1	1	1	1	1	1	1	
3	604895	Main bearing set (+.010 in.)	A/R	A/R	A/R	A/R	A/R	A/R	A/R	A/R	A/R	A/R	A/R	A/R	A/R	A/R	A/R	A/R	A/R	
3	604896	Main bearing set (+.020 in.)	A/R	A/R	A/R	A/R	A/R	A/R	A/R	A/R	A/R	A/R	A/R	A/R	A/R	A/R	A/R	A/R	A/R	
3	604897	Main bearing set (+.030 in.)	A/R	A/R	A/R	A/R	A/R	A/R	A/R	A/R	A/R	A/R	A/R	A/R	A/R	A/R	A/R	A/R	A/R	
4	745798	Rod bearing set (standard)	1	1	1	1	1	1	1	1	1	1	1	1	1	1	1	1	1	
4	746100	Rod bearing set (+.010 in.)	A/R	A/R	A/R	A/R	A/R	A/R	A/R	A/R	A/R	A/R	A/R	A/R	A/R	A/R	A/R	A/R	A/R	
4	746101	Rod bearing set (+.020 in.)	A/R	A/R	A/R	A/R	A/R	A/R	A/R	A/R	A/R	A/R	A/R	A/R	A/R	A/R	A/R	A/R	A/R	
4	746102	Rod bearing set (+.030 in.)	A/R	A/R	A/R	A/R	A/R	A/R	A/R	A/R	A/R	A/R	A/R	A/R	A/R	A/R	A/R	A/R	A/R	
5	109834	Spacer (standard)	1	1	1	1	1	1	1	1	1	1	1	1	1	1	1	1	1	
5	133768	Spacer (+.007 in.)	A/R	A/R	A/R	A/R	A/R	A/R	A/R	A/R	A/R	A/R	A/R	A/R	A/R	A/R	A/R	A/R	A/R	
6	109835	Spacer (standard)	1	1	1	1	1	1	1	1	1	1	1	1	1	1	1	1	1	
6	133770	Spacer (+.007 in.)	A/R	A/R	A/R	A/R	A/R	A/R	A/R	A/R	A/R	A/R	A/R	A/R	A/R	A/R	A/R	A/R	A/R	
7	133636	Key	1	1	1	1	1	1	1	1	1	1	1	1	1	1	1	1	1	
8	604912	Gear	1	1	1	1	1	1	1	1	1	1	1	1	1	1	1	1	1	
9	747605	Piston	4	4	4	4	4	4	4	4	4	4	4	4	4	4	4	4	4	
10	563226	Circlip	2	2	2	2	2	2	2	2	2	2	2	2	2	2	2	2	2	
11	740840	Piston ring kit	1	1	1	1	1	1	1	1	1	1	1	1	1	1	1	1	1	
12	604904	Connecting rod (F)	4	4	4	4	4	4	4	4	4	4	4	4	4	4	4	4	4	
13	604905	Connecting rod (G)	4	4	4	4	4	4	4	4	4	4	4	4	4	4	4	4	4	
14	604906	Connecting rod (H)	4	4	4	4	4	4	4	4	4	4	4	4	4	4	4	4	4	
15	604907	Connecting rod (J)	4	4	4	4	4	4	4	4	4	4	4	4	4	4	4	4	4	
16	604908	Connecting rod (K)	4	4	4	4	4	4	4	4	4	4	4	4	4	4	4	4	4	
17	604909	Connecting rod (L)	4	4	4	4	4	4	4	4	4	4	4	4	4	4	4	4	4	
18	604910	Bushing	1	1	1	1	1	1	1	1	1	1	1	1	1	1	1	1	1	
19	604911	Screw	2	2	2	2	2	2	2	2	2	2	2	2	2	2	2	2	2	
20	702618	Pulley	1	1	1	1	1	1	1	1	1	1	1	1	1	1	1	1	1	
21	474037	Spacer	1	1	1	1	1	1	1	1	1	1	1	1	1	1	1	1	1	
22	474038	Screw	3	3	3	3	3	3	3	3	3	3	3	3	3	3	3	3	3	

83.00



1	ENGINE, CYLINDER OUTLETS		QUANTITY / MODEL												AP 1959		
			M30-4T	M40-4T	M50-4T		M30-4T H	M40-4T H	M50-4T H		M30-4T L	M40-4T L	M50-4T L		M30-4T HL	M40-4T HL	M50-4T HL
ITEM	PART NO.	DESCRIPTION	M30-2T	M40-2T	M50-2T		M30-2T H	M40-2T H	M50-2T H		M30-2T L	M40-2T L	M50-2T L		M30-2T HL	M40-2T HL	M50-2T HL
1	747622	Waterpump	1	1	1	1	1	1	1	1	1	1	1	1	1	1	1
2	604988	Gasket	1	1	1	1	1	1	1	1	1	1	1	1	1	1	1
3	473982	Screw	2	2	2	2	2	2	2	2	2	2	2	2	2	2	2
4	475057	Screw	2	2	2	2	2	2	2	2	2	2	2	2	2	2	2
5	476074	Screw	5	5	5	5	5	5	5	5	5	5	5	5	5	5	5
6	704546	Seal	1	1	1	1	1	1	1	1	1	1	1	1	1	1	1
7	552418	Pulley	1	1	1	1	1	1	1	1	1	1	1	1	1	1	1
8	702762	Pulley bracket	1	1	1	1	1	1	1	1	1	1	1	1	1	1	1
9	473290	Screw	4	4	4	4	4	4	4	4	4	4	4	4	4	4	4

91.00

1	ENGINE, TURBOCHARGER		QUANTITY / MODEL											AP 1964			
			M30-4T	M40-4T	M50-4T		M30-4T H	M40-4T H	M50-4T H		M30-4T L	M40-4T L	M50-4T L		M30-4T HL	M40-4T HL	M50-4T HL
ITEM	PART NO.	DESCRIPTION	M30-2T	M40-2T	M50-2T		M30-2T H	M40-2T H	M50-2T H		M30-2T L	M40-2T L	M50-2T L		M30-2T HL	M40-2T HL	M50-2T HL
1	702017	Gasket	1	1	1	1	1	1	1	1	1	1	1	1	1	1	1
2	702335	Tube	1	1	1	1	1	1	1	1	1	1	1	1	1	1	1
3	473955	Screw	4	4	4	4	4	4	4	4	4	4	4	4	4	4	4
4	702019	Hose	1	1	1	1	1	1	1	1	1	1	1	1	1	1	1
5	702018	Clamp	2	2	2	2	2	2	2	2	2	2	2	2	2	2	2
6	748409	Turbocharger	1	1	1	1	1	1	1	1	1	1	1	1	1	1	1
7	601642	Gasket	1	1	1	1	1	1	1	1	1	1	1	1	1	1	1
8	702021	Stud	4	4	4	4	4	4	4	4	4	4	4	4	4	4	4
9	473908	Nut	4	4	4	4	4	4	4	4	4	4	4	4	4	4	4
10	702330	Hose	1	1	1	1	1	1	1	1	1	1	1	1	1	1	1
11	702024	Hollow screw	1	1	1	1	1	1	1	1	1	1	1	1	1	1	1
12	702023	Washer	2	2	2	2	2	2	2	2	2	2	2	2	2	2	2
13	702024	Hollow screw	1	1	1	1	1	1	1	1	1	1	1	1	1	1	1
14	702023	Washer	2	2	2	2	2	2	2	2	2	2	2	2	2	2	2
15	702026	Gasket	1	1	1	1	1	1	1	1	1	1	1	1	1	1	1
16	474067	Screw	2	2	2	2	2	2	2	2	2	2	2	2	2	2	2
17	702331	Hose	1	1	1	1	1	1	1	1	1	1	1	1	1	1	1
18	107363	Screw	2	2	2	2	2	2	2	2	2	2	2	2	2	2	2
19	702029	Gasket	1	1	1	1	1	1	1	1	1	1	1	1	1	1	1
20	746433	Adaptor	1	1	1	1	1	1	1	1	1	1	1	1	1	1	1
21	702021	Stud	3	3	3	3	3	3	3	3	3	3	3	3	3	3	3
22	473908	Nut	3	3	3	3	3	3	3	3	3	3	3	3	3	3	3
23	748455	Bracket	1	1	1	1	1	1	1	1	1	1	1	1	1	1	1
24	473956	Screw	3	3	3	3	3	3	3	3	3	3	3	3	3	3	3
25	702332	Connection	1	1	1	1	1	1	1	1	1	1	1	1	1	1	1
26	473958	Screw	2	2	2	2	2	2	2	2	2	2	2	2	2	2	2
27	702314	Seal	1	1	1	1	1	1	1	1	1	1	1	1	1	1	1

96.00

1	DRIVE AXLE, FRONT			QUANTITY / MODEL									AX 1867				
				M30-4T	M40-4T	M50-4T		M30-4T H	M40-4T H	M50-4T H		M30-4T L	M40-4T L	M50-4T L		M30-4T HL	M40-4T HL
ITEM	PART NO.	DESCRIPTION	M30-2T	M40-2T	M50-2T		M30-2T H	M40-2T H	M50-2T H		M30-2T L	M40-2T L	M50-2T L		M30-2T HL	M40-2T HL	M50-2T HL
1	807371	Drive axle, front	1	1	1	1	1	1	1								
1	807926	Drive axle, front (frame leveling only)									1	1	1	1	1	1	1
2	477538	Bushing (frame leveling only)									2	2	2	2	2	2	2
3	564693	Axle bracket (frame leveling only)									2	2	2	2	2	2	2
4	133103	Greaser (frame leveling only)									2	2	2	2	2	2	2
5	107796	Plug (frame leveling only)									2	2	2	2	2	2	2
6	601561	Axle bracket (frame leveling only)									2	2	2	2	2	2	2
7	477964	Coupling (frame leveling only)									2	2	2	2	2	2	2

99.00

1	DRIVE AXLE, FRONT, DISC BRAKES											QUANTITY / MODEL						AX 1415		
	ITEM	PART NO.	DESCRIPTION	M30-4T	M40-4T	M50-4T		M30-4T H	M40-4T H	M50-4T H		M30-4T L	M40-4T L	M50-4T L		M30-4T HL	M40-4T HL	M50-4T HL		
				M30-2T	M40-2T	M50-2T		M30-2T H	M40-2T H	M50-2T H		M30-2T L	M40-2T L	M50-2T L		M30-2T HL	M40-2T HL	M50-2T HL		
1	562547	Lever, LH	1	1	1	1	1	1	1	1	1	1	1	1	1	1	1	1		
2	106010	Bleeder screw	2	2	2	2	2	2	2	2	2	2	2	2	2	2	2	2		
3	107796	Plug	2	2	2	2	2	2	2	2	2	2	2	2	2	2	2	2		
4	562548	Screw	6	6	6	6	6	6	6	6	6	6	6	6	6	6	6	6		
5	475059	O-ring	2	2	2	2	2	2	2	2	2	2	2	2	2	2	2	2		
6	602218	Reduction bushing	2	2	2	2	2	2	2	2	2	2	2	2	2	2	2	2		
7	562550	Needle valve	2	2	2	2	2	2	2	2	2	2	2	2	2	2	2	2		
8	133088	Nut	2	2	2	2	2	2	2	2	2	2	2	2	2	2	2	2		
12	133199	Screw	2	2	2	2	2	2	2	2	2	2	2	2	2	2	2	2		
13	562525	Intermediate disc	10	10	10	10	10	10	10	10	10	10	10	10	10	10	10	10		
14	564234	Adjusting screw	6	6	6	6	6	6	6	6	6	6	6	6	6	6	6	6		
15	602296	Spring	6	6	6	6	6	6	6	6	6	6	6	6	6	6	6	6		
16	563905	Piston	1	1	1	1	1	1	1	1	1	1	1	1	1	1	1	1		
17	562521	Anti-extrusion seal	2	2	2	2	2	2	2	2	2	2	2	2	2	2	2	2		
18	562522	O-ring	2	2	2	2	2	2	2	2	2	2	2	2	2	2	2	2		
19	107751	Centering pin	2	2	2	2	2	2	2	2	2	2	2	2	2	2	2	2		
20	562554	Lever, RH	1	1	1	1	1	1	1	1	1	1	1	1	1	1	1	1		
21	562520	Spring	6	6	6	6	6	6	6	6	6	6	6	6	6	6	6	6		
22	107286	Needle valve	4	4	4	4	4	4	4	4	4	4	4	4	4	4	4	4		
23	562523	Anti-extrusion seal	2	2	2	2	2	2	2	2	2	2	2	2	2	2	2	2		
24	562524	O-ring	2	2	2	2	2	2	2	2	2	2	2	2	2	2	2	2		
25	562516	Brake disc	8	8	8	8	8	8	8	8	8	8	8	8	8	8	8	8		
26	563906	Piston	1	1	1	1	1	1	1	1	1	1	1	1	1	1	1	1		
36	600582	Piston kit	1	1	1	1	1	1	1	1	1	1	1	1	1	1	1	1		
37	600558	Piston kit	1	1	1	1	1	1	1	1	1	1	1	1	1	1	1	1		
38	602007	O-ring	2	2	2	2	2	2	2	2	2	2	2	2	2	2	2	2		
41	604253	Lever	2	2	2	2	2	2	2	2	2	2	2	2	2	2	2	2		
42	106567	Spacer	2	2	2	2	2	2	2	2	2	2	2	2	2	2	2	2		

103.00

1	STEER AXLE REDUCTION GEAR, 4WD TORQUE CONVERTER MODELS		QUANTITY / MODEL									AX 1582						
			M30-4T	M40-4T	M50-4T							M30-4T L	M40-4T L	M50-4T L				
ITEM	PART NO.	DESCRIPTION																
1	133090	Nut	2	2	2							2	2	2				
2	562750	Screw	2	2	2							2	2	2				
4	702138	Bolt (STEER AXLE 801988)	28	28	28							28	28	28				
5	562490	Washer	4	4	4							4	4	4				
6	563903	Flange	2	2	2							2	2	2				
7	108100	Seal	2	2	2							2	2	2				
8	105101	Bearing	2	2	2							2	2	2				
9	105424	Circlips	2	2	2							2	2	2				
10	562752	O-ring	2	2	2							2	2	2				
11	603650	Axle, Cardan	2	2	2							2	2	2				
12	477847	Bushing	2	2	2							2	2	2				
13	603651	Bushing	2	2	2							2	2	2				
14	562475	Screw	20	20	20							20	20	20				
15	600559	Cover	2	2	2							2	2	2				
16	107796	Plug	4	4	4							4	4	4				
17	133103	Greaser	4	4	4							4	4	4				
18	564903	Pivot pin	2	2	2							2	2	2				
19	564898	Pivot pin	2	2	2							2	2	2				
20	562499	Seal	4	4	4							4	4	4				
21	562500	Bushing	2	2	2							2	2	2				
22	604256	LH steering case	1	1	1							1	1	1				
23	603653	Seal	2	2	2							2	2	2				
25	702418	Magnetic plug	2	2	2							2	2	2				
26	603638	Plug	4	4	4							4	4	4				
27	604257	RH steering case	1	1	1							1	1	1				

1	HYDROSTATIC MOTOR		QUANTITY / MODEL								BC 108				
ITEM	PART NO.	DESCRIPTION	M30-2T H	M40-2T H	M50-2T H							M30-4T HL	M40-4T HL	M50-4T HL	
1	208701	Hydrostatic motor assembly	1	1	1	1						1	1	1	1
2	561198	Seal	1	1	1	1						1	1	1	1
3	561187	Control parts	1	1	1	1						1	1	1	1
4	552608	Flushing and boost pressure valve	1	1	1	1						1	1	1	1
5	562317	Piston	1	1	1	1						1	1	1	1
6	562318	Swivel pin	1	1	1	1						1	1	1	1
7	562319	Screw	1	1	1	1						1	1	1	1
8	562320	Seal kit	1	1	1	1						1	1	1	1

111.00



			QUANTITY / MODEL											BP 182				
1 TRANSMISSION, 4-SPEED, 4WD, EXTERNAL COMPONENTS			M30-4T	M40-4T	M50-4T							M30-4T L	M40-4T L	M50-4T L				
ITEM	PART NO.	DESCRIPTION																
1	561757	Transmission housing	1	1	1	1						1	1	1	1			
2	561758	Transmission rear case	1	1	1	1						1	1	1	1			
3	550705	Plug	13	13	13	13						13	13	13	13			
4	109657	O-ring	13	13	13	13						13	13	13	13			
5	561759	Screw	4	4	4	4						4	4	4	4			
6	109703	Stud bolt	2	2	2	2						2	2	2	2			
7	109727	Screw	13	13	13	13						13	13	13	13			
8	561833	O-ring	4	4	4	4						4	4	4	4			
9	561825	Pipe	1	1	1	1						1	1	1	1			
10	561824	Nut	2	2	2	2						2	2	2	2			
11	561826	Bushing	2	2	2	2						2	2	2	2			
12	561835	Plug	1	1	1	1						1	1	1	1			
13	109657	O-ring	1	1	1	1						1	1	1	1			
14	473366	Drain plug	1	1	1	1						1	1	1	1			
15	147915	O-ring	1	1	1	1						1	1	1	1			
16	109705	Air breather	1	1	1	1						1	1	1	1			
17	705009	Oil pressure switch	1	1	1	1						1	1	1	1			
19	561829	Screw	4	4	4	4						4	4	4	4			
20	561831	Solenoid	1	1	1	1						1	1	1	1			
21	561837	Filter housing	1	1	1	1						1	1	1	1			
22	109646	Gasket	1	1	1	1						1	1	1	1			
23	109658	Connection	1	1	1	1						1	1	1	1			
24	561749	Oil filter	1	1	1	1						1	1	1	1			
25	109728	Screw	2	2	2	2						2	2	2	2			
26	561836	Ball	1	1	1	1						1	1	1	1			
27	561765	Spring	1	1	1	1						1	1	1	1			
28	561827	O-ring	1	1	1	1						1	1	1	1			

118.00

CLICK HERE TO **DOWNLOAD** THE COMPLETE MANUAL

- Thank you very much for reading the preview of the manual.
- You can download the complete manual from: [www.heydownloads.com](http://www.heydownloads.com) by clicking the link below



- Please note: If there is no response to CLICKING the link, please download this PDF first and then click on it.

CLICK HERE TO **DOWNLOAD** THE COMPLETE MANUAL