

H20PU40-PE2

PARTS BOOK

KOMATSU

H20PU40

GASOLINE ENGINE

manufactured by NISSAN MOTOR CO., LTD.

for KOMATSU FORKLIFT TRUCK
MODELS FG20-6 AND FG25-6

 **KOMATSU, LTD.**

H20PU40 GASOLINE ENGINE

H20PU40

CLICK HERE TO **DOWNLOAD** THE COMPLETE MANUAL

- Thank you very much for reading the preview of the manual.
- You can download the complete manual from: www.heydownloads.com by clicking the link below



- Please note: If there is no response to CLICKING the link, please download this PDF first and then click on it.

CLICK HERE TO **DOWNLOAD** THE COMPLETE MANUAL

CYLINDER BLOCK AND OIL FILTER

図書索引番号 Fig. & Index No.	品番 Part No.	品名 Description	個数 Qty	通用号機 Serial No.	備考 Remarks
I - 1	11010-J0100	ASS'Y-BLOCK, cylinder	1		
2	12294-78201	. BOLT-main bearing cap (L=77 mm)	10		
3	9-33135	. PLUG-welch	6		
4	15042-20100	. BUSHING-oil pump drive spindle	1		
5	13002-71200	. SET-BUSHING, camshaft	1		
6	89-31302-1	PLUG-taper thread (oil gallery)	1		
	11023-78200	PLUG-taper	1		
6-1	22954-25500	CONNECTOR, straight	1		
7	82-23835-1	STUD	2		(to fix fuel pump)
8	82-27030-1	STUD	2		(to fix oil filter)
9	12289-14600	SEAL-oil, rear bearing cap side	2		
10	12279-32200	SEAL-oil, crank shaft	2		
11	10005-E0700	SLINGER-engine front	1		
	10006-32200	SLINGER-engine rear	1		
12	81-21014-1	BOLT	1		
13	15146-12200	GUIDE-oil level gauge	1		
14	15140-66000	ASS'Y-GAUGE, oil level	1		
15	25240-89910	COMP.-SWITCH, oil pressure	1		
16	15208-13212	ASS'Y-ELEMENT, oil filter	1		
17	15238-78200	ASS'Y-BRACKET, oil filter	1		
18	15239-E0700	GASKET-oil filter	1		
19	89-11240-1	NUT	2		
20	89-15140-1	WASHER-lock	2		
21	89-15440-1	WASHER-plain	2		

CAMSHAFT AND VALVE MECHANISM

図書索引番号 Fig. & Index No.	品番 Part No.	品名 Description	個数 Qty	適用号機 Serial No.	備考 Remarks
5 - 28	13226-78200	SCREW-set, rocker shaft	1		
29	13256-58000	SPRING-inside, rocker shaft	3		
30	13258-78200	ROCKER-valve (R. H)	4		
31	13259-78200	ROCKER-valve (L. H)	4		
32	13235-78200	NUT-valve rocker	8		
33	13234-78200	SCREW-adjusting, valve rocker	8		
34	9-21225	PIN-cotter	2		
35	13255-58000	SPRING-outside, valve	2		
36	13289-58000	WASHER-rocker shaft	2		
37	13238-12200	ROD-push	8		
38	13231-32200	LIFTER-valve	8		

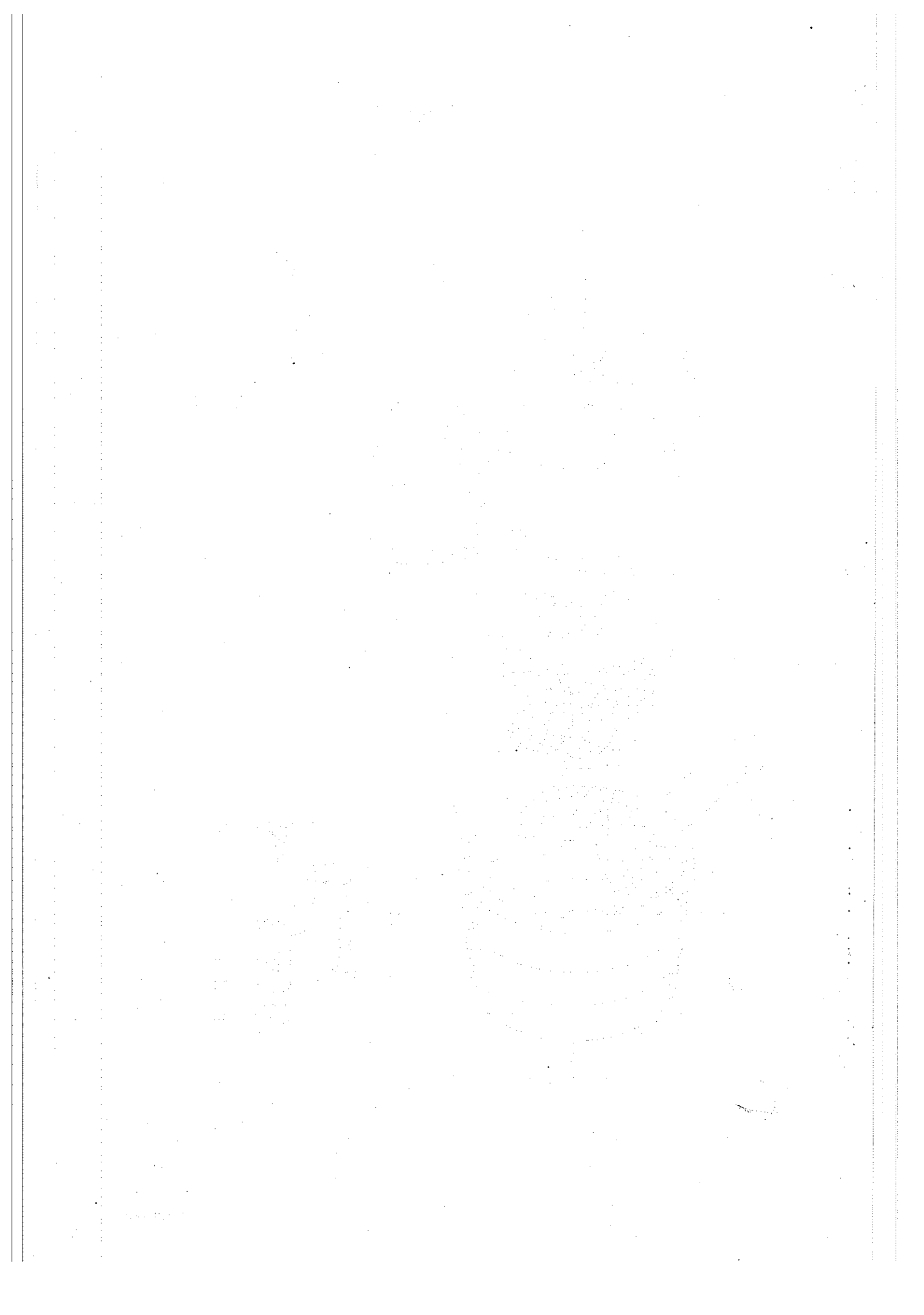
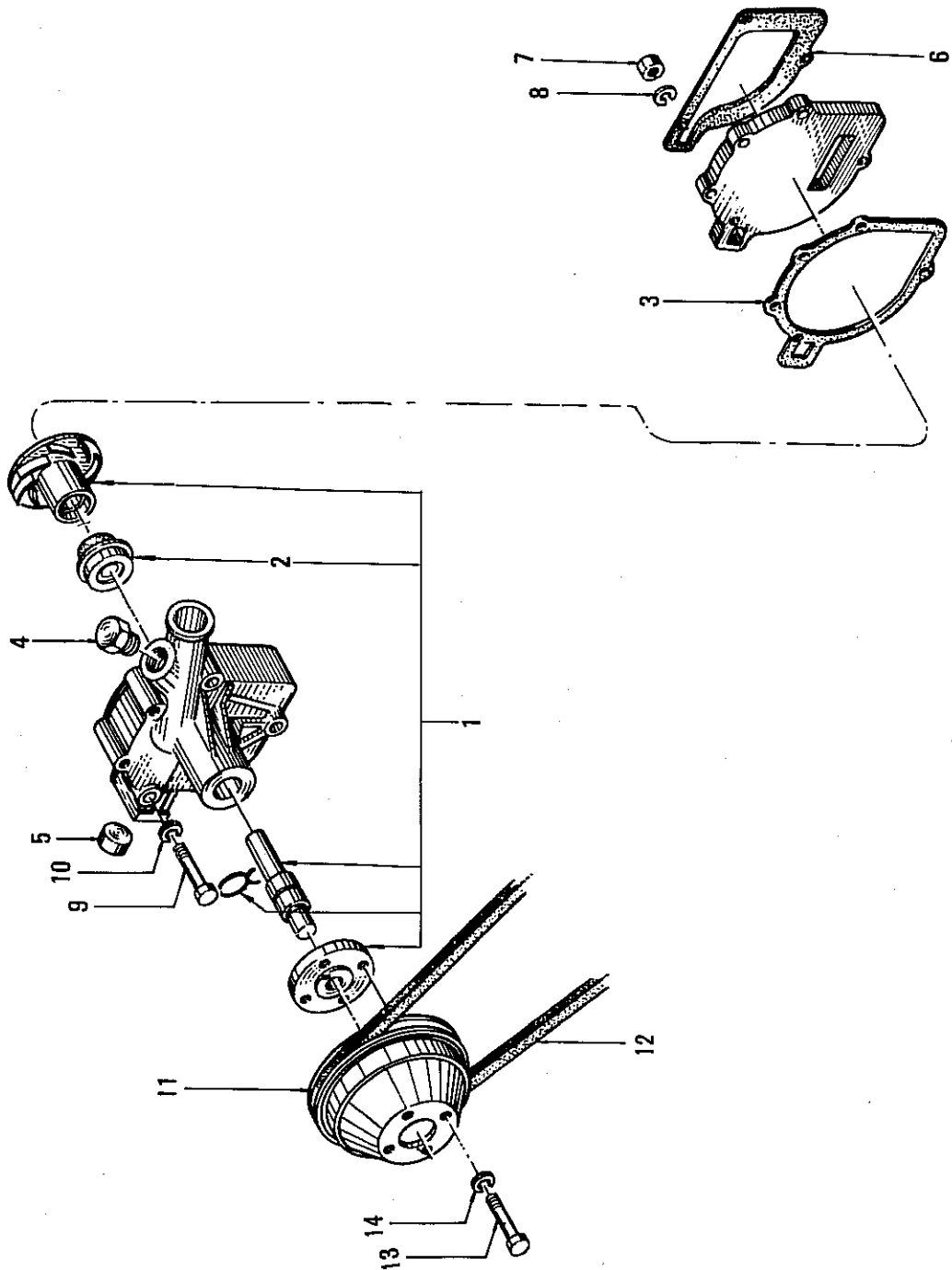

Fig.12 WATER PUMP



STARTER MOTOR(HITACHI)

图号 索引号 Fig. & Index No.	品番 Part No.	品名 Description	個数 Qty	適用号機 Serial No.	備考 Remarks
	23300-15805	ASS'Y-MOTOR, starter (S114-91K)	1		
17 - 1	23310-15801	. ASS'Y-ARMATURE	1		
2	23321-09900	. WASHER-thrust	2		
3	23312-10600	. ASS'Y-PINION <i>9T.</i>	1		
4	23369-10600	. STOPPER-pinion	1		
5	23353-10600	. CLIP-stopper	1		
6	23370-09600	. WASHER-stopper	1		
7	23383-10600	. ASS'Y-BEARING	1		
8	23441-10600	. . METAL-bearing	1		
9	23337-10605	. ASS'Y-COVER, rear	1		
10	23338-09900	. . METAL	1		
11	23380-10600	. . BRUSH(+)	2		
12	23379-09900	. . BRUSH(-)	2		
13	23547-10605	. SCREW 3 ϕ	2		
14	23340-15805	. BOLT	2		
15	23318-15805	. ASS'Y-CASE, gear	1		
16	23319-10600	. . METAL	1		
17	23322-10600	. ASS'Y-LEVER, pinion shaft	1		
18	23323-10600	. . PIN-lever shaft	1		
19	23391-43300	. . PIN-cotter 1.6 ϕ	1		
20	23306-15800	. ASS'Y-COIL, fiel	1		
21	23305-09500	. SCREW-SET, pole core	4		
22	23343-15805	. ASS'Y-SWITCH, magnetic	1		
23	23445-15800	. COVER-dust	1		
24	23446-15800	. PACKING	1		
25	23390-18005	. BOLT 5 ϕ	2		
26	23309-15805	. ASS'Y-COVER, brush	1		
27	23132-10605	. SCREW 4 ϕ	1		
28	81-21035-1	BOLT-hex. M10 1.5	2		
29	89-15240-1	WASHER-lock M10	2		

CLICK HERE TO **DOWNLOAD** THE COMPLETE MANUAL

- Thank you very much for reading the preview of the manual.
- You can download the complete manual from: www.heydownloads.com by clicking the link below



- Please note: If there is no response to CLICKING the link, please download this PDF first and then click on it.

CLICK HERE TO **DOWNLOAD** THE COMPLETE MANUAL