

# **PARTS MANUAL**

---

**S50CT  
(A267)**

**CUSTOMER EDITION**

---

***HYSTER***

CLICK HERE TO **DOWNLOAD** THE COMPLETE MANUAL

- Thank you very much for reading the preview of the manual.
- You can download the complete manual from: [www.heydownloads.com](http://www.heydownloads.com) by clicking the link below



- Please note: If there is no response to CLICKING the link, please download this PDF first and then click on it.

CLICK HERE TO **DOWNLOAD** THE COMPLETE MANUAL

### HOW TO USE THE ILLUSTRATED PARTS MANUAL

This parts manual describes and illustrates assemblies, subassemblies, and detail parts needed for service replacement.

The different constructions are indicated by keys and footnotes. The callouts correspond to descriptions found on the next page.

**HYSTER** UNIT CODE D001 NORTH AMERICA 06/2001

**TABLE OF CONTENTS**

DESCRIPTION	PAGE
AIR INTAKE AND FILTER DIESEL (→ D/B 11/98).....	3-22
AIR INTAKE AND FILTER DIESEL (D/B 11/96 →).....	
AIR INTAKE AND FILTER GASOLINE AND LPG.....	
ALTERNATOR GASOLINE, LPG, AND DIESEL.....	
ALTERNATOR TYPES GS, LPS, AND DS.....	
AUXILIARY FUNCTION TUBE TWO AND THREE STAGE FULL P.....	

**SECTION 13 NUMERICAL INDEX**

PART NO.	PAGE	ITEM NO.	PART NO.	PAGE	ITEM NO.	PART NO.	PAGE	ITEM NO.	PART NO.	PAGE	ITEM NO.
142	3-4	19	10-13	25		11-27	29	12-31	12		
12445	3-32	19	10-17	6		11-31	25	16719	3-36		5
	3-34	1	10-27	11		11-32	37	16751	3-16		27
			11	11		8-4	29	16849	3-34		21
			11	6	16485	8-4	45	16863	3-36		20
			12	13		8-8	34	16865	3-28		17
			12	6		9-7	9	16882	3-6		18
			3	17		9-7	19		4-27		41
			9	10		9-11	9		9-7		30
			9	10		9-11	17		10-10		36
			23	46		10-9	21		10-13		32
			27	46		10-9	28		11-7		24
			26	14		10-13	16		11-9		17
			28	14		11-7	19				
			50	14							

**SECTIONS**

- 1
- 2
- 3
- 4
- 5 BRAKE/ACC
- 6
- 7 MAST-TWO STAG
- 8 MAST-THREE ST
- 9 MAST-TWO ST
- 10
- 11

**TRANSMISSION HOUSING**  
S/N D001H-2628

**KEY:**  
A: Diesel  
B: Gasoline and LPG

ITEM	PART NO.	DESCRIPTION	QTY	
			A	B
		Transmission	1	1
	2022547	Transmission	1	1
	2023329	Case	2	2
1	2021670	Bearing Cap	4	4
2	2023418	Washer	1	1
3	296429	Bolt	2	2
4	293947	Cover	2	2
5	2021390	Colter Pin	4	4
6	1371656	O-Ring	1	1
7	2021329	Plug	4	4
8	2021915	Housing	22	22
9	2021675	Pin	39	39
10	2021336	Bolt	1	1
11	287860	Lockwasher	1	1
12	292682	Hydraulic Pump	1	1
13		Figure 5-3	8	8
14	2021345	Gasket	1	1
15	214364	Bolt	1	1
16	296418	Washer	1	1
17	2021388	Temperature Switch	1	1
18	2021389	Breather	9	9
19	2021383	Dipstick	9	9
20	292515	Bolt	2	2
21	136692	Nut	3	3
22	292527	Bolt	3	2
23	292531	Capscrew	4	4
24	292583	Lockwasher	4	4
25	293637	Bolt	1	1
26	296420	Washer	1	1
	996403	Transmission Kit (Includes Item 7)	1	1
	996405	Transmission Kit (Includes Item 14)	1	1

This Parts Manual is divided into 11 major sections which are listed above. Quick be made by placing the right thumb on the tab of the desired section, bending the pages to the corresponding tab.

© Copy Right Date HYSTER COMPANY See Service Manual for service procedures. 5-15







**FULL SUSPENSION SEAT  
RECLINER AND DAMPER KITS – SHEET 2 OF 3**

ITEM	PART NO.	DESCRIPTION	QTY
1	<b>a</b> 1703891	Kit-Recliner (Back Seat Adjustment) .....	1
2	.....	Knob .....	1
3	.....	Lever .....	1
4	1482905	Plate .....	1
5	.....	Spring .....	1
6	1482906	Latch .....	1
7	1367150	Nut .....	2
8	1703890	Kit-Damper Service .....	1
9	1584632	Damper .....	1
10	1367150	Nut .....	2
11	1584638	Bolt .....	2

**FOOTNOTES:**

- a** Included with Seat and Non Swivel/Swivel Sets

**COOLING SYSTEM**

ITEM	PART NO.	DESCRIPTION	QTY
1	4003831	Bracket .....	1
2	1529787	Isolator .....	4
3	2060012	Radiator .....	1
3	178899	Radiator Cap .....	1
3	1528495	Drain Plug .....	1
3	4606169	Fitting .....	2
3	252729	O-Ring .....	1
3	1546684	O-Ring .....	1
4	1530243	Insert .....	4
5	1583611	Capscrew .....	4
6	4605247	Hose (Upper) .....	1
7	369804	Clamp .....	4
8	2059211	Radiator Hose .....	1
9	4009618	Shroud .....	1
10	14385	Fitting .....	1
10	246108	Sealant .....	1
11	1329240	Hose .....	1
12	369815	Clamp .....	2
13	1633307	Reservoir .....	1
14	345455	Outlet Assembly .....	1
15	1663877	Hose .....	1
16	345453	Outlet (Reservoir) .....	1
17	345454	Cap .....	1
18	336550	Bushing .....	1
19	293614	Capscrew .....	4
20	296418	Washer .....	4
21	2101978	Fan .....	1

**TIMING GEAR COVER AND OIL PAN**  
**MAZDA 2.0L AND 2.2L, LPG – 2010 EMISSION COMPLIANT ENGINES**

ITEM	PART NO.	DESCRIPTION	QTY
	1652301	Long Block (2.0L LPG) .....	1
	1652305	Long Block (2.2L) .....	1
1	1362001	Bolt .....	5
2	1553716	Cover (Upper Timing Belt) (2.0L) .....	1
2	2029084	Cover (Upper Timing Belt) (2.2L) .....	1
3	1553717	Gasket (2.0L) .....	1
3	2028854	Gasket (2.2L) .....	1
4	1553715	Housing (2.0L) .....	1
4	1361688	Oil Seal .....	1
4	2051129	Housing (2.2L) .....	1
5	1362012	Stud .....	2
6	1361692	Connector .....	1
7	1361875	Screw .....	2
8	326504	Nut .....	2
9	1361679	Gasket .....	1
10	1361689	Cover .....	1
11	1361691	Oil Seal (Rear) .....	1
12	1362010	Pin .....	2
13	1362011	Bolt .....	6
14	1371652	Cover (Lower) .....	1
15	1361690	Gasket .....	1
16	1361680	Oil Pan (2.0L) .....	1
16	2029082	Oil Pan (2.2L) .....	1
17	1362015	Gasket .....	1
18	1361681	Drain Plug .....	1
19	1370736	Capscrew .....	19
20	2051128	Cover .....	1
21	2028853	Gasket .....	1
22	2029086	Bolt .....	1
	2045036	Kit-Gasket .....	1



**AIR INTAKE SYSTEM**

ITEM	PART NO.	DESCRIPTION	QTY
1	2067476	Grill .....	1
2	2091232	Hose (PCV) .....	1
3	1501994	Hose Clamp .....	1
4	1640814	Coupler (PCV) .....	1
5	112989	Hose Clamp .....	4
6	2085259	Hose (Air Intake) .....	1
7	<del>2060843</del> 4611249	Air Filter (☞ Figure 3-2).....	1
8	1501848	Bracket .....	1
9	1583611	Capscrew .....	3
10	1530243	Insert .....	3
11	1527879	Capscrew .....	2
12	<del>2091234</del> 2085421	Hose (Clean Air) .....	1
13	1452463	Hose Clamp .....	1

**FUEL SYSTEM HOSES AND ATTACHING PARTS**  
**MAZDA 2.0L AND 2.2L LPG – 2010 EMISSION COMPLIANT ENGINES**

ITEM	PART NO.	DESCRIPTION	QTY
1	1650780	Hose Conduit .....	1
2	1650779	Hose (Vacuum Balance) .....	1
3	1614770	Hose Clamp .....	2
4	4015023	Hose Clamp .....	1
5	1650781	Hose (Fuel) .....	1
6	1650791	Hose Conduit .....	1
7	1650785	Hose (Vacuum) .....	1
8	4015021	Hose Clamp .....	4
9	1650784	Hose (RH) (Cooling) .....	2
10	1653901	Clamp .....	2
11	1527876	Capscrew .....	3
12	<del>1655235</del>		
	1653900	Clamp .....	1
13	1650762	Bracket .....	1
14	1650789	Bracket .....	1
15	4015022	Hose Clamp .....	1

**THROTTLE PEDAL AND ATTACHING PARTS**  
(→ S/N A267V01842K)

ITEM	PART NO.	DESCRIPTION	QTY
1	1654411	Throttle Plate .....	1
2	1654754	Shaft .....	1
3	1530971	E-Ring .....	1
4	1527879	Capscrew .....	3
5	1530311	Screw (Stop) .....	1
6	329069	Nut .....	1
7	2071181	Pedal (Standard) .....	1
8	302443	Roll Pin .....	1
9	1582301	Spring (Inner) .....	1
10	1582300	Spring (Outer) .....	1
11	2063842	Sensor (Hall Throttle Position) .....	1
12	296378	Washer .....	2
13	1564752	Capscrew .....	2



**WIRE HARNESS**  
**RH CHASSIS – SHEET 1 OF 2 (→ S/N A267V01685J)**

ITEM	PART NO.	DESCRIPTION	QTY
	4603285	Wire Harness .....	1
1	.....	Connector Assembly (Brake Pedal) .....	1
1	1700460	Connector .....	1
1	1700461	Terminal .....	3
2	275493	Conduit .....	AR
3	1402816	Clip .....	1
4	275495	Conduit .....	AR
5	1402815	Clip .....	1
6	1500900	Clip .....	2
7	275496	Conduit .....	AR
8	.....	Connector Assembly (Horn Button) .....	1
8	1490242	Connector (2 Way) .....	1
8	1330438	Terminal (Socket) .....	2
8	1490243	Connector .....	1
9	.....	Connector Assembly (Display) .....	1
9	1525567	Connector .....	1
9	1463139	Terminal .....	9
9	1484377	Plug .....	3
9	1529046	Connector (Secondary Lock) .....	1
10	1566117	Dust Cap (For Diagnostic Cable) .....	1
10	1463849	Lubricant .....	AR
11	.....	Connector Assembly (Diagnostic) .....	1
11	1566116	Connector .....	1
11	1330438	Terminal (Socket) .....	3
11	1532664	Connector .....	1
12	1534329	Clip .....	3
13	275497	Conduit .....	AR
14	.....	Connector Assembly (Buzzer) .....	1
14	2101546	Buzzer .....	1
15	.....	Connector Assembly (Hydraulic Lockout Solenoid 1) .....	1
15	1484557	Connector (2 Socket) .....	1
15	1463139	Terminal .....	2
15	1484558	Connector .....	1
16	.....	Connector Assembly (Accelerator Pedal Sensor) .....	1
16	1525584	Connector .....	1
16	1532571	Terminal .....	6
17	.....	Connector Assembly (Brake Fluid) .....	1
17	1324310	Terminal .....	1
17	1324309	Sleeve .....	1
18	.....	Connector Assembly (Brake Fluid) .....	1
18	1324310	Terminal .....	1
18	1324309	Sleeve .....	1
19	.....	Connector Assembly (Park Brake) .....	1
19	1700460	Connector .....	1
19	1700461	Terminal .....	3

ITEM	PART NO.	DESCRIPTION	QTY
12	1402888	Seal .....	1
12	1521188	Lock .....	1
13	.....	Connector Assembly (Engine Harness) .....	1
13	1500925	Connector .....	1
13	1330437	Terminal (Pin) .....	12
14	.....	Connector Assembly (Engine Harness) .....	1
14	1514597	Connector .....	1
14	1330439	Plug .....	2
14	866401	Terminal .....	2
14	1514598	Connector .....	1
14	1352603	Secondary Lock .....	1
15	.....	Connector Assembly (Seat Belt Switch Harness) .....	1
15	1493465	Connector (2 Pin) .....	1
15	1330414	Connector (Secondary Lock) .....	1
15	1330437	Terminal (Pin) .....	2

**WIRE HARNESS**  
**LIGHTS WITH REVERSE ACTIVATED REAR WORK LIGHTS**

ITEM	PART NO.	DESCRIPTION	QTY
	4619184	Wire Harness .....	1
1	.....	Connector Assembly (PDM) .....	1
1	4008684	Connector .....	1
1	1521188	Lock .....	1
1	1330281	Terminal .....	6
1	1327164	Seal .....	2
1	1323579	Seal .....	6
2	.....	Connector Assembly (RH Front Work Light) .....	1
2	1490242	Connector (2 Way) .....	1
2	1490243	Connector .....	1
2	1330438	Terminal (Socket) .....	2
3	.....	Connector Assembly (Diode Pack) .....	1
3	2094490	Kit-Diode .....	1
3	1489656	Connector (4-Way) .....	1
3	1330438	Terminal (Socket) .....	2
3	1484377	Plug .....	2
3	1489657	Connector .....	1
4	.....	Connector Assembly (Strobe Light) .....	1
4	1484557	Connector (2 Socket) .....	1
4	1484558	Connector .....	1
4	1463139	Terminal .....	2
5	.....	Connector Assembly (Rear Work Light) .....	1
5	1490242	Connector (2 Way) .....	1
5	1490243	Connector .....	1
5	1330438	Terminal (Socket) .....	2
6	.....	Connector Assembly (LH Front Work Light) .....	1
6	1490242	Connector (2 Way) .....	1
6	1490243	Connector .....	1
6	1363886	Terminal (Socket) .....	2
7	1509890	Clip .....	1
8	1509888	Clip .....	1

**TRANSMISSION MOUNT (FIGURE 5-4)  
SINGLE SPEED — ALUMINUM CHAIN DRIVE (S/N A267V02065L →)**

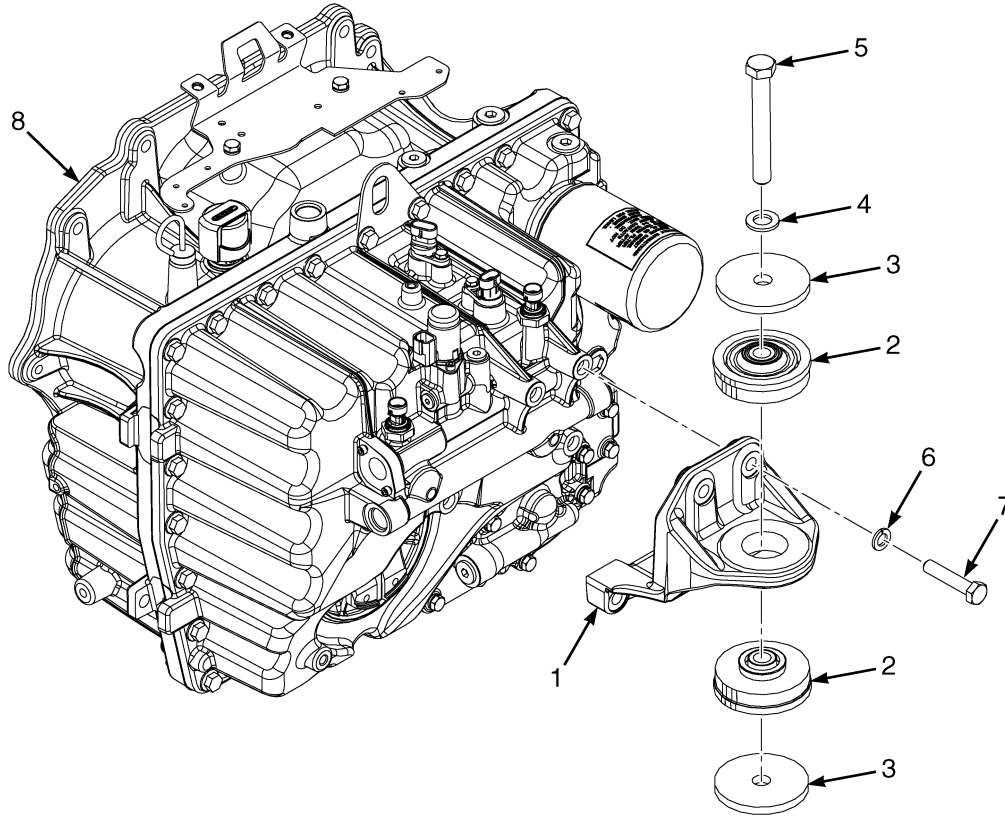

BP240237

ITEM	PART NO.	DESCRIPTION	QTY
1	1697672	Bracket .....	1
2	2070147	Isolator .....	2
3	4085524	Washer .....	2
4	320165	Washer .....	1
5	293697	Capscrew .....	1
6	292683	Lockwasher .....	4
7	292531	Capscrew .....	4
8	4043335	Transmission Assy (Without Speed Sensors) (☞ Figure 5-9, ☞ Figure 5-8).....	1
	264134	Loctite .....	AR

CLICK HERE TO **DOWNLOAD** THE COMPLETE MANUAL

- Thank you very much for reading the preview of the manual.
- You can download the complete manual from: [www.heydownloads.com](http://www.heydownloads.com) by clicking the link below



- Please note: If there is no response to CLICKING the link, please download this PDF first and then click on it.

CLICK HERE TO **DOWNLOAD** THE COMPLETE MANUAL

**TORQUE CONVERTER HOUSING AND ATTACHING PARTS**  
**SINGLE SPEED, ALUMINUM CHAIN DRIVE (2/2011 →)**

ITEM	PART NO.	DESCRIPTION	QTY
	<b>a</b> 4020057	Transmission Assy .....	1
	<b>b</b> 4043335	Transmission Assy .....	1
1	4016150	Converter Housing .....	1
2	1624401	Dipstick .....	1
3	1632741	Breather .....	1
4	<del>1589792</del> 235691	Fitting .....	1
5	1703644	Plug .....	1
6	233693	Fitting .....	3
7	1515654	Temperature Sensor .....	1
8	292500	Capscrew .....	2
9	292680	Washer .....	2
10	1702520	Cover .....	1
11	334560	Magnet .....	1
12	334450	Screen .....	1
13	1688598	Spring .....	1
14	43207	Ball Bearing .....	1
15	4016152	Sprocket .....	1
16	4020467	Drive Chain .....	1
17	4020466	Drive Chain .....	1
18	4010318	Sprocket .....	1
19	44307	Ball Bearing .....	1
20	39375	O-Ring .....	1
21	1558515	Fitting .....	1
22	58916	Snap Ring .....	1
23	44308	Ball Bearing .....	1
24	1684389	Transmission Gear .....	1
25	43208	Ball Bearing .....	8
26	1675647	Housing Stator Support (☞Figure 5-10).....	1
27	287860	Capscrew .....	4
28	<del>388049</del> 292682	Lockwasher .....	4
29	104681	O-Ring .....	2
30	1544218	Sealing Ring .....	1
31	4016151	Sprocket .....	1
32	1544216	Bearing .....	1
33	1544217	Oil Seal (Torque Converter) .....	1
34	173056	Roll Pin .....	2
35	4020311	Plate .....	1
36	292679	Washer .....	2
37	<del>384279</del> 293741	Capscrew .....	2
38	145481	O-Ring .....	1

**FOOTNOTES:****a** → S/N A267V02064L**b** S/N A267V02065L →

**COUNTER/REVERSE CLUTCH  
SINGLE SPEED TRANSMISSION**

ITEM	PART NO.	DESCRIPTION	QTY
	1676324	Clutch Pack .....	1
1	.....	Seal .....	2
2	1581416		
	4025477	Ball Bearing .....	2
3	4007888	Shaft .....	1
4	.....	Seal .....	1
5	.....	Seal .....	1
6	2085129	Piston .....	1
7	1581108	Spring .....	1
8	1581098	Spring .....	1
9	1581099	Spring Guide .....	1
10	1581100	Snap Ring .....	1
11	.....	Conical Plate .....	1
12	.....	Friction Plate .....	5
13	.....	Separator Plate .....	4
14	1543094	Pressure Plate (5.8 mm) .....	1
15	.....	O-Ring .....	1
16	1537450	Snap Ring .....	1
17	124603	Ball Bearing .....	1
18	1581107	Snap Ring .....	1
19	1537459	Snap Ring .....	1
20	4007889	Clutch Gear .....	1
21	43207	Ball Bearing .....	1
	1543102	Kit-Clutch Pack Plates .....	1
	1595425	Kit-Clutch Pack Seals .....	1

**CENTER SECTION**

ITEM	PART NO.	DESCRIPTION	QTY
	4002604	Drive Axle Center Section (Assembly) .....	1
1	.....	Center Section Housing .....	1
2	2021288	Radial Roller Bearing .....	2
3	4002527	Nut .....	2
4	293762	Capscrew .....	2
5	1523479	Ball Bearing .....	2
6	1517578	Gear .....	1
7	1516535	Housing .....	1
8	1522377	Oil Seal .....	1
9	2022352	Tapered Roller Bearing .....	1
10	1530588	Washer .....	1
11	1516536	Cover (Pinion) .....	1
12	1527879	Capscrew .....	5
13	2026861	Nut .....	1
14	1510114	Capscrew .....	9
15	302385	Dowel .....	2
16	4004475	Gear .....	1
17	4004468	Sleeve .....	1
18	2028862	Tapered Roller Bearing .....	1
19	1520755	Shim (0.04 in.) .....	1
20	1569913	Shim (0.009 in.) .....	1
21	1520752	Shim (0.012 in.) .....	1
22	1569914	Shim (0.014 in.) .....	1
23	1520753	Shim (0.016 in.) .....	1
24	1569915	Shim (0.018 in.) .....	1
25	1520754	Shim (0.19 in.) .....	1
26	1569912	Shim (0.008 in.) .....	1
27	293630	Capscrew .....	11
28	4002491	Cover .....	1
29	1683651	O-Ring .....	1
30	2021286	Bolt .....	12
31	2054381	Differential .....	1
32	1598536	Kit-Gear .....	2
33	1565325	Washer .....	2
34	1593763	Shaft .....	1
35	1593694	Cotter Pin .....	1
36	2054792	Gear and Pinion .....	1
	1584621	Sealant .....	1
	264159	Adhesive .....	1

**STEER AXLE AND ATTACHING PARTS**

ITEM	PART NO.	DESCRIPTION	QTY
	4001864	Steering Axle .....	1
1	1524921	Steering Axle .....	1
2	2055917	Steering Cylinder (☞ Figure 7-4).....	1
3	39352	O-Ring .....	2
4	1502277	King Pin .....	2
5	226986	Pin .....	2
6	300767	Spacer .....	2
7	264973	Seal .....	2
8	156194	Bearing Cup .....	4
8	1374815	Bearing Set (Optional) .....	4
9	156195	Bearing Cone .....	4
10	1524916	Spindle (LH) .....	1
11	15245	Cotter Pin .....	2
12	249289	Nut .....	2
13	300766	Sleeve .....	2
14	98525	Oil Seal .....	2
15	13957	Grease Fitting .....	6
16	<b>a</b> 1524923	Tie Rod .....	2
16	<b>b</b> 4028349	Tie Rod .....	2
17	1524914	Spindle (RH) .....	1
18	58903	Snap Ring .....	8
19	300752	Spherical Washer .....	8
20	300751	Bushing .....	4
21	1568271	Pin .....	4
22	293686	Capscrew .....	4
23	2060696	Rubber Mount .....	2
24	4004500	Plate .....	2
25	316826	Nut .....	4
26	1527886	Capscrew .....	4
27	1388838	Rubber Mount .....	1
28	2021898	Seal .....	2
29	1375472	Tapered Roller Bearing .....	2
29	2021803	Bearing Set (Optional) .....	2
30	1531171	Tapered Roller Bearing .....	2
30	2021802	Bearing Set (Optional) .....	2
31	1536250	Washer .....	2
32	249289	Nut .....	2
33	15245	Cotter Pin .....	2
34	2021800	Cap .....	2
35	320159	Washer .....	4
	1584621	Sealant .....	AR

**FOOTNOTES:****a** → 3/2011**b** 4/2011 →

**BRAKE PEDAL LINKAGE**

ITEM	PART NO.	DESCRIPTION	QTY
1	2314223	Reservoir .....	1
1	2021341	Cap .....	1
1	2077604	Tank .....	1
1	2021343	Packing .....	1
2	1510126	Screw (Button Head) .....	2
3	<del>1307884</del>		
	1514429	Nut .....	2
4	1699992	Mount .....	1
5	2021353	Holder .....	1
6	1502003	Hose Clamp .....	2
7	1531569	Hose .....	1
8	1543698	Clamp (Swivel) .....	1
9	1543842	Clamp .....	1
10	2059937	Hose Assy .....	1
11	4009385	Master Cylinder .....	1
12	1544153	Locknut .....	2
13	1527881	Capscrew .....	2
14	325897	Clamp .....	1
15	1527879	Capscrew .....	2
16	1688503	Mount .....	1
17	1683486	Sensor (Brake Position) .....	1
18	1701768	Screw .....	2
19	302398	Locknut .....	2
20	1529366	Capscrew .....	1
21	1556475	Bumper .....	1
22	239503	Nut .....	1
23	1534871	Bolt .....	1
24	1585575	Bushing .....	2
25	1704902	Capscrew .....	1
26	292668	Nut .....	2
27	1375391	Pin (Rod End) .....	1
28	1351689	Locking Cotter Pin .....	1
29	1707007	Brake Pedal .....	1
30	1570298	Rubber Pad .....	1
31	1568075	Spring (RH) .....	1
32	<del>1594950</del>		
	4053949	Plate .....	1
	2064554	Loctite .....	1
	<b>a</b> 2111171	Wire Harness (Jumper) (Brake Sensor/Cowl Harness) .....	1

**FOOTNOTES:****a** Not Illustrated

**GEAR PUMP ASSEMBLY**

ITEM	PART NO.	DESCRIPTION	QTY
	2098695	Gear Pump .....	1
1	.....	Gear Plate .....	1
2	.....	Drive Gear .....	1
3	.....	Driven Gear .....	1
4	1581536	Flange .....	1
5	1578665	Cover .....	1
6	1578673	Side Plate .....	2
7	.....	Plate Seal .....	2
8	.....	Back-Up Ring .....	2
9	.....	Oil Seal .....	1
10	.....	Snap Ring .....	1
11	1578671	Screw .....	4
12	1578672	Dowel .....	4
	1581537	Gear Set .....	1
	1465140	Kit-Seal .....	1

**TILT CYLINDER ASSEMBLY****KEY:****A: -5 degrees forward/5 degrees back****B: 10 degrees forward/5 degrees back**

ITEM	PART NO.	DESCRIPTION	QTY	
			A	B
	4601682	Tilt Cylinder .....	2	..
	4601683	Tilt Cylinder .....	..	2
1	4601850	Tube Wldmt-Cylinder .....	1	..
1	4601851	Tube Wldmt-Cylinder .....	..	1
2	2302899	Locknut .....	1	1
4	2044370	Piston Seal .....	1	1
5	1338741	Piston .....	1	1
6	1389592	Spacer .....	1	..
6	.....	Spacer .....	..	1
7	46388	O-Ring .....	1	1
8	1381082	Rod Seal .....	1	1
9	154375	Back-Up Ring .....	1	1
10	1383062	Rod Wiper .....	1	1
11	1338744	Gland .....	1	1
12	.....	Cylinder Rod .....	1	1
	1492644	Kit-Seal .....	1	1

**CONTROL VALVE LOCKOUT GROUP  
MANUAL CONTROL VALVE**

**KEY:**

**A: 3 Function**

**B: 4 Function**

ITEM	PART NO.	DESCRIPTION	QTY	
			A	B
1	1683529	Solenoid Assembly (Double Function) .....	1	2
2	1683621	Solenoid Assembly (Single Function) .....	1	..
3	18748	Capscrew .....	4	4
4	1670413	Needle Roller .....	3	4
5	.....	Manual Control Valve (☞ Figure 9-10, ☞ Figure 9-11).....	1	1
	a 1543842	Clamp .....	..	1
	a 1573549	Clamp .....	..	1
	a 4031956	Clip .....	..	1

**FOOTNOTES:**

**a** Not Illustrated



**MAIN CYLINDER  
TWO STAGE LIMITED FREE LIFT**

**LEFT HAND**

ITEM	DESCRIPTION 1 2 3 4	LIFT HEIGHT TO BOTTOM OF FORKS
		2032 mm (80.0 in.)
	<b>Mast Group Number</b>	<b>A699 2032</b>
	<b>Cylinder Group Number</b>	<b>8601643</b>
	Cylinder Assy	4619880
1	Tube Wldmt- Cylinder	2304117
2	Cylinder Rod	2308924
3	Spacer	2306250

**RIGHT HAND**

ITEM	DESCRIPTION 1 2 3 4	LIFT HEIGHT TO BOTTOM OF FORKS
		2032 mm (80.0 in.)
	<b>Mast Group Number</b>	<b>A699 2032</b>
	<b>Cylinder Group Number</b>	<b>8601693</b>
	Cylinder Assy	4619563
1	Tube Wldmt- Cylinder	2308856
2	Cylinder Rod	2308924
3	Spacer	2306250

**KEY:**

**A: Right Hand**

**B: Left Hand**

ITEM	PART NO.	DESCRIPTION	QTY	
			A	B
	<b>a . . . . .</b>	Cylinder Assy .....	1	1
1	<b>a . . . . .</b>	Tube Wldmt-Cylinder .....	1	1
2	<b>a . . . . .</b>	Cylinder Rod .....	1	1
3	<b>a . . . . .</b>	Spacer .....	1	1
4	1371653	Gland .....	1	1
5	257913	Check Valve .....	1	1
5	39348	O-Ring (Check Valve) .....	1	1
6	297531	Washer .....	1	1
7	322902	Wear Ring .....	1	1
8	187388	Snap Ring .....	1	1
9	322824	Back-Up Ring .....	2	2





**MAIN LIFT CYLINDER ASSEMBLY  
THREE STAGE FULL FREE LIFT****LEFT HAND**

ITEM	DESCRIPTION 1 2 3 4	LIFT HEIGHT TO BOTTOM OF FORKS		
		4285 mm (168.7 in.)	4735 mm (186.4 in.)	5035 mm (198.2 in.)
		Mast Group Number	A698 4285	A698 4735
	Cylinder Group Number	8803211	8803212	8803213
	Cylinder Assy	4606969	4606968	4606967
1	Tube Wldmt- Cylinder	4606922	4606923	4606924
2	Rod	4606962	4606963	4606964
3	Spacer	2310682	2310682	2310682

**RIGHT HAND**

ITEM	DESCRIPTION 1 2 3 4	LIFT HEIGHT TO BOTTOM OF FORKS		
		4285 mm (168.7 in.)	4735 mm (186.4 in.)	5035 mm (198.2 in.)
		Mast Group Number	A698 4285	A698 4735
	Cylinder Group Number	8803214	8803215	8803216
	Cylinder Assy	4606970	4606966	4606965
1	Tube Wldmt- Cylinder	4606925	4606926	4606927
2	Rod	4606962	4606963	4606964
3	Spacer	2310682	2310682	2310682

ITEM	PART NO.	DESCRIPTION	QTY
	a . . . . .	Cylinder Assy .....	1
1	a . . . . .	Tube Wldmt-Cylinder .....	1
2	a . . . . .	Rod .....	1
3	a . . . . .	Spacer .....	1
4	1371653	Gland .....	1
5	257913	Check Valve .....	1
6	. . . . .	O-Ring .....	1
7	297531	Washer .....	1
8	322902	Wear Ring .....	1
9	187388	Snap Ring .....	1
10	330692	Rod Seal .....	1
11	322824	Back-Up Ring .....	2
12	1319668	Rod Wiper .....	1
13	55407	O-Ring .....	1
14	1362871	Wear Ring .....	1





**INTEGRAL SIDE-SHIFT CARRIAGE  
THREE STAGE FULL FREE-LIFT**

ITEM	PART NO.	DESCRIPTION	QTY
	4602115	Side-Shift Carriage .....	1
1	4003822	Carriage Wldmt .....	1
2	1489010		
	4033954	Frame (Outer) (38.5 in.) .....	1
3	2043528	Sideshift Cylinder Assembly (☞Figure 12-8).....	1
4	2043531	Bearing Strip (Upper) .....	2
5	2043533	Bearing Strip (Lower) .....	2
6	<del>2043530</del>		
	4611363	Hook .....	2
7	1581833	Capscrew .....	4
8	1581854	Washer .....	4
9	1401746	Pin .....	2
10	18832	Cotter Pin .....	2
11	1498326	Shim .....	AR
12	16041	Grease Fitting .....	2
13	317735	Pin .....	2
14	1369345	Chain Anchor (Dual Hole) .....	2
14	1504010	Chain Anchor (Single Hole) .....	2
15	131358	Snap Ring .....	4
16	1514866	Pin .....	2
17	15211	Cotter Pin .....	2
18	1363272	Load Roller ("B") (3.24 in.) .....	6
18	1395174	Load Roller ("A") (3.22 in.) (Optional) .....	6
19	129387	Shim (0.020 in.) .....	28
20	366115	Spacer .....	6
21	58901	Snap Ring .....	6



CLICK HERE TO **DOWNLOAD** THE COMPLETE MANUAL

- Thank you very much for reading the preview of the manual.
- You can download the complete manual from: [www.heydownloads.com](http://www.heydownloads.com) by clicking the link below



- Please note: If there is no response to CLICKING the link, please download this PDF first and then click on it.

CLICK HERE TO **DOWNLOAD** THE COMPLETE MANUAL