



Parts Manual

Models

TH336C, TH337C

TH406C, TH407C

S/N MJR00150 thru MJR00270

S/N THM00150

S/N DJB00150 thru DJB00483

S/N SXJ00150 thru SXJ00152

S/N GAT00150 thru GAT00257

S/N MLH00150 thru MLH00842

S/N JJT00150 thru JJT00171

31200730

Revised
December 21, 2017

CLICK HERE TO **DOWNLOAD** THE COMPLETE MANUAL

- Thank you very much for reading the preview of the manual.
- You can download the complete manual from: www.heydownloads.com by clicking the link below



- Please note: If there is no response to CLICKING the link, please download this PDF first and then click on it.

CLICK HERE TO **DOWNLOAD** THE COMPLETE MANUAL

SMCS CODES - TELEHANDLER

1350 ENGINE COOLING SYSTEM

1351 RADIATOR & OIL COOLER
1353 RADIATOR
1354 EXPANSION TANK
1360 FAN GUARD
1374 HYDRAULIC OIL COOLER
1375 TORQUE CONVERTER / TRANSMISSION OIL COOLER
1380 COOLANT HOSE / LINES
1381 RADIATOR AND GUARD
1382 RADIATOR CAP
1384 ENGINE COOLANT HEATER
1386 HYDRAULIC FAN MOTOR
1387 HYDRAULIC FAN PUMP
1395 ENGINE COOLANT

1400 ELECTRICAL SYSTEM

1401 BATTERY
1402 BATTERY CABLE
1408 WIRING HARNESS
1416 START SWITCH
1417 FUSE / CIRCUIT BREAKER PANEL
1428 BACKUP LIGHT(S)
1429 LIGHT(S)
1430 DIRECTIONAL LIGHT
1431 BEACON LIGHT(S)
1432 STOP /LIGHT / TAILLIGHT
1434 CAB LIGHT
1434 FLOODLIGHT

OTHER ENGINE COMPONENTS

1801 ENGINE SOUND SUPPRESSION
1802 REFRIGERANT COMPRESSOR
1805 REFRIGERANT CONDENSER
1807 AIR CONDITIONER COMPRESSOR DRIVE
1808 AIR CONDITIONER LINES
1810 RADIATOR & REFRIGERANT CONDENSER
1812 HEATER / HOSE LINES
1813 RADIATOR HOSE

3000 TRANSMISSION & DRIVE LINE

3013 AXLE ARRANGEMENT
3020 DRIVE & STEERING AXLE
3061 TRANSMISSION GEARS
3063 TRANSMISSION SHAFT
3064 TRANSMISSION CASE
3065 TRANSMISSION CONTROL
3066 TRANSMISSION OIL PUMP
3067 TRANSMISSION OIL FILTER
3068 TRANSMISSION OIL FILTER BASE
3075 TRANSMISSION OUTPUT GEARS
3080 TRANSMISSION OIL
3081 TRANSMISSION OIL LEVEL
3082 TRANSMISSION MOUNT

3100 TORQUE CONVERTER, TORQUE DIVIDER, RETARDER

3101 TORQUE CONVERTER
3115 TORQUE CONVERTER/TRANSMISSION SCAVENGE PUMP
3133 TORQUE CONVERTER RELIEF VALVE
3139 MODULATING VALVE
3141 TORQUE CONVERTER SPEED SENSOR

3030 POWER SHIFT / HYDROSTATIC TRANSMISSION

3063 TRANSMISSION SHAFT
3064 TRANSMISSION CASE
3065 HYDROSTATIC CONTROL LINKAGE (EXTERNAL)
3066 POWER SHIFT TRANSMISSION OIL PUMP
3067 HYDROSTATIC TRANSMISSION OIL FILTER
3073 HYDROSTATIC MAIN CONTROL VALVE
3151 TRANSMISSION GOVERNOR
3154 TRANSMISSION LINES/HOSES
3155 TRANSMISSION CLUTCH
3157 TRANSMISSION SELECTOR VALVE
3159 TRANSFER GEARS
3160 TRANSMISSION PLANETARY
3167 TRANSMISSION HYDRAULIC CONTROL
3168 TRANSMISSION ELECTRONIC CONTROL
3174 SHIFT SOLENOID
3175 TRANSMISSION SPEED SENSOR



Figure 1-1 Frame & Attaching Parts (Continued)

Item	Part Number	Qty.	Description	Rev.
603	336-7619	1	MIRROR ASSY, (Hewden) , (fish eye), (if equipped) , (includes items 651 thru 653)	C
	220-4050	1	MIRROR, (rectangular)	
606	326-6617	1	BRACKET	
607	326-6618	1	BRACKET	
609		AR	LOCTITE® 243™	
610	329-3544	3	SOCKET HD CAPSCREW, M8X45, (torque to 28 Nm/20.65 lb-ft)	
611	8T-4224	3	WASHER, 8mm	
612	5C-7261	3	HEX NUT, M8X1.25	
651	3B-4503	2	LOCKWASHER, #12	
652	8T-0328	2	WASHER	
653	281-0791	2	HEX SOCKET HD CAPSCREW	
	419-0318	Ref	BOOM PROP INSTALL, (not available to order, see items 701 thru 705 for service)	A
701		AR	LOCTITE® 271™	
702	326-2012	6	BOOM PROP BRACKET	
703	9X-6424	2	STUD, M10X1.5X45, (torque to 55 Nm/40.56 lb-ft)	
704	6V-8949	2	WING NUT, M10	
705	329-3624	2	O-RING	
802	8T-7547	4	HEX HD CAPSCREW, M8X30, GR8.8, (Germany)	
803	368-5401	1	WEDGE, (Germany)	
804	368-5402	1	WEDGE HOLDER, (Germany)	
805	5C-7261	4	HEX NUT, M8X1.25, (Germany)	
808	8T-4224	8	WASHER, 8mm, (Germany)	
814		1	TIE DOWN CABLE, (Germany)	
951		Ref	CAB, (see Figure 6-1 for details)	
	495-0132	Ref	COUNTERWEIGHT INSTALLATION, (TH406C) , (includes item 1001 thru 1008)	B
	495-0131	Ref	COUNTERWEIGHT INSTALLATION, (TH407C) , (includes item 1001 thru 1008)	A
1001	7X-2532	1	HEX HD CAPSCREW, M20X130	
1002	8T-4170	2	HEX HD CAPSCREW, M20X150	
1004	7Y-1858	6	WASHER, 20mm	
1005		AR	LOCTITE® 243™	
1006	495-0134	1	COUNTERWEIGHT, (TH406C)	
	495-0133	1	COUNTERWEIGHT, (TH407C)	
1007	314-5568	2	CAP	
1008	6V-7742	3	HEX NUT, M20X2.5	



Figure 1-5 Pin Hitch - Cuna C & Cuna D2

Item	Part Number	Qty.	Description	Rev.
	341-2267	Ref	HITCH INSTALLATION, (TH336C & TH337C), (Pin Hitch - Cuna C), (Italy), (if equipped), (not available to order, see items 1 thru 6 & 8 for service)	A
	341-2272	Ref	HITCH INSTALLATION, (TH406C & TH407C), (Pin Hitch - Cuna C), (Italy), (if equipped), (not available to order, see items 1 thru 8 for service)	A
	341-2268	Ref	HITCH INSTALLATION, (TH336C & TH337C), (Pin Hitch - Cuna D2), (Italy), (if equipped), (not available to order, see items 1 thru 4, 6, 8 & 105 for service)	A
	341-2273	Ref	HITCH INSTALLATION, (TH406C & TH407C), (Pin Hitch - Cuna D2), (Italy), (if equipped), (not available to order, see items 1 thru 4, 6 thru 8 & 105 for service)	A
1	6V-3303	10	HEX HD CAPSCREW, M16X60, GR8.8, (torque to 241 Nm/178 lb-ft), (TH336C & TH337C)	
	6V-3303	20	HEX HD CAPSCREW, M16X60, GR8.8, (torque to 241 Nm/178 lb-ft) (TH406C & TH407C)	
2	8T-4132	10	HEX NUT, M16X2, (TH336C & TH337C)	
	8T-4132	20	HEX NUT, M16X2, (TH406C & TH407C)	
3	9X-8257	20	WASHER, 16mm, (TH336C & TH337C)	
	9X-8257	40	WASHER, 16mm, (TH406C & TH407C)	
4		AR	LOCTITE® 242™	
5	322-5946	1	HITCH ASSY, (Pin Hitch - Cuna C), (includes items 201 & 202)	A
6	322-5951	1	PLATE ADAPTER	
7	341-0976	2	BRACKET, (TH406C & TH407C)	
8	337-7077	1	HITCH FRAME	
105	322-5947	1	HITCH ASSY, (Pin Hitch - Cuna D2), (includes items 202 & 301)	A
201	348-8517	1	PIN	
202	348-8518	4	MOUNTING HARDWARE	
301	348-8519	1	PIN	



Figure 1-8 License Plate Installation (Continued)

Item	Part Number	Qty.	Description	Rev.



Figure 2-3 Second Boom Section

Item	Part Number	Qty.	Description	Rev.
	398-9123	1	SECOND BOOM SECTION, (TH336C & TH406C), (includes all items)	B
	417-1244	1	SECOND BOOM SECTION, (TH337C & TH407C), (includes all items)	B
1	7X-2537	2	HEX HD CAPSCREW, M8X35, GR8.8	
2	8T-4224	2	WASHER, 8mm	
3	323-7250	2	WEAR PAD	
4	323-7252	1	SHIM, 1.5X70X200mm	
5	357-7889	AR	SHIM, 0.5X70X200mm	
6	357-7890	AR	SHIM	
7	089-7343	2	SHIM	
8	1S-0994	1	CLIP	
9	9X-2040	3	TORX HD SCREW, M10X25, GR8.8	
10	318-7351	2	BEARING	
12	316-5536	1	WEAR PAD	
14	337-5000	AR	TORX HD SCREW, M12X25, GR8.8	
15	241-1830	2	TORX HD SCREW, M12X45, GR8.8	
16	172-5291	7	TORX HD SCREW, M10X30	
17	337-8663	AR	TORX HD SCREW, M12X30	
18	337-4013	2	TWINLINE BRACKET	
19	337-4014	2	SETTING BLOCK	
21	430-6592	2	HOSE CONDUIT, RH	
	430-6595	1	HOSE CONDUIT, RH	
22	430-6595	1	HOSE CONDUIT, LH	
	430-6593	1	HOSE CONDUIT, LH	
23	421-9711	1	BOOM WELDMENT, (TH336C & TH406C)	
	421-9712	1	BOOM WELDMENT, (TH337C & TH407C)	
24	398-9126	AR	WASHER, 10mm	
25	7X-0622	AR	WASHER, 12mm	
26	389-2592	1	WEAR PAD	
27	389-2593	1	WEAR PAD	
28	389-2589	2	SHIM, 1.5X70X250mm	
29	389-2590	AR	SHIM	
101		AR	LOCTITE® 242™	
102		AR	CAT MULTIPURPOSE GREASE - NLGI GRADE 2, (not shown)	



Figure 2-6 JCB Coupler, Manual & Hydraulic (Continued)

Item	Part Number	Qty.	Description	Rev.

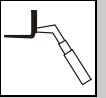

Figure 3-1 Standard Carriage (Continued)

Item	Part Number	Qty.	Description	Rev.
503	312-3338	2	SPLIT PIN	
504	309-2979	4	WASHER, 12mm	
505	132-4842	4	WING HD SCREW, M10X40	
506	417-8273	2	FORK LOCK BACK BRACKET	
507	226-3725	1	PLATE ASSEMBLY	
508	6C-7319	2	PLATE ASSEMBLY	
509	6C-7320	3	SAFETY FILM	
510	326-1976	2	PIN	
511		Ref	BEACON LIGHT, (see Figure 10-7 for details)	

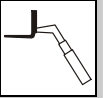

Figure 3-5 Side Shift Carriage (Continued)

Item	Part Number	Qty.	Description	Rev.
401	362-2110	1	MALE QUICK COUPLER, (TH406C Before S/N GAT00384, TH406C Before S/N RCH00179), (TH407C Before S/N MLH01651, TH407C Before S/N JJT00223)	
401	300-6079	1	MALE QUICK COUPLER, (TH406C S/N GAT00384 & After, TH406C S/N RCH00179 & After), (TH407C S/N MLH01651 & After, TH407C S/N JJT00223 & After)	
402	362-2109	1	FEMALE QUICK COUPLER, (TH406C Before S/N GAT00384, TH406C Before S/N RCH00179), (TH407C Before S/N MLH01651, TH407C Before S/N JJT00223)	
402	300-6078	1	FEMALE QUICK COUPLER, (TH406C S/N GAT00384 & After, TH406C S/N RCH00179 & After), (TH407C S/N MLH01651 & After, (TH407C S/N JJT00223 & After)	
403	362-2111	2	CONNECTOR	
404	362-2119	2	HOSE ASSEMBLY	
405	362-2104	2	BULKHEAD STRAIGHT CONNECTOR	
406	362-2118	1	HOSE ASSEMBLY	
407	362-2117	1	HOSE ASSEMBLY	
408	327-6333	2	ELBOW, 90 DEGREES	
409		Ref	CYLINDER, (see Figure 9-6 for details)	
410	327-6287	1	PIN	
411	362-2122	1	PIN	
412	362-2108	2	HEX HD CAPSCREW, 0.3X1	
413	362-2116	1	RIGHT PIN RETAINER	
414	362-2114	1	LEFT PIN RETAINER	
415	362-2100	6	HEX HD CAPSCREW, 0.5X1.5	
416	362-2115	1	SIDE SHIFT PIN	
417	327-6277	1	FORK PIN	
418	NSS	1	S/N PLATE	
419	362-2112	1	REAR FRAME	
420	362-2113	1	FRONT FRAME, (TH406C Before S/N GAT00384, TH406C Before S/N RCH00179), (TH407C Before S/N MLH01651, TH407C Before S/N JJT00223)	
420	314-8479	1	FRONT FRAME, (TH406C S/N GAT00384 & After, TH406C S/N RCH00179 & After), (TH407C S/N MLH01651 & After, TH407C S/N JJT00223 & After)	
421	327-6305	1	HOSE CLAMP	
422	362-2101	1	HEX HD CAPSCREW, 0.31X1.75	
423	327-6325	1	HI PRESSURE WARNING DECAL	
424	362-2106	1	MADE IN USA DECAL	
425	327-6328	2	PINCH POINT DANGER DECAL	
426	362-2107	2	GREASE FITTING	
427	362-2103	2	WASHER, 0.31	
428	362-2102	3	LOCKWASHER, 0.31	
429	327-6329	6	LOCKWASHER, 0.5	

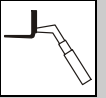

Figure 3-9 Lifting Hook

Item	Part Number	Qty.	Description	Rev.
	169-6460	NLA	LIFTING HOOK, (CE & ANSI), (includes all items), (no longer available, see 456-0465 for replacement or items 1 thru 8 for service)	B
	456-0465	1	LIFTING HOOK, (CE & ANSI),	A
1	NSS	4	TACK FASTENER	
2	169-3943	2	BLOCK	
3	NSS	1	WELDMENT	
4	NSS	1	S/N PLATE	
5	180-7826	1	HOOK	
6	180-7827	1	SHACKLE, (includes hardware)	
7	8T-6868	4	BOLT, M12X1.75	
8	NSS	1	CE NAMEPLATE	

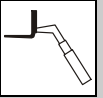

Figure 3-14 Truss Boom

Item	Part Number	Qty.	Description	Rev.
	169-3945	NLA	TRUSS BOOM, (CE & ANSI) , (no longer available, use 1 thru 7 for service or 456-0473 for replacement)	B
	456-0473	1	TRUSS BOOM, (CE & ANSI) , (includes all items)	A
	354-2622	1	TRUSS BOOM, (AUS) , (includes items 3, 5 & 6)	B
1	9V-2714	1	HOOK	
2	9V-2715	1	SHACKLE, (includes hardware)	
3	168-8389	4	TACK FASTENER	
4	169-3943	2	BLOCK	
5	NSS	1	TRUSS BOOM WELDMENT	
6	NSS	1	S/N PLATE	
7	8T-6868	4	BOLT, M12X1.75	

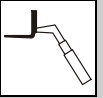

Figure 3-18 Platform Installations

Item	Part Number	Qty.	Description	Rev.
	343-9736	Ref	PLATFORM, FORK MOUNT, (ANSI), (CONSTRUCTION - TH406C & TH407C)	E
1	338-9998	1	PLATFORM WARNING DECAL	
2	469-0493	1	MANUAL, OPERATION AND SAFETY	
3	338-9999	1	ATTACHMENT WARNING DECAL	
4	339-0000	1	PLATFORM CAPACITY DECAL	
5	340-8976	1	PLATFORM, SIDE ENTRY	
6	NSS	1	S/N PLATE	



Figure 4-1 Engine Installation (Continued)

Item	Part Number	Qty.	Description	Rev.



Figure 4-3 Fuel Line Installation

Item	Part Number	Qty.	Description	Rev.
	397-9226	Ref	FUEL LINE INSTALLATION, (not available to order, see items 2 thru 40 for service)	F
2	297-7103	2	HEX HD CAPSCREW, M10X20, GR8.8	
3	7K-1181	5	TIE STRAP	
4	5C-7261	2	HEX NUT, M8X1.25, GR8	
5	5W-1417	6	WASHER, 6mm	
7	8T-4121	2	WASHER, 10mm	
8		1	GEAR CLAMP, 0.91mm	
9	330-8103	13	GEAR CLAMP, 0.78mm	
10	238-1844	1	FITTING 90 DEGREES, (includes o-ring)	
11	187-5086	1	TEE FITTING	
12	1S-0994	2	CLIP	
13	5P-4325	1	CLIP	
14	9M-8406	12	CLIP	
15		AR	LOCTITE® 243™	
16		1	HOSE ASSEMBLY	
17	133-7442	1	HOSE ASSEMBLY	
21	239-5433	1	HOSE ASSEMBLY	
22	8T-4200	2	HEX HD CAPSCREW, M8X16, GR8.8	
23	8T-4205	2	WASHER, 6mm	
24	8T-4224	16	WASHER, 8mm	
26	134-3987	1	CLIP	
27	389-3636	1	FUEL RADIATOR	
28		1	HOSE ASSEMBLY	
29		2	HOSE ASSEMBLY	
31		1	HOSE ASSEMBLY	
32	397-5662	1	PIPE ASSEMBLY	
33		2	HOSE ASSEMBLY	
34	8T-4189	6	HEX HD CAPSCREW, M8X20, GR8.8	
35	398-1611	1	FUEL COOLER BRACKET	
36	398-1608	2	FUEL COOLER MOUNT BRACKET	
37	5C-9553	8	HEX HD CAPSCREW, M6X16, GR8.8	
39	347-4584	6	RIPP NUT, M6 GR10	
40	178-3336	6	RIPP NUT, M8, GR10	
106	105-3480	5	HEX SOCKET HD SCREW, M5X16	
113	330-8103	1	GEAR CLAMP	
115	5D-1026	2	CLAMP	
117	314-5621	1	FUEL SENDER LEVEL GAUGE	
201		Ref	FUEL TANK, (see for details)	



Figure 4-5 Radiator Installation (Continued)

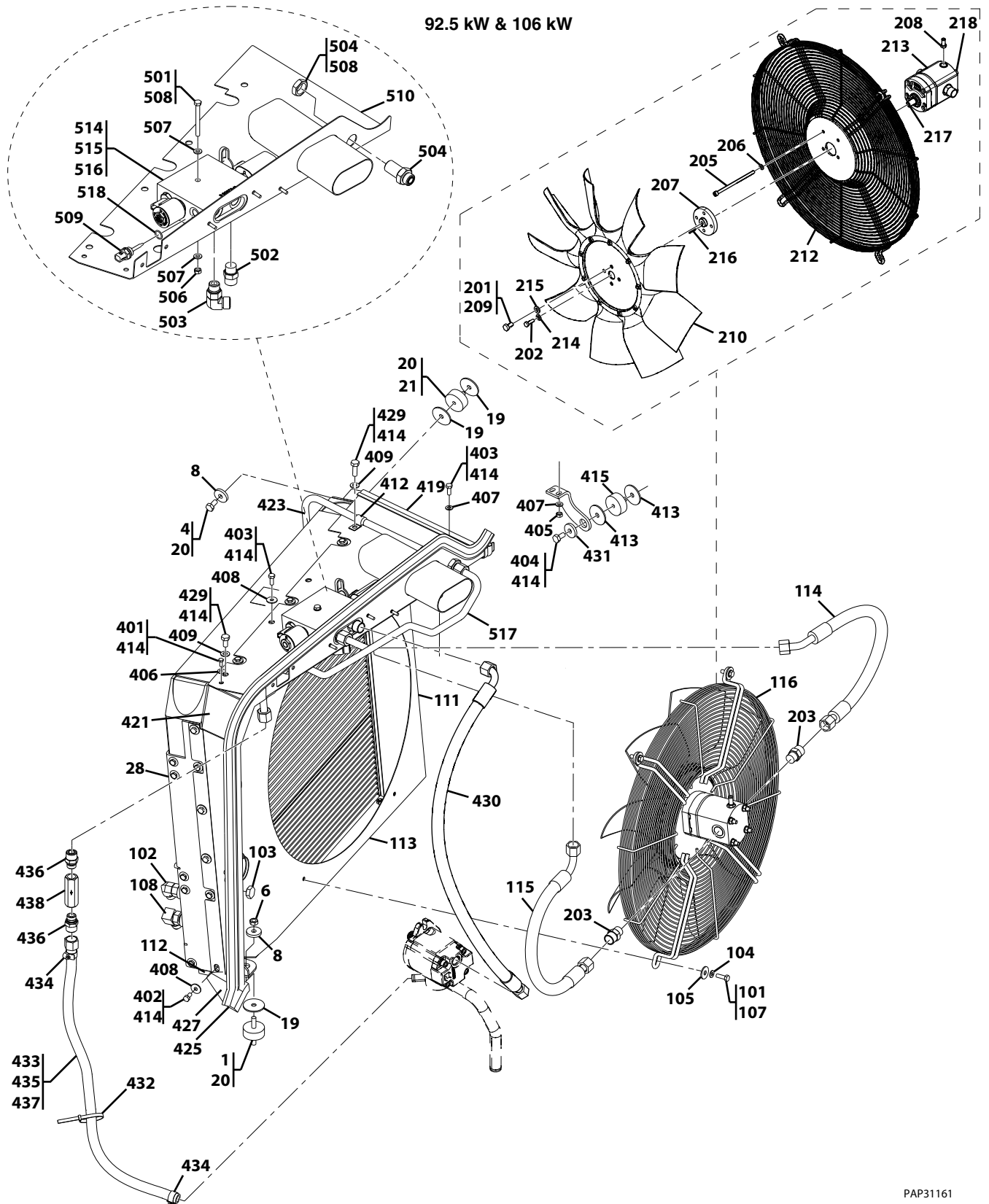



Figure 4-5 Radiator Installation (Continued)

Item	Part Number	Qty.	Description	Rev.
45	309-9184	1	HEX LOCK NUT, M8X1.25, GR8	
46	309-3997	1	WASHER, 8mm	
47	368-8447	1	CLAMP	
48	214-7458	1	CLAMP	
49	499-3434	1	CLAMP	
52	8T-4199	4	HEX HD CAPSCREW, M8X12, GR8.8, (93.1kW) , (torque to 17-19 Nm/12.5-14.0 lb-ft)	
53	8T-4200	3	HEX HD CAPSCREW, M8X16, GR8.8, (93.1kW)	
61	178-3336	1	RIPP NUT, 8mm, (93.1kW)	
101	8T-4908	4	HEX HD CAPSCREW, M8X25, GR8.8	
102	300-6096	2	FITTING, 90 DEGREES, (torque to 36-44 Nm/26.6-32.5 lb-ft)	
103	328-9686	1	FITTING, (torque to 53-63 Nm/39.1-46.5 lb-ft)	
104	8T-4224	4	WASHER, 8mm	
105	116-8517	4	WASHER, 10mm	
107		AR	LOCTITE® 243™	
108	322-8018	2	FITTING, 45 DEGREES, (torque to 36-44 Nm/26.6-32.5 lb-ft)	
111	397-4749	1	SEAL	
112	397-4748	1	SEAL	
113	397-5656	1	RADIATOR	
114	397-2452	1	HOSE ASSEMBLY	
115	397-2453	1	HOSE ASSEMBLY	
116	397-9235	Ref	FAN INSTALLATION, (not available to order, see items 201 thru 218 for service)	G
201	297-7103	4	HEX HD CAPSCREW, M10X20, GR8.8	
202	8T-5093	7	SCREW	
203	298-0466	2	FITTING, (includes o-ring), (torque to 53-63 Nm/39.1-46.5 lb-ft)	
205		4	HEX SOCKET HD SCREW, M8X140	
206	8T-4224	4	WASHER, 8mm	
207	450-4793	1	FITTING	
208	316-1999	1	FITTING, (torque to 11-13 Nm/8.1-9.6 lb-ft)	
209		AR	LOCTITE® 243™	
210	450-4785	1	FAN	
212	397-5660	1	FAN SHIELD	
213	388-1257	1	FAN MOTOR	
214	5M-2894	1	WASHER, 8mm	
215	309-2978	4	WASHER, 10mm	
216	450-4786	1	FAN HUB KEY	
217		A/R	LOCTITE® 638™	
218	495-7633	4	FLANGE NUT, 8mm	
301	247-1384	1	COOLANT TANK	
302	251-3227	1	CAP	
	480-1025	Ref	BULKHEAD AIR INDUCTION INSTALLATION, (74.5kW) , (not available to order, see items 401 thru 435)	B
	480-1024	Ref	BULKHEAD AIR INDUCTION INSTALLATION, (93.1kW) , (not available to order, see items 401 thru 435)	F
401	8T-4970	2	HEX HD CAPSCREW, M6X14, GR8.8	
402	8T-4200	4	HEX HD CAPSCREW, M8X16, GR8.8, (torque to 12-18 Nm/8.9-13.3 lb-ft)	
403	8T-4189	4	HEX HD CAPSCREW, M8X20, GR8.8	
404	297-7103	1	HEX HD CAPSCREW, M10X20, GR8.8	



Figure 4-6 Air Cleaner Installation

Item	Part Number	Qty.	Description	Rev.
10	8T-6726	1	HOSE CLAMP	
16	390-0169	1	AIR INTAKE HOSE	
20	332-7540	1	CLAMP	
102	8T-4908	2	HEX HD CAPSCREW, M8X25, GR8.8, (torque to 18-22 Nm/13-16 lb-ft)	
104	397-2476	1	ADAPTER, 90 DEGREES	
105	5C-7261	2	HEX NUT, M8X1.25, (74.5kW)	
	5C-7261	1	HEX NUT, M8X1.25, (93.1kW)	
106	8T-4224	4	WASHER, 8mm, (74.5kW)	
	8T-4224	4	WASHER, 8mm, (93.1kW)	
108	5W-9934	1	LOW PRESSURE INDICATOR	
109		AR	LOCTITE® 243™	
114	451-8433	1	AIR INLET HOSE, (74.5kW)	
	455-2175	1	AIR INLET HOSE, (93.1kW)	
117	141-2307	1	HOSE CLAMP, (torque to 4-5 Nm/3-4 lb-ft)	
118	167-3740	1	AIR FILTER	
	110-6326	1	PRIMARY ELEMENT	
	110-6331	1	SECONDARY ELEMENT	
	112-9717	1	VACUATOR VALVE	
119	8T-6726	1	HOSE CLAMP, (torque to 4-5 Nm/3-4 lb-ft)	
120	8T-4189	2	HEX HD CAPSCREW, M8X20, GR8.8, (torque to 28 Nm/21 lb-ft)	
121	8T-4179	1	HEX HD CAPSCREW, M12X20, GR8.8, (torque to 97 Nm/72 lb-ft)	
122	8T-4223	1	WASHER, 12mm	
123	397-2478	1	BRACKET	
124		1	BRACKET	
126	309-3997	2	WASHER, 8mm, (74.5kW)	
	309-3997	1	WASHER, 8mm, (93.1kW)	
127	390-0173	1	AIR FILTER, (74.5kW)	
	455-1687	1	AIR FILTER, (93.1kW)	
128	464-7435	1	BRACKET, (93.1kW)	
129	8T-4136	3	HEX HD CAPSCREW, M10X25, GR8.8, (93.1kW)	
130	8T-4121	3	WASHER, 10mm, (93.1kW)	
131	455-3027	1	STRAP, (93.1kW)	
132	7X-2537	2	HEX HD CAPSCREW, M8X35, GR8.8	
133	455-1686	1	PLATE	
	458-0895	Ref	AIR SYSTEM INSTALLATION, (74.5kW) , (not available to order, see items 202 thru 210 for service)	D
		Ref	AIR SYSTEM INSTALLATION, (93.1kW) , (not available to order, see items 202 thru 204 & 206 thru 208 for service)	B
202	328-3911	1	HOSE ASSY	
203	390-0163	2	HOSE ASSY, (74.5kW)	
	390-0163	3	HOSE ASSY, (93.1kW)	
204	368-8447	7	CLAMP, (torque to 5.5-7.85 Nm/4-6 lb-ft)	
205	451-6258	1	HOSE ASSY	
206	452-3697	1	PIPE ASSY	
207	451-8452	1	PIPE ASSY, (74.5kW)	
	455-2174	1	PIPE ASSY, (93.1kW)	
208	209-4580	1	CLAMP	
209	8T-7524	1	SEAL	



Figure 4-8 Jacket Water Heater Installation

Item	Part Number	Qty.	Description	Rev.
	217-2290	Ref	JACKET WATER HEATER INSTALLATION, (TH336C, TH337C & TH407C - AUS, AMEPR),(TH406C - AMEPR), (if equipped), (not available to order, see items 1 & 2 for service)	A
	217-2289	Ref	JACKET WATER HEATER INSTALLATION, (LACD), (TH406C & TH407C), (if equipped), (not available to order, see items 1 & 2 for service)	A
1	219-3270	1	JACKET WATER HEATER, (TH336C, TH337C & TH407C - AUS, AMEPR), (TH406C - AMEPR), (includes items 101 & 102)	
	219-3272	1	JACKET WATER HEATER, (LACD), (TH406C & TH407C), (includes items 101 & 102)	
2	9X-6772	1	STRAP, CABLE	
101	219-3271	1	HEATER ELEMENT, 240V, (TH336C, TH337C & TH407C - AUS, AMEPR), (TH406C - AMEPR)	
	219-3273	1	HEATER ELEMENT, 120V, (LACD), (TH406C & TH407C)	
102	127-8609	1	CABLE, (TH336C, TH337C & TH407C - AUS, AMEPR), (TH406C - AMEPR)	
	7X-6312	1	CABLE, (LACD), (TH406C & TH407C)	

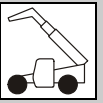

Figure 5-4 Front Axle - Swivel Housing & Steering Cylinder

Item	Part Number	Qty.	Description	Rev.
1	209-7480	2	STEERING ARM ASSY, (includes items 2 thru 4)	
2	204-3080	2	BALL JOINT	
3	217-2885	2	NUT, M24X10	
4	320-7289	2	TIE ROD	
5	320-7289	1	STEERING CYLINDER, (includes 13 thru 15)	
6	320-7291	1	LH SWIVEL HOUSING	
7	217-1443	2	NUT, M24X1.5	
8	320-9347	2	BOLT, M24X1.5	
9	320-7366	2	BUSHING	
10	320-9348	2	BOLT, M14X1.5X65	
11	198-7822	2	SEAL RING	
12	209-4330	2	BUSHING	
13	349-1095	1	ROD	
14	320-7293	2	CYLINDER HEAD	
15	320-7294	1	SEAL KIT	
16	320-9349	4	BOLT, M16X75	
17	320-9350	4	NUT, M16	
18	442-0469	1	SENSOR	
19	199-0683	16	BOLT, M16X75	
20	198-7806	4	GREASE FITTING, M6X1	
21	320-7371	2	KING PIN	
22	320-7296	1	RH SWIVEL HOUSING	
23	320-7369	2	KING PIN	
24	320-7332	4	BUSHING	
25	320-8566	2	CLAMP	

TH336C Before S/N MJR00192
 TH337C Before S/N DJB00193
 TH406C Before S/N GAT00182
 TH407C Before S/N MLH00278

DRIVE TRAIN

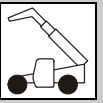

Figure 5-9 Front Axle - Wheel Hub

Item	Part Number	Qty.	Description	Rev.
1	320-7320	2	WHEEL HUB KIT, (includes item 2)	
2	226-4346	16	STUD	
3	331-8538	2	SEAL RING	
4	209-4232	4	BEARING	
5	349-1082	2	O-RING	
6	209-7459	2	SNAP RING	
7	320-7384	16	CENTERING BUSHING	
8	320-9348	16	BOLT, M14X65	
9	209-4159	2	WHEEL CARRIER	
10	320-7324	2	CROWN GEAR	

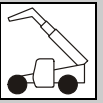

Figure 5-14 Front Axle - Swivel Housing & Steering Cylinder

Item	Part Number	Qty.	Description	Rev.
1	209-7480	2	STEERING ARM ASSY, (includes items 2 thru 4)	
2	204-3080	2	BALL JOINT	
3	217-2885	2	NUT, M24X10	
4	320-7289	2	TIE ROD	
5	320-7290	1	STEERING CYLINDER	
6	320-7291	1	LH SWIVEL HOUSING	
7		2	NUT, M24X1.5	
8	320-9347	2	BOLT, M24X1.5	
9	320-7366	2	BUSHING	
10	320-9348	2	BOLT, M14X1.5X65	
11	198-7822	2	SEAL RING	
12	209-4330	2	BUSHING	
13	349-1095	1	ROD	
14	320-7293	2	CYLINDER HEAD	
15	320-7294	1	SEAL KIT	
16	320-9349	4	BOLT, M16X75	
17	320-9350	4	NUT, M16	
18	442-0469	1	SENSOR	
19	199-0683	16	BOLT, M16X75	
20	198-7806	4	GREASE FITTING, M6X1	
21	320-7371	2	KING PIN	
22	320-7296	1	RH SWIVEL HOUSING	
23	320-7369	2	KING PIN	
24	320-7332	4	BUSHING	
25	320-8566	2	CLAMP	

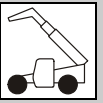

Figure 5-19 Front Axle - Wheel Hub

Item	Part Number	Qty.	Description	Rev.
1	320-7320	2	WHEEL HUB KIT	
2	226-4346	16	STUD	
3	331-8538	2	SEAL RING	
4	209-4232	4	BEARING	
5	349-1082	2	O-RING	
6	209-7459	2	SNAP RING	
7	320-7384	16	CENTERING BUSHING	
8	320-9348	16	BOLT, M14X65	
9	209-4159	2	WHEEL CARRIER	
10	320-7324	2	CROWN GEAR	

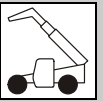

Figure 5-24 Rear Axle - Swivel Housing & Steering Cylinder

Item	Part Number	Qty.	Description	Rev.
1	209-7480	2	STEERING ARM ASSY, (includes items 2 thru 4)	
2	204-3080	2	BALL JOINT	
3	217-2885	2	NUT, M24X10	
4	320-7289	2	TIE ROD	
5	320-7290	1	STEERING CYLINDER, (includes items 13 thru 15)	
6	320-7291	1	RH SWIVEL HOUSING	
7	217-1443	2	NUT, M24X1.5	
8	320-9347	2	BOLT, M22X55	
9	320-7366	2	BUSHING	
10	320-9348	2	BOLT, M14X65	
11	198-7822	2	SEAL RING	
12	209-4330	2	BUSHING	
13	349-1095	1	ROD	
14	320-7293	2	CYLINDER HEAD	
15	320-7294	1	SEAL KIT	
16	320-9349	4	BOLT, M16X75	
17	320-9350	4	NUT, M16	
18	442-0469	1	SENSOR	
19	199-0683	16	BOLT, M16X38	
20	198-7806	4	GREASE FITTING, M6X1	
21	320-7371	2	KING PIN	
22	320-7296	1	LH SWIVEL HOUSING	
23	320-7369	2	KING PIN	
24	320-7332	4	BUSHING	
25	320-7333	2	CLAMP	

TH336C Before S/N MJR00192
 TH337C Before S/N DJB00193
 TH406C Before S/N GAT00182
 TH407C Before S/N MLH00278

DRIVE TRAIN

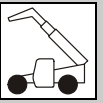

Figure 5-29 Rear Axle - Final Reduction

Item	Part Number	Qty.	Description	Rev.
1	152-6144	2	PLUG	
2	8C-7505	4	BOLT, M8X20	
3	311-2532	2	PLANETARY CARRIER ASSY	
4	465-6143	8	WASHER	
5	358-7687	448	NEEDLE BEARINGS, (56 per gear)	
6	095-0924	8	SNAP RING	
7	209-4157	8	GEAR	

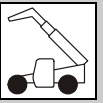

Figure 5-34 Rear Axle - Differential

Item	Part Number	Qty.	Description	Rev.
1	320-8590	1	DIFFERENTIAL KIT (includes items 2 thru 4)	
2	320-7315	2	SHAFT	
3	320-7347	4	THRUST WASHER	
4	293-2145	2	DIFFERENTIAL HOUSING	
5	320-7343	2	PIN	
6	320-7316	1	DIFFERENTIAL HOUSING	
7	209-7454	2	RING NUT, M94X2	
8	320-7344	2	BEARING	
9	320-9336	2	BOLT, M6X1X10	
10	320-7374	2	LOCKING PLATE	
11	294-9800	10	BOLT, M12X90	

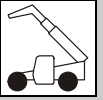

Figure 5-39 Fender Installation

Item	Part Number	Qty.	Description	Rev.
	363-1694	Ref	FENDER INSTALLATION, (TH336C & TH406C) , (not available to order, see items 1 thru 13 for service)	C
	314-5527	Ref	FENDER INSTALLATION, (TH337C & TH407C) , (not available to order, see items 1 thru 7 & 10 thru 107 for service)	E
1	6V-7357	16	HEX HD CAPSCREW, M6X25, GR8.8, (torque to 8 Nm/6lb-ft)	
2	8T-4908	16	HEX HD CAPSCREW, M8X25, GR8.8, (torque to 8 Nm/6 lb-ft)	
3	8T-4779	16	HEX HD CAPSCREW, M16X25, GR8.8	
4	208-8469	16	HEX LOCKNUT, M6X1, GR8	
5	5W-1417	32	WASHER, 6 MM	
6	309-3997	32	WASHER, 8 MM	
7	9X-8257	16	WASHER, 16 MM	
8	424-7640	NLA	LH REAR FENDER BRACKET, (TH336C & TH406C) , (no longer available, use 454-4134 for replacement)	
8	454-4134	1	LH REAR FENDER BRACKET, (TH336C & TH406C)	
9	424-7641	NLA	RH REAR FENDER BRACKET, (TH336C & TH406C) , (no longer available, use 454-4135 for replacement)	
9	454-4135	1	RH REAR FENDER BRACKET, (TH336C & TH406C)	
10		AR	LOCTITE® 243™	
11	326-3984	3	FENDER, (TH336C & TH406C)	
	326-3984	4	FENDER, (TH337C & TH407C)	
12	424-7642	NLA	FRONT FENDER BRACKET, (TH336C & TH406C) , (no longer available, use 454-4136 for replacement)	
12	454-4136	2	FRONT FENDER BRACKET, (TH336C & TH406C)	
13	363-1697	1	CUT-OUT FENDER, (TH336C & TH406C)	
106	424-7637	NLA	LH FENDER BRACKET, (TH337C & TH407C) , (no longer available, use 454-4140 for replacement)	
106	454-4140	2	LH FENDER BRACKET, (TH337C & TH407C)	
107	424-7638	NLA	RH FENDER BRACKET, (TH337C & TH407C) , (no longer available, use 454-4141 for replacement)	
107	454-4141	2	RH FENDER BRACKET, (TH337C & TH407C)	

SECTION 6

CAB

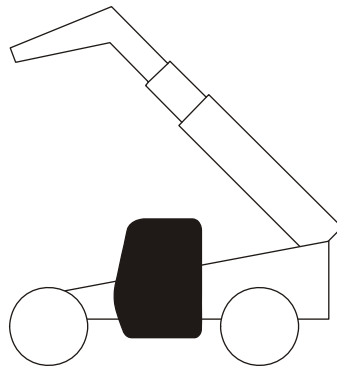
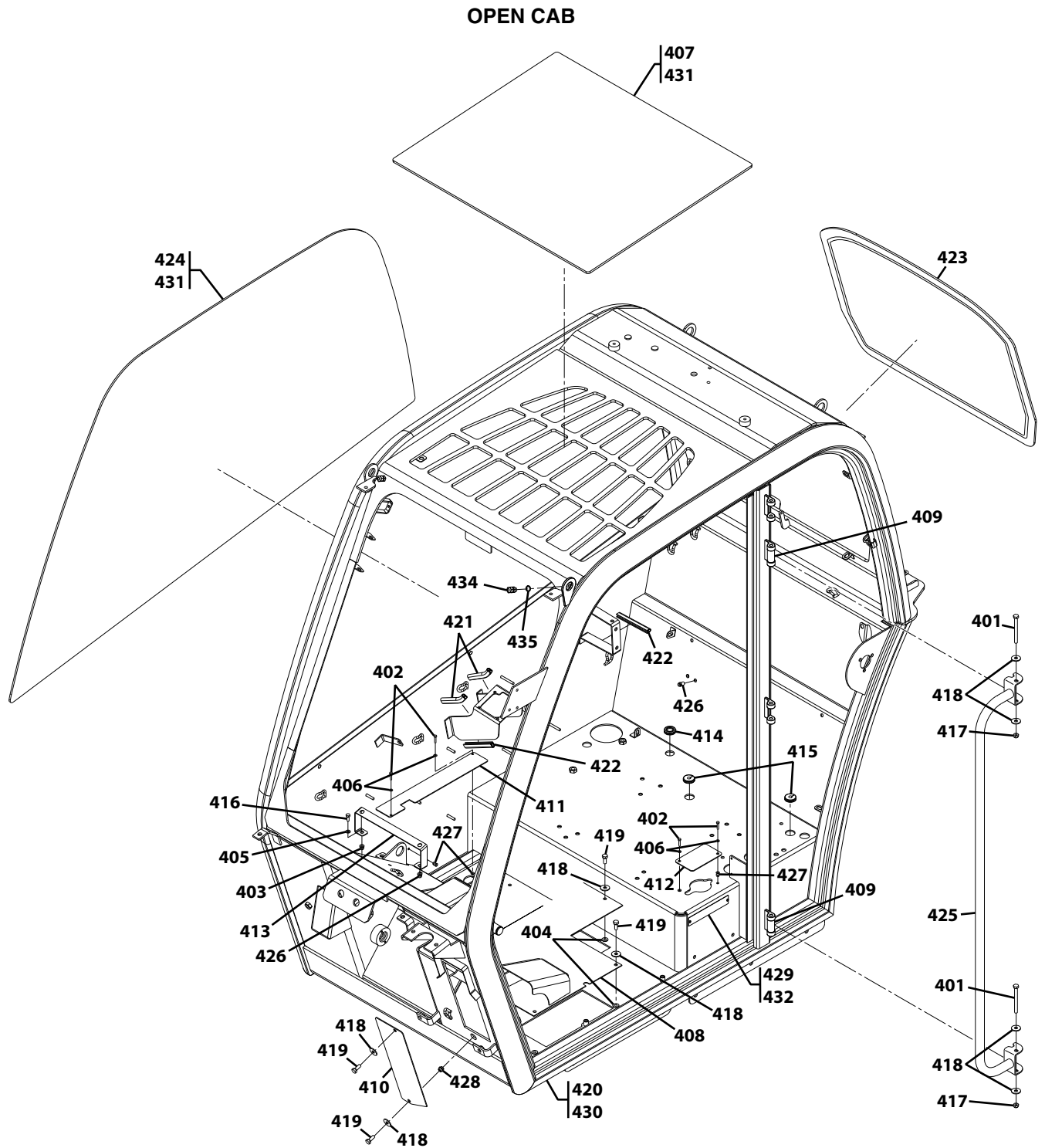



Figure 6-2 Cab Assembly



PAP35500

CLICK HERE TO **DOWNLOAD** THE COMPLETE MANUAL

- Thank you very much for reading the preview of the manual.
- You can download the complete manual from: www.heydownloads.com by clicking the link below



- Please note: If there is no response to CLICKING the link, please download this PDF first and then click on it.

CLICK HERE TO **DOWNLOAD** THE COMPLETE MANUAL



Figure 6-4 Cab Interior (Continued)

Item	Part Number	Qty.	Description	Rev.
114	315-3821	1	COVER	
115	424-5487	1	CONSOLE COVER, (ANSI, enclosed cab)	
	424-5485	1	CONSOLE COVER, (CE & AUS, enclosed cab)	
120	8T-4224	2	WASHER, 8mm, (CE & AUS, enclosed cab)	
122	315-3901	13	WASHER, 6mm	
123	318-0437	11	WASHER, 6mm	
124	445-0111	20	SCREW, M6X20	
125	347-4596	2	NUT	
126	341-7586	1	GROMMET, (CE & AUS, enclosed cab)	
128	322-5928	1	NET	
130	423-5538	4	SCREW	
151	315-3900	2	SCREW, M6X12	
152	315-3901	3	WASHER, 6mm	
153	343-1847	1	SCREW, M6X35	
154	425-6390	1	COVER	
155	423-0053	1	ARMREST COVER	
	366-2185	Ref	LOWER CAB INTERIOR INSTALLATION, (if equipped with Heater) , (not available to order, see items 201 thru 213)	J
	425-7924	Ref	LOWER CAB INTERIOR INSTALLATION, (if equipped with Heater and A/C) , (not available to order, see items 201 thru 213)	E
201	388-4063	1	SCREW, M6X16	
202	341-7590	26	RETAINER NUT, M6X1	
203	315-3820	1	COVER	
204	315-3901	8	WASHER, 6mm	
205	318-0437	17	WASHER, 6mm	
206	445-0111	25	SCREW, M6X20	
207	329-4338	1	COVER	
208	329-4342	1	COVER	
209		Ref	AIR CIRCULATION COMPONENTS, (see Figure 6-8 for details)	
211	366-2191	1	COVER	
212	315-3832	1	COVER, (if equipped with Heater)	
	425-7923	1	COVER. (if equipped with Heater and A/C)	
213	368-5865	1	COVER	



Figure 6-7 Seats (Continued)

Item	Part Number	Qty.	Description	Rev.
101	320-9298	1	PNEUMATIC SEAT, (CE, AUS & ANSI, enclosed cab), (includes items 201 thru 222), (TH336C Before S/N MJR00200, TH337C Before S/N DJB00205, TH406C Before S/N GAT00191, TH407C Before S/N MLH000308)	A
	451-8374	1	PNEUMATIC SEAT, (CE, AUS & ANSI, enclosed cab), (includes items 201 thru 222), (TH336C S/N MJR00200 & After, TH336C S/N THM00150 & After, TH337C S/N DJB00205 & After, TH337C S/N SXJ00150 & After, TH406C S/N GAT00191 & After, TH406C S/N RCH00150 & After, TH407C S/N MLH000308 & After, TH407C S/N JJT00150 & After)	A
	443-9432	1	PNEUMATIC SEAT, (CE, open cab), (includes items 601, 644, 702, 705 & 726 thru 757), (TH336C Before S/N MJR00266, TH336C Before S/N THM00152, TH337C Before S/N DJB00468, TH337C Before S/N SXJ00153, TH406C Before S/N GAT00251, TH407C Before S/N MLH00786, TH407C Before S/N JJT00167)	A
	463-2072	1	PNEUMATIC SEAT, (CE, open cab), (includes items 201 thru 222), (TH336C S/N MJR00200 & After, TH336C S/N THM00152 & After, TH337C S/N DJB00468 & After, TH337C S/N SXJ00153 & After, TH406C S/N GAT00251 & After, TH406C S/N RCH00150 & After, TH407C S/N MLH00786 & After, TH407C S/N JJT00167 & After)	A
102	5P-4116	4	WASHER, (CE, open cab)	
	5P-4116	4	WASHER, (CE, AUS & ANSI, enclosed cab), (TH336C Before S/N MJR00200, TH337C Before S/N DJB00205, TH406C Before S/N GAT00191, TH407C Before S/N MLH000308)	
	8T-4224	4	WASHER, 8mm, (CE, AUS & ANSI, enclosed cab), (TH336C Before S/N MJR00200, TH337C Before S/N DJB00205, TH406C Before S/N GAT00191, TH407C Before S/N MLH000308)	
103	457-4768	4	HEX HD CAPSCREW, M8X25, (CE, AUS & ANSI, enclosed cab)	
	5A-3604	4	HEX HD CAPSCREW, M8X25, (CE, open cab)	
104	443-4608	1	BRACKET	
105	325-7694	NLA	PNEUMATIC SEAT, (CE & AUS), (includes items 501 thru 626)	D
	443-9432	1	PNEUMATIC SEAT, (CE & AUS), (includes items 601, 644, 702, 705 & 726 thru 757), (TH336C S/N MJR00167 & After, TH337C S/N DJB00171 & After including DJB00152 & DJB00158 thru DJB00160, TH406C S/N GAT00158 & After, TH407C S/N MLH00215 & After)	B
106	8T-4200	4	HEX HD CAPSCREW, M8X16, GR8.8	
107	450-9503	1	HEADREST	
108		Ref	SEAT AIR GRAMMER HARNESS, (see Figure 10-38 for details)	
109		AR	LOCTITE® 243™	
201	322-8055	1	UPPER ASSEMBLY KIT	
202	322-8056	1	BACK COVER ASSEMBLY	
203	322-8080	1	BACK FOAM KIT	
204	322-8057	1	SEAT FRAME ASSY KIT	
205	322-8058	1	SEAT COVER ASSY KIT	
206	322-8081	1	SEAT FOAM KIT	
207	322-8059	1	DOCUMENT PLASTIC BAG	
208	322-8060	1	CROSS STRAP KIT	
209	322-8061	1	FOR AND AFT ADJUSTMENT KIT	
210	322-8062	1	SUSPENSION KIT	
211	322-8063	1	MOUNTING PLATE KIT	
212	322-8064	1	SUSPENSION COVER KIT	
213	322-8065	1	SLIDE RAIL STOP KIT	
214	322-8066	1	AIR VALVE KIT	
215	322-8067	1	AIR SPRING KIT	

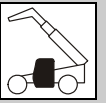

Figure 6-8 Heater Installation (Continued)

Item	Part Number	Qty.	Description	Rev.



Figure 7-1 Brake

Item	Part Number	Qty.	Description	Rev.
	315-3781	Ref	BRAKE INSTALLATION, (not available to order, see items 1 thru 4 for service)	B
1	317-8726	1	BRAKE LIGHT SWITCH	
2	347-5373	2	SCREW	
3		AR	LOCTITE® 242™	
4	315-3898	Ref	BRAKE PEDAL INSTALLATION, (not available to order, see items 101 thru 119 for service)	D
101	8T-4196	1	HEX HD CAPSCREW, 10X35mm, GR8.8	
102	5C-7261	2	HEX NUT, 8X1.25mm	
103	298-0539	1	HEX NUT, 10X1.5mm	
104	8T-4224	2	FLAT WASHER, 8mm	
105	001-5600	2	SNAP RING	
106	174-1304	1	GASKET	
107	365-1590	1	LEVER ASSY	
108	441-9710	2	PLATE	
109	254-3487	1	SPRING	
110	6H-3973	3	BUSHING	
111	8T-4167	4	HARD WASHER	
112	8T-4815	1	ROD	
113	9R-2806	3	PIN	
114	9R-2807	3	CLIP	
115	365-1591	1	MASTER BRAKE CYLINDER	
118	249-3209	1	BRAKE PEDAL	
119	343-1848	1	HEX NUT, 10X1.5mm, GR8	



Figure 7-6 Steering Column Cover

Item	Part Number	Qty.	Description	Rev.
	455-2235	1	STEERING COVER COLUMN, (if equipped with Joystick mounted FNR), (includes items 1 thru 10)	A
1		Ref	SWITCHES, (not shown), (see Figure 10-6 for details)	
2		AR	LOCTITE® 243™	
3	327-4189	2	SCREW, M4X12	
4	6V-2315	2	HEX HD CAPSCREW, 6mm	
5	349-3304	2	NUT, 6mm	
6	349-3305	7	FLAT WASHER, 6mm	
7	347-2212	1	RUBBER GROMMET	
9	424-9638	1	COLUMN COVER, REAR	
10	428-5944	1	COLUMN COVER, FRONT	
	455-2234	1	STEERING COVER COLUMN, (if equipped with FNR Lever), (includes items 102 thru 111)	C
102		AR	LOCTITE® 243™	
103	327-4189	2	SCREW, M4X12	
104	6V-2315	2	HEX HD CAPSCREW, 6mm	
105	349-3304	2	NUT, 6mm	
106	349-3305	6	FLAT WASHER, 6mm	
107	347-2212	2	RUBBER GROMMET	
108	423-3966	1	COLUMN COVER, REAR	
109	423-3968	1	COLUMN COVER, FRONT	
110	455-2250	1	FNR HORN	
111	455-2256	2	HEX HD CAPSCREW, M5X20	

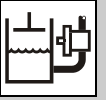
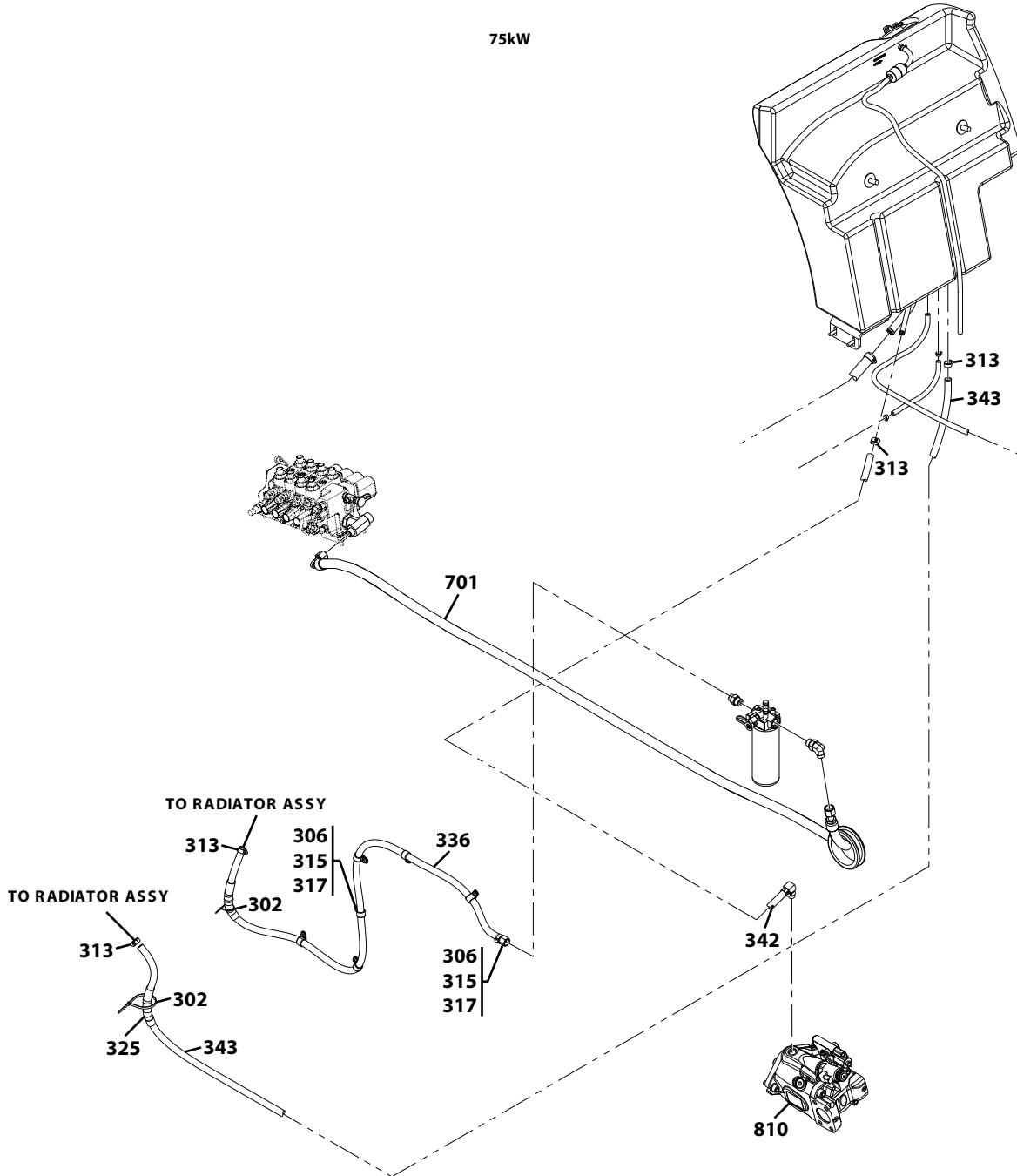

Figure 8-2 Dump Circuit (Continued)



PAP33401

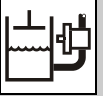

Figure 8-5 Lift Cylinder w/ Boom Suspension

Item	Part Number	Qty.	Description	Rev.
8	298-0465	2	CONNECTOR, (includes o-ring)	
47		Ref	MAIN CONTROL VALVE, (see Figure 9-8 for details)	
49		Ref	LIFT CYLINDER, (see Figure 9-1 for details)	
	417-4972	Ref	BOOM SUSPENSION INSTALLATION, (TH336C & TH406C, if equipped) , (not available to order, see items 101 thru 134 for service)	F
	417-4973	Ref	BOOM SUSPENSION INSTALLATION, (TH337C & TH407C, if equipped) , (not available to order, see items 101 thru 108, 114 & 116 thru 228 for service)	G
101	342-3862	15	CABLE BAND	
102	8T-4971	2	BOLT, M6X28	
103	8T-4191	1	HEX HD CAPSCREW, M10X16, GR8.8, (TH336C & TH406C)	
104	309-6349	1	CONNECTOR, (includes o-ring)	
105	298-0475	2	ELBOW, 90 DEGREES, (includes o-ring)	
106	317-3320	1	ELBOW, 90 DEGREES, (includes o-ring)	
107	5C-2890	2	NUT, M6X1	
108	7I-8935	4	HEX SOCKET HD SCREW, M8X75	
110	8T-4205	4	WASHER, M6	
111	8T-4121	1	WASHER, 10 MM (torque to 26 Nm/20 lb-ft), (TH336C & TH406C)	
114		AR	LOCTITE® 243™	
115	327-5534	2	HOSE CLIP, (TH336C & TH406C)	
116	327-5534	2	CYLINDER SADDLE, (TH336C & TH406C)	
	340-2292	2	CYLINDER SADDLE, (TH337C & TH407C)	
117	328-9687	1	HOSE ASSEMBLY, (TH336C & TH406C)	
	315-3600	1	HOSE ASSEMBLY, (TH337C & TH407C)	
118	340-4933	2	HOSE CLAMP	
119	340-4934	2	TUBE BRIDGE CLIP	
120	340-2293	1	ACCUMALATOR	
121	340-2294	1	BOOM SUSPENSION VALVE, (includes items 301 thru 303)	A
123	340-2300	1	MCV VENT	
	340-5915	1	CARTRIDGE VALVE WITH NUT	
		1	COIL, 12 VOLT DC	
125	340-2303	1	CONTROL, ACCESSORY MODULE, (TH336C Before SN MJR00174), (TH337C Before SN DJB00184), (TH406C Before SN GAT00161), (TH407C Before SN MLH00234)	D
	371-6711	1	PC BOARD	
	432-5954	1	BOX, CIRCUIT CARD	
	340-4130	1	DECAL	
	340-2298	1	SOFTWARE, TH RIDE AND FLOAT	
125	444-0289		CONTROL, ACCESSORY MODULE, (not shown), (TH336C SN MJR00174 & After), (TH336C SN THM00150 & After), (TH337C SN DJB00184 & After), (TH337C SN SXJ00150 & After), (TH406C SN GAT00161 & After), (TH406C SN RCH00150 & After), (TH407C SN MLH00234 & After), (TH407C SN JJT00150 & After)	B
	432-5954		BOX, CIRCUIT CARD	
	371-6711	NLA	ACCESSORY MODULE PC BOARD, (no longer available, use 1001221933 for replacement)	
		1	ACCESSORY MODULE PC BOARD	
	473-3670	1	MATING CONNECTOR	
	473-3654	1	MATING CONNECTOR	
	169-0706	2	TERMINAL	

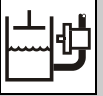

Figure 8-8 Auxiliary Hydraulics

Item	Part Number	Qty.	Description	Rev.
2	7X-2533	2	HEX HD CAPSCREW, 6x35, GR8.8, (TH336C & TH406C)	
	7X-2533	4	HEX HD CAPSCREW, 6x35, GR8.8, (TH337C & TH407C)	
3	8T-4191	2	HEX HD CAPSCREW, 10X16mm, GR8.8, (torque to 55 Nm/41 lb-ft)	
5	298-0505	2	ELBOW, 90 DEGREES, (includes o-ring)	
7	330-4258	2	NUT	
8	8T-4205	2	FLAT WASHER, 6mm, (TH336C & TH406C)	
	8T-4205	3	FLAT WASHER, 6mm, (TH337C & TH407C)	
9	8T-4121	2	FLAT WASHER, 10mm	
18	316-5515	1	TUBE ASSY, (TH337C & TH407C)	
19	316-5516	1	TUBE ASSY, (TH337C & TH407C)	
20		Ref	CLAMP, (see Figure 8-7 for details)	
23	318-2502	1	CLAMP SET, (TH336C & TH406C)	
	318-2502	2	CLAMP SET, (TH337C & TH407C)	
25		AR	LOCTITE® 242™	
26	318-7389	1	BULKHEAD PLATE	
27	382-4905	1	TWIN HOSE ASSY, (TH336C & TH406C)	
	382-4907	1	TWIN HOSE ASSY, (TH337C & TH407C)	
30	325-6923	1	TUBE ASSY, (TH336C & TH406C)	
31	325-6924	1	TUBE ASSY, (TH336C & TH406C)	
102	7X-2536	1	HEX HD CAPSCREW, 8X14mm, GR8.8	
106	298-0465	2	CONNECTOR, (includes o-ring)	
114		Ref	MAIN CONTROL VALVE, (see Figure 9-8 for details)	
127	315-3611	1	HOSE ASSY, (TH337C & TH407C)	
128	315-3612	1	HOSE ASSY, (TH337C & TH407C)	
133		Ref	CLAMP, (see Figure 8-7 for details)	
134	315-3991	1	CLAMP HALF	
143	8T-4224	1	FLAT WASHER, 8mm	
155	6V-8398	2	SEAL	
226	315-3601	2	HOSE ASSY, (TH336C & TH406C)	
	423-8923	Ref	AUXILIARY QUICK DISCONNECT INSTALLATION, (not available to order, see items 301 thru 310 for service)	A
301	8T-4189	2	HEX HD CAPSCREW, M8X20, GR8.8	
302	330-4258	2	BULKHEAD NUT, GR8	
303	5M-2894	2	WASHER, 8MM	
304	153-2994	1	QUICK DISCONNECT COUPLING, FEMALE	
305	153-2995	1	QUICK DISCONNECT COUPLING, MALE	
306		AR	LOCTITE® 243™	
307	330-4773	1	ELBOW, 45 DEGREES	
308	423-8922	1	BRACKET	
309	190-5236	1	UNION	
310	326-1968	2	HOSE ASSY	

SECTION 9

HYDRAULIC COMPONENTS

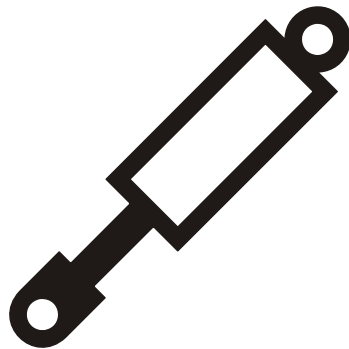



Figure 9-5 Quick Coupler Cylinder

Item	Part Number	Qty.	Description	Rev.
	367-6694	1	QUICK COUPLER CYLINDER, (includes all items)	B
1	460-2117	1	CHECK VALVE	
2	422-0893	1	BODY	
3	422-0894	2	PISTON	
4	Kit	2	PISTON SEAL	
5	422-0895	2	ROD	
6	Kit	2	O-RING	
7	Kit	2	BACK-UP RING	
8	Kit	2	ROD SEAL	
9	422-0896	2	GLAND	
10	Kit	2	WIPER SEAL	
K1	422-0897	1	SEAL KIT, (includes items 4, 6 thru 8 & 10)	



Figure 9-9 Piston Pump

Item	Part Number	Qty.	Description	Rev.
	398-4825	1	HYDRAULIC PISTON PUMP, 63cc, (includes items 1 thru 310)	B
1	450-0849	1	CONTROL VALVE	
2	450-0850	1	CONTROL VALVE	
3	450-0851	1	ADJUSTING PIECE	
30	Kit	2	PLUG	
40	450-0852	1	STOP SCREW	
43	Kit	1	O-RING	
101	450-0854	1	ROTARY GROUP	
107	450-0856	1	SWASH PLATE	
108	223-8894	1	DRIVE SHAFT	
115	299-0621	1	BEARING	
116	299-0622	1	BEARING	
117	450-0858	1	BEARING-LINER	
118	450-0859	1	BEARING-LINER	
119	298-7405	2	SCREW	
120	Kit	1	SHAFT SEAL	
121	Kit	1	O-RING	
124	Kit	2	SEAL RING	
125	Kit	1	RETAINING RING	
202	Kit	1	GASKET	
203	298-7406	4	SOCKET HD CAPSCREW	
204	Kit	1	PLUG	
307		1	SOLENOID	
309	Kit	1	O-RING	
310	Kit	3	O-RING	
K1	450-0862	1	SEAL KIT, (includes items 30, 43, 120 thru 125, 202, 204, 309 & 310)	



Figure 9-14 Side Tilt Cylinder

Item	Part Number	Qty.	Description	Rev.
	309-4317		SIDE TILT CYLINDER, (TH406C Before S/N GAT00306, TH407C Before S/N MLH01021)	C
1	462-0922	1	BARREL ASSY	
2	462-0923	1	ROD ASSY	
3	462-0924	1	PISTON	
4	Kit	1	PISTON SEAL	
5	Kit	1	O-RING	
6	Kit	2	PISTON WEAR RING	
7	462-0926	1	ROD BEARING ASSY	
8	Kit	1	ROD SEAL	
9	Kit	1	WIPER	
10	Kit	1	WEAR RING	
11	Kit	1	O-RING	
12	Kit	1	BACK-UP RING	
13	462-0928	1	HEX NUT	
14	305-5431	1	LOCKING SCREW	
15	305-5460	2	GREASE FITTING	
16	462-0929	2	CHECK VALVE	
K1	462-0925		PISTON SEAL KIT, (includes items 4 thru 6)	
K2	462-0927		ROD BEARING SEAL KIT, (includes items 8 thru 12)	

SECTION 10 ELECTRICAL

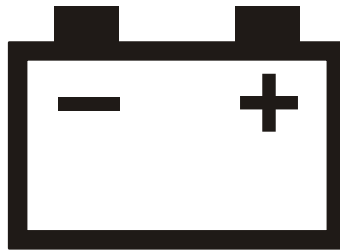

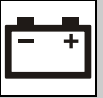

Figure 10-1 Engine Compartment Electrical Installation (Continued)

Item	Part Number	Qty.	Description	Rev.
737	134-3987	2	LOOP CLIP	
	424-0090	Ref	ENGINE POD ELECTRICAL COMPONENTS INSTALLATION, 74.5kW, (not available to order, see items 801 thru 831 for service)	M
801	7X-2535	3	HEX HD CAPSCREW, M6X60, GR8.8	
802	5C-9553	1	HEX HD CAPSCREW, M6X16, GR8.8	
803	6V-7357	4	HEX HD CAPSCREW, M6X25, GR8.8	
805		Ref	ENGINE MOUNTING HARDWARE, , (see Figure 4-2 for details)	
806	5C-2890	3	HEX NUT, M6X1	
808	8T-4205	15	WASHER, 6mm	
812	312-3330	1	BUS BAR INSULATOR	
813		AR	LOCTITE® 243™	
816		Ref	ENGINE POD WELDMENT, (see Figure 1-1 for details)	
817	398-1996	1	RED POWER MODULE RELAY, (includes fuse)	
818	442-5211	1	GREEN POWER MODULE RELAY, (includes fuse)	
819	442-0468	2	YELLOW POWER MODULE RELAY, (includes fuse)	
820		Ref	TRANSMISSION COOLING HOSES & HARDWARE	
823	451-9594	1	SEAL	
827	398-3306	1	SEAL	
828	466-1541	1	BRACKET	
830	442-6184	4	RUBBER MOUNT	
831	303-4779	4	HEX LOCKNUT, M6X1	

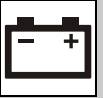
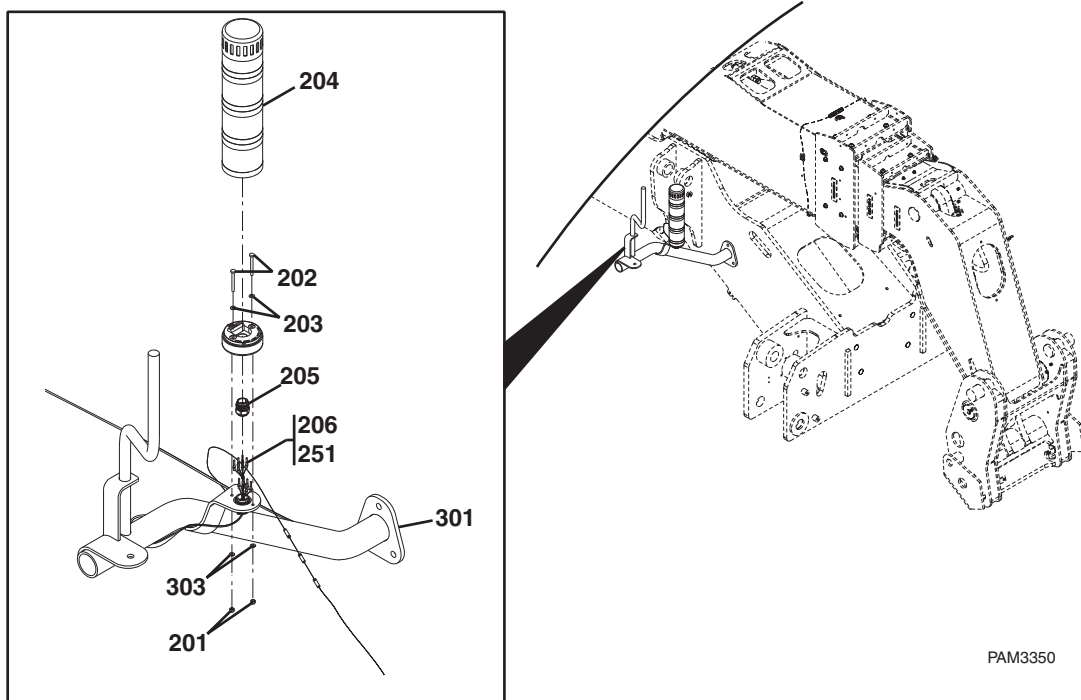

Figure 10-4 LMIS Installation (Continued)



PAM3350

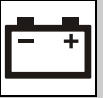

Figure 10-6 Cab Switches

Item	Part Number	Qty.	Description	Rev.
	316-8005	Ref	CAB SWITCHES INSTALLATION, (open cab), (not available to order, see items 1 & 3 thru 11 for service)	D
	388-3352	Ref	CAB SWITCHES INSTALLATION, (enclosed cab), (not available to order, see items 1 thru 18 for service)	E
1	323-7232	3	SWITCH BODY	
3	323-7233	14	BLANK SWITCH ASSEMBLY, (includes body & cover), (open cab)	
	323-7233	13	BLANK SWITCH ASSEMBLY, (includes body & cover), (enclosed cab)	
4	316-8018	1	BEACON SWITCH KEY	
5	316-8019	1	BOOM SWITCH KEY	
6	316-8027	9	SWITCH HOLDER, (open cab)	
	316-8027	7	SWITCH HOLDER, (enclosed cab)	
7	316-8028	8	SWITCH HOLDER END, (open cab)	
	316-8028	4	SWITCH HOLDER END, (enclosed cab)	
8	316-8030	1	CLUTCH LOCK SWITCH KEY	
9	316-8043	1	GAUGE DISPLAY	
10	316-8044	1	KEYPAD	
11			12V POWER CONNECTOR, (see Figure 10-5 for details)	
13	316-8029	1	SWITCH, 3 FRAME POS	
14	437-5081	1	INDICATOR BODY	
15		2	SYMBOL PLATE	
16	469-7233	2	SWITCH HOLDER	
17	469-7234	2	SWITCH HOLDER END	
18		6	ADAPTER SWITCH	
101	329-3644	1	AUXILIARY HYDRAULIC SWITCH BODY	
102	316-8017	1	AUXILIARY HYDRAULIC SWITCH KEY	
103	329-3641	2	WIPER SWITCH BODY, (if equipped)	
104	316-8015	1	REAR WIPER SWITCH KEY, (if equipped)	
105	329-3643	1	CAB WORK LIGHTS SWITCH BODY, (if equipped)	
106	316-8020	1	CAB WORK LIGHTS SWITCH KEY, (if equipped)	
107	316-8031	1	ROOF WIPER SWITCH KEY, (if equipped)	
108	329-3641	1	REVERSE FAN SWITCH BODY, (if equipped)	
109	316-8048	1	REVERSE FAN SWITCH KEY, (if equipped)	
112	340-2304	1	RIDE CONTROL SWITCH BODY, (if equipped)	
113	340-2296	1	RIDE CONTROL SWITCH KEY, (if equipped)	
114	329-3642	1	HYDRAULIC HITCH SWITCH BODY, (if equipped)	
115	316-8009	1	HYDRAULIC HITCH SWITCH KEY, (if equipped)	
116	437-5081	2	INDICATOR BODY, (if equipped)	
118	340-2302	1	LAMP ASSY, (TH336C Before SN MJR00279), (TH336C Before SN THM00152), (TH337C Before SN DJB00513), (TH337C Before SN SXJ00153), (TH406C Before SN GAT00285), (TH406C Before SN RCH00158), (TH407C Before SN MLH00940), (TH407C Before SN JJT00185)	
	454-7304	1	LAMP ASSEMBLY, (TH336C SN MJR00279 & After), (TH336C SN THM00152 & After), (TH337C SN DJB00513 & After), (TH337C SN SXJ00153 & After), (TH406C SN GAT00285 & After), (TH406C SN RCH00158 & After), (TH407C SN MLH00940 & After), (TH407C SN JJT00185 & After)	
119	340-2301	1	RIDE CONTROL INDICATOR, (if equipped)	
120	316-8025	1	HYDRAULIC QUICK COUPLER SWITCH KEY, (if equipped)	
121	340-2304	1	HYDRAULIC QUICK COUPLER SWITCH BODY, (if equipped)	
122	454-7304	1	LAMP ASSY, (ITALY, if equipped)	
123	437-5083	1	SYMBOL PLATE, BLANK, BLACK, (ITALY, if equipped)	

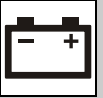

Figure 10-8 Drive Lights (Continued)

Item	Part Number	Qty.	Description	Rev.

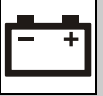

Figure 10-9 Engine Harness (Continued)

X642									
CONN POS	WIRE COLOR	WIRE LABEL	GAUGE	JOINT	TERMINAL PIN	SEAL PIN	TO		
1	WHT	111-21	2.5 mm ²	FLRYW	100126332	100126333	MS1067 (H)		
2	BLK	008-26	2.5 mm ²	FLRYW	100126332	100126333	S645 (1)		
3	WHT	111-22	2.5 mm ²	FLRYW	100126332	100126333	S647 (1)		
4	BLK	008-26	2.5 mm ²	FLRYW	100126332	100126333	S646 (1)		
5	WHT	111-21	2.5 mm ²	FLRYW	100126332	100126333	S647 (1)		
6	BLK	008-26	2.5 mm ²	FLRYW	100126332	100126333	S646 (1)		
7	WHT	103-1	0.75 mm ²	FLRYW	100126331	N/A	X652 (2)		
8					100126336	N/A			
9					100126336	N/A			
10					100126336	N/A			
11					100126336	N/A			
12					100126336	N/A			
13					100126336	N/A			
14	WHT	107-1	0.75 mm ²	FLRYW	100126384	N/A	X955 (5)		
15					100126336	N/A			
16	YEL	007-1	0.75 mm ²	FLRYW	100126384	N/A	X32 (5)		
17					100126336	N/A			
18					100126336	N/A			
19	WHT	104-1	0.75 mm ²	FLRYW	100126384	N/A	X657 (1)		
20	WHT	104-2	0.75 mm ²	FLRYW	100126384	N/A	X657 (2)		
21					100126336	N/A			
22	WHT	102-9	0.75 mm ²	FLRYW	100126384	N/A	X668 (3)		
23					100126336	N/A			
24					100126336	N/A			
25					100126336	N/A			
26					100126336	N/A			
27					100126336	N/A			
28	WHT	111-1	0.75 mm ²	FLRYW	100126384	N/A	S839 (1)		
29	WHT	109-1	0.75 mm ²	FLRYW	100126337	N/A			
30					100126336	N/A	X666 (1)		
31					100126336	N/A			
32					100126336	N/A			
33					100126336	N/A			
34					100126336	N/A			
35	WHT	107-2	0.75 mm ²	FLRYW	100126384	N/A	X955 (6)		
36					100126336	N/A			
37	BLK	008-6	0.75 mm ²	FLRYW	100126336	N/A	X32 (4)		
38					100126336	N/A			
39					100126336	N/A			
40					100126336	N/A			
41	WHT	102-6	0.75 mm ²	FLRYW	100126384	N/A	S912 (1)		
42					100126336	N/A			
43	WHT	099-2	0.75 mm ²	FLRYW	100126384	N/A	X32 (23)		
44					100126336	N/A			
45					100126336	N/A			
46	RED	CAN CABLE H-12	0.75 mm ²	CABLE	100126384	N/A	S1112 (1)		
47	BLK	CAN CABLE L-12	0.75 mm ²	CABLE	100126384	N/A	S1111 (1)		
48	WHT	099-5	0.75 mm ²	FLRYW	100126384	N/A	X32 (1)		
49					100126336	N/A			
50	WHT	111-3	0.75 mm ²	FLRYW	100126336	N/A	MS1067 (D)		
51					100126337	N/A			
52	WHT	102-8	0.75 mm ²	FLRYW	100126384	N/A	X668 (8)		
53					100126336	N/A			
54	YEL	002-2	0.75 mm ²	FLRYW	100126384	N/A	S1023 (1)		
55					100126336	N/A			
56					100126336	N/A			
57					100126336	N/A			
58	WHT	107-0	0.75 mm ²	FLRYW	100126384	N/A	X955 (7)		
59					100126336	N/A			
60	GRY	048-21	0.75 mm ²	FLRYW	100126384	N/A	X32 (7)		
61					100126336	N/A			
62					100126336	N/A			
63	WHT	TWISTED PAIR 14	0.75 mm ²	TW PAIR	100126384	N/A	X652 (6)		
64	WHT	TWISTED PAIR 13	0.75 mm ²	TW PAIR	100126384	N/A	X652 (1)		
65					100126336	N/A			
66	WHT	099-3	0.75 mm ²	FLRYW	100126384	N/A	X32 (24)		
67					100126336	N/A			
68	WHT	108-1	0.75 mm ²	FLRYW	100126384	N/A	X661 (C)		
69					100126336	N/A			
70					100126336	N/A			
71					100126336	N/A			
72					100126336	N/A			
73	WHT	099-1	0.75 mm ²	FLRYW	100126384	N/A	X32 (15)		
74					100126336	N/A			
75	GRY	048-32	0.75 mm ²	FLRYW	100126384	N/A	X32 (11)		
76					100126336	N/A			
77					100126336	N/A			
78					100126336	N/A			
79	WHT	105-2	0.75 mm ²	FLRYW	100126384	N/A	X955 (2)		
80	WHT	105-1	0.75 mm ²	FLRYW	100126384	N/A	X955 (1)		
81	WHT	101-2	0.75 mm ²	FLRYW	100126384	N/A	X952 (8)		
82	WHT	101-3	0.75 mm ²	FLRYW	100126384	N/A	X952 (7)		
83	WHT	106-2	0.75 mm ²	FLRYW	100126384	N/A	X955 (4)		
84	WHT	105-1	0.75 mm ²	FLRYW	100126384	N/A	X955 (3)		
85	BLK	TWISTED PAIR 14	0.75 mm ²	TW PAIR	100126384	N/A	X652 (2)		
86	BLK	TWISTED PAIR 13	0.75 mm ²	TW PAIR	100126384	N/A	X652 (1)		
87					100126336	N/A			
88					100126336	N/A			
89					100126336	N/A			
90					100126336	N/A			
91					100126336	N/A			
92					100126336	N/A			
93					100126336	N/A			
94	WHT	099-4	0.75 mm ²	FLRYW	100126384	N/A	X32 (22)		

S647									
CONN POS	WIRE COLOR	WIRE LABEL	GAUGE	JOINT	TERMINAL PIN	TO			
1	WHT	111-23	2.5 mm ²	FLRYW	N/A	X642 (3)			
1	WHT	111-23	2.5 mm ²	FLRYW	N/A	X642 (3)			
2	WHT	111-22	2.5 mm ²	FLRYW	N/A	MS1067 (F)			

S839									
CONN POS	WIRE COLOR	WIRE LABEL	GAUGE	JOINT	TERMINAL PIN	TO			
1	WHT	111-1	0.75 mm ²	FLRYW	N/A	S642 (3)			
2	WHT	111-1	1 mm ²	FLRYW	N/A	RL825 (2)			
2	WHT	111-2	1 mm ²	FLRYW	N/A	MS826 (D)			

S646									
CONN POS	WIRE COLOR	WIRE LABEL	GAUGE	JOINT	TERMINAL PIN	TO			
1	WHT	111-21	2.5 mm ²	FLRYW	N/A	MS1067 (G)			
1	WHT	111-23	2.5 mm ²	FLRYW	N/A	MS1067 (G)			
2	WHT	111-23	2.5 mm ²	FLRYW	N/A	MS1067 (G)			
1	WHT	111-2	4 mm ²	FLRYW	N/A	RL825-Y (1)			

S912									
CONN POS	WIRE COLOR	WIRE LABEL	GAUGE	JOINT	TERMINAL PIN	TO			
1	WHT	102-5	0.75 mm ²	FLRYW	N/A	X642 (4)			
2	WHT	102-5	3 mm ²	FLRYW	N/A	X668 (5)			

S645									
CONN POS	WIRE COLOR	WIRE LABEL	GAUGE	JOINT	TERMINAL PIN	TO			
1	BLK	008-24	2.5 mm ²	FLRYW	N/A	X642 (8)			
1	BLK	008-25	2.5 mm ²	FLRYW	N/A	X642 (4)			
1	BLK	008-26	2.5 mm ²	FLRYW	N/A	X642 (2)			
2	BLK	008-22	4 mm ²	FLRYW	N/A	T643 (1)			
2	BLK	008-21	1 mm ²	FLRYW	N/A	X666 (5)			
2	BLK	008-23	1 mm ²	FLRYW	N/A	S661 (8)			

X668									
CONN POS	WIRE COLOR	WIRE LABEL	GAUGE	JOINT	TERMINAL PIN	TO			
1	WHT	102-1	2 mm ²	FLRYW	100126481	N/A	X982 (2)		
2	WHT	102-2	2 mm ²	FLRYW	100126481	N/A	X982 (4)		
3	WHT	102-3	0.75 mm ²	FLRYW	100126481	N/A	X642 (2)		
4	WHT	102-4	5 mm ²	FLRYW	100126482	RL1028 (1)			
5	WHT	102-5	3 mm ²	FLRYW	100126482	S912 (2)			
6	WHT	102-6	2 mm ²	FLRYW	100126481	X982 (1)			
7	WHT	102-7	2 mm ²	FLRYW	100126481	X982 (3)			
8	WHT	102-8	0.75 mm ²	FLRYW	100126481	X642 (5)			

T835									
CONN POS	WIRE COLOR	WIRE LABEL	GAUGE	JOINT	TERMINAL PIN	TO			
1	BLK	000-3	4 mm ²	FLRYW	N/A	X106 (1)			
1	BLK	000-4	4 mm ²	FLRYW	N/A	X106 (2)			
1	BLK	000-5	4 mm ²	FLRYW	N/A	X106 (3)			
1	BLK	000-6	4 mm ²	FLRYW	N/A	X106 (4)			

T836									
CONN POS	WIRE COLOR	WIRE LABEL	GAUGE	JOINT	TERMINAL PIN	TO			
1	BLK	000-9	1 mm ²	FLRYW	N/A	S667 (2)			
1	BLK	000-3	1 mm ²	FLRYW	N/A	X302 (2)			

X955									
CONN POS	WIRE COLOR	WIRE LABEL	GAUGE	JOINT	TERMINAL PIN	TO			
1	WHT	105-1	0.75 mm ²	FLRYW	4460464	X642 (8)			

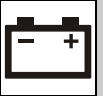

Figure 10-10 Transmission Harness

Item	Part Number	Qty.	Description	Rev.
1	399-7804	1	TRANSMISSION HARNESS, (includes all items)	E
	334-5871	7	CONNECTOR	
	305-5449	7	WEDGE LOCK	
2	303-4970	2	TERMINAL	
	362-6352	1	CONNECTOR	
	456-1577	1	TERMINAL	
3	460-2707	1	CONNECTOR	
	299-7106	1	WEDGE LOCK	
	8T-8737	7	PLUG	
4	303-4970	2	TERMINAL	
	356-2911	3	TERMINAL	
	102-8801	1	CONNECTOR	
5		1	WEDGE LOCK	
	8T-8737	3	PLUG	
	303-4969	3	TERMINAL	
6	9X-3401	6	TERMINAL	
	456-5430	1	RED BOOT	
	334-5874	1	CONNECTOR	
5	299-7107	1	WEDGE LOCK	
	8T-8737	5	PLUG	
	356-2911	3	TERMINAL	
6	456-5414	1	CONNECTOR	
	299-7106	1	WEDGE LOCK	
	303-4970	8	TERMINAL	
	8T-8737	4	PLUG	

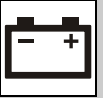

Figure 10-14 Cab Floor Harness

Item	Part Number	Qty.	Description	Rev.
	417-3524	1	CAB FLOOR HARNESS, (includes all items)	D
1	362-6352	11	CONNECTOR	
	456-1577	1	TERMINAL	
2	424-2025	1	CONNECTOR	
	390-0057	6	TERMINAL	
	456-1562	2	TERMINAL	
	NSS	1	PLUG	
3	424-2025	1	CONNECTOR	
	390-0057	5	TERMINAL	
	456-1562	4	TERMINAL	
	NSS	1	PLUG	
4	424-2025	6	CONNECTOR	
	390-0057	4	TERMINAL	
	NSS	4	PLUG	
5	424-2025	3	CONNECTOR	
	390-0057	6	TERMINAL	
	NSS	2	PLUG	
6	456-1554	1	CONNECTOR	
	217-5892	2	PLUG	
	217-5893	2	TERMINAL	
	210-8314	2	SEAL	
7	334-5872	2	CONNECTOR	
	8T-8737	2	PLUG	
	303-4970	4	TERMINAL	
8	334-5874	1	CONNECTOR	
	303-4970	7	TERMINAL	
	8T-8737	1	PLUG	
9	424-2025	1	CONNECTOR	
	390-0057	5	TERMINAL	
	NSS	3	PLUG	
10	362-6352	2	CONNECTOR	
	316-8041	2	BUZZER	
	456-1577	1	TERMINAL	
11	456-1520	1	CONNECTOR	
	456-1575	11	TERMINAL	
	NSS	1	PLUG	
12	362-8041	1	CONNECTOR	
	390-0057	4	TERMINAL	
	125-2627	2	TERMINAL	
13	362-8040	1	CONNECTOR	
	390-0057	2	TERMINAL	
	NSS	4	PLUG	
14	424-2025	1	CONNECTOR	
	390-0057	8	TERMINAL	
15	362-6365	1	CONNECTOR	
	456-1580	19	TERMINAL	
	NSS	1	PLUG	
16	234-1857	1	CONNECTOR	
	456-1575	7	TERMINAL	

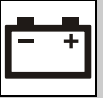

Figure 10-15 Cab Floor Harness

Item	Part Number	Qty.	Description	Rev.
	303-4970	1	TERMINAL	
	8T-8737	3	SEAL	
37	9W-1951	1	CONNECTOR	
	303-4969	7	TERMINAL	
	8T-8737	2	PLUG	
	NSS	1	SHIELD	
38	424-2025	2	CONNECTOR	
	390-0057	5	TERMINAL	
	NSS	3	PLUG	
39	362-6356	1	CONNECTOR	
	456-1535	4	TERMINAL	
	NSS	1	PLUG	
40		1	TERMINAL	
	110-9198	19	PLUG	
	456-1528	16	TERMINAL	
41	456-1545	1	CONNECTOR	
	197-6419	5	TERMINAL	
	169-0705	1	PLUG	
42	456-1531	1	CONNECTOR	
	456-1528	22	TERMINAL	
	110-9198	13	PLUG	
43	456-1529	1	CONNECTOR	
	110-9198	4	PLUG	
	456-1528	10	TERMINAL	
44	273-5621	1	CONNECTOR	
	456-1528	19	TERMINAL	
	110-9198	17	PLUG	
46	362-6353	2	CONNECTOR	
	456-1585	1	TERMINAL	
47	362-6354	3	CONNECTOR	
	456-1587	1	TERMINAL	
48	334-5866	2	CONNECTOR	
	456-1577	1	TERMINAL	
49	456-1526	1	CONNECTOR	
	456-1517	14	TERMINAL	
	NSS	1	PLUG	
50	456-1534	1	CONNECTOR	
	456-1535	4	TERMINAL	
51	362-6367	1	CONNECTOR	
	110-9198	3	PLUG	
	456-1528	5	TERMINAL	
52	456-1532	1	CONNECTOR	
	456-1528	27	TERMINAL	
	110-9198	8	PLUG	
53	456-1515	1	CONNECTOR	
	456-1517	8	TERMINAL	
	NSS	1	PLUG	
54	368-9616	3	CONNECTOR	
	390-0057	2	TERMINAL	

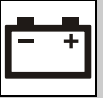

Figure 10-19 DPF Jumper Harness

Item	Part Number	Qty.	Description	Rev.
1	399-7795	1	DPF JUMPER HARNESS, (92.5 kW &106 kW) (includes all items)	B
	334-5873	1		
	9X-3401	6		
2	239-7349	1	CONNECTOR	
	356-2911	3	TERMINAL	
	110-9198	1	PLUG	
3	281-8811	1	CONNECTOR	
	356-2911	3	TERMINAL	
	110-9198	3	PLUG	

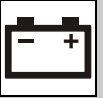

Figure 10-23 LMIS Lift Extension Harness

Item	Part Number	Qty.	Description	Rev.
1	452-7063	1	LMIS LIFT EXTENSION HARNESS, (includes all items)	A
	217-5888	2	CONNECTOR	
	217-5893	4	TERMINAL	
2	NSS	1	PLUG	
	448-4925	2	CONNECTOR	
	222-8880	3	TERMINAL	
	NSS	1	PLUG	

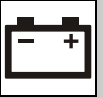

Figure 10-27 A/C Harness

Item	Part Number	Qty.	Description	Rev.
1	444-0110	1	A/C HARNESS, (includes all items)	C
	460-4116	3	CONNECTOR	
	335-1516	1	WEDGELOCK	
	303-4970	2	TERMINAL	
	8T-8737	1	PLUG	
2	334-5871	1	CONNECTOR	
	305-5449	1	WEDGELOCK	
	303-4970	2	TERMINAL	
3	323-7236	2	CONNECTOR	
	334-4128	1	WEDGELOCK	
	303-4969	2	TERMINAL	
4	334-5867	1	TERMINAL RING	
5	456-1570	1	TERMINAL RING	

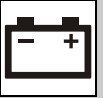

Figure 10-32 Tow Hitch Harness

Item	Part Number	Qty.	Description	Rev.
1	318-0428	1	TOW HITCH HARNESS, (includes all items)	A
	334-5870	1	PLUG CONNECTOR, (includes rear seal)	
	305-5450	1	SECONDARY WEDGE LOCK	
	303-4970	4	TERMINAL	
2	334-5871	2	PLUG CONNECTOR, (includes rear seal)	
	305-5449	1	SECONDARY WEDGE LOCK	
	303-4970	2	TERMINAL	
3	456-1566	2	CONNECTOR	
	196-2413	3	TERMINAL	
	299-0312	1	RELAY	

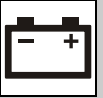

Figure 10-37 DPF Switch Harness

Item	Part Number	Qty.	Description	Rev.
1	417-4130	1	DPF SWITCH HARNESS, (includes all items)	A
	417-4128	1	CONNECTOR	
	390-0057	8	TERMINAL	
2	456-1515	1	CONNECTOR	
	6T-7929	5	TERMINAL	



Figure 11-1 Cab & Frame Decals (Continued)

Item	Part Number	Qty.	Description	Rev.



Part Number	Page	Part Number	Page	Part Number	Page	Part Number	Page	
281-1784	10-26	299-0956	10-44, 10-53		10-65, 10-71,	309-4318	3-7, 3-9	
281-8811	10-44, 10-91	299-0957	10-53		10-72, 10-73,	309-4322	3-7, 3-9	
293-2145	5-53, 5-69	299-710610-44, 10-48, 10-54,			10-74, 10-79,	309-4323	3-7, 3-9	
294-9800	5-13, 5-33, 5-53, 5-69	10-58, 10-61,			10-80, 10-81,	309-6302	9-5	
295-3349	3-33	10-97			10-82, 10-87,	309-6346	8-3	
297-7015	4-6, 4-11	299-710710-53, 10-61, 10-65,			10-89, 10-93,	309-6347	8-11	
297-7033	3-7, 3-9	10-93, 10-105			10-103, 10-105,	309-6349	8-17	
297-7077	3-7, 3-9	299-8229	4-17		10-109, 10-111,	309-6355	8-29, 8-33, 8-35	
297-7091	6-13, 8-23	2H-3922	10-7		10-113, 10-117,	309-9153	3-19	
297-7103	4-6, 4-11, 4-12, 4-19, 4-21, 4-31, 4-32, 4-33, 4-38, 4-39, 4-43, 8-8, 10-8, 10-16, 10-17	2H-3934	8-3		10-121, 10-125,	309-9184	1-7, 2-13, 4-39, 8-3, 10-7, 10-13, 10-16	
297-7107	4-7	2L-1701	3-19		10-127, 10-129,	311-2532	5-21, 5-41, 5-59, 5-75	
298-0462	8-11, 8-23	2R-1236	3-14		10-133	311-3901	4-15	
298-0463	8-21, 8-24, 8-29, 8-33	2S-3440	8-4	303-497110-44, 10-48, 10-54, 10-58, 10-74, 10-82	303-497110-44, 10-48, 10-54, 10-58, 10-74, 10-82	311-8219	5-87	
298-0464	3-14, 8-29	2V-82601-17, 6-12, 6-13, 10-9			303-4988	3-4, 3-7, 3-9	311-8220	5-87
298-0465	8-15, 8-17, 8-21, 8-23, 8-27, 8-29, 8-33, 8-35	300-6078	3-7, 3-9, 3-15		303-8599	4-33	311-8221	5-87
298-0466	4-32, 4-33, 4-39, 4-40, 4-43	300-6079	3-7, 3-9, 3-15		304-2566	6-6	312-3282	2-4
298-0468	8-3	300-6095	8-29		304-2604	9-23	312-3330	10-8, 10-11
298-0471	8-3	300-6096	4-7, 4-11, 4-31, 4-33, 4-39, 4-40, 4-43		304-3885	4-27	312-3332	10-35
298-0472	8-13, 8-29, 8-33	301-9752	3-19		304-8239	4-27	312-3338	3-5
298-0473	8-13, 8-23	301-9754	3-19		304-8242	9-23	312-5983	6-44
298-0474	8-29	301-9755	3-19		305-2107	10-38, 10-39	313-3349	3-7
298-0475	8-15, 8-17	301-9756	3-19		305-2108	10-38, 10-39	313-5671	10-53
298-0490	8-3	301-9757	3-4		305-2109	10-38, 10-39, 10-40	314-5316	11-4
298-0492	8-13	301-9758	3-4		305-5431	9-31	314-5322	11-4
298-0497	8-29	303-4741	3-4, 3-7, 3-9		305-5438	7-15	314-5512	9-23
298-0500	8-13	303-4754	8-23		305-544910-44, 10-48, 10-53, 10-58, 10-61, 10-63, 10-65, 10-67, 10-111, 10-119, 10-121, 10-125	305-5450	10-65, 10-97, 10-117, 10-121, 10-129	
298-0503	4-33, 4-40	303-4760	3-9		305-5460	9-31	314-5527	5-79
298-0505	8-27	303-4765	4-6, 4-11, 8-3		305-5502	10-72, 10-80	314-5545	4-21, 4-23
298-0507	3-7	303-4777	1-24, 10-17		308-6515	4-17	314-5546	4-23
298-0508	8-21, 8-24, 8-29, 8-33, 8-35	303-4779	10-11, 10-16, 10-27		308-7576	4-17	314-5551	4-21
298-0539	4-31, 4-38, 7-3	303-4782	3-4, 3-7, 3-9		309-2963	8-8	314-5552	4-21
298-0540	2-15	303-4785	6-23, 6-24		309-2972	10-9	314-5567	10-38, 10-40
298-1612	3-7, 3-9	303-4787	6-44, 10-22		309-2978	4-32, 4-39	314-5568	1-5, 4-34, 4-40
298-5100	4-17	303-4790	2-12, 8-30, 8-35, 10-17		309-2979	3-4, 3-5	314-5591	4-27
298-6434	7-11	303-4942	11-4		309-3992	1-24, 10-17	314-5608	4-31, 4-32, 4-33, 4-38, 4-40, 4-43
298-7341	4-6, 4-7, 4-11	303-4943	11-9		309-3996	1-24, 7-7, 10-17, 10-39	314-5619	4-27
298-7355	8-3, 8-29, 8-33	303-4948	11-4		309-3997	1-4, 1-7, 1-8, 2-3, 4-21, 4-23, 4-25, 4-32, 4-33, 4-39, 4-40, 4-47, 4-49, 5-79, 6-38, 6-39, 6-44, 8-30, 8-33, 10-16	314-5620	4-23, 6-46
298-7356	2-12, 8-3, 8-29	303-4955	10-38, 10-39				314-5621	4-19, 4-23
298-7358	3-7, 3-14	303-4956	10-38, 10-39				314-5622	4-21
298-7388	1-4	303-4957	3-4, 3-7, 3-9				314-5623	6-38
298-7389	8-3	303-4958	3-4, 3-7, 3-9				314-8479	3-14, 3-15
298-7392	3-7, 3-9	303-496910-53, 10-58, 10-61, 10-65, 10-67, 10-72, 10-73, 10-74, 10-80, 10-81, 10-82, 10-89, 10-95, 10-99, 10-103, 10-105, 10-109, 10-111, 10-115, 10-117, 10-119, 10-125, 10-127, 10-129					314-8932	5-5
298-7405	9-21						314-8933	5-45
298-7406	9-21						315-3594	2-12
299-0312	10-121						315-3595	2-3
299-0354	6-20, 11-5						315-3596	8-21
299-0621	9-21						315-3599	8-15
299-0622	9-21						315-3600	8-15, 8-17
							315-3601	8-23, 8-27
							315-3603	8-11
							315-3604	8-11
							315-3606	8-11

CLICK HERE TO **DOWNLOAD** THE COMPLETE MANUAL

- Thank you very much for reading the preview of the manual.
- You can download the complete manual from: www.heydownloads.com by clicking the link below



- Please note: If there is no response to CLICKING the link, please download this PDF first and then click on it.

CLICK HERE TO **DOWNLOAD** THE COMPLETE MANUAL