

PARTS MANUAL

Manual Number 9109

Manual Part Number 300206-001

OE-35 ELECTRIC ORDER SELECTOR

OE-35

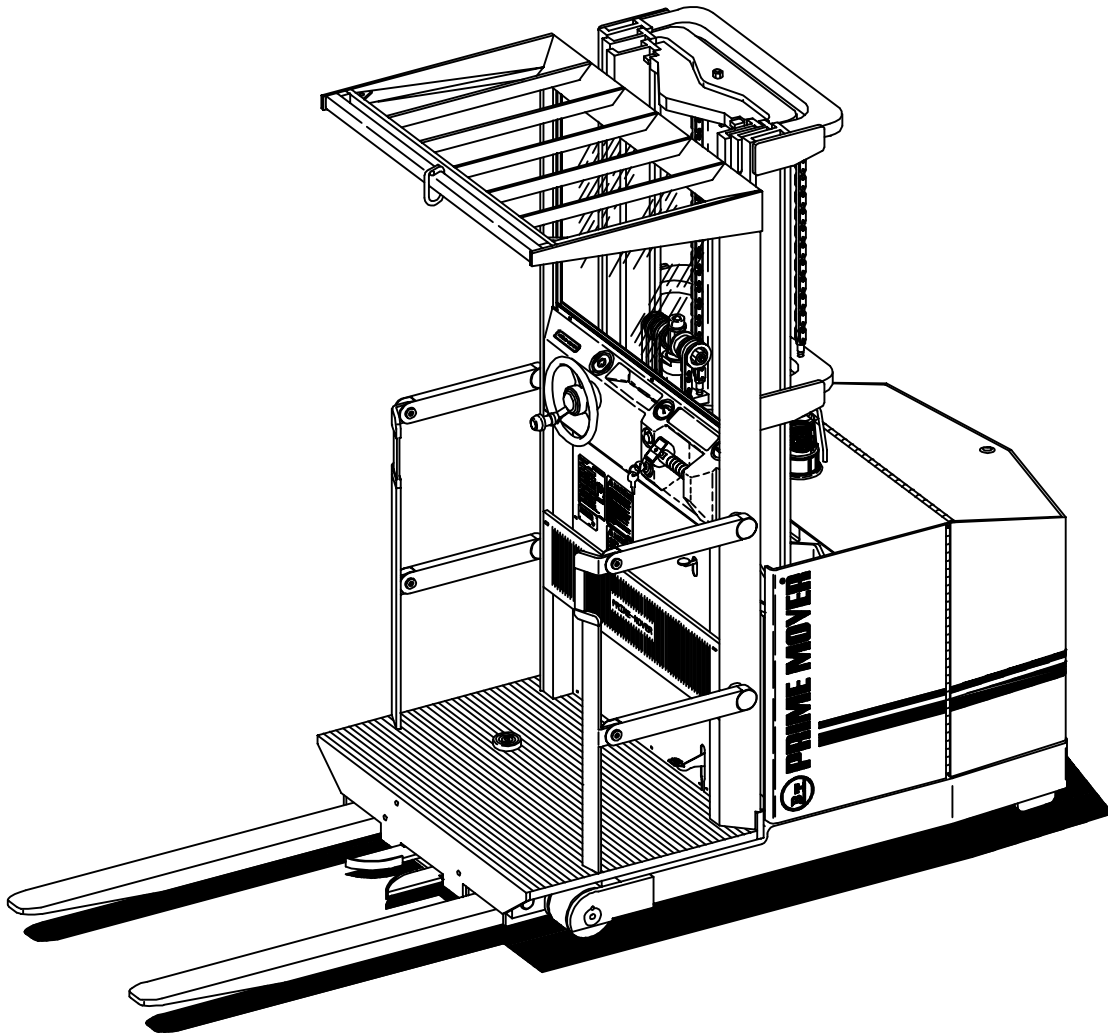

⚠ WARNING

Read and observe all warnings on this unit before operating it.

⚠ WARNING

DO NOT operate this equipment unless all factory installed guards and shields are properly secured in place.

CLICK HERE TO **DOWNLOAD** THE COMPLETE MANUAL

- Thank you very much for reading the preview of the manual.
- You can download the complete manual from: www.heydownloads.com by clicking the link below



- Please note: If there is no response to CLICKING the link, please download this PDF first and then click on it.

CLICK HERE TO **DOWNLOAD** THE COMPLETE MANUAL

FIG #	ITEM #	PART #	NAME	# FOR ASSY.	UNIT
1.1	1	11143-08	Screw, cap	1	
1.1	2	11009-06	Lockwasher	1	
1.1	3	15677-04	Clamp	1	
1.1	4	26618-03	Spacer	1	
1.1	5	11898-07	Ring, retainer	1	
1.1	6	26379-00	Bracket	1	
1.1	7	29112-00	Frame, main (See Section # 4)	1	
1.1	8	11009-08	Lockwasher	3	
1.1	9	14994-08	Screw, cap	3	
1.1	10	25194-01	Bearing, roller	4	
1.1	11	29132-00	Eccentric, bearing adjuster	4	
1.1	12	11852-51	Screw, cap	4	
1.1	12	49442-00	Screw, cap (Cold storage)	4	
1.1	13	11936-04	Washer, flat	4	
1.1	14	-----	Transmission assembly (See Fig.# 1.2, 1.3)	1	
1.1	15	20069-01	Washer	1	
1.1	16	20070-01	Bearing	1	
1.1	17	14986-03	Nut, twin	1	
1.1	18	49965-00	Switch	1	
1.1	19	11880-08	Screw, machine	2	
1.1	20	11806-10	Nut, jam	4	

FIG #	ITEM #	PART #	NAME	# FOR ASSY.	UNIT
2.4	1	11261-05	Nut	1	
2.4	2	11009-05	Lockwasher	1	
2.4	3	15677-08	Clamp, open	2	
2.4	4		<u>MALE ON SPRING SIDE</u>		
			TWO STAGE MAST		
2.4	4	26654-11	Cable assembly	1	83/122
2.4	4	26654-12	Cable assembly	1	95/144
2.4	4	26654-13	Cable assembly	1	107/168
2.4	4	26654-14	Cable assembly	1	119/186
2.4	4	26654-25	Cable assembly	1	126/198
			THREE STAGE MAST		
2.4	4	26654-16	Cable assembly	1	83/180
2.4	4	26654-17	Cable assembly	1	87/189
2.4	4	26654-18	Cable assembly	1	90/198
2.4	4	26654-19	Cable assembly	1	103/225
2.4	4	26654-22	Cable assembly	1	110/240
2.4	4	26654-23	Cable assembly	1	119/258
2.4	4	26654-24	Cable assembly	1	125/270
2.4	4	26654-26	Cable assembly	1	133/288
2.4	5		<u>FEMALE ON SPRING SIDE</u>		
			TWO STAGE MAST		
2.4	5	26654-01	Cable assembly	1	83/122
2.4	5	26654-02	Cable assembly	1	95/144
2.4	5	26654-03	Cable assembly	1	107/168
2.4	5	26654-04	Cable assembly	1	119/186
2.4	5	26654-05	Cable assembly	1	126/198
			THREE STAGE MAST		
2.4	5	26654-06	Cable assembly	1	83/180
2.4	5	26654-07	Cable assembly	1	87/189
2.4	5	26654-08	Cable assembly	1	90/198
2.4	5	26654-09	Cable assembly	1	103/225
2.4	5	26654-20	Cable assembly	1	110/240
2.4	5	26654-21	Cable assembly	1	119/258
2.4	5	26654-10	Cable assembly	1	125/270
2.4	5	26654-27	Cable assembly	1	133/288
2.4	6	11261-06	Nut	2	
2.4	7	11016-03	Washer, flat	2	
2.4	8	49934-00	Spring	2	

FIG #	ITEM #	PART #	NAME	# FOR ASSY.	UNIT
2.9	1	29223-00	Panel, 24 volt EV-100 LX SCR contactor	1	24 volt
2.9	1	29223-01	Panel, 36 volt EV-100 LX SCR contactor	1	36 volt
2.9	2	301525-000	Base	1	
2.9	3	200098	Contactor, forward & rearward (See Fig.# 2.10)	1	
2.9	4	50001-11	Lockwasher (8MM)	10	
2.9	5	50003-01	Screw, cap (M8X1.25MM 16M LG)	10	
2.9	6	300074-000	Contactor, 24 volt emergency disconnect (See Fig.# 2.14)	1	24 volt
2.9	6	301265-000	Contactor, 36 volt emergency disconnect (See Fig.# 2.14)	1	36 volt
2.9	7	300108-000	Bar, buss	1	
2.9	8	50000-13	Washer, flat (8.4MM)	As Req'd.	
2.9	9	300073-000	Contactor, power steering (See Fig.# 2.12)	1	
2.9	10	27693-02	Contactor, 24 volt lift pump (See Fig.# 2.13)	1	24 volt
2.9	10	27693-04	Contactor, 36 volt lift pump (See Fig.# 2.13)	1	36 volt
2.9	11	300112-000	Bar, buss	1	
2.9	12	301521-000	Bar, buss	1	
2.9	13	301522-000	Bar, buss	1	
2.9	14	27693-02	Contactor, 1A (See Fig.# 2.11)	1	
2.9	15	NSS	Screw, machine 3.5m x .6mm x 8mm long	2	
2.9	16	201324	Fuse, 15 AMP	1	
2.9	17	300111-000	Bar, fuse buss	1	
2.9	*	301523-000	Label, fuse	2	
2.9	18	300110-000	Block, fuse	1	
2.9	19	301366-000	Harness, wiring	1	
2.9	20	202009	Suppression, forward and rearward	2	
2.9	20	202004	Suppression, 1A	1	
2.9	20	202010	Suppression, power steering pump	1	
2.9	20	202010	Suppression, lift pump	2	
2.9	21	301524-000	Standoff	1	
2.9	22	25094-04	Fuse, 300 AMP	1	
2.9	23	25094-03	Fuse, 400 AMP (24 volt)	1	24 volt
2.9	23	25094-04	Fuse, 300 AMP (36 volt)	1	36 volt
2.9	24	29410-00	Decal, 300 AMP	1	
2.9	25	29410-01	Decal, 400 AMP (24 volt)	1	24 volt
2.9	25	29410-00	Decal, 300 AMP (36 volt)	1	36 volt

FIG #	ITEM #	PART #	NAME	# FOR ASSY.	UNIT
2.14	1	201962	Base, magnet	1	
2.14	2	200077	Coil, 24 volt field	1	24 volt
2.14	2	301490-000	Coil, 36 volt field	1	36 volt
2.14	3	201963	Frame, magnet	1	
2.14	4	300073-001	Spring (BLUE)	1	
2.14	5	204255	Armature	1	
2.14	6	200081	Base, buss	1	
2.14	7	300073-002	Tip, contact	1	
2.14	8	300073-003	Tip, contact	1	
2.14	9	200096	Bushing	1	
2.14	10	200095	Carrier	1	
2.14	11	300073-004	Tip, movable	1	
2.14	12	200094	Seat	1	
2.14	13	201263	Spring (RED)	1	
2.14	14	201259	Cap	1	
2.14	15	201367	Washer, flat	1	
2.14	16	201215	Nut, lock	1	
2.14	17	201967	Clamp	2	
2.14	18	201368	Lockwasher	4	
2.14	19	201372	Screw, machine	4	
2.14	20	27270-00	Kit, interlock switch (Contains items marked with "K")	1	
2.14	21K	NSS	Screw, machine	2	
2.14	22K	NSS	Washer, flat	2	
2.14	23K	NSS	Screw, machine	4	
2.14	24K	NSS	Bracket, right hand	1	
2.14	25K	NSS	Brack, left hand	1	
2.14	26K	NSS	Screw, machine	2	
2.14	27K	NSS	Switch, interlock	1	
2.14	28K	NSS	Bracket, switch mounting	1	

FIG #	ITEM #	PART #	NAME	# FOR ASSY.	UNIT
2.19	1	301503-000	Kit, coil field	1	
2.19	2	301505-000	Kit, lead	1	
2.19	3	301504-000	Brush	4	
2.19	4	300418-000	Spring, brush	4	
2.19	5	301493-000	Plate, brush	1	
2.19	6	300427-000	Ring, retainer	1	
2.19	7	300420-000	Bearing	1	
2.19	8	301506-000	Head, commutator end	1	
2.19	9	301495-000	Band, head	1	
2.19	10	301502-000	Armature assembly	1	
2.19	11	301280-000	Fan	1	
2.19	12	301501-000	Head, drive end	1	
2.19	13	301500-000	Seal	1	

FIGURE # 2.25 EV-100 LX TT ELECTRICAL SCHEMATIC SYMBOLS

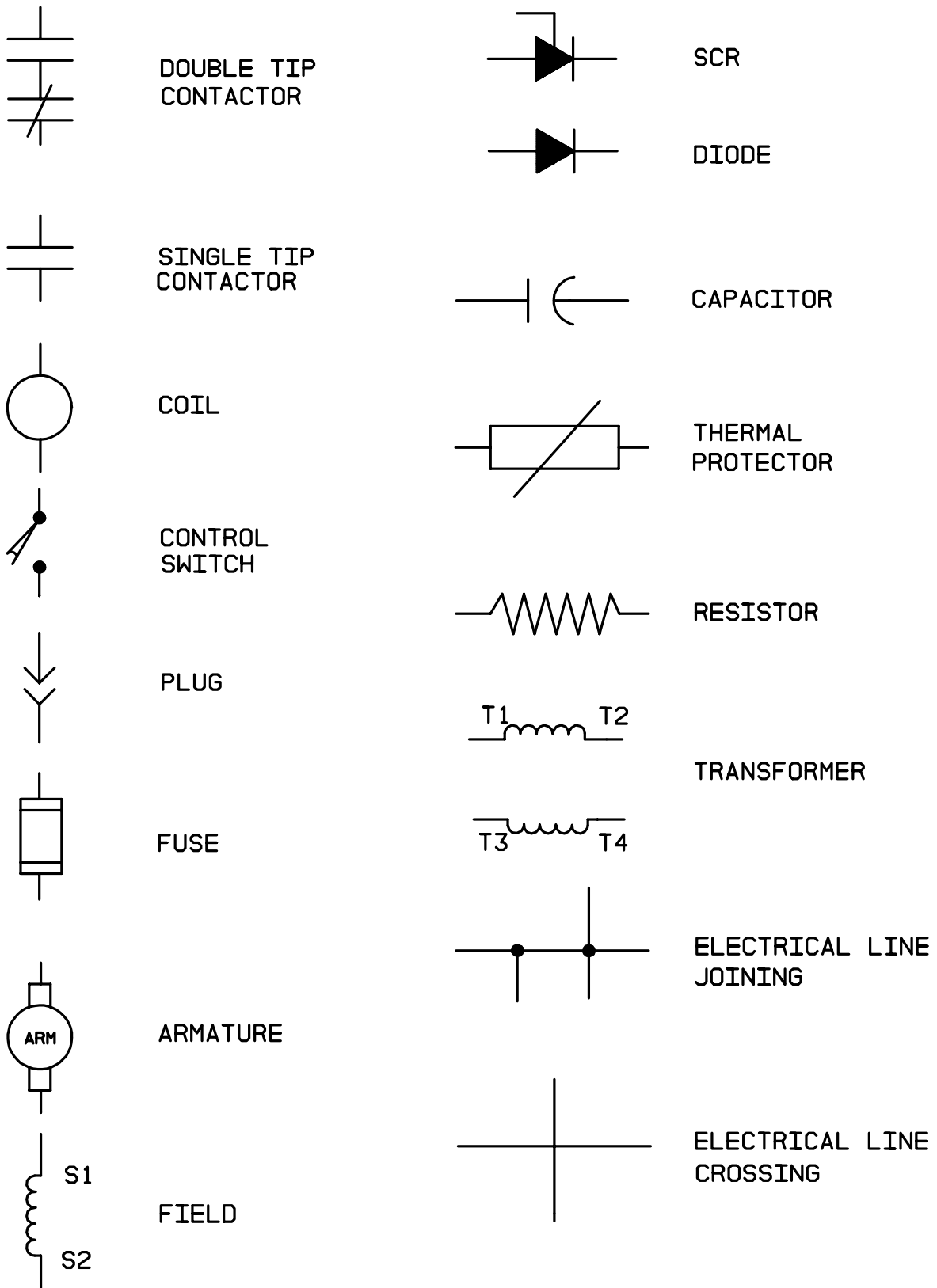

FIG #	ITEM #	PART #	NAME	# FOR ASSY.	UNIT
24 VOLT					
3.5	1	26915-00	Steering pump & motor assembly, 24 volt	1	24 VOLT
3.5	2	200075	Motor, 24 volt steering pump (See Fig.# 2.20)	1	24 VOLT
3.5	3	200727	Lockwasher	4	
3.5	4	200719	Screw, cap	4	
3.5	5	202038	Pump assembly	1	
3.5	6	201997	Kit, coupler	1	
3.5	7	200765	Gasket	1	
3.5	8	NSS	Pump, steering (See Fig.# 3.6)	1	
36 VOLT					
3.5	9	29471-00	Steering pump & motor assembly, 36 volt	1	36 VOLT
3.5	10	301492-000	Motor, 36 volt steering pump (See Fig.# 2.21)	1	36 VOLT
3.5	11	200727	Lockwasher	4	
3.5	12	200719	Screw, cap	4	
3.5	13	202038	Pump assembly	1	
3.5	14	201997	Kit, coupler	1	
3.5	15	200765	Gasket	1	
3.5	16	NSS	Pump, steering (See Fig.# 3.6)	1	
3.5	17	41243-00	Coil, 36 volt <u>(NOT PART of PUMP and MOTOR ASSEMBLY)</u>	1	

NSS - Not Sold Separately

CLICK HERE TO **DOWNLOAD** THE COMPLETE MANUAL

- Thank you very much for reading the preview of the manual.
- You can download the complete manual from: www.heydownloads.com by clicking the link below



- Please note: If there is no response to CLICKING the link, please download this PDF first and then click on it.

CLICK HERE TO **DOWNLOAD** THE COMPLETE MANUAL

FIG #	ITEM #	PUMP # 29239-00	PUMP # 29470-00	NAME	# FOR ASSY.	UNIT
3.10	1K	NSS	NSS	Seal, oil	1	
3.10	2	NA	NA	Stator	1	
3.10	3	200033	200033	Pin, dowel	4	
3.10	4K	NSS	NSS	Plate, seal	2	
3.10	5K	NSS	NSS	Seal, plate	2	
3.10	6K	NSS	NSS	Plate, pressure	2	
3.10	7	300174-000	301558-000	Shaft, idler	2	
3.10	8	300175-000	301560-000	Shaft, drive	1	
3.10	9	300176-000	301561-000	Pin, shear	2	
3.10	10	300177-000	301559-000	Gear	2	
3.10	11	300178-000	300178-000	Ring, retainer	4	
3.10	12K	NSS	NSS	Plate, wear	2	
3.10	13K	NSS	NSS	Back-up, seal	2	
3.10	14K	NSS	NSS	Seal, plate	2	
3.10	15	NA	NA	Housing, gear	1	
3.10	16K	NSS	NSS	O ring	2	
3.10	17	NA	NA	Housing, end gear	1	
3.10	18	202065	202065	Plug	1	
3.10	19	300179-000	300179-000	Screw	8	
3.10	20	202045	-----	Valve, 24 volt solenoid release	1	24 volt
3.10	20	-----	NA	Valve, 36 volt solenoid release	1	36 volt
3.10	21	41243-01	41243-01	Coil, 24 volt	1	24 volt
3.10	21	-----	41243-00	Coil, 36 volt	1	36 volt
3.10	22	202047	202047	Valve	1	
3.10	23	200073	200073	Kit, seal	1	
3.10	24K	NSS	NSS	O ring	1	
3.10	25K	NSS	NSS	O ring	1	
3.10	26K	NSS	NSS	Back-up, ring	1	
3.10	27	300183-000	300183-000	Seal	1	
3.10	28	300180-000	300180-000	Ball	1	
3.10	29	300181-000	300181-000	Spring	1	
3.10	30	300182-000	300182-000	Cap assembly	1	
3.10	K	300184-000	300184-000	Kit, seal	1	

(CONTAINS ITEMS MARKED WITH "K")

NA - NOT AVAILABLE
NSS - NOT SOLD SEPARATELY

FIG #	ITEM #	PART #	NAME	# FOR ASSY.	UNIT
3.15	1	28130-12	Tube, 83/180 cylinder	1	83/180
3.15	1	28130-13	Tube, 87/189 cylinder	1	87/189
3.15	1	28130-14	Tube, 90/198 cylinder	1	90/198
3.15	1	28130-16	Tube, 103/225 cylinder	1	103/225
3.15	1	28130-17	Tube, 110/240 cylinder	1	110/240
3.15	1	28130-18	Tube, 119/258 cylinder	1	119/258
3.15	1	28130-20	Tube, 125/270 cylinder	1	125/270
3.15	1	28130-31	Tube, 133/288 cylinder	1	133/288
3.15	1	28130-32	Tube, 140/300 cylinder	1	140/300
3.15	2	30555-00	Retainer	1	
3.15	3	30556-00	Pin	1	
3.15	4	30612-01	Spring	1	
3.15	5	13857-01	Ball	1	
3.15	6	28437-00	Piston	1	
3.15	7K	NSS	Ring, wear	1	
3.15	8	29102-11	Rod, 83/180 cylinder	1	83/180
3.15	8	29102-03	Rod, 87/189 cylinder	1	87/189
3.15	8	29102-04	Rod, 90/198 cylinder	1	90/198
3.15	8	29102-06	Rod, 103/225 cylinder	1	103/225
3.15	8	29102-07	Rod, 110/240 cylinder	1	110/240
3.15	8	29102-08	Rod, 119/258 cylinder	1	119/258
3.15	8	29102-10	Rod, 125/270 cylinder	1	125/270
3.15	8	29102-12	Rod, 133/288 cylinder	1	133/288
3.15	8	29102-13	Rod, 140/300 cylinder	1	140/300
3.15	9K	NSS	O ring	1	
3.15	10K	NSS	Ring, backup	1	
3.15	11	28142-00	Bearing	1	
3.15	12K	NSS	Ring, wear	1	
3.15	13K	NSS	Seal	1	
3.15	14K	NSS	Wiper	1	
3.15	K	28200-00	Kit, seal	1	

(CONTAINS ITEMS MARKED WITH "K")

FIG #	ITEM #	PART #	NAME	# FOR ASSY.	UNIT
4.4	1	11170-04	Nut	4	
4.4	2	11009-04	Lockwasher	4	
4.4	3	49526-00	Base	2	
4.4	4	49526-00	Ball	4	
4.4	5	49527-00	Strap	2	
4.4	6	11045-04	Screw, cap	4	
4.4	7	29172-00	Pad, pedal	1	
4.4	8	29168-00	Pedal	1	
4.4	9	11271-35	Setscrew	1	
4.4	10	49520-00	Spring	1	
4.4	11	20323-00	Switch	1	
4.4	12	29167-00	Zee	1	
4.4	13	14986-03	Nut, twin	1	
4.4	14	49751-04	Nut	2	
4.4	15	23309-01	Horn	1	
4.4	16	14805-04	Spacer	1	
4.4	17	11854-08	Screw, cap	1	
4.4	18	11854-04	Screw, cap	1	
4.4	19	11880-08	Screw, machine	2	

FIG #	ITEM #	PART #	NAME	# FOR ASSY.	UNIT
4.9	1	14958-00	Line, tether	1	
4.9	2	14959-00	Belt, safety (Standard)	1	Standard
4.9	2	300220-000	Belt, safety (X-large)	1	X-large
4.9	3	29103-00	Platform, 3 stage 83 inch down hight	1	
4.9	3	29103-01	Platform, 2 stage 83 inch down hight	1	
4.9	3	29103-02	Platform, 3 stage 87 inch down hight	1	
4.9	3	29103-03	Platform, 2 stage 87 inch down hight	1	
4.9	4	49832-00	Bearing	4	
4.9	5	11857-10	Shim, .050"	As Req'd.	
4.9	5	11857-11	Shim, .025"	As Req'd.	

FIG #	ITEM #	PART #	NAME	# FOR ASSY.	UNIT
5.2	1	29089-01	Column, 83/122 outer	1	83/122
5.2	1	29089-02	Column, 95/144 outer	1	95/144
5.2	1	29089-03	Column, 107/168 outer	1	107/168
5.2	1	29089-04	Column, 119/186 outer	1	119/186
5.2	1	29089-05	Column, 126/198 outer	1	126/198
5.2	2	11857-05	Shim, .050"	As Req'd.	
5.2	2	11857-09	Shim, .080"	As Req'd.	
5.2	3	21089-02	Bearing	2	
5.2	4	14835-15	Chain, 83/122 lift	2	83/122
5.2	4	14835-72	Chain, 95/144 lift	2	95/144
5.2	4	14835-40	Chain, 107/168 lift	2	107/168
5.2	4	14835-73	Chain, 119/186 lift	2	119/186
5.2	4	14835-74	Chain, 126/198 lift	2	126/198
5.2	5	30558-00	Anchor, chain	2	
5.2	6	30554-00	Pin	2	
5.2	7	11157-03	Pin, cotter	4	
5.2	8	14891-00	Nut, wheel	2	
5.2	9	11486-12	Nut, jum	2	
5.2	10	14994-10	Screw, cap	1	
5.2	11	26617-03	Spacer	2	
5.2	12	26592-03	Sheave	2	
5.2	13	26493-01	Bearing	2	
5.2	14	26618-04	Spacer	1	
5.2	15	11009-08	Lockwasher	3	
5.2	16	14994-05	Screw, cap	2	
5.2	17	30600-01	Bar, cylinder	1	
5.2	18	29101-11	Cylinder, 83/122 outer	1	83/122
5.2	18	29101-12	Cylinder, 95/144 outer	1	95/144
5.2	18	29101-13	Cylinder, 107/168 outer	1	107/168
5.2	18	29101-14	Cylinder, 119/186 outer	1	119/186
5.2	18	29101-15	Cylinder, 126/198 outer	1	126/198
5.2	19	26692-00	Bar	1	
5.2	20	11009-06	Lockwasher	1	
5.2	21	11143-04	Screw, cap	2	

FIG #	ITEM #	PART #	NAME	# FOR ASSY.	UNIT
5.7	1	14994-05	Screw, cap	4	
5.7	2	11009-08	Lockwasher	5	
5.7	3	29088-08	Column, 83/180 inner	1	83/180
5.7	3	29088-02	Column, 87/189 inner	1	87/189
5.7	3	29088-03	Column, 90/198 inner	1	90/198
5.7	3	29088-04	Column, 103/225 inner	1	103/225
5.7	3	29088-05	Column, 110/240 inner	1	110/240
5.7	3	29088-06	Column, 119/258 inner	1	119/258
5.7	3	29088-07	Column, 125/270 inner	1	125/270
5.7	3	29088-08	Column, 133/288 inner	1	133/288
5.7	3	29088-09	Column, 140/300 inner	1	140/300
5.7	4	11857-05	Shim, .050"	As Req'd.	
5.7	4	11857-09	Shim, .080"	As Req'd.	
5.7	5	21089-02	Bearing	2	
5.7	6	26563-00	Sheave	1	
5.7	7	14994-05	Screw, cap	1	
5.7	8	14994-11	Screw, cap	1	
5.7	9	26617-03	Spacer	2	
5.7	10	26592-03	Sheave	2	
5.7	11	26493-01	Bearing	2	
5.7	12	26618-04	Spacer	1	
5.7	13	-----	Freelift cylinder assembly (See Fig.# 5.8)	1	

FIGURE # 7.4 36 VOLT N.D.C. ELECTRICAL SCHEMATIC SYMBOLS

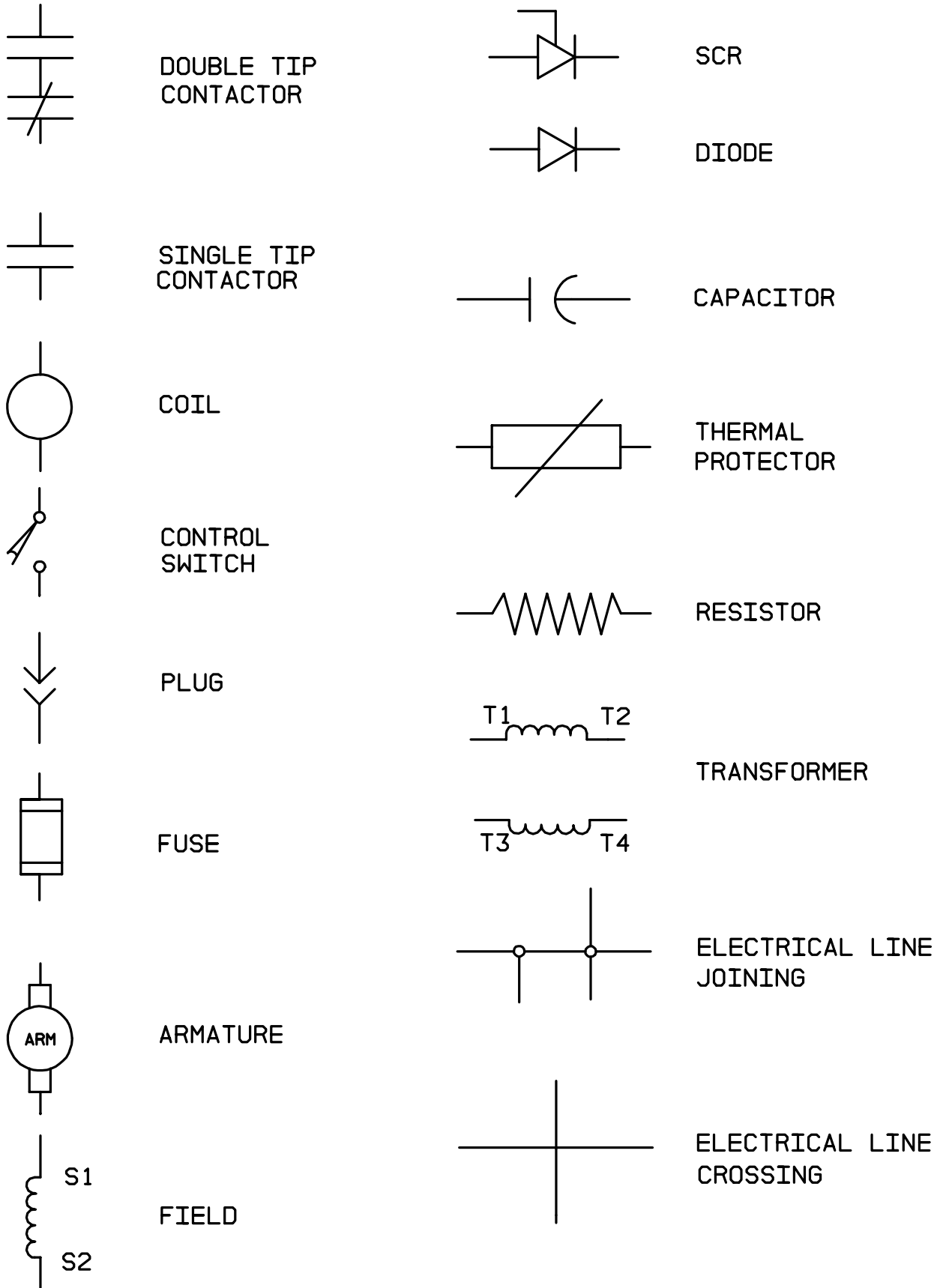

FIG #	ITEM #	PART #	NAME	# FOR ASSY.	UNIT
7.9	1	11854-13	Screw, cap	2	
7.9	2	29236-00	Plate, mounting	1	
7.9	3	11143-05	Screw, cap	2	
7.9	4	29366-00	Plate, ACC-10 mounting	1	
7.9	5	29357-00	Potentiometer	1	
7.9	6*	300824-000	Unit, ACC-10 NDC system frequency	1	24 VOLT
7.9	6*	300824-001	Unit, ACC-10 NDC system frequency	1	36 VOLT
7.9	6*	300825-000	Unit, ACC-10 PORTEC system frequency	1	24 VOLT
7.9	6*	300825-001	Unit, ACC-10 PORTEC system frequency	1	36 VOLT
7.9	6*	300849-000	Unit, ACC-10 special system frequency	1	24 VOLT
7.9	6*	300849-001	Unit, ACC-10 special system frequency	1	36 VOLT
7.9	7	11016-01	Washer, flat	5	
7.9	8	11009-04	Lockwasher	5	
7.9	9	11045-02	Screw, cap	5	
7.9	10	49387-00	Block, fuse	1	
7.9	11	29390-00	Base, relay	1	
7.9	12	29389-00	Relay, number 2 contactor	1	
7.9	13	25275-09	Fuse, 20 AMP	1	
7.9	14	25275-08	Fuse, 3 AMP	2	
7.9	15	14913-02	Screw, machine	2	
7.9	16	11016-21	Washer, flat	4	
7.9	17	11009-05	Lockwasher	4	
7.9	18	11880-03	Screw, machine	4	
7.9	19	29375-00	Angle	1	
7.9	20	11261-05	Nut	2	
7.9	21	11009-05	Lockwasher	2	
7.9	22	29388-00	Relay, number 1 contactor	1	
7.9	23	11261-06	Nut	2	
7.9	24	11009-06	Lockwasher	2	
7.9	25	29472-00	Valve, control (See Fig.# 3.11)	1	

NOTE: When ordering item number 6 ALWAYS SPECIFIC MANUFACTURERS [NDC] PART NUMBER..

MODEL OE-35 ELECTRIC ORDER SELECTOR

NUMERICAL INDEX

This Numerical Index gives part numbers and figure numbers on which they are listed. Item numbers have also been listed for easier location of part numbers.

<u>PART #</u>	<u>FIG. #</u>	<u>ITEM #</u>	<u>PART #</u>	<u>FIG. #</u>	<u>ITEM #</u>
PM-4011	10.1	1	11009-06	3.9	2
PM-4246	10.1	2	11009-06	3.3	19
11003-05	1.2	25	11009-08	5.7	2
11009-01	2.26	23	11009-08	1.2	27
11009-01	2.8	11	11009-08	5.2	15
11009-01	7.11	7	11009-08	1.1	8
11009-03	2.8	7	11009-08	5.6	11
11009-03	7.8	4	11009-08	5.5	18
11009-03	2.3	12	11009-08	5.3	9
11009-03	7.10	9	11009-13	7.11	19
11009-04	6.1	9F	11015-06	3.8	4
11009-04	2.26	18	11015-06	3.3	27
11009-04	7.12	4	11015-09	1.3	26
11009-04	2.15	2	11015-09	1.2	17
11009-04	4.4	2	11015-34	1.2	13
11009-04	2.6	8	11015-35	1.2	18
11009-04	4.10	11	11015-35	1.3	28
11009-04	4.8	5	11016-01	2.26	16
11009-04	2.21	6	11016-01	7.9	7
11009-04	7.9	8	11016-01	7.12	5
11009-04	6.1		11016-02	7.10	3
11009-04	6.2	11	11016-02	4.12	3
11009-05	2.6	24	11016-02	4.8	21
11009-05	1.2	21	11016-02	4.7	5
11009-05	4.7	4	11016-02	4.10	16
11009-05	4.10	36	11016-02	7.8	12
11009-05	3.8	15	11016-02	4.10	40
11009-05	1.3	21	11016-02	1.2	23
11009-05	4.6	6	11016-03	2.22	13
11009-05	7.9	17	11016-03	4.7	11
11009-05	2.4	2	11016-03	2.22	6
11009-05	7.10	2	11016-03	7.6	7
11009-05	7.9	21	11016-03	7.11	16
11009-05	4.8	8	11016-03	2.4	7
11009-05	4.2	13	11016-03	1.2	2
11009-05	7.8	19	11016-03	3.3	3
11009-05	7.6	2	11016-03	4.1	8
11009-05	4.12	2	11016-11	4.8	6
11009-06	5.3	2	11016-12	3.8	14
11009-06	7.9	24	11016-12	4.6	5
11009-06	2.3	8	11016-12	3.3	22
11009-06	5.2	20	11016-12	2.8	14
11009-06	5.6	2	11016-12	2.6	2
11009-06	7.11	2	11016-21	7.9	16
11009-06	4.7	12	11016-21	2.8	10
11009-06	5.5	20	11016-21	2.26	24
11009-06	1.1	2	11016-21	7.11	6
11009-06	3.8	21	11016-23	2.23	*
11009-06	1.2	36	11016-25	7.8	3

CLICK HERE TO **DOWNLOAD** THE COMPLETE MANUAL

- Thank you very much for reading the preview of the manual.
- You can download the complete manual from: www.heydownloads.com by clicking the link below



- Please note: If there is no response to CLICKING the link, please download this PDF first and then click on it.

CLICK HERE TO **DOWNLOAD** THE COMPLETE MANUAL