

# HD 11

CRAWLER TRACTOR

## Parts Catalog

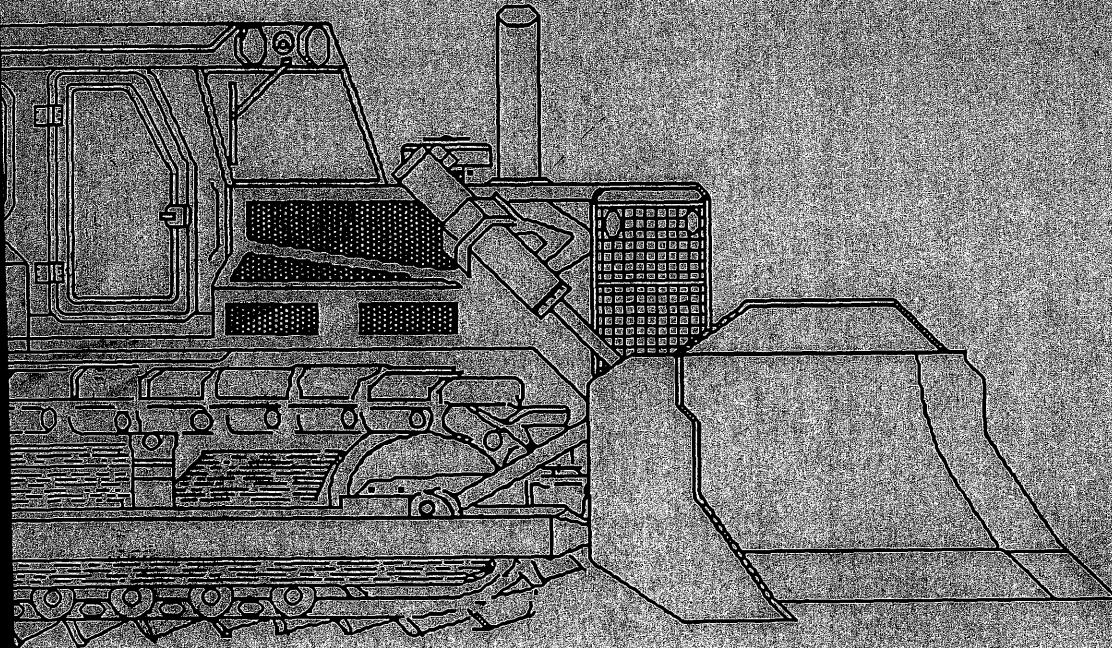

Form 70656800  
English 1/89

CLICK HERE TO **DOWNLOAD** THE COMPLETE MANUAL

- Thank you very much for reading the preview of the manual.
- You can download the complete manual from: [www.heydownloads.com](http://www.heydownloads.com) by clicking the link below



- Please note: If there is no response to CLICKING the link, please download this PDF first and then click on it.

CLICK HERE TO **DOWNLOAD** THE COMPLETE MANUAL

095887	919156	13-3/4	920850	920303	A	920865	919081	E	919076			
096002	919156	36-1/2	920850	920303	A	920865	919081	E	919076			639414
096003	919155	42-3/4	920849	920302	A	920864	919082	E	919075			
096095	919218	32-1/4	920865	919081	E	920865	919081	E	919076			
096098	919218	44	920865	919081	E	920865	919081	E	919076			
096116	919217	91-1/2	920864	919082	E	920864	919082	E	919075			
096117	919217	84-1/2	920864	919082	E	920864	919082	E	919075			
096122	919155	18-3/4	920857	919079	B	920836	919073	C	919075			
099527	920222	10-13/16	921033	921034	A	920843	919467	C	919282			
620709	919155	21-1/8	920849	920302	A	920836	919073	C	919075			644005
621292	919196	30	920847	920301	A	920862	919194	E	919143			
622431	919196	70	920847	920301	A	920862	919194	E	919143			
632147	919196	34-1/4	920877	919207	D	920862	919194	E	919143			
4335557	919196	7-7/8	920847	920301	A	920833	919200	C	919143			
4335567	920222	9-7/16		920173	L (short)		920141	L (long)	919282	919274	2-1/4"	
										919251	3"	
4335583	919196	10-1/8	920847	920301	A	920862	919194	E	919143			
4335716	919196	10-5/8	920847	920301	A	920833	919200	C	919143			
4335897	919155	7-3/4	920849	920302	A	920836	919073	C	919075			
4335898	919155	19-1/2	920849	920302	A	920864	919082	E	919075			
4335931	919196	7	920862	919194	E (short)	920869	919253	E (long)	919143			
4335935	919155	15-1/2	920849	920302	A	920864	919082	E	919075			
4337532	920222	6-7/16		920173	L (short)		920195	L (long)	919282	919251	3"	
4339568	920388	30		920806	A		920806	A	None			
4339569	920388	26		920806	A		920806	A	None			
4354675	919217	13	920849	920302	A	920849	920302	A	919075			
4376906	919196	16-3/8	920847	920301	A	920862	919194	E	919143			
	919156	14-5/8	920865	919081	E	920865	919081	E	919076			620941
	919156	12-1/8	920850	920303	A	920865	919081	E	919076			637871
	919155	22-1/4	920857	919079	B	920879	919159	D	919075			637872
	919155	13-1/4	920864	919082	E	920864	919082	E	919075			637873
	919156	32-5/8	920858	919080	B	920880	919254	D	919076			637890

(Continued)

MEMO

TIMING GEAR HOUSING (Continued)

ITEM	PART NO.	QTY.		DESCRIPTION
		*	**	
9	915969	1	1	CAPSCREW, 1/2"NC x 3" (Used prior to engine #10-4030)
	908191	1	1	WASHER, plain, copper, 1/2"
	4335371	1	1	STUD, timing gear housing (Effective with engine #10-4030)
	904208	1	1	LOCKWASHER, 1/2"
	910195	1	1	NUT, 1/2"NF
10	4348285	1	-	PLATE, timing gear cover
	916277	3	-	CAPSCREW, 5/16"NC x 5/8"
	917330	3	-	WASHER, plain, copper, 5/16"
11	4376605	1	-	□GASKET, cover plate
12	4335711	-	1	PLATE, timing gear cover (Used prior to tractor #6069 excl.#5490 and #6044)
13	4335712	-	1	□GASKET, cover plate (Used prior to tractor #6069 excl.#5490 and #6044)
14	4335067	1	1	BRACKET, engine mounting (Includes cap)
	916009	10	10	WASHER, shimming (1/32" thick)
	4254891	2	2	CAPSCREW, 1/2"NC x 2-1/2"
	4335550	2	2	LOCKWASHER
15	4364864	2	2	LINER, engine mounting bracket(rubber)(Used prior to engine #10-6001)
	4336491	-	2	LINER, engine mounting bracket(nylon)(Effective with engine #10-6001)
16	4348310	1	1	PLATE,cover, injection pump driving gear (Used prior to engine#10-4855)
	916269	4	4	CAPSCREW,3/8"NC x 7/8"
	904206	4	4	LOCKWASHER, 3/8"
17	4349011	1	1	GASKET, cover plate (Used prior to engine #10-4855)
18	4348126	1	1	□GASKET, timing gear housing cover
19	4347120	1	1	□GASKET, timing hole cover
20	4347119	1	1	COVER, fuel pump timing hole (Used prior to engine #10-5896)
	919225	2	2	CAPSCREW, 3/8"NC x 1-3/8"
	904206	2	2	LOCKWASHER, 3/8"
	4336524	-	1	COVER, fuel pump timing hole (Effective with engine #10-5896)
	919225	-	1	CAPSCREW, 3/8"NC x 1-3/8"
21	919287	-	1	CAPSCREW, 3/8"NC x 1-7/8"
	904206	-	2	LOCKWASHER, 3/8"
	4348136	1	1	□GASKET, timing gear housing
22	4336346	-	1	COVER, timing gear housing (Used prior to tractor #6069 excl.#5490 and #6044)
	916277	-	6	CAPSCREW, 5/16"NC x 5/8"
	917330	-	6	WASHER, plain, copper, 5/16"
23	4336345	-	1	□GASKET, housing cover (Used prior to tractor #6069 excl.#5490 and 6044)
24	079751	1	-	COCK, drain (1/4"NPT)(Used prior to tractor #2562)
	089894	1	1	COCK, drain (3/8"NPT)(Effective with tractor #2562)
25	089879	1	-	CLAMP, drain hose (Used prior to tractor #2562)
	089107	1	1	CLAMP, drain hose (Effective with tractor #2562)
26	089607	1	-	HOSE, water drain (3/8"I. D.)(Used prior to tractor #2562)
	091996	1	-	HOSE, water drain (5/8"I. D. x 22" long)(Used on tractors #2562 thru #4059)
	092652	1	1	HOSE, water drain (5/8"I. D. x 26" long)(Effective with tractor #4060)
27	092758	2	2	CLIP, supporting, water drain hose (Effective with tractor #4060)

□ Also see PACKAGED PARTS

CYLINDER HEAD

USAGE: Tractors serial No. 6427 and up (10000 and 11000 series engines)

ITEM	PART NO.	QTY.	DESCRIPTION
1	4339548	2	HEAD ASSEMBLY, cylinder (Includes items 2 thru 5 and hardware indented below)
	917673	4	PLUG, pipe, hex-socket, 1/8"NPT
	920340	8	PLUG, pipe, hex-socket, 3/4"NPT
	917560	6	PIN, dowel, 3/16" x 3/8" (intake valve locator)
2	4336419	6	INSERT, exhaust valve seat (standard size)
	4336602	6	INSERT, exhaust valve seat (.005" oversize)
	4339547	6	INSERT, exhaust valve seat (standard size)
	4339625	6	INSERT, exhaust valve seat (.005" oversize)
3	4336418	6	INSERT, intake valve seat (standard size)
	4336601	6	INSERT, intake valve seat (.005" oversize)
	4339546	6	INSERT, intake valve seat (standard size)
	4339624	6	INSERT, intake valve seat (.005" oversize)
4	4336586	12	GUIDE, valve stem
5	4336157	6	SLEEVE, injection nozzle
6	4336128	6	VALVE, exhaust
7	4336127	6	VALVE, intake
8	4354294	1	□ GASKET ASSEMBLY, cylinder head, front (shown)
	4354295	1	□ GASKET ASSEMBLY, cylinder head, rear (opposite)
8A	4339848	6	GASKET, fire ring (cylinder sealing)(Effective with engine #10-13216)
9	4339499	2	STUD, cylinder head (1/2" x 7-1/4")
	4339434	2	STUD, cylinder head (1/2" x 8-5/8")(Also attaches rear lifting eye)
10	4339505	24	STUD, cylinder head (5/8" x 6-1/2")
11	4339498	4	STUD, cylinder head (1/2" x 6-1/8")
12	4339497	2	STUD, cylinder head (1/2" x 7-3/8")(Also attaches front lifting eye)
13	4336131	6	SPRING, exhaust valve
14	4343799	6	RETAINER, exhaust valve spring
15	4376497	24	LOCK, valve spring retainer (half-only)
16	4336153	6	RETAINER, intake valve spring
17	4336129	6	SPRING, intake valve, outer
18	4336130	6	SPRING, intake valve, inner
19	4336758	6	LOCATOR, intake valve

5/16" thick. Used prior to engine #10-11912

13/32" thick. Effective with engine #10-11912

5/16" thick. Used prior to engine #10-11912

13/32" thick. Effective with engine #10-11912

Each includes item 8A

□ Also see PACKAGED PARTS

(Continued)

SCAVENGING OIL PUMP

\* Used prior to engine serial No. 10-4028  
 \*\* Effective with engine serial No. 10-4028

ITEM	PART NO.	QTY.		DESCRIPTION
		*	**	
1	4335004	1	1	PUMP ASSEMBLY, scavenging (Consists of items 4 thru 16)
2	4311869	1	1	CAPSCREW, drilled-hd., 1/2"NC x 1-1/4"
3	4509035	1	1	WIRE, locking, #18 x 10"
	904208	1	1	LOCKWASHER, 1/2"
4	4660408	1	1	GEAR, pump driving
	917466	1	1	PIN, roll, 3/16" x 1-1/8"
5	4346327	2	2	BUSHING, pump body
6	4346125	1	1	BODY ASSEMBLY (Includes items 5 and 7)
7	4660409	1	1	SHAFT, stub
8	4347893	1	1	SHAFT, drive
	905122	2	2	KEY, #7 woodruff, 1/8" x 3/4"
9	4660412	1	1	BUSHING, pumping gear
10	4660410	1	1	GEAR ASSEMBLY, pumping (Includes item 9)
11	4251141	2	2	RING, snap, drive shaft
12	4660407	1	1	GEAR, pumping (keywayed)
13	4335000	1	1	COVER, pump body
14	{ 910899	5	-	CAPSCREW, 1/4"NC x 2"
	{ 4335167	-	5	CAPSCREW, drilled-hd., 1/4"NC x 2"
15	{ 913299	1	-	CAPSCREW, 1/4"NC x 2-1/4"
	{ 4335168	-	1	CAPSCREW, drilled-hd., 1/4"NC x 2-1/4"
	{ 904204	6	6	LOCKWASHER, 1/4"
16	{ 4348691	-	3	WIRE, locking, #18 x 6"
17	4347578	1	1	BRACKET, suction pipe bracing, left
18	{ 916308	1	-	CAPSCREW, 1/2"NC x 7/8"
	{ 4375812	-	1	CAPSCREW, drilled-hd., 1/2"NC x 1"
	{ 904208	1	1	LOCKWASHER, 1/2"
19	{ 4348691	-	1	WIRE, locking, #18 x 6"
20	4347577	1	1	BRACKET, suction pipe bracing, right
21	{ 916308	1	-	CAPSCREW, 1/2"NC x 7/8"
	{ 4375812	-	1	CAPSCREW, drilled-hd., 1/2"NC x 1"
	{ 904208	1	1	LOCKWASHER, 1/2"
22	{ 4348691	-	1	WIRE, locking, #18 x 6"
23	{ 916274	1	-	CAPSCREW, suction pipe to brace (3/8"NC x 2-1/4")
	{ 900817	1	-	WASHER, plain, U.S. std., 3/8"
	{ 904206	1	-	LOCKWASHER, 3/8"
	{ 910324	1	-	NUT, 3/8"NC
	{ 4335153	-	1	CAPSCREW, suction pipe to brace (drilled-end)
	{ 912597	-	1	WASHER, plain
	{ 904206	-	1	LOCKWASHER, 3/8"
	{ 914773	-	1	NUT, slotted, 3/8"NC
	{ 900802	-	1	PIN, cotter, 3/32" x 1"

(Continued)

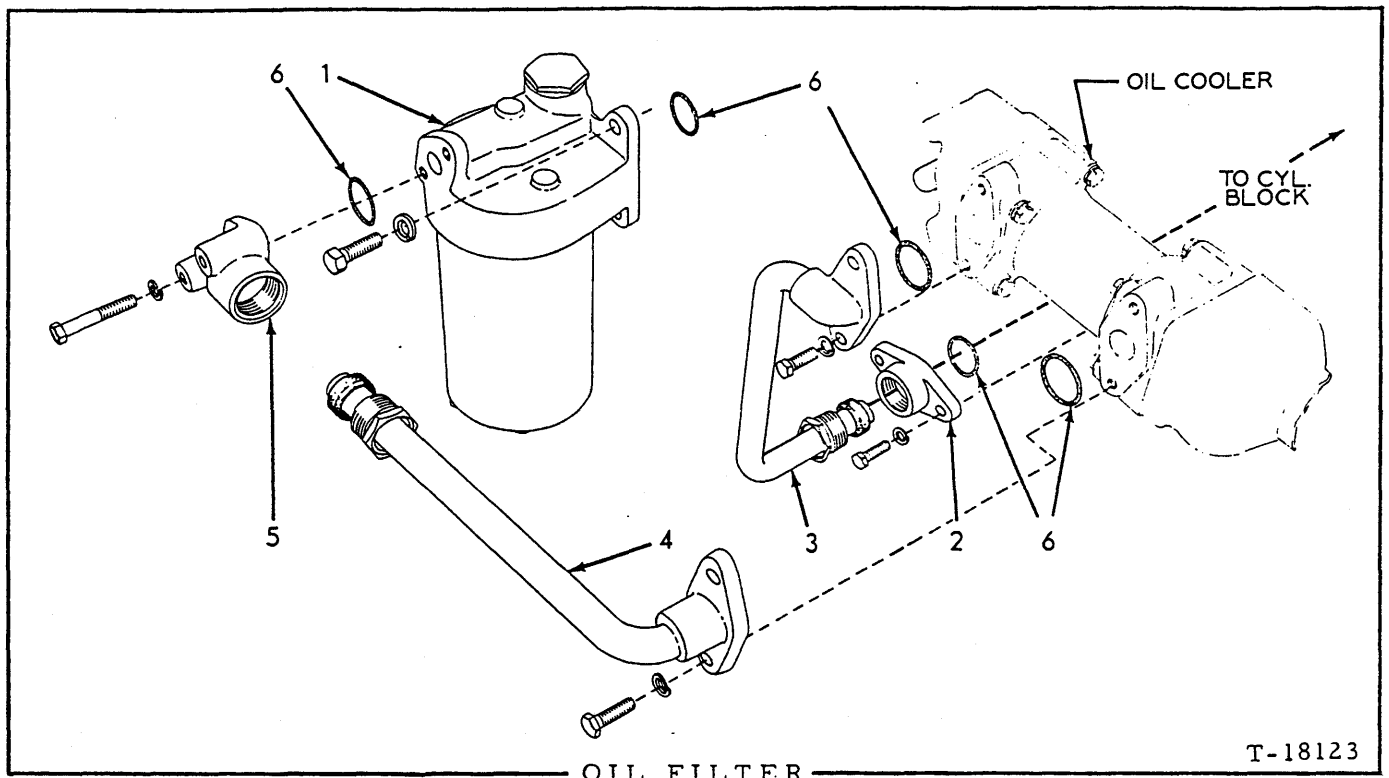

T-18123

USAGE: Models HD11B, E, ES, S, F. Engines serial No. 10-4030 thru 10-4331 only

ITEM	PART NO.	QTY.	DESCRIPTION
1	4335338	1	FILTER ASSEMBLY (See page 59 for parts)
	919230	4	CAPSCREW, 1/2"NC x 1-3/8"
	904208	4	LOCKWASHER, 1/2"
2	4348279	1	FLANGE, crankcase oil line
	919224	2	CAPSCREW, 3/8"NC x 1-1/8"
	904206	2	LOCKWASHER, 3/8"
3	4335331	1	LINE ASSEMBLY, oil cooler to crankcase (Includes NUT and RING indented below)
	917741	1	NUT, male, Sealastic, 7/8" tube
	918327	1	RING, Sealastic, 7/8" tube (Includes ferrule)
	919224	2	CAPSCREW, 3/8"NC x 1-1/8"
	904206	2	LOCKWASHER, 3/8"
4	4335323	1	LINE ASSEMBLY, oil filter to cooler (Includes NUT and RING indented below)
	917741	1	NUT, male, Sealastic, 7/8" tube
	918327	1	RING, Sealastic, 7/8" tube (Includes ferrule)
	919224	2	CAPSCREW, 3/8"NC x 1-1/8"
	904206	2	LOCKWASHER, 3/8"
5	4335334	1	FLANGE, oil line connection
	912069	2	CAPSCREW, 3/8"NC x 2-1/2"
	904206	2	LOCKWASHER, 3/8"
6	4253106	5	□ O-RING, oil lines
			□ Also see PACKAGED PARTS

## HEAVY-DUTY OIL FILTER (Continued)

ITEM	PART NO.	QTY.	DESCRIPTION
6	096116	1	HOSE ASSEMBLY, oil return (See page 6 for parts)
	919127	1	CONNECTOR, flare type, 3/8" tube, 1/2"NPT male
	919172	1	CONNECTOR, flare type, 3/8" tube, 3/8"NPT male
7	096118	1	BRACKET, hose supporting, front
8	035067	1	CAPSCREW 1/2"NF x 2"
	904208	1	LOCKWASHER, 1/2"
	911043	1	NUT, 1/2"NF
9	096120	1	BRACKET, hose supporting, rear
10	035073	1	CAPSCREW, 1/2"NF x 1-3/4"
	904208	1	LOCKWASHER, 1/2"
	911043	1	NUT, 1/2"NF
11	094422	6	CLIP, hose supporting
12	035167	3	CAPSCREW, 3/8"NF x 7/8"
	904206	3	LOCKWASHER, 3/8"
	911041	2	NUT, 3/8"NF

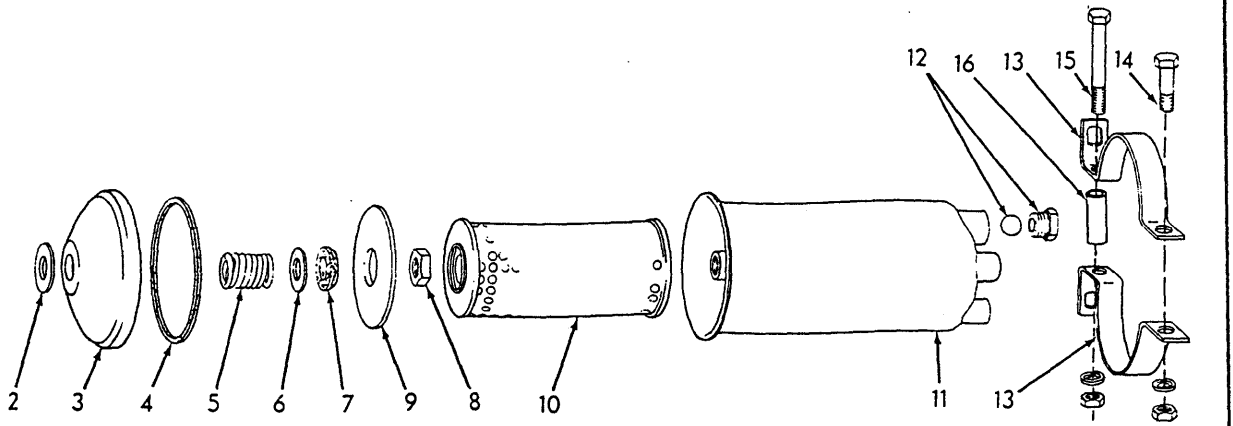

HEAVY-DUTY FILTER PARTS ("Briggs")

T-71312

\* 654674 FILTER ASSEMBLY, oil (See page 73)  
 \*\* 654673 FILTER ASSEMBLY, fuel (See page 87)

PART NO.	QTY.		DESCRIPTION
	*	**	
647680	1	-	VALVE ASSEMBLY, by-pass (Includes ball, spring and retainer) (Serviced only as a unit)
647432	-	1	CAPSCREW, cover retaining
647436	1	1	WASHER, cover retaining capscREW
3 647446	1	1	COVER, tank
4 647448	1	1	GASKET, tank cover
5 647439	1	1	SPRING, element retaining
6 647449	1	1	WASHER, element retaining spring (steel)
7 647450	1	1	WASHER, sealing, cover retaining capscREW (cork)
8 647455	1	1	NUT
9 647453	1	1	PLATE, element retaining
10 647513	1	1	ELEMENT KIT (Includes item 4)
11	654720	1	- TANK
	654719	-	1 TANK
12	654721	1	- BUSHING, oil inlet
	905366	1	- BALL, steel, 11/16" diam. (check valve)
13	647554	4	4 STRAP, mounting
14	013059	2	2 CAPSCREW, 3/8"NC x 2"
15	041915	2	2 CAPSCREW, 3/8"NC x 3-1/2"
	904206	4	4 LOCKWASHER, 3/8"
	911026	4	4 NUT, 3/8"NC
16	654717	2	2 PIPE, spacing, mounting strap

HEAVY-DUTY FUEL FILTER

USAGE: Special equipment. Applicable to tractor serial No. 10001 and up. Supplements standard fuel filter.

ITEM	PART NO.	QTY.	DESCRIPTION
1	098364	1	FILTER ASSEMBLY ("Walker". See page 76 for parts)(Used prior to August 1965)
	654673	1	FILTER ASSEMBLY ("Briggs". See page 77 for parts)(Effective August 1965)
2	035018	4	CAPSCREW, 1/2"NF x 1-1/2"
	064531	4	WASHER, plain
	904208	4	LOCKWASHER, 1/2"
	911043	4	NUT, 1/2"NF
3	099830	2	PLATE, reinforcing
4	633519	1	COCK, drain, 3/8"NPT
5	639414	1	HOSE, tank to filter (See page 6)
	919063	1	CONNECTOR, flare type, 1/2" tube, 3/8"NPT male
6	639413	1	HOSE, filter to fuel line (See page 6)(Used prior to tractor #10452)
	646917	1	HOSE, filter to fuel line (See page 6)(Effective with tractor #10452)
	919063	1	CONNECTOR, flare type, 1/2" tube, 3/8"NPT male
7	644876	2	GROMMET, hose protecting
8	622992	3	CLIP, hose supporting
	036032	2	CAPSCREW, 3/8"NF x 7/8"
	904206	2	LOCKWASHER, 3/8"
	911041	2	NUT, 3/8"NF
9	639415	1	ANGLE, hose supporting
10	614478	3	CAPSCREW, 1/2"NF x 1-3/8"
	904208	3	LOCKWASHER, 1/2"
	911043	3	NUT, 1/2"NF
11	630280	1	ANGLE, hose supporting
12	-----	-	See FUEL LINES for shut-off valve and fittings

FUEL LINES (Pr. to S/N 4415)(Continued)

ITEM	PART NO.	QTY.		DESCRIPTION
		*	**	
6	089083	-	1	TUBE, fuel return, center section
	918325	-	2	NUT, Sealastic, 3/8" tube
	915367	-	2	RING, Sealastic, 3/8" tube (Includes ferrule)
	915386	-	1	UNION, Sealastic, 3/8" tube
7	086951	1	1	TUBE, fuel return, front section (Used prior to engine #10-3871)
	092797	1	1	TUBE, fuel return, front section (Effective with engine #10-3871)
	918325	2	2	NUT, Sealastic, 3/8" tube
	915367	2	2	RING, Sealastic, 3/8" tube (Includes ferrule)
	915368	1	1	CONNECTOR, Sealastic, 3/8" tube, 1/4"NPT male
8	086954	1	1	HOSE, fuel return (Used prior to engine #10-3871)
	912324	1	1	CONNECTOR, flared fitting, 1/4"NPT male
	901677	1	1	ELBOW, pipe, 90°, 1/4"NPT
	901479	1	1	NIPPLE, pipe, 1/4"NPT x 1-1/2"
	901764	1	1	COUPLING, pipe, 1/4"NPT
9	047381	1	1	CLIP, hose supporting (5/8" diam., 13/32" bolt-hole)(Used prior to engine #10-3871)
10	087082	1	1	SPACER, tube supporting clips (Used prior to engine #10-3871)
11	055232	5	2	CLIP, tube supporting (For one 1/2" diam. tube and one 3/8" diam. tube, 13/32" bolt-hole)
	915809	1	1	CAPSCREW, 5/16"NC x 3/4" Effective with engine #10-3871
	904205	1	1	LOCKWASHER, 5/16"
12	036032	4	1	CAPSCREW, 3/8"NF x 3/4"
	904206	4	1	LOCKWASHER, 3/8"
	911115	4	-	WASHER, plain, SAE std., 3/8"
13	076498	1	1	CLIP, hose supporting (1/2" diam., 13/32" bolt-hole)(Used prior to engine #11-3871)
14	037450	1	1	CAPSCREW, 5/16"NC x 1-1/4"
	904205	1	1	LOCKWASHER, 5/16"
15	089099	-	1	PLATE, tube supporting clip
16	055233	-	3	CLIP, tube supporting (For one 1/2" diam. tube and one 3/8" diam. tube, 13/32" bolt-hole)
17	036032	-	3	CAPSCREW, 3/8"NF x 3/4"
	904206	-	3	LOCKWASHER, 3/8"

FUEL LINES

USAGE: Tractors serial No. 4415 thru No. 10000

\* Models HD11B, E, EC, ES, S

\*\* Models HD11F, FC

1	092727	1	1	COCK, fuel shut-off (Includes item 2)
2	082189	1	1	HANDLE, fuel shut-off cock
3	095887	1	-	HOSE ASSEMBLY, fuel supply line, rear (See page 6 for parts)(Not used when HEAVY-DUTY FUEL FILTER is installed)
	919063	1	-	CONNECTOR, flare type, 1/2" tube, 3/8"NPT male
	645235	-	1	HOSE, fuel supply line, rear (See page 6)(Not used when HEAVY-DUTY FUEL FILTER is installed)
4	093682	1	-	TUBE ASSEMBLY, fuel supply line (Includes nuts)
	094664	-	1	TUBE ASSEMBLY, fuel supply line (Includes nuts)
	919066	2	1	UNION, flare type, 1/2" tube
5	096002	1	1	HOSE ASSEMBLY, fuel supply line, front (See page 6 for parts)
	919063	1	1	CONNECTOR, flare type, 1/2" tube, 3/8"NPT male

(Continued)

INJECTION FUEL RETURN LINES

USAGE: Tractors serial No. 6427 and up (10000 and 11000 series engines)

\* Engines prior to serial No. 10-6781  
 \*\* Effective with engine serial No. 10-6781 but later discontinued on tractor serial No. 10001  
 \*\*\* Tractors serial No. 10001 and up

ITEM	PART NO.	QUANTITY			DESCRIPTION
		*	**	***	
1	4336546	1	1	1	MANIFOLD ASSEMBLY, front (Includes NUTS and SLEEVES indented below)
	917809	4	4	4	NUT, Imperial, 1/4" tube
	917806	4	4	4	SLEEVE, Imperial, 1/4" tube
	919800	3	3	3	CONNECTOR, Imperial, 1/4" tube, 1/8"NPT male
2	4336547	1	1	1	MANIFOLD ASSEMBLY, rear (Includes NUTS and SLEEVES indented below)
	917809	4	4	4	NUT, Imperial, 1/4" tube
	917806	4	4	4	SLEEVE, Imperial, 1/4" tube
	919800	3	3	3	CONNECTOR, Imperial, 1/4" tube, 1/8"NPT male
3	4336687	1	1	-	TUBE ASSEMBLY, manifolds to filter (Includes NUTS and SLEEVES indented below)(Used prior to engine #10-7563)
	4338463	-	1	-	TUBE ASSEMBLY, manifolds to filter (Includes NUTS and SLEEVES indented below)(Effective with engine #10-7563)
	4339113	-	-	1	TUBE ASSEMBLY, manifolds to filter (Includes NUTS and SLEEVES indented below)
4	917809	2	2	2	NUT, Imperial, 1/4" tube
	917806	2	2	2	SLEEVE, Imperial, 1/4" tube
	919797	1	1	1	TEE, union, Imperial, 1/4" tube
	919481	1	1	1	ELBOW, Imperial, 1/4" tube, 1/4"NPT male
	4336549	1	-	-	TUBE ASSEMBLY, pump to filter (Includes NUTS and SLEEVES indented below)
	4337223	-	1	-	TUBE ASSEMBLY, pump to filter (Includes NUTS and SLEEVES indented below)
	4339112	-	-	1	TUBE ASSEMBLY, pump to filter (Includes NUTS and SLEEVES indented below)
	917809	2	2	2	NUT, Imperial, 1/4" tube
	917806	2	2	2	SLEEVE, Imperial, 1/4" tube
	920242	1	1	1	CONNECTOR, Imperial, 1/4" tube, 1/8"NPT male
919040	1	-	-	ELBOW, Imperial, 1/4" tube, 1/8"NPT male	
919481	-	1	1	ELBOW, Imperial, 1/4" tube, 1/4"NPT male	
5	4515304	1	-	-	VALVE ASSEMBLY, pressure relief (Consists of items 6 thru 9)
	914588	1	-	-	ELBOW, street, brass, 90°, 1/4"NPT
6	-----	1	-	-	BODY, relief valve (Not serviced separately)
	901651	1	-	-	PLUG, pipe, 1/8"NPT
7	4041015	1	-	-	VALVE, pressure relief
8	4050685	1	-	-	SPRING, pressure relief valve
9	4051304	1	-	-	SCREW, pressure relief valve

(Continued)

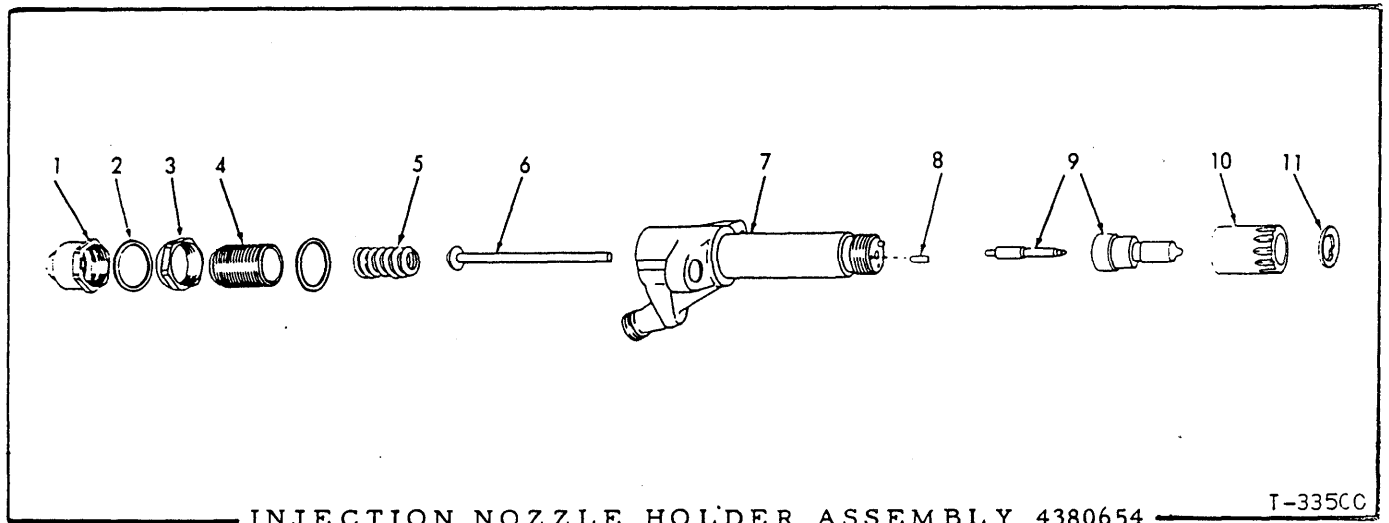

INJECTION NOZZLE HOLDER ASSEMBLY 4380654

T-335CC

USAGE: See page 114

ITEM PART NO. QTY. DESCRIPTION

NOTE: Quantities indicated are for one (1) Holder Assembly only

1	4378032	1	NUT, cap
2	4511243	2	GASKET, cap nut
3	4511213	1	NUT, locking
4	4378033	1	SCREW, adjusting
5	4380652	1	SPRING
6	4380656	1	ROD, spindle
7	-----	1	BODY (Not serviced separately)
8	922943	2	PIN, nozzle locating
9	4380651	1	NOZZLE ASSEMBLY (Includes item 11)
10	4380662	1	NUT, nozzle retaining
11	4378031	1	□ GASKET, nozzle holder

□ Also see PACKAGED PARTS

ENGINE DECELERATOR

USAGE: Special equipment on Model HD11B, E, ES, S, F tractors serial No. 6427 thru No. 10000.  
 Special equipment on Model HD11EC, FC tractors serial No. 6427 thru No. 6510;  
 standard equipment on tractors serial No. 6511 thru No. 10000.

ITEM	PART NO.	QTY.	DESCRIPTION
1	620767	1	LEVER ASSEMBLY, pedal (Includes item 2)
2	063222	2	BUSHING, pedal lever
3	035018	1	CAPSCREW, pedal stop (1/2"NF x 1-1/2")
	913830	1	NUT, jam, 1/2"NF
4	098389	1	SHAFT, pedal lever
	918111	1	PIN, roll, 1/8" x 1"
5	620571	1	BRACKET, pedal lever
6	070469	2	CAPSCREW, 1/2"NF x 1-1/4"
	904208	2	LOCKWASHER, 1/2"
7	092881	1	ROD, pedal lever
	911041	1	NUT, 3/8"NF
	628736	1	YOKE, rod end, adjustable, 3/8"NF
	078810	1	PIN, yoke, 3/8" diam.
	900942	1	PIN, cotter, 3/32" x 5/8"
7A	078810	1	PIN, pedal lever rod yoke (Used prior to tractor #7447)
	900942	1	
	088566	1	PIN, pedal lever rod yoke (Effective with tractor #7447)
	900942	1	
8	620099	1	SHAFT, cross
	905121	1	KEY, #5 woodruff, 1/8" x 5/8"
9	620573	1	BRACKET, cross shaft
	917831	2	CAPSCREW, 1/2"NF x 1-3/8"
	904208	2	LOCKWASHER, 1/2"
10	034258	1	SPRING, cross shaft
11	097646	1	LEVER, cross shaft
12	041981	1	CAPSCREW, 5/16"NF x 1-1/2"
	904205	1	LOCKWASHER, 5/16"
	913636	1	NUT, 5/16"NF
13	095525	1	LEVER, cross shaft
14	072438	1	SPRING, cross shaft lever
15	620119	1	ROD, control adjustment, rear
	919763	1	NUT, 3/8"NF, left hand thread
	078810	1	PIN, yoke, 3/8" diam.
	900942	1	PIN, cotter, 3/32" x 5/8"
16	095421	1	NUT, control adjustment
17	620100	1	ROD, control adjustment, front
	911041	1	NUT, 3/8"NF

(Continued)

## ENGINE SHUT- OFF CONTROL

USAGE: Tractors serial No. 10001 and up

ITEM	PART NO.	QTY.	DESCRIPTION
1	091855	1	KNOB, shut-off rod
2	631555	1	ROD, upper
	919763	1	NUT, 3/8"NF (left-hand thread)
3	095421	1	NUT, control adjustment
4	644573	1	ROD, intermediate
	911048	1	NUT, jam, 3/8"NF
5	097663	1	SPRING, retracting
6	631477	1	PIN, yoke, intermediate rod
	911115	2	WASHER, plain, SAE std., 3/8"
	900942	2	PIN, cotter, 3/32" x 5/8"
7	644560	1	LEVER ASSEMBLY, intermediate rod (Includes item 8)
8	624585	1	BUSHING, intermediate rod lever
9	043021	2	BEARING, needle, intermediate rod lever
10	096921	2	SEAL, bearing
11	634192	1	ROD, lower
12	628738	2	PIN, yoke, lower rod
	900970	2	PIN, cotter, 1/16" x 1/2"
13	644565	1	BRACKET, supporting, control linkage
14	035439	2	CAPSCREW, 3/8"NC x 1"
	904206	2	LOCKWASHER, 3/8"
15	035220	1	CAPSCREW, 1/2"NC x 1-1/8"
	904208	1	LOCKWASHER, 1/2"
	910244	1	WASHER, plain, SAE std., 1/2"
	900806	1	PIN, cotter, 1/8" x 1"
16	634650	2	CAPSCREW, lever stop (3/8"NC x 1-1/2")
	911034	2	NUT, jam, 3/8"NC

TURBOCHARGER

USAGE: Models HD11E, EC, S, tractors serial No. 10001 and up

ITEM	PART NO.	QTY.	DESCRIPTION	
1	4339212	1	TURBOCHARGER ASSEMBLY (Engines prior to #11-12098) (Order TURBOCHARGER ASSEMBLY 4354698)	} See page 149 for parts
	4354698	1		
2	4336558	1	GASKET, turbocharger mounting (See item 20)	
3	4339535	4	STUD, turbocharger mounting	
4	4385387	4	NUT, stainless, 3/8"NC	
	913544	4	WASHER, plain	
5	4388349	1	HOSE, air discharge elbow	
	4255644	2	CLAMP, hose	
6	4339585	1	ELBOW, air discharge (See ENGINE AIR HEATER for optional Elbow)	
	919840	1	PLUG, pipe, hex-hd., 1/4"NPT (Not used when engine primer is installed)	
	919230	4	CAPSCREW, 1/2"NC x 1-3/8"	
	904208	4	LOCKWASHER, 1/2"	
7	4349193	1	GASKET, air discharge elbow (See item 20)	
8	4339370	1	LINE, oil drain	
	916269	2	CAPSCREW, 3/8"NC x 7/8"	
	904206	2	LOCKWASHER, 3/8"	
9	4339532	1	GASKET, oil drain line (See item 20)	
10	4255606	1	CLAMP, supporting, oil drain line	
	915809	1	CAPSCREW, 5/16"NC x 3/4"	
	904205	1	LOCKWASHER, 5/16"	
	910323	1	NUT, 5/16"NC	
11	4354450	1	BRACKET, supporting, oil drain line	
12	4379723	1	ADAPTOR, oil drain line (rubber)	
13	4254968	1	CLAMP, hose, 1-3/16" diam.	
14	4254991	1	CLAMP, hose, 1-7/16" diam.	
15	4339496	1	FLANGE, oil drain line	
	919230	1	CAPSCREW, 1/2"NC x 1-3/8"	
	904208	1	LOCKWASHER, 1/2"	
16	4336436	1	GASKET, oil drain line flange	
17	4339518	1	TUBE ASSEMBLY, oil feed (Includes SLEEVE and NUT indented below)	
	917807	1	SLEEVE, Sealastic, 3/8" tube	
	917810	1	NUT, Sealastic, 3/8" tube	
	920700	1	CONNECTOR, Sealastic, 3/8" tube, 3/8"NPT male	
	916269	2	CAPSCREW, 3/8"NC x 7/8"	
	904206	2	LOCKWASHER, 3/8"	
18	4339533	1	GASKET, oil feed tube (See item 20)	
19	4375953	1	CLAMP, supporting, oil feed tube	
20	4339827	-	GASKET KIT (Consists of items 2, 7, 9 and 18)(Not illustrated)	

AIR CLEANER (Dry-type)

USAGE: Standard equipment on tractors serial No. 7376 thru No. 10000; optional on prior units. See page 150 for oil-bath air cleaner

ITEM	PART NO.	QTY.	DESCRIPTION
1	621979	1	CAP, rain (Includes item 2)
2	632650	1	CLAMP ASSEMBLY, rain cap (Includes bolt and nut)
3	622685	1	TUBE, air inlet
	921916	1	CLAMP, adjustable, 3-7/8" to 4-3/4" diam.
4	621980	1	CLEANER ASSEMBLY, air (Includes items 5 thru 14)
5	622892	1	BODY, upper
6	-----	1	GASKET, filter element, upper (Not serviced separately)
7	-----	1	GASKET, filter element, lower (Not serviced separately)
8	622893	1	ELEMENT ASSEMBLY, filter (Includes items 6 and 7)
9	620719	3	NUT, wing, element retaining
10	622895	2	GASKET, air pre-cleaner, outer
11	622898	1	GASKET, air pre-cleaner, inner
12	622894	1	PRE-CLEANER ASSEMBLY, air (Serviced only as a unit)
13	622896	1	CUP, dust
14	622897	2	CLAMP ASSEMBLY (Includes screw)
15	622887	1	SADDLE, air cleaner mounting
16	070467	3	CAPSCREW, 1/2"NF x 1"
	070469	1	CAPSCREW, 1/2"NF x 1-1/4"
	904208	4	LOCKWASHER, 1/2"
	911043	4	NUT, 1/2"NF
17	622884	2	BAND, air cleaner mounting
18	081796	4	PIN, mounting band (threaded hole)
19	081795	4	PIN, mounting band (plain hole)
20	053667	4	SPACER, mounting band capscREW
21	086238	4	CAPSCREW, mounting band (3/8"NC x 3-3/4")
22	622590	1	HOSE, air
	921916	2	CLAMP, hose, 3-7/8" to 4-3/4" diam.
23	622432	1	ELBOW, air inlet (Also see page 175 for special elbow used with Engine Air-Heater)
	919840	1	PLUG, pipe, hex-hd., 1/4"NPT (Not used when Engine Primer is installed)
	919134	1	PLUG, pipe, hex-hd., 1/8"NPT (Not used when Air Restriction Indicator is installed)
24	035061	4	CAPSCREW, 1/2"NC x 1-1/4"
	904208	4	LOCKWASHER, 1/2"
25	084868	1	GASKET, air inlet elbow

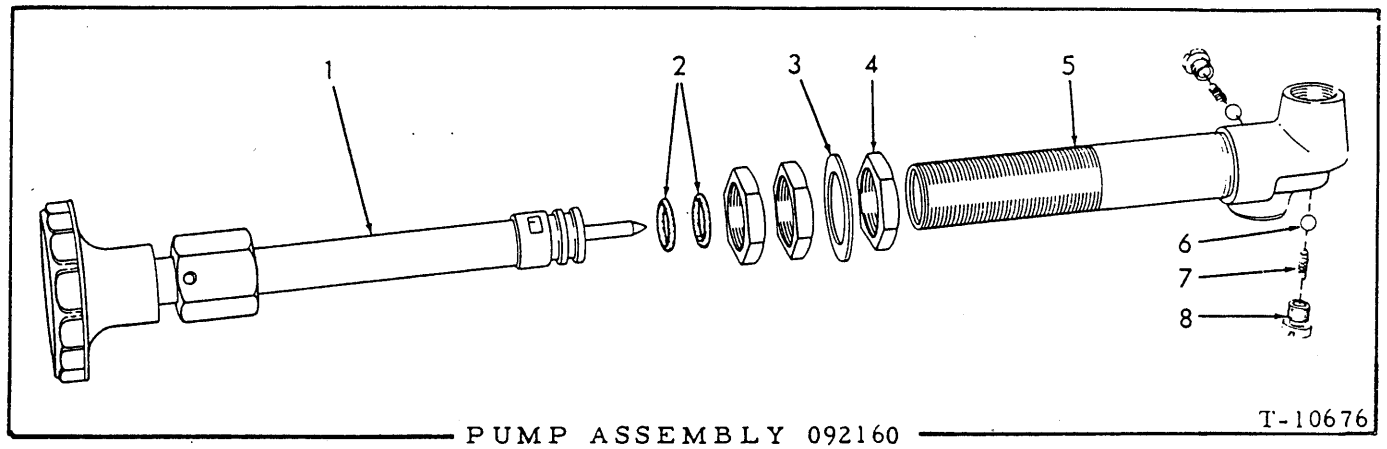

USAGE: See pages 165 , 169 , 171, 175 and 177

ITEM PART NO. QTY. DESCRIPTION

1	-----	1	PISTON ASSEMBLY (Not serviced separately)
2	923560	2	O-RING, plunger
3	066873	1	WASHER, mounting
4	066872	3	NUT, mounting
5	-----	1	BARREL ASSEMBLY (Not serviced separately)
6	066876	2	BALL, check valve (5/32" diam.)
7	066875	2	SPRING, check valve
8	066874	2	RETAINER, check valve

AIR HEATER (Fourth type)

USAGE: Tractors serial No. 10001 and up. Optional equipment in place of Engine Primer.

\* Model HD11B  
\*\* Models HD11E, EC, S

ITEM	PART NO.	QTY.		DESCRIPTION
		*	**	
1	622433	1	-	ELBOW, air intake (Replaces standard ELBOW 622432)
	644476	-	1	ELBOW, air intake (Replaces standard ELBOW 4339585)
2	919134	1	-	PLUG, pipe, hex-hd., 1/8"NPT
	919840	1	1	PLUG, pipe, hex-hd., 1/4"NPT
	035061	4	-	CAPSCREW, 1/2"NC x 1-1/4"
	919230	-	4	CAPSCREW, 1/2"NC x 1-3/8"
	904208	4	4	LOCKWASHER, 1/2"
3	084868	1	1	GASKET, air intake elbow
4	644133	1	1	BRACKET, resistor mounting
	912226	1	-	SCREW, machine, fil-hd., 1/4"NC x 5/8"
	904204	1	-	LOCKWASHER, 1/4"
5	631198	1	1	WASHER, insulating
6	630830	1	1	RESISTOR
	915922	1	1	SCREW, machine, #8-32 x 2-1/4"
	915923	1	1	LOCKWASHER, external teeth, #8
	907154	1	1	NUT, #8-32
7	631199	1	1	BRACKET, ignition coil mounting
	912226	2	2	SCREW, machine, fil-hd., 1/4"NC x 5/8"
	904204	2	2	LOCKWASHER, 1/4"
8	097026	1	1	COIL, ignition (Serviced only as a unit)
9	088038	1	1	BUSHING, spray nozzle
10	630787	1	1	WASHER, spray nozzle
11	631225	1	1	STRAINER ASSEMBLY, spray nozzle (1 body and 1 screen)
12	631224	1	1	NOZZLE ASSEMBLY, spray (Includes item 11)
13	631566	1	1	GASKET, insulator
14	631226	1	1	INSULATOR PACKAGE (Includes terminal nut and item 13)
15	630828	1	1	NUT, insulator retaining
16	630827	1	1	SCREW ASSEMBLY, electrode (1 screw and 1 electrode)
	904204	1	1	LOCKWASHER, 1/4"
17	074887	1	-	CABLE, coil to insulator
	095860	-	1	CABLE, coil to insulator
18	644883	3	-	CLIP, cable supporting (1/8" diam., 17/32" bolt-hole)
19	084520	1	-	CABLE, switch to coil
	644225	-	1	CABLE, switch to coil

(Continued)

FAN

USAGE: Engines serial No. 10-4855 thru 10-5895

ITEM PART NO. QTY. DESCRIPTION

NOTE: See FAN DRIVE for fan belt

1	{ 096070	1	FAN (Suction type)(Standard equipment)
	{ 085288	1	FAN (Push type)(Special equipment)
2	{ 053616	6	CAPSCREW, 3/8"NC x 1-3/4" (For suction fan)
	{ 035439	6	CAPSCREW, 3/8"NC x 1" (For push fan)
	{ 904206	6	LOCKWASHER, 3/8"
3	088526	1	SPACER, fan (For use with suction fan only)
4	4349668	1	HUB ASSEMBLY (Consists of items 5 thru 20)
5	4371703	1	WASHER, plain, spindle clamping, rear
6	4056232	1	WASHER, plain, spindle clamping, front
7	4349670	1	SPINDLE
	911174	1	NUT, jam, slotted, 1"NF (rear)
	915946	1	PIN, roll, 5/32" x 1-1/4"
8	4371707	1	LOCKWIRE, fan hub
9	4040386	1	RETAINER, spindle sealing washer
10	4040385	1	WASHER, spindle sealing (cork)
11	4040384	1	WASHER, retaining, rear bearing
12	4640976	1	GASKET, bearing retaining washer
13	4253863	1	BEARING, ball, rear
14	4040383	1	SPACER, spindle bearings
15	4640978	1	WASHER, spacing, front bearing
16	4253862	1	BEARING, ball, front
17	4348502	1	NUT, spindle
	911064	1	PIN, cotter, 1/8" x 1-3/8"
18	4349669	1	HUB, fan
	915274	2	FITTING, lubricating, 45°, 1/8"NPT
19	088561	1	CAP, hub
20	4042081	1	RING, snap, cap retaining
21	4349671	1	SCREW, fan adjustment
22	-----	1	BRACKET, fan mounting (Order BRACKET 4336522)
	915969	4	CAPSCREW, 1/2"NC x 3"
	904208	3	LOCKWASHER, 1/2"
	913432	1	WASHER, plain
23	098166	1	GUARD, fan (Special equipment)
24	036034	4	CAPSCREW, 3/8"NF x 1"
	044973	4	WASHER, plain
	904206	4	LOCKWASHER, 3/8"

RADIATOR

\* Models HD11B, E, ES, S, F  
 \*\* Models HD11EC, FC

ITEM	PART NO.	QTY.		DESCRIPTION	
		*	**		
1	093339	1	-	RADIATOR ASSEMBLY (Standard. Not used on Model HD11E tractors #10001 thru #10893)	
	624637	1	1	RADIATOR ASSEMBLY (Standard. For Model HD11EC, FC tractors prior to #10001; also Model HD11E tractors #10001 thru #10893)	
	645482	-	1	RADIATOR ASSEMBLY (Standard. For Model HD11EC tractors #10001 and up)	
	095224	1	-	RADIATOR ASSEMBLY (Special. Has armored tubes at rear of core) (Used prior to tractor #8138. Order RADIATOR ASSEMBLY 632164)	
	632164	1	1	RADIATOR ASSEMBLY (Special. Has armored tubes at rear of core) (Effective with tractor #8138 on Models HD11B, E, ES, S, F; also used on Model HD11EC, FC tractors prior to #10001)	
	645782	-	1	RADIATOR ASSEMBLY (Special. Has armored tubes at rear of core)(For Model HD11EC tractors #10001 and up)	
	644815	1	1	RADIATOR ASSEMBLY (Special. Has in-line core tubes to minimize clogging)(Model HD11EC, FC tractors prior to #10001; also Model HD11B, E, S tractors #10001 and up)	
	645733	-	1	RADIATOR ASSEMBLY (Special. Has in-line core tubes to minimize clogging)(Model HD11EC tractors #10001 and up)	
2	023574	8	-	CAPSCREW, 5/8"NF x 7-1/4" (Tractors prior to #11379)	} For RADIATORS 093339 and 095224 only
	649298	8	-	CAPSCREW, 5/8"NC x 7-1/4" (Tractors #11379 and up)	
	065468	8	8	CAPSCREW, 5/8"NF x 8-1/4" (Not for HD11B, E tractors after #11378)	} For all RADIATORS except 093339 and 095224
	649852	8	8	CAPSCREW, 5/8"NC x 8-1/4" (HD11B, E tractors #11379 and up only)	
	904209	8	8	LOCKWASHER, 5/8"	
<u>NOTE:</u> See page 199 for radiator parts					
3	085039	1	1	SCREEN, radiator (Not for Model HD11EC tractors after #10000)	} Special equipment. Not used with pusher fan or armored core radiator
	645913	-	1	SCREEN, radiator (Model HD11EC tractors #10001 and up only)	
4	046321	6	6	CAPSCREW, 5/16"NC x 1-1/2"	} 2 additional used on Model HD11EC tractors #10001 and up
5	092665	6	6	WASHER, plain	
	904205	6	6	LOCKWASHER, 5/16"	
	911025	6	6	NUT, 5/16"NC	
6	084888	1	1	GASKET, radiator inlet elbow	
7	084042	1	1	ELBOW, radiator inlet	
	916197	4	4	CAPSCREW, 7/16"NC x 1-1/4"	
	904207	4	4	LOCKWASHER, 7/16"	

(Continued)



ENGINE CLUTCH AND HOUSING  
(Dry Clutch)

USAGE: Model HD11B, E, ES, S, F tractors prior to serial No. 10001. Standard on units prior to serial No. 6911; optional thereafter.

ITEM	PART NO.	QTY.	DESCRIPTION
1	083870	1	CLUTCH ASSEMBLY (See page 217 for parts)
2	921556	9	CAPSCREW, 1/2"NC x 2"
	904208	9	LOCKWASHER, 1/2"
3	082716	1	HOUSING
4	056721	11	CAPSCREW, 3/8"NC x 2-1/2"
5	013058	1	CAPSCREW, 3/8"NC x 1-1/4"
	904206	12	LOCKWASHER, 3/8"
6	050579	1	DISC, brake
7	083270	6	CAPSCREW, 5/16"NF x 5/8"
	904205	6	LOCKWASHER, 5/16"
8	083091	1	SHAFT, clutch
9	083121	1	RETAINER, clutch shaft rear bearing
10	013058	6	CAPSCREW, 3/8"NC x 1-1/4"
	904206	6	LOCKWASHER, 3/8"
11	042847	1	BEARING, ball, clutch shaft, rear
12	030123	1	WASHER, locking, rear bearing nut
13	030107	1	NUT, clutch shaft rear bearing
14	050647	1	GASKET, rear bearing cap
15	051597	1	CAP, rear bearing (Used prior to tractor #6069 excluding #6044 and #5490)
	099546	1	CAP, rear bearing (Effective with tractor #6069 including #6044 and #5490)
	914465	1	FITTING, lubricating, straight, 1/8"NPT
	901763	1	COUPLING, pipe, 1/8"NPT
	901475	1	NIPPLE, pipe, 1/8"NPT x 5"
16	035733	4	CAPSCREW, 1/2"NC x 1-3/8"
	904208	4	LOCKWASHER, 1/2"
17	081140	1	PLATE, engine clutch inspection
18	035439	2	CAPSCREW, 3/8"NC x 1"
	904206	2	LOCKWASHER, 3/8"
19	013058	2	CAPSCREW, 3/8"NC x 1-1/4"
	904206	2	LOCKWASHER, 3/8"
	044973	2	WASHER, plain
20	053899	2	HOSE, lubricating, clutch shifting bearing (10-1/2" long)
	911100	1	WASHER, plain, SAE std., 5/8" (Used prior to tractor #6069 excluding #6044 and #5490)
	064810	1	WASHER, plain (Effective with tractor #6069 including #6044 and #5490)
	911049	2	NUT, jam, 5/8"NF
	914465	1	FITTING, lubricating, straight, 1/8"NPT (Used prior to tractor #6069 excluding #6044 and #5490)
	915276	1	FITTING, lubricating, 90°, 1/8"NPT (Effective with tractor #6069 including #6044 and #5490)
	907059	1	ELBOW, street, 90°, 1/8"NPT
21	099133	1	BEARING, ball, clutch shaft, front

TORQUE CONVERTER AND CLUTCH (Continued)

ITEM	PART NUMBER	QTY.	DESCRIPTION
25	629721	1	BLOCK, torque converter breather
	-----	1	CAPSCREW (See AIR CLEANER)
26	050748	1	BREATHER, torque converter
27	621198	1	BRACKET, tube supporting, lower
28	920539	2	CAPSCREW, 3/8"NC x 1" (Nyllok)
	904206	2	LOCKWASHER, 3/8"
29	621196	2	BLOCK, tube clamping, lower
30	099575	1	CAPSCREW, 3/8"NF x 2-1/4"
	911115	1	WASHER, plain, SAE std., 3/8"
	904206	1	LOCKWASHER, 3/8"
	911041	1	NUT, 3/8"NF
31	620614	1	BRACKET, steering control
32	056721	2	CAPSCREW, 3/8"NC x 2-1/2"
33	044249	2	CAPSCREW, 3/8"NC x 1-1/8"
	904206	4	LOCKWASHER, 3/8"
34	630175	1	BAFFLE, oil
35	628571	1	GASKET, oil baffle

ENGINE CLUTCH CONTROL  
(Dry Clutch)

USAGE: Model KD11B, E, ES, S, F tractors prior to serial No. 10001. Standard on units prior to serial No. 6911; optional thereafter.

ITEM	PART NO.	QTY.	DESCRIPTION
1	620862	1	LEVER ASSEMBLY, clutch operating (Includes 2 BUSHING 049988)
2	049988	1	BUSHING, clutch operating lever
3	078620	1	GRIP, operating lever
4	056945	1	SHAFT, pivot, operating lever
5	050221	1	BLOCK, shaft locking
6	047478	1	CAPSCREW, 1/4"NC x 5/8"
	904204	1	LOCKWASHER, 1/4"
7	051513	2	BEARING, needle, operating lever shaft
8	053926	2	SEAL, dust, needle bearing
9	084476	1	ROD, operating lever
	911043	1	NUT, 1/2"NF
10	049993	2	PIN, yoke
	900805	2	PIN, cotter, 1/8" x 3/4"
11	068389	1	YOKE, operating rod
12	068511	1	LEVER, shifting yoke shaft
13	080704	1	BOLT, eye
	904206	1	LOCKWASHER, 3/8"
	911041	2	NUT, 3/8"NF
14	056872	1	SHAFT, clutch shifting yoke, left
15	036997	2	KEY, #13 woodruff, 3/16" x 1", hardened
16	056871	1	SHAFT, clutch shifting yoke, right
17	036997	1	KEY, #13 woodruff, 3/16" x 1", hardened
18	051513	3	BEARING, needle, shifting yoke shaft
19	053926	4	SEAL, dust, needle bearing
20	056873	1	YOKE, clutch shifting
21	035068	2	CAPSCREW, 1/2"NF x 2-1/4"
	904208	2	LOCKWASHER, 1/2"
	911043	2	NUT, 1/2"NF
22	056865	2	BLOCK, sliding, shifting yoke (Used on all tractors except Nos. 4071 thru 4568)
	-----	2	BLOCK, sliding, shifting yoke (Used on tractors No. 4071 thru 4568. Order BLOCK 056865 and items 23 and 24)
23	050442	2	BEARING, needle, shifting yoke
24	053927	4	SEAL, dust, needle bearing
25	-----	2	RACE, inner, needle bearing (See CLUTCH ASSEMBLY 083870)

ENGINE CLUTCH OILING SYSTEM (Continued)

ITEM	PART NO.	QTY.	DESCRIPTION
30	621183	1	PLUG, oil filler
31	035249	1	GASKET, oil filler plug
32	629183	1	GAUGE, oil level
	919063	1	CONNECTOR, flare type, 1/2" tube, 3/8"NPT male
<p><u>NOTE:</u> Items 33 thru 37 comprise the second type oil filler arrangement effective with tractor #10001</p>			
33	644035	1	TUBE, oil filler
34	643791	1	ADAPTOR, oil filler tube
35	631285	1	HOSE, oil filler tube
	921912	2	CLAMP, hose, 1-1/16" to 2" diam.
36	650293	1	GAUGE, oil level
37	053096	1	CLIP, tube supporting
	921865	1	CAPSCREW, Nylok, 1/2"NC x 1"
	904208	1	LOCKWASHER, 1/2"
38	4511629	1	FILTER ASSEMBLY, oil (Serviced only as a unit)
	919063	1	CONNECTOR, flare type, 1/2" tube, 3/8"NPT male
39	630046	1	ELBOW, oil return, upper
40	044249	2	CAPSCREW, 3/8"NC x 1-1/8"
	904206	2	LOCKWASHER, 3/8"
41	630035	1	ELBOW, oil return, lower
42	040382	1	CAPSCREW, 3/8"NC x 1-3/8" (Also attaches hose supporting clip)
43	013058	1	CAPSCREW, 3/8"NC x 1-1/4"
	904206	2	LOCKWASHER, 3/8"
44	630030	2	GASKET, oil return elbow
45	623234	1	HOSE, oil return
	921913	2	CLAMP, hose, 1-13/16" to 2-3/4" diam.
46	628821	1	SUPPORT, hose
47	098108	1	PLATE, hose supporting clip
48	630494	1	ANGLE, hose supporting (Used prior to tractor #10001)
49	621451	4	CLIP, hose supporting (13/32" bolt-hole)
50	036032	4	CAPSCREW, 3/8"NF x 3/4"
	904206	4	LOCKWASHER, 3/8"
	911041	4	NUT, 3/8"NF
			} 2 less used effective with tractor #10001
51	643957	2	CLIP, hose supporting (17/32" bolt-hole)
52	070467	2	CAPSCREW, 1/2"NF x 1"
	904208	2	LOCKWASHER, 1/2"
			} Effective with tractor #10001
53	-----	-	RETAINER (See ENGINE CLUTCH AND HOUSING)

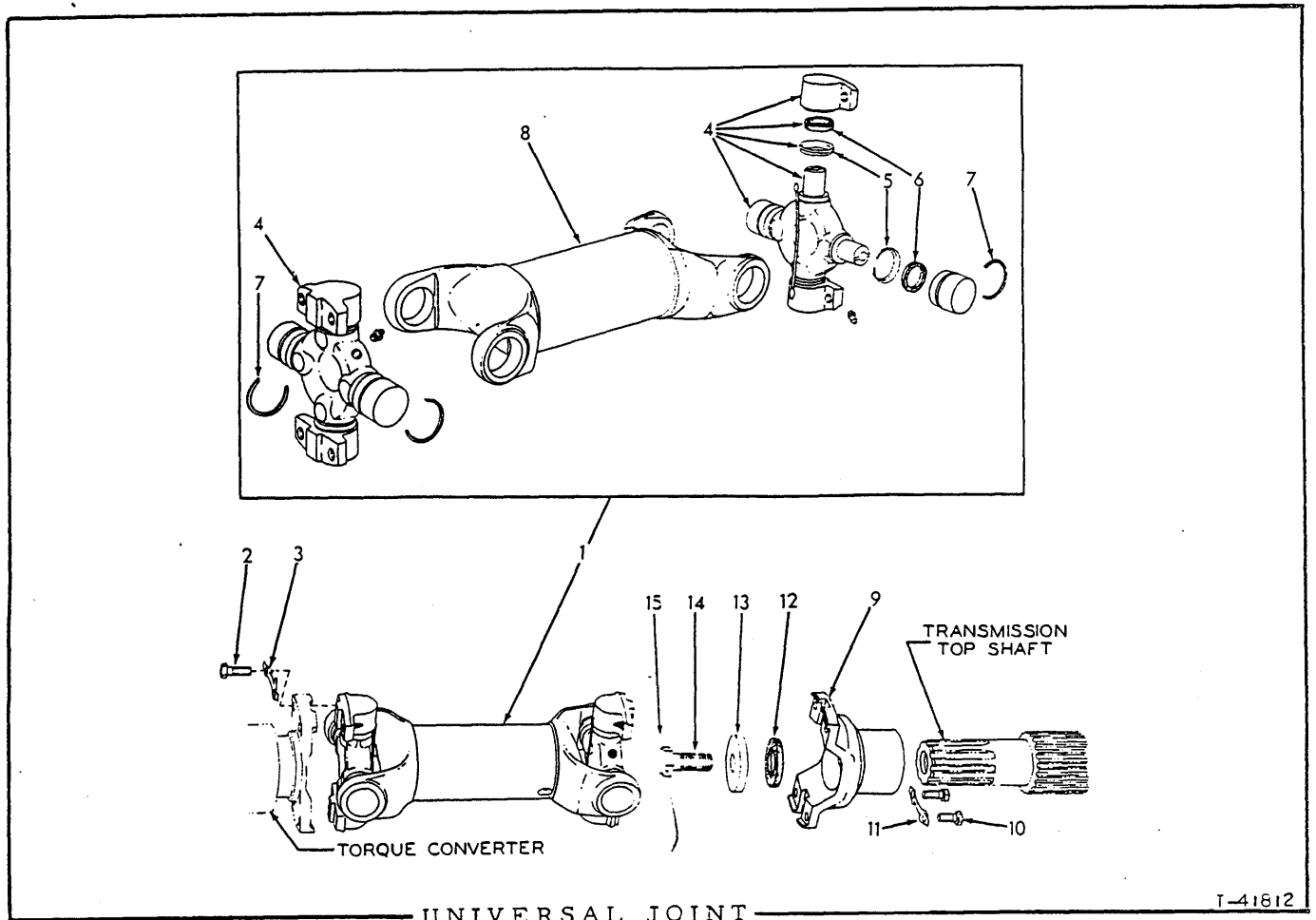

USAGE: Models HD11EC, FC

ITEM	PART NO.	QTY.	DESCRIPTION
1	620945	1	JOINT ASSEMBLY, universal (Consists of items 4 thru 8)
2	036034	4	CAPSCREW, 3/8"NF x 1"
3	059876	2	LOCK, capscrew
4	084435	2	SPIDER ASSEMBLY, universal joint (Includes bearings, items 5 and 6) FITTING indented below. Serviced only as a unit)
	914687	2	FITTING, lubricating, straight, 1/4"NF
5	059873	8	SHIELD, dust
6	076461	8	WASHER, sealing, spider bearing (cork)
7	059879	4	RING, snap, bearing retaining
8	620942	1	TUBE, connecting
9	624528	1	YOKE, rear
10	035167	4	CAPSCREW, 3/8"NF x 7/8"
11	059876	2	LOCK, capscrew
12	059813	1	SEAL, yoke (rubber)
13	078314	1	WASHER, yoke retaining
14	075950	1	CAPSCREW, yoke retaining
15	023633	1	WIRE, locking (1/16" x 12")

TRANSMISSION (Continued)

ITEM	PART NO.	QTY.	DESCRIPTION
4	075390	1	COVER, side (HD11EC only)
	630061	1	COVER, side (HD11FC only)
5	035439	11	CAPSCREW, 3/8"NC x 1"
	904206	11	LOCKWASHER, 3/8"
6	075391	1	GASKET, side cover
7	034265	1	CAP, oil level gauge rod
8	034304	1	ROD, gauge, transmission oil level (HD11EC only)
	630063	1	ROD, gauge, transmission oil level (HD11FC only)
9	089814	1	PLUG, transmission oil filling hole
10	034269	1	GASKET, oil level gauge rod cap
11	-----	-	See TRANSMISSION TOP SHAFT
12	-----	-	See TRANSMISSION REVERSE SHAFT
13	-----	-	See TRANSMISSION PINION SHAFT
14	-----	-	See GEAR SHIFT

TRANSMISSION PINION SHAFT

USAGE: Models HD11B, E, ES, S, F

\* Tractors prior to serial No. 6473

\*\* Tractors serial No. 6473 and up

ITEM	PART NO.	QTY.		DESCRIPTION		
		*	**			
1	{ 095725	1	-	PINION, bevel (11 teeth)(If for tractors prior to #4529, equipped with Odometer, also order 1 PLATE 095673, 1 NUT 095675, 2 SPACER 095676 and 2 CAPSCREW 011089)		
		-	1		PINION, bevel (11 teeth)	
2	098996	-	1	PLUG, pinion oil hole	} Used prior to tractor #8807	
3	098997	-	1	LOCK, pinion oil hole plug		
4	067627	1	1	RING, snap, rear bevel pinion bearing		
5	057283	1	1	BEARING, roller, bevel pinion, rear		
6	{ 069469	1	1	SPACER, rear bevel pinion bearing (Used prior to tractor #10001 and up; also used on prior units with transmission dry sump conversion. See page 301)		
		-	1		SPACER, rear bevel pinion bearing (Standard on tractors #10001 and up; also used on prior units with transmission dry sump conversion. See page 301)	
7	069454	3	3	WASHER, gear spacing		
8	069385	12	-	BEARING, roller, pinion shaft gears		
9	069462	4	-	SPACER, gear bearing (7/16" long)		
10	623668	-	4	BUSHING, pinion shaft gears (2" long)		
11	623669	-	2	BUSHING, pinion shaft gears (1-9/16" long)		
12	069245	1	1	GEAR, 3rd and 5th speed (55 teeth)		
13	{ 069242	1	-	HUB, 2nd reverse and 3rd and 5th speed gears		
		-	1		HUB, 2nd reverse and 3rd and 5th speed gears	
14	{ 069244	3	-	COLLAR, shifting (7/16" groove)(Used prior to tractor #11592)		
		-	3		COLLAR, shifting (7/16" groove)(Used prior to tractor #11592)	
		-	3		COLLAR, shifting (5/8" groove)(Effective with tractor #11592)	
15	643487	1	1	GEAR, 2nd reverse (55 teeth)		
16	069246	2	2	GEAR, 3rd reverse and 4th and 6th speed (48 teeth)		
17	{ 069247	1	-	HUB, 3rd reverse and 4th and 6th speed gears		
		-	1		HUB, 3rd reverse and 4th and 6th speed gears	
18	069248	2	2	GEAR, 1st reverse and 1st and 2nd speed (62 teeth)		
19	{ 069249	1	-	HUB, 1st reverse and 1st and 2nd speed gears		
		-	1		HUB, 1st reverse and 1st and 2nd speed gears	

(Continued)

FORWARD HIGH-LOW GEAR SHIFT (Continued)

ITEM	PART NO.	QTY.	DESCRIPTION
23	634852	1	SHAFT, shifting lever
	905123	1	KEY, #9 woodruff, 3/16" x 3/4"
	910255	1	WASHER, plain, SAE std., 3/4"
	910847	1	NUT, jam, 3/4"NF
24	052662	1	SEAL, oil, shifting lever shaft
25	606009	1	BUSHING, shifting lever housing
26	634980	1	HOUSING ASSEMBLY, shifting lever (Includes items 24 and 25)
27	013058	6	CAPSCREW, 3/8"NC x 1-1/4"
	904206	6	LOCKWASHER, 3/8"
28	057407	1	GASKET, shifting lever housing
29	633207	1	LEVER, shifting
30	080943	1	FORK, shifting (Used prior to tractor #11382. Can be replaced by FORK 646256, COLLAR 647908 and COLLAR 647321)
	646256	1	FORK, shifting (Effective with tractor #11382)
31	035018	2	CAPSCREW, 1/2"NF x 1-1/2"
31A	647908	1	COLLAR, wear, shifting fork (Effective with tractor #11382)
32	643045	1	SHAFT, shifting fork
33	069468	1	GASKET, interlock housing
34	643046	1	HOUSING, gear shift interlock
35	053616	2	CAPSCREW, 3/8"NC x 1-3/4"
	904206	2	LOCKWASHER, 3/8"
36	643040	1	PIN, interlock
37	641356	1	PLUNGER, shaft locating
38	096922	1	SPRING, shifting shaft interlock
39	049918	1	WASHER, interlock spring capscREW (copper)
40	035159	1	CAPSCREW, interlock spring (5/8"NF x 1")
41	050267	1	WASHER, plunger sleeve (copper)
42	620975	1	SLEEVE, shifting lock plunger (13/32" hole)
43	080166	1	BOOT, locking plunger
	916897	2	CLAMP, hose, 1" diam.
44	643044	1	PLUNGER, shifting lock
45	630594	1	ROD, shifting lock plunger
	916202	1	PIN, roll, 1/8" x 7/8"
	911041	1	NUT, 3/8"NF
46	035910	2	SPRING, plunger rod
47	082875	1	PIN, plunger rod yoke
	900942	1	PIN, cotter, 3/32" x 5/8"
48	078967	1	YOKE, plunger rod
49	044973	1	WASHER, plunger rod
50	628736	1	YOKE, plunger rod (3/8"NF)
51	078810	1	PIN, yoke, 3/32" x 5/8"
	900942	1	PIN, cotter, 3/32" x 5/8"
52	-----	1	LEVER ASSEMBLY (See ENGINE CLUTCH CONTROL)

GEAR SHIFT (Continued)

ITEM	PART NO.	QTY.	DESCRIPTION
24	620982	1	BAR, plunger retaining
25	013058	2	CAPSCREW, 3/8"NC x 1-1/4"
	904206	2	LOCKWASHER, 3/8"
26	623904	1	PLATE, shaft locking, front
27	623905	1	PLATE, shaft guiding
28	638953	8	DETENT, shifting shaft interlock
29	620964	2	BLOCK, spacing, interlock detent
30	620240	1	SHAFT, shifting fork, upper
	911233	1	KEY, #11 woodruff, 3/16" x 7/8"
31	620238	1	SHAFT, shifting fork, center
32	620242	1	SHAFT, shifting fork, lower
	911233	1	KEY, #11 woodruff, 3/16" x 7/8"
33	035018	6	CAPSCREW, shifting fork (1/2"NF x 1-1/2")
34	{ 080867	1	FORK, gear shifting, rear (Original equipment)
	{ 650743	1	FORK, gear shifting, rear (Service replacement transmissions)
35	{ 080882	1	FORK, gear shifting, center (Original equipment)
	{ 650742	1	FORK, gear shifting, center (Service replacement transmissions)
36	{ 080939	1	FORK, gear shifting, front (Original equipment)
	{ 650741	1	FORK, gear shifting, front (Service replacement transmissions)
36A	650744	2	COLLAR, wear, rear and center shifting forks
36B	647908	1	COLLAR, wear, front shifting fork
			} Service replacement transmissions only
37	050267	1	WASHER, plunger sleeve (copper)
38	078402	1	WASHER, shifting lock plunger
39	{ 620975	1	SLEEVE, shifting lock plunger (Used prior to tractor #7808)
	{ 635081	1	SLEEVE, shifting lock plunger (Effective with tractor #7808)
	{ 651580	1	SLEEVE, shifting lock plunger (Not original equipment. Furnished in service replacement transmissions only)
40	{ 080166	1	BOOT, locking plunger (Used prior to tractor #7808)
	{ 635082	1	BOOT, locking plunger (Effective with tractor #7808)
	916897	2	CLAMP, hose, 1" diam.
41	{ -----	1	PLUNGER, shifting lock (Used prior to tractor #7808. Order PLUNGER 638094, SLEEVE 651580 and SEAL 651725)
	{ 638094	1	PLUNGER, shifting lock (Effective with tractor #7808)
	916146	1	PIN, roll, 3/32" x 1/2"
42	{ 923560	1	O-RING, shifting lock plunger (Effective with tractor #7808)
	{ 651725	1	SEAL, shifting lock plunger (Not original equipment. Furnished in service replacement transmissions only)
43	620939	1	ROD, shifting lock
	911115	2	WASHER, plain, SAE std., 3/8"
	900942	1	PIN, cotter, 3/32" x 5/8"
	911041	2	NUT, 3/8"NF
44	035910	2	SPRING, plunger rod
45	050265	1	SWIVEL, shifting lock plunger rod
	910244	1	WASHER, plain, SAE std., 1/2"
	900805	1	PIN, cotter, 1/8" x 3/4"
46	620937	1	LEVER, shifting lock
47	036997	1	KEY, #13 woodruff, 3/16" x 1", hardened
48	046419	1	CAPSCREW, 3/8"NF x 2"
	904206	1	LOCKWASHER, 3/8"
	911041	1	NUT, 3/8"NF

CLICK HERE TO **DOWNLOAD** THE COMPLETE MANUAL

- Thank you very much for reading the preview of the manual.
- You can download the complete manual from: [www.heydownloads.com](http://www.heydownloads.com) by clicking the link below



- Please note: If there is no response to CLICKING the link, please download this PDF first and then click on it.

CLICK HERE TO **DOWNLOAD** THE COMPLETE MANUAL

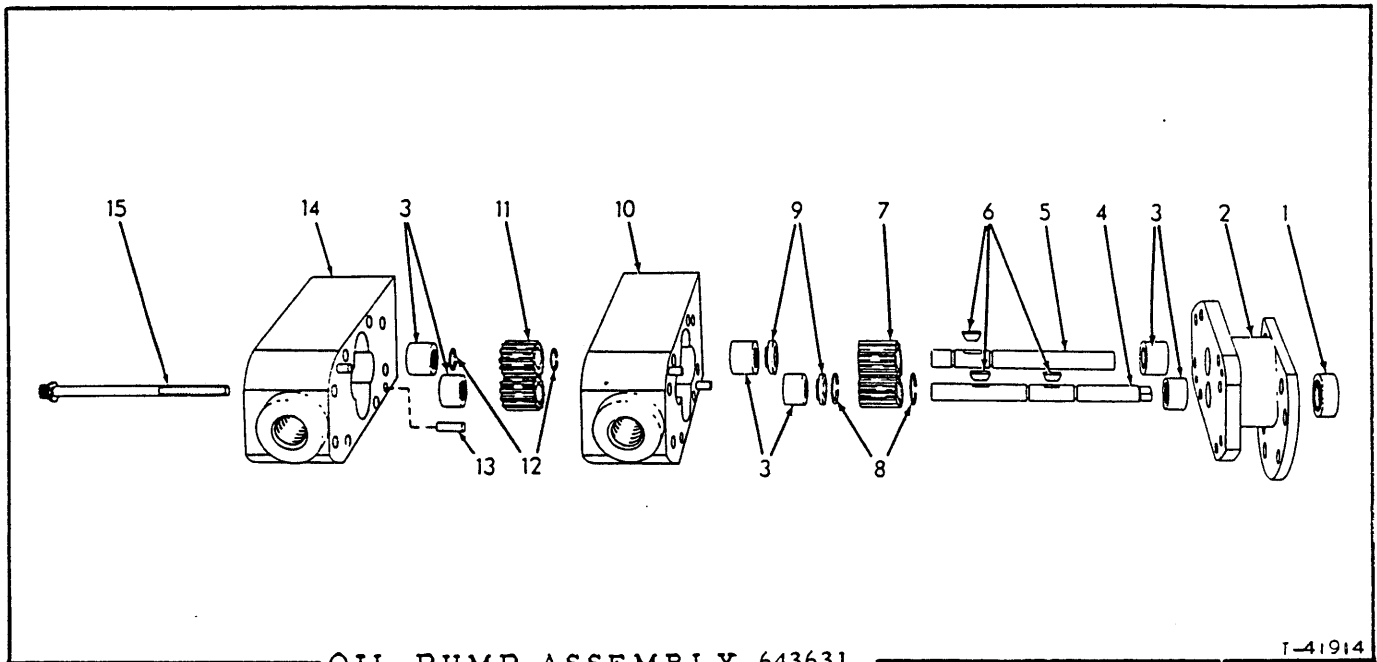

OIL PUMP ASSEMBLY 643631

T-41914

USAGE: See pages 301, 307 and 309

ITEM	PART NO.	QTY.	DESCRIPTION
1	4047783	1	SEAL, oil, drive shaft
2	-----	1	STATOR (Not serviced separately)
3	077241	6	BEARING, needle
4	643705	1	SHAFT, drive
5	643704	1	SHAFT, driven
6	918699	3	KEY, woodruff #3, 1/8" x 1/2"
7	643680	2	GEAR (1-1/4" long)
8	3015050	2	RING, snap, drive shaft
9	643706	2	SEAL, gear housing
10	-----	1	HOUSING, gear (Not serviced separately)
11	643679	2	GEAR (1" long)
12	099949	2	RING, snap, driven shaft
13	4048000	4	PIN, dowel
14	-----	1	HOUSING, gear (Not serviced separately)
15	643742	8	SCREW ASSEMBLY (Includes lockwasher)

## STEERING CLUTCHES

USAGE: All units except Model HD11E, EC tractors serial No. 10001 and up

ITEM	PART NO.	QTY.	DESCRIPTION
1	056790	2	CLUTCH ASSEMBLY, steering (Consists of items 3 thru 13)
2	090767	20	CAPSCREW, drilled-hd., 1/2"NC x 1-3/16"
	023633	10	WIRE, locking, 1/16" x 12"
3	056791	2	HUB, clutch
4	057375	30	DISC, friction (bi-metallic)
	093996	4	DISC, friction (bi-metallic, tapered thickness)
5	624562	34	DISC, friction (steel)(Use as req'd)
6	056792	2	PLATE, back
7	056793	2	PLATE, pressure
8	087958	16	SPRING, pressure
9	034300	16	WASHER, spring insulating
10	050214	2	PLATE, throwout
11	056817	16	CAPSCREW, throwout plate (1/2"NC x 6")
12	023756	4	WIRE, locking, 1/16" x 26"
13	056794	16	SPACER, throwout plate
14	069220	2	HUB, driving
15	637932	2	WASHER ASSEMBLY, hub retaining (Includes item 18)
16	630045	2	CAPSCREW, thin-hd., 1"NF x 1-3/4"
17	651745	2	WASHER, locking
18	035793	2	PIN, hub retaining washer
19	082262	2	SLEEVE, throwout
20	050440	2	BEARING, ball, throwout sleeve
21	050249	2	CAGE ASSEMBLY, throwout bearing (Includes item 22)
	901652	2	PLUG, pipe, 1/4"NPT
22	050227	4	BUSHING, pivot, throwout bearing (steel)
23	082785	2	HOSE, lubricating, throwout bearing (9-3/4" long)(Used prior to tractor #6821)
	901722	2	ELBOW, pipe, street, 90°, 1/4"NPT
	907058	2	ELBOW, pipe, street, 45°, 1/4"NPT
	061133	2	HOSE, lubricating, throwout bearing (16" long)(Effective with tractor #6821)
	901722	2	ELBOW, pipe, street, 90°, 1/4"NPT
	901825	2	BUSHING, pipe reducing, 1/4"NPT to 1/8"NPT
	911100	2	WASHER, plain, SAE std., 5/8"
	910543	2	LOCKWASHER, ext-tooth, 5/8"
	911049	2	NUT, jam, 5/8"NF
	914465	2	FITTING, lubricating, straight, 1/8"NPT
24	042538	2	ELBOW, throwout bearing hose (90°, 1/4"NPT male and female, long type)(Used prior to tractor #6821)
25	620712	2	YOKE ASSEMBLY, clutch throwout (Includes items 26 and 27)
26	035878	2	BALL, throwout yoke
27	050220	2	PIN, wear, throwout yoke
28	050222	4	PIN, trunnion
29	050221	4	BLOCK, trunnion pin locking
30	047478	4	CAPSCREW, 1/4"NC x 5/8"
	904204	4	LOCKWASHER, 1/4"

STEERING CLUTCH AND FINAL DRIVE HOUSING

USAGE: Model HD11 E, EC tractors serial No. 10001 and up

ITEM	PART NO.	QTY.	DESCRIPTION	
1	70629446	1	HOUSING ASSY. (Includes items 2 thru 9)	
	70904223	4	PLUG, pipe, ctsk-hd., 1/2"NPT	
	70901667	2	PLUG, pipe, ctsk-hd., 1-1/4"NPT (Effective with tractor #10777)	
2	70060552	4	CAP, track frame pivot shaft (Also see items 4 and 5)(Original equipment)	
	70666488	2	CAP ASSY., track frame pivot shaft, inner (Includes PIN 70666489)	} Service replacement. Used only on units converted for pressure lubrication.
	70060552	2	CAP, track frame pivot shaft, outer	
3	70052527	8	CAPSCREW, 3/4"NF x 3-1/2"	
	70904369	8	LOCKWASHER, 3/4"	
4	70096210	2	CAP ASSY., truck frame pivot shaft, inner	
5	70096209	2	CAP ASSY., truck frame pivot shaft, outer	
NOTE: Each Cap Assy. listed above includes items 2, 3 and 6; also upper block which requires welding to housing.				
6	70075053	8	DOWEL, hollow, pivot shaft cap	
7	70076726	2	WICK ASSY., pivot shaft lubricating (Consists of 1 PIN and 1 WICK 70050357. Also serves as dowel for pivot shaft)(Original equipment)	
	70666489	2	PIN, dowel, pivot shaft inner cap (Service replacement)	} Used only on units converted to pressure - lubrication of pivot shaft.
	70665667	2	PLUG, main housing (steel, 5/16" diam. x 3/4")(Used to plug oiling wick hole)	
8	70050357	2	WICK, pivot shaft lubricating (felt)	
9	70624485	2	PIN, dowel, clutch compartment covers	
10	70035250	8	PLUG, final drive compartment	
11	70067543	1	PLUG, drain, bevel gear compartment (magnetic)	
12	70035249	9	GASKET, plug	
13	70052979	6	PLUG, thread protecting (1-1/4"NF)	
14	70053421	4	PLUG, thread protecting (3/4"NPT)	
15	70051496	2	PLUG, thread protecting (5/8"NC)	
16	70067480	4	CAPSCREW, hole-plugging	
	70618724	4	WASHER, copper	
17	70920107	-	PLUG, housing (Includes O-RING 70921206)	
18	70630947	1	COVER, dipstick hole	
19	70035167	2	CAPSCREW, 3/8"NF x 7/8"	
	70904206	2	LOCKWASHER, 3/8"	
20	70628951	1	GASKET, cover plate	
21	70630102	1	PIPE, oil filler	
22	70034269	1	GASKET, oil filler plug	
23	70034268	1	PLUG, oil level	
24	70633102	1	GAUGE, oil level	
25	70034265	1	CAP, oil filler plug	

(Continued)

FINAL DRIVE SPROCKET, SHAFT AND GEAR

\* All Model HD11B, ES, S, F, FC tractors; also Model HD11E, EC tractors prior to serial No. 10001  
 \*\* Model HD11E, EC tractors serial No. 10001 and up; also used on all prior models equipped with extreme-duty service replacement tracks

ITEM	PART NO.	QTY.		DESCRIPTION
		*	**	
1	70642643	2	2	GEAR, driving
2	70058826	4	4	LOCK, gear retaining
3	70035439	8	8	CAPSCREW, 3/8"NC x 1"
4	70052444	8	8	LOCK, capscrew
5	70084289	2	2	CAGE, inner bearing cup
6	70057273	2	-	COVER, inner bearing (Used prior to tractor #2502)
	70091571	2	2	COVER, inner bearing (Effective with tractor #2502)
7	70923829	2	-	O-RING, inner bearing cover (Used prior to tractor #2502)
	70923817	2	2	O-RING, inner bearing cover (Effective with tractor #2502)
8	70049918	2	2	WASHER, bearing cage setscrew (copper)
9	70084278	2	2	SETSCREW, bearing cage (hex-hd., dog-pt., 5/8"NF x 3-3/8")
10	70052070	2	2	CUP, inner bearing
11	70084277	2	2	CONE ASSEMBLY, inner bearing
12	70622135	2	2	SHAFT, sprocket
13	70069615	2	2	CONE ASSEMBLY, intermediate bearing
14	70069614	2	2	CUP, intermediate bearing
15	70056971	8	8	SHIM, bearing adjustment (.005" thick. Use as required)
	70056970	4	4	SHIM, bearing adjustment (.007" thick. Use as required)
	70056969	24	24	SHIM, bearing adjustment (.010" thick. Use as required)
16	70084349	2	2	CAGE ASSEMBLY, intermediate bearing (Includes item 18)
17	70035018	16	16	CAPSCREW, 1/2"NF x 1-1/2"
	70904208	16	16	LOCKWASHER, 1/2"
18	70084432	6	6	PIN, locating, seal ring
19	70058807	2	2	GASKET, seal ring
20	70081788	4	4	O-RING, inner seal (Original equipment)
	70651996	-	4	O-RING, inner seal (For service SPROCKET 70654500 only)
21	70058796	2	2	FOLLOWER ASSEMBLY, inner seal (Serviced only as a unit)
22	70058806	2	2	OBOOT, inner seal

(Continued)

(Revised December 1979)

STEERING LEVERS AND LINKAGE (Continued)

ITEM	PART NO.	QTY.	DESCRIPTION	
28	630795	4	BUSHING, intermediate shaft lever (large)	
29	078810	14	PIN, control linkage yokes	
	900801	14	PIN, cotter, 3/32" x 3/4"	
30	638309	1	LEVER ASSEMBLY, lower shaft, left	} Each includes items 32 and 33
31	638310	1	LEVER ASSEMBLY, lower shaft, right	
32	624584	4	BUSHING, lower shaft lever (small)	
33	630795	4	BUSHING, lower shaft lever (large)	
34	638314	1	SHAFT, lower	
	915989	1	PIN, roll, 3/16" x 1-3/8"	
35	043881	2	SPRING, retracting	
36	630564	2	ROD, horizontal	
	911043	2	NUT, 1/2"NF	
37	052601	2	NUT, adjusting	
38	053005	2	NUT, control rod yoke (1/2"NF left hand thread)	
39	073034	2	YOKE, control rod	
40	049993	2	PIN, control rod yoke	
	900805	2	PIN, cotter, 1/8" x 3/4"	
41	-----	1	LEVERS (See THROTTLE CONTROL)	

## CONTROL VALVE ASSEMBLY 099865

USAGE: See page 351

ITEM	PART NO.	QTY.	DESCRIPTION
1	057838	1	COVER, housing
	914453	1	COCK, vent, T-handle, 1/8"NPT
2	035061	12	CAPSCREW, 1/2"NC x 1-1/4"
	904208	12	LOCKWASHER, 1/2"
3	057839	1	GASKET, housing cover
4	080514	2	LEVER ASSEMBLY, actuating (Includes item 6)
5	035236	2	CAPSCREW, 1/2"NC x 1-3/4"
	906961	2	LOCKWASHER, internal teeth, 1/2"
6	049988	2	BUSHING, actuating lever
7	057843	2	SHAFT, actuating lever
8	051513	4	BEARING, needle, actuating lever shaft
9	075955	2	RETAINER, actuating lever shaft bearing
10	035439	4	CAPSCREW, 3/8"NC x 1"
10A	621453	4	LOCK, capscREW
11	923577	2	O-RING, bearing retainer
12	057848	2	SEAL, oil, actuating lever shaft
13	057846	2	GASKET, lever shaft bearing retainer
14	057852	1	HOUSING, control mechanism
	907859	1	PLUG, pipe, hex-socket, 1/4"NPT
15	049993	2	PIN, connecting rod
	910967	2	PIN, cotter, 1/8" x 7/8"
16	080513	2	ROD, connecting
17	099863	2	PISTON, control
18	052459	2	PIN, piston
19	059883	2	GASKET, valve spool bracket
20	099862	2	BRACKET, valve spool
21	036203	4	CAPSCREW, 1/2"NC x 1-3/4"
22	035190	4	CAPSCREW, 1/2"NC x 1-1/2"
	904208	8	LOCKWASHER, 1/2"
23	099856	4	SEAL, oil, valve spool
24	099864	2	SPOOL ASSEMBLY, valve (Includes item 25)
25	049988	2	BUSHING, valve spool (steel)
26	079421	2	BOOT, valve spool
	913232	2	CLAMP, hose, 1-3/8" diam. (front)
	914503	2	CLAMP, hose, 2-3/16" diam. (rear)

BRAKES

USAGE: All tractors prior to serial No.10001; also Model HD11B, S tractors serial No.10001 and up

ITEM	PART NO.	QTY.	DESCRIPTION
1	057381	2	BAND ASSEMBLY, top section (4" wide)(Original equipment)
	654825	2	BAND ASSEMBLY, top section (5-1/2" wide)(Optional equipment)
2	057382	2	BAND ASSEMBLY, bottom section (4" wide)(Original equipment)
	654821	2	BAND ASSEMBLY, bottom section (5-1/2" wide)(Optional equipment)
<u>NOTE:</u> Each Band Assembly includes linings and rivets			
3	057208	12	LINING, brake band (4" wide)(Original equipment. See item 62)
	654827	12	LINING, brake band (5-1/2" wide)(For optional replacement bands only)
	911097	60	RIVET, tubular, brass, fl-hd., 3/16" x 3/8"
	915639	12	RIVET, tubular, brass, fl-hd., 3/16" x 21/32"
4	057207	2	PIN, hinge, brake band
	910244	4	WASHER, plain, SAE std., 1/2"
	900805	4	PIN, cotter, 1/8" x 3/4"
<u>NOTE:</u> Items 5 thru 8 comprise the FIRST TYPE BAND SUPPORT used prior to tractor serial No. 4304			
5	060772	2	BOLT, eye, band supporting
	900817	2	WASHER, plain, U.S. std., 3/8"
	910863	2	NUT, slotted, 3/8"NF
	900802	2	PIN, cotter, 3/32" x 1"
6	078810	2	PIN, eye bolt
	900942	2	PIN, cotter, 3/32" x 5/8"
7	060668	2	SPRING, band supporting eye bolt
8	060770	2	SUPPORT, band adjustment
	913830	2	NUT, jam, 1/2"NF
<u>NOTE:</u> Items 9 thru 12 comprise the SECOND TYPE BAND SUPPORT effective with tractor serial No. 4304			
9	095216	2	YOKE, band support
10	035038	2	PIN, band support yoke
	900942	2	PIN, cotter, 3/32" x 5/8"
11	095214	2	SPRING, band supporting
12	095215	2	BOLT, band supporting
	910867	2	NUT, slotted, 1/2"NF
	900807	2	PIN, cotter, 1/8" x 1-1/4"
	913830	2	NUT, jam, 1/2"NF
13	060774	2	NUT, band adjustment support
14	-----	2	ADJUSTER, brake band (6-7/16" long)(Used prior to tractor #2722. Order ADJUSTER 090960 and BLOCK 090958)
	090960	2	ADJUSTER, brake band (6-7/8" long)(Effective with tractor #2722)
	916227	2	PIN, roll, 1/4" x 1"

(Continued)

MEMO

TRANSMISSION GUARDS

USAGE: Standard equipment on Models HD11F, FC; optional on all other models

\* Tractors prior to serial No. 8930  
 \*\* Tractors serial No. 8930 thru No. 10000; also Model HD11B, S tractors serial No. 10001 and up  
 \*\*\* Model HD11E, EC tractors serial No. 10001 and up

ITEM	PART NO.	QUANTITY			DESCRIPTION
		*	**	***	
1	-----	1	-	-	SHIELD, transmission (Order GUARD 643773, PLATE 643770, 4 CAPSCREW 035018 and 4 LOCKWASHER 904208)
	643773	-	1	-	GUARD, transmission
2	035073	6	-	-	CAPSCREW, 1/2"NF x 1-3/4"
	035067	-	6	-	CAPSCREW, 1/2"NF x 2"
	064531	6	6	-	WASHER, plain
	904208	6	6	-	LOCKWASHER, 1/2"
	911043	6	6	-	NUT, 1/2"NF (Used prior to tractor #10001)
3	643770	-	1	-	COVER, transmission drain hole
4	035018	-	4	-	CAPSCREW, 1/2"NF x 1-1/2" (Early units)
	035190	-	4	-	CAPSCREW, 1/2"NC x 1-1/2" (Late units)
	904208	-	4	-	LOCKWASHER, 1/2"
5	638442	-	-	1	GUARD, transmission, front section
6	035068	-	-	4	CAPSCREW, 1/2"NF x 2-1/4" (Not used on units with BOTTOM GUARDS)
	904208	-	-	4	LOCKWASHER, 1/2"
	064531	-	-	4	WASHER, plain
7	646490	-	-	1	GUARD, transmission, rear section
8	035068	-	-	4	CAPSCREW, 1/2"NF x 2-1/4" (2 less used on units with BOTTOM GUARDS)
	904208	-	-	4	LOCKWASHER, 1/2"
	064531	-	-	4	WASHER, plain
	035248	-	-	2	CAPSCREW, 5/8"NF x 2-1/4"
	064810	-	-	2	WASHER, plain
9	904209	-	-	2	LOCKWASHER, 5/8"
	911044	-	-	2	NUT, 5/8"NF
	638480	-	-	4	SHIM, rear transmission guard (1/16" thick. Use as required)
10	638479	-	-	4	SHIM, rear transmission guard (1/8" thick. Use as required)
11	637971	-	-	1	COVER, rear transmission guard
12	035190	-	-	4	CAPSCREW, 1/2"NF x 1-1/2"
	904208	-	-	4	LOCKWASHER, 1/2"
13	644483	-	-	1	COVER, rear (Not used on units equipped with special SWINGING DRAWBAR)
14	013465	-	-	4	CAPSCREW, 3/4"NF x 2-1/2"
15	012767	-	-	4	NUT, high, 3/4"NF
16	646591	-	2	2	BAR, tapped (Effective with tractor #10001)
17	614478	-	4	4	CAPSCREW, 1/2"NF x 1-3/8"
	904208	-	4	4	LOCKWASHER, 1/2"

TRACK FRAME

USAGE: Model HD11B,S tractors prior to serial No. 7632; Model HD11E,EC,ES tractors prior to serial No. 7538; Model HD11F,FC tractors prior to serial No. 7609

\* HD11B,S  
 \*\* HD11E,EC,ES  
 \*\*\* HD11F,FC; also HD11E with special 44-link track

ITEM	PART NO.	QUANTITY			DESCRIPTION
		*	**	***	
1	-----	1	-	-	FRAME ASSEMBLY, left (Order TRACK FRAME KIT 631989. If for tractors prior to #6473 also order 1 SHAFT 622847, 2 RETAINER 622850, 2 RETAINER 622855. If for tractors prior to #5467 also add 1 CAPSCREW 035244, 1 WASHER 064531, 2 CAPSCREW 035073, 3 CAPSCREW 023618, 24 CAPSCREW 070161)
	-----	-	1	-	FRAME ASSEMBLY, left (Order TRACK FRAME KIT 631993. If for tractors prior to #6473 also order 1 SHAFT 622847, 2 RETAINER 622850, 2 RETAINER 622855)
	-----	-	-	1	FRAME ASSEMBLY, left (For Model HD11E with special 44-link track only. Order TRACK FRAME KIT 632115)
	-----	-	-	1	FRAME ASSEMBLY, left (Model HD11F,FC tractors prior to #4629. Order TRACK FRAME KIT 634823)
	-----	-	-	1	FRAME ASSEMBLY, left (Model HD11F,FC tractors #4629 and up. Order TRACK FRAME KIT 631991. If for tractors prior to #6473 also order 1 SHAFT 622847, 2 RETAINER 622850, 2 RETAINER 622855)
	-----	1	-	-	FRAME ASSEMBLY, right (Order TRACK FRAME KIT 631990. If for tractors prior to #6473 also order 1 SHAFT 622847, 2 RETAINER 622850, 2 RETAINER 622855. If for tractors prior to #5467 also add 1 CAPSCREW 035244, 1 WASHER 064531, 2 CAPSCREW 035073, 3 CAPSCREW 023618, 24 CAPSCREW 070161)
	-----	-	1	-	FRAME ASSEMBLY, right (Order TRACK FRAME KIT 631994. If for tractors prior to #6473 also order 1 SHAFT 622847, 2 RETAINER 622850, 2 RETAINER 622855)
	-----	-	-	1	FRAME ASSEMBLY, right (For Model HD11E with special 44-link track only. Order TRACK FRAME KIT 632116)
	-----	-	-	1	FRAME ASSEMBLY, right (Model HD11F,FC tractors prior to #4629. Order TRACK FRAME KIT 634824)
	-----	-	-	1	FRAME ASSEMBLY, right (Model HD11F,FC tractors #4629 and up. Order TRACK FRAME KIT 631992. If for tractors prior to #6473 also order 1 SHAFT 622847, 2 RETAINER 622850, 2 RETAINER 622855)

NOTE: Each Frame Assembly listed above includes items 2 thru 4

2	70056895	2	2	2	CAP, sprocket shaft bearing
3	70071014	4	4	4	CAPSCREW, 3/4"NF x 4-1/2"
	70904369	4	4	4	LOCKWASHER, 3/4"
4	70056261	2	2	2	BUSHING, pivot shaft (4"long)(Original equipment)
	70666459	2	2	2	BUSHING, pivot shaft (4-1/4"long)(Service replacement. Used only on units converted for pressure lubrication)
5	70056260	2	2	2	SHAFT, pivot (Original equipment)
	70666464	2	2	2	SHAFT, pivot (Service replacement. Used only on units converted for pressure lubrication)
	70907070	2	2	2	PLUG, pipe, ctsk-hd., 1/4" NPT

(Continued)

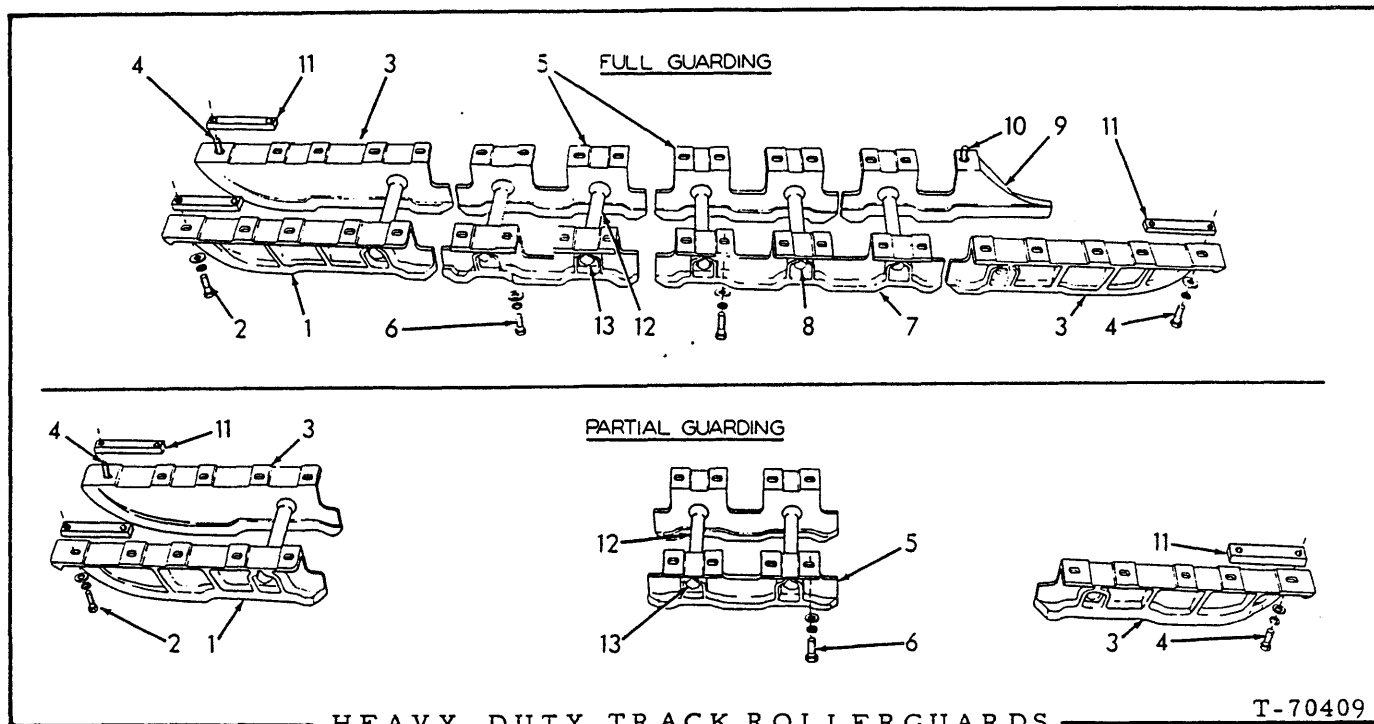

HEAVY-DUTY TRACK ROLLERGUARDS

T-70409

USAGE: Special equipment. Model HD11 E, EC tractors serial No. 10001 and up with standard 40-link track

\* Partial guarding  
 \*\* Full guarding

ITEM	PART NO.	QTY.		DESCRIPTION
		*	**	
1	644093	3	3	GUARD, end section, left hand
2	013467	15	15	CAPSCREW, 5/8"NF x 3"
	904209	15	15	LOCKWASHER, 5/8"
	064810	15	15	WASHER, plain
3	644094	3	3	GUARD, end section, right hand
4	013467	15	15	CAPSCREW, 5/8"NF x 3"
	904209	15	15	LOCKWASHER, 5/8"
	064810	15	15	WASHER, plain
5	644154	4	6	GUARD, intermediate section
6	013467	16	24	CAPSCREW, 5/8"NF x 3"
	904209	16	24	LOCKWASHER, 5/8"
	064810	16	24	WASHER, plain
7	644200	-	2	GUARD, intermediate rear section, outer
8	013467	-	12	CAPSCREW, 5/8"NF x 3"
	904209	-	12	LOCKWASHER, 5/8"
	064810	-	12	WASHER, plain
9	644203	-	1	GUARD, rear inner section, left side
	644204	-	1	GUARD, rear inner section, right side
10	013467	-	6	CAPSCREW, 5/8"NF x 3"
	904209	-	6	LOCKWASHER, 5/8"
	064810	-	6	WASHER, plain
11	632769	12	12	BLOCK, tapped, end guard attachment
12	644112	6	12	SPACER, guard bracing
13	644179	6	12	CAPSCREW, guard bracing (7/8"NF x 12-1/8")
	905347	6	12	LOCKWASHER, 7/8"
	911046	6	12	NUT, 7/8"NF
	638341	12	24	WASHER, plain

TRACK ROLLER (Heavy-duty)(Continued)

ITEM	PART NO.	QTY.	DESCRIPTION
20	056346	2	BRACKET, attaching (2-7/8" wide)(Used prior to tractor #6460)
	093805	2	BRACKET, attaching (2-7/16" wide)(Effective with tractor #6460)
21	045524	4	CAPSCREW, 5/8"NF x 4-1/2"
	904209	4	LOCKWASHER, 5/8"
22	056802	2	BLOCK, tapped, attaching capscrews (tapered section)(Used prior to tractor #7632 on HD11B, S; tractor #7609 on HD11F, FC; tractor #7538 on HD11E, EC, ES)
	631617	2	BLOCK, tapped, attaching capscrews (straight section)(Effective with tractor #7632 on HD11B, S; tractor #7609 on HD11F, FC; tractor #7538 on HD11E, EC, ES)
23	054890	-	SOLVENT, neoprene cement, 1/2 pint can
24	033288	-	CEMENT, neoprene, 1/2 pint can
25	083208	1	SEAL KIT (Includes parts for one (1) roller only; items 8, 9, 10 and 14)

} For cementing boots

NOTE: All quantities listed above are for one (1) roller only. The number of rollers used on the various models is listed below. Tractors prior to serial No. 6299 used four (4) double-flange rollers.

Models HD11B, S. . . . .	12
Model HD11B with special 41-link track . . . . .	14
Models HD11E, EC, ES (Prior to #10001) . . . . .	14
Models HD11E, EC (Effective with #10001) . . . . .	12
Models HD11E, EC with special 44-link track . . . . .	16
Models HD11F, FC. . . . .	16

TRACK RELEASE (Continued)

ITEM	PART NO.	QTY.	DESCRIPTION
11	056645	2	SEAL, release spring chamber cover
12	098121	2	WASHER, release spring
13	098123	2	SPRING, inner (If for tractors prior to #5790 also order items 12 and 15)
14	069260	2	SPRING, outer (34-5/8" long)(Used prior to tractor #5790)
	098122	2	SPRING, outer (35-1/2" long)(Effective with tractor #5790)
15	095794	2	SEAT, release spring (Used prior to tractor #5790)
	098124	2	SEAT, release spring (Effective with tractor #5790)
16	645545	2	BLOCK, tapped
17	035190	4	CAPSCREW, 1/2"NC x 1-1/2"
	904208	4	LOCKWASHER, 1/2"
<p><b>NOTE:</b> Items listed below are used only on Models HD11F, FC and Models HD11E, EC with special 44-link track</p>			
18	095281	2	SCREW, adjustment (34-1/2" long)
19	093389	2	BRACKET, supporting, adjustment screw (2-1/2" hole)(Used on tractors #3830 thru #4568)
	095280	2	BRACKET, supporting, adjustment screw (2-3/4" hole)(Effective with tractor #4569)
20	023618	4	CAPSCREW, 5/8"NF x 2-1/2"
	904209	4	LOCKWASHER, 5/8"
21	093982	4	BLOCK, tapped (tapered section)(Used prior to tractor #7632 on HD11B,S; #7609 on HD11F, FC; #7538 on HD11E, EC, ES)
	631665	4	BLOCK, tapped (straight section)(Effective with tractor #7632 on HD11B,S; #7609 on HD11F, FC; #7538 on HD11E, EC, ES)
22	035067	4	CAPSCREW, 1/2"NF x 2"
	904208	4	LOCKWASHER, 1/2"

TRACK (Continued)

ITEM	PART NO.	QTY.		DESCRIPTION	COMPLETE TRACK ASSEMBLIES WITH SHOES (2 Required)	
		*	**		*	**
10	084342	320	352	NUT, track shoe bolt		
10A	651370	-	-	LUBRICANT, track pin, 1-gal. can (Not illustrated)		
				TRACK SHOES	(40 links)	(44 links)
11	643963	80	88	SHOE, grouser, 16".....	643852	
	644061	80	88	SHOE, grouser, 18".....	644076	
	644084	80	88	SHOE, grouser, 20".....	644150	
	644143	80	88	SHOE, grouser, 22".....	644166	650664
	644156	80	88	SHOE, grouser, 24".....	644193	648481
	644148	80	88	SHOE, grouser, 30".....	644176	651337
12	644086	80	88	SHOE, grouser, cut-out, 18".....	644171	
	644083	80	88	SHOE, grouser, cut-out, 20".....	644211	
13	644047	40	44	SHOE, grouser, snow and ice, single calk, cut-out, 18".....	644163	
14	644085	40	44	SHOE, grouser, snow and ice, double calk, cut-out, 18".....		
15	644062	80	88	SHOE, semi-grouser, 16".....	644186	645699
	644144	80	88	SHOE, semi-grouser, 20".....	644215	

STREET PLATES

USAGE: Special equipment. For grouser shoes only.

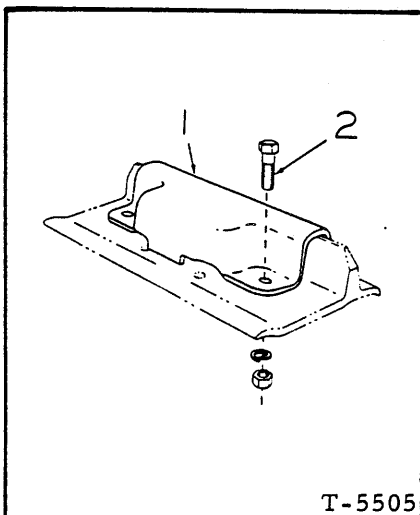

ITEM	PART NO.	QTY.	DESCRIPTION
1	073558	1	PLATE, street
2	035014	2	CAPSCREW, 5/8"NF x 1-1/2"
	904209	2	LOCKWASHER, 5/8"
	911044	2	NUT, 5/8"NF

NOTE: Quantities indicated are for one (1) shoe only

RADIATOR GUARD (Plain. Second type)

USAGE: Tractors serial No. 10001 and up, Standard on all models except HD11S. See following pages for optional designs.

ITEM	PART NO.	QTY.	DESCRIPTION
1	645498	1	GUARD ASSEMBLY, radiator (Includes items 2 thru 5)
2	093446	1	PLATE, top closure (Tractors prior to #11609)
	651623	1	PLATE, top closure (Tractors #11609 and up)
3	070467	4	CAPSCREW, 1/2"NF x 1"
	904208	4	LOCKWASHER, 1/2"
4	085555	2	CAP, guard pivot
5	075878	4	CAPSCREW, 7/8"NF x 4"
	905347	4	LOCKWASHER, 7/8"
6	641490	1	BAFFLE, air, upper
7	036034	5	CAPSCREW, 3/8"NF x 1"
	904206	5	LOCKWASHER, 3/8"
	044973	5	WASHER, plain
8	085413	2	BAFFLE, air, side (Model HD11B, E)
	645510	2	BAFFLE, air, side (Model HD11EC)
9	036034	10	CAPSCREW, 3/8"NF x 1"
	904206	10	LOCKWASHER, 3/8"
	044973	10	WASHER, plain
10	641491	1	BAFFLE, air, lower
11	012992	5	CAPSCREW, 3/8"NF x 1-1/4"
	044973	5	WASHER, plain
	904206	5	LOCKWASHER, 3/8"
	911041	5	NUT, 3/8"NF
12	642631	1	GRILLE, front closure
13	035190	12	CAPSCREW, 1/2"NC x 1-1/2"
	904208	12	LOCKWASHER, 1/2"
	064531	12	WASHER, plain
14	085305	2	PLATE, bottom closure, front
15	035018	4	CAPSCREW, 1/2"NF x 1-1/2"
	904208	4	LOCKWASHER, 1/2"
	064531	4	WASHER, plain
16	085304	2	PLATE, bottom closure, rear
17	035018	4	CAPSCREW, 1/2"NF x 1-1/2"
	904208	4	LOCKWASHER, 1/2"
	064531	4	WASHER, plain
18	091942	1	PLATE, top closure (Includes hinge)
19	035167	2	CAPSCREW, 3/8"NF x 7/8"
	904206	2	LOCKWASHER, 3/8"
	911041	2	NUT, 3/8"NF
20	624487	1	KNOB, top closure plate
	910244	1	WASHER, plain, SAE std., 1/2"
	916202	1	PIN, roll, 1/8" x 7/8"
21	624488	1	BLOCK, tapped

Tractors prior to #11609

NOTE: See PAINTING AND MARKING for transfers



RADIATOR GUARD (Cable. Third type)

USAGE: Special equipment. For tractors serial No. 10001 and up equipped with cable dozer.

\* Used with rear-mounted cable control units  
 \*\* Used with front-mounted cable control units

ITEM	PART NO.	QTY.		DESCRIPTION	
		*	**		
1	645501	1	1	GUARD ASSEMBLY, radiator (Includes items 2 thru 5)	
2	093446	1	1	PLATE, top closure (Tractors prior to serial No. 11609)	}
	651623	1	1	PLATE, top closure (Tractors #11609 and up)	
3	070467	4	4	CAPSCREW, 1/2"NF x 1"	}
	904208	4	4	LOCKWASHER, 1/2"	
4	085555	2	2	CAP, guard pivot	}
5	075878	4	4	CAPSCREW, 7/8"NF x 4"	
	905347	4	4	LOCKWASHER, 7/8"	
6	091942	1	1	PLATE, top closure (Includes hinge)	}
7	035167	2	2	CAPSCREW, 3/8"NF x 7/8"	
	904206	2	2	LOCKWASHER, 3/8"	
	911041	2	2	NUT, 3/8"NF"	
8	624487	1	1	KNOB, top closure plate	}
	910244	1	1	WASHER, plain, SAE std., 1/2"	
	916202	1	1	PIN, roll, 1/8" x 7/8"	
9	624488	1	1	BLOCK, tapped	
10	084758	3	1	SHEAVE, control cable	
11	044875	3	1	BEARING, roller, cable sheave	
12	085521	1	-	SHAFT, front sheave	}
	088786	-	1	SHAFT, front sheave	
	914465	1	2	FITTING, lubricating, straight, 1/8"NPT	
13	035188	1	1	SETSCREW, shaft retaining	}
	911035	1	1	NUT, jam, 1/2"NC	
14	084384	2	-	SHAFT, side sheaves	}
	914465	2	-	FITTING, lubricating, straight, 1/8"NPT	
	917936	2	-	PIN, roll, 3/8" x 3-1/2"	
	093043	-	2	CUP, hole closure	
15	917936	-	2	PIN, roll, 3/8" x 3-1/2"	}
	085395	1	-	GUIDE, cable	
16	093866	-	1	GUIDE, false (Serves as sheave compartment dirt closure)	}
	035306	2	2	CAPSCREW, 5/8"NF x 3-1/4"	
17	904209	2	2	LOCKWASHER, 5/8"	}
	911044	2	2	NUT, 5/8"NF	
	085304	2	2	PLATE, bottom closure, rear	
18	035018	4	4	CAPSCREW, 1/2"NF x 1-1/2"	}
	904208	4	4	LOCKWASHER, 1/2"	
	064531	4	4	WASHER, plain	

(Continued)

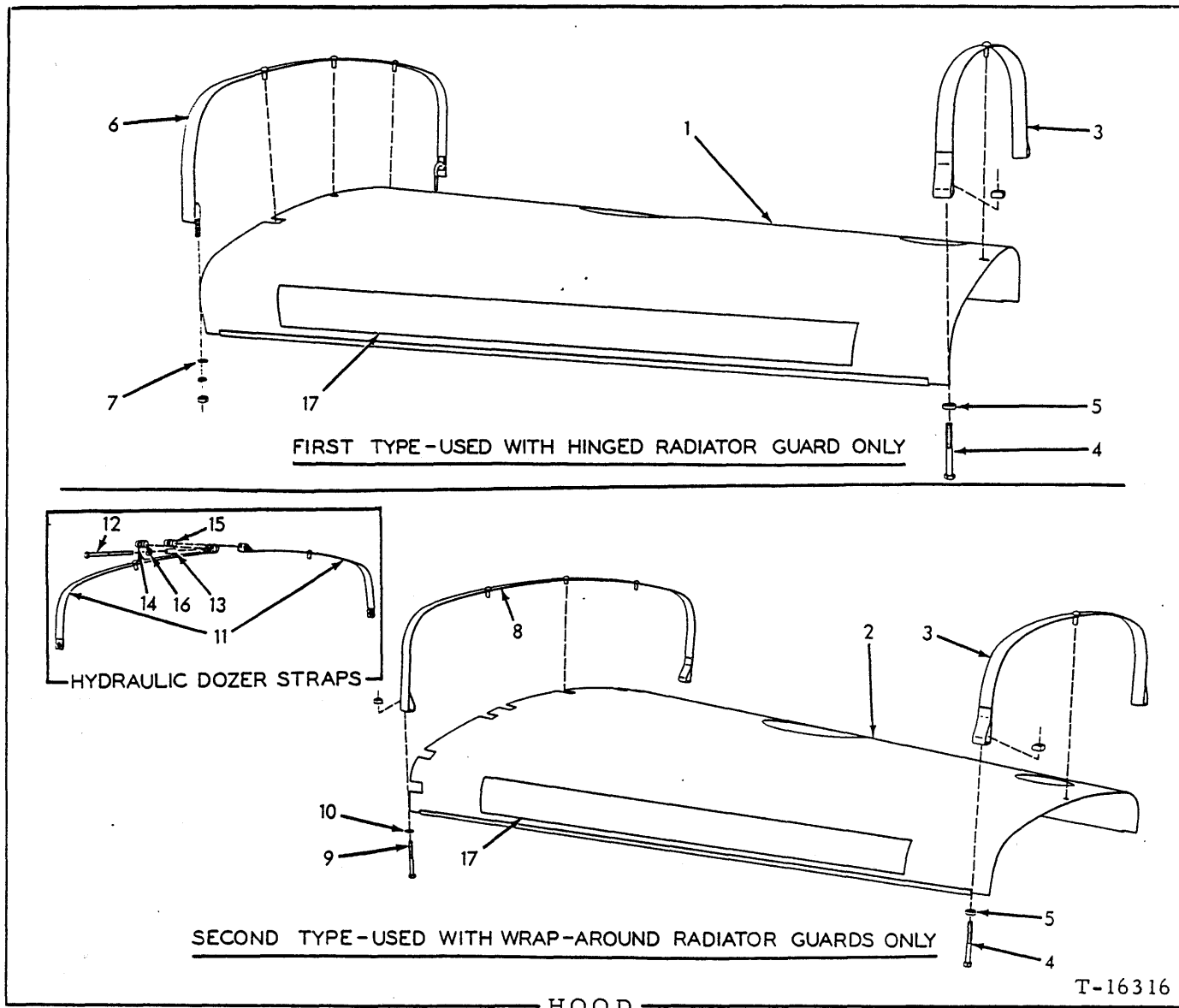

USAGE: Tractors prior to serial No. 10001

\* Models HD11ES, F, FC, S. Standard equipment.

\*\* Models HD11B, E, EC except when equipped with hydraulic dozer. Also applicable to Models HD11ES, S, when equipped with wrap-around plain or cable radiator guard

\*\*\* Models HD11B, E, EC, ES, S when equipped with hydraulic dozer.

\*\*\*\* Model HD11B, E, EC when equipped with Model 11HI hydraulic dozer.

ITEM	PART NO.	QUANTITY				DESCRIPTION
		*	**	***	****	
1	084279	1	-	-	-	HOOD, engine (Used with oil-bath air cleaner)
	623738	1	-	-	-	HOOD, engine (Used with dry-type air cleaner)
2	-----	-	1	1	-	HOOD, engine (Used with oil-bath air cleaner)(Order HOOD 623737)
	623737	-	1	1	-	HOOD, engine (Used with dry-type air cleaner)
	093448	-	-	-	1	HOOD, engine (Used with oil-bath air cleaner)
	623814	-	-	-	1	HOOD, engine (Used with dry-type air cleaner)

(Continued)

REAR FENDERS (Continued)

ITEM	PART NUMBER	QTY.	DESCRIPTION
17	089898	1	CHANNEL, fender bracing (Effective with tractor #2601, including #2516 thru #2553)
18	035018	4	CAPSCREW, 1/2"NF x 1-1/2"
	904208	4	LOCKWASHER, 1/2"
	900818	4	WASHER, plain, U.S. std., 1/2"

FLOOR (Continued)

ITEM	PART NO.	QTY.		DESCRIPTION
		*	**	
11	646291	1	-	PLATE, rear, right section
	646152	1	-	PLATE, rear, right section (For units with special engine decelerator)
	646292	-	1	PLATE, rear, right section
12	035061	1	1	CAPSCREW, 1/2"NC x 1-1/4"
13	035190	1	1	CAPSCREW, 1/2"NC x 1-1/2"
	904208	2	2	LOCKWASHER, 1/2"
14	092163	2	2	WASHER, plain
15	644070	1	-	CHANNEL, supporting
	634617	-	1	CHANNEL, supporting (Illustrated)(Also for HD11E when equipped with special engine decelerator)
16	035067	4	4	CAPSCREW, 1/2"NF x 2"
	035073	4	4	CAPSCREW, 1/2"NF x 1-3/4" (Early units with reinforced Rear Fenders)
	035236	4	4	CAPSCREW, 1/2"NC x 1-3/4" (Late units with reinforced Rear Fenders)
17	064531	8	8	WASHER, plain
	904208	4	4	LOCKWASHER, 1/2"
	911043	4	4	NUT, 1/2"NF (Not used on units with reinforced Rear Fenders)
18	642167	1	1	SHIM, supporting channel (1/8" thick)
	642168	2	2	SHIM, supporting channel (1/16" thick)
19	646507	1	-	GUIDE, gear shift lever
	646510	-	1	GUIDE, gear shift lever (Illustrated)
20	035190	2	2	CAPSCREW, 1/2"NC x 1-1/2"
	904208	2	2	LOCKWASHER, 1/2"
21	064531	2	2	WASHER, plain

SEAT ASSEMBLY 632053

USAGE: See page 503

ITEM	PART NO.	QTY.	DESCRIPTION
1	{ 638422	1	CUSHION, back (outside section)
	{ 642499	1	COVER, slip, back cushion (Includes fastenings)(Not original equipment)
2	{ 638421	1	CUSHION, back (center section)
	{ 642498	1	COVER, slip, back cushion (Includes fastenings)(Not original equipment)
3	{ 638420	1	CUSHION ASSEMBLY, seat (Includes item 4)
	{ 642500	1	COVER, slip, seat cushion (Includes fastenings)(Not original equipment)
4	638431	2	PLATE, bearing, seat cushion
	-----	4	SCREW, wood, fl-hd., #8 x 1/2" (Procure locally)
5	638432	2	BRACKET, pivot, seat cushion
	916532	2	SCREW, machine, rd-hd., 1/4"NC x 3/4"
	914105	2	LOCKWASHER, ext-tooth, 1/4"
6	638369	1	STOP, seat cushion locking rod
	916532	2	SCREW, machine, rd-hd., 1/4"NC x 3/4"
	914105	2	LOCKWASHER, ext-tooth, 1/4"
7	638370	1	PLATE, reinforcing, back cushion
	916532	7	SCREW, machine, rd-hd., 1/4"NC x 3/4"
	914105	7	LOCKWASHER, ext-tooth, 1/4"
8	638427	1	SUPPORT, back cushion
	916532	3	SCREW, machine, rd-hd., 1/4"NC x 3/4"
	914105	3	LOCKWASHER, ext-tooth, 1/4"
9	638435	2	BRACKET, retaining, back cushion
	916532	4	SCREW, machine, rd-hd., 1/4"NC x 3/4"
	914105	4	LOCKWASHER, ext-tooth, 1/4"
10	638468	1	FRAME ASSEMBLY, seat (Includes items 11 thru 19)
11	638425	1	ROD, locking, seat cushion
	911115	2	WASHER, plain, SAE std., 3/8"
	900801	2	PIN, cotter, 3/32" x 3/4"
12	638429	1	SPRING, seat cushion locking rod
13	638363	1	STRAP, operating, seat position
14	638428	2	SPRING, seat position operating strap
15	638426	2	ROD, locking, seat position
16	638430	3	PIN, seat position locking rod
17	628001	3	WASHER, spacing, seat position rod
18	638354	3	WASHER, retaining, seat position rod pin
19	638433	1	SPRING, cushion height adjuster
	914197	2	SCREW, thd-cutting, rd-hd., #6 x 3/8"
20	638423	4	LINK, suspension, seat frame
21	638434	8	PIN, seat frame suspension lever
22	638351	16	RING, locking, suspension lever pin
23	638424	1	SPRING, retracting, seat frame
24	638371	1	FRAME ASSEMBLY, base (Includes items 25 and 26)
25	639975	1	ROD, seat release
	910335	1	WASHER, plain, SAE std., 5/16"
	900801	2	PIN, cotter, 3/32" x 3/4"
26	638429	1	SPRING, seat release rod

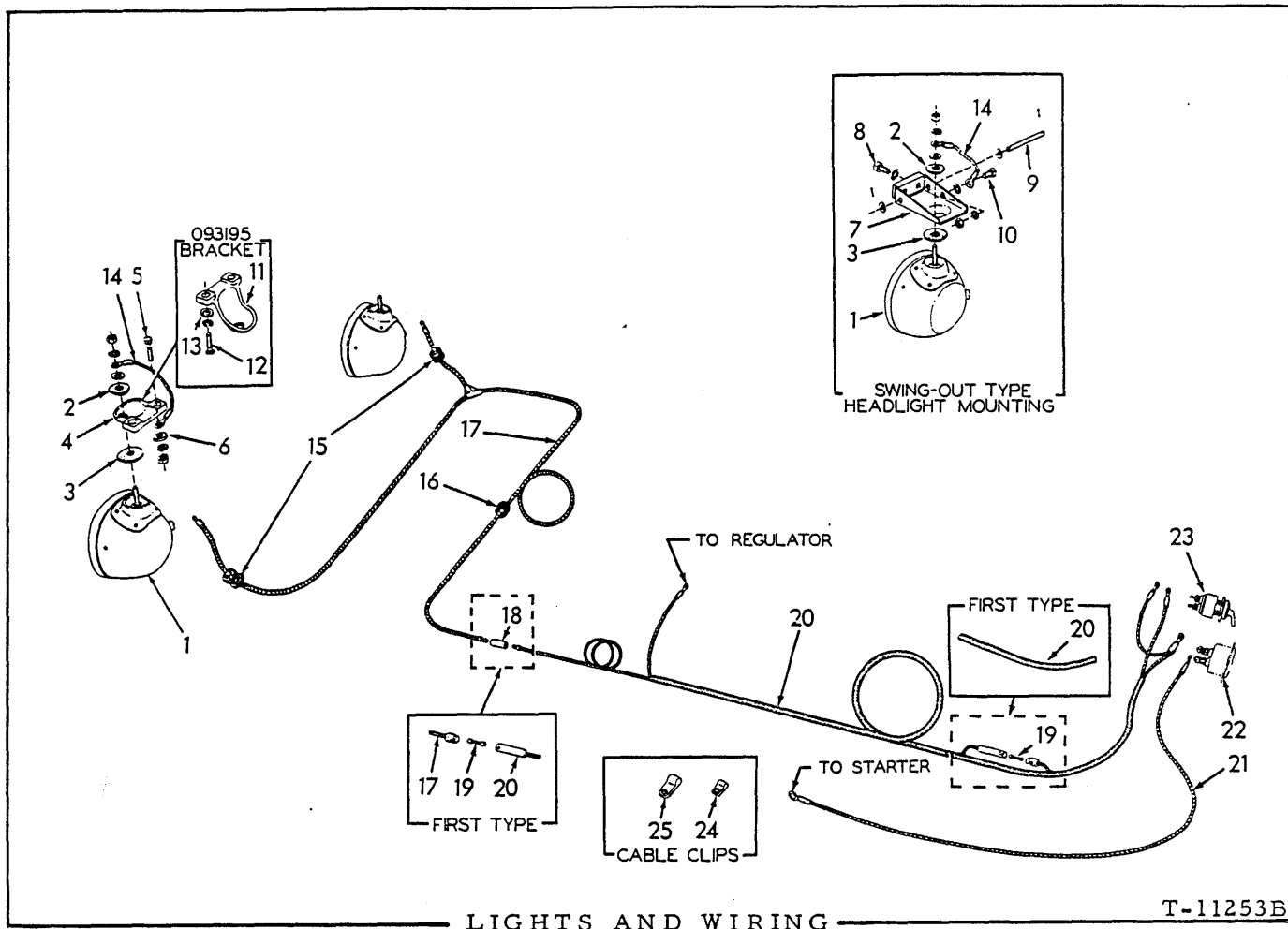

LIGHTS AND WIRING

T-11253B

USAGE: Tractors prior to serial No. 6069 excluding Nos. 5490 and 6044

ITEM	PART NO.	QTY.	DESCRIPTION
1	074388	2	LIGHT ASSEMBLY (See page 517 for parts) (Order 1 each LIGHT ASSEMBLY 097030, WASHER 075535, WASHER 900818, LOCKWASHER 904208 and NUT 911043)
	900817	2	WASHER, plain, U. S. std., 3/8"
	904206	2	LOCKWASHER, 3/8"
	911026	2	NUT, 3/8"NC
2	075854	2	WASHER, head light mounting (rubber, beveled)
3	075853	2	WASHER, head light mounting (rubber, flat)
4	075429	2	BRACKET, mounting (Standard on all Model HD11ES, F and S tractors; also Model HD11B tractors prior to serial No. 1764)
5	203188	4	CAPSCREW, 3/8"NF x 1-1/2"
6	044973	4	WASHER, plain
	904206	4	LOCKWASHER, 3/8"
	911041	4	NUT, 3/8"NF (HD11F and S only)

**NOTE:** Items 7 thru 10 comprise the SWING-OUT TYPE HEADLIGHT MOUNTING used as standard equipment on Model HD11B tractors serial No. 1764 thru 4303.

7	089152	2	BRACKET, mounting
8	036034	4	CAPSCREW, 3/8"NF x 1"
	906960	4	LOCKWASHER, int-tooth, 3/8"

(Continued)

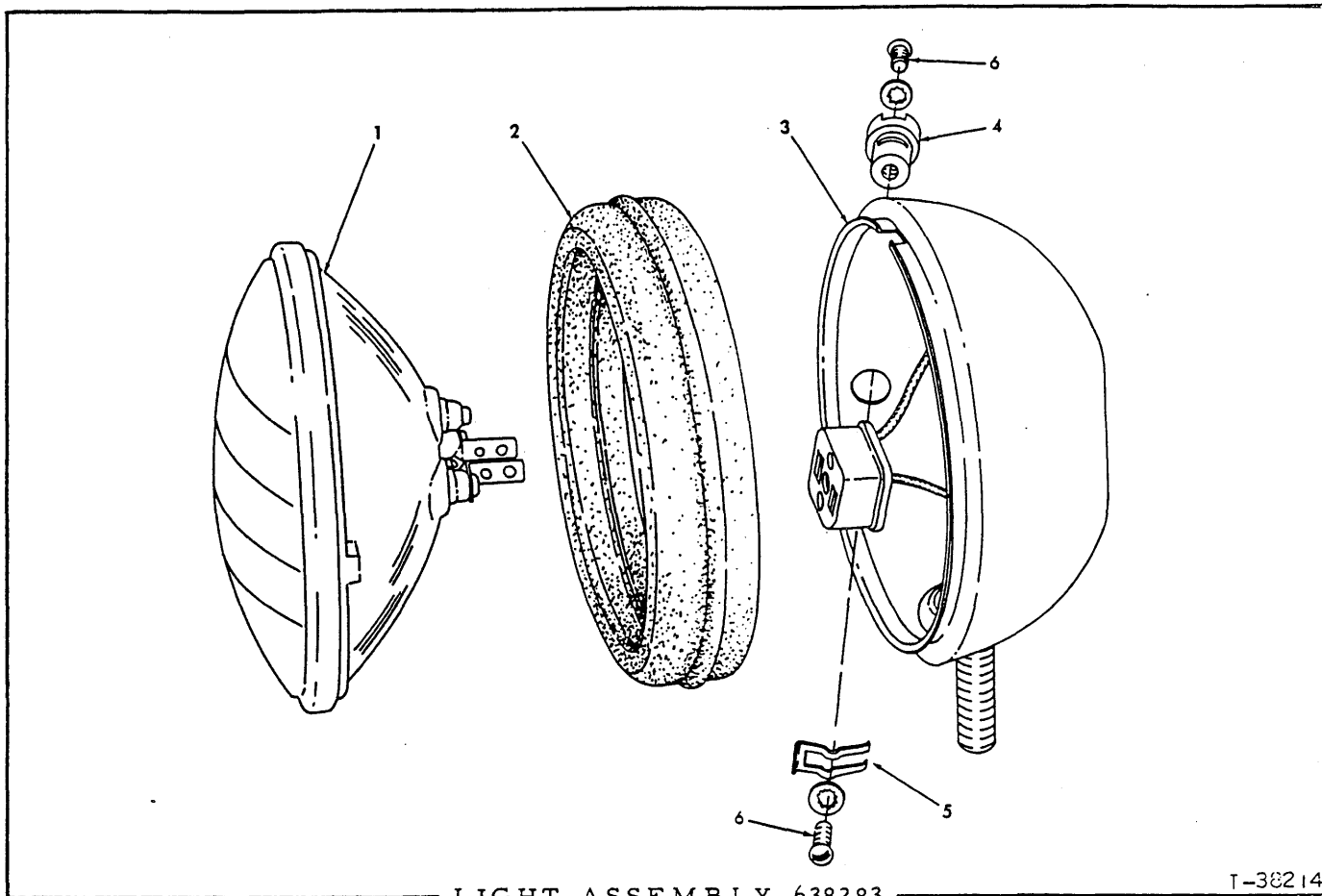

USAGE: See pages 523 and 562

ITEM PART NO. QTY. DESCRIPTION

NOTE: Quantities indicated below are for one (1) light only

1	182763	1	SEALED BEAM (24 volt)
2	638282	1	RING, retaining (rubber)
3	-----	1	BODY ASSEMBLY (Includes wiring. Not serviced separately)
4	055589	1	TERMINAL KIT (Includes items 5 and 6)
5	048922	1	SPRING, retaining, terminal bushing
6	034076	2	SCREW, terminal
	912739	2	LOCKWASHER, internal teeth, #8

S T A R T E R (Continued)

ITEM	PART NO.	QTY.		DESCRIPTION
		*	**	
3	082178	1	1	STRAP, starter to ground (8" long)(Original equipment)
	633334	1	1	STRAP, starter to ground (16" long)(Not original equipment)
	915942	1	1	LOCKWASHER, int-ext-tooth, 5/8"
4	4346320	1	1	ADAPTER, starting motor
5	240962	1	1	SWITCH ASSEMBLY, push-button (Includes mounting nut)
6	098910	1	-	HARNESS, wiring
	-----	-	1	HARNESS, wiring (See LIGHTS AND WIRING)
7	040796	3	-	CLIP, wiring harness
8	035979	3	-	CAPSCREW, 3/8"NF x 5/8"
	904206	3	-	LOCKWASHER, 3/8"
9	634677	1	1	GUARD, starter switch

I N S T R U M E N T S (Third type)

USAGE: Tractors serial No. 6473 thru No. 10000

ITEM	PART NO.	QTY.	DESCRIPTION
1	621976	1	PLATE, instrument mounting
	912789	4	CAPSCREW, 1/4"NF x 3/4"
	906958	8	LOCKWASHER, internal teeth, 1/4"
	911040	4	NUT, 1/4"NF
	921113	1	PLUG, button, 11/16" hole-diam. (Not used when Engine Primer or Air Heater is installed)
2	091589	1	GAUGE, fuel pressure (Includes mounting clamp)
3	088534	1	RESTRICTOR, fuel pressure gauge line
4	621292	1	HOSE ASSEMBLY, fuel pressure gauge (See page 6 for parts)
	919171	1	CONNECTOR, flare type, 1/4" tube, 1/8"NPT male
5	630792	1	GAUGE, engine temperature (Includes mounting clamp)
6	091585	1	GAUGE, engine oil pressure (Includes mounting clamp)
7	094450	1	TEE, oil pressure gauge
	901652	1	PLUG, pipe, 1/4"NPT (Not used on tractors equipped with Hour Meter)
	901651	1	PLUG, pipe, 1/8"NPT
8	647915	1	HOSE, oil pressure gauge (See page 6)
	919171	1	CONNECTOR, flare type, 1/4" tube, 1/8"NPT male
9	096067	1	TEE, oil pressure gauge hose (at cylinder block)
	901652	1	PLUG, pipe, 1/4"NPT
	901651	1	PLUG, pipe, 1/8"NPT
10	094527	4	CLIP, hose supporting (13/32" bolt-hole)
11	036032	3	CAPSCREW, 3/8"NF x 3/4"
	904206	3	LOCKWASHER, 3/8"
	911041	2	NUT, 3/8"NF
12	094692	1	BRACKET, supporting, oil pressure gauge hose (Not used on Models HD11B, E, F, FC tractors #8311 and up)
	635547	1	CLIP, hose supporting (Effective on Model HD11B, E, F, FC tractors #8311 and up)
13	091588	1	AMMETER (Includes mounting clamp)
14	-----	1	SWITCH (See LIGHTS AND WIRING)
15	095257	1	LIGHT ASSEMBLY, instrument panel (See page 543 for parts)
	910334	1	LOCKWASHER, internal teeth, 5/8"
	911049	1	NUT, jam, 5/8"NF
16	641809	1	GAUGE, transmission oil pressure (Includes mounting clamp)
17	622431	1	HOSE ASSEMBLY, transmission oil pressure gauge (See page 6 for parts)
	919174	1	CONNECTOR, flare type, 1/4" tube, 1/8"NPT female
	921277	1	REDUCER, flare type, 1/2" tube to 1/4" tube
	919068	1	NUT, flare type, 1/2" tube
18	620063	1	CLIP, transmission oil gauge hose (9/16" bolt-hole)
19	621984	1	ANGLE, supporting, transmission oil gauge hose
20	622161	1	CLIP, transmission oil gauge hose (long type)
21	036032	1	CAPSCREW, 3/8"NF x 3/4"
	904206	1	LOCKWASHER, 3/8"

BATTERIES AND CABLES

USAGE: Models HD11F, FC only

ITEM	PART NO.	QTY.	DESCRIPTION	
1	052782	2	HOLD-DOWN, battery	
2	052791	8	BLOCK, hold-down (rubber)	
3	-----	2	BATTERY, storage, 12 volts, 25 plates ("Prestolite" type D-6. Order from local battery dealer)	
4	-----	-	BOARD, side (Procure locally as required)	
5	-----	-	BOARD, bottom (Procure locally as required)	
6	081867	4	BRACKET, hold-down bolt	
7	035236	8	CAPSCREW, 1/2"NC x 1-3/4"	
8	064531	8	WASHER, plain	
	904208	8	LOCKWASHER, 1/2"	
	911028	8	NUT, 1/2"NC	
9	081404	4	SPRING, hold-down bolt	
10	075322	4	BOLT, hold-down	
	904208	4	LOCKWASHER, 1/2"	
	911043	4	NUT, 1/2"NF	
11	644648	1	STRAP, battery connecting (6-1/2" long)	
12	089642	1	CABLE, battery to starter (112" long)	
13	096918	1	CABLE, battery to master switch (15-1/2" long) (Effective with tractor #6069 including #5490 and #6044)	
14	096908	1	SWITCH ASSEMBLY, master (Serviced only as a unit) (Effective with tractor #6069 including #5490 and #6044)	
	912789	2	CAPSCREW, 1/4"NF x 3/4"	
	904204	2	LOCKWASHER, 1/4"	
	911040	2	NUT, 1/4"NF	
15	096913	1	BRACKET, master switch (Effective with tractor #6069 including #5490 and #6044)	
	912789	2	CAPSCREW, 1/4"NF x 3/4"	
	904204	2	LOCKWASHER, 1/4"	
	911040	2	NUT, 1/4"NF	
16	{	089641	1	CABLE, battery to ground (36" long) (Used prior to tractor #6069 excluding #5490 and #6044)
		097063	1	CABLE, master switch to ground (49" long) (Effective with tractor #6069 including #5490 and #6044)
		900817	1	WASHER, plain, U.S. std., 3/8"
		915898	1	LOCKWASHER, int-ext-tooth, 3/8"
17	076572	1	BOOT, protecting, starter terminal	
18	076469	8	BOOT, cable protecting	
19	921912	9	CLAMP, cable boot (adjustable, 1-1/16" to 2")	
20	076470	4	CLIP, cable supporting	
21	035979	1	CAPSCREW, 3/8"NF x 5/8"	
	904206	1	LOCKWASHER, 3/8"	
22	084895	2	CLIP, cable supporting	
	070467	1	CAPSCREW, 1/2"NF x 1"	
	904208	1	LOCKWASHER, 1/2"	
	911043	1	NUT, 1/2"NF	
23	621995	1	PLATE, cable supporting (Effective with tractor #6069 including #5490 and #6044)	

HOUR METER (Continued)

ITEM	PART NO.	QTY.	DESCRIPTION
3	066467	1	DAMPER, vibration
	918210	3	SCREW ASSEMBLY, #6 x 1/2" (Includes lockwasher)
4	605808	1	CABLE, pressure switch to ammeter (10" long)
5	238136	1	CLIP, hour meter cable (3/16" diam., 13/32" bolt-hole)
6	050288	1	SWITCH, pressure
7	086946	1	PLATE, extension (Used only with AIR HEATER on tractors prior to #4415)
	912789	2	CAPSCREW, 1/4"NF x 3/4"
	906958	2	LOCKWASHER, internal teeth, 1/4"
	911040	2	NUT, 1/4"NF
	085571	1	PLATE, extension (Used only when ENGINE SIDE SCREENS are installed)
8	099219	1	CABLE, meter to pressure switch (28" long)(Used prior to tractor #7352)
	630626	1	CABLE, meter to pressure switch (34" long)(Effective with tractor #7352)
9	048142	1	CONNECTOR, meter cable (Used prior to tractor #7352)
10	630917	1	CABLE, meter to ground (8" long)(Effective with tractor #7352)
11	631639	1	CABLE, meter connecting (7-1/2" long)(Used only with item 2 when replacing early type meter)

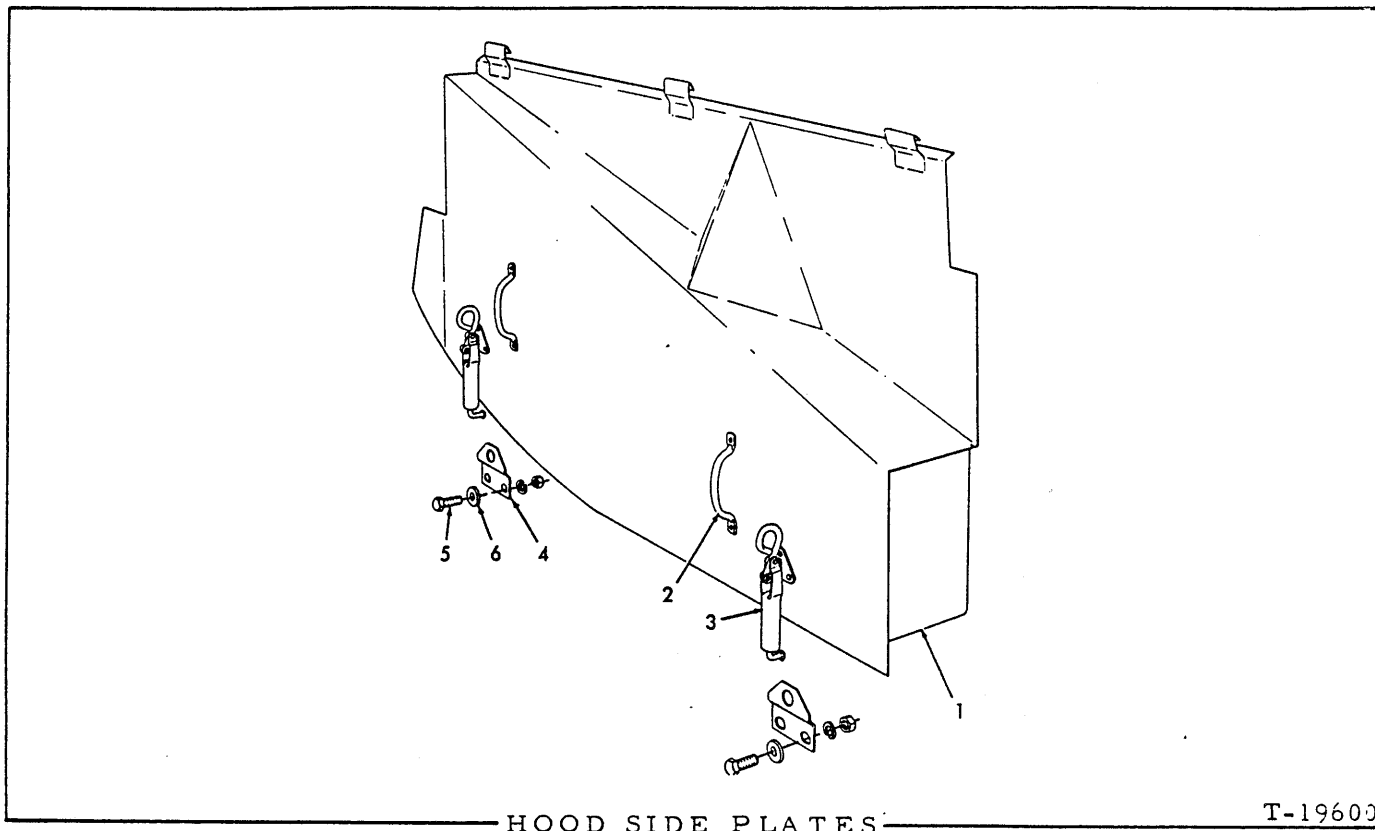

HOOD SIDE PLATES

T-19600

USAGE: Special equipment. For Model HD11B, E, EC tractors prior to serial No. 10001 when equipped with hydraulic radiator guard.

ITEM	PART NO.	QTY.	DESCRIPTION	
1	093961	1	PLATE ASSEMBLY, left side	} For use with radiator guard not having removable front upper closure plate.
	093962	1	PLATE ASSEMBLY, right side	
	093013	1	PLATE ASSEMBLY, left side	} For use with radiator guard having removable front upper closure plate.
	093014	1	PLATE ASSEMBLY, right side	
<u>NOTE:</u> Each Plate Assembly listed above includes items 2 and 3.				
2	032834	4	HANDLE, lifting	
	900764	8	RIVET, fl-hd., 3/16" x 1/2"	
3	033060	4	FASTENER	
	900764	12	RIVET, fl-hd., 3/16" x 1/2"	
4	091805	4	BRACKET, latching	
5	070469	8	CAPSCREW, 1/2"NF x 1-1/4"	
6	064531	8	WASHER, plain	
	904208	8	LOCKWASHER, 1/2"	
	911043	8	NUT, 1/2"NF	

## POWER TAKE-OFF (Continued)

ITEM	PART NO.	QTY.	DESCRIPTION
13	068489	1	GASKET, oil seal retainer
14	055529	1	COVER, shaft protecting
15	035061	2	CAPSCREW, 1/2"NC x 1-1/4"
	904208	2	LOCKWASHER, 1/2"
16	078482	1	GUARD, coupling shaft (When installed, item 14 is discarded)
17	921556	4	CAPSCREW, 1/2"NC x 2"
	904208	4	LOCKWASHER, 1/2"
18	064531	4	WASHER, plain

POWER PULLEY

USAGE: Special equipment

ITEM	PART NO.	QTY.	DESCRIPTION
1	068631	1	SPACER
	910023	1	ELBOW, street, 45°, 3/4"NPT
	912726	2	PLUG, pipe, 3/4"NPT
	901652	1	PLUG, pipe, 1/4"NPT
2	036707	9	CAPSCREW, 5/8"NC x 1-3/4"
	904209	9	LOCKWASHER, 5/8"
3	068487	1	GASKET, spacer to transmission case
4	068630	1	SHAFT, input
5	043004	2	CONE ASSEMBLY, input shaft bearing
6	043003	2	CUP, input shaft bearing
7	032325	1	RETAINER, input shaft front bearing
8	021527	4	CAPSCREW, drilled-hd., 3/8"NC x 1-5/8"
9	023756	1	WIRE, locking, 1/16" x 26"
10	032347	1	SEAL, oil, input shaft
11	042658	1	GEAR SET (Consists of 1 PINION (18 teeth) and 1 GEAR (31 teeth))
	910851	1	KEY, #G woodruff, 3/8" x 1-1/2"
	911190	1	KEY, #T woodruff, 3/8" x 2-3/8"
12	036093	3	SHIM, bearing adjustment (.005" thick. Use as required)
	036094	3	SHIM, bearing adjustment (.010" thick. Use as required)
	036095	4	SHIM, bearing adjustment (.020" thick. Use as required)
13	032358	1	WASHER, pinion retaining
14	013044	2	CAPSCREW, drilled-hd., 3/8"NC x 7/8"
15	023633	1	WIRE, locking, 1/16" x 12"
16	032335	1	CASE, output shaft
17	035236	6	CAPSCREW, 1/2"NC x 1-3/4"
	904208	6	LOCKWASHER, 1/2"
18	032939	12	SHIM, pinion adjustment (.005" thick. Use as required)
	032941	3	SHIM, pinion adjustment (.020" thick. Use as required)
19	035250	2	PLUG, filling and draining
20	035249	2	GASKET, filling and draining plug
21	042659	1	SHAFT, output
22	043004	1	CONE ASSEMBLY, output shaft bearing, inner
23	211567	1	CUP, output shaft bearing, inner
24	032336	1	SPACER, output shaft inner bearing

(Continued)

SPECIAL TOOLS (Continued)

ITEM	PART NO.	QTY.	DESCRIPTION
6	053423	1	WRENCH, open end, double head, 15°, 9/16" and 5/8"
7	050609	1	WRENCH, open end, double head, 15°, 5/8" and 3/4"
8	050610	1	WRENCH, open end, double head, 15°, 3/4" and 7/8"
9	043769	1	WRENCH, drain and filling plugs (90°, 1/2" square)
10	040736	1	WRENCH, track release adjustment (1-7/8" open end)(Early units)
11	095120	1	WRENCH, track release adjustment (2-1/8" open end)(Late units)
12	050612	1	HANDLE, socket, sliding T, 1/2" square drive, 15" long
13	914715	1	SOCKET, 1/2" square drive, 15/16" hex
14	073735	1	GUN, grease (high-pressure, lever type, 17 oz. capacity)
	907059	1	ELBOW, street, 90°, 1/8"NPT (For lubricating fan hub)
15	058937	1	NOZZLE ASSEMBLY, low pressure lubrication (Includes FITTING indented below)
	914767	1	FITTING, lubricating, straight, 1/8"NPT female
16	631352	1	GAUGE, wear (Provides maximum wear tolerances for track rails, grouser shoes, sprockets, idlers and track rollers)
17	043421	1	WRENCH, fan spindle mounting nut (1-7/16" open end)
18	040272	1	WRENCH, grease hole plugs (For early units only)
19	604943	1	BOX, tool
	012992	4	CAPSCREW, 3/8"NF x 1-1/4"
	630753	4	WASHER, plain (heavy)
	911115	4	WASHER, plain, SAE std., 3/8"
	904206	4	LOCKWASHER, 3/8"
	911041	4	NUT, 3/8"NF
20	095548	2	PLATE, box attaching(Early units only)
	012992	2	CAPSCREW, 3/8"NF x 1-1/4"
	044973	2	WASHER, plain
	904206	2	LOCKWASHER, 3/8"
	911041	2	NUT, 3/8"NF
21	912484	1	PADLOCK

NUMERICAL INDEX

Part No.	Page	Part No.	Page	Part No.	Page	Part No.	Page
628226...	233	629188...	561	630787...	169 thru 177	631665...	425
628227...	233	629189...	561	630792...	541, 545, 546	631666...	391, 393
628228...	233	629205...	514	630795...	283 thru 347	631668...	399
628229...	233	629267...	336	630803...	221	631680...	399
628230...	233	629270...	336	630804...	221	631687...	400
628231...	233	629439...	230	630805...	221	631769...	164
628232...	233	629446...	325	630806...	221	631795...	488
628233...	233	629509...	511	630807...	222	631828...	360
628320...	330	629533...	229	630808...	221	631835...	399
628342...	229	629645...	297	630809...	221	631836...	399
628343...	229	629646...	297	630827...	169 thru 177	631861...	399
628344...	229	629647...	297	630828...	169 thru 177	631862...	399
628345...	229	629697...	438	630829...	169	631863...	399
628346...	229	629716...	343, 347	630830...	169 thru 177	631864...	399
628348...	229	629721...	227	630833...	348	631869...	360
628350...	229	629733...	396, 399	630836...	125	631870...	360
628351...	229	629967...	514	630846...	348	631872...	360
628354...	230	629968...	219	630847...	343, 347	631883...	371, 379
628355...	230	629972...	219	630848...	343, 347	631927...	69, 71
628356...	230	629973...	219	630914...	351, 357	631935...	362
628357...	230	630023...	254	630917...	565, 566	631975...	125
628358...	230	630029...	253	630947...	325	631981...	379
628359...	230	630030...	245, 250	631039...	373	631989...	13
628361...	230	630033...	243, 247	631078...	223	631990...	13
628362...	230	630035...	245	631110...	99	631991...	14
628363...	230	630040...	241	631184...	326	631992...	14
628364...	230	630045...	317, 330	631185...	326	631993...	13
628365...	230	630046...	245	631186...	381	631994...	13
628366...	230	630050...	237	631198...	169 thru 177	632053...	503
628367...	229	630052...	330	631199...	169 thru 177	632060...	360
628368...	239	630059...	250	631224...	169 thru 177	632061...	360
628406...	379	630061...	265	631225...	169 thru 177	632062...	360
628458...	361	630063...	265	631226...	169 thru 177	632063...	360
628468...	251	630076...	239	631235...	373	632071...	371
628478...	230	630096...	243, 249	631285...	245, 249	632072...	242
628479...	230	630102...	323, 325	631289...	227	632074...	243
628503...	230	630148...	561	631293...	512	632075...	399
628509...	230	630169...	241	631298...	373	632076...	399
628510...	230	630175...	225, 227	631300...	317	632082...	237
628511...	230	630189...	319	631305...	317	632115...	13
628512...	32	630190...	319, 321	631316...	330	632116...	14
628515...	230	630216...	243	631329...	313	632146...	164
628516...	230	630231...	482	631331...	374	632147...	164
628518...	229	630280...	87	631342...	429	632148...	164
628519...	229	630290...	262	631352...	605, 607	632164...	197
628520...	229	630301...	357	631355...	253	632175...	283
628567...	230	630407...	243	631356...	254	632179...	503
628568...	229	630427...	361	631357...	254	632183...	511
628569...	229	630437...	242	631358...	254	632188...	503
628570...	229	630446...	241	631359...	253	632226...	513
628571...	225, 227, 229	630485...	292	631386...	317	632282...	283
628572...	229	630486...	292	631418...	268	632284...	503
628721...	225	630493...	241	631426...	573, 577	632389...	512
628730...	371	630494...	245	631476...	126, 129, 131	632390...	513
628736...	120 thru 347	630498...	241	631477...	137	632437...	403, 406, 409
628737...	120, 126, 133	630499...	292	631496...	126	632438...	403, 406, 409
628738...	120 thru 137	630508...	237	631498...	129, 131	632471...	200
628748...	292	630510...	241	631510...	317	632488...	403, 406, 409
628821...	245	630521...	241	631545...	317	632499...	341
628823...	269	630522...	471	631555...	137	632523...	403, 407, 409
628915...	427	630528...	362	631561...	373	632524...	403, 407, 409
628933...	427	630540...	74	631562...	373	632544...	341
628934...	427	630543...	299, 309	631564...	159 thru 164	632650...	157
628940...	330	630544...	299, 311	631566...	169 thru 177	632666...	381
628951...	325	630545...	299	631575...	317	632691...	403, 406, 409
629040...	270 thru 588	630564...	342, 345	631576...	313	632710...	125
629041...	270	630574...	341	631577...	331	632716...	125
629048...	336	630591...	256	631584...	330	632719...	237
629049...	263	630592...	341	631587...	313	632747...	125
629064...	200	630594...	282, 285	631588...	313	632752...	125
629067...	200	630626...	565	631601...	579	632756...	126
629068...	200	630636...	357	631602...	579	632766...	125, 292
629069...	200	630686...	511	631610...	579	632769...	404 thru 409
629139...	464	630713...	173, 176, 179	631617...	412, 415	632774...	292
629140...	464	630752...	393	631639...	565	632787...	409
629141...	32	630753...	605, 607	631646...	129	632923...	406
629183...	245, 249	630785...	569	631651...	125	632924...	406

CLICK HERE TO **DOWNLOAD** THE COMPLETE MANUAL

- Thank you very much for reading the preview of the manual.
- You can download the complete manual from: [www.heydownloads.com](http://www.heydownloads.com) by clicking the link below



- Please note: If there is no response to CLICKING the link, please download this PDF first and then click on it.

CLICK HERE TO **DOWNLOAD** THE COMPLETE MANUAL