



**GENUINE PARTS CATALOGUE
CATALOGUE PIECES D'ORIGINE
ORIGINAL ERSATZTEILKATALOG
CATALOGO DE PIEZAS LEGITIMAS
CATALOGO RICAMBI ORIGINALI**

This document has been printed from  myedoc

MANITOU BF

Head office: 430, Rue de l'Aubinière
44150 Ancenis - FRANCE
Share capital: 39,548,949 euros
857 802 508 RCS Nantes
Tel: +33 (0)2 40 09 10 11
www.manitou.com

CLICK HERE TO **DOWNLOAD** THE COMPLETE MANUAL

- Thank you very much for reading the preview of the manual.
- You can download the complete manual from: www.heydownloads.com by clicking the link below



- Please note: If there is no response to CLICKING the link, please download this PDF first and then click on it.

CLICK HERE TO **DOWNLOAD** THE COMPLETE MANUAL

Позиция	№ детали	Название	К-во	SupersededPartNumber	Product Type
0	571588	Double mast	1		MAT 2,5 T, MAT 2 T
0	571589	Double mast	1		MAT 2,5 T, MAT 2 T
0	571590	Double mast	1		MAT 2,5 T, MAT 2 T
0	571591	Double mast	1	571591ACC, 571573	MAT 2,5 T, MAT 2 T
0	571592	Double mast	1	571592ACC, 571574	MAT 2,5 T, MAT 2 T
0	571593	Double mast	1		MAT 2,5 T, MAT 2 T
0	571594	Double mast	1		MAT 2,5 T, MAT 2 T
0	571595	Double mast	1		MAT 2,5 T, MAT 2 T
0	571596	Double mast	1		MAT 2,5 T, MAT 2 T
0	653743	Double mast	1		MAT 2,5 T, MAT 2 T
1	230935	Outer channel	1		MAT 2,5 T, MAT 2 T
1	230936	Outer channel	1		MAT 2,5 T, MAT 2 T
1	230937	Outer channel	1		MAT 2,5 T, MAT 2 T
1	230938	Outer channel	1		MAT 2,5 T, MAT 2 T
1	230939	Outer channel	1		MAT 2,5 T, MAT 2 T
1	230940	Outer channel	1		MAT 2,5 T, MAT 2 T
1	230941	Outer channel	1		MAT 2,5 T, MAT 2 T
1	230942	Outer channel	1		MAT 2,5 T, MAT 2 T
1	230943	Outer channel	1		MAT 2,5 T, MAT 2 T
1	242957	Outer channel	1		MAT 2,5 T, MAT 2 T
2	588592	Shim	1	U612332074071, 612332074071	MAT 2,5 T, MAT 2 T
2	171605	Shim	1	612342074071, 612342200071, U612342074071, 612342054071	MAT 2,5 T, MAT 2 T
3	613562360071	Friction lining side	2		MAT 2,5 T, MAT 2 T
4	61171F203071	Roller axle (To weld)	2		MAT 2,5 T, MAT 2 T
5	178580	Washer	1	612372074071, 612372054071	MAT 2,5 T, MAT 2 T
5	178579	Washer	1	612382074071, 612382054071	MAT 2,5 T, MAT 2 T
6	588437	Roller	1	612362360171, 612362360071, 61236F203071	MAT 2,5 T, MAT 2 T
6	61239F203071	Roller	1		MAT 2,5 T, MAT 2 T
11	180392	Articulating pin	2		MAT 2,5 T, MAT 2 T
12	5135	Straight greaser	2		MAT 2,5 T, MAT 2 T
13	2637	Circlip	4		MAT 2,5 T, MAT 2 T
14	181490	Washer	1		MAT 2,5 T, MAT 2 T
14	181491	Washer	1		MAT 2,5 T, MAT 2 T
15	219280	Stop plate	2		MAT 2,5 T, MAT 2 T
16	183970	Stop plate	2		MAT 2,5 T, MAT 2 T

Позиция	№ детали	Название	К-во	SupersededPartNumber	Product Type
73	204382	Lever	2		MAT 3,5 T, MAT 3 T
74	231076	Forks carrier, stripped (Length 1470 mm)	1		MAT 3,5 T, MAT 3 T
75	231077	Forks carrier, stripped (Length 1580 mm)	1		MAT 3,5 T, MAT 3 T
76	578097	Fork	2	415449, 415614	MAT 3,5 T, MAT 3 T
77	415566	Fork	2		MAT 3,5 T

DOUBLE MAST 2,70m/3,00m à / bis / a / to / a 6,00m

10 AD 141

KIT HYDRAULIQUE ACCESSOIRE 3^{ème} ELEMENT (Double effet)
 KIT 3er ELEMENT ZUBEHÖR HYDRAULIK (Doppeltwirkend)
 KIT HIDRAULICO ACCESSORIO 3ro ELEMENTO (Doble efecto)
 3rd ELEMENT ATTACHMENT HYDRAULIC KIT (Double-acting)
 KIT IDRAULICO ACCESSORIO 3 ELEMENTO (Doppio effetto)

MSI 20/25/30 D S2-E2 - MSI 20/25/30 D BUGGIE S2-E2
 MSI 20/25/30 T S2-E3 / S3-E3
 MSI 20/25/30 T BUGGIE S2-E3 / S3-E3
 MSI 20/25/30 G S2-E - MSI 20/25/30 G BUGGIE S2-E
 MH 20/25-4 T BUGGIE S2-E2 / S2-E3 / S3-E3
 MSI 35 T S2-E2/S2-E3/S3-E3
 MSI 35 T BUGGIE S2-E2/S2-E3/S3-E3
 MSI 20/25/30 T S1-E2 - MSI 20/25/30 T BUGGIE S1-E2
 MSI 25/30/35 T 4ST3A - MH 25-4 T BUGGIE 4ST3A

- SEULEMENT POUR - NUR FÜR
 SOLAMENTE PARA - ONLY FOR - SOLO PER
 □ 2,70m à / bis / a / to 3,70m
- SEULEMENT POUR - NUR FÜR
 SOLAMENTE PARA - ONLY FOR - SOLO PER
 □ 4,00m à / bis / a / to 6,00m

- 2,70 m 56
- 3,00 m 50
- 3,30 m 51
- 3,50 m 52
- 3,70 m 53
- 4,00 m 54
- 4,50 m 55
- 5,00 m 70
- 5,50 m 71
- 6,00 m 72

- SEULEMENT POUR - NUR FÜR
 SOLAMENTE PARA - ONLY FOR - SOLO PER
 □ MH..
- SAUF POUR - NICHT FÜR
 EXCEPTO PARA - EXCEPT FOR- TRANNE PER
 □ MH..

- △ SAUF POUR - NICHT FÜR
 EXCEPTO PARA - EXCEPT FOR- TRANNE PER
 □ MSI 35 T S2-E2 / S2-E3 / S3-E3 / 4ST3A
 □ MSI 35 T BUGGIE S2-E2 / S2-E3 / S3-E3

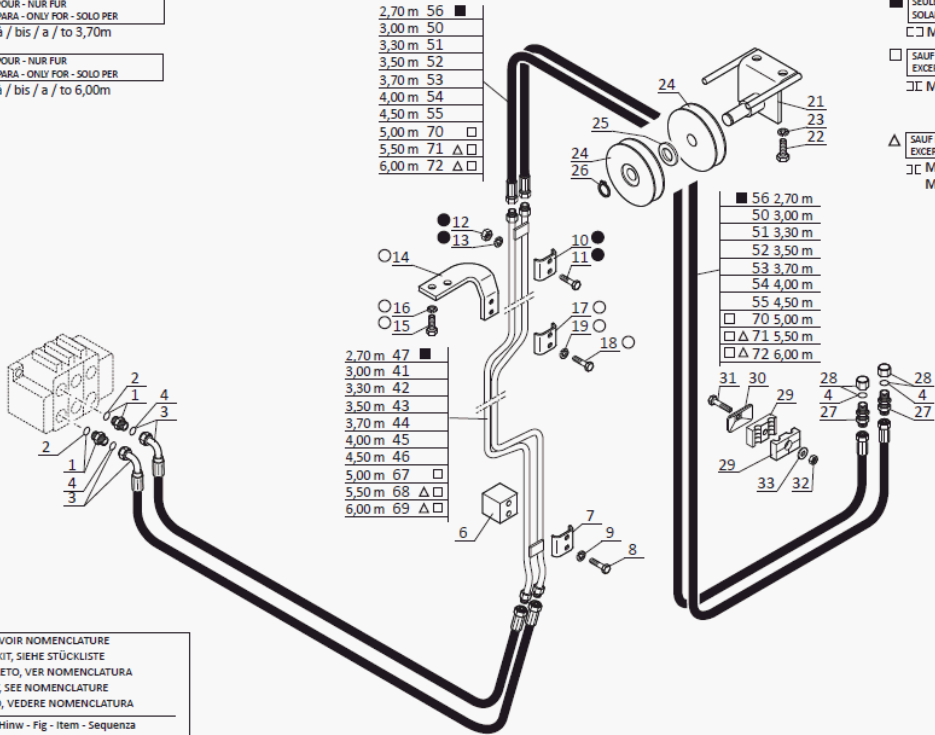

- 2,70 m 47
- 3,00 m 41
- 3,30 m 42
- 3,50 m 43
- 3,70 m 44
- 4,00 m 45
- 4,50 m 46
- 5,00 m 67
- 5,50 m 68
- 6,00 m 69

- 56 2,70 m
- 50 3,00 m
- 51 3,30 m
- 52 3,50 m
- 53 3,70 m
- 54 4,00 m
- 55 4,50 m
- 70 5,00 m
- 71 5,50 m
- 72 6,00 m

- 31 30
- 29 4
- 28 4
- 27 4
- 33 32

KIT COMPLET, VOIR NOMENCLATURE
 KOMPLETTER KIT, SIEHE STÜCKLISTE
 JUEGO COMPLETO, VER NOMENCLATURA
 COMPLETE KIT, SEE NOMENCLATURE
 KIT COMPLETO, VEDERE NOMENCLATURA

Rep - Hinw - Fig - Item - Sequenza
 60-61-62-63-64-65-66-73-74-75
 ■ □ △

POUR FLEXIBLE ET RACCORD
 FÜR SCHLAUCH UND VERSCHRAUBUNG
 PARA FLEXIBLE Y RACOR
 FOR HOSE AND CONNECTION
 PER FLESSIBILE E RACCORDO

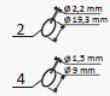

Позиция	№ детали	Название	К-во	SupersededPartNumber	Product Type
29	169436	"0" ring	1		MAT 2,5 T, MAT 3,5 T, MAT 3 T, MAT 2 T
30	266089	Quick male union	2	192038	MAT 2,5 T, MAT 3,5 T, MAT 3 T, MAT 2 T
31	192039	Plug	2		MAT 2,5 T, MAT 3,5 T, MAT 3 T, MAT 2 T
32	192040	BRACKET	2		MAT 2,5 T, MAT 3,5 T, MAT 3 T, MAT 2 T
33	26957	Screw	2	706942, 479153, 40601, Q20276	MAT 2,5 T, MAT 3,5 T, MAT 3 T, MAT 2 T
34	58528	Nut	2	9411040800, 132110, 42049, 704888, 132459, 41632, D3316466, 482310, 448741, 554197, 551157, 801707600771, A503511VZ, 418752, 774, 900894100571, 2162104MI, T4008000, 94110F080071, 581840, 602108, 106175, 455185, 131598, A4109166A, D1122477, 55691F212071, A7218467A, A7274633A, 506859, 841107600171, T3008000, 127308, 475803, 503511VZ, 2431, 418747, 133088, 137520, 2762081MI, X6030195, 132075, 9017508003, 820097	MAT 2,5 T, MAT 3,5 T, MAT 3 T, MAT 2 T
35	42325	Washer	2	561561, 448285, 484829, 749854, 744649, A7374634A, A503710VZ, 420461, 824136, 506965, 824126, 745826, 550425, 550964, 573083, 138167, Q22528, 506283, K506283, 479336, A503710, 820098	MAT 2,5 T, MAT 3,5 T, MAT 3 T, MAT 2 T
36	168758	Half-clamp	2		MAT 2,5 T, MAT 3,5 T, MAT 3 T, MAT 2 T
37	168494	Protection plate	1		MAT 2,5 T, MAT 3,5 T, MAT 3 T, MAT 2 T
38	58531	Screw	1		MAT 2,5 T, MAT 3,5 T, MAT 3 T, MAT 2 T

Позиция	№ детали	Название	К-во	SupersededPartNumber	Product Type
27	563091	Bushing	1		MAT 2,5 T, MAT 2 T
28	563091	Bushing	1		MAT 2,5 T, MAT 2 T
29	242962	Lifting cylinder	1		MAT 2,5 T, MAT 2 T

DOUBLE MAST 2,70m/3,00m à / bis / a / to / a 6,00m

12 AA 332

ABAQUE DE CHARGE (MAT DOUBLE)
 BELASTUNG TABELLE
 ABACO DE CARGA
 LOAD CHART
 DIAGRAMMA DI CARICO

MSI 30 D S2-E2 - MSI 30 D BUGGIE S2-E2
 MSI 30 T S2-E3 / S3-E3 - MSI 30 T BUGGIE S2-E3 / S3-E3
 MSI 30 G S2-E - MSI 30 G BUGGIE S2-E
 MSI 35 T S2-E2 - MSI 35 T BUGGIE S2-E2
 MSI 35 T S2-E3 / S3-E3 - MSI 35 T BUGGIE S2-E3 / S3-E3
 MSI 30 T S1-E2 - MSI 30 T BUGGIE S1-E2
 MSI 30 / 35 T 4ST3A

Seulement pour enveloppe - Nur für Reifen - Solamente para neumático
 Only for tyre - Solamente per pneumatico

- GOOD YEAR : 275/70 R22.5 RHS (X : 1323 mm)
- CONTINENTAL : 8 - 25 - 20 - CSE SC15 (X : 1310 mm)
- CONTINENTAL : 10.5 R20 14PR MPT 80 134G (X : 1322 mm)
- MICHELIN : 285/70 R19.5 XZY 140/137 L (X : 1412 mm)
- DUNLOP : 12.0 x 18 12PR T86 (X : 1423 mm) (Sauf 3,5T)
- DUNLOP : 15.5/55 R18 SPPG7 14PR (X : 1540 mm)
- DUNLOP : 15.5/55 R18 SPPG7 14PR (X : 1650 mm)

Seulement pour enveloppe - Nur für Reifen - Solamente para neumático
 Only for tyre - Solamente per pneumatico

- GOOD YEAR : 275/70 R22.5 RHS (X : 1523 mm)
- CONTINENTAL : 10.5 R20 14PR MPT 80 134G (X : 1522 mm)

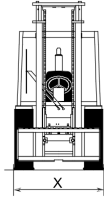

- 1 (3,00 m)
- 2 (3,30 m)
- 3 (3,50 m)
- 4 (3,70 m)
- 5 (4,00 m)
- 6 (4,50 m)
- 37 (4,50 m)
- 7 (5,00 m)
- 8 (5,50 m)
- 38 (5,00 m)
- 9 (6,00 m)

- 10 (3,00 m)
- 11 (3,30 m)
- 12 (3,50 m)
- 13 (3,70 m)
- 14 (4,00 m)
- 15 (4,50 m)
- 39 (4,50 m)
- 16 (5,00 m)
- 40 (5,00 m)

- 19 (3,00 m)
- 20 (3,30 m)
- 21 (3,50 m)
- 22 (3,70 m)
- 23 (4,00 m)
- 24 (4,50 m)
- 25 (5,00 m)
- 35 (4,50 m)
- 36 (5,00 m)

- 28 (3,00 m)
- 29 (3,30 m)
- 30 (3,50 m)
- 31 (3,70 m)
- 32 (4,00 m)
- 33 (4,50 m)
- 34 (5,00 m)
- 41 (4,50 m)
- 42 (5,00 m)

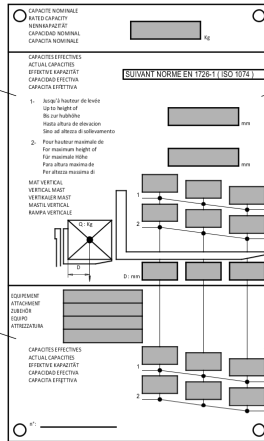

- SAUF POUR - NICHT FÜR
EXCEPTO PARA - EXCEPT FOR- TRAINE PER
- ☐ CONTINENTAL : 10.5 R20 14PR MPT 80 134G (X : 1322 mm)
- SEULEMENT POUR - NUR FÜR
SOLAMENTE PARA - ONLY FOR - SOLO PER
- ☐ CONTINENTAL : 10.5 R20 14PR MPT 80 134G (X : 1322 mm)



Позиция	№ детали	Название	К-во	SupersededPartNumber	Product Type
77	178580	Washer	1	612372074071, 612372054071	MAT 2,5 T, MAT 3,5 T, MAT 3 T, MAT 2 T
77	178579	Washer	1	612382074071, 612382054071	MAT 2,5 T, MAT 3,5 T, MAT 3 T, MAT 2 T
78	63371F203071	Roller axle (To weld)	4		MAT 2,5 T, MAT 3,5 T, MAT 3 T, MAT 2 T
79	588437	Roller	1	612362360171, 612362360071, 61236F203071	MAT 2,5 T, MAT 3,5 T, MAT 3 T, MAT 2 T
79	588465	Roller	1	63381F203071, 633812360171	MAT 2,5 T, MAT 3,5 T, MAT 3 T, MAT 2 T
80	7519	Circlip	4		MAT 3,5 T, MAT 3 T
81	588437	Roller	1	612362360171, 612362360071, 61236F203071	MAT 2,5 T, MAT 3,5 T, MAT 3 T, MAT 2 T
81	588459	Roller	1	61238F203071	MAT 2,5 T, MAT 3,5 T, MAT 3 T, MAT 2 T
81	61239F203071	Roller	1		MAT 2,5 T, MAT 3,5 T, MAT 3 T, MAT 2 T
82	588658	Roller axle	2	63374F204071	MAT 2,5 T, MAT 2 T
82	588960	Roller axle (To weld)	2	63374F304071	MAT 3,5 T, MAT 3 T
83	588447	Roller	2	764511011171, 764511011071, 63451F204071, 764511074071	MAT 2,5 T, MAT 2 T
83	588446	Roller	2	63451F303071, 764513017071	MAT 3,5 T, MAT 3 T
84	37500	Circlip	4	133033	MAT 2,5 T, MAT 3,5 T, MAT 3 T, MAT 2 T
85	61957	Screw	4		MAT 2,5 T, MAT 3,5 T, MAT 3 T, MAT 2 T
86	42231	Washer	4		MAT 2,5 T, MAT 3,5 T, MAT 3 T, MAT 2 T
87	588659	Shim	1	633762074071, 633762200071, 666762074071	MAT 2,5 T, MAT 3,5 T, MAT 3 T, MAT 2 T
87	588660	Shim	1	633772074071	MAT 2,5 T, MAT 3,5 T, MAT 3 T, MAT 2 T
88	176716	Screw	2		MAT 2,5 T, MAT 3,5 T, MAT 3 T, MAT 2 T
89	588643	Washer	2	63582F2030, 63582F203071	MAT 2,5 T, MAT 3,5 T, MAT 3 T, MAT 2 T
90	631323280071	Chain tightener	2		MAT 3,5 T, MAT 3 T
91	631313278071	Chain anchor	2		MAT 3,5 T, MAT 3 T
92	631353280071	Chain clip	2		MAT 3,5 T, MAT 3 T
93	90632F706571	Complete chain (65 Link)	2		MAT 3,5 T, MAT 3 T
94	90632F707171	Complete chain (71 Link)	2		MAT 3,5 T, MAT 3 T
95	90632F706571	Complete chain (65 Link)	2		MAT 3,5 T, MAT 3 T
96	90632F706771	Complete chain (67 Link)	2		MAT 3,5 T, MAT 3 T

Позиция	№ детали	Название	К-во	SupersededPartNumber	Product Type
0	571684	Double mast	1		MAT 2,5 T, MAT 2 T
0	571685	Double mast	1		MAT 2,5 T, MAT 2 T
0	571686	Double mast	1		MAT 2,5 T, MAT 2 T
0	571687	Double mast	1		MAT 2,5 T, MAT 2 T
0	571688	Double mast	1		MAT 2,5 T, MAT 2 T
0	571689	Double mast	1		MAT 2,5 T, MAT 2 T
0	571690	Double mast	1		MAT 3,5 T, MAT 3 T
0	571691	Double mast	1		MAT 3,5 T, MAT 3 T
0	571692	Double mast	1		MAT 3,5 T, MAT 3 T
0	571693	Double mast	1		MAT 3,5 T, MAT 3 T
0	571694	Double mast	1		MAT 3,5 T, MAT 3 T
0	571695	Double mast	1		MAT 3,5 T, MAT 3 T
1	588934	Connection	1	90407F250171, 65916F203071	MAT 2,5 T, MAT 2 T
2	125751	"O" ring	1	501225, A003001633, A003001605, 174531, 190015, H570828R1	MAT 2,5 T, MAT 3,5 T, MAT 3 T, MAT 2 T
3	588933	Connection	1	65915F203071, 96421F155571	MAT 3,5 T, MAT 3 T
4	48905	"O" ring	1		MAT 2,5 T, MAT 3,5 T, MAT 3 T, MAT 2 T
6	588856	Connection	2	67623F203071, 96421F093371, 964211093371	MAT 2,5 T, MAT 3,5 T, MAT 3 T, MAT 2 T
7	189956	"O" ring	1	109657, 501224, 125614, 704818, 486087, 107902, 691655, 177743, 676781250071, 474347	MAT 2,5 T, MAT 3,5 T, MAT 3 T, MAT 2 T
8	588665	Hose	1	68211F203071	MAT 2,5 T, MAT 2 T
10	588934	Connection	1	90407F250171, 65916F203071	MAT 2,5 T, MAT 3,5 T, MAT 3 T, MAT 2 T
11	68021F21 2071	Tube	1		MAT 2,5 T, MAT 3,5 T, MAT 3 T, MAT 2 T
12	60360	Screw	2		MAT 2,5 T, MAT 3,5 T, MAT 3 T, MAT 2 T

Позиция	№ детали	Название	К-во	SupersededPartNumber	Product Type
15	42232	Washer	1	133123, 594526, D1119613, 484674, 127343, 83507, 550960, 418731, 94512F100071, 127339, 36103, 506971, 83633, 845117600671, 475456, 473871, 720607, 477934, 542772, 128627, 38845, 479337, 132482, F63805, 448291, 5592, 484802, 138800, 820206, 2766184MI, 133697, T6410000, D1102800, 449520, 9451201000, 130722, 133119, A4104190A, 820052, 87720, 475833041071, 45285, 900894571471, 9451101000, T6610000	MAT 3,5 T, MAT 3 T
16	96287F313571	Hose	1		MAT 3,5 T, MAT 3 T
17	68301F305071	Tube	1		MAT 3,5 T, MAT 3 T
18	68801F205071	Flange	1		MAT 3,5 T, MAT 3 T
19	175826	Screw	2		MAT 3,5 T, MAT 3 T
20	42232	Washer	2	133123, 594526, D1119613, 484674, 127343, 83507, 550960, 418731, 94512F100071, 127339, 36103, 506971, 83633, 845117600671, 475456, 473871, 720607, 477934, 542772, 128627, 38845, 479337, 132482, F63805, 448291, 5592, 484802, 138800, 820206, 2766184MI, 133697, T6410000, D1102800, 449520, 9451201000, 130722, 133119, A4104190A, 820052, 87720, 475833041071, 45285, 900894571471, 9451101000, T6610000	MAT 3,5 T, MAT 3 T
21	68501F305071	Guide	1		MAT 3,5 T, MAT 3 T
22	403357	Screw	2		MAT 3,5 T, MAT 3 T

TRIPLE MAST TOTAL FREE LIFT 3,00m à / bis / a / to / a 4.50m

10 AD 118

KIT HYDRAULIQUE ACCESSOIRE 4ème ELEMENT (Double effet)
 KIT 4er ELEMENT ZUBEHÖR HYDRAULIK (Doppeltwirkend)
 KIT HIDRAULICO ACCESSORIO 4ro ELEMENTO (Doble efecto)
 4th ELEMENT ATTACHEMENT HYDRAULIC KIT (Double-acting)
 KIT IDRAULICO ACCESSORIO 4 ELEMENTO (Doppio effetto)

MSI 30 D S2-E2 - MSI 30 D BUGGIE S2-E2
 MSI 30 T S2-E3 / S3-E3 - MSI 30 T BUGGIE S2-E3 / S3-E3
 MSI 30 G S2-E - MSI 30 G BUGGIE S2-E
 MSI 35 T S2-E2 - MSI 35 T BUGGIE S2-E2
 MSI 35 T S2-E3 / S3-E3 - MSI 35 T BUGGIE S2-E3 / S3-E3
 MSI 30 T S1-E2 - MSI 30 T BUGGIE S1-E2
 MSI 30 / 35 T 4ST3A

KIT COMPLETO, VOR NOMENCLATURE
 NONPLETTER KITSIEHE STÜCKLISTE
 JUEGO COMPLETO, VER NOMENCLATURA
 COMPLETE KIT, SEE NOMENCLATURE
 KIT COMPLETO, VEDERE NOMENCLATURA

Rep - Hinw - Fig - Item - Sequenza
 67 - 68 - 69 - 70 - 71 - 72

POUR FLEXIBLE ET RACCORD
 FÜR SCHLAUCH UND VERSCHRÄUBUNG
 PARA FLEXIBLE Y RACOR
 FOR HOSE AND CONNECTION
 PER FLESSIBILE E RACCORDO

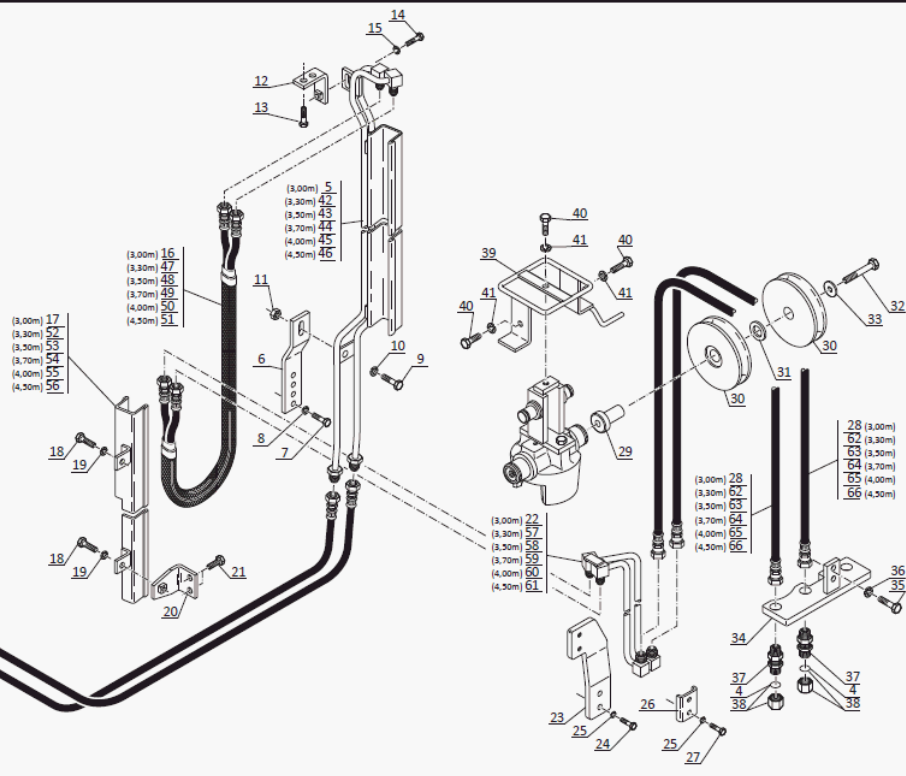

06 / 02 / 04
 P.A.C. - Illust

Позиция	№ детали	Название	К-во	SupersededPartNumber	Product Type
44	29483	Washer	4	50309, 446293, 702260, 820108, 845127600571, 845247600171, 485641, 36100, 418728, 448766, A7374635A, G1823230, W50114407814, 54231, 9451100500, 105556, 455415, 845117600271	MAT 2,5 T, MAT 2 T
45	266090	Quick female union	2	192037	MAT 2,5 T, MAT 2 T
46	167927	Connection	2		MAT 2,5 T, MAT 2 T
47	197233	Connection	2	499386, 405955	MAT 2,5 T, MAT 2 T
48	211373	Hose	1		MAT 2,5 T, MAT 2 T
49	248240	Hose	1	212091	MAT 2,5 T, MAT 2 T
50	217951	Connection	1		MAT 2,5 T, MAT 2 T
51	89813	Connection	1		MAT 2,5 T, MAT 2 T
52	168758	Half-clamp	4		MAT 2,5 T, MAT 2 T
53	168494	Protection plate	2		MAT 2,5 T, MAT 2 T
54	58530	Screw	1		MAT 2,5 T, MAT 2 T
55	61323	Screw	1		MAT 2,5 T, MAT 2 T
56	217788	Connection side shift carriage (Without quick coupling)	1		MAT 2,5 T, MAT 2 T
57	570207AC C	KIT RACCORD C547041P10AF50	1	211591, 570207, 217789	MAT 2,5 T, MAT 2 T
58	570202AC C	KIT BRANCHEMENTC547041P10AF50	1	570202, 217791	MAT 2,5 T, MAT 2 T
59	222982	Sheat	1		MAT 2,5 T, MAT 2 T
60	42347	Screw	2	T2108020, 133168, D1112322, 562678, 473919, 21968, 448667, 502413VZ, A7018093A, 811117605471, 29442, 9161160818, D1112324, 2821121MI, 137036, 505186, Q21935, 9111150820, 2821727MI, A502413, 127192, 484109, 132502, 482307, 132028, 816117603371, 816117603271, 132429, 911115082071, A502413VZ, 448677, 573078, 745469, 2830009MI, 820132, A7074632A	MAT 2,5 T, MAT 2 T

TRIPLE MAST TOTAL FREE LIFT 3,00m à / bis / a / to / a 4.50m

10 AF 278

KIT HYDRAULIQUE ACCESSOIRE 4ème ELEMENT (Double effet)
 KIT 4tr ELEMENT ZUBEHOR HYDRAULIK (Doppeltwirkend)
 KIT HIDRAULICO ACCESSORIO 4to ELEMENTO (Doble efecto)
 4th ELEMENT ATTACHMENT HYDRAULIC KIT (Double-acting)
 KIT IDRAULICO ACCESSORIO 4 ELEMENTO (Doppio effetto)

MSI 20/25/30 D S2-E2 - MSI 20/25/30 D BUGGIE S2-E2
 MSI 20/25/30 T S2-E3 / S3-E3
 MSI 20/25/30 T BUGGIE S2-E3 / S3-E3
 MSI 20/25/30 G S2-E - MSI 20/25/30 G BUGGIE S2-E
 MH 20/25-4 T BUGGIE S2-E2 / S2-E3 / S3-E3
 MSI 35 T S2-E2/S2-E3/S3-E3
 MSI 35 T BUGGIE S2-E2/S2-E3/S3-E3
 MSI 20/25/30 T S1-E2 - MSI 20/25/30 T BUGGIE S1-E2
 MSI 25/30/35 T 4ST3A - MH 25-4 T BUGGIE 4ST3A

POUR FLEXIBLE ET RACCORD
 FÜR SCHLAUCH UND VERSCHRAUBUNG
 PARA FLEXIBLE Y RACOR
 FOR HOSE AND CONNECTION
 PER FLESSIBILE E RACCORDO

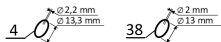

POUR TUBE - FÜR ROHR
 PARA TUBO - FOR TUBE
 PER TUBO

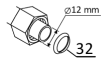

● 1er MONTAGE
 1ste MONTAGE
 1ro MONTAJE
 1st MOUNTING
 1mo MONTAGGIO

○ 2ème MONTAGE
 2te MONTAGE
 2do MONTAJE
 2nd MOUNTING
 2do MONTAGGIO

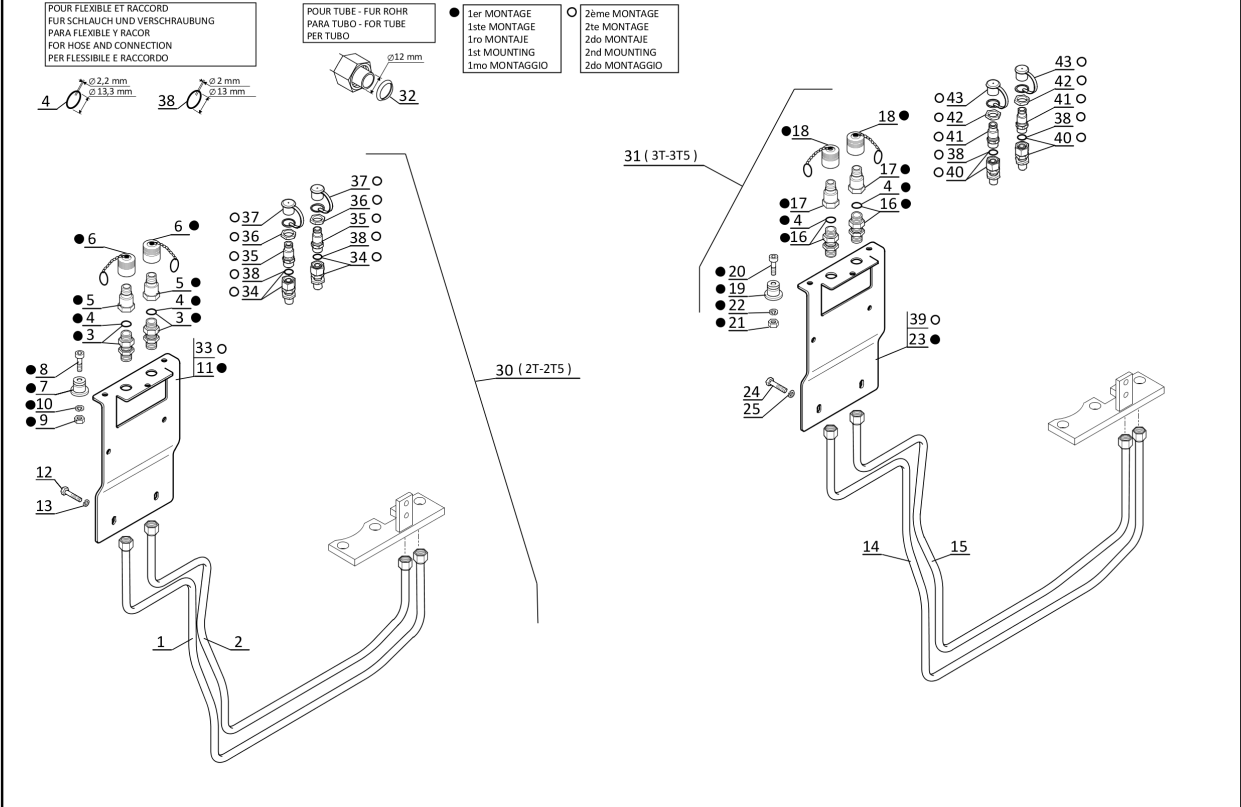

P.A.O. illus
 26 / 11 / 07

Позиция	№ детали	Название	К-во	SupersededPartNumber	Product Type
26	65705F20 5071	Cylinder rod	1		MAT 2,5 T, MAT 2 T
27	564576	Cylinder rod	1		MAT 2,5 T, MAT 2 T
28	65707F20 5071	Cylinder rod	1		MAT 2,5 T, MAT 2 T
29	564575	Cylinder rod	1		MAT 2,5 T, MAT 2 T
30	603989	Cylinder rod	1		MAT 2,5 T, MAT 2 T
31	563096	Seal kit	1		MAT 2,5 T, MAT 2 T
32	561591	Ball	2	564222	MAT 2,5 T, MAT 2 T

CLICK HERE TO **DOWNLOAD** THE COMPLETE MANUAL

- Thank you very much for reading the preview of the manual.
- You can download the complete manual from: www.heydownloads.com by clicking the link below



- Please note: If there is no response to CLICKING the link, please download this PDF first and then click on it.

CLICK HERE TO **DOWNLOAD** THE COMPLETE MANUAL

TRIPLE MAST TOTAL FREE LIFT 3,00m à / bis / a / to / a 4.50m

12 AA 399

ABAQUE DE CHARGE (MAT DOUBLE L.L)
 BELASTUNG TABELLE
 ABACO DE CARGA
 LOAD CHART
 DIAGRAMMA DI CARICO

MSI 20/25 D S2-E2 - MSI 20/25 D BUGGIE S2-E2
 MSI 20/25 T S1-E2 / S2-E3 / S3-E3
 MSI 20/25 T BUGGIE S1-E2 / S2-E3 / S3-E3
 MSI 20/25 G S2-E - MSI 20/25 G BUGGIE S2-E
 MSI 25 T 4ST3A

Seulement pour enveloppe - Nur für Reifen - Solamente para pneumatico
 Only for tyre - Solamente per pneumatico

- GOOD YEAR : 275/70 R22.5 RHS (X : 1323 mm)
- CONTINENTAL : 8 - 25 - 20 - CSE SC15 (X : 1310 mm)
- CONTINENTAL : 10.5 R20 14PR MPT 80 134G (X : 1322 mm)
- MICHELIN : 275/80 R20 XM27 (X : 1336 mm)
- MICHELIN : 285/70 R19.5 XZY 140/137 L (X : 1412 mm)
- DUNLOP : 12.0 x 18 12PR T86 (X : 1423 mm)
- DUNLOP : 15.5/55 R18 SPPG7 14PR (X : 1540 mm)
- DUNLOP : 15.5/55 R18 SPPG7 14PR (X : 1650 mm)

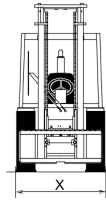

Seulement pour enveloppe - Nur für Reifen - Solamente para pneumatico
 Only for tyre - Solamente per pneumatico

- GOOD YEAR : 275/70 R22.5 RHS (X : 1523 mm)
- CONTINENTAL : 10.5 R20 14PR MPT 80 134G (X : 1522 mm)

- 2T | 2 (3,00 m)
- 3 (3,30 m)
- 4 (3,50 m)
- 5 (3,70 m)
- 6 (4,00 m)
- 7 (4,50 m)

- 2T5 | 12 (3,00 m)
- 13 (3,30 m)
- 14 (3,50 m)
- 15 (3,70 m)
- 16 (4,00 m)
- 17 (4,50 m)

- 2T | 22 (3,00 m)
- 23 (3,30 m)
- 24 (3,50 m)
- 25 (3,70 m)
- 26 (4,00 m)
- 27 (4,50 m)

- 2T5 | 32 (3,00 m)
- 33 (3,30 m)
- 34 (3,50 m)
- 35 (3,70 m)
- 36 (4,00 m)
- 37 (4,50 m)

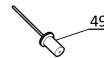
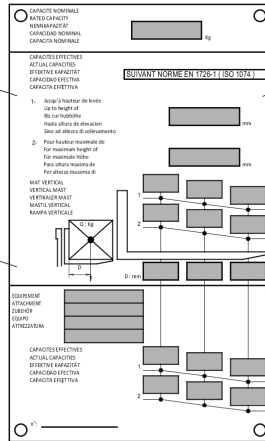

Позиция	№ детали	Название	К-во	SupersededPartNumber	Product Type
18	65051234 5071	Clamp	2		MAT 2,5 T, MAT 2 T
19	588639	Shim	1	654572300071, 654572072071, 65457F203071	MAT 2,5 T, MAT 2 T
19	588640	Shim	1	65458F203071	MAT 2,5 T, MAT 2 T
19	588641	Shim	1	65459F203071	MAT 2,5 T, MAT 2 T
20	588595	Fastening plate	2	654532300071, 654532072071	MAT 2,5 T, MAT 2 T
22	65454233 2071	Anti-vibration plate	2		MAT 2,5 T, MAT 2 T
23	65452234 5071	Clamp	2		MAT 2,5 T, MAT 2 T
24	81672760 0471	Screw	4	9167281045, 816517604771	MAT 2,5 T, MAT 2 T
26	81552760 0571	Screw + Washer	2	9155281012, 816117606371, 816117606271	MAT 2,5 T, MAT 2 T
27	67657132 0071	Washer	2		MAT 2,5 T, MAT 2 T
28	89114	Nut	6	820172, 9017016182, 94115F160071, 1001701TOY, 824734, E763046, 900894102071, 747028, 9411551600, 901701600171	MAT 2,5 T, MAT 2 T
33	63122227 7071	Chain tightener	2		MAT 2,5 T, MAT 2 T
34	63125234 5071	Chain clip	4		MAT 2,5 T, MAT 2 T
35	63126234 5071	Inner plate	4		MAT 2,5 T, MAT 2 T
36	662341	Chain clip	4	631272345071	MAT 2,5 T, MAT 2 T
37	85381760 4871	Pin	4	631282345071, 9538102040	MAT 2,5 T, MAT 2 T
38	63121227 8071	Chain anchor	2		MAT 2,5 T, MAT 2 T
39	62011F21 1071	Intermediate channel	1		MAT 2,5 T, MAT 2 T
39	62101F21 1071	Intermediate channel	1		MAT 2,5 T, MAT 2 T
39	62102F21 1071	Intermediate channel	1		MAT 2,5 T, MAT 2 T
39	62103F21 1071	Intermediate channel	1		MAT 2,5 T, MAT 2 T
39	62105F21 1071	Intermediate channel	1		MAT 2,5 T, MAT 2 T
39	62106F21 1071	Intermediate channel	1		MAT 2,5 T, MAT 2 T
39	62107F21 1071	Intermediate channel	1		MAT 2,5 T, MAT 2 T
39	62108F21 1071	Intermediate channel	1		MAT 2,5 T, MAT 2 T
39	62109F21 1071	Intermediate channel	1		MAT 2,5 T, MAT 2 T

Позиция	№ детали	Название	К-во	SupersededPartNumber	Product Type
40	588592	Shim	1	U612332074071, 612332074071	MAT 3,5 T, MAT 3 T
40	171605	Shim	1	612342074071, 612342200071, U612342074071, 612342054071	MAT 3,5 T, MAT 3 T
41	613562360071	Friction lining side	2		MAT 3,5 T, MAT 3 T
42	631313331071	Chain roller	2		MAT 3,5 T, MAT 3 T
43	7519	Circlip	2		MAT 3,5 T, MAT 3 T
44	61171F203071	Roller axle (To weld)	2		MAT 3,5 T, MAT 3 T
45	588437	Roller	1	612362360171, 612362360071, 61236F203071	MAT 3,5 T, MAT 3 T
45	588459	Roller	1	61238F203071	MAT 3,5 T, MAT 3 T
45	61239F203071	Roller	1		MAT 3,5 T, MAT 3 T
46	178580	Washer	1	612372074071, 612372054071	MAT 3,5 T, MAT 3 T
46	178579	Washer	1	612382074071, 612382054071	MAT 3,5 T, MAT 3 T
47	588644	Washer	1	651551418071, 651551074071	MAT 3,5 T, MAT 3 T
47	588645	Shim	1	651561418071, 651561074071	MAT 3,5 T, MAT 3 T
48	179777	Nut	2		MAT 3,5 T, MAT 3 T
49	901051200671	Screw	2		MAT 3,5 T, MAT 3 T
50	231120	Outer channel	1		MAT 3,5 T, MAT 3 T
50	231121	Outer channel	1		MAT 3,5 T, MAT 3 T
50	231122	Outer channel	1		MAT 3,5 T, MAT 3 T
50	231123	Outer channel	1		MAT 3,5 T, MAT 3 T
50	231124	Outer channel	1		MAT 3,5 T, MAT 3 T
50	231125	Outer channel	1		MAT 3,5 T, MAT 3 T
50	231126	Outer channel	1		MAT 3,5 T, MAT 3 T
50	231127	Outer channel	1		MAT 3,5 T, MAT 3 T
50	231128	Outer channel	1		MAT 3,5 T, MAT 3 T
51	61171F203071	Roller axle (To weld)	2		MAT 3,5 T, MAT 3 T
52	588437	Roller	1	612362360171, 612362360071, 61236F203071	MAT 3,5 T, MAT 3 T
52	588459	Roller	1	61238F203071	MAT 3,5 T, MAT 3 T
52	61239F203071	Roller	1		MAT 3,5 T, MAT 3 T
53	178580	Washer	1	612372074071, 612372054071	MAT 3,5 T, MAT 3 T
53	178579	Washer	1	612382074071, 612382054071	MAT 3,5 T, MAT 3 T
54	588655	Plate	1	61575F204071	MAT 3,5 T, MAT 3 T

Позиция	№ детали	Название	К-во	SupersededPartNumber	Product Type
0	571644	Triple mast	1		MAT 2,5 T, MAT 2 T
0	571645	Triple mast	1		MAT 2,5 T, MAT 2 T
0	571628	Complete triple mast	1	571646, 571628ACC, 556049, 555959	MAT 2,5 T, MAT 2 T
0	571647	Triple mast	1		MAT 2,5 T, MAT 2 T
0	571648	Triple mast	1		MAT 2,5 T, MAT 2 T
0	571649	Triple mast	1		MAT 2,5 T, MAT 2 T
0	571650	Triple mast	1		MAT 2,5 T, MAT 2 T
0	571651	Triple mast	1		MAT 2,5 T, MAT 2 T
0	571652	Triple mast	1		MAT 2,5 T, MAT 2 T
1	68410F310071	Regulator	1		MAT 2,5 T, MAT 2 T
2	588595	Fastening plate	1	654532300071, 654532072071	MAT 2,5 T, MAT 2 T
3	9155281045	Screw	2		MAT 2,5 T, MAT 2 T
5	231110	Tube	1		MAT 2,5 T, MAT 2 T
6	588897	Connection	1	90407F190171	MAT 2,5 T, MAT 2 T
7	125751	"0" ring	1	501225, A003001633, A003001605, 174531, 190015, H570828R1	MAT 2,5 T, MAT 2 T
8	68211F204071	Hose	1		MAT 2,5 T, MAT 2 T
11	203309	Hose	2	90640F215071, 244468, 234363, 234362, 241817, 246522, 233769, 90640F210571, 90643F420071, 90640F214571, 90640F212571, 90640F216571, 213112, 242434, 220509, 203308, 203306, 203307, 209436, 203157, 203155, 203156, 203153, 90640F211571, 203154, 90640F211871, 234369, 90640F215571, 234368, 90640F213071	MAT 2,5 T, MAT 2 T

Позиция	№ детали	Название	К-во	SupersededPartNumber	Product Type
11	203309	Hose	2	90640F215071, 244468, 234363, 234362, 241817, 246522, 233769, 90640F210571, 90643F420071, 90640F214571, 90640F212571, 90640F216571, 213112, 242434, 220509, 203308, 203306, 203307, 209436, 203157, 203155, 203156, 203153, 90640F211571, 203154, 90640F211871, 234369, 90640F215571, 234368, 90640F213071	MAT 3,5 T, MAT 3 T
11	203309	Hose	2	90640F215071, 244468, 234363, 234362, 241817, 246522, 233769, 90640F210571, 90643F420071, 90640F214571, 90640F212571, 90640F216571, 213112, 242434, 220509, 203308, 203306, 203307, 209436, 203157, 203155, 203156, 203153, 90640F211571, 203154, 90640F211871, 234369, 90640F215571, 234368, 90640F213071	MAT 3,5 T, MAT 3 T
12	68199236 0071	Return pipe	1		MAT 3,5 T, MAT 3 T
13	209531	Bracket	1		MAT 3,5 T, MAT 3 T
14	42347	Screw	1	T2108020, 133168, D1112322, 562678, 473919, 21968, 448667, 502413VZ, A7018093A, 811117605471, 29442, 9161160818, D1112324, 2821121MI, 137036, 505186, Q21935, 9111150820, 2821727MI, A502413, 127192, 484109, 132502, 482307, 132028, 816117603371, 816117603271, 132429, 911115082071, A502413VZ, 448677, 573078, 745469, 2830009MI, 820132, A7074632A	MAT 3,5 T, MAT 3 T

TRIPLE MAST TOTAL FREE LIFT 3,70m à / bis / a / to / a 7,00m

10 AD 122

KIT HYDRAULIQUE ACCESSOIRE 3ème ELEMENT (Double effet)
 KIT 3er ELEMENT ZUBEHOR HYDRAULIK (Doppeltwirkend)
 KIT HIDRAULICO ACCESSORIO 3ro ELEMENTO (Doble efecto)
 3rd ELEMENT ATTACHMENT HYDRAULIC KIT (Double-acting)
 KIT IDRAULICO ACCESSORIO 3 ELEMENTO (Doppio effetto)

MSI 30 D S2-E2 - MSI 30 D BUGGIE S2-E2
 MSI 30 T S2-E3 / S3-E3 - MSI 30 T BUGGIE S2-E3 / S3-E3
 MSI 30 G S2-E - MSI 30 G BUGGIE S2-E
 MSI 35 T S2-E2 - MSI 35 T BUGGIE S2-E2
 MSI 35 T S2-E3 / S3-E3 - MSI 35 T BUGGIE S2-E3 / S3-E3
 MSI 30 T S1-E2 - MSI 30 T BUGGIE S1-E2
 MSI 30 / 35 T 4ST3A

KIT COMPLET, VOIR NOMENCLATURE
 KOMPLETTER KIT, SIEHE STÜCKLISTE
 JUEGO COMPLETO, VER NOMENCLATURA
 COMPLETE KIT, SEE NOMENCLATURE
 KIT COMPLETO, VEDERE NOMENCLATURA
 Rep - Hirw - Fig - Item - Sequenza
 60

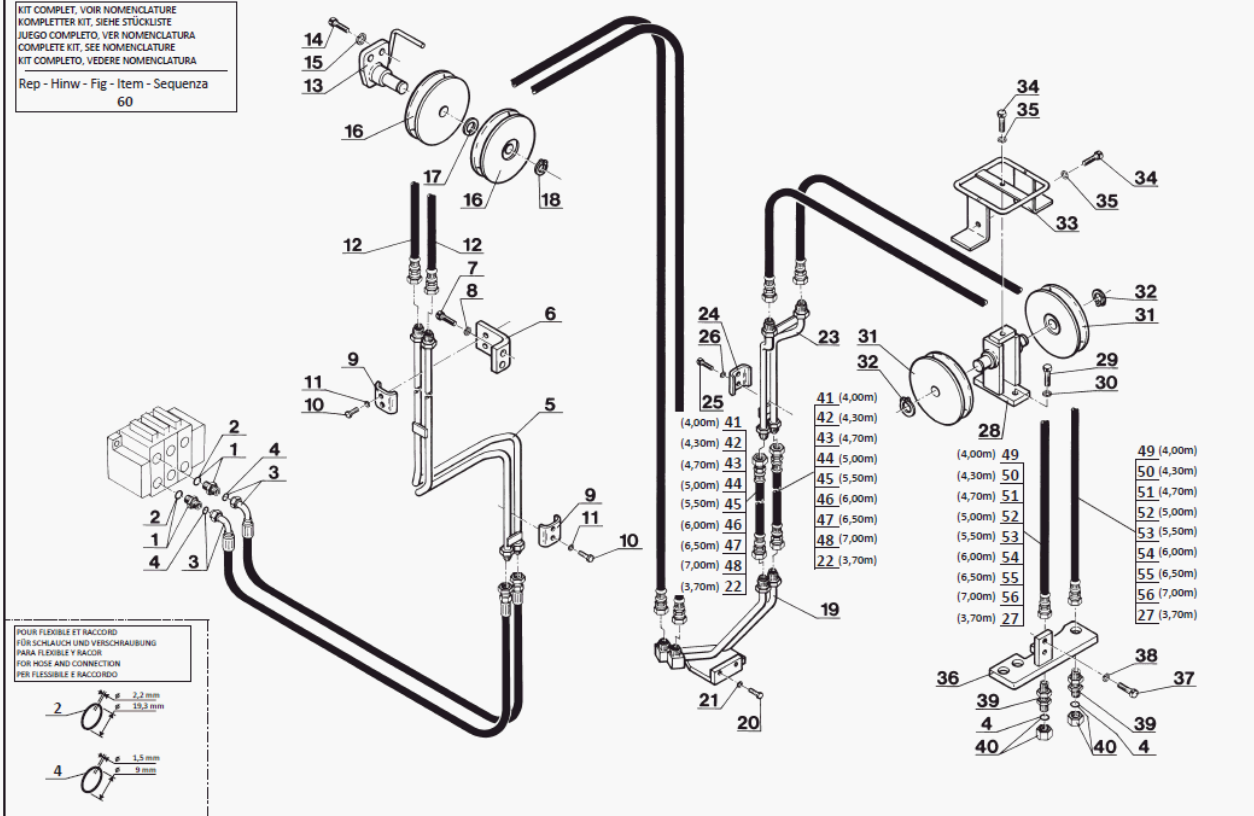

P.A.C. Ital

08 / 09 / 05

Позиция	№ детали	Название	К-во	SupersededPartNumber	Product Type
50	571787AC C	Hydraulic kit	1	234211, 571787	MAT 2,5 T, MAT 2 T
50	234212	Complete attachment hydraulic kit (mast 5,00 m)	1		MAT 2,5 T, MAT 2 T
50	234213	Complete attachment hydraulic kit (mast 5,50 m)	1		MAT 2,5 T, MAT 2 T
50	234214	Complete attachment hydraulic kit (mast 6,00 m)	1		MAT 2,5 T, MAT 2 T
50	234215	Complete attachment hydraulic kit (mast 6,50 m)	1		MAT 2,5 T, MAT 2 T

Позиция	№ детали	Название	К-во	SupersededPartNumber	Product Type
40	58528	Nut	2	9411040800, 132110, 42049, 704888, 132459, 41632, D3316466, 482310, 448741, 554197, 551157, 801707600771, A503511VZ, 418752, 774, 900894100571, 2162104MI, T4008000, 94110F080071, 581840, 602108, 106175, 455185, 131598, A4109166A, D1122477, 55691F212071, A7218467A, A7274633A, 506859, 841107600171, T3008000, 127308, 475803, 503511VZ, 2431, 418747, 133088, 137520, 2762081MI, X6030195, 132075, 9017508003, 820097	MAT 2,5 T, MAT 2 T
41	173354	Clip	4		MAT 2,5 T, MAT 2 T
42	4240	Screw	4		MAT 2,5 T, MAT 2 T
43	54232	Nut	4		MAT 2,5 T, MAT 2 T
44	29483	Washer	4	50309, 446293, 702260, 820108, 845127600571, 845247600171, 485641, 36100, 418728, 448766, A7374635A, G1823230, W50114407814, 54231, 9451100500, 105556, 455415, 845117600271	MAT 2,5 T, MAT 2 T
45	266090	Quick female union	2	192037	MAT 2,5 T, MAT 2 T
46	167927	Connection	2		MAT 2,5 T, MAT 2 T
47	197233	Connection	2	499386, 405955	MAT 2,5 T, MAT 2 T
48	211373	Hose	1		MAT 2,5 T, MAT 2 T
49	248240	Hose	1	212091	MAT 2,5 T, MAT 2 T
50	217951	Connection	1		MAT 2,5 T, MAT 2 T
51	89813	Connection	1		MAT 2,5 T, MAT 2 T
52	168758	Half-clamp	4		MAT 2,5 T, MAT 2 T
53	168494	Protection plate	2		MAT 2,5 T, MAT 2 T
54	58530	Screw	1		MAT 2,5 T, MAT 2 T
55	61323	Screw	1		MAT 2,5 T, MAT 2 T
56	231267	Connection side shift carriage (Without quick coupling)	1		MAT 2,5 T, MAT 2 T
57	570207AC C	KIT RACCORD C547041P10AF50	1	211591, 570207, 217789	MAT 2,5 T, MAT 2 T
58	570202AC C	KIT BRANCHEMENTC547041P10AF50	1	570202, 217791	MAT 2,5 T, MAT 2 T

Позиция	№ детали	Название	К-во	SupersededPartNumber	Product Type
0	571644	Triple mast	1		MAT 2,5 T, MAT 2 T
0	571645	Triple mast	1		MAT 2,5 T, MAT 2 T
0	571628	Complete triple mast	1	571646, 571628ACC, 556049, 555959	MAT 2,5 T, MAT 2 T
0	571647	Triple mast	1		MAT 2,5 T, MAT 2 T
0	571648	Triple mast	1		MAT 2,5 T, MAT 2 T
0	571649	Triple mast	1		MAT 2,5 T, MAT 2 T
0	571650	Triple mast	1		MAT 2,5 T, MAT 2 T
0	571651	Triple mast	1		MAT 2,5 T, MAT 2 T
0	571652	Triple mast	1		MAT 2,5 T, MAT 2 T
0	571653	Triple mast	1		MAT 3,5 T, MAT 3 T
0	571654	Triple mast	1		MAT 3,5 T, MAT 3 T
0	571655	Triple mast	1		MAT 3,5 T, MAT 3 T
0	571656	Triple mast	1		MAT 3,5 T, MAT 3 T
0	571657	Triple mast	1		MAT 3,5 T, MAT 3 T
0	571658	Triple mast	1		MAT 3,5 T, MAT 3 T
0	571659	Triple mast	1		MAT 3,5 T, MAT 3 T
0	571660	Triple mast	1		MAT 3,5 T, MAT 3 T
0	571661	Triple mast	1		MAT 3,5 T, MAT 3 T
1	74364	Connection	1		MAT 2,5 T, MAT 2 T
2	190874	"0" ring	1		MAT 2,5 T, MAT 3,5 T, MAT 3 T, MAT 2 T
3	89179	Connection	1		MAT 2,5 T, MAT 2 T
4	197233	Connection	1	499386, 405955	MAT 2,5 T, MAT 2 T
5	211343	Tube	1		MAT 2,5 T, MAT 2 T
6	211341	Tube	1		MAT 2,5 T, MAT 2 T
7	169787	Connection	2		MAT 2,5 T, MAT 2 T
8	169436	"0" ring	1		MAT 2,5 T, MAT 3,5 T, MAT 3 T, MAT 2 T
9	266089	Quick male union	2	192038	MAT 2,5 T, MAT 2 T
10	192039	Plug	2		MAT 2,5 T, MAT 2 T
11	192040	BRACKET	2		MAT 2,5 T, MAT 2 T
12	26957	Screw	2	706942, 479153, 40601, Q20276	MAT 2,5 T, MAT 2 T

TRIPLE MAST TOTAL FREE LIFT 3,70m à / bis / a / to / a 7,00m

10 CA 133

HYDRAULIQUE (Vérin de levée libre)
 HYDRAULIK (Freianstieg zylinder)
 HIDRAULICO (Cilindro de levantamiento libre)
 HYDRAULIC (Free lift cylinder)
 IDRAULICO (Cilindro alzata libera)

MSI 20/25 D S2-E2 - MSI 20/25 D BUGGIE S2-E2
 MSI 20/25 T S1-E2 / S2-E3 / S3-E3
 MSI 20/25 T BUGGIE S1-E2 / S2-E3 / S3-E3
 MSI 20/25 G S2-E - MSI 20/25 G BUGGIE S2-E
 MH 20/25-4 T BUGGIE S2-E2 / S2-E3 / S3-E3
 MSI 25 T 4ST3A - MH 25-4 T BUGGIE 4ST3A

COURSE - HUB - CARRERA		STROKE - CORSA	
3,70m - 615mm	5,50m - 920mm		
4,00m - 665mm	6,00m - 1015mm		
4,30m - 715mm	6,50m - 1140mm		
4,70m - 790mm	7,00m - 1265mm		
5,00m - 840mm			

□ SAUF POUR
 NICHT FÜR - EXCEPTO PARA
 EXCEPT FOR - TRANNE PER
 ☐ N° : MH20/25-4T

11 (3,70m)
 12 (4,00m)
 13 (4,30m)
 14 (4,70m)
 15 (5,00m) □
 16 (5,50m) □
 17 (6,00m) □
 18 (6,50m) □
 19 (7,00m) □

20 (3,70m) 1 65610 F2041 71
 21 (4,00m) 2 65620 F2041 71
 22 (4,30m) 3 65630 F2041 71
 23 (4,70m) 4 65650 F2041 71
 □ (5,00m) 5 65660 F2041 71
 □ (5,50m) 6 65670 F2041 71
 □ (6,00m) 7 65680 F2041 71
 □ (6,50m) 8 65690 F2041 71
 □ (7,00m) 9 65710 F2041 71

24
 25
 26
 27
 28
 29
 30
 31
 32
 33 (3,70m)
 34 (4,00m)
 35 (4,30m)
 36 (4,70m)
 37 (5,00m) □
 38 (5,50m) □
 39 (6,00m) □
 40 (6,50m) □
 41 (7,00m) □

2 x 26
 27
 29
 30
 31
 32

43

POCHETTE DE JOINTS
 DICHTUNGSATZ
 JUEGO DE JUNTAS
 SEAL KIT
 SERIE GUARNIZIONE

08 / 03 / 06

P.A.O. 08/06

Позиция	№ детали	Название	К-во	SupersededPartNumber	Product Type
24	588475	Seal	1		MAT 3,5 T, MAT 3 T
25	588471	Anti-extrusion seal	1		MAT 3,5 T, MAT 3 T
26	588472	Bushing	1		MAT 3,5 T, MAT 3 T
27	563471	Seal kit	1		MAT 3,5 T, MAT 3 T
28	588763	Flow restrictor	1		MAT 3,5 T, MAT 3 T
29	136366	Seal	1	G1827365, 967710201071	MAT 3,5 T, MAT 3 T

TRIPLE MAST WITHOUT FREE LIFT 3,30m

5 AB 51

MAT TRIPLE (Hauteur de levée : 3,30 m)
 DREIFACH HUBMAST (Hubhöhe : 3,30 m)
 MASTIL TRIPLE (Altura de levantamiento : 3,30 m)
 TRIPLE MAST (Lift height : 3,30 m)
 RAMPÀ TRIPLEX (Altezza di sollevamento : 3,30 m)

MSI 20/25 D S2-E2 - MSI 20/25 D BUGGIE S2-E2
 MSI 20/25 T S1-E2 / S2-E3 / S3-E3
 MSI 20/25 T BUGGIE S1-E2 / S2-E3 / S3-E3
 MSI 20/25 G S2-E - MSI 20/25 G BUGGIE S2-E
 MH 20/25-4 T BUGGIE S2-E2 / S2-E3 / S3-E3
 MSI 25 T 4ST3A - MH 25-4 T BUGGIE 4ST3A

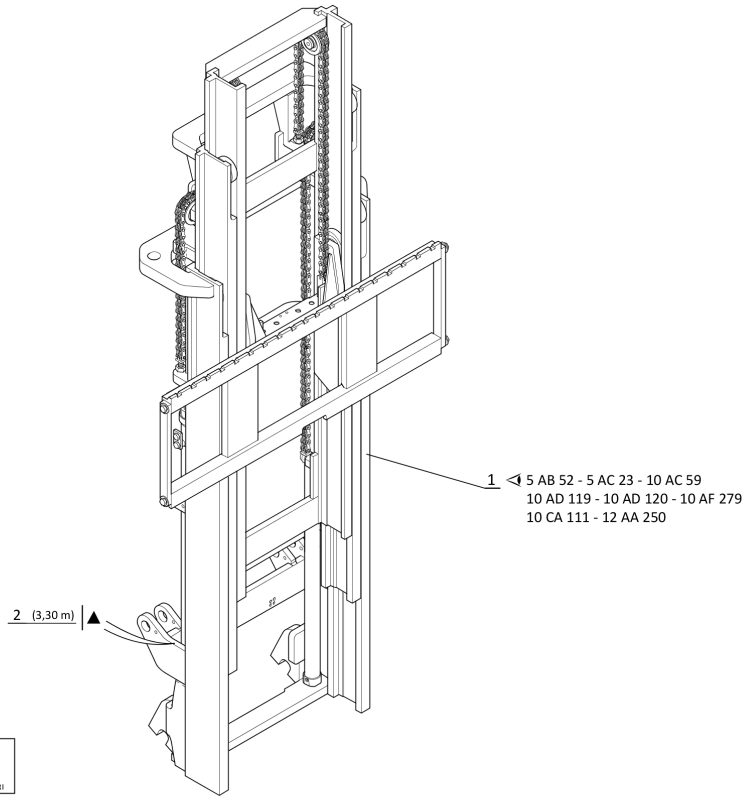

▲ N° DE MAT A SPECIFIER POUR TOUTE COMMANDE DE PIÈCES
 HUBMAST NUMMER ZUGEBEN FÜR ALLE TEILE
 N° DE MASTIS A ESPECIFICAR PARA TODAS PEDIDAS DE PIEZAS
 MAST NUMBER TO SPECIFY FOR ALL PARTS ORDER
 N° CARRELLI DA SPECIFICARE PER TUTTE GLI ORDINI DEI PARTICOLARI

P.A.O.illus
 18 / 01 / 05

Позиция	№ детали	Название	К-во	SupersededPartNumber	Product Type
0	571803	Triple mast	1		MAT 2,5 T, MAT 2 T
1	208675	Back load rest, stripped	1		MAT 2,5 T, MAT 2 T
2	53514	Screw	4		MAT 2,5 T, MAT 2 T

Позиция	№ детали	Название	К-во	SupersededPartNumber	Product Type
37	6224	Screw	1	482315, A7026115A, 137998, 2830040MI, 58529, 106639, 478558, 484733	MAT 2,5 T, MAT 2 T
38	169437	Seal	1		MAT 2,5 T, MAT 2 T
50	226362	Complete attachment hydraulic kit (mast 3,30 m)	1		MAT 2,5 T, MAT 2 T

Позиция	№ детали	Название	К-во	SupersededPartNumber	Product Type
30	42325	Washer	2	561561, 448285, 484829, 749854, 744649, A7374634A, A503710VZ, 420461, 824136, 506965, 824126, 745826, 550425, 550964, 573083, 138167, Q22528, 506283, K506283, 479336, A503710, 820098	MH 20-4 TURBO BUGGIE S2 E2, MSI 20 D S2 E2, MSI 20 TURBO S3 E3, MH 25-4 TURBO BUGGIE S2 E2, MH 25-4 TURBO BUGGIE S2 E3, MSI 20 TURBO BUGGIE S1 E2, MSI 20 TURBO BUGGIE S3 E3, MSI 25 G S2 E2, MSI 20 TURBO S1 E2, MSI 25 TURBO BUGGIE S1 E2, MSI 20 G S2 E2, MH 20 4 TURBO BUGGIE S2 E3, MSI 25 D BUGGIE S2 E2, MSI 20 D BUGGIE S2 E2, MSI 20 G BUGGIE S2 E2, MSI 25 TURBO S3 E3, MSI 25 TURBO S1 E2, MH 25-4 TURBO BUGGIE S3 E3, MSI 20 TURBO BUGGIE S2 E3, MH 20-4 TURBO BUGGIE S3 E3, MSI 25 G BUGGIE S2 E2, MSI 20 TURBO S2 E3, MSI 25 TURBO BUGGIE S3 E3, MSI 25 TURBO BUGGIE S2 E3, MSI 25 D S2 E2, MSI 25 TURBO S2 E3
31	173354	Clip	4		MH 20-4 TURBO BUGGIE S2 E2, MSI 20 D S2 E2, MSI 20 TURBO S3 E3, MH 25-4 TURBO BUGGIE S2 E2, MH 25-4 TURBO BUGGIE S2 E3, MSI 20 TURBO BUGGIE S1 E2, MSI 20 TURBO BUGGIE S3 E3, MSI 25 G S2 E2, MSI 20 TURBO S1 E2, MSI 25 TURBO BUGGIE S1 E2, MSI 20 G S2 E2, MH 20 4 TURBO BUGGIE S2 E3, MSI 25 D BUGGIE S2 E2, MSI 20 D BUGGIE S2 E2, MSI 20 G BUGGIE S2 E2, MSI 25 TURBO S3 E3, MSI 25 TURBO S1 E2, MH 25-4 TURBO BUGGIE S3 E3, MSI 20 TURBO BUGGIE S2 E3, MH 20-4 TURBO BUGGIE S3 E3, MSI 25 G BUGGIE S2 E2, MSI 20 TURBO S2 E3, MSI 25 TURBO BUGGIE S3 E3, MSI 25 TURBO BUGGIE S2 E3, MSI 25 D S2 E2, MSI 25 TURBO S2 E3
32	4240	Screw	4		MH 20-4 TURBO BUGGIE S2 E2, MSI 20 D S2 E2, MSI 20 TURBO S3 E3, MH 25-4 TURBO BUGGIE S2 E2, MH 25-4 TURBO BUGGIE S2 E3, MSI 20 TURBO BUGGIE S1 E2, MSI 20 TURBO BUGGIE S3 E3, MSI 25 G S2 E2, MSI 20 TURBO S1 E2, MSI 25 TURBO BUGGIE S1 E2, MSI 20 G S2 E2, MH 20 4 TURBO BUGGIE S2 E3, MSI 25 D BUGGIE S2 E2, MSI 20 D BUGGIE S2 E2, MSI 20 G BUGGIE S2 E2, MSI 25 TURBO S3 E3, MSI 25 TURBO S1 E2, MH 25-4 TURBO BUGGIE S3 E3, MSI 20 TURBO BUGGIE S2 E3, MH 20-4 TURBO BUGGIE S3 E3, MSI 25 G BUGGIE S2 E2, MSI 20 TURBO S2 E3, MSI 25 TURBO BUGGIE S3 E3, MSI 25 TURBO BUGGIE S2 E3, MSI 25 D S2 E2, MSI 25 TURBO S2 E3
33	54232	Nut	4		MH 20-4 TURBO BUGGIE S2 E2, MSI 20 D S2 E2, MSI 20 TURBO S3 E3, MH 25-4 TURBO BUGGIE S2 E2, MH 25-4 TURBO BUGGIE S2 E3, MSI 20 TURBO BUGGIE S1 E2, MSI 20 TURBO BUGGIE S3 E3, MSI 25 G S2 E2, MSI 20 TURBO S1 E2, MSI 25 TURBO BUGGIE S1 E2, MSI 20 G S2 E2, MH 20 4 TURBO BUGGIE S2 E3, MSI 25 D BUGGIE S2 E2, MSI 20 D BUGGIE S2 E2, MSI 20 G BUGGIE S2 E2, MSI 25 TURBO S3 E3, MSI 25 TURBO S1 E2, MH 25-4 TURBO BUGGIE S3 E3, MSI 20 TURBO BUGGIE S2 E3, MH 20-4 TURBO BUGGIE S3 E3, MSI 25 G BUGGIE S2 E2, MSI 20 TURBO S2 E3, MSI 25 TURBO BUGGIE S3 E3, MSI 25 TURBO BUGGIE S2 E3, MSI 25 D S2 E2, MSI 25 TURBO S2 E3

CLICK HERE TO **DOWNLOAD** THE COMPLETE MANUAL

- Thank you very much for reading the preview of the manual.
- You can download the complete manual from: www.heydownloads.com by clicking the link below



- Please note: If there is no response to CLICKING the link, please download this PDF first and then click on it.

CLICK HERE TO **DOWNLOAD** THE COMPLETE MANUAL