

Mecalac

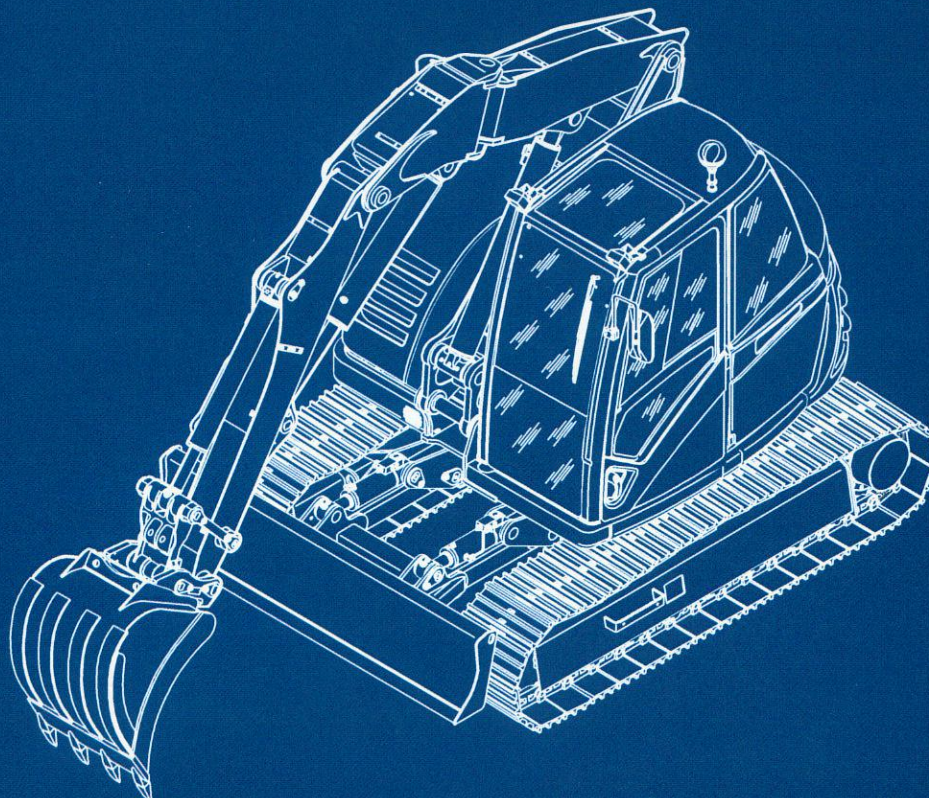

CATALOGUE DE PIECES DE RECHANGE
SPARE PARTS BOOK
ERSATZTEILLISTE



Groupe **Mecalac**

Mecalac S.A.S. : 2, avenue du Pré de Challes - P.A.E. des Glaisins - BP 230 - F-74942 Annecy-le-Vieux Cedex
Téléphone : +33 (0)4 50 64 01 63 - Téléfax : +33 (0)4 50 64 02 79 - Site internet : www.mecalac.fr

CLICK HERE TO **DOWNLOAD** THE COMPLETE MANUAL

- Thank you very much for reading the preview of the manual.
- You can download the complete manual from: www.heydownloads.com by clicking the link below



- Please note: If there is no response to CLICKING the link, please download this PDF first and then click on it.

CLICK HERE TO **DOWNLOAD** THE COMPLETE MANUAL

CATALOGUE DE PIÈCES DE RECHANGE INSTRUCTIONS POUR LES COMMANDES DE PIÈCES

Les pages suivantes donnent la référence illustrée de toutes les pièces principales qui composent votre **Mecalac**.

Lorsque vous commandez des pièces de rechange à votre Concessionnaire **Mecalac**, veuillez fournir les informations suivantes :

- 1 - Le numéro de référence de votre Catalogue de Pièces de Rechange.
(Indiqué dans le coin inférieur gauche de la page : 5400xxx).
- 2 - La référence du modèle (10MCR).
- 3 - Le numéro de série de la machine.
- 4 - Repère illustration et N° de la pièce.
- 5 - Repère de Page.

Exemple : Catalogue N° **5400867 - 10MCR**, N° série : **140300**, repères : **3 et 6**,
page : **42 10 1A**.

SPARE PARTS BOOK ORDERING INSTRUCTIONS

The following pages provide an illustrated reference for all major parts of your **Mecalac**.

When ordering spare parts from your **Mecalac** dealer please give the following information:

- 1 - Reference number of your Spare Parts Book
(Number shown in the lower left corner of the page: 5400xxx).
- 2 - Machine type: (10MCR).
- 3 - Machine serial number.
- 4 - Illustration and item reference.
- 5 - Reference mark on page

Example: Spare Parts Book N° **5400867 - 10MCR**, Serial number: **140300**, Illustration reference: **3 and 6**, page: **42 10 1A**.

ERSATZTEIL KATALOG BESTELLANWEISUNGEN

Die folgenden Seiten enthalten die mit Abbildungen versehenen Bezugsnummern für alle wesentlichen Teile Ihrer **Mecalac**.

Bitte geben Sie bei Bestellung von Ersatzteilen bei Ihrem **Mecalac** Vertreter folgende Angaben an:

- 1 - Bezugsnummer Ihres Ersatzteilkatalogs.
(Siehe unten links auf Seite: 5400xxx).
- 2 - Fahrzeugtyp: (10MCR).
- 3 - Seriennummer der Maschine.
- 4 - Illustration und Ersatzteilnummer.
- 5 - Referenzzeichen der Seite.

Beispiel: Ersatzteil Katalog Nr. **5400867 - 10MCR**, Serie: Nr. **140300**, Referenz Illustration: **3 und 6**,
Seite: **42 10 1A**.













JOINTS (JEU)
SEAL KIT
DICHTUNGS (BAUSATZ)

* 1	5960182		1	JOINTS (JEU)	SEAL KIT	DICHTUNGS (BAUSATZ)
* 2	5960150	ORFS 9/16-18	1	POCHETTE DE JOINTS	SEAL (KIT)	DICHTRING (BAUSATZ)
* 3	5960151	ORFS 11/16-16	1	POCHETTE DE JOINTS	SEAL (KIT)	DICHTRING (BAUSATZ)
* 4	5960152	ORFS 13/16-16	1	POCHETTE DE JOINTS	SEAL (KIT)	DICHTRING (BAUSATZ)
* 5	5960153	ORFS 1-14	1	POCHETTE DE JOINTS	SEAL (KIT)	DICHTRING (BAUSATZ)
* 6	5960154	ORFS 1-3/16-12	1	POCHETTE DE JOINTS	SEAL (KIT)	DICHTRING (BAUSATZ)
* 7	5960155	ORFS 1-7/16-12	1	POCHETTE DE JOINTS	SEAL (KIT)	DICHTRING (BAUSATZ)
* 8	5960156	ORFS 1-11/16-12	1	POCHETTE DE JOINTS	SEAL (KIT)	DICHTRING (BAUSATZ)
* 9	5960157	ED BSPP 1/4"	1	POCHETTE DE JOINTS	SEAL (KIT)	DICHTRING (BAUSATZ)
* 10	5960158	ED BSPP 3/8"	1	POCHETTE DE JOINTS	SEAL (KIT)	DICHTRING (BAUSATZ)
* 11	5960159	ED BSPP 1/2"	1	POCHETTE DE JOINTS	SEAL (KIT)	DICHTRING (BAUSATZ)
* 12	5960160	ED BSPP 3/4"	1	POCHETTE DE JOINTS	SEAL (KIT)	DICHTRING (BAUSATZ)
* 13	5960161	ED BSPP 1"	1	POCHETTE DE JOINTS	SEAL (KIT)	DICHTRING (BAUSATZ)
* 14	5960162	ED BSPP 1.1/4"	1	POCHETTE DE JOINTS	SEAL (KIT)	DICHTRING (BAUSATZ)
* 15	5960163	O-R BSPP 1/4"	1	POCHETTE DE JOINTS	SEAL (KIT)	DICHTRING (BAUSATZ)
* 16	5960164	O-R BSPP 3/8"	1	POCHETTE DE JOINTS	SEAL (KIT)	DICHTRING (BAUSATZ)
* 17	5960165	O-R BSPP 1/2"	1	POCHETTE DE JOINTS	SEAL (KIT)	DICHTRING (BAUSATZ)
* 18	5960166	O-R BSPP 3/4"	1	POCHETTE DE JOINTS	SEAL (KIT)	DICHTRING (BAUSATZ)
* 19	5960167	O-R BSPP 1"	1	POCHETTE DE JOINTS	SEAL (KIT)	DICHTRING (BAUSATZ)
* 20	5960168	O-R BSPP 1.1/4"	1	POCHETTE DE JOINTS	SEAL (KIT)	DICHTRING (BAUSATZ)
* 21	5960169	O-R UNF 7/16"	1	POCHETTE DE JOINTS	SEAL (KIT)	DICHTRING (BAUSATZ)
* 22	5960170	O-R UNF 7/8"	1	POCHETTE DE JOINTS	SEAL (KIT)	DICHTRING (BAUSATZ)
* 23	5960171	ED M14	1	POCHETTE DE JOINTS	SEAL (KIT)	DICHTRING (BAUSATZ)
* 24	5960172	O-R M14	1	POCHETTE DE JOINTS	SEAL (KIT)	DICHTRING (BAUSATZ)
* 25	5960173	ED M18	1	POCHETTE DE JOINTS	SEAL (KIT)	DICHTRING (BAUSATZ)
* 26	5960174	ED M22	1	POCHETTE DE JOINTS	SEAL (KIT)	DICHTRING (BAUSATZ)
* 27	5960175	O-R M27	1	POCHETTE DE JOINTS	SEAL (KIT)	DICHTRING (BAUSATZ)
* 28	5960176	O-R SAE 3/4"	1	POCHETTE DE JOINTS	SEAL (KIT)	DICHTRING (BAUSATZ)
* 29	5960177	O-R SAE 1"	1	POCHETTE DE JOINTS	SEAL (KIT)	DICHTRING (BAUSATZ)
* 30	5960178	O-R SAE 1.1/4"	1	POCHETTE DE JOINTS	SEAL (KIT)	DICHTRING (BAUSATZ)
* 31	5960179	O-R JIS 1/4"	1	POCHETTE DE JOINTS	SEAL (KIT)	DICHTRING (BAUSATZ)
* 32	5960180	O-R JIS 1/2"	1	POCHETTE DE JOINTS	SEAL (KIT)	DICHTRING (BAUSATZ)
* 33	5960181	O-R JIS 3/4"	1	POCHETTE DE JOINTS	SEAL (KIT)	DICHTRING (BAUSATZ)

OUTILLAGE DENTS (ULTRALOCK)
TOOTH TOOL (ULTRALOCK)
ZAHNEWERKZEUG (ULTRALOCK)

* 1 5620100	1	OUTIL	TOOL	WERKZEUG
-------------	---	-------	------	----------

TABLEAU CHARGES : LÈVE PALETTE
TABLE LOADS: PALLET FORK
LASTENTABELLE: PALETTENHEBER

* 1 5751866	 FR-LU-BE-CH	1	ADHESIF	ADHESIVE	KLEBSTOFF
* 1 5752132	 DE-CH	1	ADHESIF	ADHESIVE	KLEBSTOFF
* 1 5752133	 GB	1	ADHESIF	ADHESIVE	KLEBSTOFF
* 1 5751880	 ES	1	ADHESIF	ADHESIVE	KLEBSTOFF
* 1 5751886	 IT	1	ADHESIF	ADHESIVE	KLEBSTOFF
* 1 5751890	 NL	1	ADHESIF	ADHESIVE	KLEBSTOFF
* 1	 DK	1	ADHESIF	ADHESIVE	KLEBSTOFF
* 1	 SE	1	ADHESIF	ADHESIVE	KLEBSTOFF
* 1 5752131	 NO	1	ADHESIF	ADHESIVE	KLEBSTOFF
* 1 5751882	 FI	1	ADHESIF	ADHESIVE	KLEBSTOFF
* 1 5752130	 CZ	1	ADHESIF	ADHESIVE	KLEBSTOFF
* 1 5751894	 PL	1	ADHESIF	ADHESIVE	KLEBSTOFF
* 1 5752072	 TR	1	ADHESIF	ADHESIVE	KLEBSTOFF

GODET RETRO (TYPE VOLVO) AVEC DENTS (ESCO)
BACKHOE BUCKET (TYPE VOLVO) WITH TEETH (ESCO)
TIEFLOFFEL (TYPE VOLVO) MIT ZAHNEN (ESCO)

* 1	6848311	350 mm	1	GODET RETRO	BACKHOE BUCKET	TIEFLOEFFEL
* 2	6848312	450 mm	1	GODET RETRO	BACKHOE BUCKET	TIEFLOEFFEL
* 3	6848313	600 mm	1	GODET RETRO	BACKHOE BUCKET	TIEFLOEFFEL
* 4	6848314	750 mm	1	GODET RETRO	BACKHOE BUCKET	TIEFLOEFFEL
* 5	6848315	900 mm	1	GODET RETRO	BACKHOE BUCKET	TIEFLOEFFEL
* 6	6848316	1200 mm	1	GODET RETRO	BACKHOE BUCKET	TIEFLOEFFEL
* 7	2420158	U20	SB	PORTE DENT	TOOTH HOLDER	ZAHNHALTER
* 8	2420157	U20S	SB	DENT	TOOTH	ZAHN

GODET CHARGEUR AVEC DENTS (ESCO)
 LOADER BUCKET WITH TEETH (ESCO)
 LADESCHAUFFEL MIT ZAHNEN (ESCO)

* 1	6848048		350 mm	1	GODET CHARGEUR	LOADER BUCKET	LADESCHAUFFEL
* 2	6848012	1	350 mm	1	JEU DE FIXATION	ATTACHING KIT	ANBAUSATZ
* 3	3832929	2	280 mm	1	ATTACHE	FASTENER	BEFESTIGUNG
* 4	3310435	2	350 mm	1	BUTEE	CATCH	FALLE
* 5	3838017	2		1	PLAT D'ATTACHE	DISH OF FASTENER	BEFESTIGUNGSTELLER
* 6	2420158	1	U20	SB	PORTE DENT	TOOTH HOLDER	ZAHNHALTER
* 7	2420157	1	U20S	SB	DENT	TOOTH	ZAHN

GODET TRAPEZOÏDAL ORIENTABLE
 SWIVELLING TRAPEZOÏDAL BUCKET
 SCHWENKBARER TRAPEZLOFFEL

* 1	3838009	300X900X700	1	GODET TRAPEZOÏDAL ORIENTABLE	SWIVELLING TRAPEZOIDAL BUCKET	SCHWENKBARER TRAPEZLOEFFEL
* 2	3838010	400X1200X900	1	GODET TRAPEZOÏDAL ORIENTABLE	SWIVELLING TRAPEZOIDAL BUCKET	SCHWENKBARER TRAPEZLOEFFEL
* 3	6848014	450 mm	1	JEU DE FIXATION	ATTACHING KIT	ANBAUSATZ
* 4	3838017	3	1	PLAT D'ATTACHE	DISH OF FASTENER	BEFESTIGUNGSTELLER
* 5	3310434	3	450 mm	BUTEE	CATCH	FALLE
* 6	3832849	3	450 mm	ATTACHE	FASTENER	BEFESTIGUNG
* 7	3831903	1-2	1	PLATINE ROTATIVE	PLATINIZE ROTARY	PLATIN ROTIEREND
* 8	4380356	1-2	H M16X60	4 VIS	SCREW	SCHRAUBE
* 9	4450014	1-2	NYLSTOP M16	4 ECROU	NUT	MUTTER
* 10	4490008	1-2	CONTACT MU16	8 RONDELLE	WASHER	UNTERLEGSCHIEBE
* 11	4450119	1-2	HFR M30	1 ECROU AUTOFREINE	PREVAILING TORQUE TYPE NUT	MUTTERN MIT KLEMMTEIL

PLATINE (BRISE ROCHE)
ADAPTING PLATE (ROCK BREAKER)
ANBAUPLATTE (HAMMER)

* 1 3830730	TYPE VOLVO	1	PLATINE	DECK	PLATTE
* 2 3838013	BRH250	1	PLATINE	ADAPTING PLATE	ANBAUPLATTE
* 3 3838014	BRH250	1	PLATINE	ADAPTING PLATE	ANBAUPLATTE
* 4 3838015	BRH125	1	PLATINE	ADAPTING PLATE	ANBAUPLATTE
* 5 3838016	140/150MS	1	PLATINE	ADAPTING PLATE	ANBAUPLATTE

MOTEUR THERMIQUE
DIESEL ENGINE
DIESEL MOTOR

DPF/FAP*

* 1	5370486		TCD3.6 DPF/FAP	1	MOTEUR EQUIPE	ENGINE EQUIPPED	MOTOR AUSGERUESTET
* 2	537A0393	1	02 10 1A	1	FILTRE HUILE	OIL FILTER	OELFILTER
* 3	537A0397	1	02 10 1A	1	FILTRE CARBURANT	FUEL FILTER	KRAFTSTOFFILTER
* 4	537A0394	1	02 10 1A	1	CARTOUCHE: PREFILTRE (GASOIL)	CARTRIGE: PREFILTER (GASOIL)	EINSATZ: VORFILTER (GASOL)
* 5	537A0410	1		1	COURROIE TRAP.	V BELT	KEILRIEMEN
* 6	537A0350	1		1	SONDE TEMPERATURE D'EAU	WATER TEMPERATURE PROBE	TEMPERATURFUHLER (WASSER)
* 7	537A0414	1		2	SONDE	PROBE	FUELHER
* 8	537A0416	1		1	SONDE	PROBE	FUELHER
* 9	537A0408	1		1	BOUCHON DE VIDANGE	DRAIN PLUG	LECKAGESTOPSEL
* 10	537A0409	1		1	JOINT	SEAL	DICHTRING
* 11	537A0415	1		1	BOUCHON	PLUG	VERSCHL.STOPFEN
* 12	537A0412	1		1	JOINT	SEAL	DICHTRING
* 13	537A0413	1		2	CAPTEUR	SENSOR	SENSOR
* 14	537A0421	1		1	POMPE ELECTRIQUE	ELECTRIC PUMP	ELEKTROPUMPE
* 15	537A0396	4		1	JOINT	SEAL	DICHTRING
* 16	4490016		CONTACT MU5	3	RONDELLE	WASHER	UNTERLEGSCHIEBE
* 17	3833481			1	CACHE	MUFF	MUFFE
* 18	4380021		H M5X16	3	VIS	SCREW	SCHRAUBE
* 19	4380046		H M8X35	4	VIS	SCREW	SCHRAUBE
* 20	5630015			4	ENTRETOISE	SPACER	ABSTANDSTUECK
* 21	4490006		CONTACT MU8	4	RONDELLE	WASHER	UNTERLEGSCHIEBE
* 22	3070558			1	SUPPORT	BRACKET	TRAEGER
* 23	4380051		H M10X16	4	VIS	SCREW	SCHRAUBE
* 24	4490003		CONTACT MU10	4	RONDELLE	WASHER	UNTERLEGSCHIEBE

ACCOUPLLEMENT MOTEUR / POMPE HYDRAULIQUE
 ENGINE CLUTCH / HYDRAULIC PUMP
 MOTORKUPPLUNG / HYDRAULISCHE PUMPE

* 1	5010150		1	MOYEU	HUB	NABE
* 2	4290218	CHC M10X16	8	VIS	SCREW	SCHRAUBE
* 3	5010149		1	FLASQUE	FLANGE	FLANSCH
* 4	5010164		1	FLASQUE	FLANGE	FLANSCH
* 5	4290162	CHC M10X25	10	VIS	SCREW	SCHRAUBE
* 6	3833401		1	SUPPORT	BRACKET	TRAEGER
* 7	4380043	H M8X20	2	VIS	SCREW	SCHRAUBE
* 8	4490006	CONTACT MU8	4	RONDELLE	WASHER	UNTERLEGSCHIEBE
* 9	3070392		1	SUPPORT	BRACKET	TRAEGER
* 10	4690599		1	BRIDE	FLANGE	FLANSCH
* 11	4290016	CHC M8X16	2	VIS	SCREW	SCHRAUBE
* 12	4290087	CHC M10X45	2	VIS	SCREW	SCHRAUBE
* 13	4290026	CHC M10X30	2	VIS	SCREW	SCHRAUBE

CIRCUIT GAS-OIL
 FUEL CIRCUIT
 KRAFTSTOFFANLAGE

* 1	4750276		2	UNION	CONNECTOR	ANSCHLUSSTEIL
* 2	4490006	CONTACT MU8	6	RONDELLE	WASHER	UNTERLEGSCHIEBE
* 3	4490009	CONTACT M20	1	RONDELLE	WASHER	UNTERLEGSCHIEBE
* 4	4690805		4	COLLIER	COLLAR	SHELLE
* 5	4380103	H M20X40	1	VIS	SCREW	SCHRAUBE
* 6	4380044	H M8X25	3	VIS	SCREW	SCHRAUBE
* 7	4690238		1	COLLIER	COLLAR	SHELLE
* 8	1400021		1	FLEXIBLE CARBURANT	FUEL HOSE	KRAFTST.SCHLAUCH
* 9	1400022		1	FLEXIBLE CARBURANT	FUEL HOSE	KRAFTST.SCHLAUCH
* 10	1400025		1	FLEXIBLE CARBURANT	FUEL HOSE	KRAFTST.SCHLAUCH
* 11	4490003	CONTACT MU10	4	RONDELLE	WASHER	UNTERLEGSCHIEBE
* 12	4750693		4	UNION	CONNECTOR	ANSCHLUSSTEIL
* 13	4490016	CONTACT MU5	4	RONDELLE	WASHER	UNTERLEGSCHIEBE
* 14	4745032		2	BOUCHON	PLUG	VERSCHL.STOPFEN
* 15	1400023		1	FLEXIBLE CARBURANT	FUEL HOSE	KRAFTST.SCHLAUCH
* 16	4380021	H M5X16	4	VIS	SCREW	SCHRAUBE
* 17	4410020	H M10	2	ECROU	NUT	MUTTER
* 18	4380057	H M10X45	2	VIS	SCREW	SCHRAUBE
* 19	3070389		1	SUPPORT	BRACKET	TRAEGER
* 20	4690844		5	COLLIER	COLLAR	SHELLE
* 21	4410016	H M8	3	ECROU	NUT	MUTTER
* 22	4280030	HC M8X40	2	GOUJON	STUD	STIFT
* 23	4700120		1	COUDE	ELBOW	WINKELSTUECK
* 24	1400024		1	FLEXIBLE CARBURANT	FUEL HOSE	KRAFTST.SCHLAUCH

CIRCUIT HYDRAULIQUE (TRANSLATION)
 HYDRAULICS (TRAVELLING CIRCUIT)
 HYDRAULIKKREIS (FAHRBEWEGUNG)

* 1	4770788		1	PRISE DE PRESSION	PRESSURE TAPPING	ANSCHLUSS FUR OLDRUC
* 2	4750431		4	UNION	CONNECTOR	ANSCHLUSSTEIL
* 3	4700147		1	COUDE	ELBOW	WINKELSTUECK
* 4	4196163		1	FLEXIBLE	HOSE	SCHLAUCH
* 5	4750276		1	UNION	CONNECTOR	ANSCHLUSSTEIL
* 6	4750787		1	UNION	CONNECTOR	ANSCHLUSSTEIL
* 7	4700120		1	COUDE	ELBOW	WINKELSTUECK
* 8	4750055		12	UNION	CONNECTOR	ANSCHLUSSTEIL
* 9	5780633		1	TUBE	TUBE	ROHR
* 10	5780632		1	TUBE	TUBE	ROHR
* 11	5780634		1	TUBE	TUBE	ROHR
* 12	5780635		1	TUBE	TUBE	ROHR
* 13	4700119		6	COUDE	ELBOW	WINKELSTUECK
* 14	4192379		1	FLEXIBLE	HOSE	SCHLAUCH
* 15	4770613	15 bar	1	ACCUMULATEUR	ACCUMULATOR	AKKUMULATOR
* 16	4750247		2	UNION	CONNECTOR	ANSCHLUSSTEIL
* 17	4192280		1	FLEXIBLE	HOSE	SCHLAUCH
* 18	4750567		1	UNION	CONNECTOR	ANSCHLUSSTEIL
* 19	4192771		1	FLEXIBLE	HOSE	SCHLAUCH
* 20	4720018		1	TE	TEE	T STUECK
* 21	4750097		4	UNION	CONNECTOR	ANSCHLUSSTEIL
* 22	1196012		1	FLEXIBLE	HOSE	SCHLAUCH
* 23	1196015		1	FLEXIBLE	HOSE	SCHLAUCH
* 24	1196014		1	FLEXIBLE	HOSE	SCHLAUCH
* 25	1196013		1	FLEXIBLE	HOSE	SCHLAUCH
* 26	4750058		1	ADAPTATEUR	ADAPTOR	ANSCHLUSSTUECK
* 27	5781190		1	TUBE	TUBE	ROHR
* 28	5781187		1	TUBE	TUBE	ROHR
* 29	5781191		1	TUBE	TUBE	ROHR
* 30	5781189		1	TUBE	TUBE	ROHR
* 31	4192276		1	FLEXIBLE	HOSE	SCHLAUCH
* 32	4720047		1	TE	TEE	T STUECK
* 33	4750414		2	ADAPTATEUR	ADAPTOR	ANSCHLUSSTUECK
* 34	4192484	*	2	FLEXIBLE	HOSE	SCHLAUCH
* 35	4750055	*	4	UNION	CONNECTOR	ANSCHLUSSTEIL
* 36	4192276	*	2	FLEXIBLE	HOSE	SCHLAUCH

CIRCUIT HYDRAULIQUE D'ORIENTATION
 HYDRAULICS SLEWING CIRCUIT
 HYDRAULIKKREIS SCHWENKUNG

* 1 4750055	9 UNION	CONNECTOR	ANSCHLUSSTEIL
* 2 4750292	2 UNION	CONNECTOR	ANSCHLUSSTEIL
* 3 1195069	1 FLEXIBLE	HOSE	SCHLAUCH
* 4 4720049	2 TE	TEE	T STUECK
* 5 4700120	2 COUDE	ELBOW	WINKELSTUECK
* 6 1195068	1 FLEXIBLE	HOSE	SCHLAUCH
* 7 4192746	1 FLEXIBLE	HOSE	SCHLAUCH
* 8 4700119	2 COUDE	ELBOW	WINKELSTUECK
* 9 1195082	1 FLEXIBLE	HOSE	SCHLAUCH
* 10 4192276	1 FLEXIBLE	HOSE	SCHLAUCH
* 11 4192650	1 FLEXIBLE	HOSE	SCHLAUCH
* 12 4700128	2 COUDE	ELBOW	WINKELSTUECK
* 13 4750276	4 UNION	CONNECTOR	ANSCHLUSSTEIL
* 14 4192738	2 FLEXIBLE	HOSE	SCHLAUCH
* 15 4192829	2 FLEXIBLE	HOSE	SCHLAUCH
* 16 4770434	1 SELECTEUR	SELECTOR	SELEKTOR

CIRCUIT ALIMENTATION ET RETOUR TOURELLE
TOWER SUPPLY AND RETURN CIRCUIT
EINSPEIS-UND RUCKLAUFKREISLAUF OBERWAGEN

* 1	4720060		1	TE	TEE	T STUECK
* 2	6090088		1	COLLECTEUR	MANILOLD	KOLLEKTOR
* 3	4750055		24	UNION	CONNECTOR	ANSCHLUSSTEIL
* 4	5781185		1	TUBE	TUBE	ROHR
* 5	5781184		1	TUBE	TUBE	ROHR
* 6	4720047		5	TE	TEE	T STUECK
* 7	5781186		1	TUBE	TUBE	ROHR
* 8	5781188		1	TUBE	TUBE	ROHR
* 9	4192763		1	FLEXIBLE	HOSE	SCHLAUCH
* 10	4192741		1	FLEXIBLE	HOSE	SCHLAUCH
* 11	4720051		1	TE	TEE	T STUECK
* 12	4192571		1	FLEXIBLE	HOSE	SCHLAUCH
* 13	4700119		3	COUDE	ELBOW	WINKELSTUECK
* 14	4750041		2	UNION	CONNECTOR	ANSCHLUSSTEIL
* 15	5780655		1	TUBE	TUBE	ROHR
* 16	5780662		1	TUBE	TUBE	ROHR
* 17	4194127		1	FLEXIBLE	HOSE	SCHLAUCH
* 18	4192847		1	FLEXIBLE	HOSE	SCHLAUCH
* 19	4195897		1	FLEXIBLE	HOSE	SCHLAUCH
* 20	4720049		1	TE	TEE	T STUECK
* 21	4194185		1	FLEXIBLE	HOSE	SCHLAUCH
* 22	4750542		2	UNION	CONNECTOR	ANSCHLUSSTEIL
* 23	1199000	 4190950	1	FLEXIBLE / TUBE	HOSE / TUBE	SCHLAUCH / ROHR
* 24	1198017		1	FLEXIBLE	HOSE	SCHLAUCH
* 25	4750789		1	REDUCTION	REDUCER PIPE	REDUKTIONSSTUCK
* 26	4750026		3	UNION	CONNECTOR	ANSCHLUSSTEIL
* 27	4700118		2	COUDE	ELBOW	WINKELSTUECK
* 28	4194229		1	FLEXIBLE	HOSE	SCHLAUCH
* 29	1198016		1	FLEXIBLE	HOSE	SCHLAUCH
* 30	4770788		1	PRISE DE PRESSION	PRESSURE TAPPING	ANSCHLUSS FUR OLDRUC
* 31	4192558		1	FLEXIBLE	HOSE	SCHLAUCH
* 32	5330138		1	CLAPET ANTI-RETOUR	CHECK VALVE	RUCKSCHLAGVENTIL
* 33	4755228		1	ADAPTATEUR	ADAPTOR	ANSCHLUSSTUECK
* 34	5780774		1	TUBE	TUBE	ROHR
* 35	5330145		1	CARTOUCHE	CARTRIDGE	EINSATZ
* 36	4194163		1	FLEXIBLE	HOSE	SCHLAUCH
* 37	4750566		2	UNION	CONNECTOR	ANSCHLUSSTEIL
* 38	4725076		1	TE	TEE	T STUECK
* 39	4750276		2	UNION	CONNECTOR	ANSCHLUSSTEIL
* 40	4192738		1	FLEXIBLE	HOSE	SCHLAUCH
* 41	4192483		2	FLEXIBLE	HOSE	SCHLAUCH
* 42	4700076		2	RACCORD BANJO	BANJO FITTING	RINGSTUECK
* 43	4750074		1	UNION	CONNECTOR	ANSCHLUSSTEIL
* 44	4700120		1	COUDE	ELBOW	WINKELSTUECK

CLICK HERE TO **DOWNLOAD** THE COMPLETE MANUAL

- Thank you very much for reading the preview of the manual.
- You can download the complete manual from: www.heydownloads.com by clicking the link below



- Please note: If there is no response to CLICKING the link, please download this PDF first and then click on it.

CLICK HERE TO **DOWNLOAD** THE COMPLETE MANUAL

TOURELLE
TOWER
OBERWAGEN

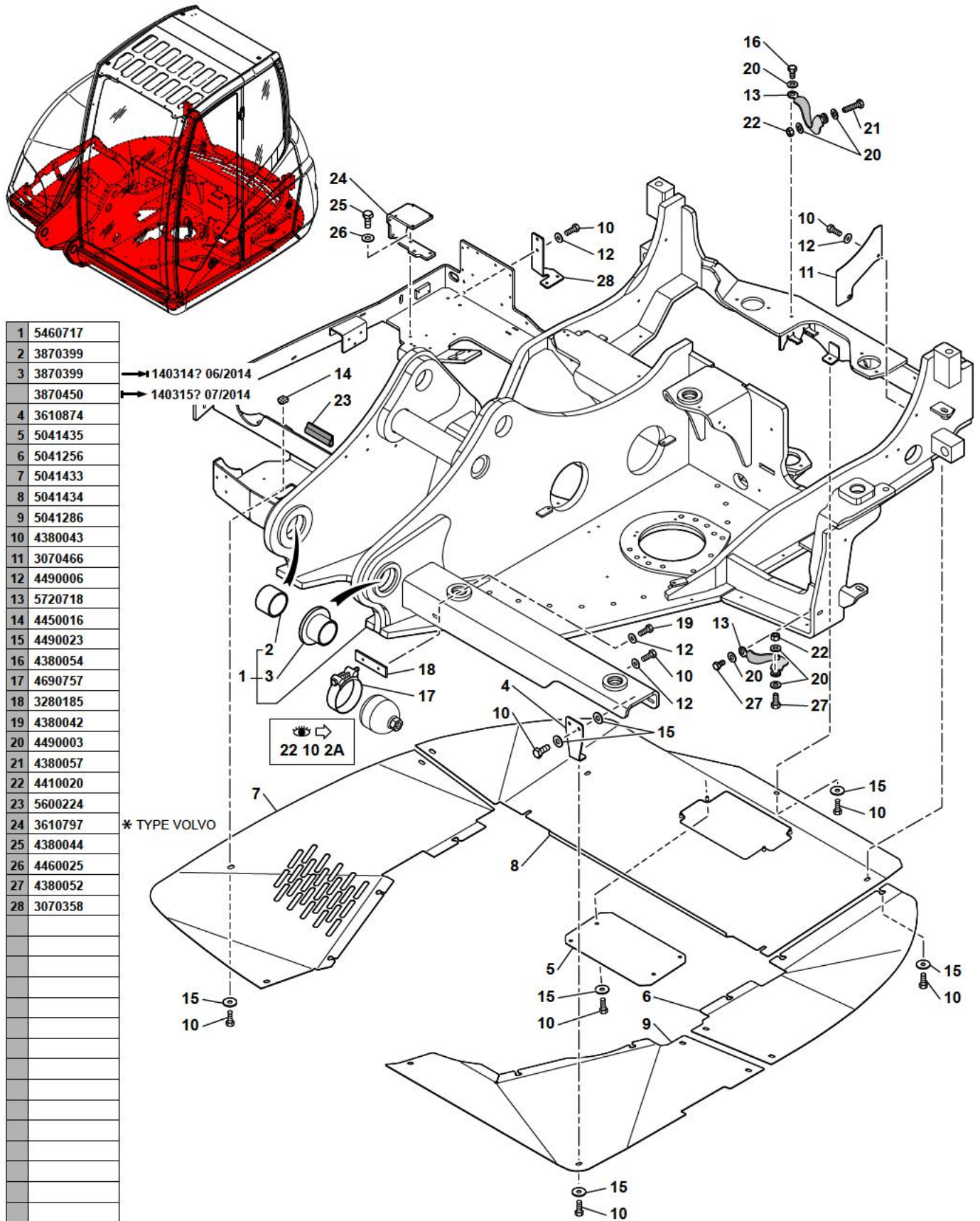

PLANCHER CABINE
 CAB FLOOR
 KABINENBODEN

1	3833315
2	4300075
3	3350124
4	4490006
5	3611017
6	4300069
7	5140587
8	4380068
9	4490019
10	3070054
11	5640832
12	3832700
13	3832693
14	3832701
15	3610419
16	3610418
17	4380042
18	4450026
19	4490014
20	4420022
21	5640831
22	4380044
23	4290184
24	4380043
25	4450019
26	5500107
27	5500104
28	5041082
29	3610998
30	4690993
31	4690451
32	5041401
33	4370138
34	5180137
35	3833270
36	4370152
37	4450014
38	4490008
39	3832616
40	5540122
41	3833318
42	4290017
43	4380037

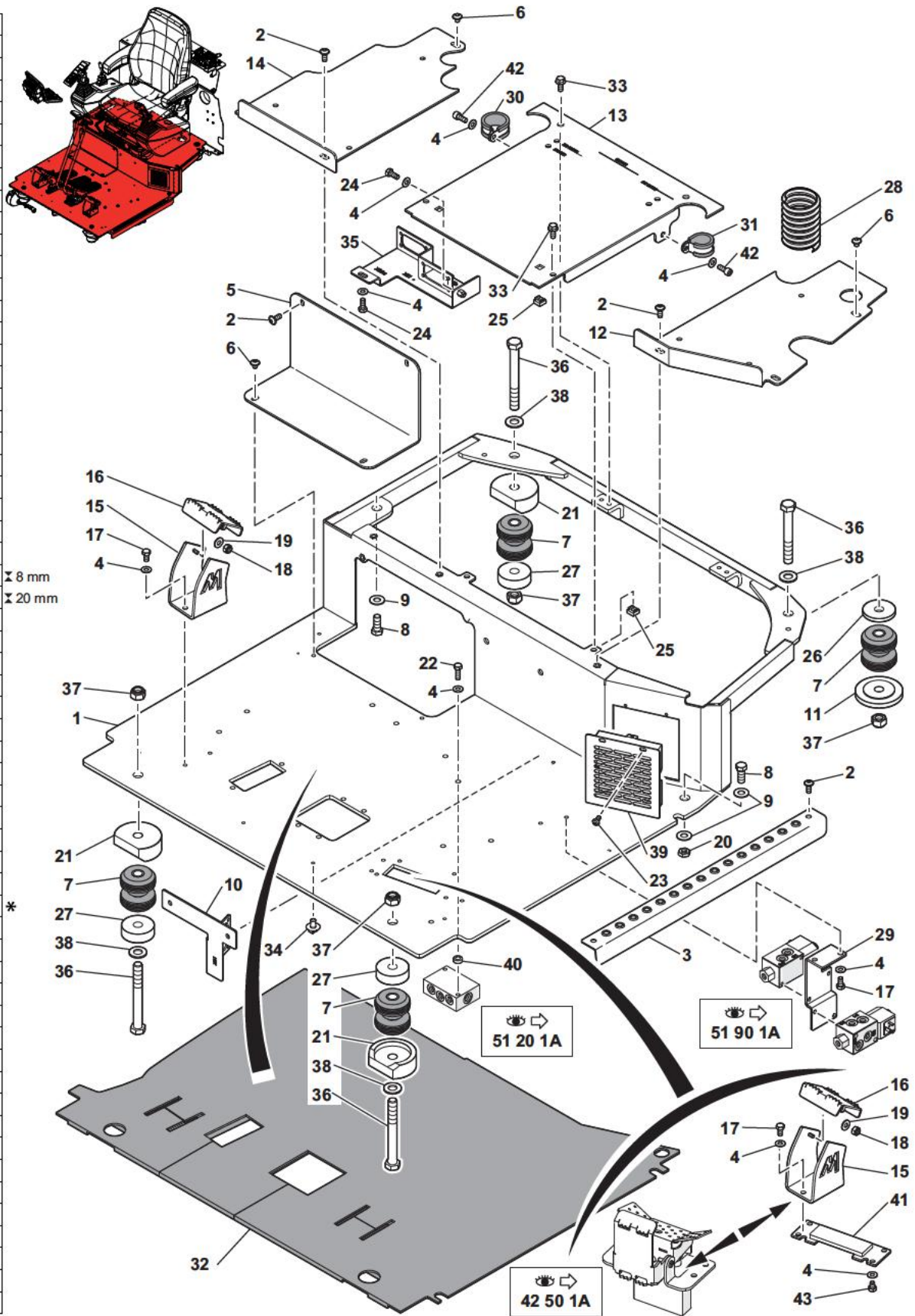

BRIDES / ÉQUIPEMENT
 FLANGES / ATTACHMENT
 FLANCH / ANBAU

1	4691204
2	4691205
3	4460034
4	4380025
5	4300042
6	4410020
7	4490003
8	4691209
9	4380048
10	4691274
11	3320101
12	4300044
13	4691318
14	3280471
15	4290037
16	4290159
17	4490014
18	3280489
19	3280448
20	4460025
21	4691208
22	4300058
23	4410016
24	4490006
25	4691212
26	3280491
27	4380056
28	4691214
29	4300064
30	4690458
31	4380037
32	4691295
33	4290019
34	3280177
35	4290009
36	4690454
37	3280173
38	4290008
39	3280447
40	2360064
41	4690608
42	3280449
43	3610905
44	3610904
45	4691211
46	3280450
47	4691269

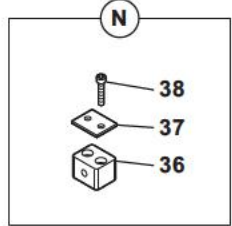
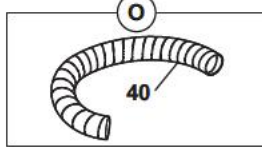
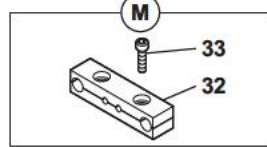
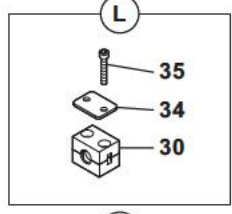
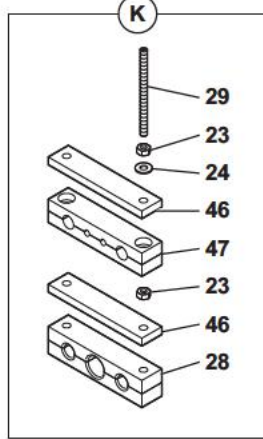
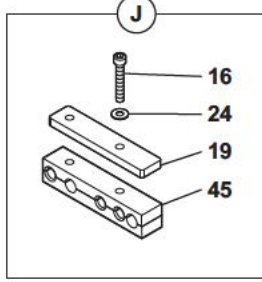
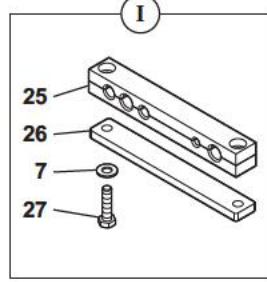
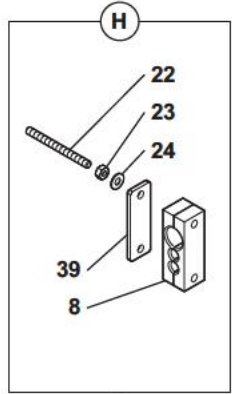
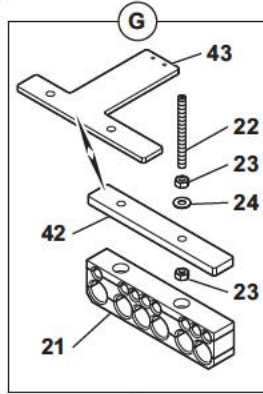
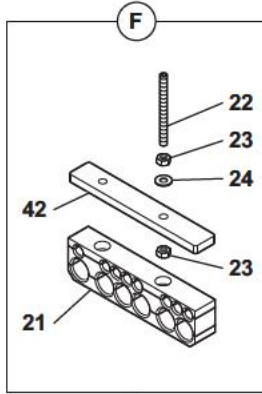
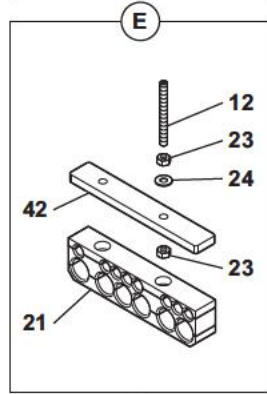
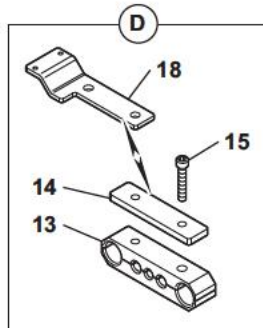
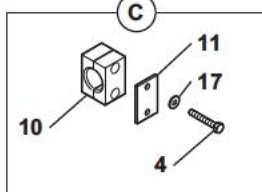
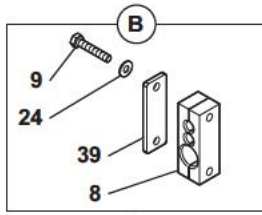
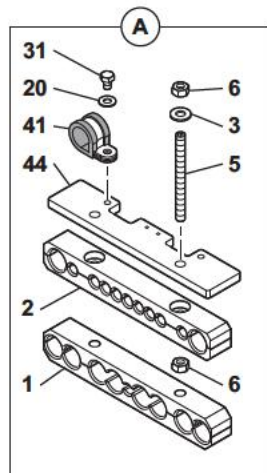
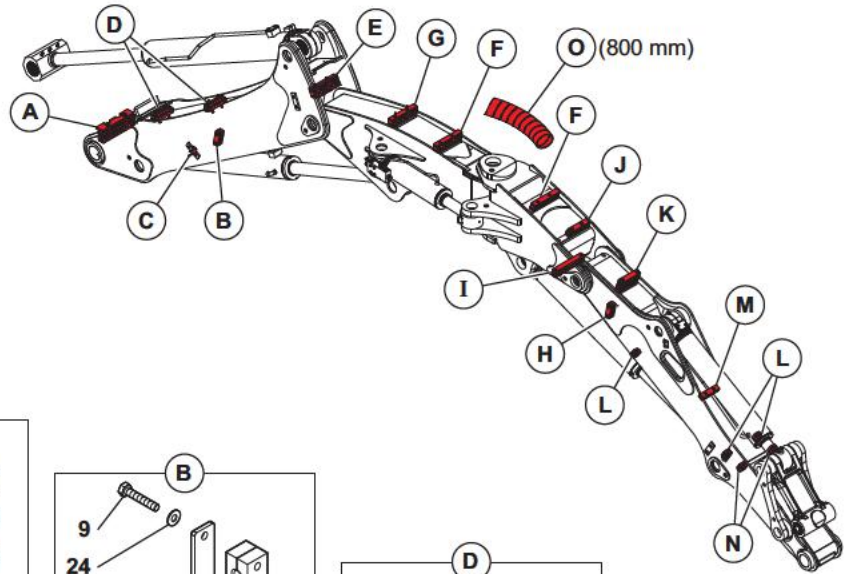

BRIDES / EQUIPEMENT (PORTE-OUTILS LEHNHOFF)
FLANGES / ATTACHMENT (TOOLS-HOLDER LEHNHOFF)
FLANCH / ANBAU (WERKZEUGETRAGER LEHNHOFF)

* 1	4380034	H M6X30	2	VIS	SCREW	SCHRAUBE
* 2	3280188		2	PLAQUE	PLATE	PLATTE
* 3	4690591		2	BRIDE	FLANGE	FLANSCH

FAISCEAU ELECTRIQUE : TOURELLE
 HARNESS WIRING: TOWER
 KABELSATZ: OBERWAGEN

* 45	5090169	1		7	COSSE	THIMBLE	KABELSCHUH
* 46	5080779	1		1	CAPOT	HOOD	HAUBE
* 47	5080987	1		1	CONNECTEUR	CONNECTOR	STECKVERBINDER
* 48	5080988	1		1	CAPOT	HOOD	HAUBE
* 49	5080989	1		1	VERROU	LATCH	RIEGEL
* 50	5080990	1		1	VERROU	LATCH	RIEGEL
* 51	5080991	1		1	VERROU	LATCH	RIEGEL
* 52	5090216	1		6	CONTACT	CONTACT	KONTAKT
* 53	5090218	1		42	CONTACT	CONTACT	KONTAKT
* 54	5090244	1		11	CONTACT	CONTACT	KONTAKT
* 55	5080983	1		1	CONNECTEUR	CONNECTOR	STECKVERBINDER
* 56	5080984	1		1	CAPOT	HOOD	HAUBE
* 57	5080985	1		1	VERROU	LATCH	RIEGEL
* 58	5080986	1		1	VERROU	LATCH	RIEGEL
* 59	5080786	1		1	CONNECTEUR	CONNECTOR	STECKVERBINDER
* 60	5080104	1		1	CONNECTEUR	CONNECTOR	STECKVERBINDER
* 61	5090106	1	1 mm ²	12	PIN	PINE	PIN
* 62	5081035	1		7	BOUCHON	PLUG	VERSCHL.STOPFEN

FAISCEAU ELECTRIQUE : ALARME TRANSLATION
HARNESS WIRING: ALARM TRANSLATION
KABELSATZ: FAHRBEWEGUNGALARM

* 1 5721416			1 FAISCEAU ELECTRIQUE	HARNESS WIRING	KABELSATZ
* 2 5080095	1		1 CONNECTEUR	CONNECTOR	STECKVERBINDER
* 3 5080096	1		1 VERROU	LATCH	RIEGEL
* 4 5090108	1	1 mm ²	4 SOCKET	SOCKET	SOCKET

SIGNALISATION ARRIÈRE
 REAR SIGNAL LIGHT
 SIGNALSYSTEM HINTER

* 1	3350169		1	SUPPORT	BRACKET	TRAEGER
* 2	4450026	NYLSTOP M6	6	ECROU	NUT	MUTTER
* 3	5130112		1	AVERTISSEUR REcul	BACK-UP WARNING UNIT	RUCK FAHRMELDER
* 4	4490014	CONTACT MU6	21	RONDELLE	WASHER	UNTERLEGSCHIEBE
* 5	4380032	H M6X20	2	VIS	SCREW	SCHRAUBE
* 6	3832969		1	SUPPORT	BRACKET	TRAEGER
* 7	4290001	CHC M5X20	3	VIS	SCREW	SCHRAUBE
* 8	5090107	2 mm ²	2	PIN	PINE	PIN
* 9	4380030	H M6X12	2	VIS	SCREW	SCHRAUBE
* 10	4410013	H M6	5	ECROU	NUT	MUTTER
* 11	3350222		1	SUPPORT	BRACKET	TRAEGER
* 12	5170195		1	FEU DE PLAQUE	NUMBER PLATE LIGHT	KENNZEICHENLEUCHT
* 13	4240002	FHC M6X16	3	VIS	SCREW	SCHRAUBE
* 14	5050028	12 V - 5 W	1	AMPOULE	BULB	GLUEHLAMPE
* 15	5170194		2	FEU ARRIERE	REAR LIGHT	HINTERLEUCHTE
* 16	4410010	H M5	9	ECROU	NUT	MUTTER
* 17	4490016	CONTACT MU5	12	RONDELLE	WASHER	UNTERLEGSCHIEBE
* 18	3832952		1	SUPPORT	BRACKET	TRAEGER
* 19	3832953		1	SUPPORT	BRACKET	TRAEGER
* 20	4290007	CHC M6X20	6	VIS	SCREW	SCHRAUBE
* 21	5080097		1	CONNECTEUR	CONNECTOR	STECKVERBINDER
* 22	5080098		1	VERROU	LATCH	RIEGEL
* 23	5041437		1	GAINE	SHEATH	HUELLE

CLICK HERE TO **DOWNLOAD** THE COMPLETE MANUAL

- Thank you very much for reading the preview of the manual.
- You can download the complete manual from: www.heydownloads.com by clicking the link below



- Please note: If there is no response to CLICKING the link, please download this PDF first and then click on it.

CLICK HERE TO **DOWNLOAD** THE COMPLETE MANUAL