



READ THIS MANUAL CAREFULLY!
It contains important safety information.

OWNER'S MANUAL

**RAPID
700R**

YFM700RV

WARNING

This ATV should not be ridden by anyone under 16 years of age.

LIT-11626-19-59

1S3-28199-11

CLICK HERE TO **DOWNLOAD** THE COMPLETE MANUAL

- Thank you very much for reading the preview of the manual.
- You can download the complete manual from: www.heydownloads.com by clicking the link below



- Please note: If there is no response to CLICKING the link, please download this PDF first and then click on it.

CLICK HERE TO **DOWNLOAD** THE COMPLETE MANUAL

Read and understand all of the labels on your machine. They contain important information for safe and proper operation of your ATV.

Never remove any labels from your ATV. If a label becomes difficult to read or comes off, a replacement label is available from your Yamaha dealer.

①

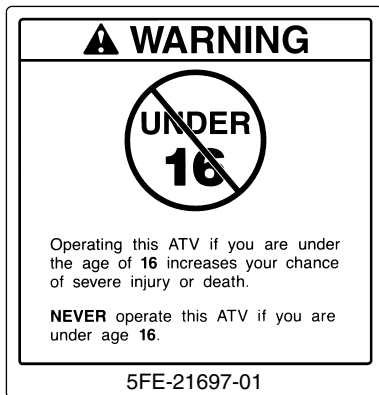

②



1

Identification number records

Record the key identification number, vehicle identification number and model label information in the spaces provided for assistance when ordering spare parts from a Yamaha dealer or for reference in case the vehicle is stolen.

1. KEY IDENTIFICATION NUMBER:

2. VEHICLE IDENTIFICATION NUMBER:

3. MODEL LABEL INFORMATION:

Key identification number

The key identification number is stamped on the key as shown in the following illustration. This number can be used for ordering a new key.

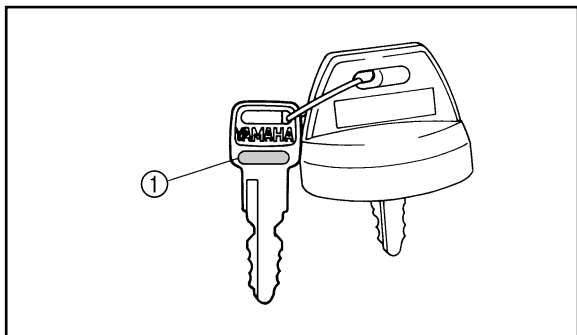

1. Key identification number

Brake pedal

The brake pedal is located on the right side of the machine. Push down on the pedal to apply the rear brake.

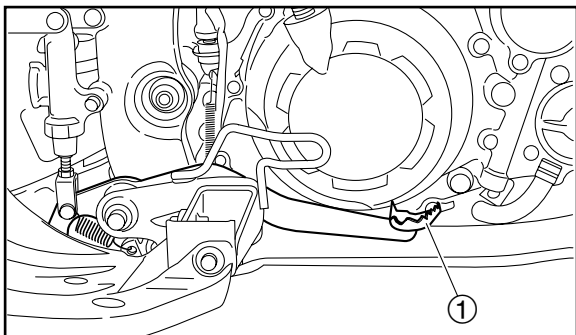

1. Brake pedal

CAUTION: _____

Never turn an adjusting mechanism beyond the minimum and maximum settings.

NOTE: _____

Although the total number of clicks of a damping force adjusting mechanism may not exactly match the above specifications due to small differences in production, the actual number of clicks always represents the entire adjusting range. To obtain a precise adjustment, it would be advisable to check the number of clicks of each damping force adjusting mechanism and to modify the specifications as necessary.

 **WARNING****POTENTIAL HAZARD**

Suspension components become hot during operation.

WHAT CAN HAPPEN

You could be burned.

HOW TO AVOID THE HAZARD

Never touch the compression damping adjuster, rebound damping adjuster or oil reservoir with your bare hand or skin until suspension components have cooled.

EBU01120

 **WARNING**

Indicates a potential hazard that could result in serious injury or death.

EBU01600

Tire wear limit

When the tire groove decreases to 3 mm (0.12 in) due to wear, replace the tire.

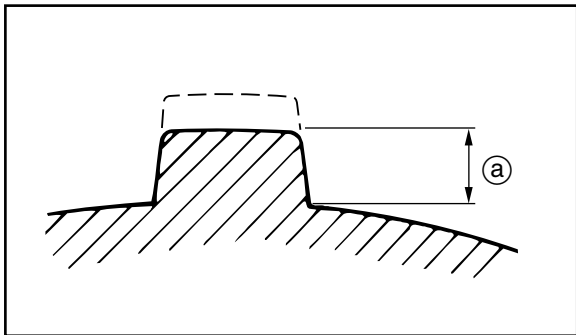

a. Tire wear limit

EBU11620

Fittings and fasteners

Always check the tightness of chassis fittings and fasteners before a ride. Take the machine to a Yamaha dealer or refer to the Service Manual for correct tightening torque.

EBU10030

Lights

Check the headlights and tail/brake light to make sure they are in working condition. Repair as necessary for proper operation.

EBU11700

Switches

Check the operation of all switches. Have a Yamaha dealer repair as necessary for proper operation.

Accessories and loading

Accessories

Accessories can affect the handling and control of your ATV. Keep the following in mind when considering an accessory or operating an ATV which has accessories.

- Choose only accessories designed for your ATV. Your Yamaha dealer has a variety of genuine Yamaha accessories. Other accessories may also be available on the market. However, it is not possible for Yamaha to test all non-Yamaha accessories, nor have any control over the quality or suitability of them. Choose a genuine Yamaha accessory, or one that is equivalent in design and quality.
- Accessories should be rigidly and securely mounted. An accessory which can shift position or come off while you are riding could affect your ability to control the ATV.
- Do not mount an accessory where it could interfere with your ability to control the ATV. Examples include (but are not limited to) a heavy or bulky object attached to the handlebars which could make steering difficult, an accessory that limits your ability to move around on the seat, or one that limits your view.
- Use extra caution when riding an ATV with accessories. The ATV may handle differently than it does without accessories.

Do not operate after consuming alcohol or drugs.

Operator's performance capability is reduced by the influence of alcohol or drugs.



⚠ WARNING

POTENTIAL HAZARD

Operating this ATV after consuming alcohol or drugs.

WHAT CAN HAPPEN

**Could seriously affect your judgment.
Could cause you to react more slowly.
Could affect your balance and perception.
Could result in an accident.**

HOW TO AVOID THE HAZARD

Never consume alcohol or drugs before or while driving this ATV.

Know the terrain where you ride. Ride cautiously in unfamiliar areas. Stay alert for **holes, rocks, or roots** in the terrain, and **other hidden hazards** which may cause the ATV to upset.

WARNING

POTENTIAL HAZARD

Failure to use extra care when operating this ATV on unfamiliar terrain.

WHAT CAN HAPPEN

You can come upon hidden rocks, bumps, or holes, without enough time to react. Could result in the ATV overturning or going out of control.

HOW TO AVOID THE HAZARD

Go slowly and be extra careful when operating on unfamiliar terrain. Always be alert to changing terrain conditions when operating the ATV.

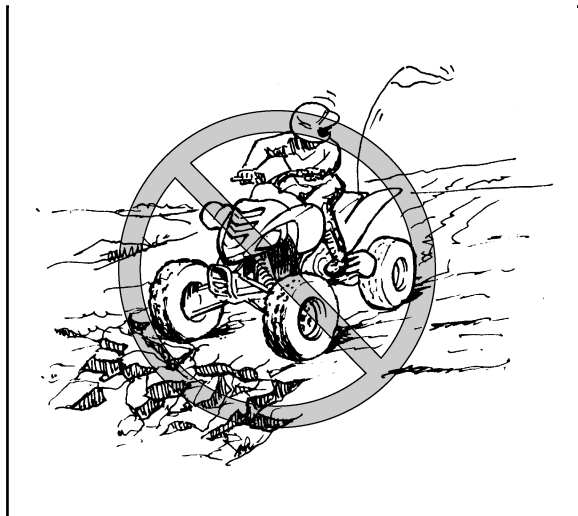

CLICK HERE TO **DOWNLOAD** THE COMPLETE MANUAL

- Thank you very much for reading the preview of the manual.
- You can download the complete manual from: www.heydownloads.com by clicking the link below



- Please note: If there is no response to CLICKING the link, please download this PDF first and then click on it.

CLICK HERE TO **DOWNLOAD** THE COMPLETE MANUAL

If your ATV has stalled or stopped and you believe you can continue up the hill, restart carefully to make sure you do not lift the front wheels which could cause you to lose control. If you are unable to continue up the hill, dismount the ATV on the uphill side. Physically turn the ATV around and then descend the hill.

If you start to roll backwards, DO NOT use the rear brake to stop or try to put the ATV in gear. The ATV could easily tip over backwards. Instead, apply the front brake gradually, or dismount the ATV immediately on the uphill side.

WARNING

POTENTIAL HAZARD

Stalling, rolling backwards or improperly dismounting while climbing a hill.

WHAT CAN HAPPEN

Could result in the ATV overturning.

HOW TO AVOID THE HAZARD

Use proper gear and maintain steady speed when climbing a hill.

If you lose all forward speed:

Keep weight uphill.

Apply the brakes.

Lock the parking brake, after you are stopped.

If you begin rolling backwards:

Keep weight uphill.

Never apply the rear brake while rolling backwards.

Apply the front brake.

SLIDING AND SKIDDING

Care should be used when riding on loose or slippery surfaces since the ATV may slide. If unexpected and uncorrected, sliding could lead to an accident.

To reduce the tendency for the front wheels to slide in loose or slippery conditions, positioning your weight over the front wheels will sometimes help.

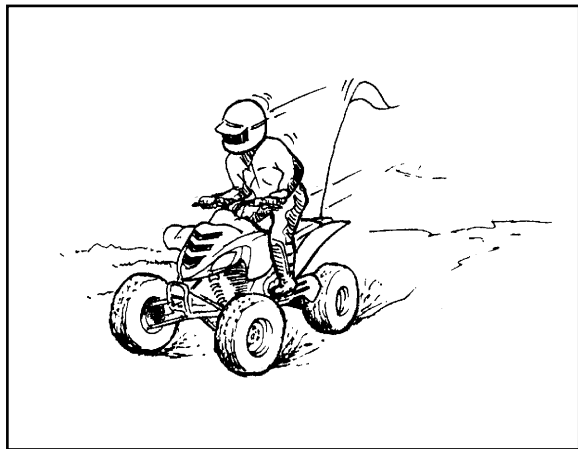

If the rear wheels of your ATV start to slide sideways, control can usually be regained (if there is room to do so) by steering in the direction of the slide. Applying the brakes or accelerating is not recommended until you have corrected the slide.

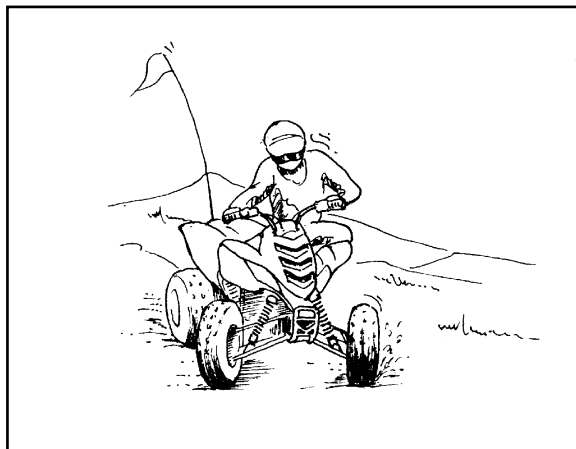

Panel removal and installation

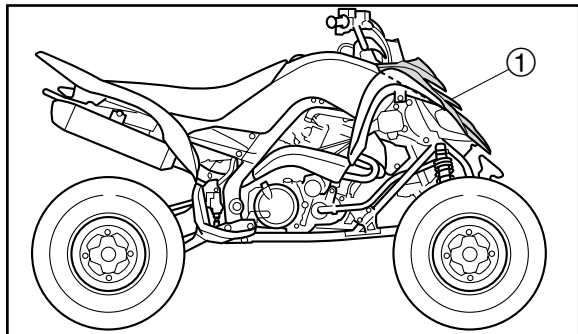

1. Panel A

The panel illustrated needs to be removed to perform some of the maintenance described in this chapter.

Refer to this section each time the panel has to be removed or installed.

Panel A

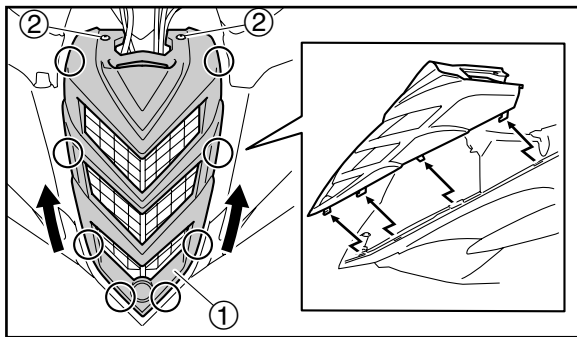

1. Panel A

2. Bolt (× 2)

To remove

Remove the bolts, and then take the panel off.

To install

Place the panel in the original position, and then install the bolts.

Spark plug inspection

Removal

1. Remove the spark plug cap.

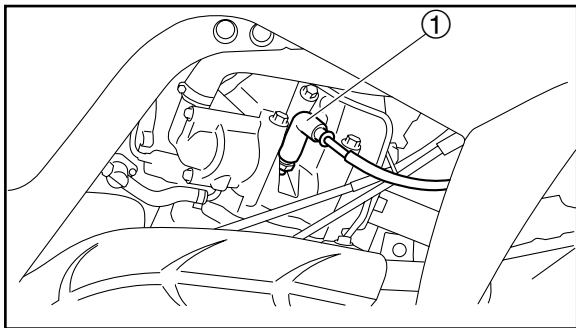

1. Spark plug cap

2. Use the spark plug wrench in the owner's tool kit to remove the spark plug as shown.

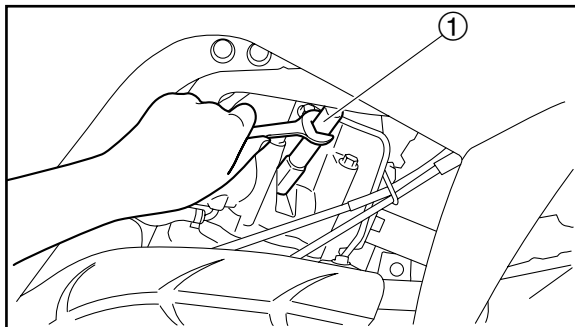

1. Spark plug wrench

Front and rear brake pad inspection

Each brake pad is provided with a wear indicator groove. The indicator grooves allow checking of brake pad wear without disassembling the brake. Apply the brake and inspect the wear indicator grooves. If a brake pad is worn to the point that the wear indicator grooves are almost in contact with the disc plate, ask a Yamaha dealer to replace the brake pads as a set.

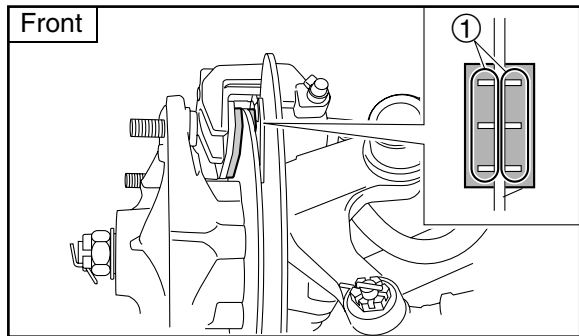

1. Wear indicator groove

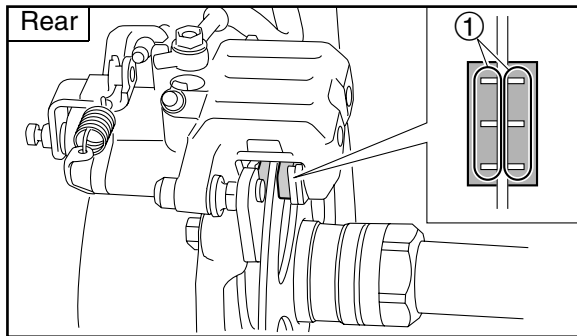

1. Wear indicator groove

6. Loosen the locknut at the crankcase side.
7. Turn the adjusting nut at the crankcase in direction (a) to increase the free play or in direction (b) to decrease the free play.
8. Tighten the locknut at the crankcase and the clutch lever.

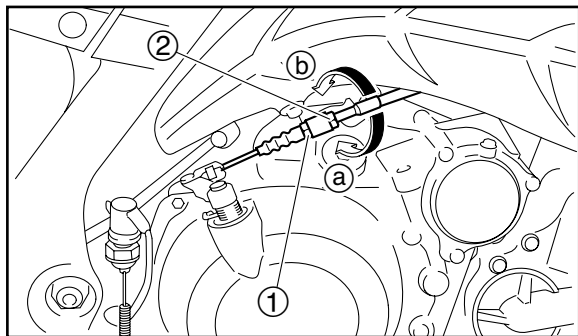

1. Locknut

2. Adjusting nut

Wheel installation

When installing the wheel, reverse the removal procedure.

NOTE:

The arrow mark  on the tire must point toward the rotating direction of the wheel.

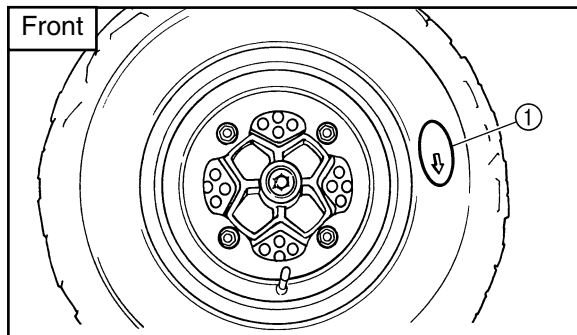

1. Arrow mark

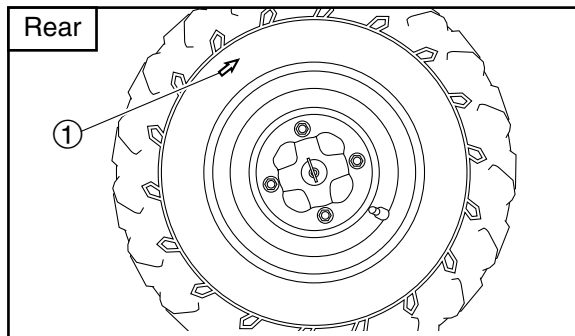

1. Arrow mark

Tighten the wheel nuts to the specified torque.

Wheel nut torque:

Front: 45 Nm (4.5 m·kgf, 33 ft·lbf)

Rear: 45 Nm (4.5 m·kgf, 33 ft·lbf)

Troubleshooting charts

Starting problems or poor engine performance

1. Fuel

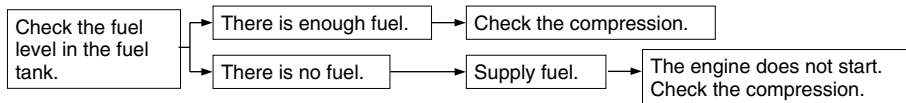

2. Compression



3. Ignition

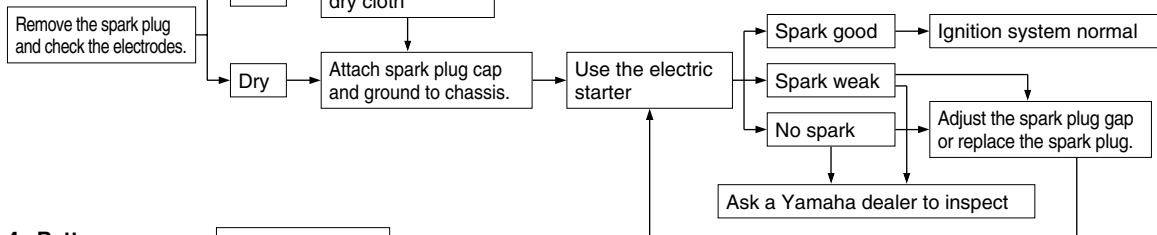

4. Battery

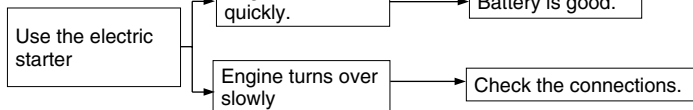

Model	YFM700R
Brake: Front brake type operation Rear brake type operation	Dual disc brake Right hand operation Single disc brake Right foot operation
Suspension: Front suspension Rear suspension	Double wishbone Swingarm (link suspension)
Shock absorber: Front shock absorber Rear shock absorber	Coil spring/Oil damper Coil spring/Gas-Oil damper
Wheel travel: Front wheel travel Rear wheel travel	230.0 mm (9.06 in) 256.0 mm (10.08 in)
Electrical: Ignition system Generator system Battery type/voltage capacity	Transistorized coil ignition (digital) A.C. magneto GT9B-4/12V, 8.0 Ah
Headlight type:	Krypton bulb

CLICK HERE TO **DOWNLOAD** THE COMPLETE MANUAL

- Thank you very much for reading the preview of the manual.
- You can download the complete manual from: www.heydownloads.com by clicking the link below



- Please note: If there is no response to CLICKING the link, please download this PDF first and then click on it.

CLICK HERE TO **DOWNLOAD** THE COMPLETE MANUAL