



Owner's Handbook



CLICK HERE TO **DOWNLOAD** THE COMPLETE MANUAL

- Thank you very much for reading the preview of the manual.
- You can download the complete manual from: www.heydownloads.com by clicking the link below



- Please note: If there is no response to CLICKING the link, please download this PDF first and then click on it.

CLICK HERE TO **DOWNLOAD** THE COMPLETE MANUAL

HOW THE AIRBAG SRS WORKS	40
CHILD SEATS	42
SERVICE INFORMATION	42

Steering Column

STEERING COLUMN ADJUSTMENT	44
--------------------------------------	----

Door Mirrors

EXTERIOR MIRRORS	45
----------------------------	----

Instruments

INSTRUMENT PANEL	46
PANEL ILLUMINATION	47

Warning Lights

INSTRUMENT PANEL	48
----------------------------	----

Audible Warnings

AUDIBLE WARNINGS	53
----------------------------	----

Lights & Indicators

DIRECTION INDICATORS	54
LIGHTS	54
FOG LIGHTS	55
HAZARD WARNING LIGHTS	56

Wipers & Washers

OPERATING	57
WINDSCREEN WIPERS	57
WINDSCREEN WASHER	58
HEADLIGHT WASHERS	58
REAR WINDOW WIPER AND WASHER	59

Horn

HORN	60
----------------	----

Electric Windows

ELECTRIC WINDOWS	61
----------------------------	----

Sunroof

ELECTRIC SUNROOF	62
----------------------------	----

Air Conditioning

VENTILATION	64
AIR CONDITIONING CONTROLS	65
GENERAL NOTES	68

Heated Screens

HEATED FRONT SCREEN AND REAR WINDOW	69
---	----

Interior Equipment

FRONT INTERIOR & LOADSPACE LIGHTS	70
REAR INTERIOR LIGHTS	70
GLOVEBOX LIGHT	70
CLOCK	71
COIN TRAY	71
CIGAR LIGHTER	72
ASHTRAYS	72
UNDER SEAT STOWAGE BOX	73
AUXILIARY POWER SOCKET	74
CUP HOLDERS	74
CUBBY BOX	75
SUN VISOR VANITY MIRROR ILLUMINATION	75

Interior Mirror & Compass

INTERIOR REAR-VIEW MIRROR	76
COMPASS FUNCTION	76
COMPASS ZONES	78

Rear Step

REAR STEP	80
---------------------	----

Loadspace Cover

LOADSPACE COVER	81
---------------------------	----

In-Car Telephones

IN-CAR TELEPHONES	82
-----------------------------	----

In-Car Entertainment

RADIO AERIAL	83
IN-CAR ENTERTAINMENT	83
HEADPHONE CONTROLS	83
RADIO REMOTE CONTROLS	84

Locks & Alarm

CHILD-PROOF LOCKS

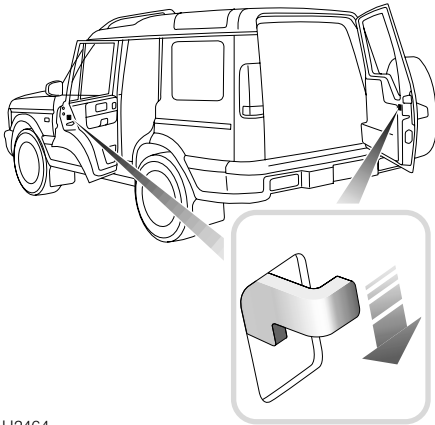

H2464

Move the locking levers on the rear doors and taildoor down to engage the child locks.

With the child-proof locks engaged, neither the rear doors nor the taildoor can be opened from inside the vehicle, thereby avoiding the risk of a door being opened accidentally while the vehicle is moving.

WARNING

TO AVOID INJURY OR DEATH, NEVER LEAVE CHILDREN UNSUPERVISED IN THE VEHICLE.

DOOR LOCKING CUT-OFF SWITCH

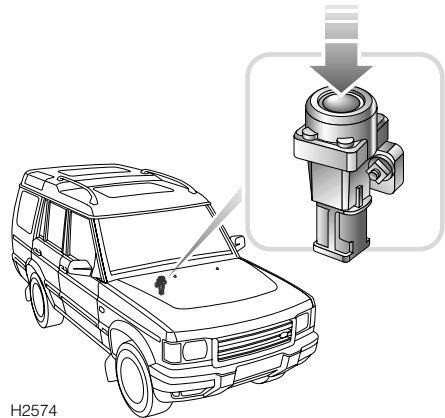

H2574

An inertia switch, operational only with the starter switch in position 'II' and the alarm disarmed, prevents the doors centrally locking (or if the doors are locked, will unlock them) in the event of an accident or sudden impact.

When the switch operates, the direction indicator lights flash (if market permits), until the system is reset by turning the starter switch on and off, and opening and closing the driver's door.

Note that doors cannot be locked again until the switch is reset. The inertia switch also cuts off the fuel supply (see 'FUEL CUT-OFF SWITCH', page 97).

WARNING

Always check for fuel leaks before resetting the switch!

Activating the switch when the fuel system has been damaged (evidenced by fuel leakage or fuel odor) will cause additional fuel leakage increasing the risk of fire and personal injury.

Seat Belts

SEAT BELT SAFETY

WARNING

Seat belts are life saving equipment. In a collision, occupants not wearing a seat belt will be thrown around inside, or possibly thrown out of the vehicle. This is likely to result in more serious injuries than would have been the case had a seat belt been worn. It may even result in loss of life!

Don't take chances with safety!

- *DO make sure ALL occupants are securely strapped in at all times - even for the shortest journeys.*
 - *The airbag supplemental restraint system (SRS) is designed to add to the overall effectiveness of the seat belts. It does not replace them. SEAT BELTS MUST ALWAYS BE WORN!*
 - *Ensure that all seat belts are worn correctly - an improperly worn seat belt increases the risk of death or serious injury in the event of a collision.*
 - *DO use the seat belts to secure items of luggage that are to be carried on the seats - in the event of an accident, loose items become flying missiles capable of causing serious injury, or even death.*
-

WARNING

- *DO NOT fit more than one person into a belt; this could result in the occupants striking each other and causing injury in the event of a crash.*
 - *DO NOT use, or attempt to fit, a seat belt that is twisted or obstructed in any way that could impede its smooth operation. If a belt is twisted, it must be straightened before use. Using a twisted or obstructed seat belt could increase the risk of injury in a crash.*
 - *ALWAYS use the seat belt lock (buckle) nearest the wearer. If the belt is locked in the wrong place, the seat belt will not fit correctly and may ride up over the abdomen, causing serious internal injury in a crash.*
-

Airbag SRS

Seating positions

In order to provide optimum protection in the event of a severe impact, it is necessary for the airbags to deploy with considerable speed.

An inflating airbag can cause facial abrasions and other injuries if the occupant is too close to the airbag at the time of its deployment.

WARNING

- ***To minimize the risk of accidental injury from inflating airbags, seat belts should be correctly worn at all times. In addition, both driver and front seat passenger should adjust their seat to provide the maximum practical distance from the airbags.***
 - ***Occupants not seated correctly in allocated seats are subject to serious injury or death upon airbag deployment.***
 - ***Both front seating positions are equipped with knee bolsters to provide knee protection in the event of an impact. DO NOT modify the bolsters, or mount after market equipment on or behind them.***
-

HOW THE AIRBAG SRS WORKS

In the event of a collision, the airbag control unit monitors the rate of deceleration or acceleration induced by the collision, to determine whether the airbags should be deployed.

Operation of the airbag SRS is dependent entirely on the rate at which the vehicle's passenger compartment changes speed as a result of a collision. The circumstances affecting different collisions (vehicle speed, angle of impact, type and size of object hit, for example), vary considerably and will affect the rate of acceleration or deceleration accordingly.

NOTE: *The SRS/airbag is not designed to activate in all frontal impacts; most minor frontal impacts, heavy braking and driving over pot holes will not result in sufficient deceleration to cause the airbags to inflate. This does not indicate that there is a fault with the system. However, if as a result of an impact, you believe the airbags should have deployed and they failed to do so, please call 1(800)637-6837 for advice, or to arrange for a Land Rover representative to inspect the vehicle to determine whether the system operated correctly.*

It follows, therefore, that significant superficial damage can occur without the airbags deploying or, conversely, that a relatively small amount of structural damage may cause the airbags to be deployed.

Airbags will only deploy when they are required to supplement the restraining force of the seat belts.

In the case of a severe frontal collision, both front airbags and seat belt pre-tensioners will be deployed.

Warning Lights

Headlight high beam - BLUE



Illuminates when the headlights are switched to main beam.

Direction indicators - GREEN



The left or right warning light flashes in time with the corresponding left or right

direction indicator lights whenever they are operated. If the warning light fails to flash, or flashes very rapidly, this may indicate a bulb failure in one of the direction indicator lights.

If the hazard switch is pressed, both warning lights will flash in conjunction with the direction indicator lights.

Trailer direction indicators - GREEN



The light illuminates briefly as a bulb check when the starter switch is turned to position 'II'. If a trailer

is attached, the light illuminates in conjunction with the vehicle direction indicator lights to show that all trailer indicator lights are functioning correctly. In the event of a bulb failure on the trailer, the warning light remains off.

Seat belt - RED



The light illuminates when the starter switch is turned to position 'II' and extinguishes after

approximately 6 seconds, even if the driver's seat belt remains unfastened. In some markets illumination of the light will be accompanied by a warning chime (see 'AUDIBLE WARNINGS', page 53)

Differential lock - RED



Illuminates whenever the differential is locked.

While carrying out maintenance operations on your vehicle, it may be necessary for the dealer to lock the differential between the front and rear axles. This will cause the warning light to illuminate.

The dealer should always unlock the differential before returning the vehicle to the owner. However, if the light illuminates when the starter switch is turned on, this indicates that this has not been done. The vehicle should not be driven in this condition because ABS performance will be impaired and Traction Control will be disabled. Contact your dealer immediately and ask for the differential to be unlocked.

Battery charging - RED



The light illuminates as a bulb check when the starter switch is turned to position 'II' and

extinguishes once the engine is running. If it remains on, or illuminates whilst driving, a fault is indicated. Seek qualified assistance urgently.

Off Road - AMBER*



Illuminates briefly as a bulb and system check when the starter switch is turned to position 'II' and then extinguishes.

If the off-road switch is pressed:

The light flashes continually while the rear of the vehicle is either; rising to off-road height, or returning to standard ride height. The light illuminates constantly while the suspension remains at off-road height.

In addition, the light will flash if extended mode is induced.

Horn

HORN

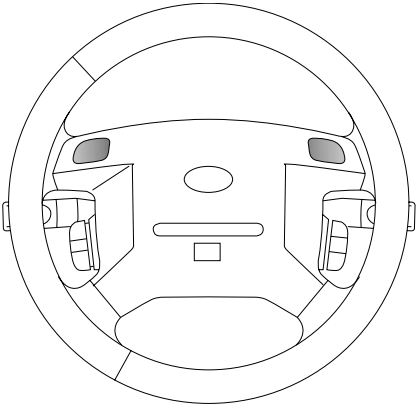

H2586

To operate, press either of the horn switches set in the steering wheel pad.

Interior Equipment

FRONT INTERIOR & LOADSPACE LIGHTS

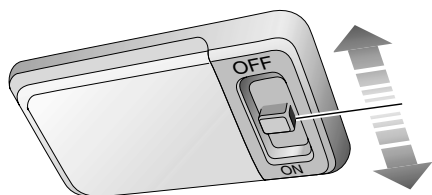

H2592

Switch positions:

- 'OFF' - Light permanently off.
- 'ON' - Light illuminates continuously.

With the switch in the centre position, the interior light illuminates automatically whenever the vehicle is unlocked, when the starter switch is turned off (to position '0'), or when a door or taildoor is opened. The light remains illuminated for 15 seconds after the doors and taildoor are closed, or until the starter switch is turned on.

After driving, the interior lights will fade and then extinguish as soon as the vehicle is locked or when the last door is closed.

NOTE: When the light is switched for automatic operation (switch in centre position), a 'time-out' function extinguishes the lights after 8 minutes approx. if a door is left open, to prevent the battery from discharging.

REAR INTERIOR LIGHTS

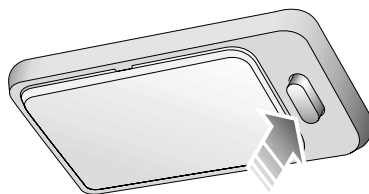

H2593

Press the switch to illuminate (or extinguish) the lights manually.

Lights illuminate automatically when the vehicle is unlocked or whenever a door or taildoor is opened, and extinguish approximately 15 seconds after ALL the doors are closed, or as soon as the starter switch is turned on.

GLOVEBOX LIGHT

Illuminates automatically whenever the glovebox is opened, provided the sidelights are switched on, and extinguishes when the glovebox is closed.

Rear Step

REAR STEP*



H2482

Press down with your foot to lower the step.
The step will automatically return to its stowed
position after use.

Starting & Driving

Breaking-in

Proper breaking-in will have a direct bearing on the reliability and smooth running of your vehicle throughout its life.

In particular, the engine, gearbox, brakes and tyres need time to 'bed-in' and adjust to the demands of everyday motoring. During the first 500 miles (800 km), it is essential to drive with consideration for the running-in process and heed the following advice:

- LIMIT maximum road speed to 110 km/h or 3,000 rev/min. Initially, drive the vehicle on a light throttle and only increase engine speeds gradually once the breaking-in distance has been completed.
- DO NOT operate at full throttle or allow the engine to labour in any gear.
- AVOID fast acceleration and heavy braking except in emergencies.

Power assisted steering

The hydraulic power-assisted is progressively geared; when steering straight ahead gearing is relatively low, but becomes progressively higher as the steering wheel is turned.

NOTE: *Power assistance is dependent on the engine running. If the engine is not running, greater effort will be required to steer the vehicle.*

FUEL ECONOMY

Fuel consumption is influenced by two major factors:

- How your vehicle is maintained.
- How you drive your vehicle.

To obtain optimum fuel economy, it is essential that your vehicle is maintained in accordance with the manufacturer's service schedule.

Items such as the condition of the air cleaner element, tyre pressures and wheel alignment will have a significant effect on fuel consumption. But, above all, the way in which you drive is most important. The following hints may help you to obtain better value from your motoring:

- Avoid unnecessary, short, start-stop journeys.
- Avoid fast starts by accelerating gently and smoothly from rest.
- Do not drive in the lower gears for longer than necessary.
- Decelerate gently and avoid sudden and heavy braking.
- Anticipate obstructions and adjust your speed accordingly well in advance.
- When stationary in traffic, select neutral to improve fuel economy and air conditioning performance.

CLICK HERE TO **DOWNLOAD** THE COMPLETE MANUAL

- Thank you very much for reading the preview of the manual.
- You can download the complete manual from: www.heydownloads.com by clicking the link below



- Please note: If there is no response to CLICKING the link, please download this PDF first and then click on it.

CLICK HERE TO **DOWNLOAD** THE COMPLETE MANUAL

Automatic Transmission

MODE SWITCH

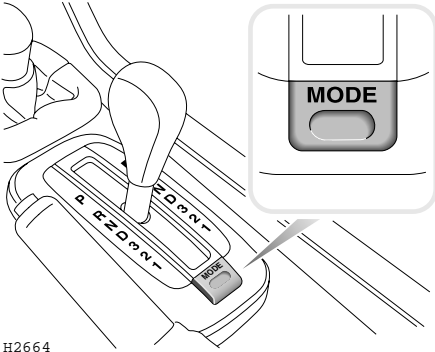

H2664

In High range press the mode switch to select 'Sport' mode (the 'S' information light on the instrument panel will illuminate).

In Low range press the mode switch to select 'Manual' mode (the 'M' information light will illuminate).

Press the switch a second time to return the gearbox to normal operation.

'Sport' mode

With 'Sport' mode selected, the gearbox is more responsive to accelerator pedal movement - downshifts occur earlier and upshifts are delayed to make optimum use of the engine's power while accelerating. Select 'Sport' when increased acceleration is required, or when negotiating long inclines or twisting roads. Note that driving in 'Sport' mode will increase fuel consumption.

'Manual' mode

In Low range, with 'Manual' mode selected, the automatic transmission functions as a manual gearbox requiring the driver to move the selector lever manually to change gear ('D' = 4th gear). Manual mode will provide maximum vehicle control and engine braking - ideal for use in severe off-road conditions. Note that 'kick-down' is disabled and that automatic downshifts will only occur to prevent the engine from stalling.

NOTE: Changing from high to low range on the transfer gearbox (or low to high range) will automatically cancel 'Sport' or 'Manual' mode..

Hill Descent Control

HDC fade-out

HDC fade-out gradually decreases the HDC brake intervention with the effect that the rate of hill descent will increase. If this occurs the HDC information light will flash and the warning chime will sound for the period that HDC takes to fade. HDC will be disabled completely once the descent is complete.

If required (eg. the angle of the descent levels out significantly), fade-out may be achieved deliberately by deselecting HDC while the system is operating.

If a fault with the HDC system is detected, or if the braking system reaches a pre-set temperature due to extreme conditions, HDC will automatically fade out.

Warning lights



HDC information light - GREEN

The light illuminates briefly as a bulb and system check when the starter switch is turned to position 'II' and also when HDC is selected.

If HDC is selected when the operating gears (LOW range) are engaged, the light will illuminate continuously.

If HDC has been selected but the system's operating criteria are not met (i.e. gearbox still in high range or vehicle speed too high), the information light will flash and the warning chime will sound continuously.

If the light flashes while HDC is active, normal functionality may cease and HDC 'fade out' may be induced.



HDC 'failure' light - AMBER

The light illuminates briefly as a bulb and system check when the starter switch is turned to position 'II'.

If the light illuminates at any other time, either a fault has occurred which affects the functionality of the system, or over-use of the system has been detected, in which case HDC may 'fade out'.

NOTE: System faults which cause the 'failure' light to illuminate after the initial system checks, or whilst driving, will be accompanied by the warning chime sounding 3 times.

Towing

TOWING WEIGHT CHART

Loading description	Suspension Type	Max. Trailer Weight	Tongue Weight	Max. Vehicle Weight
Trailer without brakes	All	1650 lb	115 lb	-
Trailer with brakes, off-road	All	2200 lb	155 lb	-
Trailer with brakes, on-road with vehicle at Gross Vehicle Weight	Coil spring	4410 lb	330 lb ⁽¹⁾	710 lb (equivalent to driver, three passenger's and 110 lb luggage) ⁽²⁾
	Self leveling	4410 lb	330 lb ⁽¹⁾	900 lb (equivalent to driver and five passenger's) ⁽²⁾
Maximum towing capacity on-road in high range ⁽³⁾	Coil spring	5500 lb	385 lb	450 lb (equivalent to driver and 2 passenger's)
	Self leveling	5500 lb	550 lb	600 lb (equivalent to driver and 3 passengers)
Maximum towing capacity on-road in low range ⁽³⁾	Coil spring	7700 lb	550 lb	450 lb (equivalent to driver and 2 passenger's)
	Self leveling	7700 lb	550 lb	600 lb (equivalent to driver and 3 passengers)
<p>⁽¹⁾ It is permissible to increase the tongue weight to a maximum of 550 lb, however the vehicle payload and rear axle loads must be reduced to keep within the GVW and maximum rear axle load.</p> <p>⁽²⁾ High and low gears may be used when loaded to these conditions, but changes between the two ranges should not be made while the vehicle is in motion.</p> <p>⁽³⁾ All occupants should be seated in the first and second row seats.</p>				

Driving Techniques

CLIMBING STEEP SLOPES

ALWAYS follow the fall line of the slope - traveling diagonally could encourage the vehicle to slide broadside down the slope.

Steep climbs will usually require the LOW gear range. If the surface is loose or slippery, use sufficient speed in the highest practical gear to take advantage of your vehicle's momentum. However, too high a speed over a bumpy surface may result in a wheel lifting, causing the vehicle to lose traction. In this case, try a slower approach. Traction can also be improved by easing off the accelerator just before loss of forward motion.

If the vehicle is unable to complete a climb, do not attempt to turn it around while on the slope. Instead, adopt the following procedure to reverse downhill to the foot of the slope.

1. Hold the vehicle stationary using both the foot and parking brakes.
2. Restart the engine if necessary.
3. Engage reverse ('R') and LOW range.
4. Select hill descent control (HDC).
5. Release the parking brake. Then release the foot brake and allow the vehicle to reverse down the slope using engine braking and HDC to control the rate of descent.
6. Unless it is necessary to stop the vehicle to negotiate obstructions, DO NOT apply the brake pedal during the descent - even a light application may cause the front wheels to lock, rendering the steering ineffective.
7. If the vehicle begins to slide, accelerate slightly to allow the tyres to regain grip.

When the vehicle is back on level ground or where traction can be regained, a faster approach will probably enable the hill to be climbed. However, DO NOT take unnecessary risks, if the hill is too difficult to climb, find an alternative route.

WARNING

DO NOT attempt to reverse down a slope without the engine running - HDC and the braking effect of the gearbox will be lost.

Engine Oil

DRAIN & REFILL

Ensure the engine oil is changed at the recommended service intervals as specified in the Passport to Service book.

NOTE: Under severe operating conditions (i.e. regular use in muddy terrain or dusty conditions), the engine oil must be changed more frequently, even to the extent of a daily change. Consult your Land Rover dealer for guidance.

Used engine oil

WARNING

Prolonged contact with used engine oil can cause serious skin disorders, including dermatitis and cancer of the skin. Wear protective clothing if possible and ALWAYS wash thoroughly after contact.



It is illegal to pollute drains, water courses or soil with toxic chemicals such as used engine oil. Use authorised waste disposal sites to dispose of used oil and toxic chemicals.

Drain

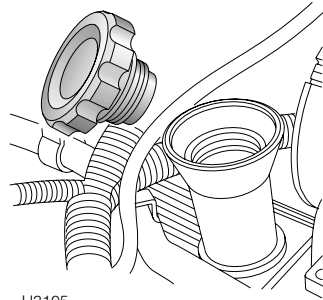

H3105

With the engine warm (to assist oil drainage) and the vehicle parked on firm, level ground, remove the filler cap and position a container of suitable size (at least 5.1 US quarts or 4.87 litres) under the drain plug, in the bottom of the sump.

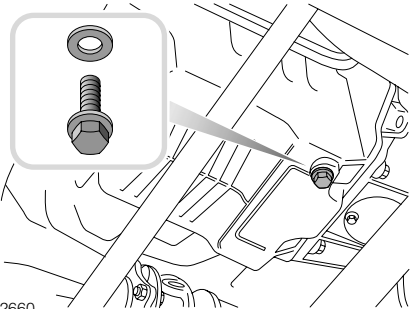

H2660

Remove the drain plug and copper washer and allow the engine oil to drain into the container.

WARNING

Oil from the engine can be very hot, to avoid harmful burns, take care when removing the drain plug.

Wiper Blades

WIPER BLADE REPLACEMENT

Front wiper blades

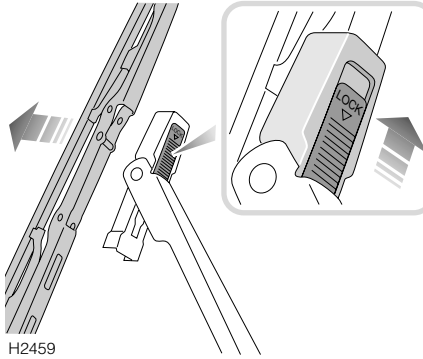

Lift the wiper arm away from the windshield. Disconnect the blade by pushing the locking tab (see inset in illustration) to the unlock position and slide upward.

Fitting a replacement blade is a reversal of this process. Check that the blade is securely locked before returning the wiper assembly to the windshield.

Only fit replacement wiper blades that are identical to the original specification.

Grease, silicone and petrol based products impair the blade's wiping capability. Wash the wiper blades in warm soapy water and periodically check their condition.

If signs of hardness or cracking in the rubber are found, or if the wipers leave streaks or unwiped areas on the windshield during use, then the wiper blades should be replaced.

Clean the windshield regularly with an approved glass cleaner and ensure the screen is thoroughly cleaned before fitting replacement wiper blades.

Rear wiper blades

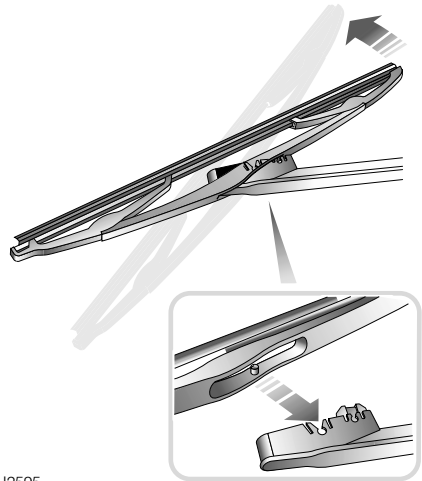

With the spare wheel removed from the taildoor, lift the wiper arm away from the rear screen. Pivot the blade assembly away from the arm (as arrowed), levering against resistance, until the two retaining lugs detach from their slots at the end of the arm. Carefully replace the arm to its stowed position.

To replace, position the wiper arm into the aperture in the middle of the blade assembly, line up the retaining lugs with the corresponding slots in the wiper arm and push firmly into position until the blade clips into place.

Cleaning & Vehicle Care

CLEANING THE INTERIOR

Plastic materials

Clean plastic-faced or cloth covered surfaces with diluted upholstery cleaner and wipe with a clean cloth.

NOTE: DO NOT polish fascia components - for safety, these should remain non-reflective.

Leather

Leather seats, steering wheel and trim features should be cleaned with a damp cloth moistened with undiluted upholstery cleaner. Leave for five minutes, and then repeat the operation using a clean cloth and water - but avoid flooding the area! Dry and polish the leather with a dry, lint-free cloth.

DO NOT use petrol, detergents, furniture creams or polishes!

Carpet and fabrics

Clean with diluted nylon upholstery cleaner - test on a concealed area first.

Instrument pack, clock and radio

Clean with a dry cloth only! DO NOT use cleaning fluids or sprays.

Seat belts

Extend the belts, then use warm water and a non-detergent soap to clean. Allow the belts to dry naturally, and do not retract them or use the vehicle until they are completely dry.

Airbag module covers

To prevent airbag SRS damage, the steering wheel centre pad and area of the fascia panel containing the passenger airbag should ONLY be cleaned sparingly with a damp cloth and upholstery cleaner.

DO NOT allow these areas to be flooded with liquid, and DO NOT use petrol, detergent, furniture cream or polishes.

Heated rear screen

The following precautions must be taken, to avoid irreparable damage being caused to the printed circuit which is 'baked' on to the interior of the screen.

- Do not remove labels or stickers from the screen, with the aid of sharp instruments or similar equipment likely to scratch the glass.
- Care should be taken to avoid inadvertently scratching the glass with a ringed finger etc, when cleaning or wiping the screen.
- Do not clean the screen with harsh abrasives.

Wheel Changing

Positioning the jack

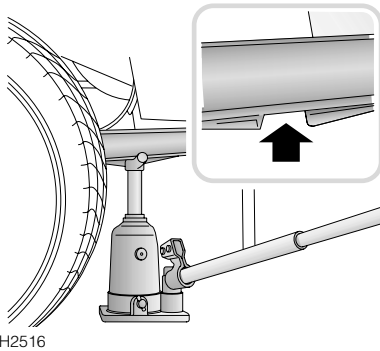

H2516

Front jacking point

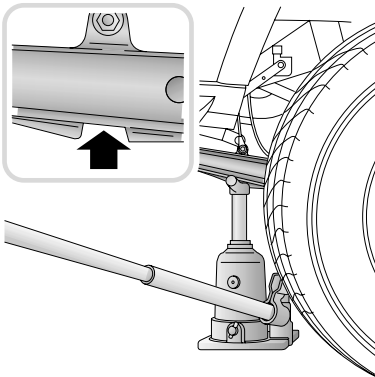

H2515

Rear jacking point

Always position the jack from the side of the vehicle, approximately in line with the appropriate jacking point. Ensure the jack is positioned on firm, level ground.

Position the jack so that, when raised the cradle head of the jack engages with the shaped notch on the underside of the front or rear suspension links - either just forward of the rear wheels or just to the rear of the front wheels.

WARNING

NEVER work beneath the vehicle with the jack as the only means of support. The jack is designed for wheel changing only!

To prevent the vehicle from tipping off the jack, ensure that it is first positioned on firm, level ground.

ALWAYS use the complete, two-piece, jack lever throughout to minimise any chance of accidental damage or injury.

ONLY jack the vehicle using the jack location points described, or damage to the vehicle could occur.

Fuses

ENGINE COMPARTMENT FUSE BOX

WARNING

Batteries emit explosive hydrogen gas; ensure that sparks, flames and other ignition sources are kept away from the engine compartment.

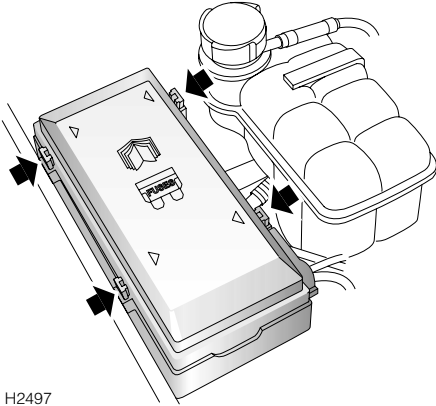

H2497

A second fuse box is located on the right side of the engine compartment adjacent to the coolant reservoir.

Press all four latches in the direction of the arrows shown on the illustration to release the fuse box cover.

Information on the underside of the cover identifies the fuses and their ratings. This information is also listed on the following page.

When replacing the cover, locate the four latches, then push firmly downwards until the latches can be heard to 'snap' closed.

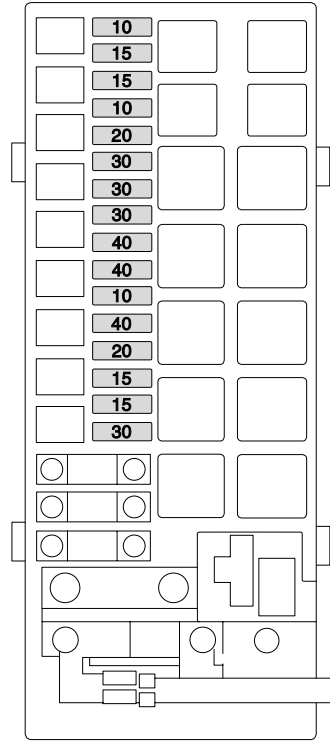

H2498

Owners are advised against removing or replacing the relays (identified as R1-R14) and fusible links (FL1-FL13). Failure of any of these items should be investigated by a qualified technician.

WARNING

To prevent a possible fire or damage to the electrical system, only fit fuses of the same rating or type. DO NOT replace a blown fuse with a fuse of a higher amperage rating. Always rectify the cause of the failure before replacing a fuse. Seek qualified assistance if necessary.

Bulb Replacement

FRONT FOG LIGHTS

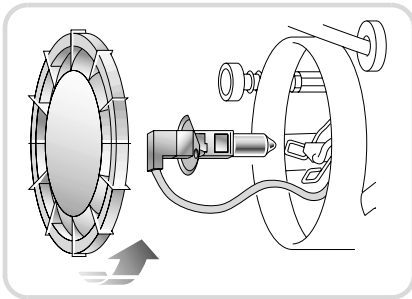
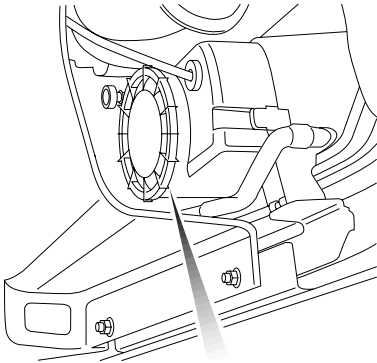

H3552

The front fog lights are mounted on the rear of the front bumpers and are shielded from behind by the lower wheelarch liners.

Access is severely restricted and will entail lying beneath the centre of the vehicle at the front and reaching between the wheelarch liner and the back of the fog light.

To access the bulb, remove the cover on the rear of the fog light by twisting it anti-clockwise.

Spring clips (similar to those in the headlights) hold the bulb in place. Unhook the clips to release the bulb from the light unit, then pull the bulb from the connector. Because access and vision are severely restricted (these operations must be carried out largely by 'feel'), it may be helpful to first examine the way in which similar spring clips in the headlight unit retain the headlight bulb.

Before fitting the replacement bulb, note the 'flat' on the otherwise circular shape of the bulb mounting flange. The flat acts as a key to enable correct positioning of the bulb in the light unit.

NOTE: Do not touch the bulb glass with your fingers. If necessary, clean the bulb with isopropyl rubbing alcohol.

CLICK HERE TO **DOWNLOAD** THE COMPLETE MANUAL

- Thank you very much for reading the preview of the manual.
- You can download the complete manual from: www.heydownloads.com by clicking the link below



- Please note: If there is no response to CLICKING the link, please download this PDF first and then click on it.

CLICK HERE TO **DOWNLOAD** THE COMPLETE MANUAL