



OWNER'S MANUAL

READ THIS MANUAL CAREFULLY,
IT CONTAINS IMPORTANT SAFETY INFORMATION.



MINIMUM RECOMMENDED OPERATOR AGE: 16

**TRX420TM/FM
FOURTRAX
RANCHER 420/4x4**

CLICK HERE TO **DOWNLOAD** THE COMPLETE MANUAL

- Thank you very much for reading the preview of the manual.
- You can download the complete manual from: www.heydownloads.com by clicking the link below



- Please note: If there is no response to CLICKING the link, please download this PDF first and then click on it.

CLICK HERE TO **DOWNLOAD** THE COMPLETE MANUAL

ATV Safety

This section presents some of the most important information and recommendations to help you ride your ATV safely. Please take a few moments to read these pages. This section also includes information about the location of safety labels on your ATV.

Important Safety Information	2
Safety Labels.....	5

Operation Component Locations

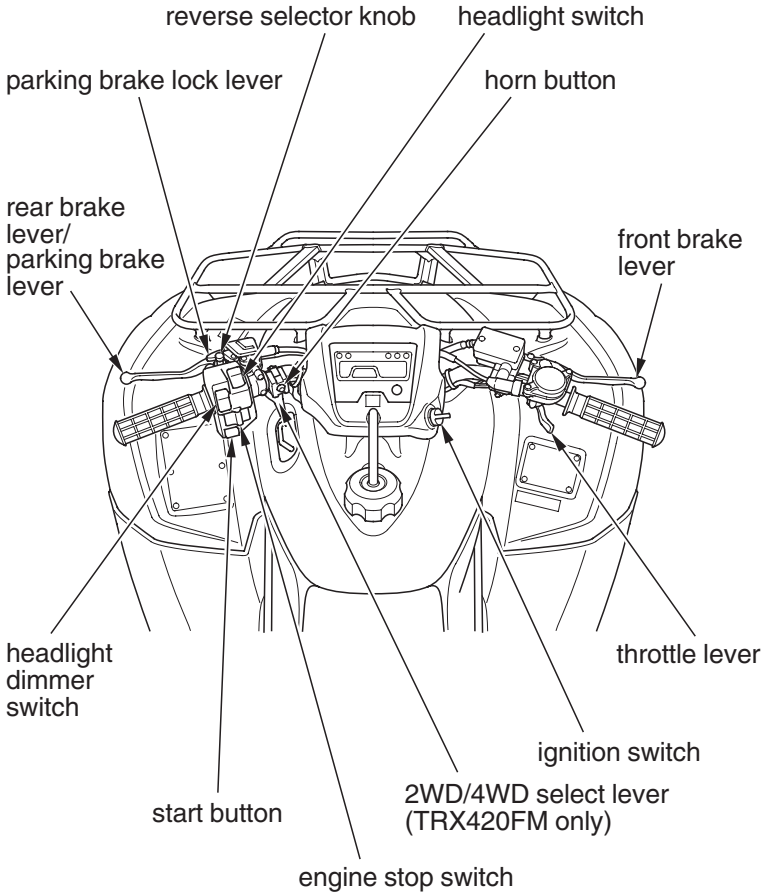

Indicators & Displays

Odometer

When selected, the odometer (1) registers total distance traveled in kilometers while the ignition is ON (1). To change the display from tripmeter or hourmeter to odometer, press and release the hourmeter/odometer/tripmeter select button (2).

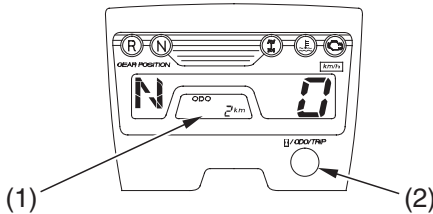

(1) odometer (2) hourmeter/odometer/tripmeter select button

Tripmeter

When selected, the tripmeter (1) shows mileage per trip while the ignition is ON (1). To change the display from odometer or hourmeter to tripmeter, press and release the hourmeter/odometer/tripmeter select button (2). To reset the tripmeter to zero, press the hourmeter/odometer/tripmeter select button and hold it in for at least 2 seconds.

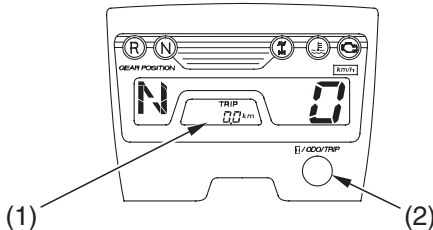

(1) tripmeter (2) hourmeter/odometer/tripmeter select button

Controls & Features

Reverse Selector Knob

The reverse selector knob (1), located on the rear brake lever/parking brake lever (2), is used to shift into reverse. To operate, with your ATV stopped and the transmission in neutral (make sure the gear position indicator shows “N”), push in the knob, squeeze the rear brake lever/parking brake lever, then depress the shift lever. See *Riding in Reverse*, page 67.

LEFT HANDLEBAR

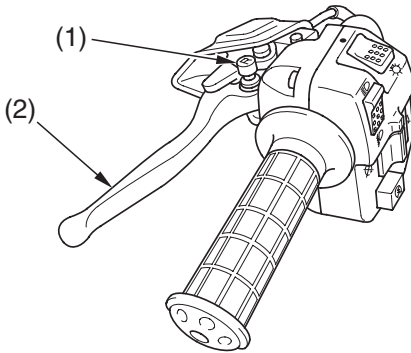

- (1) reverse selector knob
- (2) rear brake lever/parking brake lever

Are You Ready to Ride?

Age Recommendation

The minimum recommended age for this ATV model is 16. For safety, never let children under 16 years old operate this vehicle.

WARNING

A child using an ATV that is not recommended for their age could lose vehicle control while riding, resulting in severe injury or death.

A child under 16 should never operate an ATV with engine size greater than 90cc.

No Passengers

This ATV is designed as an operator-only vehicle. The long seat is designed to allow the rider to change body position, not for carrying a passenger. Never let a passenger ride on the seat or on the front or rear cargo racks.

WARNING

Carrying a passenger on this ATV greatly reduces your ability to balance and control this ATV and could cause a crash and you or your passenger could be injured or killed.

Never carry a passenger on this ATV.

Accessories & Modifications

Modifications

We strongly advise you not to remove any original equipment or modify your ATV in any way that would change its design or operation. Such changes could seriously impair your ATV's handling, stability, and braking, making it unsafe to ride.

Removing or modifying your lights, exhaust system, emission control system, or other equipment can also make your ATV illegal.

Starting & Stopping the Engine

Starting Procedure

This vehicle has a fuel-injected engine with an automatic choke. Follow the procedure indicated below.

Any Air Temperature

- Press the start button with the throttle completely closed.

The engine will not start if the throttle is fully open (because the electronic control module cuts off the fuel supply).

Riding Your ATV

Making Turns

Learn how to turn your ATV properly. Practice the techniques outlined in this section on level ground and at low speeds until you are confident in making turns.

WARNING

Turning improperly can make the ATV go out of control, causing a collision or overturn.

- Always follow proper procedures for turning as described in this owner's manual.
- Practice turning at low speeds before attempting to turn at faster speeds.
- Do not turn at excessive speeds.

Riding Your ATV

Riding Over Obstacles

Before operating in a new area, check for obstacles. Watch out for bumps, rain ruts, potholes and other obstacles in the terrain. When you approach any obstacle, reduce your speed and be prepared to stop. Never try to ride over large obstacles, such as large rocks or fallen logs.

WARNING

Improperly operating over obstacles could cause loss of control or a collision and could cause the ATV to overturn.

When you go over obstacles, always follow proper procedures as described in this owner's manual.

Maintenance Schedule

Perform the pre-ride inspection (page 43) and owner maintenance on this section at each scheduled maintenance period.

Each item on the maintenance schedule requires some mechanical knowledge. Certain items (particularly those marked * and **) may require more technical information and tools. Consult your Honda dealer.

- * Should be serviced by your Honda dealer, unless you have the proper tools and service data, and are mechanically qualified. Refer to the official Honda Shop Manual.
- ** In the interest of safety, we recommend these items be serviced only by your Honda dealer.

Summary of Maintenance Schedule Notes & Procedures:

NOTES:

1. Service more frequently when riding in dusty areas, sand or snow.
2. Service more frequently after riding in very wet or muddy conditions.
3. Replace every 2 years. Replacement requires mechanical skill.

Clip Removal

Removal

1. Press down on the center pin to release the lock.
2. Pull the clip out of the hole.

1.



2.

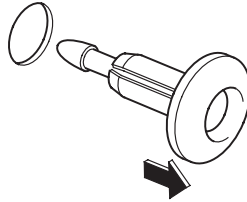

Installation

1. Push the bottom of the pin.
2. Insert the clip into the hole.
3. Lightly press down on the center pin to lock the clip.

1.

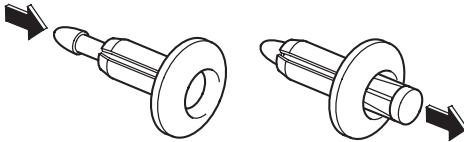

2.

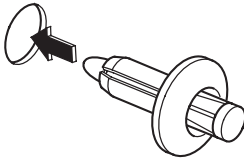

3.



CLICK HERE TO **DOWNLOAD** THE COMPLETE MANUAL

- Thank you very much for reading the preview of the manual.
- You can download the complete manual from: www.heydownloads.com by clicking the link below



- Please note: If there is no response to CLICKING the link, please download this PDF first and then click on it.

CLICK HERE TO **DOWNLOAD** THE COMPLETE MANUAL

Engine Oil & Filter

Install a New Engine Oil Filter:

1. Remove the seat (page 100).
2. Unsnap and remove the right side cover (1).

RIGHT SIDE

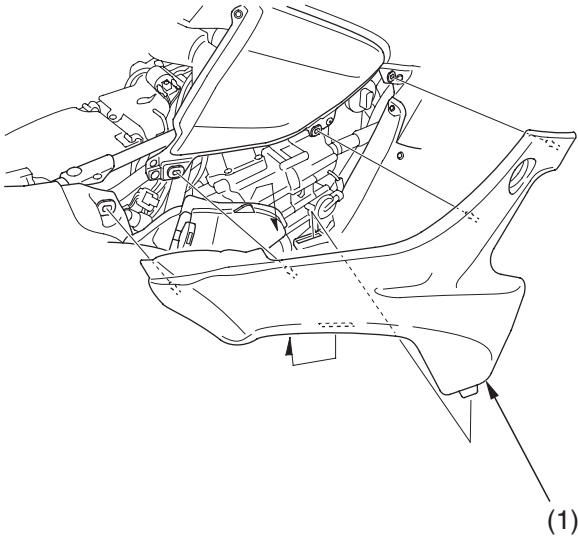

(1) right side cover

(cont'd)

Coolant Replacement

Refer to *Safety Precautions* on page 89 .

Coolant should be replaced by your Honda dealer, unless you have the proper tools and service data, and are mechanically qualified. Refer to the official Honda Shop Manual.

WARNING

Removing the radiator cap while the engine is hot can cause the coolant to spray out, seriously scalding you.

Always let the engine and radiator cool down before removing the radiator cap.

To properly dispose of drained coolant, refer to *You & the Environment*, page 180 .

NOTICE

Improper disposal of drained fluids is harmful to the environment.

Throttle Inspection

Refer to *Safety Precautions* on page 89 .

1. Check that the throttle assembly is positioned properly and the securing bolts are tight.
2. Check for smooth operation of the throttle lever from fully open to fully closed in all steering positions. If there is a problem, see your Honda dealer.
3. Inspect the condition of the throttle cable from the throttle lever down to the throttle body. If the cable is kinked or chafed, have it replaced.
4. Check the throttle cable for tension or stress in all steering positions.
5. Lubricate the throttle cable with a commercially available cable lubricant to prevent premature wear and corrosion.

Brakes

Worn brake pads should be replaced. If the pads are not worn, have your brake system inspected for leaks.

Other Inspections

- Make sure there are no fluid leaks.
- Check for deterioration or cracks in the hoses and fittings. If the hoses are worn or cracked, have them replaced by your Honda dealer.

Air Pressure

Refer to *Safety Precautions* on page 89 .

Properly inflated tyres provide the best combination of handling, tread life, and riding comfort. Generally, underinflated tyres wear unevenly, adversely affect handling, and are more likely to fail from being overheated. Overinflated tyres make your ATV ride harshly, are more prone to damage from surface hazards, and wear unevenly.

Make sure the air valve caps are secure. If necessary, install new caps.

Battery

Your ATV has a maintenance-free type battery. You do not have to check the battery electrolyte level or add distilled water as you would with a conventional-type battery.

NOTICE

Your battery is a maintenance-free type and can be permanently damaged if the cap strip is removed.

Electrical accessories use current from the battery, even when the ignition is OFF. Limited operation also allows the battery to discharge. If you have electrical accessories on your ATV or do not ride frequently, we recommend that you charge the battery frequently (see *Battery Charging*, page 165).

If you do not expect to ride your ATV for at least two weeks, we recommend you remove the battery, or at least disconnect the battery cables (negative cable first).

If you plan to store your ATV, see *Battery Storage*, page 162 .

If your battery seems weak and/or is leaking electrolyte (causing slow starting or other electrical problems), see your Honda dealer.



This symbol on the battery means that this product must not be treated as household waste.

NOTICE

An improperly disposed of battery can be harmful to the environment and human health.

Always confirm local regulations for battery disposal.

Here's helpful advice on how to prepare for an off-road adventure, how to transport and store your Honda, and how to be an environmentally responsible ATV owner.

Preparing for a Ride	172
What to Take to the Riding Area	172
What to Take on the Trail	173
Transporting Your Honda	174
Storing Your Honda	176
Preparation for Storage	177
Removal from Storage	179
You & the Environment	180

Taking Care of the Unexpected

With all the challenges you can encounter off-road, there's a chance that sometime something may go wrong. This section gives practical advice to help you deal with a wide range of problems. Take time to read this section before you ride. Also review the tips in *Preparing for a Ride* (page 172).

General Guidelines.....	182
If Your Engine Quits or Won't Start.....	184
If You Have a Flat Tyre.....	187
If the High Coolant Temperature Indicator Lights.....	190
If a Fuse Blows.....	192
If You Crash.....	196
If You Lose Your Key.....	197
If the Battery Is Low (or Dead).....	198
If a Component Fails.....	199

If the High Coolant Temperature Indicator Lights

- If the reserve tank is low or empty, don't ride without adding coolant (page 119). After adding coolant, turn the engine on and check the high coolant temperature indicator.

If the indicator doesn't turn off, do not ride. The engine needs repair.

Transport your ATV to a Honda dealer (page 174).

If the temperature drops to normal, check the coolant level. If it has gone down, add more coolant.

- Check for an oil leak.
- Check the oil level. If necessary, add the recommended oil (page 108) to the upper level mark. If you must leave your ATV to get oil, secure it as much as possible.
- Start the engine, and check that the high coolant temperature indicator goes off.

If you are able to resume riding, continue to monitor the high coolant temperature indicator frequently.

If there is an oil leak — do not ride the ATV until the leak is repaired by Honda dealer (page 174).

If there's a mild coolant leak, you can ride for awhile, carefully watching the indicator. Be prepared to stop and add more coolant or water. If the leak is bad, transport your ATV to a Honda dealer (page 174).

Technical Information

This section contains dimensions, capacities, and other technical data, plus information on government requirements and how to break-in your ATV.

Vehicle Identification.....	202
Specifications.....	204
Break-in Guidelines	208
Petrol Containing Alcohol.....	209

Table of Contents

Controls & Features	24
Fuel Valve	24
Ignition Switch	25
2WD/4WD Select Lever (TRX420FM only)	26
Start Button	27
Engine Stop Switch	27
Headlight Switch	28
Headlight Dimmer Switch	28
Horn Button	28
Recoil Starter	29
Throttle Lever	30
Reverse Selector Knob	31
Front Brake Lever	32
Rear Brake Lever/Parking Brake Lever	32
Rear Brake Pedal	32
Parking Brake	33
Flag Pole Bracket	34
Trailer Hitch	35
BEFORE RIDING	37
Are You Ready to Ride?	38
Protective Apparel	38
Rider Training	40
Age Recommendation	41
No Passengers	41
No Alcohol or Drugs	42
Is Your ATV Ready to Ride?	43
Pre-ride Inspection	43
Load Limits & Guidelines	47
Loading	47
Load Limits	48
Loading Guidelines	49

(cont'd)

Index

K

key,	
lost.....	197
number	197
kit, tool	98

L

labels, safety.....	5
lamp check	14
lever, 2WD/4WD select (TRX420FM only).....	26
limit, weight	48
load limits.....	48
loading guidelines	49
lubrication,	
differential oil (TRX420FM only)	116
engine oil.....	105
gear case oil.....	114

M

maintenance,	
component locations.....	95
importance.....	87
precautions	89
record	94
safety	88
schedule.....	90

(cont'd)

CLICK HERE TO **DOWNLOAD** THE COMPLETE MANUAL

- Thank you very much for reading the preview of the manual.
- You can download the complete manual from: www.heydownloads.com by clicking the link below



- Please note: If there is no response to CLICKING the link, please download this PDF first and then click on it.

CLICK HERE TO **DOWNLOAD** THE COMPLETE MANUAL