

4x4  
TRX350

HONDA

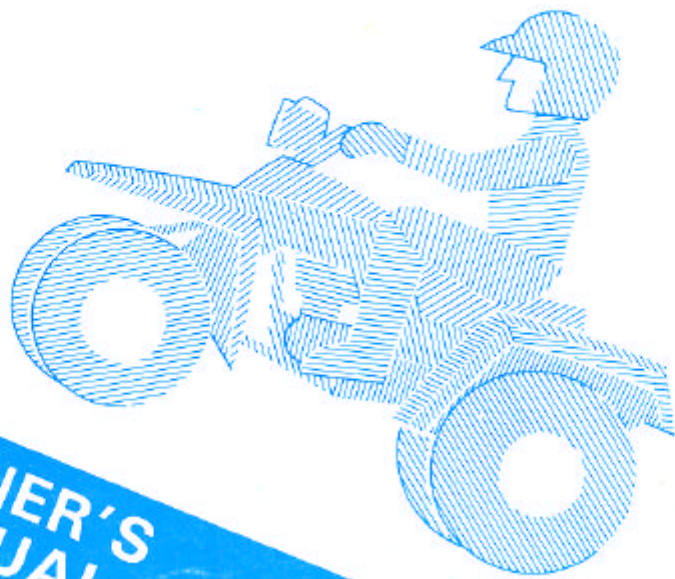

OWNER'S  
MANUAL

CLICK HERE TO **DOWNLOAD** THE COMPLETE MANUAL

- Thank you very much for reading the preview of the manual.
- You can download the complete manual from: [www.heydownloads.com](http://www.heydownloads.com) by clicking the link below



- Please note: If there is no response to CLICKING the link, please download this PDF first and then click on it.

CLICK HERE TO **DOWNLOAD** THE COMPLETE MANUAL

# DESCRIPTION

## PARTS LOCATION

- (1) Fuel tank cap
- (2) Right hand brake lever
- (3) Throttle lever
- (4) Indicator lamps
- (5) Ignition switch
- (6) 12V DC Receptacle
- (7) Fuel valve
- (8) Kickstarter pedal
- (9) Brake pedal
- (10) Oil filler cap/dipstick

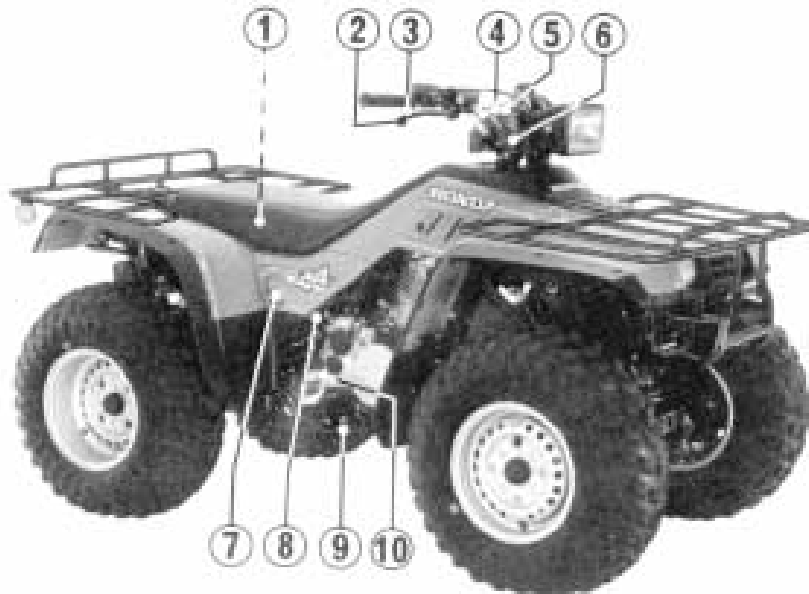

## Seat Removal

1. Release the seat lock by moving the seat lock lever (1) at the left side of the seat toward the rear.
2. Remove the seat by lifting it upward.

## Installation

1. Insert the four seat studs (2) into the holes of the grommets on the frame.
2. Press down on the seat until the seat latch engages.

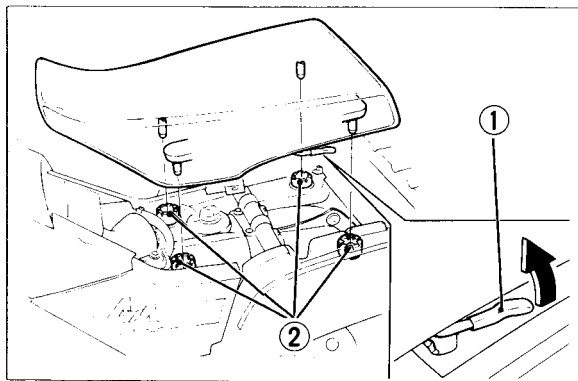

(1) Seat lock lever      (2) Seat studs

## Tool compartment

The tool compartment is under the seat. To take out the tool set, remove the seat and the tool holder (1) by unscrewing the wing bolt (2).

### NOTE:

\* The air pressure gauge should be stored in this compartment with tool set.

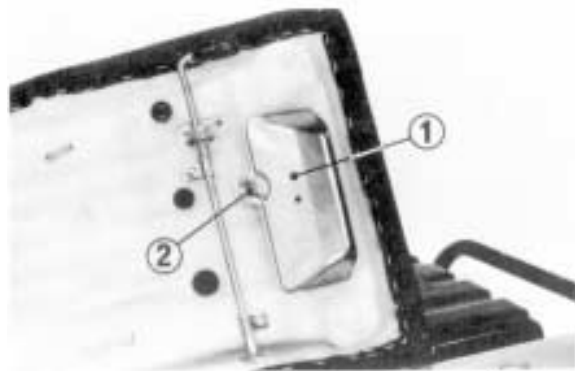

(1) Tool holder      (2) Wing bolt

## TIRES

Although the tires are designed specifically for vigorous offroad use, they are not immune to punctures. Always select your riding area with care.

### WARNING

- \* *The TRX is not designed to be driven on paved surfaces. Handling and control will be severely affected.*
- \* *This TRX is a 4-wheel drive model. Use of different sizes of tires or uneven tire pressure will adversely affect the stability and control of the vehicle.*

Check the tire pressure frequently with the air pressure gauge supplied with the TRX.

For normal use, the tires should be inflated to the recommended pressure. A manually operated tire pump should be used rather than the high pressure systems found in service stations. This will minimize the possibility of tire damage from overinflation.

### NOTE:

- \* Tire pressure should be checked when the tires are "cold," before you ride.
- \* Check tire pressure before you ride.

TIRE SIZE		24 x 9.00-11
STANDARD TIRE BRAND	FRONT	OHTSU A/T 502
	REAR	
RECOMMENDED PRESSURE		2.2 psi (15 kPa, 0.15 kg/cm <sup>2</sup> )
MAX. PRESSURE		2.6 psi (18 kPa, 0.18 kg/cm <sup>2</sup> )
MIN. PRESSURE		1.8 psi (12 kPa, 0.12 kg/cm <sup>2</sup> )
At loaded		2.2-3.1 psi (15-21 kPa, 0.15-0.21 kg/cm <sup>2</sup> )

### WARNING

- \* *Maintain proper tire air pressure. Improperly inflated tires may adversely affect maneuverability and may cause loss of control.*
- \* *When replacing tires use only the size, type and brand identified in the chart. The use of different sizes or types of tire can severely effect vehicle handling.*

5. When your speed increases, close the throttle and shift to 2nd gear by raising the gearshift pedal.

#### CAUTION

- \* *Do not shift gears without closing the throttle. The engine and drive train could be damaged by overspeed and shock.*

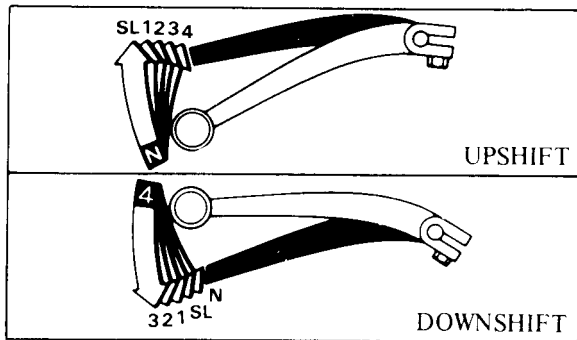

Shifting sequence

6. This sequence is repeated to progressively shift to 3rd and 4th (top) gear.

#### CAUTION

- \* *Do not tow the TRX or coast for long distances while the engine is off. The transmission will not be properly lubricated and damage may result.*

#### Reverse Riding

For reverse riding practice, make sure there are no obstacles or people in the area.

1. Make sure the transmission is in neutral and set the parking brake.
2. Start the engine and release the parking brake.
3. While the engine is idling, press the reverse selector knob, squeeze the rear brake/parking brake lever and depress the gearshift pedal into the reverse gear.
4. Release the rear brake/parking brake lever.
5. Ride the TRX cautiously in reverse by gradually opening the throttle.

#### WARNING

- \* *When backing up, open the throttle carefully to ride slowly and safely, being careful that there are no obstacles or people behind you.*
- \* *Avoid sudden application of the throttle or abrupt turns.*
- \* *Close the throttle and apply the brakes carefully to stop the TRX when riding in reverse. Don't apply the left or right brake lever, or the brake pedal, abruptly because this may cause the front wheel to lift off the ground. Remember the right hand brake lever brakes the rear wheels also.*
- \* *Make sure the neutral indicator light comes on after shifting the transmission from reverse into neutral. If the neutral indicator light does not come on, move the TRX and then try to shift the transmission into neutral again.*

## High Altitude Riding

When operating this vehicle at high altitudes, the air-fuel mixture becomes overly rich. Above 6,000 feet (1,800 m) driveability and performance may be reduced and fuel consumption increased. The carburetor can be modified to compensate for this high altitude richness. However, the carburetor must be returned to standard factory specifications when lower altitude riding is desired. (See page 61.)

### CAUTION:

- \* *Sustained operation at altitudes below 5,000 feet (1,500 m) with high altitude carburetor modifications may cause engine overheating and damage.*
- \* *Tire pressures can change significantly as you go up and down in a attitude; therefore, always check tire pressures just before you start riding.*

## PARKING

1. Stop the vehicle, shift the transmission into neutral, turn the fuel valve and ignition switch OFF.
2. Pull the parking brake lever and lock it. (See page 14.)

### WARNING

- \* ***Do not park on an incline. If you must park on a hill, place the TRX across the incline so that it neither faces downhill nor uphill.***

5. Remove the cross member plate (6).
6. Loosen the band screws (7) and remove the connecting tube (8) by removing the bolt (9).
7. Loosen the band screws (10) and remove the air cleaner case (11) by removing the bolts (12).

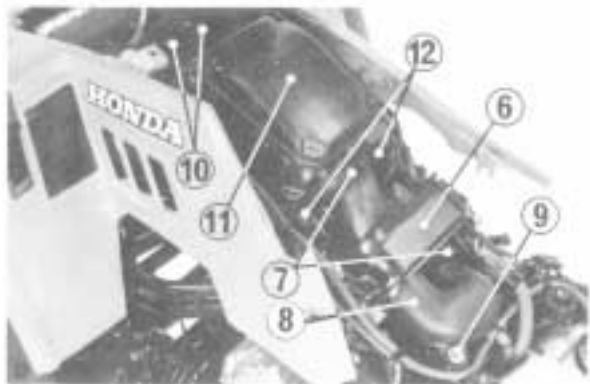

- |                        |                       |
|------------------------|-----------------------|
| (6) Cross member plate | (10) Band screws      |
| (7) Band screws        | (11) Air cleaner case |
| (8) Connecting tube    | (12) Bolts            |
| (9) Bolt               |                       |

8. Remove the three engine mount bolts (13) and mount plates (14).
9. Remove the valve adjusting hole covers (15).

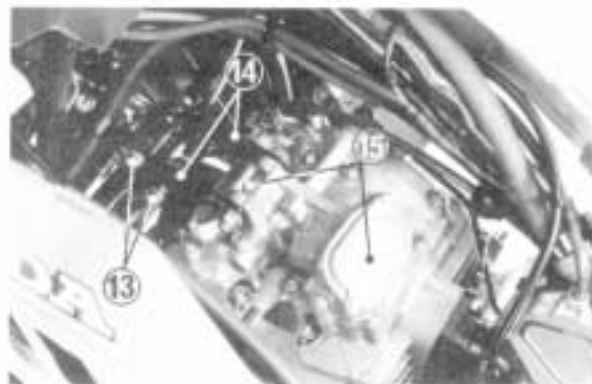

- |                                  |
|----------------------------------|
| (13) Engine mount bolts          |
| (14) Mount plates                |
| (15) Valve adjusting hole covers |

4. Recheck the brake lever free play. If free play is still excessive after adjusting the brake lining clearance, there is probably air in the brake system and it must be bled out. See your authorized Honda dealer for this service.

#### Adjustment:

1. Pump the brake lever 2-3 times firmly and release it.
2. Raise the front and rear wheels off the ground by placing a support block under the engine.
3. Remove the adjusting cap (1).
4. Turn the both brake shoe adjusters (2) of each wheel cylinder up with a screwdriver until the front brake locks.

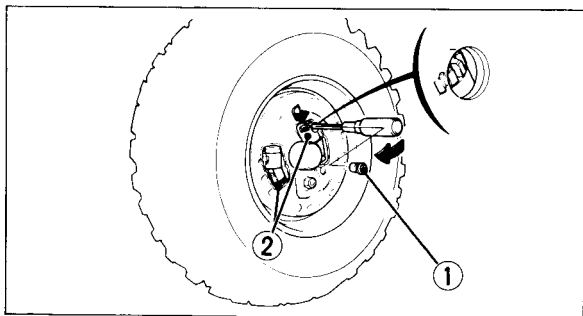

(1) Adjustment hole cap    (2) Adjusters  
(A) Brake locks

5. Back the adjusters off three clicks and pump the brake lever several times.
6. Turn the wheel 180° and follow the Steps 3 thru 5 on the other adjusters.
7. Turn the wheel manually and make sure it does not drag.
8. Adjust the other front brake.
9. Install the rubber cap.

#### Brake Fluid Level:



- \* *Brake fluid may cause irritation. Avoid contact with skin or eyes. In case of contact, flush thoroughly with water and call a doctor if your eyes were exposed.*

Remove the screws, reservoir cover, and diaphragm. Whenever the level is near the lower level mark on the reservoir, fill the reservoir with DOT 3 or 4 BRAKE FLUID from a sealed container up to the upper level mark. Reinstall the diaphragm and cover. Tighten the screws securely.

#### **CAUTION**

- \* *When adding brake fluid, be sure the reservoir is horizontal before the cover is removed or brake fluid may spill out.*

CLICK HERE TO **DOWNLOAD** THE COMPLETE MANUAL

- Thank you very much for reading the preview of the manual.
- You can download the complete manual from: [www.heydownloads.com](http://www.heydownloads.com) by clicking the link below



- Please note: If there is no response to CLICKING the link, please download this PDF first and then click on it.

CLICK HERE TO **DOWNLOAD** THE COMPLETE MANUAL