

520

HYDROSTATIC

OWNER'S MANUAL

CLARK

520

BOBCAT LOADER



CLARK Melroe
Division

CLARK EQUIPMENT CO.
Gwinner, North Dakota 58040

Printed in U.S.A.

CLICK HERE TO **DOWNLOAD** THE COMPLETE MANUAL

- Thank you very much for reading the preview of the manual.
- You can download the complete manual from: www.heydownloads.com by clicking the link below



- Please note: If there is no response to CLICKING the link, please download this PDF first and then click on it.

CLICK HERE TO **DOWNLOAD** THE COMPLETE MANUAL

These levers control the forward and reverse travel and turning of the machine (Fig. 10).

Push both levers ahead for forward travel (A).

Pull both levers back for reverse travel (B).

The machine is steered by moving one of the levers further ahead than the other (C & D).

By moving one lever forward and one lever backwards the machine will turn sharply (E & F).

Always engage steering levers slowly (especially when learning to operate loader) since only small movement of the levers is necessary to move the loader.

For maximum wheel torque (Power) use less lever movement. To increase travel speed use more lever movement.

PARKING BRAKE

The optional parking brake, when installed (Fig. 11), is engaged by firmly pressing foot pedal into locked position.

Set the parking brake whenever the machine is stopped and before starting the engine.

Always release the parking brake before operating the loader.

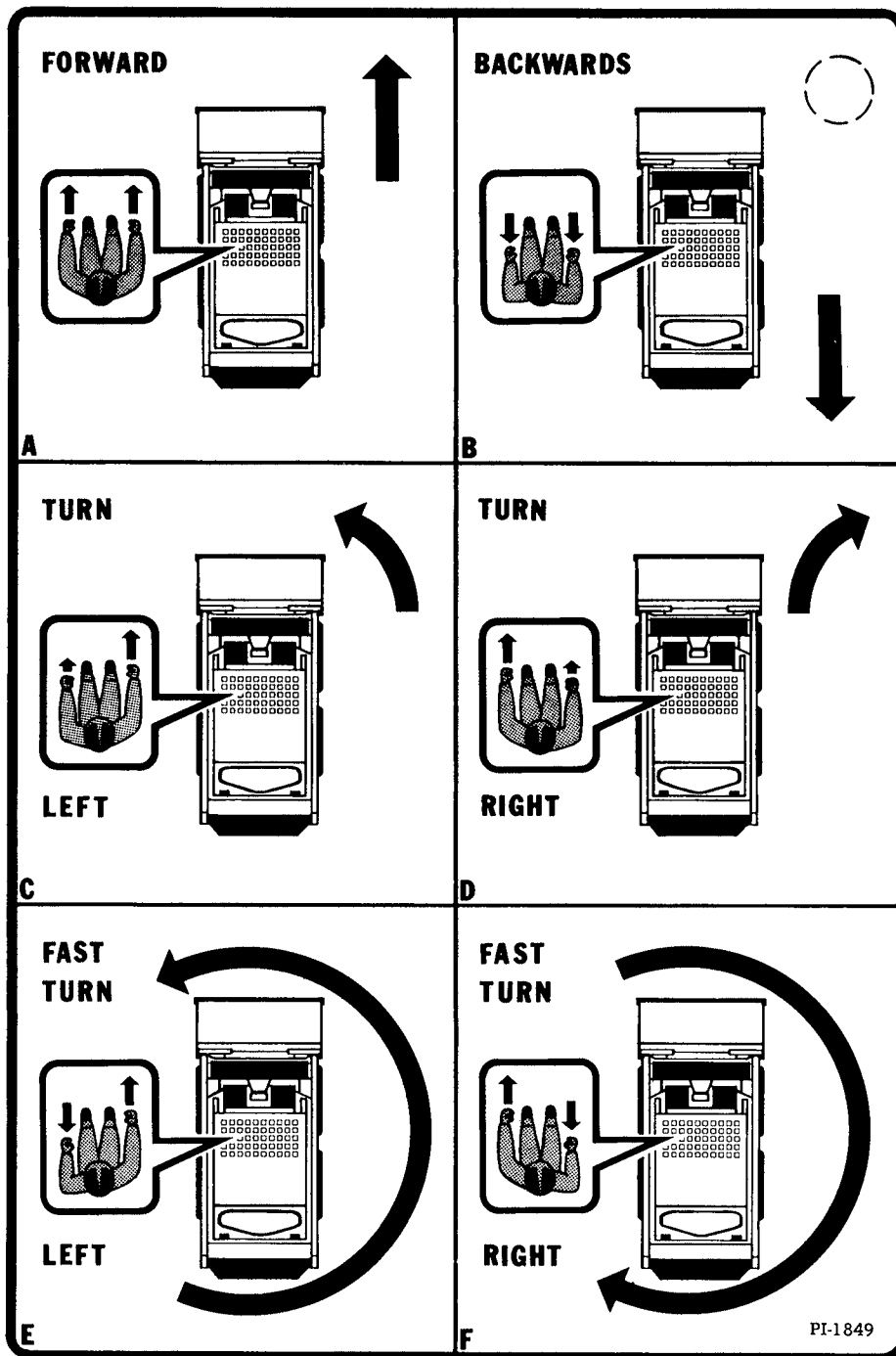

Fig. 10 Operator's Steering Procedures

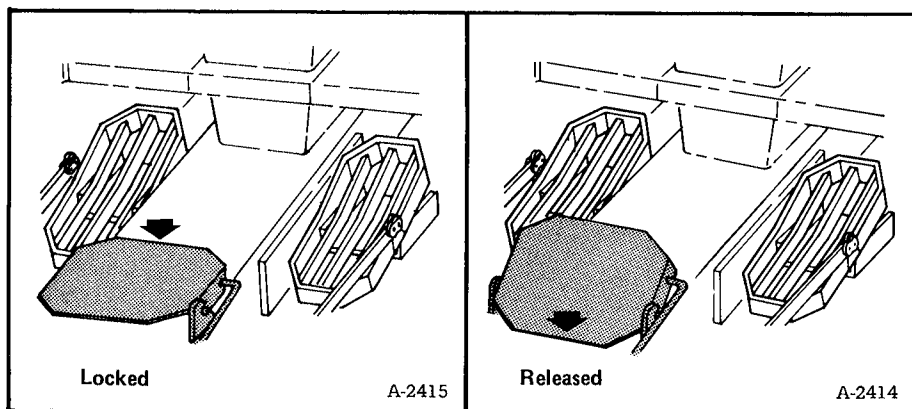
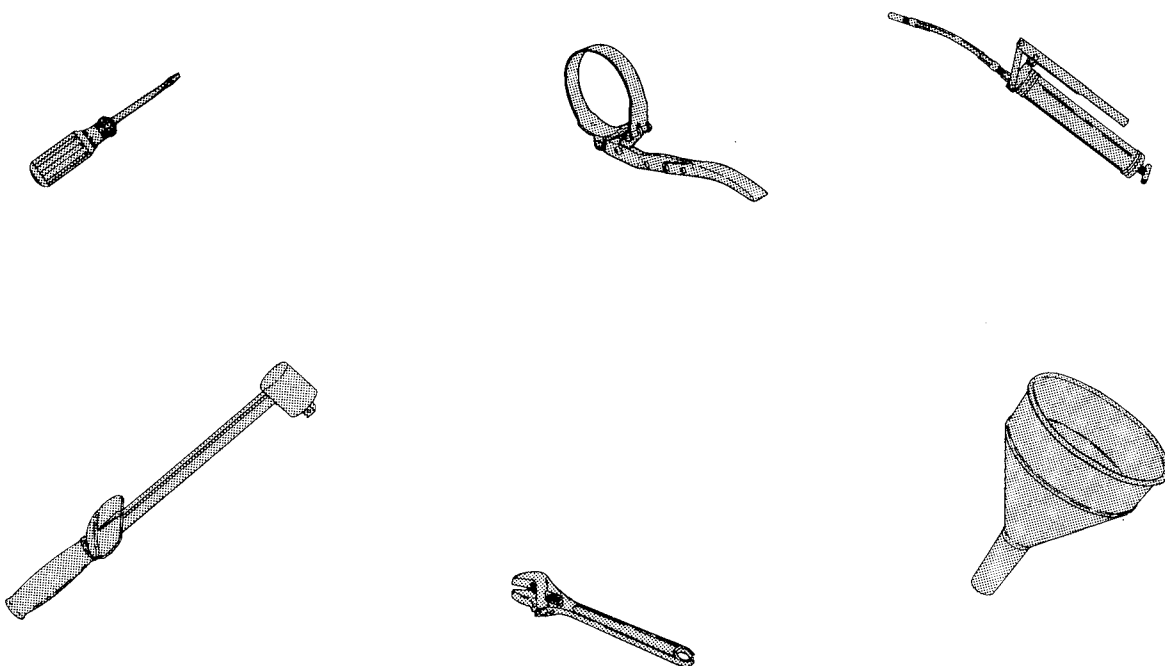
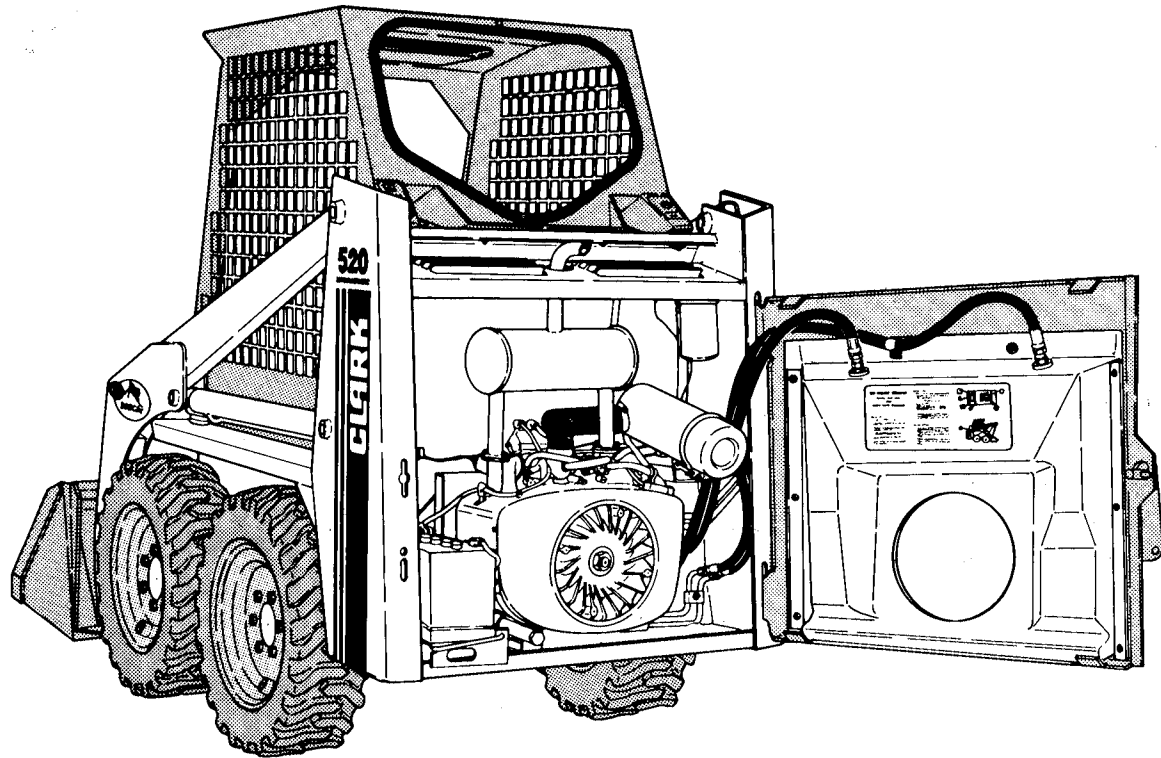

Fig. 11 Parking Brake

SERVICE & MAINTENANCE



C-2005

PRE-DELIVERY INSPECTION

The Pre-Delivery Inspection Form (Fig. 62) is filled out by your Bobcat dealer. It provides the dealer with general procedures to inspect the condition of your Bobcat on its arrival from the factory. A copy of this form, when completed, is mailed to Melroe Service Department.

DELIVERY REPORT

The Delivery Report (Fig. 63) is to be filled out by the dealer and signed by the owner or operator on delivery of the Bobcat to the owner. Make certain that the dealer explains the form and that it is filled out completely.

THIRTY HOUR INSPECTION

After the initial 30 operating hours have passed, the dealer will perform a complete inspection of the Bobcat loader at no charge to the owner.

The Bobcat dealer will explain the 30 hour inspection procedure at the time the new machine is delivered.

The 30 hour inspection will provide the following:

1. Inspection, adjustment and services after the initial wear-in period.
2. Faulty maintenance and operating practices found out and corrected.
3. Demonstration of proper service and operation procedures.

A 30 Hour Inspection form (Fig. 64) is sealed into a plastic bag along with this manual.

At a time conveniently near 30 operating hours, the owner must contact the dealer for scheduling of the 30 hour inspection.

The owner should arrange to have the Bobcat and operator available for the inspection at the scheduled time.

The inspection should be performed in the presence of the operator or owner. When the inspection is completed, the form must be filled in and signed by the service man and owner or operator.

Fig. 62 Pre-Delivery Inspection Form

Fig. 63 Delivery Report

Fig. 64 30 Hour Inspection Form

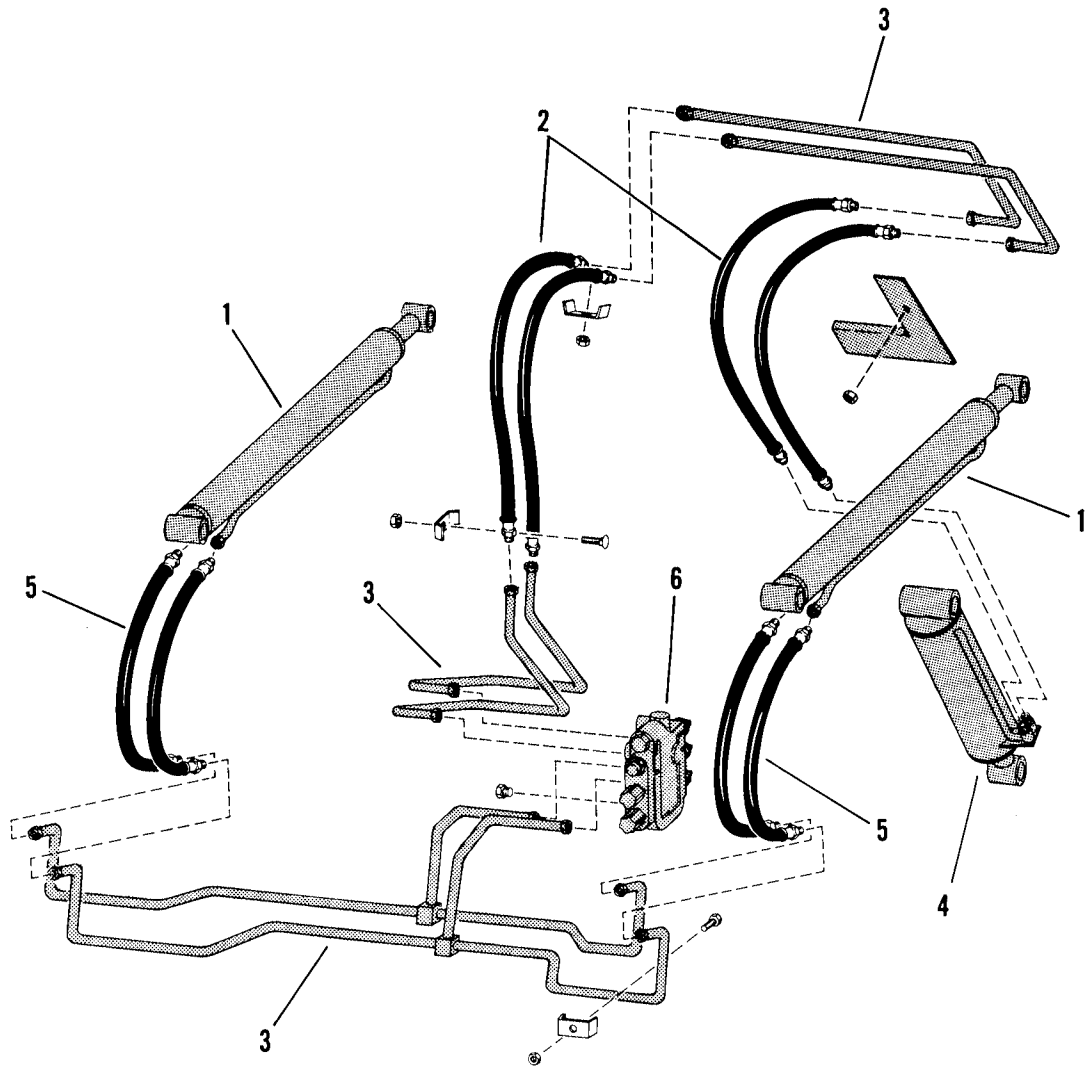

D-1284

HYDRAULIC CYLINDER CIRCUITRY

Ref.	Item	Ref.	Item
1.	Lift Cylinder	4.	Tilt Cylinder
2.	Tilt Hydraulic Lines	5.	Lift Hydraulic Lines
3.	Tubelines	6.	Control Valve

CLICK HERE TO **DOWNLOAD** THE COMPLETE MANUAL

- Thank you very much for reading the preview of the manual.
- You can download the complete manual from: www.heydownloads.com by clicking the link below



- Please note: If there is no response to CLICKING the link, please download this PDF first and then click on it.

CLICK HERE TO **DOWNLOAD** THE COMPLETE MANUAL