

2000
TRX 350FE

**HONDA FOURTRAX RANCHER 4×4 ES
OWNER'S MANUAL**

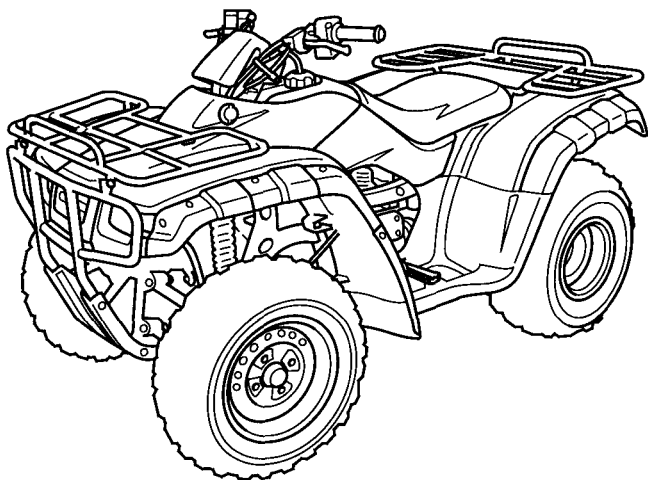

FOR OFF-ROAD USE ONLY

This vehicle is designed and manufactured for off-road use only.

USA only:

It conforms to US EPA Noise Emission regulations, but does not conform to Federal Motor Vehicle Safety Standards or US EPA Exhaust Emission regulations, and operation on public streets, roads, or highways is illegal. The vehicle is equipped with a USDA qualified spark arrester. Obey local laws and regulations.

It conforms to California exhaust emission regulations for ATVs.

CLICK HERE TO **DOWNLOAD** THE COMPLETE MANUAL

- Thank you very much for reading the preview of the manual.
- You can download the complete manual from: www.heydownloads.com by clicking the link below



- Please note: If there is no response to CLICKING the link, please download this PDF first and then click on it.

CLICK HERE TO **DOWNLOAD** THE COMPLETE MANUAL

USA only

⚠ WARNING

Improper use of ATVs can result in SEVERE INJURY or DEATH



ALWAYS USE PROTECTIVE GEAR NEVER USE AN APPROVED HELMET AND ROADS OR ALCOHOL PASSENGERS WITH DRUGS OR ALCOHOL NEVER CARRY PASSENGERS WITH DRUGS OR ALCOHOL NEVER USE AN APPROVED HELMET AND ROADS OR ALCOHOL

NEVER operate:

- without proper training or instruction.
- at speeds too fast for your skills or the conditions.
- on public roads - a collision can occur with another vehicle.
- with a passenger - passengers affect balance and steering and increase risk of losing control.

ALWAYS:

- use proper riding techniques to avoid vehicle overturns on hills and rough terrain and in turns.
- avoid paved surfaces - pavement may seriously affect handling and control.

READ THE OWNER'S MANUAL.

FOLLOW ALL INSTRUCTIONS AND WARNINGS.

U

UTILITY MODEL

THIS ATV IS FOR UTILITY USE

OPERATOR ONLY-NO PASSENGERS

NO OPERATOR UNDER AGE 16

THIS CATEGORY U (UTILITY) ATV IS FOR OFF ROAD USE ONLY. IT IS MAINLY FOR UTILITY USE BUT IT MAY ALSO BE USED FOR GENERAL RECREATION.

TRAINING COURSES TO TEACH ATV RIDING SKILLS ARE AVAILABLE.FOR INFORMATION CONTACT YOUR DEALER.

CHECK WITH YOUR DEALER TO FIND OUT ABOUT STATE OR LOCAL LAWS REGARDING ATV OPERATION.

THIS HANGTAG IS NOT TO BE REMOVED BEFORE SALE

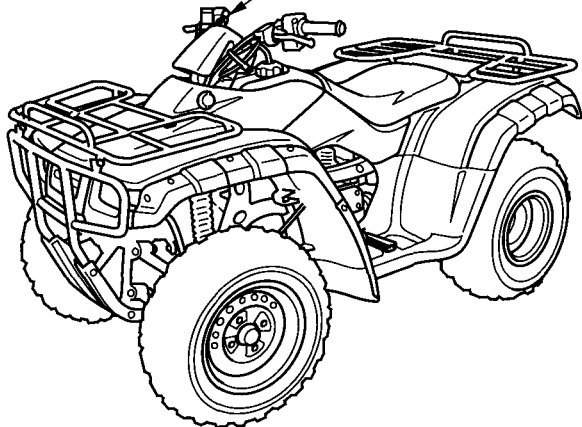

Starter Button

The starter button (Fig. 2-8) is below the headlight switch (2). To start the engine, press the starter button (1), with the transmission in neutral, the ignition switch ON (I) and the engine stop switch (3) at RUN (O).

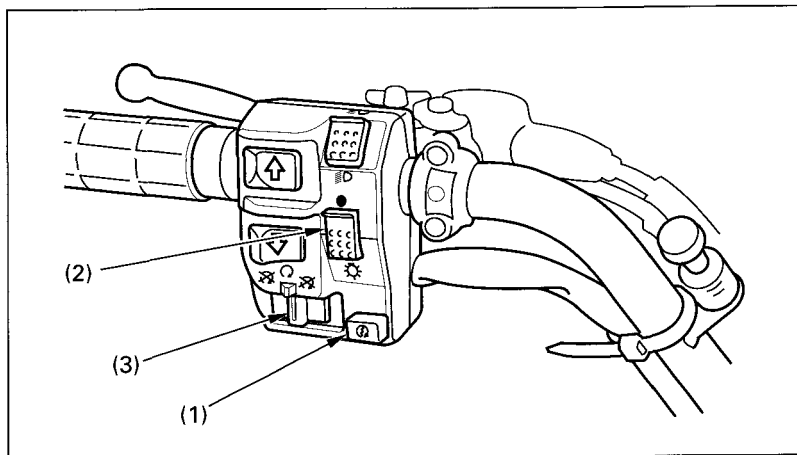

Fig. 2-8 (1) Starter button
(2) Headlight switch

(3) Engine stop switch

Gear Position Indicator

The gear position indicator (1) (Fig. 2-16) shows the gear position when the ignition switch is in the ON (I) position and the engine is running.

The indicator displays: N for neutral, R for reverse, and 1–5 for the five forward speed gears.

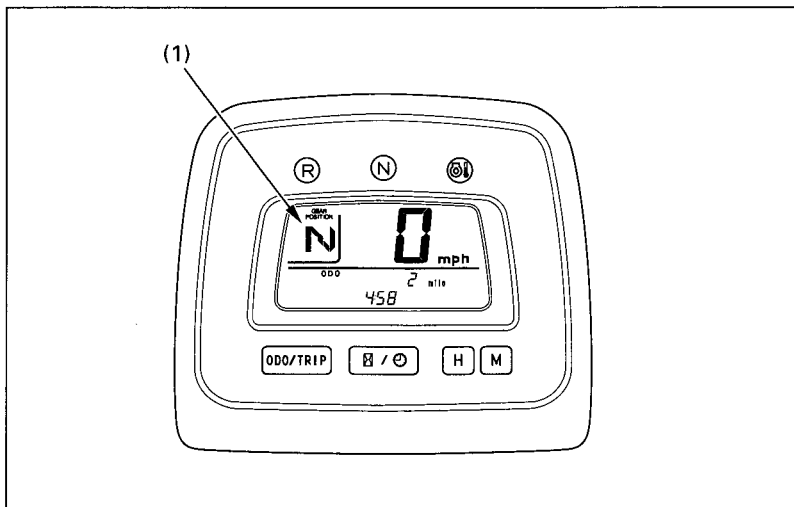

Fig. 2-16 (1) Gear position indicator

ENGINE OIL

Dipstick:

The dipstick (Fig. 2-28), on the right side of the front crankcase cover, is used to measure the oil level. The oil should be checked each day before operating the FOURTRAX and maintained between the upper level mark (2) and the lower level mark (3).

For oil recommendations and instructions on checking, adding and changing oil, see pages 112 – 116.

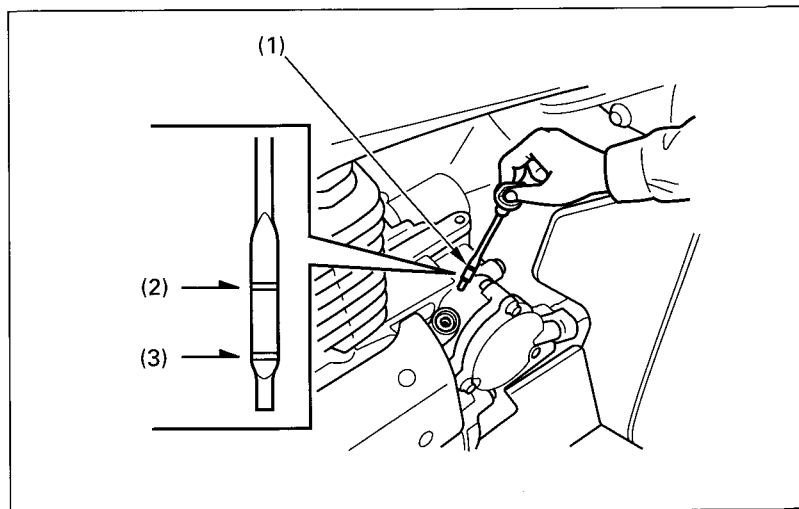

Fig. 2-28 (1) Dipstick

(2) Upper level mark
(3) Lower level mark

While reading this manual, remember:

▲WARNING

Indicates a strong possibility that serious injury or death may result if instructions are not followed.

2. **Fuel level.** Fill the fuel tank when necessary (pages 100–103). Check for leaks.
3. **Brakes.** Check operation. Make sure there is no brake fluid leakage. If necessary, adjust free play (pages 131–140).
4. **Tires.** Check condition and pressure (pages 142–144).
5. **Throttle.** Check for smooth opening and closing in all steering positions.
6. **Headlight and headlight dimmer switches.** Check for proper function (page 21).
7. **Engine stop switch.** Check for proper function (page 15).
8. **Driveshaft boots.** Check for damage (page 150).
9. **Nuts, bolts, fasteners.** Check the wheels to see that the axle nuts are tightened. Check the security of all other nuts, bolts and fasteners.
10. **Steering.** Check that the wheels turn properly as you steer the handlebars.
11. **Cargo.** Check that all cargo is properly secured.
12. **Underbody and exhaust system.** Check for, and remove, any dirt, vegetation or other debris that could be a fire hazard or interfere with the proper operation of the vehicle.
13. **Air cleaner housing drain tube.** Check for deposits in the drain tube. If necessary, clean the tube (page 108) and check the air cleaner case.

▲ WARNING

POTENTIAL HAZARD

**Failure to inspect the ATV before operating.
Failure to properly maintain the ATV.**

WHAT CAN HAPPEN

Increases the possibility of an accident.

HOW TO AVOID THE HAZARD

Always inspect your ATV each time you use it to make sure the ATV is in safe operating condition.

Always follow the inspection and maintenance procedures and schedules described in this Owner's Manual.

No Alcohol or Drugs

Alcohol, drugs and FOURTRAX's don't mix. Even a small amount of alcohol can impair your ability to operate a FOURTRAX safely. Likewise, drugs—even if prescribed by a physician—can be dangerous while operating a FOURTRAX. Consult your doctor to be sure it is safe to operate a vehicle after taking medication.

WARNING

POTENTIAL HAZARD

Operating this ATV after consuming alcohol or drugs.

WHAT CAN HAPPEN

- Could seriously affect your judgment.**
- Could cause you to react more slowly.**
- Could affect your balance and perception.**
- Could result in an accident.**

HOW TO AVOID THE HAZARD

Never consume alcohol or drugs before or while driving this ATV.

STARTING THE ENGINE

Preparation

1. Select a level surface and lock the parking brake (page 33) before starting the engine.
2. Turn the fuel valve (1) and ignition switch (2) to ON.
3. Make sure the engine stop switch (3) is at RUN (\odot).
4. Make sure that the transmission is in neutral by checking that the neutral indicator (4) lights.

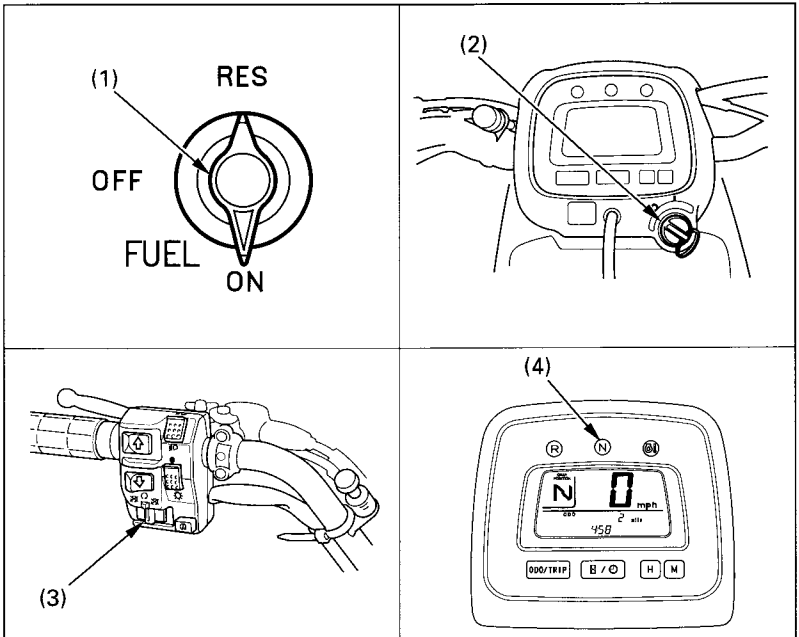

Fig. 3-9

(1) Fuel valve
(2) Ignition switch

(3) Engine stop switch
(4) Neutral indicator

CLICK HERE TO **DOWNLOAD** THE COMPLETE MANUAL

- Thank you very much for reading the preview of the manual.
- You can download the complete manual from: www.heydownloads.com by clicking the link below



- Please note: If there is no response to CLICKING the link, please download this PDF first and then click on it.

CLICK HERE TO **DOWNLOAD** THE COMPLETE MANUAL

⚠ WARNING

POTENTIAL HAZARD

Improperly operating in reverse.

WHAT CAN HAPPEN

You could hit an obstacle or person behind you, resulting in serious injury.

HOW TO AVOID THE HAZARD

When you select reverse gear, make sure there are no obstacles or people behind you. When it is safe to proceed, go slowly.

⚠ WARNING

POTENTIAL HAZARD

Applying only the rear brake abruptly when operating in reverse gear.

WHAT CAN HAPPEN

The front wheels could lift off the ground and the ATV could overturn backwards.

HOW TO AVOID THE HAZARD

Carefully apply both the front and rear brakes when stopping in reverse gear.

While reading this manual, remember:

▲WARNING Indicates a strong possibility that serious injury or death may result if instructions are not followed.

	FREQUENCY ITEMS	Whichever comes first ↪	INITIAL		REGULAR		Refer to page
			MAINTENANCE		MAINTENANCE INTERVAL		
			mi	100	600	1200	
			km	150	1000	2000	
NOTE	HOURS	20	100	200			
NON EMISSION RELATED ITEMS	DRIVE SHAFT BOOTS				I	I	—
	REAR FINAL GEAR CASE OIL AND DIFFERENTIAL OIL				(R: EVERY 2YEARS)	I	117—119
	* BRAKE FLUID	(NOTE3)			I	I	134
	* BRAKE SHOE WEAR	(NOTE1)				I	139
	BRAKE SYSTEM			I	I	I	131—140
	* REVERSE LOCK SYSTEM			I	I	I	123
	SKID PLATES,ENGINE GUARD				I	I	147
	* CLUTCH SYSTEM			I	I	I	122
	* SUSPENSION				I	I	—
	* SPARK ARRESTER				C	C	148
	* NUTS, BOLTS, FASTENERS			I		I	—
	** WHEELS/TIRES			I	I	I	141—145
** STEERING SHAFT HOLDER BEARINGS					I	—	
** STEERING SYSTEM					I	—	

* SHOULD BE SERVICED BY YOUR AUTHORIZED HONDA DEALER, UNLESS THE OWNER HAS PROPER TOOLS AND SERVICE DATA AND IS MECHANICALLY QUALIFIED. REFER TO THE OFFICIAL HONDA SERVICE MANUAL.

** IN THE INTEREST OF SAFETY, WE RECOMMEND THESE ITEMS BE SERVICED ONLY BY YOUR AUTHORIZED HONDA DEALER.

- NOTES:
1. Service more frequently when riding in dusty areas, sand or snow.
 2. Service more frequently after riding in very wet or muddy conditions.
 3. Replace every 2 years. Replacement requires mechanical skill.

- Gently wash the air cleaner in clean, non-flammable (high flash point) solvent such as kerosene — not gasoline.
Allow the air cleaner to dry thoroughly before applying oil. A wet air cleaner will not fully absorb the oil.

⚠ WARNING

POTENTIAL HAZARD

Using gasoline or low flash point solvents for cleaning ATV parts.

WHAT CAN HAPPEN

A fire or explosion could result.

HOW TO AVOID THE HAZARD

Use only a nonflammable or high flash point solvent to clean ATV parts.

- Soak the air cleaner in Pro Honda Foam Filter Oil or an equivalent [Canadian Vehicles: gear oil (SAE 80–90)] until saturated, then squeeze out the excess oil.

CAUTION:

Twisting the air cleaner when squeezing out excess oil could damage the air cleaner.

- Reassemble by reversing the disassembly sequence.

REAR FINAL GEAR CASE OIL

Change the oil in the rear final gear case when specified by the Maintenance Schedule. Change the oil with the final gear case warm, and the FOURTRAX on level ground to assure complete and rapid draining.

To change the rear final gear case oil:

1. To drain the oil, first place an oil drain pan under the oil drain plug (Fig. 4-13).
2. Remove the oil filler cap (1) and the drain plug (2).
3. After the oil has completely drained, reinstall the drain plug. Drain Plug Torque:
9 lbf·ft (12 N·m , 1.2 kgf·m)
4. Fill the gear case with the recommended oil.

Rear final gear case oil:

2.9 US oz (85 cm³ , 3.0 Imp oz)

Recommended oil:

Honda shaft drive oil or equivalent HYPOID GEAR OIL SAE 80

Remove the oil level check bolt (3).

Make sure the oil level reaches the oil level check hole (4).

5. Install the oil filler cap and oil level check bolt.

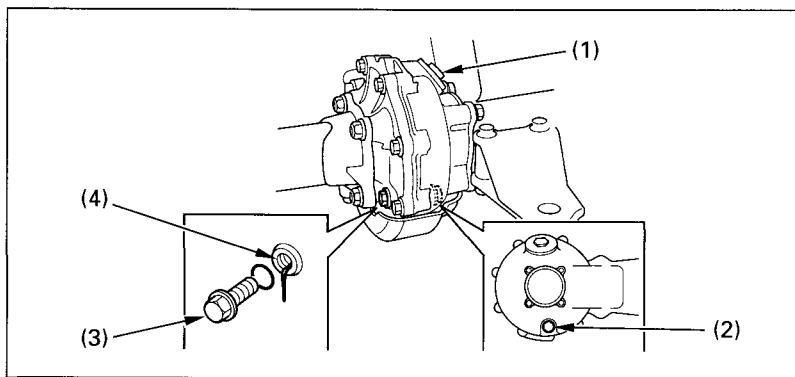

Fig. 4-13 (1) Oil filler cap
(2) Drain plug

(3) Oil level check bolt
(4) Lower edge of oil level
check hole

FUSE

As illustrated in Fig.4-20 , the fuse box (1) is located in the battery compartment. The main fuse, main fuse (electric shift motor), sub fuses and spare fuses are located in the fuse box.

The specified main fuse is:

30 A , 30 A (Electric shift motor)

The specified sub fuses are:

15 A × 2, 10 A × 2

If a fuse fails frequently, it usually indicates a short circuit or an overload in the electrical system. See your authorized Honda dealer for repair.

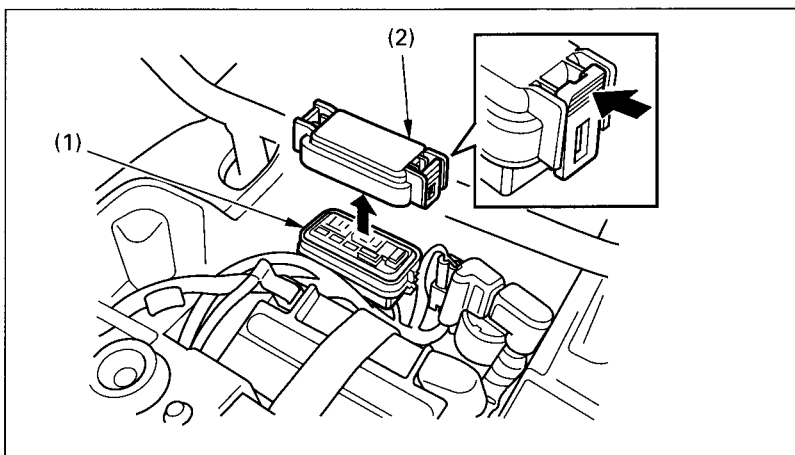

Fig. 4-20

(1) Fuse box
(2) Fuse box cover

To replace the main fuse:

1. Make sure the ignition switch is OFF (○).

CAUTION:

Turn the ignition switch OFF (○) before checking or replacing the fuse to prevent accidental short-circuiting which could damage the electrical system.

To adjust the free play, turn the brake pedal adjusting nut (1), (Fig. 4-29), located on the brake operating rod at the rear of the frame. Make sure the cut-out on the adjusting nut is properly seated on the brake arm pin (3).

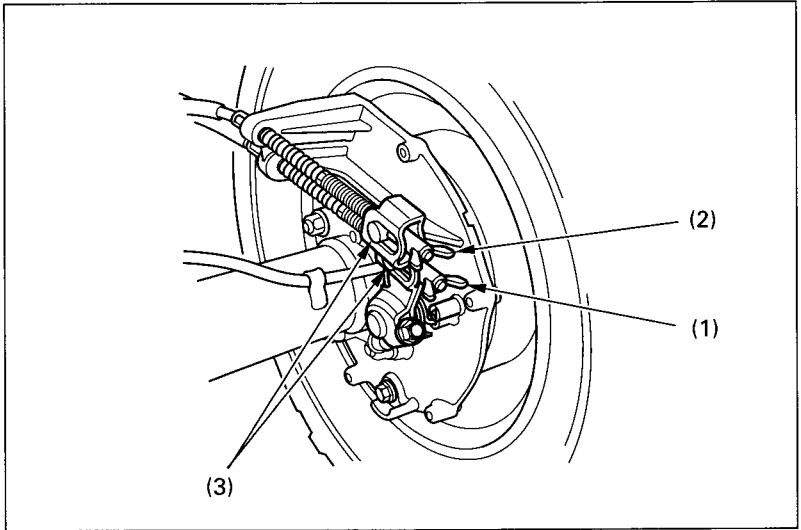

Fig. 4-29 (1) Brake pedal adjusting nut
 (2) Brake lever adjusting nut
 (3) Brake arm pin

ENGINE GUARD AND SKID PLATES

The engine guard (Fig. 4-38) protects the engine crankcase. The skid plates (2) protect the frame and rear final gear case. Check the guard and plates for cracks, damage or looseness at intervals shown in the Maintenance Schedule (page 96–97). Replace the guard and plates with new ones if they are cracked or damaged. If the guard and plate bolts are loose, tighten them securely.

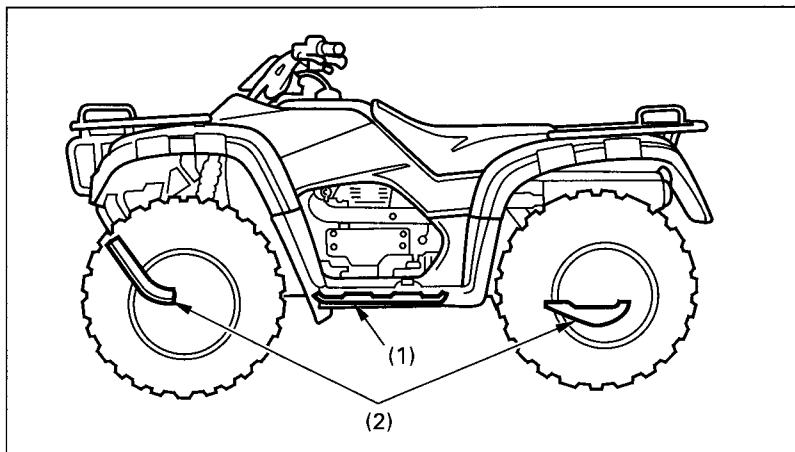

Fig. 4-38 (1) Engine guard

(2) Skid plates

STORING YOUR FOURTRAX

STORAGE

Before storing your FOURTRAX for an extended time, be sure you thoroughly check the vehicle for needed repairs and have them corrected. Otherwise, the repairs may be forgotten by the time you remove the vehicle from storage.

In addition, extended storage requires that you take the following steps to reduce the effects of deterioration from non-use of the vehicle:

1. Change the engine oil and oil filter.
2. Drain the fuel tank and carburetor. Be sure to drain the fuel in a well-ventilated area, not in a garage.

CLICK HERE TO **DOWNLOAD** THE COMPLETE MANUAL

- Thank you very much for reading the preview of the manual.
- You can download the complete manual from: www.heydownloads.com by clicking the link below



- Please note: If there is no response to CLICKING the link, please download this PDF first and then click on it.

CLICK HERE TO **DOWNLOAD** THE COMPLETE MANUAL