

NEW HOLLAND
TN60A
TN70A
TN75A

87352934 7/06
Replaces 87040063

NOT FOR REPRODUCTION

OPERATOR'S MANUAL

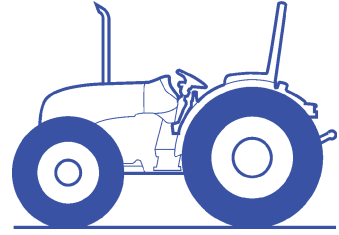

NEW HOLLAND

CLICK HERE TO **DOWNLOAD** THE COMPLETE MANUAL

- Thank you very much for reading the preview of the manual.
- You can download the complete manual from: www.heydownloads.com by clicking the link below



- Please note: If there is no response to CLICKING the link, please download this PDF first and then click on it.

CLICK HERE TO **DOWNLOAD** THE COMPLETE MANUAL

SECTION 1

GENERAL INFORMATION AND SAFETY

NOTICES FOR THE USERS

GENERAL GUIDELINES

This Use and Maintenance Manual provides a guide for the user with regard to running-in, use and maintenance of the tractor.

Read this manual carefully and keep in a convenient place for future reference. Do not hesitate to contact your local dealer for any queries concerning your tractor. The dealer can provide skilled personnel, trained by the manufacturer, original service parts and all tools and equipment necessary for your service requirements.

The tractor is designed as a power generator and drive-propulsion unit for use in normal and traditional agricultural conditions.

The tractor is also designed to provide maximum performance, economic running and easy use over a wide range of operations. Prior to delivery, all machines are carefully inspected (by both the Manufacturer and your local authorized dealer), to make sure that they reach the user in perfect condition. To maintain the tractor in this condition and ensure trouble-free operation, the routine maintenance described in Section 4 of this manual must be carried out at the specified intervals.

CLEANING THE TRACTOR

Your tractor is an advanced machine, fitted with an electrohydraulic control system. Care must be taken when cleaning the tractor, especially if a pressurized water cleaner is used.

- Never stand too close to the tractor or direct the water jet on electrical components, seals or intake openings, etc.
- Never direct jets of cold water at the hot engine or exhaust. See also page 4-38 (RECOMMENDATIONS FOR BODYWORK MAINTENANCE).

SAFETY

Safety precautions for the operator and bystanders are shown on page vi to xii inclusive. Read the safety instructions and follow recommendations and hints **before** starting to use the tractor.

SERVICE AFTER THE FIRST 50 HOURS OF WORK

The operations required for the first service are shown at the end of the Manual, immediately prior to the index.

After the first 50 hours of use, return to the dealer with your tractor and this Manual in order to carry out the Manufacturer's checks and to fill in the certificates included on pages 1 and 3). The first sheet (page 1) must be compiled on completion of the service and held by the dealer. The second sheet (page 3) must be kept in the Manual for documentation and reference purposes. **Check that both copies are signed by both yourself and the dealer.**

SPARE PARTS

"Non-original" spare parts have not been tested or authorized by the Manufacturer. Installment and/or use of such products may adversely affect the tractor's design specifications, thereby compromising operational safety. The manufacturer cannot be held responsible for any damage resulting from the use of "non-original" spare parts.

No modifications may be made to the tractor without written authorization from the Manufacturer.

WARRANTY

The tractor is guaranteed in accordance with current legislation in your country and in line with contractual agreements reached with the dealer at the time of sale. However, the warranty is no longer valid if the rules and instructions for the use and maintenance of the tractor, described in this Manual, are not observed.

SECTION 1 - GENERAL INFORMATION AND SAFETY

50. Before removing any hydraulic tubing, check that the system is not pressurized.

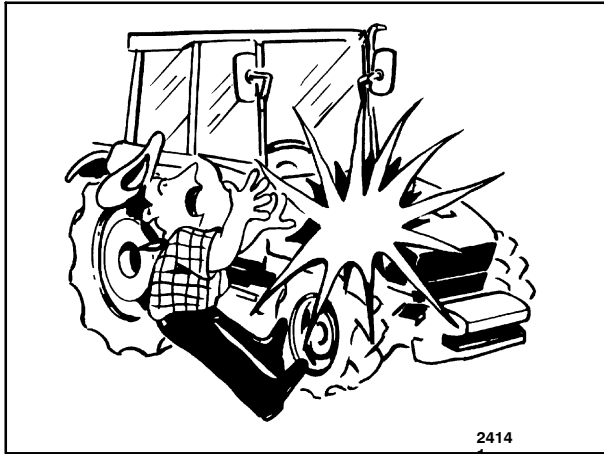

12

51. Leaks of pressurized oil can cause serious injuries. When looking for leaks use the appropriate safety equipment: screens, safety glasses and gloves.
52. Before touching any electrical components, disconnect the ground lead from the battery.

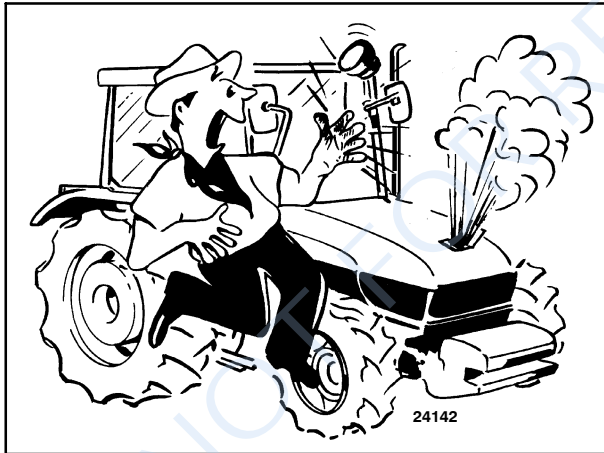

13

53. Only remove the radiator cap after the engine has been allowed to cool. With the engine switched off, use a cloth to slowly unscrew the cap and release the pressure before completely removing the cap.

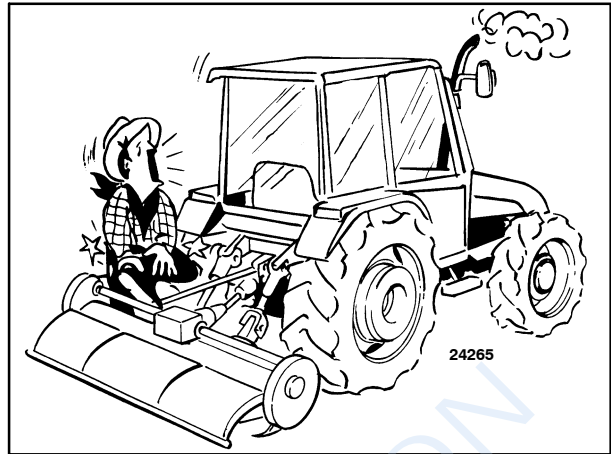

14

54. Before inspecting, cleaning or carrying out maintenance on the tractor (or any implement connected to the tractor), always ensure that the engine is switched off, the gears are in neutral, the brakes are on, the power take-off is disengaged and that all moving parts are stationary.
55. Do not fill up the fuel tank completely if the tractor is to work in extremely sunny conditions, as the fuel may expand and escape. If this occurs, dry up the spillage immediately.

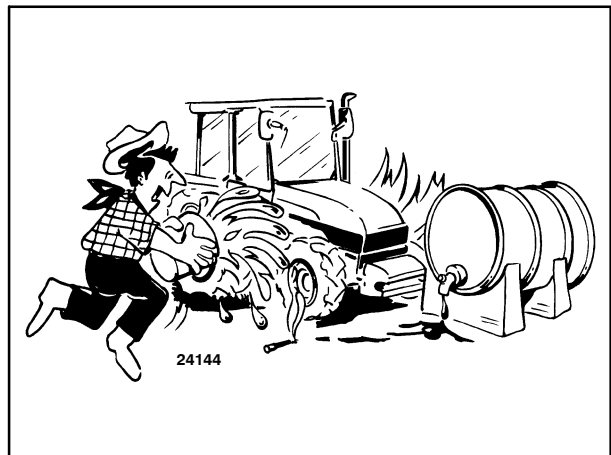

15

56. Always keep a fire extinguisher at hand.

SECTION 2

GENERAL INFORMATION, CONTROLS AND INSTRUMENTS

INTRODUCTION



Read and refer to this manual carefully, and always keep it in a convenient place so that you can refer to it whenever necessary. Carefully follow the safety precautions shown in section 1 of this manual.

BEFORE USING THE TRACTOR

This Use and Maintenance Manual has been produced to provide the user with information, documents and practical instructions.

Read this section of the manual carefully. It indicates the location of the various instruments, switches and controls on the tractor.

Read this section of the manual carefully and make sure that you are familiar with the location and function of all tractor components, even if you already have practical knowledge of other tractors.

The manual is subdivided into ten sections, as described on the "Contents" page. The alphabetical index is at the end of the manual.

Never start or try to use the tractor until you are sure how to operate the controls correctly.

Particular attention needs to be paid to the tractor's running-in period, to obtain the best operating reliability and service life for which it is designed and built.

The manufacturer is engaged in a continuous process of product development and improvement and therefore reserves the right to change the specifications, components and prices of the product itself at any time, without prior notice.

If you have any doubts about any functional aspect of the tractor, contact your NEW HOLLAND dealer.

The dealer can provide skilled personnel, original spare parts and the necessary equipment to carry out your service requirements.

All the data provided in this manual is subject to product modifications. Weights and measures are to be considered approximate figures and the illustrations do not necessarily show tractors with standard fittings.

For precise information on specific tractor models and versions, please contact your authorized dealer.

In this manual, the "left-hand" and "right-hand" parts of the tractor are as seen from the driver's seat facing forward.

Section 4 contains details of all general maintenance operations to be carried out on the tractor.

PEDAL CONTROLS

1. Transmission clutch pedal (for models with mechanical transmission)
2. Brake pedal lock pin
3. Right brake control pedal
4. Accelerator pedal
5. Left brake pedal

⚠ DANGER ⚠

When travelling on roads, always connect the brake pedals with pin. Braking when the pedals are not connected could cause the tractor to skid.

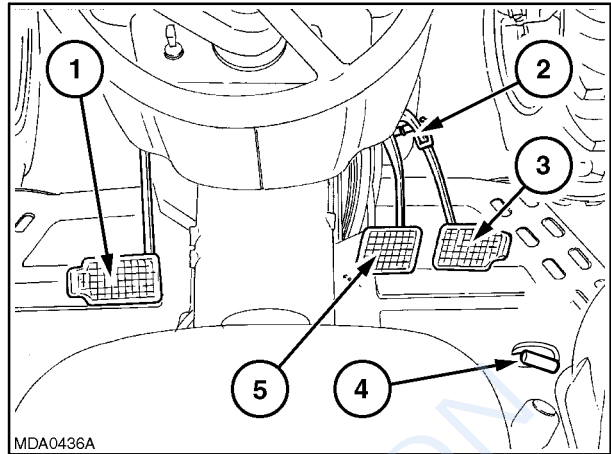

NOT FOR REPRODUCTION

TRANSMISSION WITH SYNCHRO-COMMAND (SYNCHRONIZED MECHANICAL SHUTTLE) 30/40 km/h (18.64/24.85 mph) (16F+16R)

! DANGER !

With the engine running and only one gear lever in neutral, the tractor could be engaged and start moving if the lever is accidentally operated, which may lead to possible accidents. To avoid this hazard, move both levers to neutral, disengage the power take-off, lower any implements and apply the handbrake before leaving the tractor.

To start the engine move the gear lever, 1, to the neutral position, and press the clutch pedal fully down.

The gear lever, 1, selects gear ratios from 1 to 4.

The range lever, 2, provides four ranges:

- Range A - Slow
- Range BL - Medium Slow
- Range BH - Medium Fast
- Range C - Fast

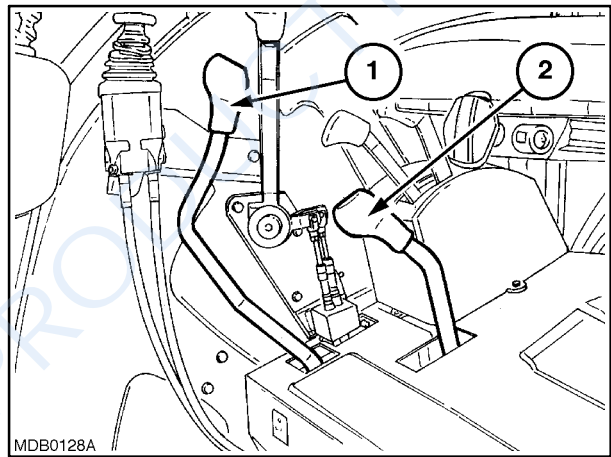

36

Separate use of the gear lever, the range gear lever, and the mechanical shuttle lever allows **16** forward gears and **16** reverse gears to be selected.

NOTE: The neutral position of the gear lever, 1, and the range lever, 2, is indicated by the black dot in the figure.

To change from one range to another, always stop the tractor; to change from one speed to another within the same range, disengage the clutch and move the main gear lever (the tractor does not have to be halted as the gears are synchro-engaged).

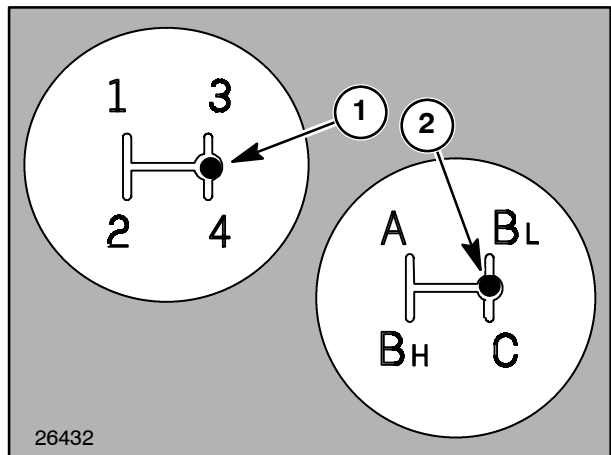

37

SECTION 3

FIELD OPERATION

WARNING

In order to prevent accidents and safeguard the operator, carefully read the use and safety instructions before starting the engine and using the tractor.

Read this section of the operator's manual carefully before using the tractor. This is particularly important if the tractor is to be used correctly as it contains all the information required on the layout and use of the tractor controls.

Even if you already have experience in using other makes of tractor, this section of the manual especially must be studied carefully and thoroughly.

After reading this section in full, ensure that you are fully familiar with the layout and use of the controls. Ensure too that you know the specifications of the tractors in question.

Never start the engine and tractor if you have not already familiarized yourself with all the controls.

Finding out once the tractor is moving may be too late.

If you have any doubts about any functional aspect of the tractor, contact your NEW HOLLAND dealer.

Particular attention needs to be paid to the tractor's running-in period, to obtain the best operating reliability and service life for which it is designed and built.

With regard to the reliability and service life of your tractor, read Section 4 completely.

Section 4 contains details of all the lubrication and general maintenance operations to be carried out on the tractor.

Section 8 contains tractor data and specifications.

CAUTION

Before starting the engine and moving the tractor, follow the instructions noted below:

- Do not start or operate the tractor in an enclosed area.
 - Before starting the engine, check that all controls are in neutral.
 - All controls must only be operated from the driving position.
 - Stop the engine before carrying out any service or maintenance operations on the tractor.
 - Use the steps provided for entering and leaving the tractor.
 - Keep the guards properly fitted.
 - When driving on roads, indicate all intentions to stop, turn or slow down.
 - Use the appropriate warning devices to signal the presence of a slow-moving vehicle.
-

STARTING THE ENGINE

If the tractor has not been used for some time, or is started up for the first time in low outside temperature conditions, operate the fuel pump starting lever approximately twenty times and allow the engine to run for 5 ÷ 10 seconds with the injection pump in the «stop» position.

Press down the clutch pedal, place the shuttle control lever in neutral to close the starting safety device switch.

Move the throttle lever to approximately the half-way position.

Turn the starter key to position **C** (ON). then release the key as soon as the engine starts.

POWER TAKE-OFF OPERATION

Operation of Power Take-off

To operate the power take-off, proceed as follows:

- Slowly engage the clutch by moving the lever, 1, into the horizontal position as in fig. 13 to set the splined output shaft in motion. Engagement is shown by the illumination of the PTO indicator on the instrument panel.

Operation is independent of tractor ground speed, therefore it is possible to:

- Halt the tractor without stopping the power take-off.
- Stop the power take-off without halting the tractor (by disengaging the power take-off clutch).

The shaft rotates clockwise, as seen from behind the tractor.

To disengage the power take-off, move the control lever, 1, upward.

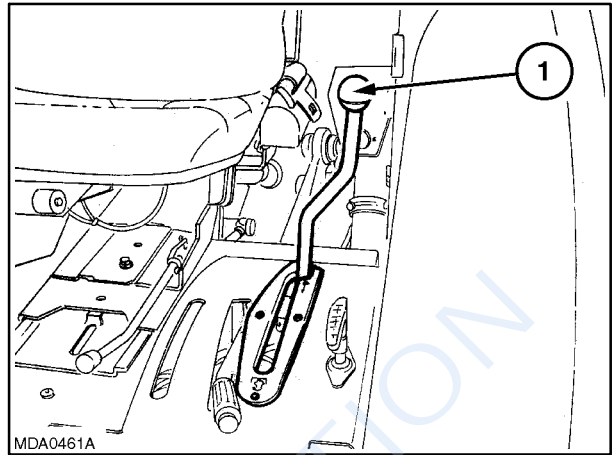

12

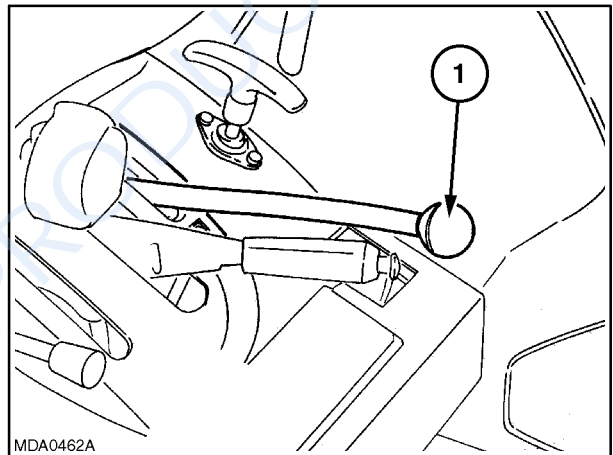

13

———— **⚠ CAUTION ⚠** ————
Always disengage the power take-off before leaving the tractor.

———— **⚠ WARNING ⚠** ————
When the power take-off is not in use, keep the clutch lever in the disengaged position.

———— **⚠ DANGER ⚠** ————
Always make sure that the plastic guards on the drive shaft connected to the power take-off are in perfect condition.

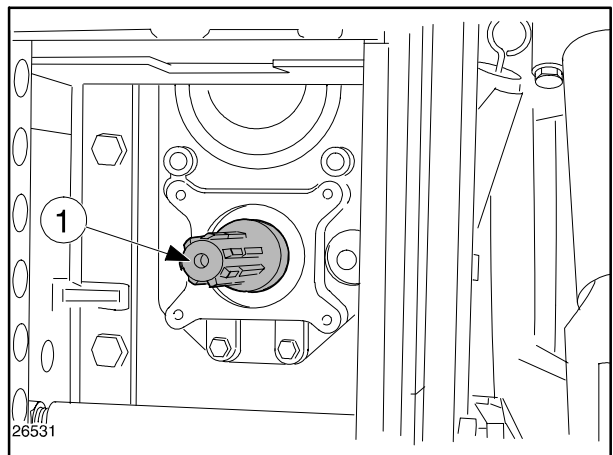

14

CLICK HERE TO **DOWNLOAD** THE COMPLETE MANUAL

- Thank you very much for reading the preview of the manual.
- You can download the complete manual from: www.heydownloads.com by clicking the link below



- Please note: If there is no response to CLICKING the link, please download this PDF first and then click on it.

CLICK HERE TO **DOWNLOAD** THE COMPLETE MANUAL

FWD IMPLEMENT LINKAGE POINTS

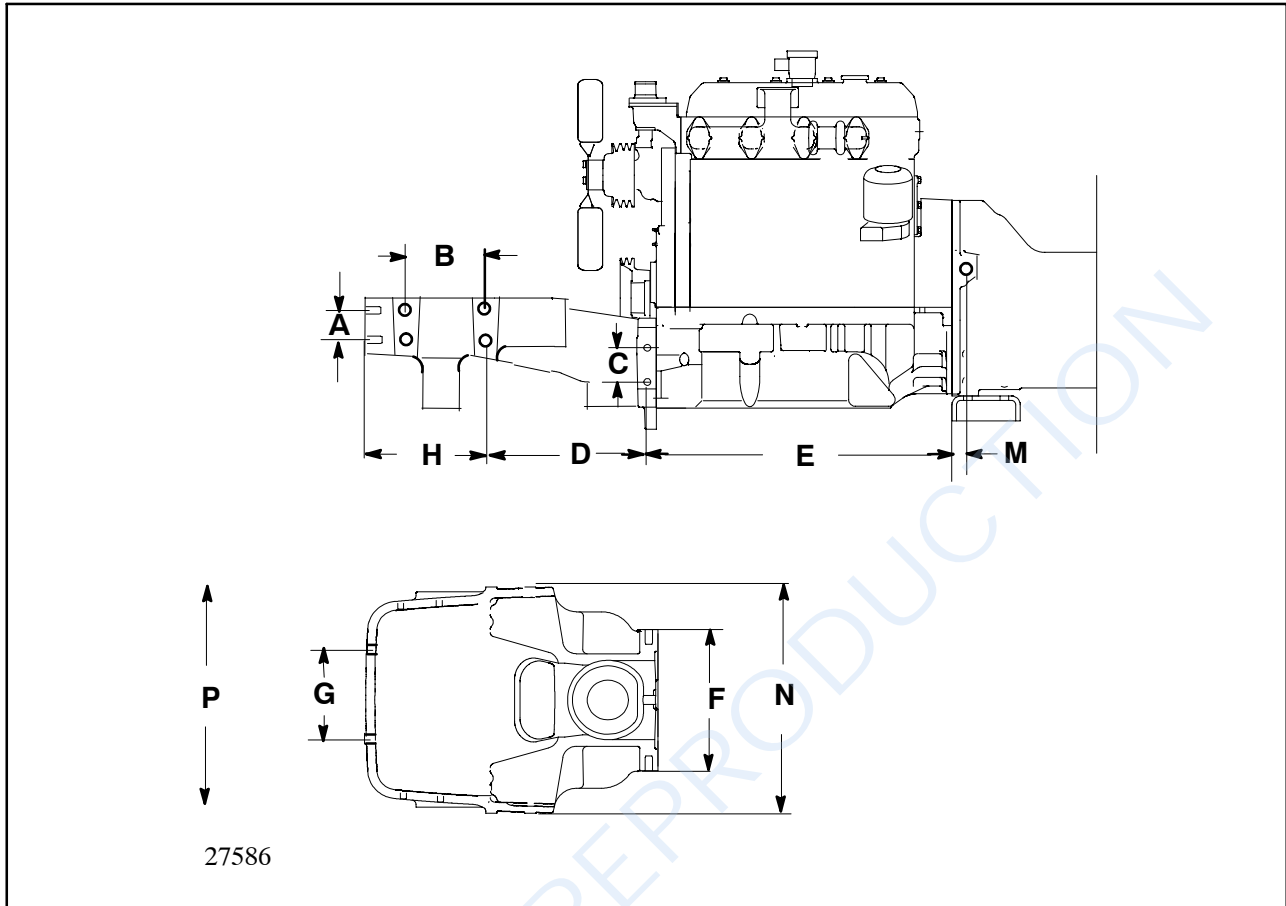

34

Both sides of the tractor are equipped with threaded holes for connecting implements and auxiliary equipment.

The figure shows the free fixing holes on the left hand side of the tractor, which are identical and symmetrical to the fixing holes on the right hand side.

⚠ WARNING ⚠

Only use the holes specified when mounting auxiliary equipment.

The use of different holes for auxiliary applications automatically exonerates CNH AMERICA LLC from all liability in relation to damage to the vehicle or injury to persons, resulting from failure to observe the relative regulations.

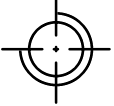
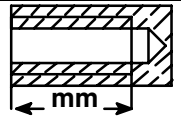
Measurement mm (in.)		
A 75 (2.9527)	M 20 x 2.5	38 mm (1.49 in.)
B 154 (6.0629)		
C 75 (2.9527)		
D 406 (15.98)		
E 554 (21.81)		
F 320 (12.59)		
G 174 (6.8503)		
H 237 (9.3307)		
M 35 (1.3779)		35 mm (1.37 in.)
N 560 (22.04)	-	-
P 524 (20.62)	-	-

TIRES

USE, MAINTENANCE AND REPLACEMENT



Tires must be changed by skilled personnel, with the correct tools and technical know-how. If tires are replaced by unskilled personnel, serious physical injuries may result, the tires may be damaged and the wheel rim may be distorted.

- When changing tires, select suitable tires for the actual tractor use, and using the recommended tire combinations in this section.
- Do not exceed the permitted load indicated in this section.
- Do not exceed the speeds shown on the tires, as this both overheats and causes premature tire wear.
- Do not fit used tires when the previous use is unknown.
- Ask the manufacturer or a tire specialist for advice.
- After installing tires, recheck the wheel nuts for tightness after 3 hours of operation and then periodically.
- Do not stand tires on hydrocarbons (oil, diesel, grease, etc.)
- The tires fitted on the tractor must be checked periodically, with special care given to:
 - Tire tread: which should wear uniformly.
 - Tire sidewall: which must not have cracks, bulges or abrasions.
- Have the tires checked by a specialist if one or more of the problems mentioned above should occur.
- Consult an expert if a tire is subject to violent shocks, even if there are no visible signs of damage.
- Tires age, even if used infrequently or not at all.
- Cracks on the walls, sometimes accompanied by bulges, are a sign of ageing.
- Tires fitted on tractors which are not used for extended periods tend to age more rapidly than those used more frequently. In this event, it is advisable to raise the tractor from the ground and protect the tires from direct sunlight.

LIQUID BALLAST

WATER INLET AND OUTLET CONNECTORS

1. Water inlet point.
2. Water drainage pipe.
3. Air line connector.
4. Water drainage pipe.

Water can be used to ballast the rear tires if there is no danger of freezing.

FILLING THE TIRES WITH WATER:

- raise the wheel from the ground and position the inflation valve at the highest point;
- loosen the inner element on the valve and wait for the tire to deflate;
- lower the wheel until the tire is approx. 30% flat to prevent the weight of the water damaging the inner tube;
- screw the NEW HOLLAND connector (no. **291885**) onto the valve and attach the water pipe to the connector, 1, remembering to detach the pipe to release air when the tire begins to inflate;
- when water escapes from the connector, 1, the tire is 75% full.

If you want to introduce less water, or achieve a lower weight, position the wheel so that the valve is lower;

- remove the connector, 1, tighten the tire valve and inflate to the specified pressure.

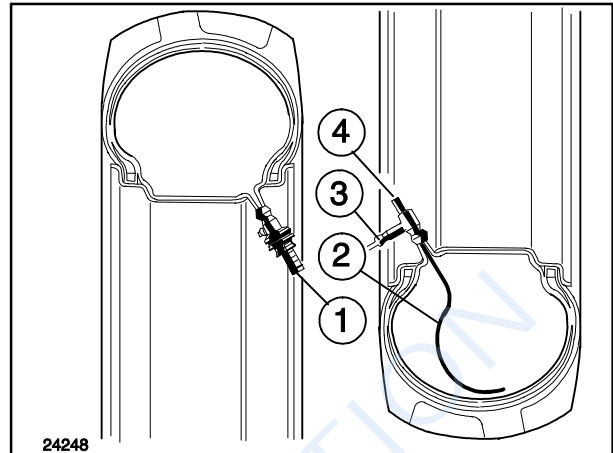

24248

60



The pressure of the water introduced must never exceed 4 bar (58 psi).

DRAINING WATER FROM THE TIRES:

- raise the wheel from the ground and position the inflation valve at the lowest point;
- loosen the valve seal and drain off the water;
- screw the NEW HOLLAND connector (no. **291886**) onto the valve, tubes, 2, and, 4, will make contact with the inner tube;
- introduce pressurized air into the connector, 3, the remaining water will drain out through pipes, 2, and, 4;
- remove the connector and replace, together with the valve seal, then inflate the tire to the specified pressure.

FLEXIBLE MAINTENANCE

OPERATION 1.

ADJUSTMENT ENGINE/GEARBOX CLUTCH (WITH MECHANICAL TRANSMISSIONS)

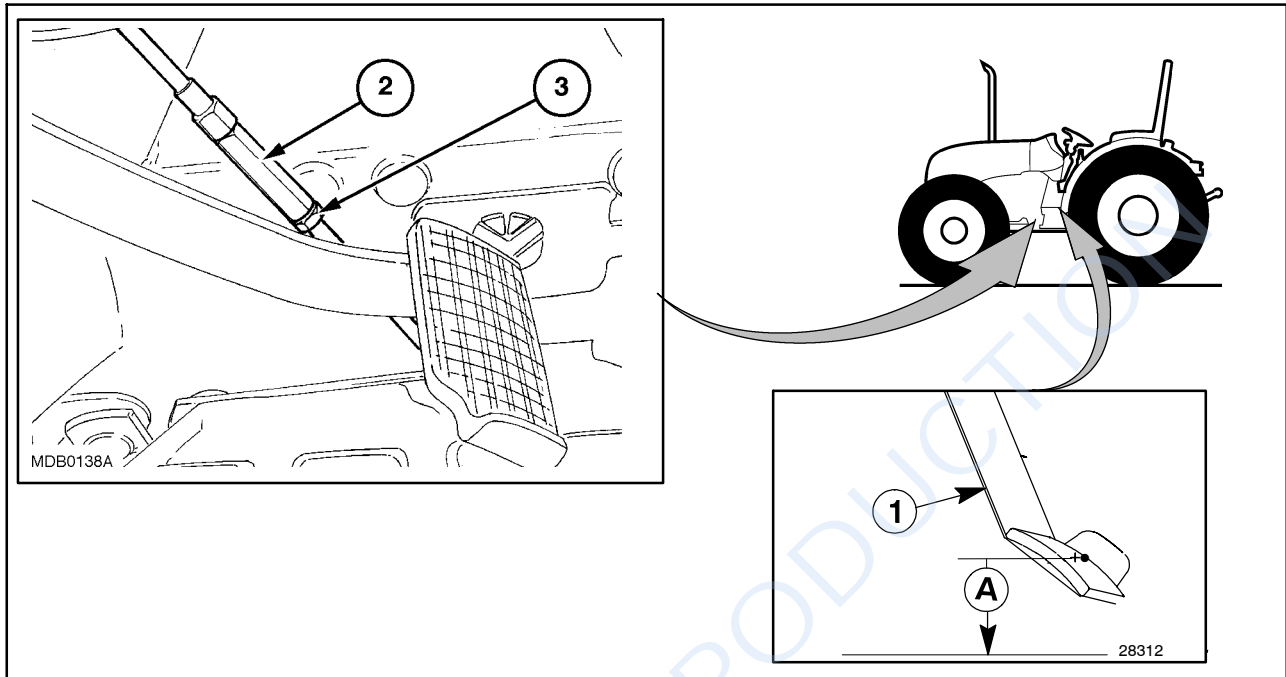

4

If pedal travel becomes uncomfortable, or to prevent the clutch from slipping, check that the distance **A** of the engine/gearbox clutch pedal, 1, (with pedal released) from the board is 140 ± 2 mm (5.5118 ± 0.07874 in.) (for all models), if not, adjust as follows:

- Loosen the locknut, 3, and screw the nut, 2, anticlockwise;
- Check that the distance **A** is correct;
- Tighten the locknut, 3.

OPERATION 19.**FUEL PUMP FILTER**

Remove cover, 1, and clean the internal filter.

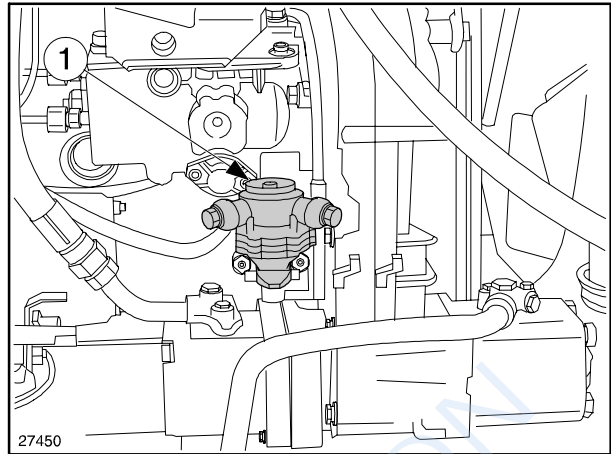

27

OPERATION 20.**SERVICES AND TRANSMISSION OIL FILTER**

Unscrew the container, 1, and replace the internal filter. Before re-positioning the container, oil the seals and screw on by hand for 3/4 of a turn. Top up with new oil (see operation no. 24.).

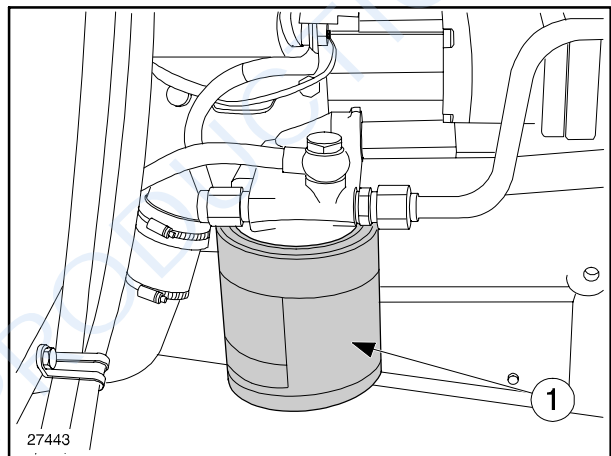

28

OPERATION 21.**OIL FILTER FOR ELECTROHYDRAULIC POWER-SHUTTLE TRANSMISSION**

Replace the filter inside the container, 1, under the cab, on the right-hand side. Before re-positioning the container, oil the seals and screw on by hand for 3/4 of a turn. Top up with new oil (see operation no. 24.).

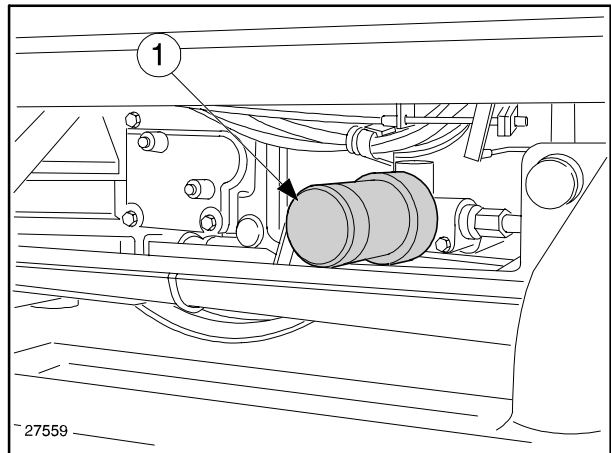

29

GENERAL MAINTENANCE

BLEEDING THE FUEL SYSTEM

Bleeding procedure

During long periods when the tractor is not used, when the filter and fuel lines are removed or when the fuel tank is empty, air may enter the fuel system.

The presence of air makes it difficult to start the engine, which will require bleeding as follows:

1. Unscrew the bleed plug, 1, by two turns.
2. Pump the lever, 1, until fuel without air bubbles spurts out of the bleed hole.
3. Tighten the bleed plug.
4. Unscrew the fuel injectors.
5. Pump the lever again, 1, until fuel without air bubbles spurts out, then tighten the injectors.
6. Turn the starter key to the ON position and, when the engine starts, release the key.

NOTE: If the engine does not start, repeat steps 1 to 6. If the engine still fails to start, contact your local dealer.

NOTE: The engine is fitted with a rotary injection pump with internal components that must be protected from rusting if not used for over a month. Therefore, before stopping the tractor, mix PROT 10 W/M oil into the fuel in the tank in a proportion of 10% and run the engine for approximately half an hour.

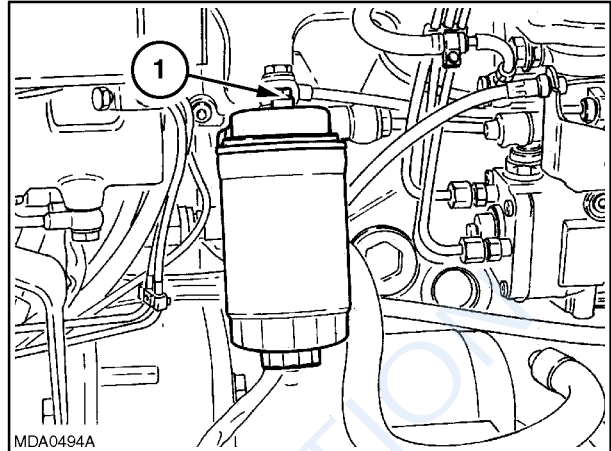

52

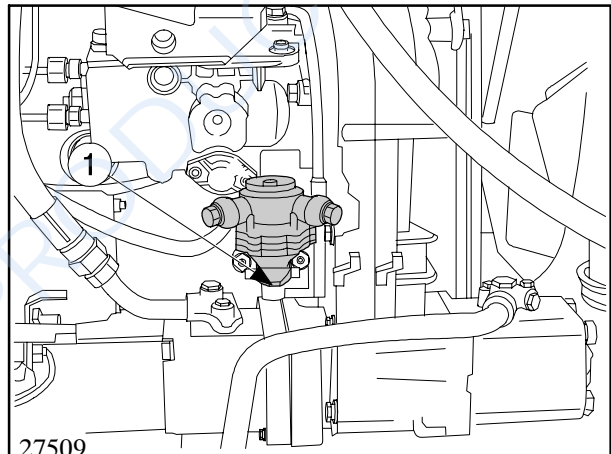

53

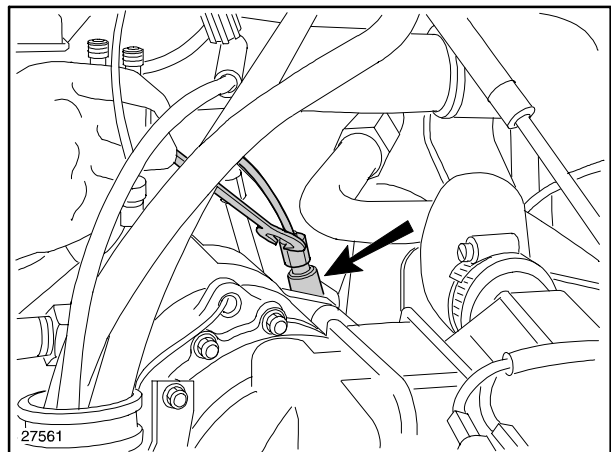

54

WORK LIGHTS FOR TRACTORS WITH ROLL BARS

To access the lamp, pull back the rubber hood, 2, and remove the transparent cover, 1.

Press the bulb, 3, in and twist anticlockwise to remove.

Replace the burnt out bulb with a new bulb of the same power (35 W).

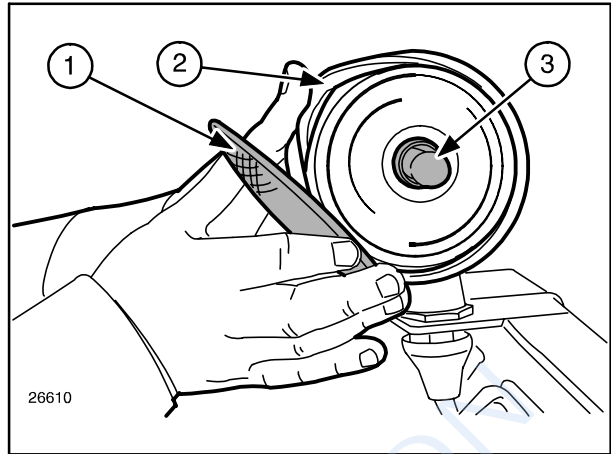

67

To access the indicators, proceed as follows:

- Loosen the four retaining screws, 1.
- Remove the instrument from its seat.

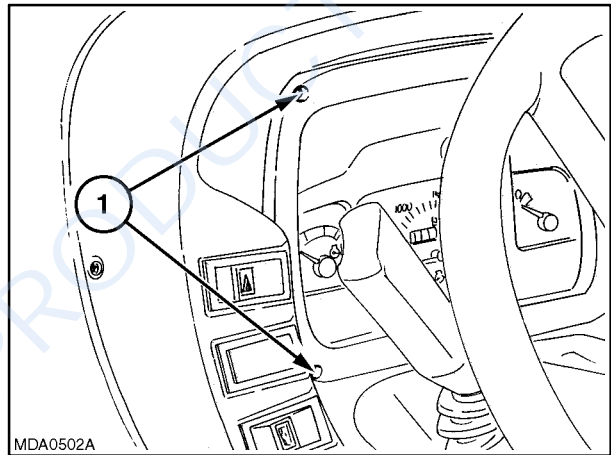

68

- Turn the burnt-out indicator, 1, counter-clockwise by 1/4 of a turn.
- Replace with a new indicator bulb of the same power (2 W).

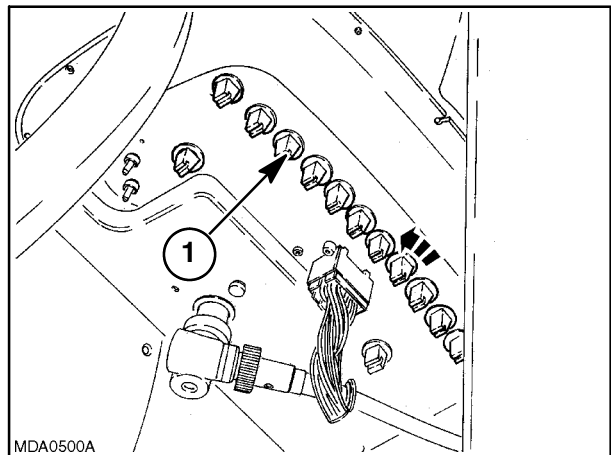

69

HYDRAULIC LIFT AND THREE POINT LINKAGE

CONDITION	POSSIBLE CAUSE	SOLUTION
The linkage does not move when the control lever is actuated	Linkage cylinder tubes not connected correctly	Connect linkage cylinder tubes correctly
	Linkage overload	Reduce load
The hydraulic lift operates slowly in draft control	Combined draft/position control incorrectly set	Adjust combined draft/position control
	Lowering speed too slow	Have control valve checked
	Implement not working properly	Adjust implement settings
The hydraulic lift operates too fast in draft control	Combined draft/position control incorrectly set	Have control valve checked

FRONT BALLAST

Each plate	kg (lbs)	40 (88.18)
Ballast support	kg (lbs)	60 (132.27)
Plate Assembly (4plates)	kg (lbs)	160 (352.73)
Plate Assembly (6 plates)	kg (lbs)	240 (529.10)

REAR BALLAST

Each ring	kg (lbs)	50 (110.23)
Ring Assembly (4 rings)	kg (lbs)	200 (440.92)

or

Each ring	kg (lbs)	32 (70.54)
Assembly (6 rings)	kg (lbs)	192 (423.28)

WEIGHTS OF TRACTORS WITHOUT BALLAST

- TN60A		
2WD	kg (lbs)	2350 (5180.86)
FWD	kg (lbs)	2450 (5401.32)
- TN70A		
2WD	kg (lbs)	2400 (5291.09)
FWD	kg (lbs)	2600 (5732.01)
- TN75A		
2WD	kg (lbs)	2400 (5291.09)
FWD	kg (lbs)	2600 (5732.01)

NOT FOR REPRODUCTION

CLICK HERE TO **DOWNLOAD** THE COMPLETE MANUAL

- Thank you very much for reading the preview of the manual.
- You can download the complete manual from: www.heydownloads.com by clicking the link below



- Please note: If there is no response to CLICKING the link, please download this PDF first and then click on it.

CLICK HERE TO **DOWNLOAD** THE COMPLETE MANUAL