

# **TEREX AERIALS**

## **OPERATOR'S MANUAL**

### **SCISSOR LIFT, MODELS: TS37RT, TS46RT**

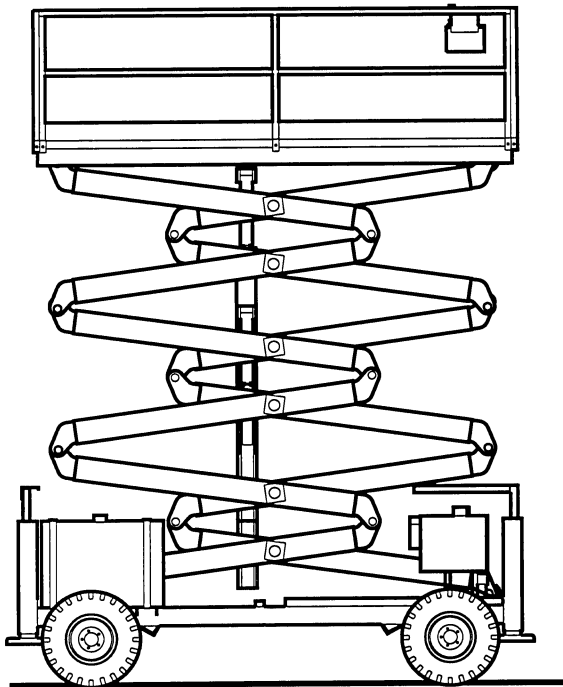

Art # A00.00956E

FOR PARTS OR SERVICE  
CONTACT:

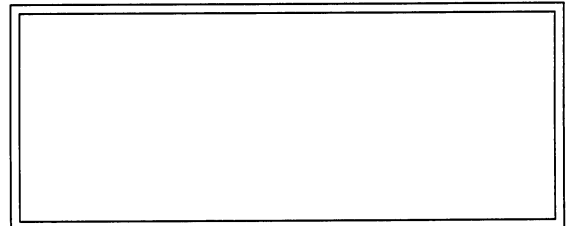

## **OPERATION AND OPERATOR MAINTENANCE MANUAL**

**Terex Aerials**  
10600 W. Brown Deer Road  
Milwaukee, WI 53224  
U.S.A.

**Telephone:** (414) 362-9300  
**Facsimile:** (414) 355-0832

**Terex Aerials**  
106 12th Street S. E.  
Waverly, IA 50677  
U.S.A.

**Telephone:** (319) 352-3920  
**Facsimile:** (319) 352-5727

**Terex Aerials**  
Courtstown Industrial Park  
Little Island, Co.  
Cork, Ireland

**Telephone:** (353) 21-353011  
**Facsimile:** (353) 21-353368

Preliminary Issued: Jul 97  
P/N 17244

CLICK HERE TO **DOWNLOAD** THE COMPLETE MANUAL

- Thank you very much for reading the preview of the manual.
- You can download the complete manual from: [www.heydownloads.com](http://www.heydownloads.com) by clicking the link below



- Please note: If there is no response to CLICKING the link, please download this PDF first and then click on it.

CLICK HERE TO **DOWNLOAD** THE COMPLETE MANUAL

# **TEREX AERIALS**

## **OPERATOR'S MANUAL**

### **Safety**



#### **General Information (Continued)**

13. **Do not** raise, lower or drive the platform into stationary objects.
14. **Do not** use the aerial lift to push or tow another vehicle.
15. Whenever **disengaging the hydraulic drive motors** or **disconnection from a towing vehicle**, ensure that the aerial lift cannot roll.
16. **Avoid** sudden braking or steering, go slowly and leave more maneuvering room during cold weather operation until the aerial lift has warmed up.
17. **Immediately report** any unusual noises, vibrations or malfunctions of the aerial lift to appropriate personnel. Machine shall be removed from service until diagnosis and any necessary repairs have been completed.
18. **When leaving the aerial lift**, lower platform to “full down” position and remove key from ground control to prevent unauthorized use.
19. **Refuel** aerial lift in a **well ventilated area** free of any hazards which may cause fuel fumes to ignite.
20. **Check fuel system** for leaks or damaged fuel lines before operating the machine. If any damage is found, contact your supervisor immediately. Machine shall be removed from service until diagnosis and any necessary repairs have been completed.
21. It is not possible for us to foresee every situation that could arise during operation of this aerial lift. Even if we do not state specifically that a particular action **should not be taken**, that does not mean that it is safe to do so. Personal injury or damage to equipment may result. If in doubt, contact Terex Customer Service.

# **TEREX AERIALS**

## **OPERATOR'S MANUAL**

### **Specifications**

#### **Machine Specifications**

#### **Model TS46RT**

* Working Height .....	<b>52 ft. (15.85 m)</b>
Maximum Platform Height .....	<b>46 ft. (14.02 m)</b>
Stowed Height:	
With Platform Rails Installed .....	<b>123.5 in. (3.14 m)</b>
With Platform Rails Removed .....	<b>81.5 in. (2.07 m)</b>
Platform Capacity (Evenly Distributed):	
With Standard Deck .....	<b>1,250 lbs. (560 kg)</b>
With Traversing or Roll-Out Deck (Option) .....	<b>1,000 lbs. (450 kg)</b>
Rated Number of Occupants in Platform .....	<b>4</b>
Platform Dimensions:	
With Standard Deck .....	<b>76 in. x 160 in. (1.93 m x 4.1 m)</b>
Guard Rail Height (Fixed) .....	<b>42 in. (1.07 m)</b>
Guard Rail Height (Folded, Optional) .....	<b>21.25 in. (0.54 m)</b>
Toe Board Height .....	<b>6 in. (1.5 cm)</b>
Roll-Out Deck .....	<b>3 ft. (0.91 m) forward</b>
Traversing Deck (Optional) .....	<b>4 ft. (1.22 m) forward</b>
Machine Length (Overall) .....	<b>14 ft. (4.27 m)</b>
Machine Width (Overall) .....	<b>8 ft. 3 in. (2.52 m)</b>
Wheelbase .....	<b>9 ft. 9 in. (2.97 m)</b>
Wheel Track .....	<b>7 ft. 1 in. (2.16 m)</b>
Inside Turning Radius .....	<b>13 ft. (3.96 m)</b>
Outside Turning Radius .....	<b>22 ft. (6.71 m)</b>
Ground Clearance .....	<b>10 in. (25.4 cm)</b>
Shipping Weight (Approx.) .....	<b>8,445 lbs. (3830 kg)</b>

### **WARNING**

**\* CLEARANCE MUST BE ALLOWED FOR BODY PARTS OF PERSONNEL IN PLATFORM AT THIS AND ALL OTHER WORK HEIGHTS.**

 **TEREX AERIALS**  
**OPERATOR'S MANUAL**

**Controls and Instruments**

**Aerial Control Station Controls Description (Continued)**

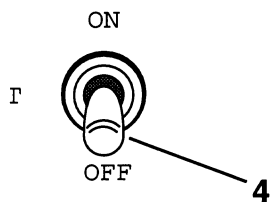

4. **Choke Switch (for Gas or Dual Fuel engines).** Raise the toggle switch to the "ON" position and hold while starting a cold engine. Release switch once the engine is running.

**Glow Plug Switch (for some Diesels).** Raise the toggle switch to the "ON" position and hold to preheat the combustion chamber. Release switch before starting Diesel engine.

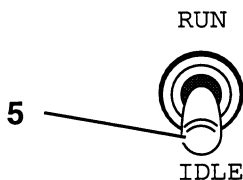

5. **Engine "Run/ Idle" Speed Switch.** Move the toggle switch to the "RUN" position to raise engine speed for operating functions or traveling. Move the switch to "IDLE" to reduce engine speed.

# **TEREX AERIALS**

## **OPERATOR'S MANUAL**

### **Controls and Instruments**

#### **Aerial Control Station Controls Description (Continued)**

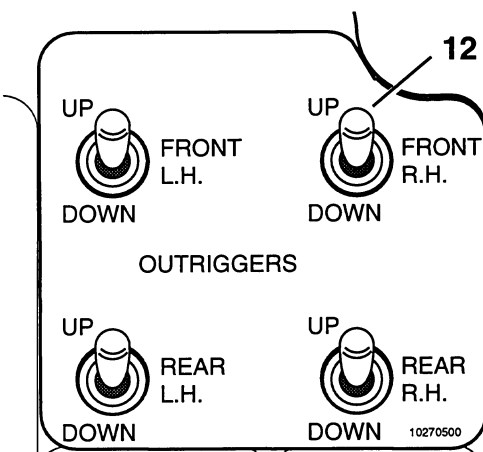

12. Four **Outriggers** (each operated by a separate switch) are also optional on TS37RT and TS46RT aerial lifts.

Press and hold a switch in the "DOWN" position to lower the selected outrigger.

Press and hold the switch in the "UP" position to raise the outrigger.

 **TEREX AERIALS**  
**OPERATOR'S MANUAL**

**Controls and Instruments**

**Ground Control Station Controls Description (Continued)**

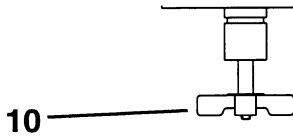

10. Brake Valve. Must be open (fully counterclockwise) for normal operation. Close by turning fully clockwise before operating the brake release pump to manually release the brakes. Use to manually release the brakes. Refer to "Moving the Machine".

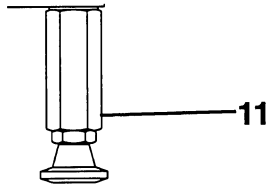

11. Brake Palm Pump. Pump to manually release the brakes. Brake valve must be closed.

# **TEREX AERIALS**

## **OPERATOR'S MANUAL**

### **Before Operation Checks**

#### **What Should I Know? (Continued)**

#### **4. Stabilizer (Outrigger) and Platform Raise Cutout**

The platform cannot be raised above 30' (25' when equipped with optional outriggers) without the stabilizers (outriggers) deployed.

#### **To Determine if Stabilizer (Outrigger) and Platform Raise Cutout is Operational:**

- a. Select a test area having a smooth, prepared surface and one which is free from any obstacles, personnel or any other hazards to travel.
- b. Try to raise the platform over 30' (25' when equipped with optional outriggers). See "Aerial Control Box" control descriptions in Section 4, "Controls and Instruments".

The platform should not rise above 30' (25' when equipped with optional outriggers) without the stabilizers (outriggers) deployed. If it does, **do not operate** the aerial lift until repairs have been made by a qualified technician.

#### **D. Platform Capacity**

- **The capacity of the platform and the capacity of the extendable platform deck** are posted on the platform and in the "Specifications" section of this manual.
- The platform capacity is equal to the **combined weight of personnel, tools and supplies** to be carried in the platform. The combined weight of personnel, tools and supplies **must not exceed** the posted platform capacity.
- Do not exceed the **maximum number of personnel** allowed on the platform. This information is posted on the platform and can be found in the "Specifications" section of this manual.

# **TEREX AERIALS**

## **OPERATOR'S MANUAL**

### **Operation**

#### **Things You Need to Know (Continued)**

#### **B. Traveling on Prepared Level Surfaces (Continued)**

### **WARNING**

**WITH THE AERIAL CONTROL BOX FACING AWAY FROM THE FRONT OF THE PLATFORM, USE CAUTION WHEN SELECTING THE TRAVEL OR STEER DIRECTION.**

**TRAVEL AND STEER DIRECTION WILL BE OPPOSITE TO DRIVE CONTROL LEVER OR STEER SWITCH MOVEMENT.**

The following directions assume the control box is in its “normal” position at the front of the platform (where a locking pin can be used to position the box).

5. Drive the aerial lift by engaging the Controls Enable Switch and operating the Drive/Steer Control Lever forward to drive the aerial lift forward, and back to drive in reverse.

Proportional controls are **standard**. Vary the drive speed from zero to maximum by gradually moving the handle away from the center “off” position.

Release lever to stop movement and apply brakes. Lever is spring centered to the “off” position.

Press and hold down the left side of the Steer Switch (on end of Drive Control Lever) to turn steer wheels to the left. Press and hold down the right side to turn right.

Release switch when desired steer angle is attained. Switch will return to the “off” position.

Wheels will remain turned to the selected angle. Press and hold the switch in the opposite direction to straighten wheels or reverse direction.

 **TEREX AERIALS**  
**OPERATOR'S MANUAL**

**Unloading**

**Unloading the Aerial Lift NOT Under Its Own Power (Continued)**

**NOTE:** The parking brake free wheel valve is located on the control inside the component box, next to the ground control station on the left hand side of the aerial lift.

3. To close free wheel valve, turn valve clockwise until completely closed; then operate the palm pump.
4. Make sure the **winch cable** is properly attached to the aerial lift. Remove all tie downs and wheel blocks.

**NOTE:** If unloading from a “roll back” or “tilt back” truck, make sure the winch cable is properly attached and that all slack is out of the cable before raising the truck bed.

5. When the aerial lift has been unloaded to level ground, block the wheels and open the parking brake free wheel valve before disconnecting the winch cable or attempting to move the aerial lift.

 **WARNING**

**ALWAYS REMEMBER TO OPEN FREE-WHEELING VALVE TO RE-STORE PARKING BRAKE OPERATION.**

6. To open free wheel valve, turn valve counterclockwise until completely open.

 **TEREX AERIALS**  
OPERATOR'S MANUAL

**Loading**

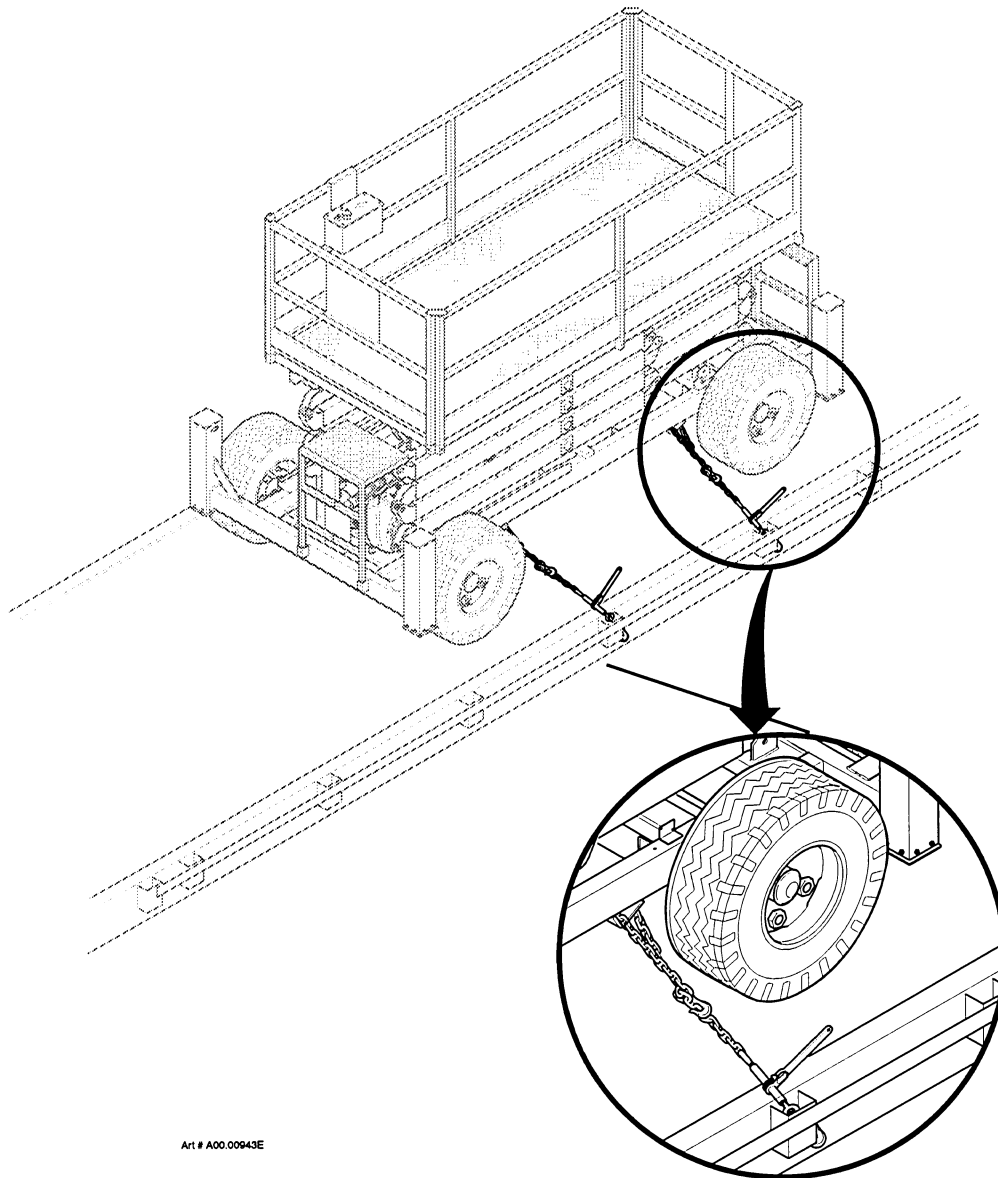

Art # A00.00943E

CLICK HERE TO **DOWNLOAD** THE COMPLETE MANUAL

- Thank you very much for reading the preview of the manual.
- You can download the complete manual from: [www.heydownloads.com](http://www.heydownloads.com) by clicking the link below



- Please note: If there is no response to CLICKING the link, please download this PDF first and then click on it.

CLICK HERE TO **DOWNLOAD** THE COMPLETE MANUAL