

santal

Operator's Manual
PDM2

Seedlings Planter 2 lines

7500.082.0 - 08/13



CLICK HERE TO **DOWNLOAD** THE COMPLETE MANUAL

- Thank you very much for reading the preview of the manual.
- You can download the complete manual from: www.heydownloads.com by clicking the link below



- Please note: If there is no response to CLICKING the link, please download this PDF first and then click on it.

CLICK HERE TO **DOWNLOAD** THE COMPLETE MANUAL

1

1.2 Safety and Precaution Decals

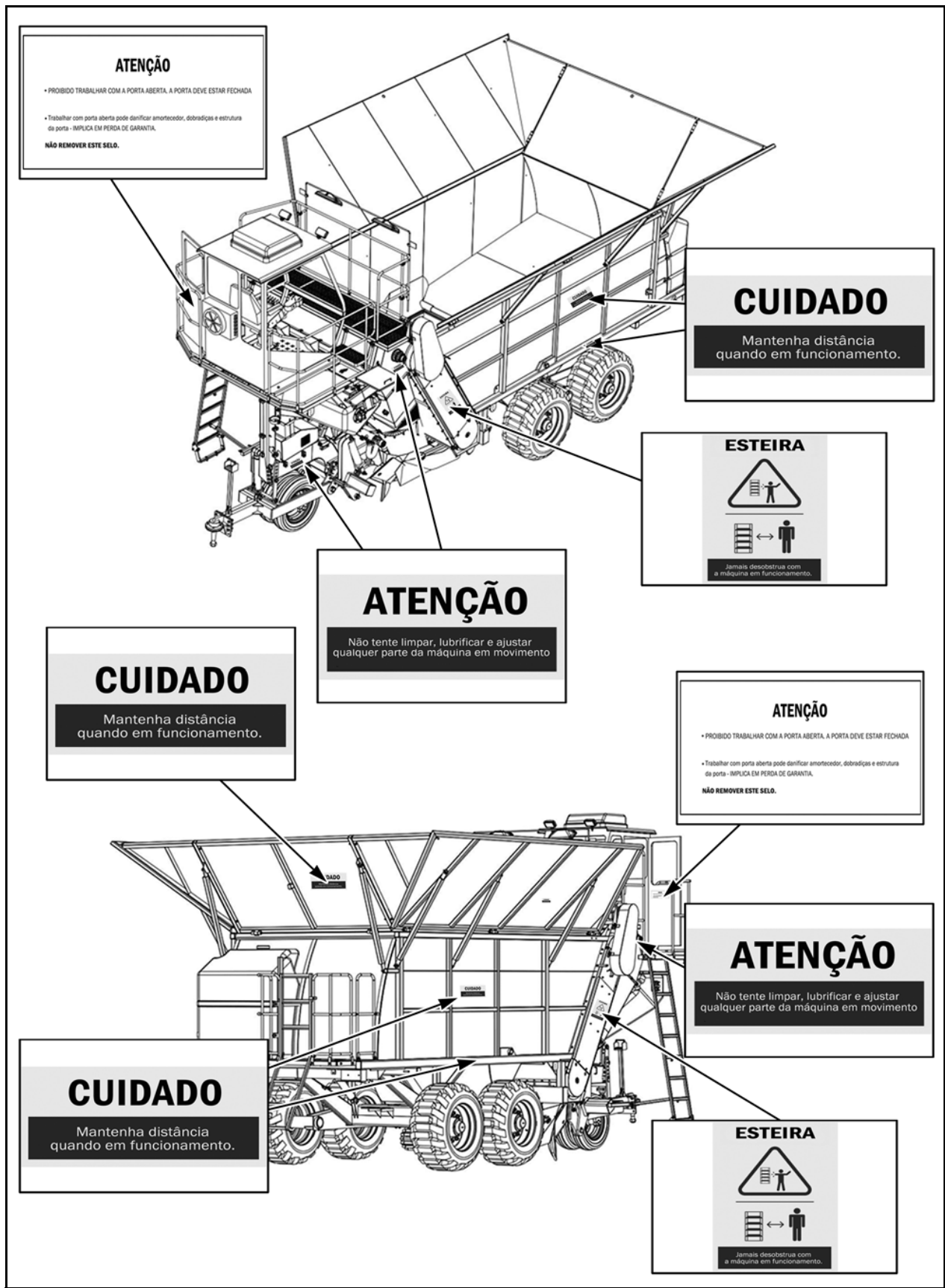

FIG. 3

2.5 Planter Maintenance

Make no repair or maintenance service with the tractor engine running or with the machine in motion.

2**ATTENTION!**

Do not perform any maintenance or checks with the planter on.

IMPORTANT:

Before starting any work on the electrical system of the planter or make a weld, disconnect the battery terminals, disconnecting the negative cable first and then the positive cable.

Under no circumstances weld any part of the machine without first turning off the main switch of the machine, disengage the planter tractor and put the ground on the part to be welded.

**DANGER!**

Never place metal objects on the battery, which could cause a short circuit and/or explosion of it.

To prevent fire or explosions keep flames away from battery. To prevent sparks, which may cause explosions, use the jumper cables in accordance with the instructions provided in this manual.

When performing repairs or adjustments, it is recommended to consult a dealer for the work to be performed by trained personnel.

Check the tightness of all nuts and bolts periodically, mainly the nuts on wheel and rims hubs. Tighten according to the recommended torques.

**DANGER!**

During the planter repair service use supporting racks properly positioned. The use of lifting devices such as mechanical or hydraulic jack can be highly dangerous, especially if it is necessary to work under the machine.

NOTE: It is the owner's responsibility to comply with the regulations and laws of proper handling and disposal of disposable products, such as oils, lubricants, coolant, battery, etc.

IMPORTANT:

Always keep the planter in good mechanical and operational conditions.

**ATTENTION!**

Follow the recommendations for maintenance and never operate the planter when it has a malfunction that could jeopardize the safety of the operator and/or machine.

3

4.2 Identification, description and operation of the planter components

4

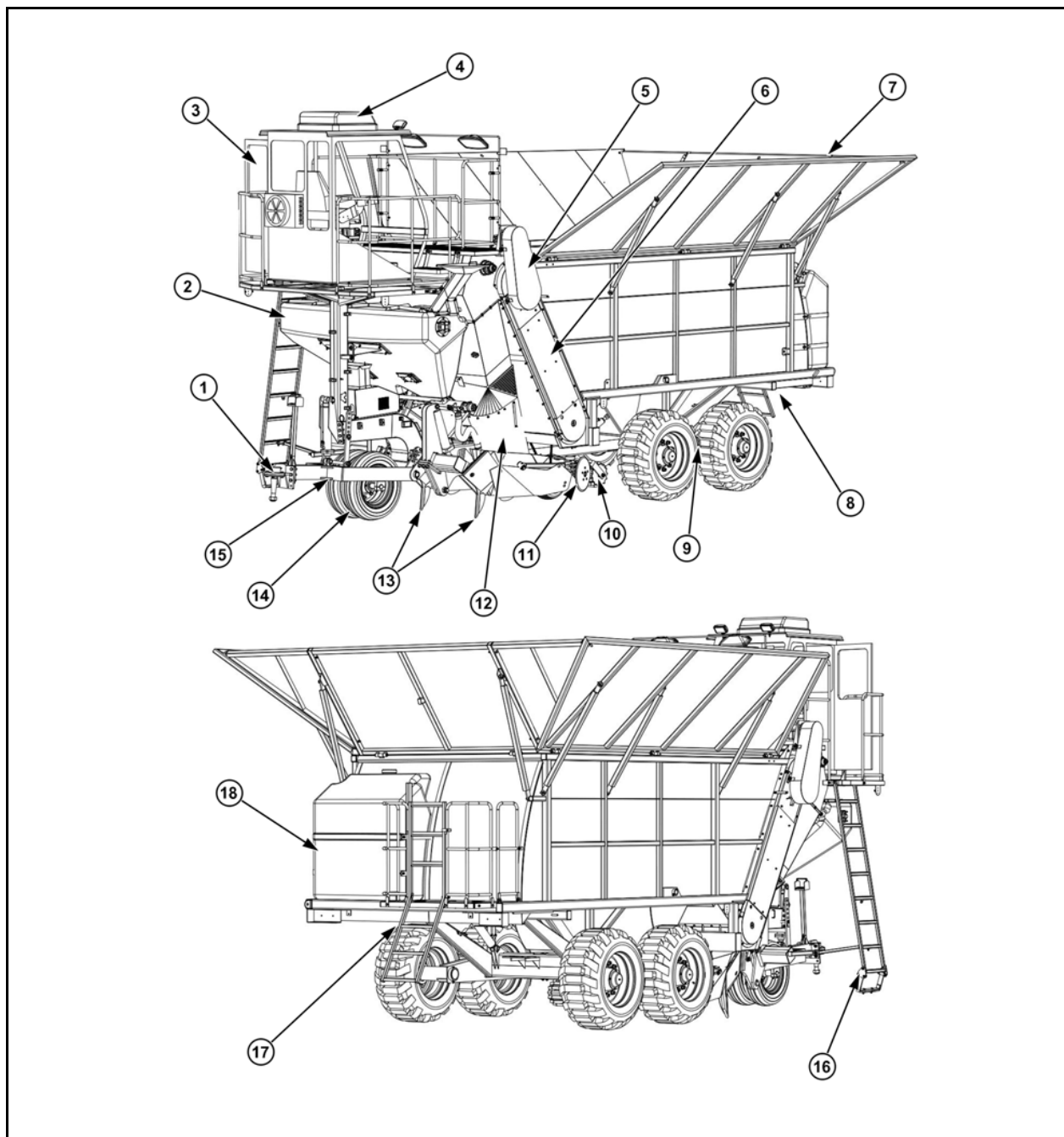

FIG. 26

- | | |
|---|--------------------------------------|
| 1. Ball pin | 10. Dosing set |
| 2. Fertilizer | 11. Coverer set |
| 3. Cabin | 12. Gutter and tap |
| 4. Air conditioner | 13. Furrowers |
| 5. Protective cover of the conveyor drive chain | 14. Depth control wheel |
| 6. Sugarcane lifter conveyor | 15. Traction bar |
| 7. Bucket | 16. Operation platform access ladder |
| 8. Tilting bottom – bucket | 17. Access ladder to the rear deck |
| 9. Tandem system rear wheel | 18. Insecticide reservoir |

5.1 Before operation

When you start working with the planter note if all hoses are properly installed and test to see if the flow is correct: connect the conveyor, activate some cylinder in end of course and see if the conveyor belt changes the rotation.

Perform daily maintenance (see Periodic Maintenance in Section 6).

5

CLICK HERE TO **DOWNLOAD** THE COMPLETE MANUAL

- Thank you very much for reading the preview of the manual.
- You can download the complete manual from: www.heydownloads.com by clicking the link below



- Please note: If there is no response to CLICKING the link, please download this PDF first and then click on it.

CLICK HERE TO **DOWNLOAD** THE COMPLETE MANUAL

5

5.5.5 Working pressure adjustment of the furrower cylinder

1. Adjustment of the planter general relief valve.
 Install a pressure gauge in the frame (arrow).
 Start the tractor;
 Accelerate to 1500 RPM;
 Move the furrower lever until the end;



ATTENTION!

Do not keep activated for more than 5 seconds, it can damage the lever.

The pressure gauge should indicate 1000 PSI;

If you cannot find the specified pressure, adjust the relief valve (1). (Fig. 55)

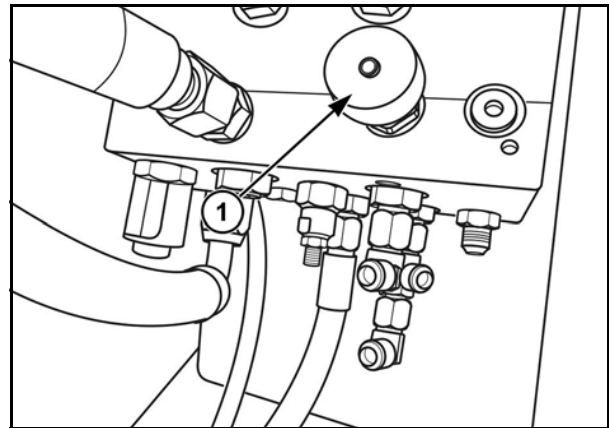

FIG. 54

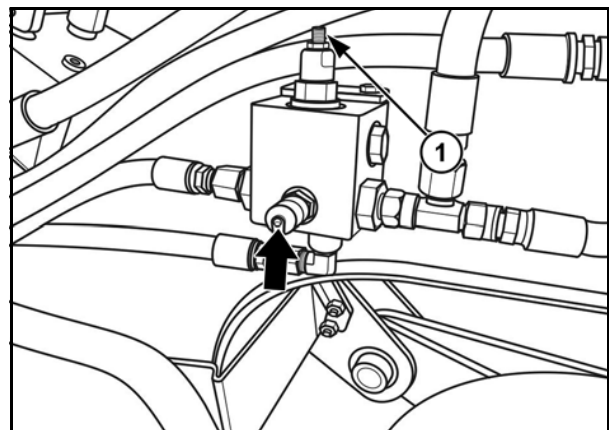

FIG. 55

5.5.6 Tow

The tow adjustment defines the desired depth in the work for the furrower nozzle. The adjustment is defined in the scaled bar (1). (Fig. 56)

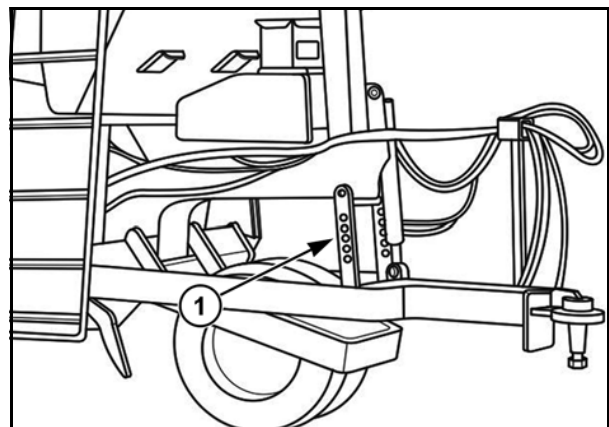

FIG. 56

5.14 Air conditioner

Air deflectors (1) directs the air as needed by the operator.

Temperature control and air conditioner activation buttons (2).

Activation of the light inside the cabin (3).

Screen filter (4) and (5) of cabin air recirculation (Fig. 69)

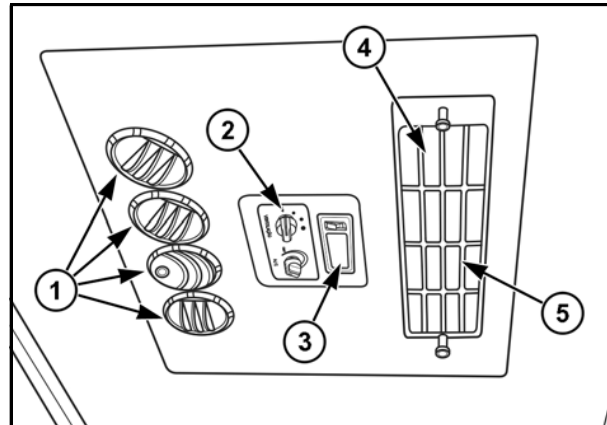

FIG. 69

6.4 Lubricants and additives recommended by SANTAL

Use the lubricant according to the manufacturer of the tractor.

IMPORTANT:

According to current legislation all used or contaminated oils, either recyclable or not, must be kept in appropriate and resistant to leaks containers. These oils must be collected by authorized companies, with the specific purpose of regulating, unless there is a specific order from the official environmental agency.

NOTE: The Santal Planter will be delivered with ISO VG 68 oil. Santal recommends to check the oil that is in use whenever you attach the planter on a tractor. If the oil is not the same, you should drain the oil from the planter and fill the tractor oil watching the level of the tractor hydraulic system.

Do not mix in any case oils from different brands, even if they have the same levels of API and the same viscosity, as there could be incompatibility between additives, causing even the neutralization of some function.

6.9.1.2 Checking the battery terminals and battery replacement

1. Turn off the main switch (arrow), turning the lever counterclockwise (Fig. 77)

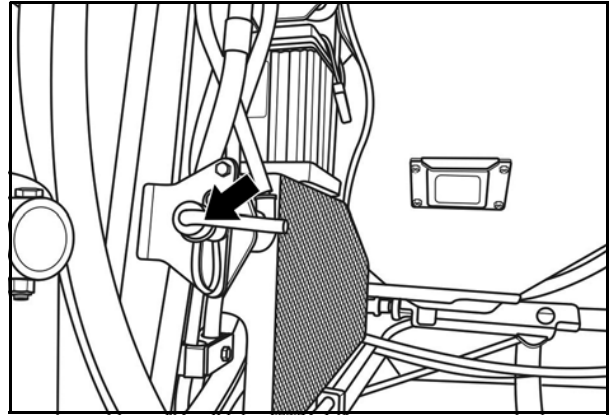

FIG. 77

2. Remove the wing nut (arrow) of the battery protective cover and remove the cover. (Fig. 78)

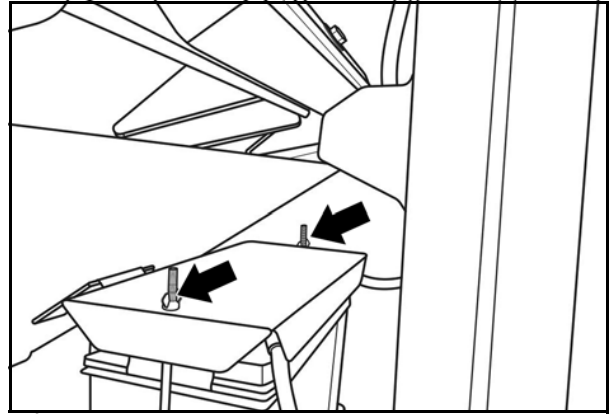

FIG. 78

3. Disconnect the terminals (arrows), beginning with the negative terminal. (Fig. 79)
4. Remove the battery by pulling its side handles.
5. Place the battery on its housing.
6. Check the condition of the connection between the terminals and the positive and negative terminals of the batteries (arrows). eliminate rust, secure them again in the battery and grease them with vaseline
7. Place the battery on its housing, install the wing nuts and tighten firmly.

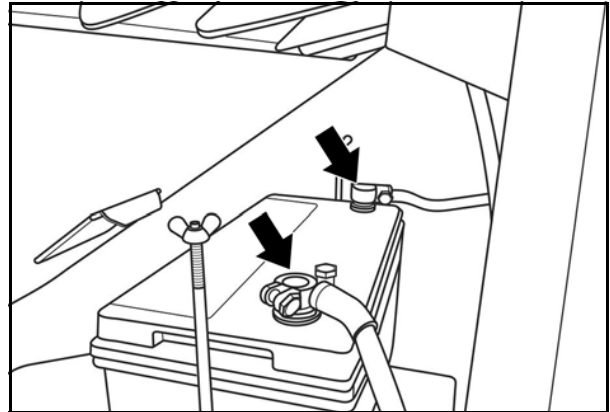

FIG. 79

IMPORTANT:

If you do not have proper training, do not handle or recharge the battery without instructions and equipment.

7.1.2 Wiring diagram (cont.)

7

Plantadora PDM2

Página 02 de 06

Corpo da Máquina

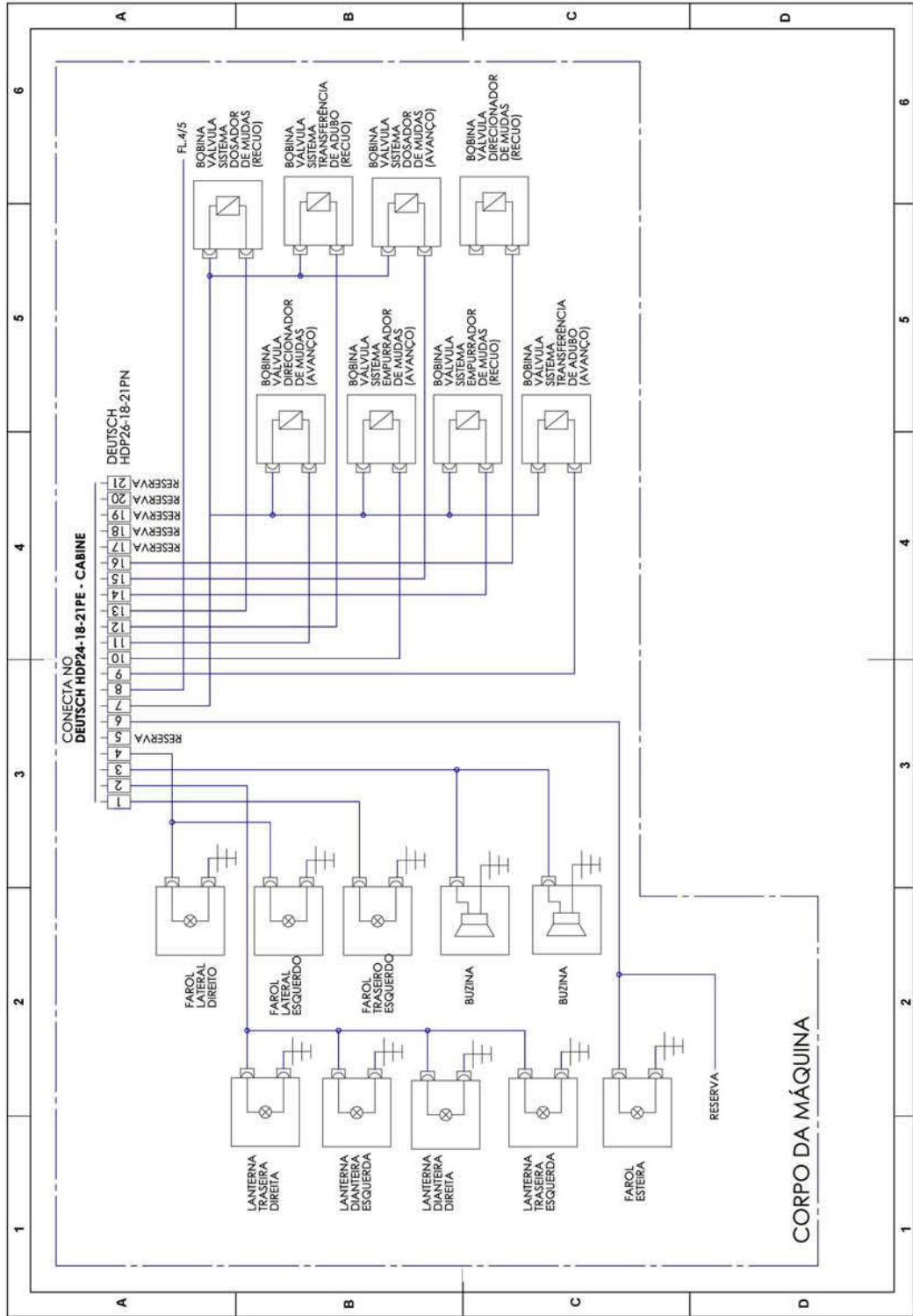

FIG. 95

7

CLICK HERE TO **DOWNLOAD** THE COMPLETE MANUAL

- Thank you very much for reading the preview of the manual.
- You can download the complete manual from: www.heydownloads.com by clicking the link below



- Please note: If there is no response to CLICKING the link, please download this PDF first and then click on it.

CLICK HERE TO **DOWNLOAD** THE COMPLETE MANUAL