

en

Operator's manual

Clamshell

GM 5B, GM 7C, GM 7CHD, GM 8B, GM 10B, GM
20B, GM 20C, GMZ 50, GMZ 80, GMZ 120

Document ID

	ORIGINAL OPERATOR'S MANUAL
Order number:	11823411
Issued:	2018-11-27
Version:	01
Author:	LHB / Technical Documentation Department

Product ID

Manufacturer:	Liebherr-Hydraulikbagger GmbH
Product type:	Clamshell GM 5B, GM 7C, GM 7CHD, GM 8B, GM 10B, GM 20B, GM 20C, GMZ 50, GMZ 80, GMZ 120

Conformity:



Contact

Liebherr-Hydraulikbagger GmbH
Liebherrstraße 12
D – 88457 Kirchdorf/Iller

CLICK HERE TO **DOWNLOAD** THE COMPLETE MANUAL

- Thank you very much for reading the preview of the manual.
- You can download the complete manual from: www.heydownloads.com by clicking the link below



- Please note: If there is no response to CLICKING the link, please download this PDF first and then click on it.

CLICK HERE TO **DOWNLOAD** THE COMPLETE MANUAL

1.1.2 Clamshell, separable with winder bolts

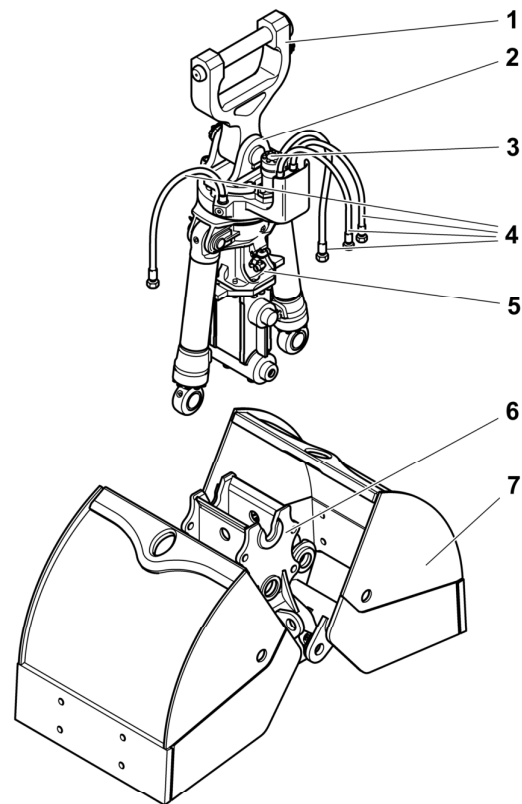

Fig. 3: Clamshell, separable with winder bolts

- | | | | |
|---|-----------------|---|-------------------------------|
| 1 | Suspension | 5 | Mechanical system |
| 2 | Bearing bracket | 6 | Bucket carrier bottom section |
| 3 | Rotary actuator | 7 | Cup |
| 4 | Hydraulic line | | |

- Applying all necessary signal signs
- Is not under any physical or mental impairment that limits one of the prescribed requirements.
- Is not under the influence of alcohol.
- Is not under the influence of drugs.

2.3.8 Spotter

Responsibility

The spotter has following tasks:

- Wear personal protective equipment.
- Forward signals from rigger to operator.
- If the spotter is the only person for this purpose: Give instructions to operator.

Requirement

The spotter has following qualification and skills:

- Has completed the legally specified minimum age.
- Is physically and mentally capable of directing persons.
 - Satisfactory eyesight
 - Satisfactory hearing ability
 - Quick reactions
 - Is able to estimate distance, height and gaps.
- The spotter has following skills:
 - Is able to operate radio units.
 - Is able to give clear instructions on radio units.
 - Is able to guide a load.
 - Is able to ensure safe movement of load and machine.
- Has the authorisation necessary for giving signal signs.
- The spotter has the necessary education (theoretical and practical) for the following:
 - Spotting
 - Applying all necessary signal signs
- Is not under any physical or mental impairment that limits one of the prescribed requirements.
- Is not under the influence of alcohol.
- Is not under the influence of drugs.

2.4 Signs on the machine

2.4.1 Information signs

These signs contain information about:

- Transporting working tool

3.1.2 Removing clamshell with attachment pins

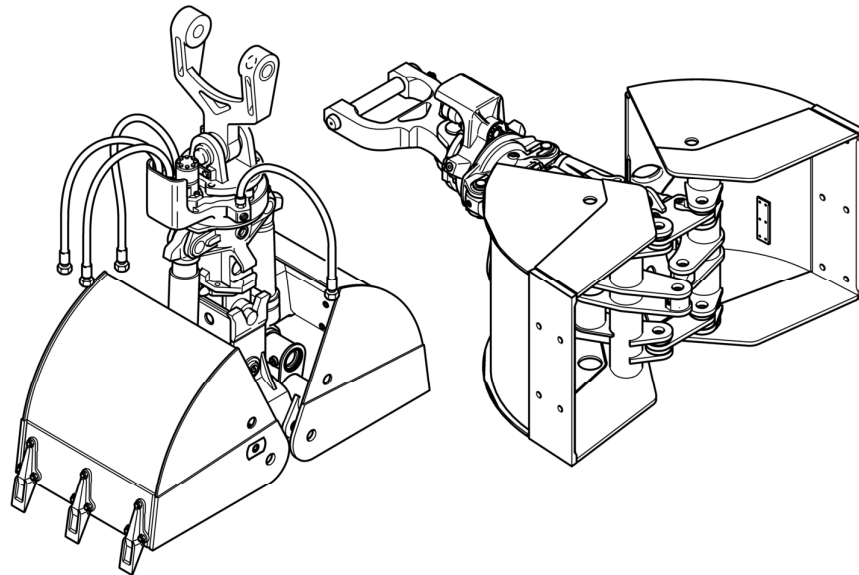

Fig. 19: Putting down clamshell

- ▶ Open clamshell completely.
- ▶ Put clamshell in secure and stable position.



WARNING

Pressurised hydraulic lines!
Injuries.

- ▶ Before installing and removing depressurise hydraulic system.
- ▶ Depressurise hydraulic lines.
- ▶ Have hydraulic lines and electrical cables removed exclusively by specialist staff.
- ▶ Prevent penetration of dirt: Immediately close open lines.



CAUTION

Tipping suspension!
Injuries.

- ▶ Make sure there are no persons in danger area.
- ▶ Fix suspension of clamshell with suitable support.
- ▶ Unlock and remove attachment pins.
- ▶ Remove clamshell.

3.1.3 Installing and removing working tool with quick coupler

- ▶ Observe instructions in operator's manual for quick coupler.

If hydraulic oils of machine and working tool are not identical:

- ▶ Completely drain hydraulic lines of working tool before installation.



WARNING

Pressurised hydraulic lines!
Injuries.

- ▶ Before installing and removing depressurise hydraulic system.
-
- ▶ Depressurise hydraulic lines. (For more information see: [4.3.1 Depressurising hydraulic lines, page 64](#))
 - ▶ Have hydraulic and electrical lines installed exclusively by specialist staff.

Putting working tool into operation

- ▶ Start machine.
- ▶ Unlock functions for operating working tool.
- ▶ Observe instructions in the operator's manual for the working tool.
- ▶ Set machine to low hydraulic power.
- ▶ Reduce engine speed.
- ▶ Remove air from hydraulic lines: Slowly close and open working tool several times.
- ▶ Turn working tool to the left and right through three turns.

3.3.3 Picking up and putting down digging material, bulk material, or other material

Putting machine in working position

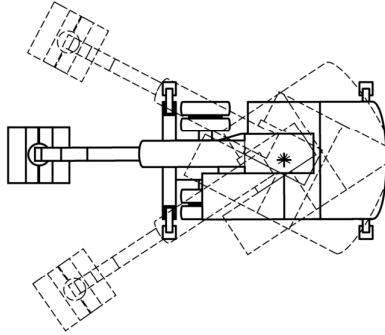

Fig. 38: Working position of the machine

- ▶ Put machine in working position.

Picking up digging material, bulk material, or other material

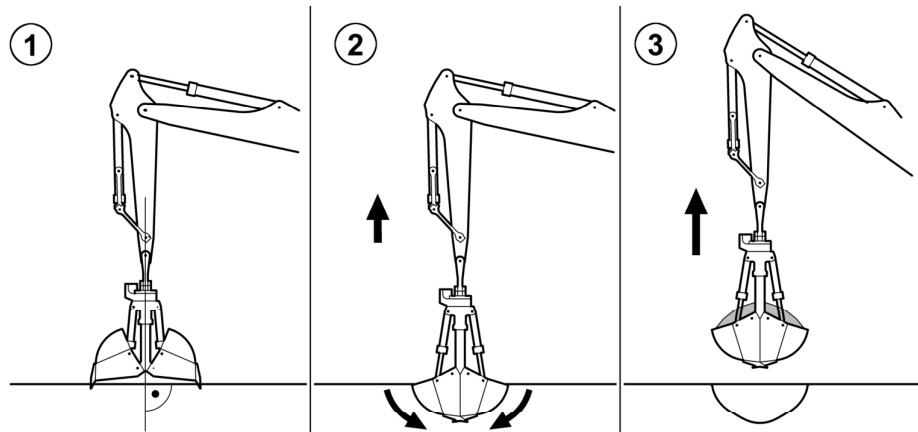

Fig. 39: Picking up digging material, bulk material, or other material

- | | |
|--|-----------------------------------|
| <p>1 Aligning stick</p> <p>2 Closing clamshell</p> | <p>3 Lifting digging material</p> |
|--|-----------------------------------|

Aligning stick (see: fig. 39, page 56)

- ▶ Open clamshell completely.
- ▶ Lower the stick vertically to the picking up point.

4.4.2 Cleaning working tool

In following situations, thoroughly clean working tool to remove all traces of contamination and dirt deposits:

- After each work deployment
- Before maintenance work
- Before repair work

NOTICE

Corrosion!
Damage to working tool.

- ▶ Thoroughly clean the working tool at the end of work.
-

Thorough cleaning prevents the penetration of dirt and foreign particles into the working tool.

After following deployments it is necessary to thoroughly clean working tool:

- Working in winter
 - Working in salty environments (for example in contact with road salt)
 - Working by the sea
 - Working in harbours
 - Working with lyes or acid compounds
 - Working with aggressive materials (for example calcium compounds, cement)
-

NOTICE

Incorrect cleaning!
Damage to paint.

- ▶ Clean working tool with high-pressure cleaner at the earliest two months after first putting into service.
 - ▶ Clean working tool with high-pressure cleaner at the earliest two months after repainting.
 - ▶ Adhere to operating instructions for high-pressure cleaner.
 - ▶ Adhere to specifications on pressure settings and distance between high-pressure nozzle and object.
-

Before cleaning

Before cleaning with water or high-pressure cleaner, perform following activities in order to avoid water penetration.

- ▶ Lubricate all bearings and pin connections, using central lubrication system if necessary.

Cleaning

- ▶ Use lint-free cleaning cloths.
- ▶ Do not clean working tool with aggressive cleaning agents or flammable liquids.
- ▶ Use water to soften dirt and then rinse it off.

If working tool is fitted with a LIKUFIX hydraulic coupling:

- ▶ Clean coupler parts and sealing surfaces with a clean, oil-soaked cloth.

CLICK HERE TO **DOWNLOAD** THE COMPLETE MANUAL

- Thank you very much for reading the preview of the manual.
- You can download the complete manual from: www.heydownloads.com by clicking the link below



- Please note: If there is no response to CLICKING the link, please download this PDF first and then click on it.

CLICK HERE TO **DOWNLOAD** THE COMPLETE MANUAL