

# 608SH TRACKED HARVESTER

(Serial No. S/N WC608SX007026- )



D  
C  
T  
J

## OPERATOR'S MANUAL 608SH TRACKED HARVESTER OMF383517 H2 (ENGLISH)

### CALIFORNIA Proposition 65 Warning

Diesel engine exhaust and some of its constituents are known to the State of California to cause cancer, birth defects, and other reproductive harm.

If this product contains a gasoline engine:

### **WARNING**

The engine exhaust from this product contains chemicals known to the State of California to cause cancer, birth defects or other reproductive harm.

The State of California requires the above two warnings.

**Worldwide Construction  
And Forestry Division**  
(This manual replaces F381267 02)  
LITHO IN U.S.A.

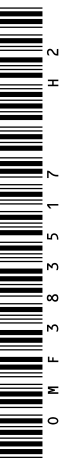

H  
2  
7  
1  
5  
3  
8  
3  
5  
O  
M  
F

CLICK HERE TO **DOWNLOAD** THE COMPLETE MANUAL

- Thank you very much for reading the preview of the manual.
- You can download the complete manual from: [www.heydownloads.com](http://www.heydownloads.com) by clicking the link below



- Please note: If there is no response to CLICKING the link, please download this PDF first and then click on it.

CLICK HERE TO **DOWNLOAD** THE COMPLETE MANUAL

### Wear Protective Equipment

Guard against injury from flying pieces of metal or debris; wear goggles or safety glasses.

Wear close fitting clothing and safety equipment appropriate to the job.

Prolonged exposure to loud noise can cause impairment or loss of hearing. Wear suitable hearing protection such as earmuffs or earplugs to protect against objectionable or uncomfortable loud noises.

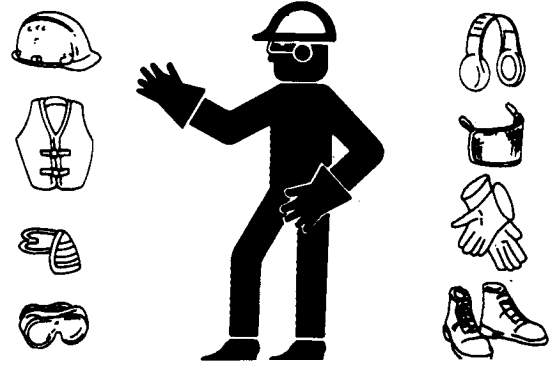

TS206 -UN-23AUG88

TX03679,00016D0 -19-30OCT00-1/1

### Avoid Unauthorized Machine Modifications

Modifications of this machine, or addition of unapproved products or attachments, may affect machine stability or reliability, and may create a hazard for the operator or others near the machine.

Always contact an authorized dealer before making machine modifications that change the intended use, weight or balance of the machine, or that alter machine controls, performance or reliability.

TX03679,00016B7 -19-30OCT00-1/1

### Inspect Machine

Inspect machine carefully each day by walking around it before starting.

Keep all guards and shields in good condition and properly installed. Fix damage and replace worn or broken parts immediately. Pay special attention to hydraulic hoses and electrical wiring.



T6607AQ -UN-18OCT88

TX03679,0001734 -19-25SEP00-1/1

## Travel Safely

Know the location of bystanders before moving the machine.

Always keep the reverse warning alarm, if equipped, in working condition. It warns people when the machine starts to move in reverse.

Use a signal person when moving the machine in congested areas. Coordinate hand signals before starting the machine.

*NOTE: When working on steep slopes, travel as straight up and down as possible to prevent roll-over.*

**DO NOT PARK ON A HILLSIDE OR AN INCLINE.**

*Always park the machine on level ground.*

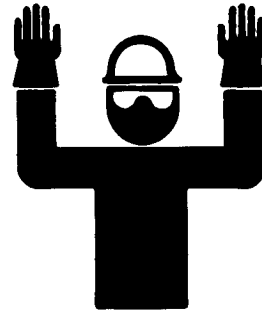

T6964AD -UN-20DEC88

MR64971,0000012 -19-05DEC01-1/1

## Avoid Power Lines

Approach with caution areas where overhanging telephone or electric power lines are present. Serious injury or death by electrocution can result if the machine or any of its attachments are not kept a safe distance from high-voltage electric power lines.

Maintain a distance of 10 feet (3 meters) between the machine or boom and any power line carrying up to 50,000 Volts or less.

**CAUTION:** Power lines carrying more than 50,000 Volts require a safety distance of 10 feet (3 meters) plus 1/2 inch (13 mm) for each additional 1,000 Volts above the 50,000 Volt level.

If state/province, local or job site regulations require even greater safety distances than stated above, adhere strictly to these regulations for your own protection.

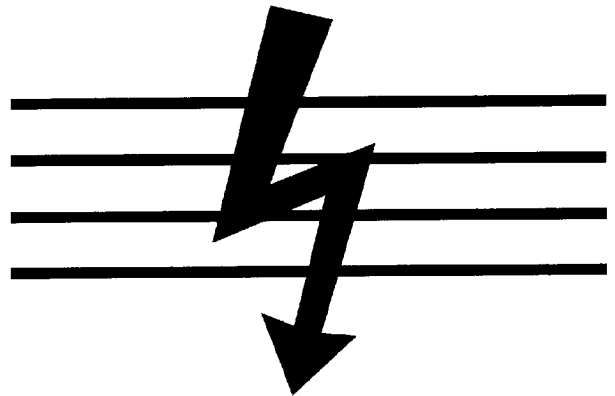

T147350 -UN-24OCT01

MR64971,000001A -19-05DEC01-1/1

# Operator's Station

### Safety Circuit Breakers

The Main System Circuit Breaker (1) protects all of the systems electrical circuits. Press to reset.

The Service Lights Circuit Breaker (2) protects the service light circuits. Press to reset.

The Enclosure Door Pump Circuit Breaker (3) protects the engine enclosure door pump circuit. Press to reset.

- 1—Main System Circuit Breaker
- 2—Service Lights Circuit Breaker
- 3—Enclosure Door Pump Circuit Breaker

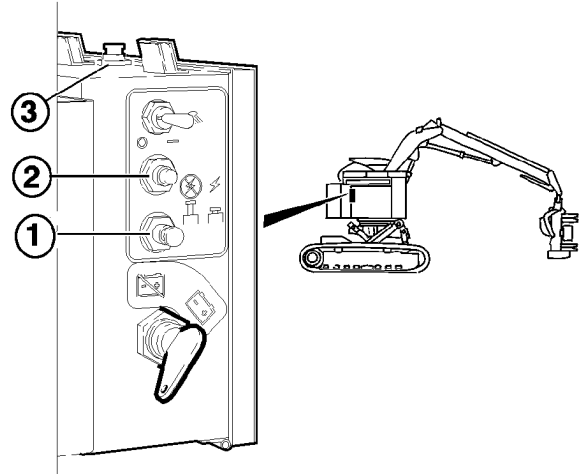

T152121 -UN-08MAR02

MR64971,0000045 -19-05DEC01-2/2

### Dome Light

The interior dome light is controlled by a switch located on the side of the light housing.

- 1—Dome Light

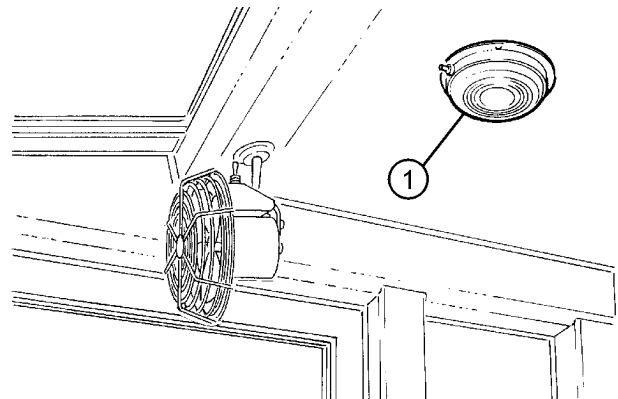

T146982 -UN-22OCT01

MR64971,0000046 -19-05DEC01-1/1

### Defroster Fan

Increased air circulation and windshield defrosting is provided by the defroster fan. It is switched ON or OFF by the switch located on the fan motor housing.

- 1—Defroster Fan

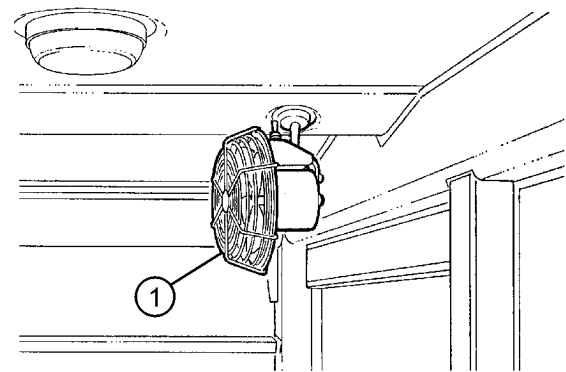

T146983 -UN-22OCT01

MR64971,0000047 -19-05DEC01-1/1

## Engine Enclosure Door

**⚠ CAUTION:** Maximum load on open enclosure door not to exceed 250Kg (550 lbs).

**⚠ CAUTION:** Before opening or closing the engine enclosure door ensure all personnel are clear of the machine. Raise or lower the enclosure door completely. Never leave the enclosure door partially raised. While standing on the enclosure door, turn Master Disconnect OFF. Failure to follow these procedures can lead to risk of personal injury.

### Enclosure Door Pump Switch

The engine enclosure door switch (2) and pump (1) are located in the valve compartment. Turning the switch clockwise will open the enclosure door, and turning it counterclockwise will close the enclosure door.

*NOTE: It will be necessary to activate the engine enclosure door switch close function (turning counterclockwise) before activating the open function. This will help to release the enclosure door lock.*

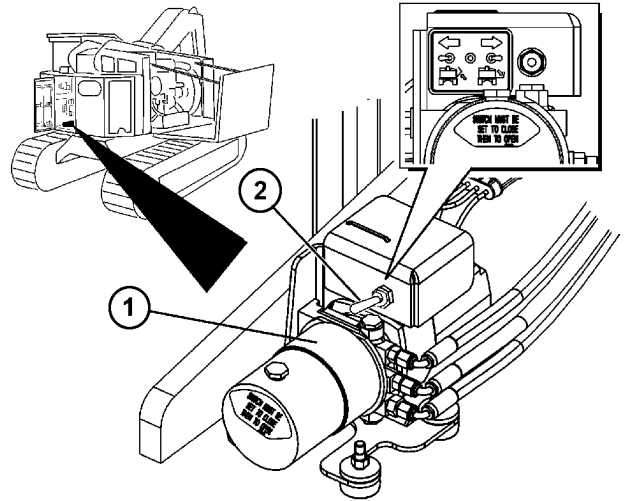

T150353 -UN-20FEB02

MR64971.0000055 -19-05DEC01-1/1

## Joystick Control Lever — Left Hand

### Stick Boom

Push the lever forward to boom out.

Pull the lever back to boom in.

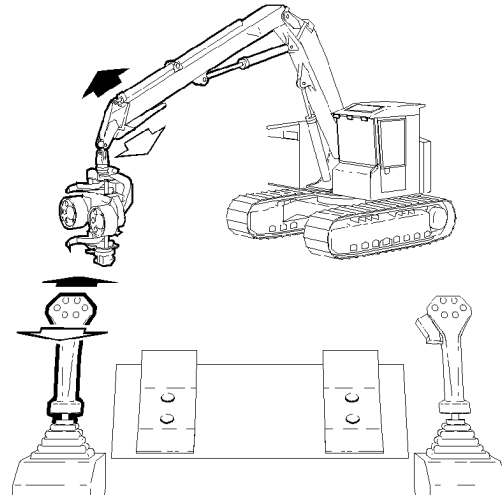

T152072 -UN-05MAR02

MR64971,000005E -19-05DEC01-1/5

### Turntable Swing

Move the lever to the left to swing left.

Move the lever to the right to swing right.

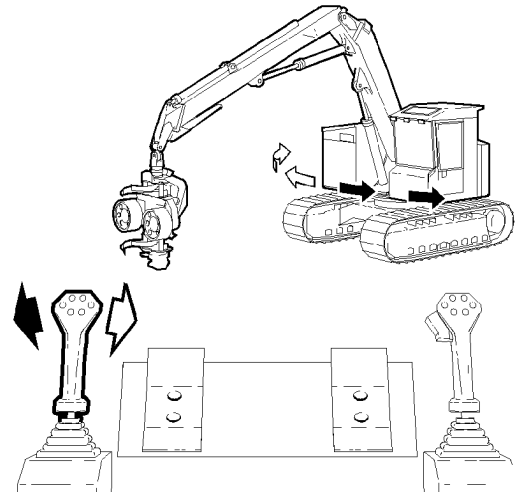

T152073 -UN-05MAR02

Continued on next page

MR64971,000005E -19-05DEC01-2/5

## Fuels and Lubricants Specifications Table

Location	Recommended Fluid	Capacity
Engine Crankcase Oil	John Deere PLUS-50® or TORQ-GARD SUPREME® engine oil preferred. Use engine oil that meets API performance classification CH-4, CG-4, CF-4 or ACEA Specification E3, E2 Choose viscosity to suit operating temperature.	23.8 L (25.2 qt)
Track Drive Planetary	John Deere GL-5 GEAR LUBRICANT or John Deere EXTREME-GARD oils preferred. Use oil that meets API Service Classification GL-5. Choose viscosity to suit operating temperature.	4.8 L (5.1 qt)
Swing Drive Planetary	John Deere GL-5 GEAR LUBRICANT or John Deere EXTREME-GARD oils preferred. Use oil that meets API Service Classification GL-5. Choose viscosity to suit operating temperature.	4.5 L (4.8 qt)
Hydraulic System (Tank Capacity)	Quality hydraulic oils. See Section 3-1 Recommended Hydraulic System Oils.	177.5 L (46.9 gal)
Fuel Tank	Use diesel fuel meeting A.S.T.M. designation D-975 Below 0°C. (32°F) No. 1-D Above 0°C. (32°F) No. 2-D	568 L (150 gal)
Engine Cooling System	John Deere COOL-GARD® Prediluted Coolant or John Deere COOL-GARD® Coolant Concentrate preferred. Mix 40% concentrate with 60% quality water. Use coolants meeting ASTM D5345 (Prediluted) or ASTM D4985 (Concentrate).	57 L (60 qt)
Grease	John Deere HD MOLY GREASE preferred. Use grease meeting SAE standard for multipurpose grease with EP performance and 3% molybdenum disulfide.	As Required
Engine Enclosure System	Esso Hydraul 50.	3 L (0.8 gal)

PLUS-50 is a trademark of Deere & Company  
 TORQ-GARD SUPREME is a trademark of Deere & Company  
 COOL-GARD is a trademark of Deere & Company

MR64971,000066 -19-05DEC01-1/1

CLICK HERE TO **DOWNLOAD** THE COMPLETE MANUAL

- Thank you very much for reading the preview of the manual.
- You can download the complete manual from: [www.heydownloads.com](http://www.heydownloads.com) by clicking the link below



- Please note: If there is no response to CLICKING the link, please download this PDF first and then click on it.

CLICK HERE TO **DOWNLOAD** THE COMPLETE MANUAL

## Maintenance and Repair Record Keeping System

The checklist in this chapter summarizes scheduled maintenance, and parts and oil required at each maintenance interval.

Use the checklist to:

- Remind you to perform machine maintenance at specified intervals to minimize downtime.
- Calculate cost of machine operation and ownership allowing you to make better job estimates.
- Place yourself in a stronger position at trade-in time.
- Satisfy your SECURE contract requirements.

As maintenance is performed, check off each item on the list and record date and hour meter reading.

Do not tear out or mark on checklist in this chapter; keep it to make extra copies.



MAINTENANCE and REPAIR RECORD KEEPING  
SYSTEM FOR JOHN DEERE MACHINE OWNERS

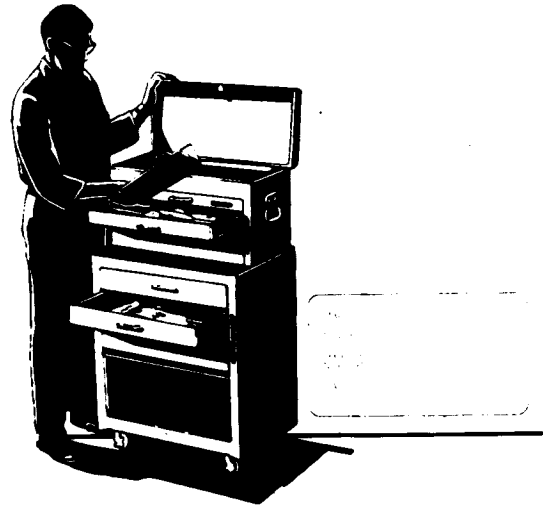

MR64971,0000071 -19-05DEC01-1/1

T7511CO -UN-27JUN91

# Maintenance — Every 8 Hours or Daily

## General



**CAUTION:** Prior to performing any maintenance procedure, always position the machine on level ground, facing forward, with the felling head resting on the ground. Failure to follow these safety precautions can lead to risk of personal injury.

MR64971,0000075 -19-05DEC01-1/1

## Service Lights

The light switch (1) will turn on two service lights, one in the engine compartment and another in the hydraulic valve compartment for improved visibility.

**IMPORTANT:** Shut the switch off after completing maintenance or service procedures. Leaving the lights on without the engine running will drain the batteries.

1—Service Lights Switch

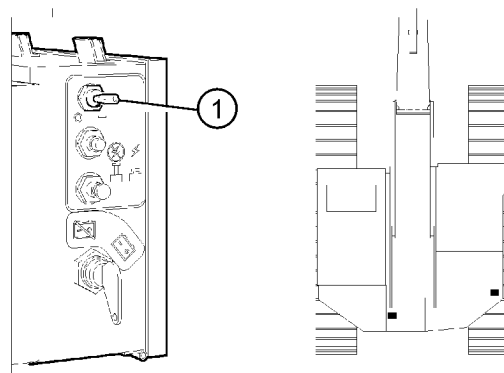

T147008 -UN-31OCT01

MR64971,0000076 -19-05DEC01-1/1

## Check Engine Oil Level

Check oil level on the dipstick. Add oil if required. See Section 3-1 for recommended engine oil.

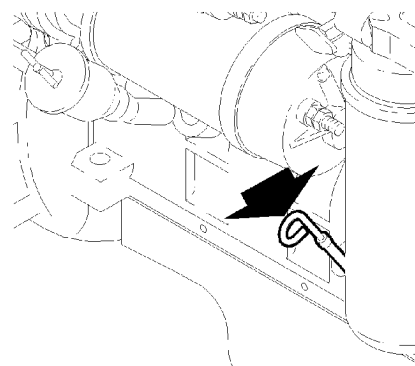

T147046 -UN-22OCT01

Continued on next page

MR64971,0000077 -19-05DEC01-1/2

### Refer to Fire Suppression System Manufacturer's Manual (If Installed)

Carry out additional maintenance procedures that are required in the manual.

MR64971.000008C -19-05DEC01-1/1

### Check Engine RPM

Check Engine RPM on the tachometer. Adjust, if necessary.

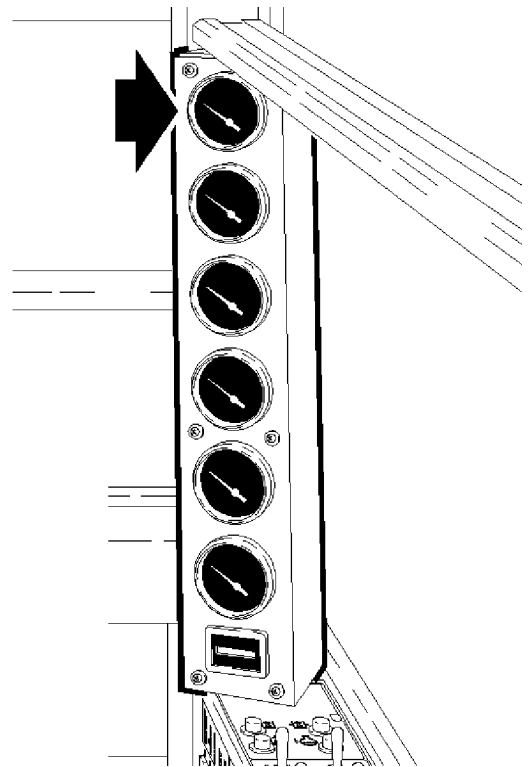

T147064 -UN-22OCT01

Item	Measurement	Specification
High Idle (no load)	Speed	2160 +/- 50 rpm
Low Idle (6CT8.3)	Speed	900 rpm
Low Idle (6CTA8.3)	Speed	950 rpm

MR64971.000008D -19-05DEC01-1/1

### Check Initial Track Shoe Bolt Torque

Check Initial Track Shoe Bolt Torque.

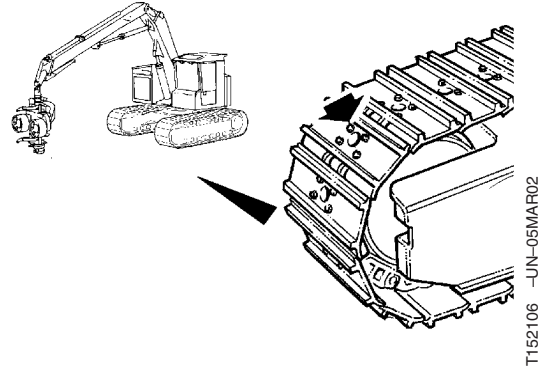

Item	Measurement	Specification
Track Shoe Bolt	Inspection Torque	570 N•m (420 lb-ft)

If bolts turn at this torque value, loosen bolt and retorque to the specified value.

**Specification**

Track Shoe Bolt—Torque..... 300 ± 54 N•m (220 ± 40 lb-ft)  
plus an additional 1/3 turn

## Change Oil in the Enclosure Door Pump

**IMPORTANT:** Cleanliness procedures must be observed when working on any hydraulic component in order to prevent contamination of the hydraulic systems.

**Failure to follow these procedures may lead to equipment damage.**

Remove the reservoir and drain the oil from the pump into a suitable container. Prior to assembly, clean reservoir and replace the o-ring.

Replace fluid with Hydraul 50 automatic transmission or equivalent fluid as follows:

1. Open valve on manual (hand) pump.
2. Fill power unit reservoir.
3. Cycle pump while keeping the reservoir full until no more oil is required.
4. Close valve on manual pump.
5. Cycle with the cylinder rod end detached until all air has been purged from the system.
6. Attach rod end to side door and close the unit.
7. Open valve on manual hand pump.
8. With the breather/filler cap removed from the power unit, pump the enclosure open with the manual pump.
9. Close the valve on the manual pump and test the system.
10. Replace the breather/filler cap.
11. Repeat as required.

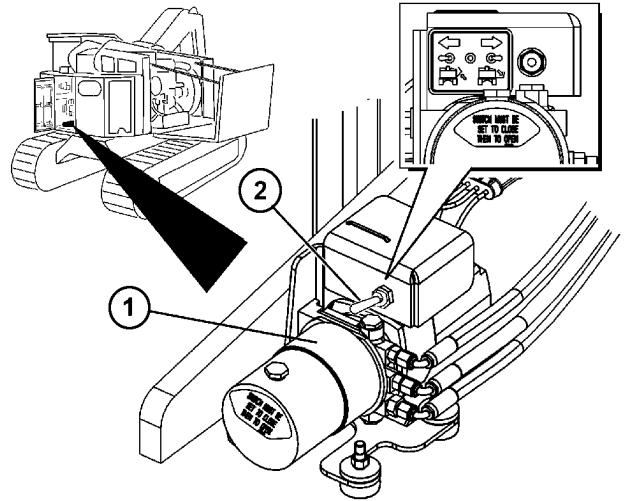

T150353 -UN-20FEB02

**Check Left Joystick Keypad Harvesting Functions**

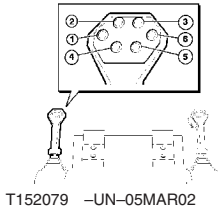

- 1—All Knives Open
- 2—Teleboom Out (Top saw (head type 7-11))
- 3—Teleboom In (Find end (head type 7-11))
- 4—Upper Knives Open
- 5—Upper Knives Close
- 6—Saw

Start engine.

Press the buttons one at a time on the left joystick keypad.

*LOOK: All knives should open, upper knives should open/close, teleboom should move in/out, saw should turn On.*

*NOTE: Hydraulic functions should operate promptly and smoothly and stop when the control is released.*

*NOTE: After checks are completed, shut off the engine.*

**OK:** All left hand joystick keypad functions are OK.

**NOT OK:** Contact authorized dealer for service.

**IF OK:** Go on to next check.

--1/1

**Check Right Joystick Hoist Boom Function**

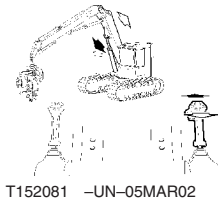

Start engine.

Move the right joystick forward away from the operator.

*LOOK: Hoist boom should move OUT.*

Move the right joystick back toward the operator.

*LOOK: Hoist boom should move IN.*

*NOTE: Hydraulic functions should operate promptly and smoothly and stop when the control is released.*

*NOTE: After checks are completed, shut off the engine.*

**OK:** Right Joystick Hoist Boom Function is OK.

**NOT OK:** Contact authorized dealer for service.

**IF OK:** Go on to next check.

--1/1

### Diagnose Pilot Pressure Circuit

Symptom	Problem	Solution
<b>Pilot control valves will not operate</b>	Pilot shut-off valve is not activated.	Activate armrest and switch.
	Circuit breaker is open.	Put circuit breaker in ON position.
	Pilot shut-off switch or solenoid wiring circuits open, grounded or shorted.	Check wiring at pilot shut-off switch and shut-off solenoid.
	Pilot circuit relief valve malfunction or incorrect pressure setting.	Repair/replace relief valve. Adjust relief valve pressure setting.
	Loose suction line connections.	Repair/replace suction hose or fittings.
	Excessive wear in the pilot pump or pump drive components.	Repair/replace pump and drive components.

MR64971,00000BA -19-05DEC01-1/1

### Diagnose Travel Brakes

Symptom	Problem	Solution
<b>Brakes will not release</b>	Pilot oil is not releasing brakes.	Check brake release screw position. Screw may be turned in.  Check pressure in both directions at BRE test port of suspect motor. Repair pilot supply.
	Pressure reducing valve seized.	Repair/replace pressure reducing valve.
	Brakes seized or leaking.	Repair/replace brakes.

MR64971,00000BB -19-05DEC01-1/1

# Miscellaneous — Specifications

*Miscellaneous — Specifications*

<b>Item</b>	<b>Measurement</b>	<b>Specification</b>
Pad	Type	Single, Double or Triple Grouser
Track Chain Pitch	Pitch	203 mm (8.0 in.)
Track Shoe Bolts	Size	M20 x 1.5 or 3/4 - 16
Track Shoe Bolts	Torque	298 ± 54 N•m plus 1/3 turn (220 ± 40 lb-ft plus 1/3 turn)
Track Shoe Bolts	Inspection Torque	569 N•m (420 lb-ft)
<b>Swing Bearing</b>		
Swing Bearing	Diameter	1189 mm (46.8 in.)
Ball	Diameter	44.5 mm (1.75 in.)
Internal Ring Gear	Type	2.5 in. DP, 104 Teeth
<b>Hydraulic Function Speeds (@ 2000 Engine RPM)</b>		
Stick Cylinder Extend	Speed	5.1 seconds
Stick Cylinder Retract	Speed	3.3 seconds
Hoist Cylinder Extend	Speed	8.1 seconds
Hoist Cylinder Retract	Speed	5.4 seconds
Teleboom Cylinder Extend	Speed	3.2 seconds
Teleboom Cylinder Retract	Speed	5.1 seconds
Turntable Swing	Speed	Up to 6.1 rpm
<b>Travel Speed</b>		
Maximum High	Speed	4.05 km/h (2.5 mph)
Maximum Low	Speed	1.78 km/h (1.1 mph)

Continued on next page

MR64971.00000C6 -19-05DEC01-8/9

CLICK HERE TO **DOWNLOAD** THE COMPLETE MANUAL

- Thank you very much for reading the preview of the manual.
- You can download the complete manual from: [www.heydownloads.com](http://www.heydownloads.com) by clicking the link below



- Please note: If there is no response to CLICKING the link, please download this PDF first and then click on it.

CLICK HERE TO **DOWNLOAD** THE COMPLETE MANUAL