

# 608LH TRACKED HARVESTER

(Serial No. WC608L006007- )



D  
C  
T  
J

## OPERATOR'S MANUAL 608LH TRACKED HARVESTER OMF383522 H2 (ENGLISH)

### CALIFORNIA Proposition 65 Warning

Diesel engine exhaust and some of its constituents are known to the State of California to cause cancer, birth defects, and other reproductive harm.

If this product contains a gasoline engine:

### **WARNING**

The engine exhaust from this product contains chemicals known to the State of California to cause cancer, birth defects or other reproductive harm.

The State of California requires the above two warnings.

**Worldwide Construction  
And Forestry Division**  
(This manual replaces F381273 02)  
LITHO IN U.S.A.



H  
2  
2  
2  
5  
3  
8  
3  
5  
0  
M  
F  
3  
8  
1  
2  
7  
3  
0  
2

CLICK HERE TO **DOWNLOAD** THE COMPLETE MANUAL

- Thank you very much for reading the preview of the manual.
- You can download the complete manual from: [www.heydownloads.com](http://www.heydownloads.com) by clicking the link below



- Please note: If there is no response to CLICKING the link, please download this PDF first and then click on it.

CLICK HERE TO **DOWNLOAD** THE COMPLETE MANUAL

### Wear Protective Equipment

Guard against injury from flying pieces of metal or debris; wear goggles or safety glasses.

Wear close fitting clothing and safety equipment appropriate to the job.

Prolonged exposure to loud noise can cause impairment or loss of hearing. Wear suitable hearing protection such as earmuffs or earplugs to protect against objectionable or uncomfortable loud noises.

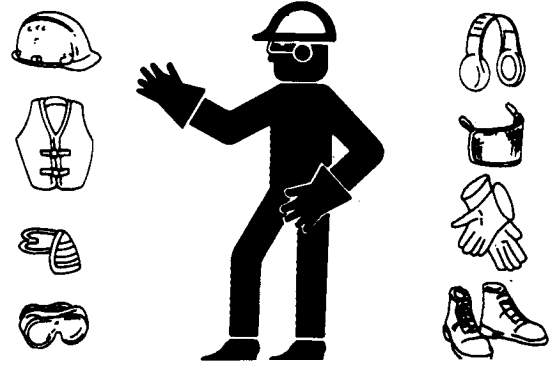

TS206 -UN-23AUG88

TX03679,00016D0 -19-30OCT00-1/1

### Avoid Unauthorized Machine Modifications

Modifications of this machine, or addition of unapproved products or attachments, may affect machine stability or reliability, and may create a hazard for the operator or others near the machine.

Always contact an authorized dealer before making machine modifications that change the intended use, weight or balance of the machine, or that alter machine controls, performance or reliability.

TX03679,00016B7 -19-30OCT00-1/1

### Inspect Machine

Inspect machine carefully each day by walking around it before starting.

Keep all guards and shields in good condition and properly installed. Fix damage and replace worn or broken parts immediately. Pay special attention to hydraulic hoses and electrical wiring.



T6607AQ -UN-18OCT88

TX03679,0001734 -19-25SEP00-1/1

## Travel Safely

Know the location of bystanders before moving the machine.

Always keep the reverse warning alarm, if equipped, in working condition. It warns people when the machine starts to move in reverse.

Use a signal person when moving the machine in congested areas. Coordinate hand signals before starting the machine.

*NOTE: When working on steep slopes, travel as straight up and down as possible to prevent roll-over.*

**DO NOT PARK ON A HILLSIDE OR AN INCLINE.**

*Always park the machine on level ground.*

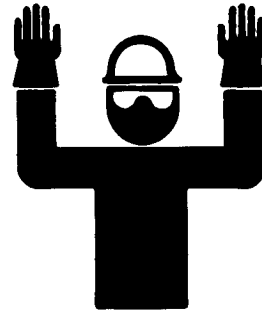

T6964AD -UN-20DEC88

MR64971,0000012 -19-05DEC01-1/1

## Avoid Power Lines

Approach with caution areas where overhanging telephone or electric power lines are present. Serious injury or death by electrocution can result if the machine or any of its attachments are not kept a safe distance from high-voltage electric power lines.

Maintain a distance of 10 feet (3 meters) between the machine or boom and any power line carrying up to 50,000 Volts or less.



**CAUTION: Power lines carrying more than 50,000 Volts require a safety distance of 10 feet (3 meters) plus 1/2 inch (13 mm) for each additional 1,000 Volts above the 50,000 Volt level.**

If state/province, local or job site regulations require even greater safety distances than stated above, adhere strictly to these regulations for your own protection.

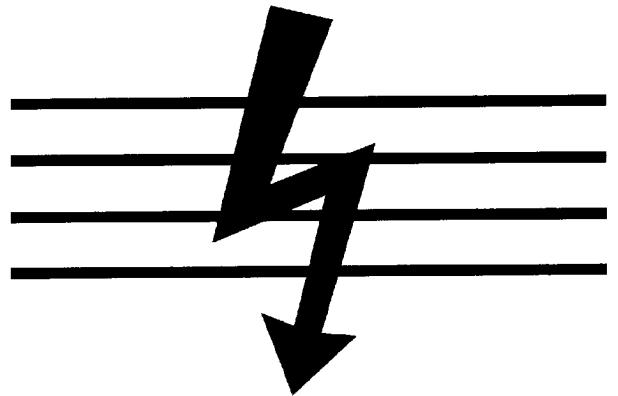

T147350 -UN-24OCT01

MR64971,000001A -19-05DEC01-1/1

# Operator's Station

### Dome Light

The interior dome light is controlled by a switch located on the side of the light housing.

1—Dome Light

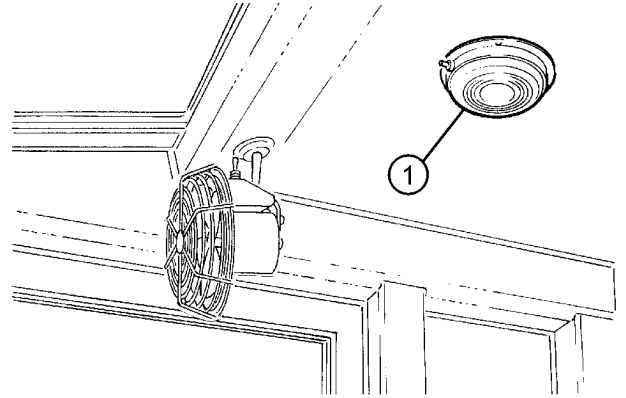

T146982 -UN-22OCT01

MR64971,0000046 -19-05DEC01-1/1

### Defroster Fan

Increased air circulation and windshield defrosting is provided by the defroster fan. It is switched ON or OFF by the switch located on the fan motor housing.

1—Defroster Fan

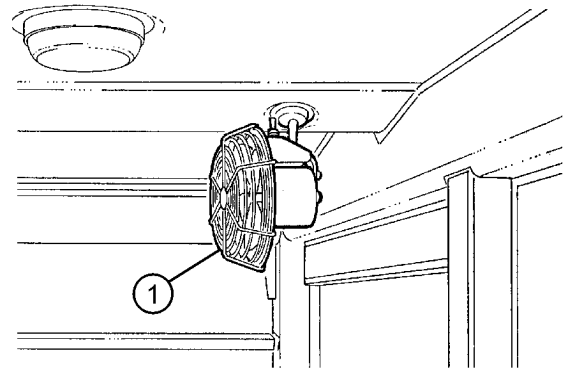

T146983 -UN-22OCT01

MR64971,0000047 -19-05DEC01-1/1

## Battery Disconnect Switch

This two position key switch (A) connects/disconnects all electrical circuits on the machine except the service lights.



**CAUTION:** Before leaving the machine unattended, always lower the attachment to the ground and turn the engine OFF. Switch the battery disconnect switch OFF. Failure to do this can lead to risk of personal injury.

A—Battery Disconnect Key Switch  
1—ON  
0—OFF

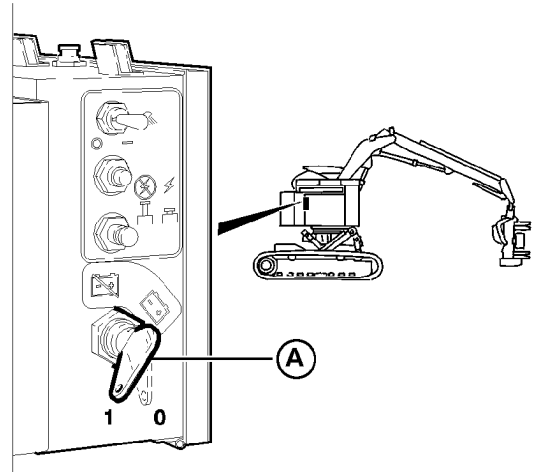

T152120 -UN-08MAR02

MR64971,000052 -19-05DEC01-1/1

## Service Light Switch

This switch is used to turn ON and OFF the service lights in the engine compartment and the hydraulic valve compartment.

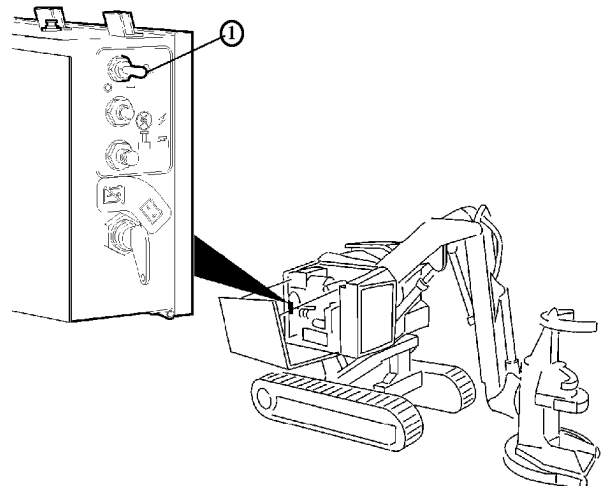

T149810 -UN-21JAN02

MR64971,000053 -19-05DEC01-1/1

## Using Booster Batteries



**CAUTION:** Prevent possible injury from exploding batteries. An explosive gas is produced while batteries are in use or being charged. Keep flames or sparks away from the battery area. Charge batteries in a well-ventilated area.

**IMPORTANT:** The machine electrical system is a 24-volt negative (-) ground. Connect two 12-volt booster batteries together in series as shown for 24 volts.

1. Connect one end of the positive (+) cable to the positive terminal (2) of the starter and the other end of the positive terminal of the booster battery.
2. Connect one end of the negative (-) cable to the negative terminal of the booster battery. Then connect other end of the negative cable to the ground stud (1).
3. Start engine.
4. Immediately after starting engine disconnect end of the negative cable from the ground stud. Then disconnect the other end of the negative cable from the negative terminal of the booster battery.
5. Disconnect one end of positive cable from positive terminal of the booster battery and disconnect the other end from the positive terminal of the starter.

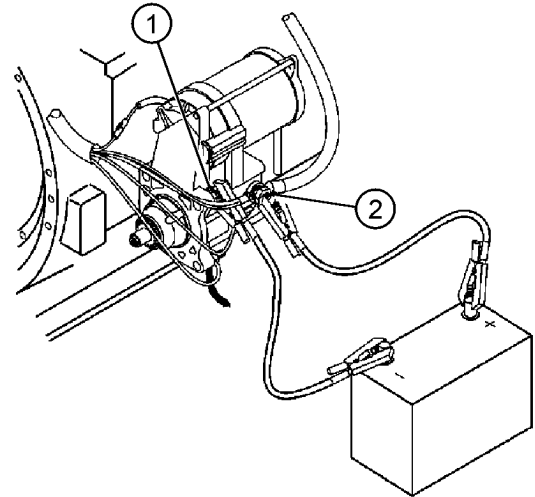

T147027 -UN-22OCT01

MR64971,000005C -19-05DEC01-1/1



**CAUTION:** Prevent possible injury from unexpected machine movement. Clear all persons from the area before lowering the boom with the engine stopped.



**CAUTION:** Diesel fuel or hydraulic fluid under pressure can penetrate the skin and cause serious personal injury, blindness or death. If any fluid is injected into the skin, it must be surgically removed within a few hours by a doctor familiar with treating this type of injury.

To avoid injury from escaping fluid under pressure, stop engine and relieve the pressure in the system before disconnecting or connecting hydraulic or other lines. Tighten all connections before applying pressure.

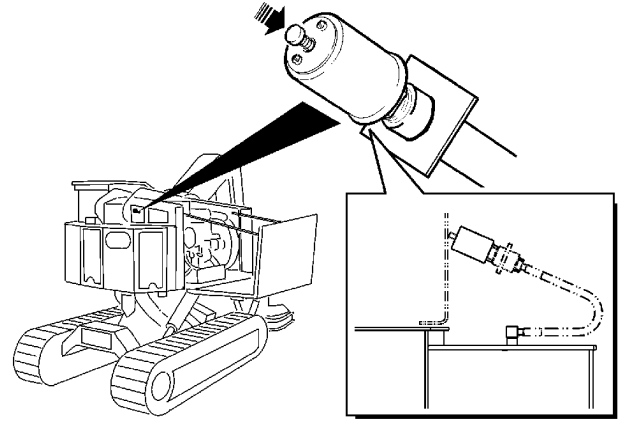

T152139 -UN-08MAR02

MR64971,0000061 -19-05DEC01-2/3

1. Open enclosure door to access hydraulic control valve.
2. Loosen the jam nut and slowly turn adjusting nut counterclockwise until boom begins to lower. Allow the boom to lower until attachment is resting on level ground.
3. After the machine has been repaired, readjust the boom hoist port relief valve to the correct pressure.

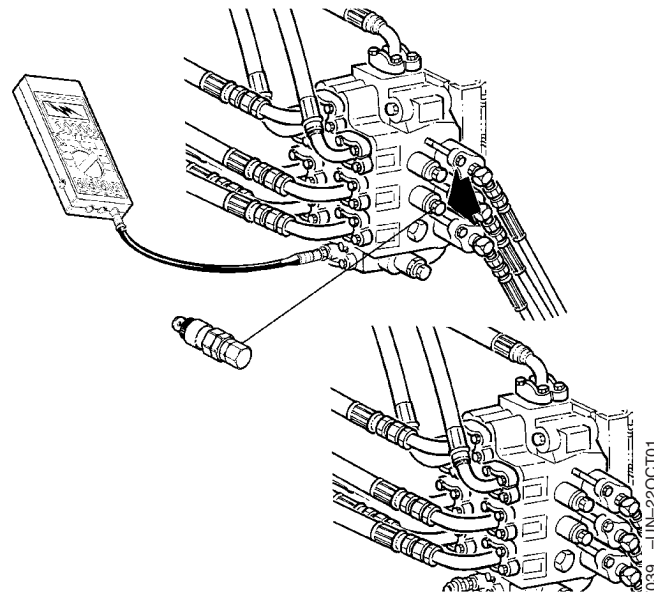

T147039 -UN-22OCT01

MR64971,0000061 -19-05DEC01-3/3

## Grease

Use grease based on NLGI consistency numbers and the expected air temperature range during the service interval.

The following grease is recommended:

- John Deere HD MOLY GREASE

Other greases may be used if they meet the following:

- SAE multipurpose grease with EP performance and containing 3 to 5% molybdenum disulfide.

**IMPORTANT:** Some types of grease thickeners are not compatible with others. Consult your grease supplier before mixing different types of grease.

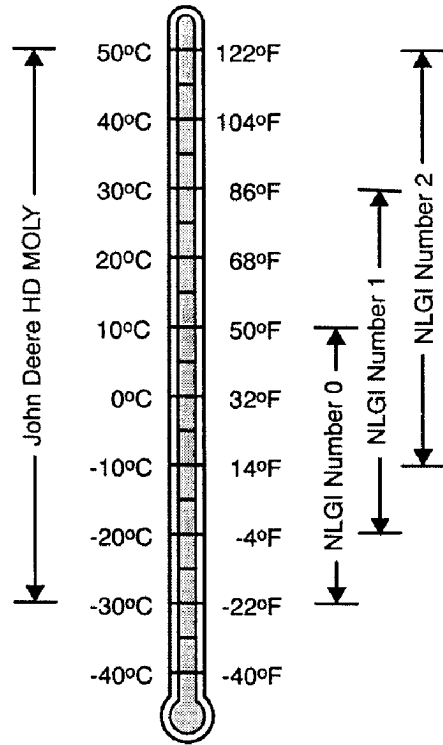

T147345 -UN-24OCT01

MR64971,000006C -19-05DEC01-1/1

CLICK HERE TO **DOWNLOAD** THE COMPLETE MANUAL

- Thank you very much for reading the preview of the manual.
- You can download the complete manual from: [www.heydownloads.com](http://www.heydownloads.com) by clicking the link below



- Please note: If there is no response to CLICKING the link, please download this PDF first and then click on it.

CLICK HERE TO **DOWNLOAD** THE COMPLETE MANUAL

Maintenance — Periodic Maintenance

1—Upper Delimiting Arms	18—Track Sprocket	32—Air Intake	43—Engine Enclosure Door Pump
2—Saw	19—Track Drive Planetary	33—Swing Planetary & Drive Motor	44—Engine Enclosure Door Cylinder
3—Lower Delimiting Arms	20—Cab Assembly	34—Hydraulic Pumps	45—Engine Enclosure Door Hand Pump
4—Harvesting Attachment	21—Foot Pedals	35—Hydraulic Reservoir	46—Engine Enclosure Door Lock Cylinder
5—Feed Rollers	22—Control Panel & Gauges	36—L.H. Track/Hoist/Pump 2 Control Valve	47—Anti Skid Material
6—Rotator and Link	23—Joysticks & Seat Assembly	37—Pilot Circuit Manifold	48—Ladder
7—Telescoping Boom	24—Cab Heater/Air Conditioner	38—Pilot Circuit Filter	49—R.H Leveler Cylinder Control Valve
8—Telescoping Boom Cylinder	25—Fuel Tank	39—R.H. Track/Swing/Stick Control Valve	50—L.H Leveler Cylinder Control Valve
9—Stick Boom	26—Rotary Manifold	40—Pilot Valves	51—R.H Leveler Cylinder
10—Hoist Boom	27—Front Enclosure	41—Pump 1/Telescoping Boom, Rotator, Control Valve	52—L.H Leveler Cylinder
11—Stick Cylinder	28—Radiator/Oil Cooler/AC Condenser	42—Engine Enclosure Door	
12—Hoist Cylinder	29—Fire Suppression		
13—Track Assembly	30—Battery Compartment		
14—Front Idler	31—Engine Assembly		
15—Track Rollers			
16—Track Slide			
17—Swing Bearing			

MR64971,0000037 -19-05DEC01-2/2

## Lubricate Harvesting Attachment

Refer to the Attachment Technical Manual for procedures to service the harvesting head attachment.

### Lubricate Harvesting Attachment Chain Saw

- Check saw chain and bar for straightness.
- Check chain tension.
- Check bolt torque.

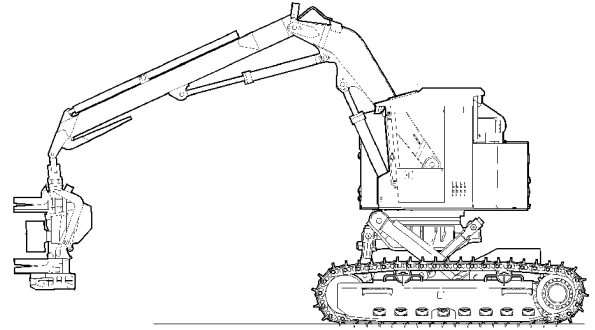

### Check Chain Saw Lubrication Oil

- Check tank fluid levels.
- Check for oil leaks.

### Lubricate Harvesting Attachment

- Rotator link.
- Delimiting arms cylinder mountings and bearings.
- Tilt arms cylinder mounting and bearings.
- Feed roller cylinder mounting and bearings.
- Feed roller mounting on attachment.
- Saw cylinder mounting and bearings.
- Measuring wheel mounting and bearings.

MR64971,0000081 -19-05DEC01-1/1

### Check Swing Bearing Bolt Torque

Check swing bearing bolt torque.

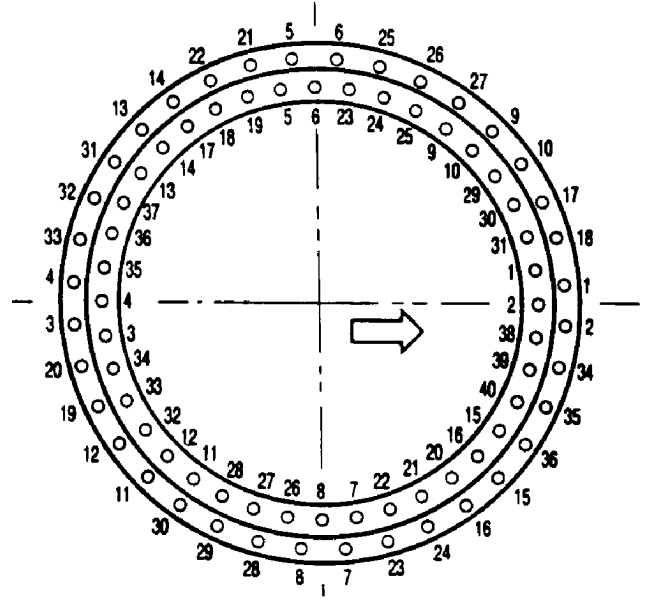

T147070 -UN-22OCT01

Item	Measurement	Specification
Swing Bearing Bolts	Torque	610 - 678 N•m (450 - 500 lb-ft)

Follow the torque sequence as shown. Torque inner race first then outer race.

MR64971.0000095 -19-05DEC01-1/1

### Check Cab Mounting Bolt Torque

Check cab mounting bolt torque. Tighten, if necessary.

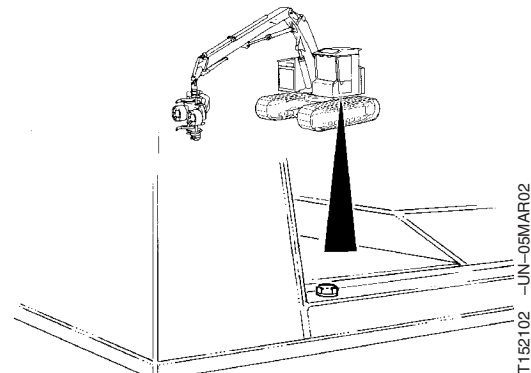

T152102 -UN-05MAR02

Item	Measurement	Specification
Cab Mounting Bolts	Torque	380 - 434 N•m (280 - 320 lb-ft)

MR64971.0000096 -19-05DEC01-1/1

## Check A/C Compressor Belt Tension

Apply approximately 4.5 lb (2.04 kg) midpoint force to the belt as shown. The deflection of the belt should not exceed the specified distance.

### Specification

A/C Compressor Belt Deflection—  
Distance..... 5 mm (0.19 in.)

If deflection exceeds the specified distance, adjust the tension using the following procedure:

1. Loosen the adjustment bolt.
2. Reposition the compressor to increase belt tension.
3. Tighten the adjustment bolt.
4. Remeasure the deflection until correct tension is obtained.

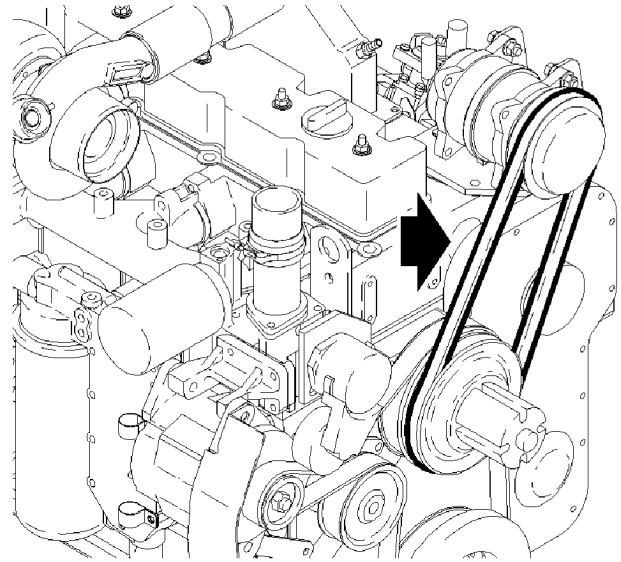

T147109 -UN-22OCT01

MR64971,00000A7 -19-05DEC01-1/1

## Replace Coolant Filter

Remove and discard the coolant filter.

(Refer to the Cummins Engine Operator and Maintenance Manual for detailed instructions and correct replacement filter.)

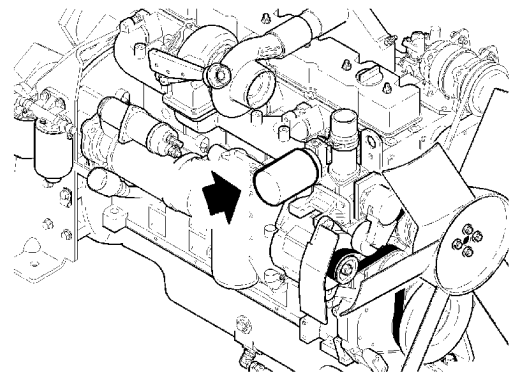

T147110 -UN-22OCT01

MR64971,00000A8 -19-05DEC01-1/1

Miscellaneous — Operational Checkout

	<p>Check the Fuel Gauge.</p> <p><i>LOOK: The gauge should indicate fuel level corresponding to the level known to be in the tank.</i></p> <p>Check Hourmeter.</p> <p><i>LOOK: The hourmeter should be moving, indicating the number of hours the engine has operated. Since the hourmeter registers tenths of an hour, the indicator will move slowly.</i></p> <p>After checking the gauges, shut off the engine.</p>	<p><b>OK:</b> Gauges are OK.</p> <p><b>NOT OK:</b> Contact authorized dealer to service any malfunctioning gauge or sensing circuit.</p> <p><b>IF OK:</b> Go on to next check.</p>
--	---	--

-19- -2/2

<p><b>Check Horn Override and Lamp Test Switch</b></p>	<div data-bbox="440 667 657 787" data-label="Image"> </div> <p>T147578 -UN-01NOV01</p> <p><b>1—Horn Override and Lamp Test Switch</b></p> <p>Ignition switch to position 3 (RUN).</p> <p>Press Horn Override and Lamp Test Switch.</p> <p><i>LOOK: The Hydraulic Oil Level Warning Light, Return Filter Oil Light and Pump Inlet Pressure Warning Light should be lit.</i></p>	<p><b>OK:</b> Horn Override and Lamp Test Switch and warning lights bulbs are OK.</p> <p><b>NOT OK:</b> Replace bulbs.</p> <p>If problem persists, contact authorized dealer to service the warning lights circuits.</p> <p><b>IF OK:</b> Go on to next check.</p>
--	--	--

--1/1

Miscellaneous — Operational Checkout

<p><b>Check Right Joystick Leveler Left/Right Function</b></p>	<p>T152487 -UN-08MAR02      T152489 -UN-08MAR02</p>	<p><b>OK:</b> Right Joystick Leveler Left/Right Function is OK.</p> <p><b>NOT OK:</b> Contact authorized dealer for service.</p> <p><b>IF OK:</b> Go on to next check.</p>
<p>With machine on level ground, start engine.</p> <p>Press the bottom right finger switch on the right joystick.</p> <p><i>LOOK: Leveler should tilt the cab right.</i></p> <p>Press the bottom left finger switch on the right joystick.</p> <p><i>LOOK: Leveler should tilt the cab left.</i></p> <p><i>NOTE: Hydraulic functions should operate promptly and smoothly and stop when the control is released.</i></p> <p>After checks are completed, shut the engine OFF.</p>		<p>--1/1</p>

**④ Undercarriage Checks**

<p><b>Check Tracks</b></p>	<p>Inspect tracks for unusual signs of wear, cracks and damage.</p> <p>Check for accumulation of dirt and debris.</p> <p><i>LOOK: Tracks should be in good condition.</i></p>	<p><b>OK:</b> Tracks are OK.</p> <p><b>NOT OK:</b> Remove dirt and debris. Contact authorized dealer to repair any damage to tracks.</p> <p><b>IF OK:</b> Go on to next check.</p>
		<p>--1/1</p>

## Diagnose Swing Function

Symptom	Problem	Solution
<b>Swing does not function; swing brake control in the "OFF" position</b>	Swing brake is not released.	See "Swing Brake will not release" below.
	Loose connections or leaks.	Repair. Tighten fittings or replace hoses.
	Pilot oil is not available at the joystick pilot valve.	Repair pilot system.
	Pilot oil is not available at the control valve.	Repair/replace joystick pilot valve.
	Main relief, port relief and crossover reliefs malfunctioning or incorrectly adjusted.	Adjust, repair, replace.
	Seized spool in the control valve.	Repair/replace valve.
	Insufficient pump flow.	Repair/replace pump.
	Swing motor for worn or damaged.	Repair/replace swing motor.
<b>Swing brake will not release; brake control in the "OFF" position</b>	Loose connections or leaks.	Repair. Tighten fittings or replace hoses.
	Pilot oil is not available at the brake control valve.	Repair pilot system.
	Pilot oil is not available at the brake cylinder.	Repair/replace brake control valve.
	Brake cylinder malfunction.	Repair/replace brake cylinder.

MR64971,00000BD -19-05DEC01-1/1

*Miscellaneous — Specifications*

A—8047 mm (316.8 in.)  
B—2187 mm (86.1 in.)  
C—1867 mm (73.5 in.)

D—1840 mm (72.4 in.)  
E—2563 mm (101 in.)  
F—2994 mm (117.8 in.)

G—3314 mm (130.4 in.)  
H—3244 mm (127.6 in.)  
I—4436 mm (174.7 in.)

J—3349 mm (131.8 in.)  
K—9678 mm (381 in.)

MR64971.00000C5 -19-05DEC01-2/2

# Miscellaneous — Crime Prevention Tips

## Help Prevent Crime

You can help take a bite out of crime by properly documenting ownership and discouraging theft.

**TAKE A BITE OUT OF  
CRIME**  
© 1979 The Advertising Council, Inc.



TS140 -19-07OCT88

MR64971.00000C7 -19-05DEC01-1/1

## Record Identification Numbers

1. Mark your machines with your own unique numbering system.
2. Record the Product Identification Number (PIN) of the unit and also individual component identification numbers for engines, axles, pumps, etc. Include the PIN numbers on all documentation, such as insurance, financial, and warranty papers.

MR64971.00000C8 -19-05DEC01-1/1

## Keep Proof of Ownership

1. Take color photographs from several angles of each machine.
2. Maintain an up-to-date inventory of all your machines.
3. Keep your documented identification numbers, color photographs, and inventory in a safe, secure location.

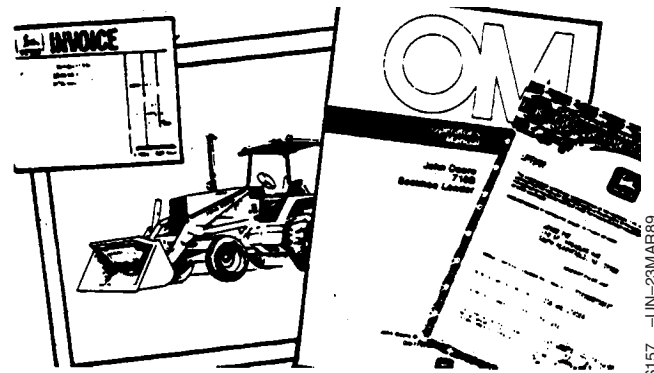

TS157 -UN-23MAR89

MR64971.00000C9 -19-05DEC01-1/1

## Park Indoors Out of Sight

Make machines hard to move:

- Park large equipment in front of exits.
- Lower equipment to the ground. Remove key.
- Remove battery when unit is in storage.
- Lock cab doors, windows, and vandal-proof devices.
- Lock building.

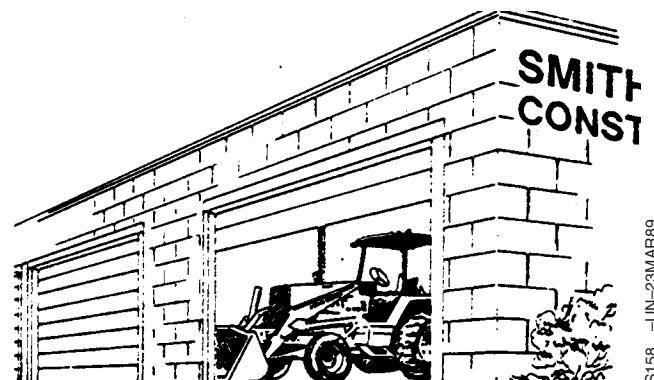

TS158 -UN-23MAR89

MR64971.00000CA -19-05DEC01-1/1

CLICK HERE TO **DOWNLOAD** THE COMPLETE MANUAL

- Thank you very much for reading the preview of the manual.
- You can download the complete manual from: [www.heydownloads.com](http://www.heydownloads.com) by clicking the link below



- Please note: If there is no response to CLICKING the link, please download this PDF first and then click on it.

CLICK HERE TO **DOWNLOAD** THE COMPLETE MANUAL