

608B FELLER BUNCHER

S/N 997457 – 997472

S/N 10BA1000 – PRESENT

OPERATOR'S MANUAL 608B FELLER BUNCHER OMF294826

CALIFORNIA Proposition 65 Warning

Diesel engine exhaust and some of its constituents are known to the State of California to cause cancer, birth defects and other reproductive harm.



WARNING

The engine exhaust from this product contains chemicals known to the State of California to cause cancer, birth defects or other reproductive harm.

Worldwide Construction and Forestry Division

English

CLICK HERE TO **DOWNLOAD** THE COMPLETE MANUAL

- Thank you very much for reading the preview of the manual.
- You can download the complete manual from: www.heydownloads.com by clicking the link below



- Please note: If there is no response to CLICKING the link, please download this PDF first and then click on it.

CLICK HERE TO **DOWNLOAD** THE COMPLETE MANUAL

1. Introduction

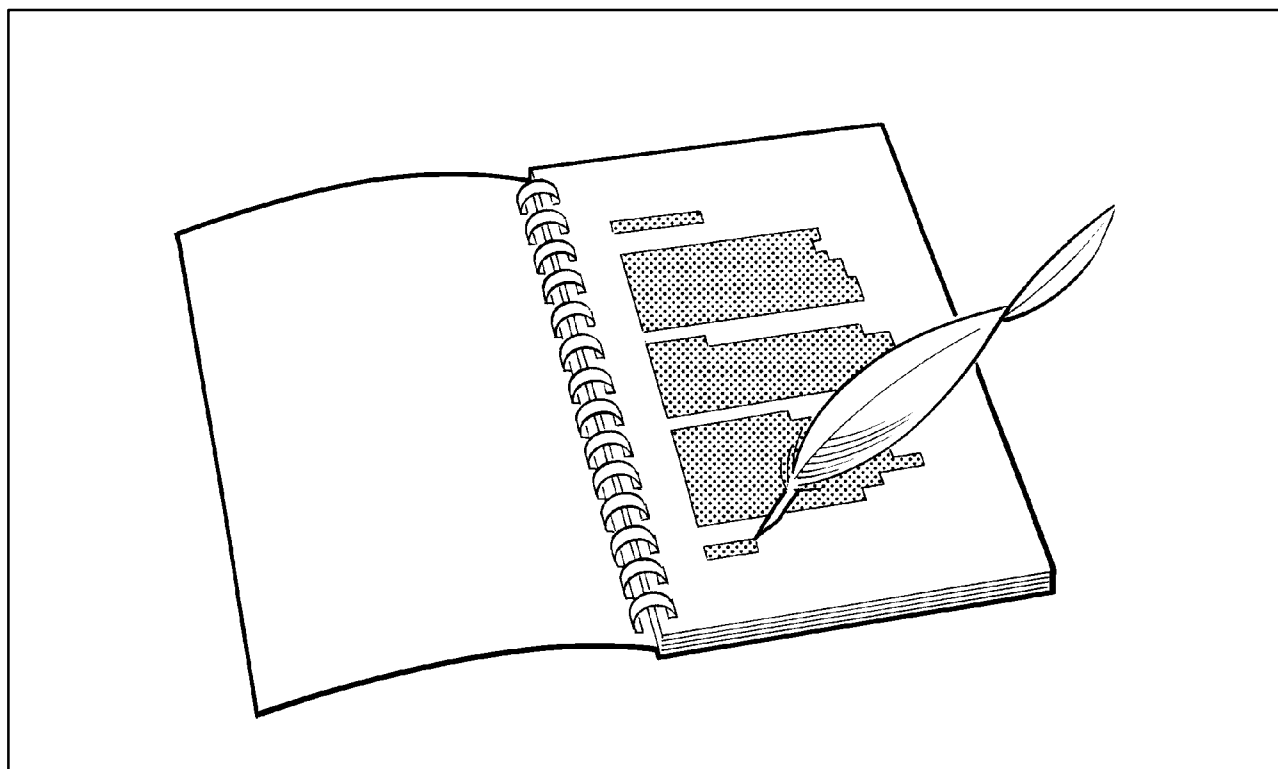

| | |
|--|-----|
| 1.1 Foreword | 1-2 |
| 1.2 Model and Serial Number Record | 1-3 |
| 1.3 Modifications or Repairs to Roll-over Protective Structures (ROPS) | 1-4 |
| 1.4 Non-approved Field Product Changes | 1-6 |
| 1.5 Sound Information | 1-7 |

2.2 Items Not Covered By Warranty

Items and service related functions that are not covered by warranty include, but are not limited to:

1. Issues resulting from misuse, negligence or accident.
2. Issues arising from the use of non approved parts.
3. Repairs or adjustment by other than Timberjack or its authorized dealers.
4. Engine Tune up.
5. Issues resulting from the installation of unauthorized attachments or modifications.
6. Transportation of the machine to or from the repair location.
7. Dealer travel or mileage expense.
8. Injection pump and injector adjustments.
9. Air, oil and fuel filter elements.
10. Air conditioning filters, freon, receiver dryer.
11. Diagnosis time will not be considered warranty labour.
12. Tightening of nuts, bolts, screws, etc. or adjustments.
13. Natural wear or defects caused by natural wear.
14. Issues due to use of improper fuel, oil, grease, coolant, or other fluid or lubricant.
15. Freight expenses, daily allowances and overtime labour rates.
16. Damage occurring while in dealer inventory or in transit from the factory to dealer and from dealer to customer.
17. Indirect damages such as loss of earnings, etc.
18. Normal Maintenance services. Maintenance services that are not directly involved with defective parts are considered normal service and should be excluded from a claim. These services include (but not limited to):
 - Fuel system cleaning
 - Engine tune up
 - Brake inspection and adjustment
19. Other adjustments (but not limited to) such as:
 - Tightening of hydraulic fittings
 - Adding or replacing of service fluid and filters
 - Replacement of air, hydraulic, engine fuel filters, oil, belts, and breathers.
 - Hydraulic pressure adjustments.

3.6 Servicing Safety Precautions

When servicing or repairing equipment, shut the engine down, and disconnect the negative (-) battery cable from both batteries.

Before performing maintenance or repair work on any equipment, consult the manufacturer's instruction manual and follow recommended procedures.



WARNING

Diesel fuel or hydraulic fluid under pressure can penetrate the skin and cause serious personal injury, blindness, or death. If any fluid is injected into the skin, it must be surgically removed within a few hours by a doctor familiar with treating this type of injury.

Never use your bare hand to check for fluid leaks.

Fluid leaks under pressure may not be visible. When searching for leaks, wear work gloves and use a piece of cardboard or wood. Wear safety goggles for eye protection.

Pressure can be maintained in a hydraulic system long after the power source and pump have been shut down. Lower the implements to the ground and relieve trapped pressure before performing work on components, or disconnecting any hoses.

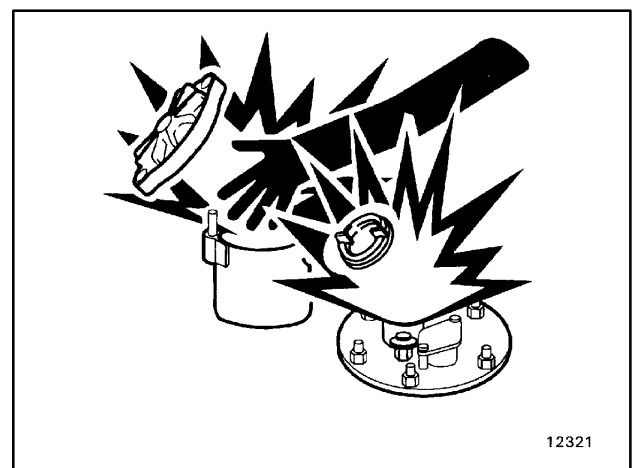
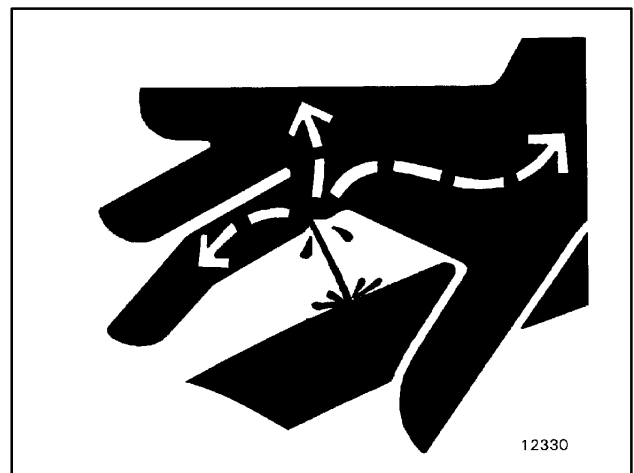
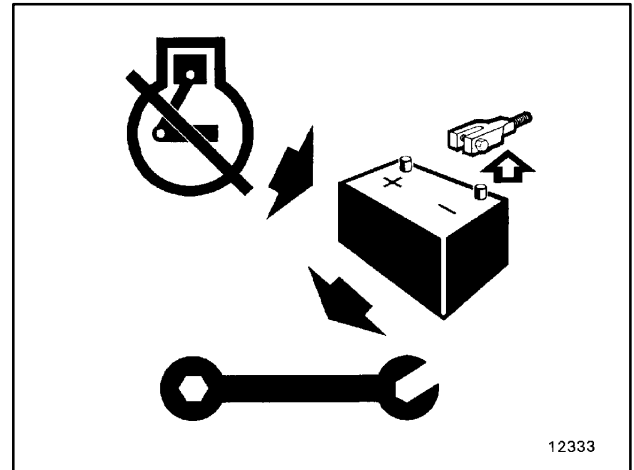

4.2 Equipment Nomenclature

4.2.2 S546 Felling Head with Heavy Duty Undercarriage

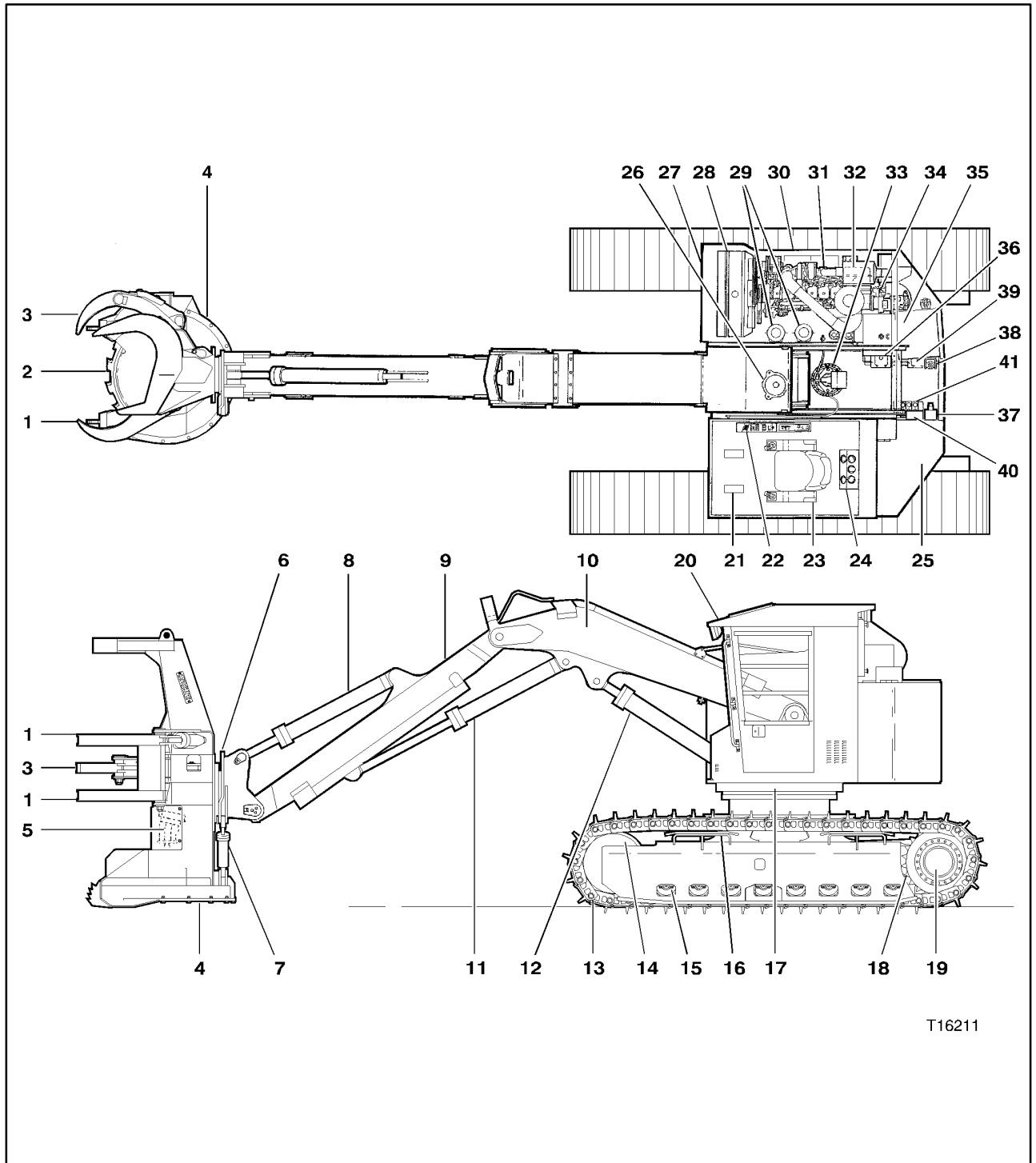

4.3 Controls and Instrumentation

4.3.3 Switches and Gauges

Throttle Lever

To regulate engine speed, push lever forward completely for full throttle and pull back completely for low idle.

All felling operations should be performed at full throttle. It is most important that the rpm of the engine be correct at all times.

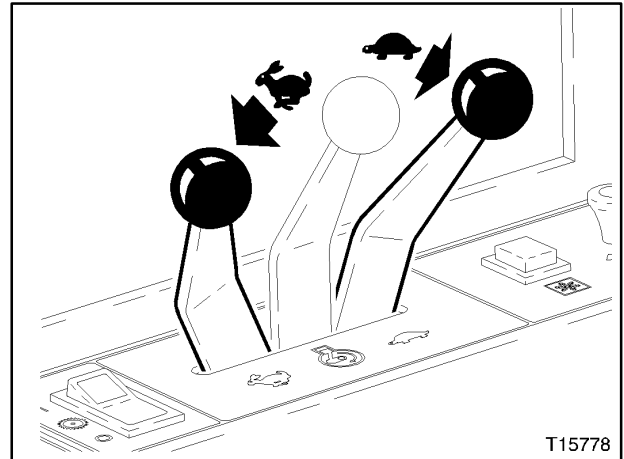

WARNING

Under no circumstances allow the Full Throttle engine rpm to exceed the recommended settings as serious damage to the pumps will result.

Turntable Swing Brake Control

This is a two position switch used to engage or disengage the turntable swing brake.
0 = OFF, 1 = ON.

When the swing brake is "ON" the turntable will not rotate. During normal operation the swing brake must be switched "OFF".

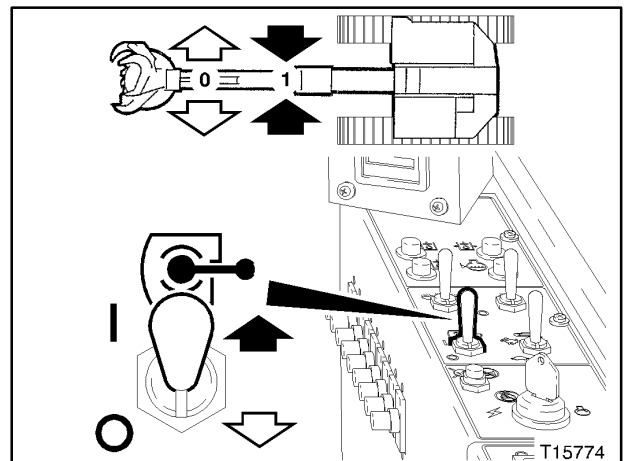

Travel Speed Control

This is a two position switch for Low and High travel speed. Harvesting should be done in Low travel speed position.

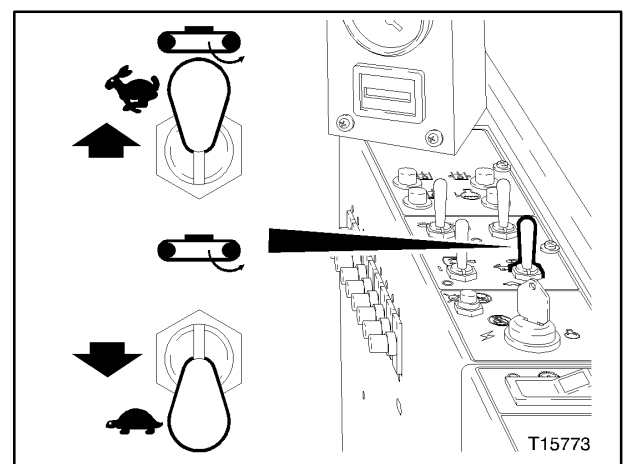

4.3 Controls and Instrumentation

4.3.5 Safety Items

Escape Hatch (Rear Window)

In case of emergency the rear window can be removed by releasing the over-centre latches and pushing out the window.

Note!

Apply vaseline to the seal around the window frame prior to installation.

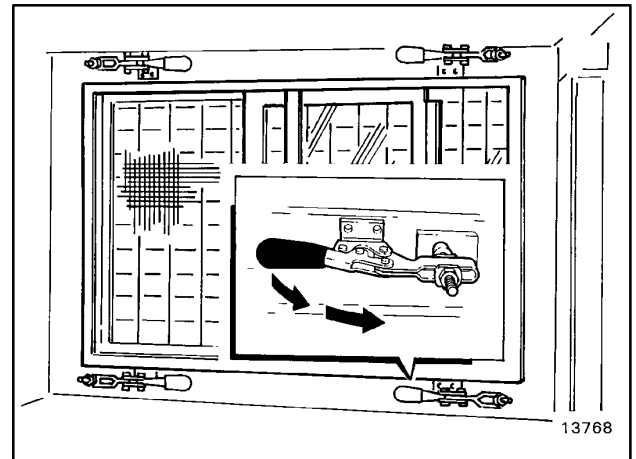

The rear window can also be removed from the outside by removing the 4 knobs on the window frame and lifting out the window. Every 125 Hours, remove the knobs and add Never-Seez to the threads.

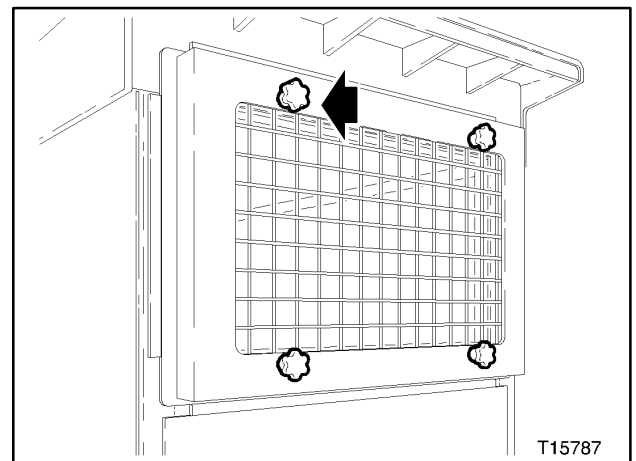

5.1 Driving The Feller Buncher

5.1.4 Stopping Procedure

7. Turn the ignition key switch OFF to stop the engine.

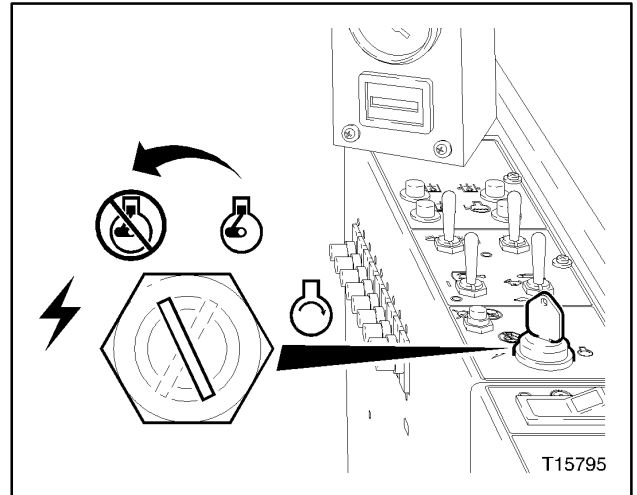

8. Turn the battery disconnect switch (2) OFF (position 0) if the machine is to be parked for more than a few hours.

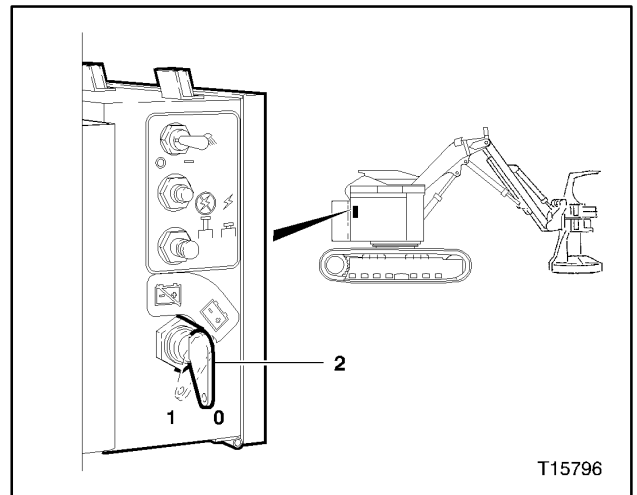

CLICK HERE TO **DOWNLOAD** THE COMPLETE MANUAL

- Thank you very much for reading the preview of the manual.
- You can download the complete manual from: www.heydownloads.com by clicking the link below



- Please note: If there is no response to CLICKING the link, please download this PDF first and then click on it.

CLICK HERE TO **DOWNLOAD** THE COMPLETE MANUAL

5.3 Felling Technique

5.3.1 General

The following operating techniques cover some of the important points for the operator to keep in mind while using the feller buncher.

This information is intended as a guide for the new operator as well as an experienced operator changing from another type of feller buncher to achieve the best possible performance and production output.

Planning the Operation

The most preferable felling approach is where the trees are placed in rows, (either single stems or pre-bunched), with the butt end pointing toward the skidding direction. Plan the felling pattern and skidding routes so that potential trouble spots can be avoided.

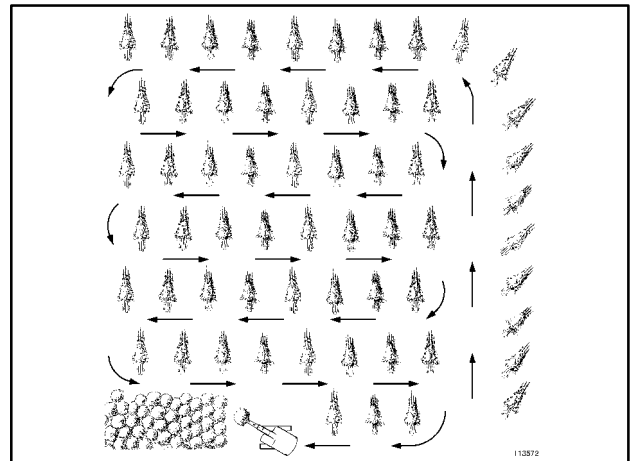

Shallow Timber Stand

Start the felling operation at the outer boundary of the logging area and progressively move the machine forward in continuous felling and bunching cycles.

Although the illustration shows clear cutting, the same approach may be used for thinning operation.

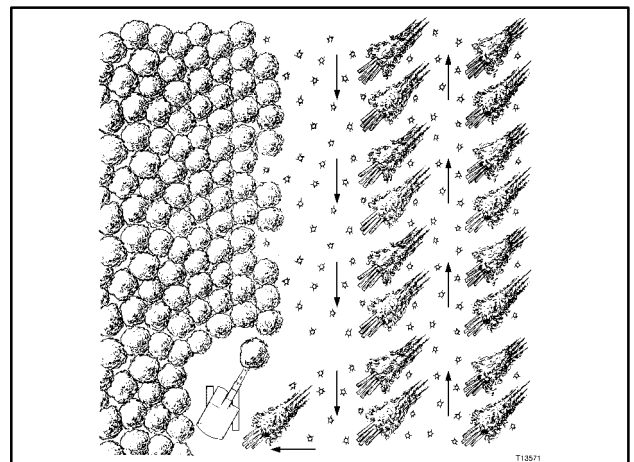

Deep Stand

This approach is used on level ground or in winter conditions where snow is greater than 2 ft (60 mm) deep and tracks from the feller buncher may present problems for skidding operation.

5.3.2 Felling Head

Read and understand the Felling Head Operator's Manual thoroughly.

With the felling head lowered to the ground and the engine shut off, remove the saw guard (1) and keep for reinstallation during servicing of the felling head. (S566 felling head shown).

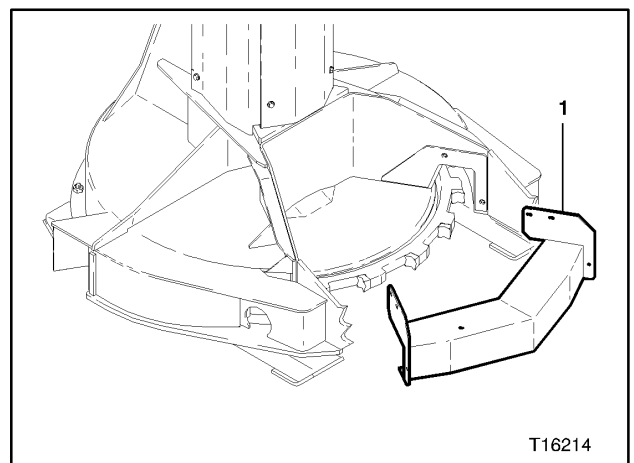

6.1 Maintenance Schedule

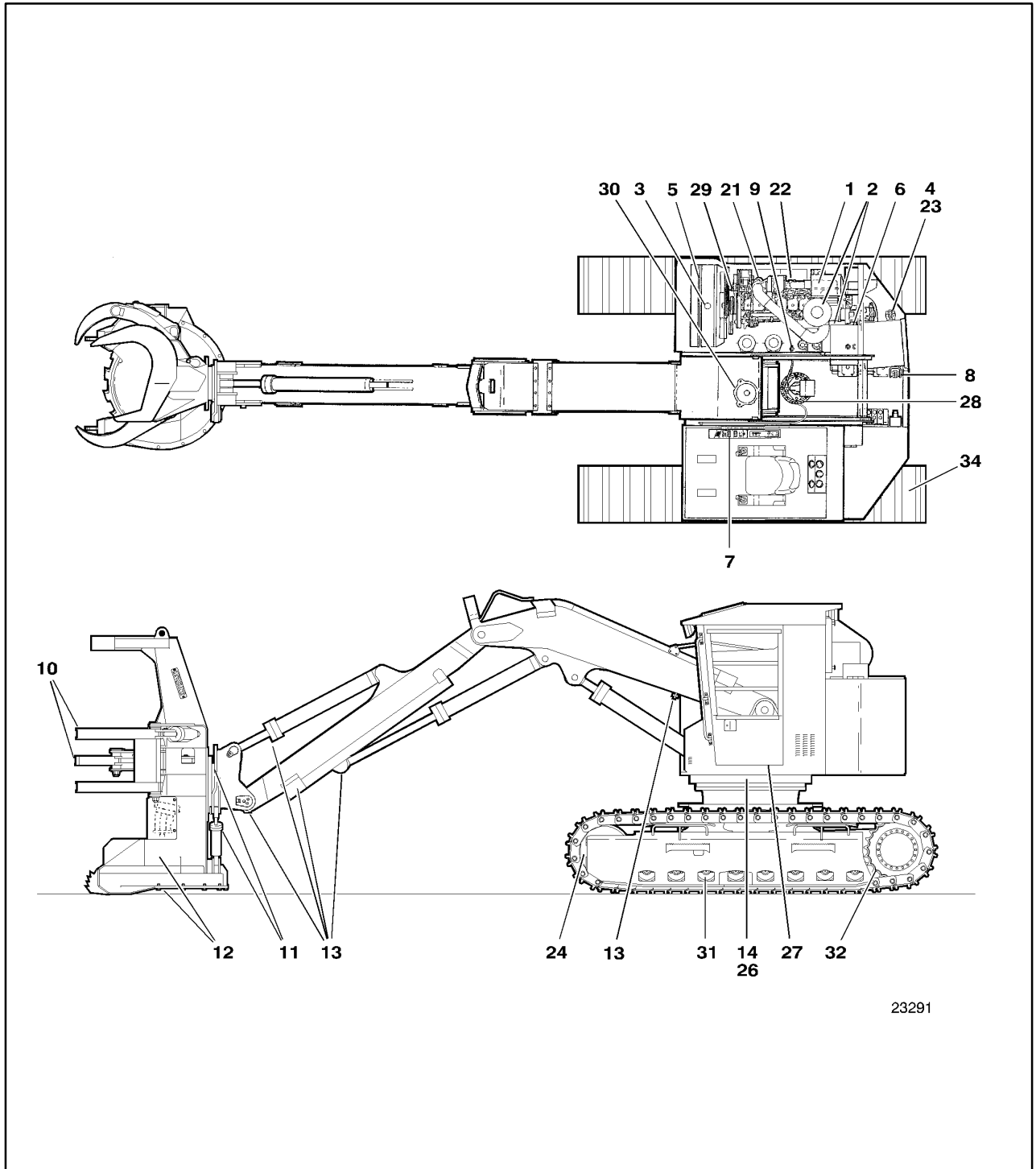

23291

6.2 Maintenance Procedures

6.2.2 Maintenance - First 25 Hours

21. Change Engine Oil and Filter

Remove the retaining bolt and swing the battery box fully open. Take out the plug from the drain hose and drain the engine oil into a suitable container.

Replace the plug after all of the oil has been drained.

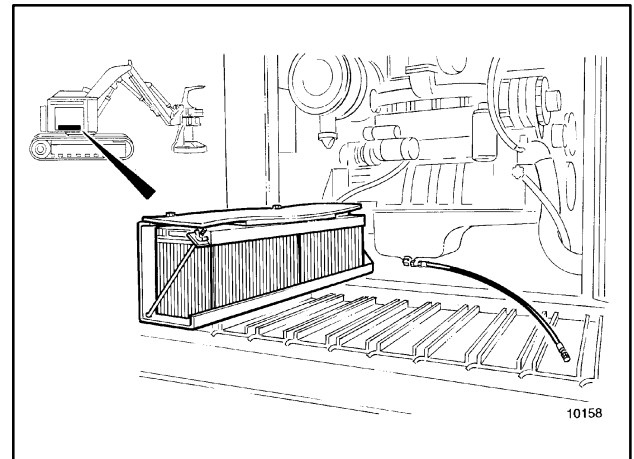

Change the oil filter, then fill with fresh oil. See paragraph 6.3.2 for recommended oil.

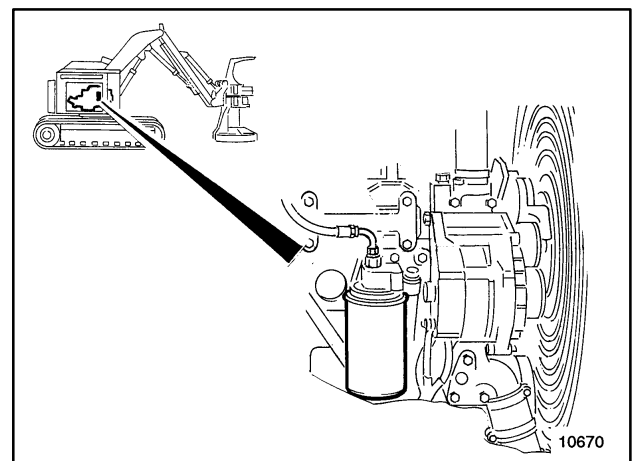

Swing open the engine compartment panel to access the oil filler tube.

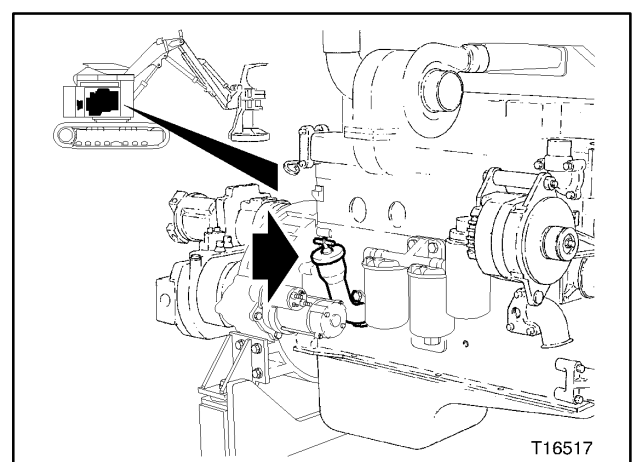

6.2 Maintenance Procedures

6.2.3 Maintenance - 125 Hours

48. Check Swing Bearing Bolt Torque

Torque to 450 - 500 lb ft (610 - 680 Nm). Follow the torque sequence as shown. Torque inner race first then outer race.

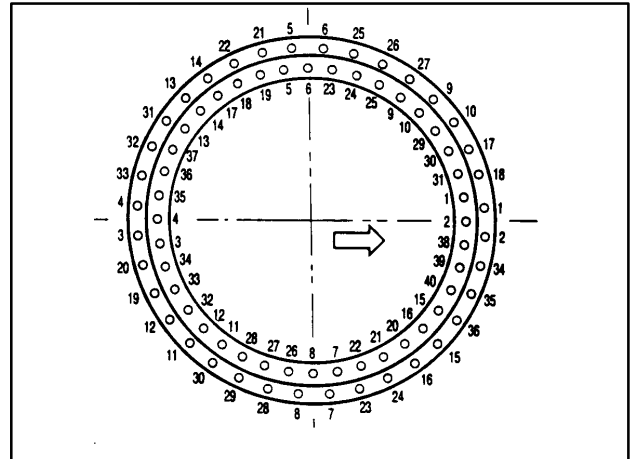

49. Check Cab Mounting Bolt Torque

See item 27. for torque specification.

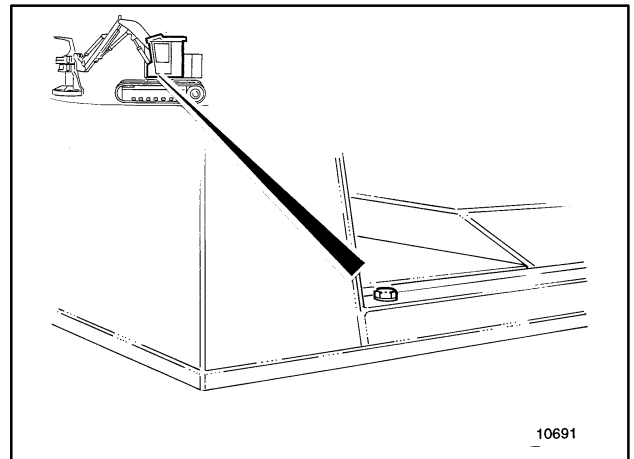

10691

50. Check Swing Gearbox Bolt Torque

See item 28. for torque specification.

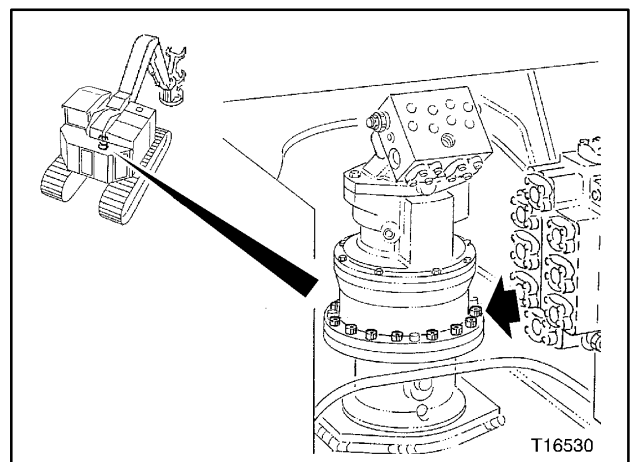

T16530

6.2 Maintenance Procedures

6.2.8 Maintenance - 2000 Hours

72. Check Specific Gravity Of Battery Electrolyte

Electrolyte specific gravity should be 1.260 - 1.280 on fully charged battery.

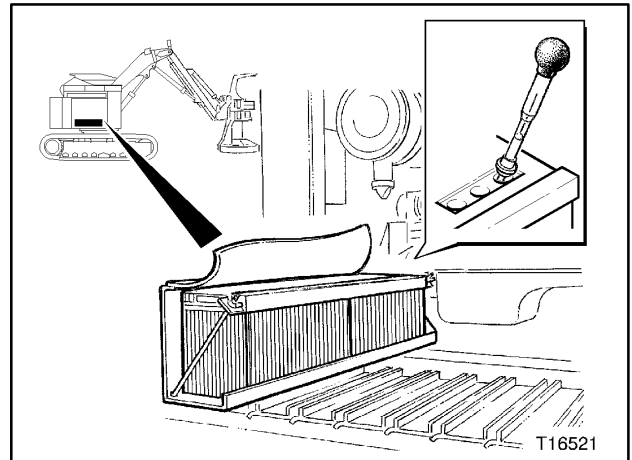

73. Change Engine Coolant

Refer to engine manufacturer's manual for additional information.

6.2.9 Unscheduled Maintenance

74. Drain Hydraulic Fluid

Due to seasonal changes, periodic hydraulic fluid change may be required.

Remove the end cap from the hydraulic tank drain valve and attach a suitable drain hose (with a #16 JIC female fitting) to the end of the drain valve. Place the drain hose in a suitable container. Open the drain valve and drain the hydraulic fluid into the container.

With all the hydraulic cylinders retracted except hoist, refill the tank with clean oil to the proper level using the hand pump. Refer to section 6.3.1 for recommended oil.

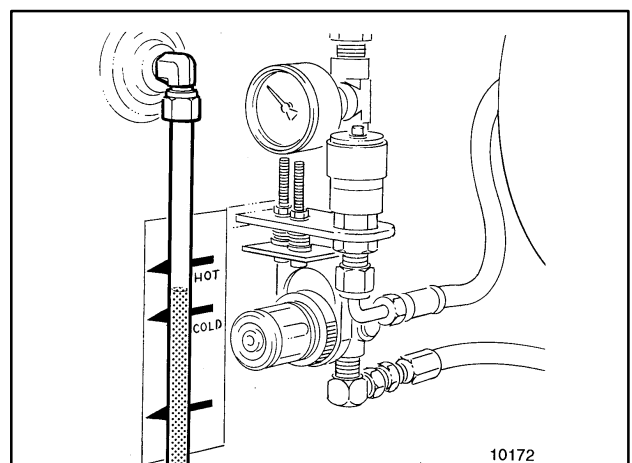
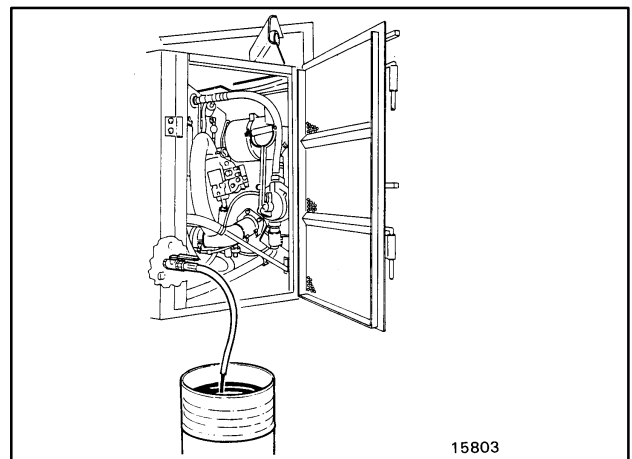

9.6 Swing

Swing does not function; swing brake control in the "OFF" position

| | |
|--|---|
| Check if swing brake is released. | See Swing Brake will not release. Fault Finding Procedure, below. |
| Check for loose connections or leaks. | Repair. |
| Check if pilot oil is available at the pilot valve (joystick). | Repair pilot system. |
| Check if pilot oil is available at the control valve. | Repair/replace joystick pilot valve. |
| Check the main relief, port relief and crossover reliefs. | Adjust, repair, replace. |
| Check for seized spool in the control valve. | Repair/replace valve. |
| Check the pump for flow. | Repair/replace. |
| Check the swing motor for wear or damage. | Repair/replace. |

Swing brake will not release; brake control in the "OFF" position

| | |
|---|-------------------------------------|
| Check for loose connections or leaks. | Repair. |
| Check if pilot oil is available at the brake control valve. | Repair pilot system. |
| Check if pilot oil is available at the brake cylinder. | Repair/replace brake control valve. |
| Check the brake cylinder for a malfunction. | Repair/replace. |

10.2 Specifications

Stick and Tilt Cylinder:

| | |
|------------------------|-----------------------|
| Quantity | 2 |
| Bore | 5.0 in. (127 mm) |
| Stroke | 40.5 in. (1029 mm) |
| Rod Diameter | 3.0 in. (76.2 mm) |
| Collapsed Length | 59.88 in. (1520.8 mm) |

Hydraulic Valves:

Main Valves

| | |
|-------------------|------------------------|
| Quantity | 2 |
| Spools | 3 |
| Main Relief | 4600 psi (31.72 MPa) |
| Rated Flow | 50 U.S gpm (189.3 L/M) |

Saw Valve

| | |
|-------------------|----------------------|
| Quantity | 1 |
| Spools | 1 |
| Main Relief | 4000 psi (24.82 MPa) |

Attachment Valve

| | |
|-------------------|---------------------|
| Quantity | 1 |
| Spools | 3 |
| Main Relief | 2500 psi (17.2 MPa) |

Joystick & Foot Pedal Valves

| | |
|--------------------------|-------------------|
| Quantity | 2 Each |
| Operating Pressure | 550 psi (3.8 MPa) |

CLICK HERE TO **DOWNLOAD** THE COMPLETE MANUAL

- Thank you very much for reading the preview of the manual.
- You can download the complete manual from: www.heydownloads.com by clicking the link below



- Please note: If there is no response to CLICKING the link, please download this PDF first and then click on it.

CLICK HERE TO **DOWNLOAD** THE COMPLETE MANUAL