

A message to hyundai lift truck operators	0-1
Introduction	0-2
How to use this manual	0-3
Safety labels	0-5
Guide (direction, S/No, symbol)	0-15

1. GENERAL SAFETY RULES

1. Daily inspection	1-1
2. Do's and don'ts	1-2
3. Seat belts	1-3
4. No riders	1-4
5. Pedestrians	1-5
6. Operator protection	1-6
7. Fork safety	1-7
8. Pinch points	1-8
9. Travel	1-9
10. Grades, ramps, slopes and inclines	1-10
11. Tip over	1-11
12. Surface and capacity	1-13
13. Parking	1-14
14. Lifting, jacking and blocking	1-15
15. Loading and unloading by crane	1-20

2. OPERATING HAZARDS

1. Loose loads	2-1
2. Long and wide loads	2-2
3. Rear swing	2-2
4. Low overhead clearance	2-3
5. Fast turns and high loads	2-3
6. Drop-offs	2-4
7. Right-angle stacking	2-4
8. Chain slack	2-5
9. Pallets and skids	2-5
10. Caution for electrical lines	2-6

CLICK HERE TO **DOWNLOAD** THE COMPLETE MANUAL

- Thank you very much for reading the preview of the manual.
- You can download the complete manual from: www.heydownloads.com by clicking the link below



- Please note: If there is no response to CLICKING the link, please download this PDF first and then click on it.

CLICK HERE TO **DOWNLOAD** THE COMPLETE MANUAL

4) 22/25/30/32B-7

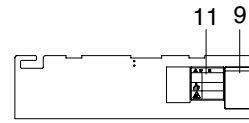
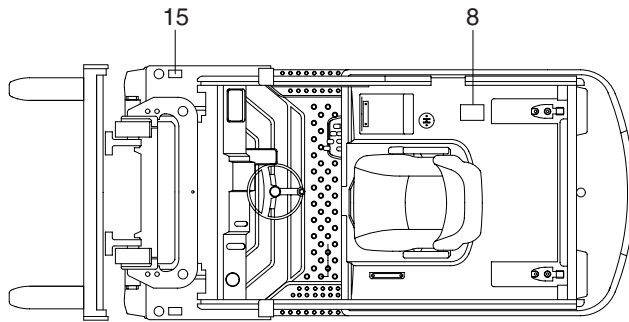

BONNET

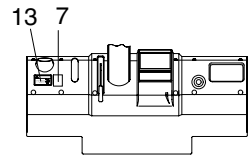

DASHBOARD COVER

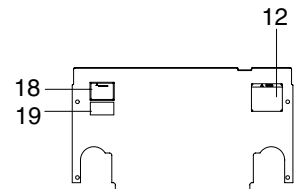
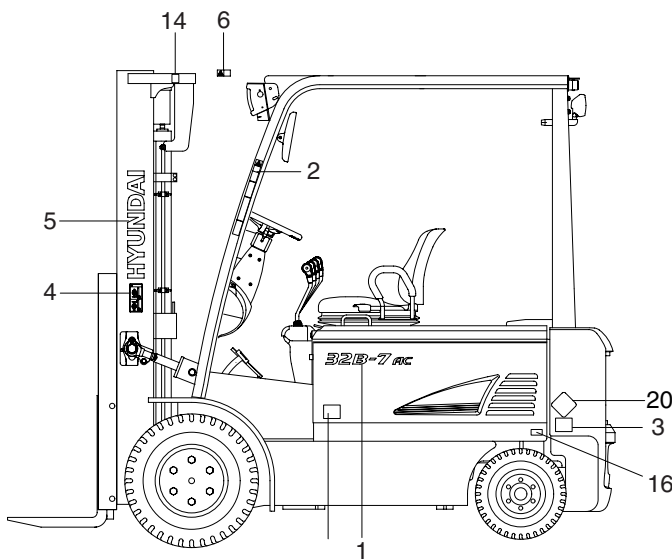

DASHBOARD

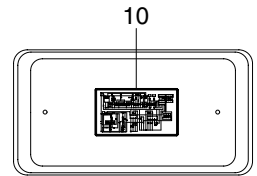

REAR COVER

22B7OM101

- | | | |
|---------------------------|----------------------------|----------------------------|
| 1 Model name | 8 Load capacity chart | 15 Front tire air pressure |
| 2 Warning over head guard | 9 Maintenance instructions | 16 Rear tire air pressure |
| 3 Hanger | 10 Circuit diagram | 17 Temperature |
| 4 Warning mast | 11 Battery handling | 18 Name plate |
| 5 Logo | 12 Warning safety | 19 Label-CE |
| 6 Hand caution | 13 Brake fluid | 20 EE mark |
| 7 Parking brake | 14 Hook | |



Don't operate the truck outdoors in rainy day.

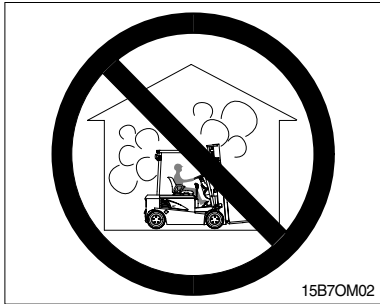

Don't perform battery charging service in the room without adequate ventilation.



Don't park the truck outdoors in rainy day in order to protect electric components.



Don't splash water about electric components during truck washing.

2. LONG AND WIDE LOADS

⚠ With long or wide loads, you need more room. So slow down and watch your clearance.

When extra-long material makes it necessary to travel with the load elevated, do so with extreme care and be alert to load end-swing when turning.

⚠ A long load reduces the capacity of the truck. Know and understand your truck load rating.

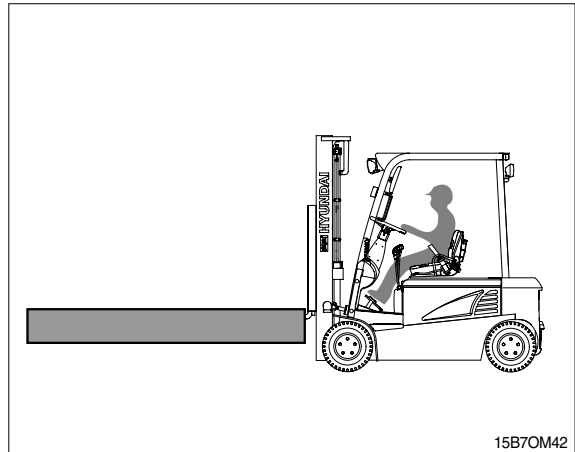

3. REAR SWING

⚠ When turning, be sure the rear end of the truck does not swing into racks, posts, etc. Watch for pedestrians beside the truck.

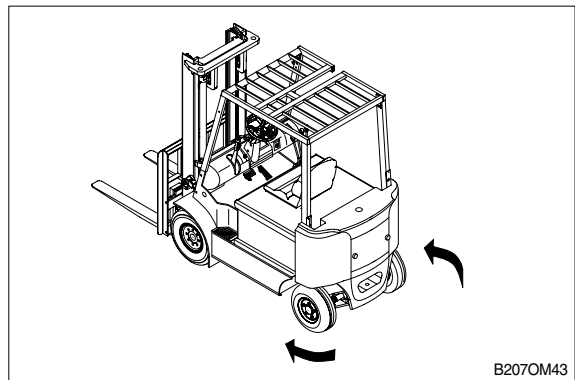

6) 35/40/45/50B-7

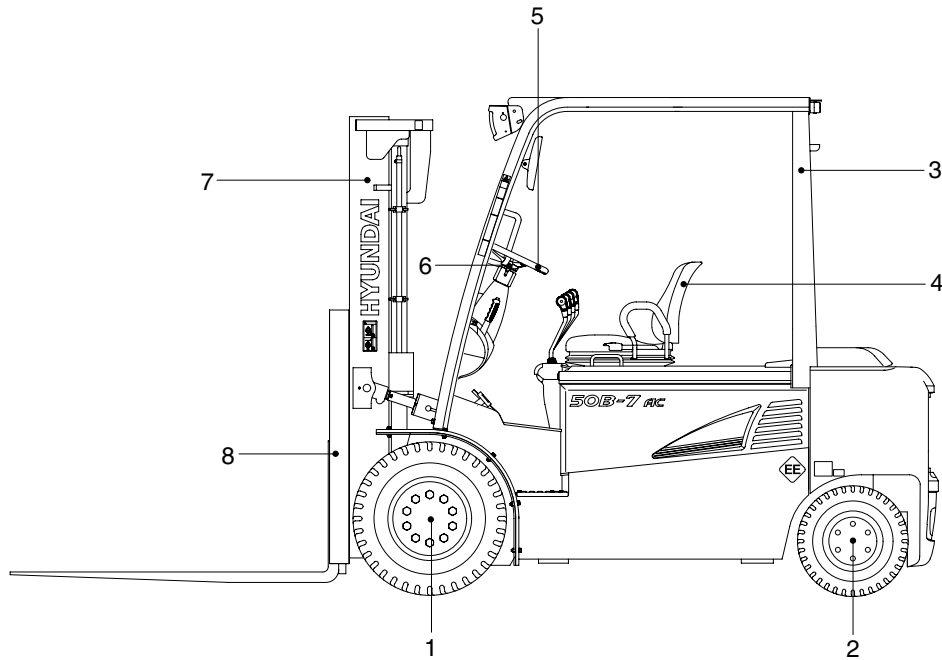

35B7OM54

TRUCK TYPE : Electric Sit-Down Rider, 80 Volt.

- | | | | |
|---|---------------------------------|---|---------------------------|
| 1 | Drive unit, tires and wheels | 5 | Steering wheel |
| 2 | Steering axle, tires and wheels | 6 | Directional control lever |
| 3 | Overhead guard | 7 | Mast |
| 4 | Seat | 8 | Carriage and backrest |

CLICK HERE TO **DOWNLOAD** THE COMPLETE MANUAL

- Thank you very much for reading the preview of the manual.
- You can download the complete manual from: www.heydownloads.com by clicking the link below



- Please note: If there is no response to CLICKING the link, please download this PDF first and then click on it.

CLICK HERE TO **DOWNLOAD** THE COMPLETE MANUAL

(3) Turtle

The turtle symbol (3) is normally off; when it appears (fixed) it shows activation of the "soft" mode of the truck, in which maximum speed and acceleration are reduced. The "soft" mode can be activated pressing button .

(4) Hour meter

The number displayed on the bottom right side of the unit (4) shows the Hours Worked.

The letter present near the hour meter shows which hour meter is displayed:

- K : the key hour meter is displayed;
- T : the traction hour meter is displayed;
- P : the pump hour meter is displayed; it increases if pump control is working.

(5) Accelerator

The accelerator level indication is displayed on the central top side of the unit (5); it is shown by ten notches. When the accelerator level is minimum only a notch is displayed, when the accelerator level is maximum all the ten notches are displayed. Each notch represents 1/10 of the difference between maximum and minimum accelerator level.

(6) Speed

The number displayed under the accelerator notches on the center of the unit (6) shows the truck speed. The unit can be km/h or mph depending on the SPEED UNIT parameter setting.

(7) Wheel position

The notch displayed on the left of the hour meter (7) represents the wheel (only one of the nine notches is displayed) and shows the steering angle (it corresponds to the relative truck direction if the truck is running).

(8) Running direction

The arrow (8) shows the set truck running direction. The arrow point is up when the truck is forward running; the arrow point is down when the truck is reverse running. If the truck doesn't run a dot is displayed instead of the arrow.

4. STARTING THE TRUCK

Before you start the truck, make sure that you have taken all the above mentioned precautions and that the directional control lever is in NEUTRAL. Also you must sit down on the seat before starting the truck.

To start the truck, turn the key switch clockwise to the ON position.

1) RUNNING

- (1) Place the directional control lever on the FORWARD position (or the REVERSE position) and gradually step on the accelerator pedal.
- (2) The vehicle will start forward (or backward).

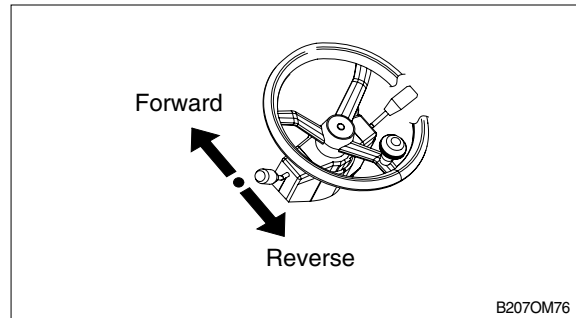

- (3) The speed can be controlled from zero to top speed by varying the amount of accelerator pedal depression.

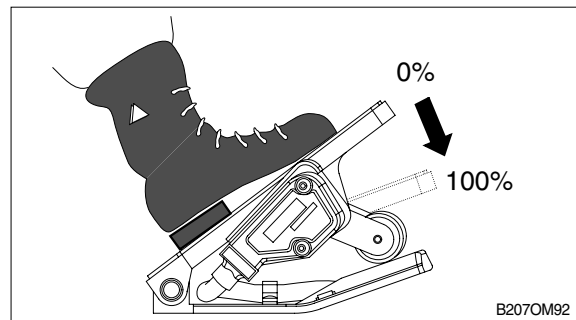

2) TURNING

- (1) Hold the steering wheel or knob with the left hand to operate the steering.
- (2) Forklift trucks are steered by the rear wheels.
- (3) So when travelling FORWARD, keep to the inside and when travelling in REVERSE, keep to the outside when turning.
- (4) When turning, do not let the outside of the counterweight touch anything.

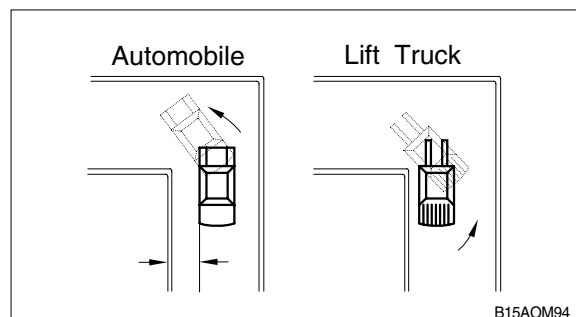
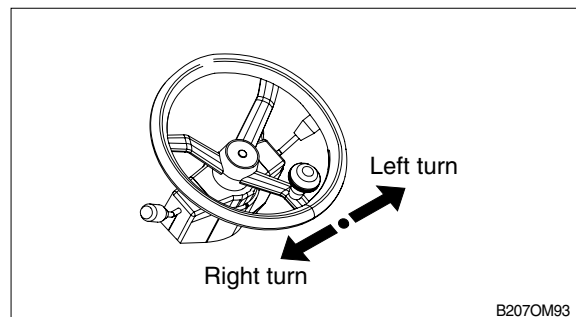

(2) To move a load from a stack

Approach the stack carefully, truck lined up squarely with the load. With mast vertical, raise the forks to the correct height for freely engaging the load pallet. Adjust fork angle as necessary to fit squarely under the load. Move (inch) forward until the forks are under the load.

Be sure that the forks do not extend beyond the load, causing damage or tipping of other adjacent loads or materials behind the load being moved. If the forks are longer than the load, move the tips partially under the load without extending beyond the load.

Raise the load to clear the under surface. Back out several inches, then set the load down and move forward until the front face of the forks contacts the load. Be careful that the fork tips now clear the adjacent load or material behind the load being moved.

Raise the load from the stack by tilting the mast back just enough to lift the load from the surface. Or, with the mast still vertical, raise the forks until they begin to lift the load. at this point, apply the minimum back tilt that will stabilize the load.

Check your travel path, slowly back up until clear of the stack, stop, and then lower the load to the travel position [150~200mm(6~8in) off the ground]. Tilt full back to travel(Except for certain loads that may have to be transported as level as possible). Be sure the load is back flush against the carriage or front face of the forks.

※ **Certain loads must be transported as level as possible.**

5) 22/25/30BHA-7

Use the illustration below to locate components included in the PM procedures.

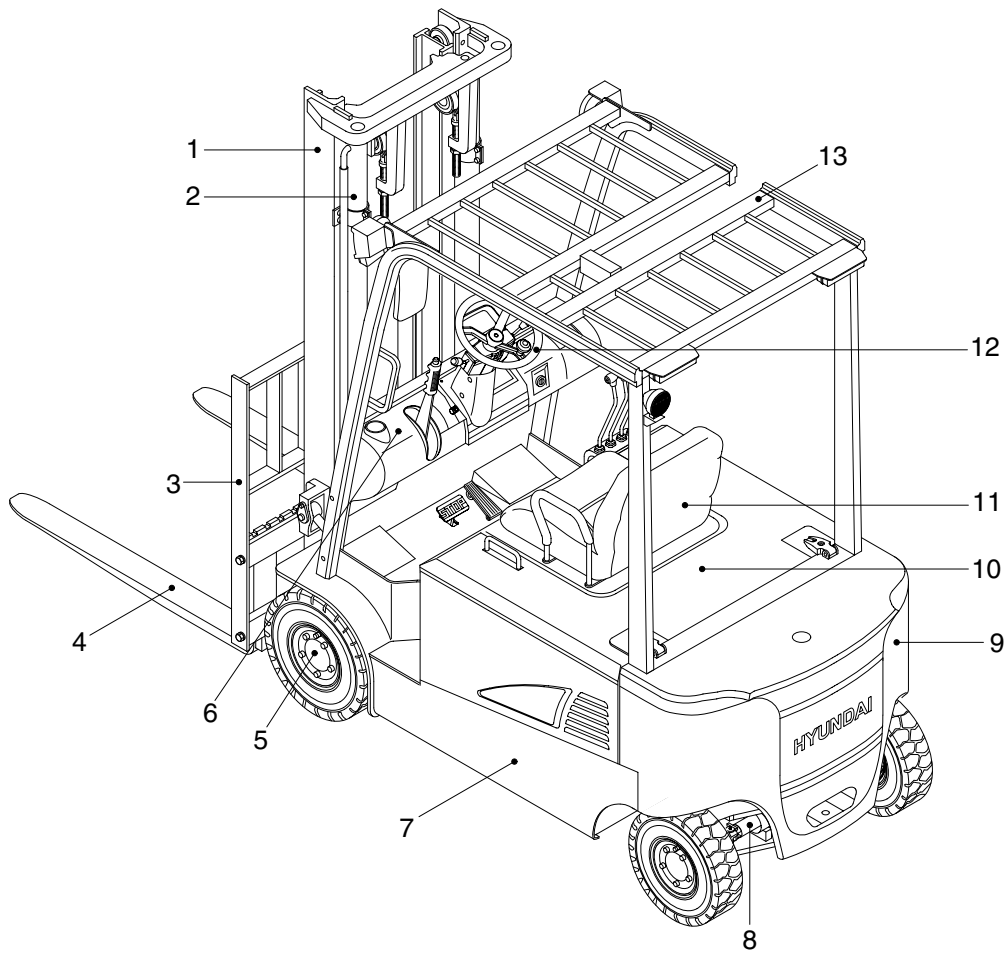

22BHA70M113

- | | | |
|-------------------------|------------------|-------------------|
| 1 Mast | 6 Dash board | 11 Seat |
| 2 Lift cylinder | 7 Frame | 12 Steering wheel |
| 3 Carriage and backrest | 8 Steering axle | 13 Overhead guard |
| 4 Forks | 9 Counterweight | |
| 5 Drive unit | 10 Battery cover | |

10. VISUAL INSPECTION

First, perform a visual inspection of the lift truck and its components.

- Walk around the truck and take note of any obvious damage and maintenance problems. Check for loose fasteners and fittings.
- Check to be sure all capacity, safety, and warning plates or decals are attached and legible.
- ※ **NAMEPLATES AND DECALS: Do not operate a lift truck with damaged or lost decals and nameplates. Replace them immediately. They contain important information.**
- Inspect the truck for any sign of external leakage: drive axle fluid etc.
- Check for hydraulic oil leaks and loose fittings.

▲ HYDRAULIC FLUID PRESSURE: Do not use your hands to check for hydraulic leakage. Fluid under pressure can penetrate your skin and cause serious injury.

- Be sure that the driver's overhead guard, load backrest extension and safety devices are in place, undamaged and attached securely.

Then check all of the critical components that handle or carry the load.

1) OVERHEAD GUARD

Check the overhead guard for damage. Be sure that it is properly positioned and all mounting fasteners are in place and tight.

2) LOAD BACKREST

Check the load backrest for damage. Inspect the welds on the carriage and load backrest for cracks.

Be sure that the mounting fasteners are all in place and tight.

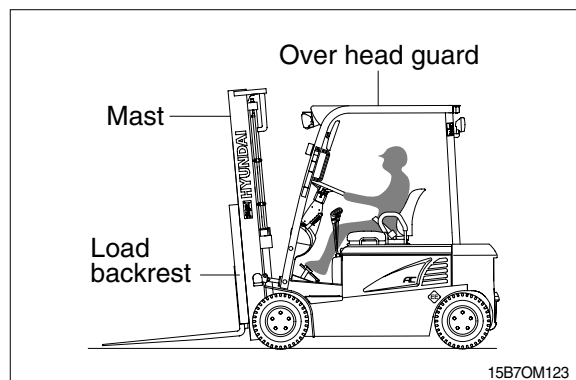

3) MAST ASSEMBLY

Inspect the mast assembly : Rails, carriage rollers, lift chains, lift cylinders and tilt cylinders. Look for obvious wear and maintenance problems and damaged or missing parts. Check for any loose parts or fittings. Check for leaks, any damaged or loose rollers and rail wear(metal flaking). Inspect all lift line hydraulic connections for leaks.

4) LIFT CHAIN

Carefully check the lift chains for wear, rust, corrosion, cracked or broken links, stretching, etc.. Check that the lift and carriage chains are adjusted to have equal tension. Check that the lift chain anchor fasteners and locking means are in place and tight.

△ **Masts and lift chains require special attention to maintain them in safe operating condition.**

- **Mast can drop suddenly. Look at the mast, but keep hands out.**
- **Lift chain repairs and adjustments should be made by trained service personnel.**

5) Remove the battery stopper.

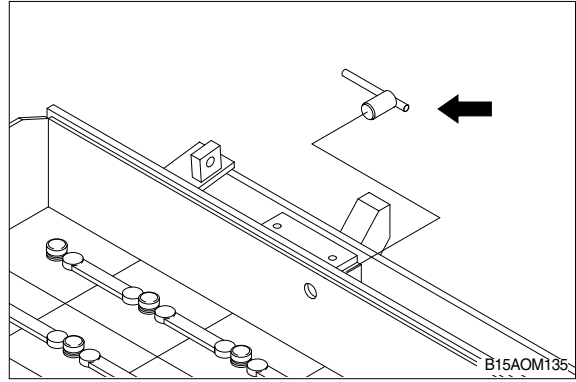

6) Put down the battery with fork lift or chain block by hang up hook at 4 links which located in right and left of the battery.

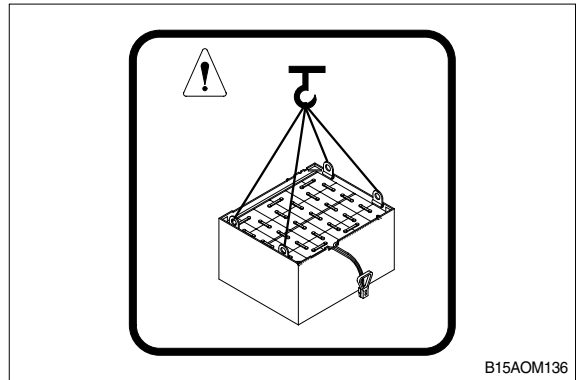

6) 35/40/45/50B-7

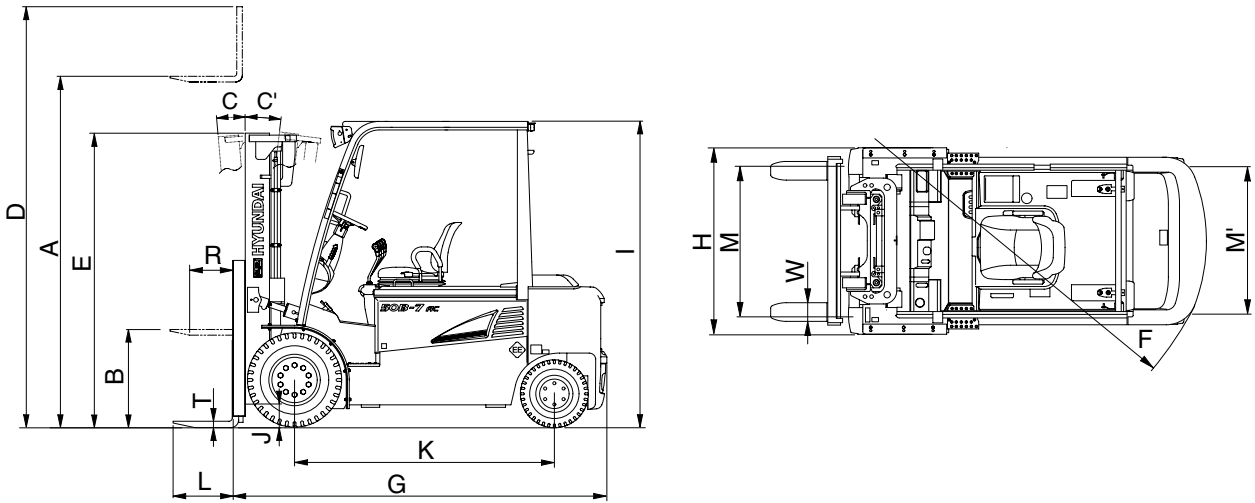

35B7SP01

Model		Unit	35B-7	40B-7	45B-7	50B-7	
Capacity		kg	3500	4000	4500	4990	
Load center		R mm	500	←	←	←	
Weight		kg	6415	6655	7020	7520	
Fork	Lifting height	A mm	3020	←	←	2920	
	Free lift	B mm	120	←	←	←	
	Lifting speed[Unload/Load]		mm/sec	500/380	←	500/330	450/320
	Lowering speed[Unload/Load]		mm/sec	520/550	←	←	430/500
	L × W × T		L,W,T mm	1070×122×50	←	1070×150×50	←
Mast	Tilt angle forward/backward		C/C' degree	6/10	←	←	←
	Max height		D mm	4224	←	←	4146
	Min height		E mm	2225	←	←	2230
Body	Travel speed[Unload/Load]		km/h	18/18	←	←	←
	Gradeability[Unload/Load]		%	26/30	26/28	24/26	23/24
	Min turning radius[Outside]		F mm	2390	2575	2615	2665
ETC	Max hydraulic pressure		kgf/cm ²	210	←	←	←
	Hydraulic oil tank		l	44.9	←	←	←
Overall length		G mm	2777	2922	2970	3030	
Overall width		H mm	1370	←	←	1424	
Overhead guard height		I mm	2225	2315	←	2320	
Ground clearance(Mast)		J mm	160	←	←	165	
Wheel base		K mm	1855	2000	←	←	
Wheel tread front/Rear		M mm	1141/1090	←	←	1114/1090	

CLICK HERE TO **DOWNLOAD** THE COMPLETE MANUAL

- Thank you very much for reading the preview of the manual.
- You can download the complete manual from: www.heydownloads.com by clicking the link below



- Please note: If there is no response to CLICKING the link, please download this PDF first and then click on it.

CLICK HERE TO **DOWNLOAD** THE COMPLETE MANUAL