



A TEREX BRAND

Operator's Manual

Serial number range

GTH 4016 SR

From s/n: 17857
to s/n: 20126

GTH 4018 SR

From s/n: 17888
to s/n: 20172

With Maintenance
Information

First Edition
First Printing
Part No. 57.0009.0499

CLICK HERE TO **DOWNLOAD** THE COMPLETE MANUAL







- Thank you very much for reading the preview of the manual.
- You can download the complete manual from: www.heydownloads.com by clicking the link below

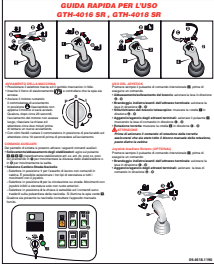

- Please note: If there is no response to CLICKING the link, please download this PDF first and then click on it.

CLICK HERE TO **DOWNLOAD** THE COMPLETE MANUAL

Labels And Plates Applied On The Machine

Ref.	Decal	Code	Description	Qt.
9		09.4618.1050	Label - Stabilizer Max Pres.	4
10		09.4618.0776	Label - Upper Door Internal Unlock System	1
11		09.4618.1191	Quick guide and Control lever decal	1
12		09.4618.0921	Label - Use limits close to electric power lines	1
13		09.4618.0933	Crush Hazard	8
14		09.4618.0922	Crush Hazard	7
15 16		09.4618.0243 09.4618.0241	Cosmetic - GENIE Logo in WHITE	1 1

Safety precautions

- The machine shall be parked on a ground adequate to the maximum admissible payload. If the subsoil collapses, the machine could tip over. To avoid any risk of overturning, the following precautions should be taken:

1. Ask your employer (site manager or manager assistant) if there may be buried pipes, pits, old tanks, cellar floor, dung yards, etc. under the ground onto which the outriggers shall be lowered.
2. A rough estimate of the ground consistency can be done using the tables and picture in this page.
3. The resistance of the subsoil is in relation to the ground type and geomorphological characteristics.

Table 1 indicates the superficial pressure which can be admitted under the outriggers of the machine.

Type of ground, geomorphological features		Admissible superficial pressure	
		kg/cm ²	N/mm ²
loose, non-compact soil		generally speaking, not solid; special precautions needed	
loamy, peaty, pasty soil			
rippable, soft ground			
non-cohesive, well compact soil, sand, gravel		2.0	0.2
rippable soil	solid	1.0	0.1
	semi-solid	2.0	0.2
	hard	4.0	0.4
Rocks, concrete, heavy traffic paved roads		above 10.0	above 1.0

Table 1



Make sure the machine (wheels and stabilisers) rests on a firm ground to prevent hazardous unstable conditions.

If the ground is not firm enough, position some supporting planks under the stabilisers or the wheels. These plates must grant a specific pressure of 1.2 to 1.5 kg/cm² (800x800mm plates are sufficient).

- Look for the best route to the job site.
- When the machine is running, nobody can enter its working range.
- While working, keep the working area in order. Never leave objects scattered: they could hinder the machine movements and represent a danger for personnel.
- In presence of trenches, lower the outriggers at a safe distance from the trench edge.

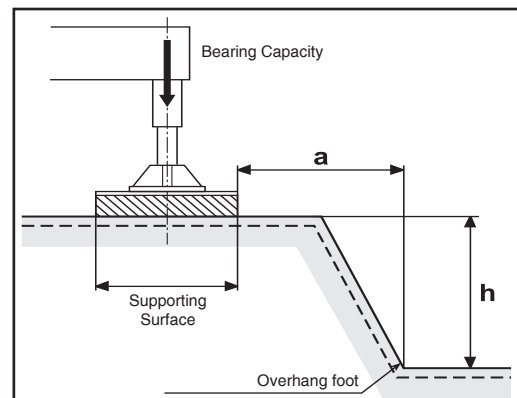

The distance (a) from the foot of the overhang shall be adequate to height (h) of the same overhang.

If the ground fulfils the required conditions:

$$a : h = 1 : 1$$

(values with a grey background in table 1)

In the case of doubts:

$$a : h = 2 : 1$$

Controls and Instruments

■ Brakes

14 _ Service Brake Pedal

Gradually step on the brake pedal to decelerate and stop the machine. The pedal operates on the front axle.

Fully depressing the brake pedal causes a reset of the displacement of the power drive pump and makes the braking action more powerful.

12 _ Parking Brake Lever

To engage the parking brake, pull the lever upward while holding the locking button pressed down. Release the button when reaching the required braking tension. It operates on the axle shafts of the rear axle and, when engaged, it cuts both forward and reverse gear off.



Never use the parking brake to slow down the machine, unless in an emergency. It may reduce the brake efficiency.

■ Accelerator Control

13 _ Throttle Pedal

Its pressure controls the engine rpm and the machine speed. It is fitted with an adjustable stop in the lower part.

17 _ Manual Accelerator

By pulling the lever up, the engine rpm increases gradually. To reduce the rpm, set the lever down.



The manual gas control can only be used with man-platform, winch, mixing bucket, hook and maintenance jib.

■ Safety and Emergency Devices

31 _ Hazard Warning Lights Switch



Fitted with on-off position, it switches on the turn signals simultaneously. When the hazard warning light is lit, the relevant switch and the turn signals light start flashing.

8 _ Emergency Stop Pushbutton



By pressing this button, the engine of the machine is shut down. Before restarting the machine, it is necessary to reset the pushbutton by rotating it clockwise.

27 _ Emergency Pump Switch (OPTIONAL)

Two position switch:



0 OFF

1 Hold pressed down to turn on the electric pump and operate the controls



Check the operation of the emergency pump every week as it could get damaged if it is not used.

6 _ Load Limiter Disable Selector

The load limiter can be deactivated operating the key-selector placed under the protection cover.



WORKING WITH THE LOAD LIMITING SYSTEM CUT OUT CAN RESULT IN A MACHINE OVERTURNING AND IN SERIOUS INJURY.



The load limiting system disconnect key is active only in the Jobsite mode. In the Platform mode, the limiting system cannot be deactivated.

Controls And Instruments

■ Quick-Coupling The Attachments



Before operating the boom, make sure that nobody is within the working range of the machine.

To lock the attachments:

- Set the control lever to central position and press switch 4.
- Press button 3 to select the attachment locking function and hold it pressed until the end of the motion.
- Smoothly shift the lever to position C to lock the attachment; shift the lever to position D to unlock the attachment.

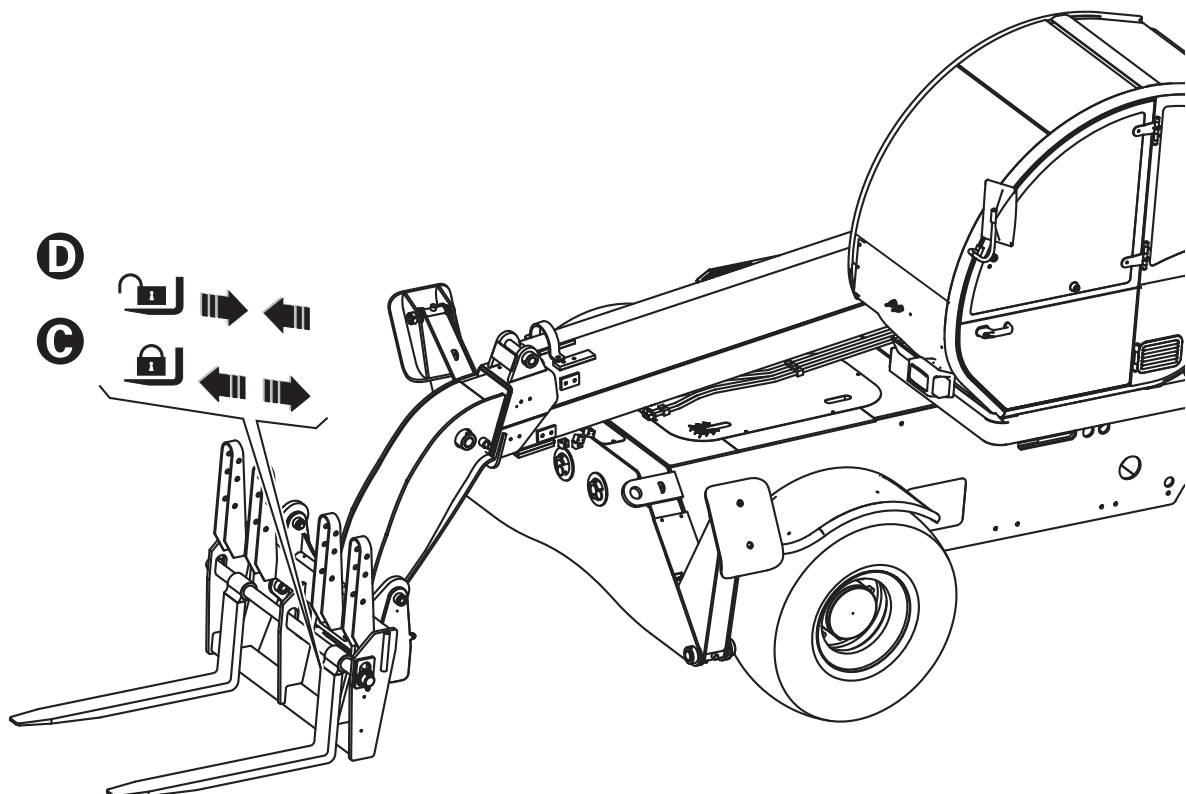
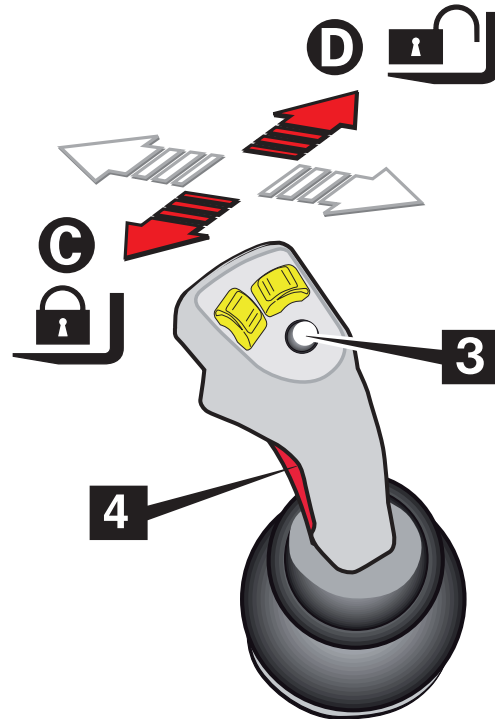

Inspections

■ WORKPLACE INSPECTION

The workplace inspection helps the operator determine if the workplace is suitable for safe machine operation. It should be performed by the operator prior to moving the machine to the workplace.

Make sure:

- You learn and practice the principles of safe machine operation contained in this operator's manual.
 - 1 Avoid hazardous situations.
 - 2 Always perform a pre-operation inspection.
 - 3 Always perform function tests prior to use.
 - 4 Inspect the workplace.
 - 5 Only use the machine as it was intended.
-

It is the operator's responsibility to read and remember the workplace hazards, then watch for and avoid them while moving, setting up and operating the machine

Be aware of and avoid the following hazardous situations:

- drop-offs or holes
- bumps, floor obstructions or debris
- sloped surfaces
- unstable or slippery surfaces
- overhead obstructions and high voltage conductors
- hazardous locations
- inadequate surface support to withstand all load forces imposed by the machine
- wind and weather conditions
- the presence of unauthorized personnel
- other possible unsafe conditions

Operating Instructions

■ 9 _ LOAD MOMENT INDICATOR

At the back of the driving place there is a unit which lets you manage the moment limiting system of the machine.

The collected data, processed in relation to the attachment used, are continuously compared with the data stored in the program memory. The processing of these data results in three different situations which are displayed by the warning lights located at the left side of the display.

1 **Green LED ON**

Stability condition. The raised load does not exceed 90% of maximum allowed load of the chart in that defined working position.

2 **Yellow LED ON**

Pre-alarm condition. The raised load exceeds 90% of maximum allowed load, but it is still inferior to it: the boom movements are slow down and the acoustic alarm emits short bips.

3 **Red LED ON**

Alarm condition. The raised load exceeds the maximum allowed load, the acoustic alarm emits long bips and the machine motions are stopped, but for those allowing to return the load within safety limits.

The display of the limiting device is divided into three areas:

LED's area: Three LED's warn of the variation of the working condition:

- 1 **green LED** - machine stable
- 2 **yellow LED** - machine in pre-alarm
- 3 **red LED** - machine in alarm

Control Keys

ESC To go back to the previous screen page

ENTER To confirm and open the screen page linked

ARROWS To scroll the lines up or down

PLUS (+) Additional selection button

MINUS (-) Additional selection button

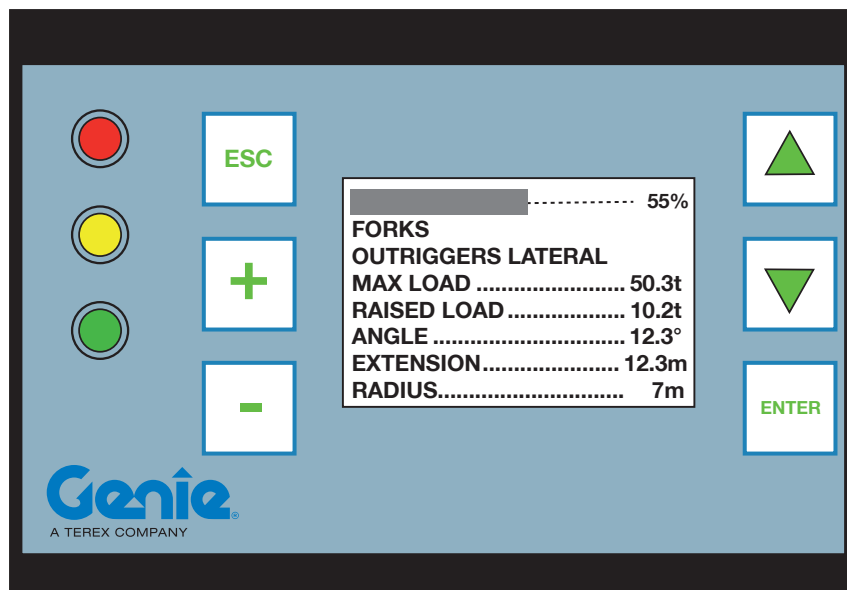

■ **LIFTING THE MACHINE**

When the machine shall be lifted, use only means having a suitable capacity. The characteristic data are detailed in the relevant chapter of this manual and on the identification plate.

For the machine lifting, anchor the chains to the special lugs on the machine (marked with the decal below).

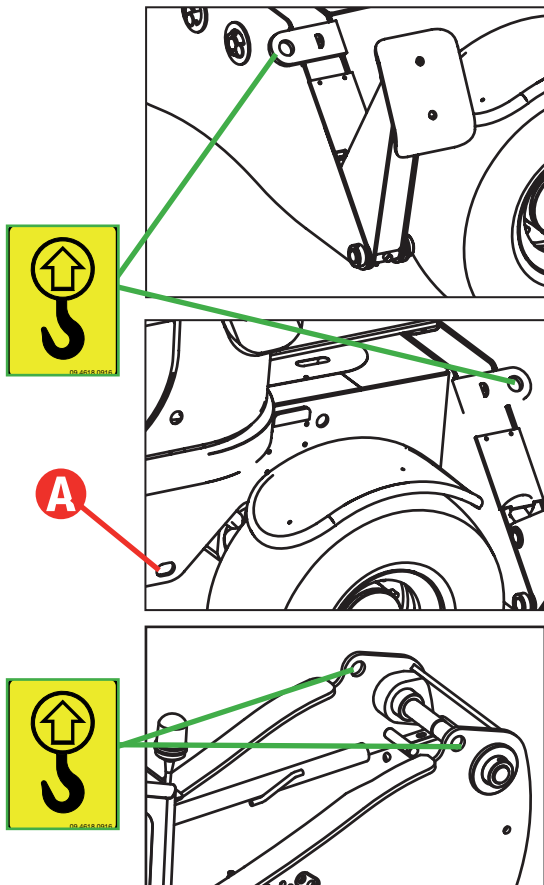

Transporting The Machine

■ **TRANSPORTING THE MACHINE ON OTHER VEHICLES**

To transport the machine on another vehicle, follow the steps below:

- Ensure ramps are correctly positioned.
- Retract the boom to transfer position.
- Carefully drive the machine onto the transporting vehicle.
- Put the parking brake and rest the attachment flat on the vehicle platform.
- Ensure the overall dimensions do not exceed the allowed limits.
- Shut the engine down and close the driving cab of the machine.
- Secure the machine to the vehicle platform by wheel-chocks.
- Anchor the machine to the transporter's platform by fixing the chains to the special eyebolts **A** on the chassis.

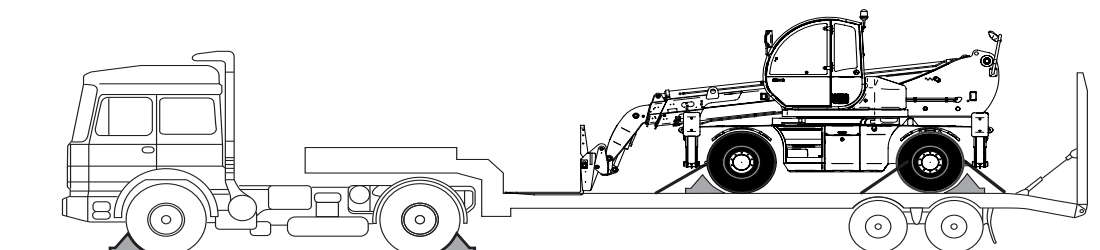
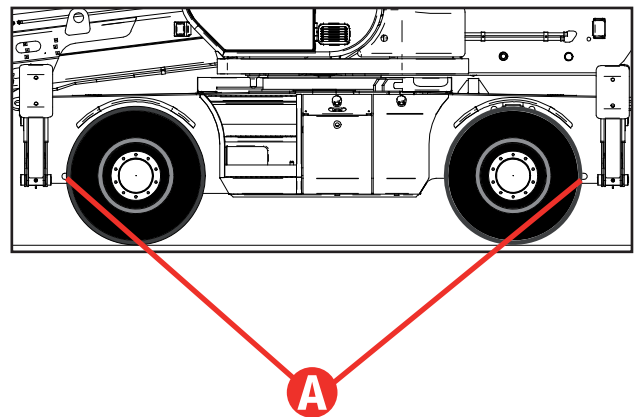

CLICK HERE TO **DOWNLOAD** THE COMPLETE MANUAL

- Thank you very much for reading the preview of the manual.
- You can download the complete manual from: www.heydownloads.com by clicking the link below



- Please note: If there is no response to CLICKING the link, please download this PDF first and then click on it.

CLICK HERE TO **DOWNLOAD** THE COMPLETE MANUAL

Maintenance

■ ACCESS TO THE ENGINE COMPARTMENT

For any operation within the engine compartment, open the protection bonnet.

The bonnet is equipped with pneumatic shock absorbers which unburdens and hold the bonnet in raised position. To open the bonnet:

- Shut the engine down and put the parking brake.
- Turn the key to unlock and open the bonnet front part (see fig. **A**).
- Open the special joints placed to both side of the bonnet upper part (see fig. **B**).

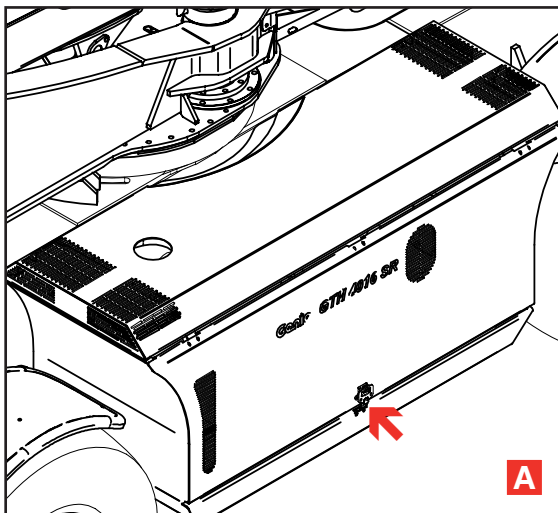

Take all precautions when approaching the engine compartment. Some parts of the engine may be very hot. Always use protective gloves.

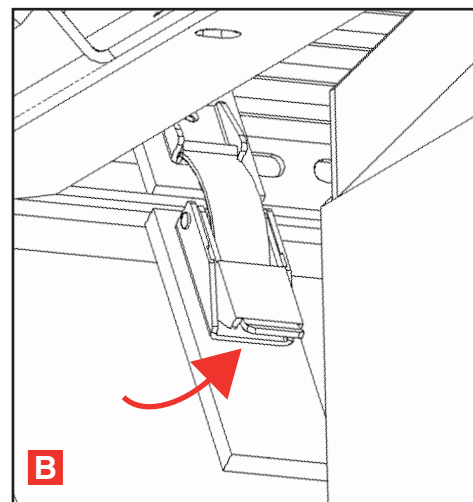

Maintenance

TYRES AND WHEELS



Over-inflated tyres can burst.



Overheated can burst. Do not weld the wheel rims. For any repair work, call in a qualified technician.

On new machines, and when a wheel has been disassembled or replaced, check the nut torque of the wheels every 2 hours until they stay correct.

Torque: 400 N/m.

Always use tyres having the dimensions indicated in the vehicle registration card.



SERVICE INTERVAL

Running-in _____ Within the first **10** hours
 Ordinary _____ Every **250** hours

OKAY

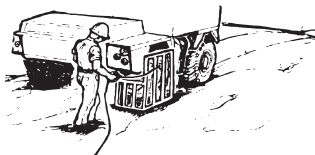

WRONG

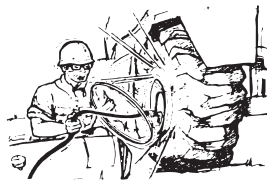

For the tyre inflation or substitution, please refer to the table below:

	GTH-4016 SR GTH-4018 SR
Dimensions (front and rear)	18 - 19.5
P.R. (or load index)	16 pr
Rim	14x19.5
Wheel disc	10 holes DIN 70361
Pressure bar/Psi	5,5/80

BRAKES

For any intervention on the braking system (adjustment and/or substitution of the brake discs) address to the TEREXLIFT Technical Assistance Service or the nearest TEREXLIFT authorised workshop.

Maintenance

■ CHECKING THE STATE OF THE STRUCTURE

Five years or 6000 hours after the first placing into operation of the machine (whichever occurs first), check the state of the structure paying an extreme attention to the welded supporting joints and the pins of both boom and platform (if present).



After the first 5 years, repeat this check every 2 years.

Optional Attachments

INTRODUCTION

This section provides information on the optional interchangeable attachments, especially manufactured for the handlers.

Use only genuine attachments, described in this section, after having read their features thoroughly and understood their use.

To install and remove the attachments, follow the instructions supplied in the “**Operating Instructions**” section.



When replacing interchangeable attachments, keep any person clear of the working area.



Mounting optional attachments, and especially the extension jib, can change the centre of gravity of the machine. Before handling a load, check its weight and compare it with the values on the load charts. The weight of the used attachment must always be deducted from the rated payload.

Optional Attachments

■ BASKET FOR BRICKS

(code 59.0400.7000)

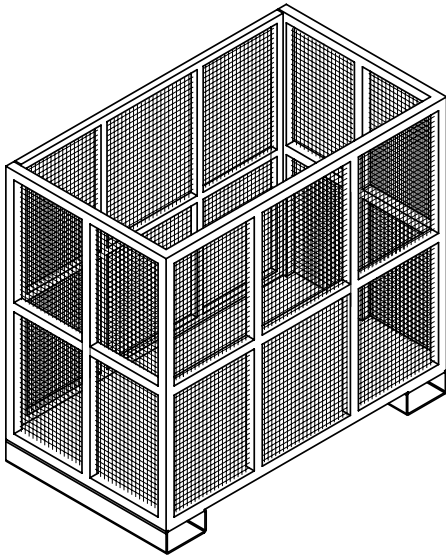

Application

Attachment used to handle construction manufactured products, to be fixed to the standard forks of the handler and locked in position with the chains with shackles supplied.

Safety

Strictly obey the general safety precautions given in section “**Safety**”.

Operation

Fork the basket from the rear side being careful that the door that can be opened is at the front. Secure the basket to the forks using the chains supplied.

Maintenance

Visually check the attachment for damage before using it.

TECHNICAL DATA	
Width	800 mm
Length	1100mm
Height	1150 mm

Load Charts

LOAD CHART WITH MAN-PLATFORM GTH-4018 SR

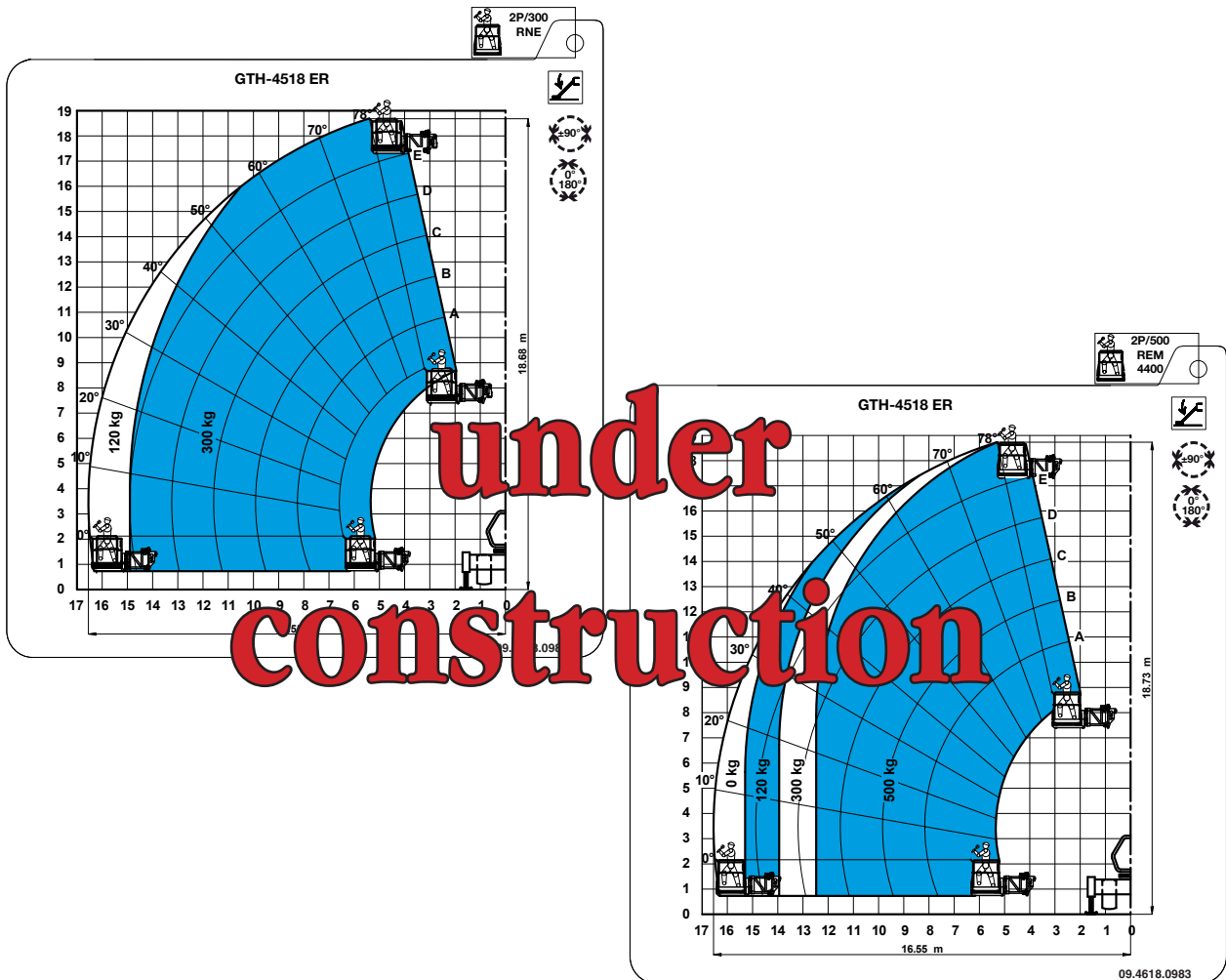

Diagrams and Schemes

■ GTH-4016 SR WIRING DIAGRAM 3/14

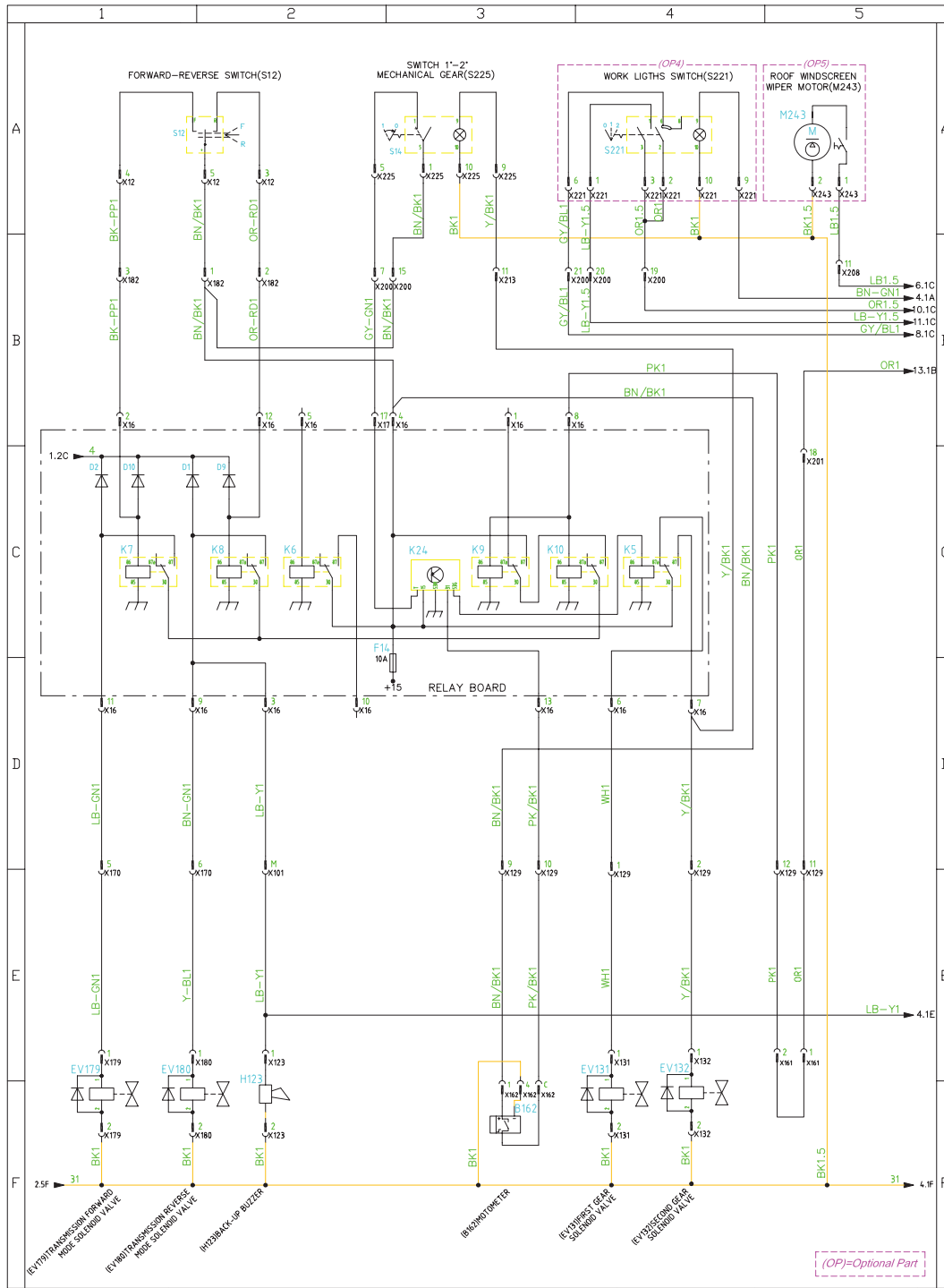

Diagrams and Schemes

■ GTH-4016 SR WIRING DIAGRAM 13/14

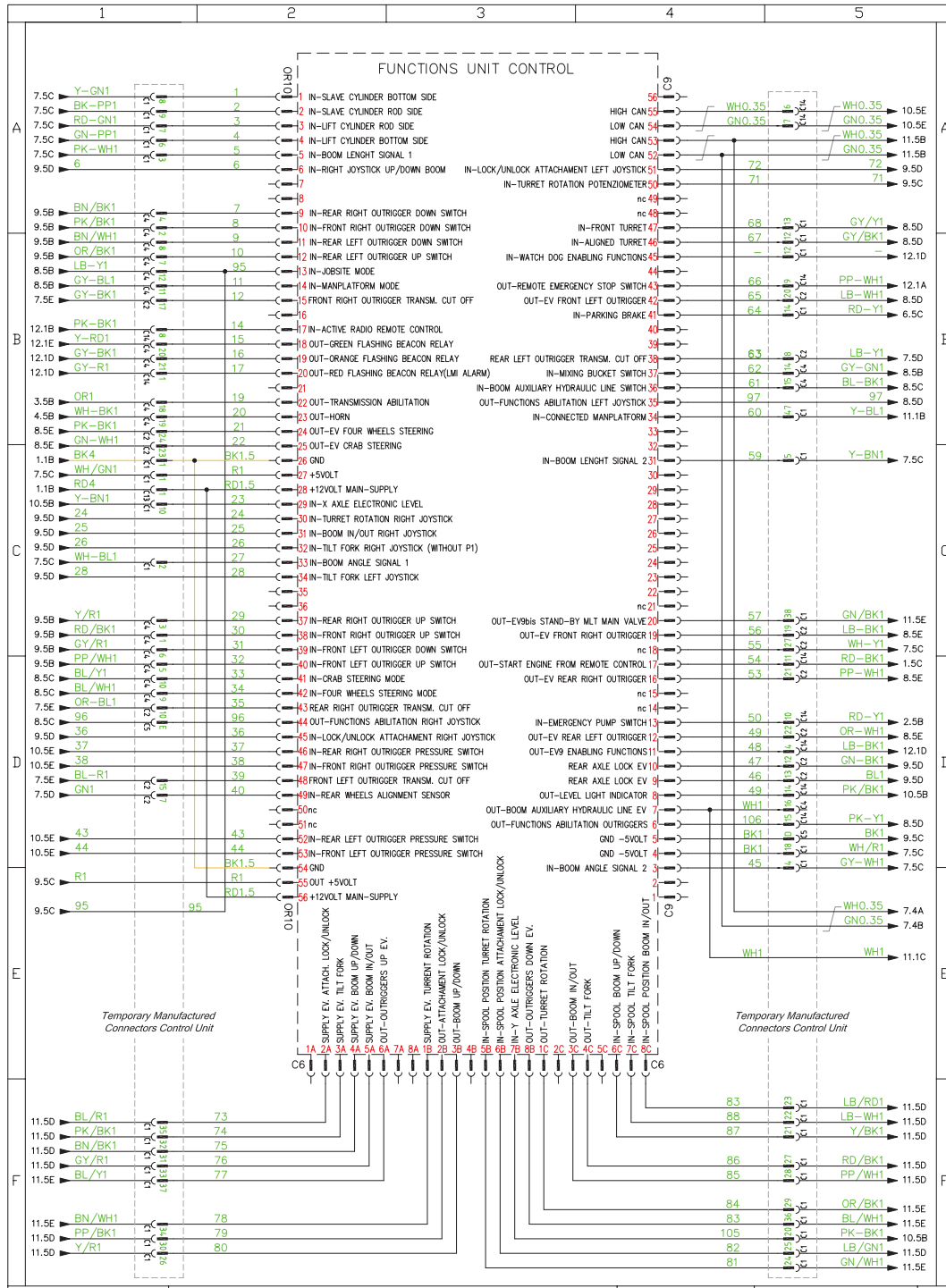

Diagrams and Schemes

■ GTH-4018 SR WIRING DIAGRAM 9/14

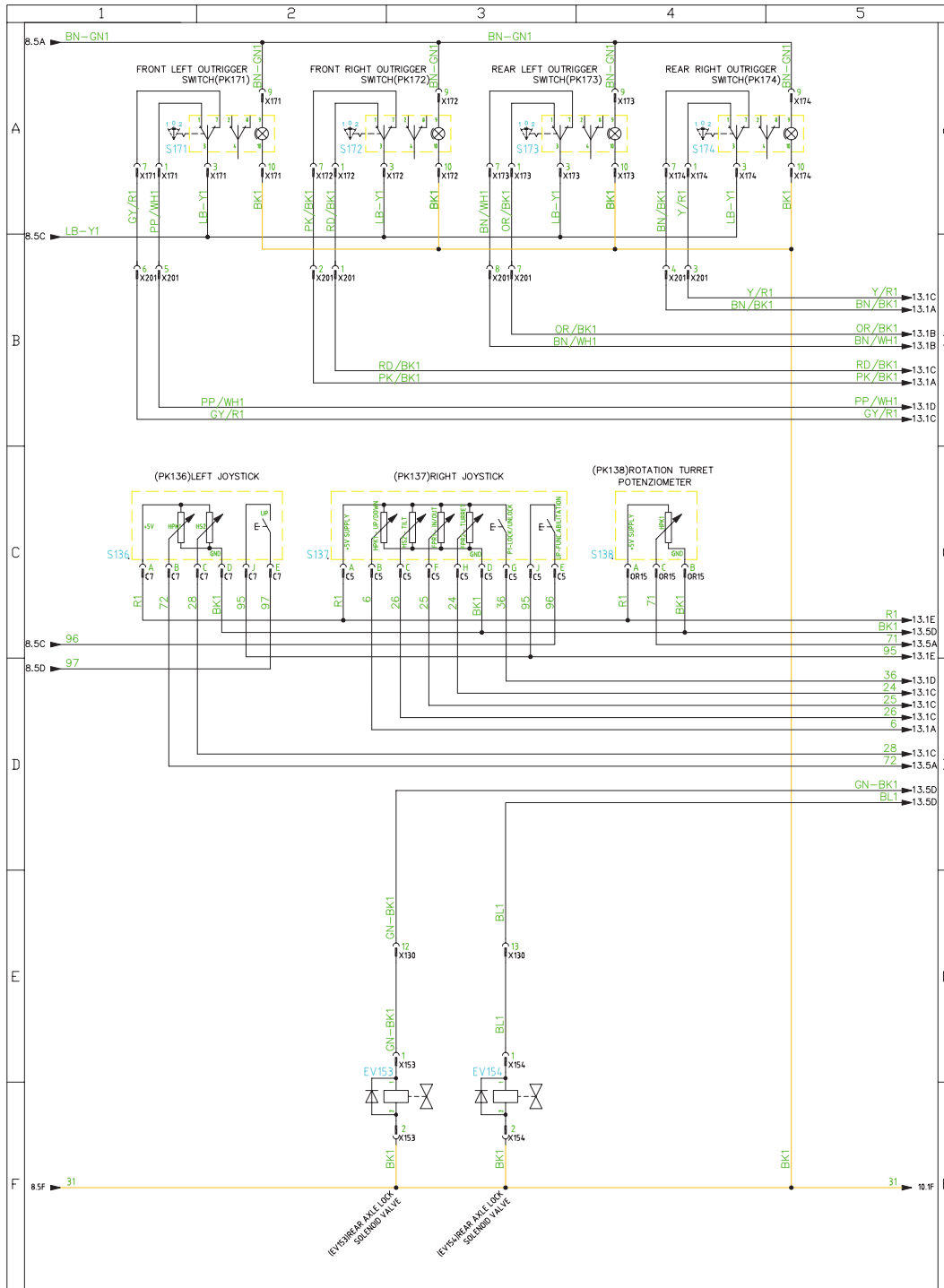

CLICK HERE TO **DOWNLOAD** THE COMPLETE MANUAL

- Thank you very much for reading the preview of the manual.
- You can download the complete manual from: www.heydownloads.com by clicking the link below



- Please note: If there is no response to CLICKING the link, please download this PDF first and then click on it.

CLICK HERE TO **DOWNLOAD** THE COMPLETE MANUAL