

SLICER

Disc mower

3060 FP

FCO 10001

3060 FPKC

FCQ 10001

3060 FPRC

FCR 10001

3060 FPSL

FCP 10001



CLICK HERE TO **DOWNLOAD** THE COMPLETE MANUAL

- Thank you very much for reading the preview of the manual.
- You can download the complete manual from: www.heydownloads.com by clicking the link below



- Please note: If there is no response to CLICKING the link, please download this PDF first and then click on it.

CLICK HERE TO **DOWNLOAD** THE COMPLETE MANUAL



Abb. 5 Warning notices on the machine, rear view

Number	Warning	Explanation
1		Before using the machine for the first time, read the Operator's Manual and safety instructions. Always observe the Operator's Manual and safety instructions while using the equipment.
2		Do not exceed the maximum permitted drive speed of 1000 rpm.
3		Secure the coupled machine's interlocking system using a hairpin .
4		Move the machine's safety equipment to the safety position before switching on the PTO.
5		Keep out of the hazard area . Please take particular care when working near roads and buildings.
6		Only approach when the machine parts have come to a complete stop .

4.3 Axle loads, gross weight and minimum ballast required

The front axle of the tractor must always be loaded with at least 20% of the empty weight.

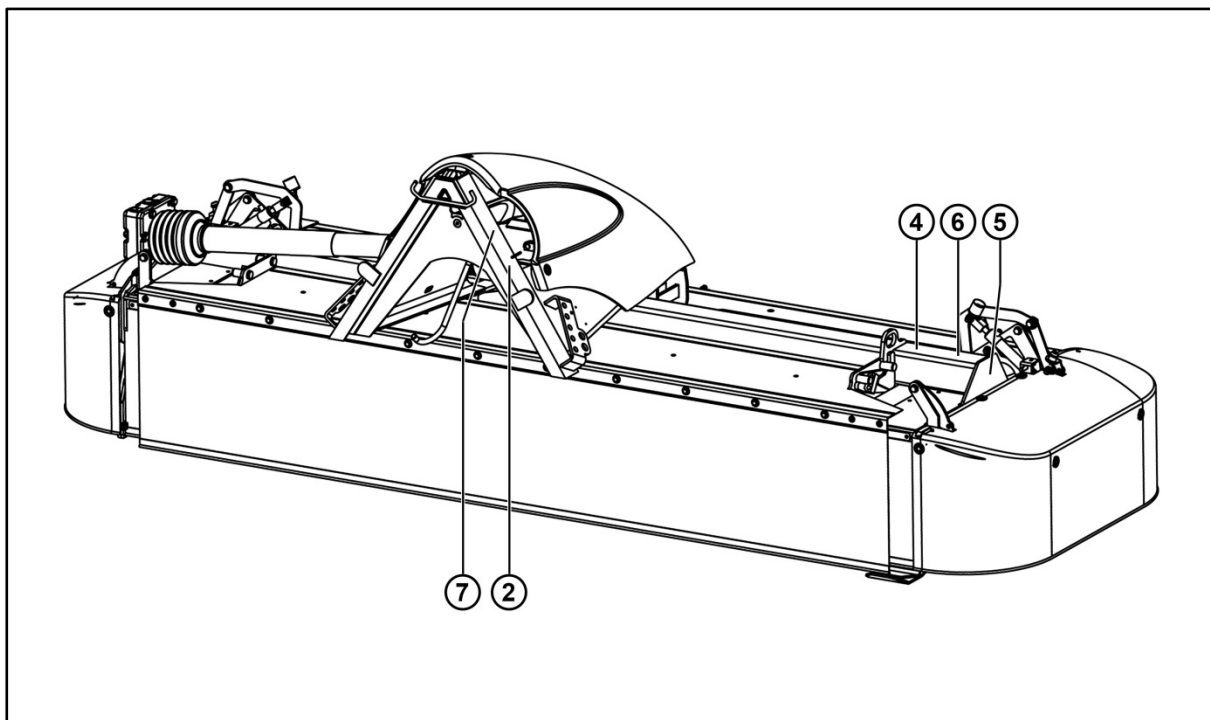
To ensure compliance with the permissible axle loads and gross weight as well as with the steerability of the tractor-machine combination, make the following calculations.



Abb. 14 Data required for the calculation

	Unit	Explanation	
T_E	[kg]	Empty weight of tractor	1)
T_F	[kg]	Front axle load of empty tractor	1)
T_R	[kg]	Rear axle load of empty tractor	1)
I_R	[kg]	Gross weight of rear-mounted attachment/rear-mounted ballast of towed machine: $I_R =$ bearing load	2)
I_F	[kg]	Total weight of front-mounted attachment/front ballast	4)
a	[m]	Distance between center of gravity of front-mounted attachment/front ballast and center of front axle	4), 3)
b	[m]	Tractor wheel base	1), 3)
c	[m]	Distance between center of rear axle and center of lower link balls	1), 3)
d	[m]	Distance between center of lower link balls and center of gravity of rear-mounted attachment/rear-mounted ballast of towed machine: $d = 0$	3)

- 1) See Operator's Manual for the tractor
- 2) See Operator's Manual for rear-mounted attachment
- 3) Measure
- 4) See Section 4.1 Machine data

Calculation of minimum ballast required on the front axle:

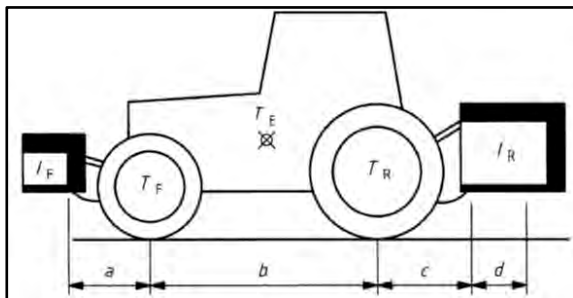
$$I_{Fmin} = \frac{[I_R \times (c + d)] - (T_F \times b) + (0,2 \times T_E \times b)}{a + b}$$

Calculation of actual front axle load:

$$T_{Ftat} = \frac{[I_F \times (a + b)] + (T_F \times b) - [I_R \times (c + d)]}{a + b}$$

Calculation of actual gross weight:

$$I_{tat} = I_F + T_E + I_R$$

Calculation of actual rear axle load:

$$T_{Rtat} = I_{tat} - T_{Ftat}$$

Special equipment

7 Special equipment

Special equipment can be ordered from your dealer.

Install the special equipment according to the assembly instructions supplied.

7.1 Anti-wear skid

One anti-wear skid per mower disc is recommended. At least two anti-wear skids per cutter bar are required.

7.1.1 Adjusting the cutting height when using an anti-wear skid



Abb. 38 Adjusting cutting height

- Release the anti-wear skid (1).
- Arrange the spacers (2) between the anti-wear skid and the skid shoe according to the cutting height required.

Cutting height	
a = 55 mm	Low
b = 68 mm	Medium
c = 80 mm	High

- Tighten the anti-wear skid.

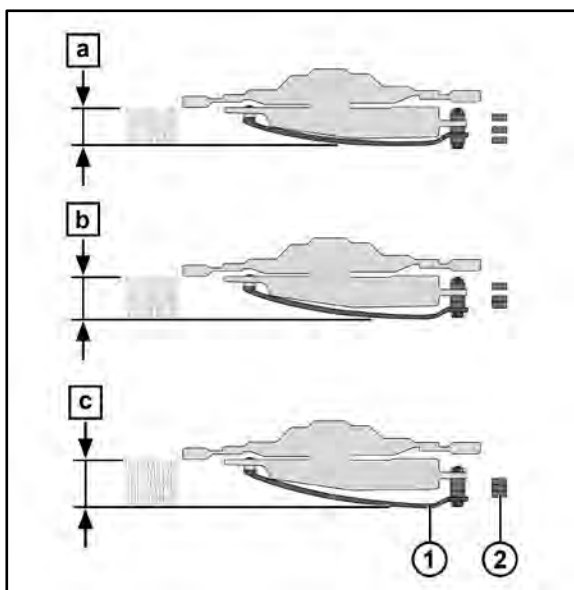
7.2 Swath disc

Machines without conditioners can be retrofitted with swath discs.

7.2.1 Adjusting the swath disc



Abb. 39 Fitted swath disc

- Undo the bolts (1).
- Turn the swath disc to the desired position.
- Lock the swath disc using the bolts.



Abb. 40 Distance from swath disc to cutter blade

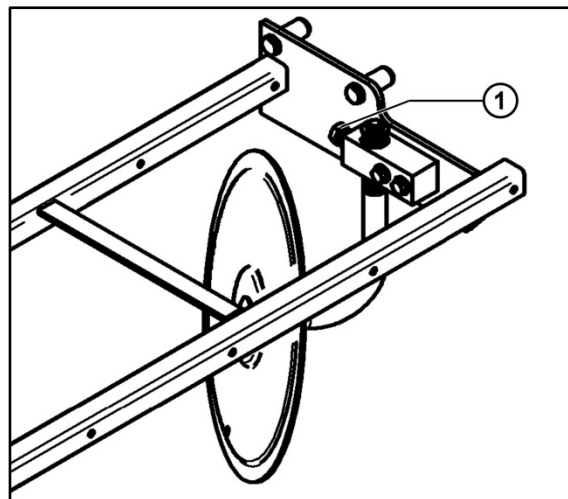

Abb. 41 Distance from swath disc to cutter blade and feeder drum

- Lower the protective cover and insert the stabiliser back into the strap to close the guard.

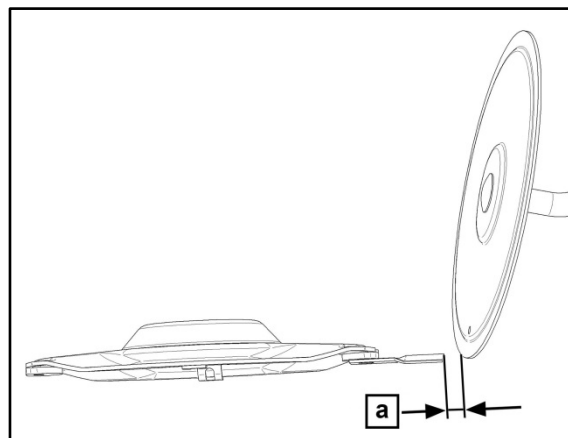

Abb. 64 Chain guard on the rake

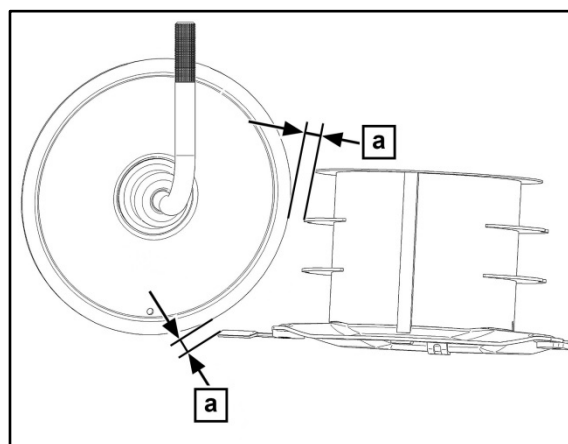
- Undo the bolts (1).
- Remove the chain guard (2).
- To reattach the chain guard, hang it above the chains and secure it with the bolts.

9.3 Cleaning

ATTENTION

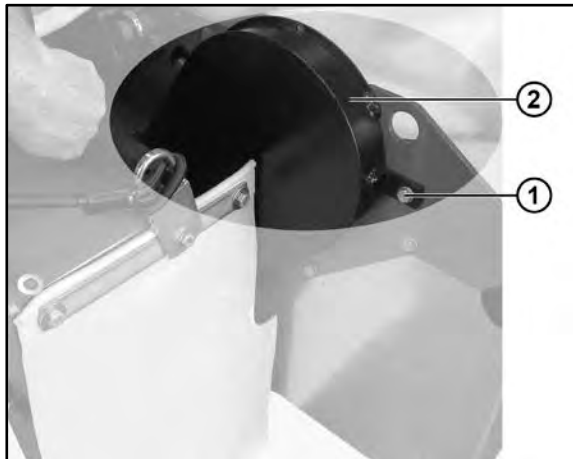
Risk of material damage as a result of using a high-pressure cleaner

Cleaning with a high-pressure cleaner can cause damage to the paintwork. Rust and bearing damage may occur as a result.

- Do not use a high-pressure cleaner at all for cleaning bearings and hydraulic components.
 - Do not use too much pressure when using the high-pressure cleaner to clean the machine.
-
- Remove contamination.
 - Lubricate the machine after cleaning according to the lubrication instructions (see Section 9.11 Lubrication instructions).
 - Perform a quick trial run.

9.4 Tightening torques for nuts and bolts

- Check the nuts and bolts to make sure they are secure.
- Tighten nuts and bolts in accordance with the tightening torques.

Bolt/nut type	Nm	ft lb
M 6 - 8.8	10	7
M 8 - 8.8	25	18
M 10 - 8.8	49	36
M 10 - 10.9	69	51
M 10 - 100 *VERBUS-RIPP®	105	78
M 12 - 8.8	86	63
M 12 - 10.9	120	89
M 12 - 100 *VERBUS-RIPP®	165	122
M 14 - 8.8	135	100
M 14 - 10.9	190	140
M 16 - 8.8	210	155
M 16 - 10.9	295	218
M 16 - 100 *VERBUS-RIPP®	410	302
M 20 - 8.8	410	302

* VERBUS-RIPP® is a self-locking fastener system.

9.5 Decals

- After each use, check that all decals on the machine are present and legible.
- Replace any illegible, damaged or missing decals.

CLICK HERE TO **DOWNLOAD** THE COMPLETE MANUAL

- Thank you very much for reading the preview of the manual.
- You can download the complete manual from: www.heydownloads.com by clicking the link below



- Please note: If there is no response to CLICKING the link, please download this PDF first and then click on it.

CLICK HERE TO **DOWNLOAD** THE COMPLETE MANUAL