

# SLICER

## Disc mower

**260 FP**  
FDD 10001

**260 FPS**  
FDC 10001



CLICK HERE TO **DOWNLOAD** THE COMPLETE MANUAL

- Thank you very much for reading the preview of the manual.
- You can download the complete manual from: [www.heydownloads.com](http://www.heydownloads.com) by clicking the link below



- Please note: If there is no response to CLICKING the link, please download this PDF first and then click on it.

CLICK HERE TO **DOWNLOAD** THE COMPLETE MANUAL

The following section indicates the consequences that may occur if no measures for preventing the risk(s) are taken.

The final section outlines risk-prevention measures.

The following key words are used.

**⚠ DANGER**  
 Situation posing an immediate hazard that could lead to serious injury or death if the respective warning is ignored.

**⚠ WARNING**  
 Potentially hazardous situation leading to serious injury or death if the respective warning is ignored.

**⚠ CAUTION**  
 Potentially hazardous situation leading to minor or slight injury if the respective warning is ignored.

**ATTENTION**  
 Potentially hazardous situation leading to material damage if the warning is ignored.

## 2.4.2 Warning notices on the machine

Warning notices on the machine are decals that indicate residual risks. Residual risks are hazards or hazardous areas that cannot be sufficiently prevented or secured through technical preventive measures alone.

- ➔ Warning notices attached to the machine must be observed.
- ➔ Prior to each use, check that the decals are in good condition.
- ➔ Replace any illegible or damaged decals.
- ➔ Replace any missing decals.



Abb. 4 Warning signs on the SLICER 260 FP

### 4.3 Axle loads, gross weight and minimum ballast required

The front axle of the tractor must always be loaded with at least 20% of the empty weight.

To ensure compliance with the permissible axle loads and gross weight as well as with the steerability of the tractor-machine combination, make the following calculations.

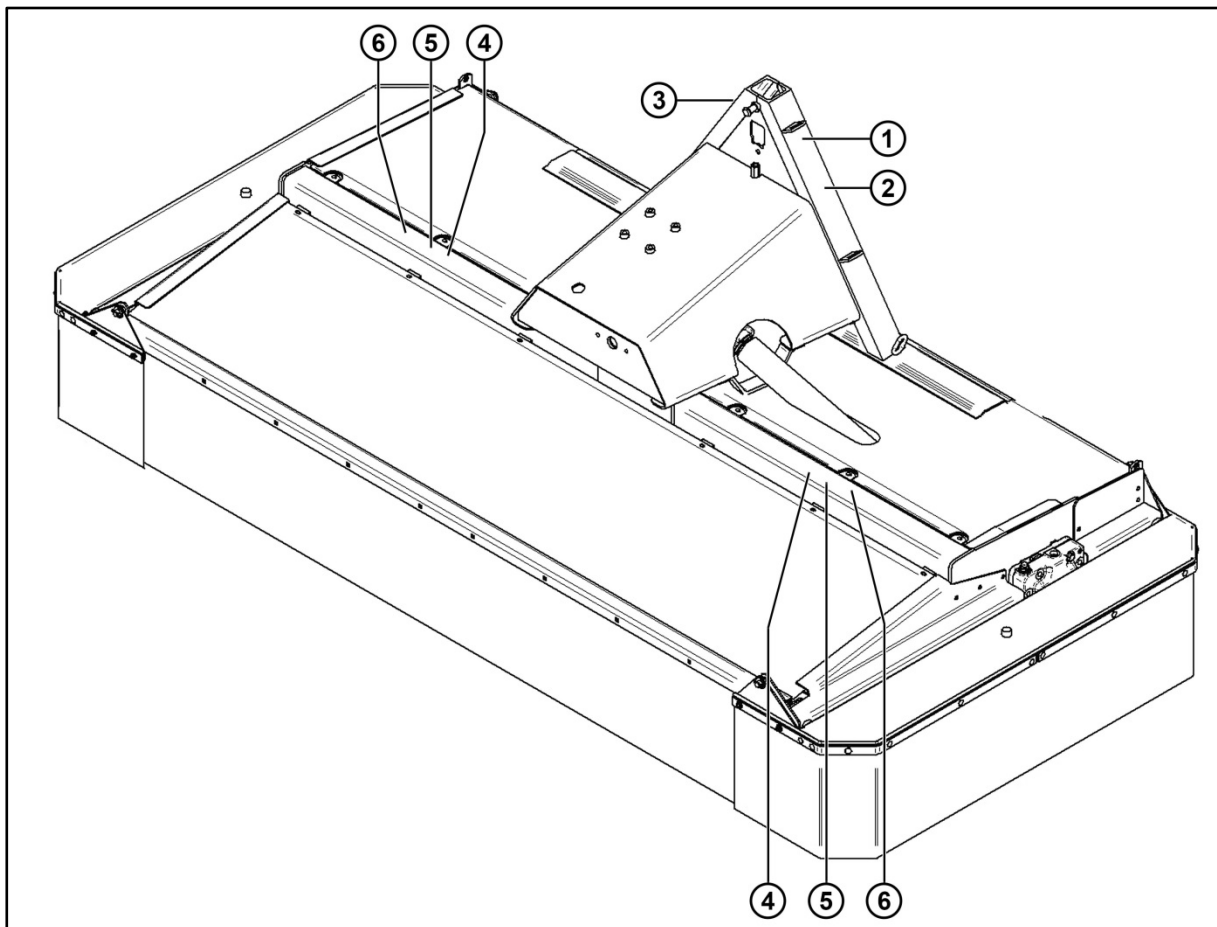

Abb. 14 Data required for the calculation

	Unit	Explanation	
$T_E$	[kg]	Empty weight of tractor	1)
$T_F$	[kg]	Front axle load of empty tractor	1)
$T_R$	[kg]	Rear axle load of empty tractor	1)
$I_R$	[kg]	Gross weight of rear-mounted attachment/rear-mounted ballast of towed machine: $I_R =$ bearing load	2)
$I_F$	[kg]	Total weight of front-mounted attachment/front ballast	4)
a	[m]	Distance between center of gravity of front-mounted attachment/front ballast and center of front axle	4), 3)
b	[m]	Tractor wheel base	1), 3)
c	[m]	Distance between center of rear axle and center of lower link balls	1), 3)
d	[m]	Distance between center of lower link balls and center of gravity of rear-mounted attachment/rear-mounted ballast of towed machine: $d = 0$	3)

- 1) See Operator's Manual for the tractor
- 2) See Operator's Manual for rear-mounted attachment
- 3) Measure
- 4) See Section 4.1 Machine data

Calculation of minimum ballast required on the front axle:

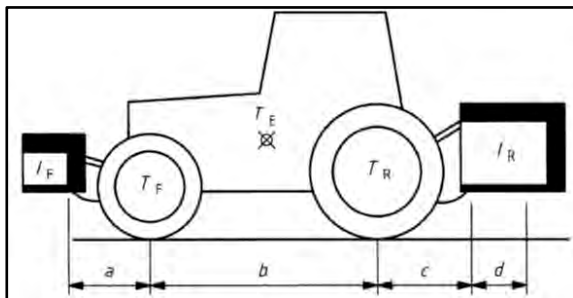
$$I_{Fmin} = \frac{[I_R \times (c + d)] - (T_F \times b) + (0,2 \times T_E \times b)}{a + b}$$

Calculation of actual front axle load:

$$T_{Ftat} = \frac{[I_F \times (a + b)] + (T_F \times b) - [I_R \times (c + d)]}{a + b}$$

Calculation of actual gross weight:

$$I_{tat} = I_F + T_E + I_R$$

Calculation of actual rear axle load:

$$T_{Rtat} = I_{tat} - T_{Ftat}$$



Abb. 30 Distance from swath disc to cutter blade and feeder drum

- ➔ Maintain a distance a of min. 5 mm and max. 10 mm between the swath disc and the adjacent cutter blades and the feeder drum.

### 7.2.2 Instructions on rectifying faults

Fault	Possible causes	Remedy
Swath too narrow/wide	Swath guiding device has been adjusted incorrectly	Correct the swath guiding device (see Section 7.2.1 Adjusting the swath guiding device).

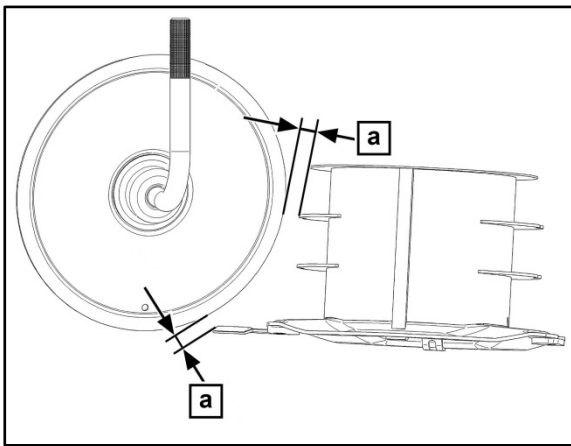
## 7.3 driveGUARD

driveGUARD is an overload protection for the cutter bar.

The retrofit kit is for one mower disc. Installation is done on the mower disc.

Fit every mower disc with driveGUARD for effective protection of the cutter bar.

### 7.3.1 Instructions on rectifying faults

Fault	Possible causes	Remedy
Irregular cutting pattern	driveGUARD has been triggered	Replace the driveGUARD element that has been triggered.
Cutter bar is making a clanking noise	Cutter blades are knocking against each other	Check for any damage to the driveGUARD element and that it has been installed correctly.

Maintenance task	Interval								
	Before each season	Before each use	After the first 2 operating hours	Every 50 operating hours	Every 500 operating hours	After each use	As required	After 6 years	Special regulations
Check the cutter blades and holders		X							
Replace cutter blades and/or holders							X		
Check the protective covers		X							
Replace the protective covers							X		
Lubricate				X <sup>3</sup>					

- 1) Refer to the Operator's Manual from the transmission shaft manufacturer.
- 2) Only during repairs
- 3) Refer to Section 9.11 for lubrication instructions.

## 9.2 Accessing the maintenance points



Abb. 50 Opening the protective cover

- Fold the protective cover (1) upwards.
- Secure the protective cover with the strap (2).
- To close the guard, release the strap and lower the protective cover.

## 9.3 Cleaning

### ATTENTION

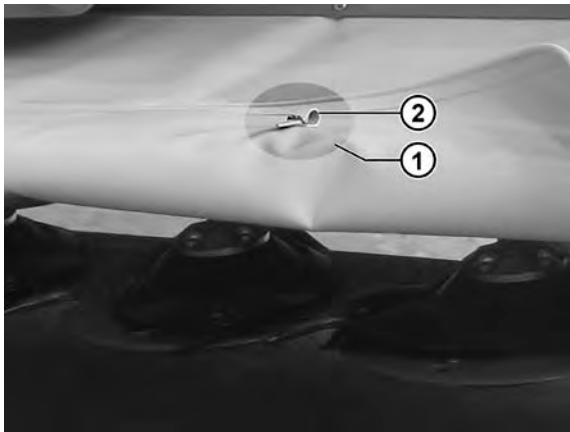
#### Risk of material damage as a result of using a high-pressure cleaner

Cleaning with a high-pressure cleaner can cause damage to the paintwork. Rust and bearing damage may occur as a result.

- Do not use a high-pressure cleaner at all for cleaning bearings and hydraulic components.
  - Do not use too much pressure when using the high-pressure cleaner to clean the machine.
- 
- Remove contamination.
  - Lubricate the machine after cleaning according to the lubrication instructions (see Section 9.11 Lubrication instructions).
  - Perform a quick trial run.
- Only on the SLICER 260 FPS:**
- If the machine has had a prolonged period of downtime outdoors, clean the piston rods of the hydraulic cylinders and lubricate them with grease. Before initial operation, remove the grease from the piston rods.

CLICK HERE TO **DOWNLOAD** THE COMPLETE MANUAL

- Thank you very much for reading the preview of the manual.
- You can download the complete manual from: [www.heydownloads.com](http://www.heydownloads.com) by clicking the link below



- Please note: If there is no response to CLICKING the link, please download this PDF first and then click on it.

CLICK HERE TO **DOWNLOAD** THE COMPLETE MANUAL