

# SK600

Kubota® D902-E4B

# Operator's Manual



CMW®

Issue 4.0  
Original Instruction

053-2962

CLICK HERE TO **DOWNLOAD** THE COMPLETE MANUAL

- Thank you very much for reading the preview of the manual.
- You can download the complete manual from: [www.heydownloads.com](http://www.heydownloads.com) by clicking the link below



- Please note: If there is no response to CLICKING the link, please download this PDF first and then click on it.

CLICK HERE TO **DOWNLOAD** THE COMPLETE MANUAL

---

**Support**

**83**

The warranty policy for this machine and procedures for obtaining warranty consideration and training

---

## Prepare Jobsite



**WARNING**

Underground utilities. Contact can cause death or serious injury. Locate and verify underground utilities before digging or drilling.

**To help avoid injury:**

- Expose lines by careful hand digging or soft excavation before operating equipment. Use appropriate equipment and procedures for exposing utility lines.
- Classify jobsite and follow precautions based on classification.
- Follow local regulations for digging near utilities.

A successful job begins before working. The first step in planning is reviewing information already available about the job and jobsite.

### Review Job Plan

Review blueprints or other plans. Check for information about existing or planned structures, elevations, or proposed work that may be taking place at the same time.

### Select Start and End Points

Select one end to use as a starting point. Consider the following when selecting a starting point:

#### Slope

Equipment should be parked on a level site. Consider how slope will affect setup and operation. Assess the risks on each slope to determine if factors affecting risks create an unsafe condition for working. See “Slope Guidelines” on page 44.

#### Space

Check that starting and ending points allow enough space for working.

#### Comfort

Consider shade, wind, fumes, and other site features.

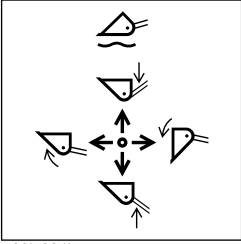
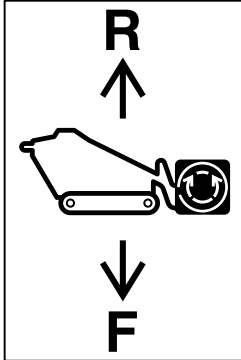

Item	Description	IMPORTANT
<p><b>5. Lift arm control</b></p>  <p>c00ic284h.eps</p>	<p>To move lift arms down, push.</p> <p>To float, push to end.</p> <p>To move lift arms up, pull.</p> <p>To curl attachment up, move left.</p> <p>To curl attachment down, move right.</p>	
<p><b>6. Attachment drive control</b></p>  <p>c00ic090a.eps</p>	<p>To move attachment in reverse, push.</p> <p>To move attachment forward, pull.</p>	<p>Use auxiliary lock control to lock auxiliary function.</p> <p>See "Auxiliary lock switch" on page 38.</p> <p>See "Hydraulic fluid bypass" on page 34 for instructions on operating attachment drive control at low flow.</p>
<p><b>7. Auxiliary lock control</b></p>	<p>To lock auxiliary function, press pedal.</p> <p>To unlock, release.</p>	

## Load

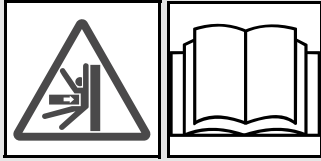





**⚠ WARNING** Horizontal movement. Crushing can cause death or serious injury. Read and understand operator's manual and all safety instructions before use.

**To help avoid injury:** Start and operate only from platform.

1. Start engine.
2. Release parking brake.
3. Set to low throttle.
4. Raise attachment clear of trailer, but keep it low.
5. Move machine to rear of trailer and align with ramps.
6. Drive forward slowly to move machine onto trailer until tiedown position is reached.
7. Lower attachment to trailer bed.
8. Set parking brake.
9. Ensure all controls are in neutral position.
10. Shut off machine.
11. Tie down machine.

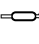
## Recommended Lubricants

Item	Description
 DEAC	Diesel engine antifreeze/coolant, low silicate, fully-formulated meeting ASTM D6210.  See "Approved Coolant" on page 61.
 DEO	<b>HRC:</b> Diesel engine oil meeting or exceeding API CH-4 (CH-4, CI-4, CJ-4) or ACEA E7 (E6, E7 OR E9). See "Engine Oil Temperature Chart" on page 61.  API American Petroleum Institute, ACEA European Automobile Manufacturer's Association  <b>LRC:</b> Diesel engine oil compatible with the sulfur content of the fuel used. <ul style="list-style-type: none"><li>• If the fuel sulfur content exceeds 500ppm (500mg/kg), the oil's base number (TBN) should exceed 10.</li><li>• If the fuel sulfur content exceeds 5000ppm (5000mg/kg), reduce change interval to every 50 hours.</li><li>• See viscosity chart.</li></ul>
 MPG	Multipurpose grease, polyurea based NLGI GC-LB Grade 1.5 or lithium based NLGI GC-LB Grade 2
 THF	Tractor hydraulic fluid, Phillips 66® PowerTran Fuid, Mobilfluid® 423, Chevron® Tractor Hydraulic Fluid, Texaco® TDH Oil, or equivalent

Proper lubrication and maintenance protects Ditch Witch equipment from damage and failure. Maintenance intervals listed are for minimum requirements. In extreme conditions, service machine more frequently. Use only genuine Ditch Witch parts, filters, approved lubricants, TJC, and approved coolants to maintain warranty. Fill to capacities listed in "Specifications" on page 77.

For more information on engine lubrication and maintenance, see your engine manual.

## Filter, Fuel

**NOTICE:** If refueling from cans, replace filters more often.

Change filter (shown) every 400 hours.

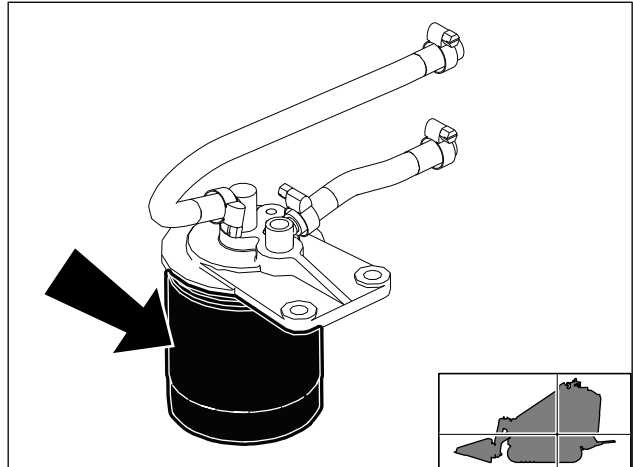

t51om035w.eps

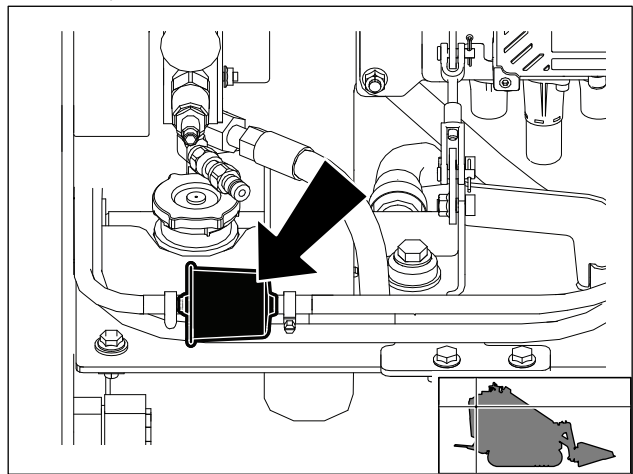

t51om005w.eps

## Filter, Hydraulic Fluid

Change filter (shown) at 50 hours and every 300 hours thereafter.

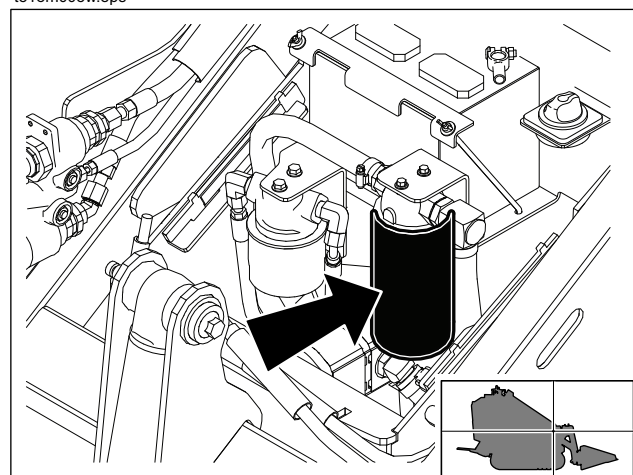

t51om004w.eps

CLICK HERE TO **DOWNLOAD** THE COMPLETE MANUAL

- Thank you very much for reading the preview of the manual.
- You can download the complete manual from: [www.heydownloads.com](http://www.heydownloads.com) by clicking the link below



- Please note: If there is no response to CLICKING the link, please download this PDF first and then click on it.

CLICK HERE TO **DOWNLOAD** THE COMPLETE MANUAL