

PR100

Operator's Manual



CLICK HERE TO **DOWNLOAD** THE COMPLETE MANUAL

- Thank you very much for reading the preview of the manual.
- You can download the complete manual from: www.heydownloads.com by clicking the link below



- Please note: If there is no response to CLICKING the link, please download this PDF first and then click on it.

CLICK HERE TO **DOWNLOAD** THE COMPLETE MANUAL



Service Record

a record of major service performed on the machine

107

PR100 Best Practices

- Rod threads should be clean and free of grit.
- Bursting box must be perpendicular and level to the pipe being burst.
- Grease pivots daily.
- Threaded joints must be lubricated.
- Threaded joint must be completely tightened so shoulders touch.
- Re-tighten drill string in exit pit before pullback.
- Bursting box and rod must stay in alignment.
- No sharp bends in rod string during pullback.
- Jaws should be cleaned when job is complete.

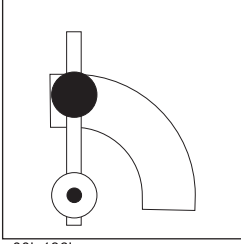
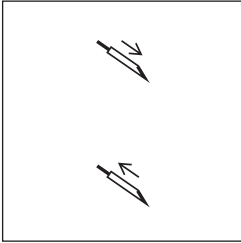
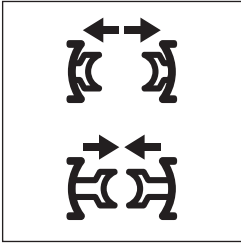
Item	Description	Notes
<p>5. Hydraulic flow control (for AMD)</p>  <p>c00ic136h.eps</p>	<p>To increase hydraulic flow to assisted makeup device (AMD), move handle toward horizontal position.</p> <p>To decrease hydraulic flow to assisted makeup device, move handle toward vertical position.</p>	<p>Maximum output is 7.2 gpm (27.2 L/min) at 2500 psi (172 bar).</p> <p>IMPORTANT:</p> <ul style="list-style-type: none"> • Stop flow before connecting or disconnecting hydraulic tools. • Leave flow at 0 when not in use and when hoses are not connected.
<p>6. Bursting unit manual control</p>  <p>c00ic572h.eps</p>	<p>To return carriage to back of bursting unit or to pull new product through pipe, pull.</p> <p>To return carriage to front of bursting unit or to push rod into pipe, push.</p>	<p>Use in sequence with rear clamp manual control to push and pull rods from power pack control station.</p> <p>Push sequence:</p> <ul style="list-style-type: none"> • push clamp manual control • push bursting unit manual control • pull clamp control • pull bursting unit control <p>Pull sequence:</p> <ul style="list-style-type: none"> • push clamp manual control • pull bursting unit control • pull clamp control • push bursting unit manual control
<p>7. Clamp control</p>  <p>c00ic033h.eps</p>	<p>To close clamp, push.</p> <p>To open clamp, pull.</p>	<p>Use in sequence with bursting unit manual control to push and pull rods.</p> <p>See "Bursting unit manual control" for sequence.</p>

Gather Information

A successful job begins before the pull. The first step in planning is reviewing information already available about the job and jobsite.

Review Job Plan

Review blueprints or other plans and make sure you have taken enlargement during pullback into account. Check for information about existing or planned structures, elevations, or proposed work that may be taking place at the same time.

Notify One-Call Services

Contact your local One-Call (811 in USA) or the One-Call referral number (888-258-0808 in USA and Canada) to have underground utilities located before digging. Also contact any utilities that do not participate in the One-Call service.

Examine Pullback Material

Ask for a sample of the new product material you will be pulling back. Check its weight and stiffness. Contact the manufacturer for bend radius information. Check that you have appropriate pullback devices.

Arrange for Traffic Control

If working near a road or other traffic area, contact local authorities about safety procedures and regulations.

Plan for Emergency Services

Have the telephone numbers for local emergency and medical facilities on hand. Check that you will have access to a telephone.

Lift Points and Procedure



WARNING Crushing weight. If load falls or moves it could kill or crush you. Use proper procedures and equipment or stay away.

Lifting points are identified by lifting decals. Lifting at other points is unsafe and can damage machinery.

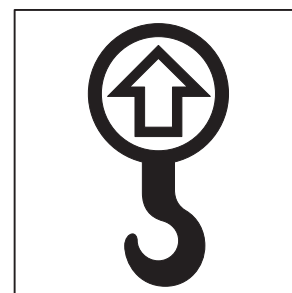

ic1319a.eps

Power Pack

Use equipment capable of supporting the power pack's size and weight. See "Specifications" on page 99 or measure and weigh equipment before lifting. Use supplied lift chains at lift points as shown.

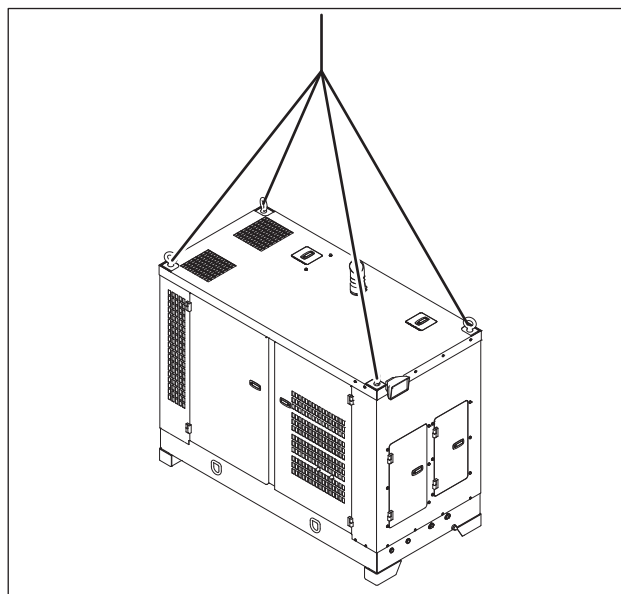

J29om024h.eps

Setup and Configuration

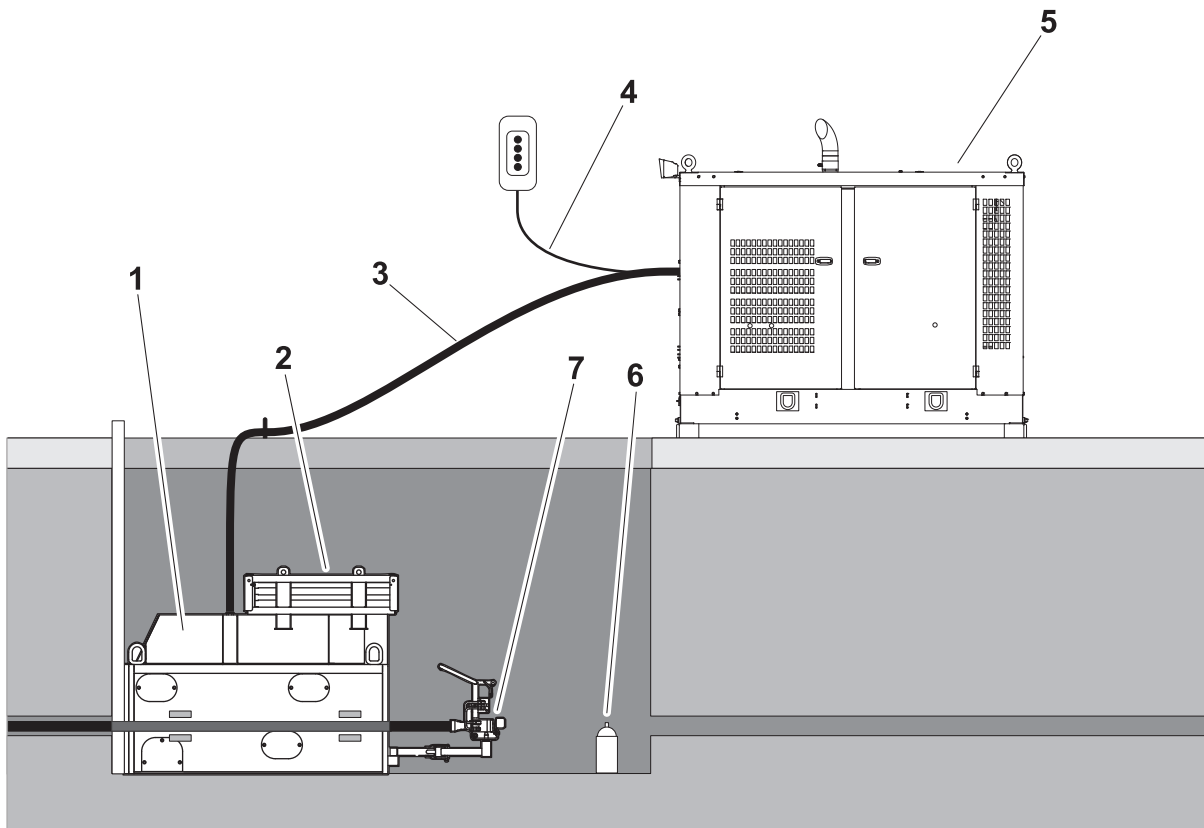

j29m068h.eps

For proper setup:

- place bursting unit (1) in gravel-lined bursting pit with steel plate in position
- allow space for operator behind pulling unit
- position power pack (5) outside of bursting pit
- connect hydraulic hoses (3) from power pack to bursting unit
- secure hoses to D-ring on bursting unit, and use a stake to keep hoses away from operator area
- set power pack engine switch to OFF
- connect electrical cable from remote controller (4) to power pack
- set remote enable switch on power pack to OFF
- mount optional assisted makeup device (7) on bursting unit
- place rod box (2) on top of bursting unit so that rods are available
- remove pins and end plate from rod box
- keep spray lube (6) available for lubricating rod threads

NOTICE: Follow U.S. Department of Labor regulations on excavating and trenching (Part 1926, Subpart P) and other similar regulations.

Extension Cage

The extension cage allows room to remove the bursting/splitting assembly from the new product after it enters the installation pit.

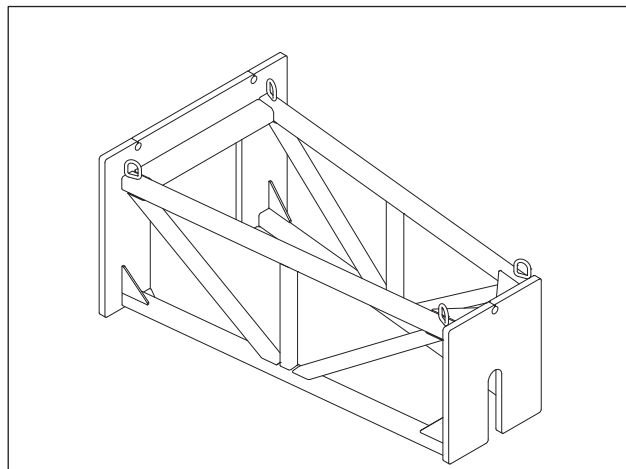

J29om030h.eps

Tool Kit

Accessory Tool Kit:

- 7' chain set (for power pack, bursting unit)
- 3' chain set (for smaller items)
- grease gun and grease cartridges
- hand tools
- slide hammers

Note: Accessories and tools are available separately. Contact your Ditch Witch dealer.

10 Hour

Location	Task	Notes
POWER PACK	Check engine oil level	DEO
	Drain fuel/water separator	
	Check engine coolant level	DEAC
	Check engine air filter service indicator	
	Check hydraulic fluid level	THF
	Check hydraulic hoses and fittings	

Power Pack

Check Engine Oil Level

Check engine oil at dipstick (1) before operation and every 10 hours thereafter. Check with unit on level surface and at least 15 minutes after stopping engine. Add DEO at fill (2) as necessary to keep oil level at highest line on dipstick.

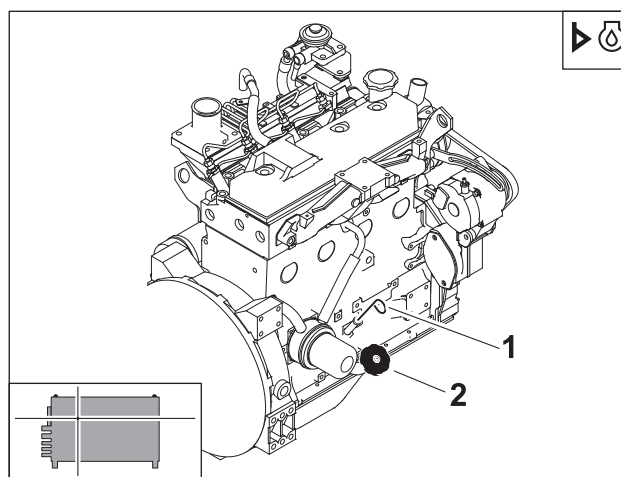

J29om031h.eps

Drain Fuel/Water Separator

Drain water out of filter every 10 hours. To drain, place loose end of drain hose into approved container. Turn valve on bottom of filter counterclockwise 4 turns until water flows out of drain hose. When fuel comes out, turn valve clockwise to close.

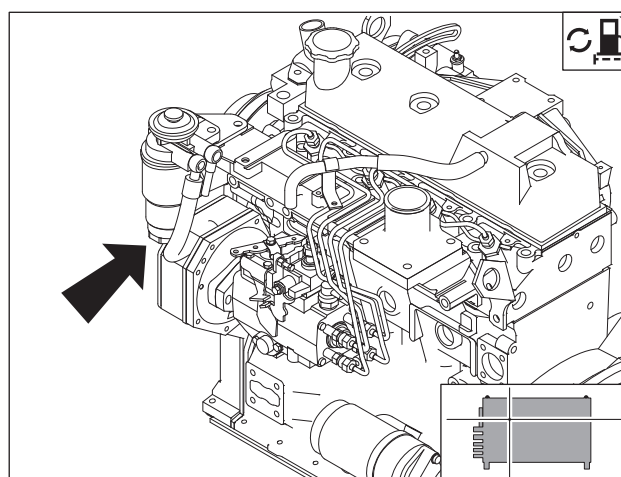

J29om039h.eps

As Needed

Location	Task	Notes
BURSTING UNIT	Repair jaw threads	
POWER PACK	Change air filter	
	Adjust fan belt tension	

Bursting Unit

Repair Jaw Threads

Maintenance and service procedures will extend the life of jaws.

Dirt and mud should be cleaned from jaws. Use a sharp screwdriver to remove mud.

Grinding will be necessary to restore threads as they wear. Thread sharpness is important for proper gripping.

Remove Jaws

1. Fully extend thrust cylinders until large pivot pin is aligned with frame opening.
2. Remove top covers and side covers (shown).
3. Fully retract clamping cylinders.
4. Turn unit off.

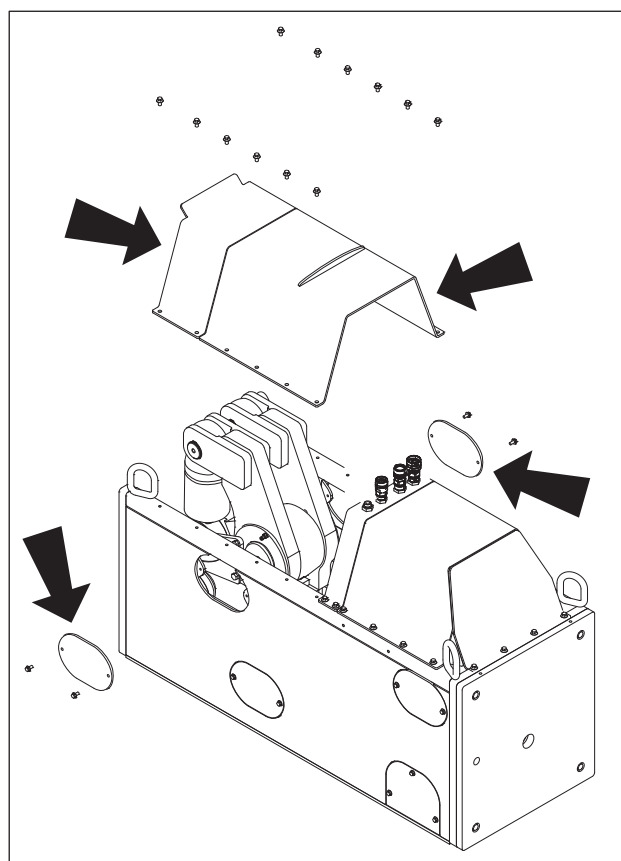

J29om001h.eps

CLICK HERE TO **DOWNLOAD** THE COMPLETE MANUAL

- Thank you very much for reading the preview of the manual.
- You can download the complete manual from: www.heydownloads.com by clicking the link below



- Please note: If there is no response to CLICKING the link, please download this PDF first and then click on it.

CLICK HERE TO **DOWNLOAD** THE COMPLETE MANUAL