

SERVICE

SERIAL NUMBER RECORD

Record serial numbers and date of purchase in spaces provided. Tractor (1) and engine serial numbers (2) are located as shown.

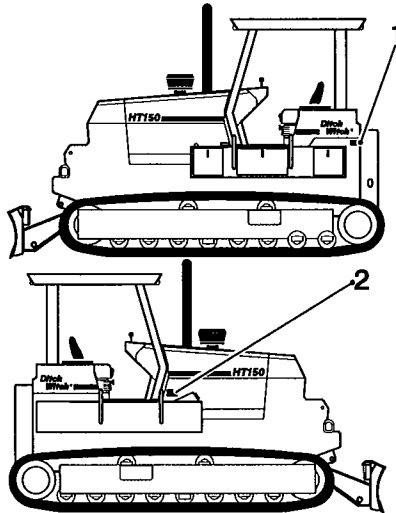

om0133h

Date of Manufacture:	
Date of Purchase:	
Tractor Serial Number:	
Front Attachment Serial Number:	
Rear Attachment Serial Number:	
Trailer Serial Number:	
Engine Serial Number:	

CLICK HERE TO **DOWNLOAD** THE COMPLETE MANUAL

- Thank you very much for reading the preview of the manual.
- You can download the complete manual from: www.heydownloads.com by clicking the link below



- Please note: If there is no response to CLICKING the link, please download this PDF first and then click on it.

CLICK HERE TO **DOWNLOAD** THE COMPLETE MANUAL

CONTROLS

CONTROL CONSOLE OVERVIEW

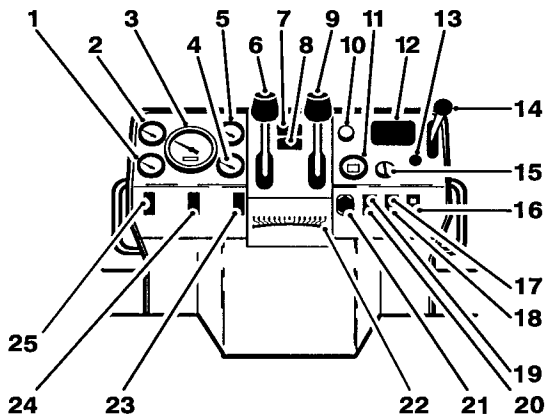

om0118h.eps

- | | |
|----------------------------------|---|
| 1. Fuel gauge | 15. Ignition switch |
| 2. Voltmeter | 16. Parking brake indicator |
| 3. Tachometer/Hourmeter | 17. Hydraulic filter service indicator |
| 4. Engine oil pressure gauge | 18. Hydraulic oil temperature indicator |
| 5. Water temperature gauge | 19. Engine oil pressure indicator |
| 6. Left track control | 20. Engine temperature indicator |
| 7. Frame tilt switch | 21. Auxiliary power outlet |
| 8. Hydraulic motor switch | 22. Frame tilt indicator |
| 9. Right track control | 23. Cold start switch* |
| 10. AutoCrowd steering control* | 24. Parking brake switch |
| 11. Air filter service indicator | 25. Reel carrier control* |
| 12. Start interlock | |
| 13. Horn | |
| 14. Throttle | |

*optional

WORK POSITION OVERVIEW

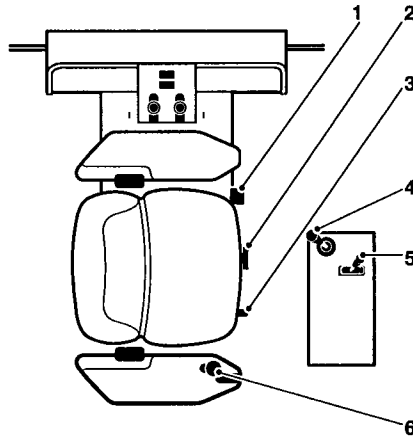

om01 19h.eps

1. Seat pivot control
2. Seat base control
3. Seat position control
4. Blade lift/tilt control*
5. Blade angle control*
6. Attachment speed/direction control

*optional

SAFETY

Follow these guidelines before operating any jobsite equipment:

- Complete proper training and read operator's manual before using equipment.
- Contact your local One-Call (888-258-0808) and utility company. Have all underground pipes and cables located and marked before operating equipment. If you damage a utility, contact utility company.
- Classify jobsite based on its hazards and use correct tools and machinery, safety equipment, and work methods for jobsite.
- Mark jobsite clearly and keep spectators away.
- Wear personal protective equipment.
- Review jobsite hazards, safety and emergency procedures, and individual responsibilities with all personnel before work begins. Watch "Stay Alert, Stay Alive," or "Don't Take Chances."
- Replace missing or damaged safety shields and safety signs.
- Use equipment carefully. Stop operation and investigate anything that does not look or feel right.
- Contact your Ditch Witch dealer if you have any question about operation, maintenance, or equipment use.



When you see this safety alert sign, carefully read and follow all instructions. **YOUR SAFETY IS AT STAKE.** Read this entire section before using your equipment.

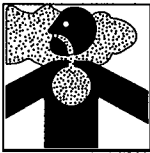

sf1025

**DANGER**

Deadly gases. Lack of oxygen or presence of gas will cause sickness or death. Provide ventilation.

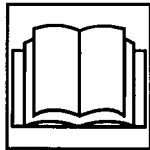

sf1027

**WARNING**

Incorrect procedures could result in death, injury, or property damage. Learn to use equipment correctly.



sf1013

**WARNING**

Fluid or air pressure could pierce skin and cause injury or death. Stay away.

NOTICES:

- Before disconnecting lines, turn off engine and operate controls to relieve system pressure.
- Before pressuring system, check that all connections are tight and lines, pipes, and hoses are not damaged. Check for escaping fluid with a piece of cardboard or wood.
- Wear protective clothing and eye protection.
- Seek immediate medical attention for all injuries from a doctor familiar with this type of injury.

TRANSPORTATION

LIFT

Lifting Points

Lifting points are identified by lifting decals. Lifting at any other point can be unsafe and can damage machinery.

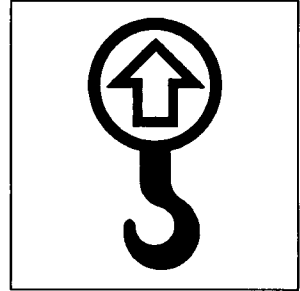

om1362.pcx

Tractor

Before lifting, check **SPECIFICATIONS**. Use a hoist capable of supporting equipment's size and weight. Do not attempt to lift tractor with attachments installed.

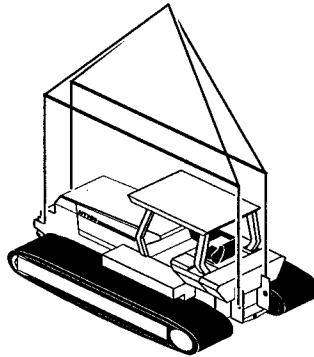

st1026

⚠ WARNING

Crushing weight could cause death or serious injury. Use proper procedures and equipment or stay away.

PLOW ATTACHMENT

PLOW CONTROLS OVERVIEW

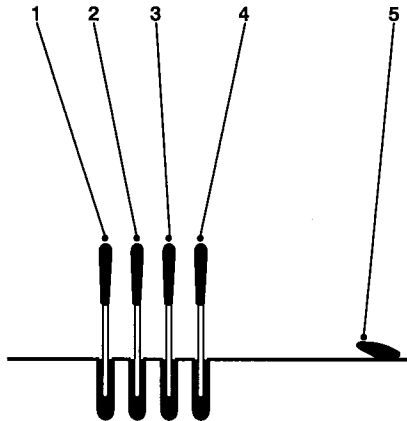

om0362h.eps

1. Plow swing control
2. Blade position control
3. Blade pitch control
4. Plow lift control
5. Plow lock

OPTIONAL EQUIPMENT

Blades

Several blade lengths and types are available. See your authorized Ditch Witch dealer to select the blade right for your needs.

Reel Carrier

Reel carriers are designed to fit your Ditch Witch equipment and speed cable installation. Contact your Ditch Witch dealer.

Toe or Bullet

Toes (feed blades) stabilize the plow for more constant depth. Bullets (pull blades) allow a larger cavity for the material being installed. To select the toe or bullet for your equipment and jobsite, contact your Ditch Witch dealer.

CLICK HERE TO **DOWNLOAD** THE COMPLETE MANUAL

- Thank you very much for reading the preview of the manual.
- You can download the complete manual from: www.heydownloads.com by clicking the link below



- Please note: If there is no response to CLICKING the link, please download this PDF first and then click on it.

CLICK HERE TO **DOWNLOAD** THE COMPLETE MANUAL



sf1017

⚠ WARNING

Jobsite hazards could cause death or serious injury. Use correct equipment and work methods. Use and maintain proper safety equipment.

NOTICE: Know and comply with regulations covering One-Call service and utility notification before digging or boring.

8. Lower saw to just above ground.
9. Lower stabilizer until distance from bottom of skid shoe to bottom of saw bits equals desired trench depth.
10. Check that saw is in line with planned trench and that tracks are pointing straight ahead.

Trench Cleaner Slide Control

This optional lever lengthens and shortens trench cleaner slide.

- Push to lengthen.
- Pull to shorten.

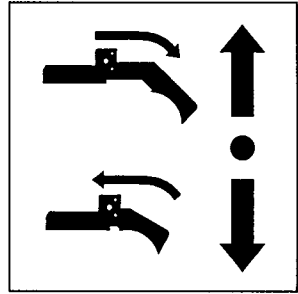

ic0145h.eps

Trench Cleaner Lift Control

This lever raises or lowers trench cleaner.

- Push to lower
- Pull to raise.

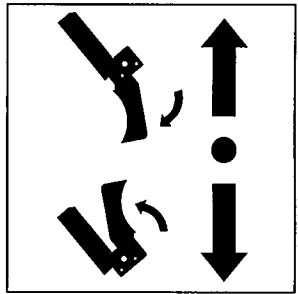

ic0144h.eps

OPERATING TIPS

- Avoid using badly worn teeth. When replacing teeth, maintain original pattern. Use Ditch Witch replacement teeth.
- Operate engine at full throttle.
- Sight along center of hood to a stake driven beyond end of trench line for straight trench.
- Use correct length boom. See your Ditch Witch dealer for more information.
- Do not make sharp turns. Lower boom to full depth when turning.
- If an object becomes lodged in chain, move attachment speed/direction control to neutral and raise boom slightly. Reverse chain direction. If object must be removed manually, turn engine off and engage parking brake.
- When cutting asphalt, start trench in soil at edge of road and use shortest possible boom at full depth.
- Always start trenching with attachment speed set at low. If soil conditions permit optimum digging at higher speed, select high.
- For optimum spoils delivery, adjust the auger positions forward or backward to accommodate terrain and digging depth.
- Before operating booms equipped with rock chains, check bits for free rotation. Tap bits lightly with a hammer and turn by hand. If bits are stuck, remove and clean packed soil from bit block.
- Carbide cap bits and cup tooth bits are recommended for cutting abrasive material, such as sandstone or frozen sands or gravels.

LUBRICATION

Proper lubrication and maintenance protects Ditch Witch equipment from damage and failure. In extreme conditions, lubricate more frequently.

Use only recommended lubricants. Fill to capacities listed in **SPECIFICATIONS**.

Recommended Lubricants	
DEO	Diesel engine oil (SAE 10W40) meeting API engine service classification SF/CD or CE
EPG	Extreme pressure grease
MPL	Multipurpose gear oil (SAE 80W90) meeting API service classification GL-5
THF	Tractor hydraulic fluid, similar to Phillips 66 HG, Mobilfluid 423, Chevron Tractor Hydraulic Fluid, Texaco TDH Oil, or equivalent

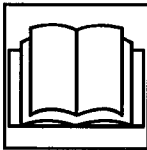

sf1027



WARNING

Incorrect procedures could result in death, injury, or property damage. Learn to use equipment correctly.

NOTICES:

- Unless otherwise instructed, all service should be performed with engine off.
- Refer to engine manufacturer's manual for engine maintenance instructions.
- Before servicing equipment, lower unstowed attachments to ground.

SAW

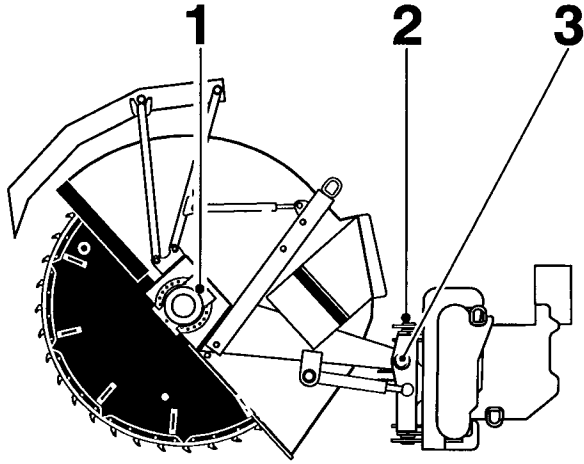

om0219h

Ref.	Task	Hours	Lubricant
3	Lube lift arm pivot	10 hours	EPG
1	Lube wheel shaft bearing	10 hours	EPG
2	Lube pivot	10 hours	EPG

Fuel Filter/Water Trap

Check water trap every 10 hours. Drain at plug as needed until water is removed and fuel runs from drain.

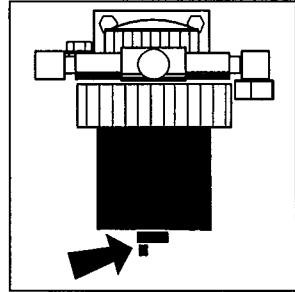

om0156h

Check Fuel Tank Breather

Every 50 hours ensure that fuel tank breather is not clogged. Remove dust around breather as needed by blowing with low-pressure air. When breather element becomes clogged, remove and clean or replace.

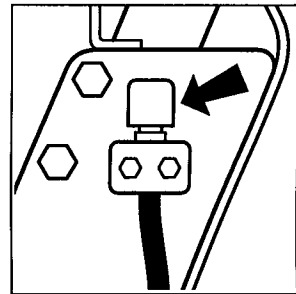

om2294a.eps

Fan Belt

Check belt every 50 hours for damage or wear. Replace worn belt.

Belt is properly tensioned when long span moves about 1/2 inch (13 mm) when pushed. If needed, loosen alternator bolts and adjust idler pulley.

Feed Tube

Clean feed tube every 10 hours.

Arm Pins and Bushings

Check arm pins every 10 hours.
Tighten as needed.

Every 100 hours, lower plow blade to ground and visually inspect bushings and joints. Replace bushings if there is excessive motion.

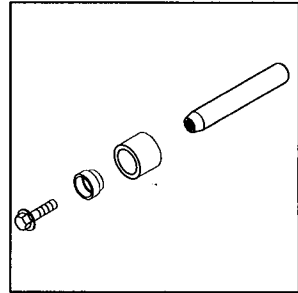

om0158h

Attachment Mounting Bolts

Check bolts every 10 hours and torque as necessary to keep bolts and other fasteners tight. Check for looseness or wear. Apply Loctite® 271 adhesive. Check that bolts are torqued to 700 ft•lb (950 N•m).

Sod Cutter and Blade

Replace worn sod cutters and plow blades as needed.

If plow blade is attached with bolts, do not over-torque. Use hand wrench and bullet socket in tool box to tighten bolts and castle nuts. Use cotter pins to secure castle nuts to bolts.

Attachment Mounting Bolts

Check bolts every 10 hours and torque as necessary to keep bolts and other fasteners tight. Check for looseness or wear.

Apply Loctite 271[®] adhesive. Check that bolts are torqued to 700 ft•lb (950 N•m).

Personnel Restraint Bar/ Trench Cleaner

Check 6 bolts that mount arm to trencher boom and 6 bolts that mount restraint bar/trench cleaner to arm every 10 hours and torque as necessary to keep bolts tight. Check for looseness or wear. Apply Loctite 271[®] adhesive. Check that bolts holding restraint bar/trench cleaner to arm are torqued to 350 ft•lb (475 N•m). Bolts mounting arm to boom should be torqued to 700 ft•lb (950 N•m).

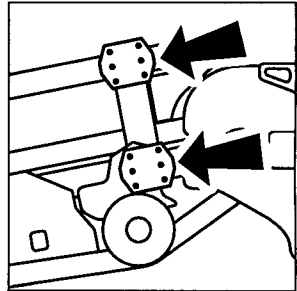

om2302a.eps

Auger Bolts

Check

Check auger bolts every 10 hours.

Adjust

For optimum spoils delivery, move augers to match terrain and digging depth.

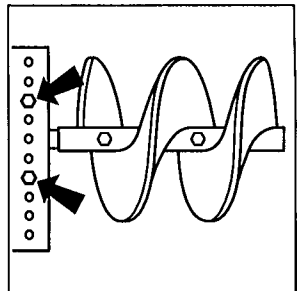

om2282a.eps

H1530

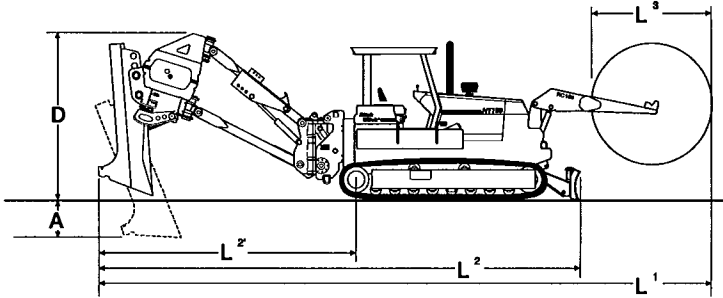

om0169h

DIMENSIONS		U.S.	METRIC
A	Cover depth	36, 42, 48 in	915, 1070, 1220 mm
D	Attachment height		
	Blade on ground with cable guide	123 in	3.13 m
	Blade on ground without cable guide	113 in	2.86 m
	Transport position	168 in	4.26 m
L1	Length with reel carrier	440 in	11.2 m
L2	Length without reel carrier	339 in	8.6 m
L2'	Attachment length, plow on ground	169 in	4.3 m
Pitch adjustment		+/- 4.1°	+/- 4.1°
Angle of departure			
	36 inch (915 mm) depth	22°	22°
	42 inch (1.07 m) depth	19°	19°
	48 inch (1.22 m) depth	16°	16°
Below grade capability		36 in	915 mm

CLICK HERE TO **DOWNLOAD** THE COMPLETE MANUAL

- Thank you very much for reading the preview of the manual.
- You can download the complete manual from: www.heydownloads.com by clicking the link below



- Please note: If there is no response to CLICKING the link, please download this PDF first and then click on it.

CLICK HERE TO **DOWNLOAD** THE COMPLETE MANUAL