

# **CLAAS**

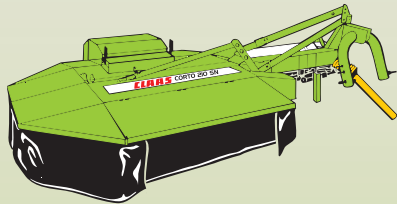

**CORTO 210 N / S**  
**CORTO 185 N / S**  
**CORTO 165 N / S**

## **Assembly and operator's manual**

***SERVICE & PARTS***

CLICK HERE TO **DOWNLOAD** THE COMPLETE MANUAL

- Thank you very much for reading the preview of the manual.
- You can download the complete manual from: [www.heydownloads.com](http://www.heydownloads.com) by clicking the link below



- Please note: If there is no response to CLICKING the link, please download this PDF first and then click on it.

CLICK HERE TO **DOWNLOAD** THE COMPLETE MANUAL

## HYDRAULIC SYSTEM

The hydraulic system is under high pressure!

When attaching hydraulic cylinders and motors, ensure the stipulated connection of the hydraulic hoses!

When connecting the hydraulic hoses to the tractor hydraulics, it is important to ensure that the hydraulics are depressurised both on the tractor side and the machine side!

For hydraulic function connections between the tractor and the machine, the coupling sleeves and plugs should be marked to avoid incorrect operation! Interchanging connections causes reversed functions (e.g. raise/lower) – **Safety hazard!**

Check hydraulic hose lines at regular intervals, and replace them in case of damage or ageing! Replaced hydraulic hose lines must correspond to the technical requirements of the equipment manufacturer!

Checking for leaks is hazardous. Use suitable aids to check for leaks!

Fluid escaping under high pressure (hydraulic oil) can penetrate the skin and cause serious injuries. If any fluid penetrates the skin, consult a doctor immediately!

– **Risk of infections!**

Before performing any work on the hydraulic system, lower the machine, release the pressure from the hydraulic system and stop the engine!

## TYRES

When working on tyres make sure the machine is safely parked and secured so that it will not roll away (use wheel chocks)!

Fitting tyres and wheels requires special training and expert knowledge and the correct tools!

Repair work on tyres on wheels must only be carried out by professionals and with correct tools!

Check the air pressure regularly! Observe the recommended tyre pressure!

## MAINTENANCE

Repair, service and cleaning work and elimination of malfunctions should only be performed when the drive and the engine are switched off!

– Remove ignition key!

Wait until the mower drum has come to a complete stop.

Repair work on prestressed energy accumulators (springs, hydraulic accumulators etc.) should be carried out in specialist workshops and with suitable tools!

Regularly check nuts and screws for tight fit and tighten them, if necessary!

When performing maintenance work on the raised machine, ensure that it is supported safely using suitable supports!

Use suitable tools and wear safety gloves when replacing working parts!

Dispose of used oil and grease according to regulations!

Always disconnect the power supply before working on the electrical system!

Guards and protecting devices that are subject to wear must be checked at regular intervals and replaced in time!

Spare parts must at least comply with the technical standards required by the manufacturer of the machine! Original spare parts, for instance, are manufactured to meet these standards!

Before performing electrical welding work on the tractor and mounted machines, always disconnect the leads from the battery and alternator!

## SOUND PRESSURE LEVEL

If the noise level at the driver's ear exceeds 85 dB (A) (see 'Specifications'), he must wear ear protection.

# 6 Assembly

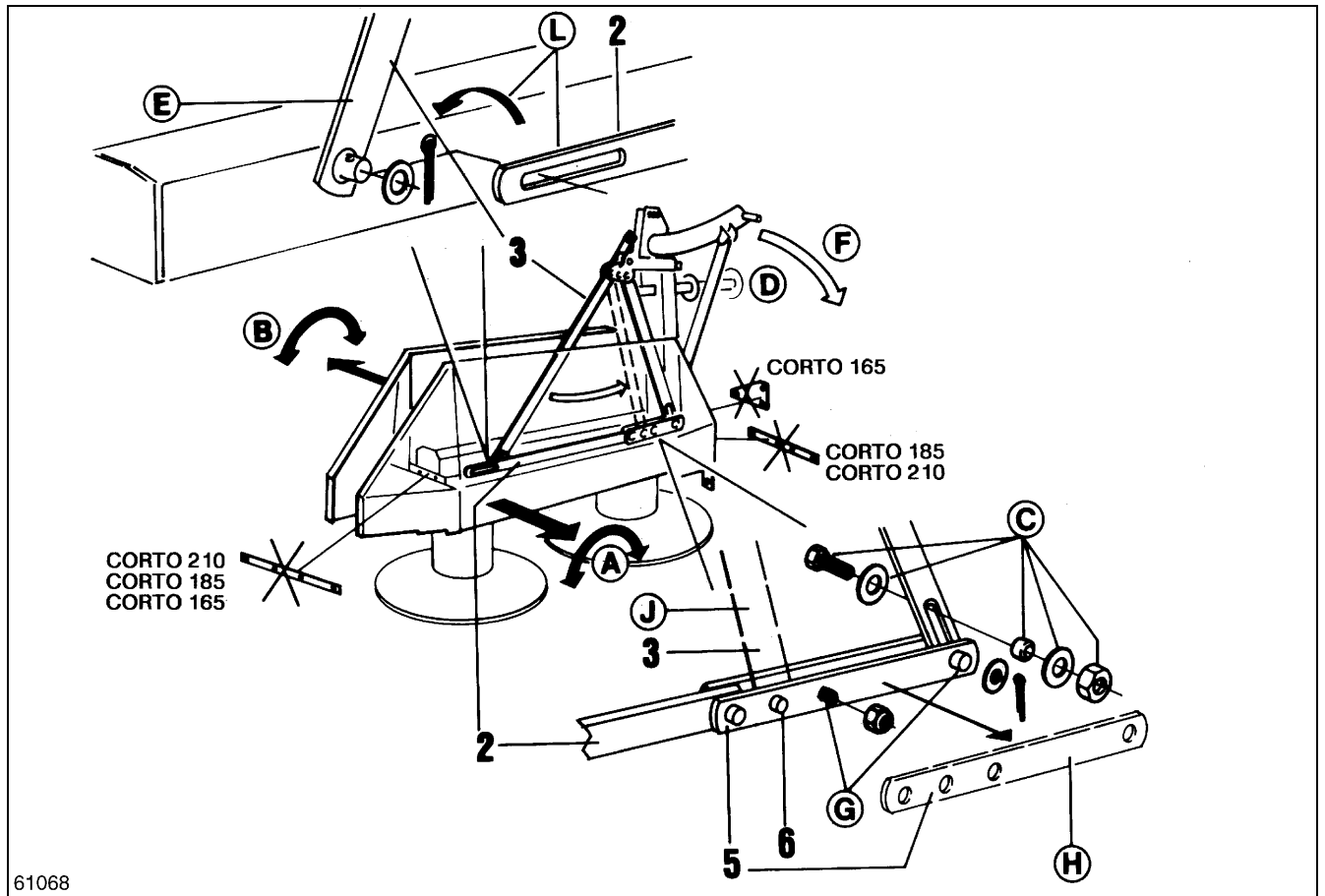

61068

1

## ASSEMBLY CORTO 210 S / 210 N / 185 S / 185 N / 165 S / 165 N

Perform assembly as follows:

- A, B) Remove guard plates.
- C) Remove fixing components (not required).
- D) Extend stand.
- E) Remove struts (3) from frame.
- F) Swing headstock downwards.



### Attention!

Weight approx. 80 kg.

- G, H) Remove front section of rocker arm (5).
- J) Hook the struts (3) into the pin (6) on the rocker arm. Bolt the rocker arm (5) together.
- L) Hook the struts (2) in the pin on the frame and secure in position.

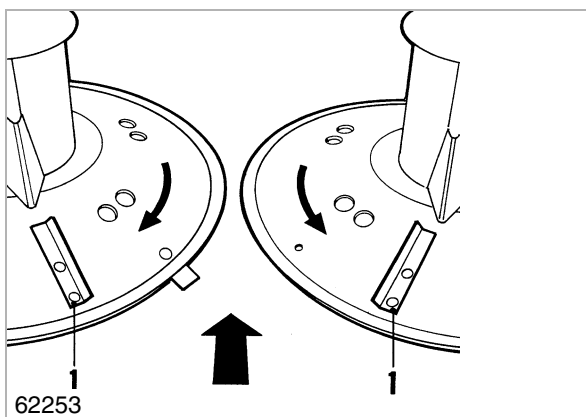

15

The accessories of the conditioner include carriers. These must be fitted before use.

**CORTO 185 / 165:**

The carriers (1) are bolted to the mower drum (2 per drum). The side of the carrier with the chamfer at the top must follow on. (Fig. 15).

2x 948 884.2 Carrier right

2x 948 885.2 Carrier left

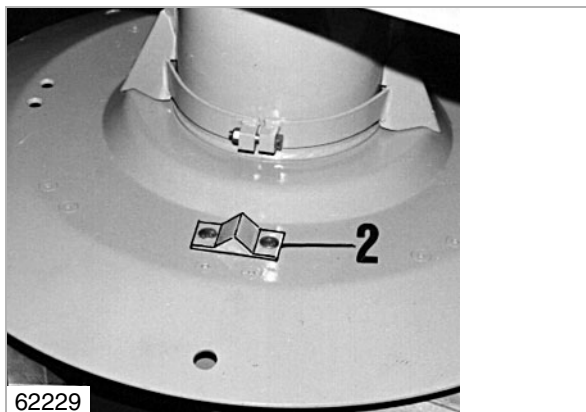

16

**CORTO 210:**

The carriers (2) (948 893.0) are shown in illustration 12, bolted to the mower drum (2 per drum).

(Fig. 16)

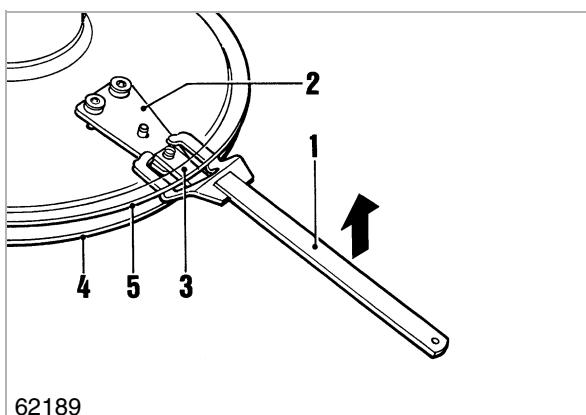

17

**FITTING CUTTING BLADES**

Before using mower for first time, cutters must be mounted. Insert mounting lever (1) between sliding disc (4) and cutting disc (5). Pull fitting lever upwards and fit cutter onto cutter pin, with cutting edge facing downwards.

(Fig. 17)

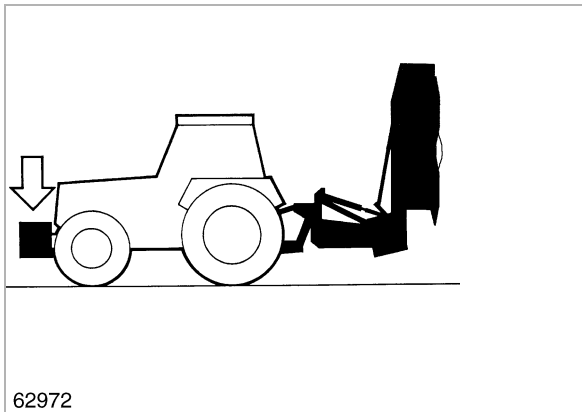

17

## Driving on public roads



### Danger!

The front axle of the tractor must always be loaded with a minimum of 20 % of the empty weight of the tractor when the machine is fitted (Fig. 17).

- If necessary, fit balancing weights.
- Observe the maximum permissible axle loads and total weights!

During road travel with a raised machine, the hydraulic control lever must be locked against inadvertent lowering.

- Lock the control lever!

- The applicable laws and regulations must be observed when travelling on public roads!
- For the Federal Republic of Germany, the “Straßenverkehrszulassungsordnung” (StVZO) applies.

The corresponding national (country-specific) provisions apply in other countries.

- Always adapt your driving speed to the traffic and road conditions. Observe national (country-specific) provisions concerning the maximum permitted vehicle ground speed! Reduce speed as appropriate when going around curves.
- Prepare machine for transport – see 'Prior to transportation', page 7.9.

- Mower unit with hydraulic lifting:

The mower unit can be swung up from the side or the back with the hydraulic cylinder.

If the width of the tractor, with the mower unit raised to the side, the dimension x, exceeds 3.00 m, the machine must firstly be swung to the back before lifting with the hydraulic cylinder. (Fig. 18)

- The mower unit must be made visible from the back with a warning plate with integrated lighting if the tractor lighting is obscured.
- If the mower unit raised to the side projects more than 40 cm over the limiting lights of the tractor it must be made visible from the front by fitting a warning sign with integrated lighting.

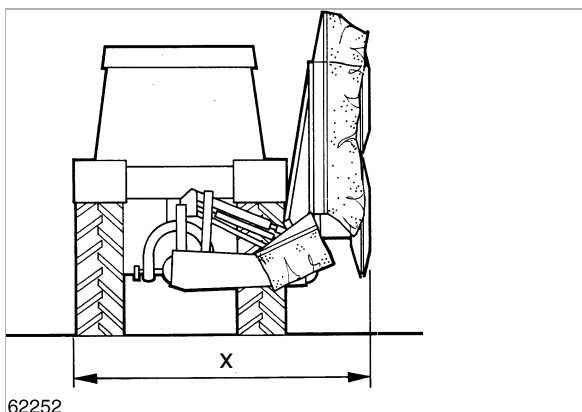

18

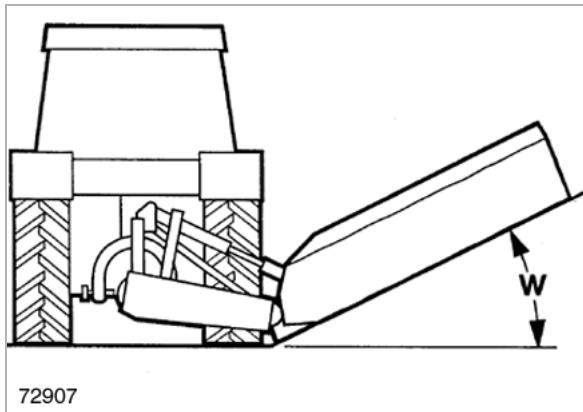

16

When mowing on inclines the cutterbar should be brought back to the horizontal position every 15 minutes.

Inclination angle for mowing, **max. angle w = 20°**

(Fig. 16, 17)

Difficult operating conditions

Take special care when working under difficult operating conditions or on uneven ground. To prevent foreign bodies from being hurled around, observe the following points:

1. Increase the cutting height by lengthening the upper link. The cutterbar should be inclined slightly forwards up to maximum horizontal.
2. Reduce ground speed.
3. Check that the mower blades can rotate around the cutter retaining bolt.

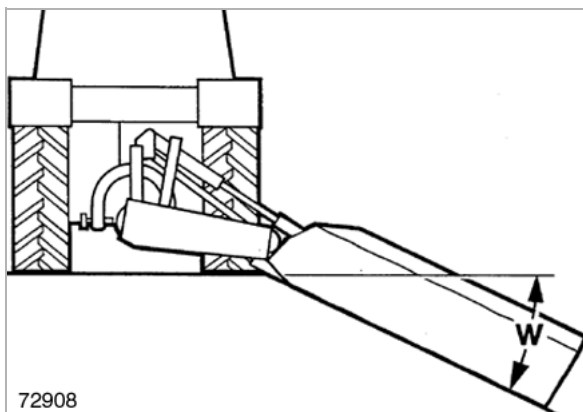

17

**Recommendations for environmental protection**

A simple change in the way we normally mow can help reduce the loss of wild animals.

At the same time, the quality of the mowed crop is increased.



**Environment!**

If we mow from the outside inwards, wild animals have hardly any chance of escape!

- Mow from the inside outwards.

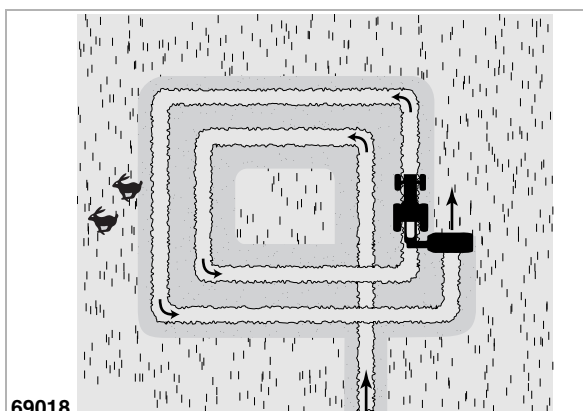

18

Drive to the middle of the lot and mow from the inside outwards.

The centre can be mowed if there is enough room to turn.

Wild animals thus have the chance of escaping outwards.

(Fig. 18)

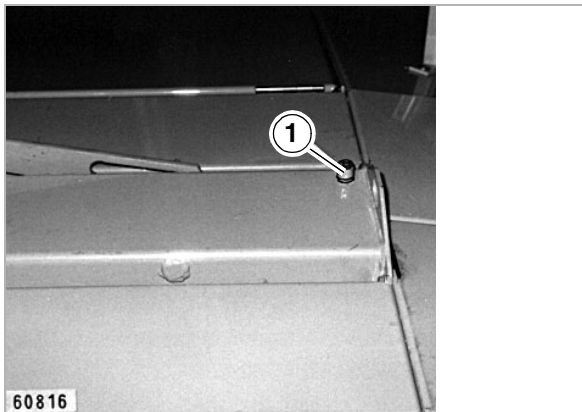

60816

3

### Gearbox and gear casing

For lubricating the gearbox and the gear casing, use only hypoid gear oil SAE 90 in accordance with (MIL-L-2105) API-G-L-5-90.

#### Oil filling quantities:

CORTO 210:	6.00 Litre
CORTO 185:	5.75 Litre
CORTO 165:	5.00 Litre

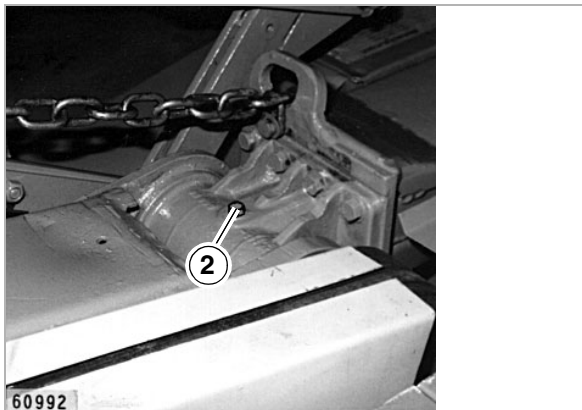

60992

4

(1) = Bleeding screw, filling aperture (Fig. 3)

(2) = Top-up aperture (Fig. 4)

(3) = Drain screw gear casing (Fig. 5)

(4) = Drain screw gearbox (Fig. 6)

#### Checking the oil level:

With the gear casing horizontal, the oil depth must be 2 cm. Check the oil level through the filling hole (1) in the gear casing.

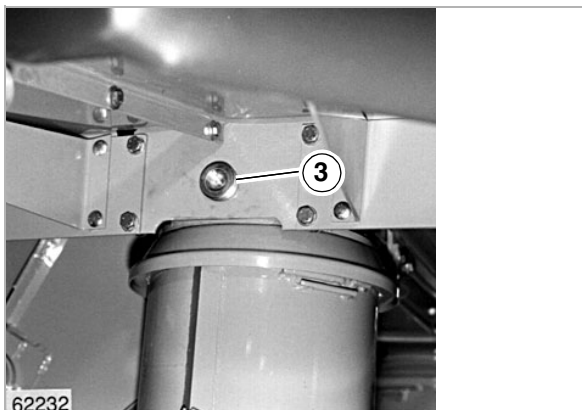

62232

5

#### Oil change:

The first oil change must be carried out after the first 30 hours of operation (also applies in case of a gearbox overhaul), and then every 100 operating hours, but not later than at the end of the harvesting season.

#### Draining oil:

Drain the oil from the gear casing via the oil drain screw (3).

The gear casing should be tilted downwards at an angle to the oil drain screw (3).

Drain the oil from the gearbox via the oil drain screw (4). Swing the gear casing into the vertical position.

Clean the magnetic plug screws (3) and (4) before re-assembly (Fig. 4, 6).



62231

6

CLICK HERE TO **DOWNLOAD** THE COMPLETE MANUAL

- Thank you very much for reading the preview of the manual.
- You can download the complete manual from: [www.heydownloads.com](http://www.heydownloads.com) by clicking the link below



- Please note: If there is no response to CLICKING the link, please download this PDF first and then click on it.

CLICK HERE TO **DOWNLOAD** THE COMPLETE MANUAL