

**McCormick
No. 8 Tractor Plow
(2 and 3-Furrow)**

Operator's Manual

1003630R2

Reprinted

CASE III

CLICK HERE TO **DOWNLOAD** THE COMPLETE MANUAL

- Thank you very much for reading the preview of the manual.
- You can download the complete manual from: www.heydownloads.com by clicking the link below



- Please note: If there is no response to CLICKING the link, please download this PDF first and then click on it.

CLICK HERE TO **DOWNLOAD** THE COMPLETE MANUAL

HITCH ADJUSTMENTS (Horizontal Adjustments)

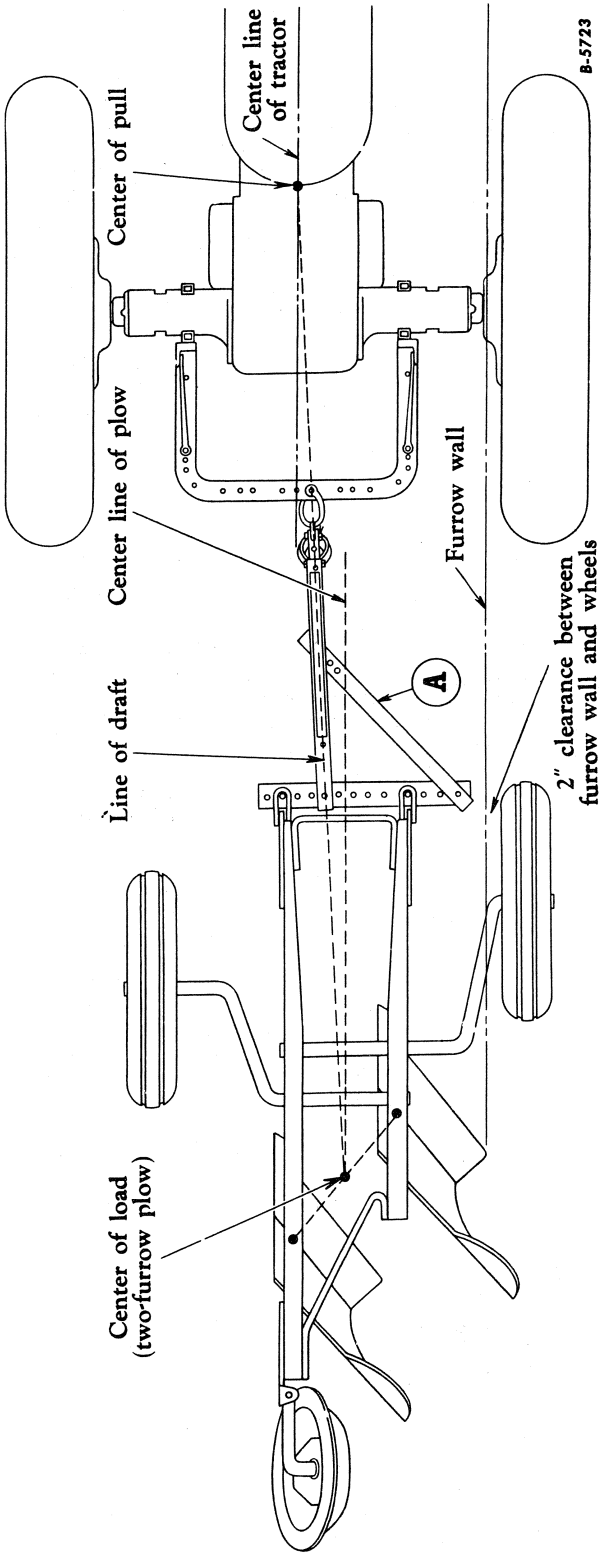

Illust. 3
Two-furrow plow.

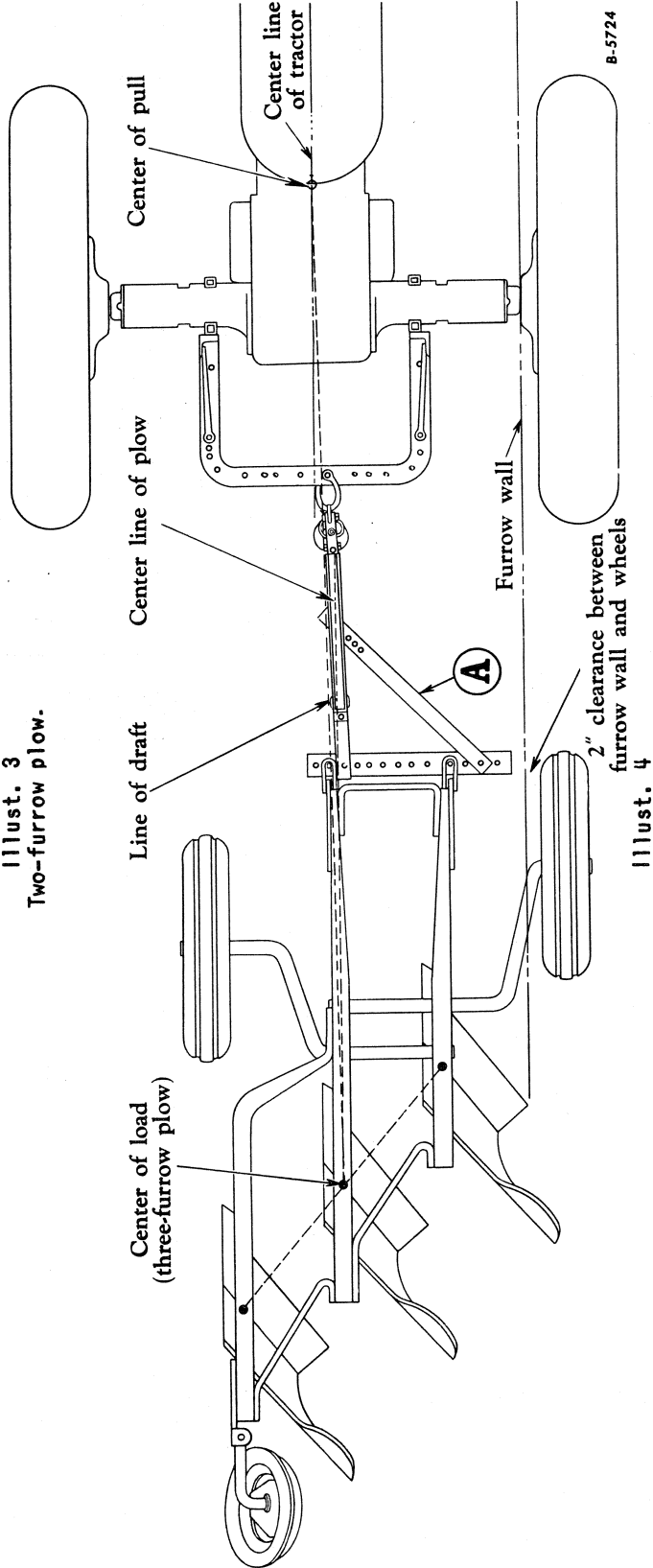

Illust. 4
Three-furrow plow.

STATIONARY JOINTER ADJUSTMENT - Continued

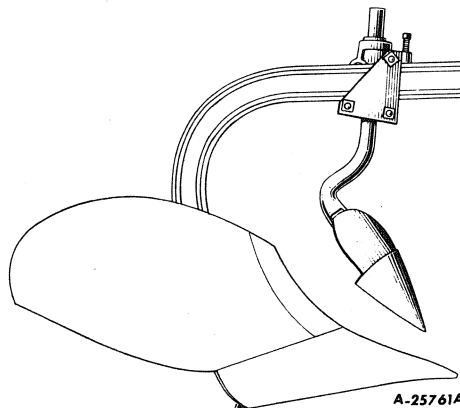

Illustr. 21

Illustr. 21 shows the jointer tipped back to run approximately 3" behind the share point. This position is often used when penetration is difficult in hard ground. If penetration is especially difficult, it is often best to remove

the jointers entirely.

Illustr. 22 shows how the stationary jointer can be used in combination with the rolling colter for better trash coverage.

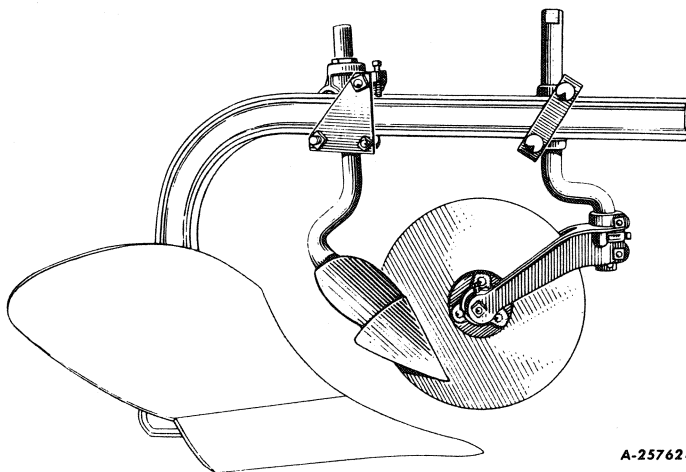

Illustr. 22

TWO-FURROW PLOW - Continued (Clutch Lift)

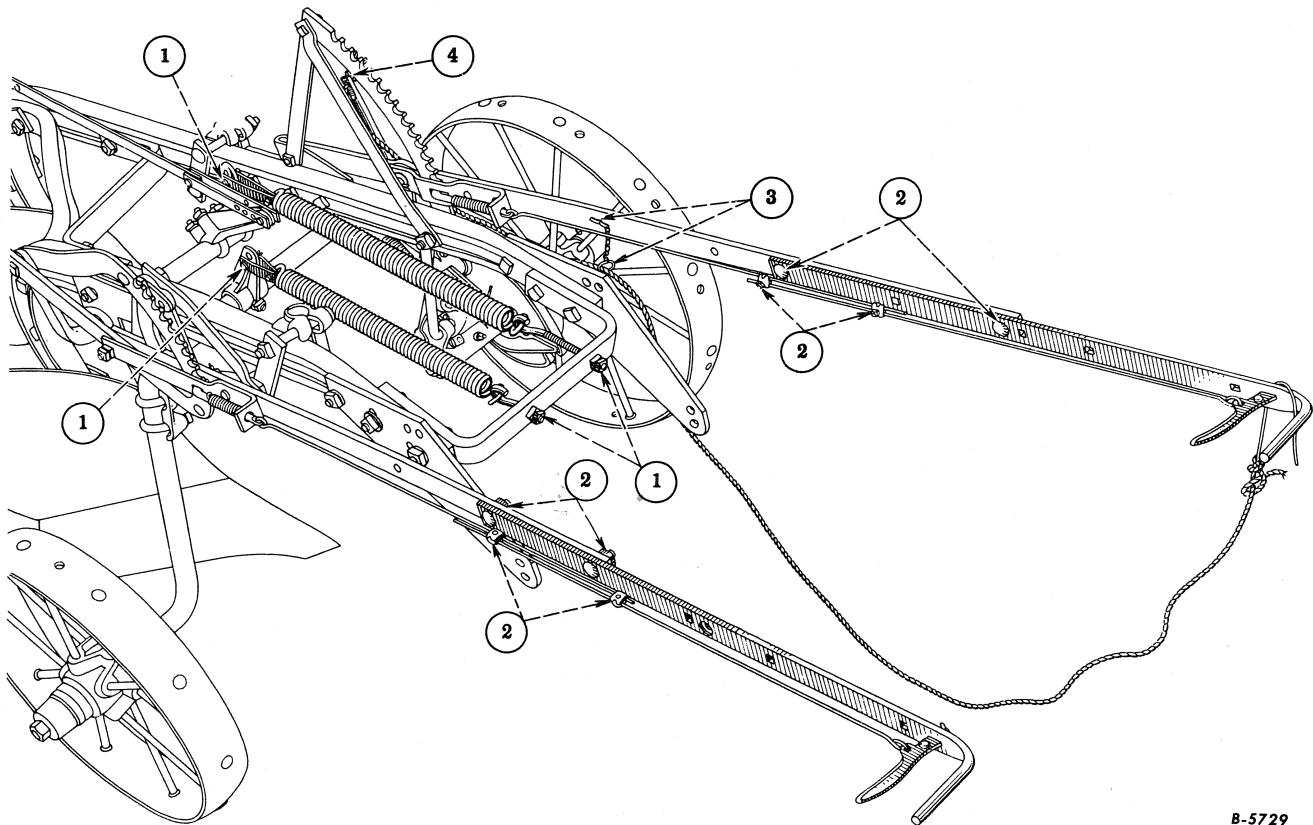

B-5729

Illust. 35

When the wheels have been installed, trip the clutch and raise both levers as high as they will go. With the plow in this position, grasp the land wheel and turn it forward to raise the plow until the trip roller falls in the notch in the clutch. See *Illust. 52*.

1. Pull both levers down as far as possible as shown and attach the raising springs. Use the long spring and the long eyebolt in the left side connected to the land axle arm and the short spring and the short eyebolt connected to the furrow axle arm.

NOTE: Assemble the clips found on the axle arms in the second hold in the arms to prevent excessive spring action.

2. Loosen the latch rod clamps and bolt the lever extensions to the levers as desired. See that the spring bolts are seated firmly in a quadrant notch, set the hand latch in the position shown and then tighten the latch rod clamps securely.

The short lengths of wire found between the levers and extensions serve for painting purposes only. Discard them as they are of no further use.

The levers should be set so they are easily reached from the tractor seat. The setting will vary depending on the type of tractor; however, the setting shown will be found satisfactory for Farmall H and M Tractors and others of similar type.

3. A short chain with a ring and a collar will be found in the cloth bag wired to the land axle. Insert the cotter with the chain attached in the small hole in the land lever and clinch the ends of the cotter.

4. Run the trip rope through the chain ring and tie the rope to the trip lever.

For installing the rolling colters, refer to *page 53*.

For installing the hitch, refer to *pages 54 to 57*.

THREE-FURROW PLOW - Continued (Clutch Lift)

1. Connect the clutch connecting link to the clutch axle arm and the land lever, securing it with cotters at both ends. Use washer between clutch axle arm and cotter.

2. Remove the trip lever cap, set the trip lever in place and replace the cap. See that the lever moves freely after assembly.

3. Revolve the clutch until the trip roller will set in the notch in the clutch plate as shown, then hook the spring to the trip lever and connect the spring eyebolt to the axle bracket. Tension the spring slightly and secure the setting with the eyebolt lock nut.

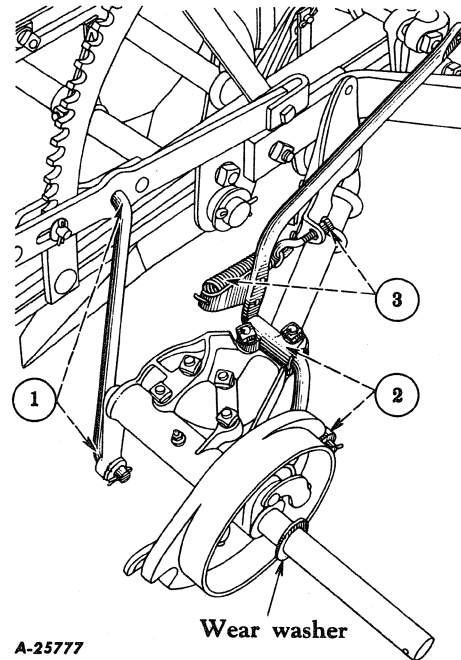

Illustr. 49

1. Remove the bolt through the rear axle plate and brace. For easier assembly the brace may be bent slightly to the right. Hook the axle sleeve over the plate and replace the bolt through the brace, sleeve bearing and plate.

2. Swing the axle around to the left, remove the cotter from the end of the guide rod, slide the guide rod through the guide arm, and replace the cotter.

3. Bolt the bellcrank to the bellcrank bracket. See that the bushing found wired to the axle is in place when this bolt is inserted.

4. Lubrication fittings will be found in a cloth bag wired to the land axle. Screw one fitting in the axle sleeve and another in the sand band.

For adjustment, see "REAR FURROW WHEEL" in the Adjusting and Operating Instructions.

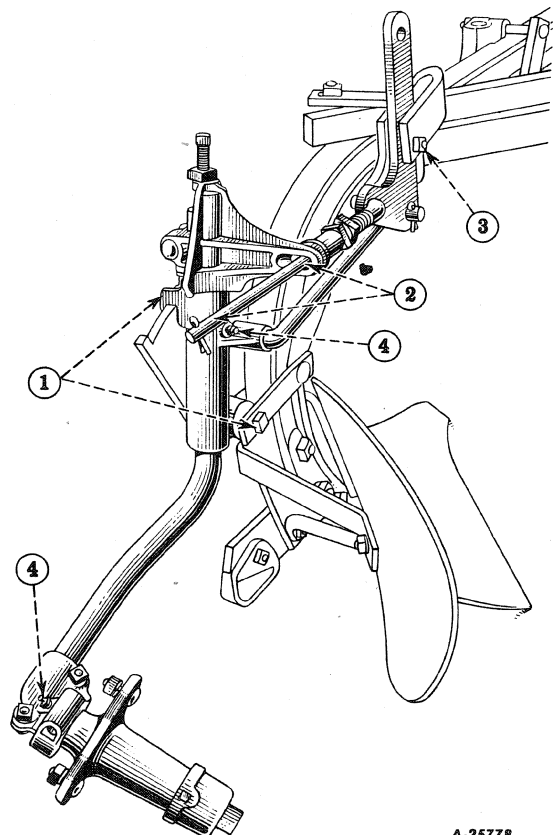

Illustr. 50

PNEUMATIC WHEELS

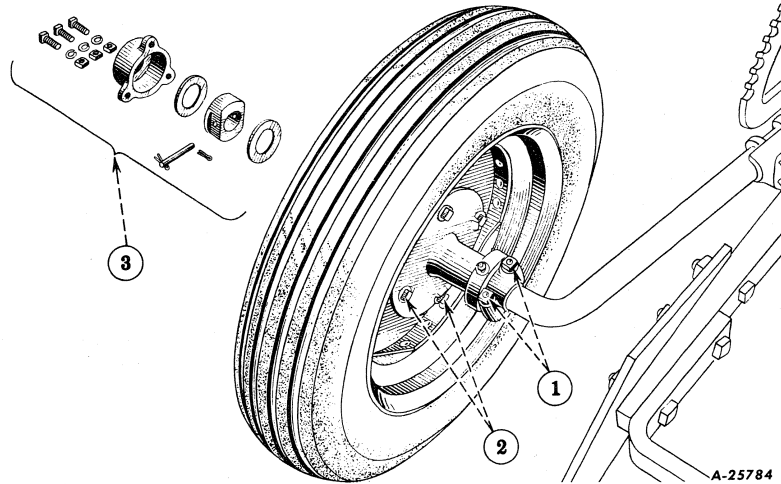

Illustr. 63

Furrow wheel.

The land wheel on the cylinder lift plow is assembled in the same manner.

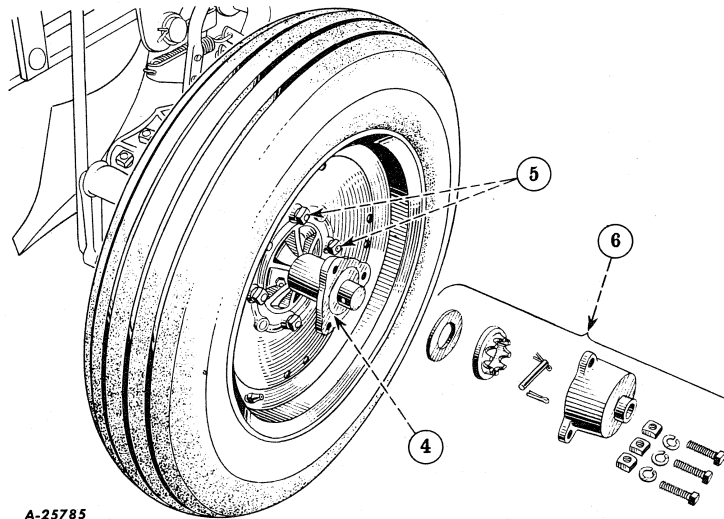

Illustr. 64

Land wheel (shown on clutch lift plow).

1. Remove the sand bands from the front furrow axle, remove the wheel cap (with enclosed parts) from the hub, put on the hub and replace the sand bands.

2. Bolt the wheel to the hub.

3. Install the wear washers, thrust collar, pin with cotters and wheel cap in the order shown in *Illustr. 63*.

FOR CYLINDER LIFT PLOWS: The wheel on the land axle is assembled in the same manner as indicated above for the wheel on the furrow axle.

THE FOLLOWING INSTRUCTIONS ARE FOR CLUTCH LIFT PLOWS ONLY:

4. Remove the wheel cap (with enclosed parts) from the hub and slide the hub on the land axle.

Refer to Illustr. 49. See that the clutch and axle parts are in the same position shown and the wear washer is in place on the clutch axle.

5. Raise the land axle to a convenient height with the land lever and bolt the wheel to the hub.

6. Install the wear washer, step-collar, pin with cotters and wheel cap in the order shown in *Illustr. 64*.

CLICK HERE TO **DOWNLOAD** THE COMPLETE MANUAL

- Thank you very much for reading the preview of the manual.
- You can download the complete manual from: www.heydownloads.com by clicking the link below



- Please note: If there is no response to CLICKING the link, please download this PDF first and then click on it.

CLICK HERE TO **DOWNLOAD** THE COMPLETE MANUAL