

ORIGINAL INSTRUCTIONS

CX30C
Mini Excavator

OPERATOR'S MANUAL

Part number 51698860
1st edition English
January 2020



CLICK HERE TO **DOWNLOAD** THE COMPLETE MANUAL

- Thank you very much for reading the preview of the manual.
- You can download the complete manual from: www.heydownloads.com by clicking the link below



- Please note: If there is no response to CLICKING the link, please download this PDF first and then click on it.

CLICK HERE TO **DOWNLOAD** THE COMPLETE MANUAL

Product identification

Your machine is a hydraulic excavator. It consists of an undercarriage fitted with tracks and a swing bearing which supports the upper-structure frame. The upper-structure frame supports the attachment at the front end of the machine, plus the engine, hydraulics and the cab/canopy. When the operator works the controls, the engine-driven pump delivers hydraulic fluid to the control valves. The control valves distribute the hydraulic fluid to the various cylinders and hydraulic motors employed. A cooling system maintains the hydraulic fluid at normal operating temperature.

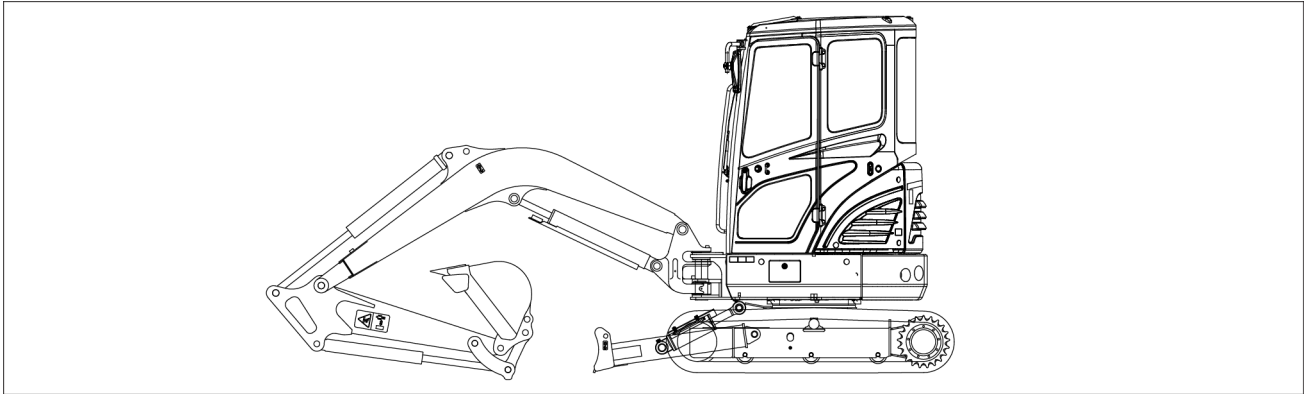

SMIL16MEX0363EA 1
Cab version

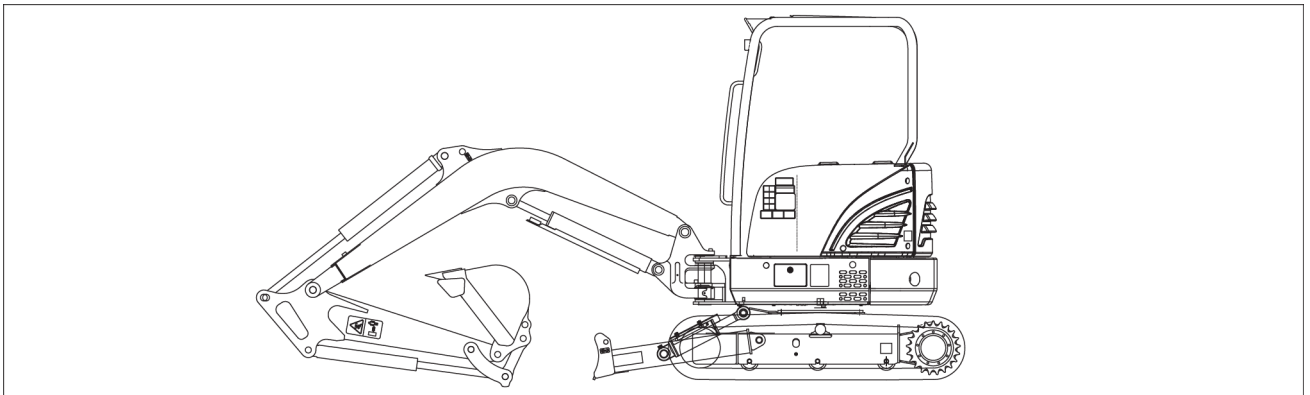

SMIL16MEX0629EA 2
Canopy version

When ordering parts, obtaining information, or seeking assistance, always supply your CASE CONSTRUCTION Dealer with the type and Product Identification Number (PIN) of your machine or accessories.

Write the following in the spaces below:

- Machine Type
- Machine PIN
- Machine year of manufacture
- Serial numbers of hydraulic and mechanical components

2 - SAFETY INFORMATION

Signal word definitions

Personal safety





This is the safety alert symbol. It is used to alert you to potential personal injury hazards. Obey all safety messages that follow this symbol to avoid possible death or injury.

Throughout this manual you will find the signal words DANGER, WARNING, and CAUTION followed by special instructions. These precautions are intended for the personal safety of you and those working with you.

Read and understand all the safety messages in this manual before you operate or service the machine.

 DANGER indicates a hazardous situation that, if not avoided, will result in death or serious injury.

 WARNING indicates a hazardous situation that, if not avoided, could result in death or serious injury.

 CAUTION indicates a hazardous situation that, if not avoided, could result in minor or moderate injury.

FAILURE TO FOLLOW DANGER, WARNING, AND CAUTION MESSAGES COULD RESULT IN DEATH OR SERIOUS INJURY.

Machine safety

NOTICE: Notice indicates a situation that, if not avoided, could result in machine or property damage.

Throughout this manual you will find the signal word Notice followed by special instructions to prevent machine or property damage. The word Notice is used to address practices not related to personal safety.

Information

NOTE: Note indicates additional information that clarifies steps, procedures, or other information in this manual.

Throughout this manual you will find the word Note followed by additional information about a step, procedure, or other information in the manual. The word Note is not intended to address personal safety or property damage.

⚠ Using an Implement other than a bucket ⚠

- When using a special implement (hydraulic breaker, cutter crusher etc.), refer to the operator's manual provided with the implement.

⚠ Implement operation and maintenance ⚠

- For the implement operation and maintenance, refer to the operator's manual provided with the implement.

⚠ Safety area ⚠

The safety area is the space necessary for the machine to operate at the maximum range of the tool and at full swing **360° plus 2 m (6.56 ft)**.

(1) Working area.

(2) Safety area.

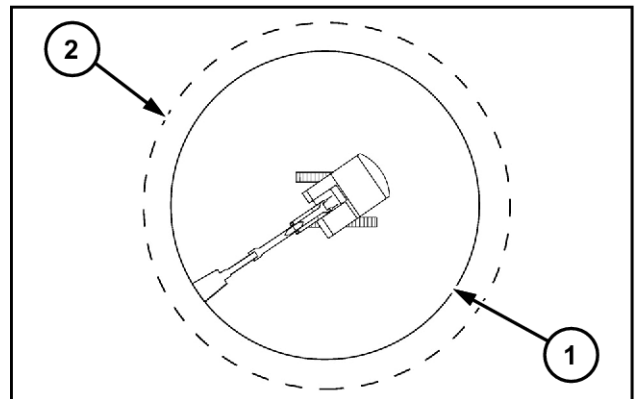

SMIL13CEX2517AB 1

(3B) Engine access door support caution - High pressure hoses and radiator

⚠ WARNING

Burn hazard!
 Before performing any service on the hydraulic system, you must allow it to cool. Hydraulic fluid temperature should not exceed 40 °C (104 °F). Failure to comply could result in death or serious injury.

W0241A



SMIL19MEX0749AA 6

⚠ WARNING

Pressurized system!
 Never attempt to drain fluids or remove filters when the engine is running. Turn off the engine and relieve all pressure from pressurized systems before servicing the machine. Failure to comply could result in death or serious injury.

W0905A

⚠ WARNING

Escaping fluid!
 Hydraulic fluid or diesel fuel leaking under pressure can penetrate the skin and cause infection or other injury. To prevent personal injury: Relieve all pressure before disconnecting fluid lines or performing work on the hydraulic system. Before applying pressure, make sure all connections are tight and all components are in good condition. Never use your hand to check for suspected leaks under pressure. Use a piece of cardboard or wood for this purpose. If injured by leaking fluid, see your doctor immediately. Failure to comply could result in death or serious injury.

W0178A

Location: this signs is located on the engine access door support.

Quantity: 1

Part number: 91MJ-07111

This sign warns you not to loosen the high pressure hoses, not to touch the radiator, and not to remove the radiator cap before the temperature of the cooling system drops. Start working after the cooling system is sufficiently cooled down.

(21) Frame general warning

Cab location: this sign is located on the right-hand side of the engine hood.

Canopy location: this sign is located on the right-hand side of operator's compartment.

Quantity: 1

Part number: 97MJ-04100

This sign warns you to refill the recommended hydraulic oil up to the specified level.

When lift the excavator, ensure that the wire rope is proper size. Follow the instructions in this manual.

This sign indicates that you always need to read the operator's manual before you transport the machine.

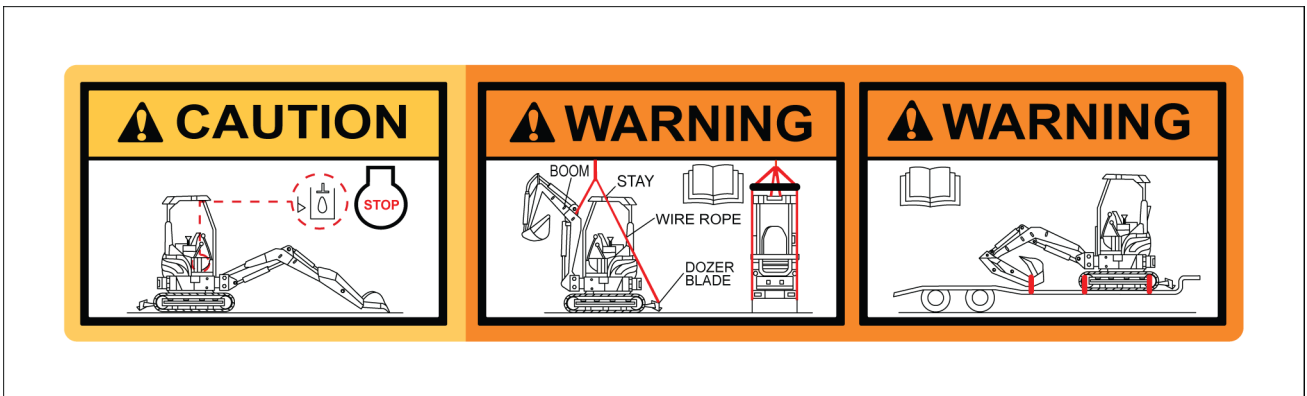

SMIL19MEX0732EA 28

(22) Machine control pattern

WARNING

Unexpected machine movement!
Pilot controls have two different machine control patterns. Before you operate the machine, check which pattern is active.
Failure to comply could result in death or serious injury.

W1577A

The machine control pattern can easily be changed to the "ISO type" or to the "SAE type" by changing the position of the lever-pattern.

How to use:

1. Move the lever to the "ISO" or "SAE" position.

Location: this sign is located on the left-hand side of the upper structure.

Quantity: 1

Part number: 91MK-07381

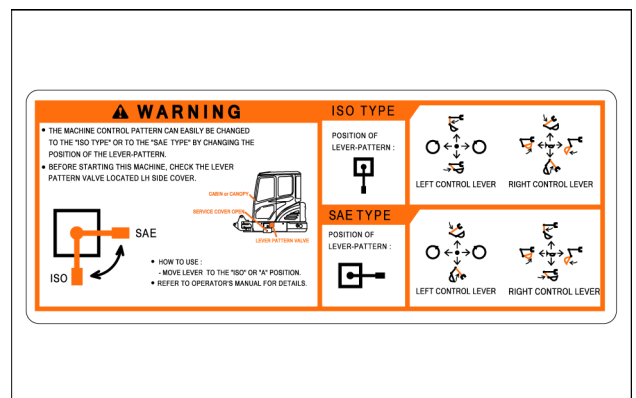

SMIL19MEX0825AA 29

3 - CONTROLS AND INSTRUMENTS

Right-hand control lever:

5. The boom lowers.
6. The boom raises.
7. The bucket retracts (filling).
8. The bucket extends (dumping).

NOTE: the movement speed of the boom or of the bucket depends on the control lever tilt angle. In the intermediate position two movements can be obtained simultaneously.

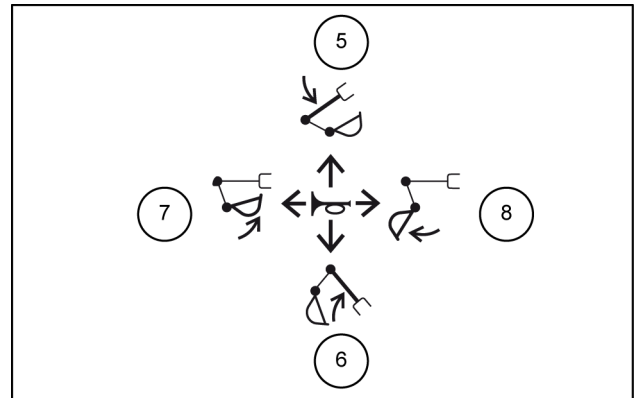

SMIL16MEX3076AB 4

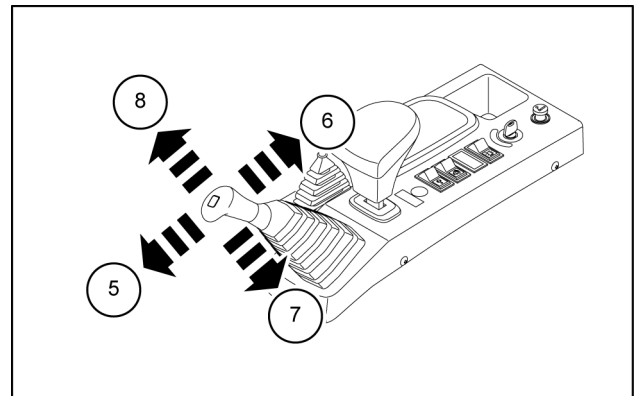

SMIL16MEX0368AB 5

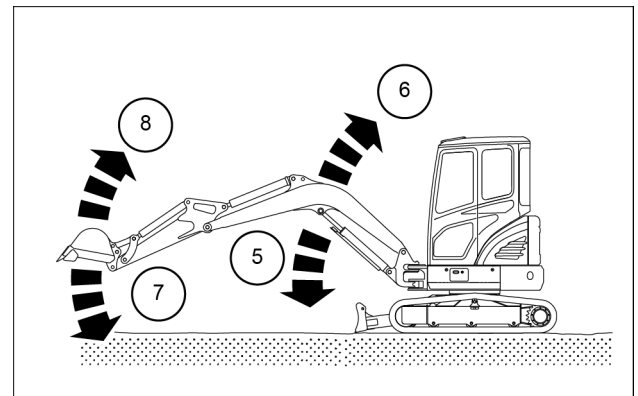

SMIL16MEX0369AB 6

Windshield washer reservoir

This reservoir, located in the left-hand side of the cab, is equipped with an electric pump which is operated from the wiper and washer switch.

NOTICE: never operate the windshield washer control when the reservoir is empty. This could cause damage to the electric pump.

Remove the cap to add windshield washing fluid.

NOTICE: in cold weather, add anti-freeze to the windshield washer water.

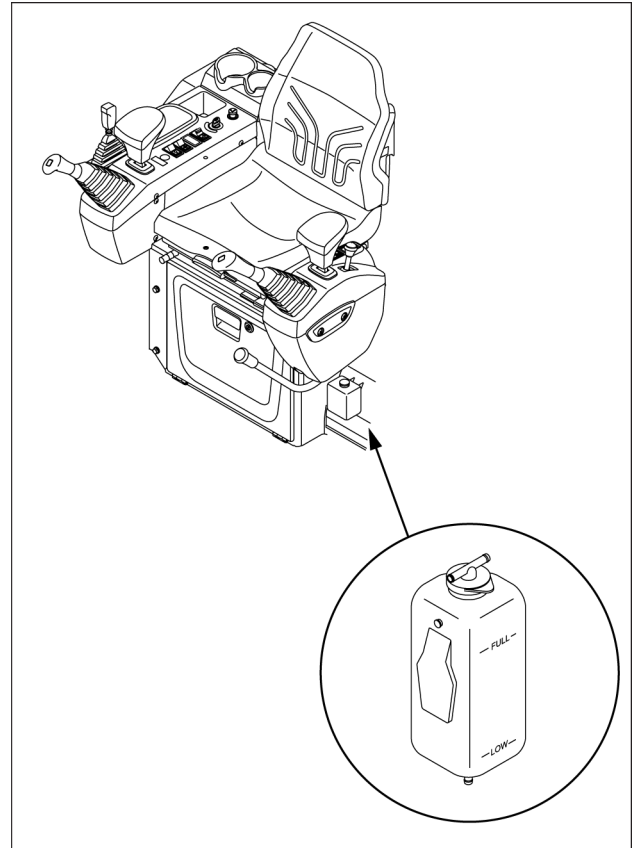

SMIL19MEX0779BA 1

Ventilation and heating

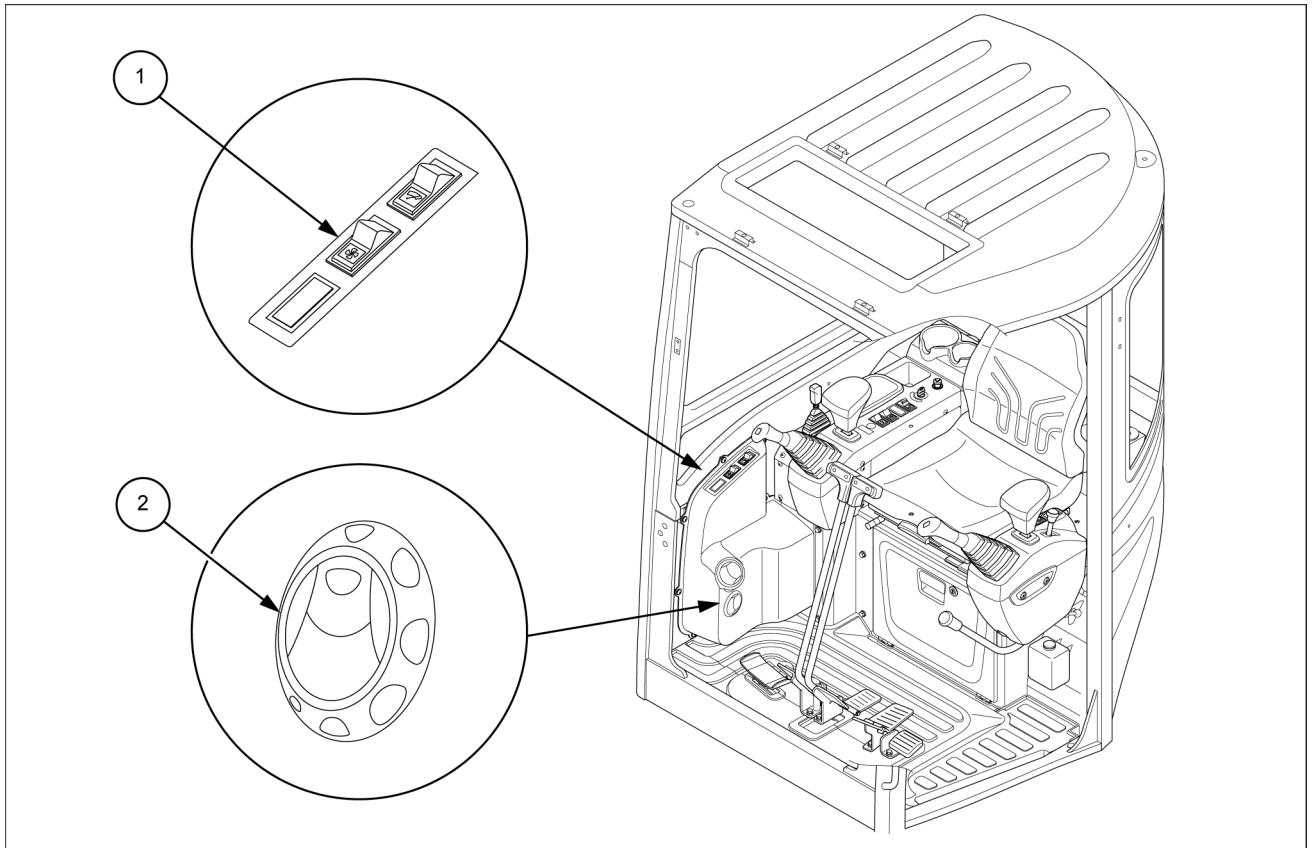

SMIL19MEX0793FB 1

The switch **(1)** activates two different speeds of ventilation.
The first step activates the low fan speed of ventilation.
The second step activates the high fan speed of ventilation.

The outlet control louvers **(2)** allows the operator to control the direction of air.
The outlet control louvers can be closed or open.

(6) Pre-set scan (SCAN) / Best Station Memory (BSM) button

Pre-set scan (SCAN).

Press the SCAN button **(A)** momentarily to scan the 6 pre-set station stored the memories on each band (AM/FM).

The unit will stop at each pre-set station (the pre-set number on the LCD screen will flash during pre-set scan operation) and remain on the selected frequency.

Press the SCAN button **(A)** momentarily again to remain on the station currently being heard.

Best station memory (BSM)

Press the BSM button **(A)** for longer than **2 s** to activate the BSM tuning feature which will automatically scan and enter each station into memory.

If you have already set the pre-set memories to your favorite stations, activating the BSM tuning feature will erase those stations and enter the new ones.

This BSM feature is most useful when traveling in a new area where you are not familiar with the local stations.

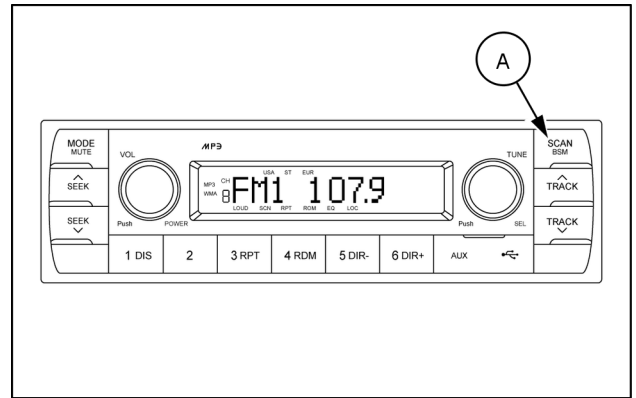

SMIL17MEX2806AA 8

Battery disconnect switch

The battery disconnect switch is located in the engine compartment. Open the engine access door to access to the battery disconnect switch.

The battery disconnect switch allows to cut off any power supply in the electrical system of the machine.

NOTE: when the switch is turned to OFF position, all electrical circuits are cut off and the stations stored on the radio presets and the time set for the clock will be cleared.

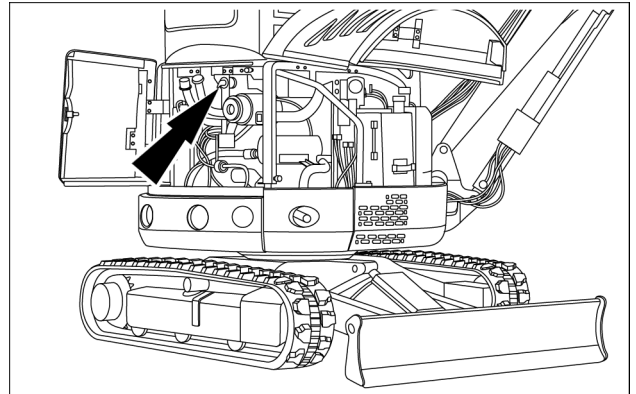

SMIL16MEX0435AA 1

Place the battery disconnect switch in the **(I)** position during normal operation.

Place the battery disconnect switch in the **(O)** position only during the following operations:

- Battery removal
- Electrical system connector removal
- Electrical system service
- Long-term storage
- As required for inspections and repairs
- Welding

NOTICE: never turn the battery disconnect switch to **(O)** position with the engine running. This could damage the electrical system.

NOTICE: never turn the battery disconnect switch to **(O)** position within **3 min** after the starter key is turned off. The machine control system and the engine control system will be damaged.

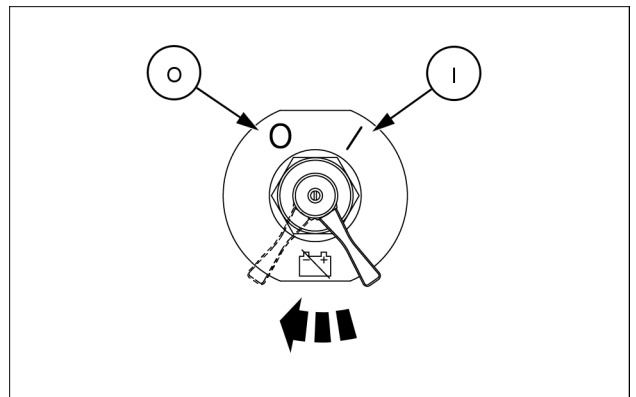

SMIL16MEX0410AA 2

Operating the machine

⚠ WARNING

Misuse hazard!

Follow the operating instructions in this chapter. Any other practice that has not received the prior approval of the manufacturer is considered to be strictly forbidden.

Failure to comply could result in death or serious injury.

W0281A

⚠ WARNING

Hazard to bystanders!

Always know the location of all workers in your area. Warn them before you start working on the machine. Always keep all unauthorized bystanders clear of the area.

Failure to comply could result in death or serious injury.

W0176A

- Before you operate the machine, take notice of the job site ground conditions and characteristics. Take notice of the local climate.
- Inspect the job site for potential risks before operating the machine. Holes on working site, obstructions and hazardous materials such as debris are subject to cause serious accident.
- Pay attention to location of pipes and cables before commencing work. Electric cables, gas pipes, water pipes and underground installations may cause serious injury. If the work takes place adjacent to high voltage power lines make sure to check the following work range:
Less than **57000 V**: **4 m (13.1 ft)**
57000 V or more: **5 m (16.4 ft)**
- Sit on the operator's seat, adjust it so as to be able to easily reach the console, and then fasten the seat belt.
- Check that the cab door is tightly secured at position of open or close.
- Sound the horn to warn other workers in the proximity of the machine.
- Start up the engine.
- Check all the indicator lights and gauges are operating properly.
- Push the safety lock lever forward.

NOTICE: *perform the following operations to avoid damage to the machine.*

- Do not use weight of the machine as an impact force for excavation.
- Do not use traveling force of the machine for excavation.
- Avoid abrupt change of swing direction when swinging the upper structure.
- Never hit or push objects with side of the bucket. Do not sweep ground with the bucket to level rubbles.
- Open and close the bucket for several times to loosen soil and mud when soil and mud are tightly packed in the bucket.
- After work, remove mud from the machine and clean it.

Do not let oil, fuel, solvents, etc., come in contact with rubber shoes. If this happens, wipe off tracks with a cloth immediately.

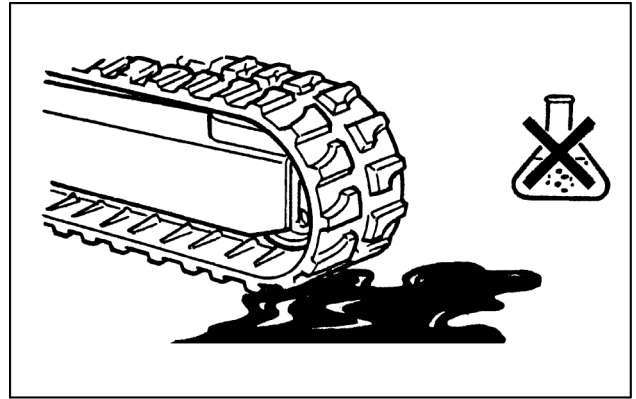

LEL11E0261AA 3

Do not enter such hot places as an open-air fire, or a steel plate left in the open sun.
Do not work in asphalt leveling.

When storing the machine for a long period (more than three months), keep it in a closed room where it will not be exposed to direct sunshine or rain.

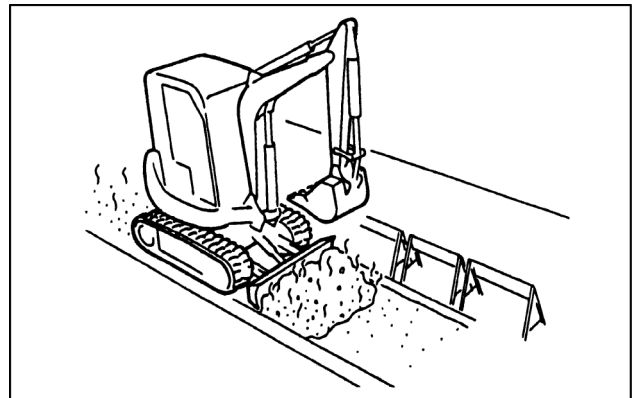

LEL11E0262AA 4

When the machine travels only on one side of the track, and keeps the other side floating, the track may come off of the rollers or get damaged.

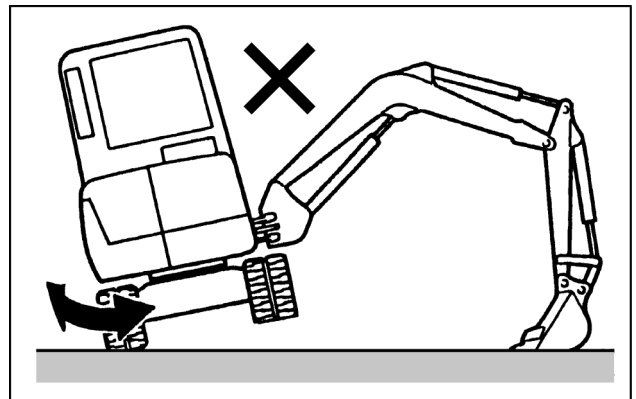

LEL11E0263AB 5

Precautions for use

Use care of the following when working.

Rubber tracks slip easily on icy surfaces.
Take the necessary safety precautions.

Avoid making a spin turn on concrete surfaces.

Avoid abrupt changes of direction as this will cause an early wear or damage of the rubber tracks.

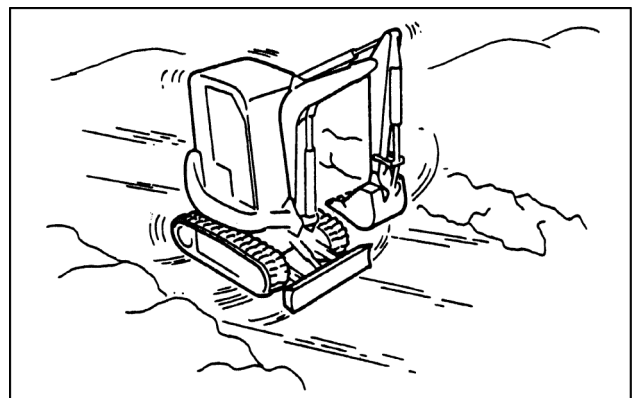

LEL11E0264AA 6

Parking the unit

Parking the machine

⚠ WARNING

Fall hazard!

Jumping on or off the machine could cause an injury. Always face the machine, use the handrails and steps, and get on or off slowly. Maintain a three-point contact to avoid falling: both hands on the handrails and one foot on the step, or one hand on the handrail and both feet on the steps. Failure to comply could result in death or serious injury.

W0141A

- Always park the machine on a level and firm ground.
- Orient the upper structure frame parallel to the undercarriage. The front equipment shall be positioned on the same side of the blade, as indicated in the picture.
- Align the front equipment parallel to the upper structure.
- Lower the bucket to the ground.
- Lower the dozer blade to the ground.

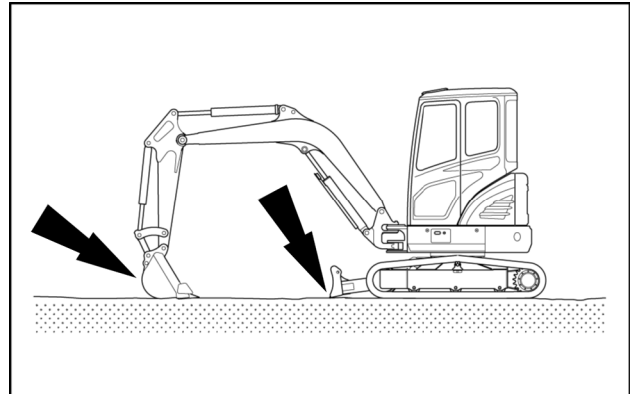

SML16MEX0040AA 1

- Move both travel control levers (1) to the neutral position.
- Set the throttle lever (2) to LOW IDLING.

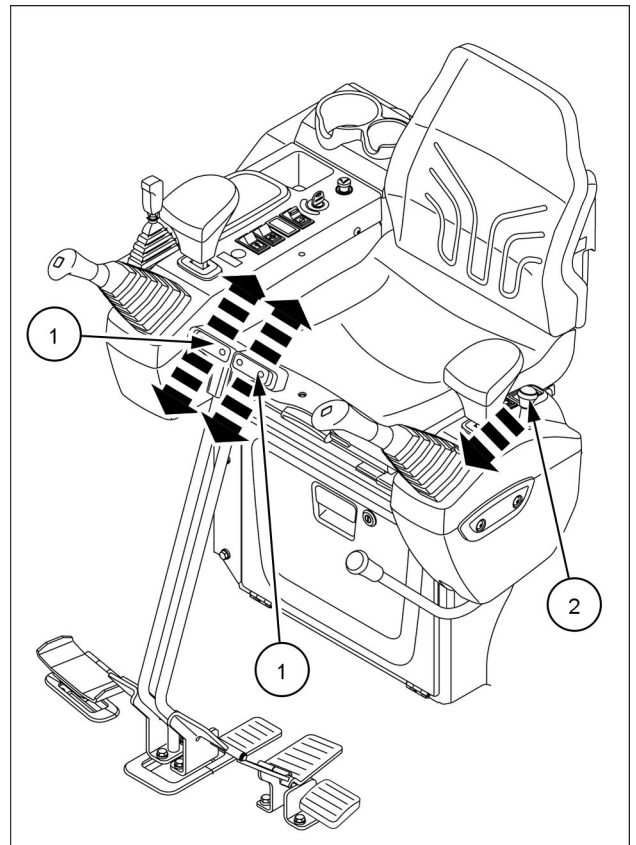

SML19MEX0792BA 2

CLICK HERE TO **DOWNLOAD** THE COMPLETE MANUAL

- Thank you very much for reading the preview of the manual.
- You can download the complete manual from: www.heydownloads.com by clicking the link below



- Please note: If there is no response to CLICKING the link, please download this PDF first and then click on it.

CLICK HERE TO **DOWNLOAD** THE COMPLETE MANUAL

6 - MAINTENANCE

General information

Basic instructions

⚠ WARNING

Improper operation or service of this machine can result in an accident.
If you do not understand a maintenance procedure, or doubt your ability to perform a maintenance procedure correctly, see your authorized dealer.
Failure to comply could result in death or serious injury.

W0157A

⚠ WARNING

Improper operation or service of this machine can result in an accident.
Raised equipment or machine movement without an operator can cause serious injury. Always do the following before performing any maintenance:
Park the machine on flat, level ground.
Lower the attachment to the ground.
Shut down the engine and remove the ignition key.
Lock the tracks.
Failure to comply could result in death or serious injury.

W0944D

⚠ WARNING

Falling object hazard!
Risk of injury from **FALLING ENGINE HOOD**. Latch the hood in the fully open position prior to working within the engine compartment.
Failure to comply could result in death or serious injury.

W1090B

NOTICE: be sure all the service operations in this section are carried out punctually at the intervals given, in order to ensure optimum performance levels and maximum safety when using the machine.

NOTICE: while any company can perform necessary maintenance or repairs on your equipment, CASE CONSTRUCTION strongly recommends that you use only authorized CASE CONSTRUCTION dealers and products that meet given specifications. Improperly or incorrectly performed maintenance and repair voids the equipment warranty and may affect service intervals.

- Respect the maintenance intervals by checking the hour meter every day. Before starting maintenance, park the machine on flat, firm ground, away from any obstacles, with the arm retracted and the bucket on the ground. Lower the dozer blade (if equipped) until it rests on the ground. Unless otherwise specified, all maintenance operations must be carried out with the engine stopped and the key removed from the starter switch. Wait for all circuits to cool down before starting work.
- Clean the grease fittings before lubrication. Clean around plugs and filler holes before adding fluid. No dust or dirt must enter the components or the circuits. Wear suitable clothing and remember to use the necessary safety equipment.
- When carrying out service work on the machine, place a "Do not operate" tag on the instrument panel. Never climb down from the operator's compartment leaving the engine running.
- Remove the necessary lower panels during maintenance of certain machine components. Make sure the lower panels are properly closed before operating the machine.

Any modification to the machine without prior authorization could cause serious injury. Do not make any modifications without authorization. Consult your CASE CONSTRUCTION Dealer.

NOTICE: if you use your machine in particularly harsh conditions (dusty or corrosive atmosphere, etc.), the servicing intervals should be reduced accordingly.

NOTICE: take particular care to replace all filters regularly. Clean filters mean longer engine running life.

5. Operate the dozer blade control lever a dozen times approximately.

NOTE: *this procedure does not completely release the pressure, so when operate on the hydraulic system, loosen the connections slowly and do not stand in the direction where the oil drains out.*

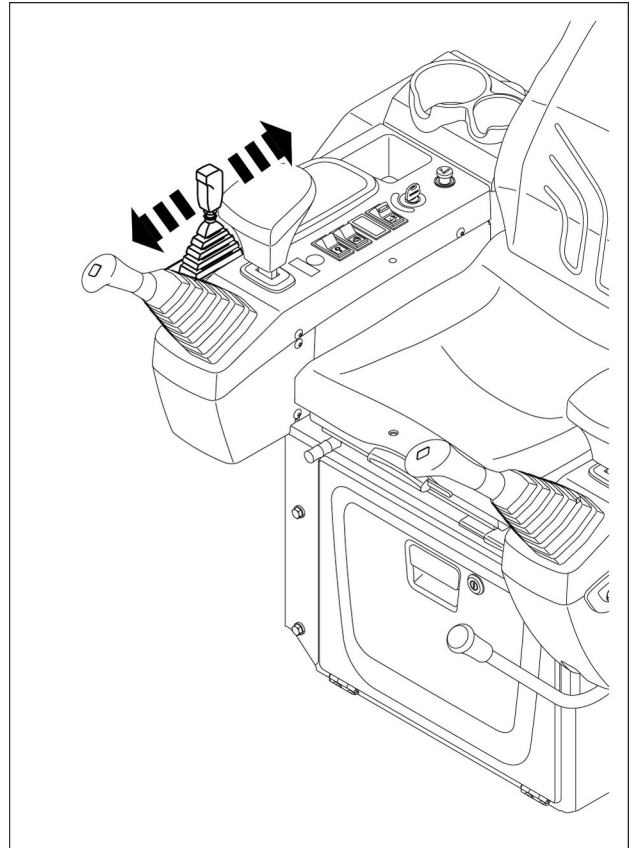

SMIL19MEX0790BA 3

6. Operate the travel levers from front to rear a dozen times approximately.

NOTE: *this procedure does not completely release the pressure, so when operate on the hydraulic system, loosen the connections slowly and do not stand in the direction where the oil drains out.*

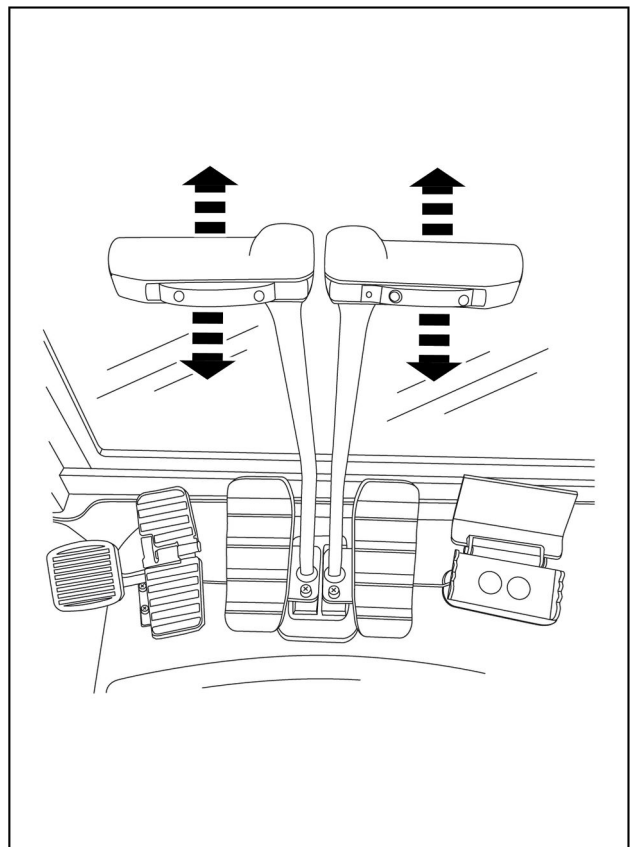

SMIL19MEX0775BA 4

Engine coolant level

⚠ WARNING

Hazardous chemicals!

Coolant can be toxic. Avoid contact with skin, eyes, and clothing. Antidotes:

EXTERNAL - Rinse thoroughly with water. Remove soiled clothing.

INTERNAL - Rinse the mouth with water. **DO NOT** induce vomiting. Seek immediate medical attention.

EYES - Flush with water. Seek immediate medical attention.

Failure to comply could result in death or serious injury.

W0282A

⚠ CAUTION

Burn hazard!

Take care if removing the filler cap while the system is hot. Before removing the cap: completely cover the cap using a thick cloth, and slowly open the filler cap to allow the pressure to escape. Do not add cold water to a hot coolant reservoir.

Failure to comply could result in minor or moderate injury.

C0031A

Check the coolant level in the reserve tank every **10 h** or every day

Fluid: **CASE AKCELA ACTIFULL™ OT EXTENDED LIFE COOLANT**

1. Park the machine on a flat and level place. Stop the engine, and remove the starter key.
2. Open the engine access door.
3. Check that the level of reserve tank is between the **FULL (1)** mark and the **LOW (2)** mark.

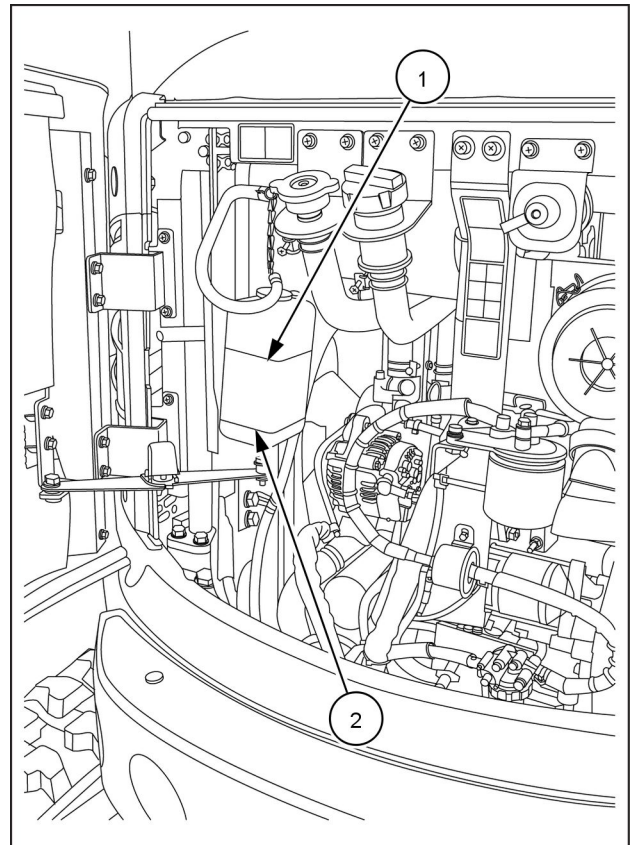

SMIL16MEX0923BA 1

Fuel tank drain

⚠ WARNING

Fire hazard!

When handling diesel fuel, observe the following precautions:

- 1. Do not smoke.**
- 2. Never fill the tank when the engine is running.**
- 3. Wipe up spilled fuel immediately.**

Failure to comply could result in death or serious injury.

W0099A

Drain water and sediment from the fuel tank every **50 h**.

NOTE: take all necessary precautions during the following operations; no foreign matter must enter the fuel system.

1. Place a receptacle of a suitable capacity under the drain plug.
2. Open the drain plug located at the bottom of the tank and drain the accumulated sediment and water.
3. After draining, close the drain plug.

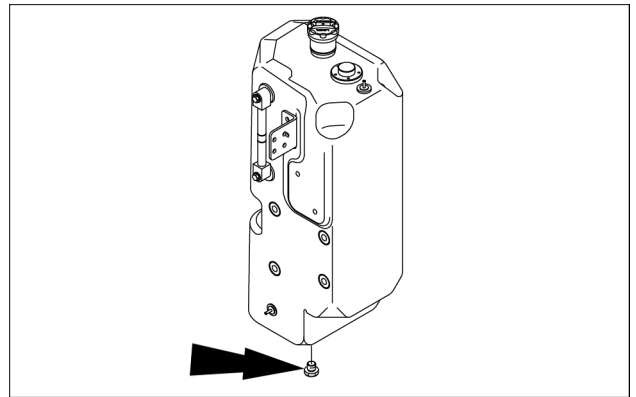

SML16MEX0416AA 1

Grease points (Boom and arm)

Grease the boom, the arm, the bucket cylinder pin (head side), and the boom swing post every **250 h** (after the break-in period).

Lubricant: **CASE AKCELA MOLY GREASE**

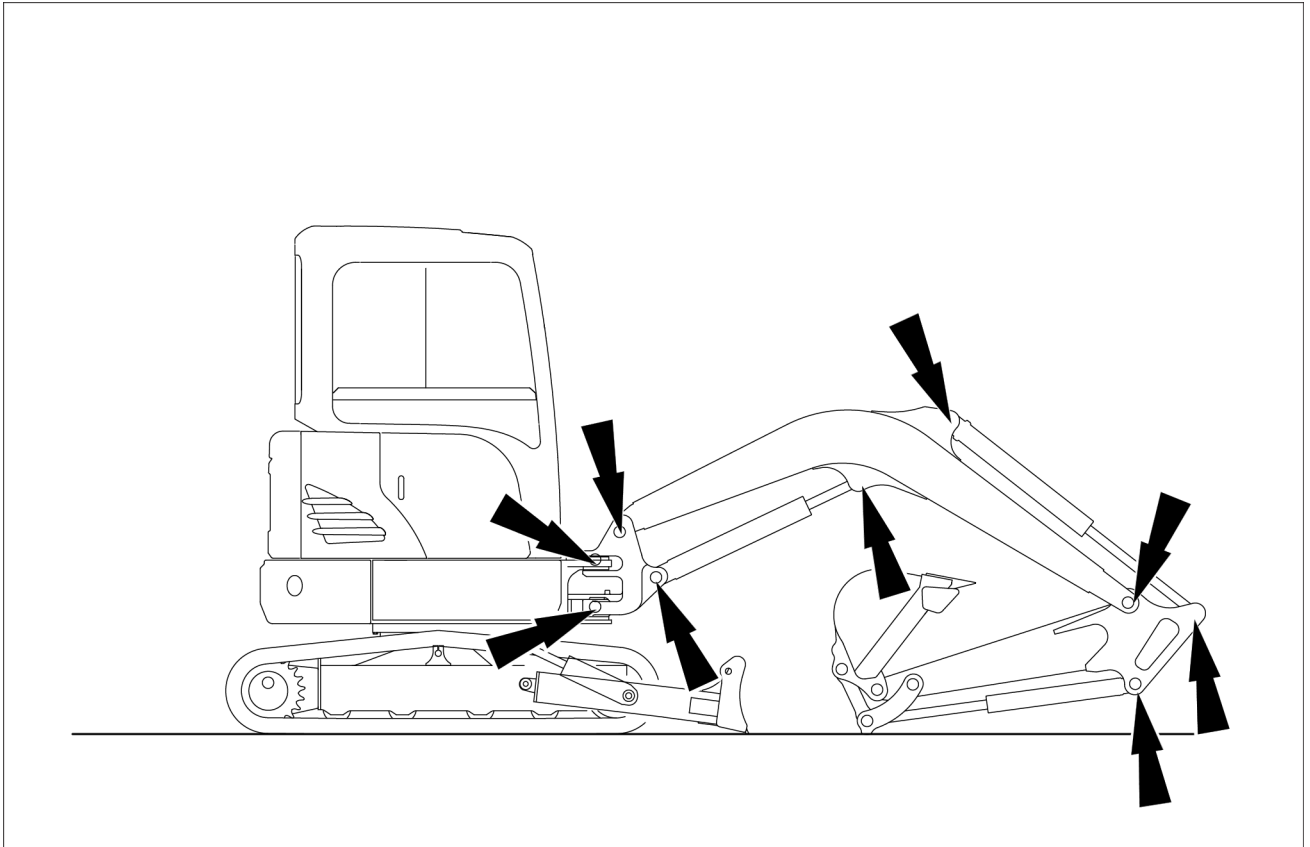

SMIL16MEX0420FA 1

Boom cylinder (head and rod side): two grease fittings

Arm cylinder pin (head and rod side): two grease fittings

Boom connection pin: one grease fittings

Boom and arm connection pin: one grease fitting

Boom swing post - upper frame connection: two grease fittings

Bucket cylinder pin (head side): one grease fitting

NOTICE: if you operate the machine in water or mud, you must lubricate the boom, the arm, the swing system, and the bucket cylinder pin (head side) every **10 h**.

3. Loosen the nut positioned on the filter body.
4. Pull out the pilot line filter element and clean the filter housing.
5. Install the new filter and tighten.

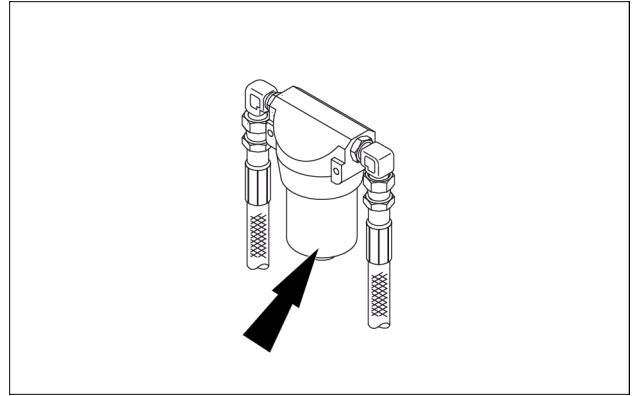

SML16MEX0441AA 2

4. Place a container with a capacity of **30 L (7.9 US gal)** under the drain plug. Loosen the drain plug at the bottom of the hydraulic oil tank.
5. When the hydraulic oil is drained, clean the hydraulic oil suction filter, refer to page **6-58**.
6. Install the drain plug.
7. Add new hydraulic oil to the tank.
8. Tighten the filling cap on the hydraulic oil tank.
9. Using a solvent, clean the periphery of the air bleed plug at top of the hydraulic pump. Loosen the air bleed plug. If any fluid comes out, remove the plug, and fill the pump with new clean hydraulic fluid.
10. Tighten the air bleed plug on the hydraulic pump.
11. Start the engine, and run it with no load for about **5 min**.
12. Move each control several times to remove all air from the system.
13. Park the machine at the specified position, and then stop the engine.
14. Check the oil level of the hydraulic tank, refill it with oil as necessary. Check that there are no bubbles in the hydraulic tank.
15. Loosen the air bleed plug on the pump, and check that air free fluid comes out from the bleed port.

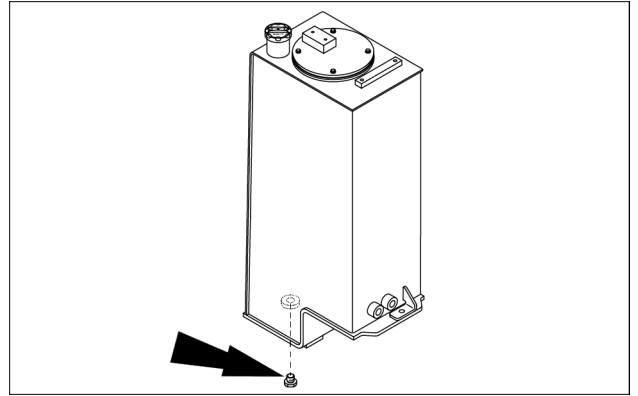

SMIL16MEX0437AA 2

Fuse and relay locations

Fuses

To access the fuse box (1), open the door (2) located below the operator's seat.

The fuse box cover indicates the function and amperage of each fuse.

NOTICE: before changing fuses or relays, turn the starter key to the OFF position.

NOTICE: never replace a fuse with a fuse of a different amperage.

NOTE: use the provided fuse puller to remove and install the fuses.

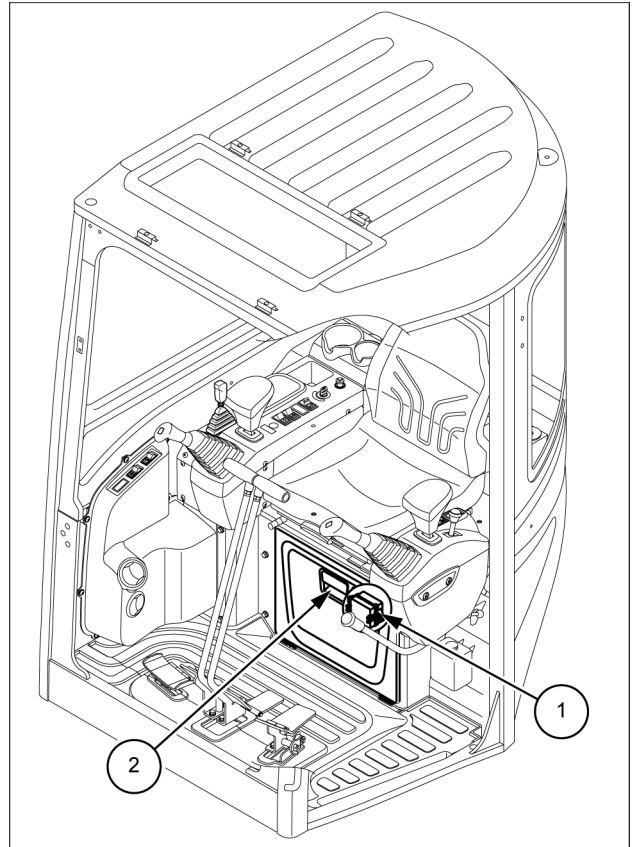

SML16MEX0372BB 1

8 - SPECIFICATIONS

Machine specifications

Engine

Model	Kubota D1305
Type	4-cycle vertical overhead valve, diesel fuel
Cooling method	Water cooling
Number of cylinders and arrangement	3 cylinders, in-line
Firing order	1 - 2 - 3
Combustion chamber type	Swirl chamber type
Cylinder bore x stroke	78 mm (3.07 in) x 88 mm (3.46 in)
Piston displacement	1261 cm³ (77 in³)
Compression ratio	24 : 1
Rated gross horse power (SAE J1995)	18.5 kW (25.2 Hp) at 2400 RPM
Maximum torque at 1600 RPM	81.4 N·m (60 lb ft)
Engine oil quantity	5.7 L (1.5 US gal)
Dry weight	102 kg (225 lb)
High idling speed	2350 – 2400 RPM
Low idling speed	1400 – 1450 RPM
Rated fuel consumption	192 g/Hp·hr at 2400 RPM (257 g/kW·hr at 2400 RPM)
Starting motor	12 V, 1.4 kW
Alternator	12 V, 40 A
Battery	1 x 12 V x 58 A·h

Main pump (P1 / P2)

Type	Variable displacement tandem axis piston pumps
Capacity	2 x 12 cm³/rev (0.7 in³/rev)
Rated oil flow	2 x 27.6 L/min (7.3 US gpm)
Rated speed	2300 RPM

Gear pump / Pilot pump (P3 / P4)

Type	Fixed displacement gear pump single stage
Capacity	8.5 cm³/rev (0.5 in³/rev) / 4.5 cm³/rev (0.3 in³/rev)
Rated oil flow	19.6 L/min (5.2 US gpm) / 10.4 L/min (2.7 US gpm)

Main control valve

Type	Sectional, 9 spools (12 blocks)
Operating method	Hydraulic pilot system
Main relief valve pressure: P1, P2 / P3	21581 – 17168 kPa (3130 – 2490 psi)
Overload relief valve pressure	23511 kPa (3410 psi)

Auxiliary hydraulic circuits

First auxiliary hydraulic circuits (1-way or 2-way)

The machine can be provided with a first auxiliary hydraulic circuit. This type of circuit can be alternatively set as a single acting circuit (1-way) or as a double-acting hydraulic circuit (2-way).

- The single-acting hydraulic circuit is intended for attachments such as a hydraulic breaker.
- The double-acting hydraulic circuit is intended for attachments such as auger, clamshell or nibbler.

Hydraulic switching

The selection between the single-acting hydraulic circuit and the double-acting hydraulic circuit is done acting on the bolt located on the three-way valve near the hydraulic oil tank.

To select the hydraulic circuit perform the following operations.

Park the machine on a flat and level place. Stop the engine, and remove the starter key.

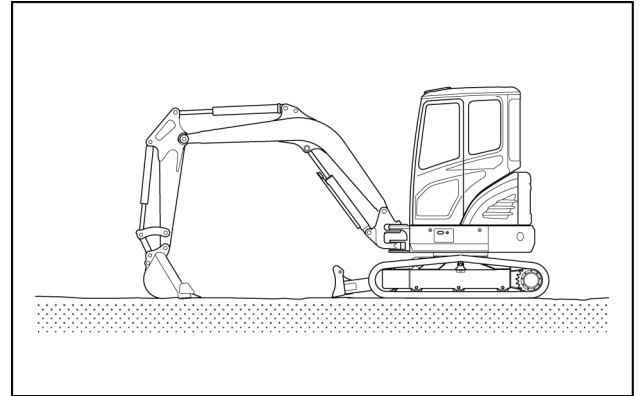

SMIL16MEX0040AA 1

Open the side hood to access to the three-way valve.

Use a wrench to turn the bolt of the three-way valve and select the hydraulic circuit.

- **(1)**: 1-way flow, single-acting hydraulic circuit
- **(2)**: 2-way flow, double-acting hydraulic circuit

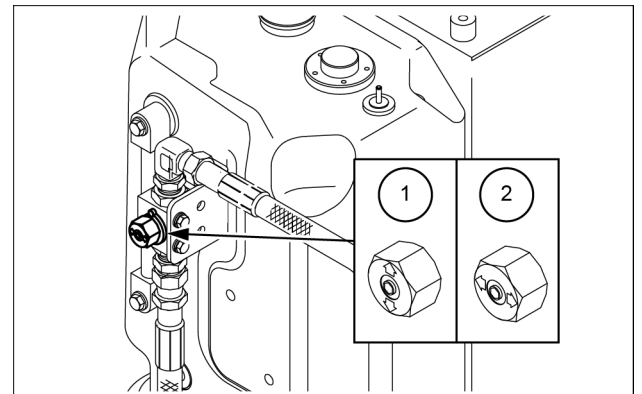

SMIL16MEX0460AB 2

Pin, bushing and insert kit
Unit weight
16 kg (35.3 lb)

NOTE: for all direct fit and pin-grabber coupler application.

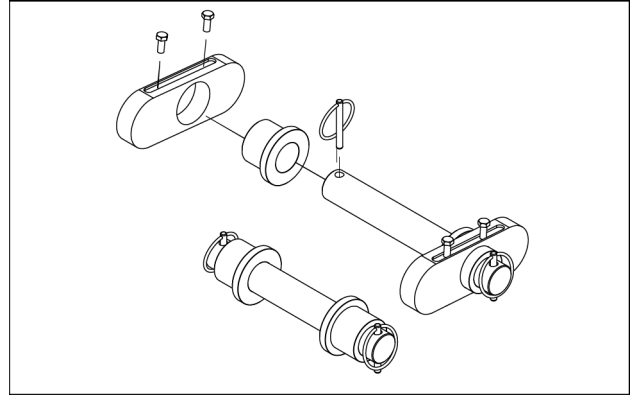

SMIL17MEX2838AA 20

Quick coupling system - Klac type

⚠ WARNING

Crushing hazard!

Never put your hands inside the quick coupler mechanism. Turn off the engine and wait for all movement to stop.

Failure to comply could result in death or serious injury.

W1542A

⚠ WARNING

Hazard to bystanders!

ALWAYS make sure the work area is clear of bystanders and domestic animals before starting this procedure. Know the full area of movement of the machine. Do not permit anyone to enter the area of movement during this procedure.

Failure to comply could result in death or serious injury.

W0245A

NOTICE: *the quick coupler extends the length of the arm. Make sure to check the operating range of the coupled attachment in order to avoid risk of striking the cab or the machine frame.*

NOTICE: *never operate with a quick-coupled hydraulic breaker for an extended period of time, in order to reduce the risk of premature wear, failures or breakage of the quick coupler. Never use the breaker as a lever, as this subjects the quick coupler cylinder to stress.*

NOTICE: *be sure to read and understand the Operator's Manual of the quick coupler to proper installation, usage and maintenance.*

5. Install the locking pin **(2)** and the retainer pin **(4)**.
6. Remove the release bar **(3)**.
7. Get into the machine, fasten the seat belt and start the engine.

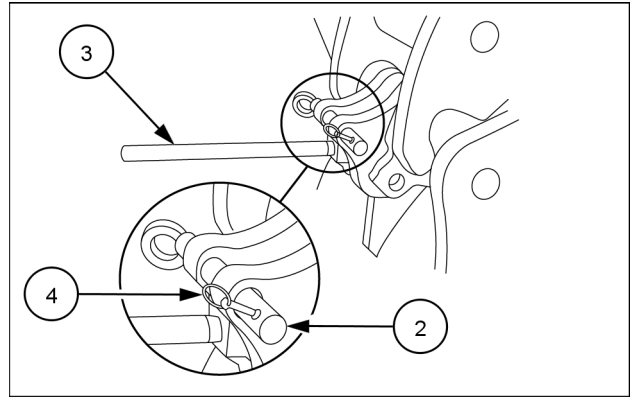

SMIL17MEX2819AA 7

8. Retract the bucket cylinder.
9. Move the arm away from the attachment pin until the coupler hooks are clear of the attachment.

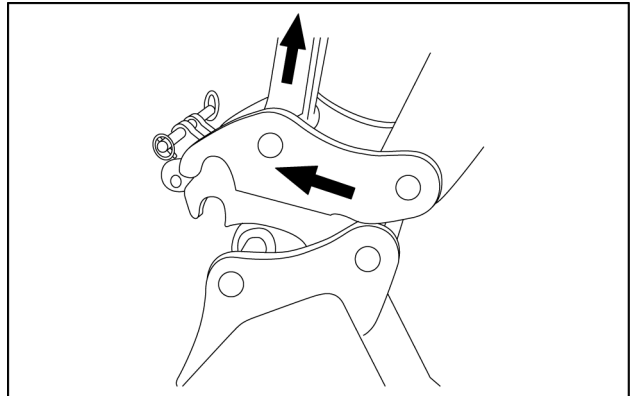

SMIL17MEX2820AA 8

Load handling

⚠ WARNING

Crushing hazard!

During load handling operations, it is very important to adhere strictly to the instructions given in this manual and local legislation.

Failure to comply could result in death or serious injury.

W0257A

⚠ WARNING

Improper operation or service of this machine can result in an accident.

When lifting a load the machine must be equipped with:

- safety valves,
- an overload indicator,
- a load fixing point,
- a load handling chart corresponding to the type of machine and to its attachment.

Failure to comply could result in death or serious injury.

W1168A

NOTICE: *the machine has been specifically designed to perform digging/loading works. If you handle suspended loads with this machine, you must equip the machine with the appropriate optional equipment including safety valves, load handling eye, load lifting table, and an overhead warning alarm. Make sure to handle suspended loads following strictly all current Regulations regarding this application, as well as the rules described in the SAFETY INFORMATION chapter.*

NOTICE: *make provision for lifting devices that comply with current Regulations for lifting applications. Make sure that the lifting devices (hooks, chains etc.) are in perfect conditions without any sign of excessive wear. Make sure to use self-locking hooks in order to avoid unintended opening during lift operation. The lifting devices can be used exclusively for the lifting of parts not anchored to the ground. Never use them for towing operations, uprooting or tearing apart.*

NOTICE: *a suspended load can swing freely, and it can thus hit persons or the cab of the machine. Make sure that all bystanders are moved away from the field of action of the machine, and make sure to handle the load slowly. If the load starts to swing during the handling, lower it slowly to the ground and sling it in a way that avoid unintended swinging as much as possible.*

CLICK HERE TO **DOWNLOAD** THE COMPLETE MANUAL

- Thank you very much for reading the preview of the manual.
- You can download the complete manual from: www.heydownloads.com by clicking the link below



- Please note: If there is no response to CLICKING the link, please download this PDF first and then click on it.

CLICK HERE TO **DOWNLOAD** THE COMPLETE MANUAL