

550G CRAWLER
Operator's Manual

Bur 9-26012



CLICK HERE TO **DOWNLOAD** THE COMPLETE MANUAL

- Thank you very much for reading the preview of the manual.
- You can download the complete manual from: www.heydownloads.com by clicking the link below



- Please note: If there is no response to CLICKING the link, please download this PDF first and then click on it.

CLICK HERE TO **DOWNLOAD** THE COMPLETE MANUAL

SAFETY/DECALS/HAND SIGNALS



SAFETY RULES



Most accidents involving machine operation and maintenance can be avoided by following basic safety rules and precautions. Read and understand all the safety messages in this manual, the safety manual, and the safety decals on the machine before you operate or service the machine. See your dealer if you have any questions.

READ THIS MANUAL COMPLETELY and make sure you understand the controls. All equipment has a limit. Make sure you understand the speed, brakes, steering, stability and load characteristics of this machine before you start to operate.

Do not remove this manual or the safety manual from the machine. See your dealer for additional manuals.

The safety information given in this manual does not replace safety codes, insurance needs or, federal, state, and local laws. Make sure your machine has the correct equipment according to these rules or laws.



A25837

IMPORTANT: *Safety messages in this section point out situations which can be encountered during the normal operation and maintenance of your machine. These safety messages also give possible ways of dealing with these conditions.*

NOTE: *Additional safety messages are used in the text of the manual to show specific safety hazards.*

A



WARNING

DO NOT MODIFY ROPS IN ANY MANNER. UNAUTHORIZED MODIFICATIONS SUCH AS WELDING, DRILLING, CUTTING OR ADDING ATTACHMENTS COULD WEAKEN THE STRUCTURE AND REDUCE YOUR PROTECTION. REPLACE ROPS IF SUBJECTED TO ROLLOVER OR DAMAGE. DO NOT ATTEMPT TO REPAIR. SEE OPERATOR'S MANUAL FOR COMPLETE INSTRUCTIONS AND INSPECTION REQUIREMENTS.

321-4192

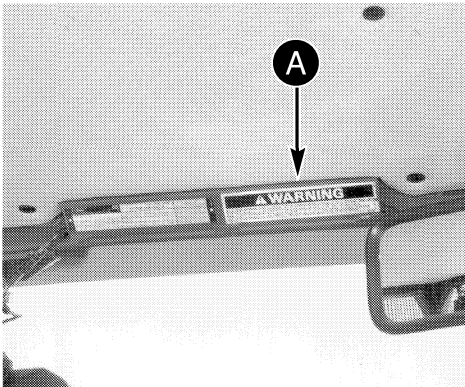

A25788

B



WARNING

WRONG JUMPER CABLE CONNECTIONS TO STARTER TERMINALS OR SHORTING ACROSS THE STARTER TERMINALS CAN CAUSE THE MACHINE TO MOVE SUDDENLY OUT OF CONTROL. YOU CAN BE INJURED OR KILLED.

USE THE CORRECT METHOD SHOWN IN THE OPERATOR'S MANUAL TO CONNECT JUMPER CABLES TO START THE ENGINE.

321-6718

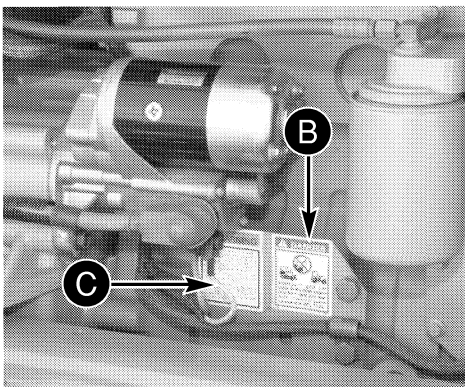

A25800

C



DANGER



Starting in gear can cause death. Start engine only from operator seat with transmission controls in NEUTRAL.

321-7040

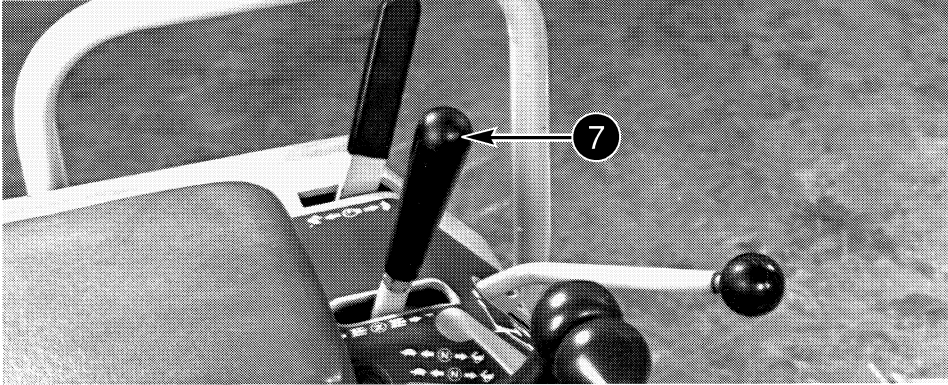

B4070591F

7. OPTIONAL DIRECTION CONTROL LEVER: This control lever has three positions (1) FORWARD, (2) NEUTRAL, and (3) REVERSE. Both tracks are controlled by this lever.

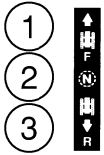

837L92

(1) FORWARD - Move the control lever forward to drive the machine forward.

(2) NEUTRAL - Pull the control lever backward to the center of the slot. This control is moved to NEUTRAL automatically when the NEUTRAL LOCK/PARKING BRAKE control is pushed down.

(3) REVERSE - Pull the control lever all the way back to drive the machine in reverse.

BACK-UP ALARM

While driving backwards a signal horn sounds with intervals.

FUEL GAUGE

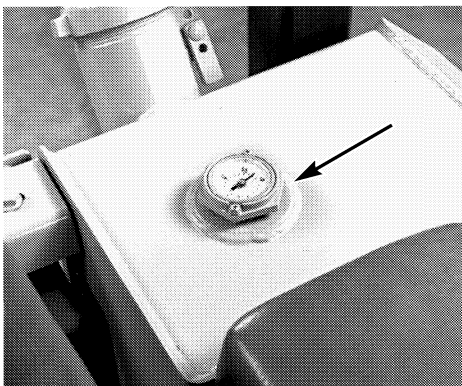

B4070891T

The fuel gauge is to the left of the operators seat. This gauge shows the amount of fuel remaining in the fuel tank.

Starting the Engine

NOTE: *If the weather is cold, if the machine has not been run for several weeks, or if the engine oil filter has been replaced, see Priming the Turbocharger Lines with Oil in this manual.*

IMPORTANT: *If this is not the machine you would normally operate, check if the machine is equipped with a foot throttle or decelerator. See Foot Throttle or Decelerator in this manual.*

1. Adjust the seat and fasten your seat belt. Make sure you can push the brake pedals completely down with your back against the seat cushion.
2. Make sure the neutral lock/parking brake control is pushed down.
3. Make sure the equipment control levers are in NEUTRAL with the equipment on the ground.
4. Select HIGH or LOW transmission range.

NOTE: *See Operating in Cold Weather in this manual for starting the engine during cold weather.*

5. Turn the key switch to the START position. If the engine starts and stops, do not engage the starter motor again until the starter motor stops turning.

NOTE: *Do not operate the starter motor more than 30 seconds at one time. Let the starter motor cool for three minutes before you engage the starter motor again. While the starter motor is engaged, white or black smoke must be seen at the exhaust pipe. If no smoke is seen, check the fuel supply.*

6. After the engine starts, check the instruments to make sure the gauge indications are correct. Run the engine at 1000 rpm until the coolant temperature is warm.

TRANSPORTING THE MACHINE



WARNING: *The machine can slip and fall from a trailer or ramp and cause injury or death. Make sure the trailer and ramp is not slippery. Remove all oil, grease, ice, etc. Carefully move the machine off or onto the trailer with the machine centered on the trailer and ramp.*

SB042

You must know the rules or laws for safety that are used in each area that you will be in. Make sure that your truck and machine are equipped with the correct safety equipment.

1. Put a block on both sides of the trailer wheels.
2. Be careful. Move the machine slowly onto the trailer.
3. Lower the blade and ripper, if equipped, to the trailer.
4. Put the neutral lock/parking brake control down.
5. Stop the engine and remove the key.
6. Put blocks at both ends of the tracks.
7. Use chains to fasten the machine to the trailer. Remove the blocks from the trailer wheels.
8. When moving the crawler off of the trailer, drive slowly and keep the machine centered on the trailer and ramp.

NOTE: *Cover exhaust pipe if machine is equipped with a turbocharger.*

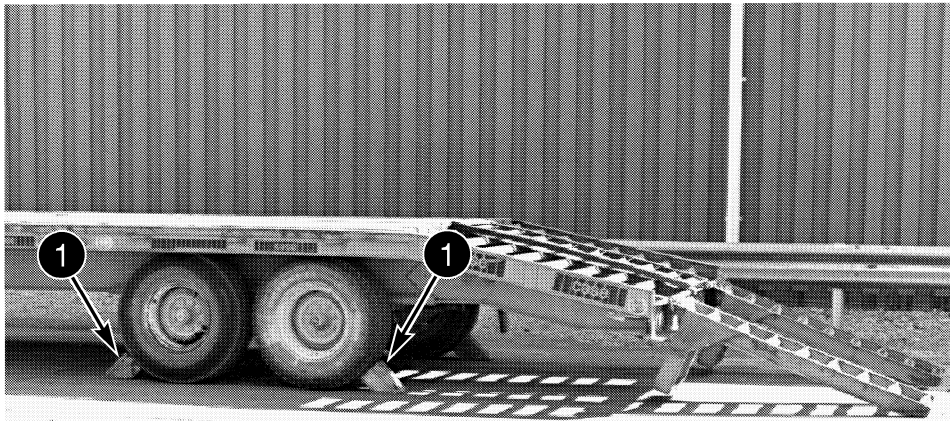

B835873F

1. BLOCKS FOR TRAILER WHEELS



WARNING: *When moving the machine on or off of the trailer, drive slowly and keep the machine centered on the trailer and ramp.*

CM113

Slot Dozing

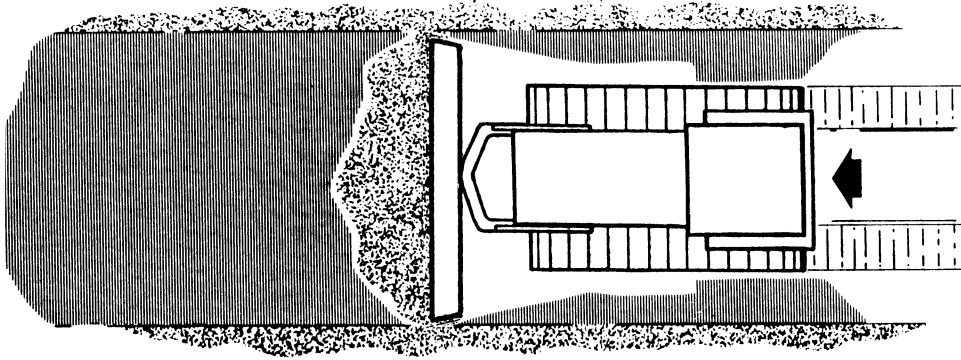

804L94

Side by Side Dozing

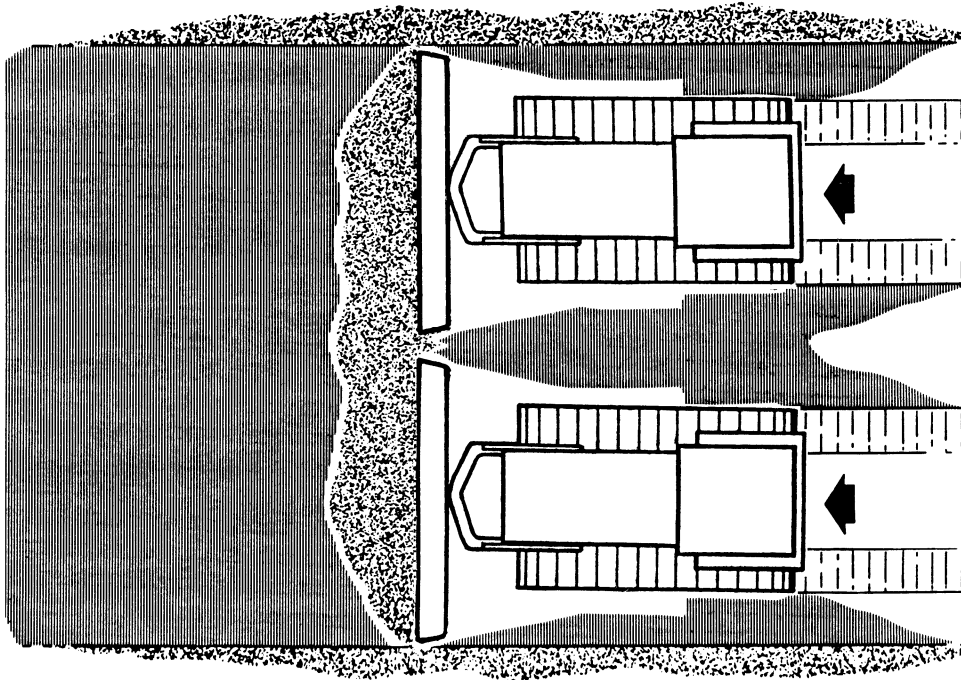

802L94

CLICK HERE TO **DOWNLOAD** THE COMPLETE MANUAL

- Thank you very much for reading the preview of the manual.
- You can download the complete manual from: www.heydownloads.com by clicking the link below



- Please note: If there is no response to CLICKING the link, please download this PDF first and then click on it.

CLICK HERE TO **DOWNLOAD** THE COMPLETE MANUAL

Factor Controlling Undercarriage Wear - Wear Factors You Can Partially Control

Speed

Unnecessary speed directly affects the wear rate on pins, bushings and sprockets. The faster the speed, the faster the wear rate. High speed reverse accelerates bushing and sprocket wear. Reverse speeds are faster than forward speeds. Wear rate is a function of speed and distance traveled, not just hours worked.

Impact

High speed will increase impact loading when there is low grouser penetration on hard surfaces or when working in rock.

Impact can cause structural problems such as bending, cracking or breakage of components. This can also affect pin and bushing retention and bushing cracking. And, if a chain is worn, can cause fractures.

Turning

Wear rate increases with increased turning. Turning increases interference loads between moving components. Turning in reverse accelerates bushing and sprocket wear due to increased loads transferred from the rotation of the bushings against the sprocket in reverse.

Track Slip

Wear rate on all components increase when tracks are slipping. Track shoe grousers are affected due to increased sliding between the grouser and the ground.

Favored Side Operation

Wear rates will increase on all components when only one side of the machine is favored. Wear increases as more power is applied to the favored side. Also, more packing and slippage will occur on the favored side that results in an increased wear rate.

Reverse Operation

Avoid excessive use of reverse operation. This is not only nonproductive use of the machine but it also accelerates bushing and sprocket wear. Most speeds are faster in reverse than forward.

Applications

Applications is often used to describe underfoot conditions. In this section application will describe what the machines doing without regarding the under foot conditions.

Dozing - This operation shifts the machine weight to the front causing a faster wear rate on the front rollers and idlers.

Ripping - This operation will shift the machine weight toward the rear causing a faster wear rate on the rear rollers. Then, during severe applications, the sprockets and track bushings wear much faster.

LUBRICATION/FILTERS/FLUIDS

GENERAL SAFETY BEFORE YOU SERVICE



WARNING: *Improper service or repair can cause injury or death. If you do not understand the service procedures for this machine, see your dealer or the service manual for this machine.*

SC021



WARNING: *Raised equipment on the machine without an operator can cause injury or death. Before you leave the operators compartment, always support or lower the equipment (backhoe, blade, boom, bucket, etc.) to the ground and stop the engine.*

SA044

Read the safety decals and information decals on the machine. Read the operators manual and safety manual. Understand the operation of the machine before you start servicing.



B801147T

Before you service the machine, put a Do Not Operate tag on the instrument panel. One Do Not Operate tag is included with your machine. Additional tags, part number 321-4614, are available from your dealer.

Use the correct safety clothing and safety equipment. Understand how to use a fire extinguisher and first aid kit.



B770996R

<p>DO NOT OPERATE</p> <p>REASON: _____</p> <p>_____</p> <p>_____</p> <p>_____</p> <p>Signed by: _____</p>	<p>DO NOT REMOVE THIS TAG!</p> <p>See Other Side</p> <p>CASE CORPORATION</p> <p><small>Case Part Number 321-4614/Printed in U.S.A</small></p>
--	---

ENGINE SERVICE

Engine Service Specifications

Oil Capacity - with Filter Change 10.4 Litres (11 U.S. Quarts)
Oil Level Check Interval Every 10 Hours of Operation or Once Each Day
Oil Change and Filter Replacement Interval Every 250 Hours of Operation
Oil Type See Engine Lubrication

Engine Oil Level

Check the engine oil level before you start the engine each day or before the start of each 10 hour shift. Always check the oil level with the engine stopped and when the machine is on level ground.

Push the engine oil level dipstick completely down and pull out before you check the oil level.

If the oil level is below the ADD mark, add oil to raise the oil level up to the FULL mark.

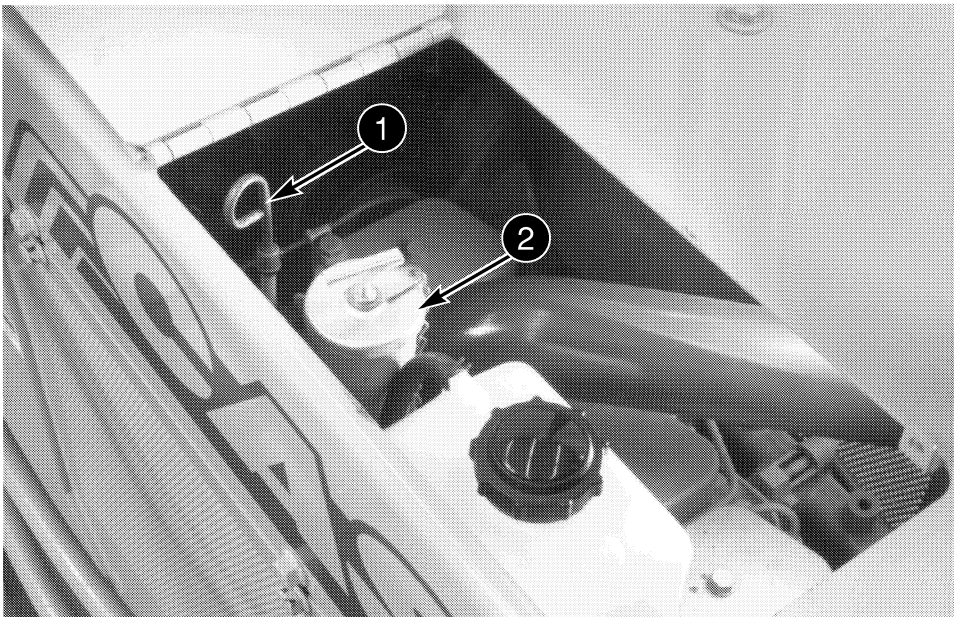

A25838A

1. ENGINE OIL DIPSTICK (NON EMISSION ENGINE)
2. ENGINE OIL FILL TUBE(NON EMISSION ENGINE)

DIESEL FUEL SYSTEM

Service Specifications

Fuel Tank Capacity	115.5 Litres (30.5 U.S. Gallons)
Interval for Draining Water from the Fuel Tank	As Required
Interval for Draining Water from First Stage Fuel Filter	50 Hours
Interval for Replacing the Fuel Filters	500 Hours
Clean Fill Cap Breather	1000 Hours

Fuel Line Shutoff Valve

Close the shutoff valve at the hand primer when the fuel filters are replaced or the fuel system is serviced. (The photo below shows a non emission engine).

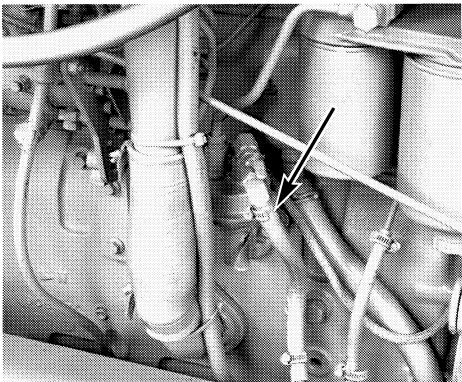

B4072091T

Filler Screen

There is a screen installed in the fuel filler pipe. If you see foreign material on the screen, remove and clean the screen in diesel fuel.



B4073591T

Fuel Gauge

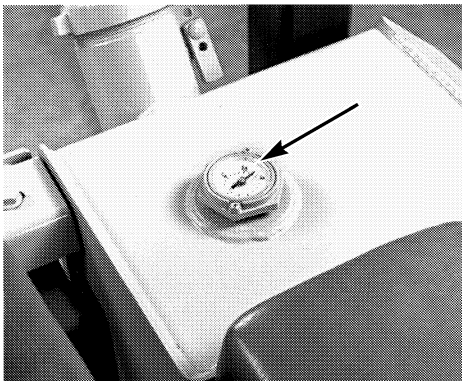

B4070891T

Oil Change, Screen and Breather Service

Change the transmission oil, clean the screen and clean the breather every 1000 hours of operation.

If possible, drain the transmission when the oil is warm. You will remove more contamination from the transmission with warm oil than with cold oil.

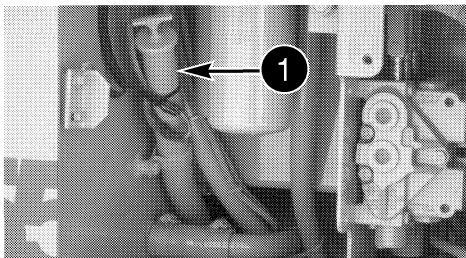

A25804

1. TRANSMISSION BREATHER

1. Remove the rear guard and have a container that will hold 30.3 litres (8 gallons). Remove the drain plug.
2. Remove the floor plate.

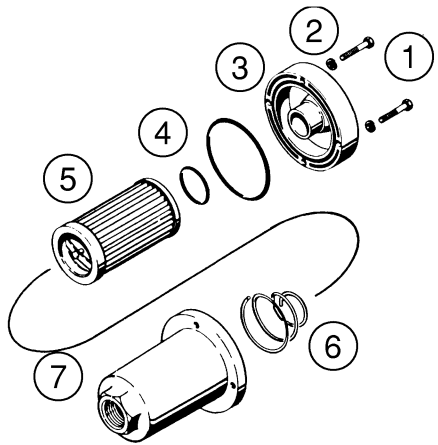

B840009R

1. CAP SCREWS (4)
2. LOCK WASHERS (4)
3. HEAD
4. O-RINGS
5. SCREEN
6. SPRING
7. HOUSING

3. Clean the housing (7) and remove the cap screws (1) and lock washers (2).
4. Remove the screen (5).
5. Clean the inside of the housing (7).
6. Clean the screen (5) with cleaning solvent.
7. Dry the screen (5) with compressed air.
8. Inspect the O-rings for damage. If necessary, install new O-rings.
9. Install the screen (5).
10. Install the lock washers (2) and cap screws (1). Tighten the cap screws (1) to 7 to 13 Nm (5 to 10 lb ft). Tighten and check the hose clamp.
11. Install the drain plug and put new oil into the transmission. Install the floor plate and access plate for the drain plug.
12. Remove and clean the dipstick breather with solvent.
13. Install the breather.
14. Replace the transmission filter.
15. Start and run the engine at idle speed for about two minutes. Operate the transmission. Check for leaks.
16. Stop the engine and check the transmission oil level.

ELECTRICAL SYSTEM

BATTERY SERVICE



WARNING: Battery acid causes severe burns. Batteries contain sulfuric acid. Avoid contact with skin, eyes or clothing. Antidote - **EXTERNAL:** flush with water. **INTERNAL:** drink large quantities of water or milk. Follow with milk of magnesia, beaten egg or vegetable oil. Call physician immediately. **EYES:** flush with water for 15 minutes and get prompt medical attention.

SB032



WARNING: When the battery electrolyte is frozen, the battery can explode if, (1) you try to charge the battery, or (2) you try to jump start and run the engine. To prevent the battery electrolyte from freezing, try to keep the battery at full charge. If you do not follow these instructions, you or others in the area can be injured.

SA033



WARNING: Sparks or flame can cause hydrogen gas in a battery to explode. To prevent an explosion, do the following:

1. When you disconnect the battery cables, always disconnect the negative (-) battery cable first.
2. When you connect the battery cables, always connect the negative (-) cable last.
3. Do not short circuit the battery posts with metal items.
4. Do not weld, grind, or smoke near a battery.

SB034

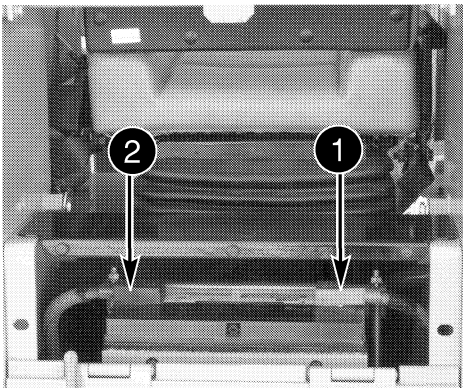

1. POSITIVE BATTERY TERMINAL
2. NEGATIVE BATTERY TERMINAL

NOTE: The electrical system in this machine is 12 volts, negative ground.

Before you service components of the electrical system, always disconnect the negative (-) battery cable.

Dirt, moisture, and corrosion on the battery will discharge the battery. Clean the battery with Case Battery Saver and Cleaner. Follow the instructions on the can.

Disconnect the alternator wires if you must run the engine with the battery wires disconnected.

Before you use an electric welder, disconnect the alternator wires.

Do not use a steam cleaner or cleaning solvent to clean the alternator.

SPECIFICATIONS

Dozer Blade Long Track and Rubber Track

Blade Height..... 762 mm (30 in)
Push Beam..... Inside
SAE Blade Capacity..... 1.07 m³ (1.4 yd³)

Tractor Dozer Long Track and Rubber Track

Overall Length with Ripper Raised..... 5.09 m (16 ft 8.3 in)
Overall Length Less "C" Frame and Blade 3.00 m (9 ft 10 in)
Maximum Shoe Width 406 mm (16 in)
Overall Width at Track with Standard Shoes 1.75 m (69 in)
Turning Clearance Circle, Pivot Turn..... 6.25 m (20 ft 6 in)

CLICK HERE TO **DOWNLOAD** THE COMPLETE MANUAL

- Thank you very much for reading the preview of the manual.
- You can download the complete manual from: www.heydownloads.com by clicking the link below



- Please note: If there is no response to CLICKING the link, please download this PDF first and then click on it.

CLICK HERE TO **DOWNLOAD** THE COMPLETE MANUAL