



**bobcat**

**2000**

**RTF™**

**S/N 15021 & Above**

# **OPERATOR'S MANUAL**



**CLARK** Melroe  
Division

CLICK HERE TO **DOWNLOAD** THE COMPLETE MANUAL

- Thank you very much for reading the preview of the manual.
- You can download the complete manual from: [www.heydownloads.com](http://www.heydownloads.com) by clicking the link below



- Please note: If there is no response to CLICKING the link, please download this PDF first and then click on it.

CLICK HERE TO **DOWNLOAD** THE COMPLETE MANUAL

3. All controls must be in the neutral position with the seat bar lowered (Fig. 5) and the brake engaged before you start the engine.
4. Keep personnel away from the work area while you are operating the forklift.
5. Fully lower the vertical mast, stop the engine and engage the brake before you leave the seat.
6. DO NOT fill the fuel tank until after the engine is stopped and is cool. The area must have good ventilation and be free of sparks or open fire (Fig. 6).
7. Before operating the Bobcat Forklift you must do the following:
  - a. Make sure the Operator's Handbook (P/N 6584796) is on the forklift and is read by the operator.
  - b. Read this Operator's Manual.

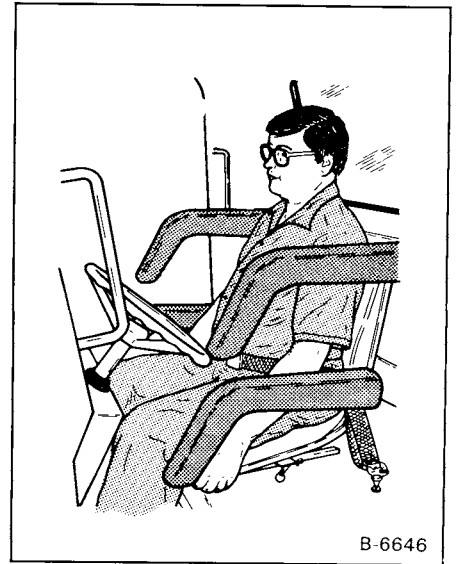

Fig. 5 Seat Bar Lowered

### MACHINE SIGNS (DECALS)

Follow the instructions on the machine signs (decals) that are on the Bobcat Forklift in the locations shown in figures 7 and 8. You must replace any damaged decals and be sure they are in the correct locations. Decals are available from your Bobcat dealer.

### LEARNING THE CONTROLS

All the controls for operating the Bobcat Forklift are in easy reach of the operator.

Learn the locations and the action of all the instruments on the dash panel.

Learn the action of the steering wheel and foot pedal which control the drive functions of the forklift.

Learn the action of the hydraulic control.

The Bobcat Forklift has a seat belt and seat bar. When the seat bar is raised the foot pedal is in a locked position.

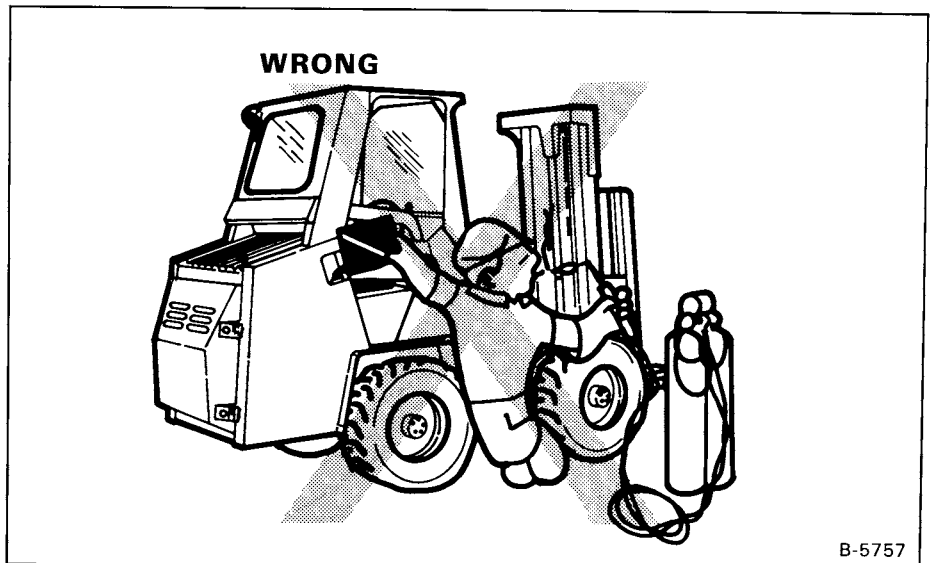
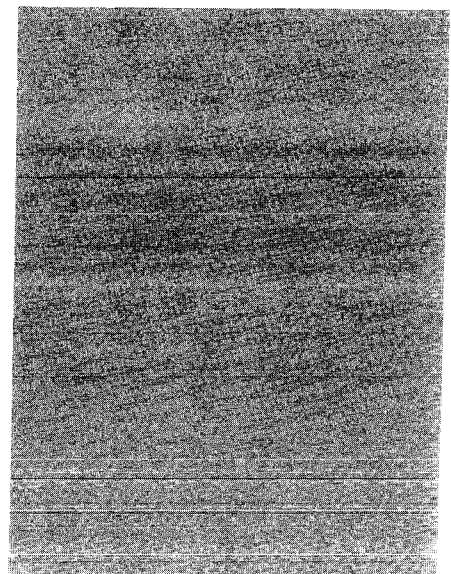

Fig. 6 NO SMOKING when filling the fuel tank

⚠
**WARNING**

**When operating the forklift, always fasten seat belt snugly, lower seat bar and keep foot on pedal. Failure to obey warnings can cause injury or death.**



3. Push the fork lock lever down into the locked position to lock the fork securely into the notches (Fig. 29, Item 2) on the top bar of the lift carriage.
4. Repeat steps 1 thru 3 for the other fork.

### Vertical Mast

The Bobcat Forklift is base-equipped with a 10-foot vertical mast. An optional 14-foot mast is available.

If the vertical mast must be removed or replaced, see the Service Manual for the correct procedure.

Figure 31 shows the maximum load to be carried with the Bobcat Forklift.

CLARK		Metroe Division		CAPACITY with upright in vertical position			
LOAD	"A"	"B"	"C"	LOAD	"A"	"B"	"C"
LBS.	Inches	Inches	Inches	Kg.	mm	mm	mm
3900	24	120	24	1769	609	3048	609
3250	24	168	24	1474	609	4267	609

Machine weight (W/Standard Tires) 7570 lbs. 3434 kg.  
12 x 16.5 x 15, 6 Ply

From factory, this truck meets Part III, ANSI B56.6 1978  
Bismarck, N.D. USA 6584920

Fig. 31 Load Rating

### OPERATING PROCEDURES

1. Always let the engine and the hydraulic/hydrostatic system warm up before operating the forklift. Run the engine at half throttle for at least five minutes. After the engine is warm operate the hydraulic controls several times: Lift and lower the vertical mast and tilt it fully forward and fully back. During cold temperatures (0°F. [-23°C.] or below) increase the warm-up time.

## ! WARNING

For safe operation of the forklift and hydraulic functions and to avoid damage to engine and forklift components, do not operate controls until engine is warmed up.

2. Always run the engine at full throttle. Move the foot pedal only a small amount to operate the forklift at a slow rate.
3. New operators must learn to operate the forklift in an open area without bystanders.
4. Operate all of the controls until you can handle the forklift at an efficient rate that is safe for the conditions in your work area.
5. Take advantage of the efficient operation of the Bobcat forklift. Keep the travel distance as short as possible. Keep the work area small so that the work cycle time is short.
6. Do not let anyone in or near the pivot area without the steering frame lock connected (Fig. 32).
7. Operate the Bobcat Forklift in as smooth and level an area as possible.
8. Raise the vertical mast only high enough to avoid obstructions on rough ground (Fig. 33).

## ! WARNING

Always carry vertical mast as low as possible while driving Bobcat forklift from location to location. Do not travel or turn with vertical mast up. Failure to obey warnings can cause injury or death.

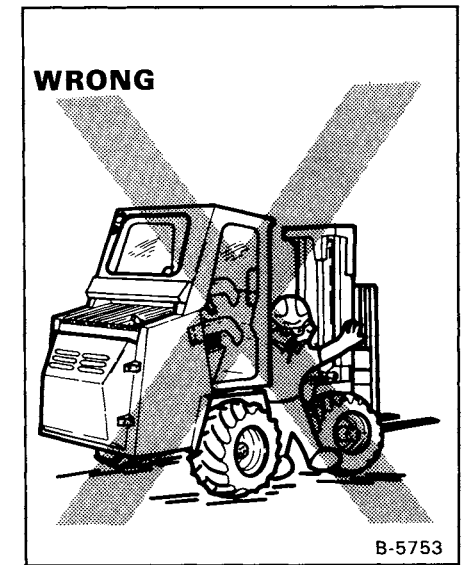

Fig. 32 WARNING - Pivot Area

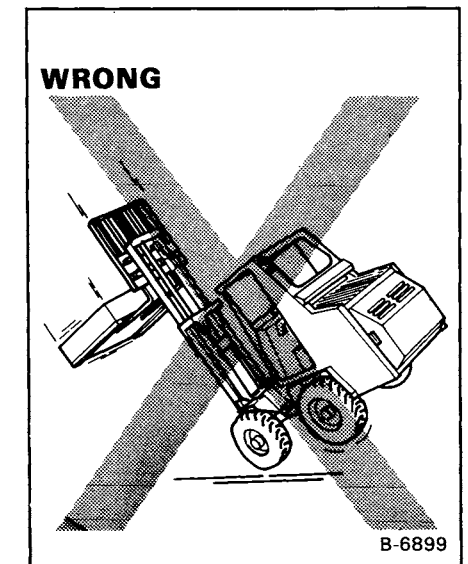

Fig. 33 Load, Carry and Unload Safety

## FUEL SYSTEM

Use number 2 diesel fuel in the engine. During very cold temperature conditions, number 1 fuel can be used.

**! WARNING**

**Stop and cool engine before adding fuel. NO SMOKING! Failure to obey warnings can cause injury or death.**

W-2063-0284

### Fuel System Service

1. Remove the filler cap from the fuel tank (Fig. 50, Item 1).
2. Use a clean, approved safety container to add fuel.
3. The key switch must be in the "OFF" position and the engine must be cool.
4. Add fuel only in an area that has a free movement of air and no open flames or sparks. NO SMOKING (Fig. 51).
5. Use only clean fuel of the correct specifications (See the "Specifications" Section of this Operator's Manual).
6. Tighten the cap on the fuel tank on the right side of the forklift (Fig. 50, Item 1).

### Fuel Filter

The fuel filter is located at the front left of the engine (Fig. 52). See the Service Schedule (Page 19) for the service interval on the water trap and the fuel filter element.

Use the following procedure to check the water trap.

1. If there is water in the water trap at the bottom of the filter, loosen the thumb screw (Fig. 52, Item 1).
2. When fuel flows from the drain with no water, tighten the thumb screw.

Use the following procedure to replace the fuel filter element.

1. Clean the area around the fuel filter. Put a clamp on the fuel supply hose from the fuel tank.
2. Remove the thumb screw at the bottom of the filter and drain the fuel from the filter.
3. Remove the small bolt at the top of the filter head (Fig. 52, Item 2) while holding the nut below the filter bowl. Remove the filter bowl.
4. Remove the filter element (Fig. 52, Item 3) and discard it.
5. Check the condition of the seals. Replace as needed.
6. Install a new filter element with the bowl, nut and thumb screw. Tighten the thumb screw finger tight only. Remove the clamp.

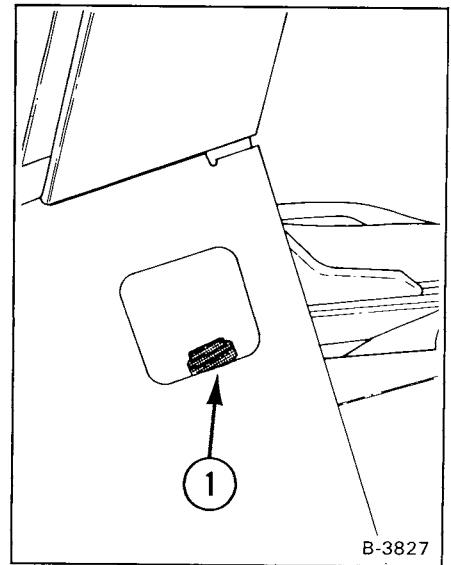

Fig. 50 Fuel Fill Location

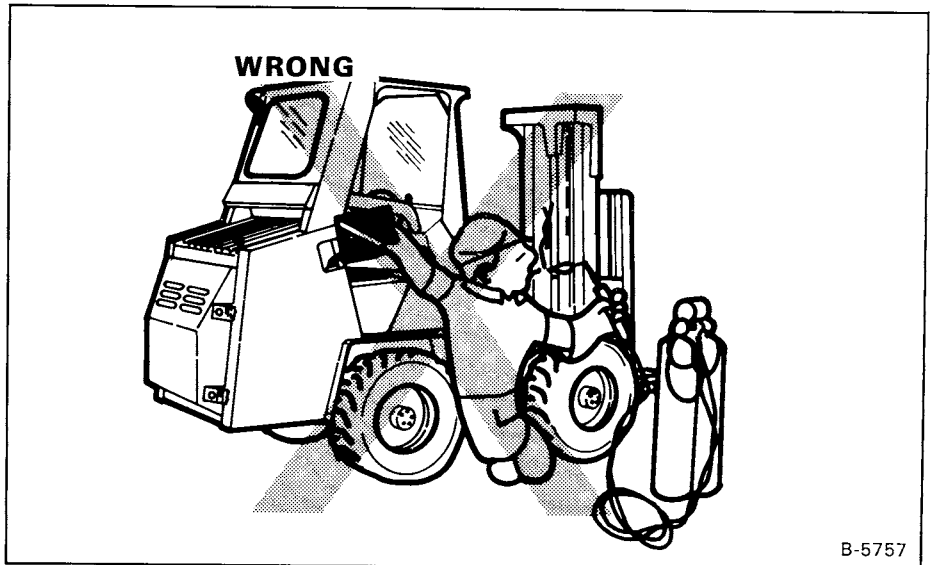

Fig. 51 Fuel Fill Warning

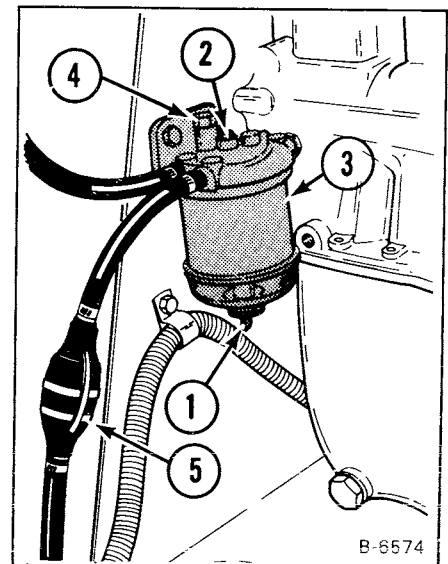

Fig. 52 Fuel Filter

### Hydraulic/Hydrostatic Fluid Removal

See the Service Schedule (Page 19) for the service interval to remove the fluid from the hydraulic reservoir and replace it with new fluid. The fluid must also be replaced if it has become contaminated and after any major repairs.

1. Remove the drain plug (Fig. 74).
2. Put a container under the reservoir (Fig. 75) and remove the fluid.
3. When all the fluid is out, install the plug and tighten.
4. Remove the oil fill cap/dipstick from the reservoir (Fig. 72).
5. Add fluid to the reservoir until the fluid is at the top mark on the dipstick. See the "Specifications" Section for the type of fluid to use. DO NOT fill above the top mark on the dipstick.
6. Operate the hydraulic controls through all the hydraulic functions. Check the fluid level again (See "Checking and Adding Fluid").

### Hydraulic/Hydrostatic Filter Replacement

See the Service Schedule (Page 19) for the service interval to remove the fluid from the hydraulic reservoir and replace it with new fluid. The fluid must also be replaced if it has become contaminated and after any major repairs.

1. Clean the area around the filter housing.
2. Remove the filter element (Fig. 76 or 77) with a filter wrench.
3. Clean the surface of the filter housing head where the filter element makes contact with the filter housing.
4. Lubricate the rubber gasket on the new filter element with grease.
5. Install the new filter element. Tighten the filter element by hand only.
6. Check for leaks after operating the machine.
7. Record the operating hours of the forklift on the decal (Fig. 49).

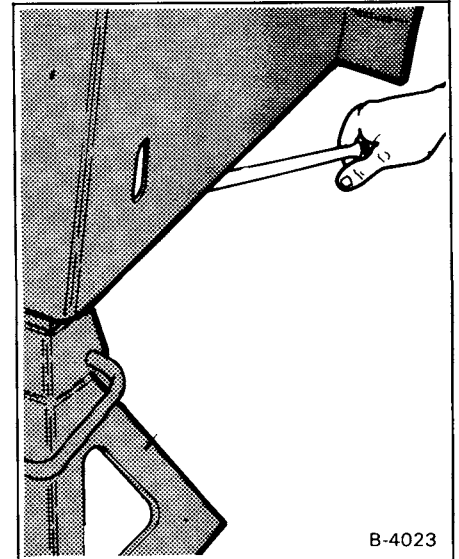

Fig. 74 Removing Drain Plug

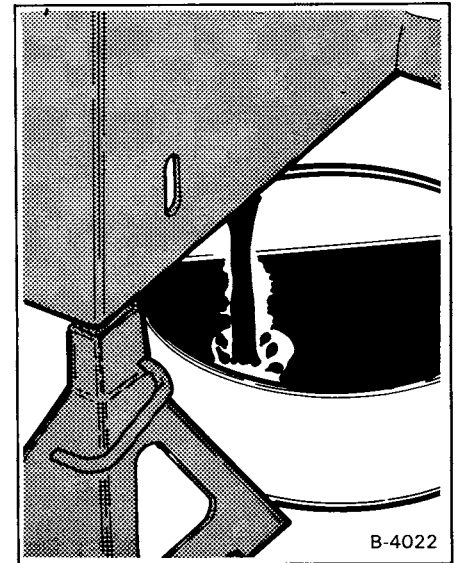

Fig. 75 Removing the Fluid

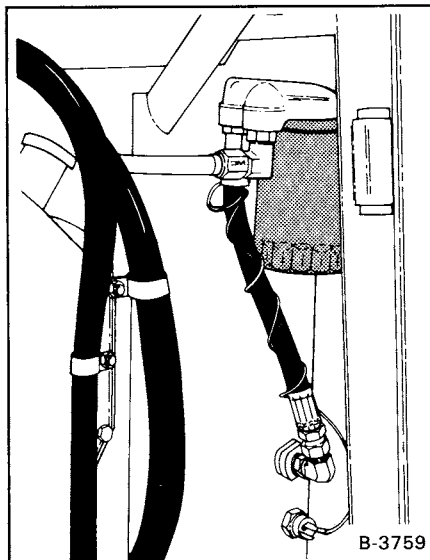

Fig. 76 Filter Location

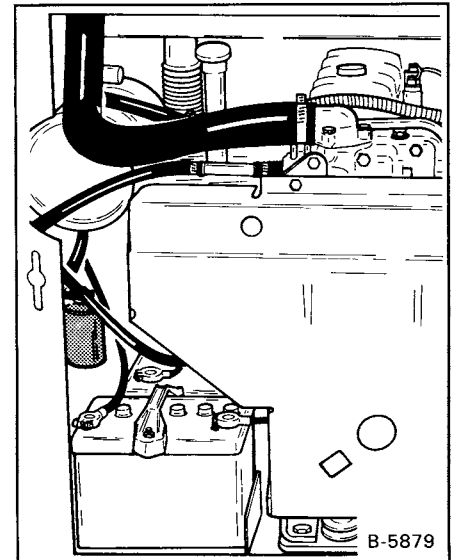

Fig. 77 Filter Location

## KEY TO CORRECT THE CAUSE

	<b>PAGE</b>
1. The fluid level is not correct.....	30
2. The linkage is disconnected.....	D/S
3. The hydraulic pump is not working correctly.	D/S
4. The relief valve is not at the correct pressure.....	D/S
5. Slow engine RPM.....	—
6. Incorrect viscosity fluid (See "Specifications" for the correct fluid).....	40
7. Flow divider valve is not working correctly.....	D/S
8. Air in the hydraulic system.....	32
9. Suction leak on the inlet side of the hydraulic pump.....	D/S
10. Steering relief valve is not at the correct pressure.....	D/S
11. Cylinder seals are leaking.....	D/S
12. Port relief is not at the correct pressure.....	D/S
13. Linkage is not adjusted correctly.....	D/S
14. Internal leaks at the lift cylinder.....	D/S
15. Spool centering spring is broken.....	D/S
16. External leak at the lift cylinder.....	D/S
17. Internal restriction.....	D/S
18. Counterbalance valve damaged.....	D/S
19. Lift cylinder flow restrictor not working correctly.....	D/S

### TROUBLESHOOTING THE VERTICAL MAST

<b>PROBLEM</b>	<b>CAUSE</b>	<b>KEY TO CORRECT THE CAUSE</b>
Mast rocks backwards and forward.	1	1. Pivot pins and bushings on the rod ends of the tilt cylinders are worn.
Mast is loose where mounting frame connects to the axle.	2	2. Bronze bushing is worn.
Mast tilts when the engine is not running.	3	3. Counterbalance valve is not working correctly.
Mast tilts forward too fast with heavy load.	3	4. Lift cylinder flow restrictor is not working correctly.
Mast drops too fast with heavy load.	4	

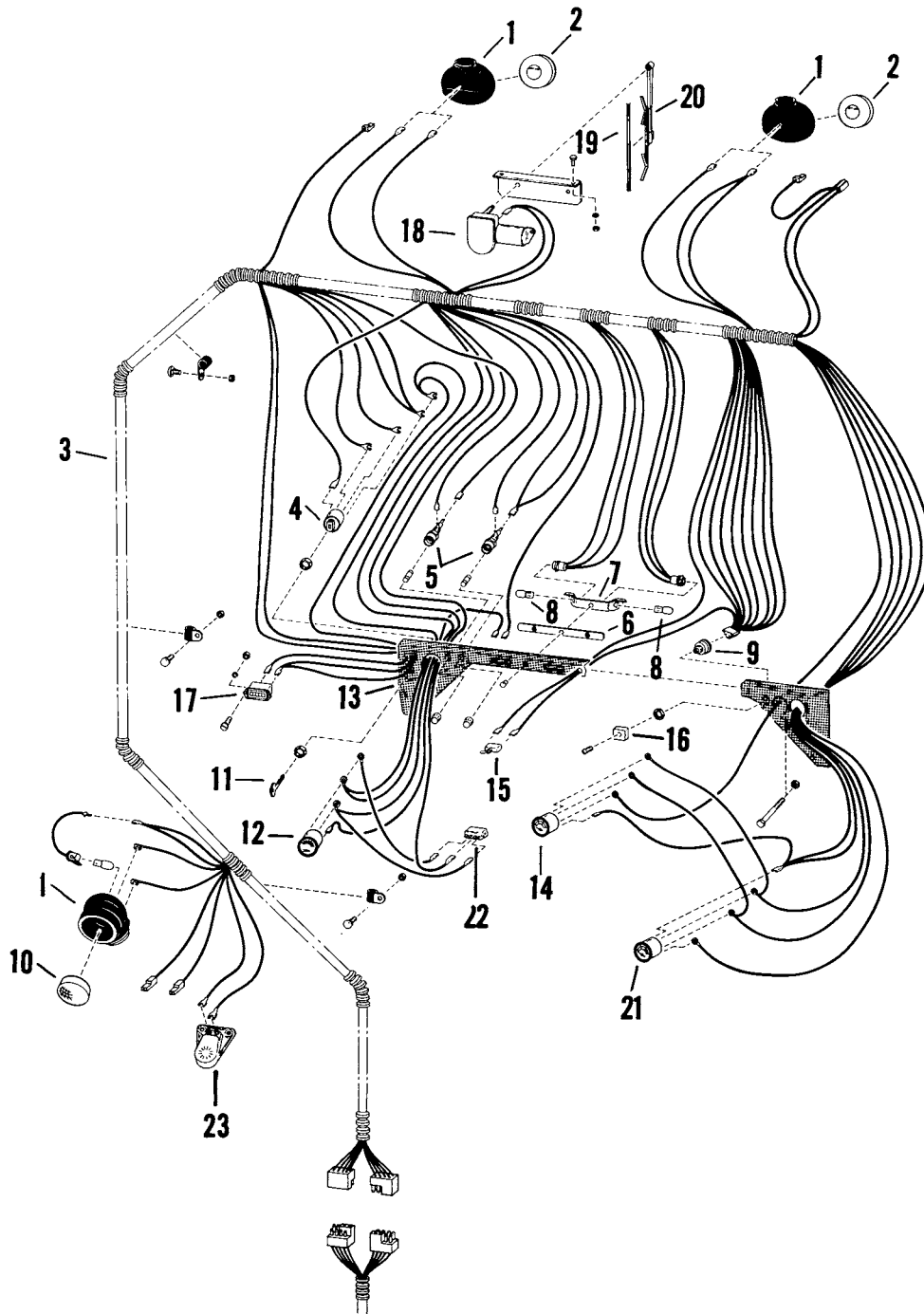

E-1434

### OPERATOR CAB ELECTRICAL

Ref.	Description	Ref.	Description
1.	Housing	13.	Panel
2.	Light, front	14.	Gauge, fuel
3.	Harness	15.	Switch, toggle
4.	Switch, starter	16.	Knob
5.	Fuse	17.	Meter, hour
6.	Lens	18.	Motor, wiper
7.	Bracket	19.	Blade, wiper
8.	Bulb	20.	Arm, wiper
9.	Switch, light	21.	Gauge, temperature
10.	Light, rear	22.	Relay, time delay
11.	Key	23.	Alarm, back-up
12.	Voltmeter		

## WICHTIG (GERMAN)

DIESER LADER IST FABRIKMÄSSIG MIT EINEM FUNKENFÄNGER-AUSPUFF AUSGERÜSTET, DER DEN U.S.D.A.-FORSTEINSATZBESTIMMUNGEN ENTSPRICHT.

DIESER FUNKENFÄNGER-AUSPUFF MUSS GEWARTET WERDEN, UM SEINE FUNKTIONSAHIGKEIT ZU BEHALTEN. ZUR WARTUNG DES FUNKENFÄNGER-AUSPUFFS MUSS DER FUNKENFÄNGERTOPF ALLE 100 BETRIEBSSTUNDEN AUSGELEERT WERDEN.

WENN DIESE MASCHINE AUF LEICHTENTZÜNDLICHEM FORSTGESTRÜPP-ODER GRASLAND EINGESETZT WIRD, MUSS SIE MIT EINER FUNKENFÄNGER-ANLAGE AM AUSPUFF AUSGERÜSTET SEIN UND DIESE ANLAGE MUSS REGELMÄSSIG GEWARTET WERDEN. ZUWIDERHANDLUNG VERSTÖSST GEGEN DAS STAATSGESETZ VON KALIFORNIEN, ABSATZ 4442, PAR. C.

ÖRTLICHE GESETZE UND BESTIMMUNGEN ÜBER FUNKENFÄNGER-AUSRÜSTUNG GENAU BEACHTEN.

## IMPORTANTE (SPANISH)

ESTE CARGADOR VIENE EQUIPADO DE FÁBRICA CON UN SILENCIADOR REPRESOR DE CHISPAS APROBADO POR EL SERVICIO FORESTAL DEL DEPARTAMENTO DE AGRICULTURE DE LOS E.U.

ES NECESARIO DAR SERVICIO AL REPRESOR DE CHISPAS PARA QUE ESTÉ EN CONDICIONES DE BUEN FUNCIONAMIENTO PARA DAR SERVICIO AL REPRESOR DE CHISPAS HAY QUE VACIAR LA CÁMARA DE CHISPAS CADA 100 HORAS DE OPERACIÓN.

SI ESTÁ MÁQUINA TRABAJA EN UN BOSQUE INFLAMMABLE O EN UN LLANO CON MALEZA O HIERBA SECA, DEBE ESTAR EQUIPADA CON UN REPRESOR DE CHISPAS COLOCADO EN EL SISTEMA DE ESCAPE Y SE DEBE MANTENER EL IMPLEMENTO EN BUENAS CONDICIONES DE TRABAJO. SI NO SE CUMPLE CON ESTA INDICACIÓN, SE ESTARÁ EN CONTRAVENCIÓN DE LA LEY DEL ESTADO DE CALIFORNIA, SECCIÓN 4442 PRC.

CONSULTE LAS LEYES Y REGLAMENTACIONES LOCALES PARA CONOCER LOS REQUERIMIENTOS SOBRE REPRESOR DE CHISPAS.

## IMPORTANT

THIS LOADER IS FACTORY EQUIPPED WITH A U.S.D.A. FORESTRY SERVICE APPROVED SPARK ARRESTOR MUFFLER.

IT IS NECESSARY TO DO MAINTENANCE ON THIS SPARK ARRESTOR MUFFLER TO KEEP IT IN WORKING CONDITION. THE SPARK ARRESTOR MUFFLER MUST BE SERVICED BY DUMPING THE SPARK CHAMBER EVERY 100 HOURS OF OPERATION.

IF THIS MACHINE IS OPERATED ON FLAMMABLE FOREST, BRUSH OR GRASS COVERED LAND, IT MUST BE EQUIPPED WITH A SPARK ARRESTOR ATTACHED TO THE EXHAUST SYSTEM AND MAINTAINED IN WORKING ORDER. FAILURE TO DO SO WILL BE IN VIOLATION OF CALIFORNIA STATE LAW, SECTION 4442, PRC.

MAKE REFERENCE TO LOCAL LAWS AND REGULATIONS FOR SPARK ARRESTOR REQUIREMENTS.

SEE OPERATOR'S MANUAL FOR MORE INSTRUCTIONS.

WEITERE INSTRUKTIONEN FINDEN SIE IN DER BEDIENUNGSANLEITUNG.

CONSULTA EL MANUAL DEL OPERADOR PARA MAS INSTRUCCIONES.

SE REPORTER AU MANUEL DE L'OPERATEUR POUR PLUS ENSEIGNEMENTS.

6560573

## IMPORTANT (FRENCH)

CETTE CHARGEUSE EST EQUIPEE SORTIE USINE D'UN POT D'ÉCHAPPEMENT A PARE-ÉTINCELLES APPROUVE PAR LE SERVICE DES EAUX EX FORETS DES ETATS-UNIS (U.S.D.A. FORESTRY SERVICE).

IL EST INDISPENSABLE D'EFFECTUER UN ENTRETIEN REGULIER DE CE POT D'ÉCHAPPEMENT AFIN DE LA GARDER EN BON ETAT DE MARCHE. L'ENTRETIEN CONSISTE A VIDER LA CHAMBRE A ETINCELLES TOUTES LES 100 HEURES DE MARCHE.

SI CET ENGIN EST UTILISE SUR TERRAIN COUVERT D'ARBRES, DE BROUSSAILLES, OU D'HERBAGES INFLAMMABLES, IL DOIT ABSOLUMENT ETRE EQUIPE D'UN PARE-ÉTINCELLES MONTE SUR LE SYSTEME D'ÉCHAPPEMENT ET GARDE EN BON ETAT DE MARCHE. TOUT MANQUE A CE REGLEMENT CONSTITUERA UNE INFRACTION A LA LOI DE L'ÉTAT DE CALIFORNIE, SECTION 4442, PRC.

CONSULTER LES LOIS ET REGLEMENTS LOCAUX QUI SE RAPPORTENT AUC PARE-ÉTINCELLES.

CLICK HERE TO **DOWNLOAD** THE COMPLETE MANUAL

- Thank you very much for reading the preview of the manual.
- You can download the complete manual from: [www.heydownloads.com](http://www.heydownloads.com) by clicking the link below



- Please note: If there is no response to CLICKING the link, please download this PDF first and then click on it.

CLICK HERE TO **DOWNLOAD** THE COMPLETE MANUAL