

# Operator Manual

# MF9000

280 and 335 Bushel Air Systems

Models: 9920



VISION INNOVATION LEADERSHIP QUALITY RELIABILITY SUPPORT PRIDE COMMITMENT



MASSEY FERGUSON

CLICK HERE TO **DOWNLOAD** THE COMPLETE MANUAL

- Thank you very much for reading the preview of the manual.
- You can download the complete manual from: [www.heydownloads.com](http://www.heydownloads.com) by clicking the link below



- Please note: If there is no response to CLICKING the link, please download this PDF first and then click on it.

CLICK HERE TO **DOWNLOAD** THE COMPLETE MANUAL

# SAFETY

## Shield and Guards

FIG. 9: All shields and guards must be in the correct operating position and in good condition.

Do not open, remove, or reach around shields while the engine is operating. Entanglement in rotating belts and components can cause serious injury or death. Stay clear of rotating components.

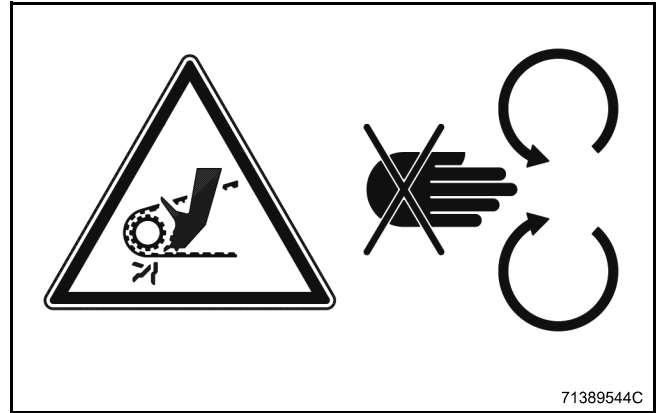

FIG. 9

FIG. 10: Do not operate the machine with the drive shaft shields open or removed. Entanglement in rotating drive shafts can cause serious injury or death. Stay clear of rotating components.

Make sure rotating guards turn freely.

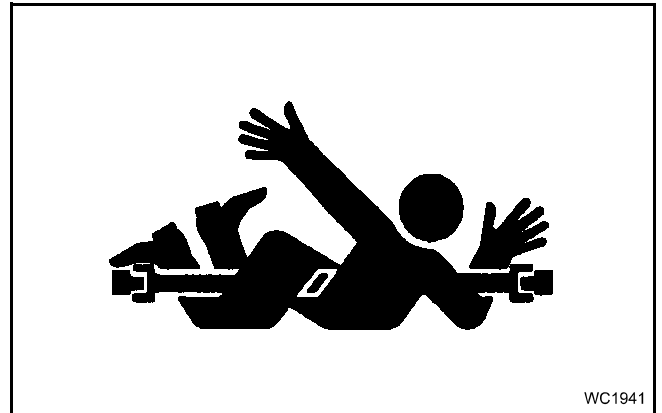

FIG. 10

## Exhaust Warning

FIG. 11: Never operate the engine in a closed building unless the exhaust is vented outside.

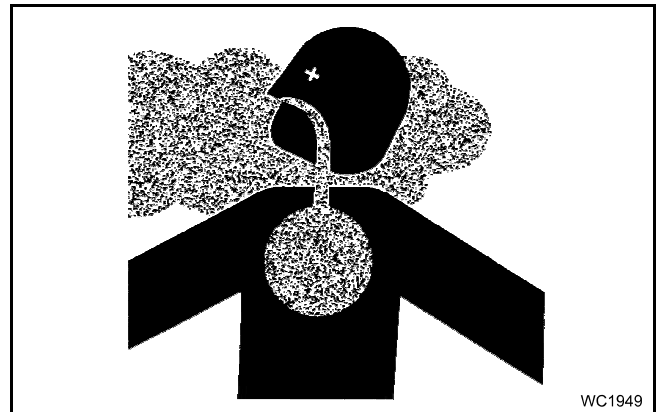

FIG. 11

FIG. 29: (7) 997852

Unhitch hazard: Negative tongue weight will cause immediate elevation of tongue.

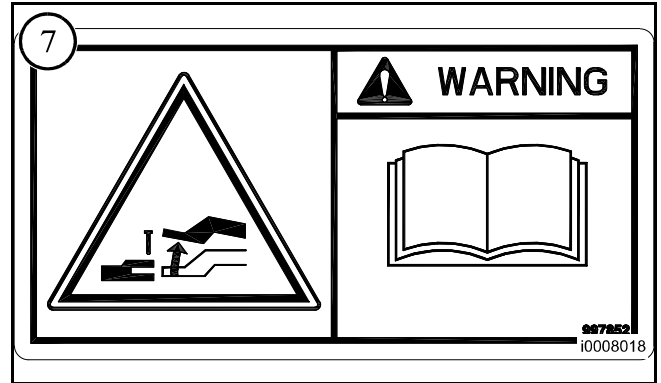

FIG. 29

FIG. 30: (8) 997858

Safety alert: Shut off the engine and remove the key before performing maintenance or repair work.

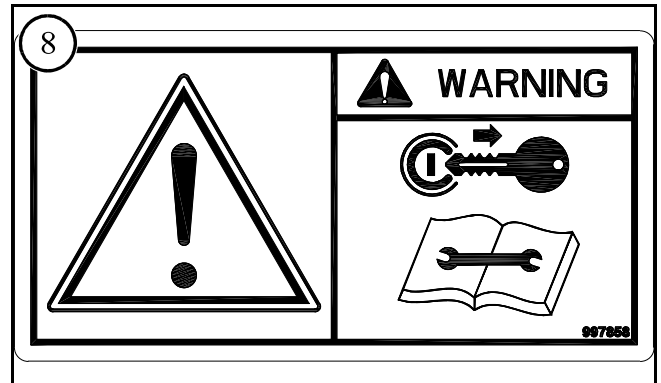

FIG. 30

FIG. 31: (9) 997862

Electrocution hazard: Keep clear of overhead electrical power lines when machine is in the transport position.

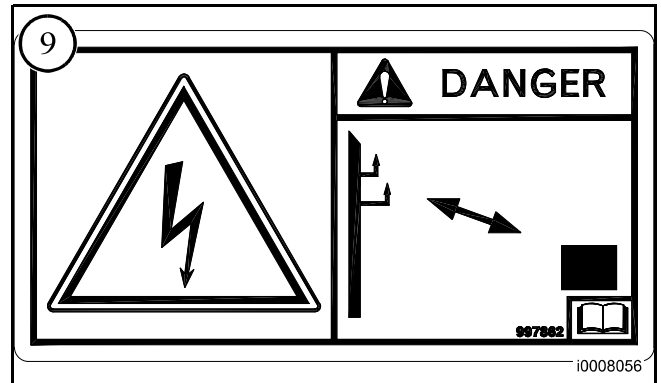

FIG. 31

FIG. 32: (10) 997866

Oil injection hazard: Avoid fluid escaping under pressure, consult service manual for repair procedures.

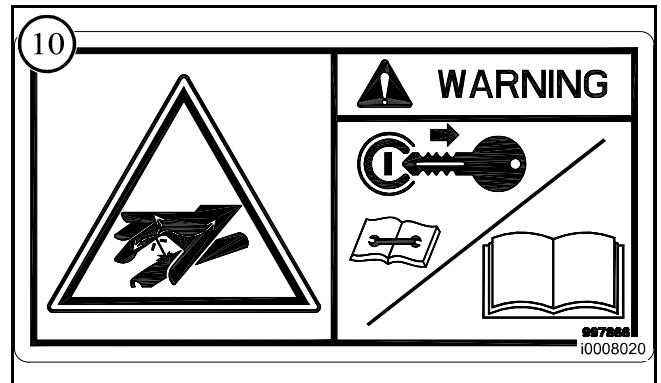

FIG. 32

# Warranty Policy

Revised 8/01/09

## GENERAL WARRANTY

AGCO Corporation (The Company) warrants all new Sunflower® brand agricultural equipment to be free of defects in material and workmanship at the time of delivery to the first retail purchaser. The Company will repair or replace at its option, without charge for parts or labor, any defective part of the equipment for the period described in these Terms, from the date of delivery to the first retail purchaser or from the date the unit is rented or leased, whichever occurs first. Sunflower® brand equipment is further warranted against defects for the period of time, as described below.

## TILLAGE WARRANTY

The Company provides a Three (3) Year Limited Warranty on all tillage equipment, excluding high wear items.

During Year One (1):The Company will repair or replace, at its option, without charge for parts or labor, any defective part of the equipment.

During Year Two (2):The Company will repair or replace, at its option, without charge for parts, any defective part of the equipment.

During Year Three (3):The Company will repair or replace, at its option, without charge for parts, any defective part of the equipment.

## AIR DRILL WARRANTY

The Company provides a Two (2) Year Limited Warranty on Air Drills, excluding high wear items.

During Year One (1):The Company will repair or replace, at its option, without charge for parts or labor, any defective part of the equipment.

During Year Two (2):The Company will repair or replace, at its option, without charge for parts, any defective part of the equipment.

## GRAIN DRILL, GRAIN SHUTTLE, DUMP WAGON WARRANTY

The Company provides a One (1) Year Limited Warranty on Grain Drills, Grain Shuttle, Dump Wagon, except for high wear items.

During Year One (1):The Company will repair or replace, at its option, without charge for parts or labor, any defective part of the equipment.

## ATTACHMENTS

The Company provides a One (1) Year Limited Warranty on Attachments, except for high wear items. This coverage applies to attachments purchased with the equipment, as well as ones purchased separately.

During Year One (1):The Company will repair or replace, at its option, without charge for parts or labor, any defective part of the attachment.

## HIGH WEAR ITEM WARRANTY

The Company provides a One (1) Year Limited Warranty on the high wear items shown below. High wear items are normal maintenance items and are often ground-engaging tools.

During Year One (1):The Company will repair or replace, at its option, without charge for parts or labor, any defective high wear item. This coverage does not include normal wear of an item.

High wear items are specified here by equipment type...

All Products	disc blades, hydraulic hoses, light kits, scrapers, points, sweeps
Chisels	spring shank assemblies
Blade Plow	standards & supports, coulter mounts, coulter hub assemblies
Coulter Ripper	shank assemblies
Trash Mulcher	auto reset shank assemblies
Disc Ripper	shank assemblies
Disc Chisel	auto reset shank assemblies
Field Cultivator	S-Tine shank assemblies
Land Finisher	S-Tine shank assemblies
Soil Conditioner	reels
Strip Till	reels, NH3 knives, wheel spokes

## D3 SYSTEM OVERVIEW

---

Your Air Cart utilizes a state-of-the-art electronic system to monitor and control the air cart's functions. The D3 ISO Monitor system is based on the ISO 11783 standard, often also referred to as ISOBUS. ISOBUS is a communications standard that enables a variety of agricultural electronics systems to talk to each other. Its purpose is to integrate all current and future farm functions by standardizing communication between tractor and implement. ISOBUS permits the use of the same tractor terminal on a number of different machines and hence control of a wide range of implements without the need to reprogram a system.

### D3 System Hardware

---

The D3 ISO System includes a D3 electronic control unit (ECU), which connects to a variety of sensors and an electric-over-hydraulic (EOH) meter drive system. The ECU communicates with a virtual terminal (VT) located inside the tractor cab. The VT displays information and enables you to configure, calibrate and operate multiple systems from a single user interface.

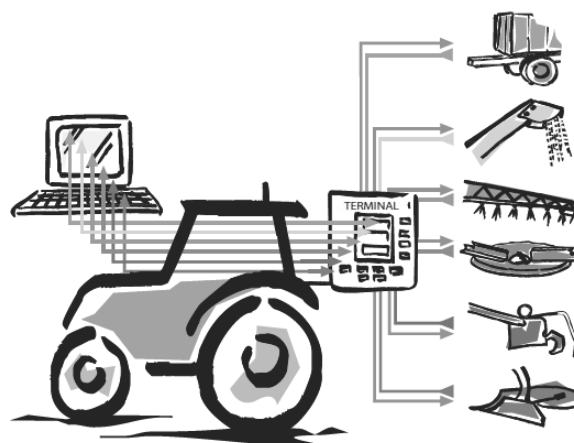

### D3 Electronic Control Unit

---

The ECU is mounted on the air system. It monitors all system sensors and controls the meter drives. The ECU connects to the VT in the tractor cab via an interconnecting cable that plugs into the front of the ECU on one end and into the standard ISOBUS connector on the tractor at the other end.



*D3 ECU*

### Virtual Terminal

---

The VT in the tractor cab provides a user interface for the system, communicating with the D3 ECU and (any other ISOBUS-compatible equipment you may add to your equipment). Your VT could be the Amity-supplied VT, the tractor's OEM VT, or any other ISOBUS-compatible VT.

Several companies manufacture ISOBUS-compatible virtual terminals. All terminals use the same screen icons to represent the main functions. The control screens, or pages, for the implement (which are displayed in the central area of the screen) are identical for any ISOBUS-compatible terminal.

Contact the manufacturer of the virtual terminal on the tractor to make sure that it can be used with the ISO Drill Manager system on this machine.



*C1000*

# BARLEY

High Capacity Flute P/N 65705  
 6 mm (1/4 in) WIDE X 13 mm (1/2 in) DEEP BARS  
 GROUND DRIVE ONLY  
 17T GEAR BOX SPROCKET W/ 18.4 R26 TIRES  
 15T GEAR BOX SPROCKET W/ 23.1 R26 TIRES

WIDTH	APPLICATION RATE - KG/HECTARE (LBS/ACRE)																		
	67 (60)	78 (70)	90 (80)	101 (90)	112 (100)	123 (110)	135 (120)	146 (130)	157 (140)	168 (150)	179 (160)	191 (170)	202 (180)	213 (190)	224 (200)	235 (210)	247 (220)	258 (230)	269 (240)
6.1 m (20 ft)	3.4	3.9	4.5	5.0	5.6	6.2	6.7	7.3	7.8	8.4	8.9	9.5	10.1	10.7	11.2	11.8	12.3	12.9	13.4
7.6 m (25 ft)	4.2	4.9	5.6	6.3	7.0	7.7	8.4	9.1	9.8	10.5	11.2	11.9	12.6	13.3					

9.1 m (30 ft)	5	5.8	6.7	7.6	8.4	9.2	10.1	10.9	11.8	12.6	13.4
10.7 m (35 ft)	5.9	6.8	7.8	8.8	9.8	10.8	11.7	12.8	13.7		

APPROXIMATE POINTER SETTING

12.2 m (40 ft)	6.7	7.8	8.9	10.1	11.2	12.3	13.4
13.7 m (45 ft)	7.5	7.0	10.0	11.4	12.6	13.8	

15.2 m (50 ft)	8.4	9.8	11.1	12.6	14.0
16.8 m (55 ft)	9.2	10.7	12.2	13.9	

18.3 m (60 ft)	10.1	11.7	13.4
----------------	------	------	------

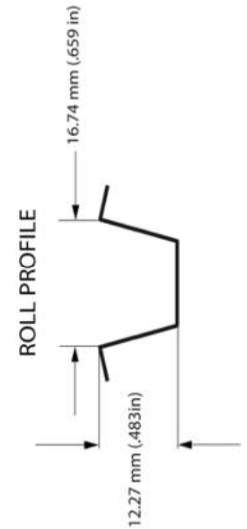
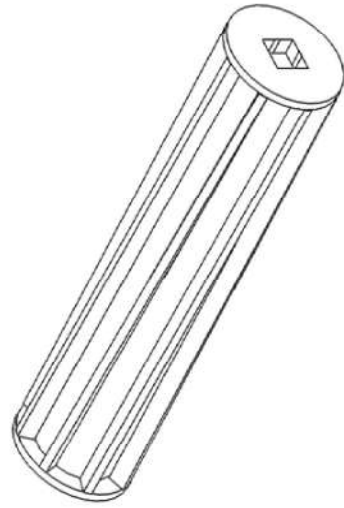

CLICK HERE TO **DOWNLOAD** THE COMPLETE MANUAL

- Thank you very much for reading the preview of the manual.
- You can download the complete manual from: [www.heydownloads.com](http://www.heydownloads.com) by clicking the link below



- Please note: If there is no response to CLICKING the link, please download this PDF first and then click on it.

CLICK HERE TO **DOWNLOAD** THE COMPLETE MANUAL