



U.S.A. : **KUBOTA TRACTOR CORPORATION**  
3401 Del Amo Blvd., Torrance, CA 90503, U.S.A.  
Telephone : (310)370-3370

Western Division : 1175 S. Guild Av., Lodi, CA 95240  
Telephone : (209)334-9910

Central Division : 14855 FAA Blvd., Fort Worth, TX 76155  
Telephone : (817)571-0900

Northern Division : 6300 at One Kubota Way, Groveport, OH 43125  
Telephone : (614)835-1100

Southeast Division : 1025 Northbrook Parkway, Suwanee, GA 30024  
Telephone : (770)995-8855

Canada : **KUBOTA CANADA LTD.**  
5900 14th Avenue, Markham, Ontario, L3S 4K4, Canada  
Telephone : (905)294-7477

France : **KUBOTA EUROPE S.A.S**  
19-25, Rue Jules Vercurysse, Z.I. BP88, 95101 Argenteuil Cedex, France  
Telephone : (33)1-3426-3434

Italy : **KUBOTA EUROPE S.A.S Italy Branch**  
Via Grandi, 29 20068 Peschiera Borrome (MI) Italy  
Telephone : (39)02-51650377

Germany : **KUBOTA (DEUTSCHLAND) GmbH**  
Senefelder Str. 3-5 63110 Rodgau /Nieder-Roden, Germany  
Telephone : (49)6106-873-0

U.K. : **KUBOTA (U.K.) LTD.**  
Dormer Road, Thame, Oxfordshire, OX9 3UN, U.K.  
Telephone : (44)1844-214500

Spain : **KUBOTA ESPAÑA S.A.**  
Avenida Recomba No.5, Poligno Industrial la Laguna, Leganes, 28914 (Madrid) Spain  
Telephone : (34)91-508-6442

Australia : **KUBOTA TRACTOR AUSTRALIA PTY LTD.**  
25-29 Permas Way, Truganina, VIC 3029, Australia  
Telephone : (61)-3-9394-4400

Malaysia : **SIME KUBOTA SDN. BHD.**  
No.3 Jalan Sepadu 25/123 Taman Perindustrian Axis,  
Seksyen 25, 40400 Shah Alam, Selangor Darul Ehsan Malaysia  
Telephone : (60)3-736-1388

Philippines: **KUBOTA PHILIPPINES, INC.**  
155 Panay Avenue, South Triangle Homes, 1103 Quezon City, Philippines  
Telephone : (63)2-9201071

Taiwan : **SHIN TAIWAN AGRICULTURAL MACHINERY CO., LTD.**  
16, Fengping 2nd Rd, Taliaw Shiang Kaohsiung 83107, Taiwan R.O.C.  
Telephone : (886)7-702-2333

Indonesia : **P.T. KUBOTA INDONESIA**  
Jalan Setyabudi 279, Semarang, Indonesia  
Telephone : (62)-24-7472849

Thailand : **SIAM KUBOTA CORPORATION CO., LTD.**  
101/19-24 Moo 20, Navanakorn Industrial Estate, Tambon Khlongnueng, Amphur Khlongluang,  
Pathumthani 12120, THAILAND  
Telephone : (66)2-909-0300

Korea : **KUBOTA KOREA CO., LTD.**  
106-24 Mongsan-Ri, Mankyung-Up, Kimje-City, Chonrapuk-Do, KOREA  
Telephone : (82)-63-544-5822

India : **KUBOTA AGRICULTURAL MACHINERY INDIA PVT. LTD.**  
Regus, Level 2 Altius, Olympia Tech Park, No.1 SIDCO Industrial Estate, Guindy, Chennai 600032, TN, India  
Telephone : (91)-44-4299-4237

Vietnam : **KUBOTA VIETNAM CO., LTD.**  
Lot B-3A2-CN, My Phuoc 3 Industrial Park, Ben Cat District, Binh Duong Province, Vietnam  
Telephone : (84)-650-3577-507

KUBOTA Corporation

Code No. K7611-7121-5

# OPERATOR'S MANUAL

## KUBOTA *RTV1140CPX* UTILITY VEHICLE

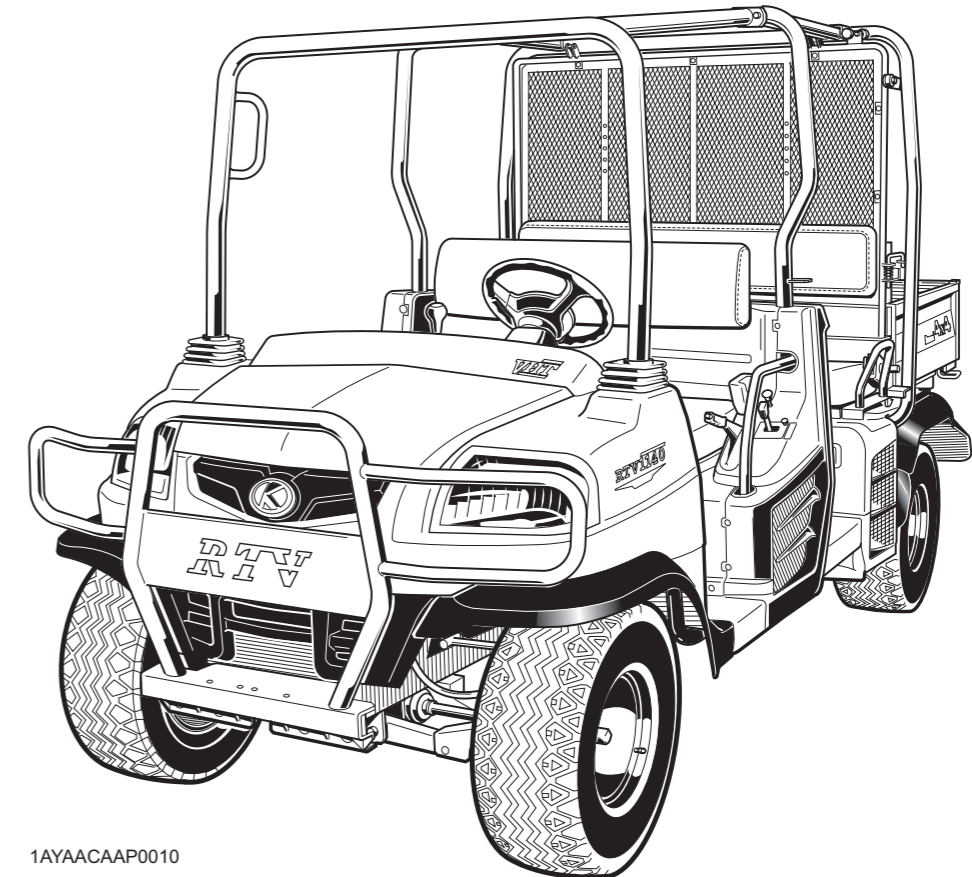

1AYAACAAP0010

RTV1140CPX

READ AND SAVE THIS MANUAL



CLICK HERE TO **DOWNLOAD** THE COMPLETE MANUAL

- Thank you very much for reading the preview of the manual.
- You can download the complete manual from: [www.heydownloads.com](http://www.heydownloads.com) by clicking the link below



- Please note: If there is no response to CLICKING the link, please download this PDF first and then click on it.

CLICK HERE TO **DOWNLOAD** THE COMPLETE MANUAL

4. Do not stop or start suddenly when going uphill or downhill. Be especially cautious when changing direction on slopes.
5. If vehicle stops or loses power going up a hill, lock parking brake to hold vehicle on slope. Maintain direction of travel and release brake slowly. Back straight downhill while maintaining control. Do not turn vehicle sideways. Vehicle is more stable in a straight forward or rearward position.
6. When riding on soft terrain, turn front wheels slightly uphill to keep vehicle on a straight line across the hill.
7. If the vehicle begins to tip, turn front wheels downhill to gain control before proceeding.
  - (1) To avoid upsets, always back up steep slopes. If you cannot back up the slope or if you feel uneasy on it, do not operate on it. Stay off slopes too steep for safe operation.
  - (2) Driving forward out of a ditch, mired condition or up a steep slope increases the risk of a vehicle to be upset backward. Always back out of these situations. Extra caution is required with four-wheel drive mode because the increased traction can give the operator false confidence in the vehicle's ability to climb slopes.
  - (3) Keep all movement on slopes slow and gradual. Do not make sudden changes in speed, direction or apply brake and make sudden motions of the steering wheel.
  - (4) Special attention should be made to the weight and location of implements and loads as such will affect the stability of the vehicle.

#### ◆ Operation in inclement conditions

1. Only operate during daylight or with good artificial light.
2. Operate vehicle in an open, unobstructed area.
3. Use helmet and/or protective gear for certain operating conditions.
4. Reduce speed according to trail, terrain and visibility conditions.
5. Never drive exceeding the limit of visibility. Slow down near crest of hill until getting a clear view of the other side.
6. Stay alert for holes, rocks and other hidden hazards in the terrain.
7. Never cross any body of water where depth may be unknown to the operator (Deep water is considered anything in excess the bottom edge of the axle cap). Choose a course within the waterway where both banks have a gradual incline. Cross at a point known to be safe.

#### ◆ Driving the vehicle at high speeds

1. Check the front wheel engagement. The braking characteristics are different between two and four wheel drive. Be aware of the difference and use carefully.
2. Always slow the vehicle down before turning. Turning at high speed may tip the vehicle over.

3. Turn the headlights on.
4. Drive at speeds that allow you to maintain control at all times.
5. Do not apply the differential lock while traveling at high speeds. The vehicle may run out of control.
6. Avoid sudden motions of the steering wheel as they can lead to a dangerous loss of stability. The risk is especially great when the vehicle is traveling at high speeds.

#### ◆ Other miscellaneous

1. Clean platform if dirty and remove any debris from around foot controls.
2. Always keep both hands on the steering wheel.
3. Always keep arms and legs inside the operating compartment.
4. Never operate the vehicle while standing.
5. Do not tow a cart with any riders on it.
6. Never attempt wheelies, jumps or other stunts.

### 3. HAULING LOADS IN THE CARGO BED

1. No riders in cargo bed or anywhere else.
2. Do not overload vehicle. Securely anchor all loads.
3. Be sure load is evenly distributed.
4. Reduce cargo capacity when operating on rough or hilly terrain.
5. Balance loads evenly and secure them. Braking could shift the load and affect vehicle stability.
6. Never operate vehicle with the cargo bed raised.
7. Operate cargo bed dump with vehicle stationary and parking brake locked. Do not dump while moving.
8. Operate hydraulic dump on level ground only.
9. Operate dump from operator's seat only.
10. Do not place hands or body under the cargo bed when lowering bed.

### 4. PARKING THE VEHICLE

1. Lower all implements to the ground, place all control levers in their neutral positions, set the parking brake, stop the engine, and remove the key.
2. Make sure that the vehicle has come to a complete stop before dismounting.
3. Avoid parking on steep slopes, if at all possible park on a firm and level surface; if not, park across a slope with chock the wheels and always with attachment on the ground.  
Failure to comply with this warning may allow the vehicle to move and could cause injury or death.

(1) Part No. K7561-6542-2

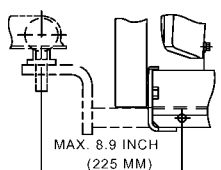
<p><b>WARNING</b></p> <p>TO AVOID PERSONAL INJURY: Attach pulled or towed loads to the drawbar only.</p>	 <p>MAX. 8.9 INCH (225 MM)</p>	<p><b>IMPORTANT</b></p> <ol style="list-style-type: none"> <li>Carefully read the loading information and trailer hitch sections in the Operator's Manual.</li> <li>Towing Capacity <ul style="list-style-type: none"> <li>•Max. Towing Load : 295kg (650lbs)</li> <li>•Max. Tongue Weight : 50kg (110lbs)</li> </ul> </li> </ol>
--	---	---

1AYAAAAAP135E

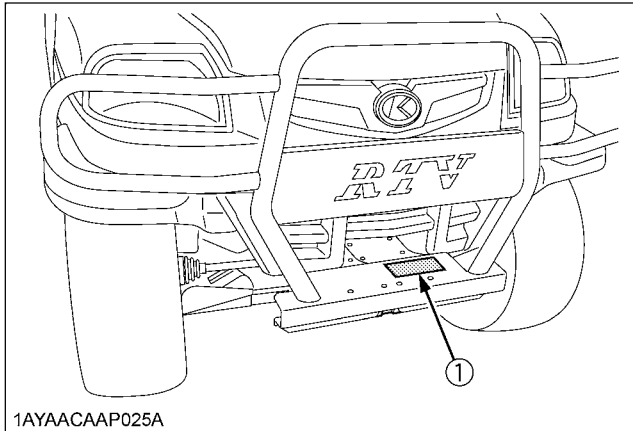

1AYACAAP025A

1AYACAAP0540

## 8. CARE OF DANGER, WARNING AND CAUTION LABELS

- Keep danger, warning and caution labels clean and free from obstructing material.
- Clean danger, warning and caution labels with soap and water, dry with a soft cloth.
- Replace damaged or missing danger, warning and caution labels with new labels from your local KUBOTA Dealer.
- If a component with danger, warning and caution label(s) affixed is replaced with new part, make sure new label(s) is(are) attached in the same location(s) as the replaced component.
- Mount new danger, warning and caution labels by applying on a clean dry surface and pressing any bubbles to outside edge.

# PRE-OPERATION CHECK

## DAILY CHECK

To prevent trouble from occurring, it is important to know the condition of the vehicle well. Check it before starting.



### CAUTION

To avoid personal injury:

- **Be sure to check and service the vehicle on a level surface with the engine shut off and the parking brake "ON" and implement lowered to the ground if equipped.**

### Check item

- Walk around inspection
- Check engine oil level
- Check transmission fluid level
- Check hydraulic tank oil level
- Check brake fluid level
- Check coolant level
- Clean radiator screen  
(When used in a dusty place)
- Check brake and pedal
- Check parking brake
- Check indicators, gauges and meters
- Check lights
- Check seat belts and ROPS
- Check front and rear joint boots
- Check tire inflation pressure
- Check backup beeper (if equipped)
- Refuel  
(See "DAILY CHECK" in "PERIODIC SERVICE" section.)
- Care of danger, warning and caution labels  
(See "DANGER, WARNING AND CAUTION LABELS" in "SAFE OPERATION" section.)

#### 4. Selecting the travel speed.

##### ■ Range Gear Shift Lever

### ⚠ CAUTION

To avoid personal injury:

- Avoid changing range gear shift lever when ascending or descending a slope.
- Before ascending or descending a slope, shift to the "L" range to control the vehicle speed.
- If you shift gears while ascending or descending a slope, be prepared to use the brake to maintain control.
- Operate in reverse at slow speeds to maintain control.

1. The range gear shift lever can only be shifted when vehicle is completely stopped and the speed control pedal is in the "NEUTRAL" position.
2. To avoid transmission and shift linkage damage, completely stop the vehicle using the brake pedal before shifting gears.
3. Select proper gear and engine speed depending on the type of job.
4. Before dismounting vehicle, shift the range gear shift lever to the "NEUTRAL" position and set parking brake.

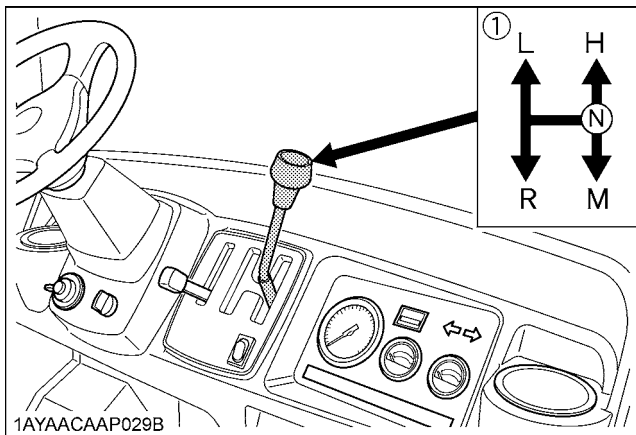

(1) Range gear shift lever  
 (L) LOW Range  
 (H) HIGH Range  
 (M) MEDIUM Range  
 (R) "REVERSE"  
 (N) "NEUTRAL" POSITION

#### NOTE :

- When range gear shift lever is hard to engage, do not force the lever. Set the parking brake, slightly depress the speed control pedal and release it to neutral position, then shift the lever.  
 When the lever is hard to disengage, do not force the lever.  
 Depress the brake pedal fully, then shift the lever.
- An accident may occur with erratic shifting operation.
- Improper range gear shift lever position will cause the vehicle to momentarily coast on slopes.

##### ■ 4WD Lever

### ⚠ CAUTION

To avoid personal injury:

- Do not engage the front wheel drive when traveling at road speed.
- When driving on icy, wet or loose surfaces, make sure the vehicle is correctly ballasted to avoid skidding and loss of steering control. Operate at reduced speed and engage front wheel drive.
- An accident may occur if the vehicle is suddenly braked, such as by heavy towed loads shifting forward causing loss of control.
- The braking characteristics are different between two and four wheel drive. Be aware of the difference and use carefully.

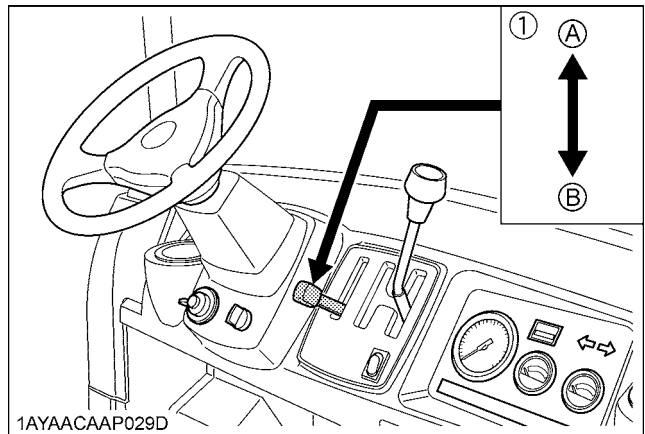

(1) 4WD lever  
 (A) "4WD"  
 (B) "2WD"

#### IMPORTANT :

- Use the lever to engage the front wheels with the vehicle stopped. Shift the lever to "4WD" to engage the front wheel drive.
- Tires will wear quickly if front wheel drive is engaged on paved roads.
- If the 4WD lever is difficult to shift to "2WD", stop the vehicle, turn the steering wheel in both directions and then move the lever.

#### ◆ Front wheel drive is effective for the following jobs:

1. When greater pulling force is needed, such as working in a wet field, when pulling a trailer, or when working with a front-end blade.
2. When working in sandy soil.

# SEATING AND CARGO BED

## CARGO BED

### ■ General Caution













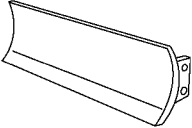



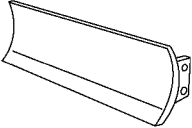

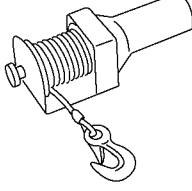
### WARNING

To avoid personal injury:

- Never carry passengers in the cargo bed. They can be tossed about or even thrown off causing serious injury or death.
- Driving with the cargo bed tilted may be hazardous.  
Always lower the bed and lock the hydraulic lift cylinder lever before driving.
- Be careful not to put any part of your body, such as hands or arms, between the bed and vehicle.
- Drive slowly when it is loaded.

### ■ Max. Cargo Load

	Operator	Passenger	Implement	Cargo Bed Capacity
1 row seating mode 	 95 kg (209 lbs)	---	W: weight 	500 kg (1100 lbs) - W
	 95 kg (209 lbs)	 95 kg (209 lbs)		500 kg (1100 lbs) - W
2 row seating mode 	 95 kg (209 lbs)	---	Blade 	300 kg (661 lbs) - W
	 95 kg (209 lbs)	 95 kg (209 lbs)		Winch 
	 95 kg (209 lbs)	  95 kg (209 lbs) 95 kg (209 lbs)	300 kg (661 lbs) - W	
	 95 kg (209 lbs)	   95 kg (209 lbs) 95 kg (209 lbs) 95 kg (209 lbs)	300 kg (661 lbs) - W	

1AYAACAAP076A

### IMPORTANT :

- Cargo Bed Capacity (CBC) is 500 kg (1100 lbs) for 1 row seating mode and 300 kg (661 lbs) for 2 row seating mode.
- Never carry loads exceeding the Permissible Cargo Load (PCL).

### NOTE :

- Max. Cargo load should not exceed "CBC" or "PCL".  
 $PCL = PC - (\text{operator} + \text{passengers} + \text{opt.} + \text{acc.} + \text{cabin}) \text{ weight}$   
 (PCL: Permissible Cargo Load / CBC: Cargo Bed Capacity / opt.: option / acc.: accessory / PC: Payload Capacity)

Payload Capacity	kg (lbs)	730 (1609)
------------------	----------	------------

No.	Items		Indication of Hour Meter													After 700 hrs	Ref. Page				
			50	100	150	200	250	300	350	400	450	500	550	600	650					700	
13	VHT pressure release	Check		○		○		○		○		○		○		○	every 100 hrs	55	*4		
14	Toe-in	Adjust		○		○		○		○		○		○		○	every 100 hrs	59			
15	Fuel filter element	Check		○		○		○		○		○		○		○	every 100 hrs	57			@
		Replace										○					every 500 hrs	71	*4		
16	Fuel line	Check		○		○		○		○		○		○		○	every 100 hrs	57			@
		Replace															every 2 years	73	*3		
17	Air cleaner element	Clean		○		○		○		○		○		○		○	every 100 hrs	56	*1		@
		Replace															every 1 year	71	*2		
18	Brake pedal	Check	⊙			○				○						○	every 200 hrs	64	*4		
19	Parking brake lever	Adjust	⊙			○				○						○	every 200 hrs	61			
20	Brake light switch	Check	⊙			○				○						○	every 200 hrs	66			
21	Front brake case	Check	⊙			○				○						○	every 200 hrs	65			
22	Hydraulic tank oil	Change				○				○						○	every 200 hrs	63			
23	Hydraulic oil line	Check				○				○						○	every 200 hrs	-			
24	Power steering oil line	Check				○				○						○	every 200 hrs	67			
25	Hydraulic tank oil filter	Replace								○							every 400 hrs	70			
26	Radiator hose and clamp	Check				○				○						○	every 200 hrs	66			
		Replace															every 2 years	73			
27	Intake air line	Check				○				○						○	every 200 hrs	67			@
		Replace															every 2 years	73	*3		
28	Engine breather hose	Replace															every 2 years	73	*4		
29	Brake hose & pipe	Check	⊙			○				○						○	every 200 hrs	65			
		Replace															every 4 years	73	*4		
30	Tire wear	Check	⊙					○								○	every 300 hrs	68			
31	Front axle case oil	Change								○							every 400 hrs	70			

### ■ Checking Coolant Level

#### CAUTION

To avoid personal injury:

- Do not remove radiator cap while coolant is hot. When cool, slowly rotate cap to the first stop and allow sufficient time for excess pressure to escape before removing the cap completely.

1. Park the vehicle on a flat surface, raise the cargo bed, mount the safety support and shut off the engine.
2. Check to see that the coolant level is between the "FULL" and "LOW" marks of recovery tank.
3. When the coolant level drops due to evaporation, add water only up to the full level.

In case of leakage, add anti-freeze and water in the specified mixing ratio up to the full level.

(See "Flush Cooling System and Changing Coolant" in "EVERY 2 YEARS" in "PERIODIC SERVICE" section.)

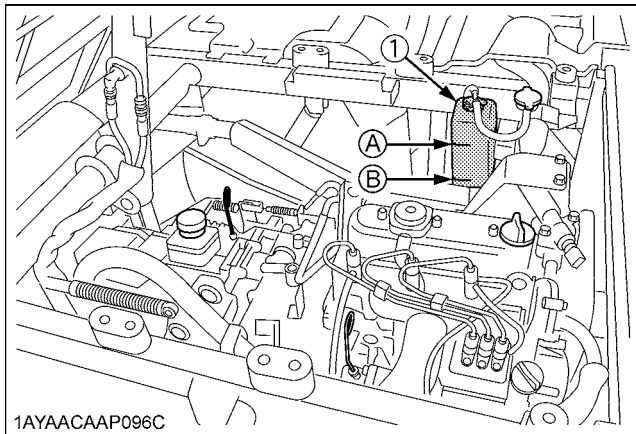

1AYAACAAP096C

(1) Recovery tank  
 (A) "FULL"  
 (B) "LOW"

#### IMPORTANT :

- If the radiator cap has to be removed, follow the caution above and securely retighten the cap.
- Use clean, fresh water and anti-freeze to fill the recovery tank.
- If water should leak, consult your local KUBOTA Dealer.

### ■ Cleaning Radiator Screen

#### CAUTION

To avoid personal injury:

- Be sure to stop the engine before removing the screen.

1. Park the vehicle on a flat surface.
2. Remove the radiator cover.
3. Detach the screen and remove all foreign materials.

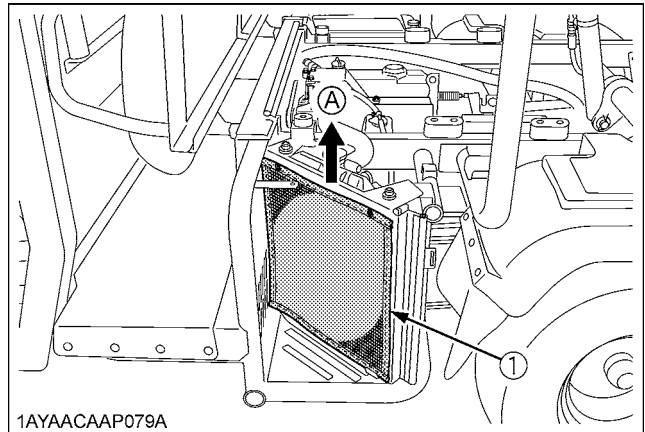

1AYAACAAP079A

(1) Radiator screen  
 (A) "DETACH"

#### IMPORTANT :

- Radiator screen must be clean from debris to prevent engine from overheating.

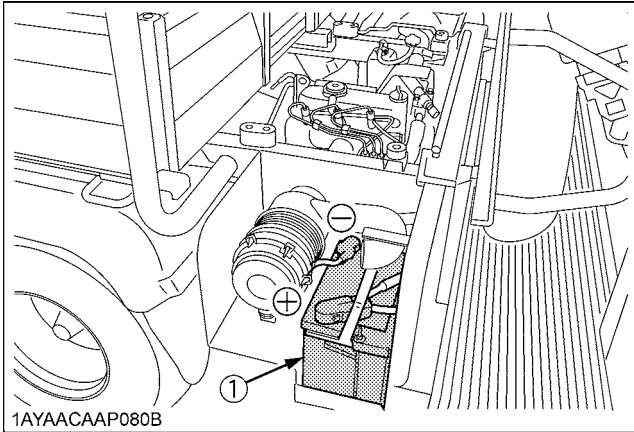

(1) Battery

1. To slow charge the battery, connect the battery positive terminal to the charger positive terminal and the negative to the negative, then recharge in the standard fashion.
2. A boost charge is only for emergencies. It will partially charge the battery at a high rate and in a short time. When using a boost-charged battery, it is necessary to recharge the battery as early as possible. Failure to do this will shorten the battery's service life.
3. When exchanging an old battery for a new one, use battery of equal specification shown in table 1.

Battery TYPE		Volts (V)
624FMF		12

Reserve Capacity (min)	Cold Cranking Amps	Recommended Charging Voltage at 26.7°C (V)
120	650	15.5

◆ **Direction for Storage**

1. When storing the vehicle for a long period, remove the battery from vehicle, adjust the electrolyte to the proper level (refillable type only) and store in a dry place out of direct sunlight.
2. The battery self-discharges while it is stored. Recharge it once every three months in hot seasons and once every six months in cold seasons.

■ **Adjusting Toe-in**

Proper toe-in	0 to 20 mm (0 to 0.79 in.)
---------------	----------------------------

1. Park vehicle on a flat place.
2. Turn steering wheel so front wheels are in the straight ahead position.
3. Lock the park brake and stop the engine.
4. Measure distance between tire beads at front of tire, at hub height.
5. Measure distance between tire beads at rear of tire, at hub height.
6. Front distance should be shorter than rear distance. If not, adjust tie rod length.

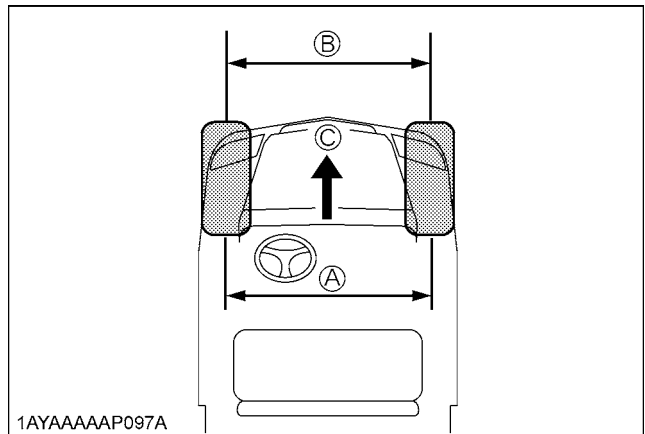

(A) Wheel - to - wheel distance at rear  
 (B) Wheel - to - wheel distance at front  
 (C) "FRONT"

## ■ Changing Transmission Fluid

### CAUTION

To avoid personal injury:

- Be sure to stop the engine before changing the oil.
- Allow engine to cool down sufficiently, oil can be hot and can burn.

1. Park the vehicle on a flat surface, raise the cargo bed, mount the safety support.
2. To drain the used oil, remove the drain plug at the bottom of the transmission case and drain the oil completely into the oil pan.
3. After draining, reinstall the drain plug.
4. Fill with the new KUBOTA SUPER UDT fluid up to the upper notch on the dipstick.  
(See "LUBRICANTS, FUEL AND COOLANT" in "MAINTENANCE" section.)
5. After running the engine for a few minutes, stop the engine and check the oil level again; add oil to prescribed level.

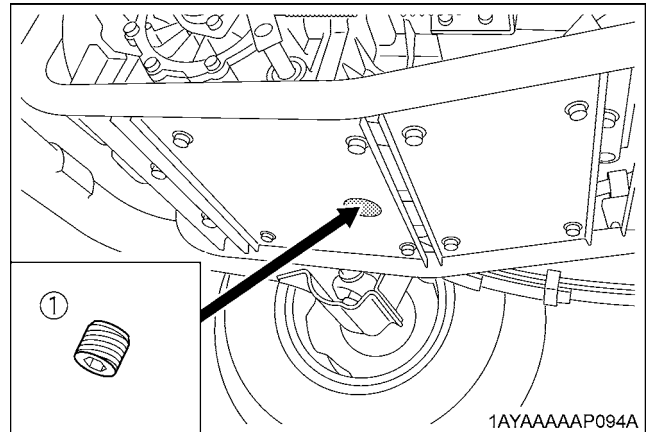

(1) Drain plug

### IMPORTANT :

- Do not operate the vehicle immediately after changing the transmission fluid.  
Run the engine at medium speed for a few minutes to prevent damage to the transmission.

Oil Capacity	12 L (3.2 U.S.gals.)
--------------	----------------------

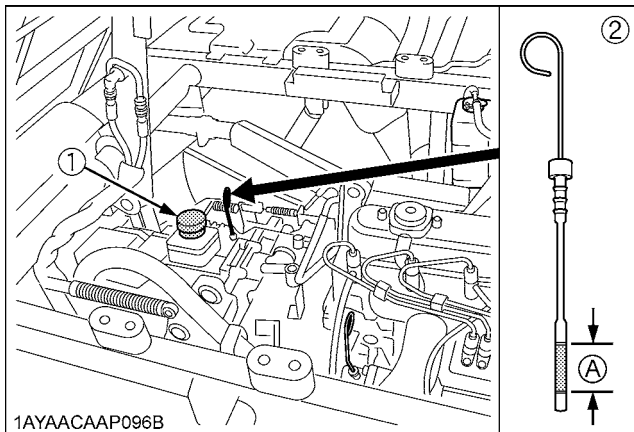

(1) Oil inlet  
(2) Gauge

(A) Oil level is acceptable within this range

CLICK HERE TO **DOWNLOAD** THE COMPLETE MANUAL

- Thank you very much for reading the preview of the manual.
- You can download the complete manual from: [www.heydownloads.com](http://www.heydownloads.com) by clicking the link below



- Please note: If there is no response to CLICKING the link, please download this PDF first and then click on it.

CLICK HERE TO **DOWNLOAD** THE COMPLETE MANUAL