

OPERATOR'S MANUAL

HYDRAULIC PUMP

HP2025-HP2134

Serial # 1XFHP20XCF0150001 and up
And 1XFHP21XHF0150021 and up

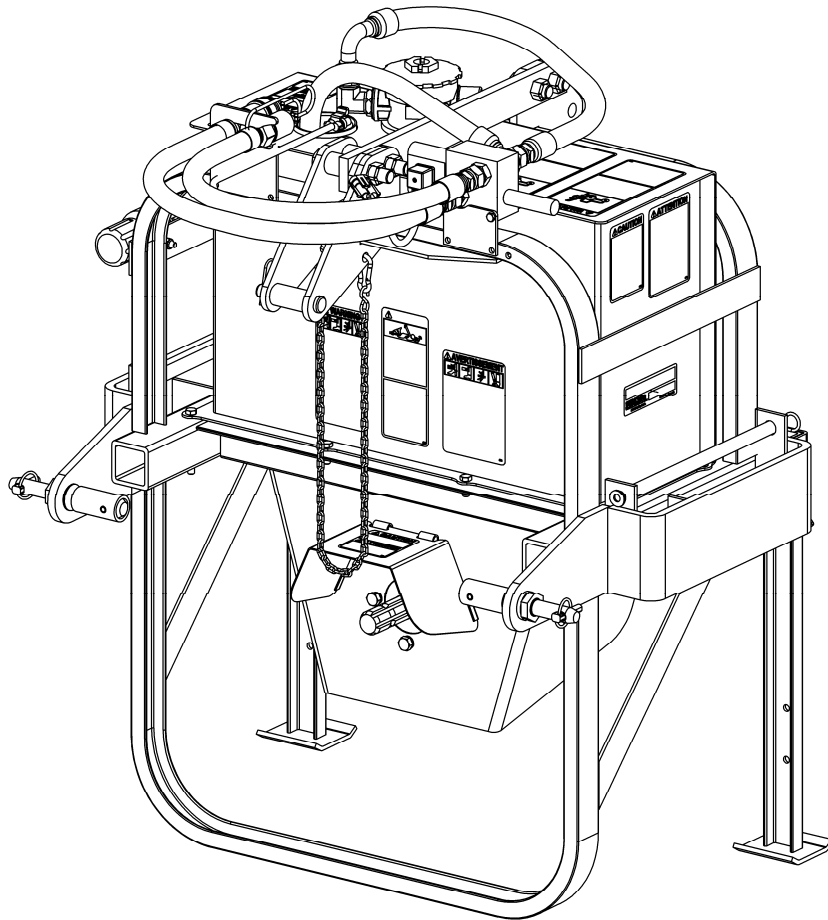

FRONTIER

CLICK HERE TO **DOWNLOAD** THE COMPLETE MANUAL

- Thank you very much for reading the preview of the manual.
- You can download the complete manual from: www.heydownloads.com by clicking the link below



- Please note: If there is no response to CLICKING the link, please download this PDF first and then click on it.

CLICK HERE TO **DOWNLOAD** THE COMPLETE MANUAL

DECALS

Replace immediately if damaged

CAUTION

Hot surface :
Stay clear to avoid burn.



AVERTISSEMENT

Surface chaude :
Rester éloigné pour éviter les brûlures.

656

5RD2500796

WARNING

Hydraulic fluid under pressure can penetrate the skin causing serious injury.



ATTENTION

Un liquide hydraulique sous pression peut pénétrer la peau et causer des blessures sérieuses.

651

5RD2500791

MISE EN GARDE

TOMBER PEUT OCCASIONNER DE SE FAIRE PASSER DESSUS.



Tomber Du Tracteur Ou Se Placer Sous L'équipement Peut Occasionner Des Blessures Graves Ou La Mort.

- Le tracteur doit être muni d'un arceau de sécurité "ROPS" ou d'une cabine ("ROPS" CAB) et d'une ceinture de sécurité. Garder l'arceau pliant en position verrouillée en tout temps.
- Attachez-vous ! Garder la ceinture de sécurité attachée en tout temps.
- Ne jamais faire monter de passagers.

Un Équipement En Position Soulevé Peut Tomber Et Ecraser

- Ne jamais se placer sous l'équipement soulevé puisqu'il pourrait tomber soudainement du véhicule ou de l'attache 3 points du tracteur suite à une défaillance hydraulique, une fuite d'huile, un mouvement des leviers de contrôle ou un bris mécanique du système d'attache.
- Les travaux d'entretien ne nécessitent pas d'aller sous l'équipements. Lire les instructions du manuel.

655

5RD2500795

WARNING

FALLING OFF CAN RESULT IN BEING RUN OVER.



Falling Off Or Going Underneath Implement Can Result In Serious Injury Or Death.

- Tractor must be equipped with ROPS (or ROPS CAB) and seat belt. Keep foldable ROPS systems in "locked up" position at all times.
- Buckle up ! Keep seat belt securely fastened.
- Allow no riders

Raised Implement Can Drop And Crush.

- Never go underneath raised implement which can drop from equipment or tractor 3-point hitch hydraulic leak down, hydraulic system failures, movement of control levers, or mechanical linkage failures.
- Service work does not require going underneath implement. Read manual instructions.

654

5RD2500794

WARNING

Tractor instability or loss of steering control may result if power unit is installed without loader. To avoid injury do not operate tractor with power unit unless loader is installed.

ATTENTION

L'instabilité ou la perte du contrôle de la direction du tracteur peut arriver si l'unité hydraulique est installée sans le chargeur frontal. Afin d'éviter toute blessure ne pas opérer le tracteur avec l'unité hydraulique, sauf si le chargeur frontal est installé.

677

5RD2500829

CAUTION

Operate only with
540 rpm PTO

ATTENTION

Toujours opérer
avec une P.D.F. de
540 tr/min

653

5RD2500793

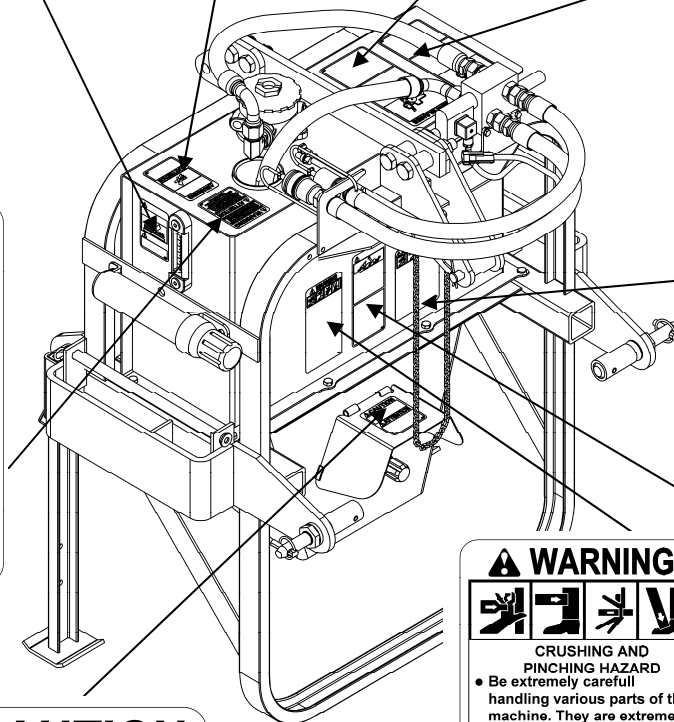

AVERTISSEMENT



RISQUE D'ÉCRASEMENT ET DE PINCEMENT

- Soyez très prudent en manipulant les diverses pièces de la machine. Elles sont lourdes et peuvent écraser ou pincer les mains, doigts, pieds et autres parties du corps entre le tracteur et l'équipement.
- Toujours manoeuvrer l'équipement à partir du siège du tracteur.
- Ne pas se tenir entre le tracteur et l'équipement lorsque que le tracteur est en marche.
- Appliquer le frein avant de circuler entre le tracteur et l'équipement.
- Rester éloigné de l'équipement lorsqu'il est en opération ou lorsqu'il est soulevé ou abaissé.

658

5RD2500798

WARNING



CRUSHING AND PINCHING HAZARD

- Be extremely careful handling various parts of the machine. They are extremely heavy and hands, fingers, feet and other body parts could be crushed or pinched between tractor and implement.
- Operate tractor controls from tractor seat only.
- Do not stand between tractor and implement when tractor is in gear.
- Make sure parking brake is engaged before going between tractor and implement.
- Stand clear of machine when in operation or when it is being raised or lowered.

657

5RD2500797

DANGER



Rotating Driveline Contact Can Cause Death. Keep People And Clothing Away. Do not operate without:

- All driveline, tractor and equipment shields in place.
- Driveline securely attached at both ends.
- Driveline shield turning freely on driveline.

Transmission Rotative À Cardan. Tout Contact Peut Causer La Mort. Tenir Les Vêtements Et Personnes À L'écart

Ne pas opérer sans:

- Que tous les protecteurs du tracteur, de l'équipement et de l'arbre à cardan soient en place.
- L'arbre à cardan fixé solidement à chaque bout.
- Que les protecteurs tournent librement sur l'arbre à cardan.

652

5RD2500792

ASSEMBLY

Installation of the Hydraulic Hoses

1. **Figure 18:** Connect the hoses to the front bulkhead adaptors (item 1). Hoses should not be inserted in the supports to make it easier to connect the hoses in the front. Tighten the lower hose first (item 2).

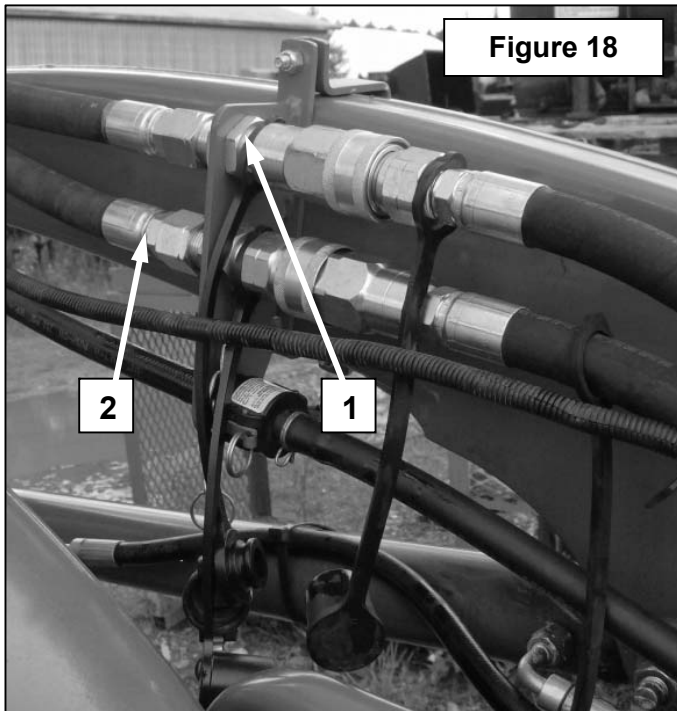

2. **Figure 19a:** Insert the hoses (item 1) in the rear hose support (item 2) of the left loader arm.

3. **Figures 19b-19c:** Run the hoses (item 1) under the tractor as shown on figure 19b then insert the hoses in the hose support located under the step plate (item 2) then lock in place with a round wire lock pin (item 3).

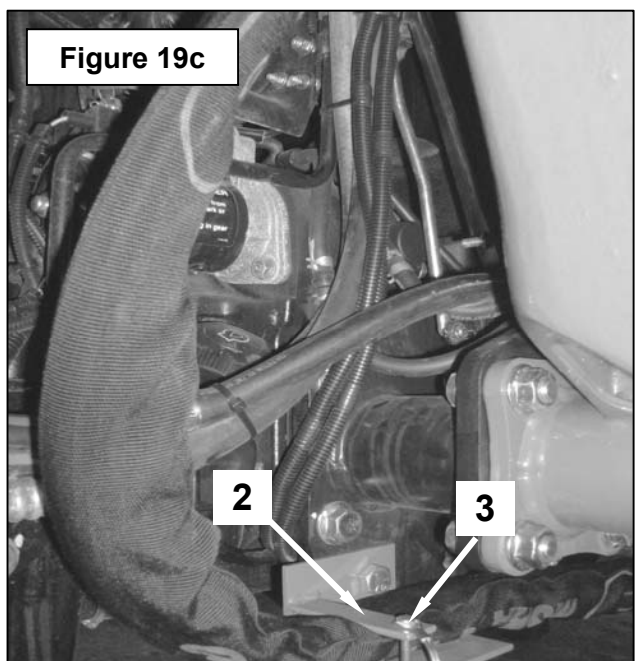
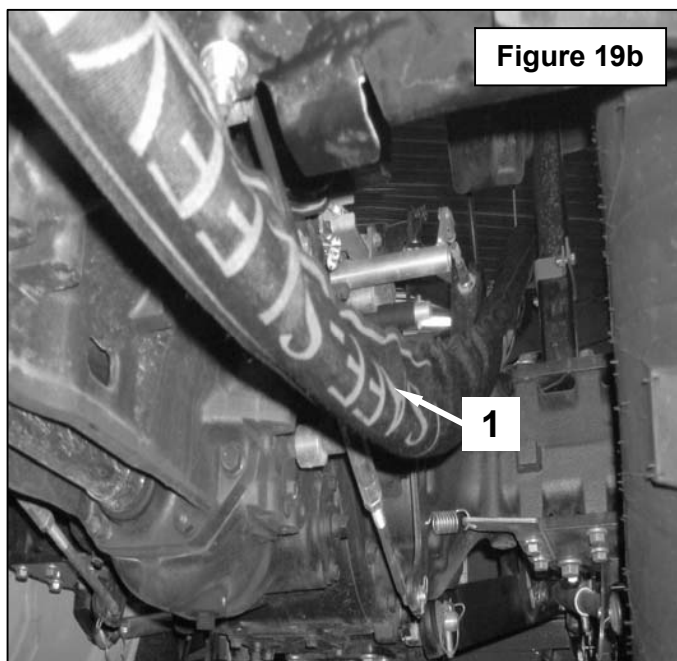
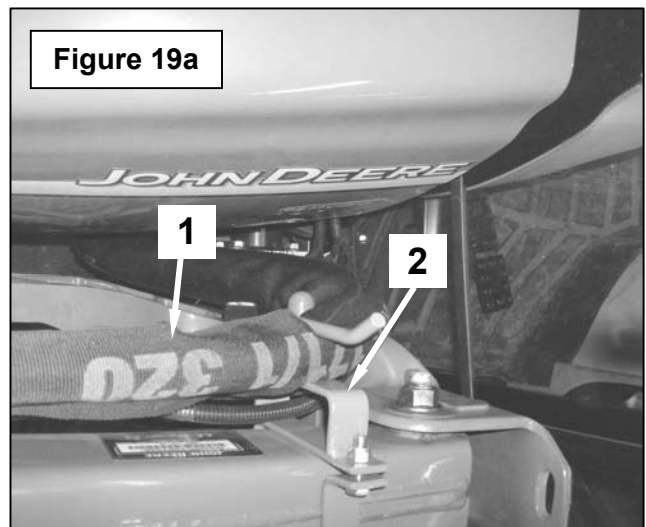

OPERATION

Checking the Oil Temperature

Figure 45: Check the oil temperature indicated on the thermometer (item 1) of the hydraulic pump (item 2).

IMPORTANT: The oil temperature must never exceed 149°F (65°C). If the temperature is above that, disengage the hydraulic pump to allow the oil to return to a temperature below 149°F (65°C). A temperature higher than 149°F (65°C) could cause damage to the hydraulic components.

Checking the Hydraulic Oil Level

Figure 46: The oil level must be between the red line and blue line of the level indicator (item 1). If the level is close to the red line, add some oil to bring it back to the blue line. Make sure the oil level never goes below the red line on the indicator (item1).

IMPORTANT: Make sure the oil level never goes below the red line on the indicator while in operation or it could cause damage to the hydraulic pump.

Checking Oil Level of the Multiplier

Figure 46: To check the oil level, simply look through the oil level plug (item 1) located on the right hand side of the multiplier. If the gauge glass is yellowish, the oil level is good. If it's white, add someSAE80W90 oil.

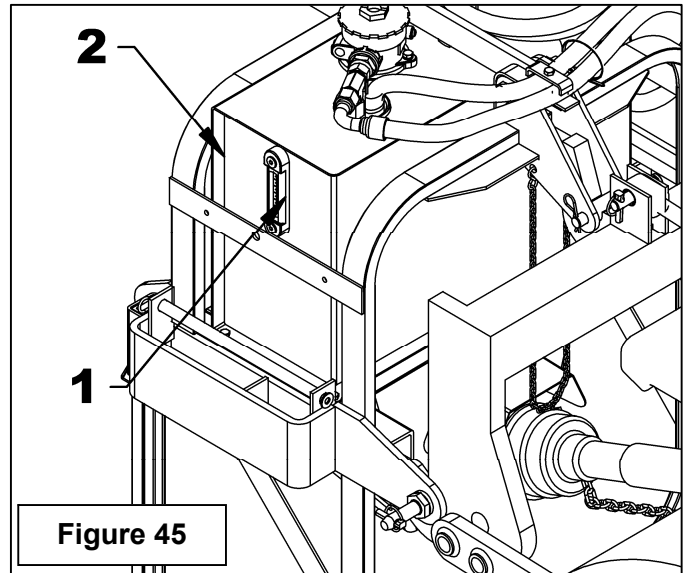

Figure 45

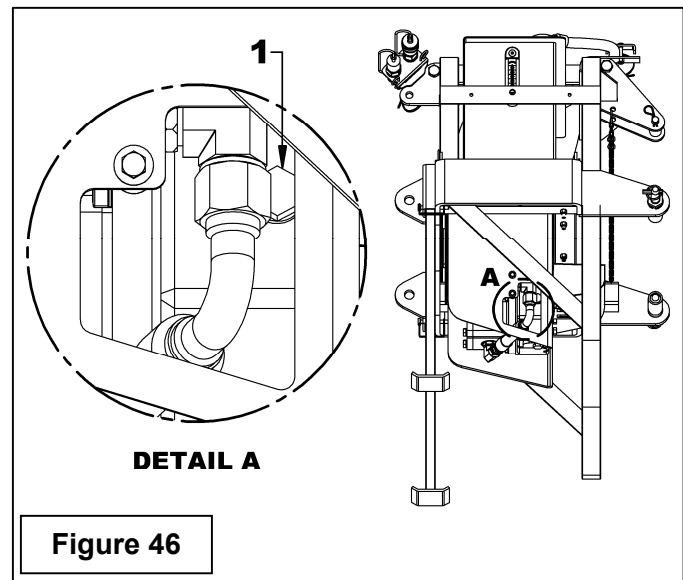

Figure 46

MAINTENANCE

PROBLEM	CORRECTIVE MEASURE
<p>3. The front mount equipment is working but in reverse.</p>	<ul style="list-style-type: none"> • Check that the pressure hose is connected to the letter "P" on the hydraulic blocks of the pump and the equipment. • Check the connections of the equipment. Refer to the Operator's manual of the equipment.
<p>4. The front mount equipment is working with low power (low hydraulic pressure)</p>	<ul style="list-style-type: none"> • Check the oil level of the hydraulic pump. • Check the viscosity of the hydraulic oil. • Check if the tractor engine is at full RPM • Check for oil leaks. • Check the filter. Clean or replace if needed. • Check the strainer. Clean or replace if needed. • Check the adjustment of the pressure valve. Adjust if necessary. (see page 37). • Check the front mount equipment. Refer to the Operator's manual of the equipment. • Check that the pump is working properly and replace if necessary.
<p>5. There is no electric signal on the hydraulic block.</p>	<ul style="list-style-type: none"> • Check the connections between the hydraulic pump and the tractor. • Check the position of the ignition key (see page 28). • Check the fuse on the wiring harness. • Check the battery connections. • Check the connection on the tractor connector. • Check the relays. • Check the connections on the solenoid valve: <ul style="list-style-type: none"> ○ solenoid valve: red on 1, purple on 2 ○ Temperature gauge: purple on 1, black on 2

PARTS

HYDRAULIC BLOCK

REF.	DESCRIPTION	QTY	
1	Cartridge 2 way, 2 positions	1	5RD3920039
	- Seal kit for 5RD3920039	1	5RD3920041
2	Coil 12VDC DIN connector for 5RD3920039	1	5RD3920040
3	Relief valve preset at 3000 PSI for HP2134	1	5RD3920025
	Relief valve preset at 2700 PSI for HP2025	1	5RD3920038
	- Seal kit for 5RD39200025 and 5RD3920038	1	5RD3920032
4	Fitting 7/8"ORB M x 1 1/16"JIC M	4	5RD2600058
5	Temperature switch 210°F	1	5RD3920042
6	Hydraulic plug 7/16"ORB M Allen head	2	5RD2600213
7	DIN connector	2	5RD4000062
8	Hydraulic plug 9/16"ORB M	1	5RD2600212

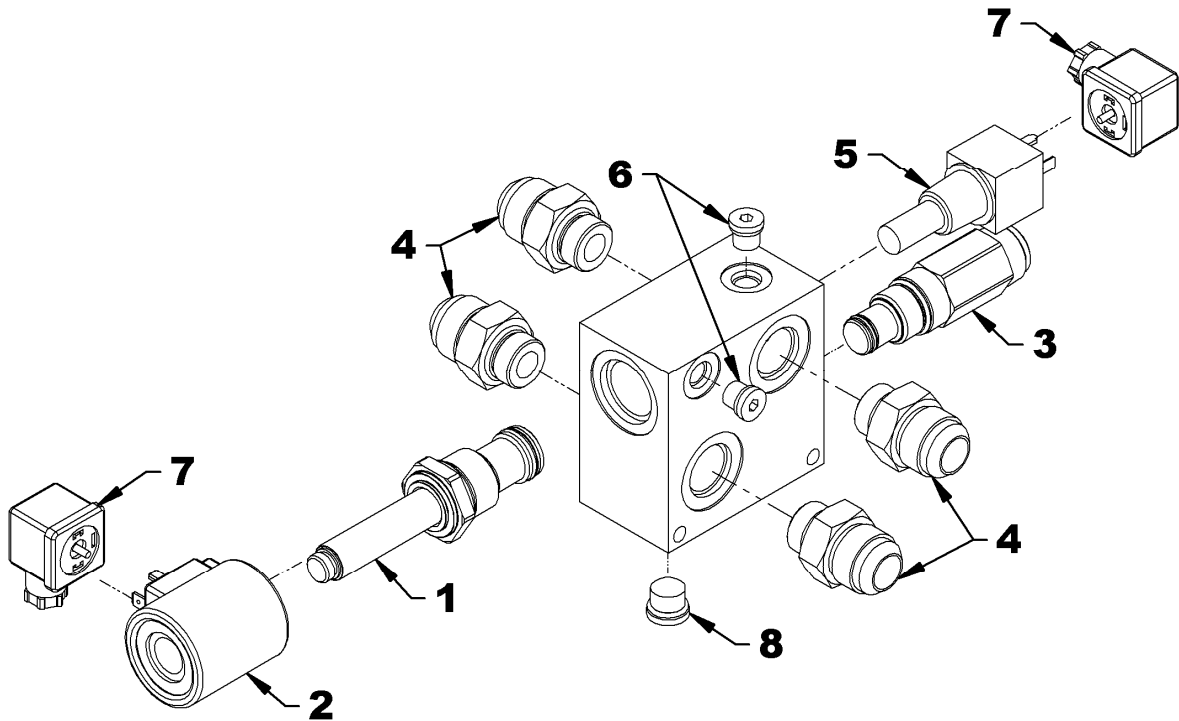

CLICK HERE TO **DOWNLOAD** THE COMPLETE MANUAL

- Thank you very much for reading the preview of the manual.
- You can download the complete manual from: www.heydownloads.com by clicking the link below



- Please note: If there is no response to CLICKING the link, please download this PDF first and then click on it.

CLICK HERE TO **DOWNLOAD** THE COMPLETE MANUAL