

---

*OPERATOR'S MANUAL*

---

*FENDT*

---

*PowerFlow 18-30*

---

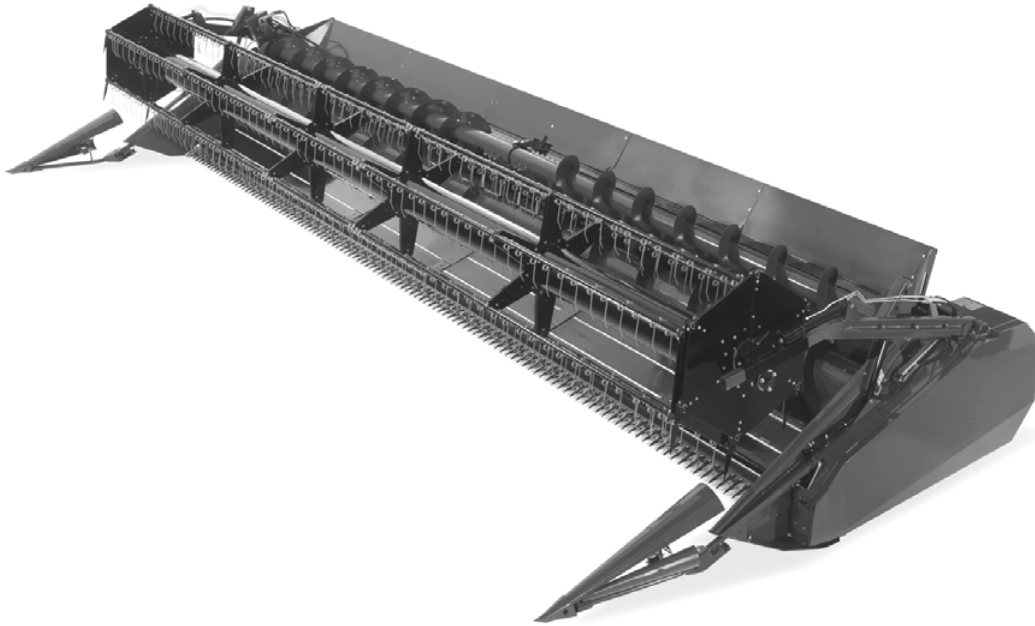

CLICK HERE TO **DOWNLOAD** THE COMPLETE MANUAL

- Thank you very much for reading the preview of the manual.
- You can download the complete manual from: [www.heydownloads.com](http://www.heydownloads.com) by clicking the link below



- Please note: If there is no response to CLICKING the link, please download this PDF first and then click on it.

CLICK HERE TO **DOWNLOAD** THE COMPLETE MANUAL

1.2.3 EC Declaration of conformity for table

T020034



|  |  |  |   |
|--|--|--|---|
|  <p style="text-align: center;"><b>AGCO S.p.A.</b><br/>Via F. Laverda 15/17<br/>36042 Breganze (VI)<br/>Italy</p> | <p style="text-align: center;"><b>IT</b></p> <p style="text-align: center;"><b>DICHIARAZIONE DI CONFORMITÀ EC</b><br/>IN CONFORMITÀ ALLE DIRETTIVE<br/>2006/42/CE E 2004/108/CE</p> <p>L'AZIENDA ..... 1</p> <p>E IL SUO RAPPRESENTANTE AUTORIZZATO ..... 2</p> <p>DICHIARA SOTTO LA PROPRIA RESPONSABILITÀ CHE IL MEZZO AGRICOLO CON LA FUNZIONE DI :<br/>ATTREZZATURA INTERCAMBIABILE</p> <p>MODELLO ..... 3</p> <p>NOME COMMERCIALE ..... 4</p> <p>NUMERO DI SERIE ..... 5</p> <p>L'OGGETTO DELLA PRESENTE DICHIARAZIONE È CONFORME ALLE DISPOSIZIONI DELLA DIRETTIVA 2006/42/CE, MODIFICATA IL : ..... 6</p> <p>E DELLA DIRETTIVA 2004/108/CE, MODIFICATA IL ..... 7</p> <p>NOME, RUOLO E FIRMA DELLA PERSONA AUTORIZZATA : ..... 8</p> <p>SEDE E DATA ..... 9</p> | <p style="text-align: center;"><b>FR</b></p> <p style="text-align: center;"><b>DECLARATION DE CONFORMITE CE</b><br/>SELON LES DIRECTIVES 2006/42/CE<br/>&amp; 2004/108/CE</p> <p>NOUS ..... 1</p> <p>ET NOTRE MANDATAIRE ..... 2</p> <p>DECLARONS SOUS NOTRE SEULE RESPONSABILITE QUE LA MACHINE AGRICOLE AYANT POUR FONCTION :<br/>EQUIPEMENT INTERCHANGEABLE</p> <p>MODELE ..... 3</p> <p>NOM COMMERCIAL ..... 4</p> <p>N° DE SERIE ..... 5</p> <p>FAISANT L'OBJET DE LA DECLARATION EST CONFORME AUX DISPOSITIONS DE LA DIRECTIVE 2006/42/CE, AMENDEE PAR : ..... 6</p> <p>AINSI QU'AUX PRESCRIPTIONS DE LA DIRECTIVE 2004/108/CE AMENDEE PAR ..... 7</p> <p>NOM, FONCTION ET SIGNATURE DE LA PERSONNE AUTORISEE : ..... 8</p> <p>LIEU ET DATE ..... 9</p>                                | <p style="text-align: center;"><b>DA</b></p> <p style="text-align: center;"><b>EF-OVERENSSTEMMELSEERKLÆRING</b><br/>I OVERENSSTEMMELSE MED DIREKTIV<br/>2006/42/EF OG 2004/108/EF</p> <p>VI ..... 1</p> <p>OG VORES AUTORISEREDE REPRÆSENTANT ..... 2</p> <p>ERKLÆRER UNDER EGDET ANSVAR, AT LANDBRUGSMASKINEN MED FUNKTION AF :<br/>UDSKIFTELT UDSTYR</p> <p>MODEL ..... 3</p> <p>FIRMANAVN ..... 4</p> <p>SERIENUMMER ..... 5</p> <p>DER ER OMFATTET AF ERKLÆRINGEN, ER ERKLÆRET I OVERENSSTEMMELSE MED BESTEMMELSENE I DIREKTIV 2006/42/EF, ÆNDRET VED : ..... 6</p> <p>SAMT BESTEMMELSENE I DIREKTIV 2004/108/EF, ÆNDRET VED ..... 7</p> <p>UNDERSKRIFTSBEMYNDIGEDES NAVN, TITEL OG UNDERSKRIFT : ..... 8</p> <p>STED OG DATO ..... 9</p>   |
|  | <p style="text-align: center;"><b>DE</b></p> <p style="text-align: center;"><b>EU-KONFORMITÄTSERKLÄRUNG</b><br/>GEMÄSS DEN RICHTLINIEN<br/>2006/42/EG UND 2004/108/EG</p> <p>WIR ..... 1</p> <p>UND UNSER BEVOLLMÄCHTIGTER ..... 2</p> <p>ERKLÄREN IN ALLEINIGER VERANTWORTUNG, DASS DAS LANDWIRTSCHAFTLICHE GERÄT MIT DER FUNKTION EINES :<br/>AUSWECHSELBARE AUSRÜSTUNG</p> <p>MODELL ..... 3</p> <p>HANDELSNAME ..... 4</p> <p>SERIENUMMER ..... 5</p> <p>DAS GEGENSTAND DIESER ERKLÄRUNG IST, DEN BESTIMMUNGEN FOLGENDEN RICHTLINIEN GENÜGTE RICHTLINIE 2006/42/EG, ERGÄNZT DURCH : ..... 6</p> <p>SOWIE RICHTLINIE 2004/108/EG, ERGÄNZT DURCH : ..... 7</p> <p>NAME, FUNKTION UND UNTERSCHRIFT DES BEVOLLMÄCHTIGTEN : ..... 8</p> <p>ORT, DATUM ..... 9</p>       | <p style="text-align: center;"><b>EN</b></p> <p style="text-align: center;"><b>EC DECLARATION OF CONFORMITY</b><br/>IN ACCORDANCE WITH DIRECTIVES<br/>2006/42/EC &amp; 2004/108/EC</p> <p>WE ..... 1</p> <p>AND OUR AUTHORISED REPRESENTATIVE ..... 2</p> <p>DECLARE UNDER OUR SOLE RESPONSIBILITY THAT THE AGRICULTURAL MACHINE WITH THE FUNCTION OF :<br/>INTERCHANGEABLE EQUIPMENT</p> <p>MODEL ..... 3</p> <p>COMMERCIAL NAME ..... 4</p> <p>SERIAL NUMBER ..... 5</p> <p>FORMING THE SUBJECT OF THE DECLARATION IS IN CONFORMITY WITH THE PROVISIONS OF DIRECTIVE 2006/42/EC, AMENDED BY : ..... 6</p> <p>AS WELL AS WITH THE PROVISIONS OF DIRECTIVE 2004/108/EC, AMENDED BY ..... 7</p> <p>NAME AND SIGNATURE OF THE AUTHORISED PERSON : ..... 8</p> <p>LOCATION AND DATE ..... 9</p> | <p style="text-align: center;"><b>ES</b></p> <p style="text-align: center;"><b>DECLARACIÓN DE CONFORMIDAD CE</b><br/>DE ACUERDO CON LAS DIRECTIVAS<br/>2006/42/CE y 2004/108/CE</p> <p> NOSOTROS ..... 1</p> <p>Y NUESTRO REPRESENTANTE AUTORIZADO ..... 2</p> <p>DECLARAMOS BAJO NUESTRA ÚNICA RESPONSABILIDAD LA CONFORMIDAD DE LA MÁQUINA AGRÍCOLA CON LA FUNCIÓN DE :<br/>EQUIPO INTERCAMBIABLE</p> <p>MODELO : ..... 3</p> <p>NOMBRE COMERCIAL ..... 4</p> <p>NÚMERO DE SERIE : ..... 5</p> <p>A LA QUE SE REFIERE ESTA DECLARACIÓN CON LAS DISPOSICIONES DE LA DIRECTIVA 2006/42/CE, MODIFICADA POR : ..... 6</p> <p>ASÍ COMO LAS DISPOSICIONES DE LA DIRECTIVA 2004/108/CE, MODIFICADA POR ..... 7</p> <p>NOMBRE, CARGO Y FIRMA DE LA PERSONA AUTORIZADA : ..... 8</p> <p>LUGAR Y FECHA ..... 9</p>                          |
|  | <p style="text-align: center;"><b>ET</b></p> <p style="text-align: center;"><b>EÜ VASTAVUSDEKLARATSIOON</b><br/>KÕDSKÕLAS DIREKTIVIDEGA<br/>2006/42/EÜ JA 2004/108/EÜ</p> <p>MEIE ..... 1</p> <p>JA MEEE VOLITATUD ESINDAJA ..... 2</p> <p>KINNITAME ONAL TÄIEL VASTUUSEL, ET JÄRGMINE PÕLLUTÖÖMASJIN :<br/>VAHETATIV SEADE</p> <p>MUDEL : ..... 3</p> <p>KAUBANIMI ..... 4</p> <p>SEERIANUMBER : ..... 5</p> <p>MIS ON KÄRSOLEVA DEKLARATSIOONI OBJEKTIS, ON VASTAVUSES DIREKTIVIGA 2006/42/EÜ, MIDA ON MUUDETUD DIREKTIVIGA ..... 6</p> <p>NING DIREKTIVIGA 2004/108/EÜ, MIDA ON MUUDETUD DIREKTIVIGA ..... 7</p> <p>VOLITATUD ISIKU NIMI, AMET JA ALLKIRI : ..... 8</p> <p>ASUKOHT JA KUUPÄEV : ..... 9</p>   | <p style="text-align: center;"><b>FI</b></p> <p style="text-align: center;"><b>EY-H DIREKTIVIEN</b><br/>2006/42/EY JA 2004/108/EY<br/>VAATIMUSTENMUKAISUUDEN VAKUUTUS</p> <p>ME ..... 1</p> <p>JA VALTUUTETUT EDUSTAJAMME ..... 2</p> <p>VAKUUTAMME TÄYSHIN OMAALLA VASTUULLAMME, ETTÄ MAATALOUSKONE, JOKA TOIHII VAHDETETÄVÄLLÄ LAITTEELLA</p> <p>MALLI : ..... 3</p> <p>KAUPPANIEMI ..... 4</p> <p>SARJANUMERO : ..... 5</p> <p>JA JOKA MUODOSTAA TÄMÄN VAKUUTUKSEN KOHTEEN, ON DIREKTIVIIN 2006/42/EY JA SEN MUUTOSTEN : ..... 6</p> <p>SEKÄ DIREKTIVIIN 2004/108/EY JA SEN MUUTOSTEN : ..... 7</p> <p>EHTOJEN MUKAINEN</p> <p>VALTUUTETUN HENKILÖN NIMI, TEHTÄVÄ JA ALLEKIRJOITUS : ..... 8</p> <p>PAIKKA JA PÄIVÄYS ..... 9</p>   | <p style="text-align: center;"><b>NL</b></p> <p style="text-align: center;"><b>EG-CONFORMITEITSVERKLARING</b><br/>OVEREENKOMSTIG DE RICHTLIJNEN<br/>2006/42/EG EN 2004/108/EG</p> <p>WIJ ..... 1</p> <p>EN ONZE BEVOEGDE VERTEGENWOORDIGER ..... 2</p> <p>VERKLAREN ONDER ONZE UITSLUITENDE VERANTWOORDELIJKHEID DAT DE LANDBOUWMACHINE MET DE FUNCTIE VAN :<br/>VERWISSELBAAR UTRUSTINGSSTUK</p> <p>MODEL : ..... 3</p> <p>HANDELSNAAM ..... 4</p> <p>SERIENUMMER : ..... 5</p> <p>WAAROP DE VERKLARING BETREKKING HEEFT, IN OVEREENSTEMMING IS MET DE BEPALINGEN VAN DE RICHTLIJN 2006/42/EG, ZOALS GEWIJZIGD DOOR : ..... 6</p> <p>ALSMEDE MET DE BEPALINGEN VAN DE RICHTLIJN 2004/108/EG, ZOALS GEWIJZIGD DOOR ..... 7</p> <p>NAAM, FUNCTIE EN HANDEKENING VAN DE BEVOEGDE PERSOON : ..... 8</p> <p>PLAATS EN DATUM ..... 9</p> |

Fig. 1.

1049982

**Before start****WARNING:**

**Never start the machine unless persons near the machine are aware of your intentions to start. Check the immediate surroundings before starting - Children!**

**WARNING:**

**During road transport the switch for multifunction lever and cutting height control must be switched off, to avoid unintentional lowering of main crop elevator and table.**

**WARNING:**

**Never leave the combine unattended without stopping the engine, setting the multifunction lever into neutral and applying the parking brake. Lower table and main crop elevator completely, remove ignition key and main switch handle from the switches.**

**Always check before start:**

1. Belts and chains (see the section about "Transmissions").

**General safety regulations before start:**

2. Make sure the table trailer is properly attached.
3. When driving with trailer attached to the machine, the brake pedals must be latched to be operated simultaneously.
4. Use only the appropriate devices for attaching the trailer. Be particularly cautious when attaching the trailer. Observe maximum permissible load of trailer hitch.
5. Observe permissible axle load and total weight.
6. During road transport the machine must be in transport position and the table must be fastened on the table trailer.
7. Never allow any persons between combine and table, without the combine being secured against rolling by applying the parking brake and/or inserting sprags under the wheels.
8. Be cautious when attaching the table to the combine - risk of injury.
9. Never engage the transmission shaft unless the safety guards are properly fitted.
10. Before start check the table for any loose nuts, bolts, etc.
11. Lubricate the table according to the lubrication chart, (see the section "Lubrication Intervals").

**2.1.4 Road Transport**

T023391

It is the responsibility of the owner/user that cutting table and machine are fitted with the equipment required in the country and driven according to the regulations in force for road transport.

1. Safety guards, traffic lights, rotating beacon, reflectors and warning triangle must be fitted and in transport position.
2. Brakes, steering gear, and other safety equipment must comply with the relevant statutory requirements.
3. Rules governing maximum width, length, height and total weight must be observed.
4. Rules governing driver's licence and insurance must be observed.
5. Table and table trailer must be attached and secured according to regulations. For details, see the section about "Operation and adjustment".
6. In transport the forward speed of the machine must not exceed the speed limit prescribed by law, irrespective of the conditions.

**WARNING:**

**During road transport the switch for multifunction lever and cutting height control must be switched off, to avoid unintentional lowering of main crop elevator and table. Before leaving the machine, lower the table, stop the engine and remove the ignition key from the switch.**

**Attachment (continued)**

8. Descend from the machine and pull the lever (1) all the way up. This secures the table using the hooks on the main crop elevator.
9. Make sure that the hole (7) on the lever (1) is inserted in the locking pin (8), whereby the tensile force of the spring (9) ensures that the lever (1) is retained in this position.  
If necessary, loosen the nut (10) and adjust the vertical position of the locking pin (8). Then re-tighten the nut (10).

**IMPORTANT:** To ensure proper connection, the dimension **A** must be 16 mm.

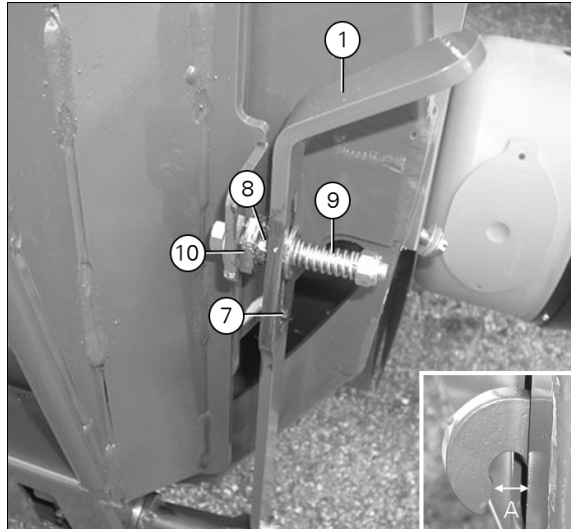

Fig. 2.

I048135

10. Connect the table transmission shaft (11) to the main crop elevator drive shaft and then secure the stop chain (12) to the table frame.

**IMPORTANT:** For easier connection of the transmission shaft (11), the main crop elevator drive shaft can be rotated using the key (13) placed on the left-hand side of the main crop elevator.

**Make sure the guards above the transmission shaft are in good condition; if not, replace them immediately.**

Use only original parts.

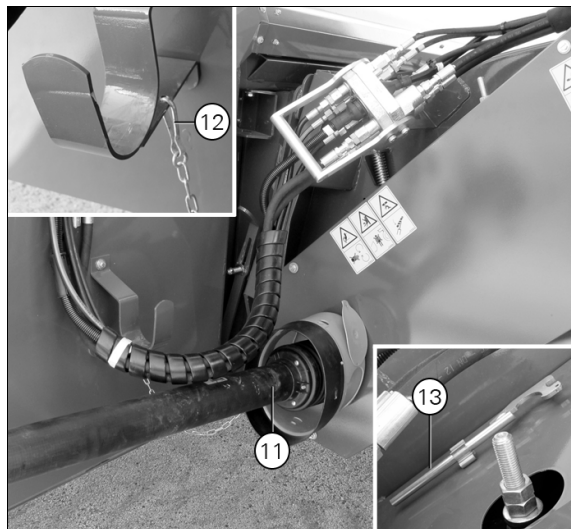

Fig. 3.

I048137

### 3.6.5 Reel tine bars

T006137

(fig. 5)

The position of the reel tine bars is adjusted with the lever (1).

Loosen the locking pin with the lever (2) and remove it from the notched plate.

Moving the lever forward angles the spring tines against the knife, and the material will be lifted further.

Moving the lever backward angles the spring tines forward, and they will let go of the material at an earlier stage.

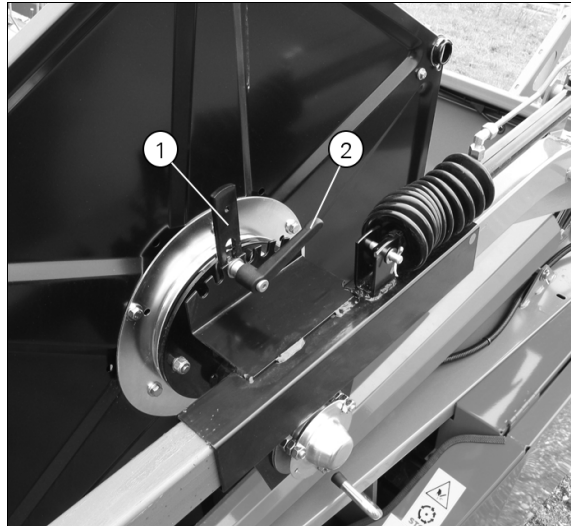

Fig. 5.

I016865

**3**

### 3.6.6 Adjustment of the Reel in the Table

T006136

(fig. 6)

The reel speed must be slightly faster than the forward speed to provide even feed.

Too high reel speed is likely to cause table loss. Ears may break off and grains fall to the ground.

In standing crops the reel should run just below the ears and be adjusted suitably backwards to provide even feed.

In partially or completely laid crops the reel tine bars should be angled slightly backward. Under these conditions it is advisable to adjust the reel forwards and downwards so that the spring tines lift the crop onto the knife.

In laid crops the reel must not keep the crop down, so that the ears are cut off.

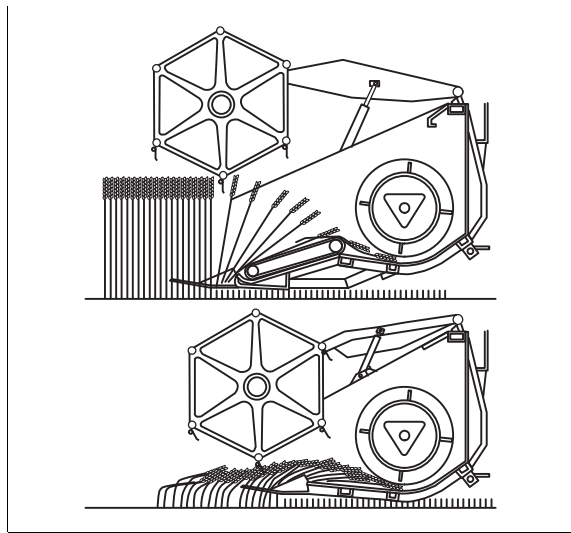

Fig. 6.

I016833

### 3.10.5 Table Bottom

T006147

(fig. 5)

The PowerFlow table is equipped with full-width steel skids.

There are holes (1) under the joints between the PowerFlow belts allowing dirt from the scrapers to fall out.

The holes are equipped with labyrinth plates (2) to prevent soil and straw from entering the table from underneath.

Check daily that dirt does not accumulate in the holes and block them.

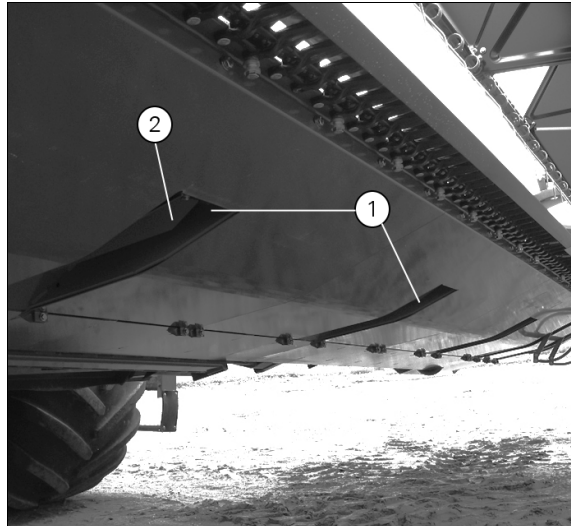

Fig. 5.

I016859

**3**

## 4. Lubrication and Maintenance

|            |   |    |
|------------|---|----|
| <b>4.1</b> | <b>Lubrication Intervals</b> .....                  | 63 |
| 4.1.1      | Lubrication chart, time intervals .....             | 63 |
| 4.1.2      | Lubrication chart, right- and left-hand sides ..... | 63 |
| 4.1.3      | Lubrication points, left-hand side .....            | 64 |
| 4.1.4      | Lubrication points, right-hand side .....           | 67 |
| 4.1.5      | Lubricants .....                                    | 69 |
| <b>4.2</b> | <b>Maintenance</b> .....                            | 70 |
| 4.2.1      | Maintenance required .....                          | 70 |



## **5. Storage**

|            |  |    |
|------------|--|----|
| <b>5.1</b> | <b>Storage</b> .....                     | 73 |
| 5.1.1      | General .....                            | 73 |
| 5.1.2      | After harvest .....                      | 73 |
| 5.1.3      | Ordering spare parts .....               | 73 |
| 5.1.4      | Before the Start of the New Season ..... | 73 |



CLICK HERE TO **DOWNLOAD** THE COMPLETE MANUAL

- Thank you very much for reading the preview of the manual.
- You can download the complete manual from: [www.heydownloads.com](http://www.heydownloads.com) by clicking the link below



- Please note: If there is no response to CLICKING the link, please download this PDF first and then click on it.

CLICK HERE TO **DOWNLOAD** THE COMPLETE MANUAL