

Challenger[®]

OPERATOR MANUAL

1435

Three Section Tandem Disc



CLICK HERE TO **DOWNLOAD** THE COMPLETE MANUAL

- Thank you very much for reading the preview of the manual.
- You can download the complete manual from: www.heydownloads.com by clicking the link below



- Please note: If there is no response to CLICKING the link, please download this PDF first and then click on it.

CLICK HERE TO **DOWNLOAD** THE COMPLETE MANUAL

SAFETY SIGN PLACEMENT

The safety sign placements are on the following pages.

FIG. 27: (7) 997853

Unhitching hazard: Negative tongue weight will cause immediate elevation of tongue. Lower the machine or install the rear jack stand to the ground before removing the hitch pin.

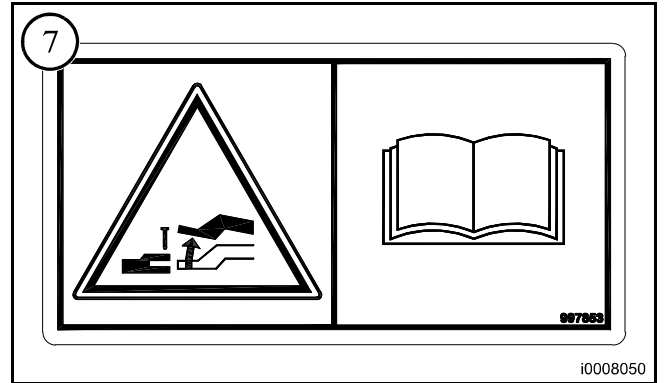

FIG. 27

FIG. 28: (8) 997859

Safety alert: Shut off the engine and remove the key before performing maintenance or repair work.

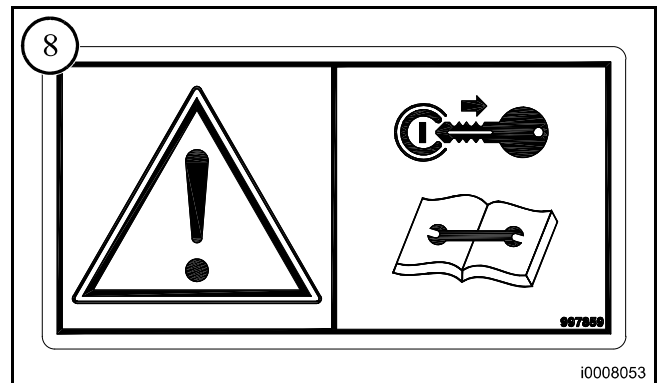

FIG. 28

FIG. 29: (9) 997861

Safety alert: Read and understand the Operator's Manual before operating the machine.

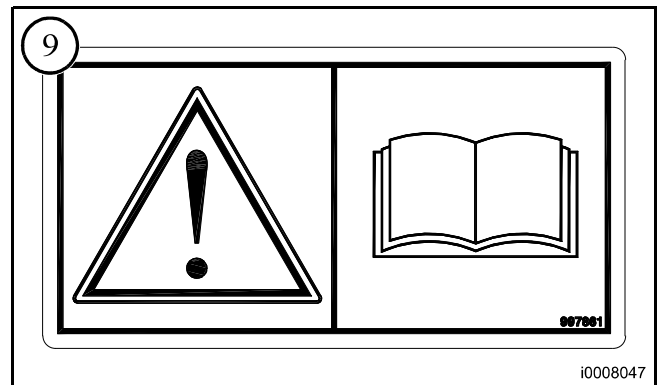

FIG. 29

FIG. 30: (10) 997863

Electrocution hazard: keep clear of overhead electrical power lines when machine is in the transport position.

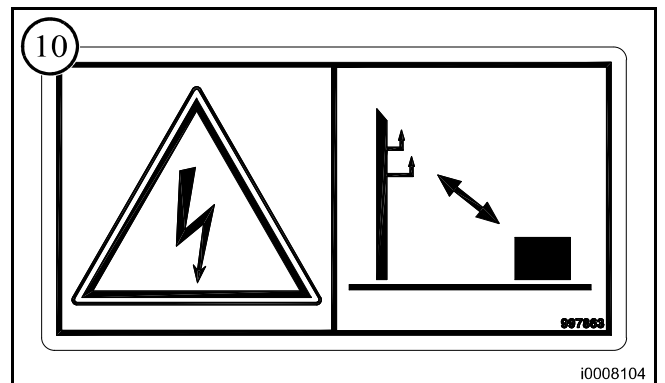

FIG. 30

MACHINE IDENTIFICATION

NOTE: Always quote the serial number in any communication to your dealer.

Machine Model Number.:

Machine Serial Number:

Date of Delivery:

Dealer Name and Address:

Dealer Telephone Number:

Dealer E-mail Address:

Dealer Fax Number:

LEVELING THE FLEXIBLE TANDEM DISC

IMPORTANT: Multiple-section flexible discs require the transport wheels to be in contact with the ground for satisfactory performance. Operating this disc with the transport wheels off the ground will not increase penetration, but will result in uneven penetration which can cause buckling and gouging. In cases where maximum depth of operation is desired, some weight must be carried on transport wheels to stabilize the machine. This also allows the front to rear leveling system to function properly.

Hydraulic Self Leveler (Optional)

The optional hydraulic leveler allows the operator to adjust the disc front-to-rear leveling from the tractor. The hydraulic leveler uses a cylinder to change the length of the leveler tube. The cylinder is equipped with a lock valve to prevent settling.

If a furrow is left behind the center of the disc, the rear of the disc should be lowered. If a ridge is present behind the center of the disc, the rear should be raised.

The disc is equipped with a pointer and a lettered indicator scale for setting reference. Retracting the leveler cylinder lowers the rear of the disc. Extending the leveler cylinder raises the rear of the disc. When adjusting the self-leveler, the gauge wheels should also be adjusted.

NOTE: A ridge in the center of the machine, regardless of the position of the leveler cylinder, could be caused by improper gauge wheel adjustment. Refer to Gauge Wheel Adjustments later in this chapter.

Hydraulic Self Leveler Pointer Adjustment

FIG. 3: The operating range of the hydraulic self leveler or the indicator pointer (1), as shown, can be manually adjusted to match different tractor drawbar heights. If the disc is working level and the pointer is in the middle range of the indicator scale, then no further adjustment is needed.

If the disc is working level, but the pointer is at the high or low end of the scale, or the disc is not working level, then the leveler screw (2), should be adjusted. The leveler screw is adjusted manually at the center of the disc. First loosen the locking jam nut (3), against the indicator rod bracket (4). Then screw the inner self leveler tube (5), in or out from the leveler screw (2). It may be necessary to lower the disc to the ground and relieve the weight on the leveler assembly. Tighten the locking jam nut to secure the inner self leveler tube and indicator rod bracket. This adjustment should only need to be made once to match the tractor drawbar and approximate working depth.

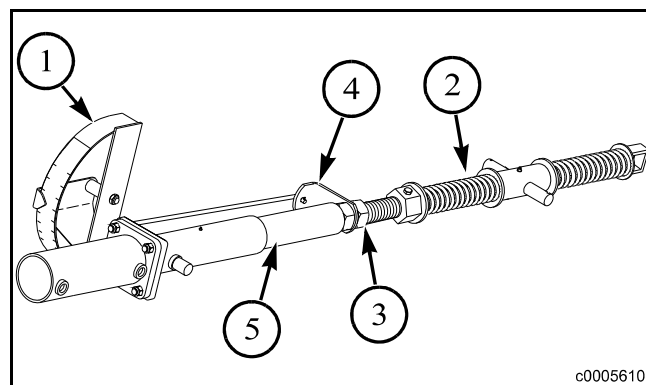

FIG. 3

TROUBLESHOOTING

Contents

TroubleShooting	D-3
Rephasing Lift Cylinders	D-4

FIG. 4: Walking Tandem Bearing

Grease every 50 hours during normal use.

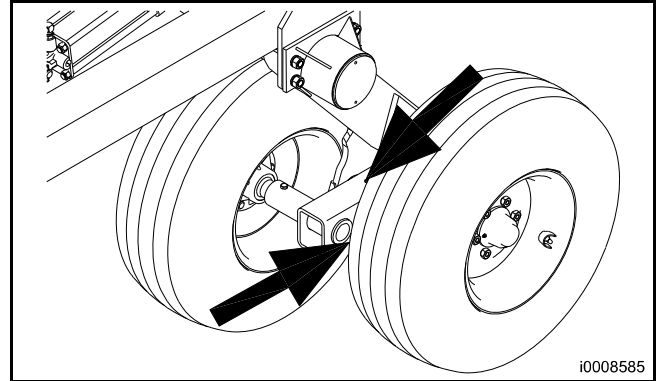

FIG. 4

BEFORE BEGINNING ASSEMBLY

Before beginning any actual assembly, this entire section must be read carefully and fully understood. Refer to the Assembly Identification section for additional component breakdowns when assembling the machine.

It is important that all the bolts and nuts are used in the proper locations in which they were designed, to prevent damage to the disc.

IMPORTANT: When two or more bolts are used to install a part, always insert the bolts and loosely tighten the nuts. Once the correct placement has been achieved, tighten the nuts evenly to prevent misalignment or distortion of the parts. When u-bolts are used, tighten both nuts evenly to prevent misalignment or distortion.

For the proper torque values, refer to the torque values section of the Lubrication and Maintenance section.

The right hand and left hand side is determined by facing the direction the machine will travel in operation.

CONNECTING THE LEVELER SYSTEMS ON THE CENTER LIFT OF THE 21 - 29 FT MODELS

FIG. 20: Place the left (3) and right (2) lift axle links of the leveler cross at the rear of the leveler screw assembly. The bushings on the lift axle links should face to the outside when installed on the leveler cross.

Slide pivot links (9) on each side of the leveler cross after the lift axle links are installed. The larger hole on the pivot links (9), should be at the top and fit over the bushings on the lift axle links (2) & (3). Secure with 1 inch flat washers (4) and cotter pins (1).

Align the lower holes of the pivot link (9), with the holes on the mount located on the center frame. Connect the pivot links to the mount using a 1 x 5 13/16 inch pin (7), 1 inch flat washers (4) and 5/16 inch roll pins (5).

Connect the lower holes of the right and lift axle links (2) & (3), to the mount on the center lift assembly, using a 1 inch pin (7). Place two 1 inch flat washers (4), on the right side of the pin and secure the flat washers with a 5/16 inch roll pin (5). Use a 5/16 x 1 3/4 inch shoulder bolt (6) with a 1/4 inch lock nut (8), on the left side of the pin.

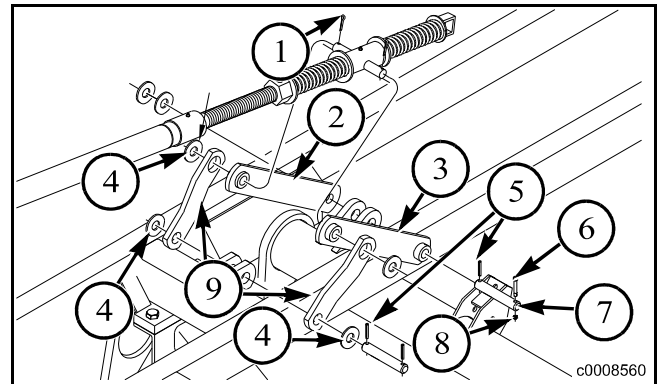

FIG. 20

CONNECTING THE LEVELER SYSTEMS ON THE CENTER LIFT OF THE 30 - 36 FT MODELS

FIG. 21: Place the left (3) and right (2) lift axle links, as shown, on each side of the leveler cross at the rear of the leveler screw assembly. The bushings on the lift axle links should face to the outside when installed on the leveler cross.

Slide pivot links (9) on each side of the leveler cross after the lift axle links are installed. The larger hole on the pivot links (9), should be at the top and fit over the bushings on the lift axle links (2) & (3).

Align the lower holes of the pivot link (9), with the hole on the center frame. Connect the pivot links to the frame using a 1 x 6 1/4 inch pin (10), flat washer (4) and a 5/16 inch roll pin (5).

Connect the lower holes of the right and lift axle links (2) & (3), to the mount on the center lift assembly, using a 1 inch pin (7). Place one or two 1 inch flat washers (4) as necessary, on the right side of the pin and secure the flat washers with a 5/16 inch roll pin (5). Use a 5/16 x 1 3/4 inch shoulder bolt (6) with a 1/4 inch lock nut (8), on the left side of the pin.

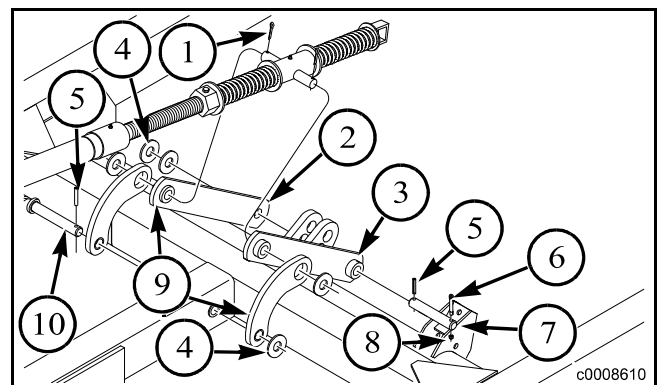

FIG. 21

OPTIONAL REAR TOW HITCH

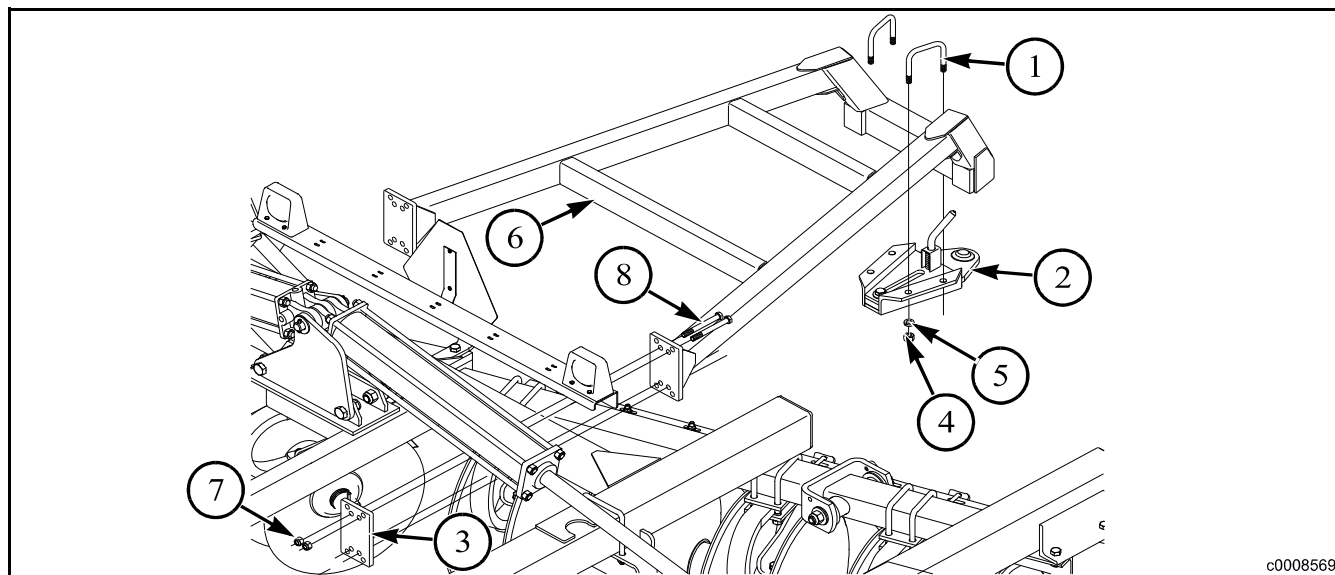

FIG. 37

FIG. 37: Position the rear tow hitch (6) on the rear bar of the center frame.

Attach the hitch to the frame using clamp plates (3), 5/8 x 6 inch hex bolts (8) with lock nuts (7).

Mount the hitch slide with ball joint (2), to the rear tow hitch (6), using 3/4 x 5 1/2 x 5 inch wide u-bolts (1), lock washers (5) and hex nuts (4).

FIG. 42: 36 ft fold hydraulic components

Item Number	Reference Number	Description
1	10812R	CYLINDER, 4" X 30" (40 1/4" CPC) ORB CROSS, 3000 PSI
2	4455	90 DEG STR THD ELBOW, 3/4"-16 MF
3	4473	SWIVEL NUT BRANCH TEE, 3/4"-16 MF
4	4482	UNION CROSS, 3/4"-16 MF
5	4472	90 DEG SWIVEL ELBOW, 3/4"- 16 MF
6	4052002	HOSE, 3/8" X 52" L, FEMALE ENDS
7	4137002	HOSE, 3/8" X 137" L, FEMALE ENDS
8	4107002	HOSE, 3/8" X 107" L, FEMALE ENDS
9	4075002	HOSE, 3/8" X 75" L, FEMALE ENDS
10	4105002	HOSE, 3/8" X 105" L, FEMALE ENDS
11	4255002	HOSE, 3/8" X 255" L, FEMALE ENDS
12	4020002	HOSE, 3/8" X 20" L, FEMALE ENDS
13	4048002	HOSE, 3/8" X 48" L, FEMALE ENDS
14	4080002	HOSE, 3/8" X 80" L, FEMALE ENDS
15	3164	ROLL PIN, 5/16" X 2" SPIRAL MEDIUM
16	FK150172	FLAT WASHER, 1 1/4" SAE, Y/D
17	5309	PIN, 1 1/4" X 6 9/16" (5 1/4") Y/D
18	5339	PIN, 1" X 4 1/16" (3"), Y/D
19	2487	HEX BOLT, 3/8"-16 X 2 1/2", GR 5, Y/D
20	5302	PIPE CLAMP, 3/8" BOLT HOLE, Y/D
21	3567	LOCK NUT, 3/8"-16 HEX NYLON INSERT, GR 2, Y/D
22	3806	HEX BOLT, 3/8"-16 X 3", GR 5, Y/D
23	176	LOCK WASHER, 3/8" SPLIT TYPE MED, Y/D
24	4463	STRAIGHT THD. CONNECTOR, 3/4"-16
25	16903P	COUPLER, MALE HALF, 3/4"-16 ORB
	(A)	HOSE CLAMP ON BOTTOM SIDE OF FRAME FOR HOSES GOING TO FRONT OF MACHINE

Refer to the drawing and component table for the parts identification when assembling the fold hydraulics. The cylinders are not filled with oil and must be purged of air before initial field operation.

CAUTION: Escaping hydraulic fluid under pressure can penetrate the skin causing serious injury. Relieve pressure before disconnecting hydraulic lines. Tighten all connections before applying pressure. Keep hands and body parts away from pinholes and nozzles which eject fluids under high pressure. Wear proper hand and eye protection when searching for leaks. Use a piece of cardboard or paper instead of your hand. If any fluid is injected into the skin, it must be surgically removed within a few hours by a doctor familiar with this type of injury, or gangrene may result.

CLICK HERE TO **DOWNLOAD** THE COMPLETE MANUAL

- Thank you very much for reading the preview of the manual.
- You can download the complete manual from: www.heydownloads.com by clicking the link below



- Please note: If there is no response to CLICKING the link, please download this PDF first and then click on it.

CLICK HERE TO **DOWNLOAD** THE COMPLETE MANUAL

ASSEMBLY IDENTIFICATION

FIG. 3: 30 - 36 ft split center frame components

Item Number	Reference Number	Description
1	669-1	LOCK NUT, 5/8"-11 HEX NYLON INSERT,GR 5, Y/D
2	16154R	ANCHOR, FOLD (36 FT)
3	194	HEX BOLT, 1/2"-13 X 1 1/2",GR 5, Y/D
4	506	FLAT WASHER, 1/4", Y/D
5	7001	SMV EMBLEM
6	2568	HEX BOLT, 1/4"-20 X 3/4", GR 5 Y/D
7	506	FLAT WASHER, 1/4", Y/D
8	13183R	BAR, LIGHT
9	2096	LOCK NUT, 1/2"-13 HEX NYLON INSERT,GR 8, Y/D
10	13184R	MOUNT, LIGHT BAR
11	6307	HEX BOLT, 3/4"-10 X 3" GR 8, Y/D
12	16153R	FRAME, (EEA) CENTER WIDE LEFT
13	6305	HEX BOLT, 3/4"-10 X 2" GR 8, Y/D
14	1040	LOCK WASHER,3/4" SPLIT TYPE MED,Y/D
15	106	HEX NUT, 3/4"-10 FULL, GR 5, Y/D
16	13932B	GANG BAR, 150 3/4" LEFT WING REAR, 36'
17	13987R	STABILIZER, WING
18	2089	FLAT WASHER, 5/8", Y/D
19	12372B	WRENCH, ADJUSTMENT
20	13934R	GANG BAR, 95 1/32" LEFT CENTER FRONT, 30'-36'
21	13954YD	L-BOLT, 5/8"-11 X 7 5/8" X 7 5/8",Y/D
22	12268	PIN, WIRE LOCK 3/8" X 2 1/2", Y/D
23	3750	OPERATOR'S MANUAL TUBE
24	3765	HOSE CLAMP, 3 1/2"
25	6575	BALL LOCK PIN, 3/8" X 3 1/2"(3 1/8")Z/P
26	7265	U-BOLT, 5/8"-11 X 6 1/2" X 4 3/4" W, GR 5, Y/D
27	13933B	GANG BAR, 95 1/32" RIGHT CENTER FRONT, 30'-36'
28	13935B	GANG BAR, 89 5/8" RIGHT CENTER REAR,30'-36'
29	6306	HEX BOLT, 3/4"-10 X 2 1/2" GR 8, Y/D
30	7785B	LOCK, TRANSPORT 11 1/2" L, W/DECAL
31	13980R	ANCHOR, FOLD (30 ft)
	13985R	ANCHOR, FOLD (33 ft)
32	13953YD	L-BOLT, 5/8"-11 X 5 5/8" X 7 5/8",Y/D
33	2521	TIE PLATE
34	1484	HEX BOLT, 3/4"-10 X 7 1/2", GR 5,Y/D
35	16152R	FRAME, (EEA) CENTER WIDE RIGHT
	(A)	36 FT MODEL
	(B)	30 - 33 FT MODEL
	(C)	BOLT COMES UP FROM BOTTOM
	(D)	TIE PLATES USED AT ALL LOCATIONS FOR 30 - 33 FT

ASSEMBLY IDENTIFICATION

FIG. 8: 21 - 29 ft center lift components

Item Number	Reference Number	Description
1	106	HEX NUT, 3/4"-10 FULL, GR 5, Y/D
2	1040	LOCK WASHER, 3/4" SPLIT TYPE MED, Y/D
3	7870R	BEARING CAP
4	1220	HEX BOLT, 3/4"-10 X 2", GR 5 Y/D
5	13928R	LIFT, CENTER LEFT 1435-21'-29'
6	13937R	SPINDLE, 2" X 8 1/16" TANDEM PIVOT
7	7325	BEARING, LIFT (SPLIT) 6" WIDE
8	16950P	WASHER, SPRING 2.000"OD X 1.063"ID,.084" THK
9	2992	HEX NUT, 1"-14 FULL SLOTTED GR 2, Y/D
10	3066	COTTER PIN, 7/32" X 1 1/2", Y/D
11	3063	WALKING BEAM SEAL (ESP P/N: VBHY-229731480359-NCO
12	3061	WALKING BEAM BEARING (342A)
13	3062	WALKING BEAM RACE (332)
14	2098-5	GREASE ZERK, 1/8" NPTF, 1 1/4" L
15	13943R	TANDEM PIVOT, 2" SPINDLE (21 - 23 FT MODELS)
	13940R	TANDEM PIVOT, 2 1/4" SPINDLE (26 - 29 FT MODELS)
16	6864	BEARING CAP
17	9781	BEARING, LIFT (SPLIT) 4 1/2" WIDE
18	13927R	LIFT, CENTER RIGHT 1435-21'-29'
19	5530	HEX BOLT, 1"-8 X 3", 1" THD, GR 5, Y/D
20	2526R	FEMALE LINKAGE
21	2079	JAM NUT, 1 1/2"-6 HEX, GR 2, Y/D
22	2525	MALE LIFT LINKAGE, 18'-32' DISC
23	1283	LOCK WASHER, 1" SPLIT TYPE MED, Y/D
24	1849	JAM NUT, 1"-8 HEX, GR 2, Y/D
25	2098-1	GREASE ZERK, 1/8" NPTF, 5/8" L

(A) NOTE THE ORIENTATION OF THE SPRING WASHERS (8)

ASSEMBLY IDENTIFICATION

FIG. 13: Standard self leveler components

Item Number	Reference Number	Description
1	1876	LEVELER SCREW
2	1875	SPRING, 2.938" OD X 1.625" ID X 8 7/8" L COMPRESSION
3	2755	FLAT WASHER, 1 9/16"ID X 2 13/16" OD, 10 GA, Y/D
4	1609	COTTER PIN, 3/16" X 1 1/2"
5	2098-1	GREASE ZERK, 1/8" NPTF, 5/8" L
6	6076R	LEVELER CROSS, 5"
7	1880	JAM NUT, 1 1/2"-6 HEX W/SET SCREW, GR 2, Y/D
	2077	SET SCREW, 3/8" X 1/2" SOCKET Y/D
8	9824R	LIFT AXLE LINK, RIGHT, 15 1/2" L
9	9825R	LIFT AXLE LINK, LEFT, 15 1/2" L
10	245	FLAT WASHER, 1" WIDE RIM, Y/D
11	3164	ROLL PIN, 5/16" X 2" SPIRAL MEDIUM
12	3880	SHOULDER BOLT, 5/16" X 1 3/4", GR 8 EQUIV, Y/D
13	5251	PIN, 1" X 5 13/16" (4 1/2"), Y/D
14	3881	LOCK NUT, 1/4"-20 HEX NYLON INSERT,GR 2, Y/D
15	9858R	PIVOT LINK, 21' - 29'
16	*1305	PIN, 1" X 6 1/4" (5 3/4"), Y/D (30-36 FT MODELS)
17	6282	HEX BOLT, 7/16"-14 X 3", GR 5, Y/D
18	10351R	LEVELER PIPE, 35" L (21 - 29 FT MODELS)
	10352R	LEVELER PIPE, 46" L (30 - 36 FT MODELS)
19	6406	HEX BOLT, 3/4"-10 X 3 1/2", 1 1/4"
20	6074R	LEVELER CROSS BRACKET
21	1753	HEX BOLT, 1"-8 X 4" GR5, Y/D
22	1678	HEX BOLT, 1"-8 X 4 1/2", GR 5 Y/D
23	2073	MACHINE BUSHING, 1 1/2"OD X 1"ID, 14 GA, Y/D
24	1283	LOCK WASHER, 1" SPLIT TYPE MED, Y/D
25	110	HEX NUT, 1"-8 FULL, GR 5, Y/D
26	9828R	CONNECTING LINK, BALL JOINT, 14" L
27	9829R	LEVELER "L", WELDED
28	6120R	LEVELER CRANK
29	106	HEX NUT, 3/4"-10 FULL, GR 5, Y/D
30	1040	LOCK WASHER,3/4" SPLIT TYPE MED,Y/D
31	6280R	LEVELER CROSS
32	6466	MACHINE BUSHING, 1 1/4" ID X 1 7/8" OD, 14 GA, Y/D
33	303	HEX NUT, 7/16"-14 FULL, GR 2, Y/D
34	302	LOCKWASHER,7/16" SPLIT TYPE MED,Y/D
35	*7941R	PIVOT LINK, 8 1/2" HC (30 - 36 FT MODELS)
36	16927YD	INDICATOR, SELF LEVELER, Y/D
	9844R	LEVELER SCREW ASSY, 34"

*NOTE: ITEMS 35 & 16 ARE USED ON THE 30 - 36 FT MACHINES IN PLACE OF ITEMS 13 & 15

ASSEMBLY IDENTIFICATION

FIG. 18: Gauge wheel components

Item Number	Reference Number	Description
1	7849	CONNECTING LINK SCREW, Y/D
	7856R	CONNECTING LINK ASSEMBLY
2	7853R	UPPER LINK
3	10034	WASHER, 2.125" OD X 1.062" ID,.250", Y/D
4	110	HEX NUT, 1"-8 FULL, GR 5, Y/D
5	1283	LOCK WASHER, 1" SPLIT TYPE MED, Y/D
6	7854R	LOWER LINK
7	7851	BUSHING, 1 1/2"OD X 1.030"ID, 4 13/16" L
8	13951R	AXLE, HEAVY DUTY GAUGE WHEEL W/STOP
9	2801Y	TIRE, 20.5 X 8 X 10 WH ASSY
10	2392	TUBE, 20.5 X 8 X 10
11	2391	TIRE, 20.5 X 8 X 10
12	2390Y	WHEEL, 6 X 10
13	302	LOCKWASHER,7/16" SPLIT TYPE MED,Y/D
14	303	HEX NUT, 7/16"-14 FULL, GR 2, Y/D
15	1609	COTTER PIN, 3/16" X 1 1/2"
16	1799	SEAL, TRIPLE LIP, WHEEL (CR 17618)
17	1611-1	SHOULDER BOLT, 1/2"-20X2 3/32"
18	1611	LUG NUT, 1/2"-20, GR 5, 90 DEG TAPER, Y/D
19	3302	HEX NUT, 1"-14 FULL SLOTTED GR 2, PLAIN
20	1610	DUST CAP, 2.446" OD, Y/D
21	3303	WASHER, 1 1/32" ID X 1 3/4" ODX 1/8" THICK, PLAIN
22	1606	BEARING (LM67048)
23	1605	RACE (LM67010)
24	1604	FIVE BOLT HUB, STUDDED W/CUPS AND LUG NUTS, PAINTED
25	1603	RACE (LM48510)
26	1602	BEARING (LM48548)
27	3309	SPINDLE, 1 3/4" X 8 1/2" H.D. GAUGE WHEEL
28	2585	HEX BOLT, 7/16"-14 X 3 1/2",GR 5,Y/D
29	2799	FIVE BOLT HUB ASSEMBLY
30	108	COTTER PIN, 5/16" X 2 1/2", Y/D
31	13896P	PAD, WEAR-1/4" UHMW BLACK, 6 3/4" DIA
32	13948R	MOUNT, PIVOT PLATE
33	2756	FLAT WASHER, 1 13/16" ID X 2 13/16" OD, 10 GA, Y/D
34	1282	HEX BOLT, 1"-8 X 6 1/2", GR 5, Y/D
35	2036	HEX NUT, 1 3/4"-5 SLOTTED HEAVY
36	1697	HEX BOLT, 1"-8 X 7 1/2",GR 5, Y/D
37	1978	HEX NUT, 1 1/2"-6 FULL, GR 2, Y/D
38	6298R	CONNECTING LINK MOUNT
39	155	HEX BOLT, 1"-8 X 3 1/2", GR 5 Y/D
40	16596P	BUSHING,SERRATED GLASS-FILLED NYLON, 2.250"OD X 1.750"ID, 3 11/16" L

ASSEMBLY IDENTIFICATION

FIG. 23: 21-29 ft rigid scraper w/c-flex mount components (Version 2)

Item Number	Reference Number	Description
1	13882B	SCRAPER BLADE W/ARM (10 5/16" L)LEFT RIGID
	13876B	SCRAPER BLADE W/ARM (10 5/16" L)RIGHT RIGID
2	9683	1/2-13 FLANGE TOPLOCK NUT GR G Y/D
3	13886B	SCRAPER ARM, 9 1/2" L
4	6101	CARRIAGE BOLT, 1/2"-13 X 1 3/4", GR5, Y/D
5	1187	CARRIAGE BOLT, 1/2"-13 X 1 1/4", GR5, Y/D
6	6103B	SCRAPER BLADE, 4" W RIGID
7	13884B	SCRAPER, LONG DUAL RIGHT
	13878B	SCRAPER, LONG DUAL LEFT
8	13885B	SCRAPER, SHORT DUAL RIGHT
	13879B	SCRAPER, SHORT DUAL LEFT
9	7143B	SCRAPER BAR, RIGID, 6 HOLE - 8.75"SP, LEFT
10	7143B	SCRAPER BAR, RIGID, 6 HOLE - 8.75"SP, LEFT
11	6773	U-BOLT, 1/2"-13 X 4 1/8" X 2 1/8" X 3 1/4" W, GR 5, Y/D
12	175	HEX BOLT, 3/8"-16 X 1 1/2",GR 5, Y/D
13	5302	PIPE CLAMP, 3/8" BOLT HOLE, Y/D
14	3567	LOCK NUT, 3/8"-16 HEX NYLON INSERT,GR 2, Y/D
15	16348YD	HEX BOLT, 3/4"-10 UNC-2A, 3 1/4" L,GR 8, Y/D
16	1040	LOCK WASHER,3/4" SPLIT TYPE MED,Y/D
17	16349B	MOUNT, SCRAPER RIGHT
	16350B	MOUNT, SCRAPER LEFT
18	7144B	SCRAPER BAR, RIGID, 7 HOLE - 8.75" SP, RIGHT
19	7145B	SCRAPER BAR, RIGID, 7 HOLE - 8.75" SP, LEFT
20	7142B	SCRAPER BAR, RIGID, 6 HOLE - 8.75" SP, RIGHT
21	7142B	SCRAPER BAR, RIGID, 6 HOLE - 8.75" SP, RIGHT
22	7146B	SCRAPER BAR, RIGID, 8 HOLE - 8.75" SP, RIGHT
23	7144B	SCRAPER BAR, RIGID, 7 HOLE - 8.75" SP, RIGHT
24	7174B	SCRAPER BAR, RIGID, 5 HOLE - 8.75" SP, RIGHT
25	7175B	SCRAPER BAR, RIGID, 5 HOLE - 8.75" SP, LEFT
26	7145B	SCRAPER BAR, RIGID, 7 HOLE - 8.75" SP, LEFT
27	7147B	SCRAPER BAR, RIGID, 8 HOLE - 8.75" SP, LEFT
28	7149B	SCRAPER BAR, RIGID, 9 HOLE - 8.75" SP, LEFT (21 FT)
	7153B	SCRAPER BAR, RIGID, 11 HOLE - 8.75" SP, LEFT (23 FT)
	7154B	SCRAPER BAR, RIGID, 13 HOLE - 8.75" SP, RIGHT (26 FT)
29	7148B	SCRAPER BAR, RIGID, 9 HOLE - 8.75" SP, RIGHT (21 FT)
	7152B	SCRAPER BAR, RIGID, 11 HOLE - 8.75" SP, RIGHT (23 FT)
	7155B	SCRAPER BAR, RIGID, 13 HOLE - 8.75" SP, LEFT (26 FT)
30	7143B	SCRAPER BAR, RIGID, 6 HOLE - 8.75" SP, LEFT (21 FT)
	7147B	SCRAPER BAR, RIGID, 8 HOLE - 8.75" SP, LEFT (23 FT)
	7151B	SCRAPER BAR, RIGID, 10 HOLE - 8.75" SP, LEFT (26 FT)
31	7142B	SCRAPER BAR, RIGID, 6 HOLE - 8.75" SP, RIGHT (21 FT)
	7146B	SCRAPER BAR, RIGID, 8 HOLE - 8.75" SP, RIGHT (23 FT)
	7150B	SCRAPER BAR, RIGID, 10 HOLE - 8.75" SP, RIGHT (26 FT)
32	6099YD	HOSE CLAMP BRACKET, Y/D
33	16351B	MOUNT, DUAL SCRAPER
	(A)	21 - 26 FT MODELS
	(B)	29 FT MODEL

ASSEMBLY IDENTIFICATION

FIG. 28: 26 ft disc gang components

Item Number	Reference Number	Description
1	13872PL	SHAFT, 59", 1 3/4" DIA
	13992PL	SHAFT, 58 1/2", 1 3/4" DIA
2	13995PL	SHAFT, 93 1/2", 1 3/4" DIA
	13966PL	SHAFT, 94 1/4", 1 3/4" DIA
3	13993PL	SHAFT, 49 3/4", 1 3/4" DIA
	13887PL	SHAFT, 50 1/4", 1 3/4" DIA
4	16000PL	SHAFT, 111", 1 3/4" DIA
	13965PL	SHAFT, 112", 1 3/4" DIA
5	1964N	BLADE 24", 1 3/4" BORE 4 GA, 3" CONCAVITY
	2686N	BLADE 22", 1 3/4" BORE 4 GA, 2 1/2" CONCAVITY
	9820N	BLADE 22", 1 3/4" BORE 6 GA, 2 1/2" CONCAVITY
	9821N	BLADE 24", 1 3/4" BORE 6 GA, 3" CONCAVITY
	16479N	RB BLADE 24", 1 3/4" BORE 4 GA, 3" CONCAVITY
6	2686N	BLADE 22", 1 3/4" BORE 4 GA, 2 1/2" CONCAVITY
	3271N	BLADE, 20", 1 3/4" BORE, 4 GA, 2" CONCAVITY
7	6639N	BLADE, 18", THREE SIDED, 1 3/4" BORE, 4 GA, 1 3/4" CONCAVITY
	6641N	BLADE 20" THREE SIDED, 1 3/4" BORE 4 GA, 2" CONCAVITY
8	3270N	BLADE, 20", 1 3/4" BORE, 7 GA, 2" CONCAVITY
	3271N	BLADE, 20", 1 3/4" BORE, 4 GA, 2" CONCAVITY
	2686N	BLADE 22", 1 3/4" BORE 4 GA, 2 1/2" CONCAVITY
	9820N	BLADE 22", 1 3/4" BORE 6 GA, 2 1/2" CONCAVITY
	2686N	BLADE 22", 1 3/4" BORE 4 GA, 2 1/2" CONCAVITY
9	3270N	BLADE, 20", 1 3/4" BORE, 7 GA, 2" CONCAVITY
	3271N	BLADE, 20", 1 3/4" BORE, 4 GA, 2" CONCAVITY
	9820N	BLADE 22", 1 3/4" BORE 6 GA, 2 1/2" CONCAVITY
	(A)	2 INCH SMALLER HEAVIER BLADE
	(B)	4 INCH SMALLER 3 SIDED BLADE, 22 INCH BLADES
	(C)	2 INCH SMALLER BLADE
	(D)	2 INCH SMALLER BLADE

ASSEMBLY IDENTIFICATION

FIG. 33: 21-29 ft center frame lift hydraulic components

Item Number	Reference Number	Description
1	4454	90 DEG STR THREAD ELBOW, 3/4"-16 MF X 3/4"-16 MOR
2	10814	CYLINDER, 4" X 10" REPH (22 1/4" CPC) ORB CROSS, 3000 PSI
3	3164	ROLL PIN, 5/16" X 2" SPIRAL MEDIUM DUTY, Y/D
4	5339	PIN, 1" X 4 1/16" (3"), Y/D
5	4484	IN LINE RESTRICTOR, 1/2-14 FPT, W/5/32" REST
6	2425	MALE CONNECTOR, 3/4"-16 MF X 1/2-14 MPT
7	4027002	HOSE, 3/8" X 27" L, FEMALE ENDS
8	4464	STRAIGHT THD.CONNECTOR, 7/8"-14 MF X 3/4"-16 MOR
9	4458	PLUG, 3/4"-16 MOR
10	4084002	HOSE, 3/8" X 84" L, FEMALE ENDS (21 FT)
	4090002	HOSE, 3/8" X 90" L, FEMALE ENDS (23 FT)
	4102002	HOSE, 3/8" X 102" L, FEMALE ENDS (26 FT)
	4118002	HOSE, 3/8" X 118" L, FEMALE ENDS (29 FT)
11	4132002	HOSE, 3/8" X 132" L, FEMALE ENDS (21 FT)
	4136002	HOSE, 3/8" X 136" L, FEMALE ENDS (23 FT)
	4148002	HOSE, 3/8" X 148" L, FEMALE ENDS (26 FT)
	4164002	HOSE, 3/8" X 164" L, FEMALE ENDS (29 FT)
12	4024002	HOSE, 3/8" X 24" L, FEMALE ENDS
13	9679	MALE BRANCH TEE, 3/4"-16 MF X 1/2-14MPT
14	12775YD	UNION TEE, 3/4"-16 MF X 7/8"-14 MF
15	3567	LOCK NUT, 3/8"-16 HEX NYLON INSERT, GR 2, Y/D
16	16903P	COUPLER, MALE HALF, 3/4"-16 ORB
17	175	HEX BOLT, 3/8"-16 X 1 1/2", GR 5, Y/D
18	5302	PIPE CLAMP, 3/8" BOLT HOLE, Y/D
19	4228005	HOSE, 1/2" X 228" L, FEMALE ENDS
20	4189005	HOSE, 1/2" X 189" L, FEMALE ENDS (26-29 FT)
21	4048002	HOSE, 3/8" X 48" L, FEMALE ENDS
22	4114002	HOSE, 3/8" X 114" L, FEMALE ENDS (21 FT)
	4120002	HOSE, 3/8" X 120" L, FEMALE ENDS (23 FT)
	4132002	HOSE, 3/8" X 132" L, FEMALE ENDS (26 FT)
	4148002	HOSE, 3/8" X 148" L, FEMALE ENDS (29 FT)

(A) HOSE CLAMP ON BOTTOM SIDE OF FRAME FOR HOSES GOING TO FRONT OF TONGUE

ASSEMBLY IDENTIFICATION

FIG. 38: 30-36 ft right wing hydraulic components

Item Number	Reference Number	Description
1	4454	90 DEG STR THREAD ELBOW, 3/4"-16 MF X 3/4"-16 MOR
2	10815R	CYLINDER, 3 3/4" X 10" REPH (22 1/4"CPC) ORB CROSS, 3000 PSI
3	3164	ROLL PIN, 5/16" X 2" SPIRAL MEDIUM DUTY, Y/D
4	5339	PIN, 1" X 4 1/16" (3"), Y/D
5	7334	ADJUSTABLE CYLINDER BLOCK/ Y/D
6	2079	JAM NUT, 1 1/2"-6 HEX, GR 2, Y/D
7	4623	GUIDE PIN, Y/D
8	4108002	HOSE, 3/8" X 108" L, FEMALE ENDS (30 FT)
	4123002	HOSE, 3/8" X 123" L, FEMALE ENDS (33 FT)
	4139002	HOSE, 3/8" X 139" L, FEMALE ENDS (36 FT)
9	4162002	HOSE, 3/8" X 162" L, FEMALE ENDS (30 FT)
	4177002	HOSE, 3/8" X 177" L, FEMALE ENDS (33 FT)
	4193002	HOSE, 3/8" X 193" L, FEMALE ENDS (36 FT)
10	175	HEX BOLT, 3/8"-16 X 1 1/2",GR 5, Y/D
11	176	LOCK WASHER,3/8" SPLIT TYPE MED,Y/D
12	5302	PIPE CLAMP, 3/8" BOLT HOLE, Y/D

ASSEMBLY IDENTIFICATION

FIG. 43: 36 ft fold hydraulic components

Item Number	Reference Number	Description
1	10812R	CYLINDER, 4" X 30" (40 1/4" CPC) ORB CROSS, 3000 PSI
2	4455	90 DEG STR THD ELBOW, 3/4"-16 MF
3	4473	SWIVEL NUT BRANCH TEE, 3/4"-16 MF
4	4482	UNION CROSS, 3/4"-16 MF
5	4472	90 DEG SWIVEL ELBOW, 3/4"- 16 MF
6	4052002	HOSE, 3/8" X 52" L, FEMALE ENDS
7	4137002	HOSE, 3/8" X 137" L, FEMALE ENDS
8	4107002	HOSE, 3/8" X 107" L, FEMALE ENDS
9	4075002	HOSE, 3/8" X 75" L, FEMALE ENDS
10	4105002	HOSE, 3/8" X 105" L, FEMALE ENDS
11	4255002	HOSE, 3/8" X 255" L, FEMALE ENDS
12	4020002	HOSE, 3/8" X 20" L, FEMALE ENDS
13	4048002	HOSE, 3/8" X 48" L, FEMALE ENDS
14	4080002	HOSE, 3/8" X 80" L, FEMALE ENDS
15	3164	ROLL PIN, 5/16" X 2" SPIRAL MEDIUM
16	245	FLAT WASHER, 1" WIDE RIM, Y/D
17	5251	PIN, 1" X 5 13/16" (4 1/2"), Y/D
18	5339	PIN, 1" X 4 1/16" (3"), Y/D
19	474	HEX BOLT, 3/8"-16 X 2", GR 5 Y/D
20	5302	PIPE CLAMP, 3/8" BOLT HOLE, Y/D
21	3567	LOCK NUT, 3/8"-16 HEX NYLON INSERT,GR 2, Y/D
22	3806	HEX BOLT, 3/8"-16 X 3", GR 5, Y/D
23	176	LOCK WASHER,3/8" SPLIT TYPE MED,Y/D
24	4463	STRAIGHT THD.CONNECTOR, 3/4"-16
25	16903P	COUPLER, MALE HALF, 3/4"-16 ORB
	(A)	HOSE CLAMP ON BOTTOM SIDE OF FRAME FOR HOSES GOING TO FRONT OF TONGUE

FIG. 48: Rear tow hitch hydraulic components

Seq	Reference Number	Description
1	10742	SO HYDRAULIC DUST CAP
2	10741	SO HYDRAULIC DUST PLUG
3	194	HEX BOLT, 1/2"-13 X 1 1/2",GR 5, Y/D,USA
4	10740	SO HYDRAULIC CLAMP
5	10739	SO HYDRAULIC COUPLER, FEMALE THREAD
6	2425	MALE CONNECTOR, 3/4"-16 MF X 1/2-14 MPT
7	4420002	HOSE, 3/8" X 420" L, FEMALE ENDS
8	2096	LOCK NUT, 1/2"-13 HEX NYLON INSERT, GR 8, Y/D
9	5302	PIPE CLAMP, 3/8" BOLT HOLE, Y/D
10	176	LOCK WASHER,3/8" SPLIT TYPE MED,Y/D
11	3984	HEX BOLT, 3/8"-16 X 1 1/4",GR 5, Y/D
12	474	HEX BOLT, 3/8"-16 X 2", GR 5 Y/D
13	3806	HEX BOLT, 3/8"-16 X 3", GR 5, Y/D
14	3253	HYDRAULIC COUPLER, MALE HALF
15	9963	U-BOLT, 1/2"-13 X 3 1/4" X 4 9/16"W,GR 2, Y/D
16	18036R	BRACKET, COUPLER MOUNTING
	(A)	COUPLER MOUNTING BRACKET LOCATION
	(B)	SINGLE HOSE BRACKET MOUNTING
	(C)	DOUBLE HOSE BRACKET MOUNTING
	(D)	TRIPLE HOSE BRACKET MOUNTING

COMPONENT PLACEMENT

The drawings in this section give mounting locations for various machine components.

1435 MACHINE SPECIFICATIONS

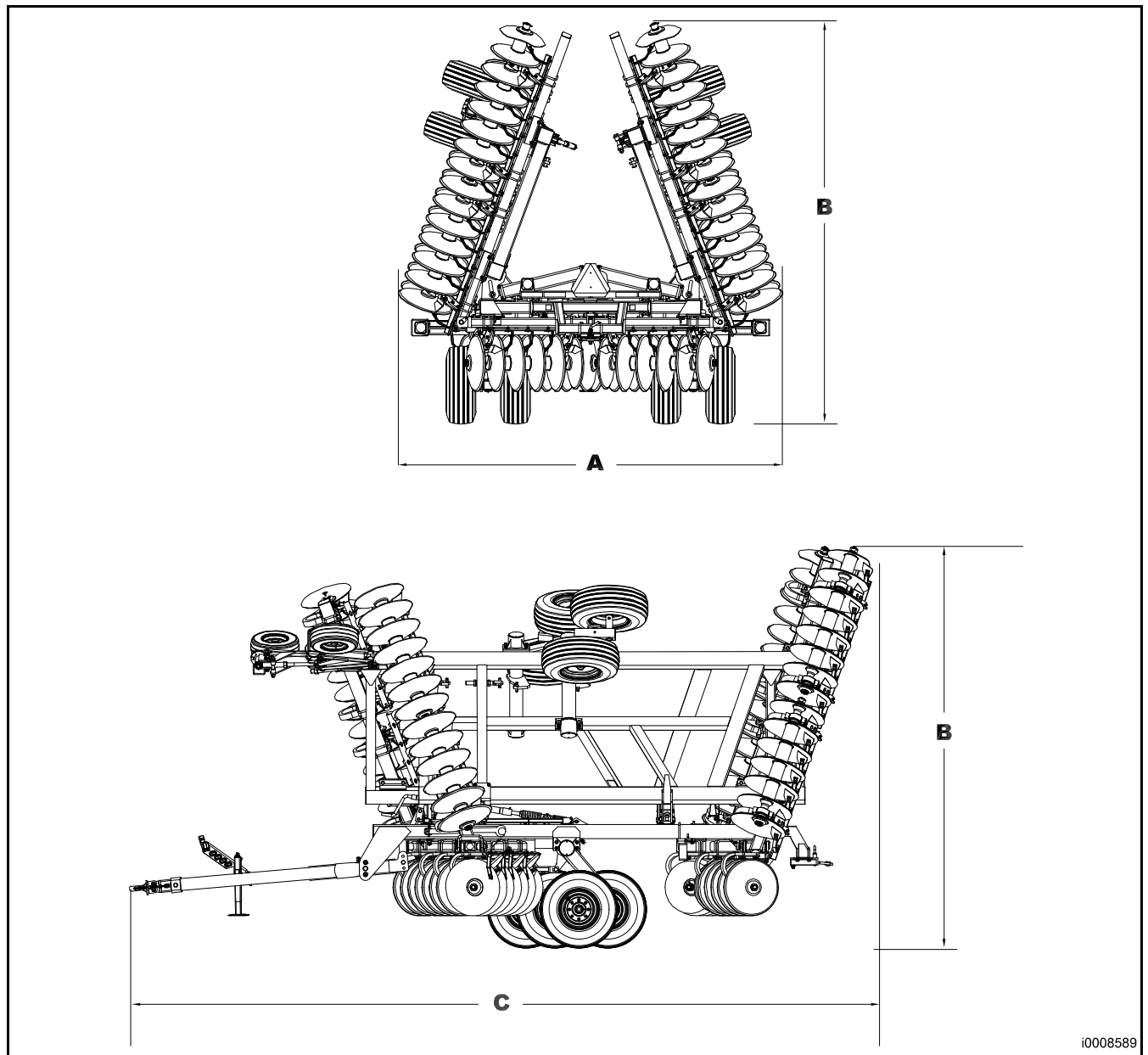

FIG. 1

FIG. 1: 1435 Transport Dimensions (Top and side view)

Model	Transport Width (A)	Transport Height (B)	Transport Length (C)
1435-21	4.1 m (13 ft 5 in)	2.85 m (9 ft 4 in)	7.47 m (24 ft 6 in)
1435-23	4.1 m (13 ft 5 in)	3.2 m (10 ft 6 in)	7.62 m (25 ft)
1435-26	4.1 m (13 ft 5 in)	3.6 m (11 ft 9 in)	7.75 m (25 ft 5 in)
1435-29	4.1 m (13 ft 5 in)	4.1 m (13 ft 5 in)	7.9 m (26 ft)
1435-30	5.4 m (17 ft 8 in)	3.6 m (11 ft 9 in)	7.95 m (26 ft 1 in)
1435-33	5.4 m (17 ft 8 in)	4.1 m (13 ft 5 in)	8.1 m (26 ft 7 in)
1435-36	5.4 m (17 ft 8 in)	4.6 m (15 ft 2 in)	8.2 m (27 ft)

CLICK HERE TO **DOWNLOAD** THE COMPLETE MANUAL

- Thank you very much for reading the preview of the manual.
- You can download the complete manual from: www.heydownloads.com by clicking the link below



- Please note: If there is no response to CLICKING the link, please download this PDF first and then click on it.

CLICK HERE TO **DOWNLOAD** THE COMPLETE MANUAL