

ORIGINAL INSTRUCTIONS

CX145D SR
Crawler Excavator

OPERATOR'S MANUAL

Part number 90393854
1st edition English
July 2020



CLICK HERE TO **DOWNLOAD** THE COMPLETE MANUAL

- Thank you very much for reading the preview of the manual.
- You can download the complete manual from: www.heydownloads.com by clicking the link below



- Please note: If there is no response to CLICKING the link, please download this PDF first and then click on it.

CLICK HERE TO **DOWNLOAD** THE COMPLETE MANUAL

Manual scope and required training level

Introduction to this manual

This manual gives information about the use of your CASE CONSTRUCTION machine as intended and under the conditions foreseen by CASE CONSTRUCTION during normal operation, routine service, and maintenance.

This manual does not contain all the information that relates to periodic service, conversions, and repairs that only trained service personnel can perform. Some of these activities may require appropriate facilities, technical skills, and/or tools that CASE CONSTRUCTION does not supply with the machine.

The manual contains the chapters as shown on the Contents pages. See the Index at the end of this manual to locate specific items about your CASE CONSTRUCTION machine.

Normal operation

Normal operation consists of the use of this machine for the purpose CASE CONSTRUCTION intends by an operator that:

- Is familiar with the machine and any mounted equipment or towed equipment
- Complies with the information on operation and safe practices as specified by CASE CONSTRUCTION in this manual and by the signs on the machine

Normal operation includes:

- Preparation and storage of the machine
- Addition and removal of ballast
- Connection and disconnection of mounted equipment and/or towed equipment
- Adjustment and configuration of the machine and equipment for the specific conditions of the job site, field, and/or crop
- Movement of components into and out of working positions

Routine service and maintenance

Routine service and maintenance consists of the daily activities necessary to maintain the proper machine function. The operator must:

- Be familiar with the machine characteristics
- Comply with the information on routine service and safe practices as specified by CASE CONSTRUCTION in this manual and by the signs on the machine

Routine service can include:

- Fueling
- Cleaning
- Washing

- Topping up fluid levels
- Greasing
- Replacing consumable items such as light bulbs

Periodic service, conversions, and repairs

Periodic service consists of activities that are necessary to maintain the expected life of the CASE CONSTRUCTION machine. These activities have defined intervals.

Trained service personnel familiar with the machine characteristics must perform these activities at the defined intervals. Trained service personnel must comply with the information on periodic service and safe practices as partly specified by CASE CONSTRUCTION in this manual and/or other company literature.

Periodic service includes:

- Oil change service for the engine, hydraulic circuits, or transmission
- Periodic exchange of other substances or components as required

Conversion activities rebuild the CASE CONSTRUCTION machine in a configuration that is appropriate for a specific job site, crop, and/or soil conditions (e.g., installation of dual wheels). Conversion activities must be done:

- By trained service personnel familiar with the machine characteristics
- By trained service personnel that comply with the information on conversion as partly specified by CASE CONSTRUCTION in this manual, assembly instructions, and/or other company literature

Repair activities restore proper function to a CASE CONSTRUCTION machine after a failure or degradation of performance. Dismantling activities occur during the scrapping and/or dismantling of the machine.

Trained service personnel familiar with the machine characteristics must perform these activities. Trained service personnel must comply with the information for repair as specified by CASE CONSTRUCTION in the service manual.

Before you operate

Read this manual before you start the engine or operate this CASE CONSTRUCTION machine. Contact your CASE CONSTRUCTION dealer if:

- You do not understand any information in this manual
- You need more information
- You need assistance

If the machine will exceed a four month shut down period:

1. Perform a complete after-run procedure.
2. Drain the **DEF/AdBLUE®** tank.
3. Flush the tank with deionized water.
4. Drain the deionized water

NOTICE: do not disconnect any electrical connections from the SCR system.

Machine start-up after extended shutdown:

1. Fill the **DEF/AdBLUE®** tank.
2. Replace the main filter in the supply module.
3. Start the machine.

Thawing

- Your CASE CONSTRUCTION machine is equipped with an internal tank heater to thaw frozen **DEF/AdBLUE®**. Your machine will still function until the **DEF/AdBLUE®** begins to flow. The SCR system will then function normally.

NOTE: you may notice a slight reduction in engine torque in high demand situations until the **DEF/AdBLUE®** is fully thawed.

- Do not heat **DEF/AdBLUE®** for long periods of time at temperatures above **30 °C (86 °F)**. This causes the solution to decompose, which very slowly decreases the expected shelf life.

NOTICE: do not use an anti-gelling or freeze point improver in your **DEF/AdBLUE®**. The **32.5%** solution is specifically designed to provide the optimum NO_x reduction properties. Any further blending or adjusting of the **DEF/AdBLUE®** mixture will lessen its ability to perform correctly and may cause damage to the components of the SCR system.

Handling and supply of additives, if any.

- Personal Protective Equipment (PPE) is not required under normal conditions. If splashing is likely, wear eye protection. For prolonged or repeated contact, impervious gloves are recommended. Follow the precautions listed in the SAFETY INFORMATION chapter when handling any service fluid.
- No additives are required.

NOTICE: contaminated **DEF/AdBLUE®** can affect the performance of your machine. Follow all instructions in this manual when handling **DEF/AdBLUE®**.

Shelf life

Constant ambient storage temperature	Minimum shelf life
Less than or equal to 10 °C (50 °F)	36 months
Less than or equal to 25 °C (77 °F) ¹	18 months
Less than or equal to 30 °C (86 °F)	12 months
Less than or equal to 35 °C (95 °F)	6 months
Greater than 35 °C (95 °F)	- ²
¹ To prevent decomposition of DEF/AdBLUE® , prolonged transportation or storage above 25 °C (77 °F) should be avoided.	
² Significant loss of shelf life: check every batch before use. See your CASE CONSTRUCTION dealer for more information on testing.	

NOTE: the main factors taken into account to define the shelf life in the table above are the ambient storage temperature and the initial alkalinity of **DEF/AdBLUE®**. The difference in evaporation between vented and non-vented storage containers is an additional factor.

NOTE: the information in this table is for reference only and has been provided by the International Organization for Standardization, Document number **ISO 22241-3** Diesel engines - NO_x reduction agent AUS 32 - Part 3: Handling, transportation and storage.

NOTE: **DEF/AdBLUE®** that remains in the tank of the machine after the season does not require any special precautions unless storage exceeds the shelf life table above.

Disposal

- When alighting from or getting into the operator's compartment, always face the machine and use the steps and access handles.
- Be sure you know the position and function of each control. Incorrect operation of the controls can cause serious injuries.
- Check all controls and safety devices in a safe, open area before starting work.
- Keep away from dangerous areas such as ditches, overhangs, rocky areas, etc. Make a survey of the work-site and determine the possible dangers before using the machine.
- Before parking the machine, make sure that the ground is stable. Plan the worksite so that the ground is flat, hard and level.
- Before moving the machine to work in a new area, walk around to determine all possible causes of accidents there. Holes, obstacles, debris and other danger risks in the working area can cause serious injury.
- Be ready to meet emergencies. Always carry a first aid kit and if possible, fire extinguisher (not supplied) within easy reach on board. Make sure the fire extinguisher is regularly serviced in conformance with the manufacturer's instructions.
- Check the fastening of the main components: counterweight, turntable bearing and operator's compartment. In the event of problems, consult your CASE CONSTRUCTION Dealer.
- Make sure you understand the symbols used on the machine safety decals. Keep the decals clean so that they are perfectly legible at all times.
- Work out a means of convenient escape from the machine (emergency exit via the windshield or the rear window glass) in the event of the machine turning over or tipping over or the cab door being jammed.
- Make sure you are perfectly familiar with traffic regulations and special safety equipment requirements before transporting this machine on a public highway.
- When loading trucks, never swing the load over the truck cab.
- Before undertaking any travel on the job site, make sure the itinerary to be followed is completely safe. If bridges are to be crossed, make sure they are perfectly capable of supporting the weight of the machine.
- Always steer round large obstacles such as boulders, big trees, etc.

Quick coupler (optional)

- Every day, check that the locking bar functions correctly and that it is not fouled by foreign matter. Clean the locking system if necessary.
- If you are obliged to use the quick coupler with buckets not manufactured by CASE CONSTRUCTION, make sure the diameter of the pins and the width between the bucket lugs meet the dimensions needed to fit the quick coupler (pins, washers, bushings, etc.). Consult your CASE CONSTRUCTION Dealer.

Operating the machine

- When working on a public highway, use standard traffic signs and take into consideration the working range of the upperstructure and its attachments. Local or national regulations stipulate the number, type and location of reflector strips.
- Avoid running the engine in a confined space. If there is no alternative, proper ventilation must be provided at all times.
- Do not allow anyone else on the machine. The passenger could fall or cause an accident.
- Never operate the working or travel controls unless you are properly seated in the operator's seat with the seat belt correctly fastened.
- Before starting the engine, check the direction of travel (in forward drive, the reduction gears should be to the rear of the machine).
- Do not work near overhead high-voltage electric lines without checking beforehand that all necessary measures have been taken to respect the minimum distances:
Less than 57000 volts: **3 m (9.8 ft)**.
More than 57000 volts: **5 m (16.4 ft)**.
- Study the position of any existing pipelines or conduits before starting work. Electrical cables, gas and water pipes and other underground installations can cause serious injury.
- Always make allowance for working conditions (sloping or rough ground), the site and weather conditions when driving the machine.
- Do not allow anyone to stand in the machine working area. Accidental operation of the upperstructure swing control or of an attachment control could cause an accident. Stop all operations until everyone has moved away.
- Before operating the dozer blade (if equipped) make sure that there is no one in the working area of the latter.
- Operate all controls gradually to ensure smooth machine operation.
- Whenever load handling operations are to be carried out, it is imperative to adhere strictly to the instructions given in this manual and local legislation.
- It is forbidden to use the machine to carry out tasks other than those for which it is intended. Never use the equipment for sweeping the ground to level out rubble or push objects (transversal stress on the attachment).
- Stop the engine and remove the ignition key when the machine is not in use, even for short periods of time.

Decal positions

When replacing a decal, make sure it is located as shown below.

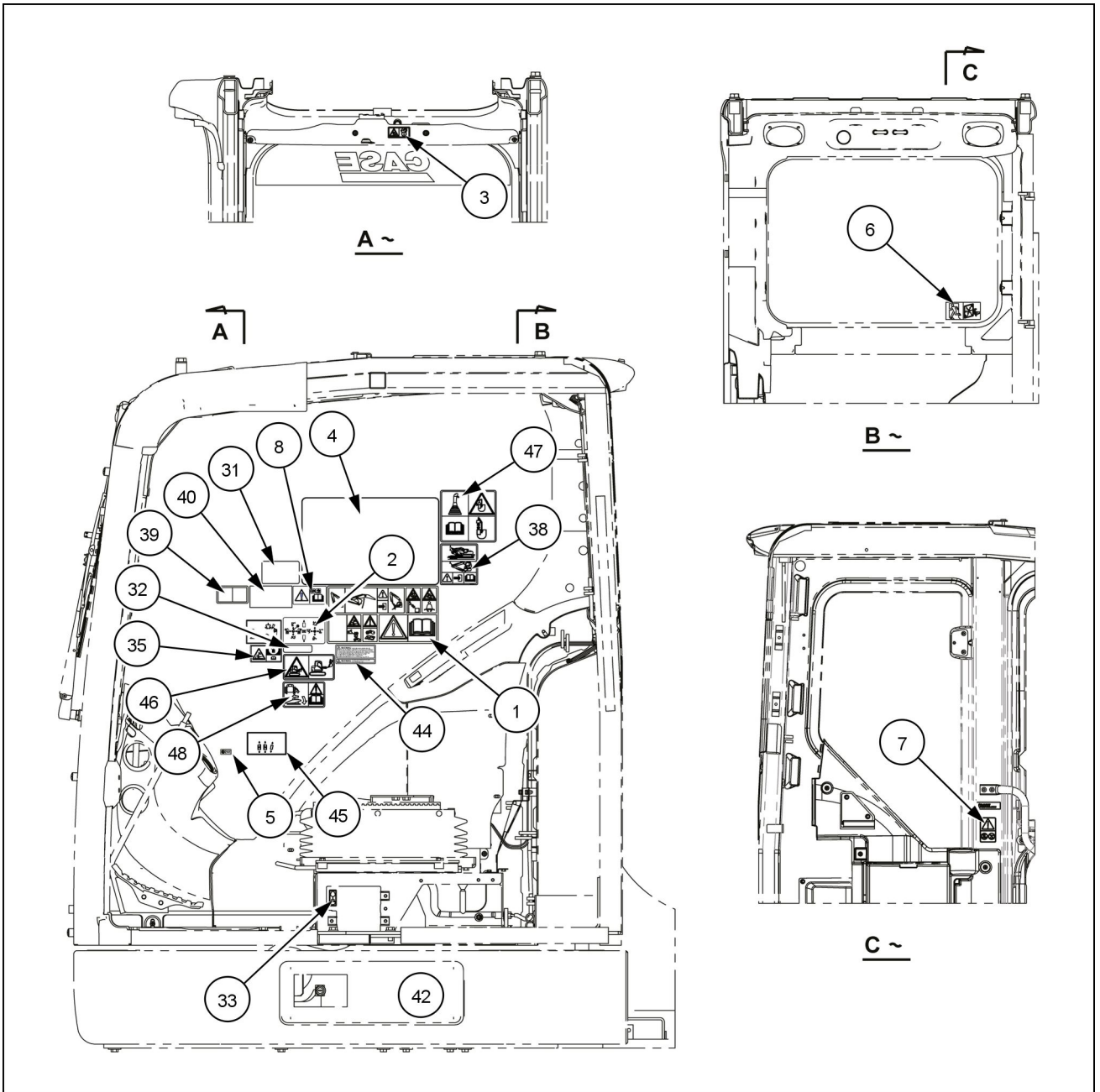

SMIL20CEX1306GA 1

(25) Service table

Part number: KMP15311 (CX145D SR LC)

Part number: KMP15151 (CX145D SR with blade)

Part number: KMP16211 (CX145D SR Offset Boom with blade)

Reference chart indicating proper timing for machine maintenance.

Make sure to read operator's manual to understand proper procedures for servicing the machine.

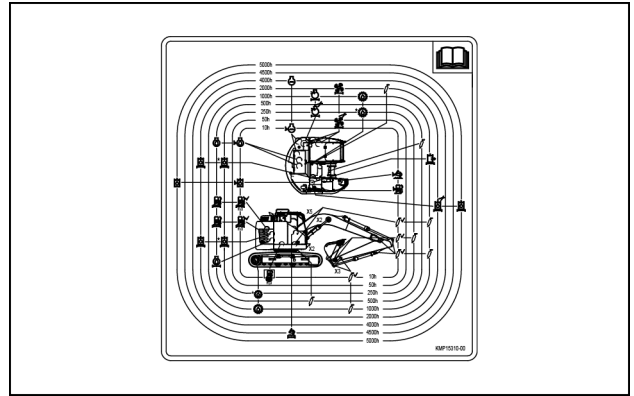

KMP15310 33

(26) Lashing point decal

Part number: KHP15201

Point on machine structure for securing the machine during transport.

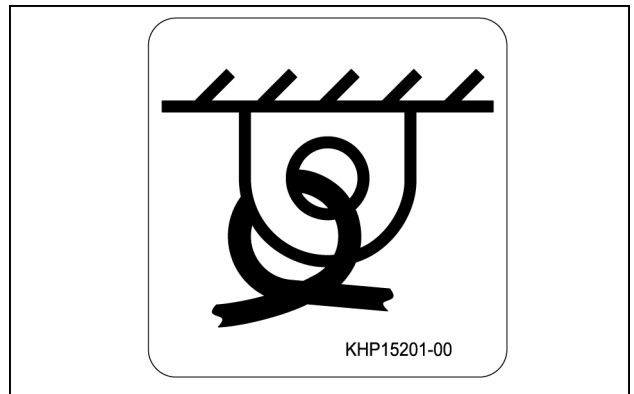

SMIL15CEX0447AA 34

(27) Lifting location

Part number: KHP19380

Machine area where the lifting devices shall be routed.

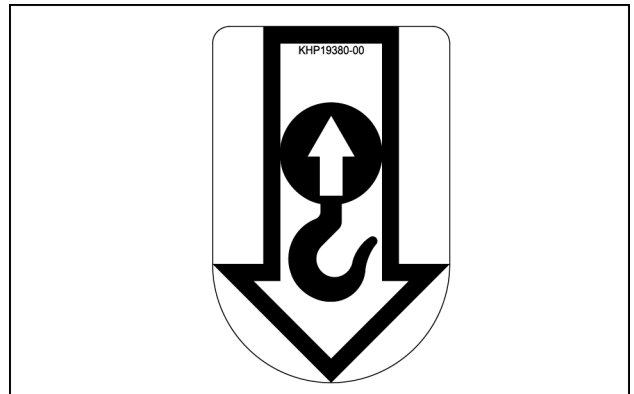

SMIL15CEX0450AA 35

(28) Fuel tank

Part number: KHP35840

Do not perform welding and avoid any operation generating sparks close to the fuel tank.

Fuel is flammable and flames can cause serious injuries.

Do not fill the fuel tank with water, **DEF/AdBLUE®** or any fluid other than Ultra Low Sulfur diesel fuel.

Using any other kind of fuel will cause serious damages to the machine.

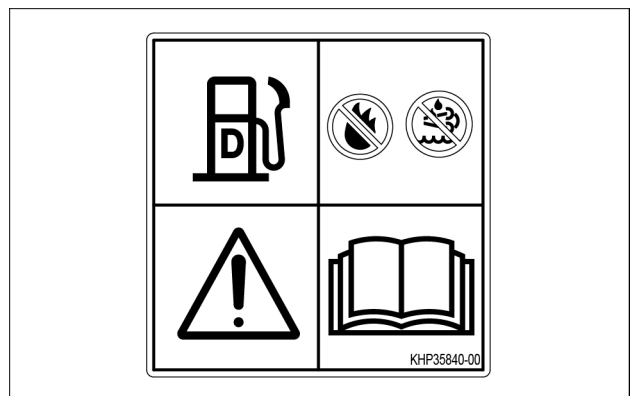

KHP35840 36

Make sure to read operator's manual to understand proper procedures to be used for storage and usage of Ultra Low Sulfur diesel fuel.

Armrest angle adjustment

- Raise the armrest.
- Adjust the armrest to the desired angle using the knob (7).
- Lower the armrest.

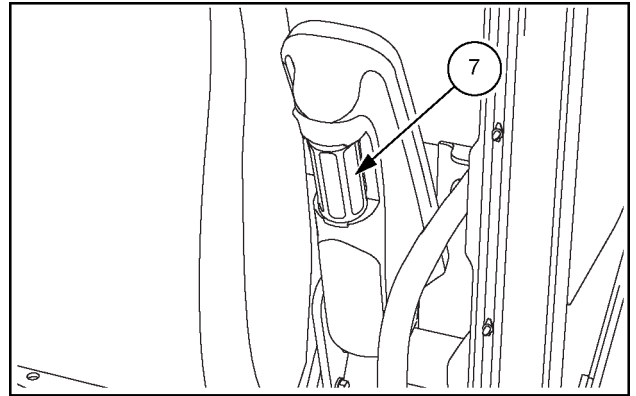

SMIL14CEX1660AB 7

Headrest adjustment

- The headrest (8) can be adjusted upwards and downwards and backwards and forwards.

NOTE: to make the headrest return to its initial position (to the rear), tilt it completely forwards and then release it.

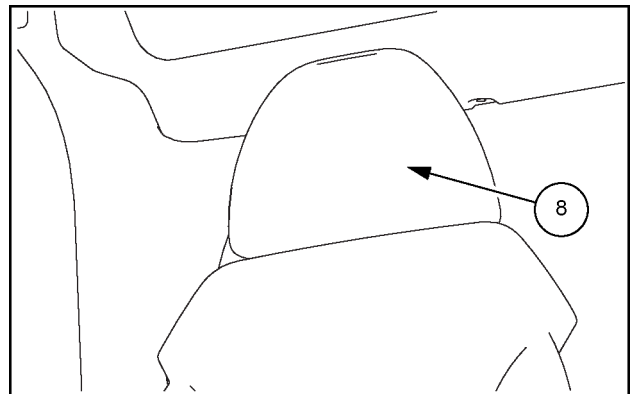

SMIL14CEX1661AB 8

Seat heater

- When the switch (10) is turned on, both the backrest and the seat area will be warmed.

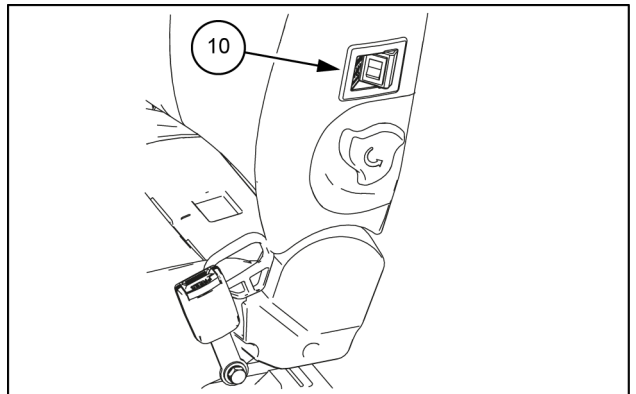

SMIL14CEX1662AB 9

Seat angle adjustment section

- Pull up the lever (11) to adjust the inclination of the seat.
- Release the lever at an appropriate angle.

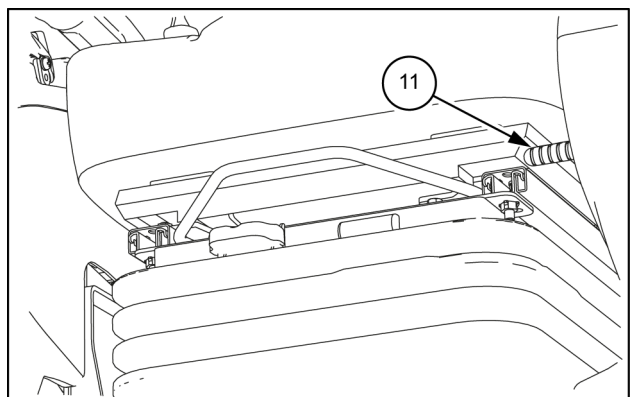

SMIL14CEX1663AB 10

Left-hand side controls

Left-hand side controls

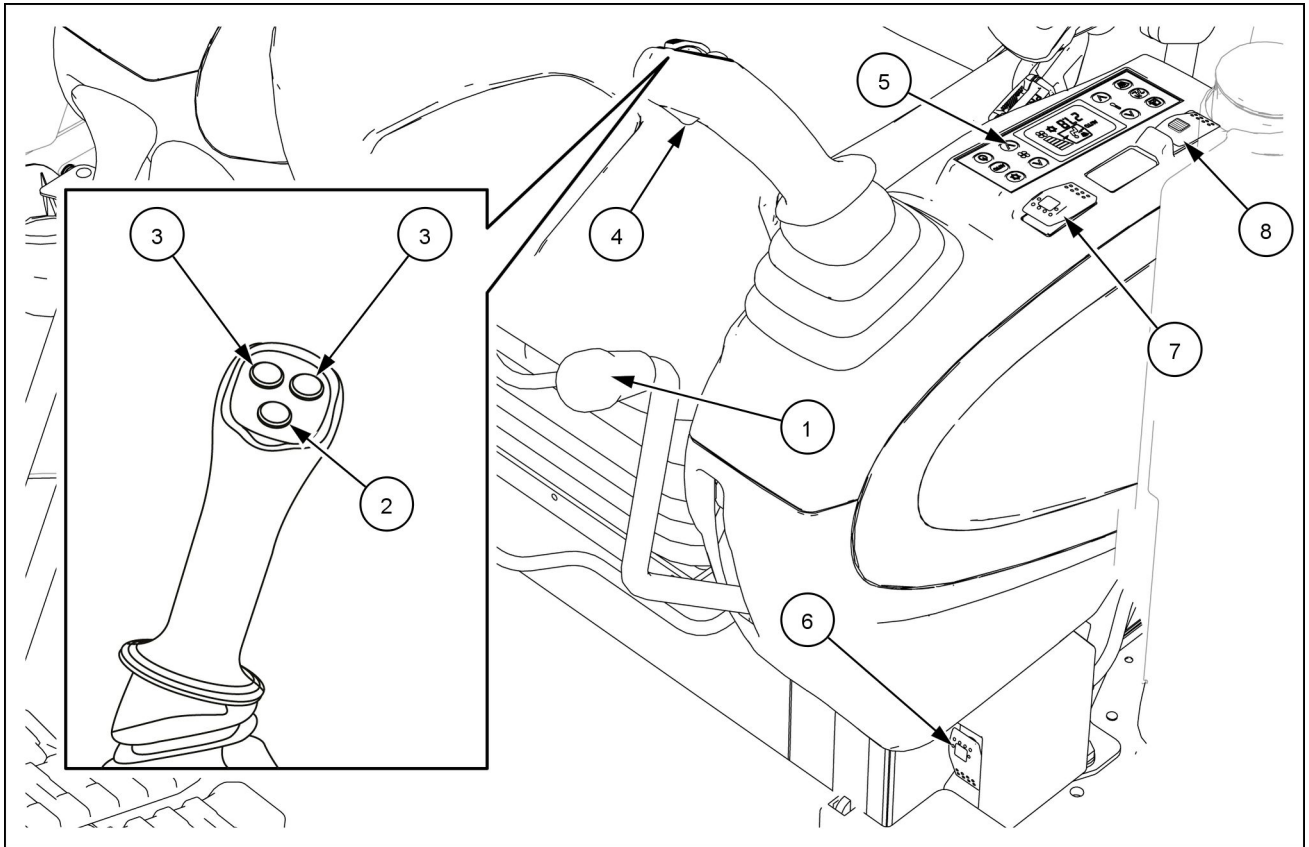

SMIL19CEX2682FA 1

(1) Gate lock lever.

(2) Horn button.

NOTICE: make sure to sound the horn before starting the engine and resuming machine operation.

(3) Not active.

(4) Radio mute button (mono-boom version): the radio mute button is located underneath the control lever. Push the button to mute the volume. Push it again to resume the volume.

(4) Temporary cancellation button (Offset Boom version): the temporary cancellation button is located underneath the control lever. Keep the button pressed to temporary override the cab interference prevention system. Refer to page 4-10.

NOTICE: The temporary cancellation button is intended for seldom usage in special operating conditions. Make sure not to get the attachment too close to the cab if not strictly necessary.

(5) Control of heating, ventilation or air conditioning.

(6) Emergency stop switch (Refer to Chapter 4).

(7) Free swing button: the button sets the condition of swing stop. If the free swing is activated the swing stop is delayed. Press the button to activate the free swing function. The free swing icon appears on the monitor. Press the button again to deactivate the function.

The free swing function is intended to be used especially for load handling application to avoid loads from slinging.

The free swing function is automatically deactivated when stopping the engine.

NOTICE: avoid working on a slope with the free swing function active. The swing becomes hard to stop.

NOTICE: when parking on a slope, never activate the free swing function from the machine parking position. The machine may start to swing because the swing parking brake is released.

(8) Emergency release switch (Offset Boom version): Slide the lock device and press the front side of the switch to set the emergency release status of the interference prevention system. Refer to page 4-10.

NOTICE: The emergency release switch is intended for exceptional usage when the interference prevention system has a failure and needs to be serviced. Never use the switch during regular machine operation.

When the machine is equipped with an auxiliary high-flow hydraulic circuit, the right-hand control lever includes:

1. Proportional switch to operate double-acting hydraulic attachments.
2. ON/OFF button to operate single-acting hydraulic attachments.
3. Engine low idle speed button.

NOTICE: Do not operate controls for auxiliary high-flow hydraulic circuit without setting any flow rate/pressure combination. The circuit would work by default at maximum pressure, and this may lead to severe damages to the attachment. For the setting procedure of auxiliary high-flow hydraulic circuit, refer to Chapter 9.

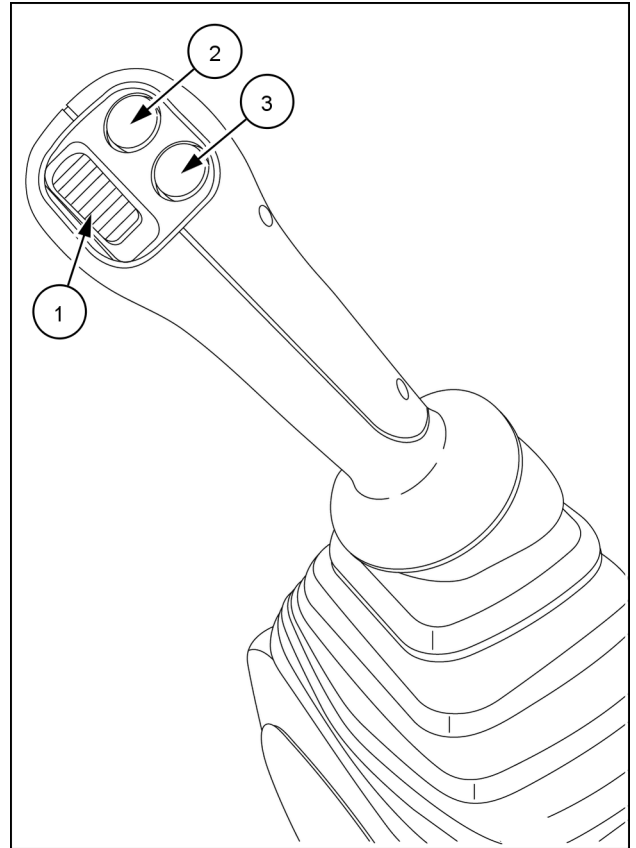

SML15CEXY838BA 2

Engine speed throttle and work mode selection

The engine speed throttle allows to increase or decrease the engine speed.

Three work modes are selectable:

Select the A mode for loads handling and high precision operations.

Select the H mode for general digging and truck loading operations.

Select the SP mode for heavy digging operations.

NOTE: to select the SP mode, turn the work mode selector clockwise while holding down the pin.

The work mode currently selected is indicated by a specific icon on the display:



The A work mode is selected.



The H work mode is selected.



The SP work mode is selected.

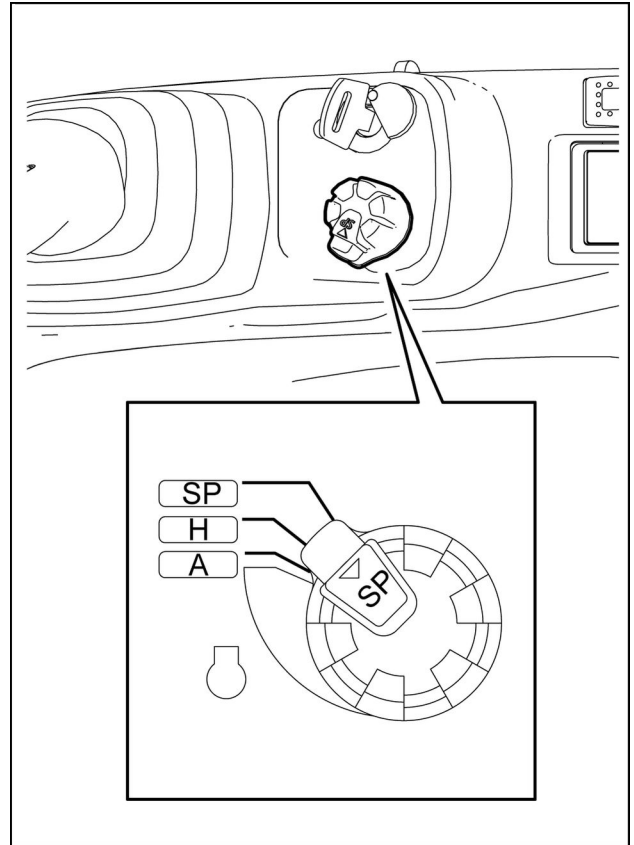

SMIL19CEX2704BA 6

Power boost

The machine control system automatically manages a boost of the hydraulic power in order to optimize the machine performance.

The activation of the Power boost is related to each work mode:

The Power boost is always active in the A work mode.

The Power boost is activated for **8 s** in the H work mode.







The Power boost is activated for **8 s** in the SP work mode.

The activation of the Power boost in the H or SP work mode is indicated by a specific icon on the display:





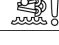

Power boost is active

NOTE: The power boost is not active on CX145D SR Offset Boom with blade.

Icon and text	Explanation	Action
 CHECK CAMERA	CHECK CAMERA: The cameras or the camera wirings have a failure.	Stop the engine, and contact the CASE CONSTRUCTION dealer immediately.
 LOW COOLANT	LOW COOLANT: The level of the coolant in the engine cooling system is low.	Stop the engine, and refill the reserve tank with coolant. Start the engine, and check for coolant leaks. If any leak is found, or if the message persists, contact the CASE CONSTRUCTION dealer immediately.
 AIR FILTER	AIR FILTER: The air cleaner element is clogged.	Stop the engine, and clean or replace the air cleaner element.
 HYD. OIL FILTER	HYD. OIL FILTER: The hydraulic return filter is clogged. The message is active if the machine is equipped with Single-acting or Multi-function auxiliary high-flow hydraulic circuit.	Stop the engine and check the hydraulic return filter. Replace it if any clogging is found.
 FUEL FILTER	FUEL FILTER: The fuel pre-filter or the fuel main filter is clogged. The engine goes automatically to low idle.	Stop the engine, and replace the filter element. Start the engine, and if the message persists, contact the CASE CONSTRUCTION dealer immediately.
 CHECK SCR SYSTEM	CHECK SCR SYSTEM: The SCR system has a failure and does not function properly.	Stop the engine, and contact the CASE CONSTRUCTION dealer immediately.
 CHECK CAB INTERFERENCE	CHECK CAB INTERFERENCE: The attachment gets beyond the interference prevention area, and may hit the cab.	Press the temporary cancellation button, and operate the control levers to move the attachment away from the cab. If the attachment doesn't move, refer to the emergency procedure described on page 4-10.

Messages with orange background

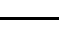
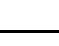
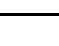
Icon and text	Explanation	Action
 ENGINE STOP	ENGINE STOP: the engine has been stopped by the emergency stop switch.	To start the engine again, press on the back of the emergency stop switch, turn the starter key to OFF position, and then restart the engine.
 IMPROPER SHUT DOWN	IMPROPER SHUT DOWN: The engine has been stopped without cooling it down.	Restart the engine, and keep it at a low idle for at least 5 min.
 OVER LOAD	OVER LOAD: an overload condition is detected during the handling of an object.	Place the load onto the ground and check the load conditions making reference to the chart located inside the cab.
 LOW FUEL	LOW FUEL: The fuel level in the tank is low.	Stop the engine, and add fuel to the fuel tank.
 CHECK FLOW RATE	CHECK FLOW RATE: The set up of the auxiliary hydraulics is not proper.	Check the specifications of the attachment currently in use, and set appropriate flow.
 AUXILIARY SET-UP REQUIRED	AUXILIARY SET-UP REQUIRED: The operation with the hydraulic attachment is attempted without any set up of the auxiliary hydraulics.	Check the specifications of the attachment currently in use, and set up the auxiliary hydraulics accordingly.
 SERVICE DUE	SERVICE DUE: One or more periodical maintenance operations are due.	Check the maintenance chart, and carry out the required maintenance operations.

External input

- Audio can be output from the speakers on the machine by connecting a commercially-available portable audio device.
- Always keep appropriate volume for the portable audio device.

- 1 USB memory
- 2 AUX input terminal

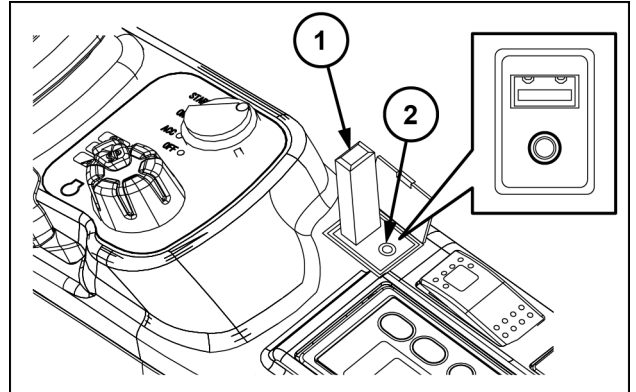

SMIL15CEX0754AA 2

AUX

- Press the MODE button to switch the audio source and check that AUX is shown on the display.
- Connect from the headphone terminal of your portable audio device using a commercially-available cord (without resistance).
- Use any commercially-available stereo mini-plug cord (D3.5) for external input terminal side. Do not use a connection cord with the wrong size or wrong shape jack.
- The volume also can be adjusted with the volume buttons on the radio unit.

USB

- Files in MP3/WMA/AAC formats are supported.
- Press the MODE button to switch the audio source and check that USB is shown on the display.
- Connect a USB memory to the USB input terminal. Playable data stored in the memory is played automatically.

Button operations when USB is selected as an audio source

Button operations		Function
UP/DOWN		Folder up/down
PRESET1		REPEAT
PRESET2		RANDOM
PRESET3	Short press	Track down
	Long press	Fast forward (while being pressed)
PRESET4	Short press	Track up
	Long press	Rewind (while being pressed)
PRESET5		PLAY/PAUSE
Volume adjustment button +		Volume up
Volume adjustment button -		Volume down

Bottom-left mirror (B)

The mirror shall be installed as shown in the picture.

The dimension (L1) is 10 mm (0.4 in).

The dimension (L2) is 658 mm (25.9 in).

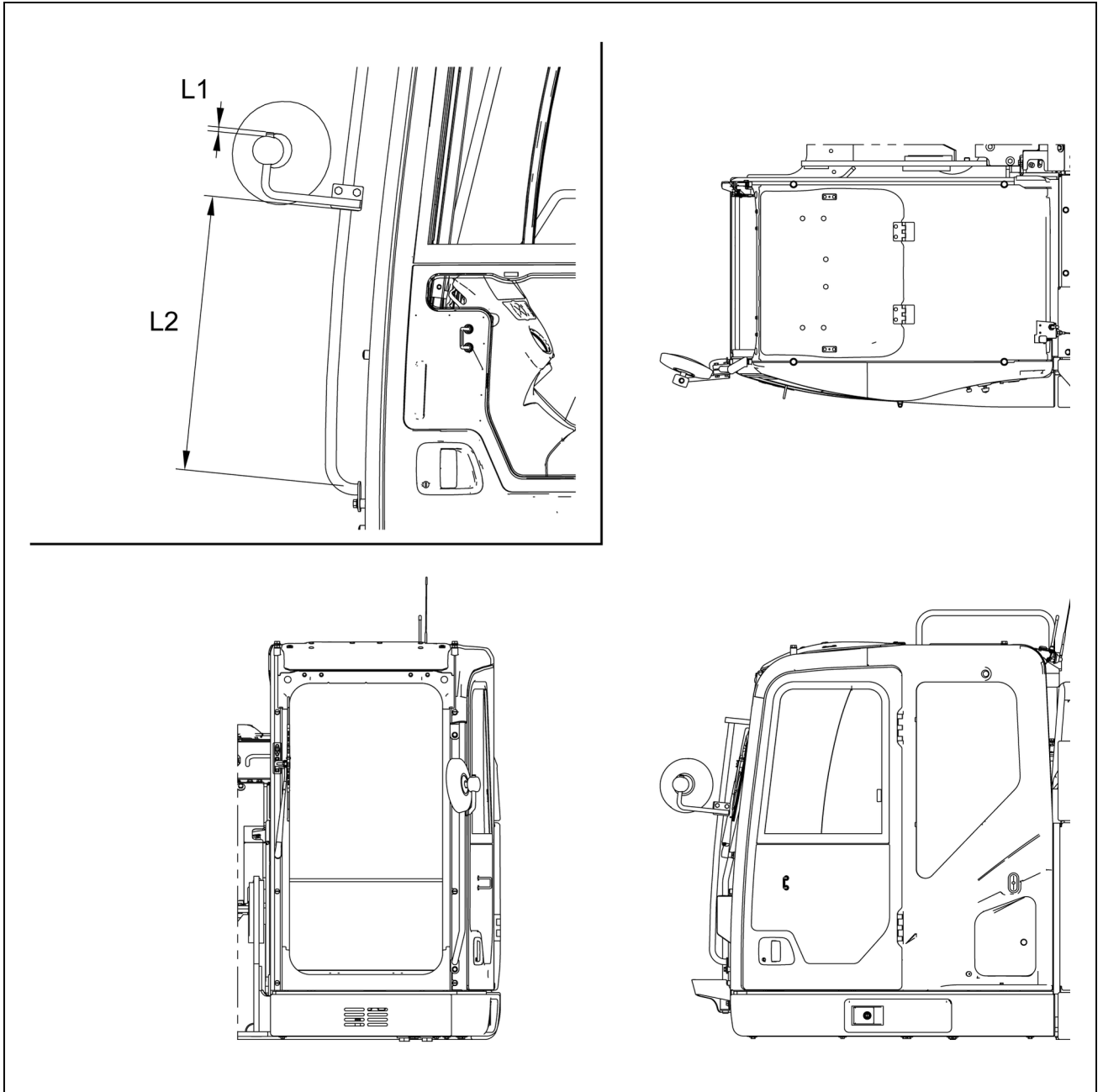

SML20CEX1318GA 5

The LED indicator **(1)** close to the battery disconnect switch is lit up in yellow as the main control systems are operating.

After the engine stop, the LED indicator will be active for some minutes. If the battery disconnect switch has to be turned to OFF position, wait the LED indicator **(1)** to turn off.

NOTICE: Never turn the battery disconnect switch to OFF position when the LED indicator **(1)** is lit up in yellow. The machine control system and the engine control system will be severely damaged.

NOTICE: The SCR system continues to operate for approximately **3 min** after the starter key is turned off in order to suck **DEF/AdBLUE®** back into the tank. **DEF/AdBLUE®** expands when freezing, and it will thus damage the lines of the SCR system.

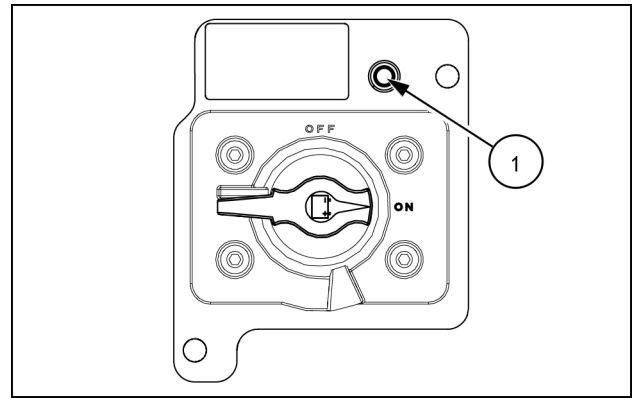

SMIL16CEX1757AA 4

Follow the steps below to add **DEF/AdBlue®**:

1. Turn the starter key to OFF position. Wait **3 min** for SCR system to completely suck **DEF/AdBlue®** back into the tank.
2. Unlock the front right-hand door **(1)** with the starter key. Open the door until it is fixed by the stay.
3. Unlock the **DEF/AdBlue®** tank cover **(2)** with the starter key. Turn the cover handle, and draw open the cover leftward.
4. Wipe the inlet on the **DEF/AdBlue®** tank clean of dirt, mud, and foreign objects.

NOTICE: some white powder deposits may form when **DEF/AdBlue®** adheres and dries in places such as the supply inlet. Wipe off these deposits to prevent them from entering the **DEF/AdBlue®** tank.

5. Turn the cap **(3)** counterclockwise and open the filler neck.

NOTICE: **DEF/AdBlue®** may emit an odor when the tank cap is opened. Do not attempt to smell inside the tank from the supply inlet.

6. Refill up to the F (upper limit) mark **(5)** on the level gauge **(4)**.

NOTICE: never refill **DEF/AdBlue®** over the F (upper limit) mark on the level gauge. Adequate air volume must be present in the top of the tank for proper functionality of the after treatment system. Moreover, **DEF/AdBlue®** may leak from the breather hose during use, and sensors may be damaged when it becomes frozen.

NOTICE: if **DEF/AdBlue®** spills while adding, wipe off the spillage with a cloth and then rinse the area with fresh water. **DEF/AdBlue®** will cause corrosion on painted and unpainted metallic surfaces, and may distort some plastic and rubber components.

7. Put the cap **(3)** on the filler neck. Turn the cap clockwise to close the filler neck.

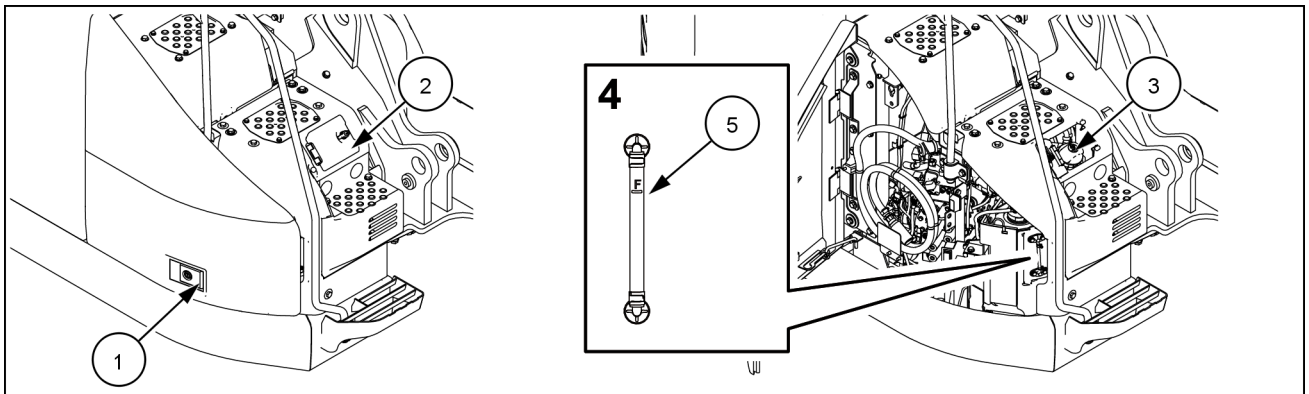

SMIL17CEX3252EA 3

- | | |
|---|--|
| <ol style="list-style-type: none"> 1. Front right-hand door 2. DEF/AdBlue® tank cover 3. Tank cap | <ol style="list-style-type: none"> 4. Level gauge 5. Upper limit level of DEF/AdBlue® to be refilled. |
|---|--|

To replace **DEF/AdBlue®** into the tank, refer first to the drain procedure described in Chapter 6, then refer to the procedure described previously in this Section to refill the tank after **DEF/AdBlue®** has run out.

After **DEF/AdBlue®** has been replaced, let the engine run at low idle for about **20 min**. The warnings, the messages and the icons remain active until the machine control system recognizes that the quality of **DEF/AdBlue®** in the tank conforms to the required specification.

NOTICE: If the warnings, the messages and the icons do not disappear after **25 min**, turn the starter key to **OFF** position. Wait **1 min** and then turn the starter key to **ON** position. If again the warnings, the messages and the icons do not disappear after **15 s**, consult the **CASE CONSTRUCTION** dealer to check for malfunctioning of the **DEF/AdBlue®** quality detection system.

If any of the following occurs within **40 h** after **DEF/AdBlue®** replacement, or after completion of SCR system repair:

The quality of **DEF/AdBlue®** is abnormal and the detection lasts for **10 s**.



An SCR system abnormality is detected and the detection lasts for **10 s**.

The machine control system immediately resumes the inducement sequence to the step **(C)**.

(C) DEF/AdBlue® bad quality, or SCR problem.

SCR detection icon slow flashing.
 CHECK SCR SYSTEM displayed.
Three short beeps.

(D) After **30 min** with no action taken.

SCR detection icon fast flashing.
 CHECK SCR SYSTEM
 CHECK ENGINE displayed.
Continuous beep.

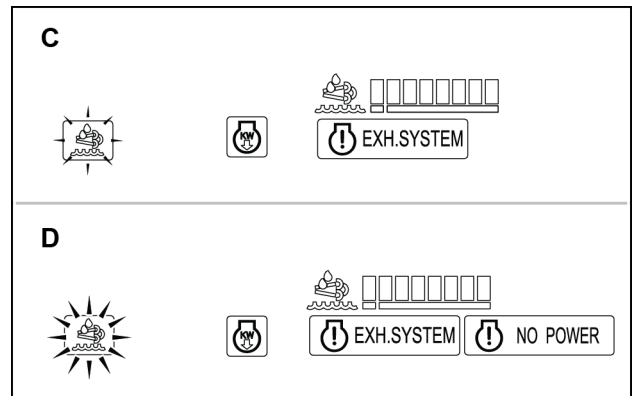

SMIL16CEX1376AA 12

At the step **(D)**, the operation of the machine shall be stopped. Reach a safe condition for the machine, and immediately call the **CASE CONSTRUCTION** dealer for inspection and repair of the SCR system, and for replacement of the fluid into the **DEF/AdBlue®** tank with the proper one.

Operating the machine

⚠ WARNING

Misuse hazard!

Follow the operating instructions in this chapter. Any other practice that has not received the prior approval of the manufacturer is considered to be strictly forbidden.

Failure to comply could result in death or serious injury.

W0281A

⚠ WARNING

Hazard to bystanders!

Always know the location of all workers in your area. Warn them before you start working on the machine. Always keep all unauthorized bystanders clear of the area.

Failure to comply could result in death or serious injury.

W0176A

- Pay attention to work condition characteristics of ground and climate condition before operating the machine.
- Inspect every possible risk before operating the machine. Holes on working site, obstructions and hazardous materials such as debris are subject to cause serious accident.
- Pay attention to location of pipes and cables before commencing work. Electric cables, gas pipes, water pipes and underground installations may cause serious injury. If the work takes place adjacent to high voltage power lines make sure to check the following work range:
Less than **57000 V**: **4 m (13.1 ft)**
57000 V or more: **5 m (16.4 ft)**
- Sit on the operator's seat, adjust it so as to be able to easily reach the console, and then fasten the safety belt.
- Check that the cab door is tightly secured at position of open or close.
- Sound the horn.
- Start up the engine.
- Check all the indicator lamps and gauges are operating properly.
- Set the gate lock lever to unlock position.

The following operation may cause damage to the machine:

- Do not use weight of the machine as an impact force for excavation.
- Do not use traveling force of the machine for excavation.
- Avoid abrupt change of swing direction when swinging the upper structure.
- Never hit or push objects with side of the bucket. Do not sweep ground with the bucket to level rubbles.
- Open and close the bucket for several times to loosen soil and mud when soil and mud are tightly packed in the bucket.
- After work, remove mud from the machine and clean it.

Emergency release switch

The emergency release switch (1) is located on the back of the left-hand console, underneath the armrest.

If the interference prevention system has a failure, a warning buzzer sounds, and the front equipment is automatically locked. In this condition, the emergency release switch may be used in order to unlock the controls of the front equipment, and to move the attachment to a safe position away from the cab.

NOTICE: The emergency release switch is intended for exceptional usage when the interference prevention system has a failure and needs to be serviced. Never use the switch during regular machine operation.

Slide the lock device and press the front side of the switch to set the emergency release status of the interference prevention system. A warning buzzer sounds continuously, and the ANTI-INTERFERENCE CANCELED message is displayed.

NOTICE: When the emergency release switch is pressed, the attachment may hit the cab: the interference prevention system is disabled, and the end-stroke cushioning of the front equipment movements does not work. Make sure to operate the controls of the front equipment slowly, and avoid end-stroke movements.

Use the controls of the front equipment strictly to move the attachment away from the cab and to place it on the ground, in order to reach a safe condition for the operator and for the machine. When a safe condition is reached, stop the engine and press the back side of the emergency release switch to reset the readiness of the interference prevention system. Immediately call the CASE CONSTRUCTION Dealer for inspection and repair.

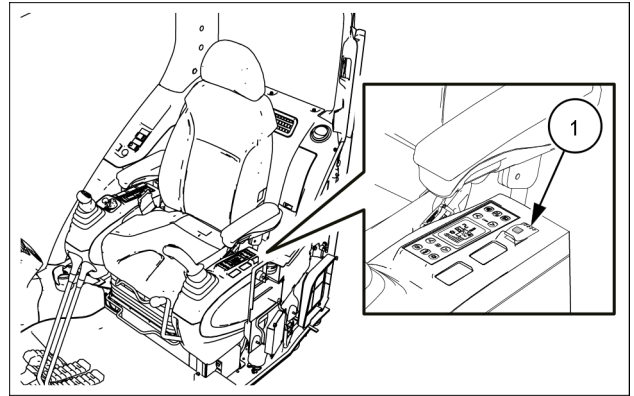

SMIL18CEX0432AA 16

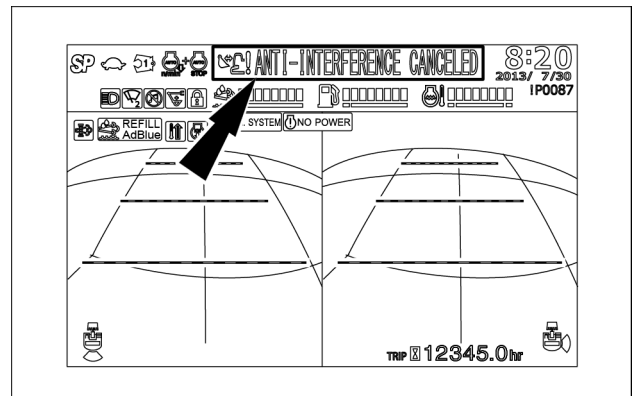

SMIL17CEX7663AA 17

Gradual turn on the move

Press one of the pedals or push one of the levers and, at the same time, press the other pedal or push the other lever in the same direction, but slightly harder.

Stopping travel

To come to a complete halt, simply release the levers or pedals and they will return to neutral.

NOTICE: Allow as much time as possible to stop the machine.

NOTICE: Avoid abrupt stopping as much as practicable.

NOTICE: Park or stop the machine on level solid ground in safe area.

Cautions for traveling

1. Start traveling operation after checking location of the travel unit before commencing travel operation.
2. Select ground as flat and solid as possible for traveling.
3. Travel bypassing obstructions.

NOTICE: when using wide shoes avoid traveling on rough ground. Wider shoes tend to cause deformation or crack of the shoes.

4. Travel with decreased traveling speed on rough ground.
5. Encourage a large turn for changing direction and avoid abrupt pivoting turns or spinning turns as much as possible.
6. Check the route to travel in advance.
7. Prepare a personnel to signal operator whenever moving the machine in a location with poor visibility.
Pay attention to permissible weight of bridge when crossing the bridge.
8. Take necessary measure such as placing plates so as not to damage surface of paved road.
9. Slow down and loosen tension of the track shoes when traveling on place with gravels and cobbles.

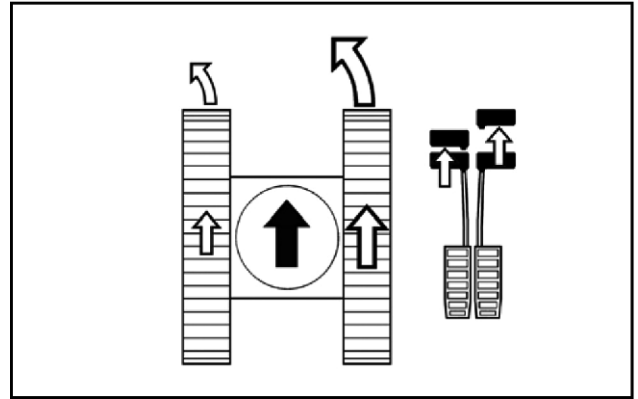

SMIL13CEX2687AB 10

CLICK HERE TO **DOWNLOAD** THE COMPLETE MANUAL

- Thank you very much for reading the preview of the manual.
- You can download the complete manual from: www.heydownloads.com by clicking the link below



- Please note: If there is no response to CLICKING the link, please download this PDF first and then click on it.

CLICK HERE TO **DOWNLOAD** THE COMPLETE MANUAL

CX145D SR with blade

Select the H work mode.

Align the machine to the trailer, so as the blade faces the trailer ramps. Fully raise the blade.

NOTICE: Starting from this position, the travel control levers must be pushed forward to move on the ramps and on the trailer bed. Confirm the travel control directions before start moving onto the ramps.

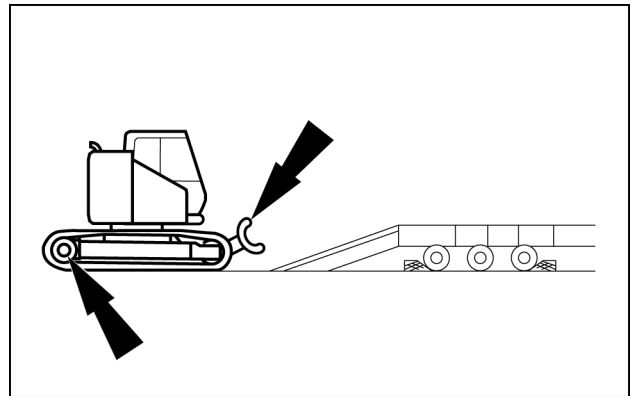

SMIL20CEX0041AB 12

Slowly climb the trailer ramps. Slowly travel on the trailer bed to reach the resting position.

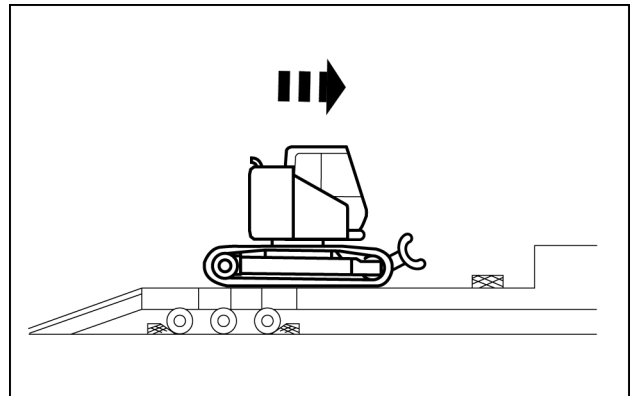

SMIL20CEX0049AB 13

After reaching the resting position, lower the blade on the supporting block.

Make sure that there is enough space between the block and the tracks to route the tie-down chains.

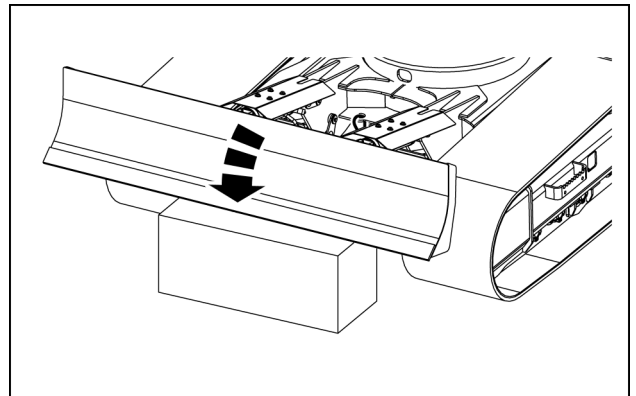

SMIL19CEX2664AA 14

Slowly turn the upper structure **180°**.

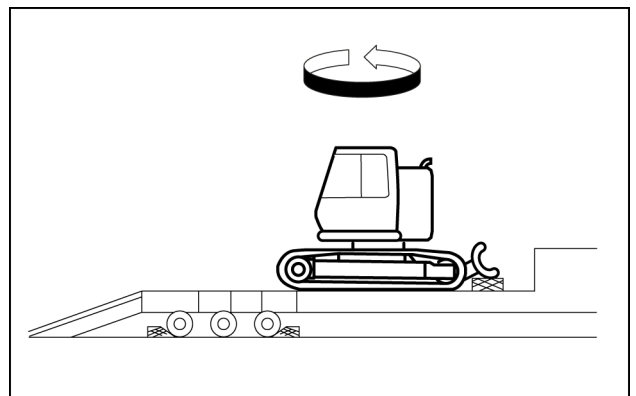

SMIL20CEX0050AB 15

6 - MAINTENANCE

General information

Basic instructions

▲ WARNING

Improper operation or service of this machine can result in an accident.
If you do not understand a maintenance procedure, or doubt your ability to perform a maintenance procedure correctly, see your authorized dealer.
Failure to comply could result in death or serious injury.

W0157A

▲ WARNING

Improper operation or service of this machine can result in an accident.
Raised equipment or machine movement without an operator can cause serious injury. Always do the following before performing any maintenance:
Park the machine on flat, level ground.
Lower the attachment to the ground.
Shut down the engine and remove the ignition key.
Lock the tracks.
Failure to comply could result in death or serious injury.

W0944D

▲ WARNING

Falling object hazard!
Risk of injury from **FALLING ENGINE HOOD**. Latch the hood in the fully open position prior to working within the engine compartment.
Failure to comply could result in death or serious injury.

W1090B

NOTICE: be sure all the service operations in this section are carried out punctually at the intervals given, in order to ensure optimum performance levels and maximum safety when using the machine.

- Before any maintenance operation, park the machine on a hard and level ground, away from obstacles, and lower the attachment and the dozer blade (if equipped) to the ground.
- Unless otherwise specified, carry out all maintenance operations with the engine stopped and the key removed from the starter switch. Wait for all circuits to cool down before you start work.
- Clean the grease fittings before lubrication. Clean around plugs and filler holes before adding fluid. No dust or dirt must enter the components or the circuits. Wear suitable clothing and remember to use the necessary safety equipment.
- When carrying out service work on the machine, place the "Do not operate" tag on the instrument panel. Never climb down from the operator's compartment leaving the engine running.
- Remove the necessary lower panels during maintenance of certain machine components. Make sure the lower panels are properly closed before operating the machine.

Any modification to the machine without prior authorization could cause serious injury. Do not make any modifications without authorization. Consult your CASE CONSTRUCTION Dealer.

NOTICE: if you use your machine in particularly harsh conditions (dusty or corrosive atmosphere, etc.), the servicing intervals should be reduced accordingly.

NOTICE: take particular care to replace all filters regularly. Clean filters mean longer engine running life.

NOTE: oil and fluid should not be thrown on the ground. They must be stored and removed by a company which is responsible for their recycling or their disposal.

Releasing pressure in the hydraulic system

NOTICE: before carrying out any work on the hydraulic system, there should be no pressure in any of the circuits.

1. Place the machine on flat, level ground, lower the attachment to the ground and stop the engine.
2. Turn the starter key to ON position.

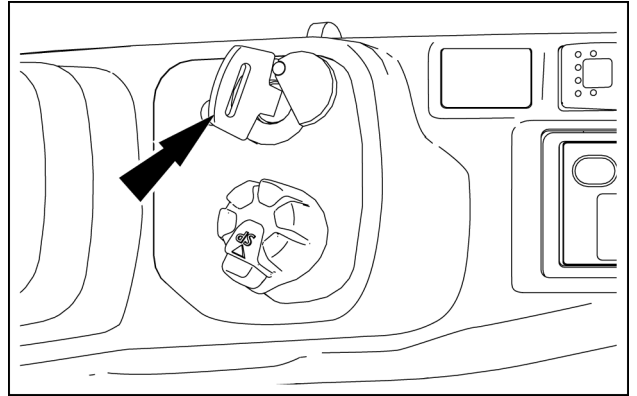

SMIL19CEX2696AA 1

3. Set the gate lock lever to unlock position.

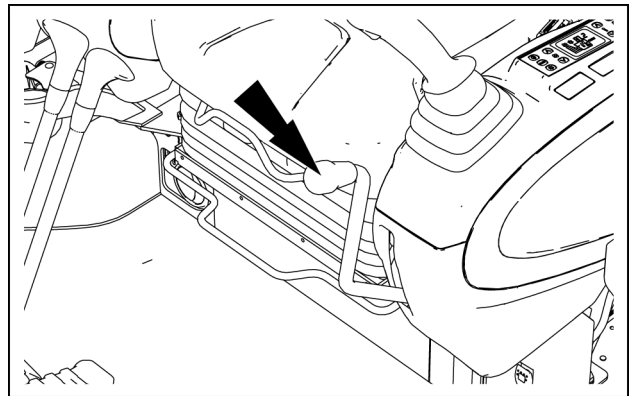

SMIL17CEX0108AA 2

4. Operate the control levers from right to left and front to rear a dozen times approximately.
5. Turn the starter key to OFF position.

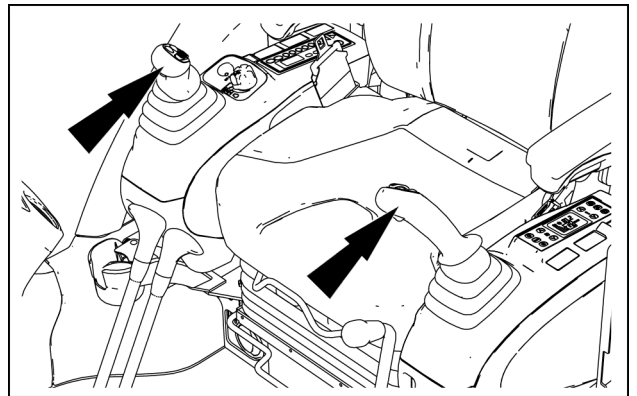

SMIL17CEX0109AA 3

6. Keep pressed the button of the hydraulic tank breather to release all the residual pressure.

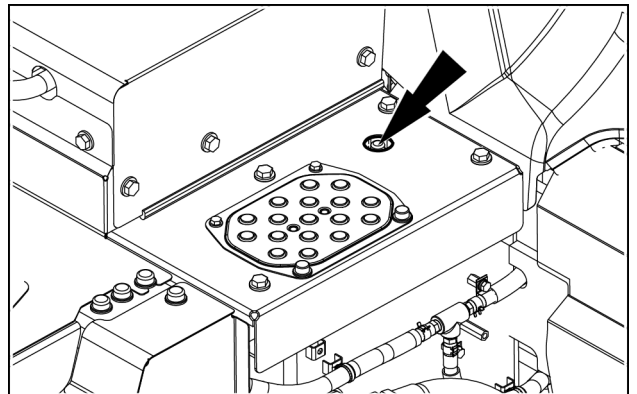

SMIL17CEX3530AA 4

Fan and alternator drive belt

Visually check the fan and alternator drive belt every **10 h** or every day

1. Refer to page **6-36**.

NOTICE: Operating the engine with loosened belt may cause over heat of the engine or insufficient charging of the battery due to slipping belt in its housing.

Fuel tank

⚠ WARNING

Fire hazard!

When handling diesel fuel, observe the following precautions:

1. Do not smoke.
2. Never fill the tank when the engine is running.
3. Wipe up spilled fuel immediately.

Failure to comply could result in death or serious injury.

W0099A

Drain water and sediment from the fuel tank every **10 h** or every day

NOTICE: The fuel tank must be drained taking precautions so that any foreign material may get inside. Failing to comply will lead to severe damages to the fuel supply system and to the fuel injection system.

To drain water and sediment from the fuel tank proceed as follows:

1. Park the machine on a hard and level ground. Orient the upper structure frame so that there is enough free space under the fuel tank to place a barrel of suitable capacity.
2. Stop the engine and remove the starter key.
3. Clean the hole on the lower panel (**1**) below the fuel tank to access the drain valve.
4. Place a container of a suitable capacity under the drain valve.
5. Open the valve and drain the accumulated sediment and water.

NOTICE: the drained materials shall be disposed according to the local Regulations for special wastes.

6. Close the drain valve.

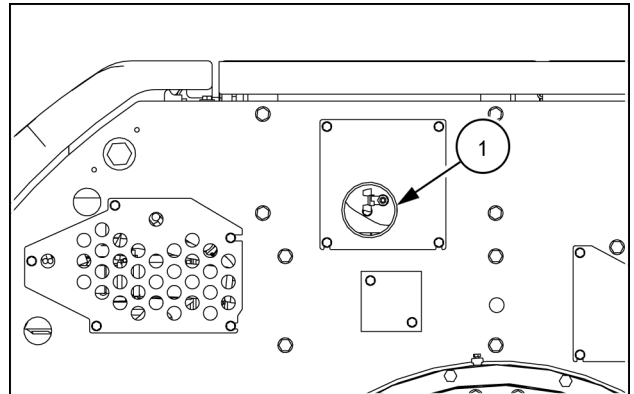

SMIL19CEX2665AA 1

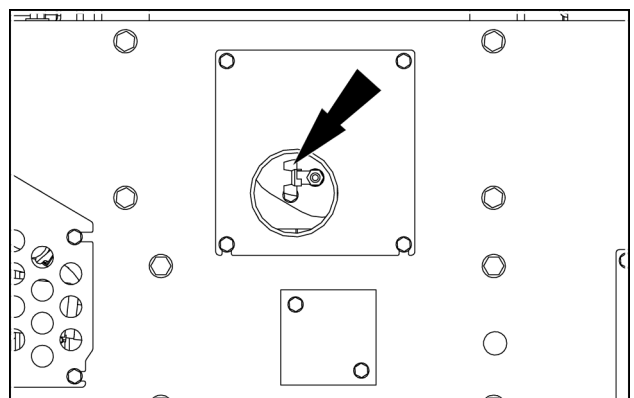

SMIL20CEX0693AA 2

NOTE: Do not use compressed air if there is oil or soot in the element.

If the cartridge is greasy:

Clean it in water, with suitable detergent. (Consult your CASE CONSTRUCTION dealer).

Instructions for using the detergent are printed on the package.

NOTE: Dry the element out completely before installing it. It is advisable to keep a clean spare element ready that can be installed on the air cleaner while the cleaned element is drying.

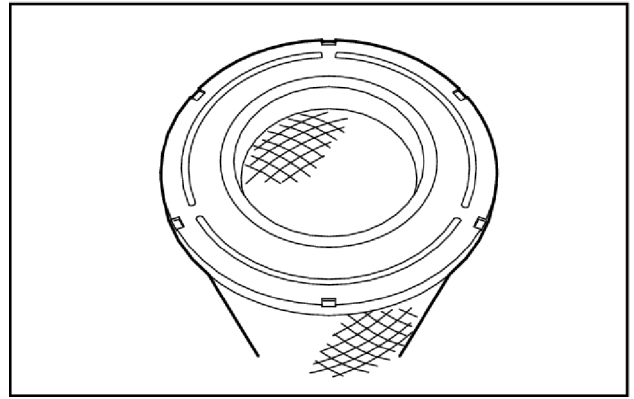

SMIL13CEX2757AA 4

Inspecting the element

Check the element for damage by placing an inspection lamp inside the element.

NOTE: Change the element if light can be seen through a hole, however small.

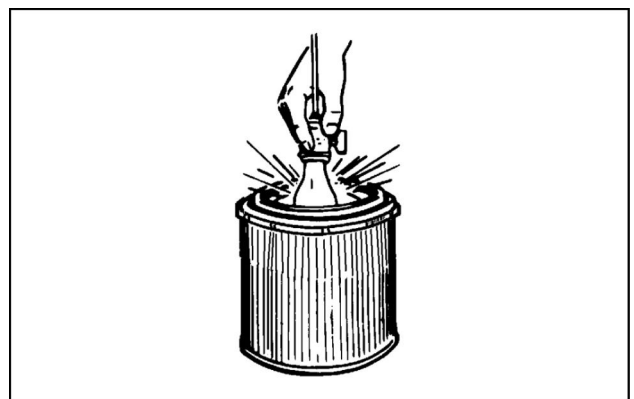

SMIL14CEX2797AA 5

5. Clean the inside of the air cleaner case, and attach the primary element.
6. Attach the cover (with the "TOP" display facing up), and lock the fasteners.

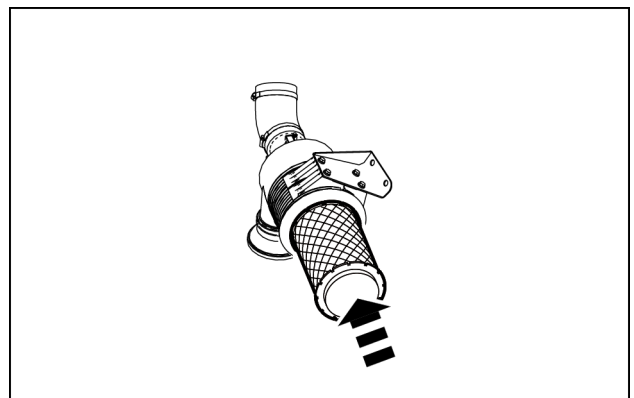

SMIL17CEX3269AA 6

NOTICE: The mass air flow (MAF) sensor is mounted on the inlet duct of the air cleaner. Output of the engine may be restricted if any dust is attached to the MAF sensor or failure of sensing part of the MAF sensor due to usage of retailed cleaning fluid.

Pay attention not to allow dust to invade the inlet duct when replacing the air cleaner element. Also, pay attention not to spray retailed cleaning fluids to the MAF sensor when using them.

Every 500 hours

Turntable bearing

Check the greasing of the swing gears, and grease the turntable bearing every **500 h**.

Lubricant: **CASE AKCELA 251H EP MULTI-PURPOSE GREASE**

Prepare a can of loose and clean grease for checking the greasing of the swing gears. Prepare a gun and cartridges of clean grease for greasing the turntable bearing.

1. Park the machine on a hard and level ground. Orient the upper structure frame parallel to the undercarriage.
2. Operate the boom, arm, and attachment controls so that the arm stands vertical and the attachment rests on the ground.
3. Set the gate lock lever to lock position, stop the engine, and remove the starter key.
4. Remove the cover in the bottom of the lower frame. Remove the plug (1) so to drain water, and greasy mud. Snug tighten the plug (1).

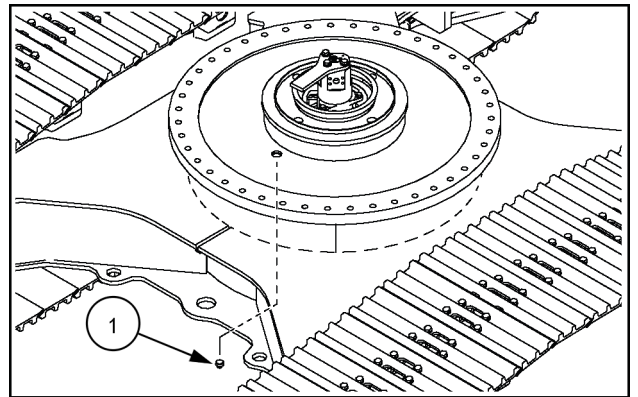

SML14CEX4312AB 1

5. Check the greasing of the swing gears. Remove the inspection cover (2) on the front of the upper frame.
6. Remove all dirty grease.
7. Check the surfaces of the swing gears for excessive wearing or damages. If any excessive wearing or damage is found, immediately call the CASE CONSTRUCTION Dealer for inspection and repair.
8. Taking clean grease from the can, restore proper greasing of the surface of the teeth of the swing ring.

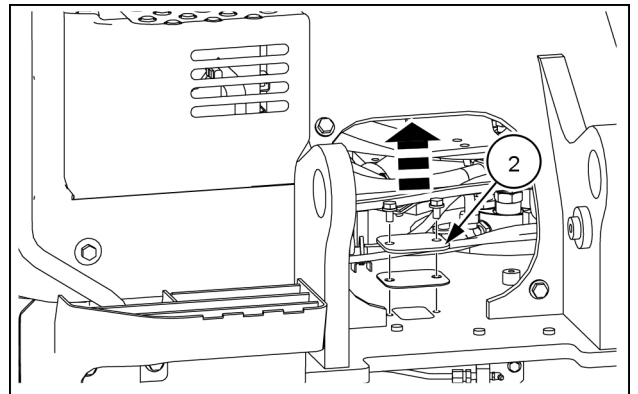

SML17CEX3539AA 2

NOTICE: do not grease the teeth at full height in order not to have too much grease spread beyond the swing ring.

9. Grease the turntable bearing. Remove the protective caps from the fittings (3) and (4) on the bearing.
10. Using the grease gun, inject clean grease into the fitting (3) so to push the old grease out from the lower sealing lip of the turntable bearing. Stop injecting as clean grease comes out from the lip.
11. Clean up the grease that exceeded the sealing lip, and reset the lip to its seating position.

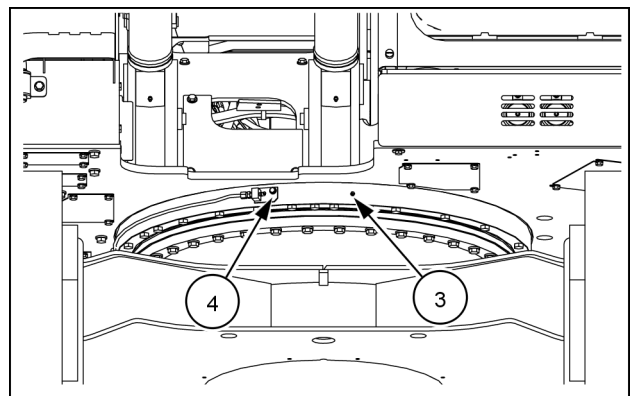

SML17CEX3538AA 3

NOTICE: Always check the sealing lip for excessive wearing or damages. If any excessive wearing or damage is found, immediately call the CASE CONSTRUCTION Dealer for inspection and repair.

12. Inject the same amount of grease into the fitting (4). Reach the opposite side of the turntable bearing, clean up the grease that exceeded the sealing lip, and reset the lip to its seating position.
13. Get onto the cab, start the engine, and set the gate lock lever to unlock position.

Grease points (Boom and arm, Offset)

Grease the boom, the positioner, and the arm every **1000 h**.

Lubricant: **CASE AKCELA 251H EP MULTI-PURPOSE GREASE**

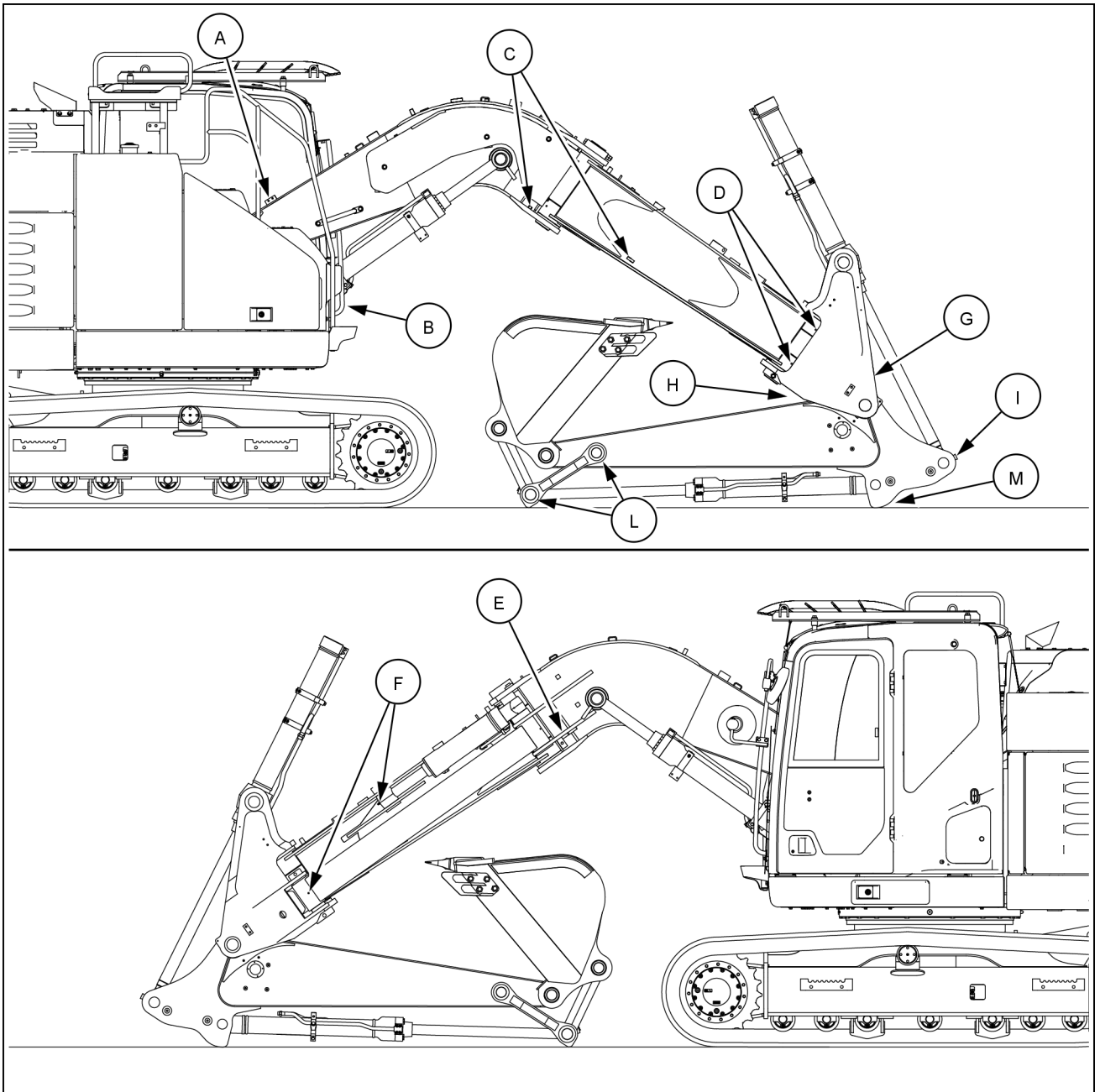

SML17CEX7637GA 1

NOTE: the boom, the positioner, and the arm shall be lubricated every **50 h** if non-genuine grease is used.

Travel reduction units oil

Replace the travel reduction units oil every **1000 h** (After **250 h** of operation in run-in period)

Lubricant: **TUTELA HYPOIDE EP GEAR LUBE SAE 80W-90**

Quantity: **2.1 L (0.6 US gal)** (per travel reduction gear)

1. Park the machine on flat, horizontal ground.
2. Move the machine so that the drain plug **(1)** comes down to the lowest position.
3. Stop the engine, and remove the starter key.
4. Place a container with an appropriate capacity under the travel reduction gear.
5. Remove the level plug **(2)**.
6. Remove the drain plug **(1)**.

NOTE: Check the condition of the drained oil. If there are pieces of metal or foreign objects in the oil, consult the **CASE CONSTRUCTION** dealer.

7. Replace the O-ring seal of the drain plug **(1)**. Insert the drain plug **(1)** with seal tape wrapped around it. Add oil through port **(2)** until the oil comes up to the bottom edge of the port.
8. Replace the O-ring seal of the level plug **(2)**. Insert the level plug **(2)** with seal tape wrapped around it.
9. Repeat steps **2** to **8** for the other travel reduction gear.
10. Run the machine slowly to check that there are no leaks.

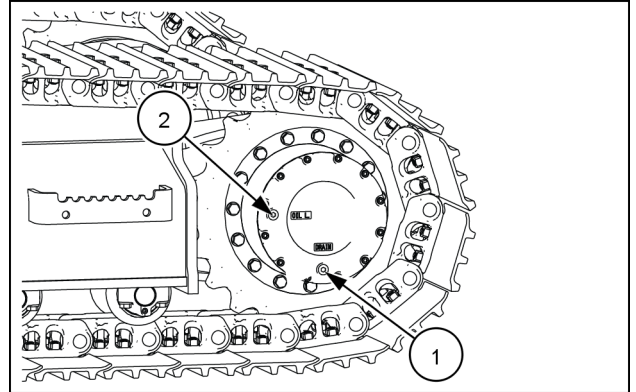

SMIL15CEX9565AA 1

23. Start the engine and let it run at low idle speed for **3 min**. Turn on the cab heating system, and set the temperature and the fan speed to the maximum level.
24. Gradually increase the engine speed to H position. Let the engine run until the coolant temperature reaches **90 °C**. Make sure that coolant temperature stays at **90 °C** for some minutes.

NOTICE: if coolant temperature gets quickly over **90 °C**, lower the engine speed to low idle. Stop the engine and check for leakages from the hoses of the cooling system.

25. Gradually decrease the engine speed to low idle and let it run for **3 min**. Stop the engine.
26. Wait until the engine has cooled down. Slowly open the radiator cap and check for coolant level. Add some coolant up to the edge of the coolant inlet of the radiator.

NOTICE: if too much coolant has to be added at this stage, carefully check for leakages into the engine cooling system.

27. Close the radiator cap.
28. Carry out final filling of the coolant reserve tank up to the FULL mark. Close the cap of the reserve tank.

NOTICE: the coolant level in the reserve tank shall be always double checked the morning after. The cooling circuit may take some more time to get stabilized. If needed, fill the reserve tank with coolant up to the FULL mark. Close the cap of the reserve tank.

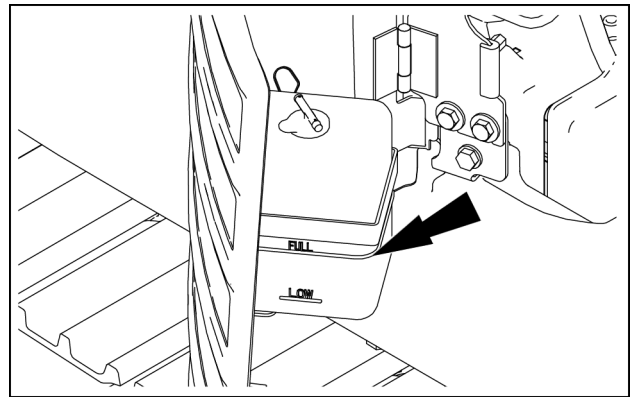

SMIL17CEX3277AA 6

⚠ WARNING

Pressurized fluid can penetrate the skin and cause severe injuries.

The grease in the cylinder is under high pressure. Never loosen the grease fitting adaptor completely in order to speed up the flow of grease.

Failure to comply could result in death or serious injury.

W0261A

To reduce the tension:

1. Turn the grease fitting adaptor about 3 times to loosen it and drain grease from the cylinder.
2. When the track tension is correct, tighten the adaptor.
3. Clean the grease adapter and fitting, then lower the track to the ground.
4. Repeat the same operations for the other track.

NOTICE: if the grease fitting adaptor is damaged, grease may leak out. Check the condition of the grease fitting adaptor regularly and replace it if necessary.

Fuel tank strainer

Clean the fuel tank strainer periodically

Remove the fuel tank strainer, inspect it for damage. If damaged, discard and replace. If in good condition, clean it in an environmentally safe manner. Diesel fuel is a preferred cleaning agent. Fuel must not be added to the tank unless the strainer is in place and in good working condition.

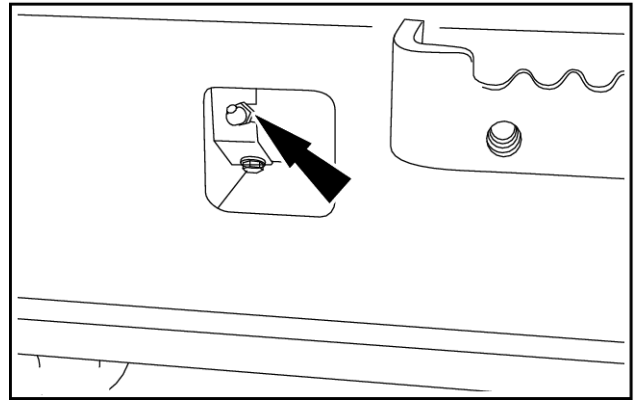

SMIL13CEX2750AB 7

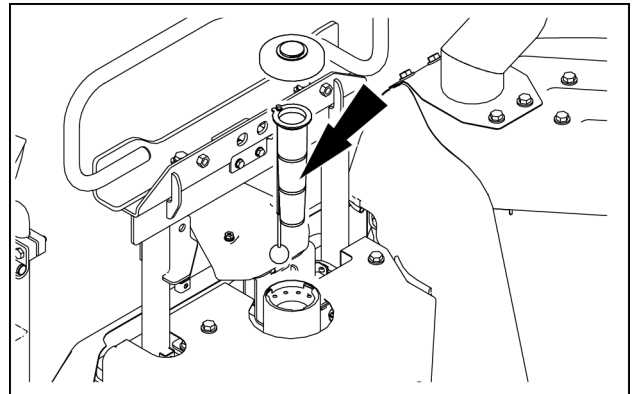

SMIL17CEX3815AA 1

DEF/AdBlue® tank drain

Drainage may be required if the machine control system detects that the quality of **DEF/AdBlue®** in the tank does not conform to the required specification. Refer to Chapter 3.

To drain **DEF/AdBlue®** from the tank proceed as follows:

1. Park the machine on a hard and level ground. Orient the upper structure frame so that there is enough free space under the **DEF/AdBlue®** tank to place a barrel of suitable capacity.
2. Stop the engine and remove the starter key. Wait 5 min to allow the SCR system to suck **DEF/AdBlue®** back into the tank.
3. Unlock the **DEF/AdBlue®** tank cover (1) with the starter key. Turn the cover handle, and draw open the cover leftward.
4. Turn the cap (2) counterclockwise and open the filler neck.
5. Remove the lower panel (3) below the **DEF/AdBlue®** tank to access the drain plug.

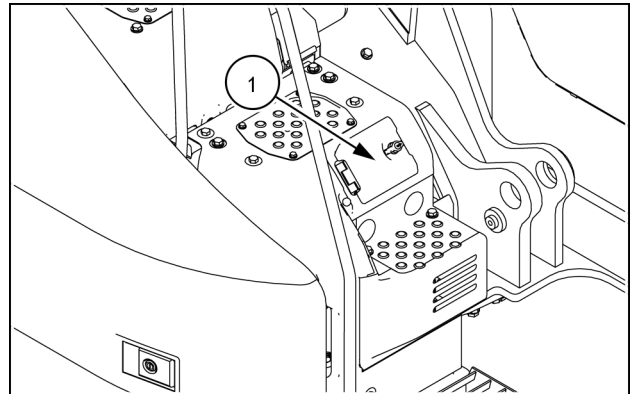

SMIL20CEX1309AA 1

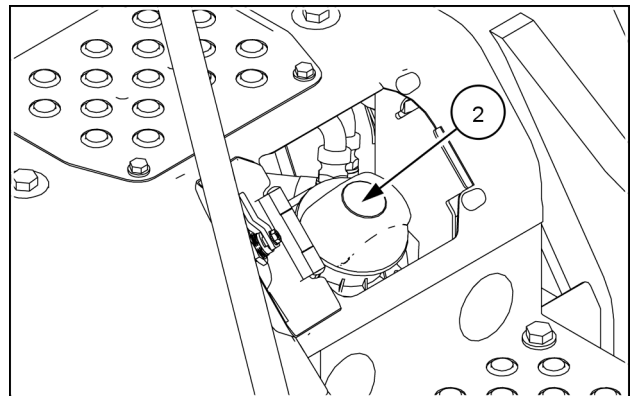

SMIL20CEX1308AA 2

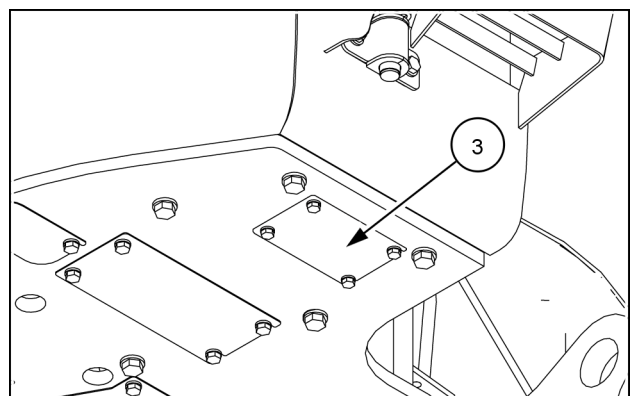

SMIL20CEX1312AA 3

8 - SPECIFICATIONS

Machine specifications

Engine

Manufacturer and model	ISUZU AR-4JJ1X
Injection	Electronic-controlled High-pressure common rail
Number of cylinders	4
Bore x stroke	95.4 mm (3.8 in) x 104.9 mm (4.1 in)
Displacement	2999 cm ³ /rev (183 in ³ /rev)
Rated speed	2000 RPM
Rated power (ISO 9249)	76.4 kW (103.9 Hp)
Cooling	Water-cooled
Battery start	2 x 12 V 72 A·h
Voltage	24 V
Alternator	50 A
Starter	24 V, 4.0 kW

Hydraulic system

Maximum flow of the main pump (at 2000 RPM)	2 x 129 L/min (34.1 US gpm)
Rated working pressure	34.3 MPa (4975.2 psi)
Maximum working pressure (Power boost) (*)	36.3 MPa (5265.3 psi)
Maximum flow of the blade pump (at 2000 RPM)	65 L/min (17.2 US gpm)
Rated working pressure	20.6 MPa (2988.0 psi)
Maximum flow of the pilot pump (at 2000 RPM)	20 L/min (5.3 US gpm)
Rated pilot pressure	3.9 MPa (565.7 psi)

NOTE: (*) The hydraulic Power boost is not active on CX145D SR Offset Boom with blade.

Swing performance

Swing speed	12.5 RPM
Swing torque	37000 N·m (27290 lb ft)

Travel performance

Low speed	0 – 3.4 km/h (0 – 2.1 mph)
High speed	0 – 5.6 km/h (0 – 3.5 mph)
Drawbar pull	116000 N (26078 lb)
Grade ability	70% (35°)

Working ranges CX145D SR Offset Boom with blade (Offset 0)

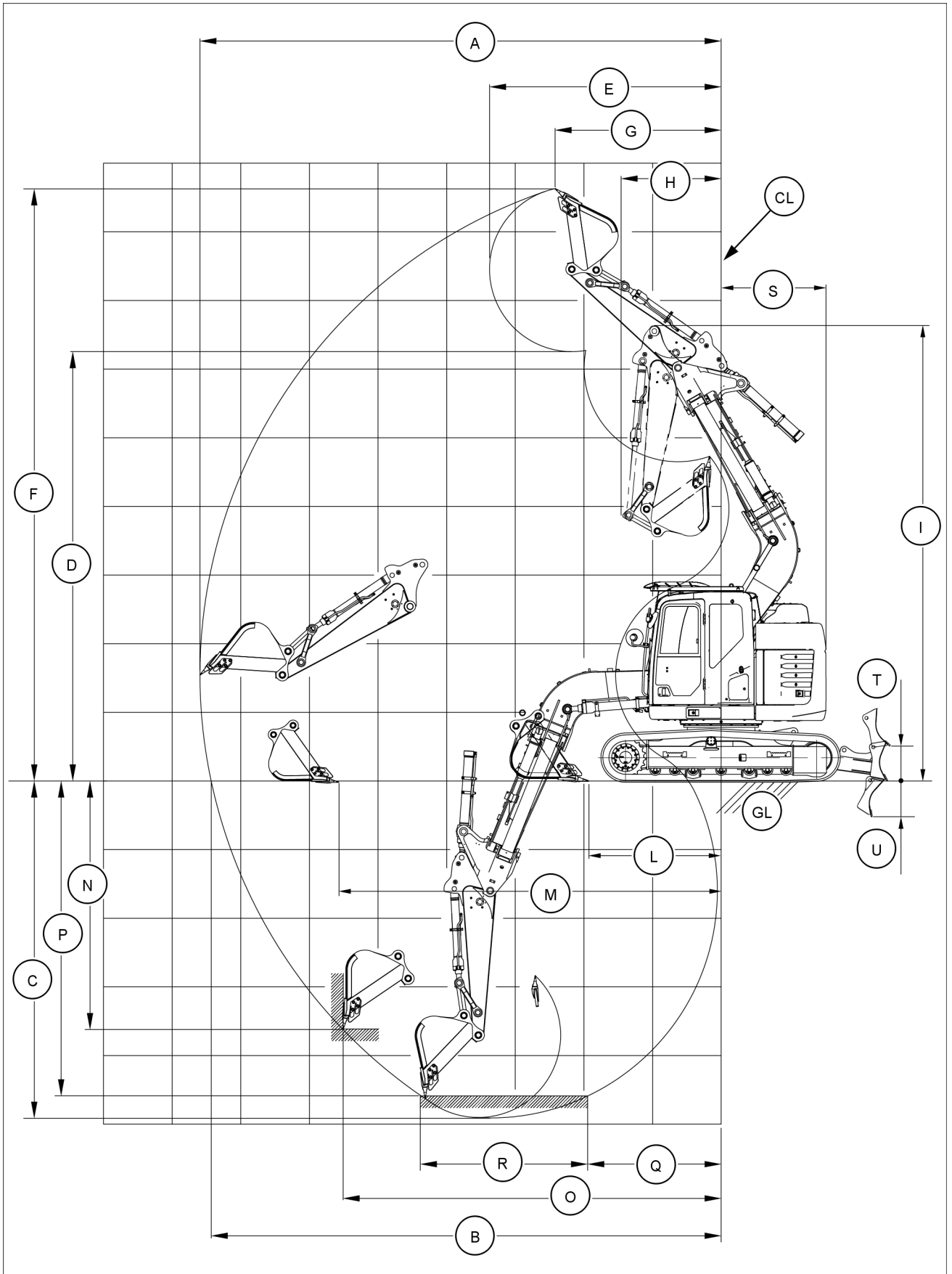

SML17CEX7671HA 5

Operational settings

The flow rate/pressure characteristic of the auxiliary high-flow hydraulic circuit can be set according to the type and to the specifications of the attachment used.

NOTICE: before operating any hydraulic attachment be sure to set the proper attachment mode (breaker or crusher) and the proper hydraulic flow rate/pressure characteristic. If the attachment mode or the hydraulic flow rate/pressure characteristic are not properly set, malfunction or failure may occur to the machine or damage may occur to the hydraulic attachment.

Before operating any hydraulic attachment, press the display mode selector button to open the User Information Mode.

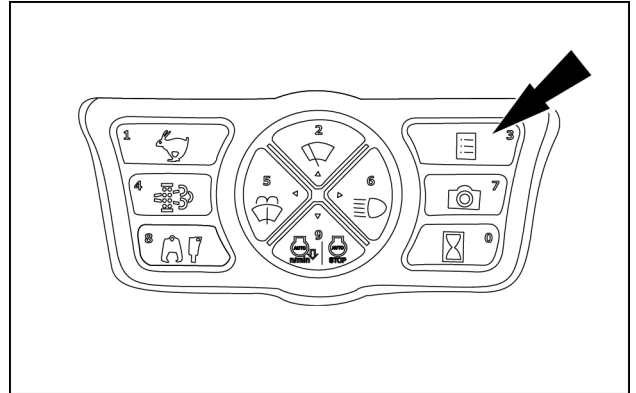

SMIL15CEX1234AA 2

Select the dedicated tab for operational settings of the auxiliary high-flow hydraulic circuit.

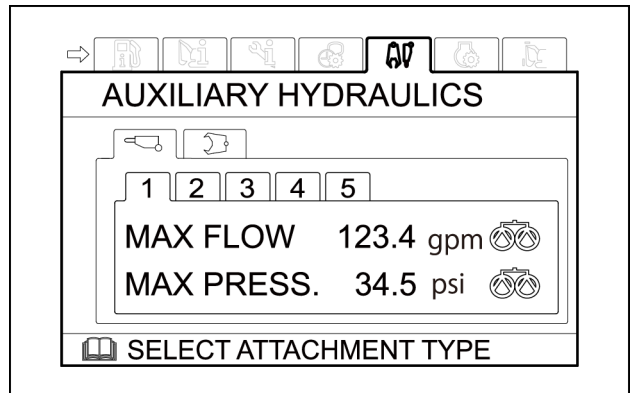

SMIL15CEXZ394AA 3

Alternatively, just press and hold the attachment selector button for **1 s** to get directly to the dedicated tab for operational settings of the auxiliary high-flow hydraulic circuit.

NOTE: the dedicated tab for operational settings of the auxiliary high-flow hydraulic circuit is not active if the machine is not equipped with any auxiliary high-flow hydraulic circuit.

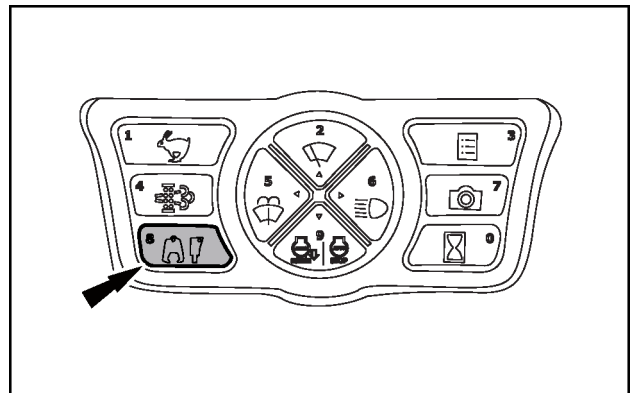

SMIL14CEX1709AA 4

Auxiliary hydraulic circuits pressure release

⚠ WARNING

Escaping fluid!

Hydraulic fluid or diesel fuel leaking under pressure can penetrate the skin and cause infection or other injury. To prevent personal injury: Relieve all pressure before disconnecting fluid lines or performing work on the hydraulic system. Before applying pressure, make sure all connections are tight and all components are in good condition. Never use your hand to check for suspected leaks under pressure. Use a piece of cardboard or wood for this purpose. If injured by leaking fluid, see your doctor immediately.

Failure to comply could result in death or serious injury.

W0178A

Auxiliary hydraulic circuits are high pressure hydraulic systems. Always release the pressure before connecting or disconnecting the hydraulic hoses between the machine and the attachment. Proceed as follows:

1. Place the machine on flat and level ground.
2. Lower the attachment to the ground and stop the engine.
3. Turn the starter key to ON position.
4. Set the gate lock lever to unlock position.
5. Slide the right proportional switch and the left proportional switch up and down three times approximately to release the pressure.
6. Turn the starter key to OFF position.

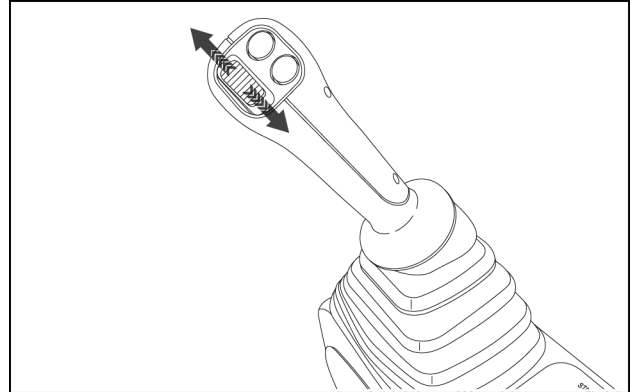

SMIL15CEXY965AB 13

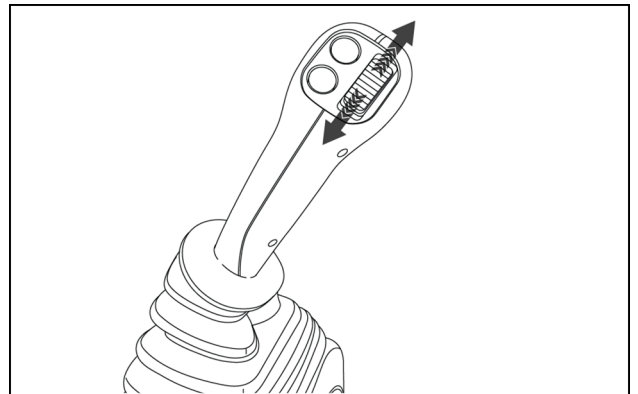

SMIL15CEXY964AB 14

Auxiliary hydraulic circuits (CX145D SR Offset Boom with blade)

The machine can be equipped with one of the following auxiliary high-flow hydraulic circuits:

- Single-acting auxiliary high-flow hydraulic circuit intended for usage of attachments such as a hydraulic breaker.
- Double-acting auxiliary high-flow hydraulic circuit intended for usage of attachments such as a hydraulic sorting grab.

Hydraulic connections

The feed valves at the top of the arm allow to install properly and safely the hoses to connect the hydraulic attachment to the lines of the auxiliary high-flow hydraulic circuit.

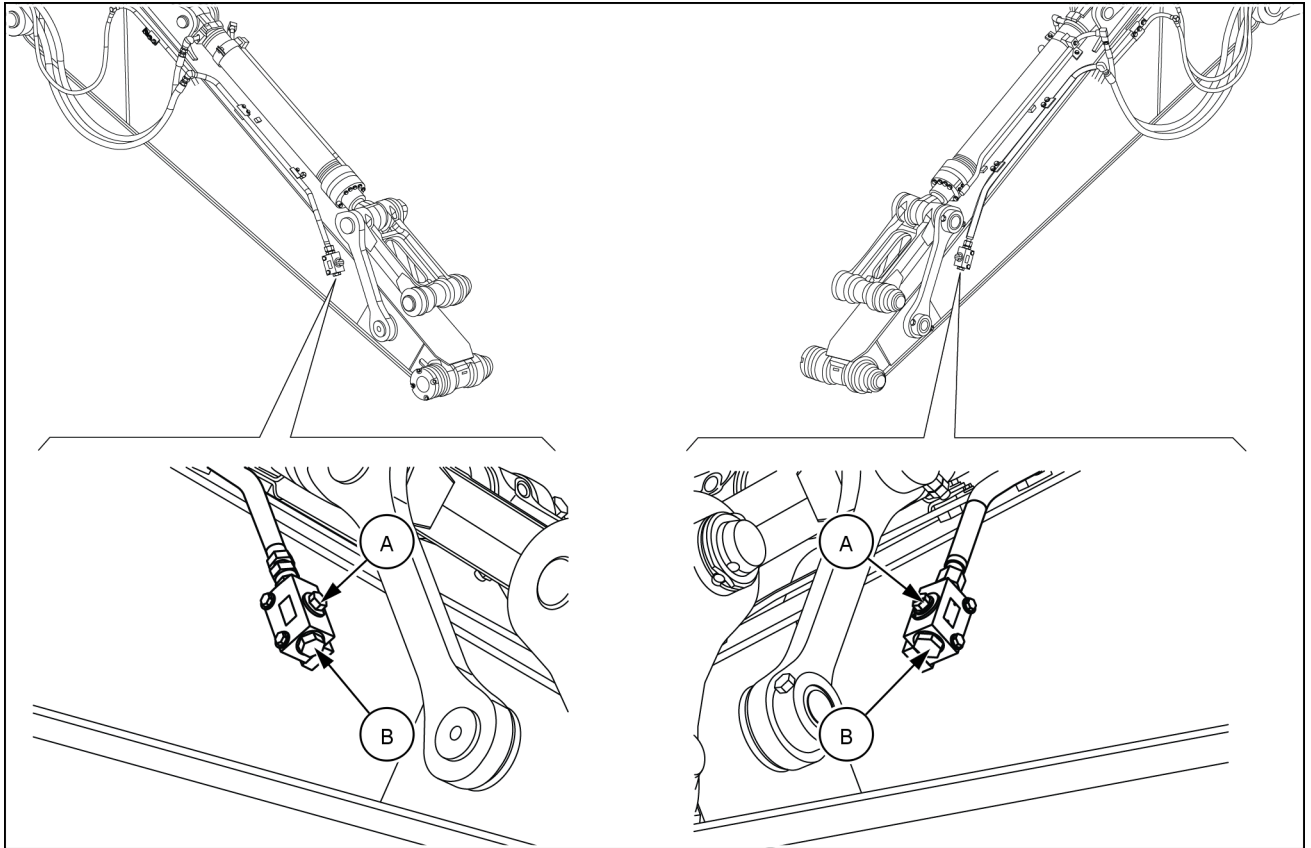

SML15CEXY959FB 1

Open/Close tool (A)	24 mm wrench
Hydraulic connection (B)	G 3/4" female port with O-Ring seat

NOTICE: Always keep each connecting hose on the same side of the arm. Never cross-over the connecting hoses between the two sides of the arm.

7. Start the engine. Press the attachment selector button **(A)** until the breaker icon **(B)** featuring the required flow rate value (1 to 5) appears on the top left of the display. If a different setting is necessary, or in case of forgotten settings, refer to the Operational settings paragraph previously in this Section.

NOTICE: If operation with the hydraulic attachment is attempted without making any setting, a warning buzzer sounds and the message **AUXILIARY SET UP REQUIRED** is displayed.

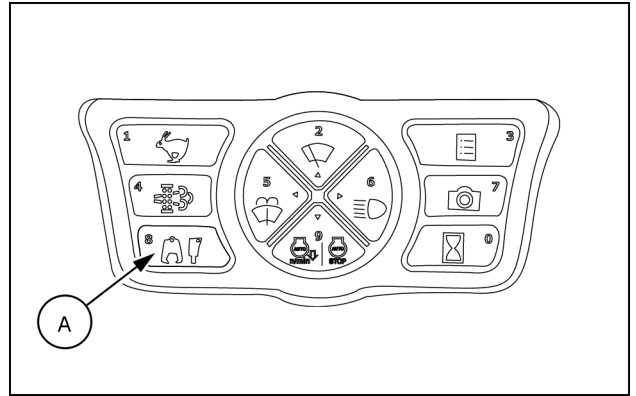

SMIL15CEX1234AA 14

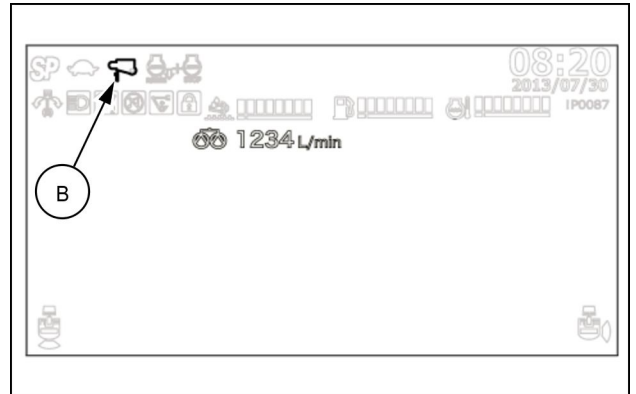

SMIL19CEX0563AA 15

8. Select the SP work mode.
9. Set the gate lock lever to unlock position.
10. Operate the controls of boom, arm and bucket in order to position the breaker right to the structure or to the object to be crushed.
11. Press and hold the ON/OFF button **(1)** located on the right-hand control lever to operate the hydraulic breaker with the continuous selected flow providing a constant blowing frequency. Release the button to stop breaker operation.

NOTE: To change the blowing frequency, get back to the dedicated tab for operational settings of the auxiliary high-flow hydraulic circuit, and change the flow rate value to be used.

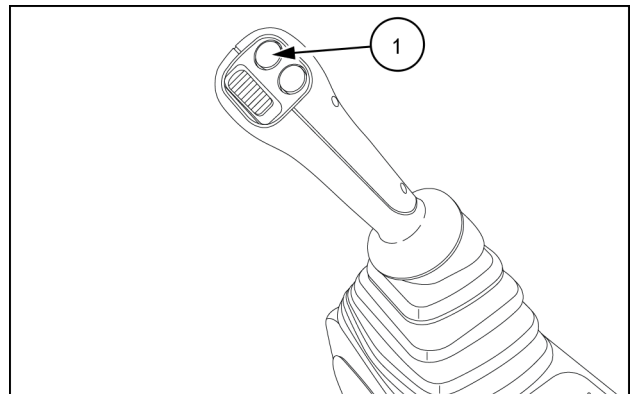

SMIL15CEXZ396AB 16

Quick coupler buckets

CASE CONSTRUCTION quick coupler

CASE CONSTRUCTION can provide a hydraulic quick coupler and a dedicated range of Coupler buckets.

The CASE CONSTRUCTION Coupler buckets are designed to optimize the fitting to the CASE CONSTRUCTION quick coupler, and are designed to optimize the operating performance of the CASE CONSTRUCTION excavators in most of construction works.

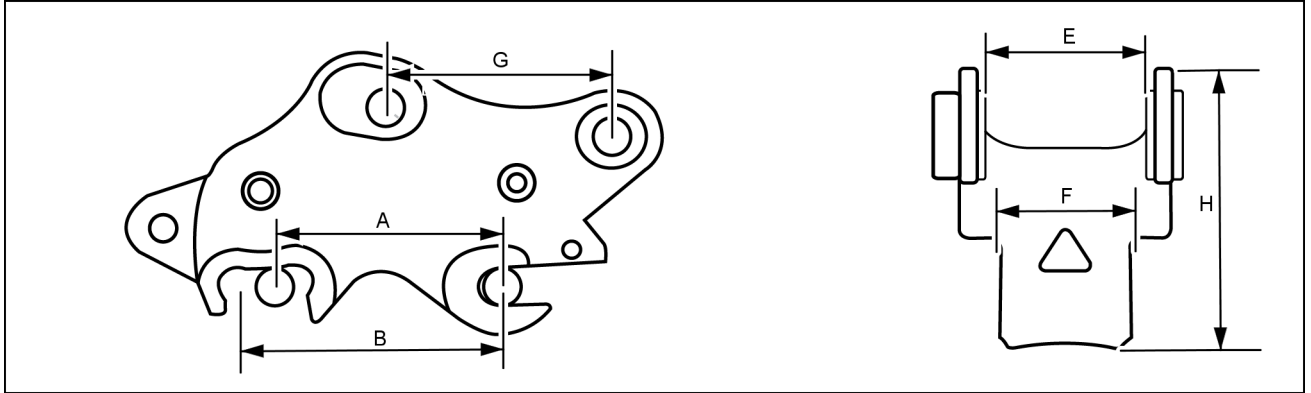

SMIL15CEX3064EA 1

Main dimensions

(E)	255 mm (10 in)
(G)	385 mm (15 in)
(H)	510.5 mm (20.1 in)
Weight	180 kg (397 lb)

NOTICE: usage of buckets other than CASE CONSTRUCTION Coupler buckets is strictly limited to the condition that the bucket hangers match with the dimensions indicated in the table below. Contact your CASE CONSTRUCTION dealer for checking the buckets intended for usage.

Bucket fitting dimensions

Bucket pin diameter	60 mm (2.4 in)	65 mm (2.6 in)
Minimum pin spread (A)	345 mm (13.6 in)	355 mm (14.0 in)
Maximum pin spread (B)	415 mm (16.3 in)	420 mm (16.5 in)
Seating width (F)	230 mm (9.1 in)	

Quick coupler identification plate

The identification plate of the CASE CONSTRUCTION quick coupler is located on the inside of the top hangers.

Serial number:

Weight:

Working pressure:

Type/Model:

Part number:

Year of manufacture:

SWL (Safe Working Load):

Field view monitor

The CASE CONSTRUCTION Field View Monitor (FVM) is a system that ensure proper visibility during operation by displaying a comprehensive visualization of the area around the machine.

The comprehensive visualization is based on the combination of the views of three external cameras: a rear camera (1) installed on the counterweight, a right-side camera (2) installed on the fuel tank, a left-side camera (3) installed above the left-hand door.

NOTICE: Never operate the machine while only looking at the images on the display. Make sure to check the area around the machine by the direct view or through the mirrors.

NOTICE: If any mud, raindrops, snow, etc. are adhered to the camera lens, the images on the display are deteriorated. Wipe away dirt with a wet and soft cloth, and then wipe it with a dry and soft cloth. Make sure not to scratch the cameras.

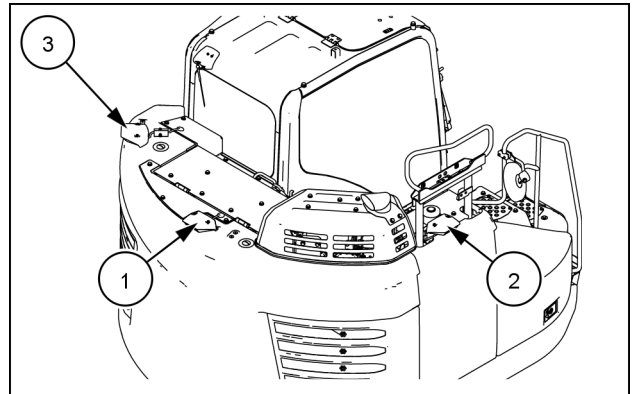

SMIL17CEX3248AA 1

FVM mode of the display

The FVM mode of the display is alternative to the normal operating mode. Press the camera view selector button on the instrument cluster to select the FVM mode. The operating mode of the display toggles every time the button is pressed.

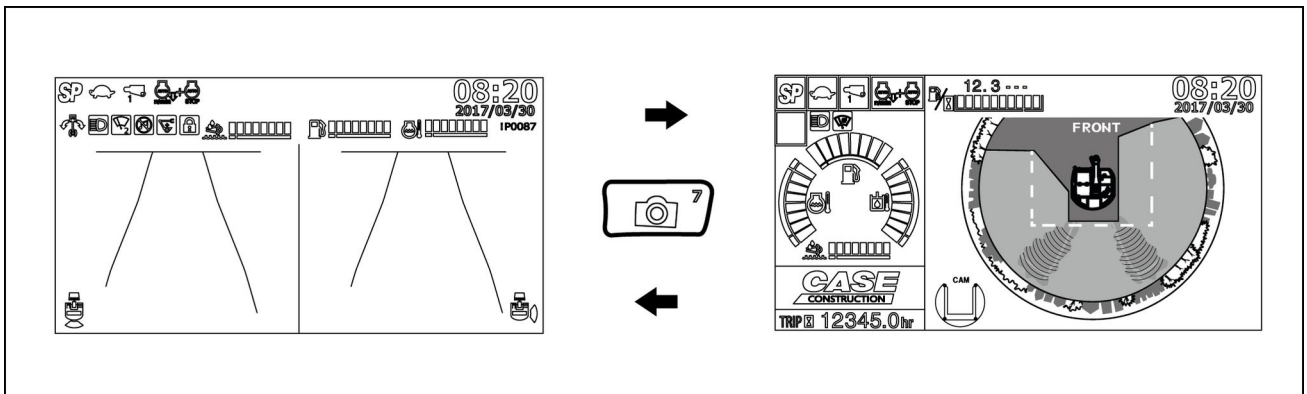

SMIL20CEX0667EA 2

NOTICE: During machine operation, make sure to select either one operating mode of the display in order to ensure proper visibility around the machine. If the display is switched to the user information mode during machine operation, the warning message *SELECT CAMERA SCREEN DURING OPERATION* will appear on the top of the display.

CLICK HERE TO **DOWNLOAD** THE COMPLETE MANUAL

- Thank you very much for reading the preview of the manual.
- You can download the complete manual from: www.heydownloads.com by clicking the link below



- Please note: If there is no response to CLICKING the link, please download this PDF first and then click on it.

CLICK HERE TO **DOWNLOAD** THE COMPLETE MANUAL