

7

2

0



# Operation & Maintenance Manual

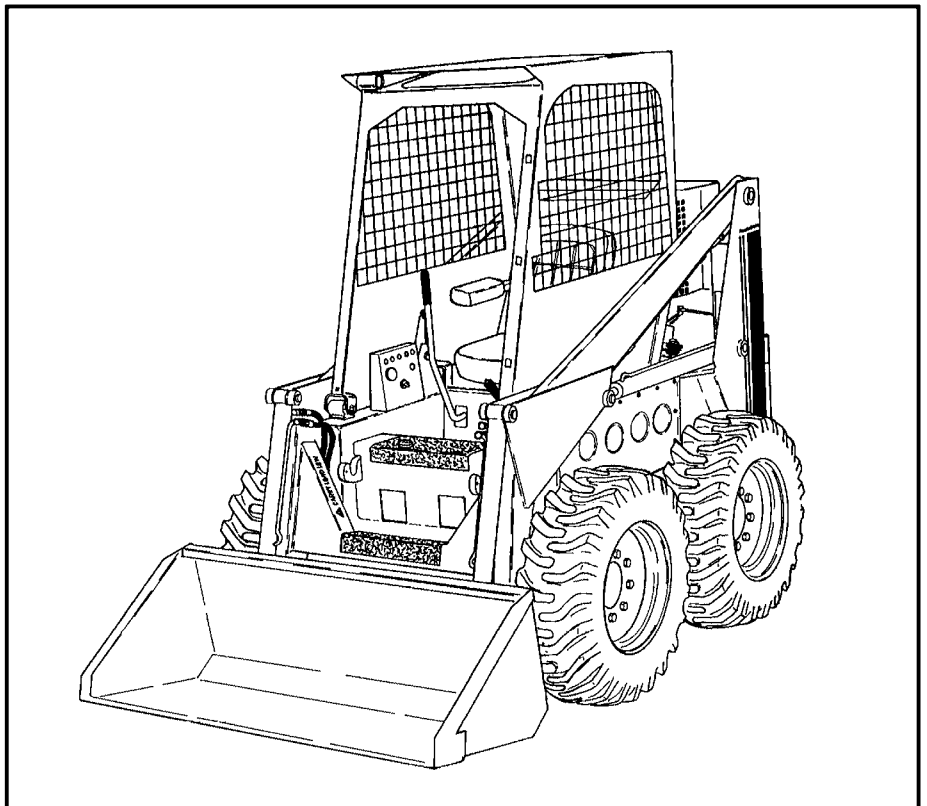

**MELROE**  
**INGERSOLL-RAND**

6549950 (7-78)



Printed in U.S.A.

CLICK HERE TO **DOWNLOAD** THE COMPLETE MANUAL

- Thank you very much for reading the preview of the manual.
- You can download the complete manual from: [www.heydownloads.com](http://www.heydownloads.com) by clicking the link below



- Please note: If there is no response to CLICKING the link, please download this PDF first and then click on it.

CLICK HERE TO **DOWNLOAD** THE COMPLETE MANUAL

## Parking Brake

The parking brake lever (Fig. 6) should be used whenever the Bobcat is stopped and parked and before starting the engine. To set the brake, pull fully back on lever. To release the brake, press down on the button on top of the lever. Always release the brake before operating the loader (Fig. 10).

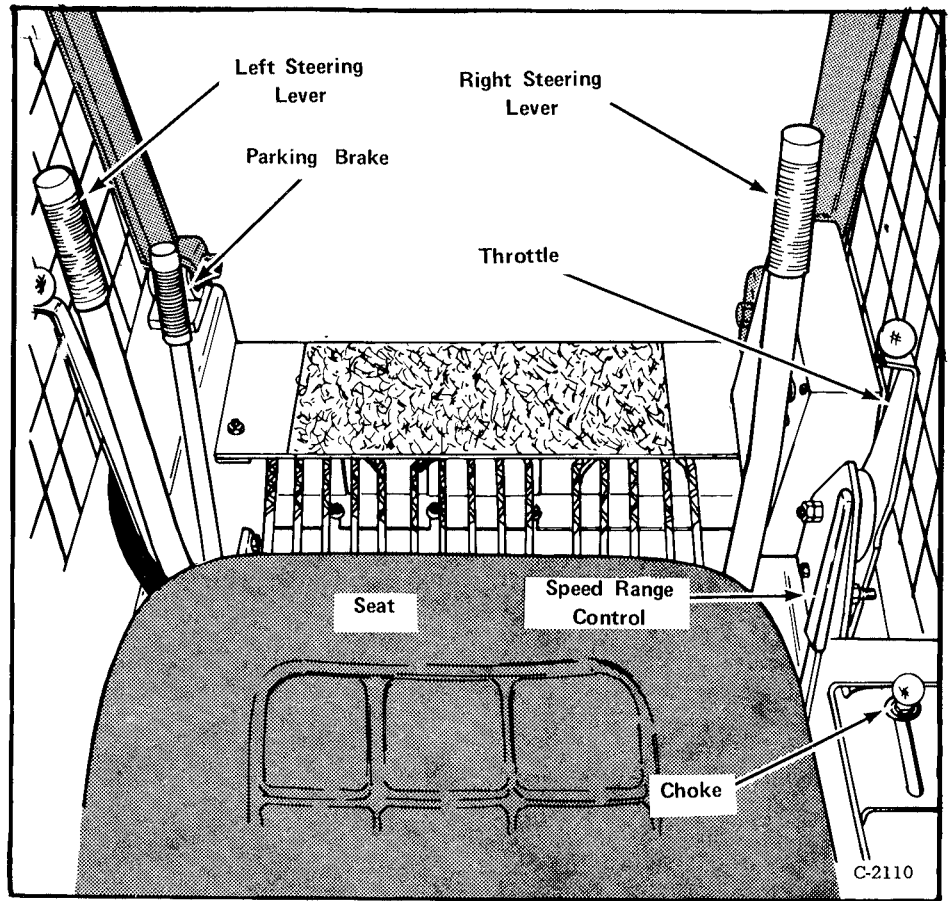
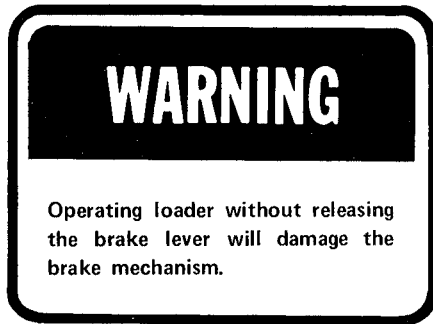

Fig. 6 Operator's Controls

## Steering Controls (Fig. 6)

The steering levers, located to the right and left of the seat (Fig. 6), control the forward, reverse, and turning of the machine. Push both levers ahead for forward travel and pull both levers back for reverse travel (Fig. 7 [A] & [B]).

The machine is steered by moving one of the levers further ahead than the other (Fig. 7). Moving the left lever further ahead than the right will cause the machine to turn to the right (D). Moving the right lever further ahead than the left will cause the machine to turn to the left (C).

By crossing the levers (one forward and one back) the machine will turn in its own track (E & F). This also applies to reverse travel.

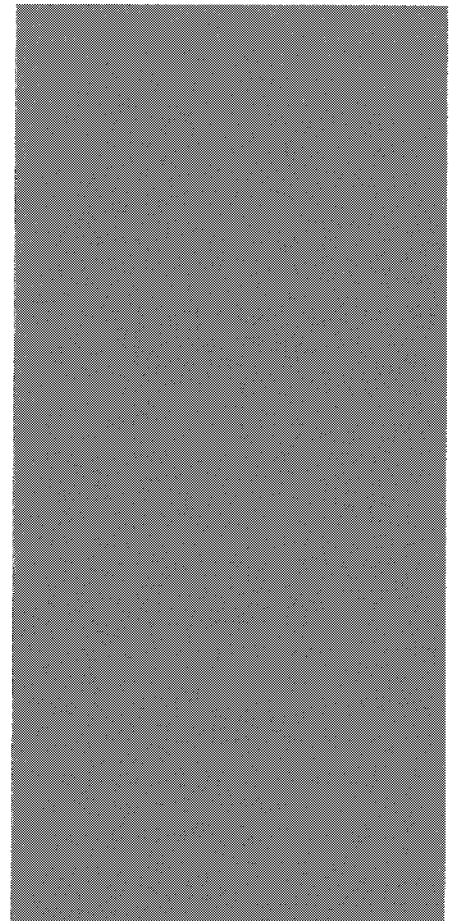

## SERVICE SCHEDULE

Maintenance work must be done at regular intervals. Failure to do so will result in damage to the loader or the engine. The service schedule is a guide for correct maintenance of the Bobcat loader. Do not change from service schedule unless to increase frequency of intervals when the Bobcat loader is operated in very hot, cold, dusty or corrosive conditions.

ITEM	SERVICE REQUIRED	HOURS					
		8-10	50	100	200	250	1000
Engine Air Cleaner	Clean dust cup. Inspect condition of system.	■					
Engine Oil	Check and add as necessary	■					
Engine Cooling System	Inspect and clean oil cooler area as needed.	■					
Tires	Inspect for damage and check tire pressure.	■					
All Pivot Points	Add lubricant to all fittings (12).	■					
Indicators, etc.	Check for correct operation of all indicators, switches, lights.	■					
Operator Guard	Check condition and holding bolts.	■					
Seat Belt	Check condition of straps and buckle.	■					
Safety Decals	Check for missing or damaged decals. Replace as necessary.	■					
Hydraulic Fluid	Check level and add recommended fluid if needed.		■				
Engine Oil & Filter	Replace oil and filter.		■				
Battery	Check water level. Add water if needed.		■				
Alternator V-Belt Freeplay	Check tension, make adjustment for correct freeplay when required.		■				
Drive Chains	Check for play.		■				
Control Pedals & Steering	Check operation. Make repairs and adjustments as needed.		■				
Bob-Tach	Inspect locking levers and wedges for condition and operation. Safety pins must be in place.		■				
Brakes	Check operation. Make repairs as needed.		■				
Transmission Fluid Reservoir	Drain condensation. Check level. Add as required (See page 19 for oil specs).		■				
Transmission Fluid Filter Pressure - (10 Micron)	Replace every 100 hours or when "FILT" light remains lit.			■			
Engine Fuel Filter	Replace element, as required.				■		
Engine Ignition System	Check points and timing. Replace spark plugs. Lubricate felt if needed.				■		
Engine Air Filter System	Inspect system for leaks. Clean or replace element, if needed.				■		
Transmission Fluid Filter Suction - (25 Micron)	Replace filter element.					■	
Starting Motor	Remove, clean and service, as required.						■
Compression	If all cylinders are within 75% of each other, compression is acceptable.						■

## OVERHEATING

If the trans "HOT" temperature warning light comes on during operation of the loader, it is an indication that the transmission fluid is overheating. Loading operation should be stopped and the transmission allowed to cool. Before resuming loader operation determine and correct the cause for high temperature condition. (Low oil level, overloading in high range, overload at low engine RPM or plugged oil cooler core may cause overheating.)

Any maintenance which involves repair or disassembly of the hydrostatic transmission must be accomplished only by an authorized Bobcat dealer.

## QUICK COUPLERS

Lack of proper care of quick couplers often causes hydraulic problems. Connecting dirty couplers puts foreign material directly into the hydraulic system. These particles always find their way into the relief valves, etc.

Protective caps or plugs should always be used when the couplers are separated (Fig. 41).

Before connecting an attachment, always wash or flush both mating points with solvent or hydraulic fluid.

## HYDRAULIC SYSTEM LEAKS

Frequent inspection should be made to detect leaks at tube fittings, hose connections, lift and tilt cylinders, reservoir side covers, filters, etc. A leaking hydraulic system should not be disregarded or allowed to continue unnoticed, even a small leak can amount to a large loss of fluid in a short period of time.

Most leaks are easily repaired, sometimes merely tightening a tube fitting or hose clamp is all that is required. Do not overtighten tube fittings as this can cause a greater leak. A tube fitting that continues to leak after it has been properly tightened should be disconnected and checked for foreign particles or a damaged joint. If the seat is cracked or has deep nicks, the part must be replaced.

"O" ring fittings which leak should be disassembled and a new "O" ring installed. Before installing new "O" rings dip them in hydraulic fluid to lubricate them.

## CONTROL LINKAGE

The steering levers should be firm in handling. Loose levers will cause awkward and difficult loader operation.

If the controls should become loose, tilt the cab to expose the linkage controls. Check the linkage mechanism for loose rollers, brackets or linkage rod swivels and screws. Also check for loose control arms on the pump assembly.

If the machine tends to "creep" when the levers are in neutral, the steering control linkage must be adjusted.

Control linkage adjustment should be accomplished by your Bobcat Service Center.

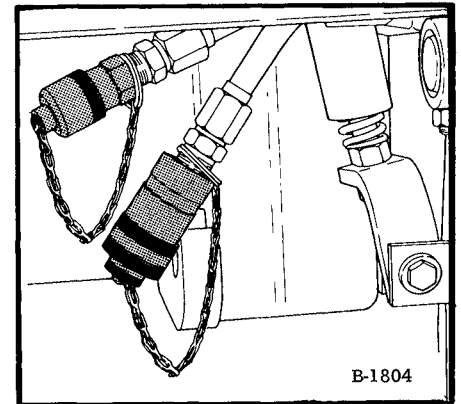
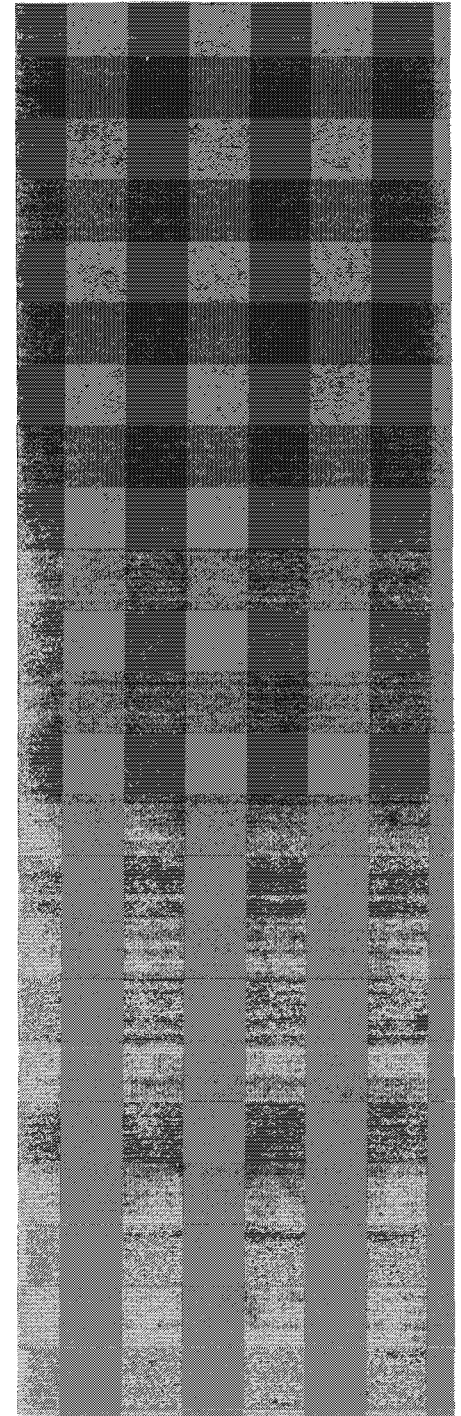
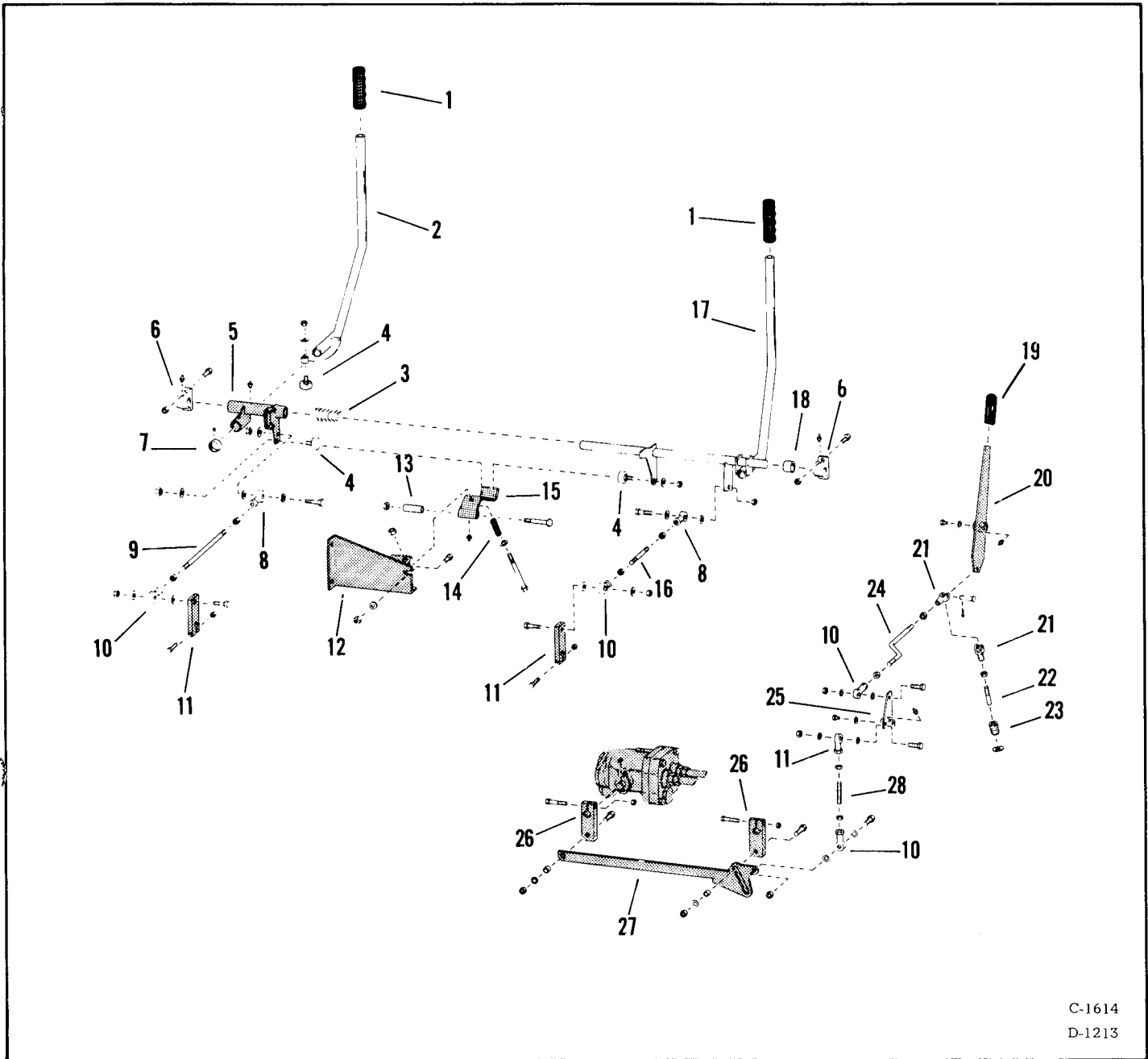

Fig. 41 Quick Couplers



PROBLEM	CAUSE	CORRECTION	PAGE
Acceleration and deceleration sluggish.	Engine lugs down.	See Engine troubleshooting section.	D/S
	Low charge pressure, or internal pump or motor damage.	See "System will not operate in either direction".	D/S
	Air in system.	Locate cause and correct as required.	D/S
System will not operate on one side of machine.	Defective pump or motor.	Replace defective unit.	27
	Broken drive chain.	Repair as necessary.	D/S



C-1614  
D-1213

### TWO-SPEED & STEERING LINKAGE

Ref.	Item	Ref.	Item
1.	Grip, lever	15.	Arm, centering
2.	Lever, steering (L.H.)	16.	Rod, pump linkage
3.	Spring, compression	17.	Pivot, (R.H.)
4.	Follower, cam	18.	Bushing
5.	Pivot	19.	Grip, lever
6.	Clamp, shaft mounting	20.	Lever, control
7.	Collar, locking	21.	Yoke, clevis
8.	Swivel, rod end	22.	Rod, connecting
9.	Rod, pump linkage	23.	Spring, compression
10.	Swivel, rod end	24.	Rod, linkage
11.	Arm, pump control	25.	Plate, pivot
12.	Bracket, pump mounting	26.	Arm, motor
13.	Pin, roll	27.	Cam
14.	Spring, compression	28.	Rod, connector

CLICK HERE TO **DOWNLOAD** THE COMPLETE MANUAL

- Thank you very much for reading the preview of the manual.
- You can download the complete manual from: [www.heydownloads.com](http://www.heydownloads.com) by clicking the link below



- Please note: If there is no response to CLICKING the link, please download this PDF first and then click on it.

CLICK HERE TO **DOWNLOAD** THE COMPLETE MANUAL